

MARKS TWP 29PRAM

Adrian Twp. *Record Subject to Section 53. (all claims)*

THE TOWNSHIP OF

MARKS

DISTRICT OF THUNDER BAY

PORT ARTHUR MINING DIVISION

SCALE: 1-INCH=40 CHAINS

Aldina Twp.

O'Connor Twp.

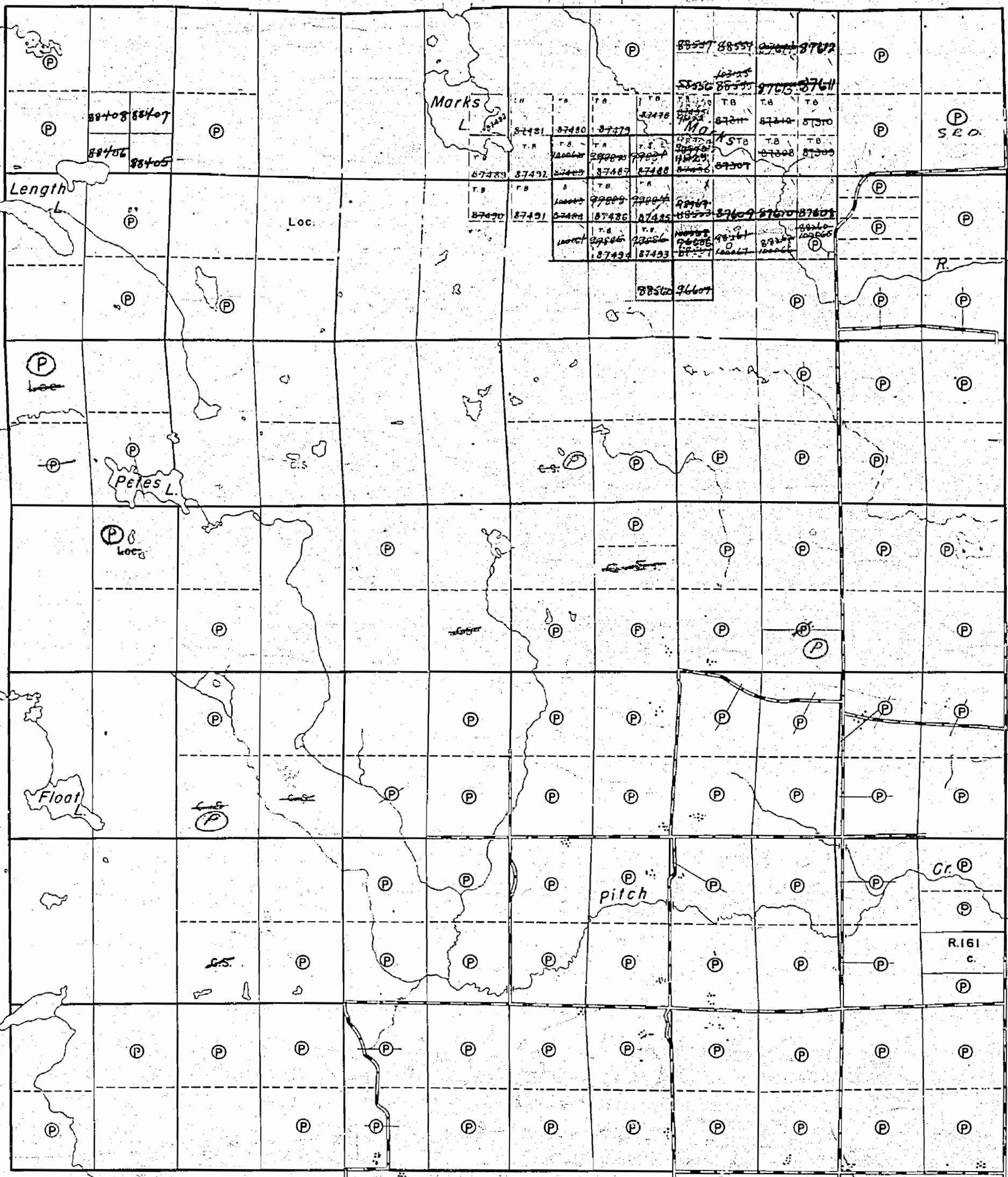

12 11 10 9 8 7 6 5 4 3 2 1

Lybster Twp.

LEGEND

- PATENTED LAND Ⓟ
- CROWN LAND SALE C.S.
- LEASES Ⓞ
- LOCATED LAND Loc.
- LICENSE OF OCCUPATION L.O.
- ROADS — — — — —
- IMPROVED ROADS — — — — —
- KING'S HIGHWAY — — — — —
- RAILWAYS — — — — —
- POWER LINES — — — — —
- MINES ✕
- MARSH OR MUSKEG — — — — —

NOTES

Staking in this Twp. subject to Section 53 of The Mining Act.

1816



1957

PLAN NO. -

DEPARTMENT OF MINES
- ONTARIO -

Adrian Twp.

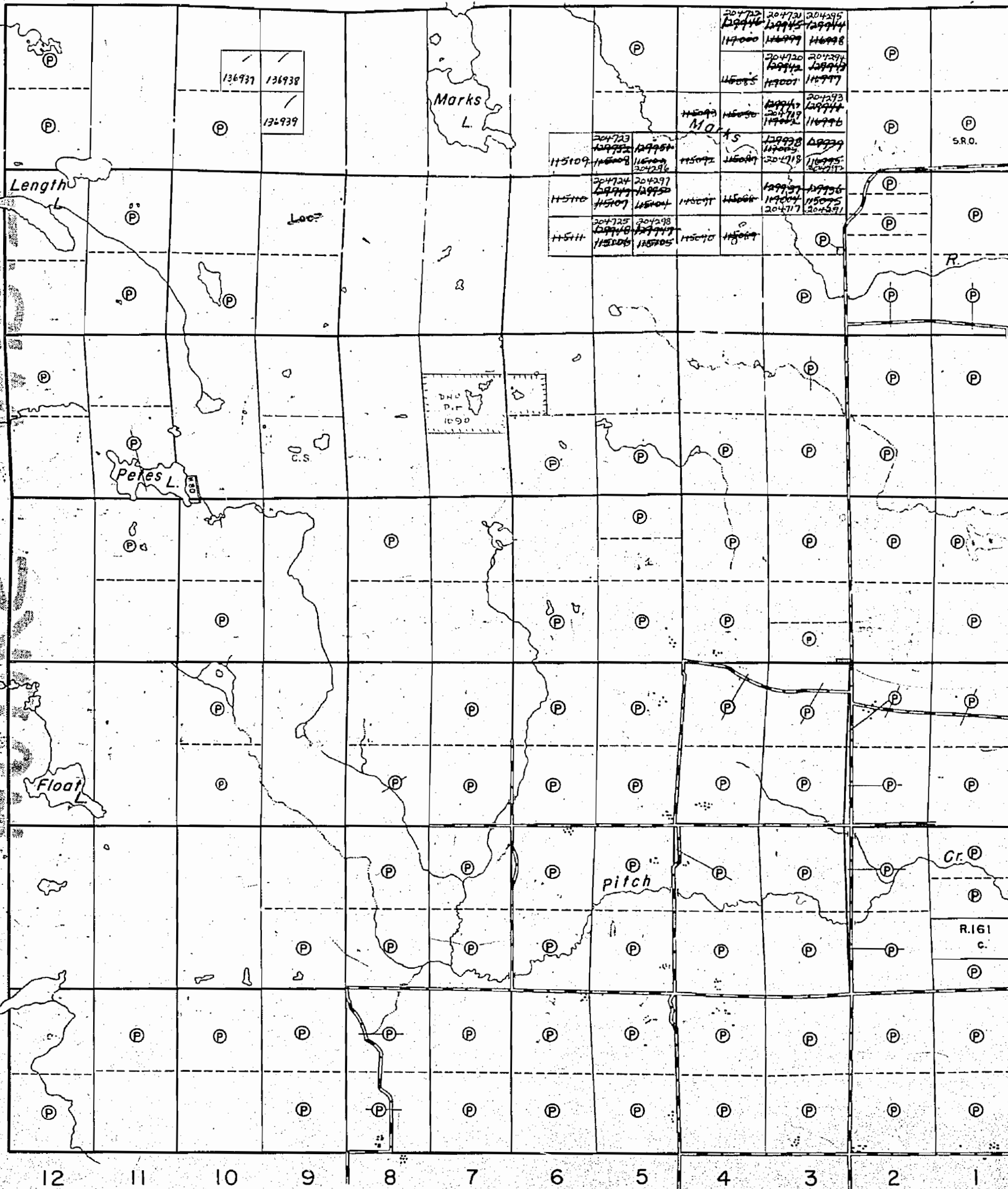

THE TOWNSHIP
OF

MARKS

DISTRICT OF
THUNDER BAY

PORT ARTHUR
MINING DIVISION

SCALE: 1-INCH=40 CHAINS

LEGEND

PATENTED LAND	Ⓟ
CROWN LAND SALE	C.S.
LEASES	Ⓞ
LOCATED LAND	Loc.
LICENSE OF OCCUPATION	L.O.
ROADS	— — — — —
IMPROVED ROADS	— — — — —
KING'S HIGHWAY	— — — — —
RAILWAYS	— — — — —
POWER LINES	— — — — —
MINES	⋈
MARSH OR MUSKEG	⊕

NOTES

Staking in this Twp. subject to Section 53 of
The Mining Act.

1964

PLAN NO. - *M1816*

DEPARTMENT OF MINES
— ONTARIO —

VII

VI

V

IV

III

II

I

O'Connor Twp.

Adrian Twp.

12

11

10

9

8

7

6

5

4

3

2

1

Lybster Twp.

1816

Adrian Twp

THE TOWNSHIP
OF

MARKS

DISTRICT OF
THUNDER BAY

THUNDER BAY
MINING DIVISION

SCALE 1-INCH=40 CHAINS

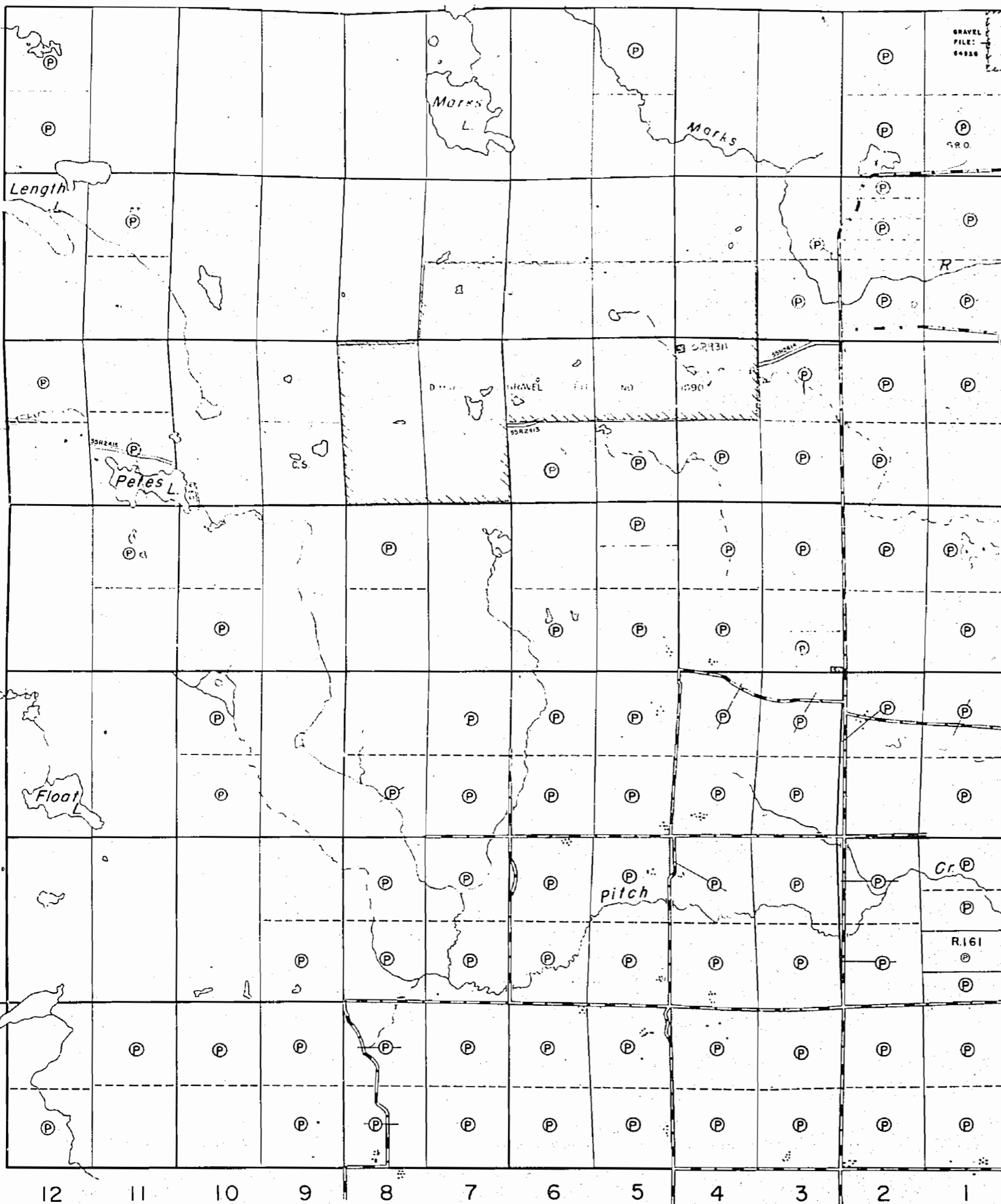

VII

VI

V

IV

III

II

I

O'Conno. Twp.

Aldino Twp.

Strange Twp.

Lybster Twp.

LEGEND

PATENTED LAND	Ⓟ
CROWN LAND SALE	C.S.
LEASES	Ⓛ
LOCATED LAND	Loc.
LICENSE OF OCCUPATION	L.O.
ROADS	—
IMPROVED ROADS	—
KING'S HIGHWAY	—
RAILWAYS	—
POWER LINES	—
MINES	*
MARSH OR MUSKEG	—

NOTES

Staking in this Twp subject to Section 53 of
The Mining Act

1977

JAN. 25/77

THUNDER BAY DIST.

PLAN NO. - M.1816

ONTARIO
MINISTRY OF NATURAL RESOURCES
SURVEYS AND MAPPING BRANCH

REFERENCES

SAND & GRAVEL

- ① GRAVEL FILE: 64936
- ② GRAVEL PIT No. 1090
- ③ GRAVEL FILE: 119558
- ④ M.T.C. PIT No. 2E-36

ADRIAN TWP G-640

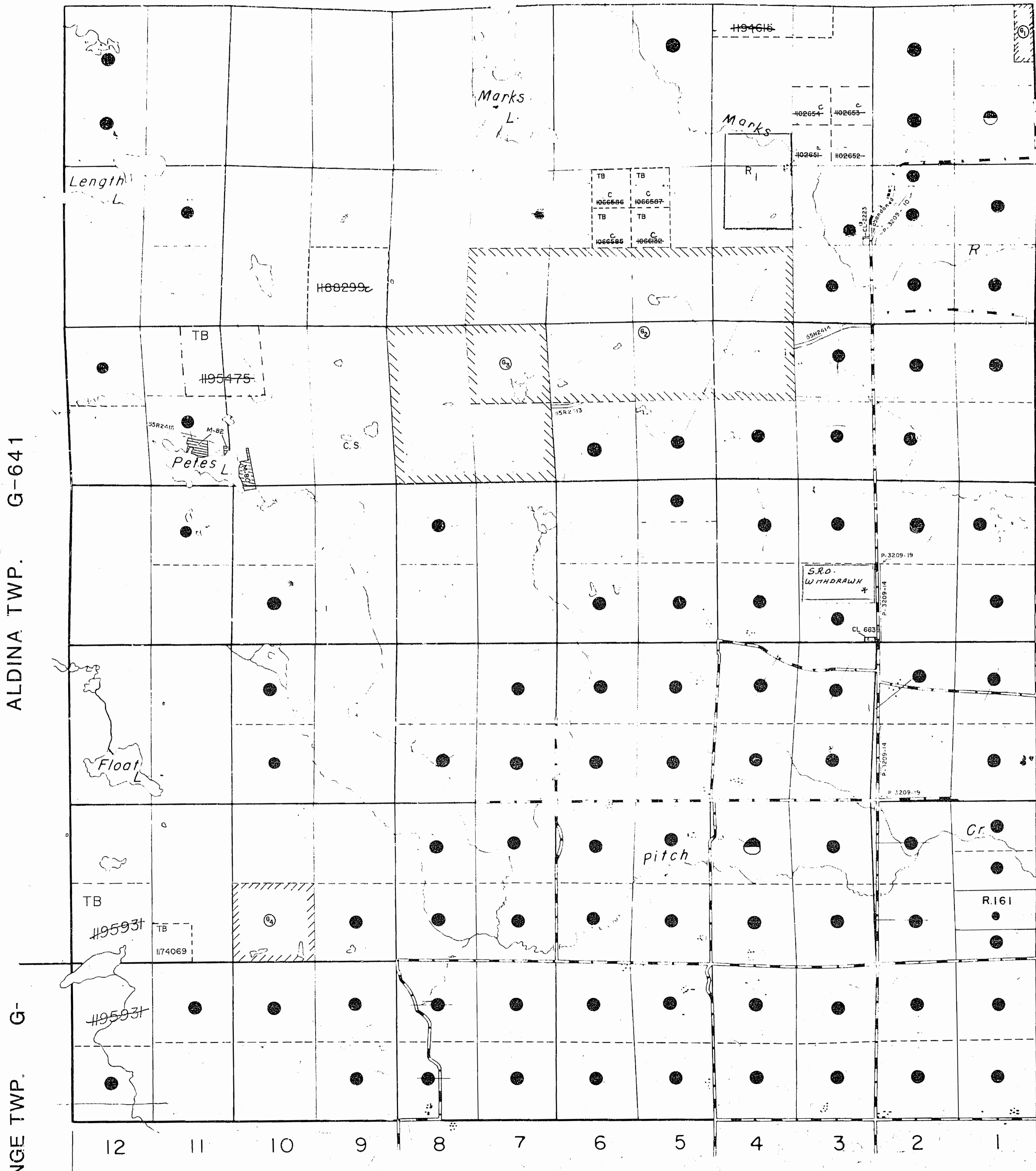

VII
 VI
 V
 IV
 III
 II
 I

ALDINA TWP. G-641
 G-
 STRANGE TWP.

LYBSTER TWP G-671

REFERENCES

Description	Order NO	Date	Disposition
R1 WASTE DISPOSAL SITE	W-TB-33/91	NOV/19/91	S.R.O.
	MARKSTWP.LAND ROLL		

Thunder Bay Mining Division
 MAY 22 1996
 RECEIVED

LEGEND

HIGHWAY AND ROUTE No	
OTHER ROADS	
TRAILS	
SURVEYED LINES	
TOWNSHIP'S, BASE LINES ETC	
LOTS, MINING CLAIMS, PARCELS ETC	
UNSURVEYED LINES	
LOT LINES	
PARCEL BOUNDARY	
MINING CLAIMS ETC	
RAILWAY AND RIGHT OF WAY	
UTILITY LINES	
NON-PERENNIAL STREAM	
FLOODING OR FLOODING RIGHTS	
SUBDIVISION OF COMPOSITE PLAN	
RESERVATION	
ORIGINAL SHOW LINES	
MARSH OR MUD FLAT	
MINES	
TRAVERSE MARKS	
LAND USE PERMITS FOR COMMERCIAL TOURISM, OUTPOST CAMPS, ETC	

DISPOSITION OF CROWN LANDS

TYPE OF DOCUMENT	SYMBOL
PATENT, SURFACE & MINING RIGHTS	
" SURFACE RIGHTS ONLY	
" MINING RIGHTS ONLY	
LEASE, SURFACE & MINING RIGHTS	
" SURFACE RIGHTS ONLY	
" MINING RIGHTS ONLY	
LICENCE OF OCCUPATION	
ORDER-IN-COUNCIL	
RESERVATION	
CANCELLED	
SAND & GRAVEL	

* See Fall Camp Lake Area Landroll WNCR 10/83
 NOTE: MINING RIGHTS IN PART OF THIS TWP. PATENTED PRIOR TO MAY 6, 1913, VESTED IN ORIGINAL PATENTEE BY THE PUBLIC LANDS ACT, R.S.O. 1911, CAP. 380, SEC. 63 SUBSEC. 1.

SCALE 1 INCH = 40 CHAINS

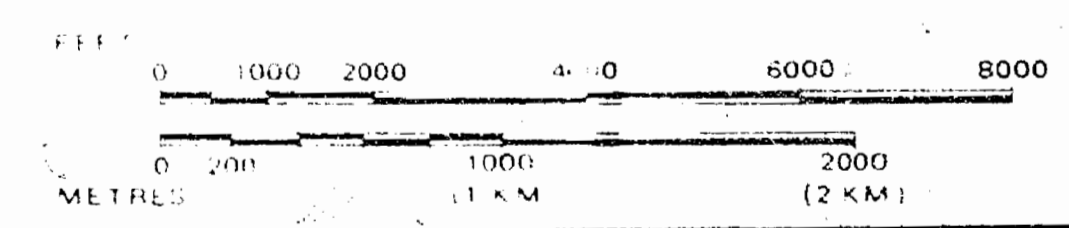

TOWNSHIP

MARKS

M.N.R. ADMINISTRATIVE DISTRICT
THUNDER BAY
 MINING DIVISION
THUNDER BAY
 LAND TITLES / REGISTRY DIVISION
THUNDER BAY

Ministry of Natural Resources
 Land Management Branch

Date MARCH, 1982
 Number **G-673**

MAY 22, 1996
 G-673

(M 79)

1572

(12/49/86)

PLAN #673 OF THE TOWNSHIP OF MARKS

IN THE DISTRICT OF THUNDERBAY SCALE 1 INCH = FORTY CHAINS

M. J. Butler
P. S.
Kapmanee
Sept. 30
1886



110485 11100 20548
1111111 242
1111111 20548

UNSURVEYED

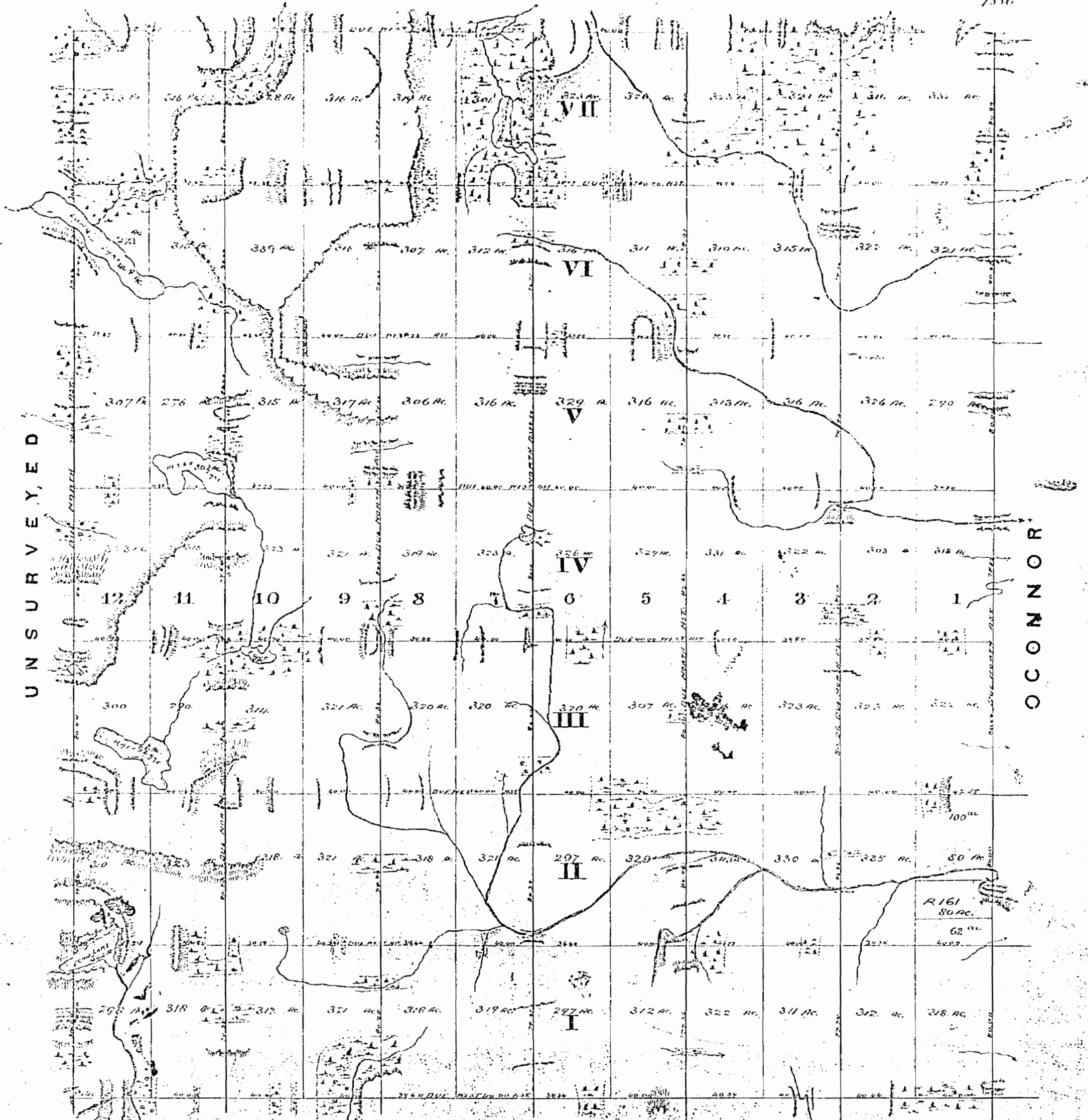

Examined with Returns Nov 9th 1886. C.R.
Copied by Registrar - January 1887.
Returned to Sales Branch, October 1897. C.R.
Imagery prepared for the City of Thunder Bay

LYBSTER

REFERENCES

SAND & GRAVEL

- ① GRAVEL FILE: 64936
- ② GRAVEL PIT No. 1090
- ③ GRAVEL FILE: 119558
- ④ M.T.C. PIT No. 2E-36

ADRIAN TWP G-640

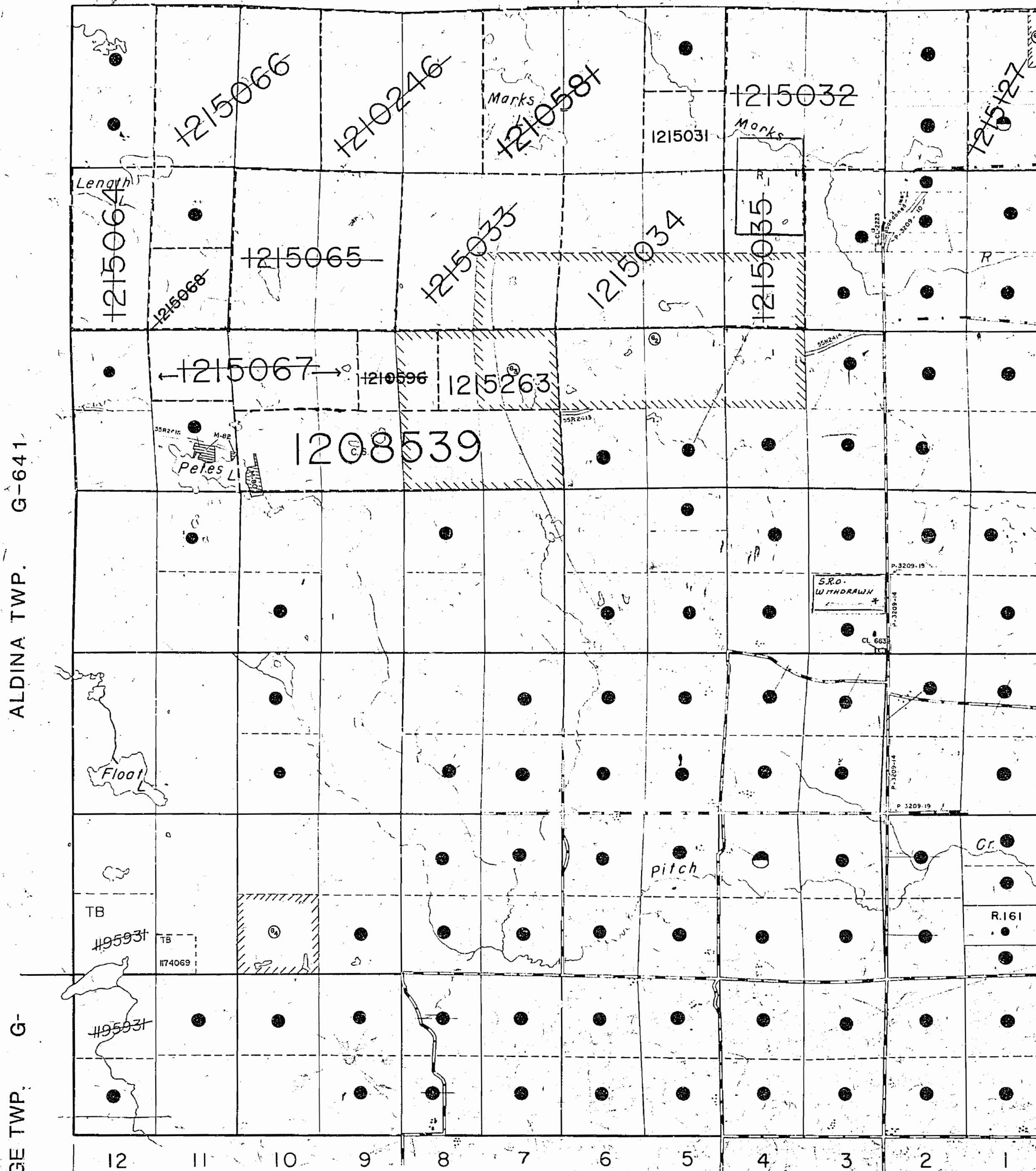

VII
VI
V
IV
III
II
I

O'CONNOR TWP G-

REFERENCES

Description	Order No.	Date	Disposition
RI WASTE	W-TB-33791	Nov/1979	S.R.O.
DISPOSAL SITE			MARKSTW/PLAND ROLL

LEGEND

HIGHWAY AND ROUTE No.	
OTHER ROADS	
TRAILS	
SURVEYED LINES	
TOWNSHIPS, BASE LINES, ETC.	
LOTS, MINING CLAIMS, PARCELS ETC.	
UNSURVEYED LINES	
LOT LINES	
PARCEL BOUNDARY	
MINING CLAIMS ETC.	
RAILWAY AND RIGHT OF WAY	
UTILITY LINES	
NON-PERENNIAL STRIP	
FLOODING OR FLOODING RIGHTS	
SUBDIVISION OR COMPOSITE PLAN	
RESERVATIONS	
ORIGINAL SHORLINE	
MARSH OR MUSKEL	
MINES	
TRAVERSE MONUMENT	
LAND USE PERMITS FOR COMMERCIAL TOURISM/OUTPOST CAMPS	

DISPOSITION OF CROWN LANDS

TYPE OF DOCUMENT	SYMBOL
PATENT, SURFACE & MINING RIGHTS	
" SURFACE RIGHTS ONLY	
" MINING RIGHTS ONLY	
LEASE, SURFACE & MINING RIGHTS	
" SURFACE RIGHTS ONLY	
" MINING RIGHTS ONLY	
LICENCE OF OCCUPATION	
ORDER-IN-COUNCIL	
RESERVATION	
CANCELLED	
SAND & GRAVEL	

* See following table for general notes 10/85
NOTE: MINING RIGHTS IN PARCEL PATENTED PRIOR TO MAY 6, 1913, VESTED IN ORIGINAL PATENTEE BY THE PUBLIC LANDS ACT, R.S.O. 1913, CAP. 380, SEC. 63, SUBSEC. 1.

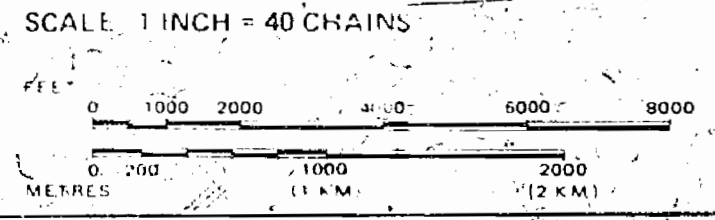

TOWNSHIP

MARKS

M.N.R. ADMINISTRATIVE DISTRICT
THUNDER BAY
MINING DIVISION
THUNDER BAY
LAND TITLES / REGISTRY DIVISION
THUNDER BAY

Ministry of Land Management
Natural Resources Branch
Ontario

Date: JUNE 3, 1982

Date: MARCH, 1982 / Number: **G-673**

Adrian Twp

THE TOWNSHIP OF
OF
MARKS
DISTRICT OF
THUNDER BAY
THUNDER BAY
MINING DIVISION
SCALE 1-INCH=40 CHAINS

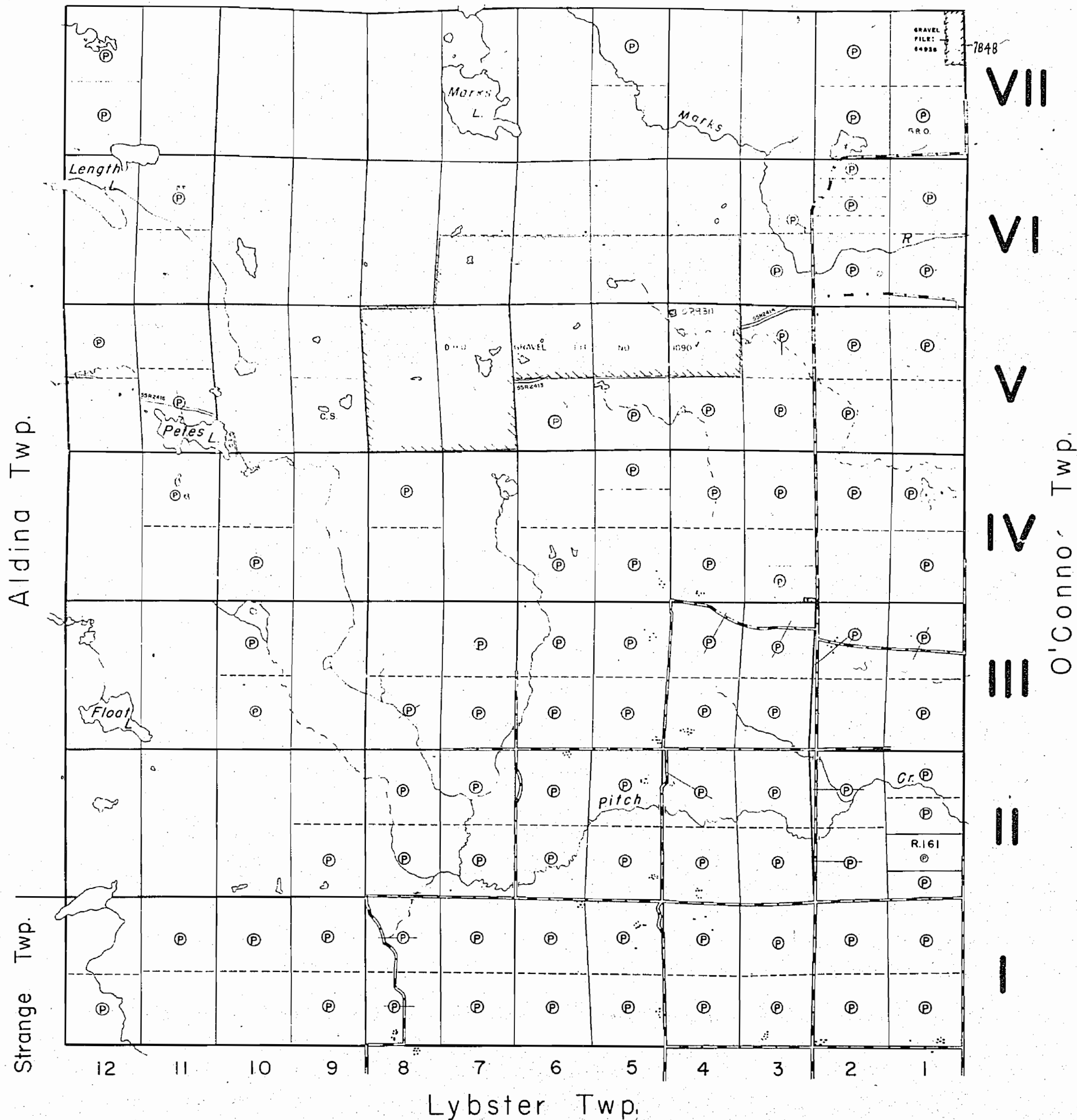

LEGEND

PATENTED LAND	Ⓟ
CROWN LAND SALE	C.S.
LEASES	Ⓛ
LOCATED LAND	Loc.
LICENSE OF OCCUPATION	L.O.
ROADS	—
IMPROVED ROADS	—
KING'S HIGHWAY	—
RAILWAYS	—
POWER LINES	—
MINES	X
MARSH OR MUSKEG	⊖

NOTES
Staking in this Twp subject to Section 53 of
The Mining Act

1977

JAN. 25/77
THUNDER BAY DIST.
PLAN NO. - M.1816
ONTARIO
MINISTRY OF NATURAL RESOURCES
SURVEYS AND MAPPING BRANCH

Adrian Twp.

THE TOWNSHIP OF
OF

MARKS

DISTRICT OF
THUNDER BAY

PORT ARTHUR
MINING DIVISION

SCALE: 1-INCH=40 CHAINS

LEGEND

PATENTED LAND	Ⓟ
CROWN LAND SALE	C.S.
LEASES	Ⓛ
LOCATED LAND	Loc.
LICENSE OF OCCUPATION	L.O.
ROADS	— — — — —
IMPROVED ROADS	— — — — —
KING'S HIGHWAY	— — — — —
RAILWAYS	— — — — —
POWER LINES	— — — — —
MINES	Ⓧ
MARSH OR MUSKEG	Ⓜ

NOTES

Staking in this Twp. subject to Section 53 of
The Mining Act.

1964

PLAN NO. - *M/1316*

DEPARTMENT OF MINES
— ONTARIO —

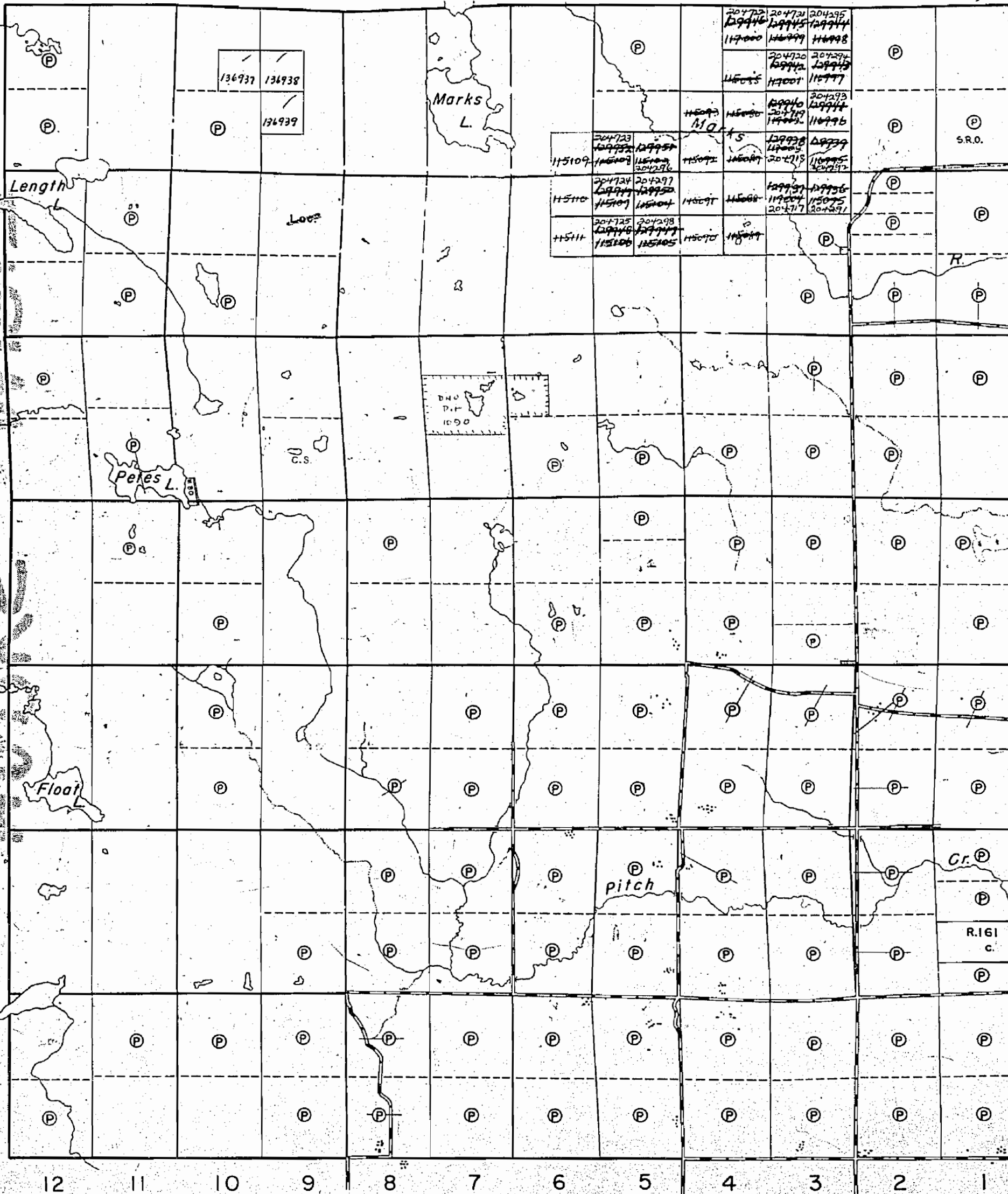

VII
VI
V
IV
III
II
I
O'Connor Twp.

Aiding Twp.

Lybster Twp.

1816

Adrian Twp.

Record Subject to Section 53 (all claims)

THE TOWNSHIP OF OF

MARKS

DISTRICT OF THUNDER BAY

PORT ARTHUR MINING DIVISION

SCALE: 1-INCH=40 CHAINS

Aldina Twp.

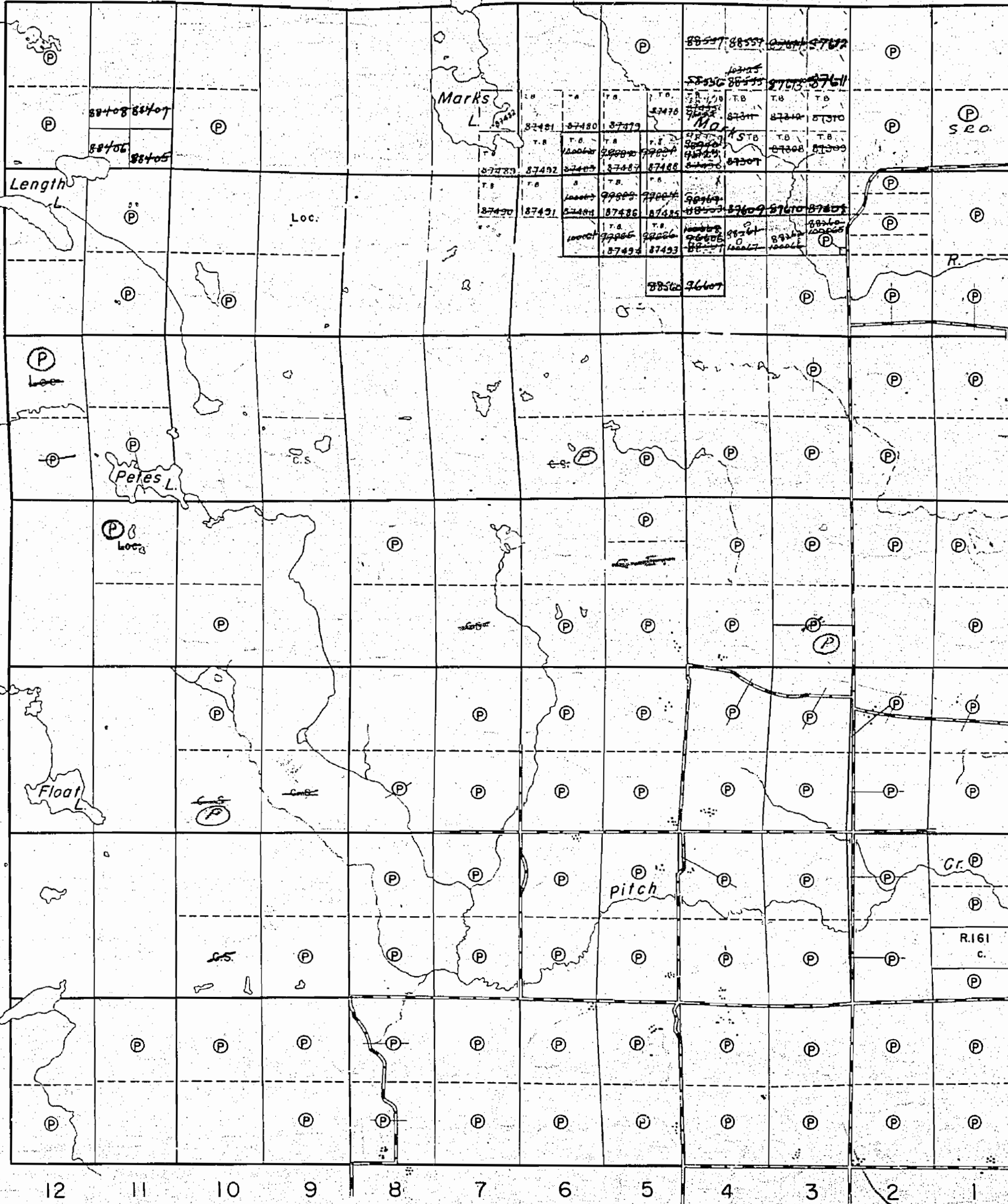

VII

VI

V

IV

III

II

I

O'Connor Twp.

LEGEND

- PATENTED LAND ⊙
- CROWN LAND SALE ⊙
- LEASES ⊙
- LOCATED LAND ⊙
- LICENSE OF OCCUPATION ⊙
- ROADS — — — — —
- IMPROVED ROADS — — — — —
- KING'S HIGHWAY — — — — —
- RAILWAYS — — — — —
- POWER LINES — — — — —
- MINES ⊙
- MARSH OR MUSKEG ⊙

NOTES

Staking in this Twp. subject to Section 53 of The Mining Act.

1816



1957

PLAN NO. -

DEPARTMENT OF MINES - ONTARIO -

MARKS

1816

Subject to Sec 53

Adrian Twp.

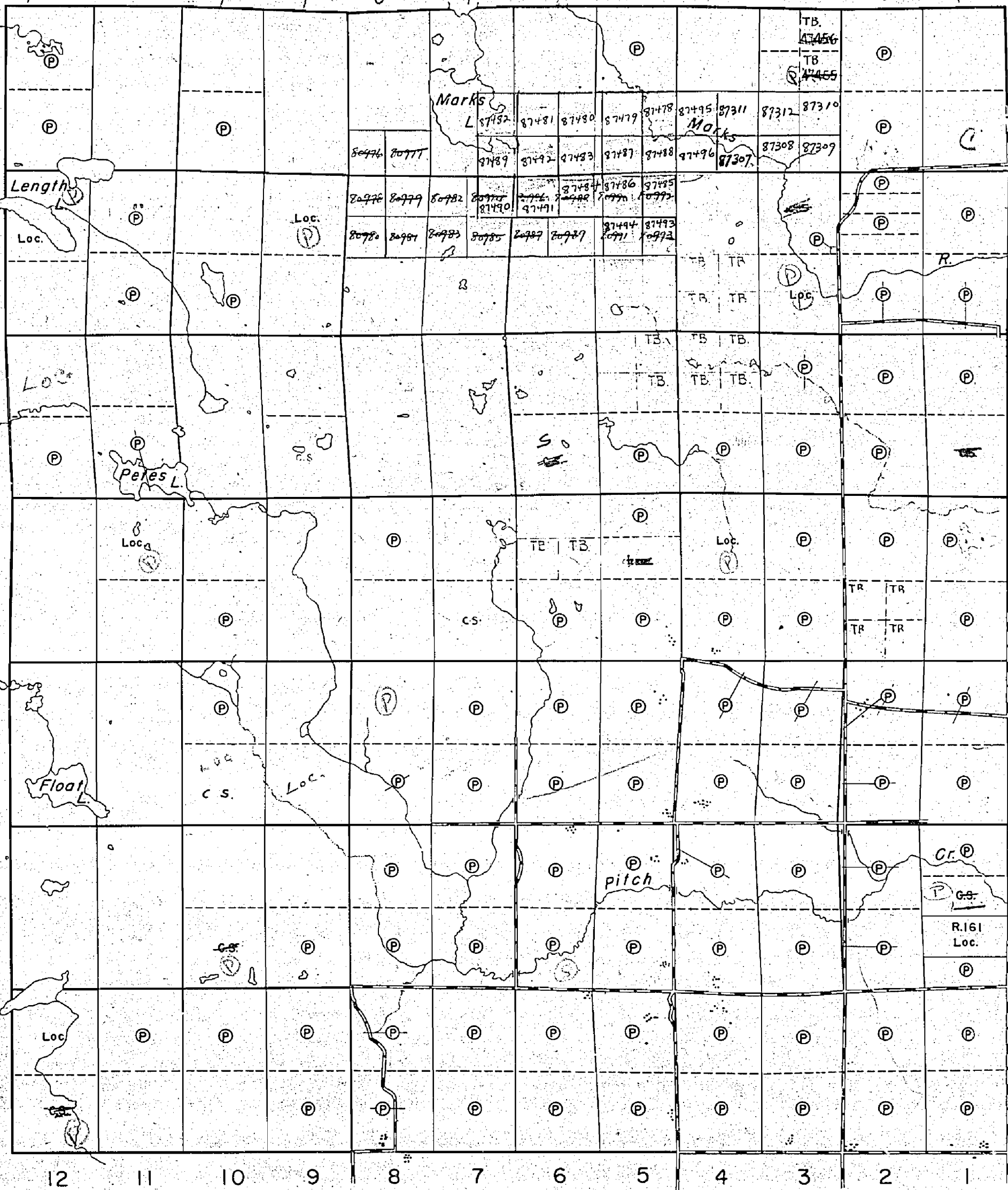

VII

VI

V

IV

III

II

I

O'Connor Twp.

THE TOWNSHIP OF OF

MARKS

DISTRICT OF THUNDER BAY

PORT ARTHUR MINING DIVISION

SCALE: 1-INCH=40 CHAINS

LEGEND

PATENTED LAND	⊕
CROWN LAND SALE	C.S.
LEASES	⊙
LOCATED LAND	Loc.
LICENSE OF OCCUPATION	L.O.
ROADS	—
IMPROVED ROADS	—
KING'S HIGHWAY	—
RAILWAYS	—
POWER LINES	—
MINES	⋈
MARSH OR MUSKEG	—

NOTES

Subject to Sec 53

M1816
1955

PLAN NO. -

DEPARTMENT OF MINES
- ONTARIO -

Aldina Twp.

Lybster Twp.

1816

MARKS

SURVEYED BY M.J. BUTLER, P.L.S.

1886

Scale, 40 CHS =

T.B.	4445
T.A.	4446
T.B.	4447
T.A.	4448

4460 is now
TP 4709

T.B.	T.A.	T.B.	T.A.	T.B.	T.P.
4445	4446	4447	4448	4449	4450
4451	4452	4453	4454	4455	4456
4457	4458	4459	4460	4461	4462

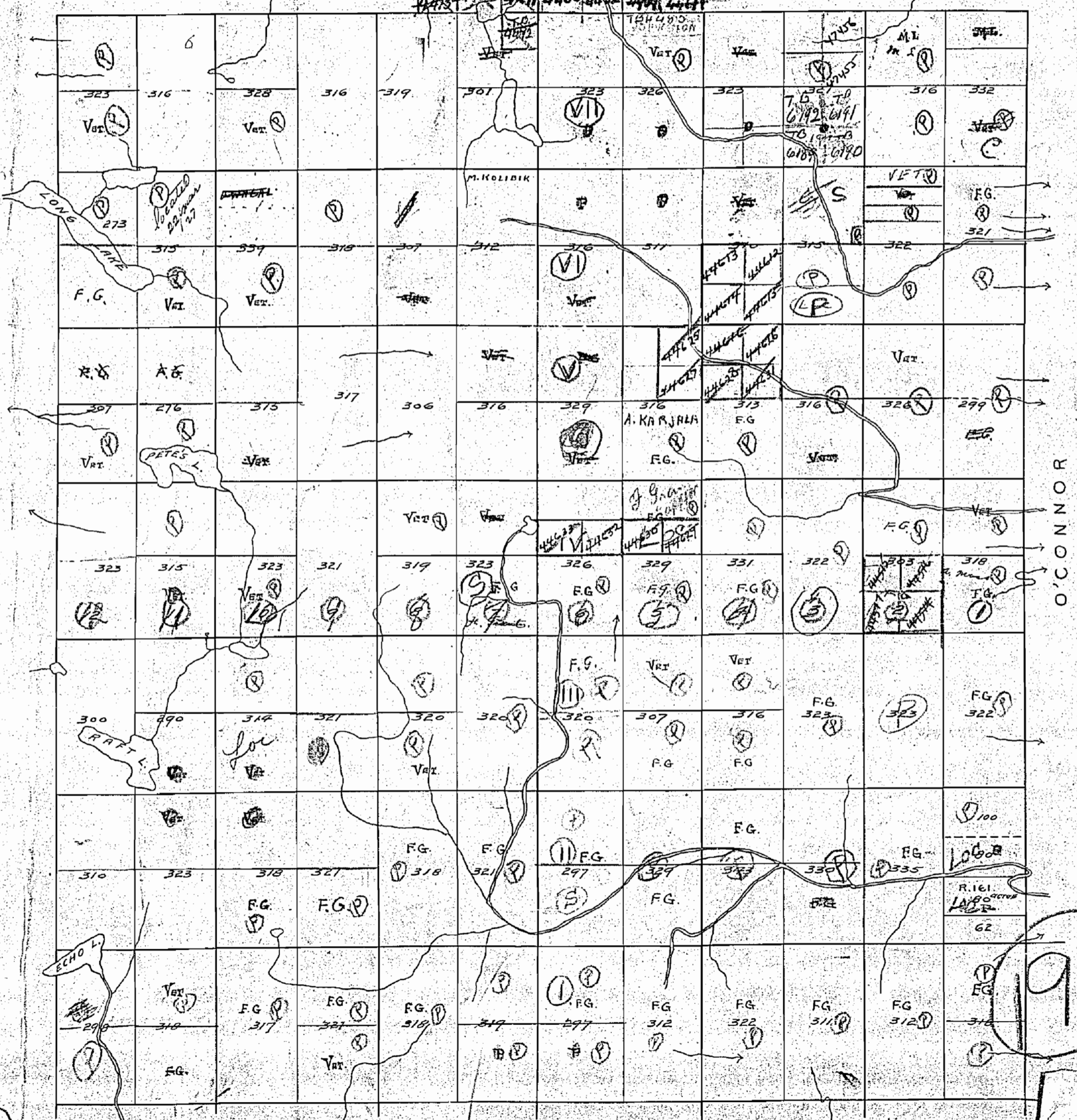

OCCONOR

LYBSTER

REFERENCES

SAND & GRAVEL

- ① GRAVEL FILE: 64936
- ② GRAVEL PIT No. 1090
- ③ GRAVEL FILE: 119558
- ④ M.T.C. PIT No. 2E-36

ADRIAN TWP G-640

ALDINA TWP. G-641

STRANGE TWP. G-

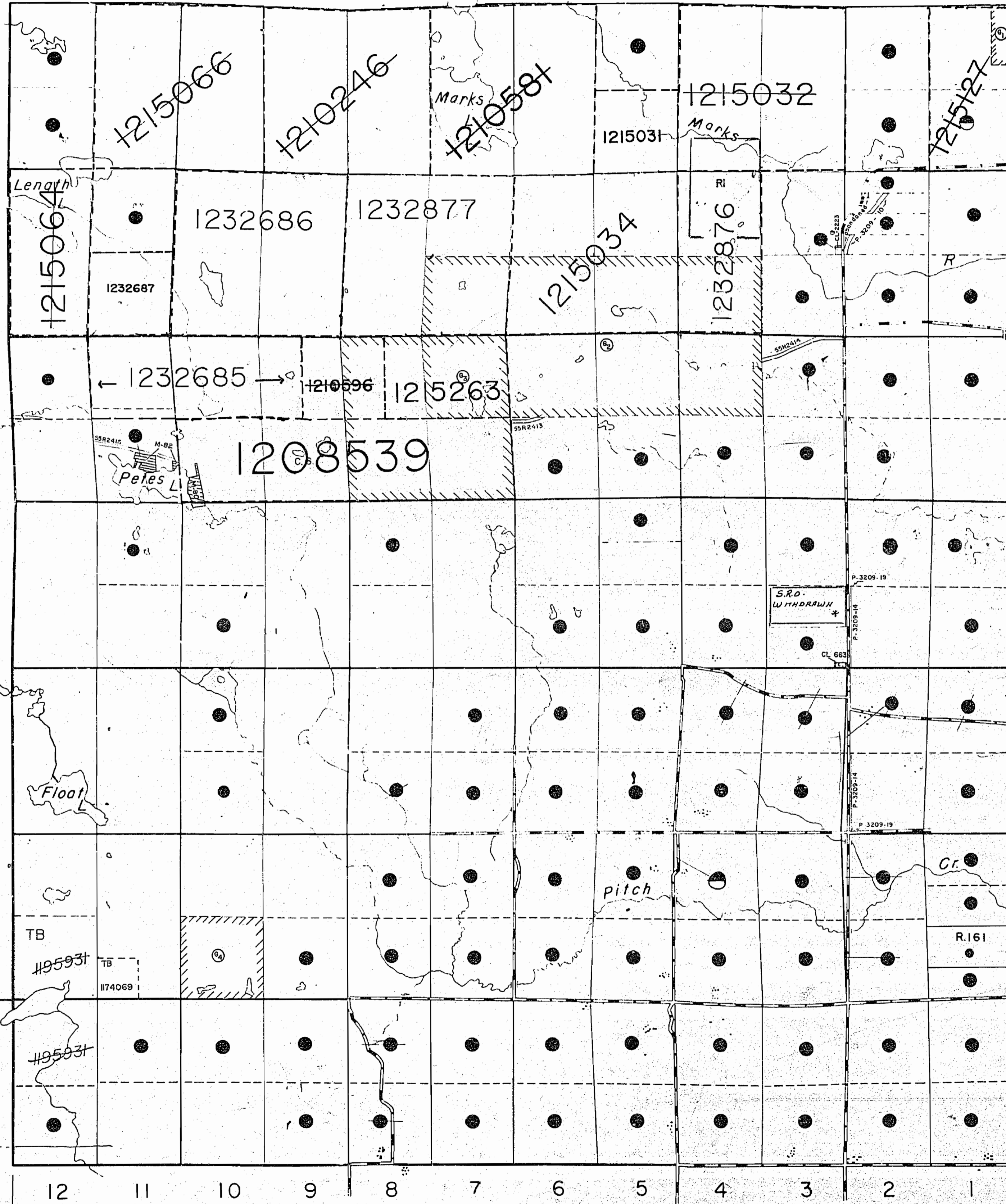

12 11 10 9 8 7 6 5 4 3 2 1

LYBSTER TWP G- 671

VII

VI

V

IV

III

II

I

O,CONNOR TWP G-

REFERENCES

Description	Order NO	Date	Disposition
WASTE DISPOSAL SITE	W-TB-33/91	NOV/19/91	S.R.O.
		MARKSTWPLAND ROLL	

LEGEND

HIGHWAY AND ROUTE No.	
OTHER ROADS	
TRAILS	
SURVEYED LINES:	
TOWNSHIPS, BASE LINES, ETC.	
LOTS, MINING CLAIMS, PARCELS, ETC.	
UNSURVEYED LINES:	
LOT LINES	
PARCEL BOUNDARY	
MINING CLAIMS ETC.	
RAILWAY AND RIGHT OF WAY	
UTILITY LINES	
NON-PERENNIAL STREAM	
FLOODING OR FLOODING RIGHTS	
SUBDIVISION OF COMPOSITE PLAN	
RESERVATIONS	
ORIGINAL SHORELINE	
MARSH OR MUSKIEG	
MINES	
TRAVERSE MONUMENT	
LAND USE PERMITS FOR COMMERCIAL TOURISM/OUTPOST CAMPS	

DISPOSITION OF CROWN LANDS

TYPE OF DOCUMENT	SYMBOL
PATENT, SURFACE & MINING RIGHTS	
" SURFACE RIGHTS ONLY	
" MINING RIGHTS ONLY	
LEASE, SURFACE & MINING RIGHTS	
" SURFACE RIGHTS ONLY	
" MINING RIGHTS ONLY	
LICENCE OF OCCUPATION	
ORDER-IN-COUNCIL	
RESERVATION	
CANCELLED	
SAND & GRAVEL	

5000 Lake Area, Thunder Bay, ON, 10/83
 NOTE: MINING RIGHTS IN PARCELS PATENTED PRIOR TO MAY 5, 1913, VESTED IN ORIGINAL PATENTEE BY THE PUBLIC LANDS ACT, R.S.O. 1970, CAP. 380, SEC. 63, SUBSEC. 1.

SCALE 1 INCH = 40 CHAINS

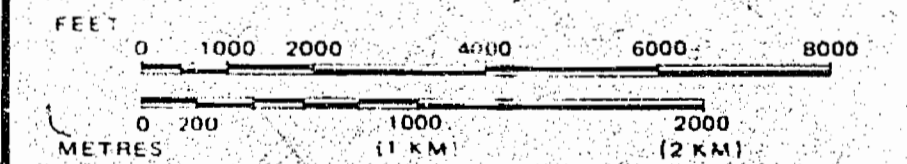

TOWNSHIP

MARKS

M.N.R. ADMINISTRATIVE DISTRICT
THUNDER BAY
 MINING DIVISION
THUNDER BAY
 LAND TITLES / REGISTRY DIVISION
THUNDER BAY

Ministry of Natural Resources
 Land Management Branch
 Ontario

Date MARCH, 1982

Number
G-673

