

TWP. 25-R.12

THE TOWNSHIP OF
OF

MARNE

DISTRICT OF
ALGOMA

SAULT STE. MARIE
MINING DIVISION

SCALE: 1-INCH=40 CHAINS

LEGEND

PATENTED LAND	Ⓟ
CROWN LAND SALE	Ⓢ
LOCATED LAND	Loc.
LICENSE OF OCCUPATION	L.O.
LEASES	Ⓛ
ROADS	—+—+—+—+—
IMPROVED ROADS	—+—+—+—+—
RAILWAYS	—+—+—+—+—
POWER LINES	—+—+—+—+—
MARSH OR MUSKEG	Ⓜ

NOTES

THIS TWP. WAS FORMERLY LISTED AS TWP.25-R.11
 PARCEL NOS. - 755, 1779, 1825, 2620, GRANTED
 BY A.C. & H.B. RLY. PRIOR TO CROWN CONTROL

400' surface rights reservation around all
 lakes & rivers.

MINING CLAIMS BROUGHT TO LEASE IN HATCHED AREA
 ARE SUBJECT TO THE LIMITATIONS & RESERVATIONS
 (TIMBER, RIGHTS, RY, R/W, ETC.) EXPRESSED IN PARCEL 51
 S.N.S. TO ALGOMA CENTRAL RAILWAY, REF. NO. 63056
 C.L.S. FILE NO 1492G1

*CLAIMS ACCEPTABLE IN THIS TWP.
 LOT 7 CAN. W. WEST LINE AMENDED
 according to J. Mans. W. F. 1965.
 Part of this town is covered by
 Unexp. Pit Permit #12206 W. &
 Canada Ltd. (see file for details)*

VI

V

IV

III

II

I

TWP. 24-R.11

DATE OF ISSUE

APR 29 1964

SAULT STE. MARIE
MINING RECORDER'S OFFICE

PLAN NO.- M-1305

DEPARTMENT OF MINES
- ONTARIO -

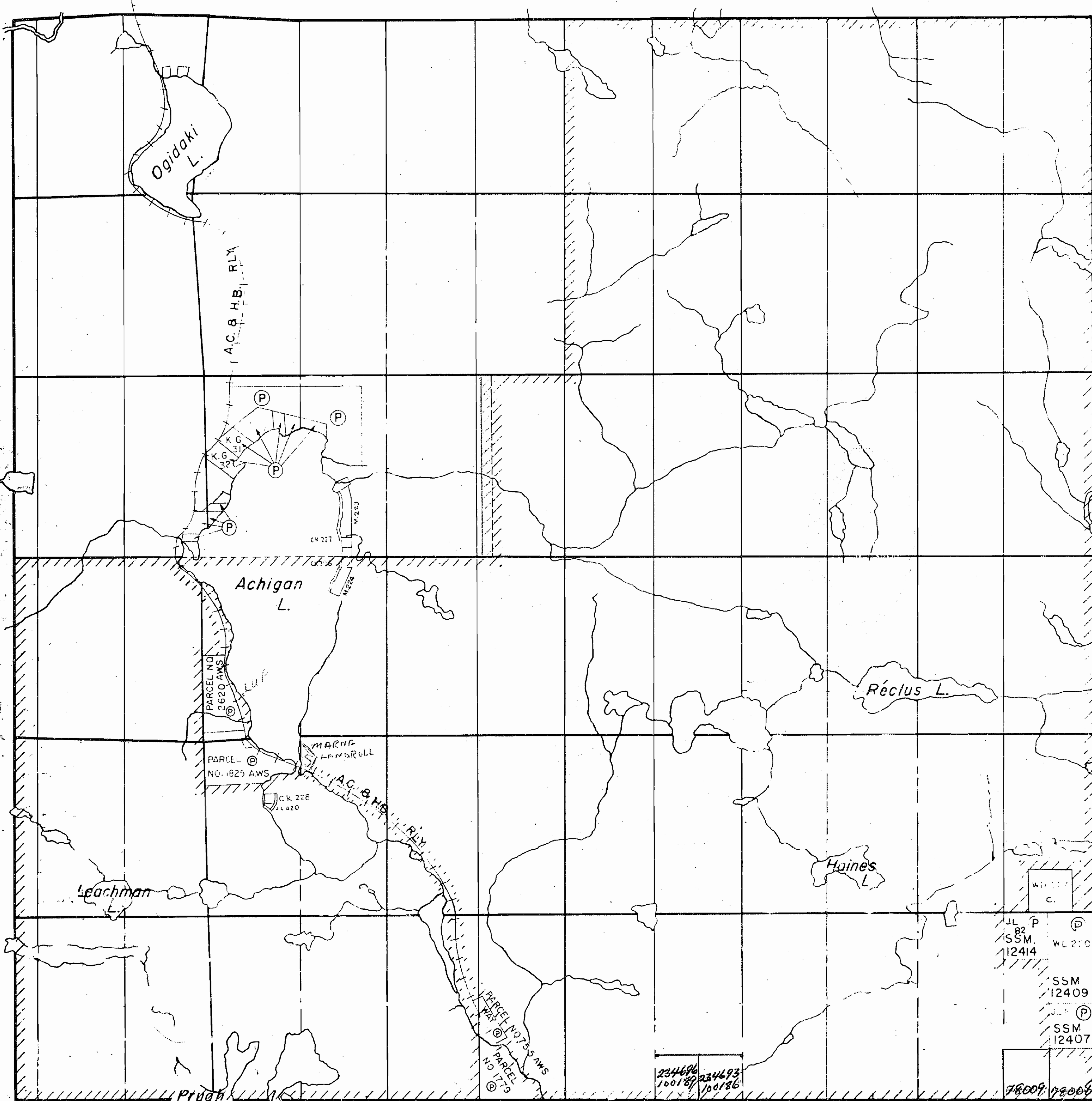

ARCHIBALD TWP

SHIELDS TWP

TWP. 25-R.12

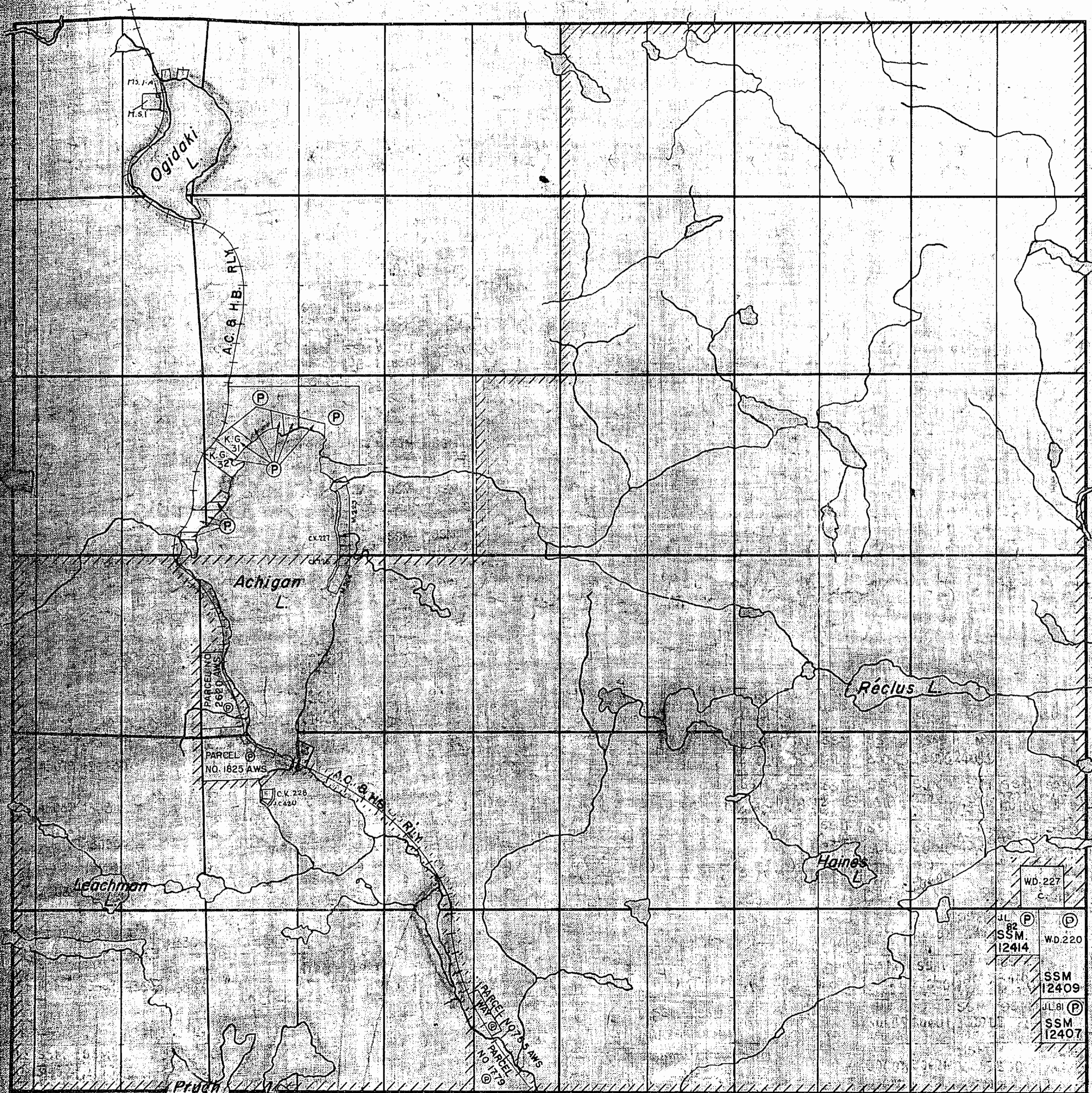

VI

V

IV

III

II

I

TWP 24-R.11

THE TOWNSHIP OF

MARNE

DISTRICT OF ALGOMA

SAULT STE. MARIE MINING DIVISION

SCALE: 1-INCH=40 CHAINS

LEGEND

- PATENTED LAND (P)
- CROWN LAND SALE (S)
- LOCATED LAND (Loc)
- LICENSE OF OCCUPATION (L.O.)
- LEASES (L)
- ROADS (---)
- IMPROVED ROADS (---)
- RAILWAYS (---)
- POWER LINES (---)
- MARSH OR MUSKEG (---)

NOTES

THIS TWP WAS FORMERLY LISTED AS TWP 25-R.11
 PARCEL NOS. - 755, 1779, 1825, 2620, GRANTED BY A.C. & H.B. RLY. PRIOR TO CROWN CONTROL

400' surface rights reserved on ground along lakes & rivers

MINING CLAIMS BROUGHT TO LEASE IN HATCHED AREA ARE SUBJECT TO THE LIMITATIONS & RESERVATIONS (TIMBER RIGHTS, RY. R/W, ETC.) EXPRESSED IN PARCEL S.N.S. TO ALGOMA CENTRAL RAILWAY, REF. NO. 63056 C.L.S. FILE NO. 149261

PLAN NO. - M-1305

ONTARIO
 MINISTRY OF NATURAL RESOURCES
 SURVEYS AND MAPPING BRANCH

Replaced by nylar Aug. 31/84

TWP. 25-R.12

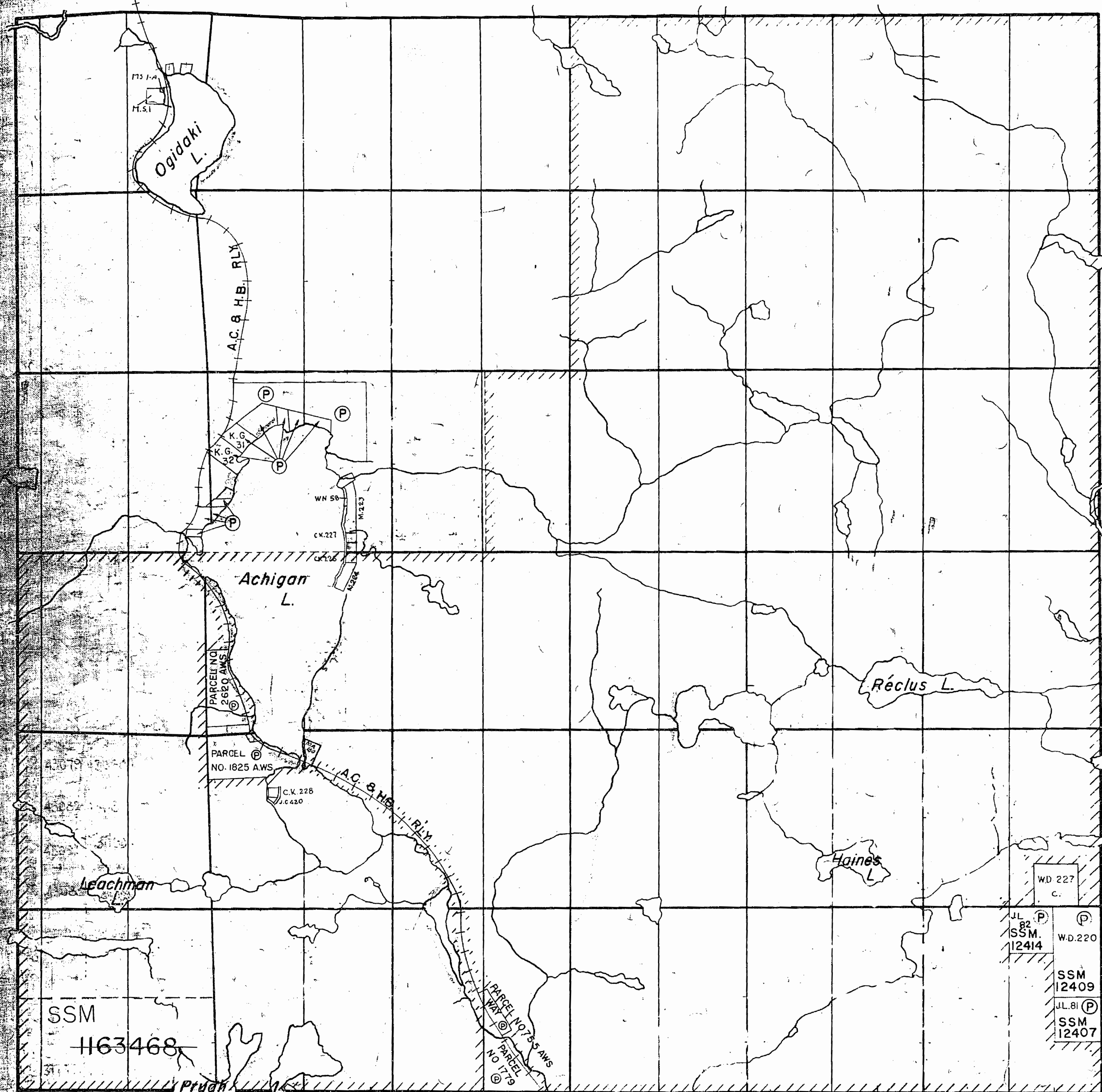

SHIELDS TWP.

THE INFORMATION THAT APPEARS ON THIS MAP HAS BEEN COMPILED FROM VARIOUS SOURCES, AND ACCURACY IS NOT GUARANTEED. THOSE WISHING TO STAKE MINING CLAIMS SHOULD CONSULT WITH THE MINING RECORDER, MINISTRY OF NORTHERN DEVELOPMENT AND MINES, FOR ADDITIONAL INFORMATION ON THE STATUS OF THE LANDS SHOWN HEREON.

VI
V
IV
III
II
I

TWP 24 - R.11

THE TOWNSHIP OF
MARNE
DISTRICT OF ALGOMA

SAULT STE. MARIE
MINING DIVISION

SCALE: 1-INCH=40 CHAINS

LEGEND

- PATENTED LAND (P)
- CROWN LAND SALE (S)
- LOCATED LAND (Loc.)
- LIGENSE OF OCCUPATION (L.O.)
- LEASES (L)
- ROADS (---)
- IMPROVED ROADS (---)
- RAILWAYS (---)
- POWER LINES (---)
- MARSH OR MUSKEG (---)

NOTES

THIS TWP. WAS FORMERLY LISTED AS TWP. 25-R.11
 PARCEL NOS. - 755, 1779, 1825, 2620, GRANTED BY A. C. & H. B. RLY. PRIOR TO CROWN CONTROL
 400' surface rights reservation on crown all lakes & rivers.
 MINING CLAIMS BROUGHT TO LEASE IN HATCHED AREA ARE SUBJECT TO THE LIMITATIONS & RESERVATIONS. (TIMBER, RIGHTS, RY, H/W, ETC) EXPRESSED IN PARCEL 51 S.N.S. TO ALGOMA CENTRAL RAILWAY, REF. NO. 63056 C.L.S. FILE NO. 4926.

RECEIVED
 DATE OF ISSUE
 JUN 04 1998
 PROVINCIAL RECORDS OFFICE - SUDBURY

PLAN NO. - M-1305

MINISTRY OF NATURAL RESOURCES

The 1985 Magnetic Bearing
 Approx. 6' W Annual Change
 increasing to

WABNE TWP. M-1305

276

TWP. 25-R.12 OFFICE MAP

ARCHIBALD TWP.

TWP. 24-R.11

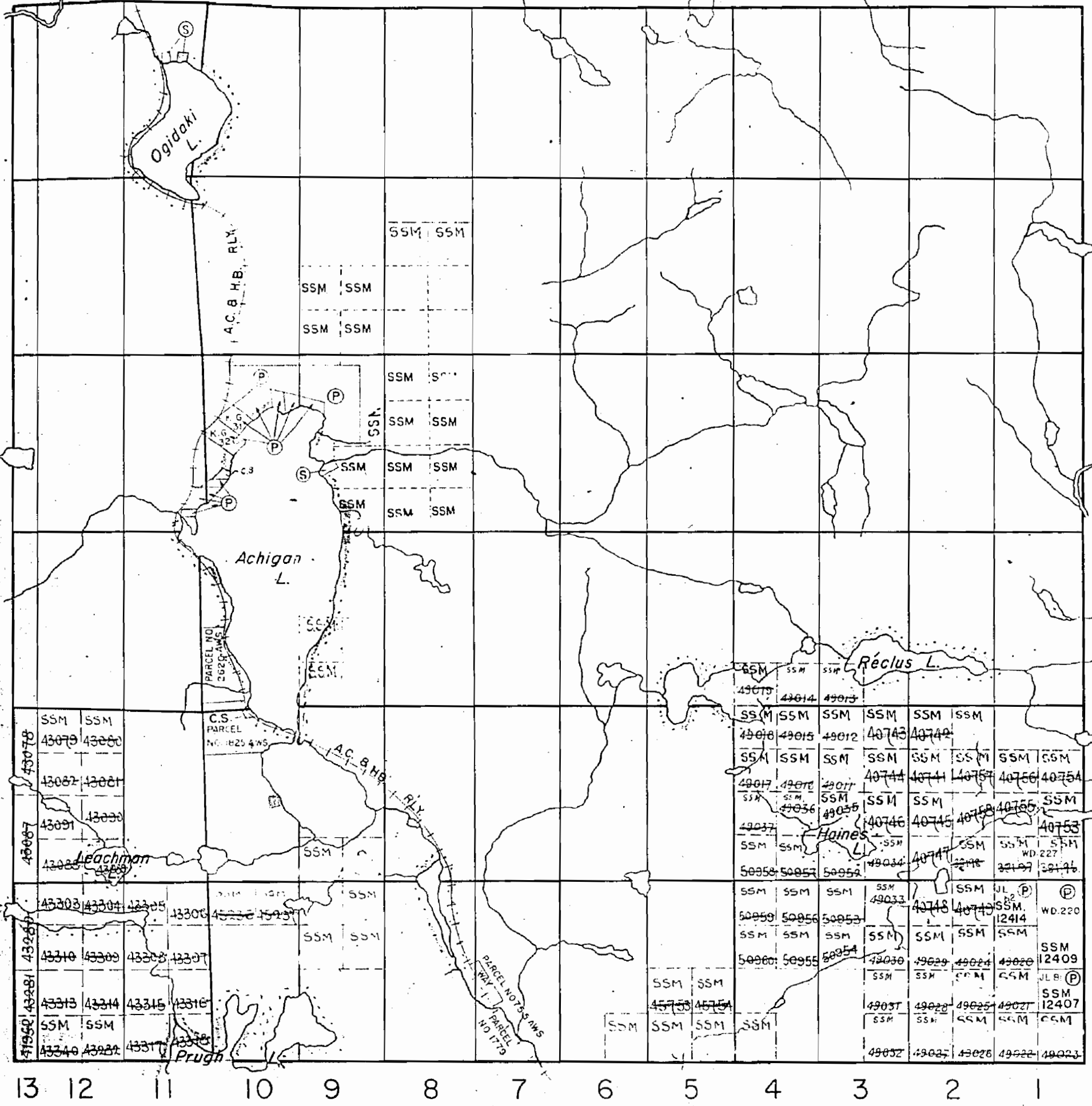

VI
V
IV
III
II
I

THE TOWNSHIP OF

MARNE

DISTRICT OF ALGOMA

SAULT STE. MARIE MINING DIVISION

SCALE: 1-INCH=40 CHAINS

LEGEND

- PATENTED LAND (P)
- CROWN LAND SALE (S)
- LOCATED LAND (Loc.)
- LICENSE OF OCCUPATION (L.O.)
- LEASES (L)
- ROADS (---)
- IMPROVED ROADS (---)
- RAILWAYS (---)
- POWER LINES (---)
- MARSH OR MUSKEG (---)

NOTES

THIS TWP. WAS FORMERLY LISTED AS TWP. 25-R.11
 PARCEL NOS. - 755, 1779, 1825, 2620, GRANTED BY A.C. & H.B. RLY. PRIOR TO CROWN CONTROL

400' Rsvd. b. Dept. of L. & F. shown thru:

PLAN NO.- M-1305

DEPARTMENT OF MINES - ONTARIO-

MARNE TWP-25-R.12

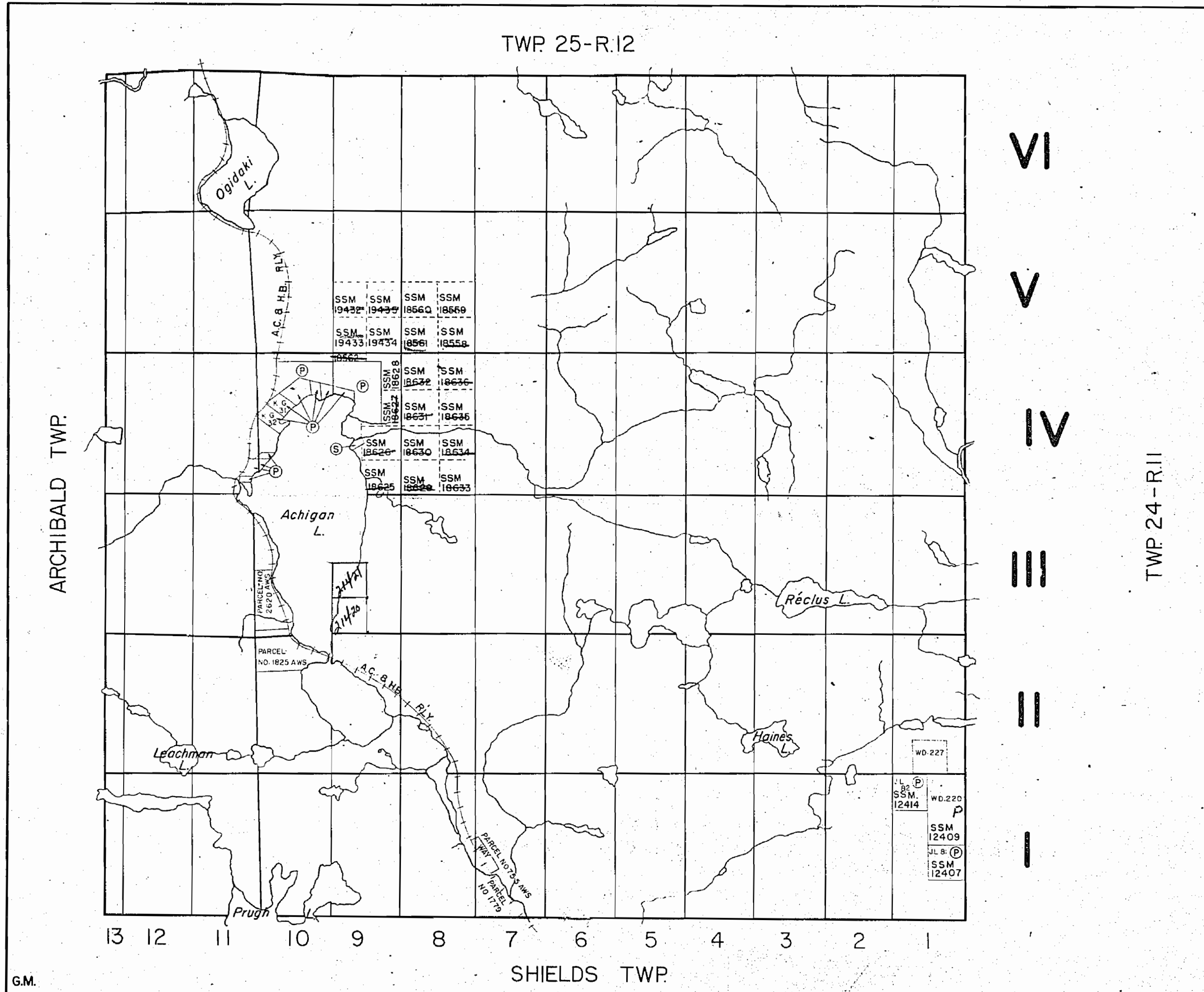

LEGEND

PATENTED LAND	(P)
CROWN LAND SALE	(S)
LOCATED LAND	Loc.
LICENSE OF OCCUPATION	L.O.
LEASES	(L)
ROADS	—+—+—+—+—
IMPROVED ROADS	—+—+—+—+—
RAILWAYS	—+—+—+—+—
POWER LINES	—+—+—+—+—
MARSH OR MUSKEG	(Wavy lines)

NOTES
THIS TWP. WAS FORMERLY LISTED AS TWP.25-R.11
PARCEL NOS.- 755, 1779, 1825, 2620, GRANTED
BY A.C. & H.B. RLY. PRIOR TO CROWN CONTROL

M.1305

PLAN NO.- SSM.-64

DEPARTMENT OF MINES
-ONTARIO-

TWP. 25-R.12

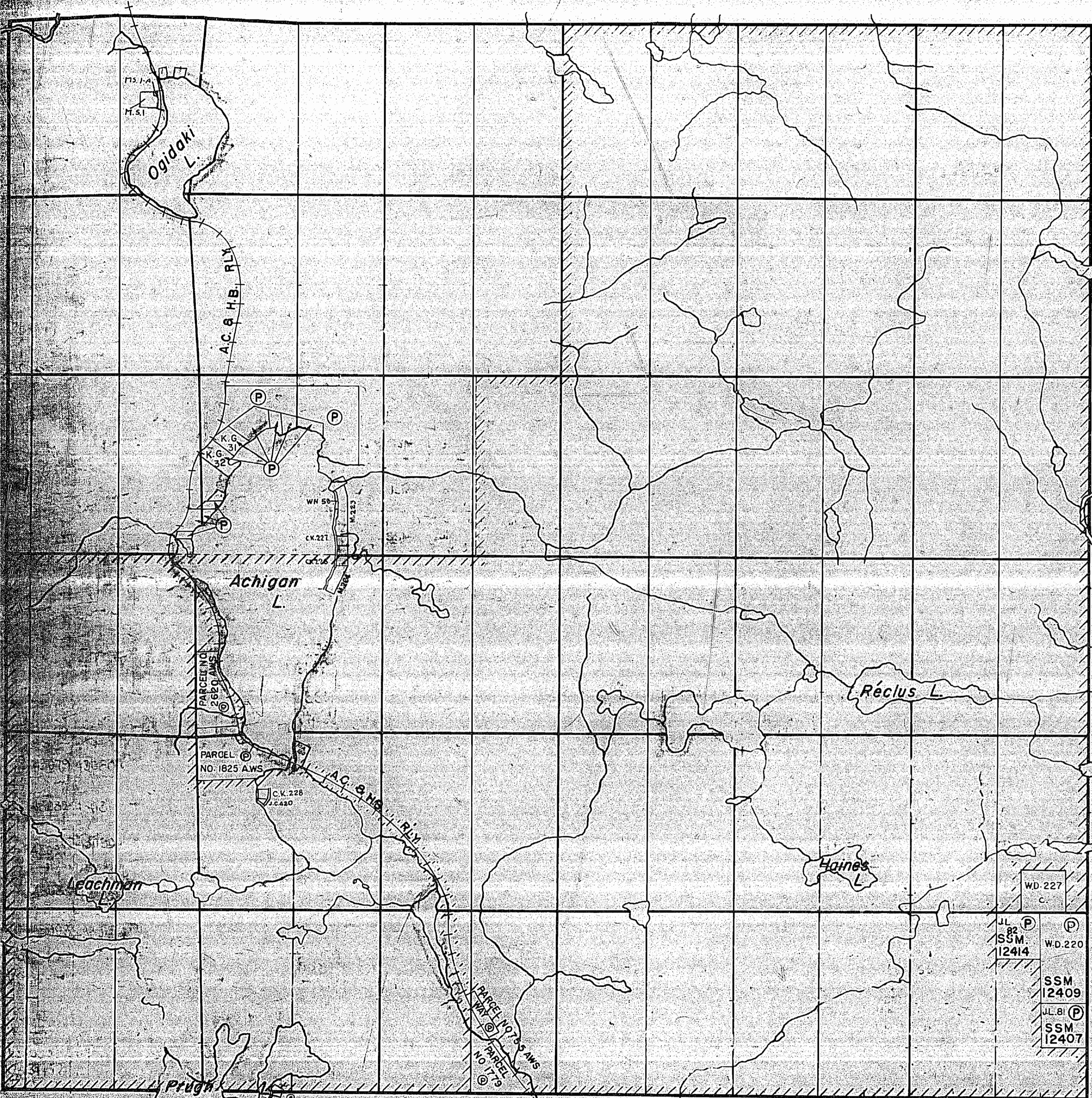

VI
V
IV
III
II
I

TWP. 24-R.11

THE TOWNSHIP OF
OF
MARNE
DISTRICT OF
ALGOMA

SAULT STE. MARIE
MINING DIVISION

SCALE 1-INCH=40 CHAINS

LEGEND

PATENTED LAND	(P)
CROWN LAND SALE	(S)
LOCATED LAND	Loc.
LICENSE OF OCCUPATION	L.O.
LEASES	(L)
ROADS	—+—+—+—+—
IMPROVED ROADS	—+—+—+—+—
RAILWAYS	—+—+—+—+—
POWER LINES	—+—+—+—+—
MARSH OR MUSKEG	(wavy lines)

NOTES

THIS TWP. WAS FORMERLY LISTED AS TWP. 25-R.11
 PARCEL NOS. - 755, 1779, 1825, 2620 GRANTED BY A. C. & H. B. RLY. PRIOR TO CROWN CONTROL
 400' surface rights reserved on crown all lakes & rivers.
 MINING CLAIMS BROUGHT TO LEASE IN HATCHED AREA ARE SUBJECT TO THE LIMITATIONS & RESERVATIONS (TIMBER, RIGHTS, RY, R/W, ETC.) EXPRESSED IN PARCEL S.S.N.S. TO ALGOMA CENTRAL RAILWAY, REF. NO. 63056 C.L.S. FILE NO. 49261

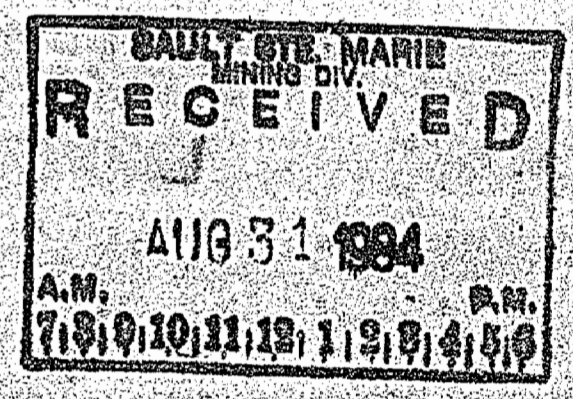

PLAN NO. - M-1305

MINISTRY OF NATURAL RESOURCES

SURVEYS AND MAPPING BRANCH

The 1985 Magnetic Bearing Approx. 6' W Annual Change increasing to

13 12 11 10 9 8 7 6 5 4 3 2 1

SHIELDS TWP.

WABME LWB-22W-02

TWP. 25-R.12

ARCHIBALD TWP.

TWP. 24-R.11

SHIELDS TWP.

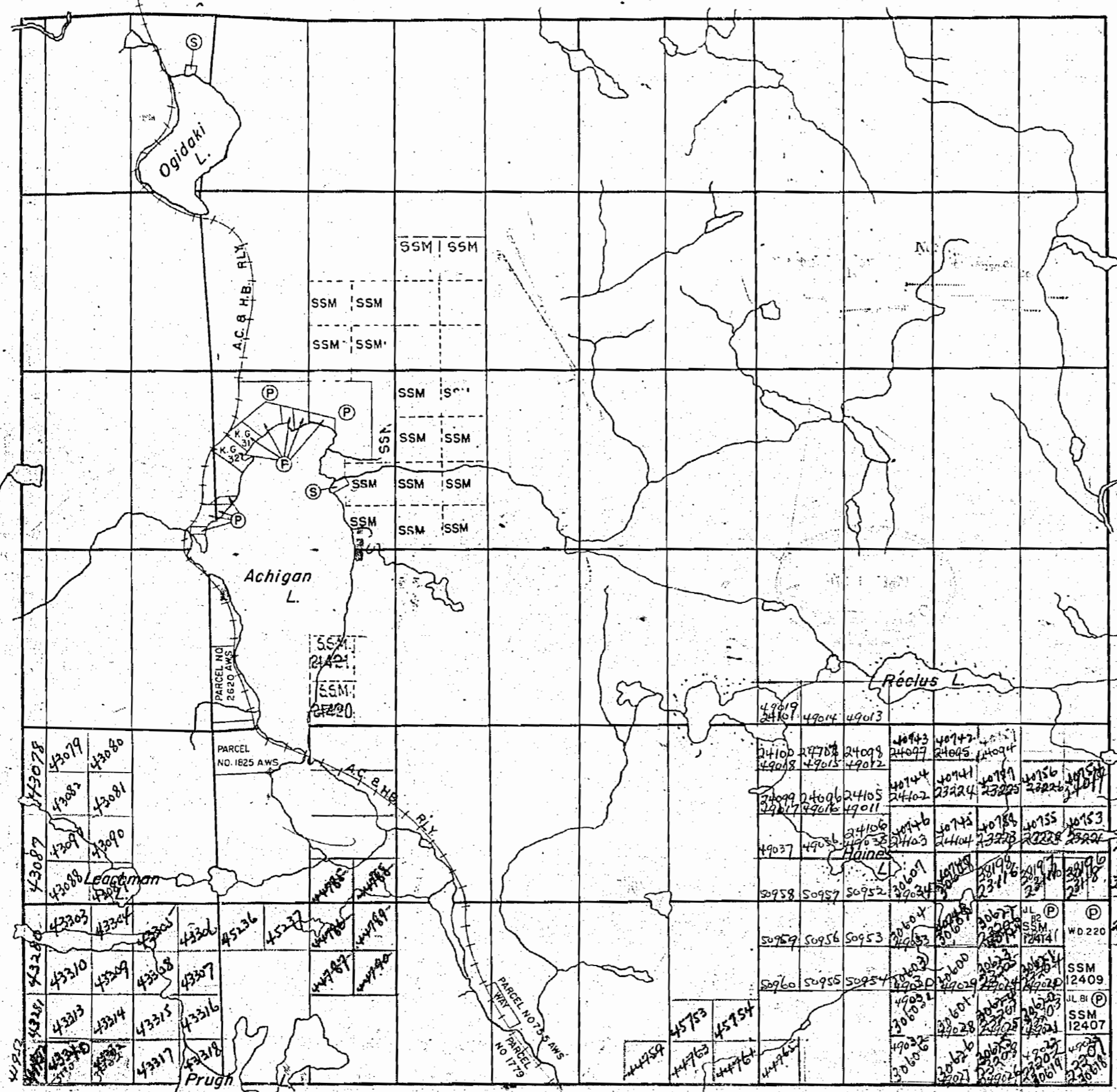

THE TOWNSHIP OF
MARNE
 DISTRICT OF ALGOMA
 SAULT STE. MARIE MINING DIVISION

SCALE: 1-INCH=40 CHAINS

LEGEND

- PATENTED LAND Ⓟ
- CROWN LAND SALE Ⓢ
- LOCATED LAND Loc.
- LICENSE OF OCCUPATION L.O.
- LEASES Ⓛ
- ROADS ▬▬▬▬
- IMPROVED ROADS ▬▬▬▬▬▬
- RAILWAYS ▬+▬+▬+▬+▬+
- POWER LINES —+—+—+—+—+—+—
- MARSH OR MUSKES ▬▬▬▬▬▬▬▬▬▬

NOTES

THIS TWP. WAS FORMERLY LISTED AS TWP.25-R.11
 PARCEL NOS. - 755, 1779, 1825, 2620, GRANTED BY A.C. & H.B. RLY. PRIOR TO CROWN CONTROL

M.1305

PLAN NO.-SSM-85

DEPARTMENT OF MINES - ONTARIO-

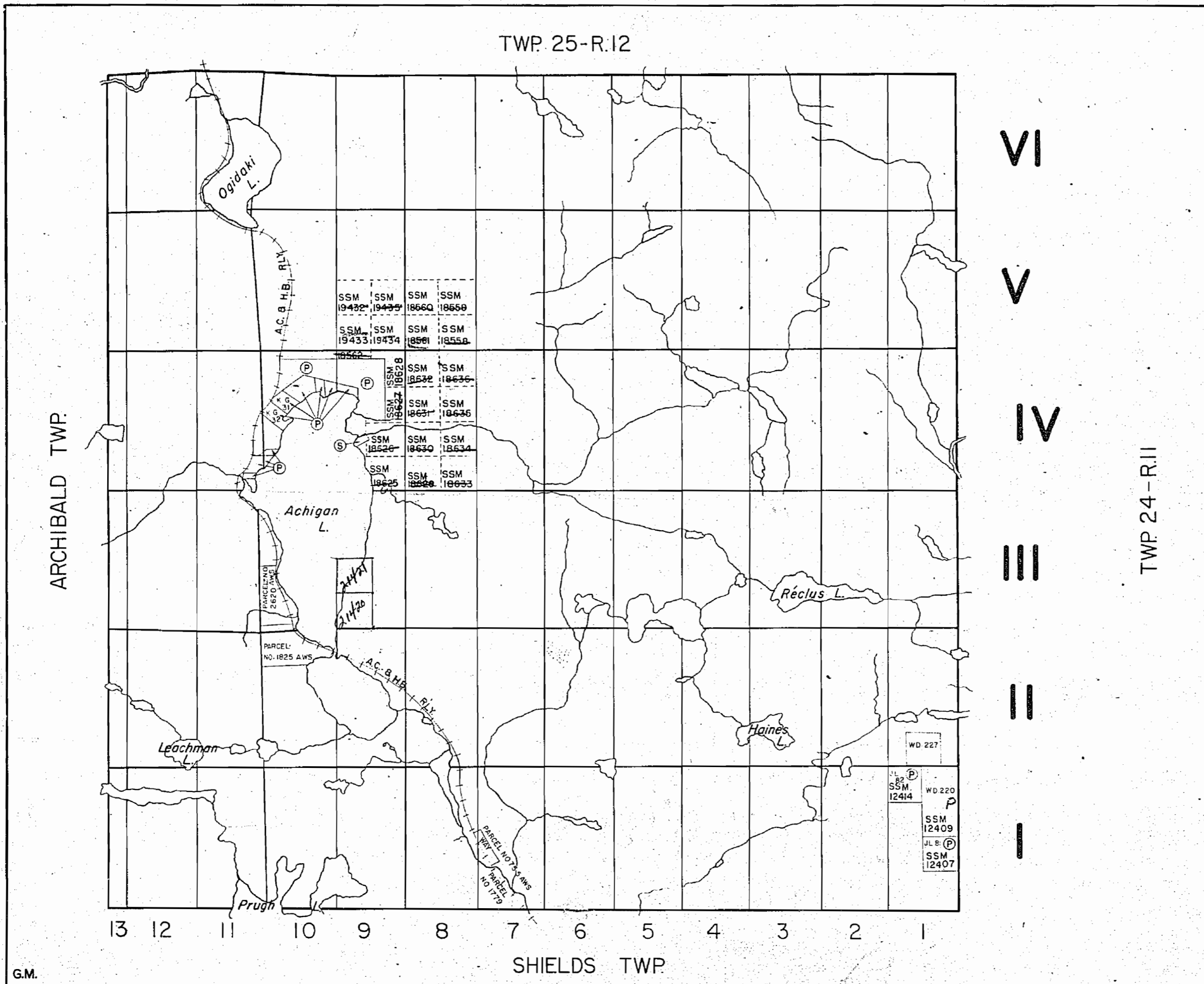

THE TOWNSHIP
OF

MARNE

DISTRICT OF
ALGOMA

SAULT STE. MARIE
MINING DIVISION

SCALE: 1-INCH=40 CHAINS

LEGEND

PATENTED LAND	(P)
CROWN LAND SALE	(S)
LOCATED LAND	Loc.
LICENSE OF OCCUPATION	L.O.
LEASES	(L)
ROADS	—+—+—+—+—
IMPROVED ROADS	—+—+—+—+—
RAILWAYS	—+—+—+—+—
POWER LINES	—+—+—+—+—
MARSH OR MUSKEG	(wavy lines)

NOTES

THIS TWP. WAS FORMERLY LISTED AS TWP.25-R.11
 PARCEL NOS.- 755, 1779, 1825, 2620, GRANTED
 BY A.C.B.H.B. RLY. PRIOR TO CROWN CONTROL

M.1305

PLAN NO.- SSM-64

DEPARTMENT OF MINES
- ONTARIO -

TWP. 25-R.12 **OFFICE MAP**

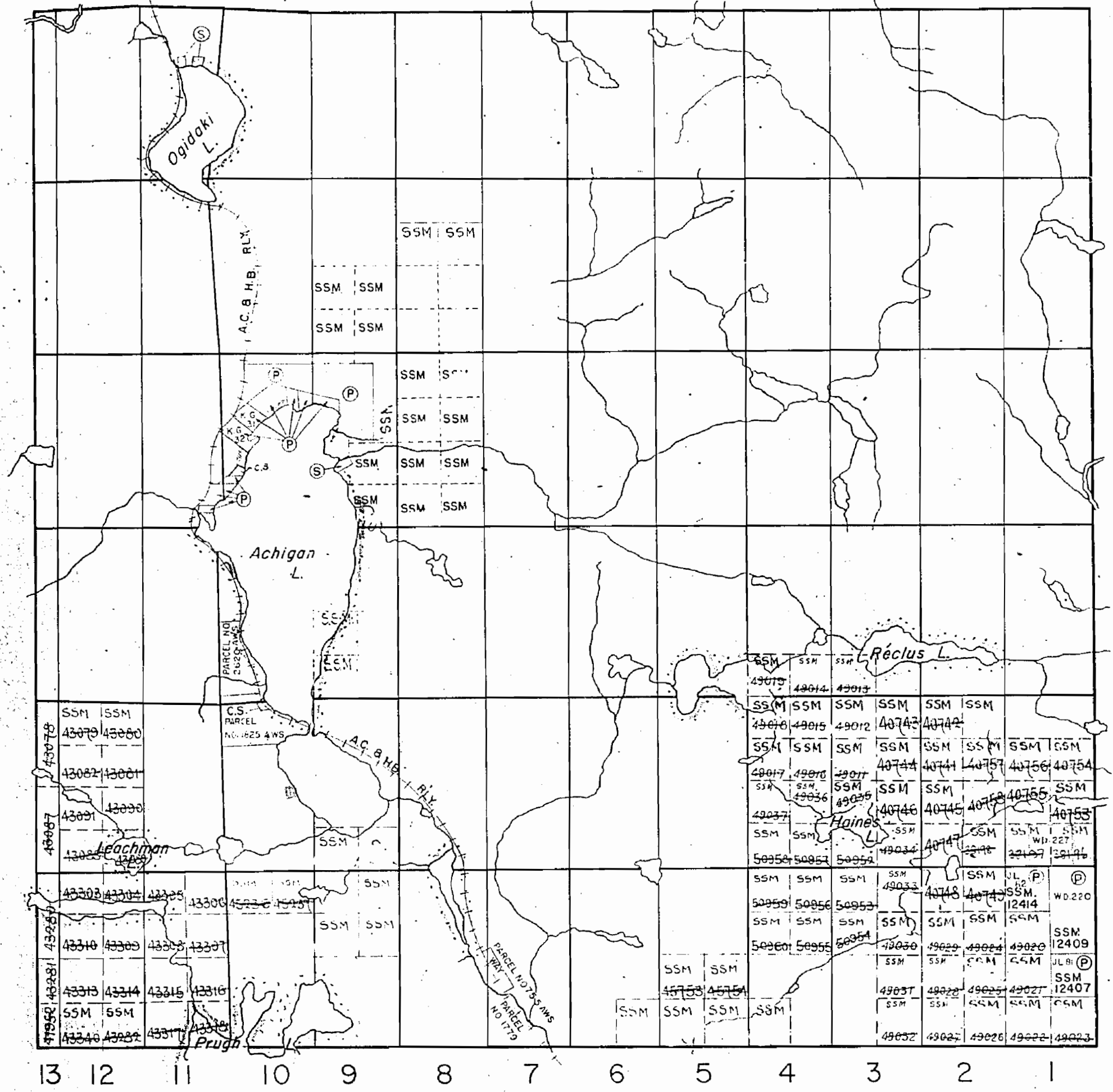

VI

V

IV

III

II

I

ARCHIBALD TWP.

TWP. 24-R.11

SHIELDS TWP.

G.M.

THE TOWNSHIP OF

MARNE

DISTRICT OF ALGOMA

SAULT STE. MARIE MINING DIVISION

SCALE: 1-INCH=40 CHAINS

LEGEND

PATENTED LAND	(P)
CROWN LAND SALE	(S)
LOCATED LAND	Loc.
LICENSE OF OCCUPATION	L.O.
LEASES	(L)
ROADS	
IMPROVED ROADS	
RAILWAYS	
POWER LINES	
MARSH OR MUSKEG	

NOTES

THIS TWP. WAS FORMERLY LISTED AS TWP. 25-R.11
 PARCEL NOS. - 755, 1779, 1825, 2620, GRANTED BY A. C. & H. B. RLY. PRIOR TO CROWN CONTROL

400' Rwd. b. Dept. of L. & F. shown thru:

PLAN NO.- M-1305

DEPARTMENT OF MINES
 - ONTARIO -

138-M22-9WT EMAN

TWP 25-R.12

ARCHIBALD TWP.

TWP 24-R.11

THE TOWNSHIP OF

MARNE

DISTRICT OF ALGOMA

SAULT STE. MARIE MINING DIVISION

SCALE: 1-INCH=40 CHAINS

LEGEND

- PATENTED LAND (P)
- CROWN LAND SALE (S)
- LOCATED LAND (Loc.)
- LICENSE OF OCCUPATION (L.O.)
- LEASES (L)
- ROADS (---)
- IMPROVED ROADS (---)
- RAILWAYS (---)
- POWER LINES (---)
- MARSH OR MUSKEG (---)

NOTES

THIS TWP. WAS FORMERLY LISTED AS TWP.25-R.11

PARCEL NOS.- 755, 1779, 1825, 2620, GRANTED BY A.C. & H.E. RLY. PRIOR TO CROWN CONTROL

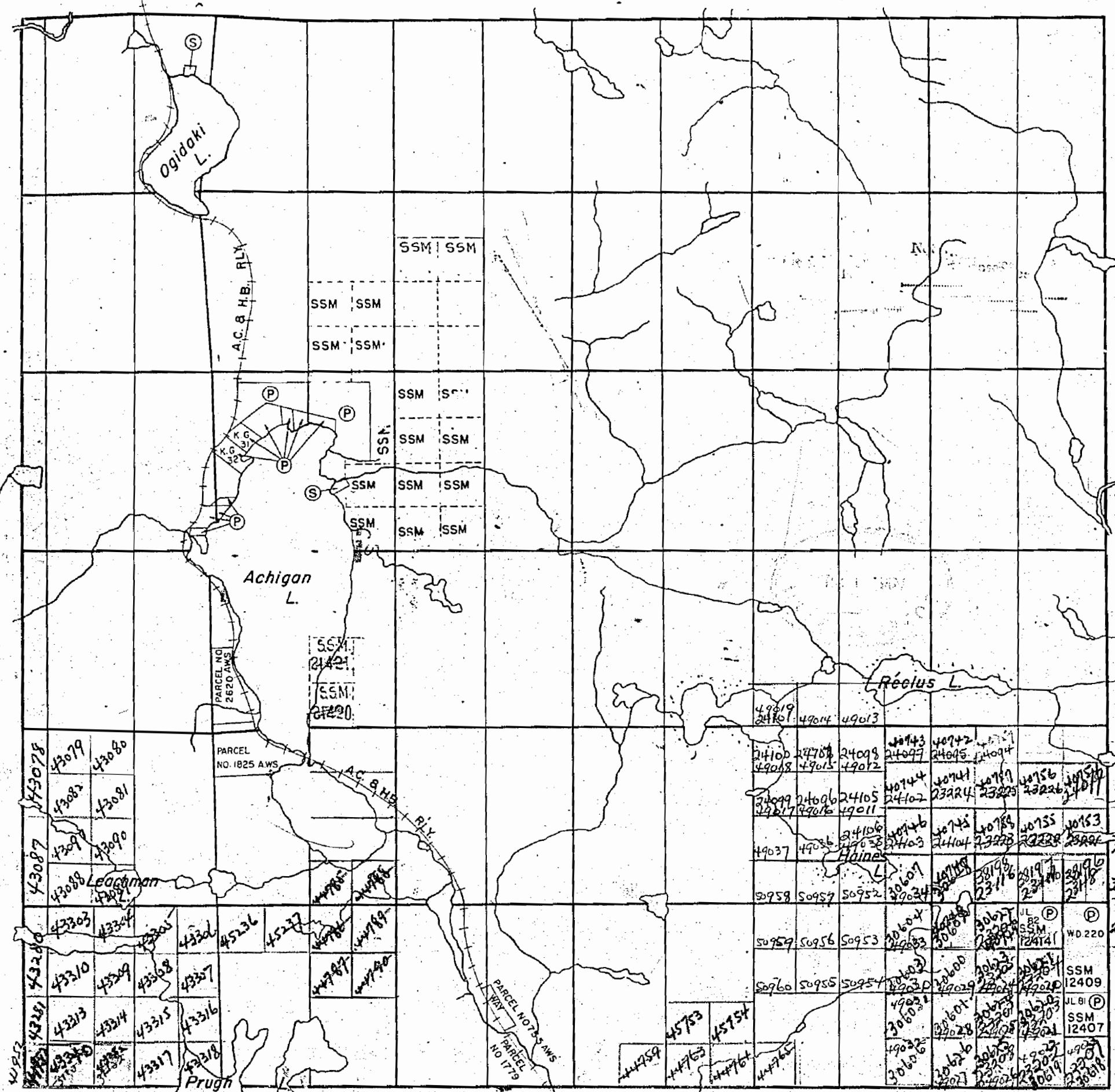

VI

V

IV

III

II

I

M.1305

PLAN NO.- S.S.M.-85

DEPARTMENT OF MINES - ONTARIO-