

M. 1307

PLAN OF MARTIN TWP.

SAULT STE. MARIE MINING DIVISION. DISTRICT OF ALGOMA.

NOTE
Surface Rights Only of
This Township, Patented.

— Scale, 40 chains to an inch. —

DATE OF ISSUE
5th 1966 W.
SAULT STE. MARIE
DISTRICT OF ALGOMA

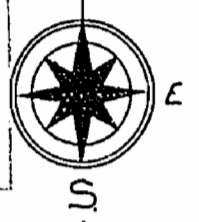

IRVING TWP.

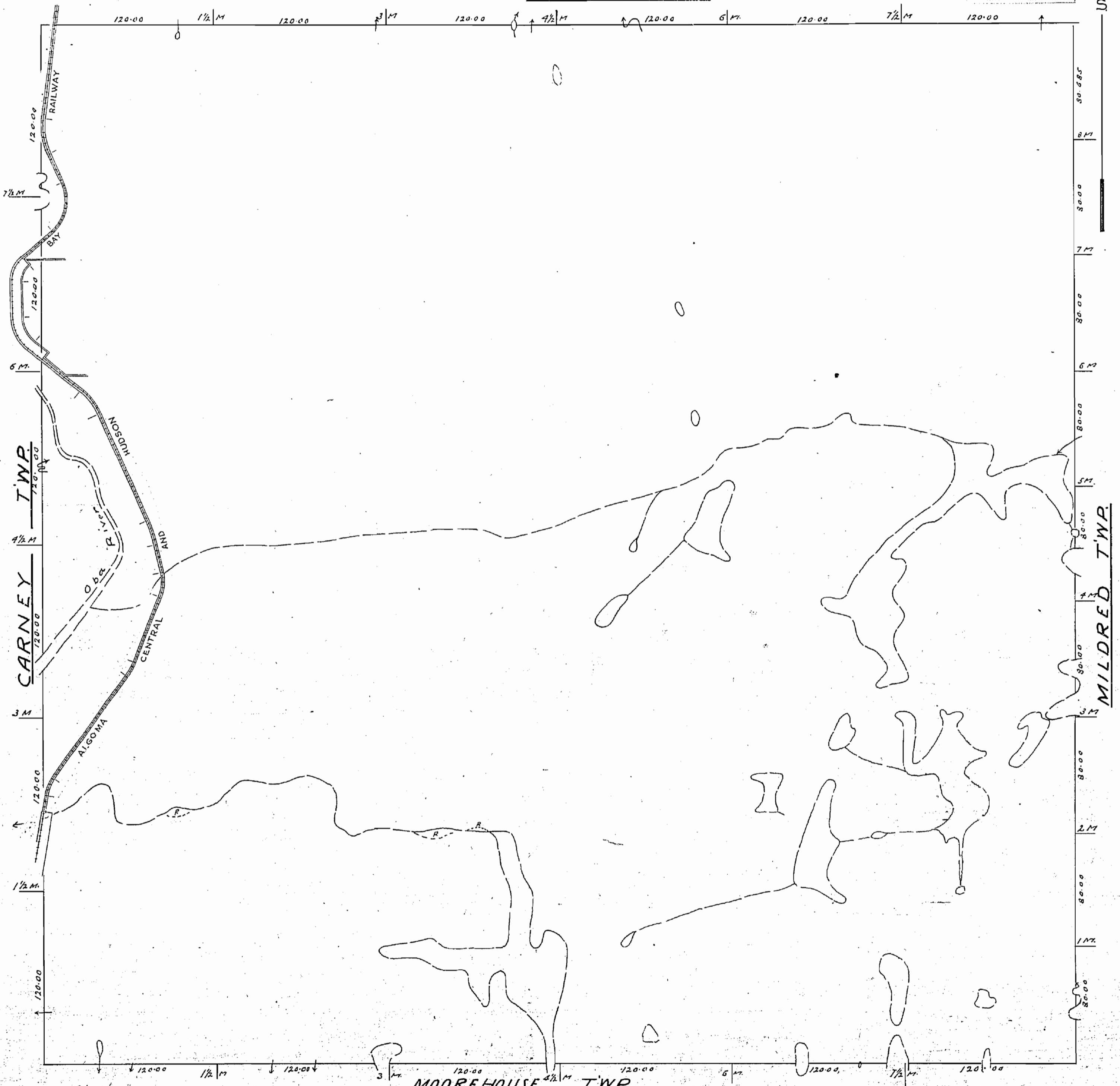

Notes

- | | |
|--|---|
| Railways shown thus | Non-perennial streams |
| Paved Highway | Bridges |
| Gravel Highway | Buildings |
| Highway Route No. | Swamps |
| Other Roads | Areas marked (C) are Patented |
| Trolley Paths | Areas marked (L) are Leased |
| Telephone & Telegraph Lines | Areas marked (M) are Held in def. of M.C.A. |
| Electric Power Lines | Areas marked (O) are Held in def. of O.C.A. |
| Algonia, Central and Hudson Bay Rly. (Extension North of Hoban) from Preliminary Plan, Mic 30-85/25 Aug. 1911 - Plan No. 02-43 | 400' surface rights reservation around all lakes & rivers |
| Revised Location of M.C.A. Rly. through Martin Twp. and Centre of Carney Twp. 2/10 Nov. 1955 - Plan No. 02-43 | |

SAULT STE. MARIE
MINING DIV.
RECEIVED
AUG 30 1984
A.M. P.M.
11 12 1 2 3 4 5 6

M.1307
ONTARIO

MINISTRY OF NATURAL RESOURCES
SURVEYS AND MAPPING BRANCH

PLAN OF
MARTIN TWP.

SAULT STE. MARIE MINING DIVISION
DISTRICT OF ALGOMA.

Scale, 40 chains to an inch.

IRVING TWP.

THE INFORMATION THAT
APPEARS ON THIS MAP
HAS BEEN COMPILED
FROM VARIOUS SOURCES,
AND ACCURACY IS NOT
GUARANTEED. THOSE
WISHING TO STAKE MINING
CLAIMS SHOULD CONSULT
WITH THE MINING
RECORDER, MINISTRY OF
NORTHERN DEVELOPMENT
AND MINES, FOR ADDITIONAL
INFORMATION ON THE STATUS OF THE
LANDS SHOWN HEREON.



NOTE
Surface Rights Only of
This Township, Patented.

The 1985 Magnetic Bearing
Approx. 72W Annual Change
-Increasing 10.20"

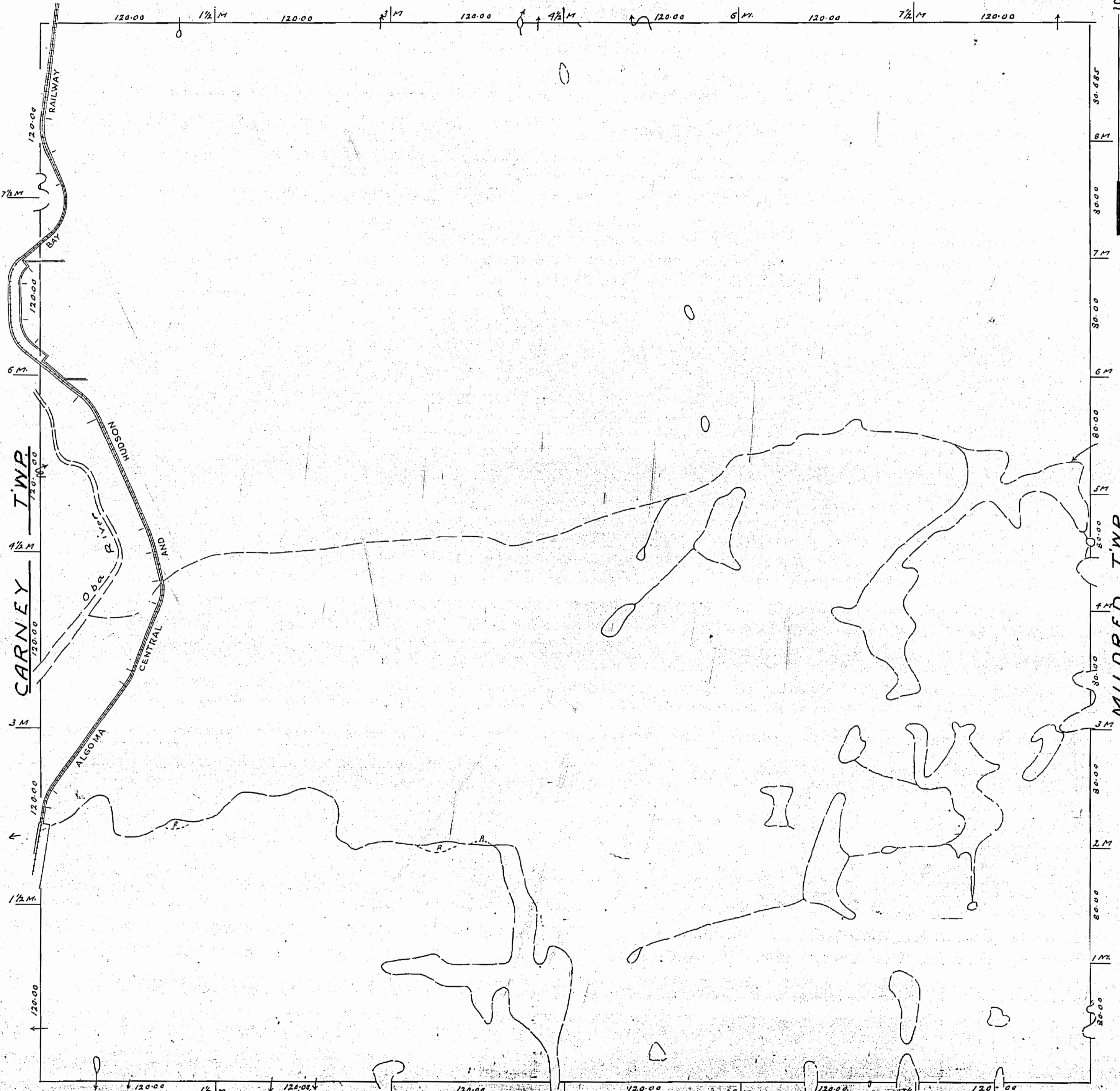

Notes

Railways (shown thus)	Non-perennial streams
Paved Highways	Buildings
Gravel Highways	Swamps
Highway Right-of-Way	Water
Other Roads	Water
Water	Water
Water	Water
Water	Water

MINING RIGHTS
OPEN FOR STAKING
Aug. 31/64 7 A.M. EST.
J. H. Moore Esq. Aug. 11/64

PLAN OF MARTIN TWP.

M. 1307

SAULT STE. MARIE MINING DIVISION. DISTRICT OF ALGOMA.

— Scale, 40 chains to an inch. —

IRVING TWP.

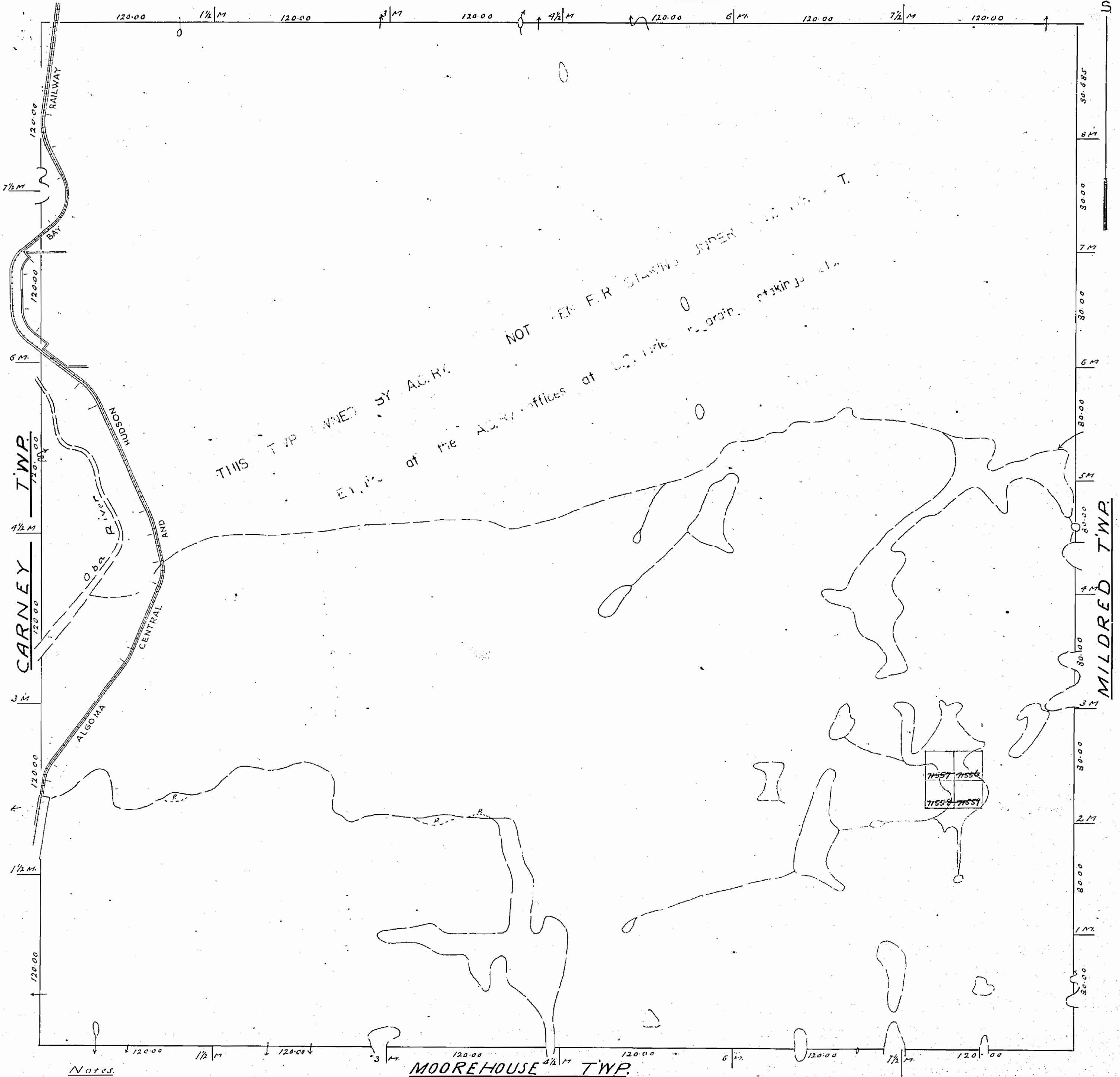
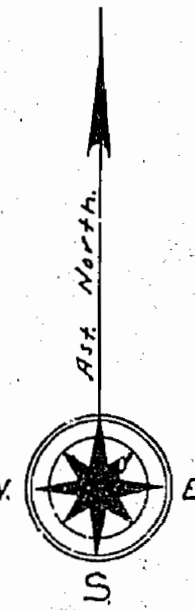

THIS TWP OWNED BY A.C.R.R.
NOT OPEN FOR STAKING UNDER THE ACT.
E.I.C. of the A.C.R.R. offices at Sault Ste. Marie, Ont.

Notes.

- Railways Shown Thus: ————
- Paved Highways: ————
- Gravel Highways: ————
- Other Roads: ————
- Trails & Paths: - - - - -
- Telephone & Telegraph Lines: ————
- Electric Power Lines: ————
- Algoma Central and Hudson Bay Rly. (Extension North of Hobart) from Preliminary Plan, M.R. 30-634/25 May 1911 - Plan No. 02-43
- Revised Location of A.C.R.R. through Martin Twp and Centre part of Carney Twp. of 10 Nov. 1935. Plan No.

- Non-perennial Stream: - - - - -
- Bridges: ————
- Buildings: ————
- Steamps: ————
- Areas marked (C) are patented
- Areas marked (L) are leased
- Areas marked (O) are held under License of Occupation

MOOREHOUSE TWP.

MILDRED TWP.

CARNEY TWP.

MINING RIGHTS
OPEN FOR STAKING
Aug. 31/64 7 A.M. EST.
9 Hours Est. Aug. 11/64

PLAN OF MARTIN TWP.

M. 1307

SAULT STE. MARIE MINING DIVISION. DISTRICT OF ALGOMA.

— Scale, 40 chains to an inch. —

IRVING TWP.

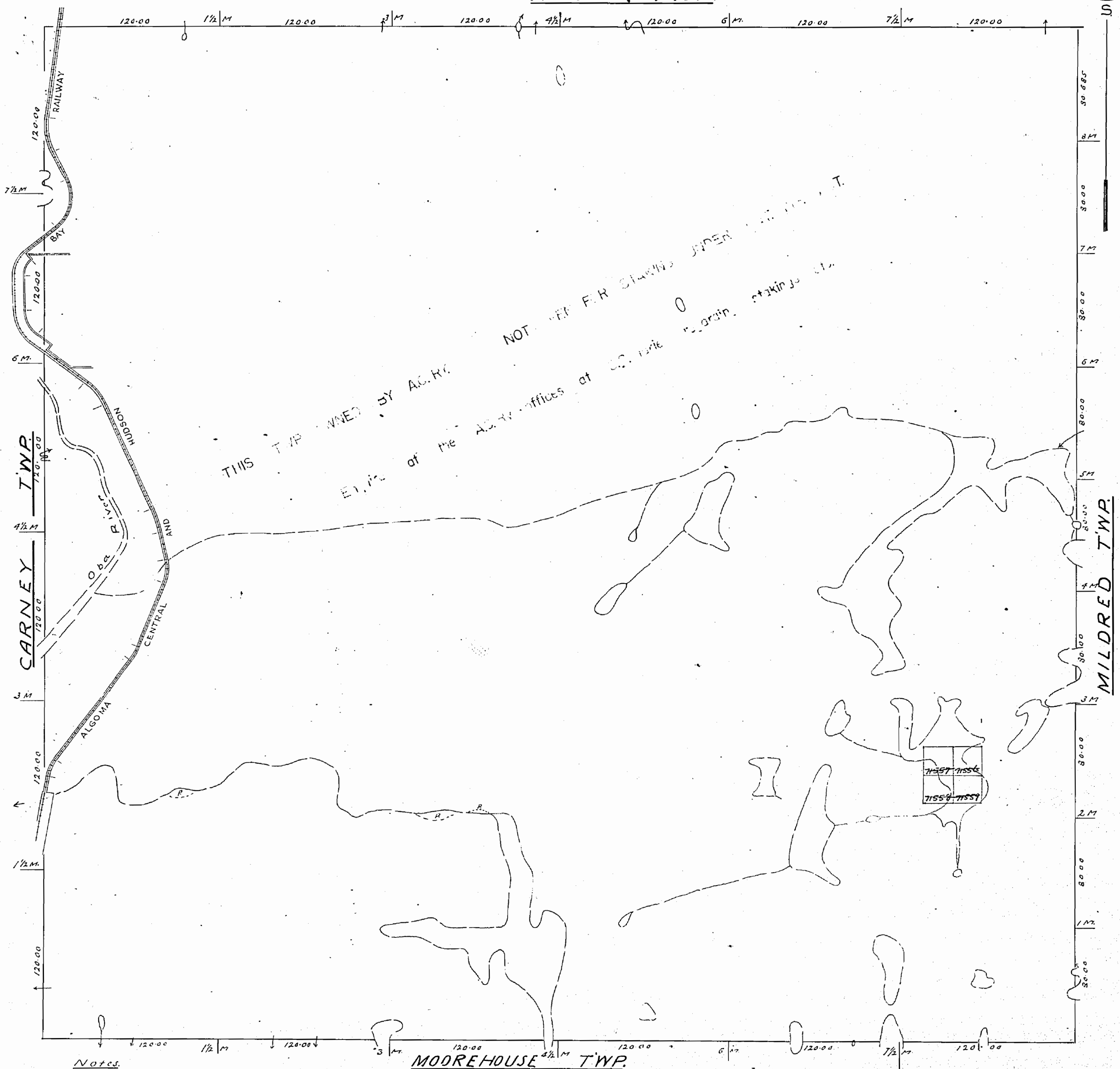
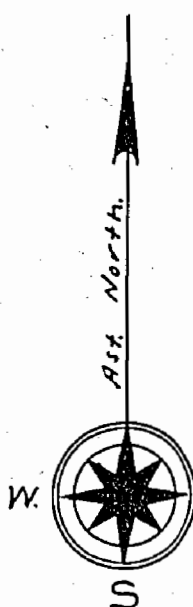

THIS TWP OWNED BY A.C.H.C.
E.T.P. of the A.C.H.C. offices at Sault Ste. Marie
NOT OPEN FOR STAKING UNDER THE M.T. ACT.

71557-71556
71558-71557

Notes.

Railways shown thus.....	Non-perennial streams.....
Paved Highways.....	Bridges.....
Gravel.....	Buildings.....
Highway Route No. 1.....	Stumps.....
Other Roads.....	Areas marked (X) are Patented
Trails & Paths.....	Leases held under
Telephone & Telegraph Lines.....	License of Occupation
Electric Power Lines.....	

Algoma Central and Hudson Bay Ry. (Extension North of Hoban) from Preliminary Plan, Misc. 30-834/29 Nov. 1911 - Plan No. 02-43. Revised Location of A.C.H.C. Ry. through Martin Twp. and Centre part of Carney Twp. J. 10 Nov. 1935. Plan No.