

M. 857

ONTARIO

MINISTRY OF NATURAL RESOURCES

SURVEYS AND MAPPING BRANCH

MASON

SUDBURY MINING DIVISION

Scale 40 Chains = 1 Inch

NOTES

400' Surface Rights Reservation
around all Lakes and Rivers.

Islands in French River withdrawn from staking. File:67051.

(R) FRENCH RIVER PROVINCIAL PARK ONTARIO REGULATION
NO.210/89 APRIL 25, 1989 SCHEDULE NO.216

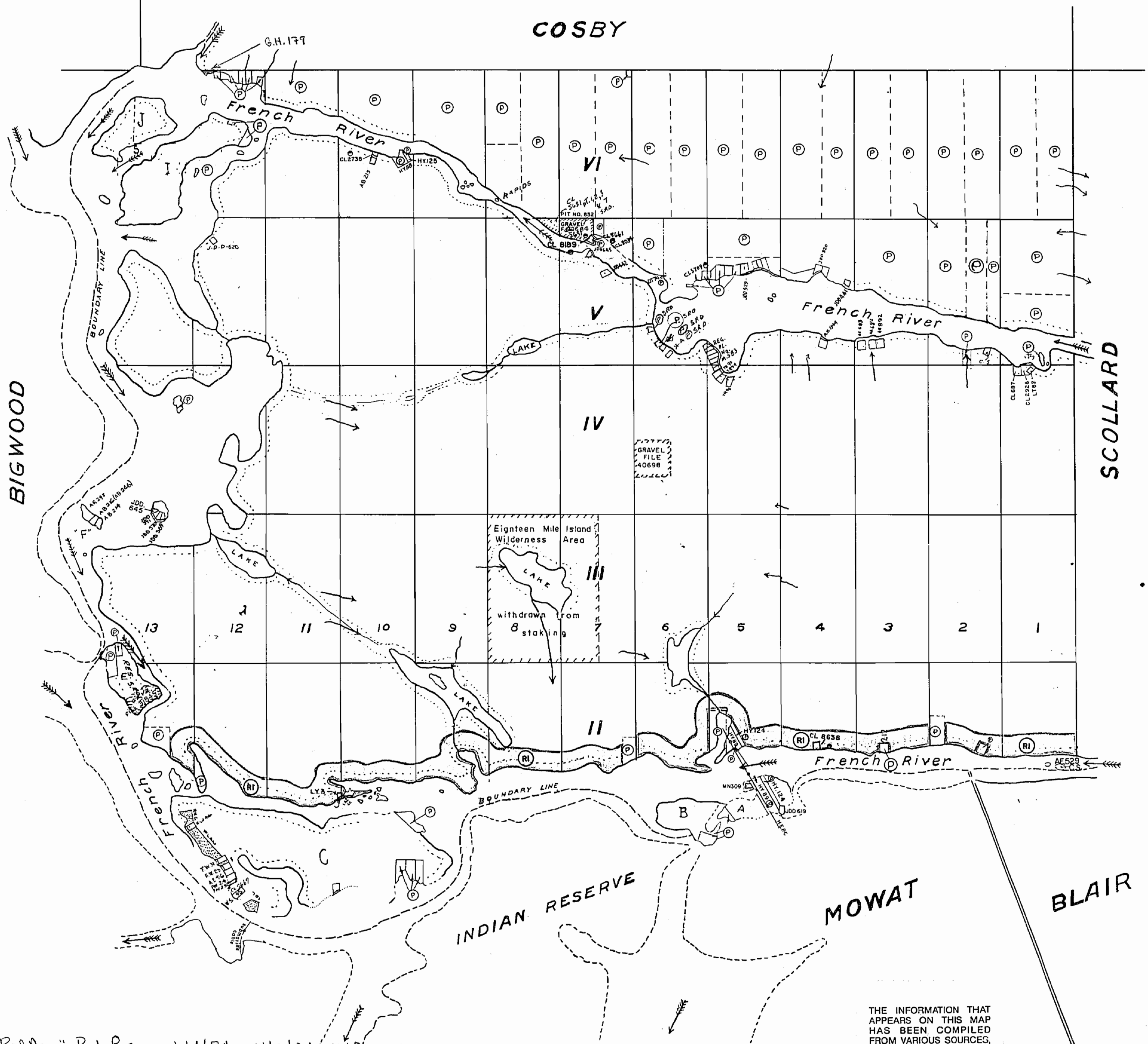

"Red Area" Park Reserve W.1/84 14/3/84 M&S 188559
 Disposition by Exploratory Licence of Occupation Only
 Apply to Mining Recorder

THE INFORMATION THAT APPEARS ON THIS MAP HAS BEEN COMPILED FROM VARIOUS SOURCES, AND ACCURACY IS NOT GUARANTEED. THOSE WISHING TO STAKE MINING CLAIMS SHOULD CONSULT WITH THE MINING RECORDER, MINISTRY OF NORTHERN DEVELOPMENT AND MINES, FOR ADDITIONAL INFORMATION ON THE STATUS OF THE LANDS SHOWN HEREON.

857

MASON

Scale 40 Chains=1-Inch-

*C.S. 24ric Contours
1931*

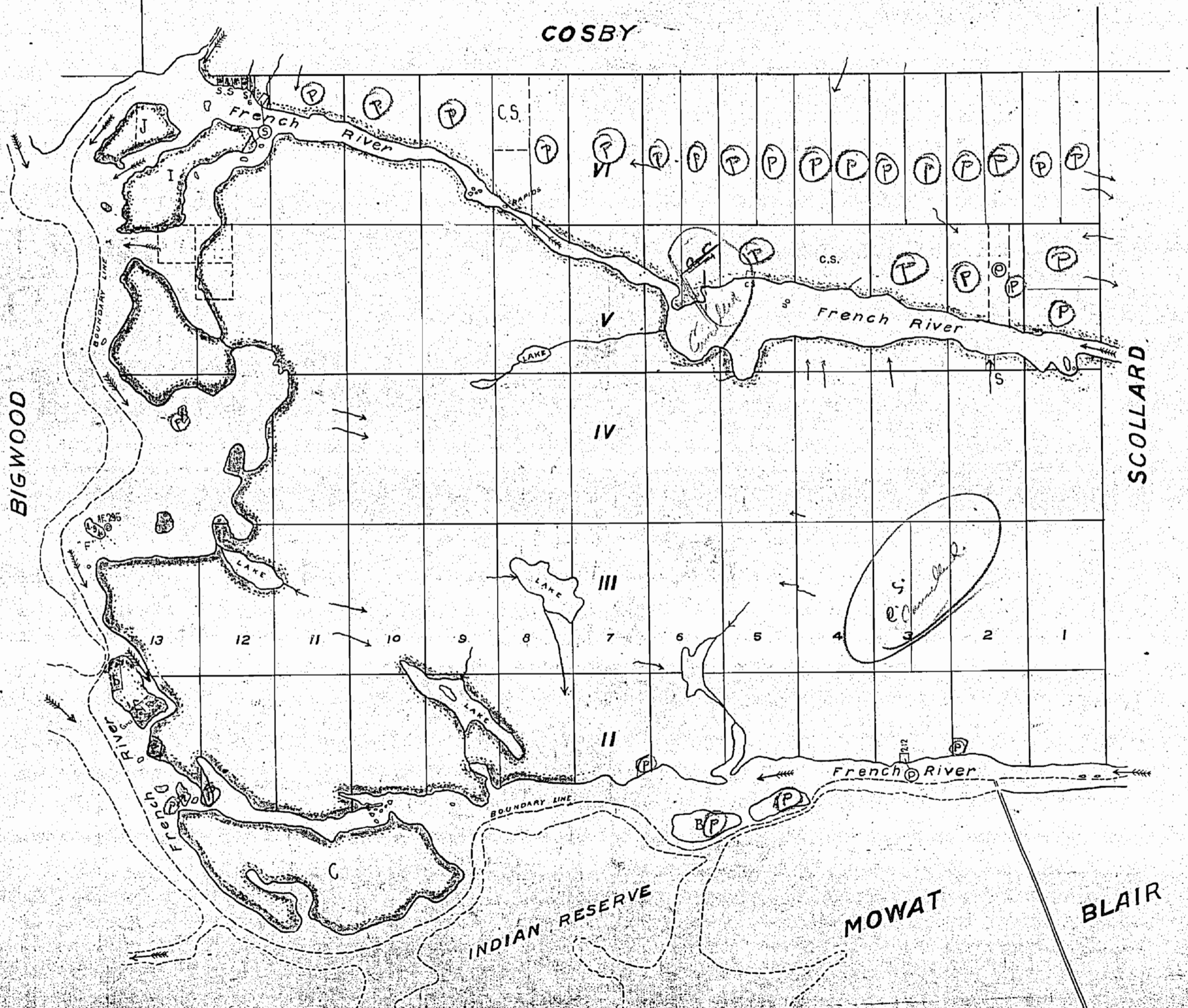

*Surface elevations taken by Dept. of L. & E.
Shawyer & Co.*

*On checking more patents
will add to the names*

M857

[Handwritten signature]

857

MASON

Scale 40 Chains=1-Inch-

COSBY

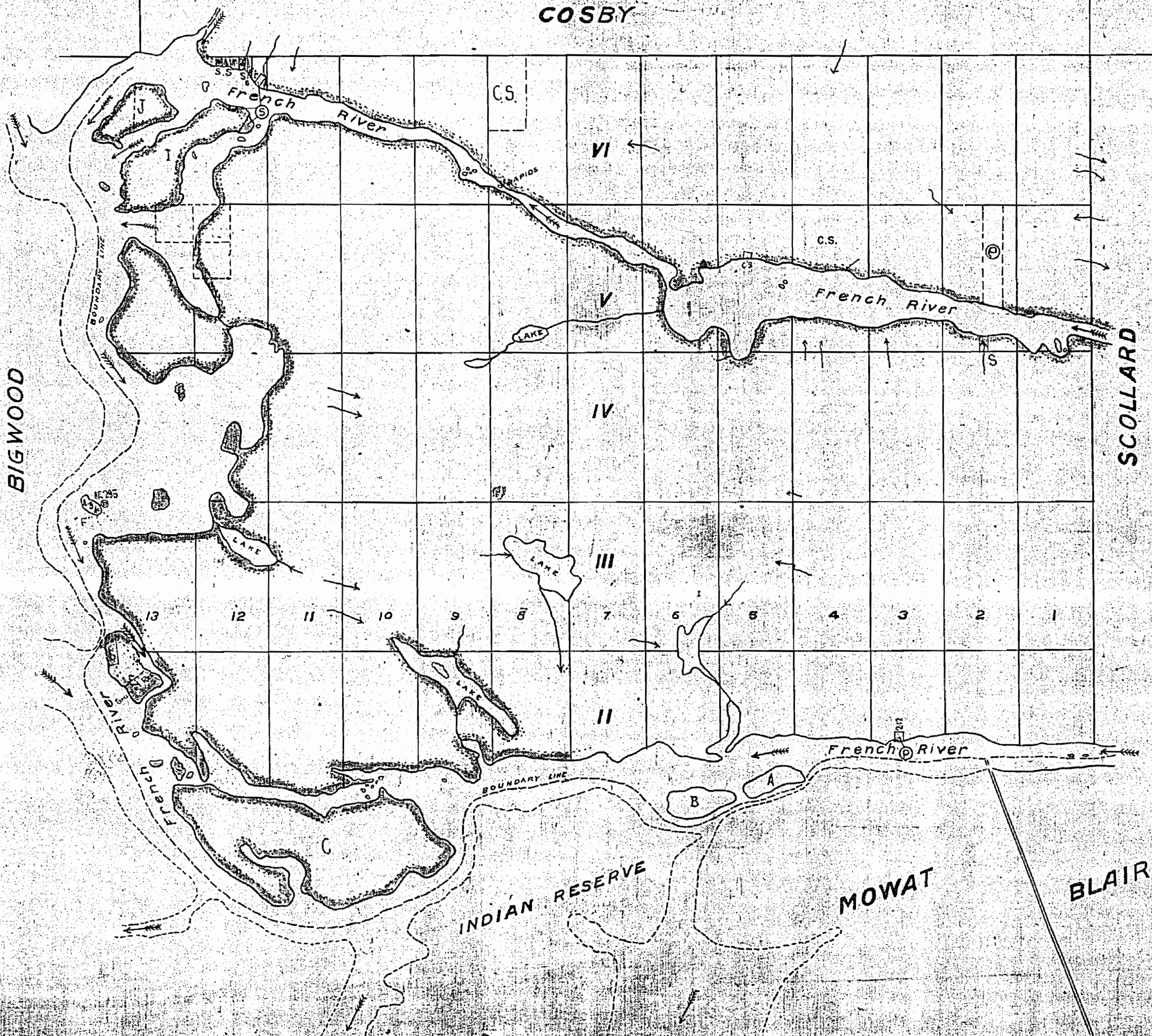

M857

Survey conducted by the Dept. of L. & S. in the year 1857.

MASON.

Scale 40 Chains to an Inch

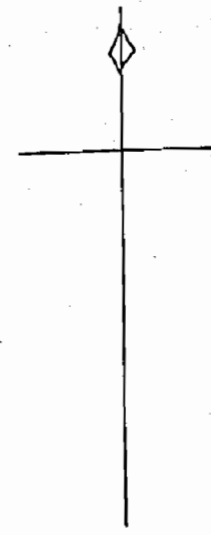

COSBY

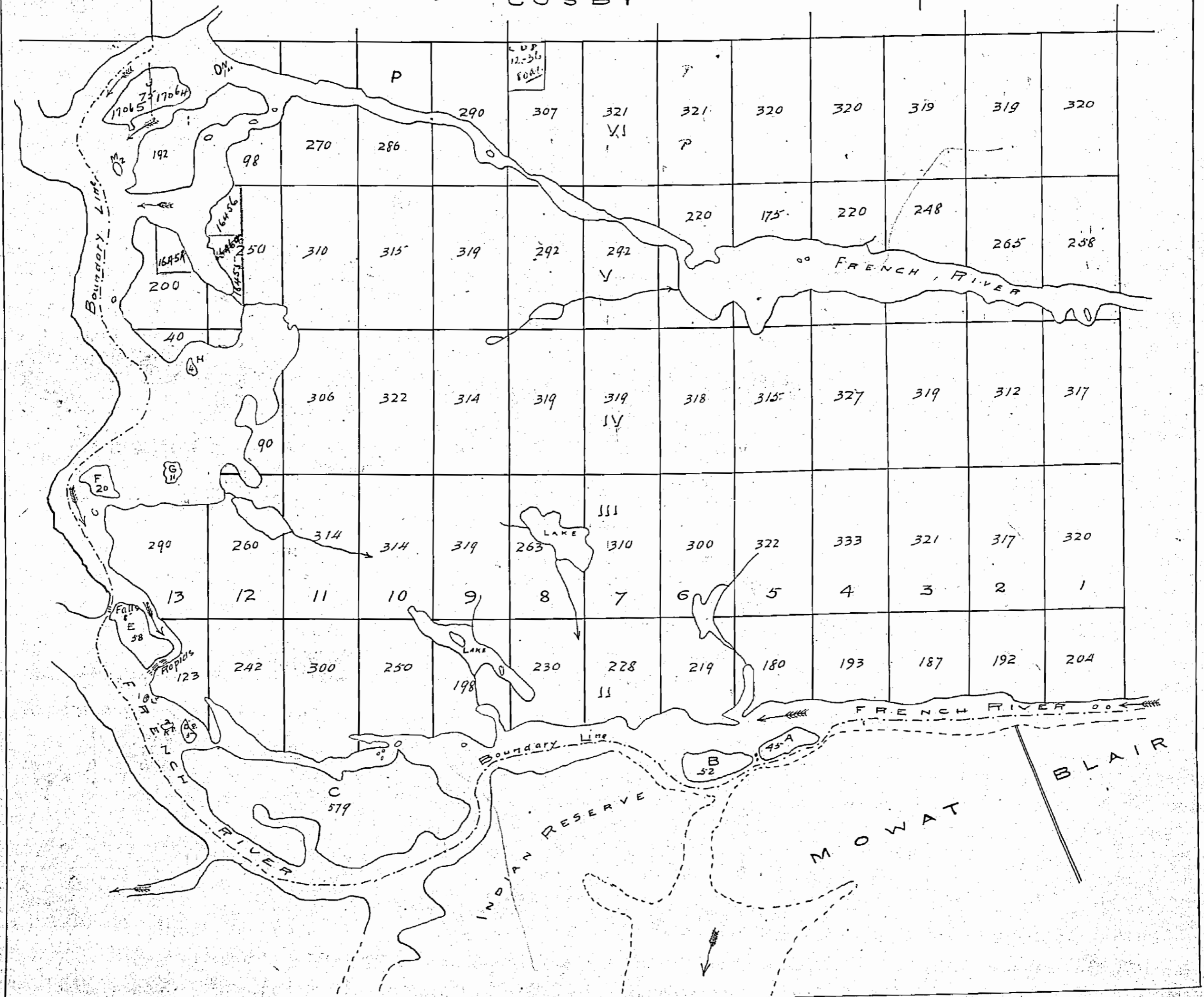

M857

INDEX TO LAND DISPOSITION

PLAN
G-4081
TOWNSHIP
MASON

M.N.R. ADMINISTRATIVE DISTRICT
SUDBURY
MINING DIVISION
SUDBURY
LAND TITLES/REGISTRY DIVISION
SUDBURY

THE INFORMATION THAT APPEARS ON THIS MAP HAS BEEN COMPILED FROM VARIOUS SOURCES AND ACCURACY IS NOT GUARANTEED. THOSE WISHING TO STAKE MINING CLAIMS SHOULD CONSULT WITH THE MINING RECORDER, MINISTRY OF NORTHERN DEVELOPMENT AND MINES, FOR ADDITIONAL INFORMATION ON THE STATUS OF THE LANDS SHOWN HEREON.

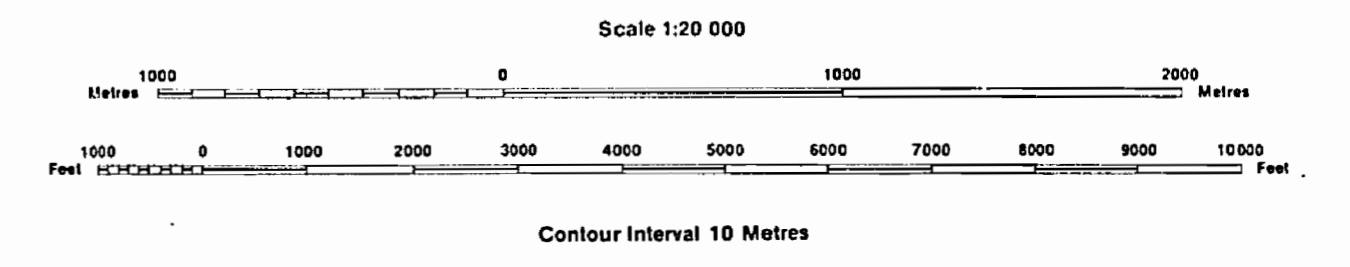

AREAS WITHDRAWN FROM DISPOSITION

- MRO - Mining Rights Only
- SRO - Surface Rights Only
- M+S - Mining and Surface Rights

SYMBOLS

- Boundary: Township, Meridian, Baseline
- Road allowance; surveyed
- shoreline
- Lot/Concession; surveyed
- unsurveyed
- Parcel; surveyed
- unsurveyed
- Right-of-way; road
- railway
- utility
- Reservation
- Cliff, Pit, Pile
- Contour: Interpolated
- Approximate
- Depression
- Control point (horizontal)
- Flooded land
- Mine head frame
- Pipeline (above ground)
- Railway; single track
- double track
- abandoned
- Road; highway, county, township
- access
- trail, bush
- Shoreline (original)
- Transmission line
- Wooded area

Description	Order No.	Date	Disposition	File
⊙ EIGHTEEN MILE ISLAND WILDERNESS AREA		8-1-60		167441

DISPOSITION OF CROWN LANDS

- Patent: Surface & Mining Rights
- Surface Rights Only
- Mining Rights Only
- Lease: Surface & Mining Rights
- Surface Rights Only
- Mining Rights Only
- Licence of Occupation
- Order-in-Council
- Cancelled
- Reservation
- Sand & Gravel

NOTES

ISLANDS IN THE FRENCH RIVER WITHDRAWN FROM STAKING FILE: 67051

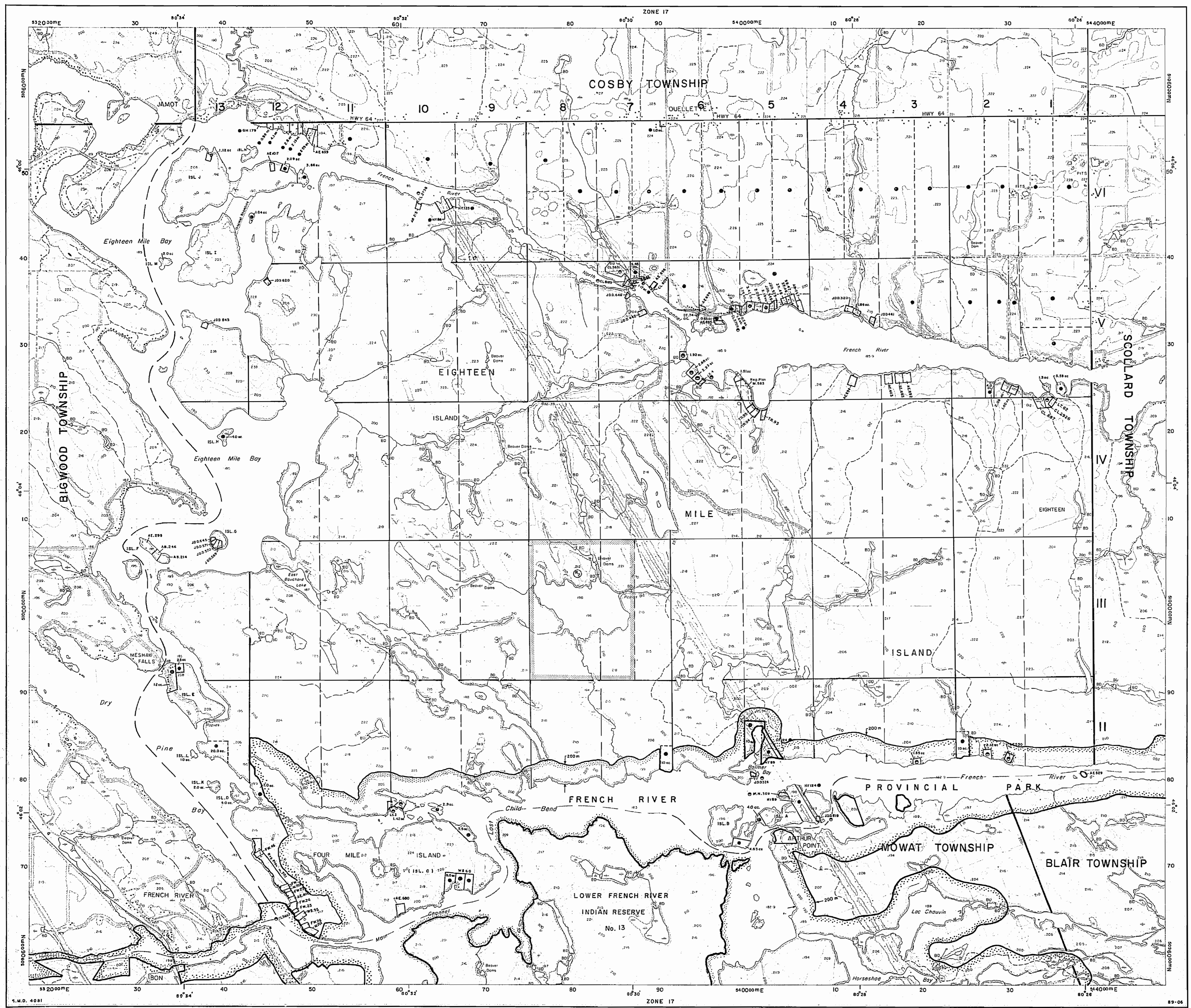

MASON

*Islands in French River waterway
from staking Nov. 23/26 Sec. 31 Sub. (C)*

Scale 40 Chains = 1 Inch

400' res

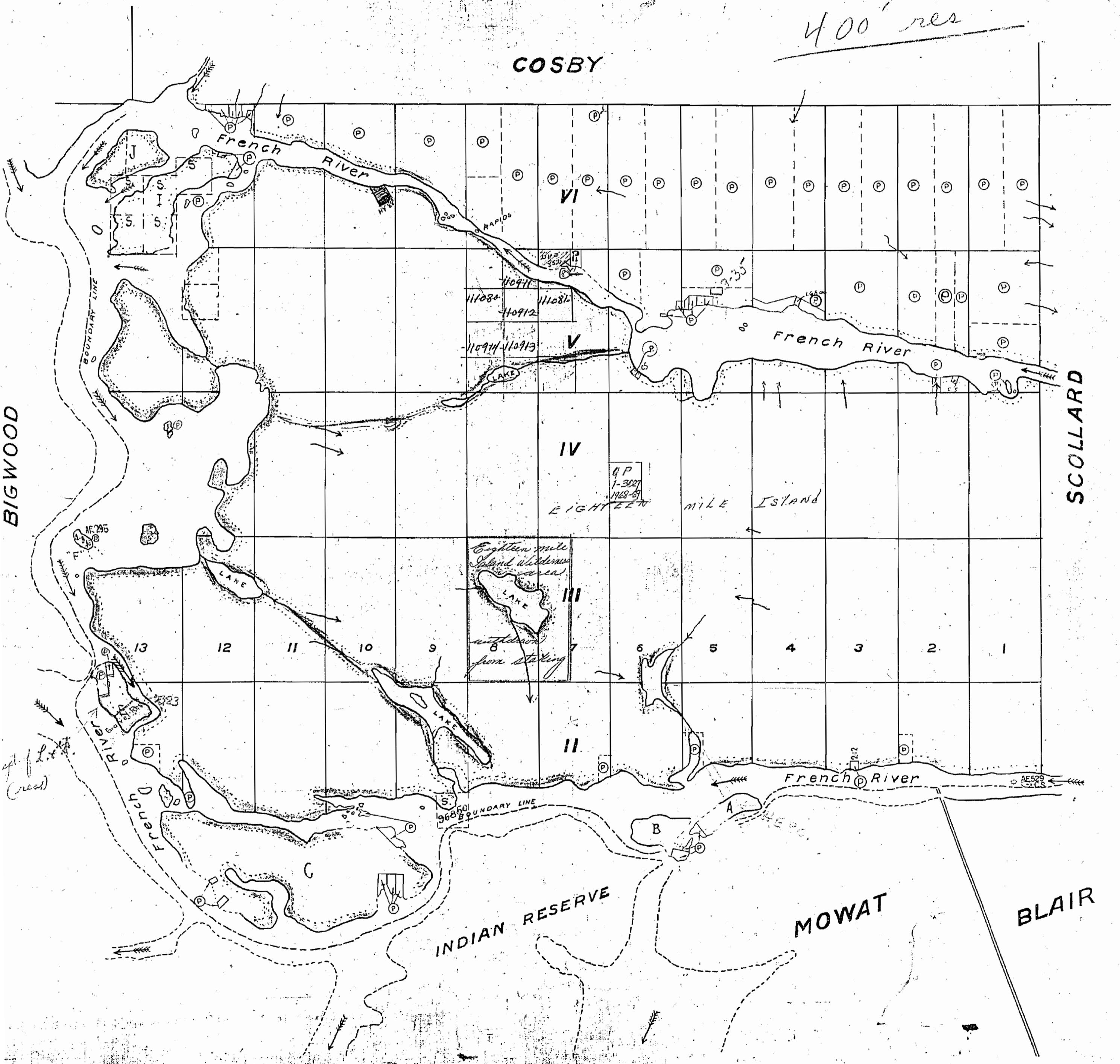

Surfaces reservations 400' wide by Dept. of L. & F. shown hereon thus

M857

MASON

Scale 40 Chains = 1 Inch

*C.S. Abrie Contours
1931*

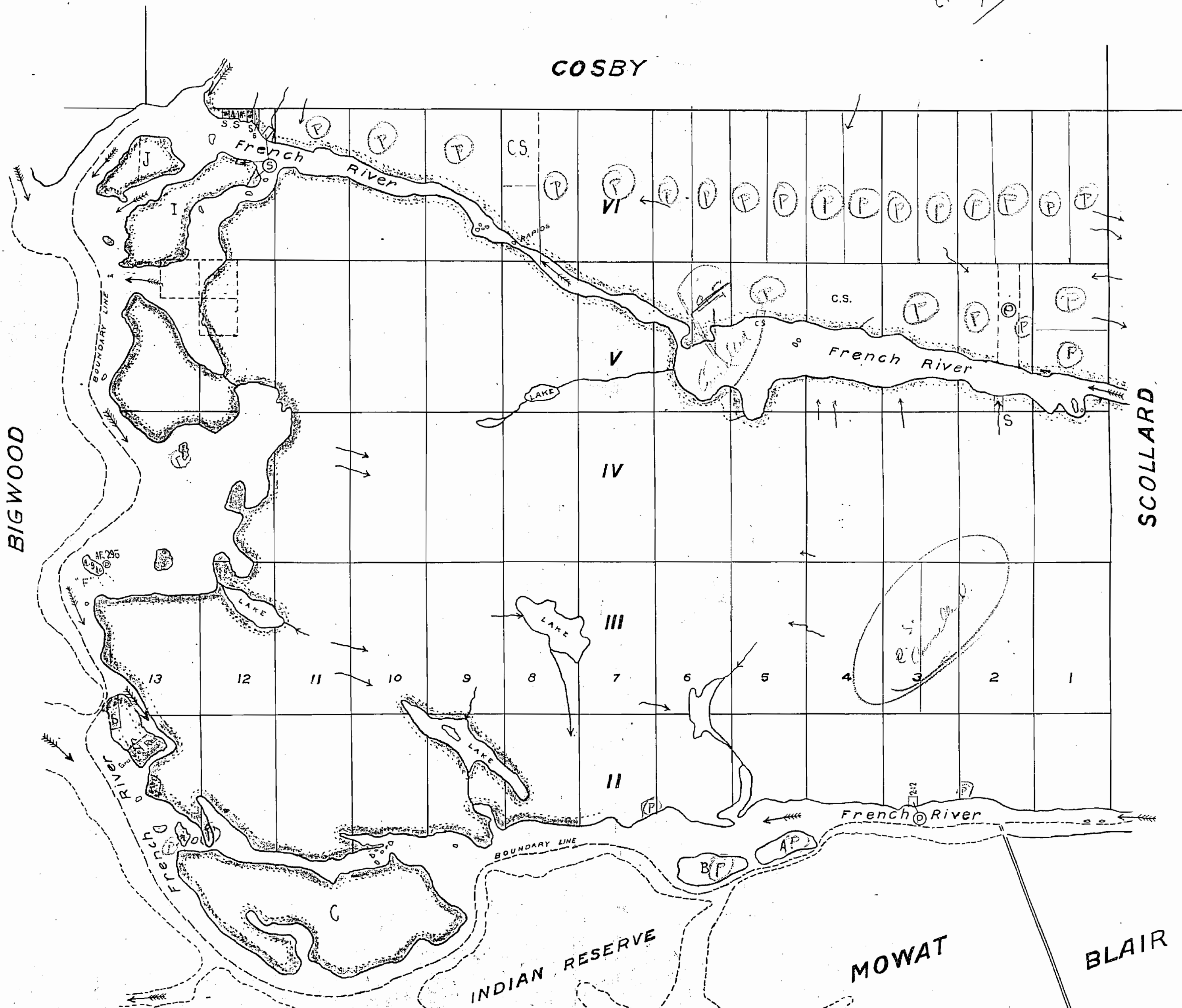

Surface reservations and works by Dept of I. & E.
shown herein thus

*On checking more patents
necessary to the survey*

M 857

Mason

MASON

Scale 40 Chains = 1 Inch

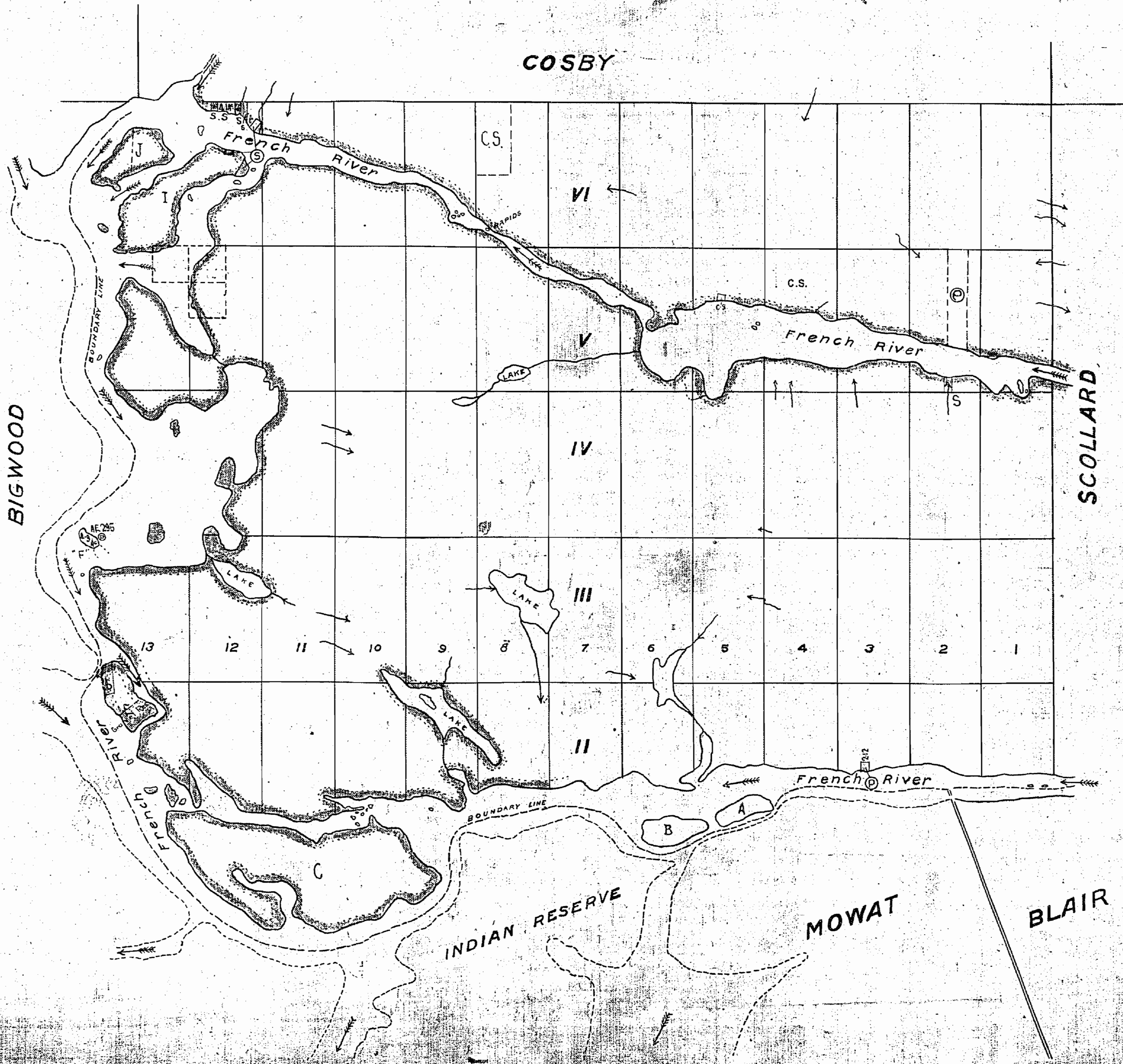

Surface elevations based on Dept. of L. & E.
shown by contour lines

M857

MASON

Scale 40 Chains = 1 Inch

*C.S. Abrie Contours
1931*

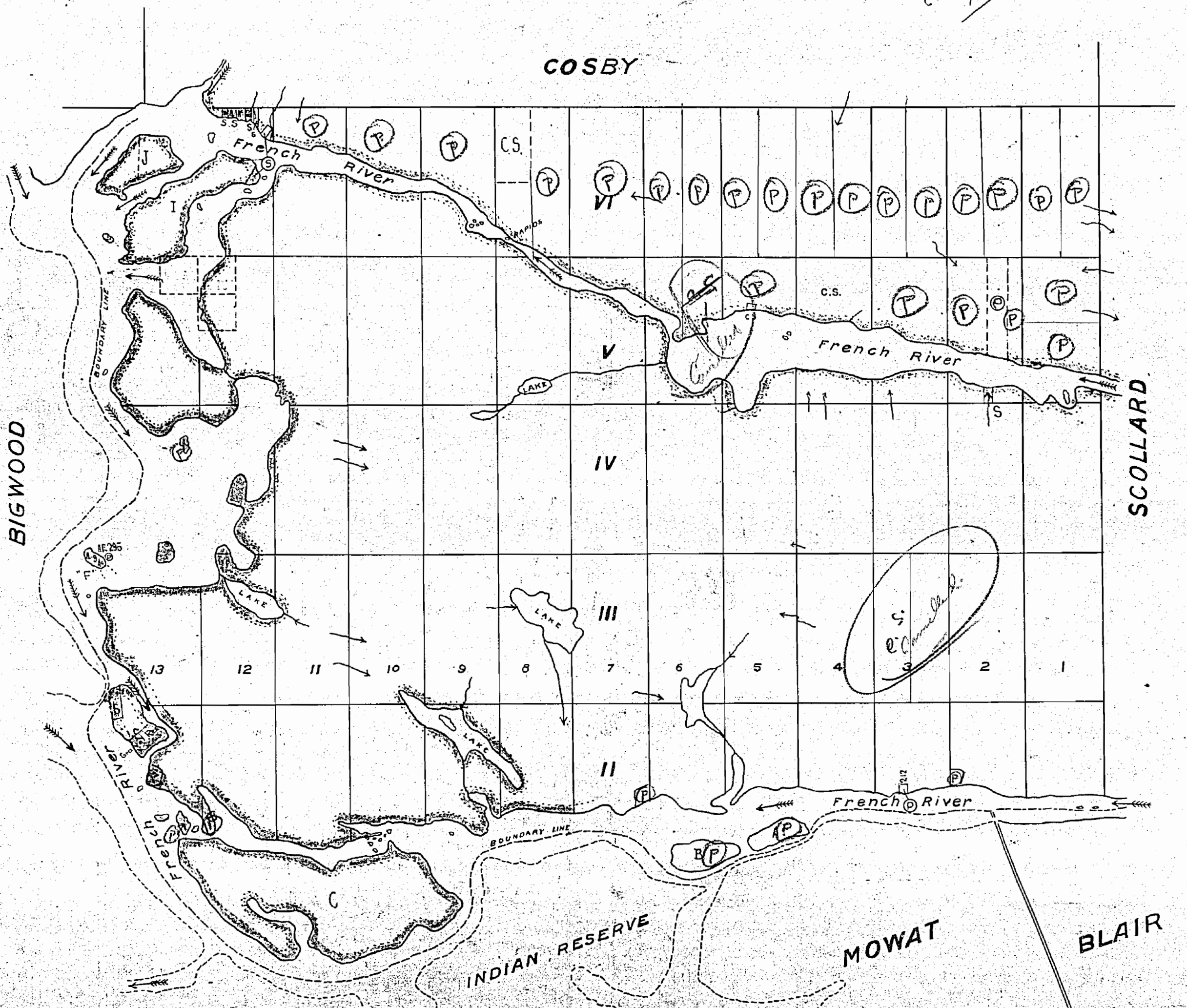

*Surface Reservations and Contours by Dept. of L. & C.
Shaw, Nelson & Co.*

*On checking more patents
were added to the survey*

M 857

S. Marshall

MASON

Scale 40 Chains=1 Inch-

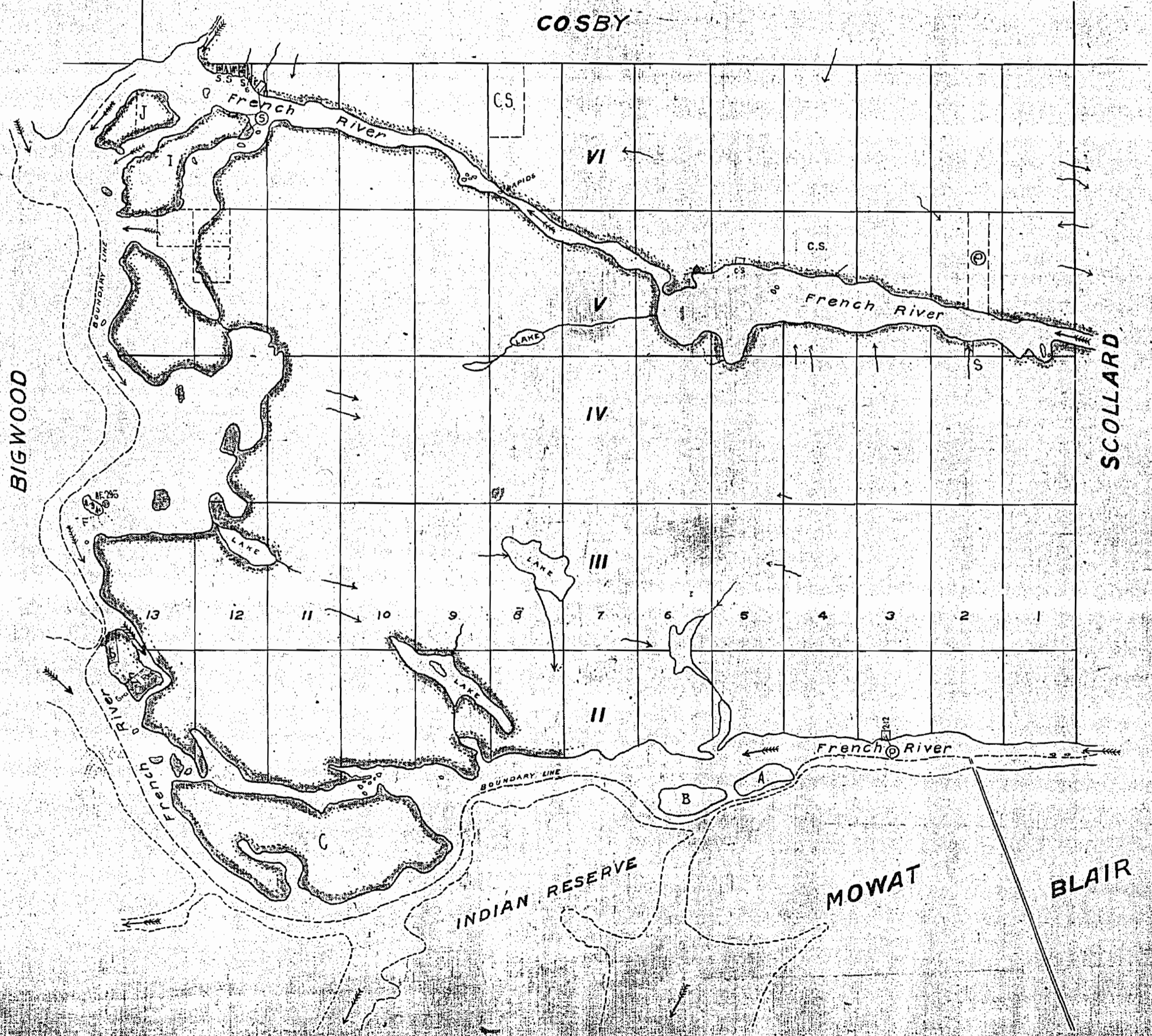

Sulfate Reservations as made by Dept. of I. & E. through Forest Service

857

MASON

Islands in French River with dimensions from staking Nov. 23/36 Sect-37 Sub (e)

Scale 40 Chains = 1 Inch

400' res

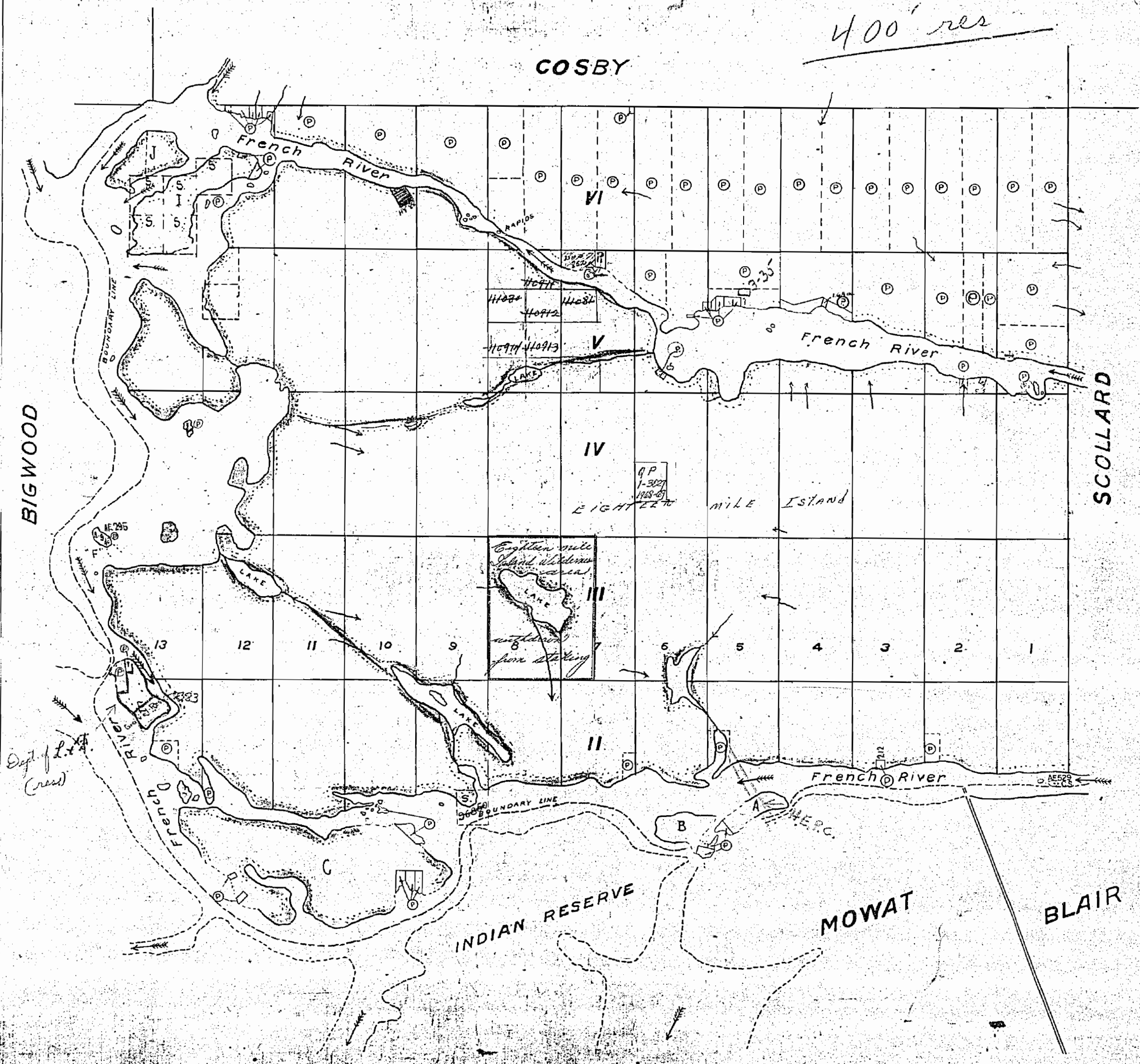

Surface reservations made by Dept. of L. & A. shown hereon this

M857

MASON

NOTE:
400 Surface Rights Reservation
around all Lakes and Rivers.

ISLANDS IN FRENCH RIVER
WITHDRAWN FROM STAKING
FILE 67051

Scale 40 Chains = 1 Inch

* Part I Plat. C.L. 2738 shows Land in front of A.B. 215
Lot 10, Con. VI - Mason's Trp. (0.29 acres)
C.L. 2826 (Plat. 1 & 2 & 3) Lot 1, Con. IV (1.585 acres) SR-9777

OFFICE USE ONLY

*Islands in French River
withdrawn from staking*

COSBY

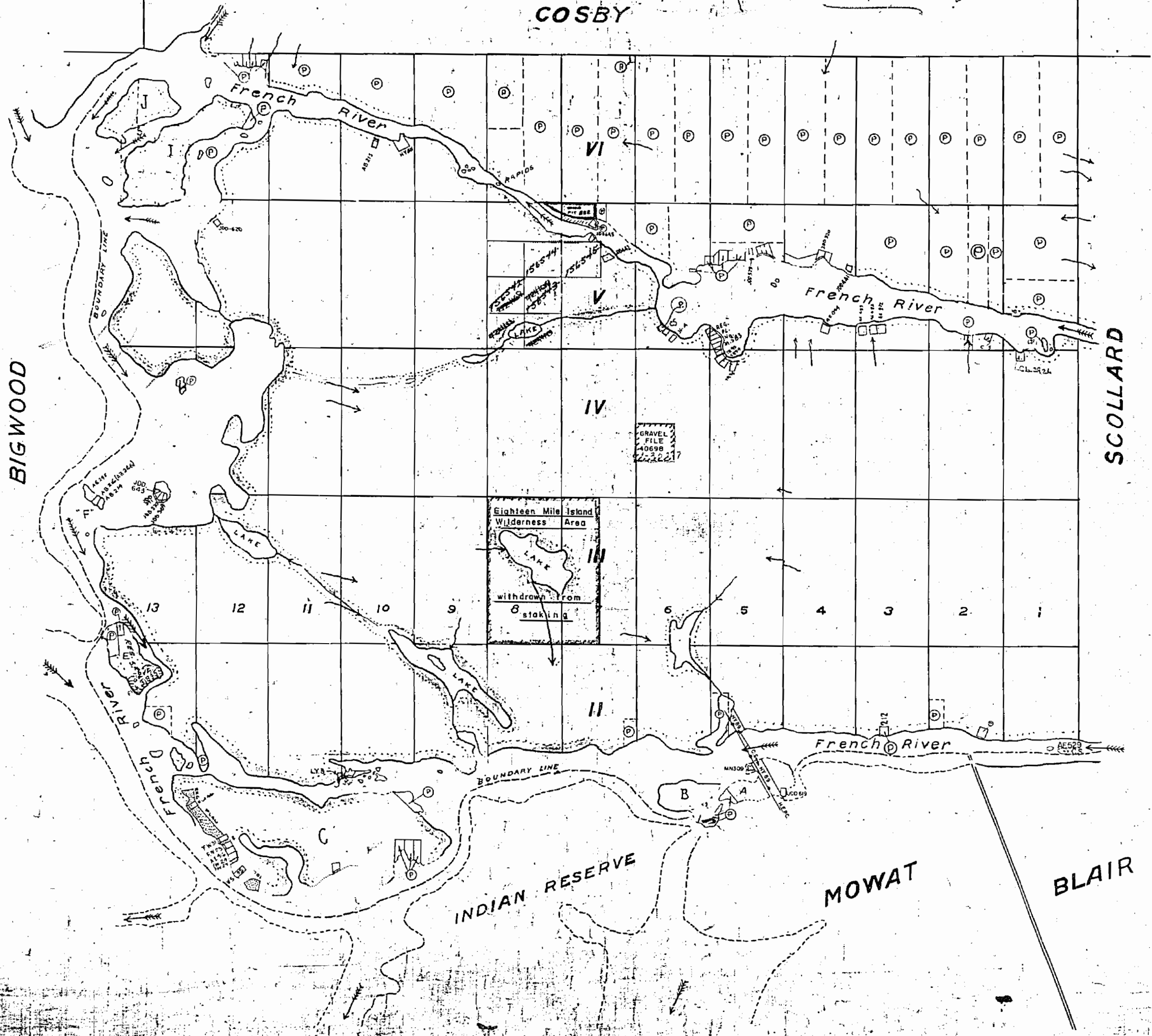

MASON.

Scale 40 Chains to an Inch

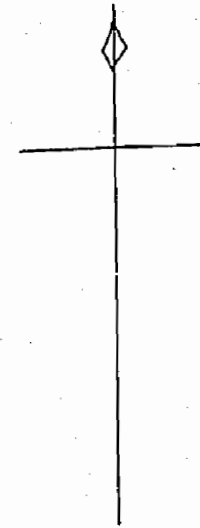

COSBY

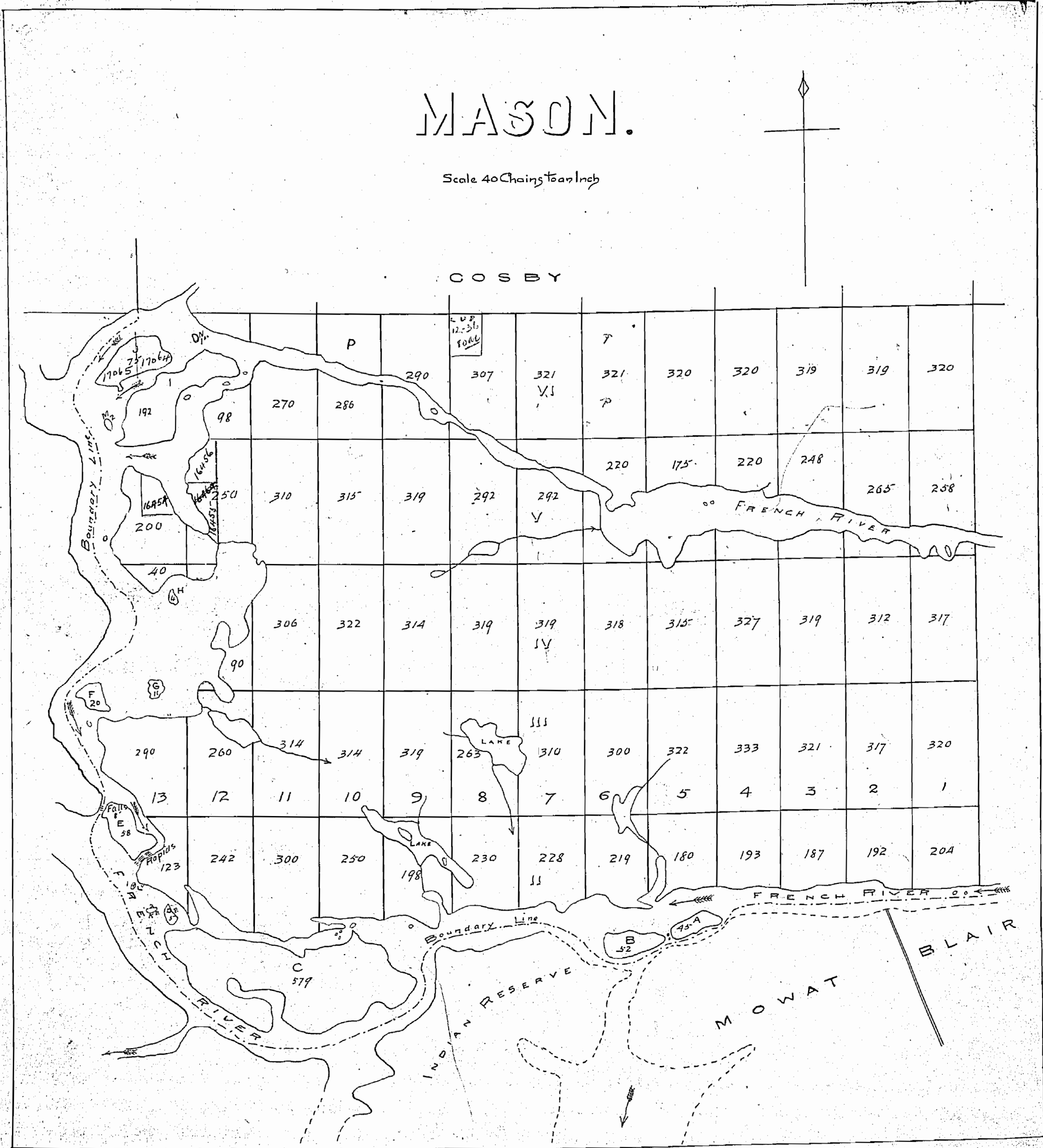

M857

857

MASON

*Islands in French River watershed
from staking Nov. 23/26 Sect. 37 Sub. (E)*

Scale 40 Chains = 1 Inch

400' res

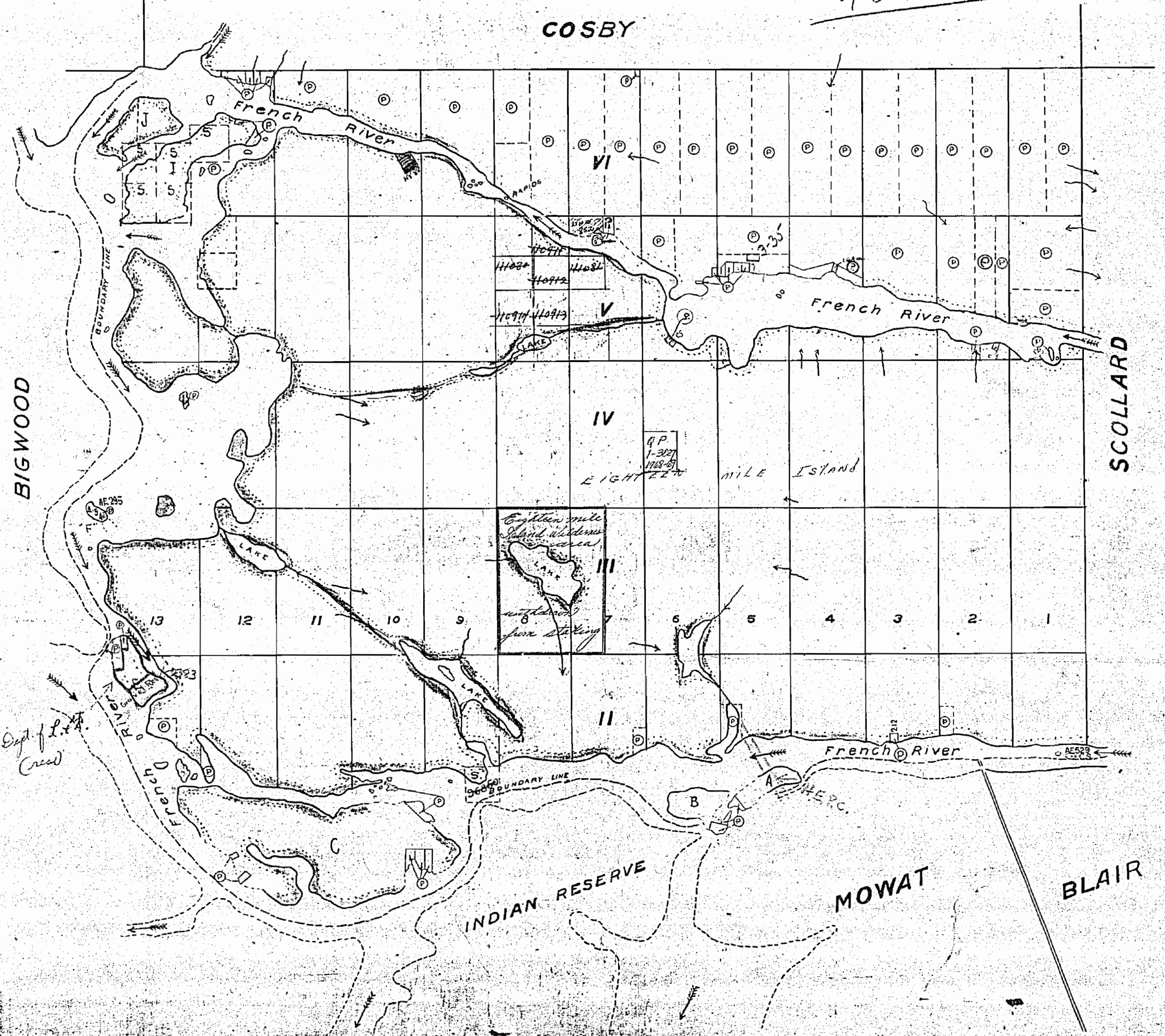

*Surface reservations made by Dept of L. & F.
Sheldon Percin 1918*

M 857