



Baxter Twp. (M.1922)

THE TOWNSHIP  
OF

**MATCHEDASH**

COUNTY OF  
SIMCOE

EASTERN ONTARIO  
MINING DIVISION

SCALE: 1-INCH=40 CHAINS

**LEGEND**

PATENTED LAND	⊙
CROWN LAND SALE	C.S.
LEASES	⊙
LOCATED LAND	⊙
LICENSE OF OCCUPATION	L.O.
MINING RIGHTS ONLY	M.R.O.
SURFACE RIGHTS ONLY	S.R.O.
ROADS	—
IMPROVED ROADS	—
KING'S HIGHWAYS	—
RAILWAYS	—
POWER LINES	—
MARSH OR MUSKEG	—
MINES	⊙
CANCELLED	⊙
TRAILS	—
EXPROPRIATION BY DOM. GOVT.	—

**NOTES**

This Map Is Not To Be Used  
FOR SURVEY PURPOSES.

Lot And Concession Lines Shown Hereon Are  
Projected From The Best Information Available,  
But Their True Position Is Not Guaranteed.  
For Official Survey Purposes Consult The  
Original Survey Plans And Field Notes Of  
Records In The Dept. Of Lands & Forests.

400' Surface Rights Reservation around all  
Lakes and Rivers.

Flooding Rights Reserved To Elevation 596.0  
Trent Canal Datum On All Lands Bordering On  
Gloucester Pool. File: 130005.

Wood Twp. (M.162)

Tay Twp.

Morrison Twp. (M.129)

Orillia Twp. (M.137)

MINING LANDS  
DATE OF ISSUE  
JAN 11 1973  
MINISTRY  
OF NATURAL RESOURCES

PLAN NO.-M.124

ONTARIO  
DEPARTMENT OF MINES  
AND NORTHERN AFFAIRS

Baxter Twp.(M.1922)

THE TOWNSHIP OF  
MATCHEDASH  
COUNTY OF SIMCOE  
EASTERN ONTARIO  
MINING DIVISION

SCALE: 1-INCH=40 CHAINS

LEGEND

- |                             |   |        |
|-----------------------------|---|--------|
| PATENTED LAND               | ⊙ | C.S.   |
| CROWN LAND SALE             | ⊙ | LOG.   |
| LEASES                      | ⊙ | L.O.   |
| LOCATED LAND                | ⊙ | M.R.O. |
| LICENSE OF OCCUPATION       | ⊙ | S.R.O. |
| MINING RIGHTS ONLY          | ⊙ |        |
| SURFACE RIGHTS ONLY         | ⊙ |        |
| ROADS                       | — |        |
| IMPROVED ROADS              | — |        |
| KING'S HIGHWAYS             | — |        |
| RAILWAYS                    | — |        |
| POWER LINES                 | — |        |
| MARSH OR MUSKES             | — |        |
| MINES                       | ⊙ |        |
| CANCELLED                   | ⊙ |        |
| TRAILS                      | — |        |
| EXPROPRIATION BY DOM. GOVT. | — |        |

NOTES

This Map Is Not To Be Used  
FOR SURVEY PURPOSES

Lot And Concession Lines Shown Herein Are Projected From The Best Information Available But Their True Position Is Not Guaranteed For Official Survey Purposes. Consult Original Survey Plans And Field Notes Of Records In The Dept. Of Lands & Forests.

400' Surface Rights Reservation around all Lakes and Rivers.

Flooding Rights Reserved To Elevation 596.0' Trent Canal Datum On All Lands Bordering On Gloucester Pool. File: 130005.

MINING LANDS  
DATE OF ISSUE  
NOV 19 1975  
MINISTRY OF NATURAL RESOURCES

Morrison Twp.(M.129)

PLAN NO.-M.124

ONTARIO  
MINISTRY OF NATURAL RESOURCES  
SURVEYS AND MAPPING BRANCH

Tay Twp.

Wood Twp.(M.162)

Orillia Twp.(M.137)

Baxter Twp.(M.1922)

Tay Twp.

Wood Twp.(M.162)

Orillia Twp.(M.137)

Morrison Twp.(M.129)

THE TOWNSHIP OF  
MATCHEDASH  
m-124  
COUNTY OF  
SIMCOE

EASTERN ONTARIO  
MINING DIVISION

SCALE:1-INCH=40CHAINS

LEGEND

- |                             |   |
|-----------------------------|---|
| PATENTED LAND for S.R.O.    | ⊙ |
| PATENTED LAND               | ⊙ |
| CROWN LAND SALE             | ⊙ |
| LEASES                      | ⊙ |
| LOCATED LAND                | ⊙ |
| LICENSE OF OCCUPATION       | ⊙ |
| MINING RIGHTS ONLY          | ⊙ |
| SURFACE RIGHTS ONLY         | ⊙ |
| ROADS                       | — |
| IMPROVED ROADS              | — |
| KING'S HIGHWAYS             | — |
| RAILWAYS                    | — |
| POWER LINES                 | — |
| MARSH OR MUSKEG             | — |
| MINES                       | — |
| CANCELLED                   | — |
| TRAILS                      | — |
| EXPROPRIATION BY DOM.GOV'T. | — |

NOTES

This Map Is Not To Be Used  
FOR SURVEY PURPOSES.

Lot And Concession Lines Shown Hereon Are  
Projected From The Best Informations Available,  
But Their True Position Is Not Guaranteed  
For Official Survey Purposes Consult The  
Original Survey Plans And Field Notes Of  
Records In The Dept. Of Lands & Forests.

400' Surface Rights Reservation around all  
Lakes and Rivers.

Flooding Rights Reserved To Elevation 596.0'  
Trent Canal Datum On All Lands Bordering On  
Gloucester Pool. File: 130005.

SAND AND GRAVEL  
QUARRY PERMIT

DATE OF ISSUE  
JUL 31 1990  
SURVEYS AND MAPPING  
BRANCH

PLAN NO.-M.124

ONTARIO  
MINISTRY OF NATURAL RESOURCES  
SURVEYS AND MAPPING BRANCH

Baxter Twp.(M.1922)

D.M. THE TOWNSHIP  
HYURONIA OF "C"

MATCHEDASH

M-124  
COUNTY OF  
SIMCOE

EASTERN ONTARIO  
MINING DIVISION

SCALE:1-INCH=40 CHAINS

LEGEND

PATENTED LAND for S.R.O.  
PATENTED LAND  
CROWN LAND SALE  
LEASES  
LOCATED LAND  
LICENSE OF OCCUPATION  
MINING RIGHTS ONLY  
SURFACE RIGHTS ONLY  
ROADS  
IMPROVED ROADS  
RAILWAYS  
POWER LINES  
MARSH OR MUSKEG  
MINES  
CANCELLED  
TRAILS  
EXPROPRIATION BY DOM. GOVT.

C.S.  
Loc.  
L.O.  
M.R.O.  
S.R.O.  
C  
E

NOTES

This Map Is Not To Be Used  
FOR SURVEY PURPOSES.

Lot And Concession Lines Shown Hereon Are  
Projected From The Best Informations Available,  
But Their True Position Is Not Guaranteed.  
For Official Survey Purposes Consult The  
Original Survey Plans And Field Notes Of  
Records In The Dept. Of Lands & Forests.

400' Surface Rights Reservation around all  
Lakes and Rivers.

Flooding Rights Reserved To Elevation 596.0'  
Trent Canal Datum On All Lands Bordering On  
Gloucester Pool. File:130005.

SAND AND GRAVEL  
QUARRY PERMIT

DATE OF ISSUE

JUL 19 1962

Ministry of Natural Resources  
TORONTO

PLAN NO.-M.124

ONTARIO  
MINISTRY OF NATURAL RESOURCES

Tay Twp.

Wood Twp.(M.162)

Morrison Twp.(M.129)

Orillia Twp.(M.137)

Baxter Twp.(M.1922)

THE TOWNSHIP  
"C" OF M-124  
**MATCHEDASH**  
D.M. HURONIA  
COUNTY OF  
SIMCOE

EASTERN ONTARIO  
MINING DIVISION

SCALE:1-INCH=40CHAINS

# LEGEND

PATENTED LAND FOR S.R.O.	CS.
PATENTED LAND	Loc.
CROWN LAND SALE	L.O.
LEASES	M.R.O.
LOCATED LAND	S.R.O.
LICENSE OF OCCUPATION	
MINING RIGHTS ONLY	
SURFACE RIGHTS ONLY	
ROADS	
IMPROVED ROADS	
KING'S HIGHWAYS	
RAILWAYS	
POWER LINES	
MARSH OR MUSKEG	
MINES	
CANCELLED	
TRAILS	
EXPROPRIATION BY L.M.S.O.T.	

## NOTES

This Map Is Not To Be Used  
FOR SURVEY PURPOSES.

Lot And Concession Lines Shown Hereon Are Projected From The Best Information Available, But Their True Position Is Not Guaranteed For Official Survey Purposes Consult The Original Survey Plans And Field Notes Of Records In The Dept. Of Lands & Forests

400' Surface Rights Reservation around all Lakes and Rivers.

Flooding Rights Reserved To Elevation 599.0' Trent Canal Datum On All Lands Bordering On Gloucester Pool. File: 130005

SAND AND GRAVEL  
QUARRY PERMIT

MINING RECORDS OFFICE - TORONTO  
**RECEIVED**  
OCT 17 1985  
AM 7:00 PM 1:00

DATE OF ISSUE  
JUL 12 1983  
Ministry of Natural Resources  
TORONTO

PLAN NO.-M.124

MINISTRY OF NATURAL RESOURCES

Tay Twp.

Wood Twp.(M.162)

Morrison Twp.(M.129)

Orillia Twp.(M.137)



Baxter Twp. (M. 1922)

Wood Twp. (M. 162)

Orillia Twp. (M. 137)

THE TOWNSHIP  
OF M124  
**MATCHEDASH**  
HURONIA DISTRICT  
COUNTY OF  
SIMCOE  
SOUTHERN ONTARIO  
MINING DIVISION  
RESIDENT GEOLOGIST - DORSET  
SCALE: 1-INCH = 40 CHAINS

**LEGEND**  
PATENTED LAND FOR S.R.O.  
PATENTED LAND  
CROWN LAND SALE  
LEASES  
LOCATED LAND  
LICENSE OF OCCUPATION  
MINING RIGHTS ONLY  
SURFACE RIGHTS ONLY  
ROADS  
IMPROVED ROADS  
KING'S HIGHWAYS  
RAILWAYS  
POWER LINES  
MARSH OR MUSKEG  
MINES  
CANCELLED  
TRAILS  
EXPROPRIATION BY DOM. GOVT.

**NOTES**  
This Map Is Not To Be Used  
FOR SURVEY PURPOSES.

Lot And Concession Lines Shown Hereon Are  
Projected From The Best Information Available.  
But Their True Position Is Not Guaranteed.  
For Official Survey Purposes Consult The  
Original Survey Plans And Field Notes Of  
Records In The Dept. Of Lands & Forests.

400' Surface Rights Reservation around all  
Lakes and Rivers.

Flooding Rights Reserved To Elevation 596.0'  
Trent Canal Datum On All Lands Bordering On  
Gloucester Pool. File: 130005.

SAND AND GRAVEL  
QUARRY PERMIT

NATURAL RESOURCES  
OCT 11 1985  
TITLES SECTION

MINING RECORDS OFFICE - TORONTO  
RECEIVED  
OCT 14 1985

PLAN NO. - M. 124

ONTARIO  
MINISTRY OF NATURAL RESOURCES  
SURVEY AND MAPPING BRANCH

Baxter Twp.(M.1922)

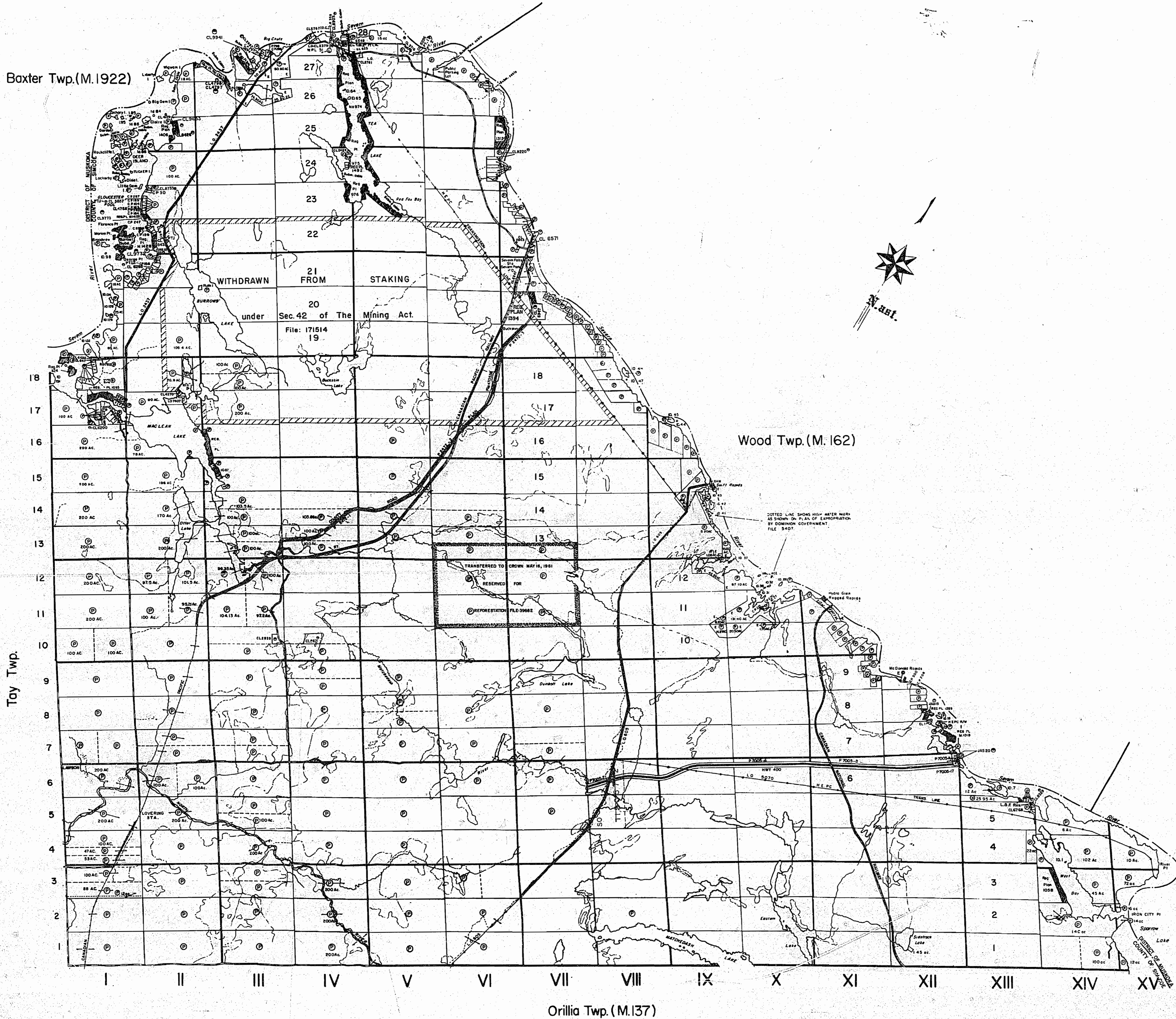

THE TOWNSHIP OF  
**MATCHEDASH**  
COUNTY OF  
SIMCOE  
SOUTHERN ONTARIO  
MINING DIVISION  
SCALE: 1-INCH=40 CHAINS

LEGEND	
PATENTED LAND for S.R.O.	○
PATENTED LAND	○
CROWN LAND SALE	○
LEASES	○
LOCATED LAND	○
LICENSE OF OCCUPATION	○
MINING RIGHTS ONLY	○
SURFACE RIGHTS ONLY	○
ROADS	—
IMPROVED ROADS	—
KING'S HIGHWAYS	—
RAILWAYS	—
POWER LINES	—
MARSH OR MUSKEG	—
MINES	—
CANCELLED	—
TRAILS	—
EXPROPRIATION BY DOM. GOVT.	—

**NOTES**  
This Map Is Not To Be Used  
FOR SURVEY PURPOSES.

Lot And Concession Lines Shown Hereon Are  
Projected From The Best Informations Available,  
But Their True Position Is Not Guaranteed  
For Official Survey Purposes Consult The  
Original Survey Plans And Field Notes Of  
Records In The Dept. Of Lands & Forests.

400' Surface Rights Reservation around all  
Lakes and Rivers.

Flooding Rights Reserved To Elevation 596.0'  
Trent Canal Datum On All Lands Bordering On  
Gloucester Pool. File: 130005.

SAND AND GRAVEL  
QUARRY PERMIT

THE INFORMATION THAT  
APPEARS ON THIS MAP  
HAS BEEN COMPILED  
FROM VARIOUS SOURCES  
AND ACCURACY IS NOT  
GUARANTEED. THOSE  
WISHING TO STAKE MIN-  
ING CLAIMS SHOULD CON-  
SULT WITH THE MINING  
RECORDS, MINISTRY OF  
NORTHERN DEVELOP-  
MENT AND MINES, FOR AD-  
DITIONAL INFORMATION  
ON THE STATUS OF THE  
LANDS SHOWN HEREON.

PLAN NO.-M.124

ONTARIO  
MINISTRY OF NATURAL RESOURCES  
SURVEYS AND MAPPING BRANCH