

TOWNSHIP OF NEWMARKET

REFERENCES

NOTE

LOT AND CONCESSION LINES SHOWN HEREON ARE PROJECTED FROM THE BEST INFORMATION AVAILABLE, BUT THEIR TRUE POSITION IS NOT GUARANTEED.

FOR LEGAL AND SURVEY PURPOSES CONSULT THE ORIGINAL SURVEY PLANS AND FIELD NOTES OF RECORD IN THE DEPARTMENT OF LANDS AND FORESTS, TORONTO.

ACREAGES SHOWN IN RESPECT OF PATENTED LOTS ARE IN ACCORDANCE WITH AREA GRANTED.

AREAS WITHDRAWN FROM DISPOSITION

M.R.O. - MINING RIGHTS ONLY  
S.R.O. - SURFACE RIGHTS ONLY  
M.F.S. - MINING AND SURFACE RIGHTS

AGGREGATE PERMIT

AGGREGATE PERMIT

AGGREGATE PERMIT

AGGREGATE PERMIT

AGGREGATE PERMIT

AGGREGATE PERMIT

AGGREGATE PERMIT

AGGREGATE PERMIT

AGGREGATE PERMIT

AGGREGATE PERMIT

AGGREGATE PERMIT

AGGREGATE PERMIT

AGGREGATE PERMIT

AGGREGATE PERMIT

AGGREGATE PERMIT

AGGREGATE PERMIT

AGGREGATE PERMIT

AGGREGATE PERMIT

AGGREGATE PERMIT

AGGREGATE PERMIT

AGGREGATE PERMIT

AGGREGATE PERMIT

AGGREGATE PERMIT

AGGREGATE PERMIT

AGGREGATE PERMIT

AGGREGATE PERMIT

AGGREGATE PERMIT

AGGREGATE PERMIT

AGGREGATE PERMIT

AGGREGATE PERMIT

AGGREGATE PERMIT

AGGREGATE PERMIT

AGGREGATE PERMIT

AGGREGATE PERMIT

AGGREGATE PERMIT

AGGREGATE PERMIT

AGGREGATE PERMIT

AGGREGATE PERMIT

AGGREGATE PERMIT

AGGREGATE PERMIT

AGGREGATE PERMIT

AGGREGATE PERMIT

AGGREGATE PERMIT

AGGREGATE PERMIT

AGGREGATE PERMIT

AGGREGATE PERMIT

AGGREGATE PERMIT

AGGREGATE PERMIT

AGGREGATE PERMIT

AGGREGATE PERMIT

AGGREGATE PERMIT

AGGREGATE PERMIT

AGGREGATE PERMIT

AGGREGATE PERMIT

AGGREGATE PERMIT

AGGREGATE PERMIT

AGGREGATE PERMIT

AGGREGATE PERMIT

AGGREGATE PERMIT

AGGREGATE PERMIT

AGGREGATE PERMIT

AGGREGATE PERMIT

AGGREGATE PERMIT

AGGREGATE PERMIT

AGGREGATE PERMIT

LITTLE TOWNSHIP OF

CALVERT TOWNSHIP

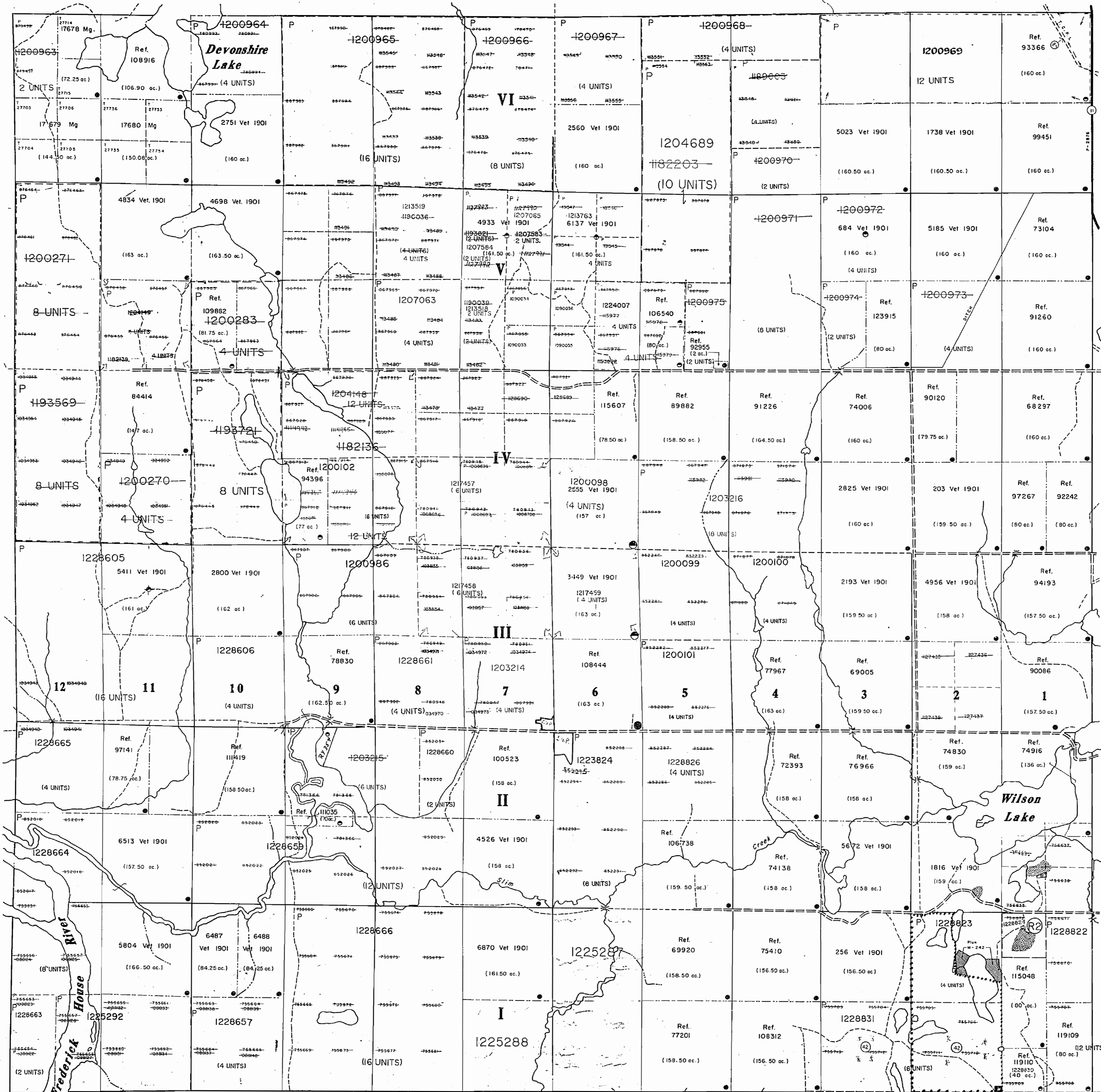

**TOPOGRAPHY**  
LAKES, RIVERS, ETC., FROM FOREST RESOURCES INVENTORY SHEETS No 486804 AND 487804

**SURVEYS**  
TOWNSHIP OF McCART SUBDIVIDED BY A.D. GRIFFIN, O.L.S., 1904. FIELD NOTE BOOK 1533.  
WEST LIMIT OF McCART TOWNSHIP (SEE LITTLE TWP) SURVEY BY J.W. FITZGERALD, O.L.S., 1904. FIELD NOTE BOOK 1402.  
EAST LIMIT OF McCART TOWNSHIP (SEE CALVERT TWP) SURVEY BY ALEXANDER BAIRD, O.L.S., 1904. FIELD NOTE BOOK 1009.  
THIRD MERIDIAN (EAST LIMIT OF McCART TWP) BY WILLIAM GALBRAITH, O.L.S., 1904. FIELD NOTE BOOK 2363.  
BASE LINE (SOUTH LIMIT OF McCART TWP) BY T.J. PATTEN, O.L.S., 1903. FIELD NOTE BOOK 2460.

**DATE OF ISSUE**  
NOV 26 1997  
PROVINCIAL RECORDING OFFICE - SUDBURY

**LEGEND**

HIGHWAY AND ROUTE No.	
OTHER ROADS	
TRAILS	
SURVEYED LINES:	
TOWNSHIPS, BASE LINES, ETC.	
LOTS, MINING CLAIMS, PARCELS, ETC.	
UNSURVEYED LINES:	
LOT LINES	
PARCEL BOUNDARY	
MINING CLAIMS ETC.	
RAILWAY AND RIGHT OF WAY	
UTILITY LINES	
NON-PERENNIAL STREAM	
FLOODING OR FLOODING RIGHTS	
SUBDIVISION OR COMPOSITE PLAN RESERVATIONS	
ORIGINAL SHORELINE	
MARSH OR MUSKEG	
MINES	
TRAVERSE MONUMENT	

**DISPOSITION OF CROWN LANDS**

TYPE OF DOCUMENT	SYMBOL
PATENT, SURFACE & MINING RIGHTS	
" SURFACE RIGHTS ONLY	
" MINING RIGHTS ONLY	
LEASE, SURFACE & MINING RIGHTS	
" SURFACE RIGHTS ONLY	
" MINING RIGHTS ONLY	
LICENCE OF OCCUPATION	
ORDER-IN-COUNCIL	
RESERVATION	
CANCELLED	
SAND & GRAVEL	
L.U.P.	

NOTE: MINING RIGHTS IN PARCELS PATENTED PRIOR TO MAY 2, 1913, VESTED IN ORIGINAL PATENTEE BY THE PUBLIC LANDS ACT, R.S.O. 1910, CHAP. 380, SEC. 93, SUBSEC. 1.

••• Ski trails within boundary.

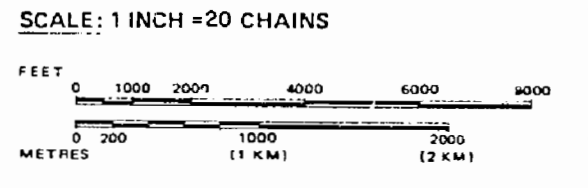

TOWNSHIP  
**McCART**

M.N.R. ADMINISTRATIVE DISTRICT  
COCHRANE  
MINING DIVISION  
PORCUPINE  
LAND TITLES / REGISTRY DIVISION  
COCHRANE

Ministry of Natural Resources  
Ministry of Northern Development and Mines  
Ontario

TOWNSHIP OF DUNDONALD

THE INFORMATION THAT APPEARS ON THIS MAP HAS BEEN COMPILED FROM VARIOUS SOURCES, AND ACCURACY IS NOT GUARANTEED. THOSE WISHING TO STAKE MINING CLAIMS OR OIL CONVEYANCE WITH THE MINING DIVISION OF THE DEPARTMENT OF LANDS AND FORESTS, TORONTO, SHOULD CONSULT THE ORIGINAL INFORMATION ON THE STATUS OF THE LANDS SHOWN HEREON.

545

Newmarket Twp

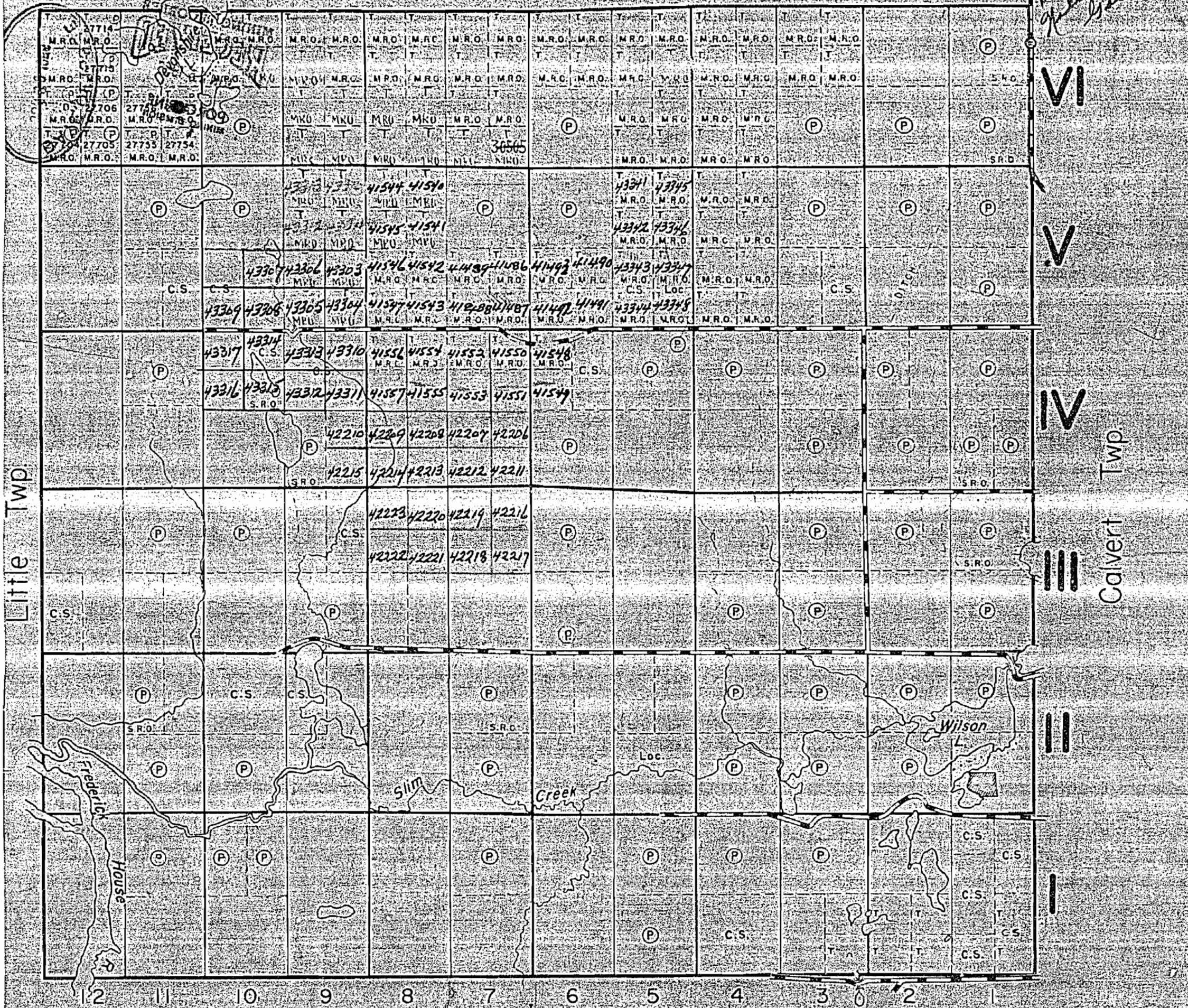

THE TOWNSHIP OF COCHRANE

McGART

DISTRICT OF COCHRANE  
PORCUPINE MINING DIVISION

SCALE: 1-INCH=40 CHAINS

LEGEND

- PATENTED LAND (P)
- CROWN LAND SALE (CS)
- LEASES (L)
- LOCATED LAND (Loc)
- LICENSE OF OCCUPATION (L.O.)
- ROADS (—)
- IMPROVED ROADS (—)
- RAILWAYS (—)
- POWER LINES (—)
- MARSH OR MUSKEG (—)
- MINERAL RIGHTS ONLY (M.R.O.)
- SURFACE RIGHTS ONLY (S.R.O.)

NOTES

400 Reserve to Dept of Lands & Forests shown thus

Reserve to Dept of Highways shown thus

Surface rights reserved on all lands staked & patented after 21 May 1945 — See O.C. 25 April 1945.

By regulations passed previously sale or other disposition of land in this Township has been limited to surface R.O. effective Oct 27, 1942.

PLAN NO - M-545

DEPARTMENT OF MINES  
— ONTARIO —

Newmarket Twp

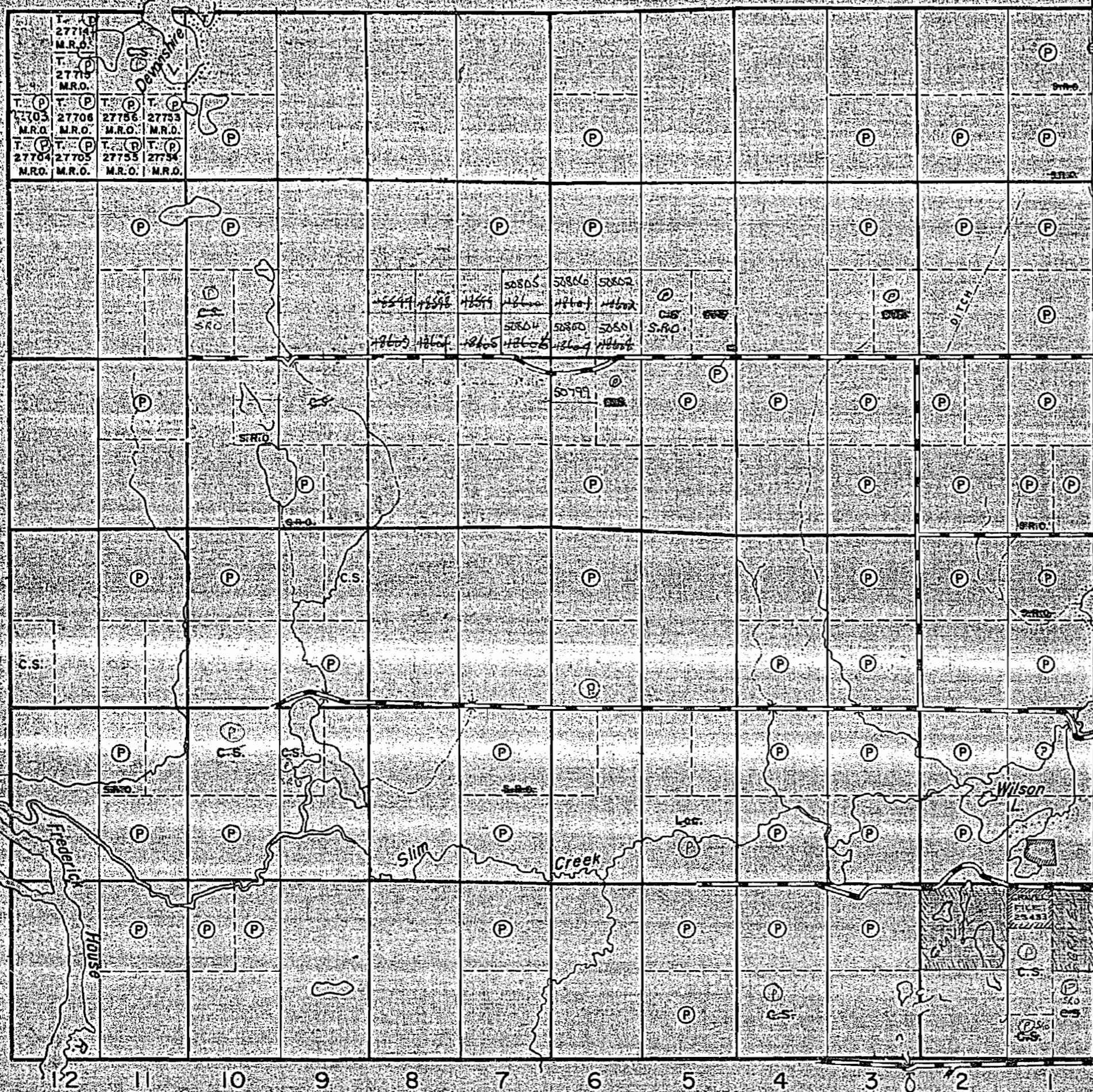

Dundonald Twp

THE TOWNSHIP OF

**Mc CART**

DISTRICT OF COCHRANE

PORCUPINE MINING DIVISION

SCALE: 1-INCH=40 CHAINS

LEGEND

PATENTED LAND	(P)
CROWN LAND SALE	C.S.
LEASES	(L)
LOCATED LAND	Loc.
LICENSE OF OCCUPATION	L.O.
ROADS	(---)
IMPROVED ROADS	(=)
RAILWAYS	(=)
POWER LINES	(---)
MARSH OR MUSKEG	(~)
MINERAL RIGHTS ONLY	M.R.O.
SURFACE RIGHTS ONLY	S.R.O.

NOTES

400' Reserve to Dept. of Lands & Forests shown thus: (---)

Reserve to Dept. of Highways shown thus: (---)

Surface rights reserved on all lands staked & patented after 21 May 1945 — See O.C. 25 April 1945.

By regulations passed previously, sale or other disposition of land in this Township has been limited to surface R.O. effective Oct. 27, 1942.

PLAN NO. - M-545

DEPARTMENT OF MINES  
— ONTARIO —

Newmarket Twp

THE TOWNSHIP OF

McCART

DISTRICT OF COCHRANE

PORCUPINE MINING DIVISION

SCALE: 1-INCH=40 CHAINS

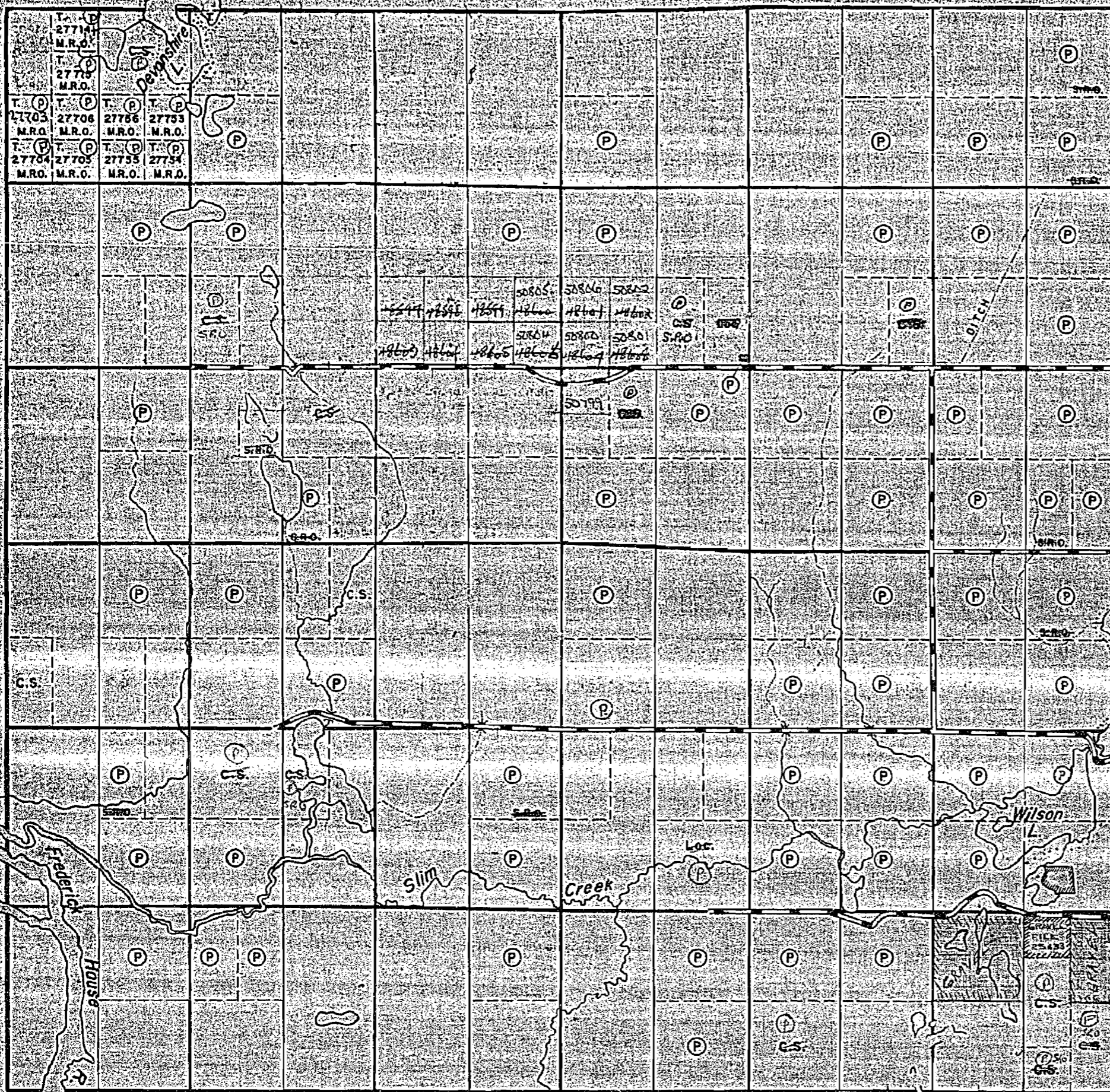

VI

V

IV

III

II

Calvert Twp.

LEGEND

PATENTED LAND	(P)
CROWN LAND SALE	C.S.
LEASES	(L)
LOCATED LAND	Loc.
LICENSE OF OCCUPATION	L.O.
ROADS	(Road symbol)
IMPROVED ROADS	(Improved road symbol)
RAILWAYS	(Railway symbol)
POWER LINES	(Power line symbol)
MARSH OR MUSKEG	(Marsh symbol)
MINERAL RIGHTS ONLY	M.R.O.
SURFACE RIGHTS ONLY	S.R.O.

NOTES

400' Reserve to Dept. of Lands & Forests shown thus: (Symbol)

Reserve to Dept. of Highways shown thus: (Symbol)

Surface rights reserved on all lands staked & patented after 21 May 1945 — See O.C. 25 April 1945.

By regulations passed previously, sale or other disposition of land in this Township has been limited to surface R.O. effective Oct. 27, 1942.

Little Twp.

Dundonald Twp.

PLAN NO - M-545

DEPARTMENT OF MINES  
— ONTARIO —

Newmarket Twp



THE TOWNSHIP  
OF  
**McGART**

DISTRICT OF  
COCHRANE  
PORCUPINE  
MINING DIVISION

SCALE 1-INCH=40 CHAINS

LEGEND

- PATENTED LAND P
- CROWN LAND SALE CS
- LEASES L
- LOCATED LAND L1
- LICENSE OF OCCUPATION L2
- ROADS R
- IMPROVED ROADS R1
- RAILWAYS R2
- POWER LINES R3
- MARSH OR MUSKEG M
- MINERAL RIGHTS ONLY M.R.O.
- SURFACE RIGHTS ONLY S.R.O.

NOTES

400' Surface Rights Reservation around all Lakes and Rivers

Reserve to Dept. of Highways shown thus

Surface rights reserved on all lands shown as patented under C.M. 1940. See O.C. 25 April 1945.

By regulations passed previously sale or other disposition of land in this Township has been limited to surface R.O. effective Oct. 27, 1942.

CLAIMS FOR  
CROWN SURFACE  
AND MINERAL  
RIGHTS  
SEE LIST

PLAN NO - M-545

DEPARTMENT OF MINES  
— ONTARIO —

545

Newmarket Twp

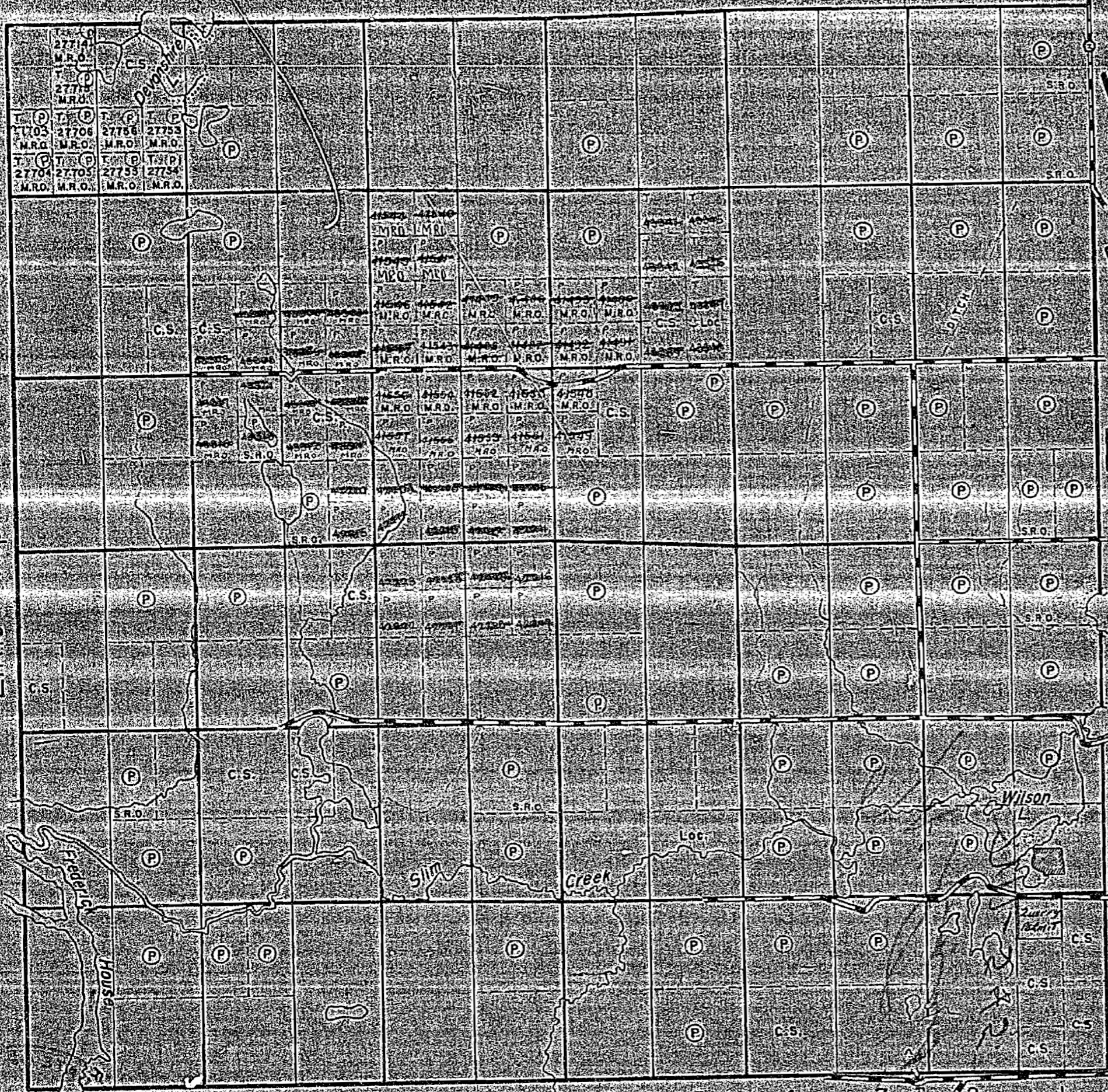

Dundonald Twp

THE TOWNSHIP  
OF

**McGART**

DISTRICT OF  
COCHRANE

PORCUPINE  
MINING DIVISION

SCALE 1-INCH=40 CHAINS

**LEGEND**

PATENTED LAND	(P)
CROWN LAND SALE	(C.S.)
LEASES	(L)
LOCATED LAND	(Loc)
LICENSE OF OCCUPATION	(L.O.)
ROADS	(—)
IMPROVED ROADS	(—)
RAILWAYS	(—)
POWER LINES	(—)
MARSH OR MUSKEG	(—)
MINERAL RIGHTS ONLY	(M.R.O.)
SURFACE RIGHTS ONLY	(S.R.O.)

**NOTES**

400' Reserve to Dept. of Lands & Forests shown thus (—)

Reserve to Dept. of Highways shown thus (—)

Surface rights reserved on all lands staked & patented after 21 May 1945 — See O.C. 25 April 1945

By regulations passed previously sale or other disposition of land in this Township has been limited to surface R.O. effective Oct. 27, 1942

PLAN NO - M-545

DEPARTMENT OF MINES  
— ONTARIO —

Newmarket Twp

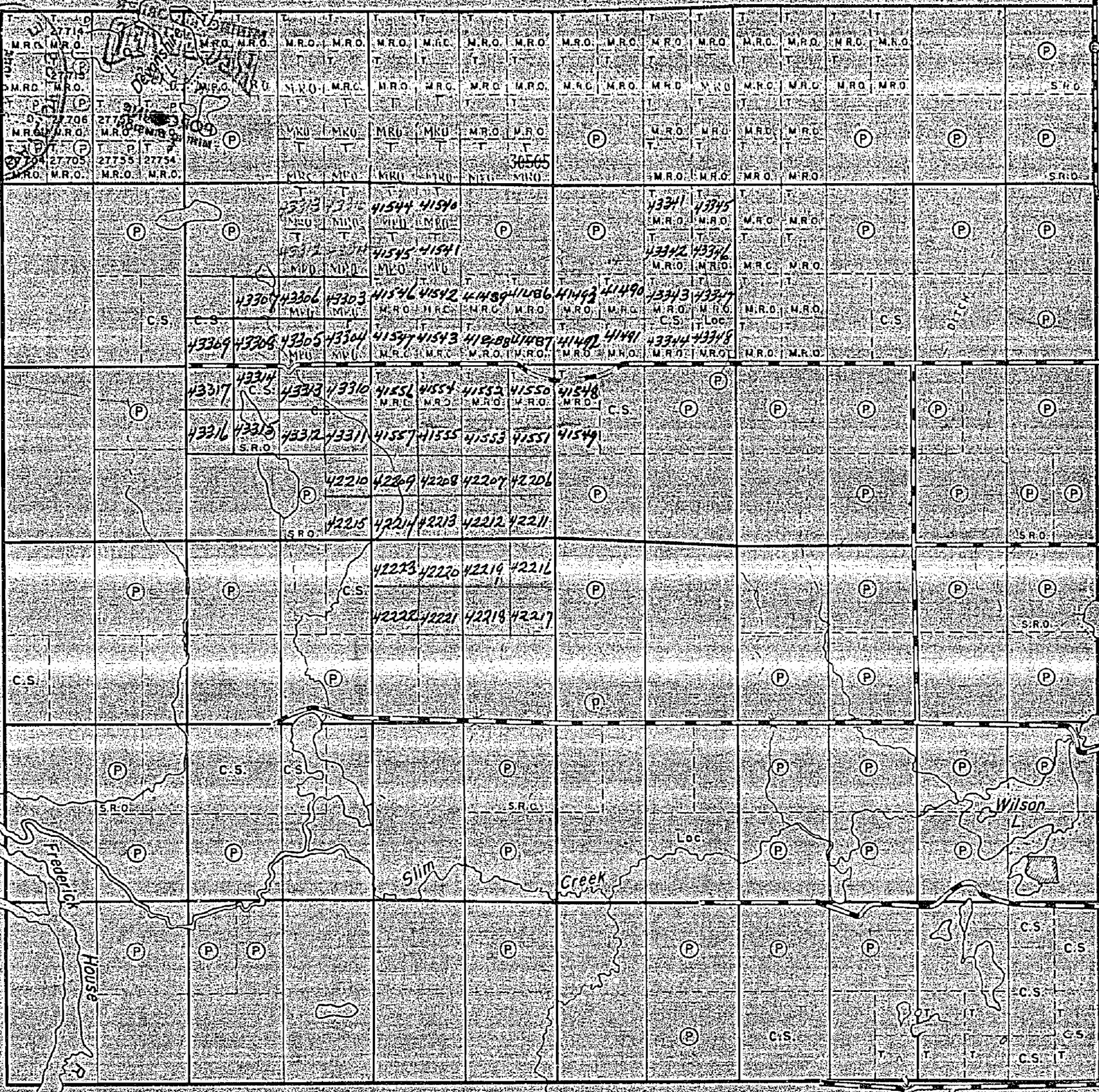

*Handwritten notes:*  
 This parcel  
 is reserved  
 for  
 the  
 use of  
 the  
 Government

THE TOWNSHIP OF COCHRANE

McCART

DISTRICT OF COCHRANE

PORCUPINE MINING DIVISION

SCALE 1-INCH=40 CHAINS

LEGEND

PATENTED LAND	(P)
CROWN LAND SALE	C.S.
LEASES	(L)
LOCATED LAND	Loc
LICENSE OF OCCUPATION	L.O.
ROADS	(---)
IMPROVED ROADS	(=)
RAILWAYS	(---)
POWER LINES	(---)
MARSH OR MUSKEG	(---)
MINERAL RIGHTS ONLY	M.R.O.
SURFACE RIGHTS ONLY	S.R.O.

NOTES

400' Reserve to Dept of Lands & Forests shown thus: (---)

Reserve to Dept of Highways shown thus: (---)

Surface rights reserved on all lands staked & patented after 23 May 1945 — See O.C. 25 April 1945

By regulations passed previously, sale or other disposition of land in this Township has been limited to surface R.O. effective Oct. 27, 1942

Dundonald Twp

PLAN NO - M-545

DEPARTMENT OF MINES

— ONTARIO —

Newmarket Twp.

THE TOWNSHIP OF  
OF

# Mc CART

DISTRICT OF  
COCHRANE  
PORCUPINE  
MINING DIVISION

SCALE 1-INCH=40 CHAINS

### LEGEND

PATENTED LAND	(P)
CROWN LAND SALE	(C.S.)
LEASES	(L)
LOCATED LAND	Loc
LICENSE OF OCCUPATION	L.O.
ROADS	—
IMPROVED ROADS	—
RAILWAYS	—
POWER LINES	—
MARSH OR MUSKEG	(M.O.)
MINERAL RIGHTS ONLY	M.R.O.
SURFACE RIGHTS ONLY	S.R.O.

### NOTES

400' Surface Rights Reservation around all Lakes and Rivers  
Reserve to Dept of Highways shown thus: —

By regulations passed previously, sale of other disposition of land in this Township has been limited to surface R.O. effective Oct. 27, 1942.

ALL CLAIMS IN YELLOW REQUIRE SURVEY

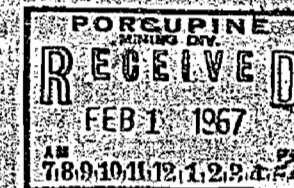

PLAN NO. - M-545

DEPARTMENT OF MINES  
— ONTARIO —

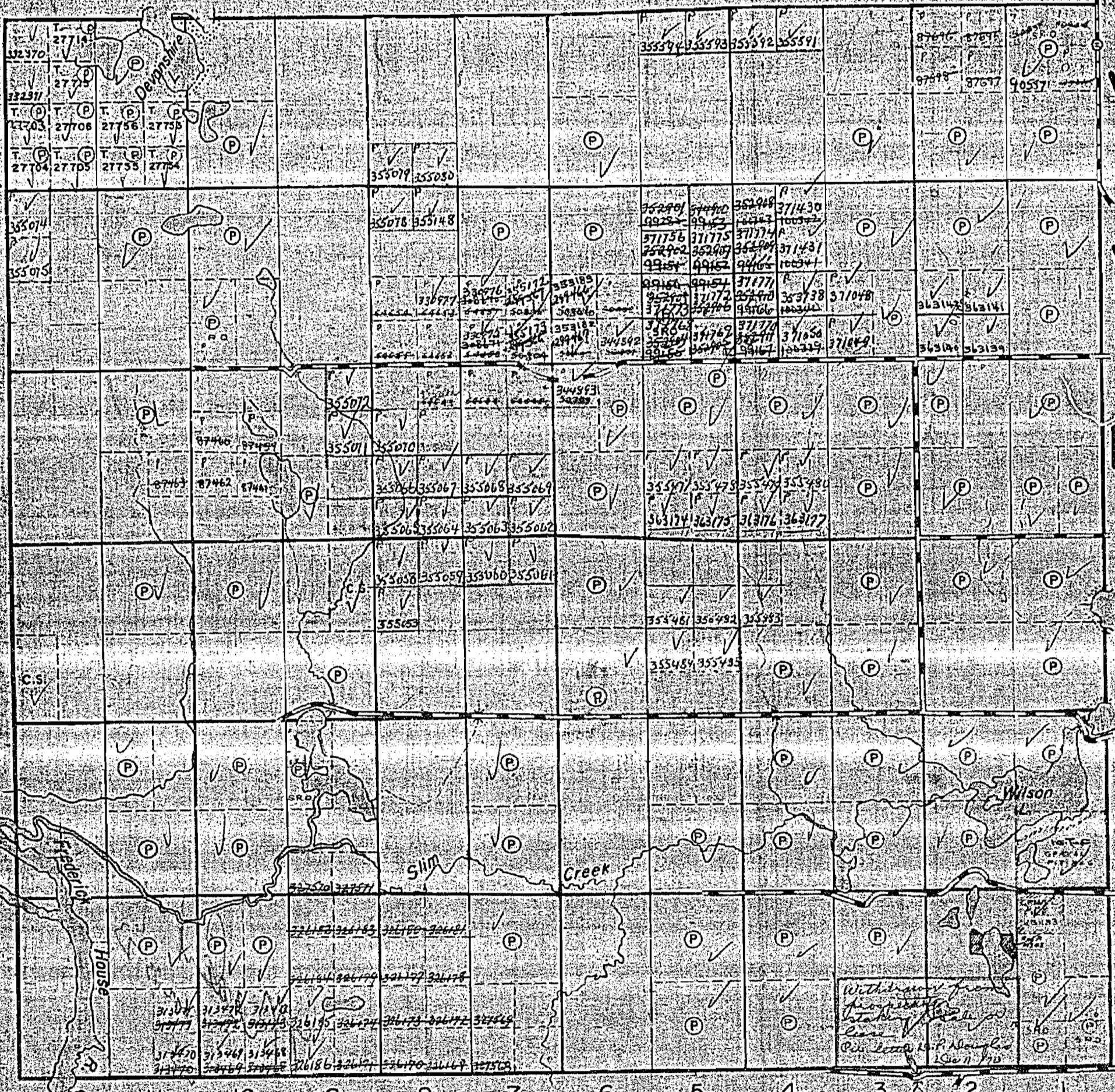

Dundonald Twp.

Little Twp.

Calvert Twp.



545

Newmarket Twp.

Dundonald Twp.

Little Twp.

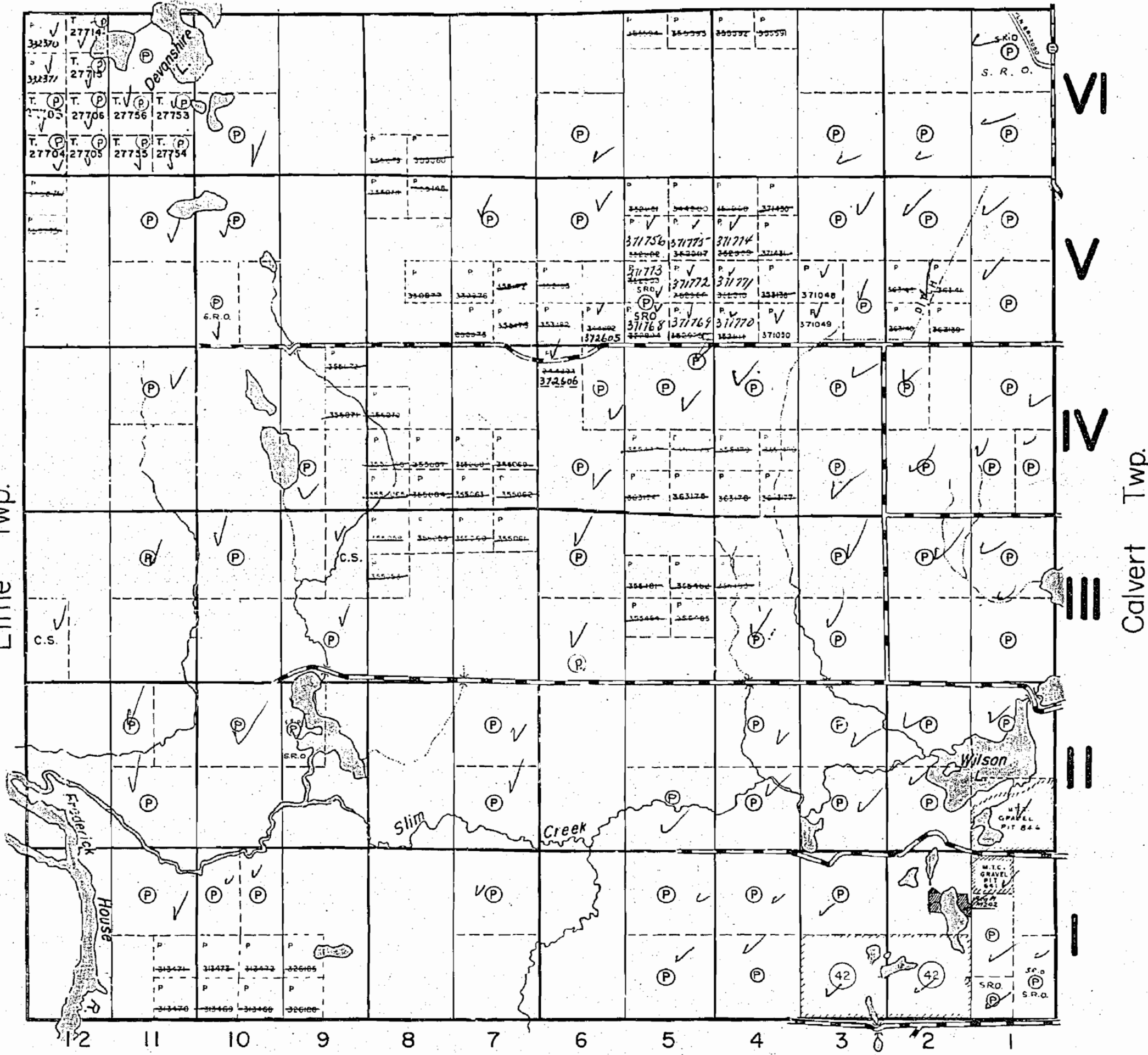

THE TOWNSHIP OF

**McCART**

DISTRICT OF COCHRANE

PORCUPINE MINING DIVISION

SCALE: 1-INCH=40 CHAINS

**LEGEND**

- PATENTED LAND (P)
- CROWN LAND SALE (C.S.)
- LEASES (L)
- LOCATED LAND (Loc.)
- LICENSE OF OCCUPATION (L.O.)
- ROADS (—)
- IMPROVED ROADS (—)
- RAILWAYS (—)
- POWER LINES (—)
- MARSH OR MUSKEG (—)
- MINERAL RIGHTS ONLY (M.P.O.)
- SURFACE RIGHTS ONLY (S.R.O.)

**NOTES**

400' Surface Rights Reservation around all Lakes and Rivers.

Reserve to Dept of Highways shown thus: —

By regulations passed previously, sale or other disposition of land in this Township has been limited to surface R.O. effective Oct 27, 1942

Areas withdrawn from staking under Section 42 of the Mining Act.

File	Date	Disposition
36866	14/12/70	S.R. & M.R.

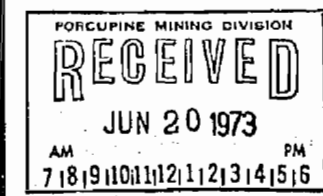

PLAN NO. - M-545

ONTARIO  
MINISTRY OF NATURAL RESOURCES  
SURVEYS AND MAPPING BRANCH

M.242

GWT T9A3CM

242.M

# Newmarket Twp.

THE TOWNSHIP OF

# Mc CART

DISTRICT OF COCHRANE

PORCUPINE MINING DIVISION

SCALE: 1-INCH=40 CHAINS

### LEGEND

PATENTED LAND	Ⓟ
CROWN LAND SALE	C.S.
LEASES	Ⓛ
LOCATED LAND	Loc.
LICENSE OF OCCUPATION	L.O.
ROADS	—
IMPROVED ROADS	—
RAILWAYS	—
POWER LINES	—
MARSH OR MUSKEG	—
MINERAL RIGHTS ONLY	M.P.O.
SURFACE RIGHTS ONLY	S.R.O.

### NOTES

400' Surface Rights Reservation around all Lakes and Rivers.

Reserve to Dept of Highways shown thus: —

L.U.P.

By regulations passed previously, sale or other disposition of land in this Township has been limited to surface R.O. effective Oct. 27, 1942

Areas withdrawn from staking under Section 42 of the Mining Act.

File	Date	Disposition
36866	14/12/70	S.R. & M.R.
42	Reopened	N.R.O. 7/1/84

PLAN NO. - M-545

ONTARIO  
MINISTRY OF NATURAL RESOURCES  
SURVEYS AND MAPPING BRANCH

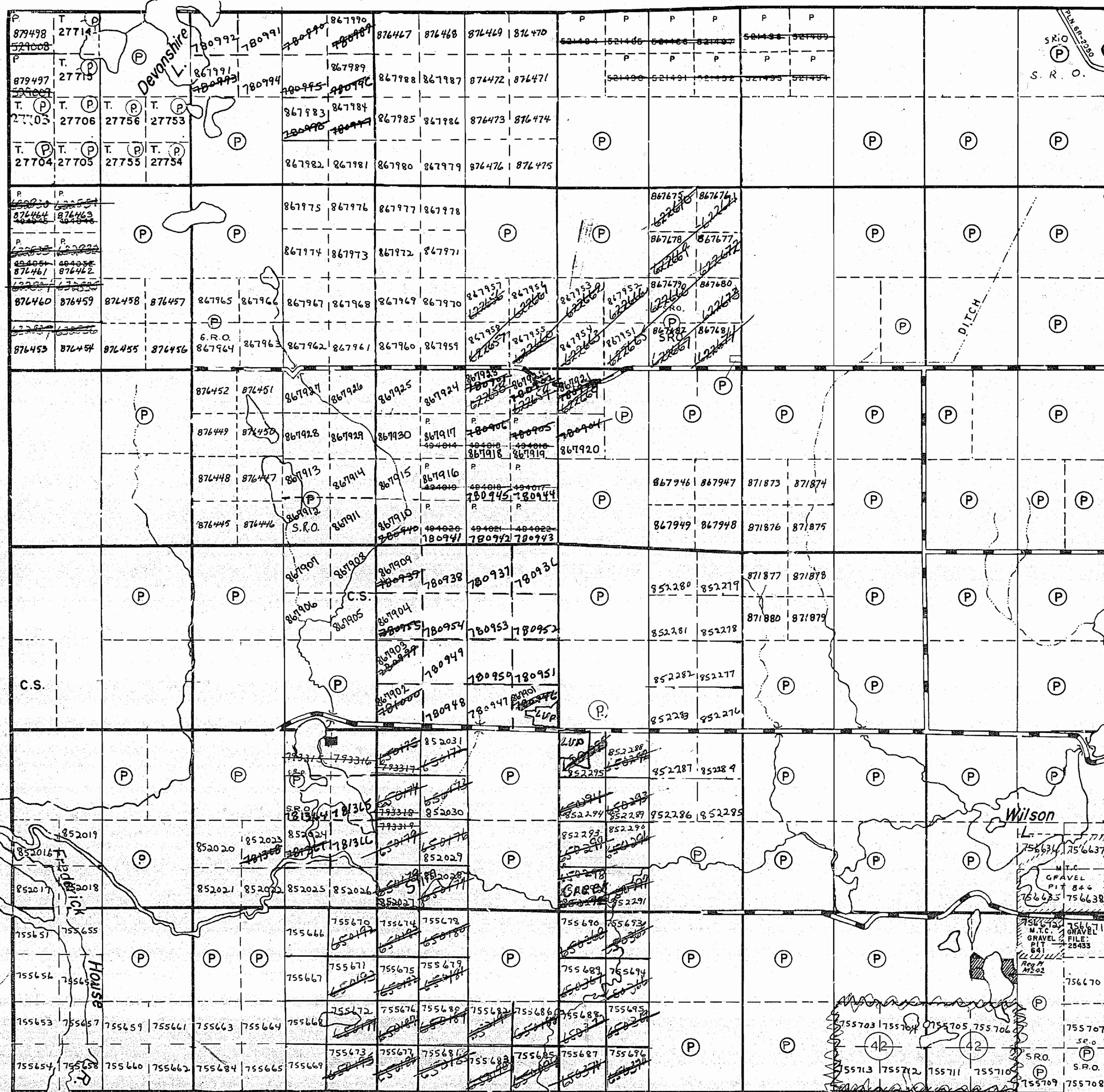

VI

V

IV

III

II

I

Calvert Twp.

# Dundonald Twp.

Newmarket Twp

*Handwritten scribbles*

THE TOWNSHIP OF  
OF  
**McGART**

DISTRICT OF  
COCHRANE

PORCUPINE  
MINING DIVISION

SCALE 1-INCH=40 CHAINS

LEGEND

- PATENTED LAND P
- CROWN LAND SALE C.S.
- LEASES L
- LOCATED LAND Loc
- LICENSE OF OCCUPATION L.O.
- ROADS ---
- IMPROVED ROADS =
- RAILWAYS =
- POWER LINES =
- MARSH OR MUSKEG (Symbol)
- MINERAL RIGHTS ONLY M.R.O.
- SURFACE RIGHTS ONLY S.R.O.

NOTES

400' Surface Rights Reservation around all Lakes and Rivers.

Reserve to Dept of Highways shown thus: *(Symbol)*

Surface rights reserved on all lands taken by patented mines in May 1946. See O.C. 25 April 1945.

By regulations passed previously, sale or other disposition of land in this Township has been limited to surface R.O. effective Oct. 27, 1942.

*Handwritten notes:*  
Crown Land  
M.R.O.  
S.R.O.  
SEE LAND R...



Little Twp

Calvert Twp

Dundonald Twp

PLAN NC - M - 545

DEPARTMENT OF MINES  
— ONTARIO —

Newmarket Twp.

THE TOWNSHIP OF

McCART

DISTRICT OF COCHRANE

PORCUPINE MINING DIVISION

SCALE: 1-INCH=40 CHAINS

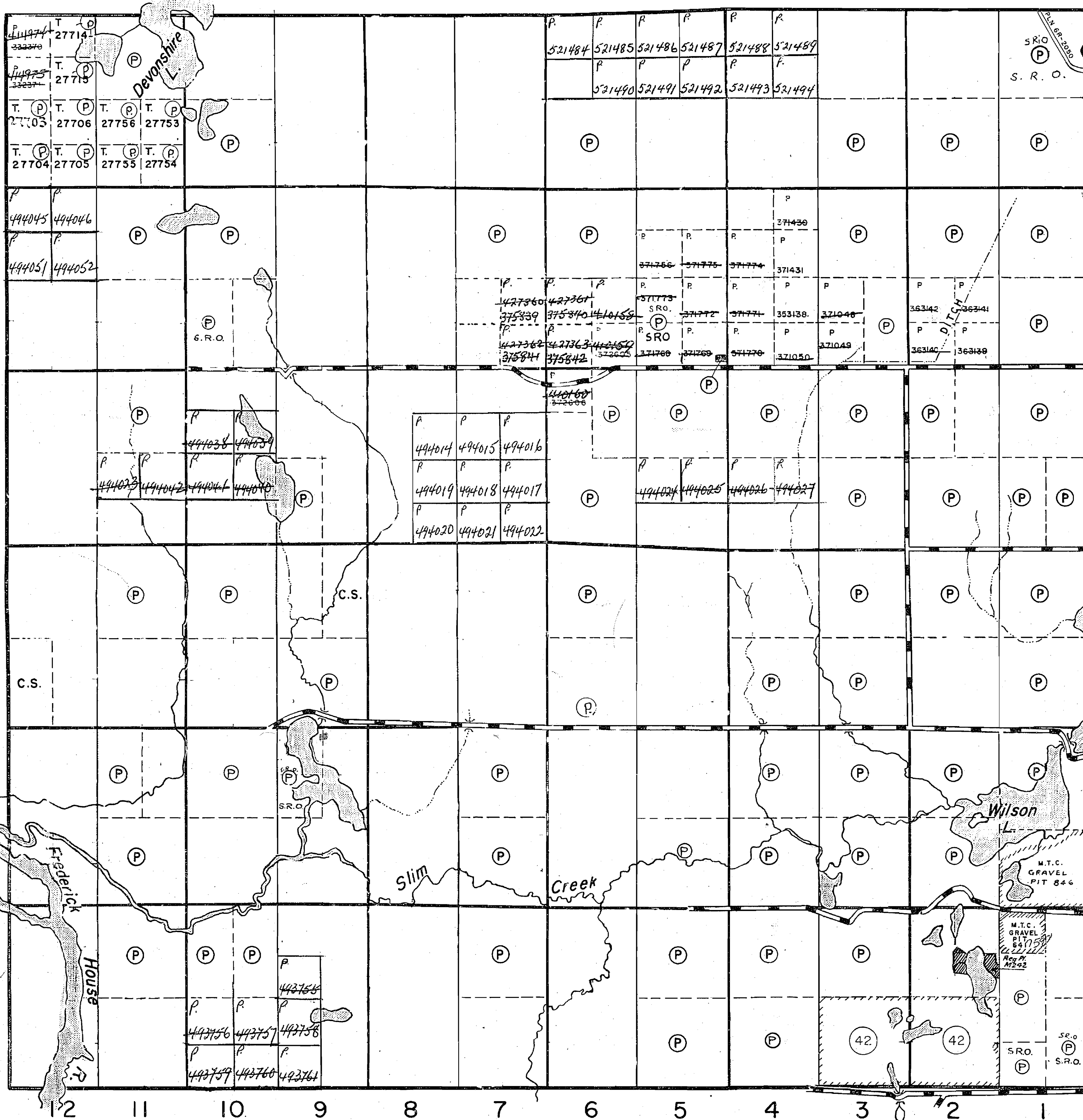

VI  
V  
IV  
III  
II  
I

Calvert Twp.

Little Twp.

Dundonald Twp.

LEGEND

- PATENTED LAND (P)
- CROWN LAND SALE (C.S.)
- LEASES (L)
- LOCATED LAND (Loc)
- LICENSE OF OCCUPATION (L.U.)
- ROADS (---)
- IMPROVED ROADS (---)
- RAILWAYS (---)
- POWER LINES (---)
- MARSH OR MUSKEG (---)
- MINERAL RIGHTS ONLY (M.P.O.)
- SURFACE RIGHTS ONLY (S.R.O.)

NOTES

400' Surface Rights Reservation around all Lakes and Rivers.

Reserve to Dept of Highways shown thus: [hatched pattern]

By regulations passed previously, sale or other disposition of land in this Township has been limited to surface R.O. effective Oct 27, 1942

Areas withdrawn from staking under Section 42 of the Mining Act.

File	Date	Disposition
42 36866	14/12/70	S.R. & M.R.

DATE OF ISSUE  
FEB 28 1974

RECEIVED  
MAY 24 1974 PM

AM 7 18 | 9 | 10 | 11 | 12 | 1 | 2 | 3 | 4 | 5 | 6

PLAN NO. - M-545

ONTARIO  
MINISTRY OF NATURAL RESOURCES  
SURVEYS AND MAPPING BRANCH

REFERENCES

TOWNSHIP OF NEWMARKET

REFERENCES

**NOTE**  
LOT AND CONVESSION LINES SHOWN HEREON ARE PROJECTED FROM THE BEST INFORMATION AVAILABLE, BUT THEIR TRUE POSITION IS NOT GUARANTEED.

FOR LEGAL AND SURVEY PURPOSES CONSULT THE ORIGINAL SURVEY PLANS AND FIELD NOTES OF RECORD IN THE DEPARTMENT OF LANDS AND FORESTS, TORONTO.

ACREAGES SHOWN IN RESPECT OF PATENTED LOTS ARE IN ACCORDANCE WITH AREA GRANTED.

AREAS WITHDRAWN FROM DISPOSITION

- M.R.O. - MINING RIGHTS ONLY
- S.R.O. - SURFACE RIGHTS ONLY
- M+S - MINING AND SURFACE RIGHTS

Description	Order No.	Date	Disposition	File
PROPOSED	M.R.O. 71/64	4/12/70	S.R.O.M.R.	36666

Surface Rights Withdrawn under Sec. 36 of the Mining Act R.S.O. 1980, OTHER NO. W-0191/CNT (Under Canada Pipeline Right of Way and Buffer Zone, particularly 402.25 meters or 132 ft. on either side of centre line of right of way)

AGGREGATE PERMIT

THE INFORMATION THAT APPEARS ON THIS MAP HAS BEEN COMPILED FROM VARIOUS SOURCES AND ACCURACY IS NOT GUARANTEED. THOSE WISHING TO STAKE MINING CLAIMS SHOULD CONSULT WITH THE MINING RECORDER, DEPARTMENT OF NORTHERN DEVELOPMENT AND MINES FOR ADDITIONAL INFORMATION ON THE STATUS OF THE LANDS SHOWN HEREON.

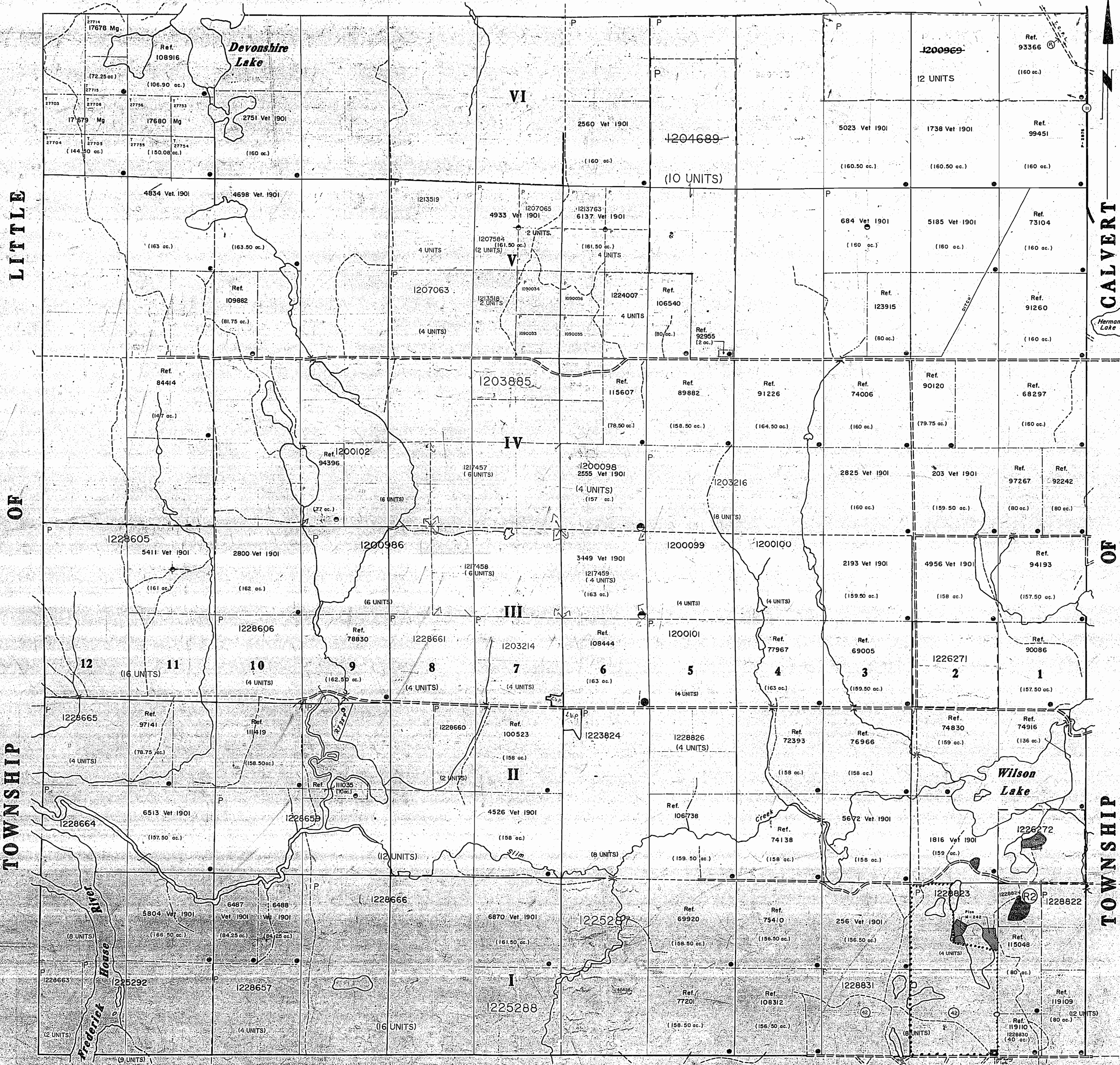

**TOPOGRAPHY**  
LAKES, RIVERS, ETC., FROM FOREST RESOURCES INVENTORY SHEETS No 486804 AND 487804

**SURVEYS**  
TOWNSHIP OF McCART SUBDIVIDED BY A.D. GRIFFIN, O.L.S., 1904. FIELD NOTE BOOK 1533.  
WEST LIMIT OF McCART TOWNSHIP (SEE LITTLE TWP) SURVEY BY J.W. FITZGERALD, O.L.S., 1904. FIELD NOTE BOOK 1402.  
EAST LIMIT OF McCART TOWNSHIP (SEE CALVERT TWP) SURVEY BY ALEXANDER BAIRD, O.L.S., 1904. FIELD NOTE BOOK 1009.  
THIRD MERIDIAN (EAST LIMIT OF McCART TWP) BY WILLIAM GALBRAITH, O.L.S., 1904. FIELD NOTE BOOK 2363.  
BASE LINE (SOUTH LIMIT OF McCART TWP) BY T.J. PATTEN, O.L.S., 1903. FIELD NOTE BOOK 2460.

**LEGEND**

HIGHWAY AND ROUTE No.	[Symbol]
OTHER ROADS	[Symbol]
TRAILS	[Symbol]
SURVEYED LINES:	
TOWNSHIPS, BASE LINES, ETC.	[Symbol]
LOTS, MINING CLAIMS, PARCELS, ETC.	[Symbol]
UNSURVEYED LINES:	
LOT LINES	[Symbol]
PARCEL BOUNDARY	[Symbol]
MINING CLAIMS ETC.	[Symbol]
RAILWAY AND RIGHT OF WAY	[Symbol]
UTILITY LINES	[Symbol]
NON-PERENNIAL STREAM	[Symbol]
FLOODING OR FLOODING RIGHTS SUBDIVISION OR COMPOSITE PLAN	[Symbol]
RESERVATION	[Symbol]
ORIGINAL SHORELINE	[Symbol]
MARSH OR MUSKEG	[Symbol]
MINES	[Symbol]
TRAVERSE MONUMENT	[Symbol]

**DISPOSITION OF CROWN LANDS**

TYPE OF DOCUMENT	SYMBOL
PATENT, SURFACE & MINING RIGHTS	[Symbol]
SURFACE RIGHTS ONLY	[Symbol]
MINING RIGHTS ONLY	[Symbol]
LEASE, SURFACE & MINING RIGHTS	[Symbol]
SURFACE RIGHTS ONLY	[Symbol]
MINING RIGHTS ONLY	[Symbol]
LICENCE OF OCCUPATION	[Symbol]
ORDER-IN-COUNCIL	[Symbol]
RESERVATION	[Symbol]
CANCELLED	[Symbol]
SAND & GRAVEL	[Symbol]

NOTE: MINING RIGHTS IN PARCELS PATENTED PRIOR TO MAY 1, 1912, VESTED IN ORIGINAL PATENTEE BY THE PUBLIC LANDS ACT, R.S.O. 1970, CHAP. 389, SEC. 63, SUBSEC. 1.  
--- Ski trails with boundary.

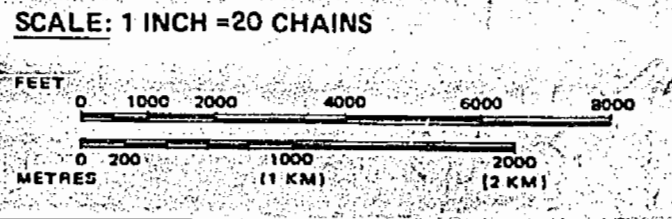

TOWNSHIP  
**McCART**  
M.N.R. ADMINISTRATIVE DISTRICT  
**COCHRANE**  
MINING DIVISION  
**PORCUPINE**  
LAND TITLES / REGISTRY DIVISION  
**COCHRANE**

Ministry of Natural Resources Ontario / Ministry of Northern Development and Mines

# M<sup>c</sup>GART

formerly NIPISSING DISTRICT now Timistaming  
Scale 40 chs = 1 in

No 1.

M545

NEWMARKET

See Letter 2<sup>nd</sup> of June 9/24

LITTLE

CALVERT

289 ac	258	282	301	307	307	307	317	319	321	321	320 ac
	VET	VET			VET VI	VET			VET	VET	
324 ac	326	327	321	322	323	322	320	322	320	320	320 ac
	VET	VET			VET	VET			VET PAT	VET	
298 ac	307	308	308	299	310	314	317	329	320	319	320 ac
	VET	VET			VET PAT IV	VET			VET	VET PAT	
12	11	10	9	8	7	6	5	4	3	2	1
	VET	VET			VET	VET			VET	VET	
314 ac	322	324	325	321	330	326	325	326	319	316	315 ac
					III						
279 ac	315	317	280	306	316	320	319	316	316	318	272
	VET	VET			VET II	VET			VET	VET	
	VET	VET			VET	VET			VET PAT	VET	
282 ac	333	337	330	321	323	323	317	313	313	317	320
	24571 23289 24475 24519 PAT	24523	26150 26152 26154 26155	26144 26145	26146	26146 26145	26146 26149	26142 26141	26142 26141	25834 25832	25831
	24510 24522 24414 24413	26149 26152 26153 26156 26157	26148 26148 26147	26148 26148	26147 26147	26147 26147	26147 26147	26143 26140	26143 26140	25836 25835 25833	25830

WEL OCT 14<sup>TH</sup> 1916

DUNDONALD

Write CLA before recording Commission

See the Pickaby-dated 26<sup>th</sup> May/43 that a sale of S.W. 1/4 lot 3, Con. 1. was made to Andrew Bezuker, & assigns for value, on April 16/43.

See page 117  
See page 117  
See page 117

545

# MCCART

No. 2

## DISTRICT OF TIMISKAMING

SCALE: 40 CHAINS = 1 INCH. M 545



MINING RIGHTS ONLY

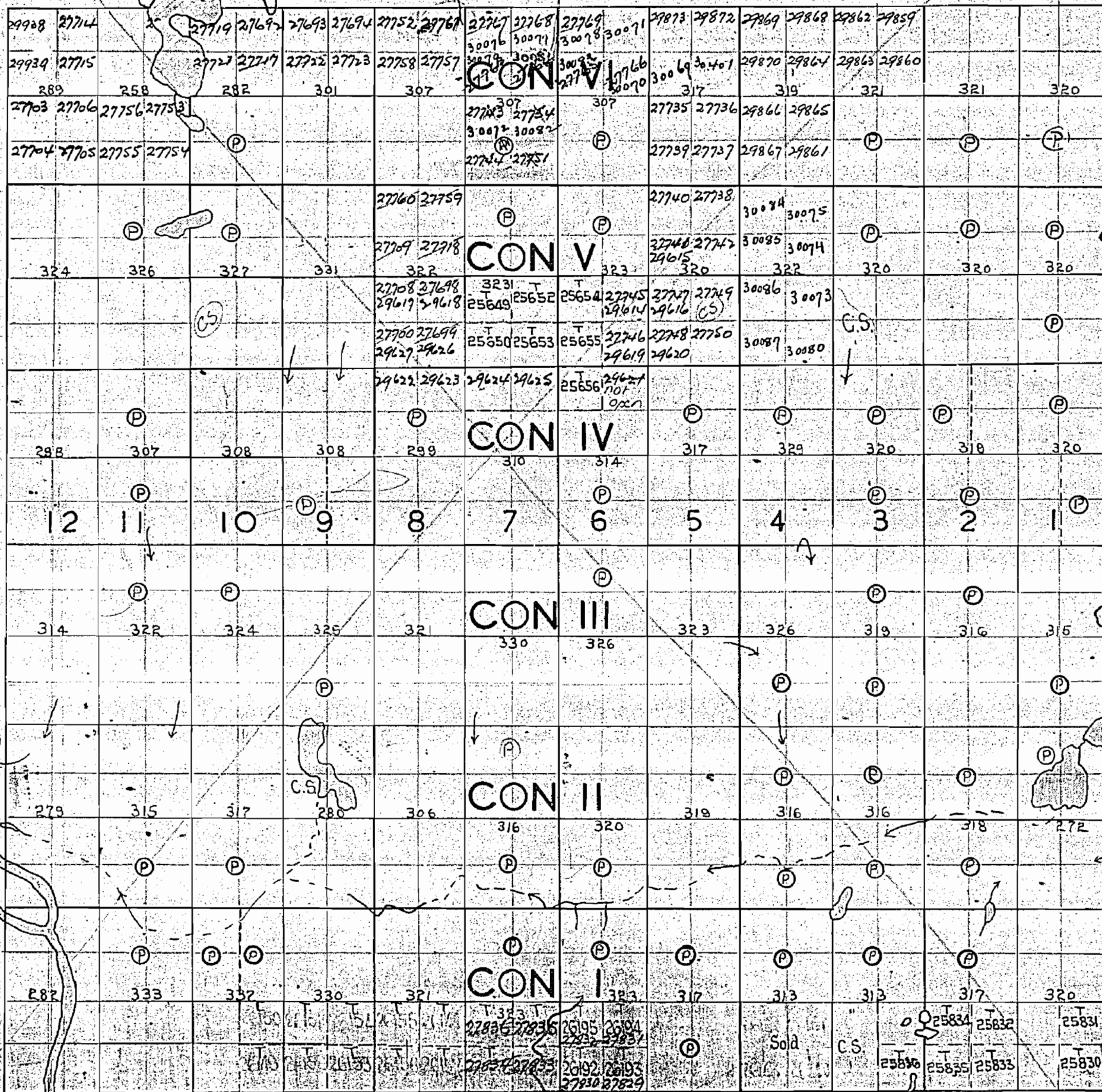

DUNDONALD

New Street 30 May 50

Newmarket Twp

Little Twp

Calvert Twp

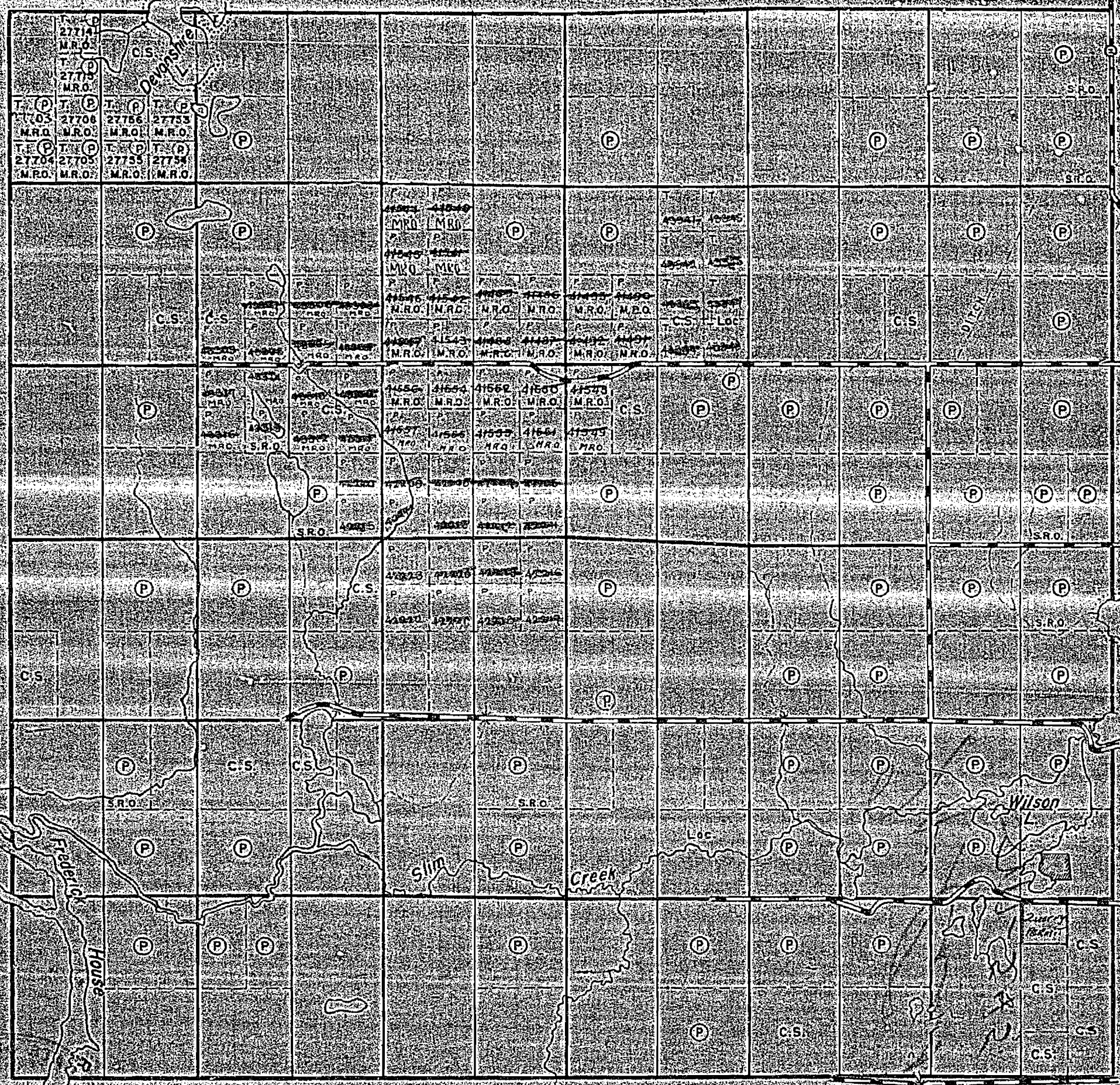

Dundonald Twp

THE TOWNSHIP OF  
OF  
**Mc CART**  
DISTRICT OF  
COCHRANE  
PORCUPINE  
MINING DIVISION

SCALE 1-INCH=40 CHAINS

LEGEND

PATENTED LAND	(P)
CROWN LAND SALE	(C.S.)
LEASES	(L)
LOCATED LAND	(Loc)
LICENSE OF OCCUPATION	(L.O.)
ROADS	(—)
IMPROVED ROADS	(=)
RAILWAYS	(—)
POWER LINES	(—)
MARSH OR MUSKEG	(—)
MINERAL RIGHTS ONLY	(M.R.O.)
SURFACE RIGHTS ONLY	(S.R.O.)

NOTES

400 Reserve to Dept. of Lands & Forests shown thus: (—)

Reserve to Dept. of Highways shown thus: (—)

Surface rights reserved on all lands staked & patented after 21 May 1945 — See O.C. 25 April 1945

By regulations passed previously, sale or other disposition of land in this Township has been limited to surface R.O. effective Oct. 27, 1942

PLAN NO - M-545

DEPARTMENT OF MINES  
— ONTARIO —



Newmarket Twp.

THE TOWNSHIP OF  
OF

**McGART**

DISTRICT OF  
COCHRANE

PORCUPINE  
MINING DIVISION

SCALE 1-INCH=40 CHAINS

LEGEND

PATENTED LAND	Ⓟ
CROWN LAND SALE	C.S.
LEASES	Ⓢ
LOCATED LAND	Loc.
LICENSE OF OCCUPATION	L.O.
ROADS	—
IMPROVED ROADS	—
RAILWAYS	—
POWER LINES	—
MARSH OR MUSKOG	—
MINERAL RIGHTS ONLY	M.R.O.
SURFACE RIGHTS ONLY	S.R.O.

NOTES

400' Surface Rights Reservation around all Lakes and Rivers.

Reserve to Dept of Highways shown thus: —

By regulations passed previously, sale of other disposition of land in this Township has been limited to surface R.O. effective Oct. 27, 1942.

ALL CLAIMS IN YELLOW REQUIRING SURVEY

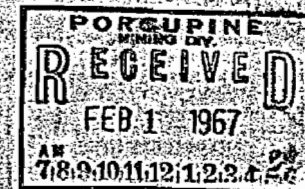

PLAN NO - M-545

DEPARTMENT OF MINES  
—ONTARIO—

Lithé Twp.

VI

V

IV

III

II

I

Calvert Twp.

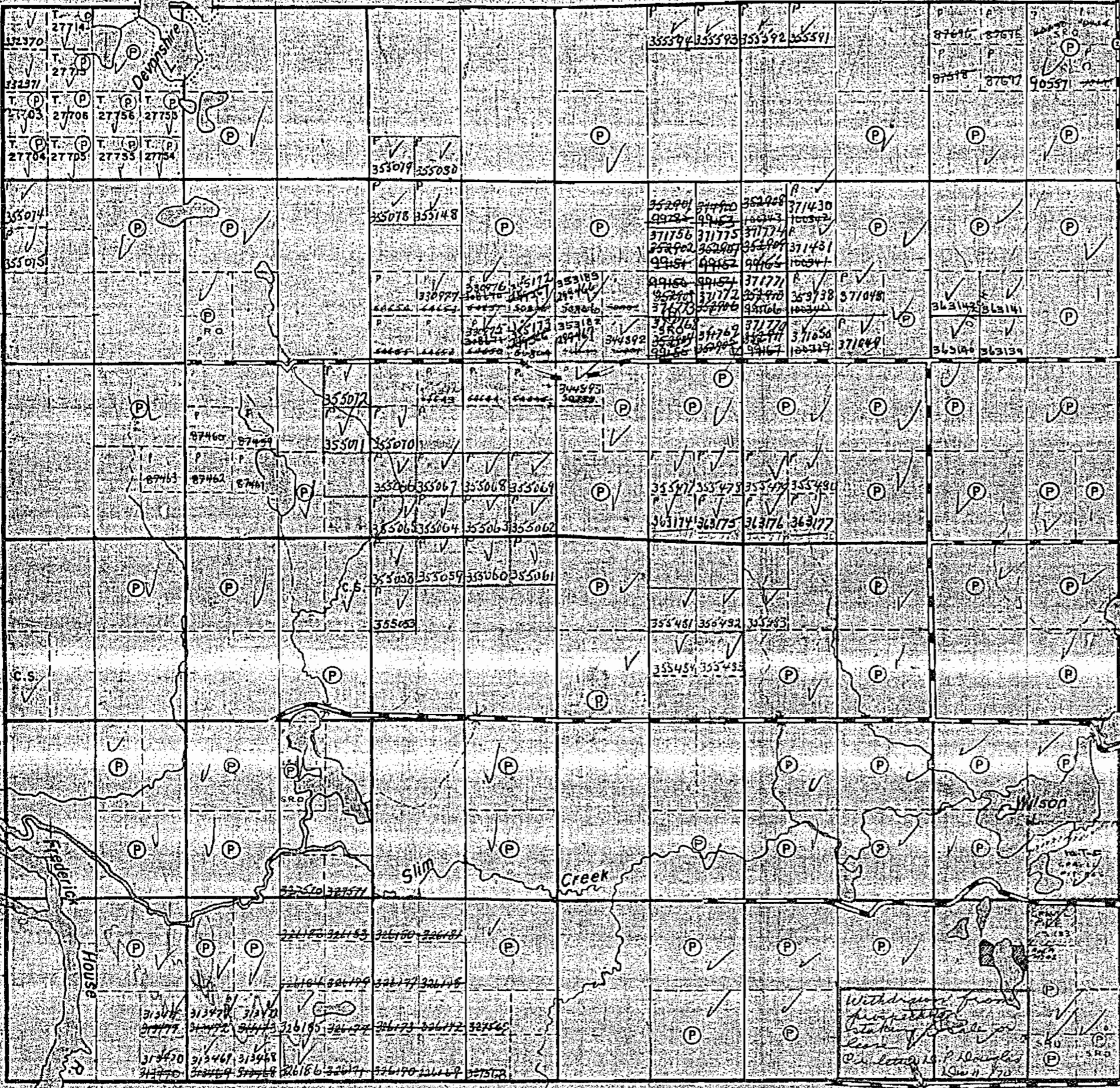

Dundonald Twp.

Newmarket Twp.

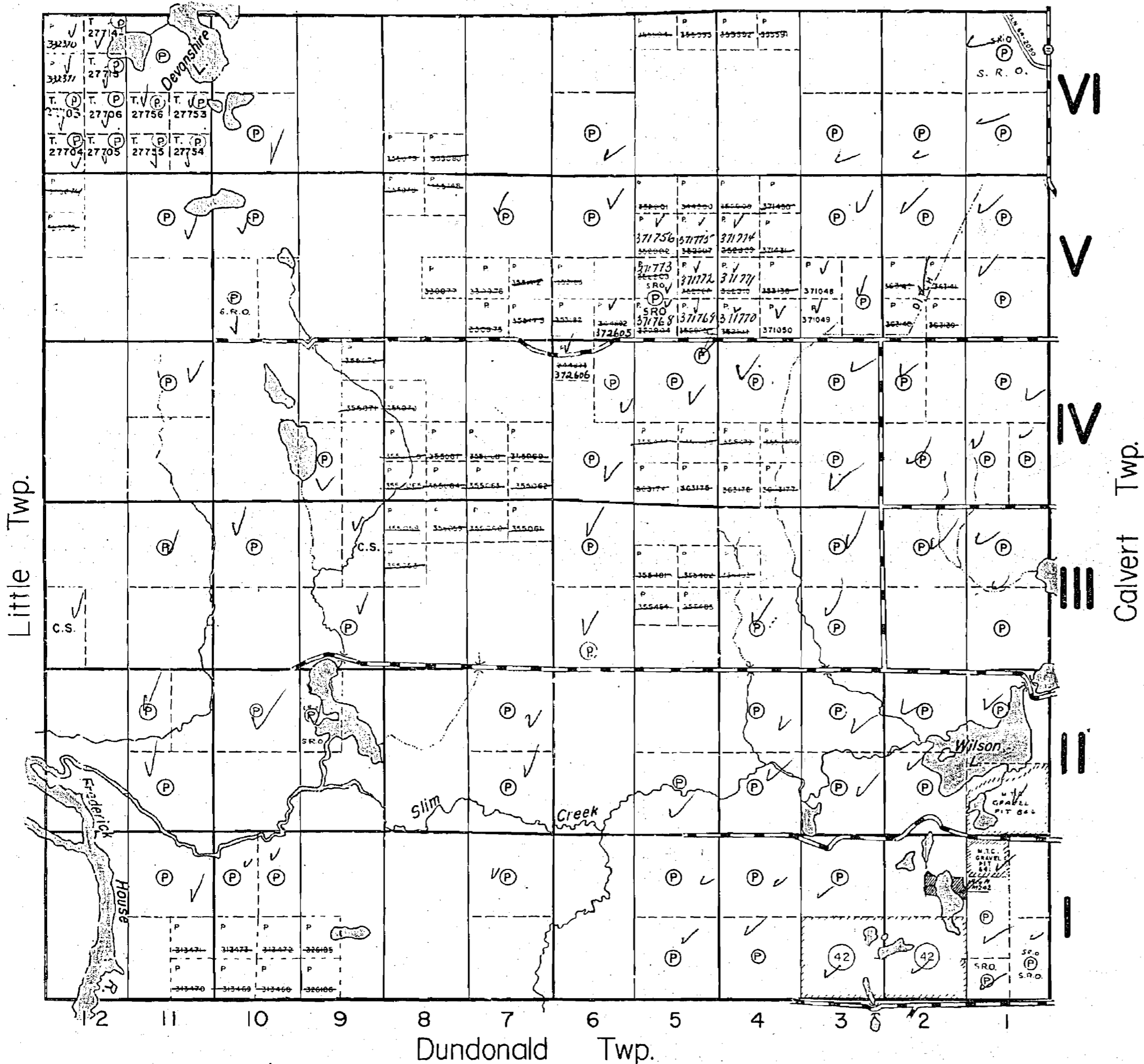

THE TOWNSHIP OF

# McCART

DISTRICT OF COCHRANE

PORCUPINE MINING DIVISION

SCALE: 1-INCH=40 CHAINS

### LEGEND

PATENTED LAND	(P)
CROWN LAND SALE	C.S.
LEASES	(L)
LOCATED LAND	Loc.
LICENSE OF OCCUPATION	L.O.
ROADS	
IMPROVED ROADS	
RAILWAYS	
POWER LINES	
MARSH OR MUSKEG	
MINERAL RIGHTS ONLY	M.P.O.
SURFACE RIGHTS ONLY	S.R.O.

### NOTES

400' Surface Rights Reservation around all Lakes and Rivers.  
Reserve to Dept of Highways shown thus:

By regulations passed previously, sale or other disposition of land in this Township has been limited to surface R.O. effective Oct. 27, 1942

Areas withdrawn from staking under Section 42 of the Mining Act.

File	Date	Disposition
36866	14/12/70	S.R. & M.R.

PORCUPINE MINING DIVISION  
**RECEIVED**  
JUN 20 1973  
AM 7 18 19 10 11 12 1 2 3 4 5 6 PM

PLAN NO. - M-545

ONTARIO  
MINISTRY OF NATURAL RESOURCES  
SURVEYS AND MAPPING BRANCH

REFERENCES

CONCESSION LINES SHOWN HEREON PROJECTED FROM THE BEST INFORMATION AVAILABLE, BUT THEIR TRUE POSITION IS NOT KNOWN.

ALL SURVEY PURPOSES CONSULT ORIGINAL SURVEY PLANS AND FIELD RECORD IN THE DEPARTMENT OF LANDS AND FORESTS, TORONTO.

CONCESSIONS SHOWN IN RESPECT OF PATENTED RIGHTS ARE IN ACCORDANCE WITH AREA RECORDS.

AS WITHDRAWN FROM DISPOSITION

M.R.O. - MINING RIGHTS ONLY  
S.R.O. - SURFACE RIGHTS ONLY  
M.S.S. - MINING AND SURFACE RIGHTS

Table with columns: Order No., Date, Disposition, File No.

Rights Withdrawn under Sec. 36, Mining Act, R.S.O. 1990, Chapter N.O. 44, as amended, and the Ontario Mining Act, R.S.O. 1990, Chapter N.O. 45, as amended, particularly 40.25 meters or 132 ft. on either side of Centre Line of right of way.

LEGATE PERMIT

TOWNSHIP OF NEWMARKET

LITTLE OF TOWNSHIP

CALVERT OF TOWNSHIP

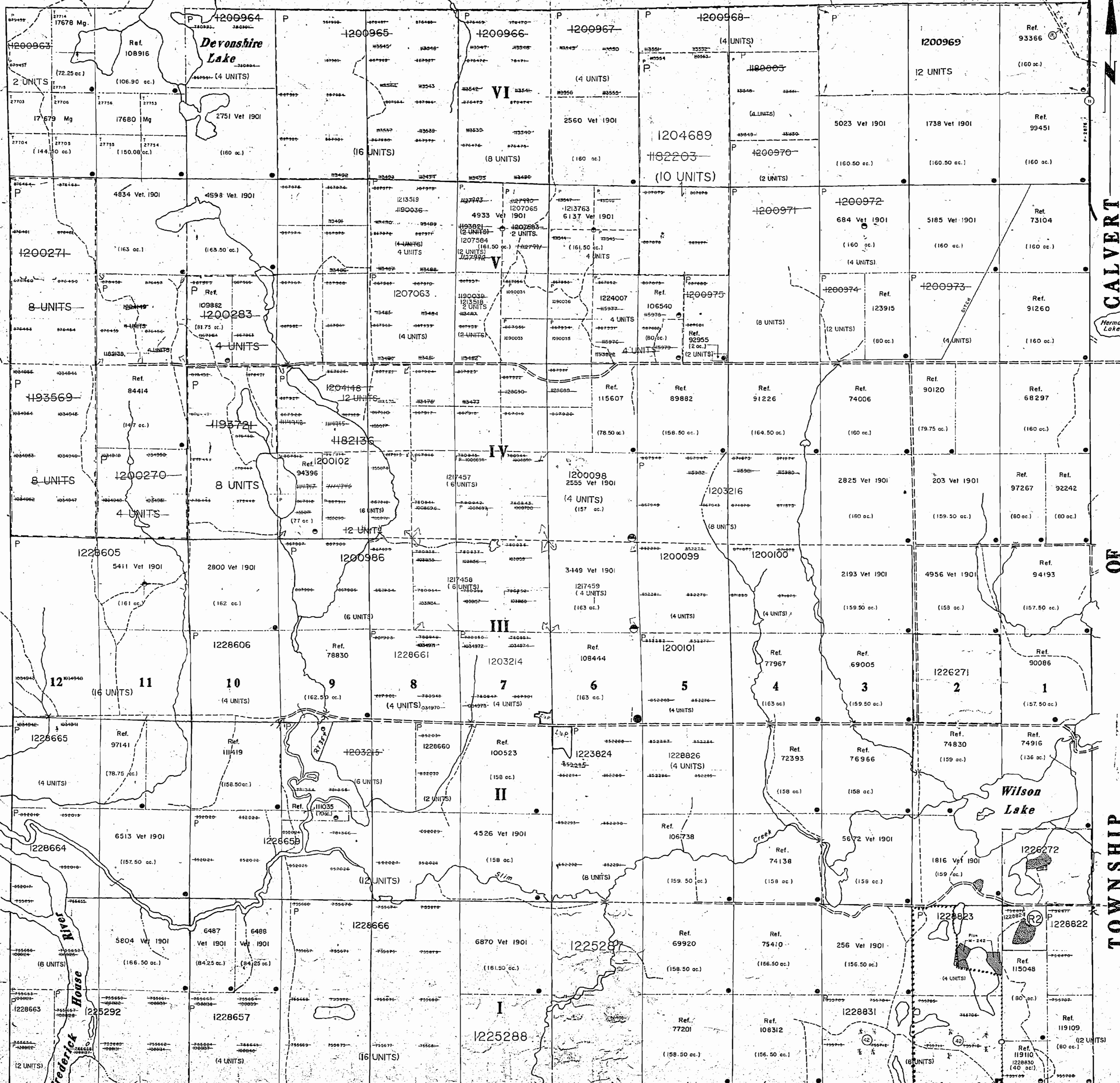

REFERENCES

TOPOGRAPHY  
LAKES, RIVERS, ETC., FROM FOREST RESOURCES INVENTORY SHEETS NO. 486804 AND 487804

SURVEYS  
TOWNSHIP OF McCART SUBDIVIDED BY A.D. GRIFFIN, O.L.S., 1904. FIELD NOTE BOOK 1533.  
WEST LIMIT OF McCART TOWNSHIP (SEE LITTLE TWP) SURVEY BY J.W. FITZGERALD, O.L.S., 1904. FIELD NOTE BOOK 1402.  
EAST LIMIT OF McCART TOWNSHIP (SEE CALVERT TWP) SURVEY BY ALEXANDER BAIRD, O.L.S., 1904. FIELD NOTE BOOK 1009.  
THIRD MERIDIAN (EAST LIMIT OF McCART TWP) BY WILLIAM GALBRAITH, O.L.S., 1904. FIELD NOTE BOOK 2363.  
BASE LINE (SOUTH LIMIT OF McCART TWP) BY T.J. PATTEN, O.L.S., 1903. FIELD NOTE BOOK 2460.

DATE OF ISSUE  
DEC 17 1997  
PROVINCIAL RECORDING OFFICE - SUDBURY

LEGEND table with symbols for Highway and Route No., Trails, Surveyed Lines, etc.

DISPOSITION OF CROWN LANDS table with columns: TYPE OF DOCUMENT, SYMBOL.

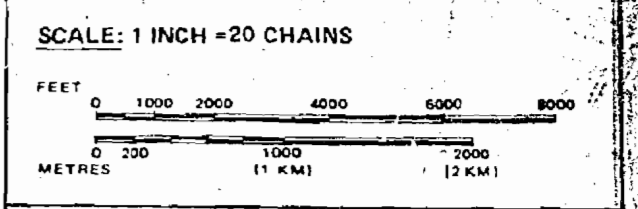

TOWNSHIP  
McCART  
M.N.R. ADMINISTRATIVE DISTRICT  
COCHRANE  
MINING DIVISION  
PORCUPINE  
LAND TITLES / REGISTRY DIVISION  
COCHRANE

Ministry of Natural Resources and Mines  
Ontario

TOWNSHIP OF DUNDONALD

THE INFORMATION THAT APPEARS ON THIS MAP HAS BEEN COMPILED FROM VARIOUS SOURCES, AND ACCURACY IS NOT GUARANTEED. THOSE WISHING TO STAKE MINING CLAIMS SHOULD CONSULT WITH THE MINING RECORDS DIVISION OF THE DEPARTMENT OF LANDS AND FORESTS FOR ADDITIONAL INFORMATION ON THE STATUS OF THE LANDS SHOWN HEREON.

TOWNSHIP OF NEWMARKET

NOTE

LOT AND CONCESSION LINES SHOWN HEREON ARE PROJECTED FROM THE BEST INFORMATION AVAILABLE, BUT THEIR TRUE POSITION IS NOT GUARANTEED.

AREAS WITHDRAWN FROM DISPOSITION

M.R.O. - MINING RIGHTS ONLY
S.R.O. - SURFACE RIGHTS ONLY
M.F.S. - MINING AND SURFACE RIGHTS

Surface Rights Withdrawn under Sec. 36, The Mining Act R.S.O. 1980, CHAPTER NO. W-01/91/UCNT

AGGREGATE PERMIT

LITTLE TOWNSHIP OF

CALVERT TOWNSHIP OF

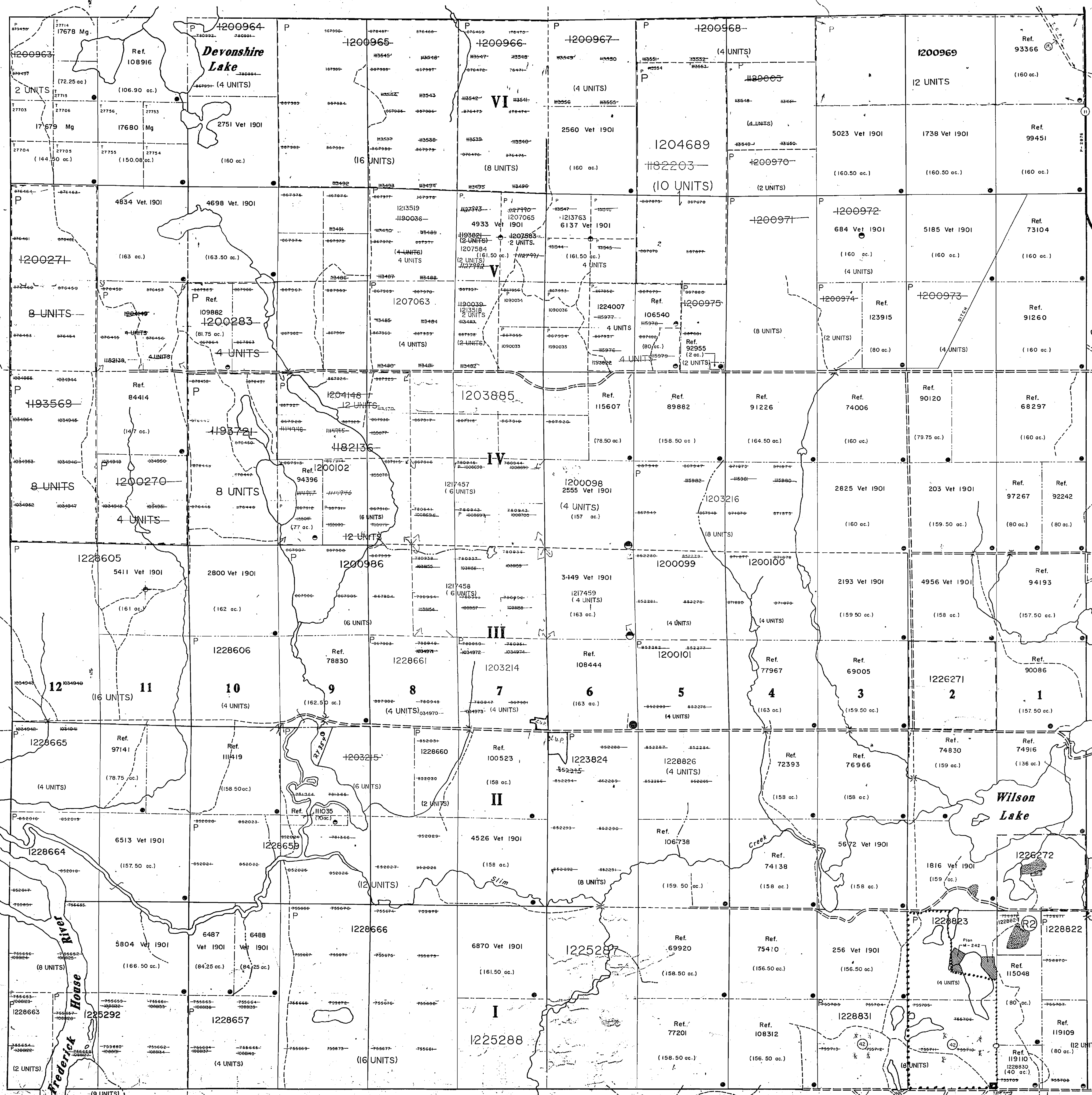

TOPOGRAPHY
LAKES, RIVERS, ETC., FROM FOREST RESOURCES INVENTORY SHEETS NO 486804 AND 487804
SURVEYS
TOWNSHIP OF McCART SUBDIVIDED BY A.D. GRIFFIN, O.L.S., 1904. FIELD NOTE BOOK 1533.
LEGEND
HIGHWAY AND ROUTE No.
DISPOSITION OF CROWN LANDS
SCALE: 1 INCH = 20 CHAINS
TOWNSHIP McCART
M.N.R. ADMINISTRATIVE DIVISION COCHRANE
MINING DIVISION PORCUPINE
LAND TITLES / REGISTRY DIVISION COCHRANE
Date: JULY 1986
Number: G-3541

THE INFORMATION THAT APPEARS ON THIS MAP HAS BEEN COMPILED FROM VARIOUS SOURCES, AND ACCURACY IS NOT GUARANTEED.