

THE TOWNSHIP OF
OF













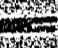
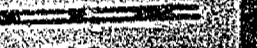

McNEVIN

DISTRICT OF
KENORA

KENORA
MINING DIVISION

SCALE: 1-INCH=40 CHAINS

LEGEND

- PATENTED LAND 
- CROWN LAND SALE 
- LEASES 
- LOCATED LAND 
- LICENSE OF OCCUPATION 
- MINING RIGHTS ONLY 
- SURFACE RIGHTS ONLY 
- ROADS 
- IMPROVED ROADS 
- KING'S HIGHWAYS 
- RAILWAYS 
- POWER LINES 
- MARSH OR MUSKEG 
- MINES 
- CANCELLED 

NOTES

400' surface rights reservation around all lakes & rivers.

Gravel roads shown thus:

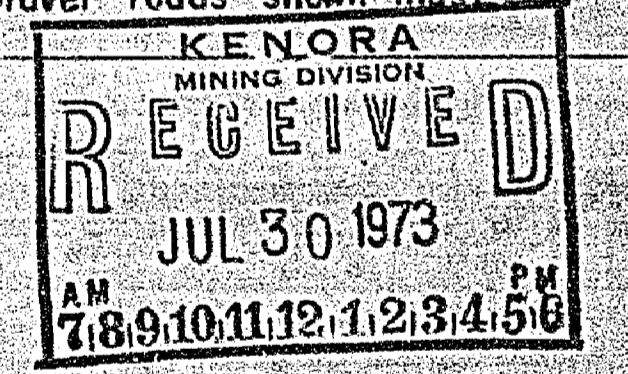

Aug. 2/74

#4

PLAN NO. M-1272

MINISTRY OF NATURAL RESOURCES
SURVEY AND MAPPING BRANCH

Scarpification 1978

Furniss Twp.

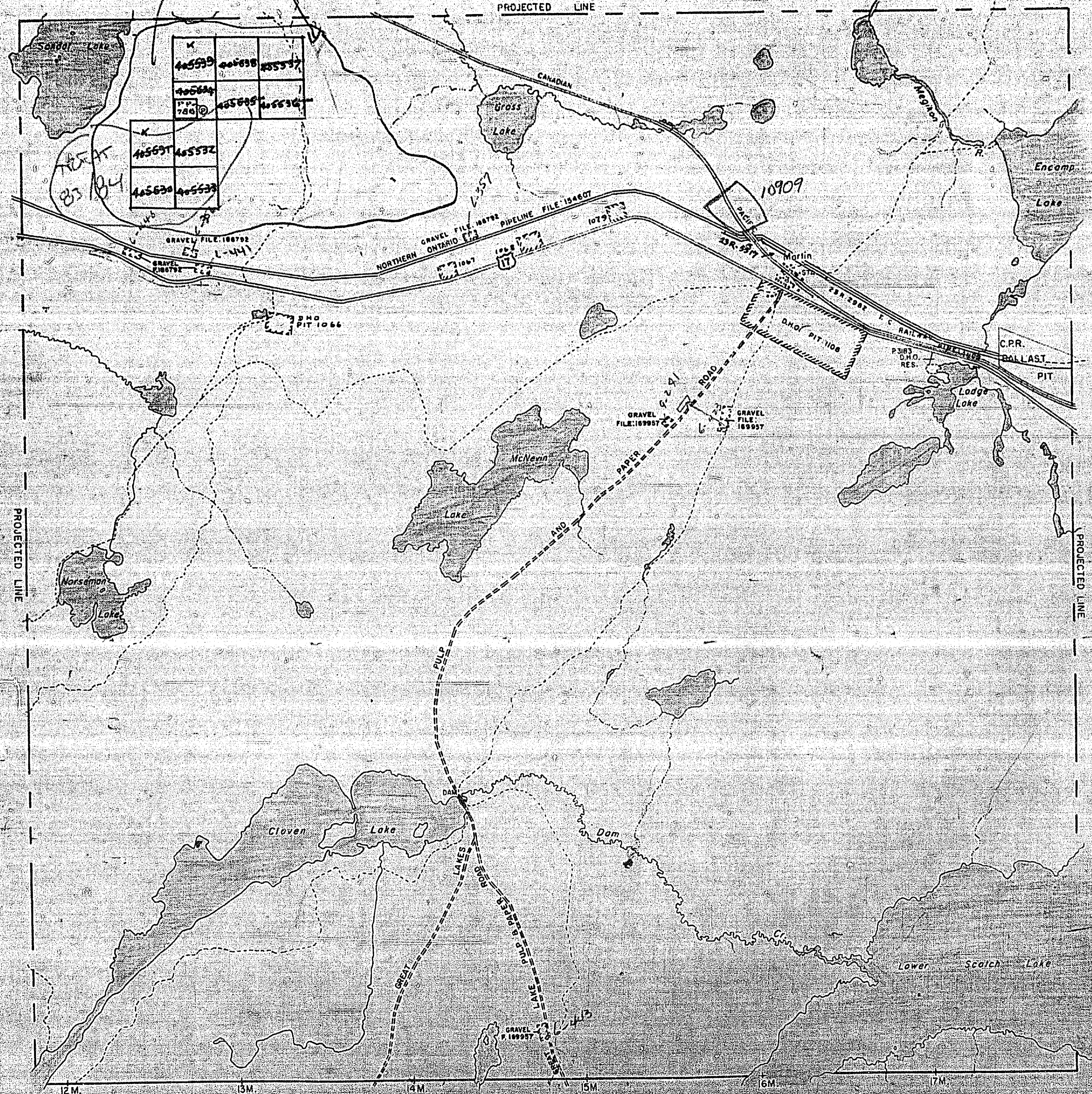

Cathcart Twp.

Corman Twp.

McNEVIN TWP 1272

Furniss Twp.

THE TOWNSHIP OF
OF

McNEVIN

DISTRICT OF
KENORA

KENORA
MINING DIVISION

SCALE: 1-INCH=40 CHAINS

LEGEND

PATENTED LAND	Ⓟ
CROWN LAND SALE	C.S.
LEASES	Ⓛ
LOCATED LAND	Loc.
LICENSE OF OCCUPATION	L.O.
MINING RIGHTS ONLY	M.R.O.
SURFACE RIGHTS ONLY	S.R.O.
ROADS	—
IMPROVED ROADS	—
KING'S HIGHWAYS	—
RAILWAYS	—
POWER LINES	—
MARSH OR MUSKEG	—
MINES	—
CANCELLED	C

NOTES

400' surface rights reservation around
all lakes & rivers.

Gravel roads shown thus: ————

SAND & GRAVEL

- Ⓟ GRAVEL FILE 186792
- Ⓛ M.T.C. PIT 1066
- Ⓛ PIT 1067
- Ⓛ PIT 1068
- Ⓛ PIT 1079
- Ⓛ GRAVEL FILE 169952
- Ⓛ M.T.C. PIT 1108

Obsolete
Aug. 23/84

DATE OF ISSUE
MAY 30 1983
Ministry of Natural Resources
TORONTO

Effective as
Linen

KENORA
MINING DIV.
RECEIVED
JUN 9 1983
AM 7 8 9 10 11 12 1 2 3 4 5 6 PM

PLAN NO.- M-1272

ONTARIO
MINISTRY OF NATURAL RESOURCES
SURVEYS AND MAPPING BRANCH

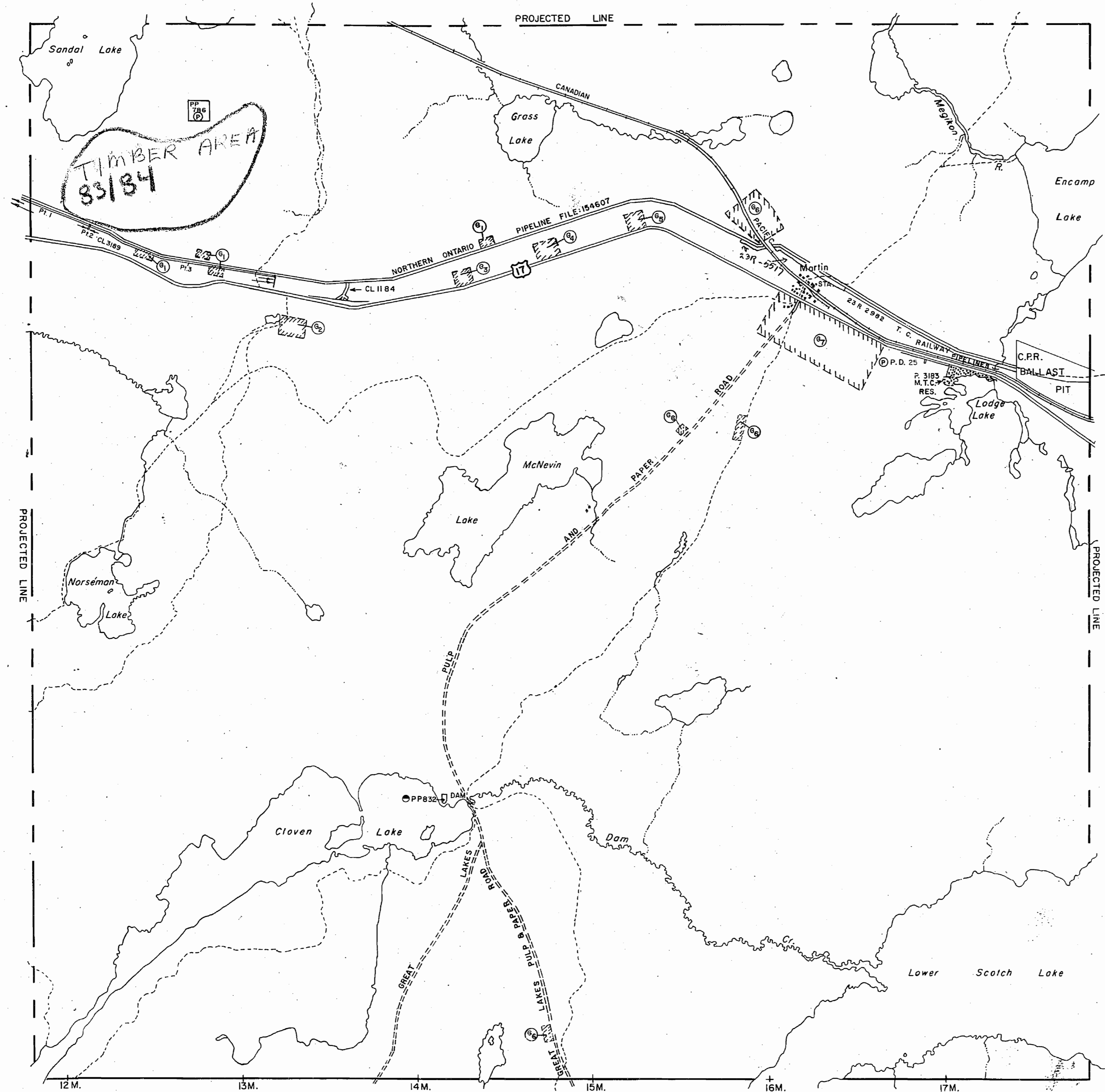

Cathcart Twp.

Corman Twp.

12M. 13M. 14M. 15M. 16M. 17M.

Furniss Twp. G2544

THE TOWNSHIP OF
OF

McNEVIN

DISTRICT OF
KENORA

KENORA
MINING DIVISION

SCALE: 1-INCH=40 CHAINS

THE INFORMATION THAT APPEARS ON THIS MAP HAS BEEN COMPILED FROM VARIOUS SOURCES, AND ACCURACY IS NOT GUARANTEED. THOSE WISHING TO STAKE MINING CLAIMS SHOULD CONSULT WITH THE MINING RECORDER, MINISTRY OF NORTHERN DEVELOPMENT AND MINES, FOR ADDITIONAL INFORMATION ON THE STATUS OF THE LANDS SHOWN HEREON.

LEGEND

PATENTED LAND	Ⓟ
CROWN LAND SALE	C.S.
LEASES	Ⓞ
LOCATED LAND	Loc.
LICENSE OF OCCUPATION	L.O.
MINING RIGHTS ONLY	M.R.O.
SURFACE RIGHTS ONLY	S.R.O.
ROADS	—
IMPROVED ROADS	—
KING'S HIGHWAYS	—
RAILWAYS	—
POWER LINES	—
MARSH OR MUSKEG	—
MINES	Ⓡ
CANCELLED	C.

NOTES

400' surface rights reservation around all lakes & rivers.
 (R) W-K-6-BB-NWR S+MR. DEC. 9/88
 Gravel roads shown thus: —

SAND & GRAVEL

- Ⓢ GRAVEL FILE 186792
- Ⓣ M.T.C. PIT 1066
- Ⓤ PIT 1067
- Ⓥ PIT 1068
- Ⓦ PIT 1079
- Ⓧ GRAVEL FILE 169957
- Ⓨ M.T.C. PIT 1108

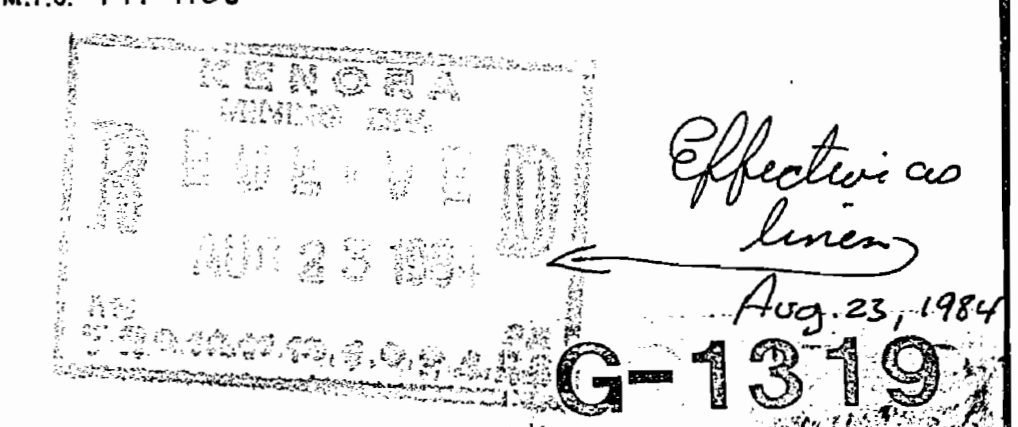
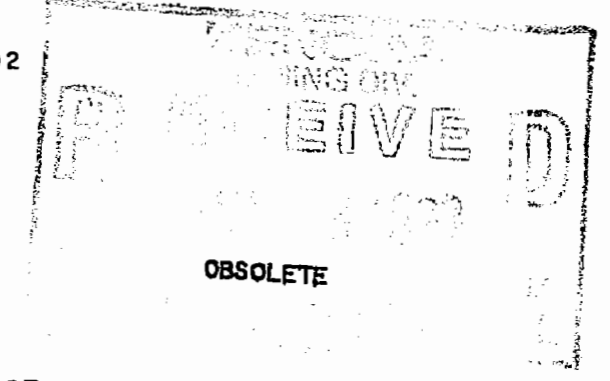

PLAN NO. - M-1272

ONTARIO
MINISTRY OF NATURAL RESOURCES
SURVEY AND MAPPING BRANCH

Cathcart Twp. G1306

Corman Twp. G1308

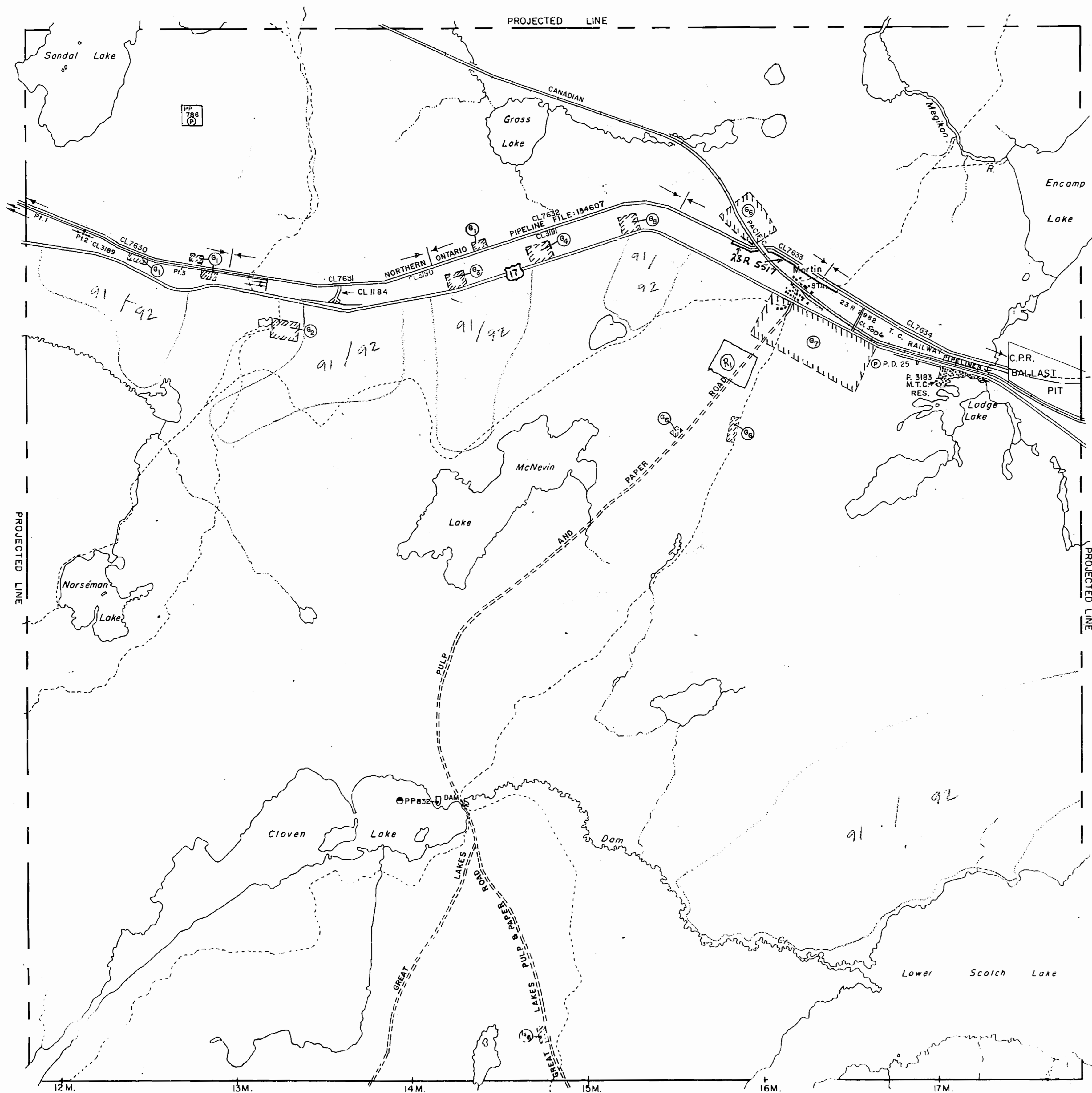

G563 UPPER SCOTCH LAKE

NOTICE: THE SURFACE RIGHTS LYING WITHIN 40.25m OF THE CENTRE LINE OF THE TRANSCANADA PIPELINE RIGHT OF WAY ARE WITHDRAWN FROM STAKING OUT, PROSPECTING, SALE OR LEASE BY ORDER W.O.191 ONT. DATED SEPT. 30, 1991. SECTION 122 OF THE NATIONAL BOARD ACT APPLIES!

G1319

1272

Furniss Twp.

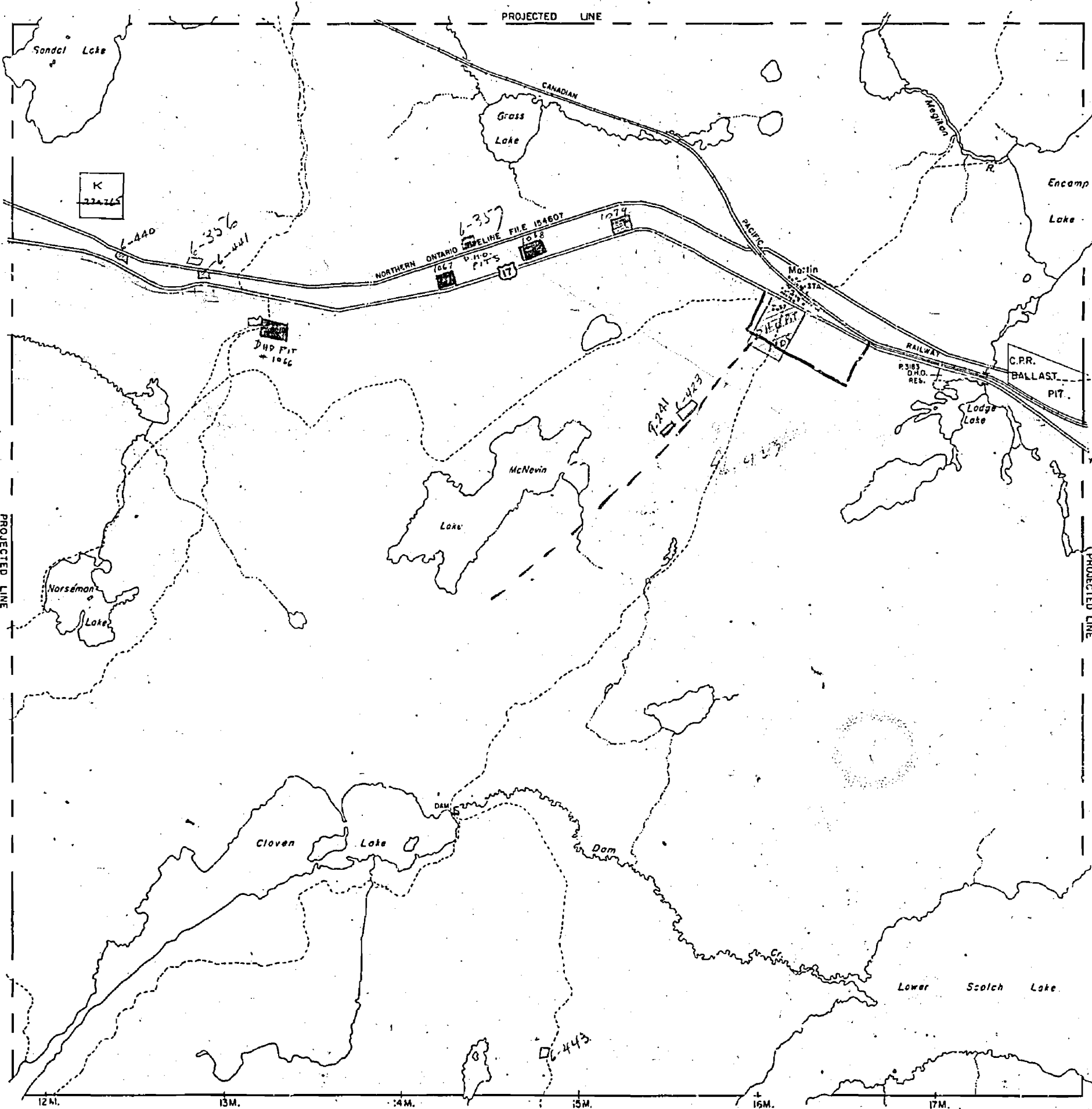

Cathcart Twp.

Corman Twp.

THE TOWNSHIP OF
OF

McNEVIN

DISTRICT OF
KENORA

KENORA
MINING DIVISION

SCALE: 1-INCH=40 CHAINS

LEGEND

PATENTED LAND	Ⓟ
CROWN LAND SALE	Ⓞ
LEASES	Ⓢ
LOCATED LAND	Loc.
LICENSE OF OCCUPATION	L.O.
MINING RIGHTS ONLY	M.R.O.
SURFACE RIGHTS ONLY	S.R.O.
ROADS	—
IMPROVED ROADS	—
KING'S HIGHWAYS	—
RAILWAYS	—
POWER LINES	—
MARSH OR MUSKEG	—
MINES	ⓧ
CANCELLED	Ⓞ

NOTES

400' Reserve around all lakes & rivers to Dept. of Lqnds & Forests.

Gravel roads shown thus: —

RECEIVED
MAY 1 1961
KENORA MINING DIV.
Sept. 9/71
Oct. 11/72

PLAN NO. M-1272

DEPARTMENT OF MINES

— ONTARIO —

McNEVIN

1272

TWP 17

Mc NEVIN TWP.

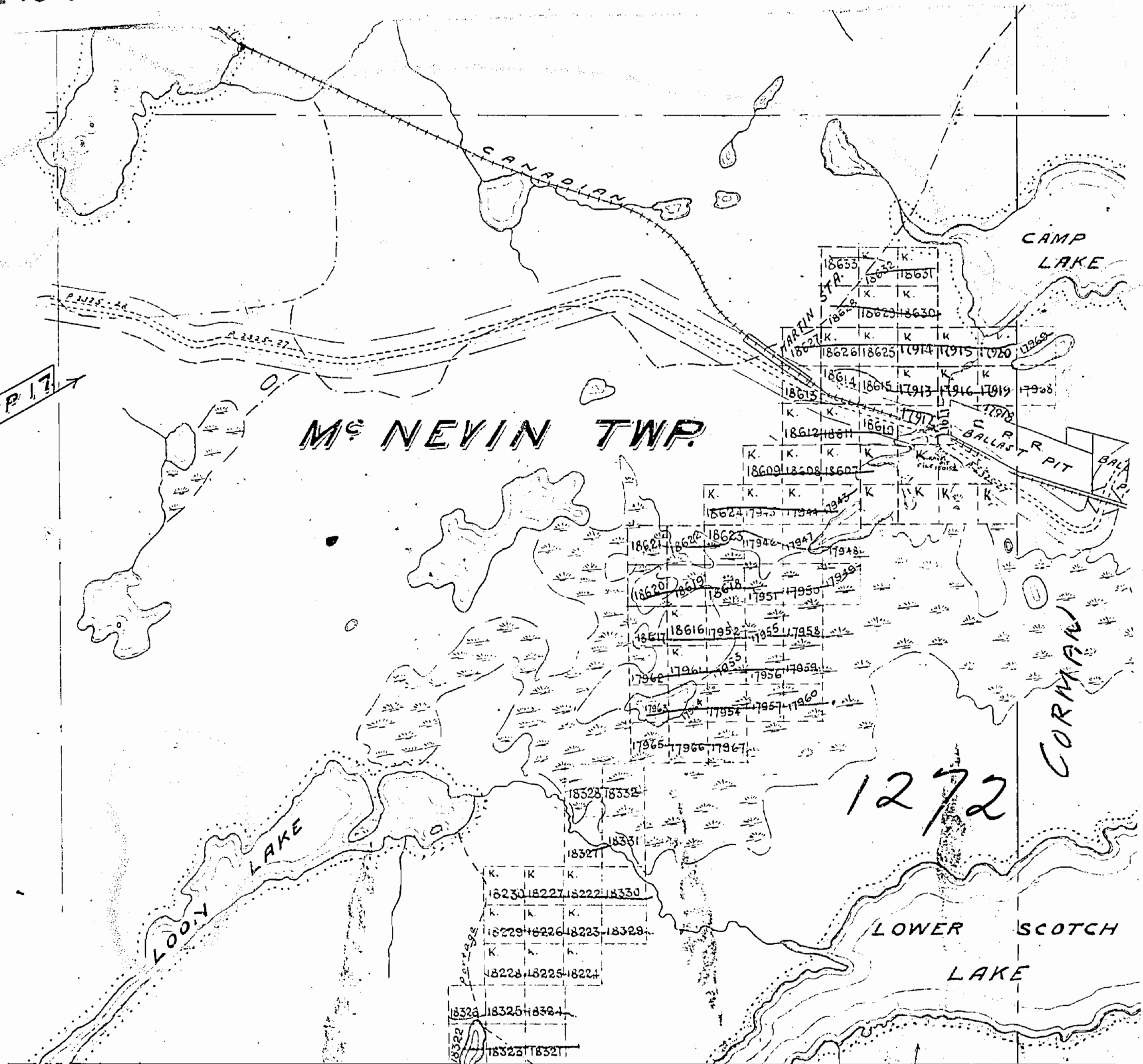

Surface reservations 400' wide by Dept. of L & F shown hereon that
 This reservation to apply also along the shore lines of all islands lying within the
 area delineated

M-1965

McKENZIE TWP

TWP 17

MS NEVIN TWP.

CAMP LAKE

LOON LAKE

1272

CORMAN

LOWER SCOTCH LAKE

12M 13M 14M 15M 16M 17M 18M
Base Line run by O.L.S. Speight and Van Norstrand 1897

Surface reservations 400' wide by Dept. of L. & F. Shown hereon thus
This reservation to apply also along the shorelines of all islands lying within the
areas delineated.

M-1965

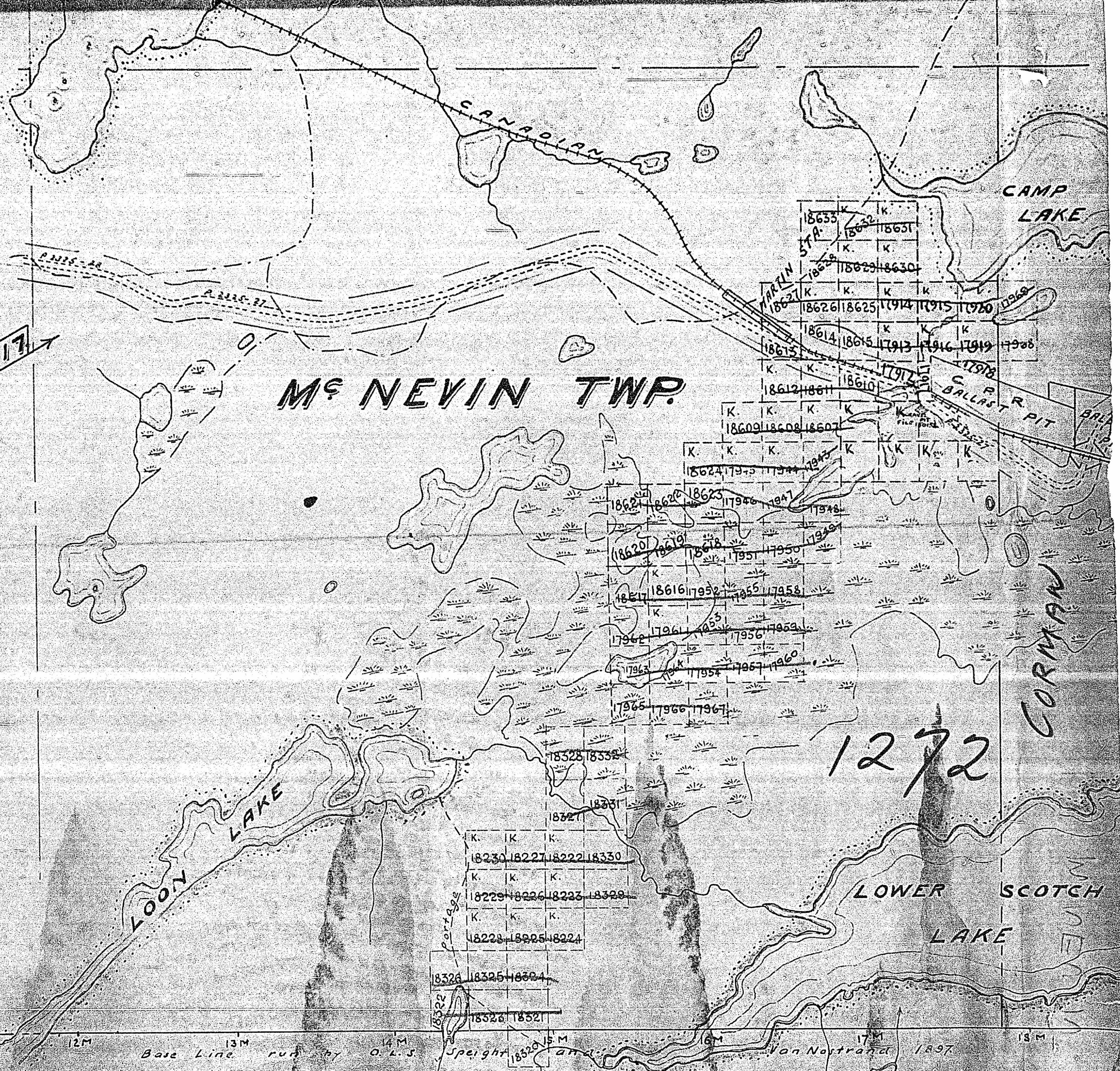

1272

Furniss Twp.

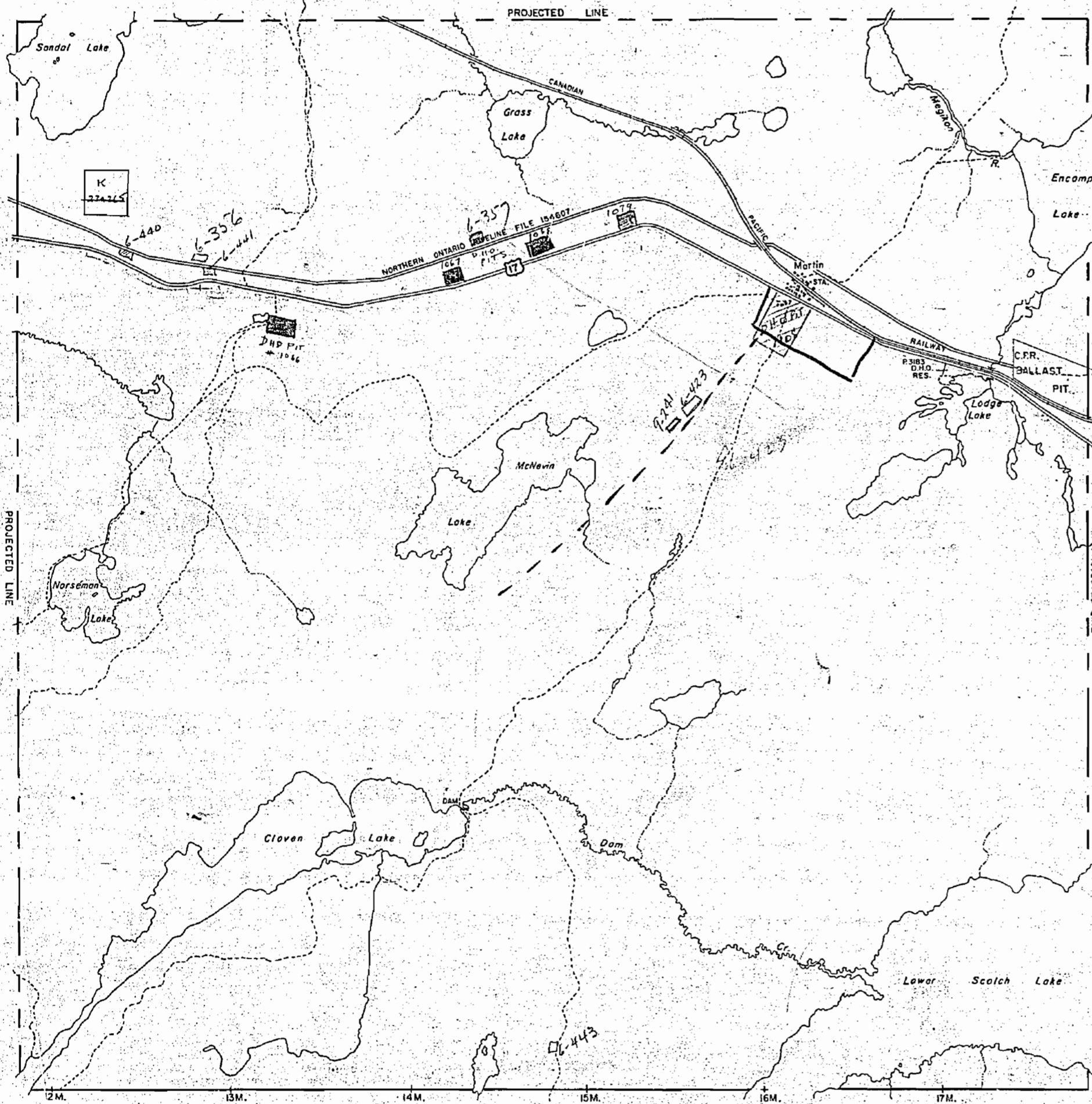

THE TOWNSHIP
OF

McNEVIN

DISTRICT OF
KENORA

KENORA
MINING DIVISION

SCALE: 1-INCH=40 CHAINS

LEGEND

PATENTED LAND	Ⓟ
CROWN LAND SALE	C.S.
LEASES	Ⓛ
LOCATED LAND	Loc.
LICENSE OF OCCUPATION	L.O.
MINING RIGHTS ONLY	M.R.O.
SURFACE RIGHTS ONLY	S.R.O.
ROADS	—
IMPROVED ROADS	—
KING'S HIGHWAYS	—
RAILWAYS	—
POWER LINES	—
MARSH OR MUSKEG	—
MINES	Ⓜ
CANCELLED	C.

NOTES

400' Reserve around all lakes & rivers to Dept. of Lqnds & Forests.

Gravel roads shown thus: —

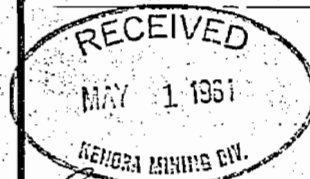

Sept. 9/71
Oct. 11/72

PLAN NO. - M-1272

DEPARTMENT OF MINES

— ONTARIO —

McNEVIN

Lower Scotch Lake
Furness Dwp
Chartraud.

1272

TOWNSHIPS
Nos. 16, 17, AND 18.
ALONG CANADIAN PACIFIC RLY.
DISTRICT OF KENORA.
KENORA MINING DIVISION.

SCALE 40 CHAINS TO AN INCH

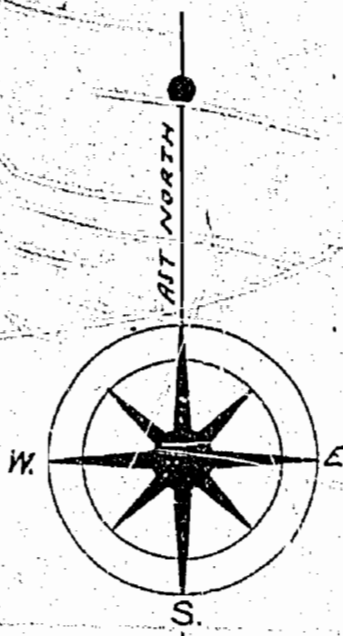

2051

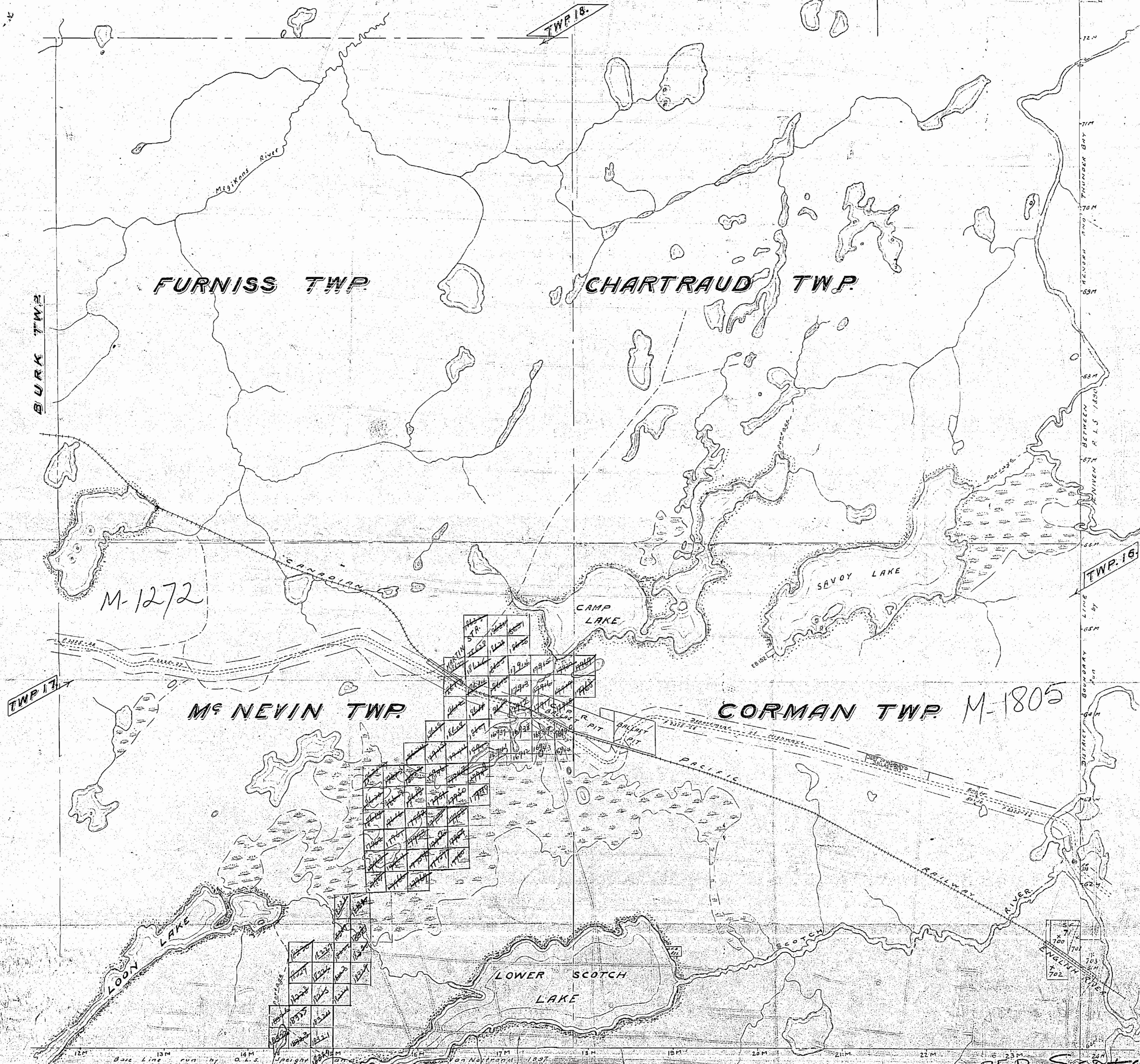

M-1272

Mc NEVIN TWP.

CORMAN TWP M-1805

Surface reservations 200' wide by Dept. of L. W. Shewan hereon thus
This reservation to apply also along the shore lines of all islands lying within the
areas delineated

UPPER SCOTCH
2051

1507

1272

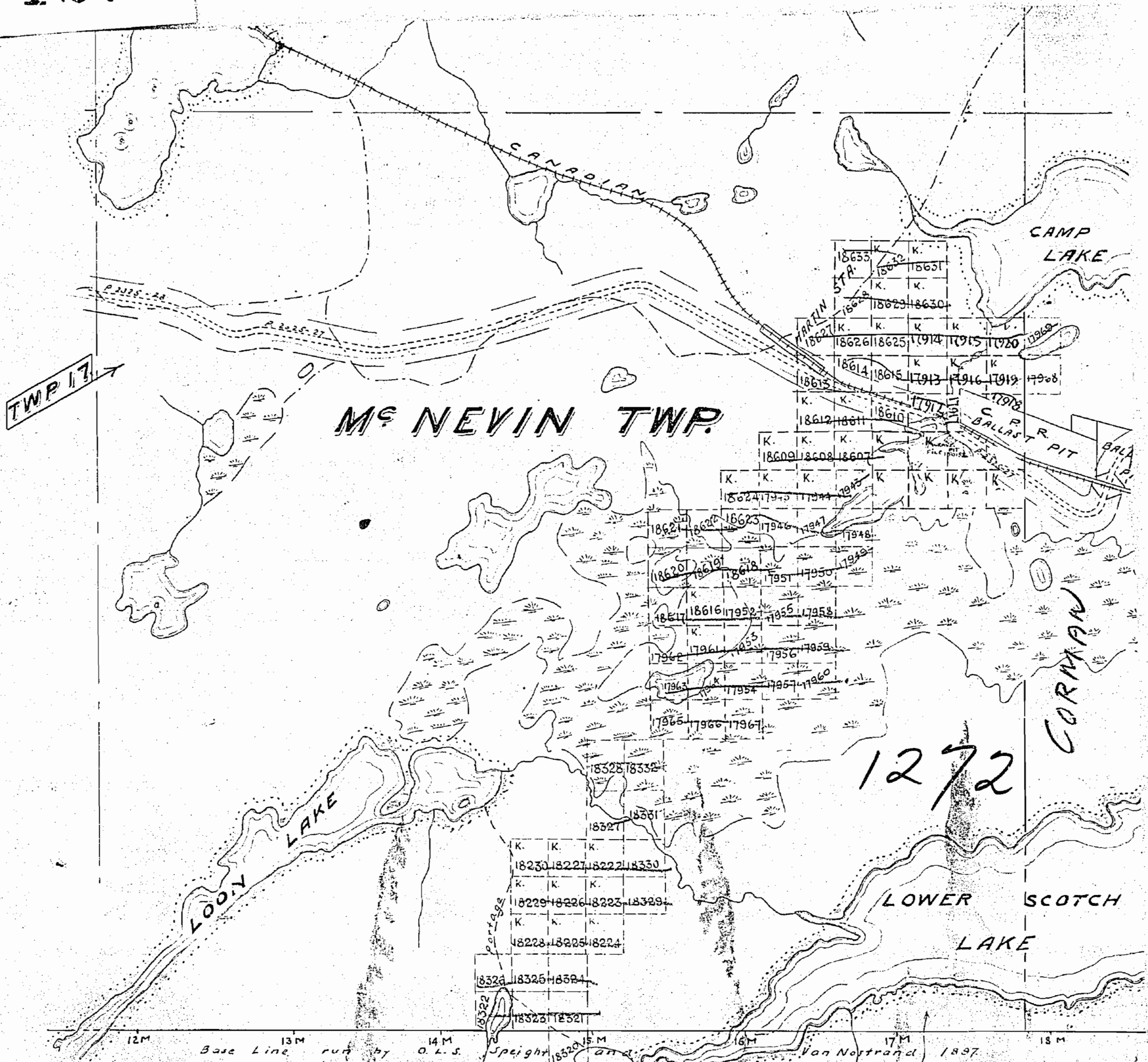

Surface reservations 400' wide by Dept. of L & F. Shown hereon thus
This reservation to apply also along the shorelines of all islands lying within the
area delineated

M-1965

REFERENCES

AREAS WITHDRAWN FROM DISPOSITION

- M.R.O. - MINING RIGHTS ONLY
- S.R.O. - SURFACE RIGHTS ONLY
- M.&S. MINING AND SURFACE RIGHTS

Description	Order No.	Date	Disposition	File
(R1)	W-K-6-88 NWR	09/12/88	M&S	

Furniss Twp.

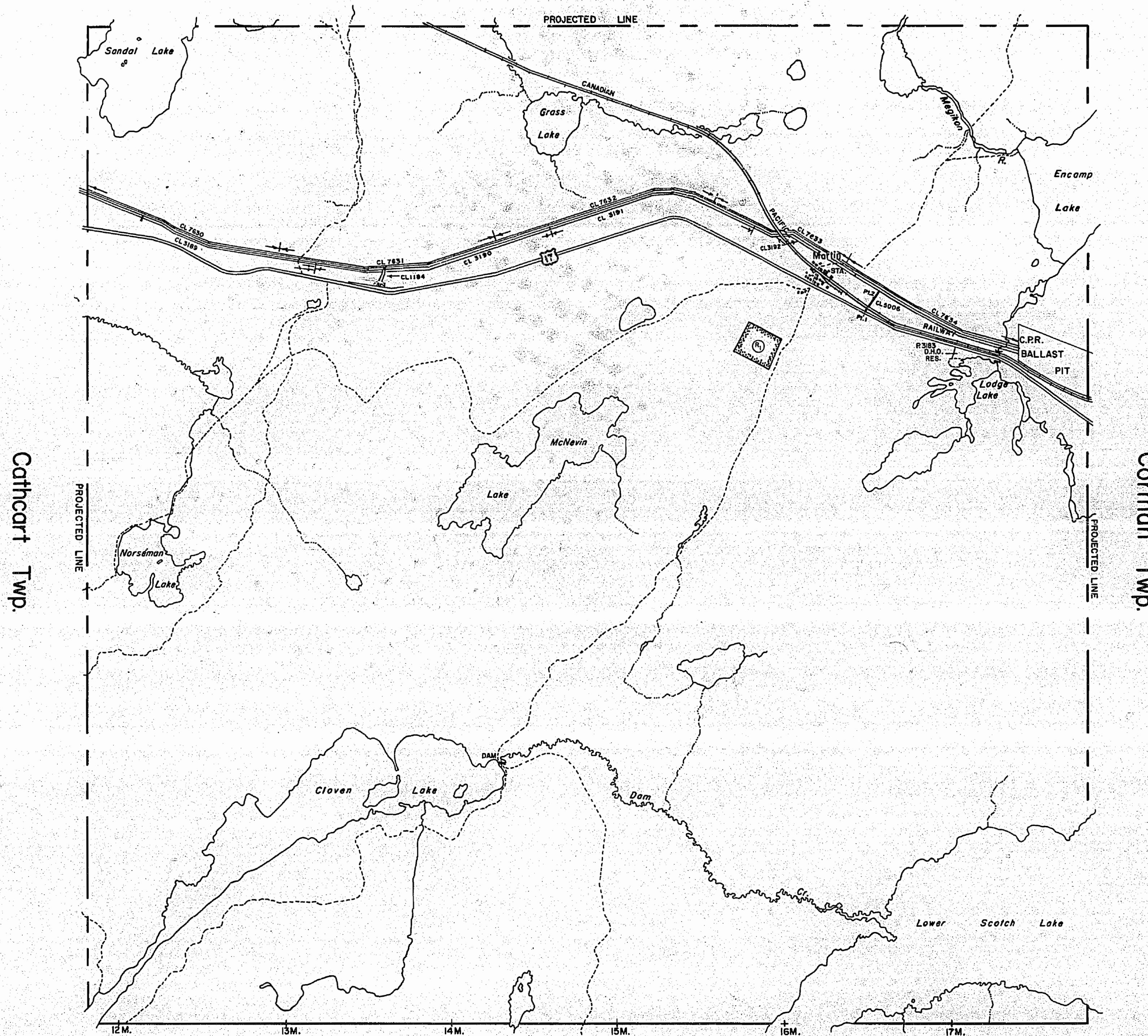

LEGEND

- HIGHWAY AND ROUTE No.
- OTHER ROADS
- TRAILS
- SURVEYED LINES:
 - TOWNSHIPS, BASE LINES, ETC.
 - LOTS, MINING CLAIMS, PARCELS, ETC.
- UNSURVEYED LINES:
 - LOT LINES
 - PARCEL BOUNDARY
 - MINING CLAIMS ETC.
- RAILWAY AND RIGHT OF WAY
- UTILITY LINES
- NON-PERENNIAL STREAM
- FLOODING OR FLOODING RIGHTS
- SUBDIVISION OR COMPOSITE PLAN
- RESERVATIONS
- ORIGINAL SHORELINE
- MARSH OR MUSKEG
- MINES
- TRAVERSE MONUMENT

DISPOSITION OF CROWN LANDS

TYPE OF DOCUMENT	SYMBOL
PATENT, SURFACE & MINING RIGHTS	
" SURFACE RIGHTS ONLY	
" MINING RIGHTS ONLY	
LEASE, SURFACE & MINING RIGHTS	
" SURFACE RIGHTS ONLY	
" MINING RIGHTS ONLY	
LICENCE OF OCCUPATION	
ORDER-IN-COUNCIL	
RESERVATION	
CANCELLED	
SAND & GRAVEL	

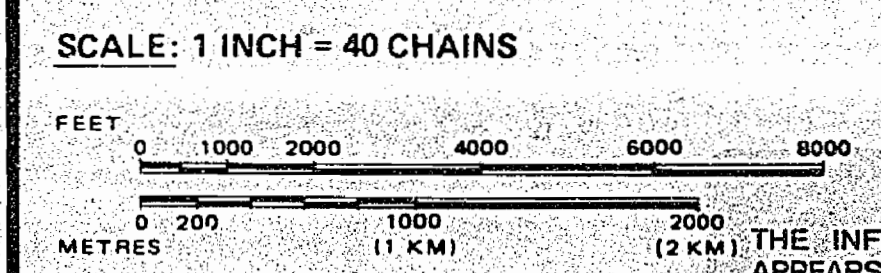

TOWNSHIP

Mc NEVIN

THE INFORMATION THAT APPEARS ON THIS MAP HAS BEEN COMPILED FROM VARIOUS SOURCES, AND ACCURACY IS NOT GUARANTEED. THOSE WISHING TO STAKE MINING CLAIMS SHOULD CONSULT WITH THE MINING RECORDER, MINISTRY OF NORTHERN DEVELOPMENT AND MINES, FOR ADDITIONAL INFORMATION ON THE STATUS OF THE LANDS SHOWN HEREON.

M.N.R. ADMINISTRATIVE DISTRICT OF KENORA MINING DIV.

DRYDEN

MINING DIVISION

KENORA

LAND TITLES / REGISTRY DIVISION

KENORA

RECEIVED

JUL - 6 1993

AM EFFECTIVE PM

789 10 11 12 1 2 3 4 5 6

Ministry of Natural Resources Ontario

Ministry of Northern Development and Mines

Date NOVEMBER/92

Number **G-1319**

Cathcart Twp.

Corman Twp.