

REFERENCES

AREAS WITHDRAWN FROM DISPOSITION

M.R.O. - MINING RIGHTS ONLY
 S.R.O. - SURFACE RIGHTS ONLY
 M.+ S. - MINING AND SURFACE RIGHTS

Description	Order No.	Date	Disposition	File

FOREST ACTIVITY INFORMATION
 THIS TOWNSHIP AREA FALLS WITHIN THE
RED LAKE CROWN
 AND MAY BE SUBJECT TO FORESTRY OPERATIONS.
 THE M.N.R. UNIT FORESTER FOR THIS AREA CAN BE
 CONTACTED AT:
 7, R.O. BOX 838 12, S. 15, 8
 RED LAKE, ONTARIO, CANADA
 (807) 727-2253

LEGEND

HIGHWAY AND ROUTE No.	
OTHER ROADS	
TRAILS	
SURVEYED LINES:	
TOWNSHIPS, BASE LINES, ETC.	
LOTS, MINING CLAIMS, PARCELS, ETC.	
UNSURVEYED LINES:	
LOT LINES	
PARCEL BOUNDARY	
MINING CLAIMS ETC.	
RAILWAY AND RIGHT OF WAY	
UTILITY LINES	
NON-PERENNIAL STREAM	
FLOODING OR FLOODING RIGHTS	
SUBDIVISION OR COMPOSITE-PLAN	
RESERVATIONS	
ORIGINAL SHORELINE	
MARSH OR MUSKEG	
MINES	
TRAVERSE MONUMENT	

DISPOSITION OF CROWN LANDS

TYPE OF DOCUMENT	SYMBOL
PATENT, SURFACE & MINING RIGHTS	
SURFACE RIGHTS ONLY	
MINING RIGHTS ONLY	
LEASE, SURFACE & MINING RIGHTS	
SURFACE RIGHTS ONLY	
MINING RIGHTS ONLY	
LICENCE OF OCCUPATION	
ORDER-IN-COUNCIL	
RESERVATION	
CANCELLED	
SAND & GRAVEL	

NOTE: MINING RIGHTS IN PARCELS PATENTED PRIOR TO MAY 6, 1913, VESTED IN ORIGINAL PATENTEE BY THE PUBLIC LANDS ACT, R.S.O. 1970, CHAP. 380, SEC. 63, SUBSEC. 1.

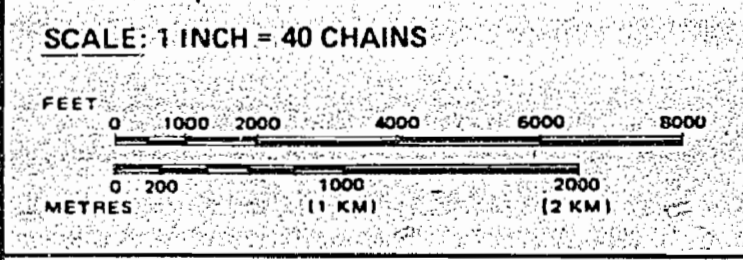

AREA
MEDICINE STONE LAKE
 M.N.R. ADMINISTRATIVE DISTRICT
RED LAKE
 MINING DIVISION
RED LAKE
 LAND TITLES / REGISTRY DIVISION
KENORA / PATRICIA

THE INFORMATION THAT APPEARS ON THIS MAP HAS BEEN COMPILED FROM VARIOUS SOURCES, AND ACCURACY IS NOT GUARANTEED. THOSE WISHING TO STAKE MINING CLAIMS SHOULD CONSULT WITH THE MINING RECORDER, MINISTRY OF NORTHERN DEVELOPMENT AND MINES, FOR ADDITIONAL INFORMATION ON THE STATUS OF THE LANDS SHOWN HEREON.

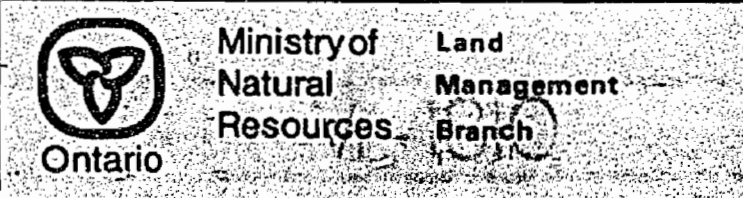

Date FEB 1983 Number **G-1823**



KILLALA

MULCAHY

SCALE - 40 CHAINS - INCH

M. 2185

2185

North Arrow

MEDICINESTONE

LAKE

32270	32271	32272	32273
32274	32275	32276	32277
32278	32279	32280	32281
32282	32283	32284	32285
32286	32287	32288	32289
32290	32291	32292	32293
32294	32295	32296	32297
32298	32299	32300	32301

MEDICINESTONE LAKE

UPPER

LONG LEGGED

LAKE

Passage

SCALE - 40 CHAINS = 1 INCH

M2185

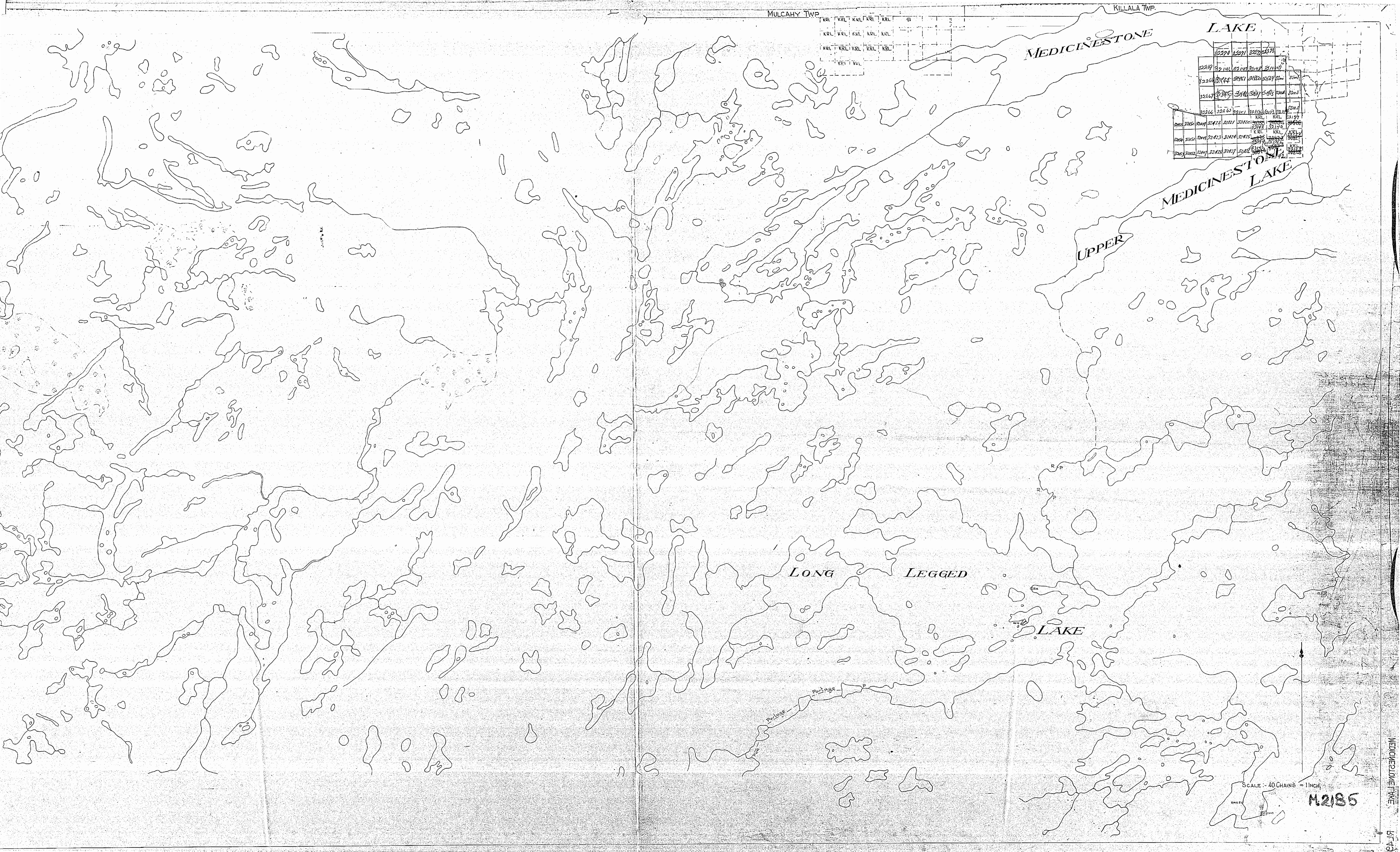

LAKE

MEDICINESTONE

MEDICINESTONE
LAKE

UPPER

LONG LEGGED

LAKE

Portage

SCALE - 40 CHAINS = INCH

M2185

MEDICINESTONE TWP

R 70

32270	32271	32272	32273
32269	32270	32271	32272
32268	32269	32270	32271
32267	32268	32269	32270
32266	32267	32268	32269
32265	32266	32267	32268
32264	32265	32266	32267
32263	32264	32265	32266
32262	32263	32264	32265
32261	32262	32263	32264
32260	32261	32262	32263

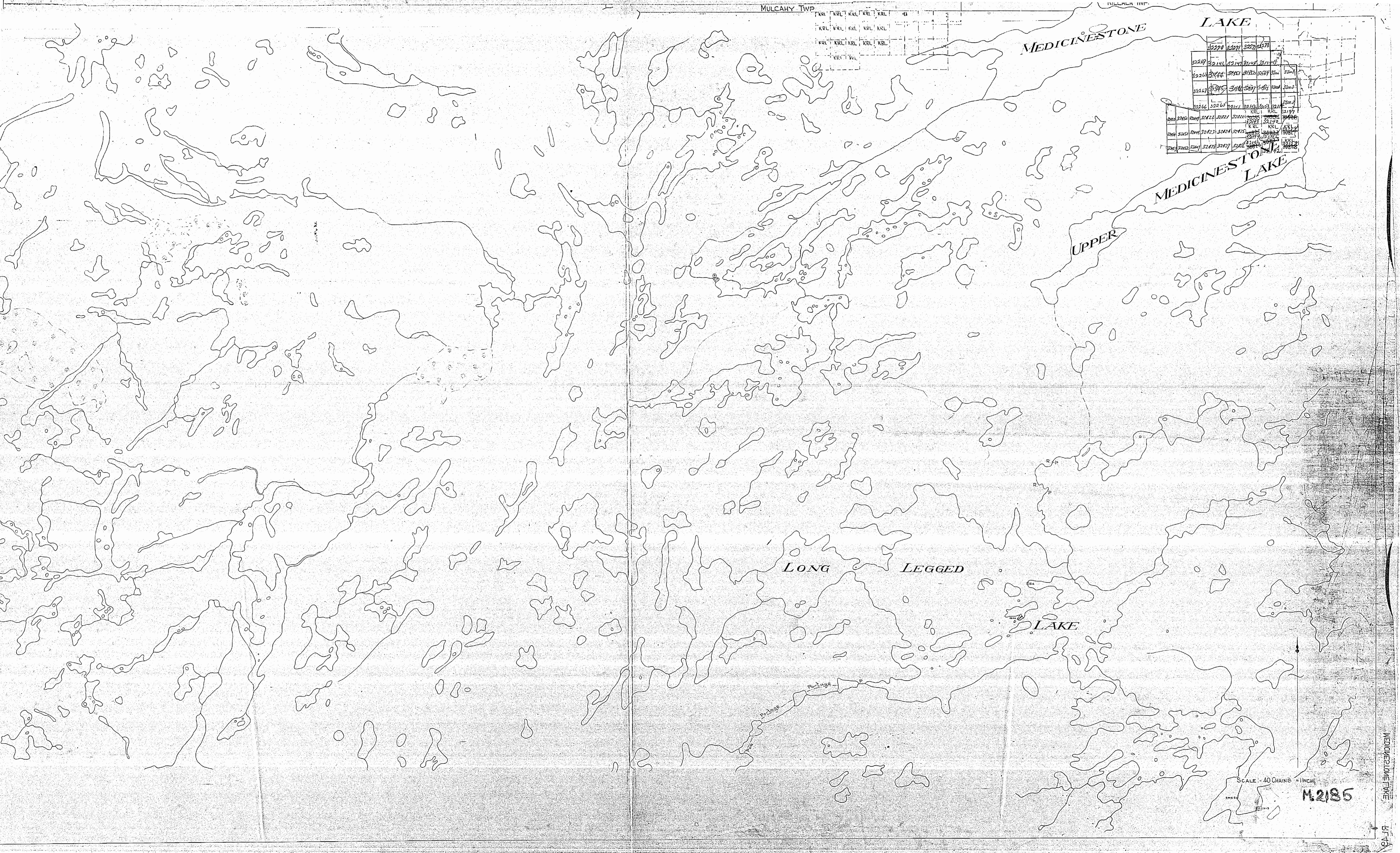

MULCAHY TWP

KILLALA TWP

MEDICINESTONE

LAKE

3226	3227	3228	3229	3230
3231	3232	3233	3234	3235
3236	3237	3238	3239	3240
3241	3242	3243	3244	3245
3246	3247	3248	3249	3250
3251	3252	3253	3254	3255
3256	3257	3258	3259	3260
3261	3262	3263	3264	3265
3266	3267	3268	3269	3270
3271	3272	3273	3274	3275
3276	3277	3278	3279	3280
3281	3282	3283	3284	3285
3286	3287	3288	3289	3290
3291	3292	3293	3294	3295
3296	3297	3298	3299	3300

MEDICINESTONE LAKE

UPPER

LONG LEGGED

LAKE

Portage

SCALE - 40 CHAINS = 1 INCH

M. 2185

MEDICINESTONE LAKE

TELESCOPE LAKE G-1897

FAULKENHAM LAKE G.1773

RAINFALL LAKE G.1857

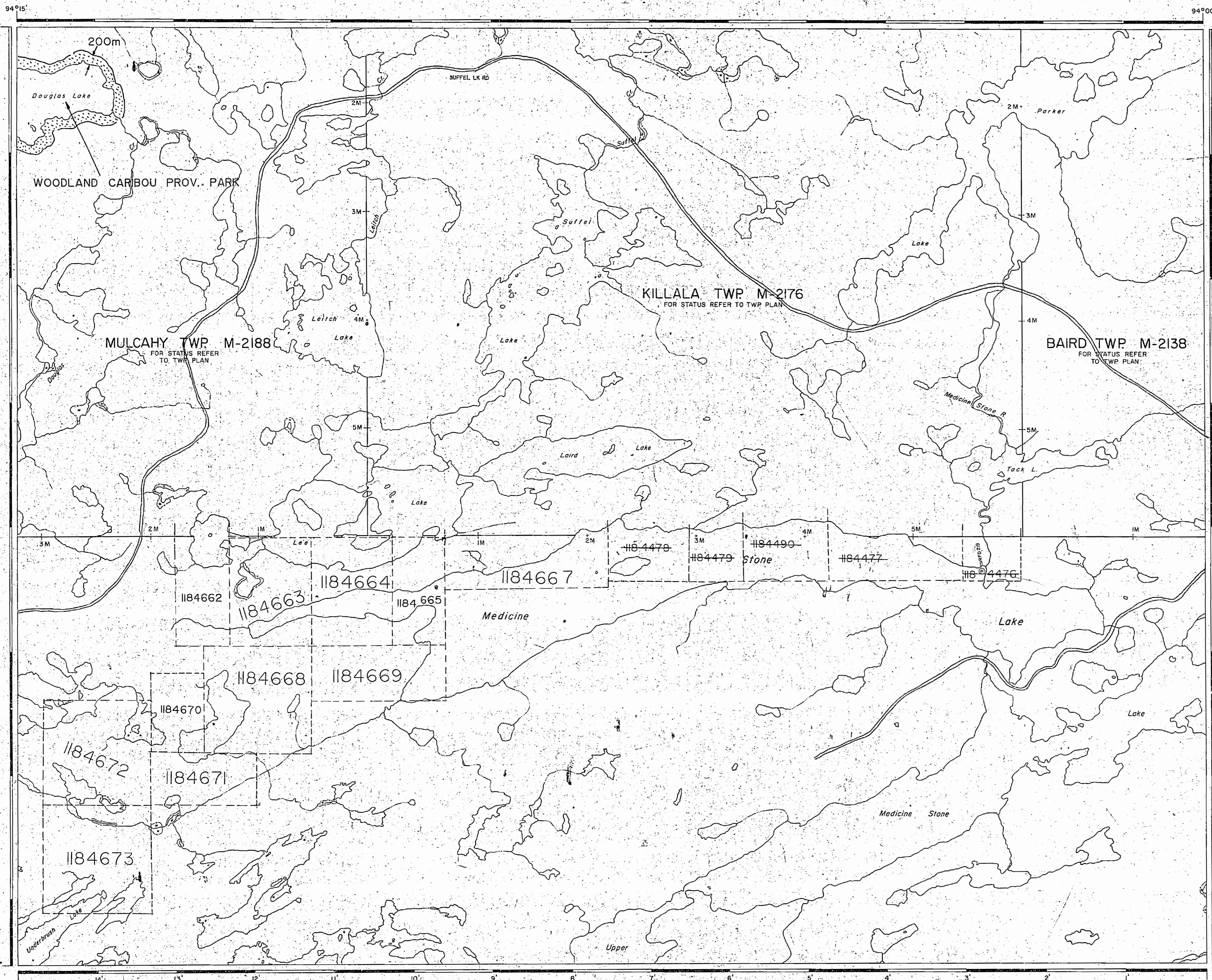

REFERENCES

AREAS WITHDRAWN FROM DISPOSITION

M.R.O. - MINING RIGHTS ONLY
 S.R.O. - SURFACE RIGHTS ONLY
 M+S. - MINING AND SURFACE RIGHTS

Description	Order No.	Date	Disposition	File

FOREST ACTIVITY INFORMATION
 THIS TOWNSHIP AREA FALLS WITHIN THE
RED LAKE CROWN
 AND MAY BE SUBJECT TO FORESTRY OPERATIONS.
 THE M.N.R. UNIT FORESTER FOR THIS AREA CAN BE
 CONTACTED AT:
 71 P.O. BOX 5008 120 113 01
 RED LAKE, ONTARIO P0V 2M0
 (807) 727-2253

LEGEND

- HIGHWAY AND ROUTE No.
- OTHER ROADS
- TRAILS
- SURVEYED LINES:
 TOWNSHIPS, BASE LINES, ETC.
- LOTS, MINING CLAIMS, PARCELS, ETC.
- UNSURVEYED LINES:
 LOT LINES
- PARCEL BOUNDARY
- MINING CLAIMS, ETC.
- RAILWAY AND RIGHT OF WAY
- UTILITY LINES
- NON-PERENNIAL STREAM
- FLOODING OR FLOODING RIGHTS
- SUBDIVISION OR COMPOSITE PLAN
- RESERVATIONS
- ORIGINAL SHORELINE
- MARSH OR MUSKEG
- MINES
- TRAVERSE MONUMENT

DISPOSITION OF CROWN LANDS

TYPE OF DOCUMENT	SYMBOL
PATENT, SURFACE & MINING RIGHTS	
SURFACE RIGHTS ONLY	
MINING RIGHTS ONLY	
LEASE, SURFACE & MINING RIGHTS	
SURFACE RIGHTS ONLY	
MINING RIGHTS ONLY	
LICENCE OF OCCUPATION	
ORDER-IN-COUNCIL	OC
RESERVATION	
CANCELLED	
SAND & GRAVEL	

NOTE: MINING RIGHTS IN PARCELS PATENTED PRIOR TO MAY 6, 1913, VESTED IN ORIGINAL PATENTEE BY THE PUBLIC LANDS ACT, R.S.O. 1970, CHAP. 380, SEC. 63, SUBSEC. 1.

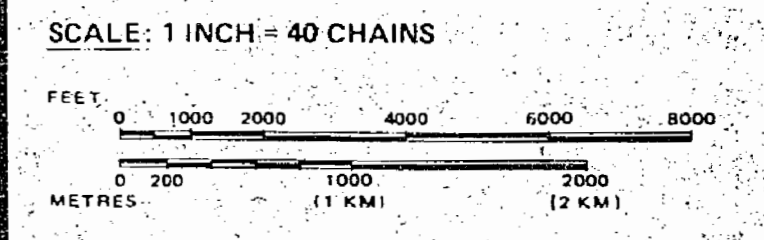

AREA
MEDICINE STONE LAKE DATE OF ISSUE
 M.N.R. ADMINISTRATIVE DISTRICT
 RED LAKE SEP 21 1983
 MINING DIVISION PROVINCIAL RECORDING OFFICE - SUDBURY
 RED LAKE
 LAND TITLES / REGISTRY DIVISION
 KENORA / PATRICIA

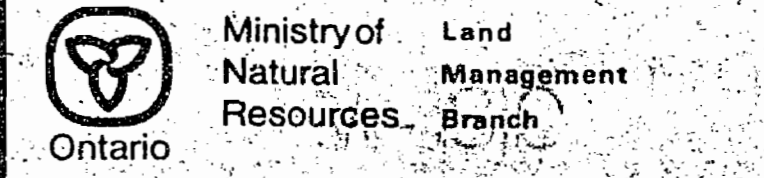

Date FEB 1983 Number
G-1823

THE INFORMATION THAT APPEARS ON THIS MAP HAS BEEN COMPILED FROM VARIOUS SOURCES AND ACCURACY IS NOT GUARANTEED. THOSE WISHING TO STAKE MINING CLAIMS SHOULD CONSULT WITH THE MINING RECORDER, MINISTRY OF NORTHERN DEVELOPMENT AND MINES, FOR ADDITIONAL INFORMATION ON THE STATUS OF THE LANDS SHOWN HEREON.