

REFERENCES
 M.R.O. - MINING RIGHTS ONLY
 S.R.O. - SURFACE RIGHTS ONLY
 M.S. - MINING AND SURFACE RIGHTS
 Division Order No. Date Division File No.
 1 10-10-94 2015/94 198

HUMPHRY

N 69°08'20"E



LEGEND

HIGHWAY AND ROUTE No.	
SECONDARY ROADS	
OTHER ROADS TRAILS	
SURVEYED LINES	
TOWNSHIP, BASE LINES ETC.	
LOTS, MINING CLAIMS, PARCELS ETC.	
UNSURVEYED LINES	
PARCEL BOUNDARY	
MINING CLAIMS ETC.	
RAILWAY AND RIGHT OF WAY	
UTILITY LINES	
NON PERENNIAL STREAM	
FLOODING OR FLOODING RIGHTS	
SUBDIVISION OR COMPOSITE PLAN	
RESERVATIONS	
ORIGINAL SHORELINE	
MARSH OR MUSKIEG	
MINES	
TRAVERSE MONUMENT	

DISPOSITION OF CROWN LANDS

TYPE OF DOCUMENT	SYMBOL
PATENT, SURFACE & MINING RIGHTS	
SURFACE RIGHTS ONLY	
MINING RIGHTS ONLY	
LEASE, SURFACE & MINING RIGHTS	
SURFACE RIGHTS ONLY	
MINING RIGHTS ONLY	
LICENSE OF OCCUPATION	
ORDER IN COUNCIL	
RESERVATION	
CANCELLED	
SAND & GRAVEL	

NOTE: MINING RIGHTS IN PARCELS PATENTED PRIOR TO MAY 1 1925, VESTED IN ORIGINAL PATENTEE BY THE PUBLIC LANDS ACT R.S.O. 1919 CHAP. 380 SEC. 43 SUBSEC. 1

SCALE: 1 INCH = 20 CHAINS

THE INFORMATION THAT APPEARS ON THIS MAP HAS BEEN COMPILED FROM VARIOUS SOURCES, AND ACCURACY IS NOT GUARANTEED. THOSE DESIRING TO STAKE MINING CLAIMS SHOULD CONSULT WITH THE MINING RECORDER, MINISTRY OF NORTHERN DEVELOPMENT AND MINES, FOR ADDITIONAL INFORMATION ON THE STATUS OF THE LANDS SHOWN HEREON.

TOWNSHIP
MEDORA (NORTH PART)
 M.N.R. ADMINISTRATIVE DISTRICT
 BRACEBRIDGE
 MINING DIVISION
 SOUTHERN ONTARIO
 LAND TITLES / REGISTRY DIVISION
 MUSKOKA

Ministry of Natural Resources and Mines
 Ontario

Date: FEBRUARY, 1997

G-2444

G-2444 MEDORA (NORTH PART) TWP. ADEMUM (PART NORTH) TWP. (PART EAST)

REFERENCES
 AREAS WITHDRAWN FROM DISPOSITION
 M.R.O. - MINING RIGHTS ONLY
 S.R.O. - SURFACE RIGHTS ONLY
 M.S. - MINING AND SURFACE RIGHTS
 Description Order No. Date Disposition Fee
 W-30-69/94 20/5/94 MRS 15550

G-5443

(T)RA9 HTUO2) PWT APODEM

RES. GEO. SUBBURY
 M.N.R. DIST.
 BRACEBRIDGE

G-5443

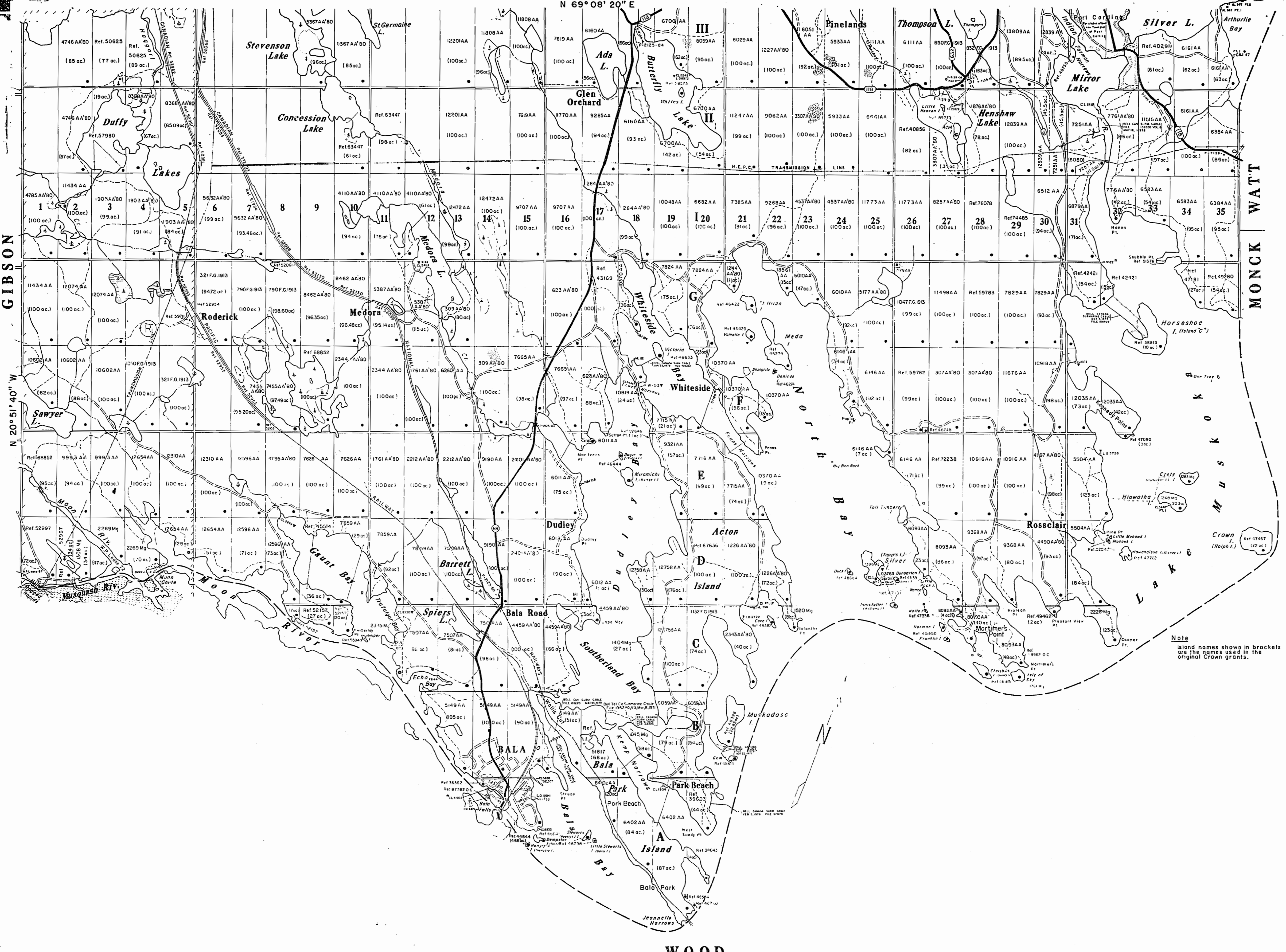

LEGEND
 HIGHWAY AND ROUTE NO.
 SECONDARY ROADS
 OTHER ROADS TRAILS
 SURVEYED LINES
 TOWNSHIPS, BASE LINES, ETC.
 LOTS, MINING CLAIMS, PARCELS, ETC.
 UNSURVEYED LINES
 LOT LINES
 PARCEL BOUNDARY
 MINING CLAIMS ETC.
 RAILWAY AND RIGHT OF WAY
 UTILITY LINES
 NON-PERMANENT STREAM
 FLOODING OR FLOODING RIGHTS
 SUBDIVISION OR COMPOSITE PLAN
 RESERVATIONS
 ORIGINAL SHORELINE
 MARSH OR MUSKOG
 MARES
 TRAVERSE MONUMENT

DISPOSITION OF CROWN LANDS
 TYPE OF DOCUMENT SYMBOL
 PATENT, SURFACE & MINING RIGHTS
 SURFACE RIGHTS ONLY
 MINING RIGHTS ONLY
 LEASE, SURFACE & MINING RIGHTS
 SURFACE RIGHTS ONLY
 MINING RIGHTS ONLY
 LICENCE OF OCCUPATION
 RESERVATION IN COUNCIL
 CANCELLED
 SAND & GRAVEL ACQUIRED LAND
 NOTE: MINING RIGHTS IN PARCELS PATENTED PRIOR TO MAY 6, 1913, VESTED IN ORIGINAL PATENTEES BY THE PUBLIC LANDS ACT, R.S.O. 1913, CHAP. 306, SEC. 83, SUBSEC. 1

SCALE: 1 INCH = 20 CHAINS

NOTE
 Island names shown in brackets are the names used in the original Crown grants.

THE INFORMATION THAT APPEARS ON THIS MAP HAS BEEN COMPILED FROM VARIOUS SOURCES, AND ACCURACY IS NOT GUARANTEED. THOSE WISHING TO STAKE MINING CLAIMS SHOULD CONSULT WITH THE MINING RECORDER, MINISTRY OF NORTHERN DEVELOPMENT AND MINES, FOR ADDITIONAL INFORMATION ON THE STATUS OF THE LANDS SHOWN HEREON.

TOWNSHIP
MEDORA (SOUTH PART)
 M.N.R. ADMINISTRATIVE DISTRICT
 BRACEBRIDGE
 MINING DIVISION
 SOUTHERN ONTARIO
 LAND TITLES / REGISTRY DIVISION
 MUSKOKA

Ministry of Natural Resources and Mines
 Ontario

Date: FEBRUARY, 1997
 Sheet: **G-2443**

MEDORA (S.P.)

G-5443

MEDORA TWP. (SOUTH PART)

G-5443

REFERENCES
 AREAS WITHDRAWN FROM DISPOSITION
 M.R.O. - MINING RIGHTS ONLY
 S.R.O. - SURFACE RIGHTS ONLY
 M.S. - MINING AND SURFACE RIGHTS
 Description Order No. Date Disposition Fee
 X 10 09 94 72 94 181

HUMPHRY

N 69°08'20"E

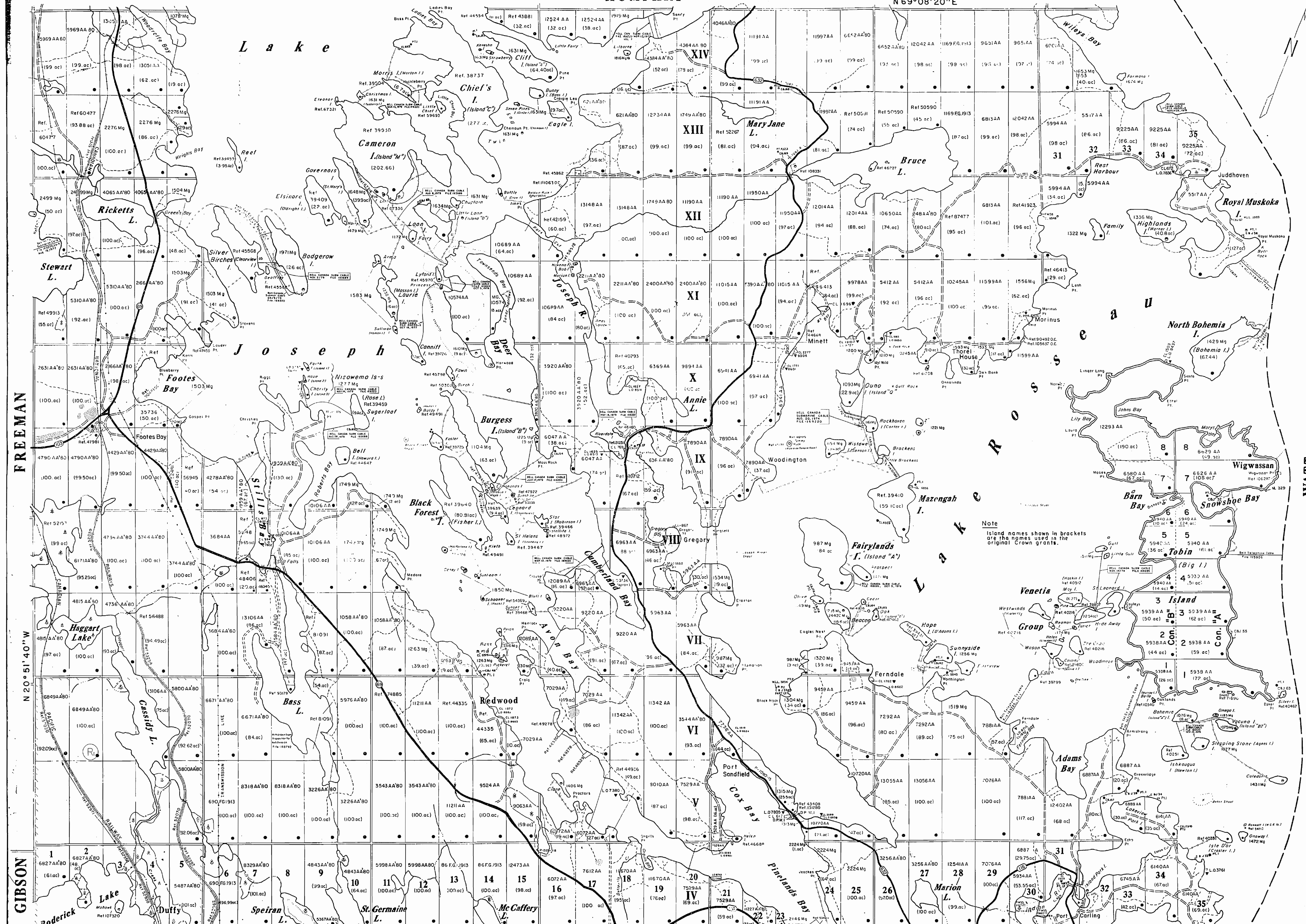

LEGEND

HIGHWAY AND ROUTE NO.	
SECONDARY ROADS	
OTHER ROADS TRAILS	
SURVEYED LINES	
TOWNSHIP, BASE LINES, ETC.	
LOTS, MINING CLAIMS, PARCELS, ETC.	
UNSURVEYED LINES	
LOT LINES	
PARCEL BOUNDARY	
MINING CLAIMS ETC.	
RAILWAY AND RIGHT OF WAY	
UTILITY LINES	
NON-PERMANENT STREAM	
FLOODING OR FLOODING RIGHTS	
SUBDIVISION OR COMPOSITE PLAN	
RESERVATIONS	
ORIGINAL SHORELINE	
MARSH OR MUSKEG	
MINES	
TRAVERSE MONUMENT	

DISPOSITION OF CROWN LANDS

TYPE OF DOCUMENT	SYMBOL
PATENT, SURFACE & MINING RIGHTS	
SURFACE RIGHTS ONLY	
MINING RIGHTS ONLY	
LEASE SURFACE & MINING RIGHTS	
SURFACE RIGHTS ONLY	
MINING RIGHTS ONLY	
LICENCE OF OCCUPATION	
ORDER IN COUNCIL	
RESERVATION	
CANCELLED	
SAND & GRAVEL	

SCALE: 1 INCH = 20 CHAINS

NOTE: MINING RIGHTS IN PARCELS PATENTED PRIOR TO MAY 6, 1915, ARE IN ORIGINAL PATENTEE BY THE PUBLIC LANDS ACT, R.S.O. 1913, CHAP. 286, SEC. 63, SUBSEC. 1.

Note: Island names shown in brackets are the names used in the original Crown grants.

DATE OF ISSUE
 1994 - 1994
 SOUTHERN ONTARIO
 MINING DIVISION

THE INFORMATION THAT APPEARS ON THIS MAP HAS BEEN COMPILED FROM VARIOUS SOURCES AND ACCURACY IS NOT GUARANTEED. THOSE WISHING TO MAKE MINING CLAIMS SHOULD CONSULT WITH THE MINING REGISTROFFICER, MINISTRY OF NORTHERN DEVELOPMENT AND MINES, FOR ADDITIONAL INFORMATION ON THE STATUS OF THE LANDS SHOWN HEREON.

TOWNSHIP
MEDORA (NORTH PART)
 M.N.R. ADMINISTRATIVE DISTRICT
 BRACEBRIDGE
 MINING DIVISION
 SOUTHERN ONTARIO
 LAND TITLES / REGISTRY DIVISION
 MUSKOKA

Ministry of Natural Resources and Mines
 Ontario
 DATE: 28 FEBRUARY, 1997
 Number: **G-2444**

RES. GEO. SUDBURY
 M.N.R. DIST.
 BRACEBRIDGE