

LEGEND

HIGHWAY AND ROUTE No.	
OTHER ROADS	
TRAILS	
SURVEYED LINES:	
TOWNSHIPS, BASE LINES, ETC.	
LOTS, MINING CLAIMS, PARCELS, ETC.	
UNSURVEYED LINES:	
LOT LINES	
PARCEL BOUNDARY	
MINING CLAIMS ETC.	
RAILWAY AND RIGHT OF WAY	
UTILITY LINES	
NON-PERENNIAL STREAM	
FLOODING OR FLOODING RIGHTS	
SUBDIVISION OR COMPOSITE PLAN	
RESERVATIONS	
ORIGINAL SHORELINE	
MARSH OR MUSKEG	
MINES	
TRAVERSE MONUMENT	

DISPOSITION OF CROWN LANDS

TYPE OF DOCUMENT	SYMBOL
PATENT, SURFACE & MINING RIGHTS	
" SURFACE RIGHTS ONLY	
" MINING RIGHTS ONLY	
LEASE, SURFACE & MINING RIGHTS	
" SURFACE RIGHTS ONLY	
" MINING RIGHTS ONLY	
LICENCE OF OCCUPATION	
ORDER-IN-COUNCIL	
RESERVATION	
CANCELLED	
SAND & GRAVEL	

NOTE: MINING RIGHTS IN PARCELS PATENTED PRIOR TO MAY 6, 1912, VESTED IN ORIGINAL PATENTEE BY THE PUBLIC LANDS ACT, R.S.O. 1970, CHAP. 380, SEC. 83, SUBSEC. 1.

REFERENCES

AREAS WITHDRAWN FROM DISPOSITION

M.R.O. - MINING RIGHTS ONLY
 S.R.O. - SURFACE RIGHTS ONLY
 M.+S. - MINING AND SURFACE RIGHTS

Description	Order No.	Date	Disposition	File
(R) SEC. 35 W-LL-C 2308/99		ONT 10/05/99	M+S	

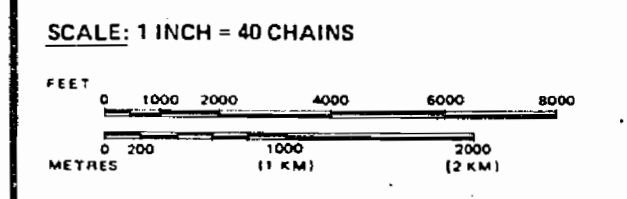

AREA MELGUND LAKE

M.N.R. ADMINISTRATIVE DISTRICT
DRYDEN
 MINING DIVISION
KENORA
 LAND TITLES / REGISTRY DIVISION
KENORA

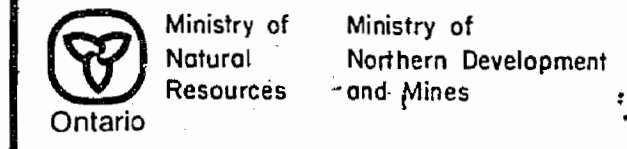

Date FEBRUARY, 1984. Number **G-2587**

THE INFORMATION THAT APPEARS ON THIS MAP HAS BEEN COMPILED FROM VARIOUS SOURCES, AND ACCURACY IS NOT GUARANTEED. THOSE WISHING TO STAKE MINING CLAIMS SHOULD CONSULT WITH THE MINING RECORDER, MINISTRY OF NORTHERN DEVELOPMENT AND MINES, FOR ADDITIONAL INFORMATION ON THE STATUS OF THE LANDS SHOWN HEREON.

KENORA - MINING DIV.
RECEIVED
 EFFECTIVE JUL 11 1994
 AM 789 10 11 12 1 2 3 4 5 6 PM

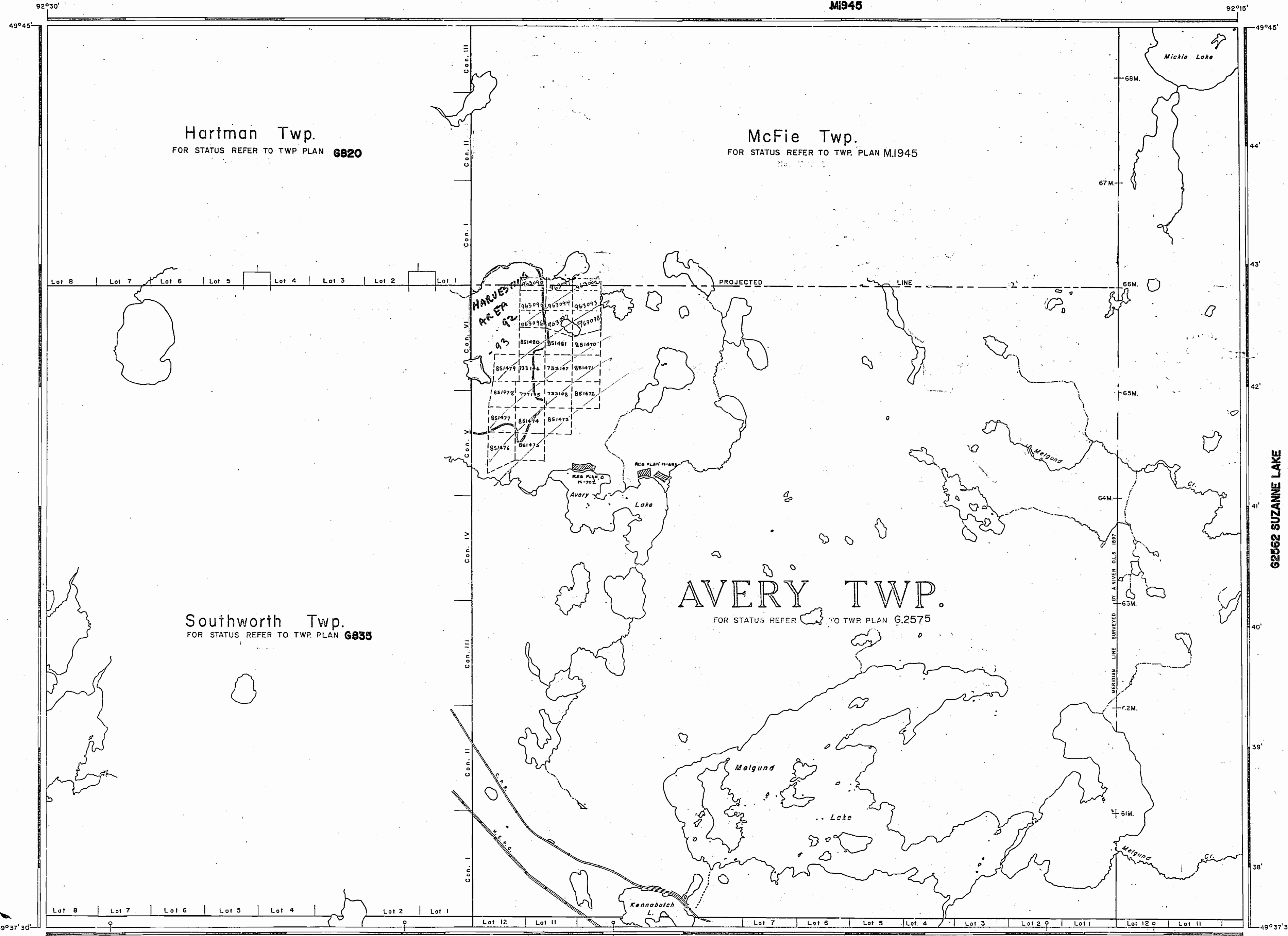

LEGEND

HIGHWAY AND ROUTE No.	
OTHER ROADS	
TRAILS	
SURVEYED LINES:	
TOWNSHIPS, BASE LINES, ETC.	
LOTS, MINING CLAIMS, PARCELS, ETC.	
UNSURVEYED LINES:	
LOT LINES	
PARCEL BOUNDARY	
MINING CLAIMS ETC.	
RAILWAY AND RIGHT OF WAY	
UTILITY LINES	
NON-PERENNIAL STREAM	
FLOODING OR FLOODING RIGHTS	
SUBDIVISION OR COMPOSITE PLAN	
RESERVATIONS, MINING RIGHTS	
ORIGINAL SHORELINE	
MARSH OR MUSKEG	
MINES	
TRAVERSE MONUMENT	

DISPOSITION OF CROWN LANDS

CROWN LANDS SALE	TYPE OF DOCUMENT	SYMBOL
PATENT, SURFACE & MINING RIGHTS		●
LEASE, SURFACE RIGHTS ONLY		○
MINING RIGHTS ONLY		○
LEASE, SURFACE & MINING RIGHTS		■
LEASE, SURFACE RIGHTS ONLY		■
LEASE, MINING RIGHTS ONLY		■
LICENCE OF OCCUPATION		▽
ORDER-IN-COUNCIL		OC
RESERVATION		○
CANCELLED		○
SAND & GRAVEL		○

NOTE: MINING RIGHTS IN PARCELS PATENTED PRIOR TO MAY 6, 1913, VESTED IN ORIGINAL PATENTEE BY THE PUBLIC LANDS ACT, R.S.O. 1970, CHAP. 380, SEC. 43, SUBSEC. 1.

REFERENCES

AREAS WITHDRAWN FROM DISPOSITION

M.R.O. - MINING RIGHTS ONLY
 S.R.O. - SURFACE RIGHTS ONLY
 M.+S. - MINING AND SURFACE RIGHTS

Description	Order No.	Date	Disposition	File

THE INFORMATION THAT APPEARS ON THIS MAP HAS BEEN COMPILED FROM VARIOUS SOURCES, AND ACCURACY IS NOT GUARANTEED. THOSE WISHING TO STAKE MINING CLAIMS SHOULD CONSULT WITH THE MINING RECORDER, MINISTRY OF NORTHERN DEVELOPMENT AND MINES, FOR ADDITIONAL INFORMATION ON THE STATUS OF THE LANDS SHOWN HEREON.

SCALE: 1 INCH = 40 CHAINS

FEET 0 1000 2000 4000 6000 8000
 METRES 0 200 1000 2000 (1 KM) (2 KM)

AREA MELGUND LAKE

M.N.R. ADMINISTRATIVE OFFICE
 DRYDEN
 MINING DIVISION

KENORA
 LAND TITLES / REGISTRY DIVISION
 KENORA

MINING DIVISION
 JUL 11 1994
 AM 7 8 9 10 11 12 1 2 3 4 5 6 PM

Ministry of Natural Resources Ontario
 Ministry of Northern Development and Mines

Date: FEBRUARY, 1984

M.2677
 G-2587

62587