

NOTES

400' surface rights reservation along the shores of all lakes and rivers.

Summer Resort Locations of Reg. plan SM.128 shown thus.

- ① File: 73000
- ② M.T.C. P.11256
- ③ " " 1376
- ④ Gravel P.I.P.-2485-1

2068

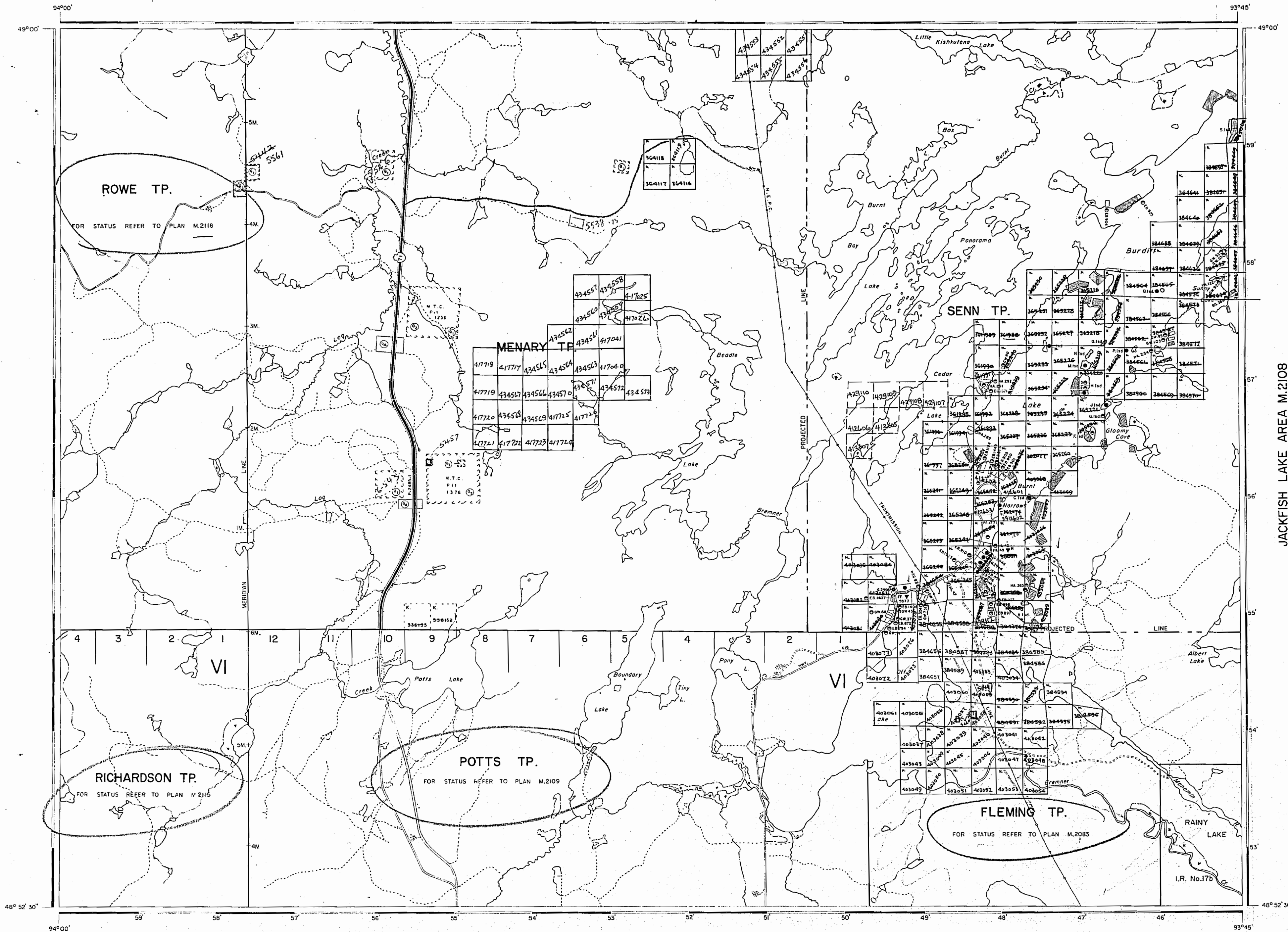

June 25/73

KENORA  
MINING DIV.  
**RECEIVED**  
JUN 25 1973  
AM 7:18.10.11.12.1.3.4.5.6 PM

7/12/73  
April 4 1974  
April 11 1974

LEGEND

- HIGHWAY AND ROUTE NO.
- OTHER ROADS
- TRAILS
- SURVEYED LINES:
  - TOWNSHIPS, BASE LINES, ETC.
  - LOTS, MINING CLAIMS, PARCELS, ETC.
- UNSURVEYED LINES:
  - LOT LINES
  - PARCEL BOUNDARY
  - MINING CLAIMS ETC.
- RAILWAY AND RIGHT OF WAY
- UTILITY LINES
- NON-PERENNIAL STREAM
- FLOODING OR FLOODING RIGHTS
- SUBDIVISION
- ORIGINAL SHORELINE
- MARSH OR MUSKEG
- MINES

DISPOSITION OF CROWN LANDS

TYPE OF DOCUMENT	SYMBOL
PATENT, SURFACE & MINING RIGHTS	
" SURFACE RIGHTS ONLY	
" MINING RIGHTS ONLY	
LEASE, SURFACE & MINING RIGHTS	
" SURFACE RIGHTS ONLY	
" MINING RIGHTS ONLY	
LICENCE OF OCCUPATION	
CROWN LAND SALE	
ORDER-IN-COUNCIL	
RESERVATION	
CANCELLED	
SAND & GRAVEL	

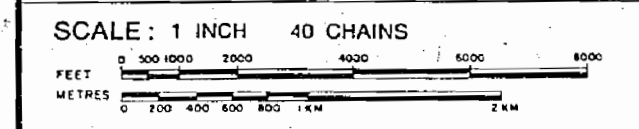

ACRES	HECTARES
40	16

AREA  
**BEADLE LAKE**  
DISTRICT  
RAINY RIVER  
MINING DIVISION  
KENORA

Ministry of Natural Resources  
Ontario Surveys and Mapping Branch  
Date MAR 28, 73 Plan No.  
National Topographical Series 52C13  
**M.2068**

JACKFISH LAKE AREA M.2108

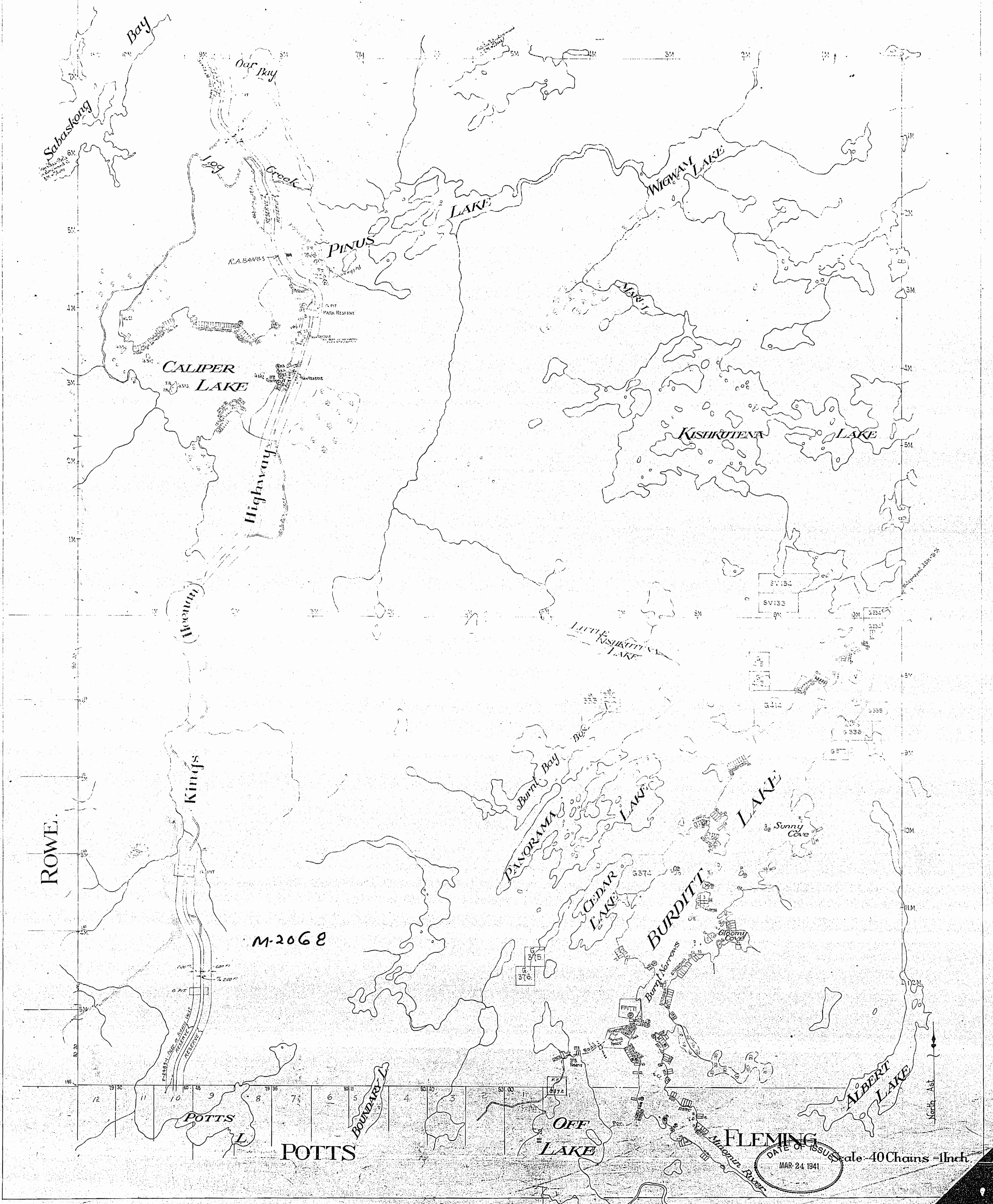

ROWE

M-2068

DATE OF ISSUE  
 MAR 24 1941  
 Scale - 40 Chains = 1 inch.

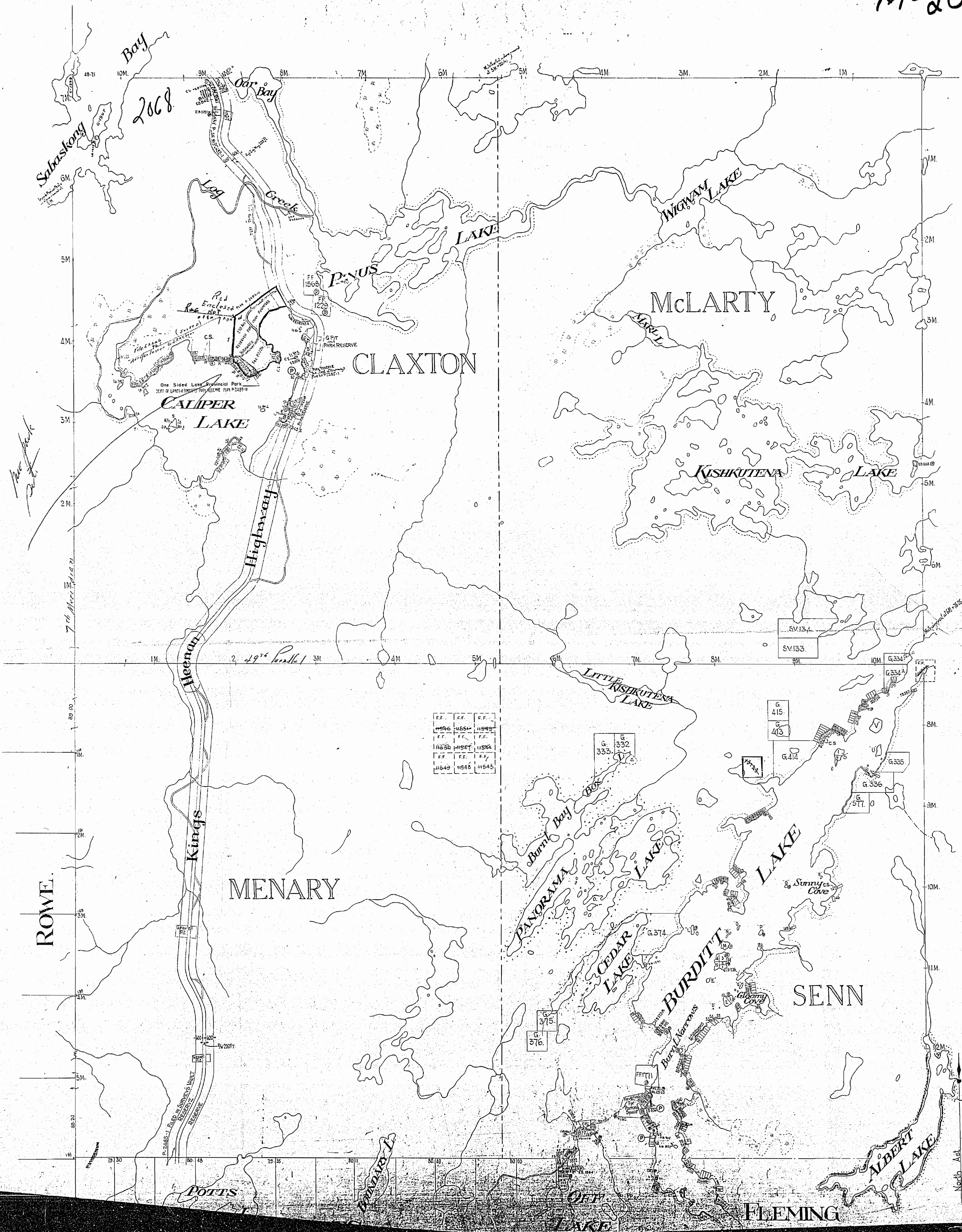

RECEIVED  
 JUN 5 1958  
 FORT FRANCES  
 ARMED DIVISION

2068

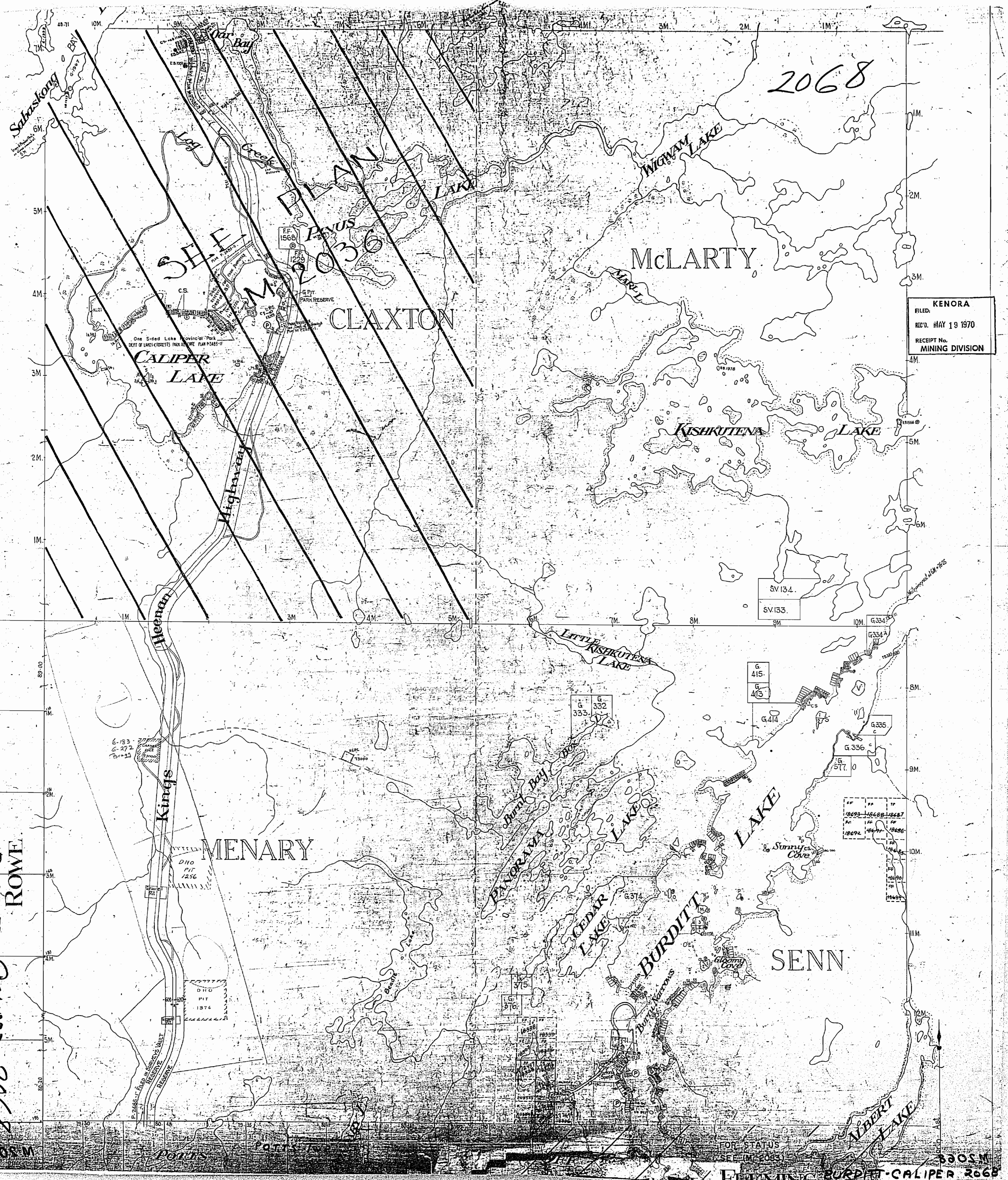

KENORA  
 FILED:  
 REC'D. MAY 19 1970  
 RECEIPT No.  
 MINING DIVISION

BURDITT-  
 CALIPER  
 2068

FOR STATUS  
 SEE (M. 2068)  
 BURDITT-CALIPER 2068

2068

M. 2068

ONTARIO DEPARTMENT OF MINES AND NORTHERN AFFAIRS

NATIONAL TOPOGRAPHIC SERIES 52C13

KENORA MINING DIVISION

Saskatchewan Bay

Bay

Mr. Bay

CLAXTON

McLARTY

Refer to M. 2036  
New Pines Lake & Claxton Twp

CALIPER LAKE

KISHKUTENA LAKE

Heenan Highway

LITTLE KISHKUTENA LAKE

ROWE

MENARY

PANORAMA LAKE

BURDITT LAKE

SENN

POTTS

POTTS TWP

FOR STATUS SEE (M. 2083)

FLEMING

ALBERT LAKE

KENORA FILED  
REC'D. JUN 14 1971  
RECEIPT No. MINING DIVISION

Oct. 13/71  
June 19/72  
Sept. 11/72  
Nov. 10/72  
Feb. 21/73

2068

2068

2068

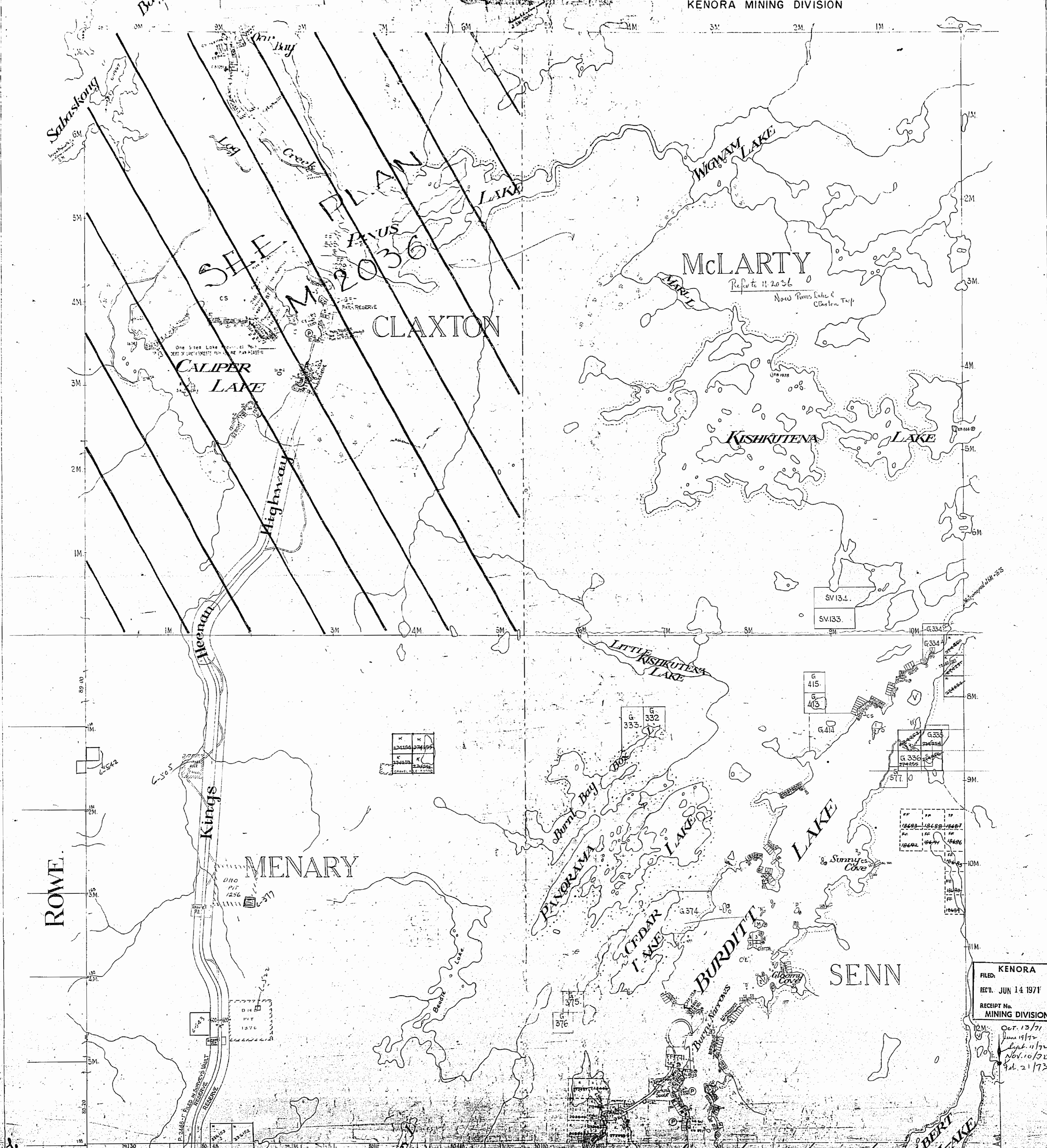

2068

Bay

Saskatchewan

Loa

Creek

LAKE

WIGNAM LAKE

SEE PLAN

M. 2036

McLARTY

Refer to M. 2036  
New Pines Lake & Claxton Twp

CLAXTON

CALIPER LAKE

KISHKUTENA LAKE

Heenan Highway

LITTLE KISHKUTENA LAKE

ROWE

MENARY

PANORAMA LAKE

CEDAR LAKE

BURDITT LAKE

SENN

Kings

Burnt Bay

Sunny's Cove

POTTS

POTTS TWP

FOR STATUS SEE (M. 2083)

FLEMING

ALBERT LAKE

FILED KENORA  
REC'D JUN 14 1971  
RECEIPT NO. MINING DIVISION

OCT. 13/71  
JUNE 19/72  
SEPT. 11/72  
NOV. 10/72  
M. 21/73

2068

19902

508205 M

508205 M











**INDEX TO LAND DISPOSITION**

PLAN  
 G-3819  
 TOWNSHIP

**MENARY**

DATE OF ISSUE  
 DEC 11 1997  
 PROVINCIAL RECORDING  
 OFFICE - SUDBURY

M.N.R. ADMINISTRATIVE DISTRICT  
 FORT FRANCES  
 MINING DIVISION  
 KENORA  
 LAND TITLES/REGISTRY DIVISION  
 RAINY RIVER

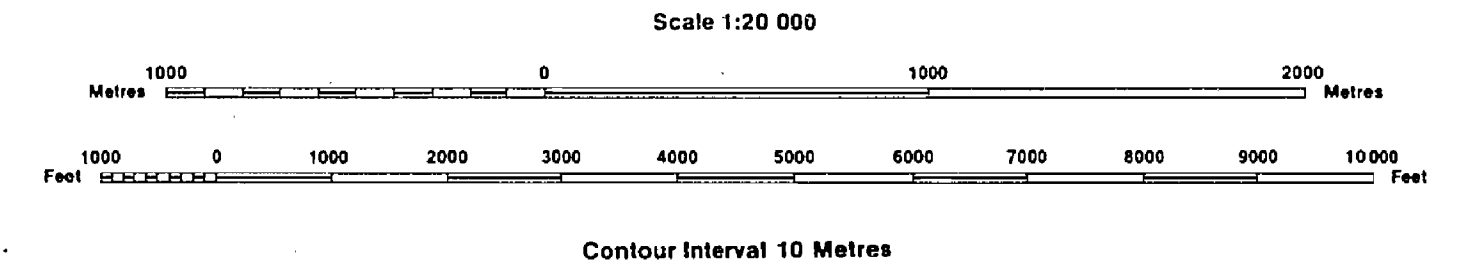

**AREAS WITHDRAWN FROM DISPOSITION**

MRO - Mining Rights Only  
 SRO - Surface Rights Only  
 M + S - Mining and Surface Rights

**SYMBOLS**

Description	Order No.	Date	Disposition	File
Boundary				
Township, Meridian, Baseline				
Road allowance; surveyed				
shoreline				
Lot/Concession; surveyed				
unsurveyed				
Parcel; surveyed				
unsurveyed				
Right-of-way; road				
railway				
utility				
Reservation				
Cliff, Pit, Pile				
Contour				
Interpolated				
Approximate				
Depression				
Control point (horizontal)				
Flooded land				
Mine head frame				
Pipeline (above ground)				
Railway; single track				
double track				
abandoned				
Road; highway, county, township				
access				
trail, bush				
Shoreline (original)				
Transmission line				
Wooded area				

SECTION 35 W-K-24/97 24/10/97 M+S 195150

**DISPOSITION OF CROWN LANDS**

Patent	
Surface & Mining Rights	●
Surface Rights Only	○
Mining Rights Only	○
Lease	
Surface & Mining Rights	■
Surface Rights Only	□
Mining Rights Only	□
Licence of Occupation	▼
Order-in-Council	OC
Cancelled	○
Reservation	○
Sand & Gravel	○

EFFECTIVE DATE →

THE INFORMATION THAT APPEARS ON THIS MAP HAS BEEN COMPILED FROM VARIOUS SOURCES, AND ACCURACY IS NOT GUARANTEED. THOSE WISHING TO STAKE MINING CLAIMS SHOULD CONSULT WITH THE MINING RECORDER, MINISTRY OF NORTHERN DEVELOPMENT AND MINES, FOR ADDITIONAL INFORMATION ON THE STATUS OF THE LANDS SHOWN HEREON.

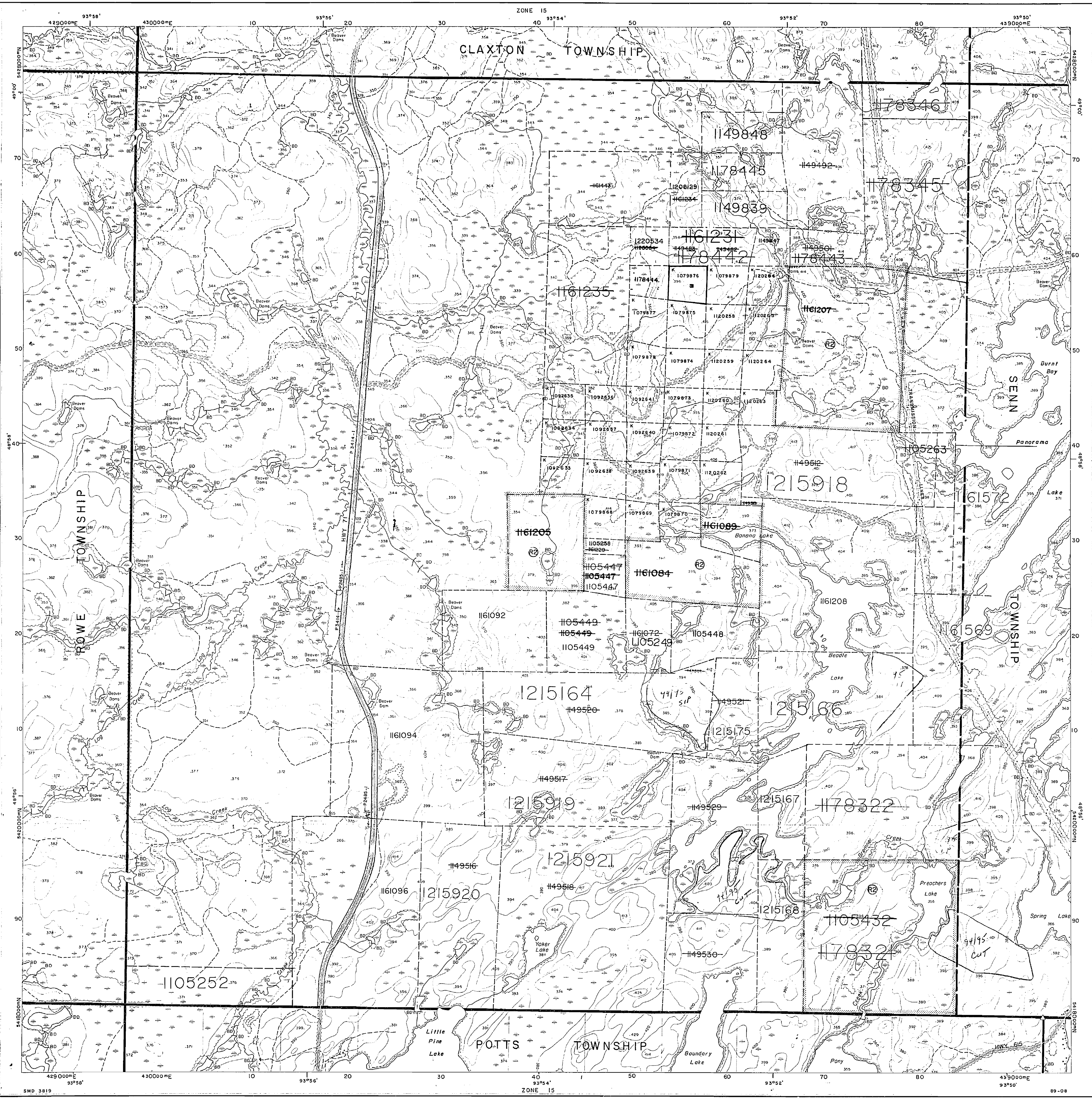

8902-W

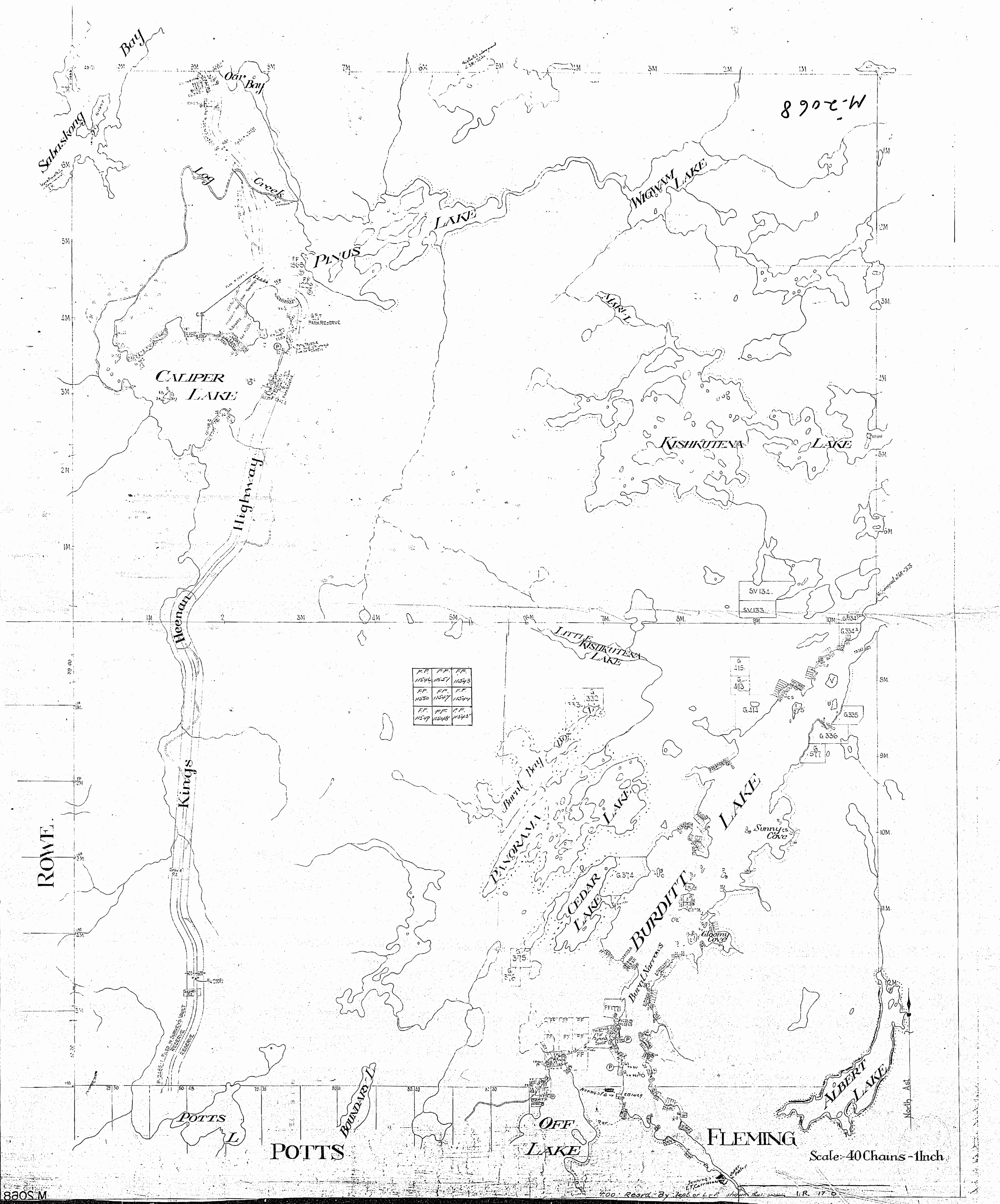

8805.M

100. Resd. By 1906 or 1907 when this was I.R. 17.0

PRINT 2068





**INDEX TO LAND DISPOSITION**

PLAN  
 G-3819  
 TOWNSHIP

M.N.R. ADMINISTRATIVE DISTRICT  
 FORT FRANCES  
 MINING DIVISION  
 KENORA  
 LAND TITLES/REGISTRY DIVISION  
 RAINY RIVER

**MENARY**

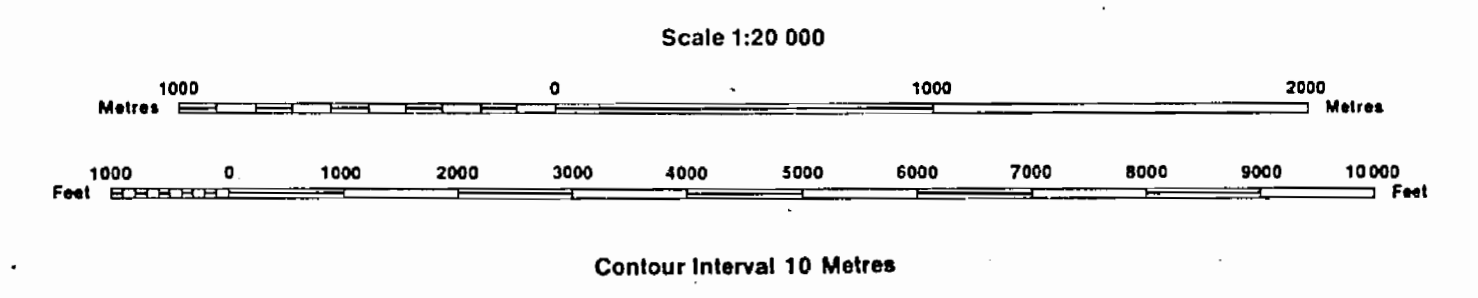

**AREAS WITHDRAWN FROM DISPOSITION**

MRO - Mining Rights Only  
 SRO - Surface Rights Only  
 M+S - Mining and Surface Rights

**SYMBOLS**

Description	Order No.	Date	Disposition	File
Boundary				
Township, Meridian, Baseline				
Road allowance; surveyed				
shoreline				
Lot/Concession; surveyed				
unsurveyed				
Parcel; surveyed				
unsurveyed				
Right-of-way; road				
railway				
utility				
Reservation				
Cliff, Pit, Pile				
Contour				
Interpolated				
Approximate				
Depression				
Control point (horizontal)				
Flooded land				
Mine head frame				
Pipeline (above ground)				
Railway; single track				
double track				
abandoned				
Road; highway, county, township				
access				
trail, bush				
Shoreline (original)				
Transmission line				
Wooded area				

SECTION 35 W-K-24/97 24/10/97 M+S 195150

**DATE OF ISSUE**

NOV 24 1997  
 PROVINCIAL RECORDING  
 OFFICE - SUDBURY

**DISPOSITION OF CROWN LANDS**

Patent	
Surface & Mining Rights	●
Surface Rights Only	○
Mining Rights Only	○
Lease	
Surface & Mining Rights	■
Surface Rights Only	■
Mining Rights Only	■
Licence of Occupation	▼
Order-in-Council	OC
Cancelled	○
Reservation	○
Sand & Gravel	○

THE INFORMATION THAT APPEARS ON THIS MAP HAS BEEN COMPILED FROM VARIOUS SOURCES, AND ACCURACY IS NOT GUARANTEED. THOSE WISHING TO STAKE MINING CLAIMS SHOULD CONSULT WITH THE MINING RECORDER, MINISTRY OF NORTHERN DEVELOPMENT AND MINES, FOR ADDITIONAL INFORMATION ON THE STATUS OF THE LANDS SHOWN HEREON.

EFFECTIVE DATE

