

MULDREW TWP.

SUDBURY MINING DIVISION
 DISTRICT OF SUDBURY.

SUDBURY MINING DIV.
 RECEIVED
 DEC 23 1970
 A.M. 7,8,9,10,11,12,1,2,3,4,5,6
 P.M. 7,8,9,10,11,12,1,2,3,4,5,6

— Scale, 40 chains to an inch. —

M.876

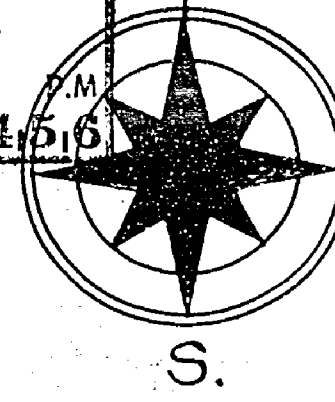

NOTE
 400' Surface Rights Reservation
 around all Lakes and Rivers.

DUBLIN TWP.

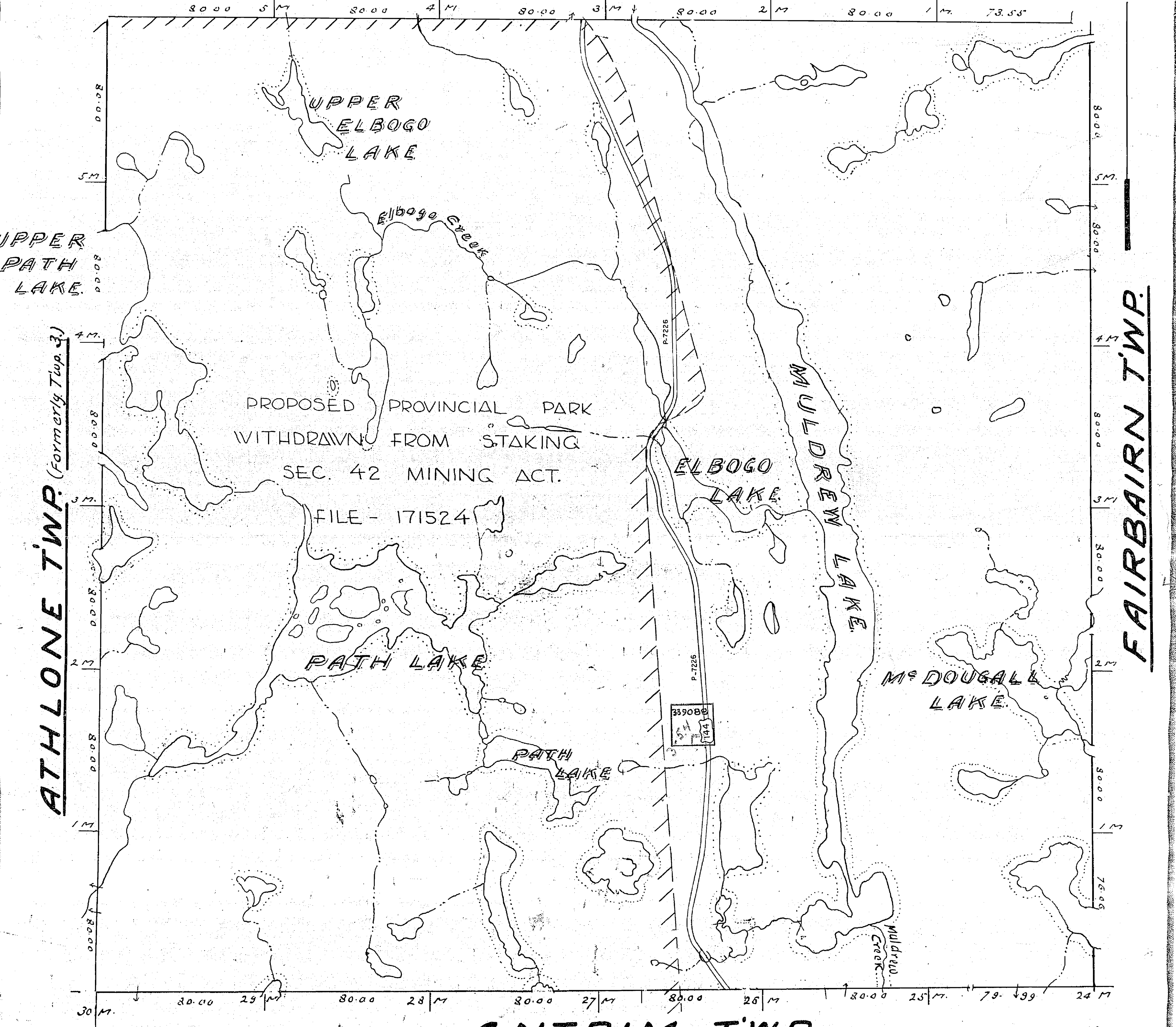

ATHLONE TWP. (Formerly Twp. 3)
 ANTRIM TWP.

FAIRBAIRN TWP.

Notes:
 Railways shown thus
 Paved Highways
 Gravel Highway Route Nos
 Other Roads
 Trails & Paths
 Telephone & Telegraph Lines
 Electric Power Lines

Non-perennial streams
 Bridges
 Buildings
 Swamps
 Areas marked (P) are Patented
 (L) Leased
 (A) Held under License of Occupation

876

M876

OFFICE USE ONLY

DUBLIN TP. M-767

NOTES

400' surface rights reservation along the shores of all lakes and rivers.



ATHLONE TP. M-638

FAIRBAIRN TP. M-797

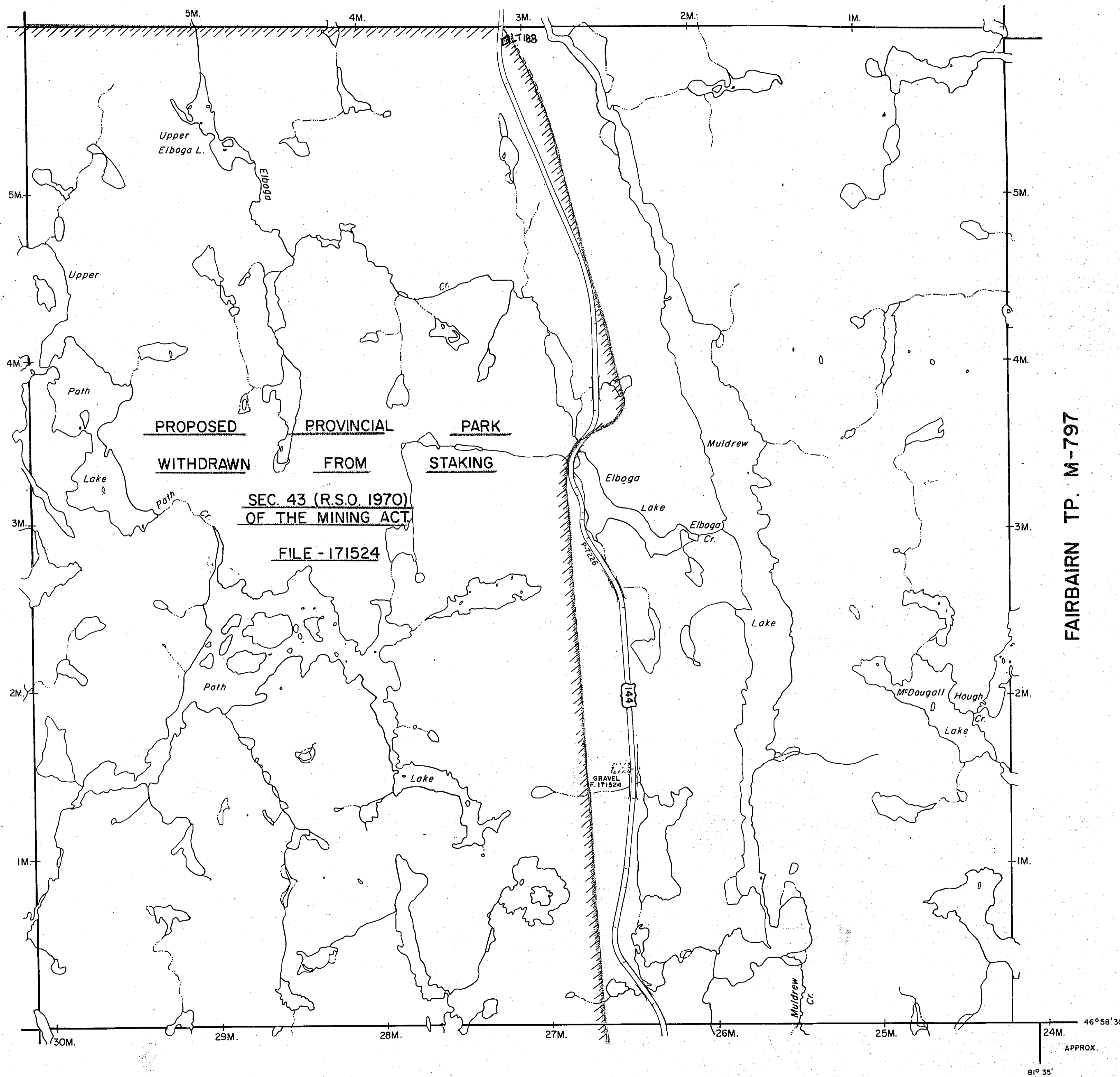

ANTRIM TP. M-631

LEGEND

- PATENTED LAND (P or *)
- PATENTED FOR SURFACE RIGHTS ONLY (L)
- LEASE (L)
- LICENSE OF OCCUPATION (L.O.)
- CROWN LAND SALES (C.S.)
- LOCATED LAND (Loc.)
- CANCELLED (C.)
- MINING RIGHTS ONLY (M.R.O.)
- SURFACE RIGHTS ONLY (S.R.O.)
- HIGHWAY & ROUTE NO. (17)
- ROADS (—)
- TRAILS (---)
- RAILWAYS (—+—)
- POWER LINES (—+—)
- MARSH OR MUSKEG (—+—)
- MINES (X)

*used only with summer resort locations or when space is limited

TOWNSHIP OF

MULDREW

DISTRICT OF
SUDBURY

SUDBURY
MINING DIVISION

SCALE : 1 INCH = 40 CHAINS (1/2 MILE)

DR. R.W. NOBLE
DATE APRIL 20, 72.

PLAN NO. **M-876**

ONTARIO
MINISTRY OF NATURAL RESOURCES

SURVEYS AND MAPPING BRANCH

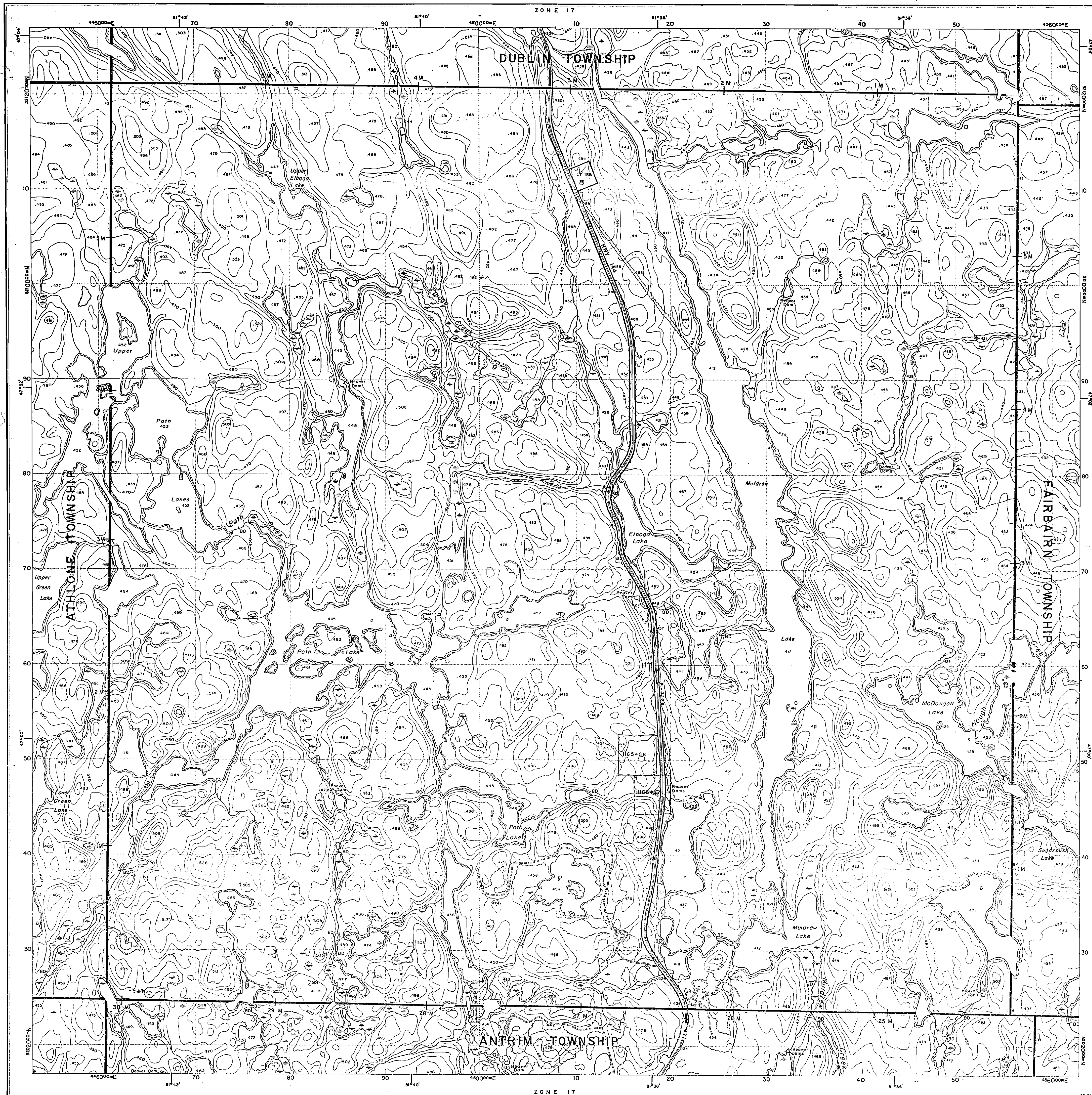

In Service: March 30, 1968

INDEX TO LAND DISPOSITION

PLAN
 G-4089
 TOWNSHIP

M.N.R. ADMINISTRATIVE DISTRICT
 SUDBURY
 MINING DIVISION
 SUDBURY
 LAND TITLES/REGISTRY DIVISION
 SUDBURY

MULDREW

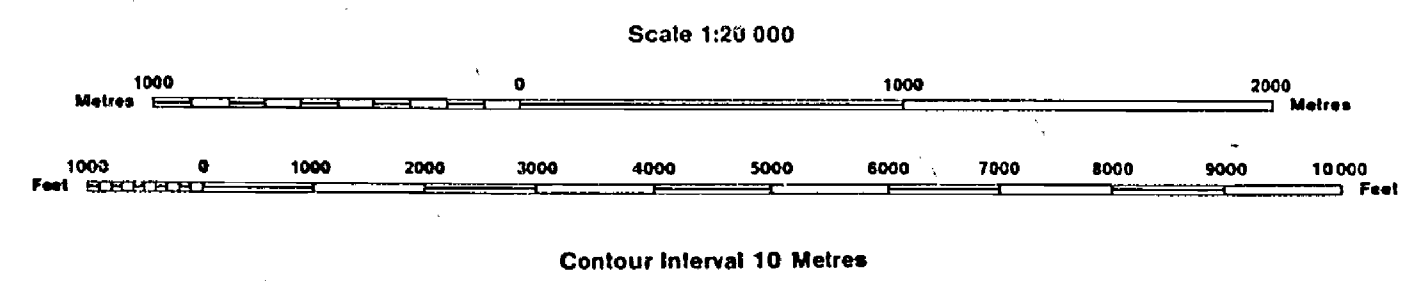

AREAS WITHDRAWN FROM DISPOSITION

- MRO - Mining Rights Only
- SRO - Surface Rights Only
- M + S - Mining and Surface Rights

SYMBOLS

Description	Order No.	Date	Disposition	File
Boundary				
Township, Meridian, Baseline				
Road allowance; surveyed				
shoreline				
Lot/Concession; surveyed				
unsurveyed				
Parcel; surveyed				
unsurveyed				
Right-of-way; road				
railway				
utility				
Reservation				
Cliff, Pit, Pile				
Contour				
Interpolated				
Approximate				
Depression				
Control point (horizontal)				
Flooded land				
Mine head frame				
Pipeline (above ground)				
Railway; single track				
double track				
abandoned				
Road; highway, county, township				
access				
trail, bush				
Shoreline (original)				
Transmission line				
Wooded area				

DATE OF ISSUE
 1968
 SUDBURY
 MINING RECORDER'S OFFICE

DISPOSITION OF CROWN LANDS

Patent	
Surface & Mining Rights	○
Surface Rights Only	○
Mining Rights Only	○
Lease	
Surface & Mining Rights	■
Surface Rights Only	■
Mining Rights Only	■
Licence of Occupation	□
Order-in-Council	OC
Cancelled	○
Reservation	○
Sand & Gravel	○

THE INFORMATION THAT
 APPEARS ON THIS MAP
 HAS BEEN COMPILED
 FROM VARIOUS SOURCES,
 AND ACCURACY IS NOT
 GUARANTEED. THOSE
 WISHING TO STAKE
 MINING CLAIMS SHOULD
 CONSULT WITH THE
 MINING RECORDER,
 MINISTRY OF
 NORTHERN DEVELOPMENT
 AND MINES, FOR
 ADDITIONAL INFORMATION
 ON THE STATUS OF THE
 LANDS SHOWN HEREON.

DATE OF ISSUE
 MAR 30 1968
 SUDBURY
 MINING RECORDER'S OFFICE

G-4089 MULDREW TOWNSHIP G-4089

INDEX TO LAND DISPOSITION

PLAN
G-4089
TOWNSHIP

M.N.R. ADMINISTRATIVE DISTRICT
SUDBURY
MINING DIVISION
SUDBURY
LAND TITLES/REGISTRY DIVISION
SUDBURY

MULDREW

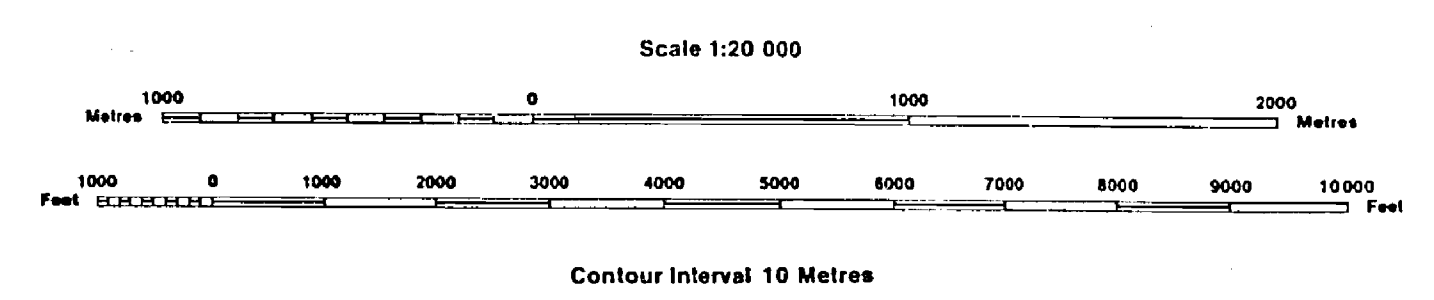

AREAS WITHDRAWN FROM DISPOSITION

- MRO - Mining Rights Only
- SRO - Surface Rights Only
- M+S - Mining and Surface Rights

SYMBOLS

Description	Order No.	Date	Disposition	File
Boundary				
Township, Meridian, Baseline				
Road allowance; surveyed				
shoreline				
Lot/Concession; surveyed				
unsurveyed				
Parcel; surveyed				
unsurveyed				
Right-of-way; road				
railway				
utility				
Reservation				
Chff, Pit, Pile				
Contour				
Interpolated				
Approximate				
Depression				
Control point (horizontal)				
Flooded land				
Mine head frame				
Pipeline (above ground)				
Railway; single track				
double track				
abandoned				
Road; highway, county, township				
access				
trail, bush				
Shoreline (original)				
Transmission line				
Wooded area				
REMOTE TOURIST SET-UP				

DISPOSITION OF CROWN LANDS

Patent	
Surface & Mining Rights	⊙
Surface Rights Only	⊙
Mining Rights Only	⊙
Lease	
Surface & Mining Rights	⊠
Surface Rights Only	⊠
Mining Rights Only	⊠
Licence of Occupation	▽
Order-in-Council	OC
Cancelled	⊙
Reservation	⊙
Sand & Gravel	⊙

THE INFORMATION THAT APPEARS ON THIS MAP HAS BEEN COMPILED FROM VARIOUS SOURCES, AND ACCURACY IS NOT GUARANTEED. THOSE WISHING TO STAKE MINING CLAIMS SHOULD CONSULT WITH THE MINING RECORDER, MINISTRY OF NORTHERN DEVELOPMENT AND MINES, FOR ADDITIONAL INFORMATION ON THE STATUS OF THE LANDS SHOWN HEREON.

DATE OF ISSUE
MAR 30 1988
SUDBURY
MINING RECORDER'S OFFICE

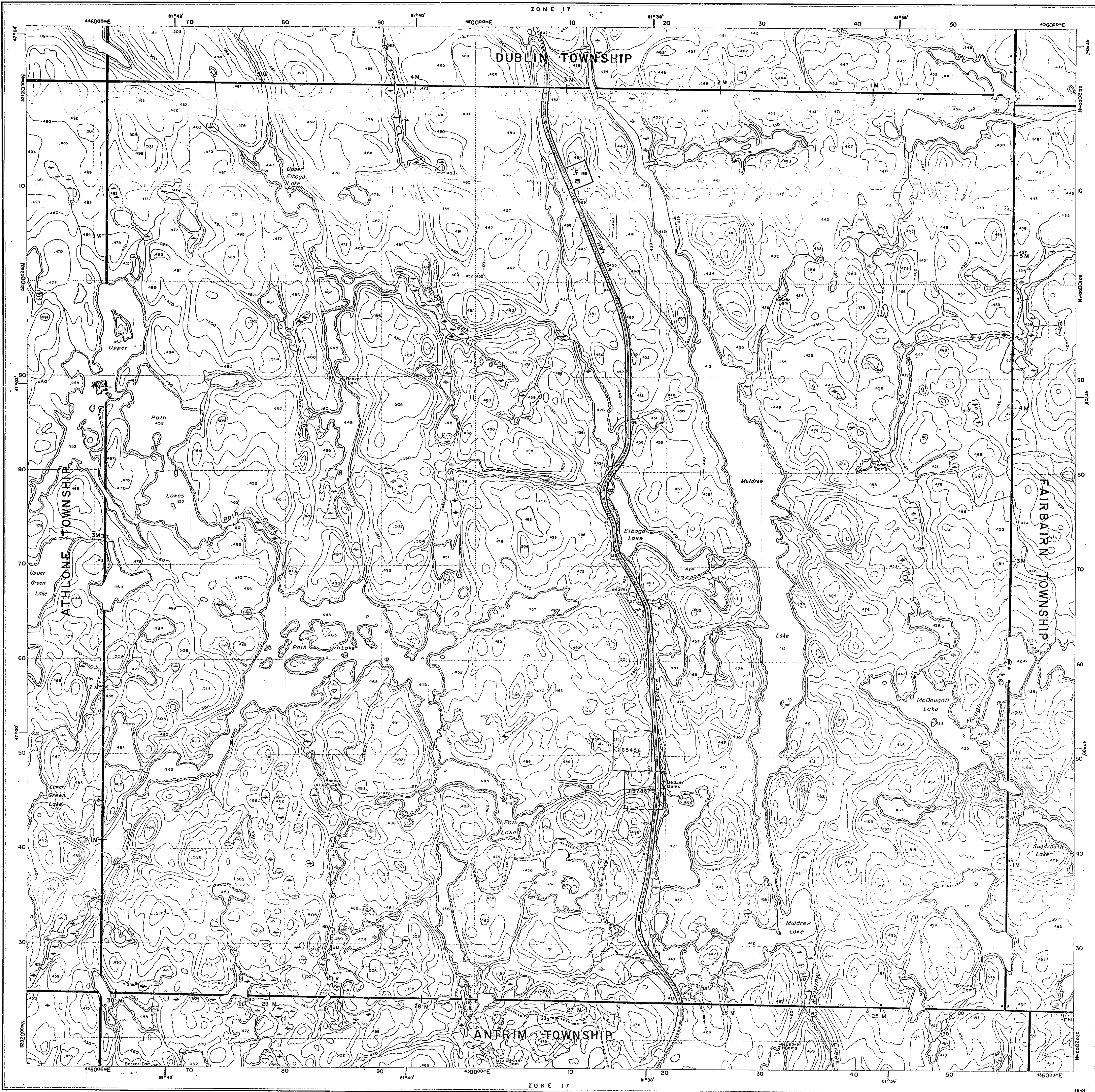

DUBLIN TP. M-767

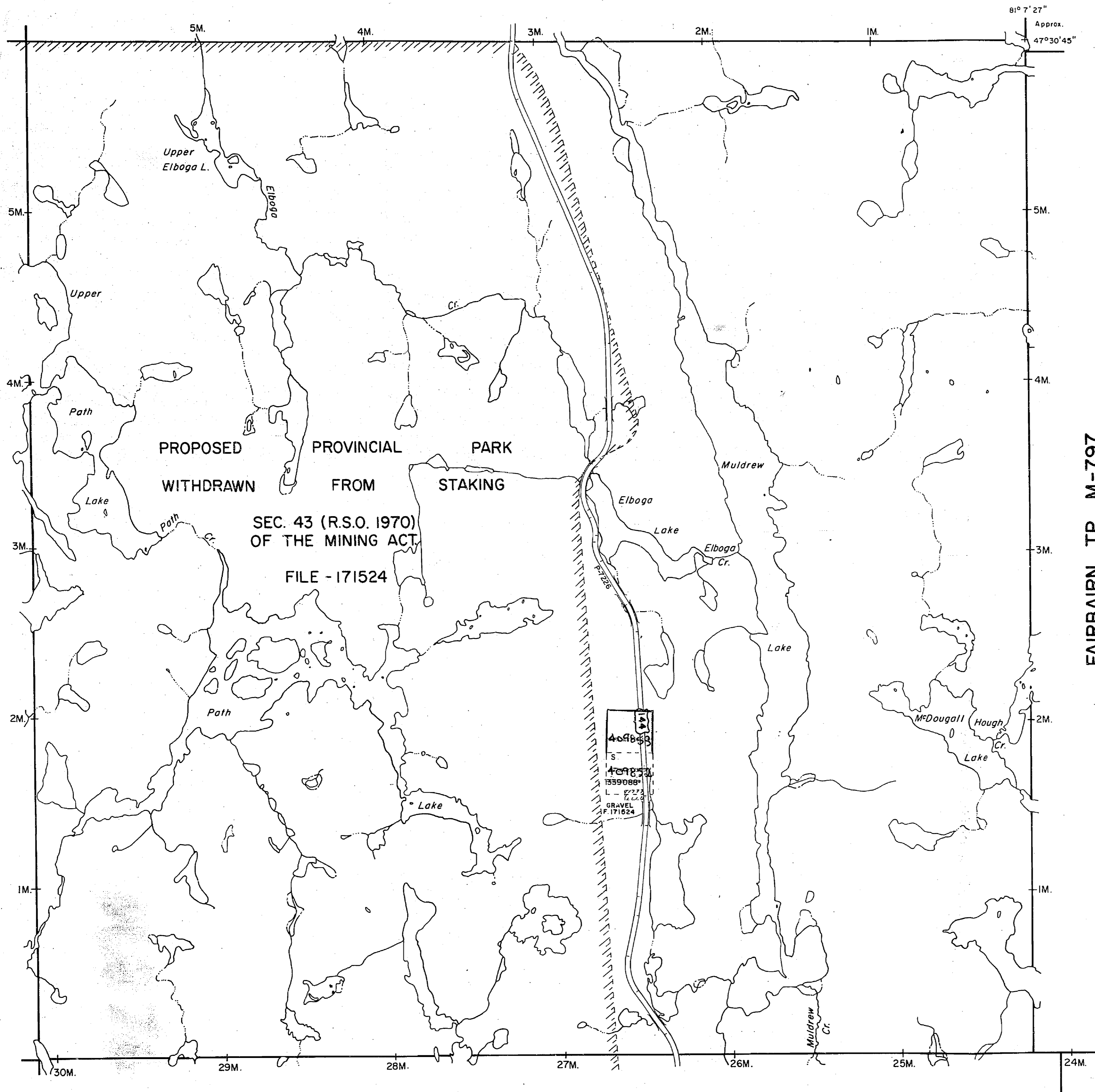

NOTES

400' surface rights reservation along the shores of all lakes and rivers.

(Surface and mining rights 1/2 mile on each side of right-of-way of Hwy. 144 are reserved for staking)

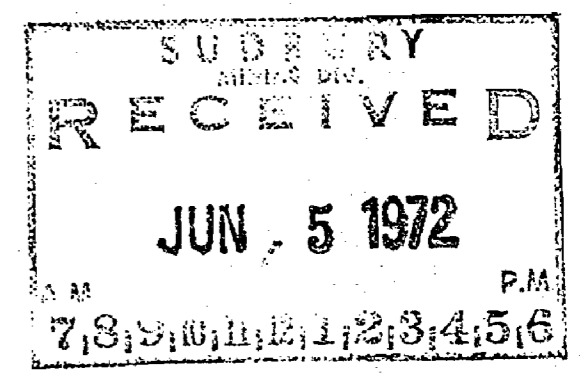

LEGEND

- PATENTED LAND (P or *)
- PATENTED FOR SURFACE RIGHTS ONLY (L)
- LEASE (C)
- LICENSE OF OCCUPATION (L.O.)
- CROWN LAND SALES (C.S.)
- LOCATED LAND (Loc.)
- CANCELLED (C)
- MINING RIGHTS ONLY (M.R.O.)
- SURFACE RIGHTS ONLY (S.R.O.)
- HIGHWAY & ROUTE NO. (7)
- ROADS (—)
- TRAILS (---)
- RAILWAYS (—+—)
- POWER LINES (—+—+—)
- MARSH OR MUSKEG (wavy lines)
- MINES (X)

TOWNSHIP OF
MULDREW
DISTRICT OF
SUDBURY

SUDBURY
MINING DIVISION

SCALE : 1 INCH = 40 CHAINS (1/2 MILE)

DR. R.W. NOBLE
DATE APRIL 20, 72
PLAN NO. **M-876**

ONTARIO
DEPARTMENT OF MINES
AND NORTHERN AFFAIRS

ATHLONE TP. M-638

FAIRBAIRN TP. M-797

ANTRIM TP. M-631

876

DUBLIN TP. M-767

61° 7' 27" Approx. 47° 30' 45"

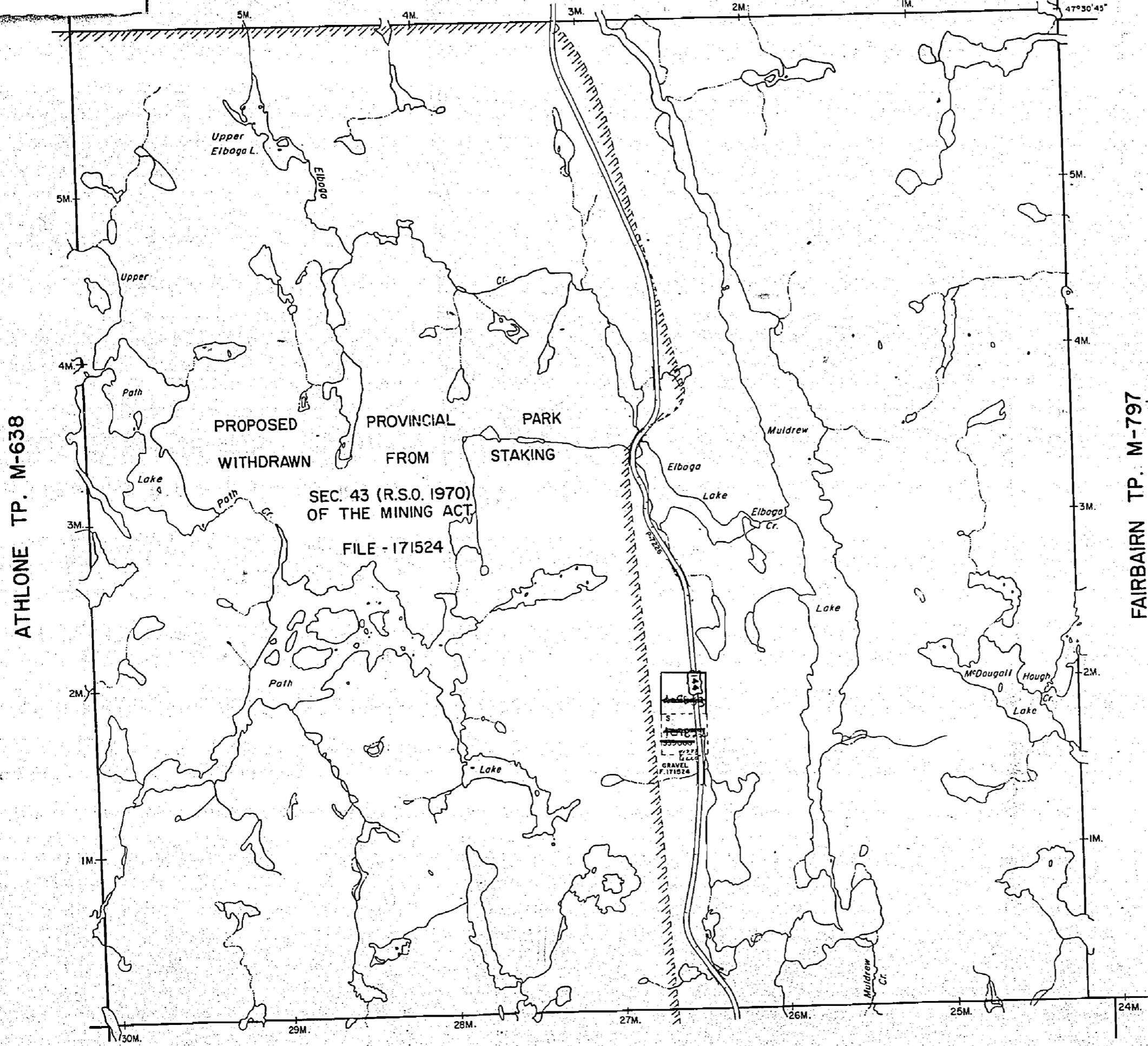

ATHLONE TP. M-638

FAIRBAIRN TP. M-797

ANTRIM TP. M-631

NOTES

400' surface rights reservation along the shores of all lakes and rivers.

(Surface and mining rights 1/2 mile on each side of right-of-way of Hwy. 144 are Reopened for staking.)

SUBURBY
RECEIVED
JUN 5 1972
7,8,9,10,11,12,13,14,15,16

LEGEND

- PATENTED LAND (P or ●)
- PATENTED FOR SURFACE RIGHTS ONLY (●)
- LEASE (○)
- LICENSE OF OCCUPATION (L.O.)
- CROWN LAND SALES (C.S.)
- LOCATED LAND (Loc.)
- CANCELLED (C.)
- MINING RIGHTS ONLY (M.R.O.)
- SURFACE RIGHTS ONLY (S.R.O.)
- HIGHWAY & ROUTE NO. (17)
- ROADS (—)
- TRAILS (---)
- RAILWAYS (—+—)
- POWER LINES (—)
- MARSH OR MUSKEG (—)
- MINES (X)

TOWNSHIP OF
MULDREW
DISTRICT OF
SUDBURY

SUDBURY MINING DIVISION

SCALE : 1 INCH = 40 CHAINS (1/2 MILE)

DR. R.W. NOBLE
DATE APRIL 20, 72. PLAN NO. **M-876**

ONTARIO
DEPARTMENT OF MINES
AND NORTHERN AFFAIRS

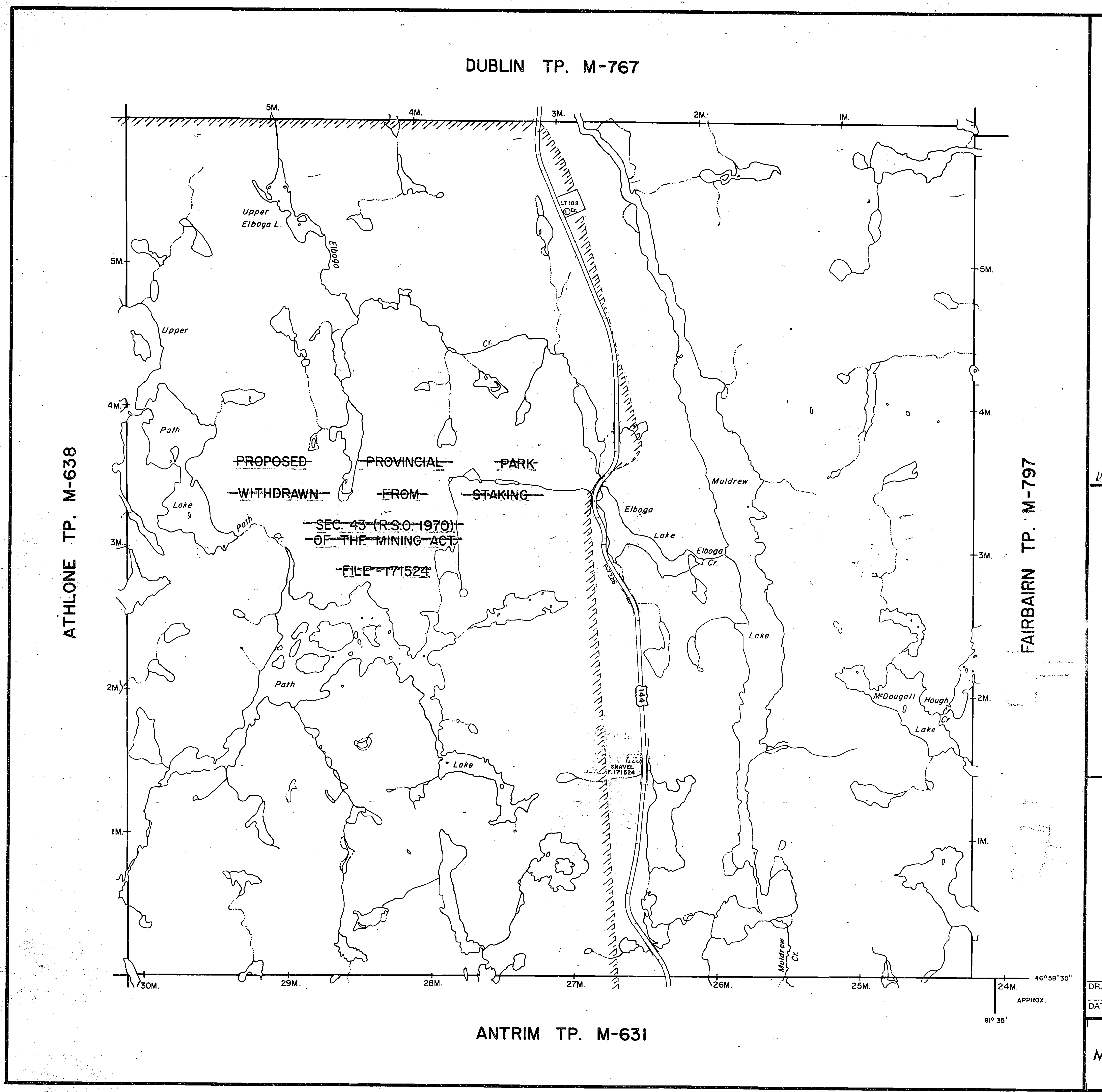

NOTES

400' surface rights reservation along the shores of all lakes and rivers.

No. 0-21/85-NER

LEGEND

PATENTED LAND	(P) or *
PATENTED FOR SURFACE RIGHTS ONLY	(P) or *
LEASE	(L)
LICENSE OF OCCUPATION	(L.O.)
CROWN LAND SALES	(C.S.)
LOCATED LAND	(Loc.)
CANCELLED	(C.)
SURFACE RIGHTS ONLY	(M.R.O.)
HIGHWAY & ROUTE NO.	(S.R.O.)
ROADS	(Road symbol)
TRAILS	(Trail symbol)
RAILWAYS	(Railway symbol)
POWER LINES	(Power line symbol)
MARSH OR MUSKEG	(Marsh symbol)
MINES	(Mines symbol)

*used only with summer resort locations or when space is limited

TOWNSHIP OF
MULDREW
 DISTRICT OF
 SUDBURY
 SUDBURY
 MINING DIVISION
 SCALE : 1 INCH -- 40 CHAINS (1/2 MILE)

DR. R.W. NOBLE
 DATE APRIL 20, 72
 PLAN NO. **M-876**

ONTARIO
 MINISTRY OF NATURAL RESOURCES
 SURVEYS AND MAPPING BRANCH

M-876

MULDREW TP.

M-876

M-876

MULDREW TP.

M-876

876

PLAN OF MULDREW TWP.

SUDBURY MINING DIVISION DISTRICT OF SUDBURY.

SUDBURY
MINING DIV.
RECEIVED
DEC 23 1970
A.M. 7,8,9,10,11,12,1,2,3,4,5,6,7,8
W.

— Scale, 40 chains to an inch. —

M.876

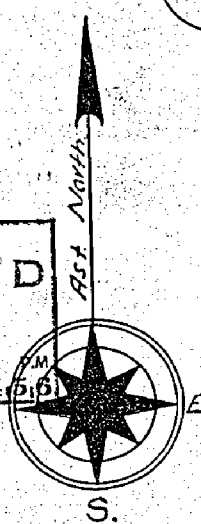

NOTE
400' Surface Rights Reservation
around all Lakes and Rivers.

DUBLIN TWP.

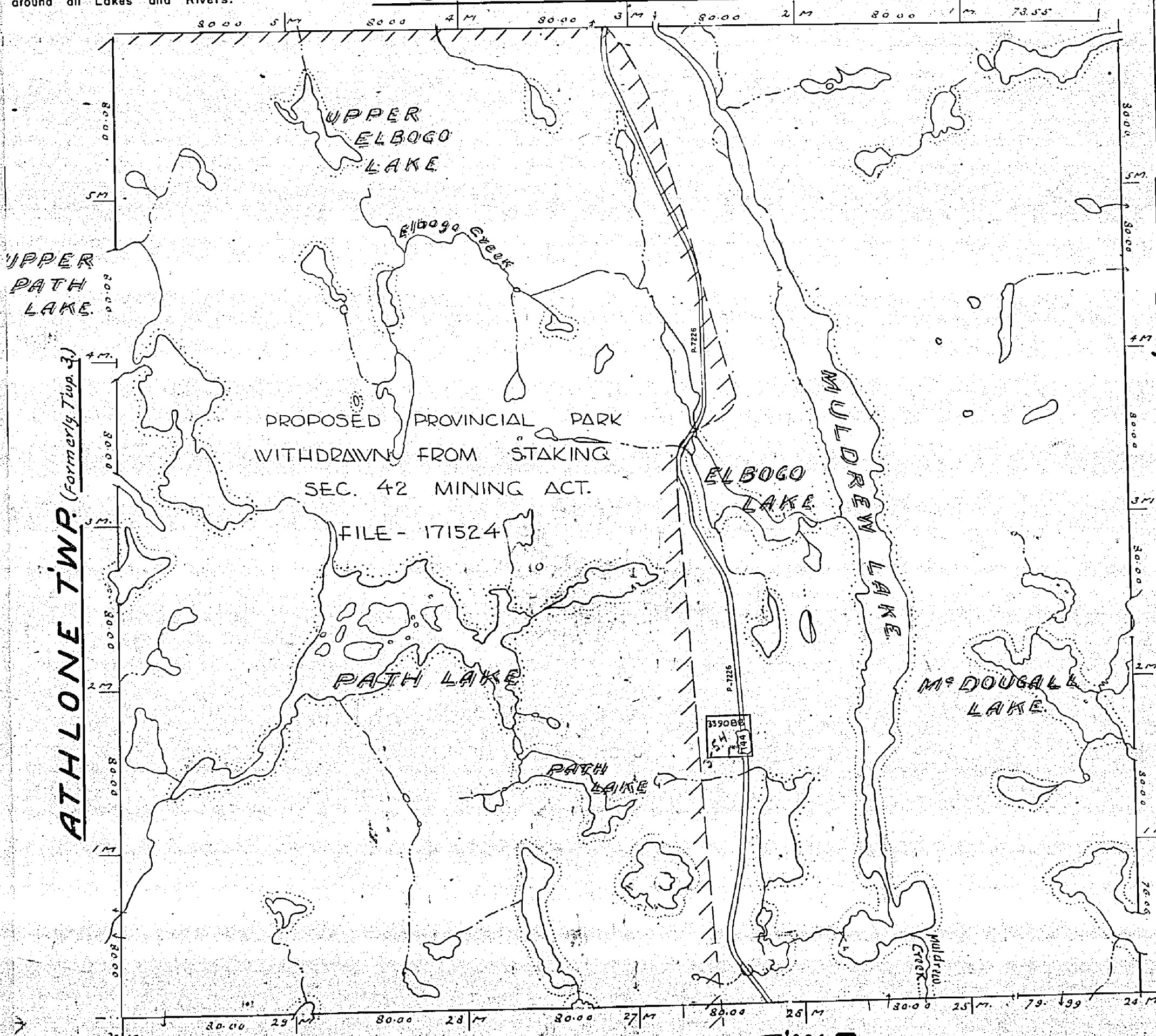

ATHLONE TWP. (Formerly Twp. 3)

FAIRBAIRN TWP.

ANTRIM TWP.

- | | | |
|--|---|---|
| <p>Notes.</p> <ul style="list-style-type: none"> Railways shown thus Paved Highways Gravel Highway Route No. Other Roads Trails Power Lines Telephone & Telegraph Lines | <ul style="list-style-type: none"> Non-perennial streams Bridges Barrages Swamp Areas marked | <ul style="list-style-type: none"> Patented Leased License of Occupation |
|--|---|---|

M876

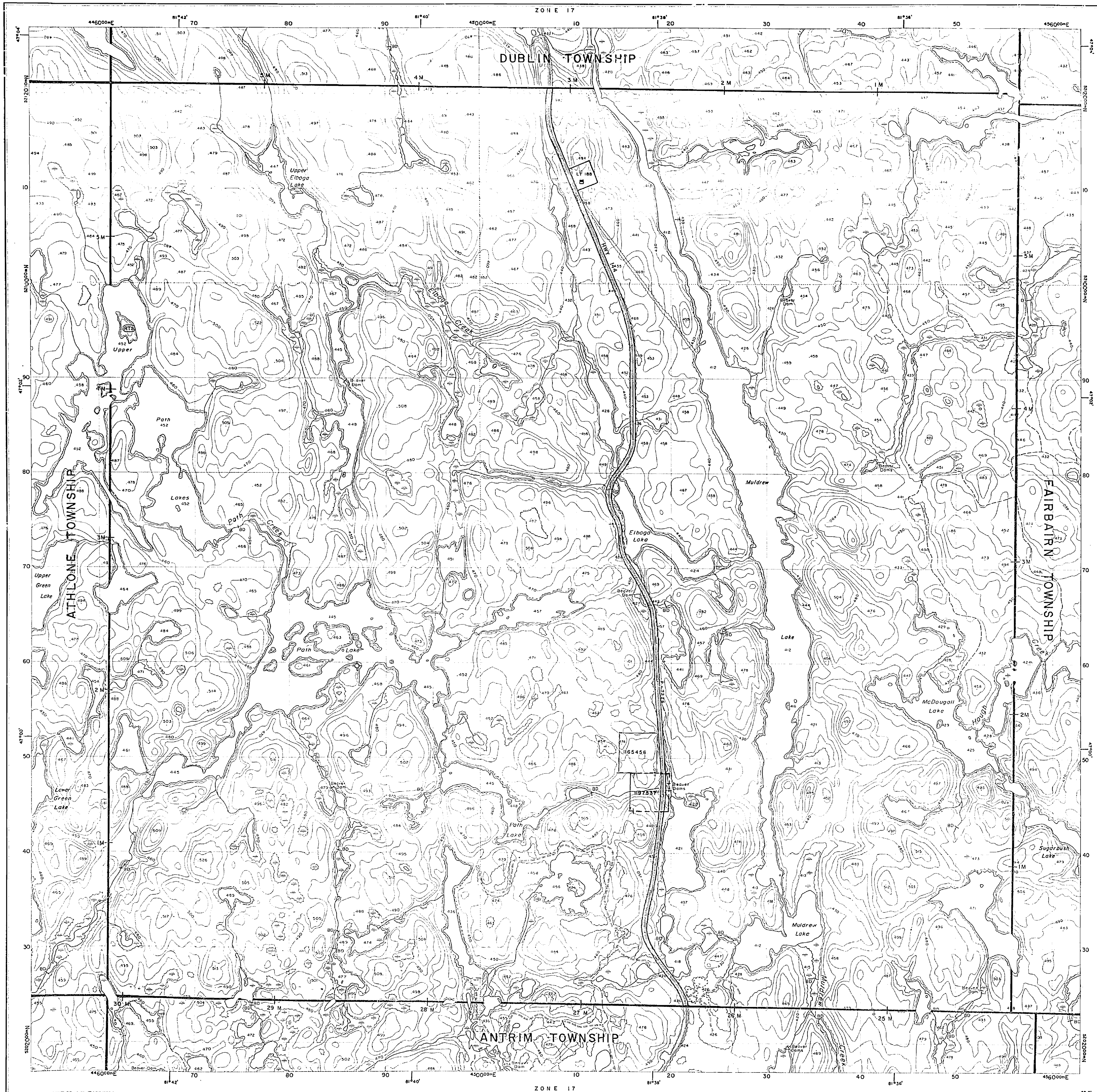

In Service: March 30, 1988

INDEX TO LAND DISPOSITION

PLAN
 G-4089
 TOWNSHIP

M.N.R. ADMINISTRATIVE DISTRICT
 SUDBURY
 MINING DIVISION
 SUDBURY
 LAND TITLES/REGISTRY DIVISION
 SUDBURY

MULDREW

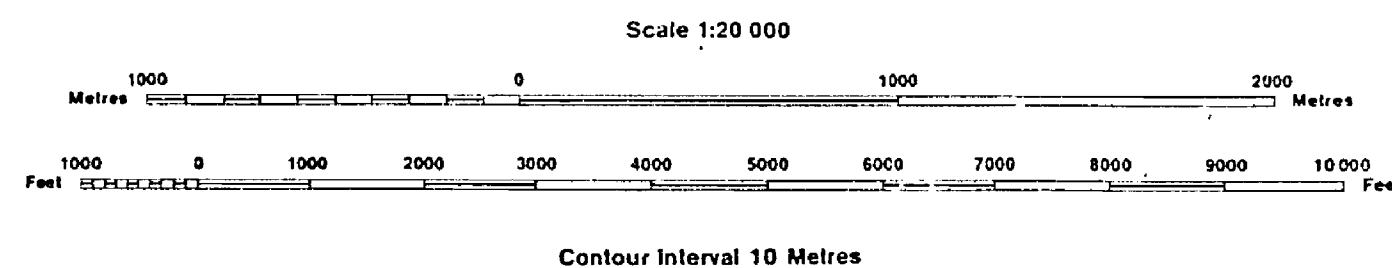

AREAS WITHDRAWN FROM DISPOSITION

- MRO - Mining Rights Only
- SRO - Surface Rights Only
- M + S - Mining and Surface Rights

SYMBOLS

Description	Order No.	Date	Disposition	File
Boundary				
Township, Meridian, Baseline				
Road allowance; surveyed				
shoreline				
Lot/Concession; surveyed				
unsurveyed				
Parcel; surveyed				
unsurveyed				
Right-of-way; road				
railway				
utility				
Reservation				
Cliff, Pit, Pile				
Contour				
Interpolated				
Approximate				
Depression				
Control point (horizontal)				
Flooded land				
Mine head frame				
Pipeline (above ground)				
Railway; single track				
double track				
abandoned				
Road; highway, county, township				
access				
trail, bush				
Shoreline (original)				
Transmission line				
Wooded area				

DISPOSITION OF CROWN LANDS

Patent	
Surface & Mining Rights	⊙
Surface Rights Only	○
Mining Rights Only	◐
Lease	
Surface & Mining Rights	⊞
Surface Rights Only	⊟
Mining Rights Only	⊠
Licence of Occupation	▼
Order-in-Council	OC
Cancelled	⊙
Reservation	⊙
Sand & Gravel	⊙
LAND USE PERMIT	⊙
REMOTE TOURIST SET-UP	⊙

THE INFORMATION THAT APPEARS ON THIS MAP HAS BEEN COMPILED FROM VARIOUS SOURCES, AND ACCURACY IS NOT GUARANTEED. THOSE WISHING TO STAKE MINING CLAIMS SHOULD CONSULT WITH THE MINING RECORDER, MINISTRY OF NORTHERN DEVELOPMENT AND MINES, FOR ADDITIONAL INFORMATION ON THE STATUS OF THE LANDS SHOWN HEREON.

DATE OF ISSUE
 MAR 30 1988
 SUDBURY
 MINING RECORDER'S OFFICE

PLAN OF MULDREW TWP.

SUDBURY MINING DIVISION
DISTRICT OF SUDBURY.

SUDBURY MINING DIV.
RECEIVED
DEC 23 1970
A.M.
7,8,9,10,11,12,1,2,3,4,5,6

— Scale, 40 chains to an inch. —

M.876

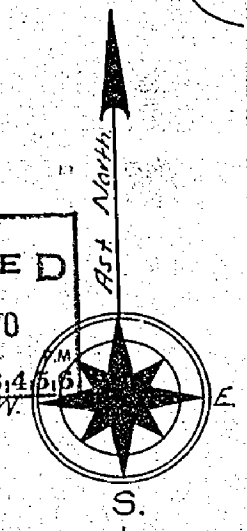

NOTE
400' Surface Rights Reservation
around all Lakes and Rivers.

DUBLIN TWP.

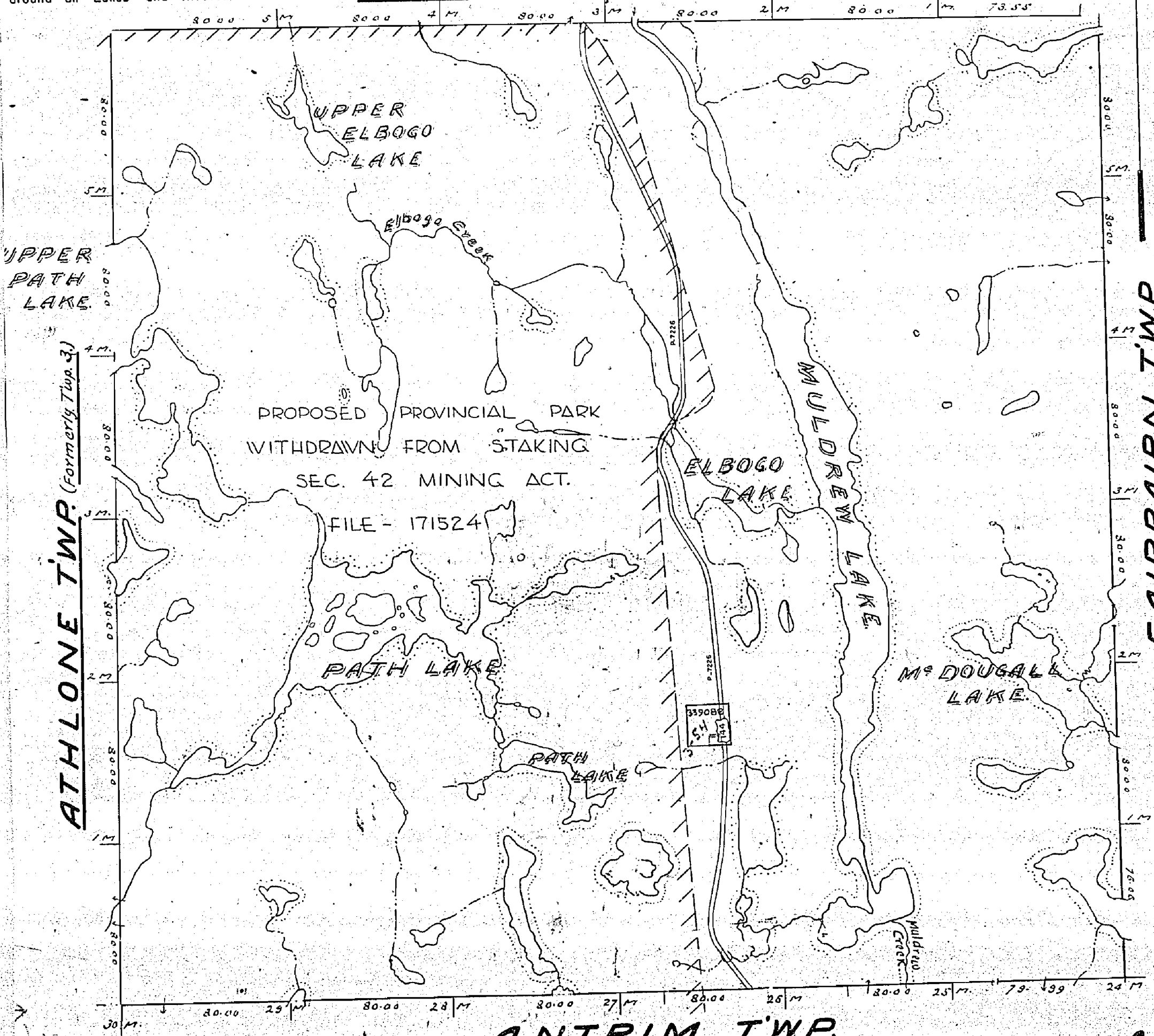

ATHLONE TWP. (Formerly Twp. 3.)

FAIRBAIRN TWP.

ANTRIM TWP.

- | | |
|-----------------------------|-----------------------|
| Railways shown thus | Non-perennial streams |
| Paved Highways | Bridges |
| Gravel | Buildings |
| Highway Route Nos. | Swamps |
| Other Roads | Artesian Wells |
| Trails | Patented |
| Telephone & Telegraph Lines | Leased |
| Electric Power Lines | License of Occupation |

M876

876

DUBLIN TP. M-767

ATHLONE TP. M-638

FAIRBAIRN TP. M-797

ANTRIM TP. M-631

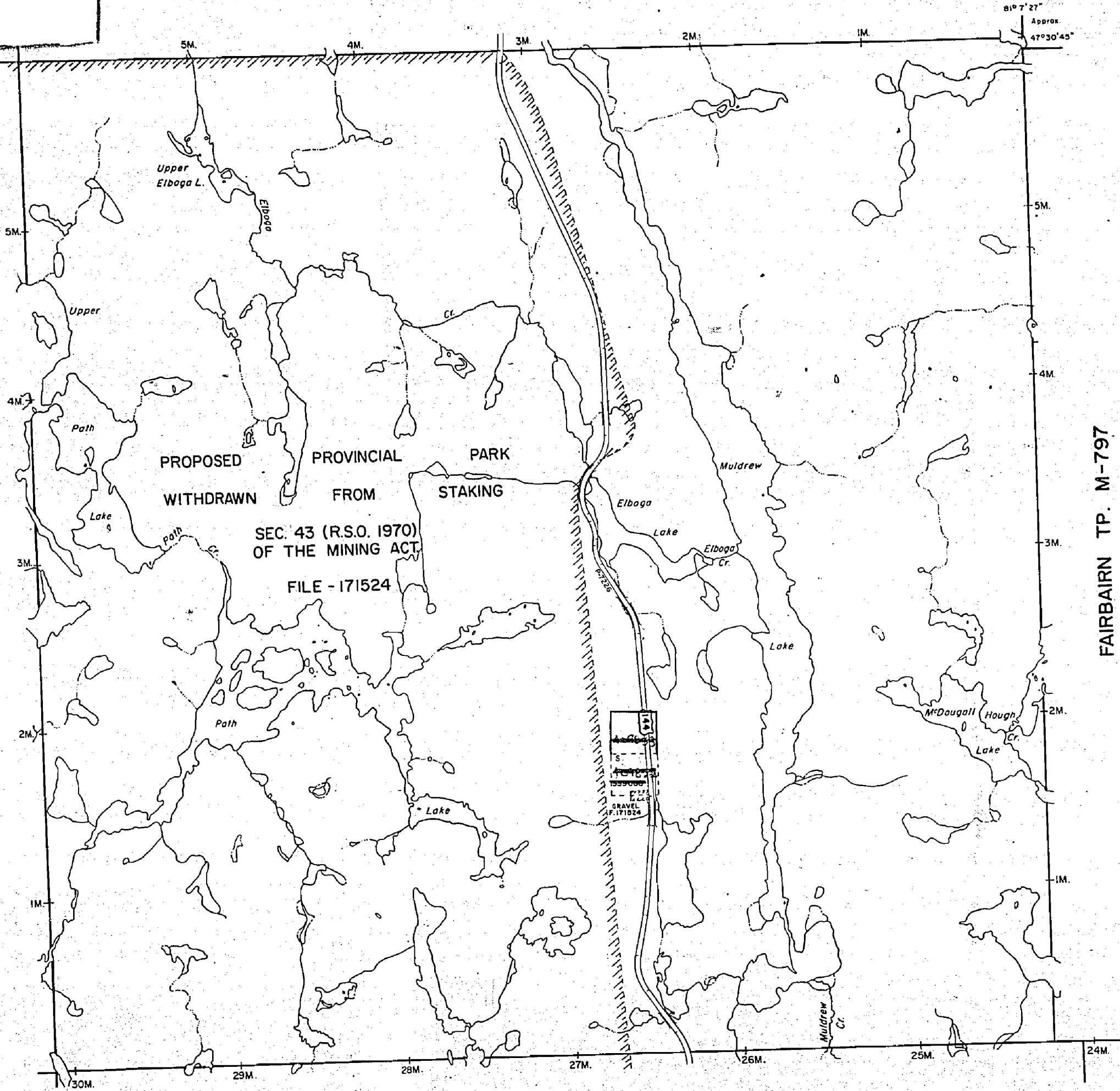

NOTES

400' surface rights reservation along the shores of all lakes and rivers.

(Surface and mining rights 1/2 mile on each side of right-of-way of Hwy. 144 are reopened for staking.)

SUBURRY RECEIVED
 JUN 5 1972 P.M.
 7,8,9,10,11,12,13,14,15,16

LEGEND

- PATENTED LAND (P or ●)
 - PATENTED FOR SURFACE RIGHTS ONLY (○)
 - LEASE (○)
 - LICENSE OF OCCUPATION (L.O.)
 - CROWN LAND SALES (C.S.)
 - LOCATED LAND (Loc.)
 - CANCELLED (C.)
 - MINING RIGHTS ONLY (M.R.O.)
 - SURFACE RIGHTS ONLY (S.R.O.)
 - HIGHWAY & ROUTE NO. (17)
 - ROADS (—)
 - TRAILS (---)
 - RAILWAYS (—+—)
 - POWER LINES (—+—)
 - MARSH OR MUSKEG (—+—)
 - MINES (X)
- *used only with summer resort locations or when space is limited

TOWNSHIP OF
MULDREW
 DISTRICT OF
 SUDBURY

SUDBURY
 MINING DIVISION

SCALE: 1 INCH = 40 CHAINS (1/2 MILE)

DR. R.W. NOBLE
 DATE APRIL 20, 72
 PLAN NO. **M-876**

ONTARIO
 DEPARTMENT OF MINES
 AND NORTHERN AFFAIRS

OFFICE USE ONLY

DUBLIN TP. M-767

NOTES

400' surface rights reservation along the shores of all lakes and rivers.

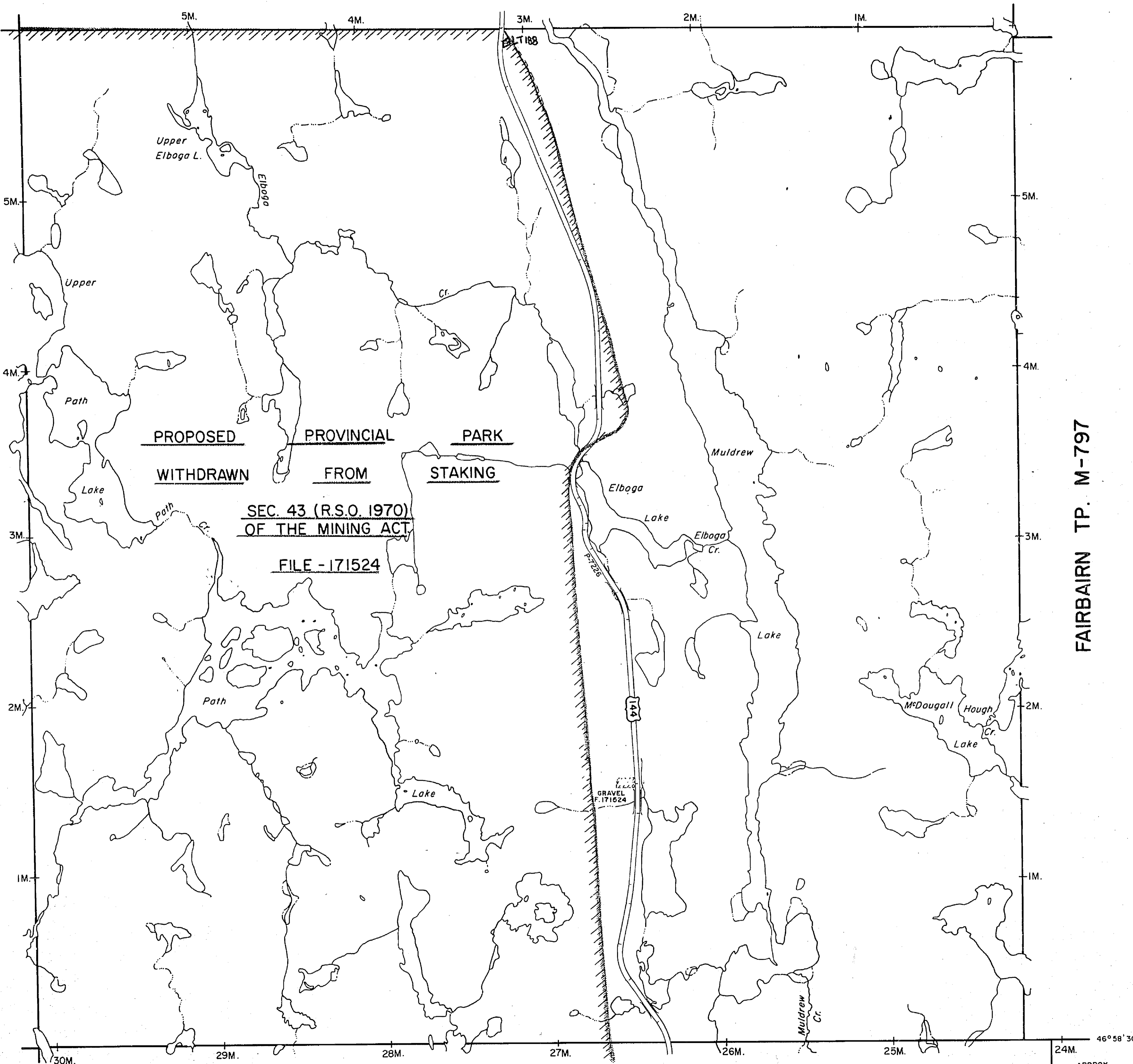

DATE OF ISSUE
FEB 24 1977

LEGEND

- PATENTED LAND
- PATENTED FOR SURFACE RIGHTS ONLY
- LEASE
- LICENSE OF OCCUPATION
- CROWN LAND SALES
- LOCATED LAND
- CANCELLED
- MINING RIGHTS ONLY
- SURFACE RIGHTS ONLY
- HIGHWAY & ROUTE NO.
- ROADS
- TRAILS
- RAILWAYS
- POWER LINES
- MARSH OR MUSKEG
- MINES

*used only with summer resort locations or when space is limited

TOWNSHIP OF

MULDREW

DISTRICT OF
SUDBURY

SUDBURY
MINING DIVISION

SCALE : 1 INCH = 40 CHAINS (1/2 MILE)

DR. R.W. NOBLE
DATE APRIL 20, 72

PLAN NO. **M-876**

ONTARIO
MINISTRY OF NATURAL RESOURCES
SURVEYS AND MAPPING BRANCH

ANTRIM TP. M-631

46° 58' 30"
APPROX.
81° 35'