

FICHT LAKE AREA G-250

Surface and mining rights withdrawn from staking Order W TB 45/95
95/06/26 MWR For Proposed Wabakimi Park Expansion
(SEE WABAKIMI PARK LANDROLL)

THE INFORMATION THAT APPEARS ON THIS MAP HAS BEEN COMPILED FROM VARIOUS SOURCES, AND ACCURACY IS NOT GUARANTEED. THOSE WISHING TO STAKE MINING CLAIMS SHOULD CONSULT WITH THE MINING RECORDER, MINISTRY OF NORTHERN DEVELOPMENT AND MINES, FOR ADDITIONAL INFORMATION ON THE STATUS OF THE LANDS SHOWN HEREON.

LEGEND

HIGHWAY AND ROUTE No.	
OTHER ROADS	
TRAILS	
SURVEYED LINES:	
TOWNSHIPS, BASE LINES, ETC.	
LOTS, MINING CLAIMS, PARCELS, ETC.	
UNSURVEYED LINES:	
LOT LINES	
PARCEL BOUNDARY	
MINING CLAIMS ETC.	
RAILWAY AND RIGHT OF WAY	
UTILITY LINES	
NON-PERENNIAL STREAM	
FLOODING OR FLOODING RIGHTS	
SUBDIVISION	
ORIGINAL SHORELINE	
MARSH OR MUSKEG	
MINES	

DISPOSITION OF CROWN LANDS

TYPE OF DOCUMENT	SYMBOL
PATENT, SURFACE & MINING RIGHTS	
" SURFACE RIGHTS ONLY	
" MINING RIGHTS ONLY	
LEASE, SURFACE & MINING RIGHTS	
" SURFACE RIGHTS ONLY	
" MINING RIGHTS ONLY	
LICENCE OF OCCUPATION	
CROWN LAND SALE	C.S.
ORDER-IN-COUNCIL	O.C.
RESERVATION	
CANCELLED	
SAND & GRAVEL	
LAND USE PERMITS FOR COMMERCIAL TOURISM/OUTPOST CAMPS	

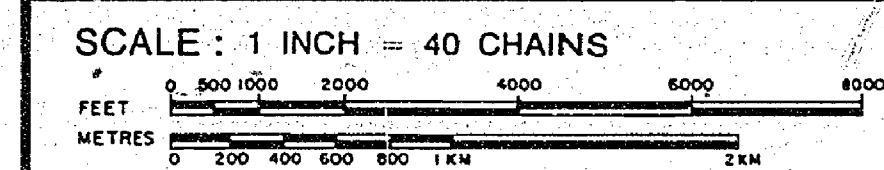

AREA
MUSGRAVE LAKE
M.N.R. ADMINISTRATIVE DISTRICT
GERALDTON
MINING DIVISION
THUNDER BAY
LAND TITLES / REGISTRY DIVISION
THUNDER BAY

Ministry of Natural Resources
Land Management Branch
Ontario

SEPT 16 1981
Date JULY 1981
Number

G-338

GREMM LAKE G-

WITCHWOOD LAKE AREA G-463

WHITECLAY LAKE G-153

SHABUSKWA LAKE AREA.

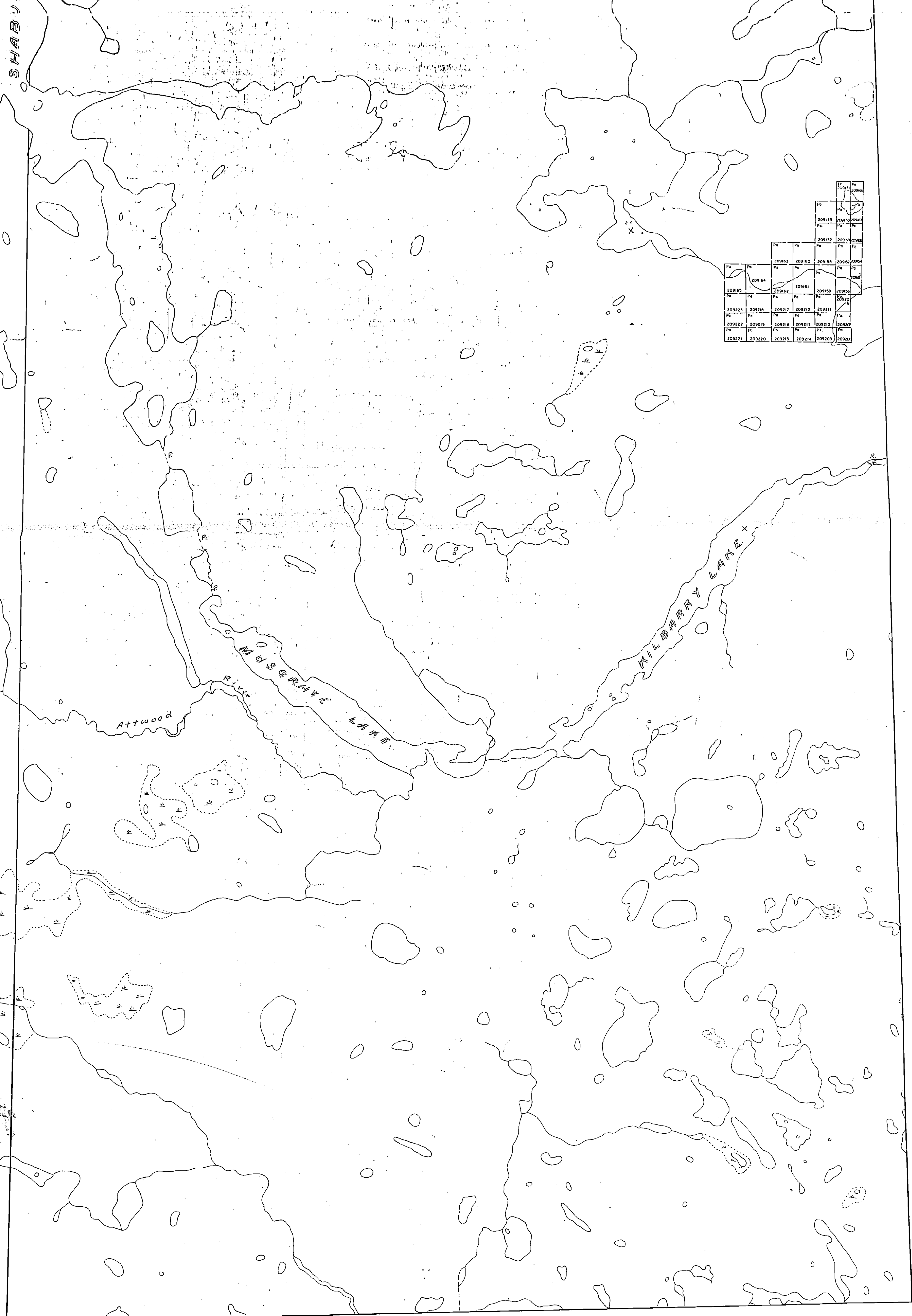

20912	20913	20914
20915	20916	20917
20918	20919	20920
20921	20922	20923
20924	20925	20926
20927	20928	20929
20930	20931	20932
20933	20934	20935
20936	20937	20938
20939	20940	20941
20942	20943	20944

NOTES

- Railways shown
- Paved Highways
- Gravel
- Highway Route No.
- Other Roads
- Trails & Paths
- Telephone & Telegraph Lines
- Electric Power Lines
- Non-perennial streams
- Bridges
- Buildings
- Swamps
- Areas marked
- or Potentia
- or Licenses
- or Licenses
- or Licenses

THUNDER BAY MINING DIVISION

M-1830 #1

F-1

1830

MUSGRAVE T. M1830

FICHT LAKE AREA M.3356

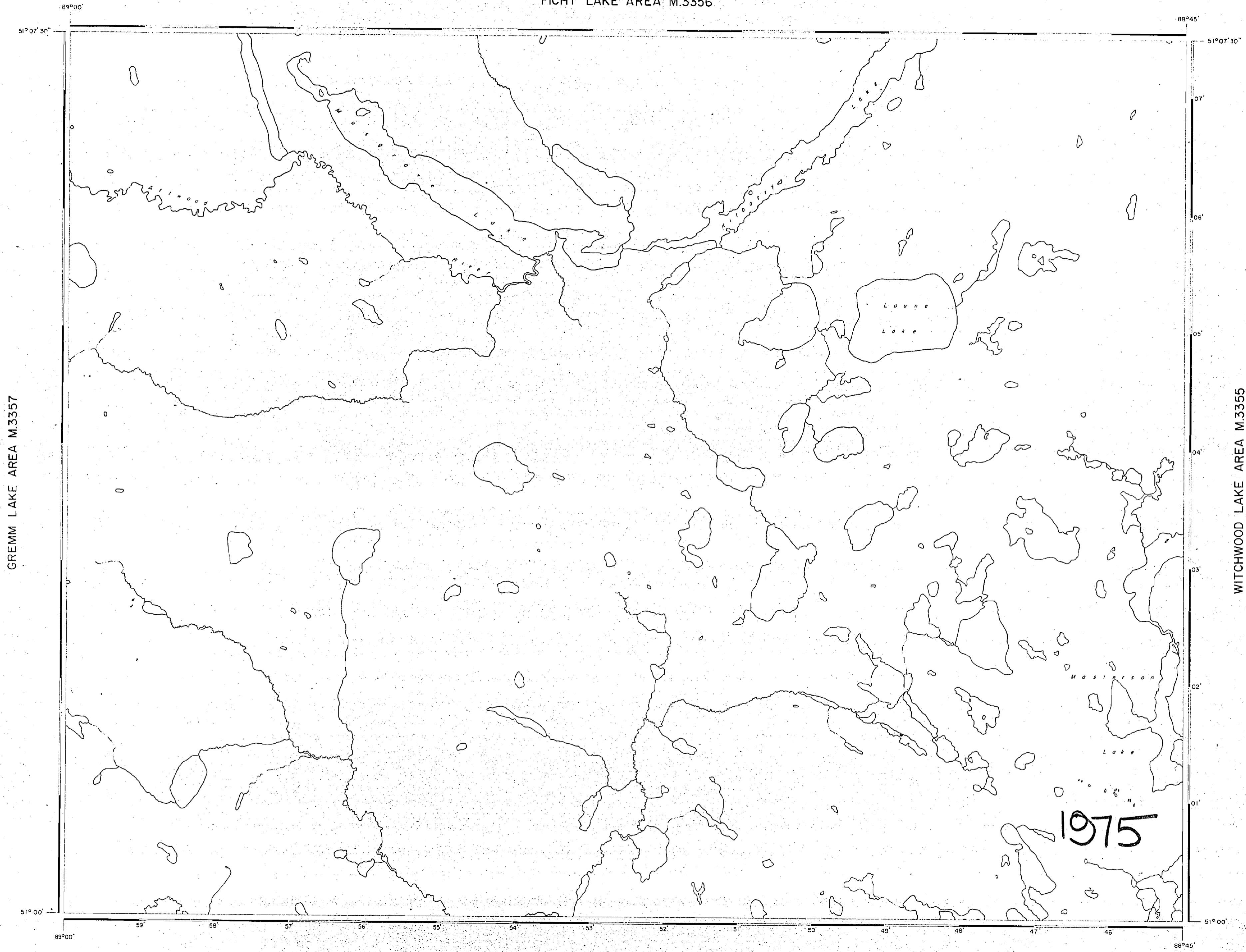

GREMM LAKE AREA M.3357

WITCHWOOD LAKE AREA M.3355

LEGEND

HIGHWAY AND ROUTE NO.	
OTHER ROADS	
TRAILS	
SURVEYED LINES	
TOWNSHIPS, BASE LINES, ETC.	
LOTS, MINING CLAIMS, PARCELS, ETC.	
UNSURVEYED LINES	
LOT LINES	
PARCEL BOUNDARY	
MINING CLAIMS, ETC.	
RAILWAY AND RIGHT OF WAY	
UTILITY LINES	
NON-PERENNIAL STREAM	
FLOODING OR FLOODING RIGHTS	
SUBDIVISION	
ORIGINAL SHORELINE	
MARSH OR MUSKEG	
MINES	

DISPOSITION OF CROWN LANDS

TYPE OF DOCUMENT	SYMBOL
PATENT - SURFACE & MINING RIGHTS	
SURFACE RIGHTS ONLY	
MINING RIGHTS ONLY	
LEASE - SURFACE & MINING RIGHTS	
SURFACE RIGHTS ONLY	
MINING RIGHTS ONLY	
LICENCE OF OCCUPATION	
CROWN LAND SALE	
ORDER-IN-COUNCIL	
RESERVATION	
CANCELLED	
SAND & GRAVEL	

SCALE: 1 INCH = 40 CHAINS

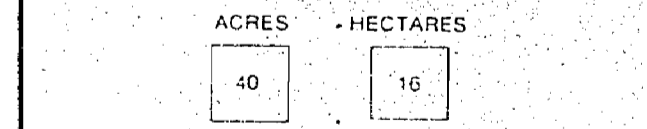

AREA
MUSGRAVE LAKE
 DISTRICT
 THUNDER BAY
 MINING DIVISION
 THUNDER BAY

1975

1830

FICHT LAKE AREA M.3356

GREMM LAKE AREA M.3357

WITCHWOOD LAKE AREA M.3355

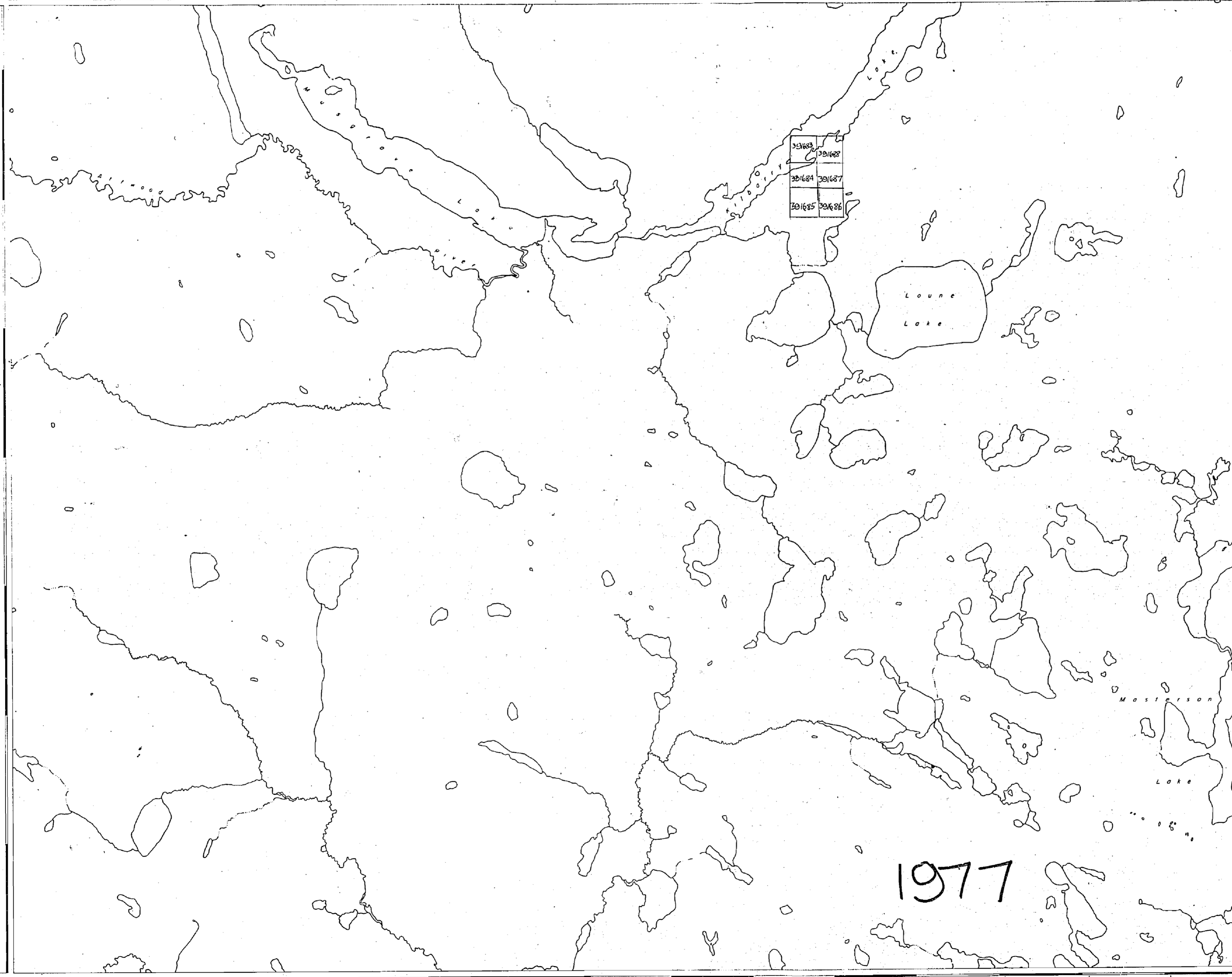

LEGEND

- HIGHWAY AND ROUTE No
- OTHER ROADS
- TRAILS
- SURVEYED LINES
- TOWNSHIPS, BASE LINES, ETC
- LOTS, MINING CLAIMS, PARCELS, ETC
- UNSURVEYED LINES
- LOT LINES
- PARCEL BOUNDARY
- MINING CLAIMS ETC
- RAILWAY AND RIGHT OF WAY
- UTILITY LINES
- NON-PERENNIAL STREAM
- FLOODING OR FLOODING RIGHTS
- SUBDIVISION
- ORIGINAL SHORELINE
- MARSH OR MUSKEG
- MINES

DISPOSITION OF CROWN LANDS

- | TYPE OF DOCUMENT | SYMBOL |
|--------------------------------|--------|
| PATENT SURFACE & MINING RIGHTS | |
| SURFACE RIGHTS ONLY | |
| MINING RIGHTS ONLY | |
| LEASE, SURFACE & MINING RIGHTS | |
| SURFACE RIGHTS ONLY | |
| MINING RIGHTS ONLY | |
| LICENCE OF OCCUPATION | |
| CROWN LAND SALE | CS |
| ORDER-IN-COUNCIL | OC |
| RESERVATION | |
| CANCELLED | |
| SAND & GRAVEL | |

SCALE: 1 INCH = 40 CHAINS



ACRES	HECTARES
40	16

AREA
MUSGRAVE LAKE
 DISTRICT
 THUNDER BAY
 MINING DIVISION
 THUNDER BAY
 Jan 21/77 GERALDTON DIST.

Ministry of Natural Resources
 Ontario Surveys and Mapping Branch

Date Dec. 12, 73. Plan No. M.1830
 National Topographical Series 52P2

1830

SHABUSKWINIA

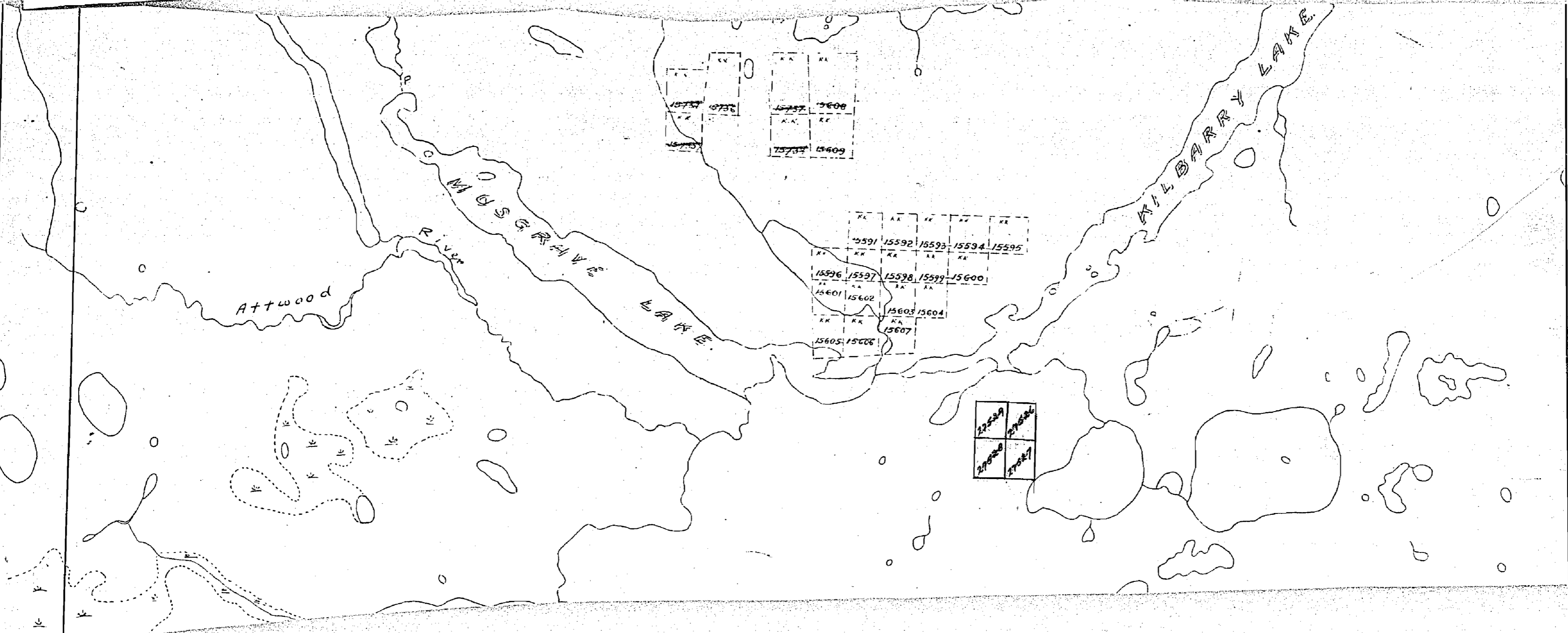

1830

SHABUSKWA

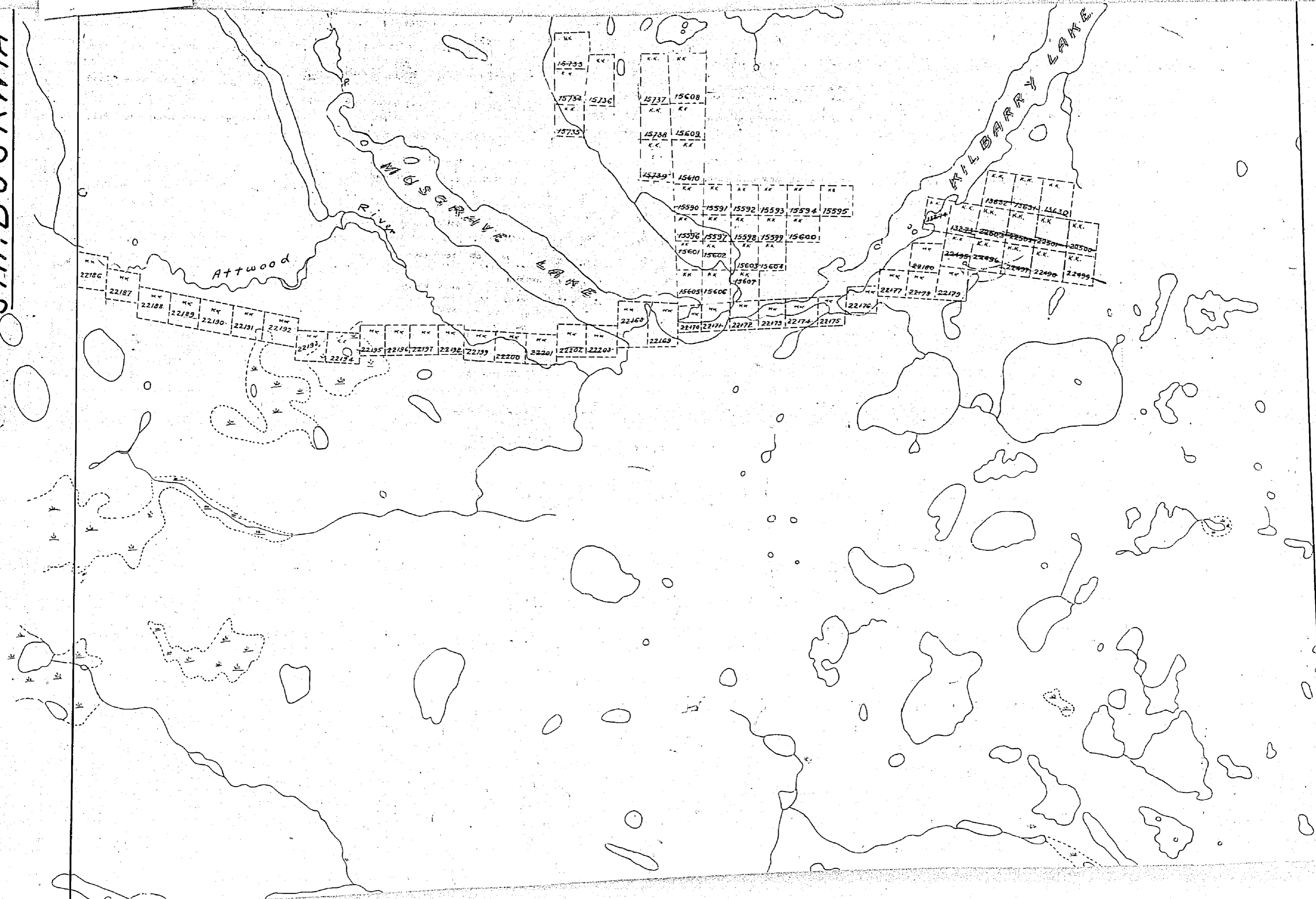

Attwood

Moose River

Attwood Lake

22186
22187
22188
22189
22190
22191
22192

22193
22194
22195
22196
22197
22198
22199
22200
22201
22202
22203

15733
15734
15735
15736
15737
15738
15739
15608
15609
15610
15590
15591
15592
15593
15594
15595
15596
15597
15598
15599
15600
15601
15602
15603
15604
15605
15606
15607

13221
13222
13223
13224
13225
13226
13227
13228
13229
13230
13231
13232
13233
13234
13235
13236
13237
13238
13239
13240
13241
13242
13243
13244
13245
13246
13247
13248
13249
13250
13251
13252
13253
13254
13255
13256
13257
13258
13259
13260
13261
13262
13263
13264
13265
13266
13267
13268
13269
13270
13271
13272
13273
13274
13275
13276
13277
13278
13279
13280
13281
13282
13283
13284
13285
13286
13287
13288
13289
13290
13291
13292
13293
13294
13295
13296
13297
13298
13299
13300

22176
22177
22178
22179
22180
22181
22182
22183
22184
22185

22163
22164
22165
22166
22167
22168
22169
22170
22171
22172
22173
22174
22175

1830

FICHT LAKE AREA M.3356

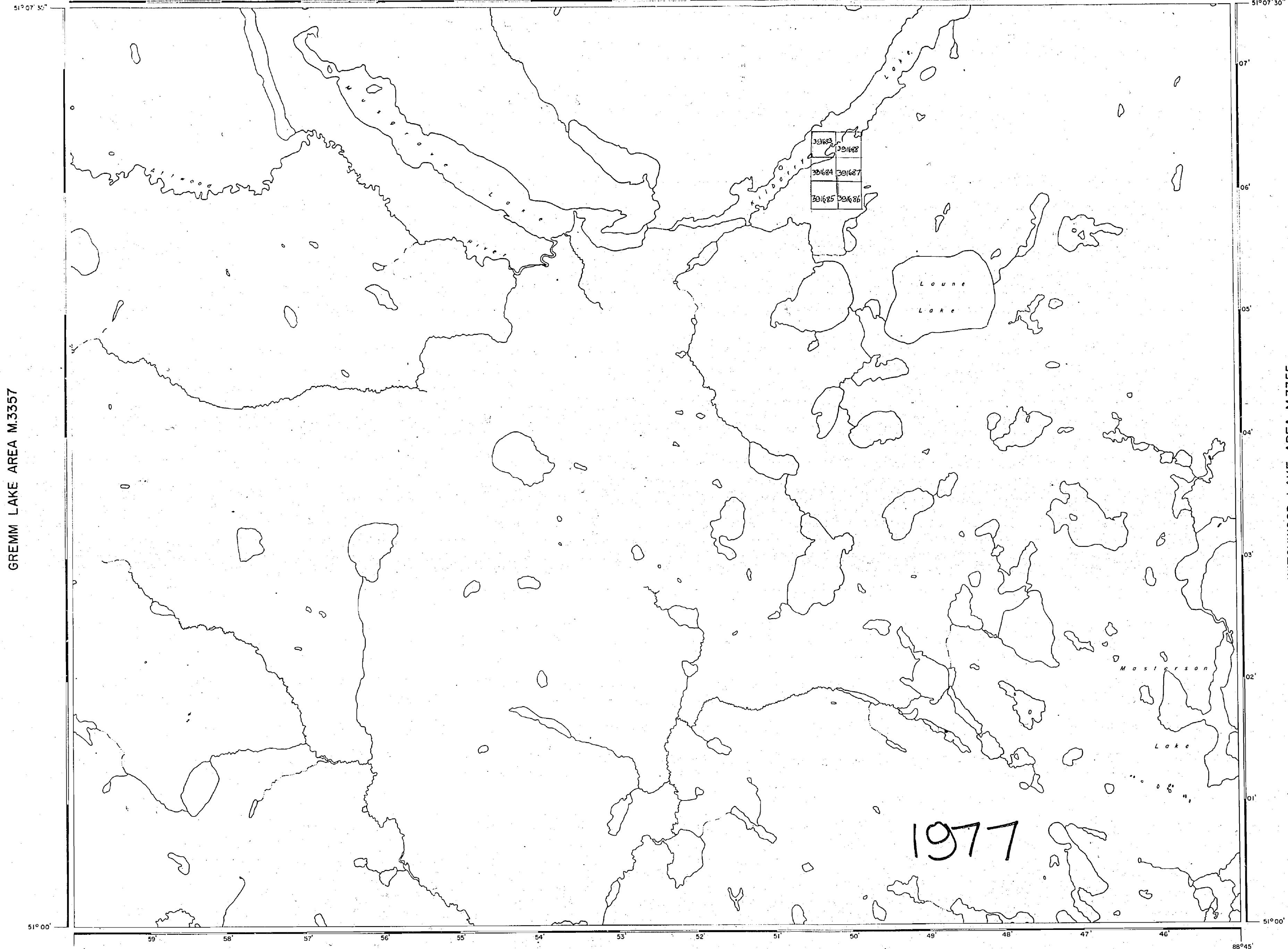

GREMM LAKE AREA M.3357

WITCHWOOD LAKE AREA M.3355

LEGEND

HIGHWAY AND ROUTE No	
OTHER ROADS	
TRAILS	
SURVEYED LINES	
TOWNSHIPS, BASE LINES, ETC	
LOTS, MINING CLAIMS, PARCELS, ETC	
UNSURVEYED LINES	
LOT LINES	
PARCEL BOUNDARY	
MINING CLAIMS ETC	
RAILWAY AND RIGHT OF WAY	
UTILITY LINES	
NON-PERENNIAL STREAM	
FLOODING OR FLOODING RIGHTS	
SUBDIVISION	
ORIGINAL SHORELINE	
MARSH OR MUSKEG	
MINES	

DISPOSITION OF CROWN LANDS

TYPE OF DOCUMENT	SYMBOL
PATENT SURFACE & MINING RIGHTS	
SURFACE RIGHTS ONLY	
MINING RIGHTS ONLY	
LEASE SURFACE & MINING RIGHTS	
SURFACE RIGHTS ONLY	
MINING RIGHTS ONLY	
LICENCE OF OCCUPATION	
CROWN LAND SALE	
ORDER-IN-COUNCIL	
RESERVATION	
CANCELLED	
SAND & GRAVEL	

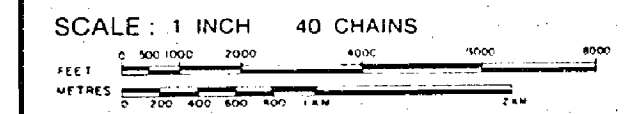

ACRES	HECTARES
40	16

AREA
MUSGRAVE LAKE

DISTRICT
 THUNDER BAY

MINING DIVISION
 THUNDER BAY

JAN 31/77 GERALDTON DIST.

Ministry of Natural Resources

Ontario Surveys and Mapping Branch

Date Dec. 12, 73 Plan No.

National Topographical Series 52P2 **M.1830**

1977

SHABUSKWINIA

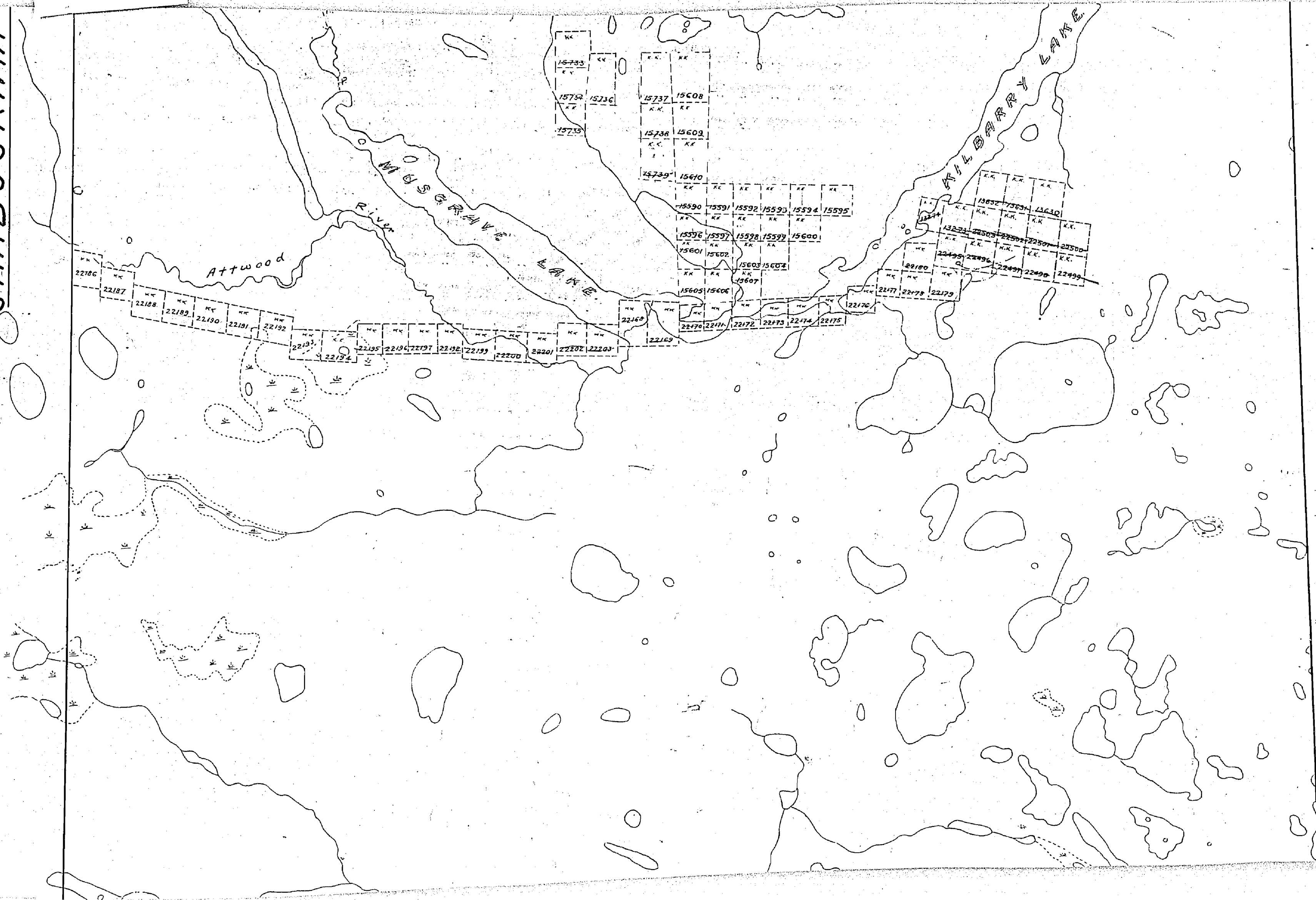

1830

SHABUSKAWIA

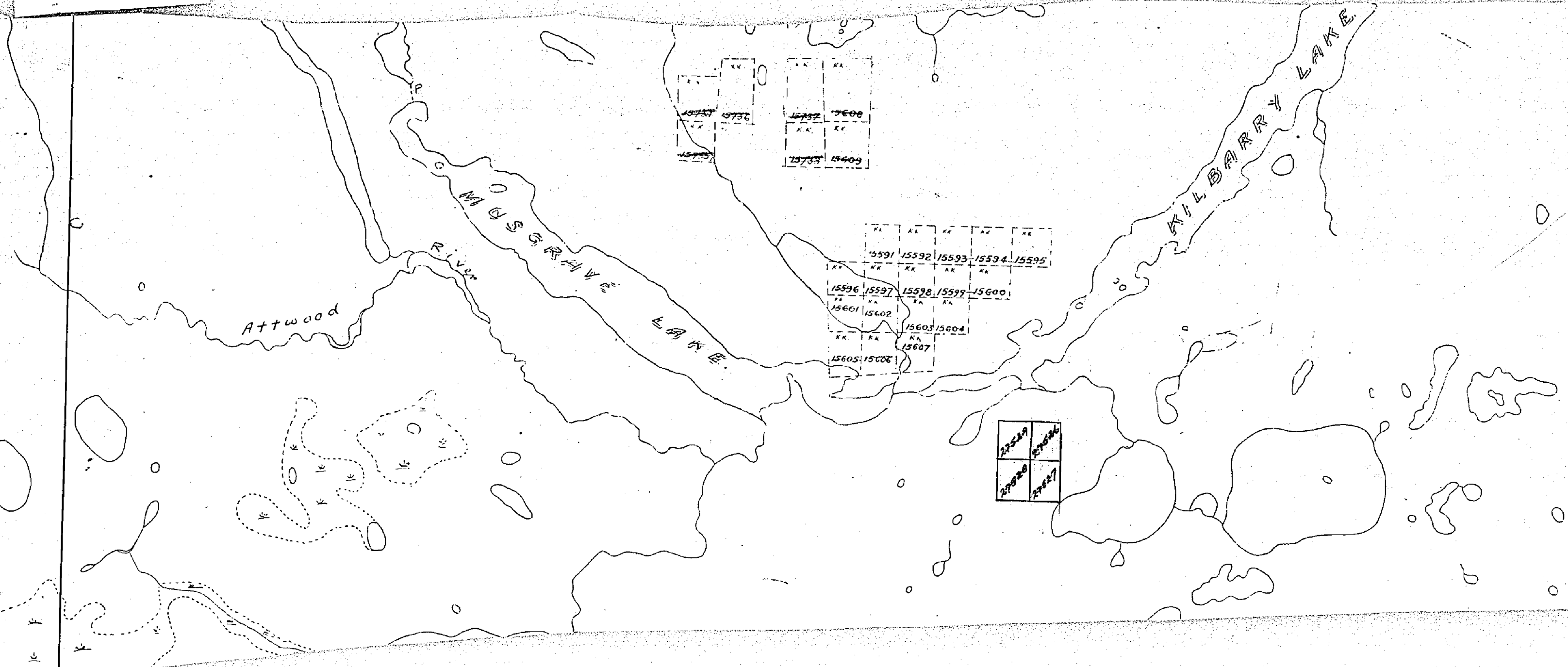

PLAIN OF MUSGRAVE LAKE AREA

THUNDER BAY MINING DIVISION
DISTRICT OF THUNDER BAY

Scale 40 chains to an inch.



PRINGLE LAKE AREA

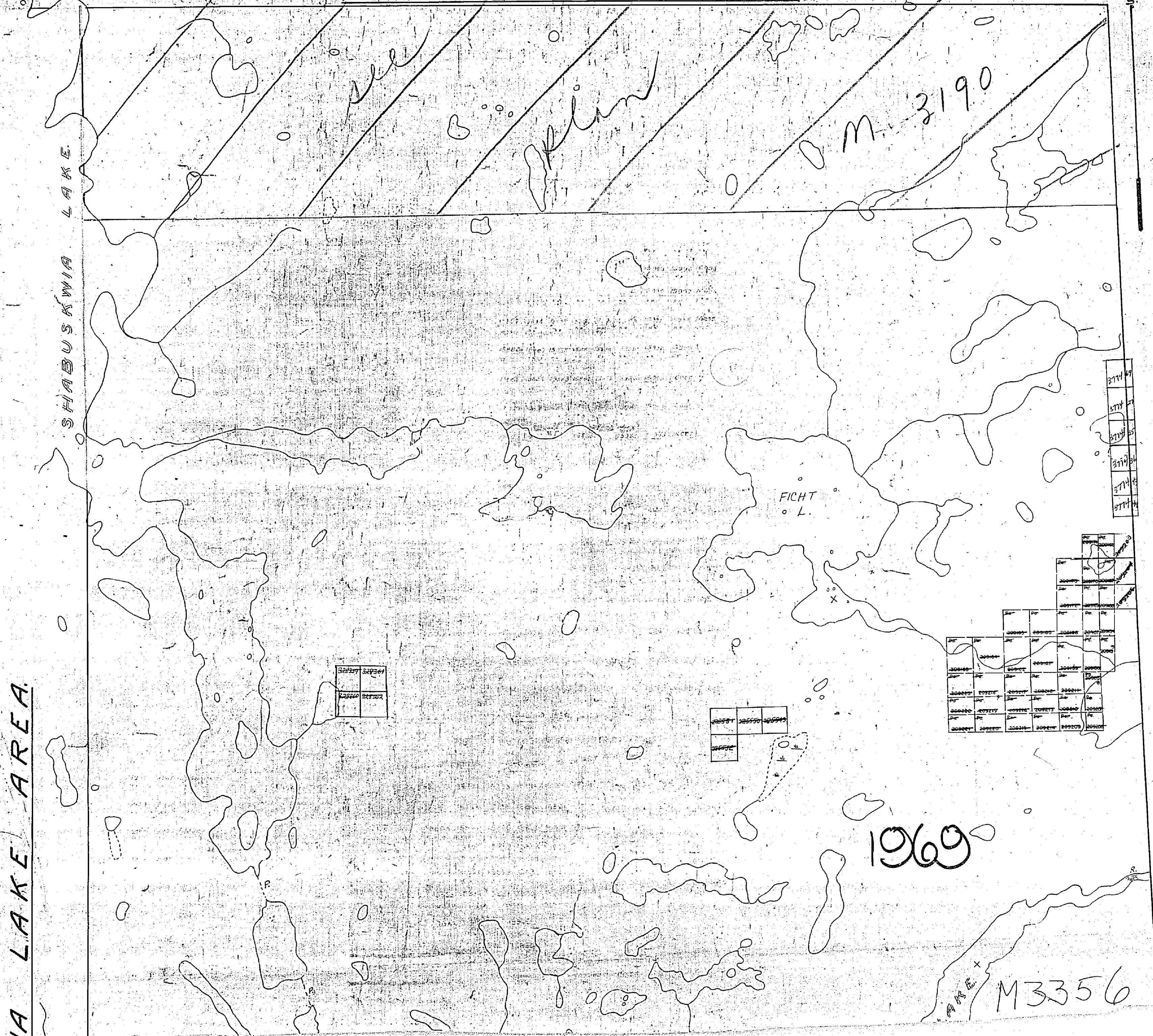

3174	49
3174	50
3174	51
3174	52
3174	53
3174	54

3174	54
3174	55
3174	56
3174	57
3174	58
3174	59

3174	59	3174	60	3174	61	3174	62	3174	63
3174	60	3174	61	3174	62	3174	63	3174	64
3174	61	3174	62	3174	63	3174	64	3174	65
3174	62	3174	63	3174	64	3174	65	3174	66
3174	63	3174	64	3174	65	3174	66	3174	67
3174	64	3174	65	3174	66	3174	67	3174	68
3174	65	3174	66	3174	67	3174	68	3174	69
3174	66	3174	67	3174	68	3174	69	3174	70
3174	67	3174	68	3174	69	3174	70	3174	71
3174	68	3174	69	3174	70	3174	71	3174	72

3174	63
3174	64

3174	63
3174	64
3174	65

1969

M3356

LAKE AREA

SHABUSKAWIA LAKE

1830

MUSGRAVE LAKE

FICHT LAKE AREA M.3356

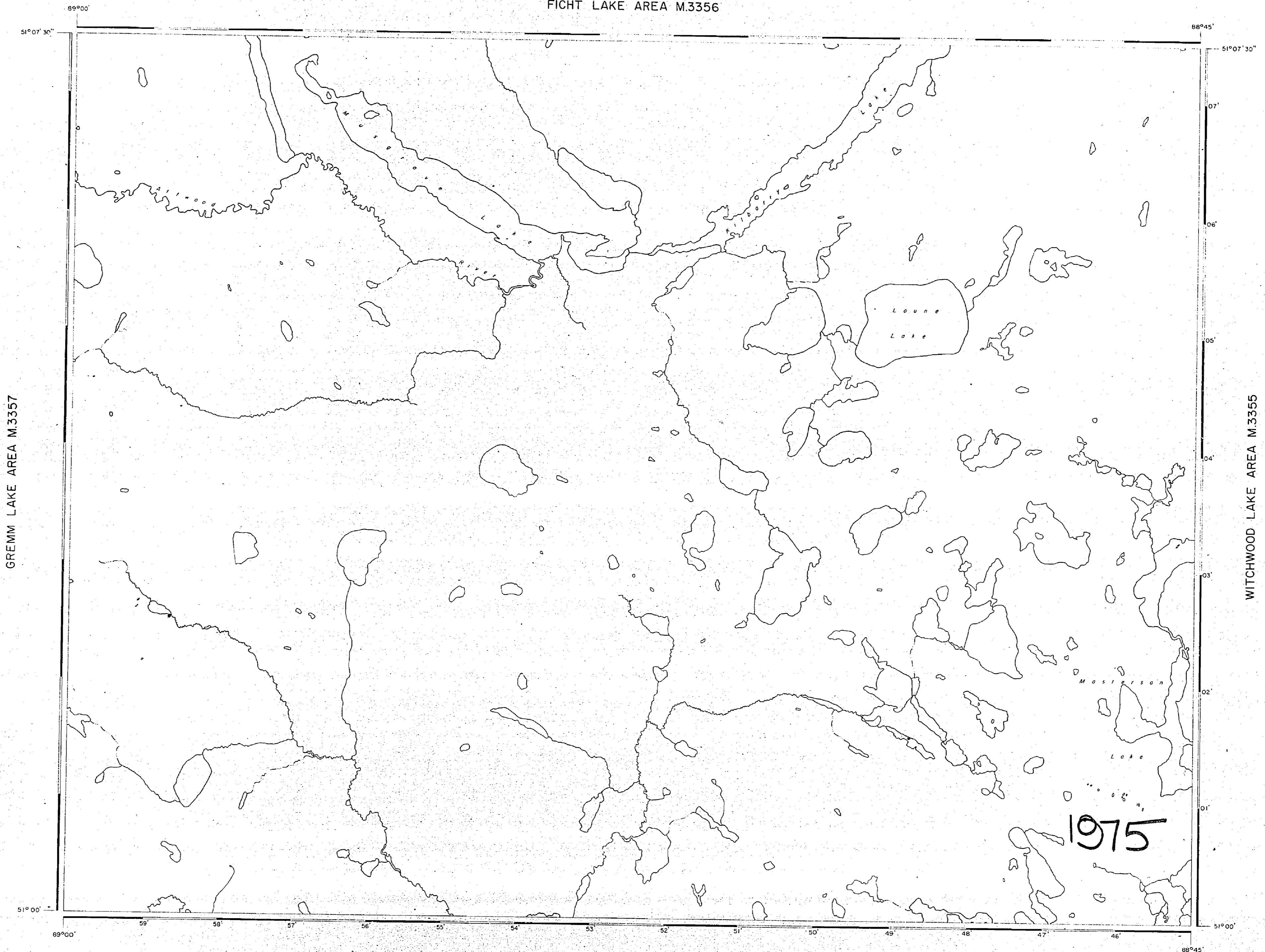

GREMM LAKE AREA M.3357

WITCHWOOD LAKE AREA M.3355

1975

LEGEND

HIGHWAY AND ROUTE NO.	
OTHER ROADS	
TRAILS	
SURVEYED LINES	
TOWNSHIPS, BASE LINES, ETC.	
LOTS, MINING CLAIMS, PARCELS, ETC.	
UNSURVEYED LINES	
LOT LINES	
PARCEL BOUNDARY	
MINING CLAIMS, ETC.	
RAILWAY AND RIGHT OF WAY	
UTILITY LINES	
NON-PERENNIAL STREAM	
FLOODING OR FLOODING RIGHTS	
SUBDIVISION	
ORIGINAL SHORELINE	
MARSH OR MUSKEG	
MINES	

DISPOSITION OF CROWN LANDS

TYPE OF DOCUMENT	SYMBOL
PATENT SURFACE & MINING RIGHTS	
SURFACE RIGHTS ONLY	
MINING RIGHTS ONLY	
LEASE SURFACE & MINING RIGHTS	
SURFACE RIGHTS ONLY	
MINING RIGHTS ONLY	
LICENCE OF OCCUPATION	
CROWN LAND SALE	
ORDER-IN-COUNCIL	
RESERVATION	
CANCELLED	
SAND & GRAVEL	

SCALE: 1 INCH = 40 CHAINS

ACRES	HECTARES
40	16

AREA
MUSGRAVE LAKE
 DISTRICT
 THUNDER BAY
 MINING DIVISION
 THUNDER BAY

Ministry of Natural Resources
 Ontario Surveys and Mapping Branch
 Date: Dec 12, 73 Plan No. 2
 52P2 M.1830