

304

FRIPP TWP. M.281

DOYLE TWP. M.275

BARTLETT TWP. M.262

BEEMER TWP. M.656

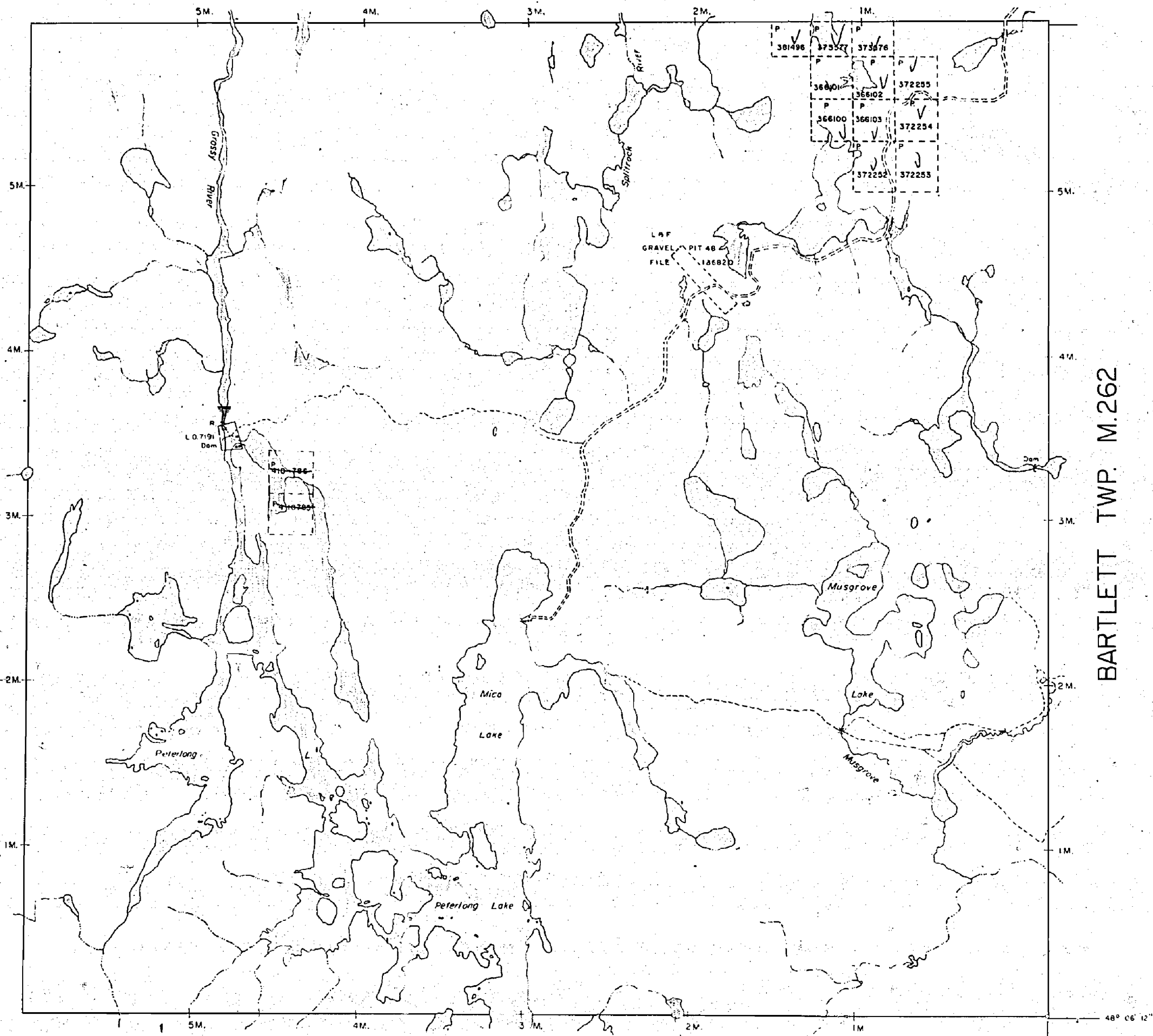

THE TOWNSHIP
OF
MUSGROVE

DISTRICT OF
TIMISKAMING

PORCUPINE
MINING DIVISION

SCALE: 1-INCH 40 CHAINS

LEGEND

PATENTED LAND	Ⓟ
CROWN LAND SALE	C.S.
LEASES	Ⓛ
LOCATED LAND	Loc.
LICENSE OF OCCUPATION	L.O.
MINING RIGHTS ONLY	M.R.O.
SURFACE RIGHTS ONLY	S.R.O.
ROADS	—
IMPROVED ROADS	—
KING'S HIGHWAYS	—
RAILWAYS	—
POWER LINES	—
MARSH OR MUSKEG	—
MINES	Ⓧ
CANCELLED	Ⓢ

NOTES

400' Surface Rights Reservation around all lakes and rivers.

Flooding Rights in Peterlong & Mica lakes assigned to HEPC LO 7191

File 1162 Vol: 4

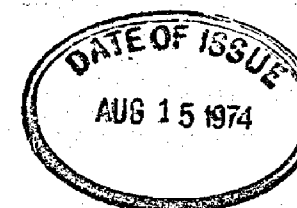

PLAN NO. **M.304**

ONTARIO
MINISTRY OF NATURAL RESOURCES
SURVEYS AND MAPPING BRANCH

FRIPP TWP. M.281

MUSGROVE

DISTRICT OF
TIMISKAMING

PORCUPINE
MINING DIVISION

SCALE: 1 INCH = 40 CHAINS

LEGEND

- PATENTED LAND (P)
- CROWN LAND SALE (C.S.)
- LEASES (L)
- LOCATED LAND (Loc.)
- LICENSE OF OCCUPATION (L.O.)
- MINING RIGHTS ONLY (M.R.O.)
- SURFACE RIGHTS ONLY (S.R.O.)
- ROADS
- IMPROVED ROADS
- KING'S HIGHWAYS
- RAILWAYS
- POWER LINES
- MARSH OR MUSKEG
- MINES
- CANCELLED
- DISPOSAL SITE - S.R.O. WITHDRAWN

NOTES

- 400' Surface Rights Reservation around all lakes and rivers.
- Flooding Rights in Peterlong & Mica lakes assigned to H.E.P.C. LO 7191 File 1162 Vol. 4
- (P) S.R.O. withdrawn from staking April 1975 - Access point

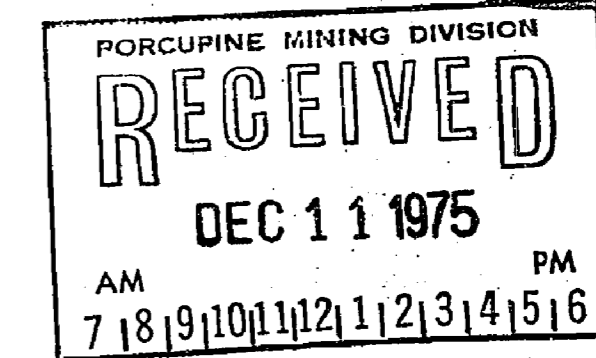
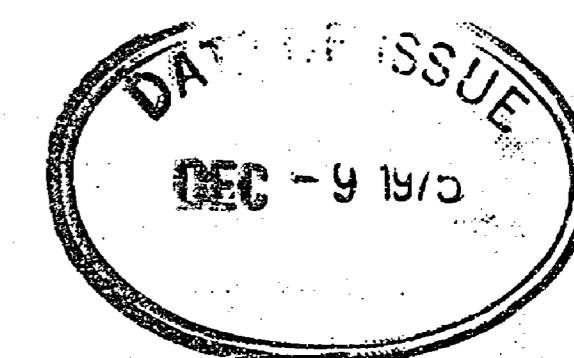

PLAN NO. **M.304**

ONTARIO
MINISTRY OF NATURAL RESOURCES
SURVEYS AND MAPPING BRANCH

DOYLE TWP. M.275

BARTLETT TWP. M.262

BEEMER TWP. M.656

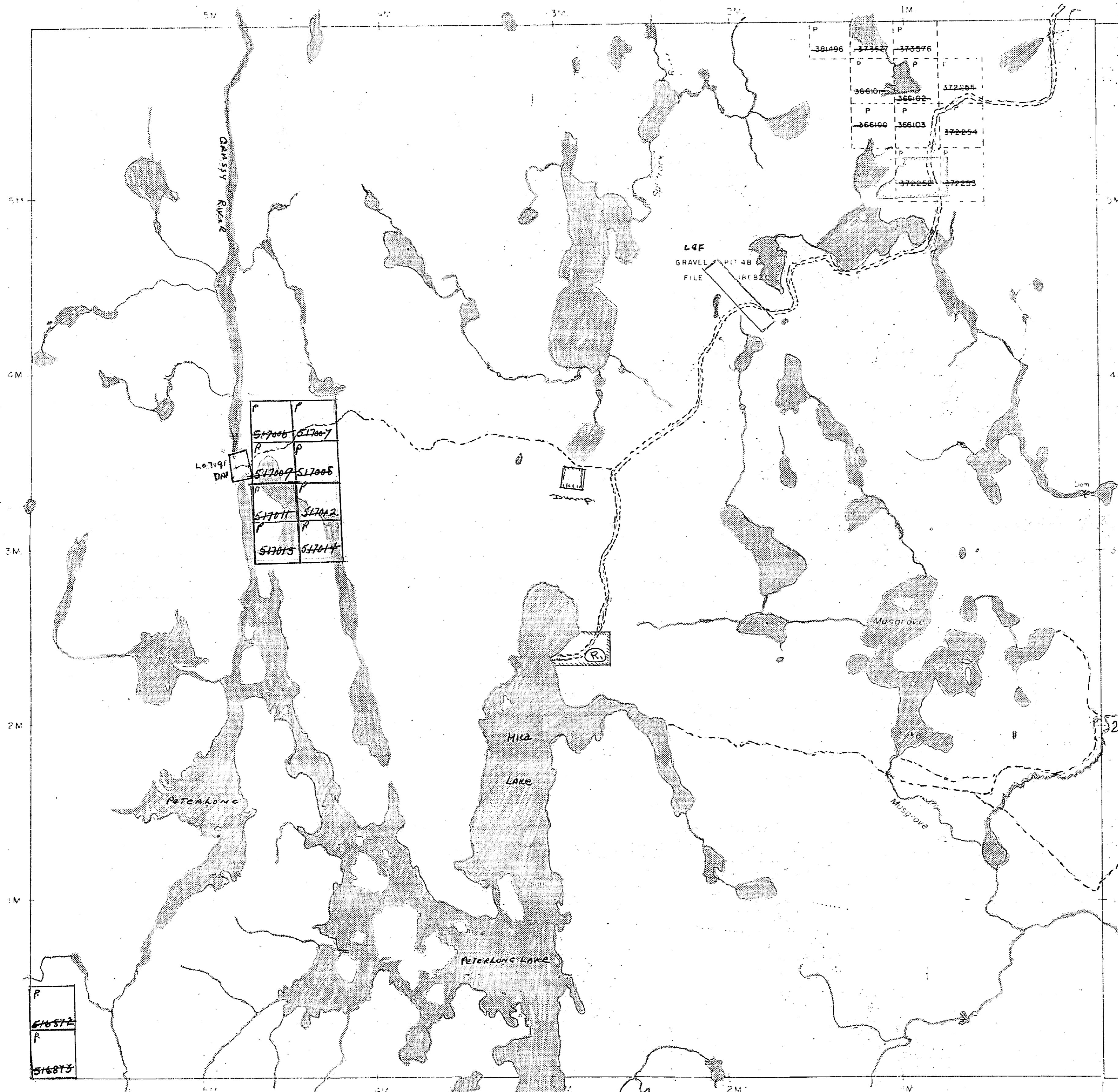

FRIPP TWP. M.281

THE TOWNSHIP
OF

MUSGROVE

DISTRICT OF
TIMISKAMING

PORCUPINE
MINING DIVISION

SCALE: 1-INCH 40 CHAINS

LEGEND

PATENTED LAND	Ⓟ
CROWN LAND SALE	C.S.
LEASES	Ⓛ
LOCATED LAND	Loc.
LICENSE OF OCCUPATION	L.O.
MINING RIGHTS ONLY	M.R.O.
SURFACE RIGHTS ONLY	S.R.O.
ROADS	— — — — —
IMPROVED ROADS	— — — — —
KING'S HIGHWAYS	— — — — —
RAILWAYS	— — — — —
POWER LINES	— — — — —
MARSH OR MUSKEG	— — — — —
MINES	Ⓜ
CANCELLED	Ⓢ

NOTES

400' Surface Rights Reservation around all lakes and rivers.

Flooding Rights in Peterlong and Mica Lakes assigned to H.E.P.C. L.O. 7190. File II62 Vol.4

Areas withdrawn from staking under Section 43 of the Mining Act, R.S.O. 1970

Order No	File	Date	Disposition
① W.23/77	188543	11/3/77	S.R.O.
② W.19/78	188543	10/4/78	S.R.O.

~~IIIIII~~ PLANNED REFORESTATION
M. 304 2/83

Ⓟ THIS TWP. SUBJECT TO FOREST ACTIVITIES IN 1992/93. FURTHER INFORMATION AVAILABLE ON FILE.

REMOVED FROM SERVICE 92-NOV-13

Received May 8/80

PLAN NO. **M.304**

ONTARIO

MINISTRY OF NATURAL RESOURCES

SURVEYS AND MAPPING BRANCH

DOYLE TWP. M.275

BARTLETT TWP. M.262

BEEMER TWP. M.656

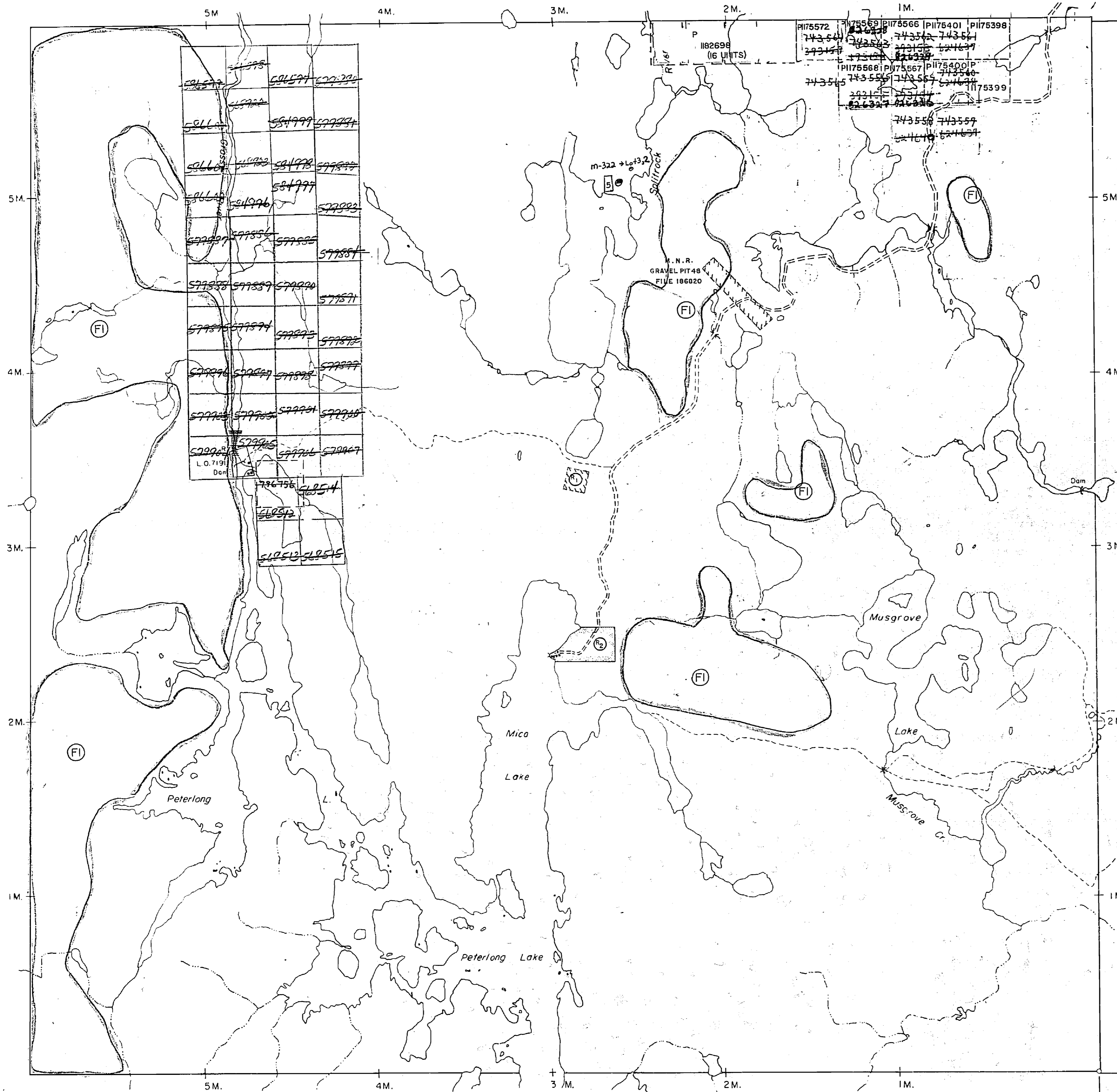

THAT MAP
ILED
CES,
NOT
USE
MIN-
ON-
NG
OF
D.
D.
N
E

P.F.K.

INDEX TO LAND DISPOSITION

PLAN
G-3962
 TOWNSHIP
MUSGROVE

M.N.R. ADMINISTRATIVE DISTRICT
TIMMINS
 MINING DIVISION
PORCUPINE
 LAND TITLES/REGISTRY DIVISION
TIMISKAMING

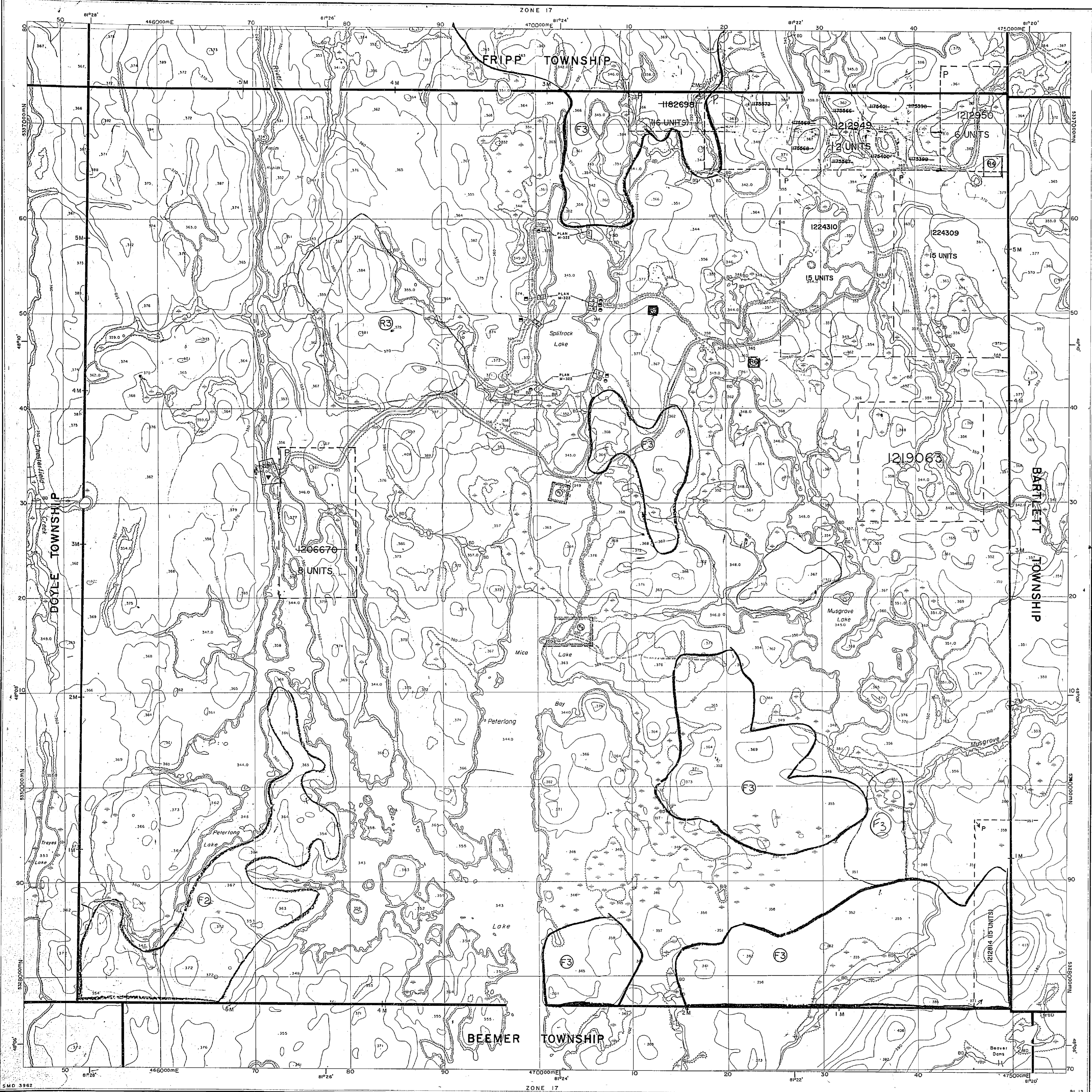
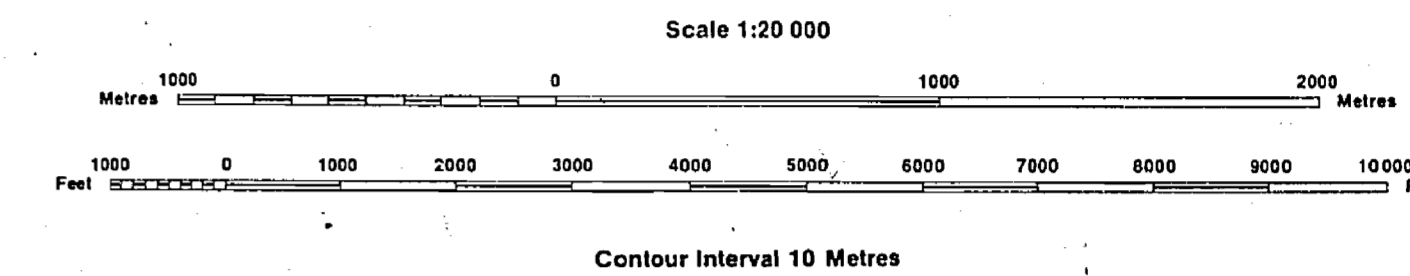

SYMBOLS

- Boundary
 - Township, Meridian, Baseline.....
 - Road allowance; surveyed.....
 - shoreline.....
 - Lot/Concession; surveyed.....
 - unsurveyed.....
 - Parcel; surveyed.....
 - unsurveyed.....
 - Right-of-way; road.....
 - railway.....
 - utility.....
- Reservation.....
- Cliff, Pit, Pile.....
- Contour
 - Interpolated.....
 - Approximate.....
 - Depression.....
- Control point (horizontal).....
- Flooded land.....
- Mine head frame.....
- Pipeline (above ground).....
- Railway: single track.....
- double track.....
- abandoned.....
- Road; highway, county, township.....
- access.....
- trail, bush.....
- Shoreline (original).....
- Transmission line.....
- Wooded area.....

AREAS WITHDRAWN FROM DISPOSITION

MRO - Mining Rights Only
 SRO - Surface Rights Only
 M + S - Mining and Surface Rights

Description	Order No.	Date	Disposition	File
(M)	W 23/77	11/3/77	S.R.O.	188543
(S)	W 19/78	10/4/78	S.R.O.	188543

(F3) THIS TWP. SUBJECT TO FOREST ACTIVITY IN 1994-95. FURTHER INFORMATION AVAILABLE ON FILE.

(M) MINING RIGHTS ONLY WITHDRAWN FROM PROSPECTING, STAKING OUT, SALE OR LEASE UNDER SECTION 35 OF THE MINING ACT, R.S.O. 1990 DATED 93-JAN-23 ORDER NO. W-P 04/93 NER

(S) MINING AND SURFACE RIGHTS WITHDRAWN FROM PROSPECTING, STAKING OUT, SALE OR LEASE UNDER SECTION 35 OF THE MINING ACT R.S.O. 1990 ORDER NO. W-P 52/94 NER DATED 94-MAY-02

(M) MINING AND SURFACE RIGHTS WITHDRAWN FROM PROSPECTING, STAKING OUT, SALE OR LEASE UNDER SECTION 35 OF THE MINING ACT R.S.O. 1990 ORDER NO. W-P 63/94 NER DATED 94-MAY-02

(S) MINING AND SURFACE RIGHTS WITHDRAWN FROM PROSPECTING, STAKING OUT, SALE OR LEASE UNDER SECTION 35 OF THE MINING ACT R.S.O. 1990 ORDER NO. W-P 54/94 NER DATED 94-MAY-02

(F3) THIS TWP SUBJECT TO FOREST ACTIVITY IN 1995-96. FURTHER INFORMATION AVAILABLE ON FILE.

L.O. 7191 HYDRO FLOODING

DATE OF ISSUE

MAY 19 1998
 PROVINCIAL RECORDING
 OFFICE - SUBURBY

DISPOSITION OF CROWN LANDS

- Patent
 - Surface & Mining Rights.....
 - Surface Rights Only.....
 - Mining Rights Only.....
- Lease
 - Surface & Mining Rights.....
 - Surface Rights Only.....
 - Mining Rights Only.....
- Licence of Occupation.....
- Order-in-Council.....
- Cancelled.....
- Reservation.....
- Sand & Gravel.....

THE INFORMATION THAT APPEARS ON THIS MAP HAS BEEN COMPILED FROM VARIOUS SOURCES AND ACCURACY IS NOT GUARANTEED. THOSE WISHING TO STAKE MINING CLAIMS SHOULD CONSULT WITH THE MINING RECORDER, MINISTRY OF NORTHERN DEVELOPMENT AND MINES, FOR ADDITIONAL INFORMATION ON THE STATUS OF THE LANDS SHOWN HEREON.

304

MUSGROVE

PORCUPINE MINING DIVISION

PORCUPINE
 RECEIVED
 SEP 25 1967
 AN 78010112123456

SCALE 40 CHAINS = 1 INCH

M-304

FRIPP

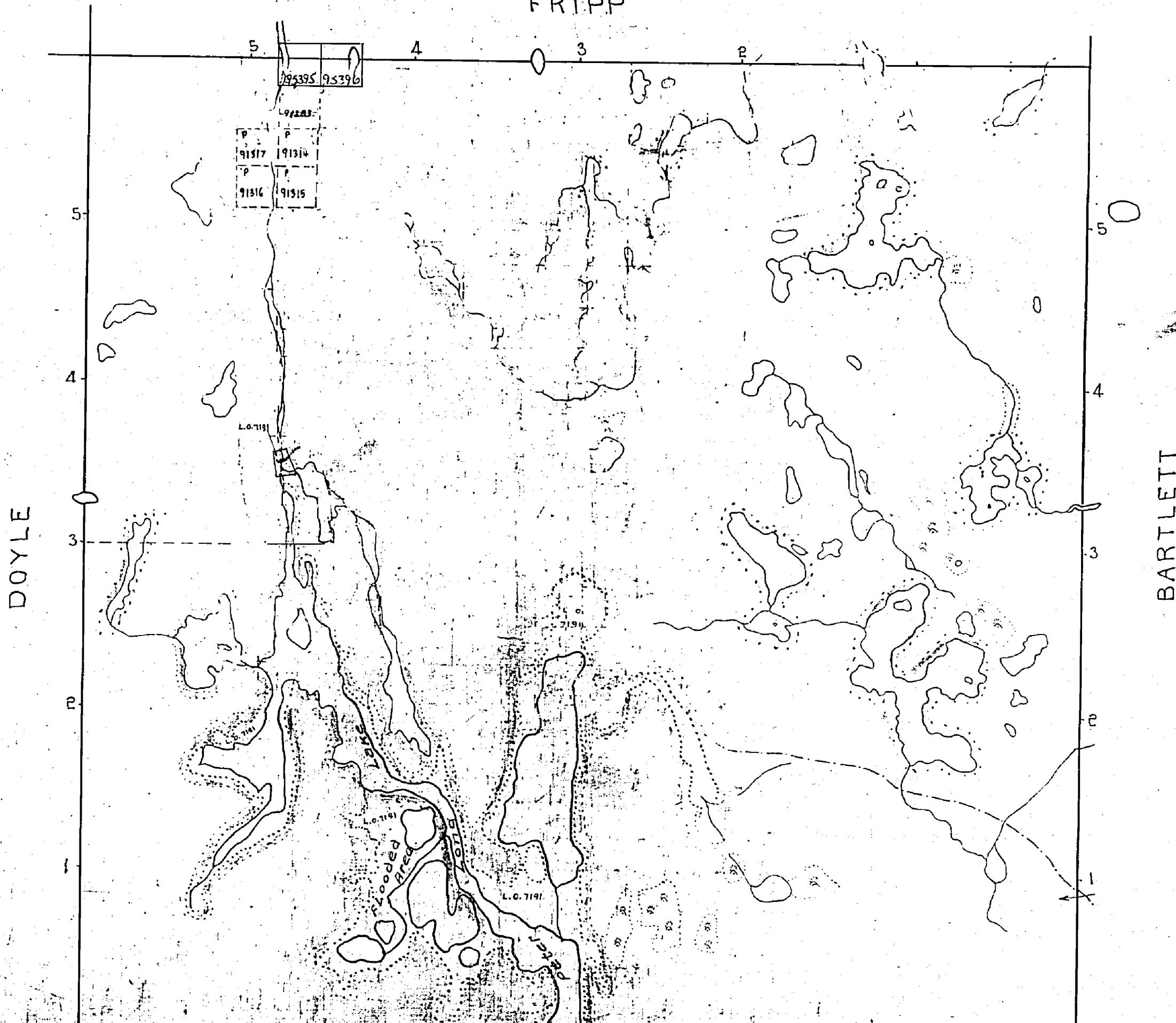

Porcupine Mining Division
 Sudbury Mining Division
 PATENTED LAND
 CROWN LAND SALE
 LEASES
 LOCATOR LAND
 LICENSE OF OCCUPATION
 MINING RIGHTS ONLY
 SURFACE RIGHTS ONLY

©
 C.S.
 ©
 LOC.
 L.O.
 M.R.O.
 S.R.O.



Ministry of Natural Resources

Ministry of Northern Development and Mines

INDEX TO LAND DISPOSITION

PLAN
G-3962
TOWNSHIP
MUSGROVE

M.N.R. ADMINISTRATIVE DISTRICT
TIMMINS
MINING DIVISION
PORCUPINE
LAND TITLES/REGISTRY DIVISION
TIMISKAMING

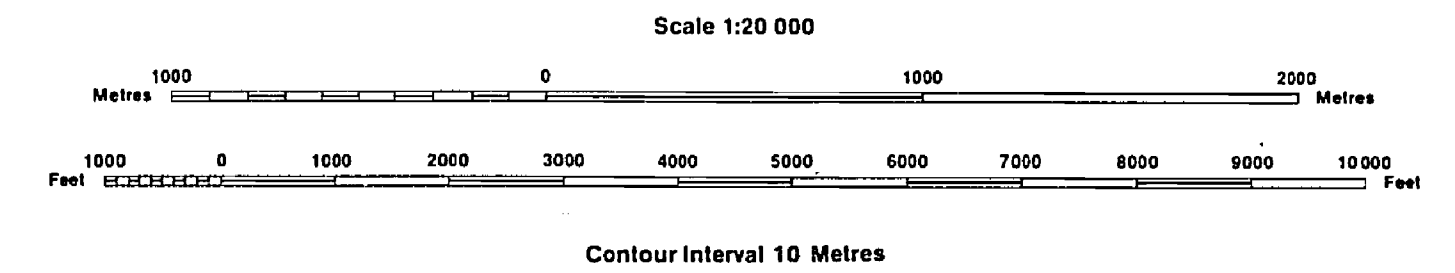

AREAS WITHDRAWN FROM DISPOSITION

MRO - Mining Rights Only
SRO - Surface Rights Only
M + S - Mining and Surface Rights

Description	Order No.	Date	Disposition	File
W 23/77	11/3/77	S.R.O.		188543
W 15/78	10/4/78	S.R.O.		188543

SYMBOLS

Boundary
Township, Meridian, Baseline
Road allowance; surveyed
shoreline
Lot/Concession; surveyed
unsurveyed
Parcel; surveyed
unsurveyed
Right-of-way; road
railway
utility
Reservation
Chill, Pit, Pile
Contour
Interpolated
Approximate
Depression
Control point (horizontal)
Flooded land
Mine head frame
Pipeline (above ground)
Railway; single track
double track
abandoned
Road; highway, county, township
access
trail, bush
Shoreline (original)
Transmission line
Wooded area

THIS TWP SUBJECT TO FOREST ACTIVITY IN 1994/95. FURTHER INFORMATION AVAILABLE ON FILE.

MINING RIGHTS ONLY WITHDRAWN FROM PROSPECTING, STAKING OUT, SALE OR LEASE UNDER SECTION 35 OF THE MINING ACT, R.S.O. 1990 ORDER NO. W-P 04/95 NER

MINING AND SURFACE RIGHTS WITHDRAWN FROM PROSPECTING, STAKING OUT, SALE OR LEASE UNDER SECTION 35 OF THE MINING ACT R.S.O. 1990 ORDER NO. W-P 52/94 NER DATED 94-MAY-02

MINING AND SURFACE RIGHTS WITHDRAWN FROM PROSPECTING, STAKING OUT, SALE OR LEASE UNDER SECTION 35 OF THE MINING ACT R.S.O. 1990 ORDER NO. W-P 53/94 NER DATED 94-MAY-02

MINING AND SURFACE RIGHTS WITHDRAWN FROM PROSPECTING, STAKING OUT, SALE OR LEASE UNDER SECTION 35 OF THE MINING ACT R.S.O. 1990 ORDER NO. W-P 54/94 NER DATED 94-MAY-02

THIS TWP SUBJECT TO FOREST ACTIVITY IN 1995-96. FURTHER INFORMATION AVAILABLE ON FILE.

L.O. 7191 HYDRO FLOODING

DISPOSITION OF CROWN LANDS

Patent
Surface & Mining Rights
Surface Rights Only
Mining Rights Only
Lease
Surface & Mining Rights
Surface Rights Only
Mining Rights Only
Licence of Occupation
Order-in-Council
Cancelled
Reservation
Sand & Gravel

ACTIVATED 92-NOV-13

Map base and land disposition drafting by Surveys and Mapping Branch, Ministry of Natural Resources.

The disposition of land, location of lot fabric and parcel boundaries on this index was compiled for administrative purposes only.

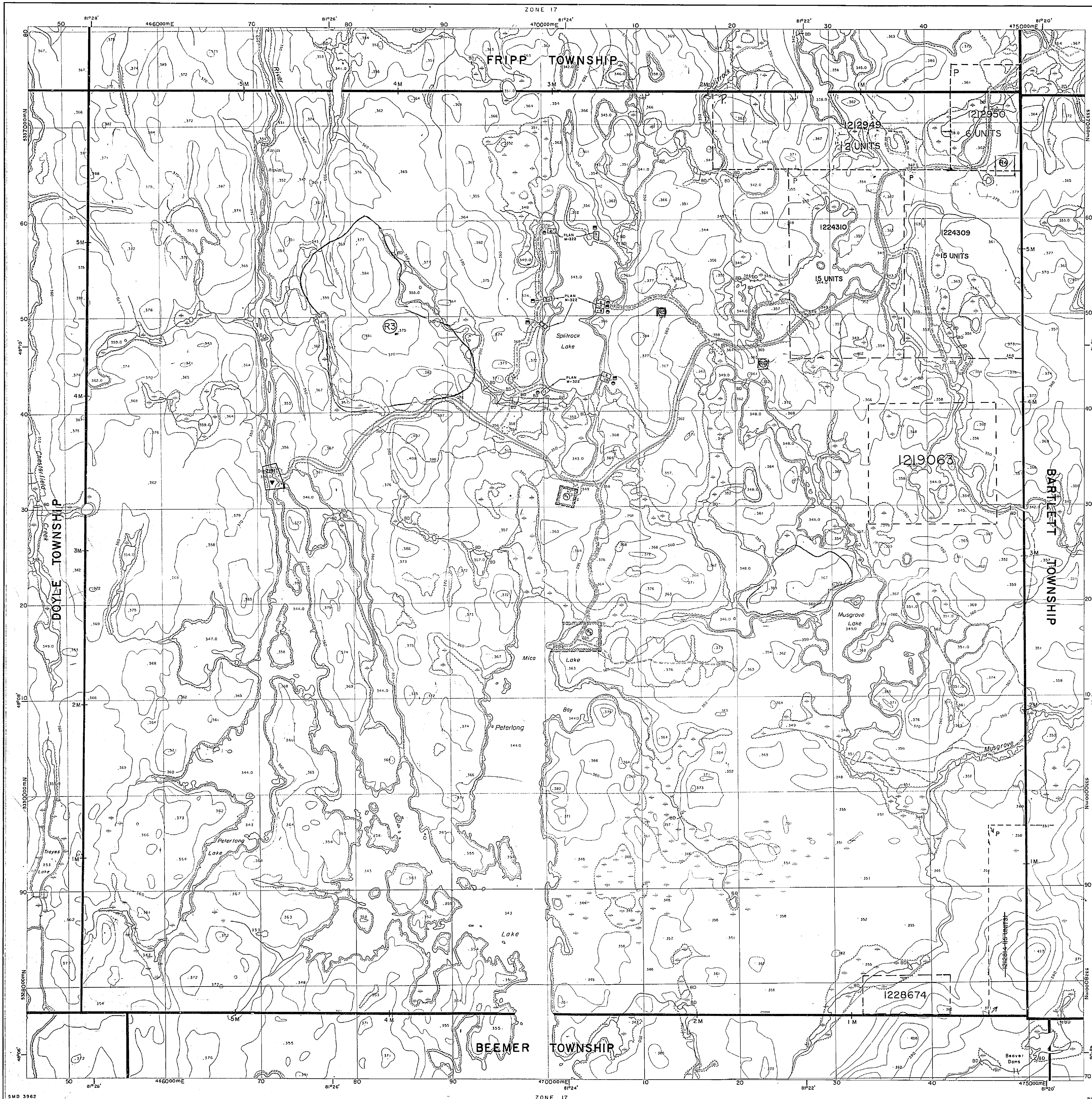

THE INFORMATION THAT APPEARS ON THIS MAP HAS BEEN COMPILED FROM VARIOUS SOURCES, AND ACCURACY IS NOT GUARANTEED. THOSE WISHING TO STAKE MINING CLAIMS SHOULD CONSULT WITH THE MINING RECORDER, MINISTRY OF NORTHERN DEVELOPMENT AND MINES, FOR ADDITIONAL INFORMATION ON THE STATUS OF THE LANDS SHOWN HEREON.

304

MUSGROVE

PORCUPINE MINING DIVISION

SCALE 40 CHAINS = 1 INCH

FRIPP

M. 304

MINING RECORDER
RECEIVED
NOV 30 1964

PORCUPINE
MINING DIVISION

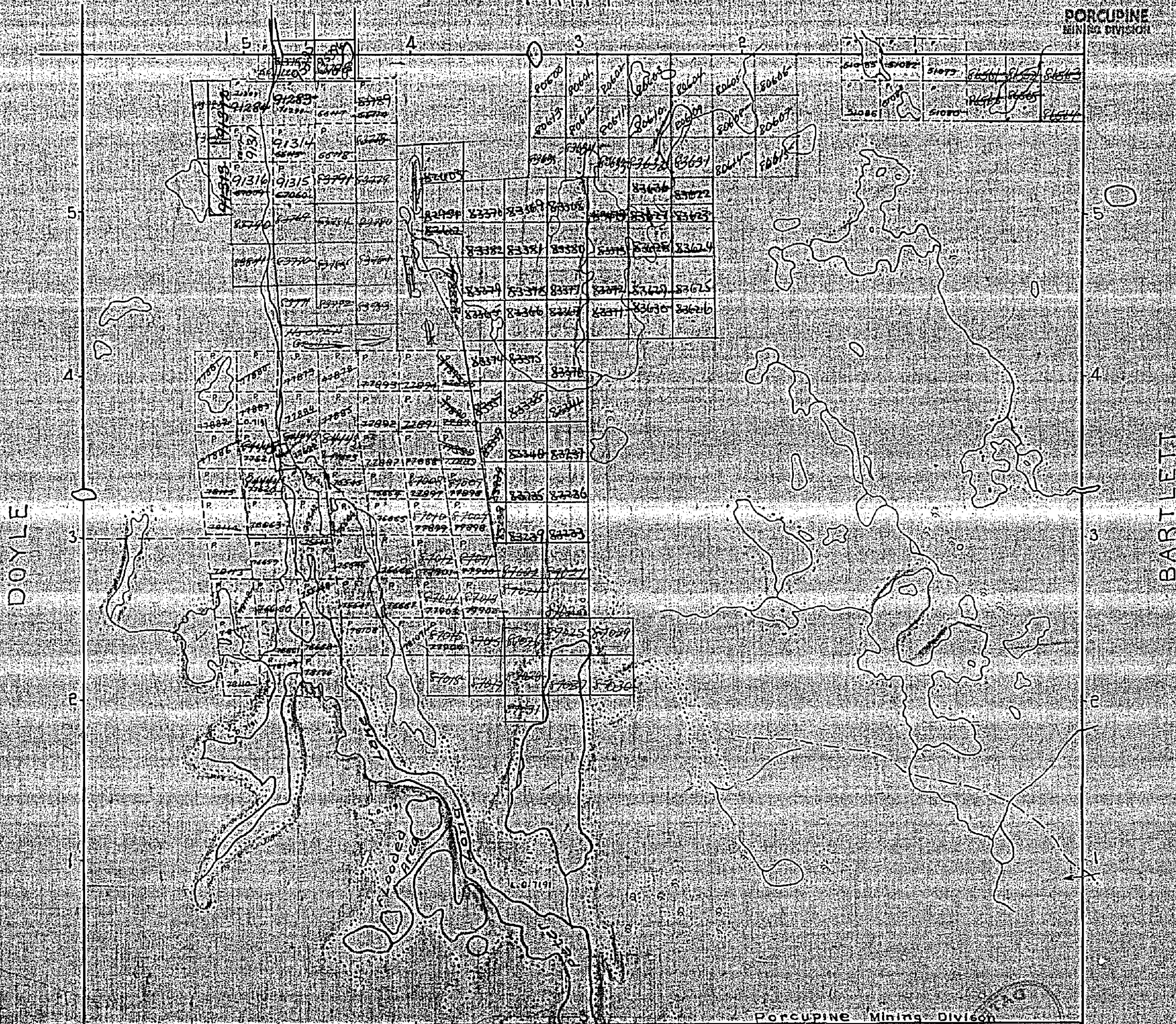

Porcupine Mining Division
 Sudbury Mining Division

PATENTED LAND
 TOWN LAND SALE
 LEASE
 EASE
 LICENSE OF OCCUPATION
 MINE
 WATER RIGHTS ONLY
 CONTRACT RIGHTS ONLY

1951

NOV 18 1951

PORCUPINE
MINING DIVISION

MUSGROVE

M 304

304

PORCUPINE MINING DIVISION

TEMAGAMI PROVINCIAL FOREST

SCALE 40 CHAINS = 1 INCH

FRIPP

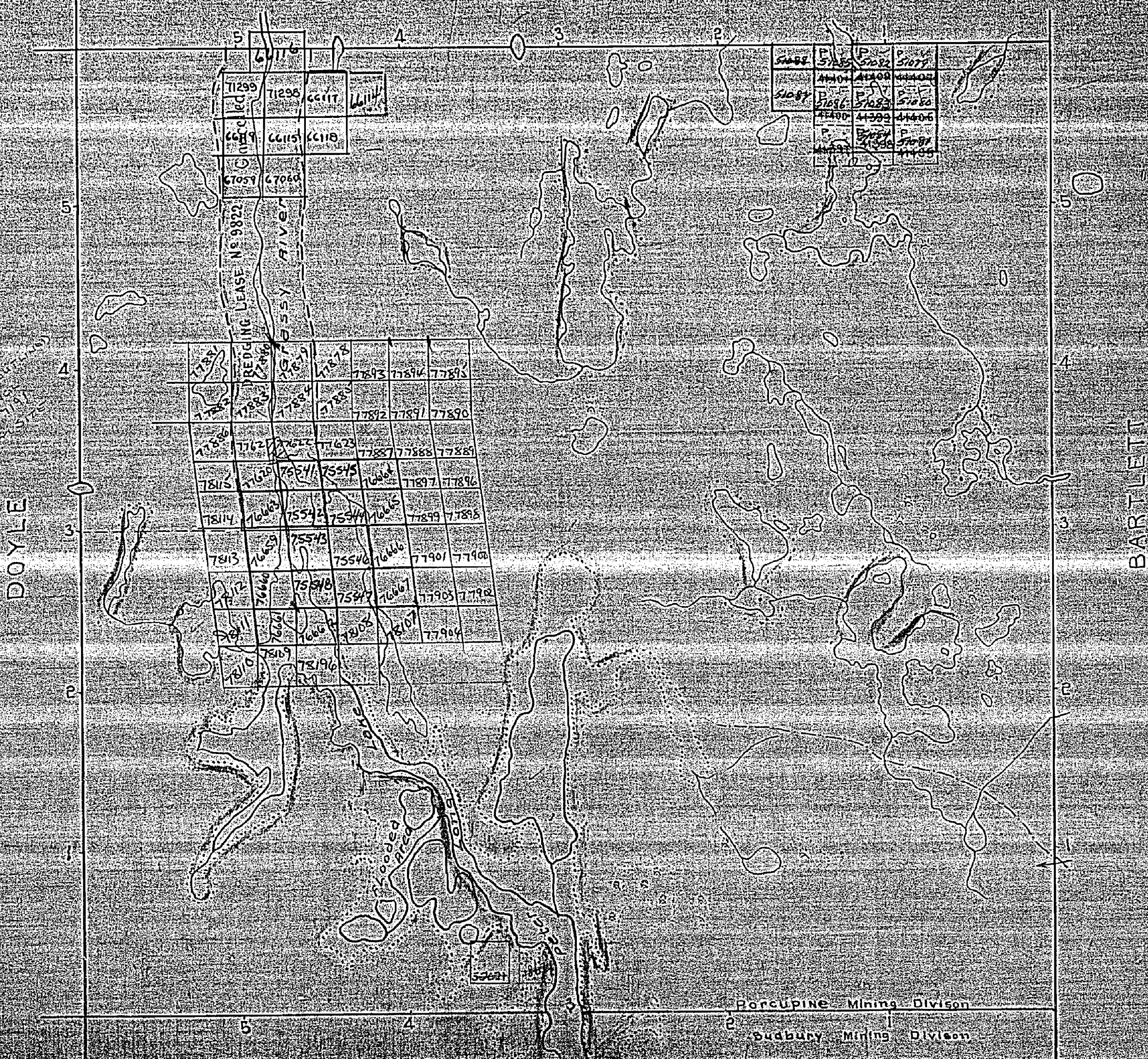

Porcupine Mining Division
Sudbury Mining Division

MUSGROVE

77 304

PORCUPINE MINING DIVISION

304

SCALE 40 CHAINS = 1 INCH

FRIPP

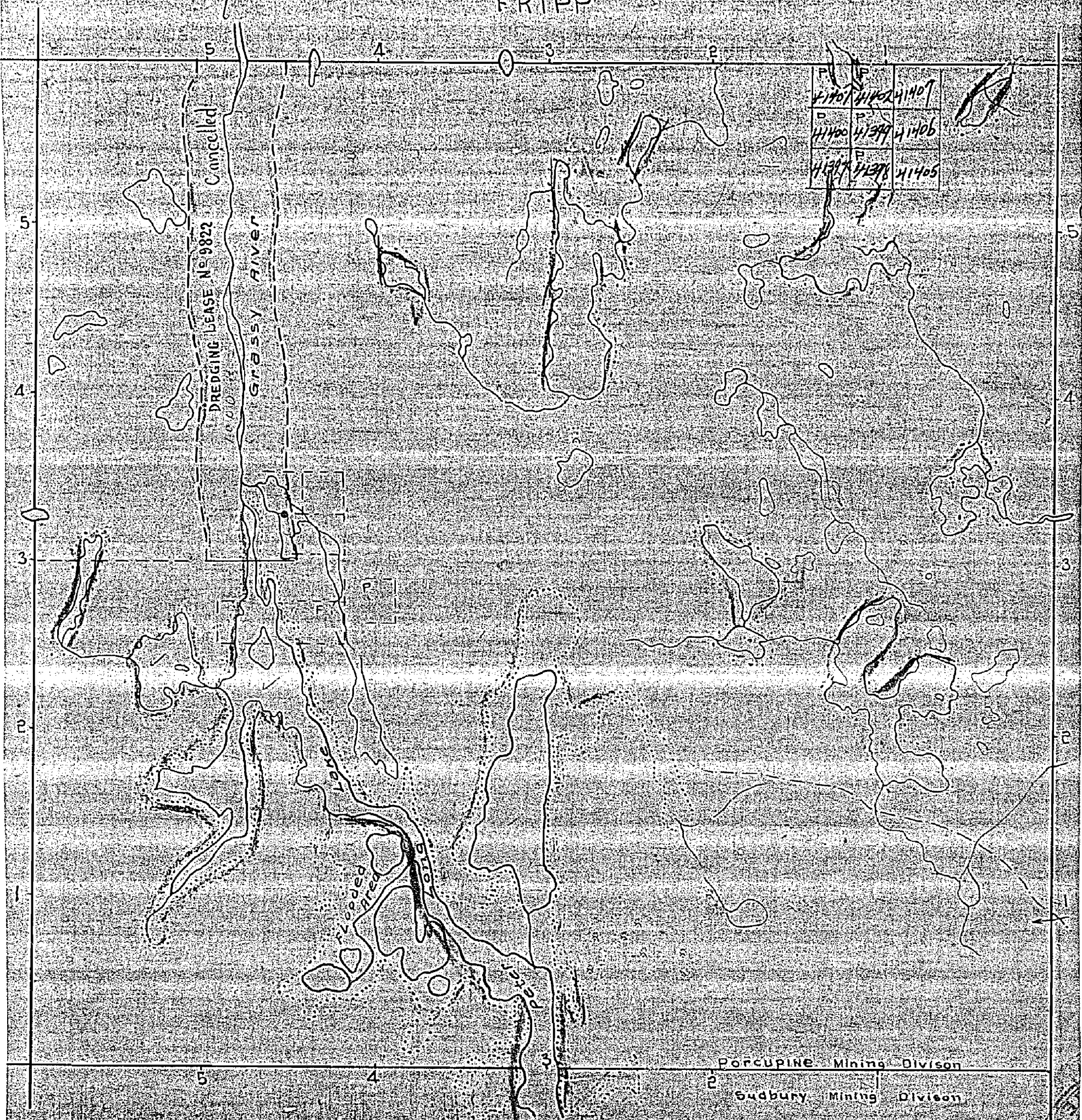

Porcupine Mining Division

Sudbury Mining Division

reservations 100 wide by Dept of P.C.F.

304

FRIPP TWP. M.281

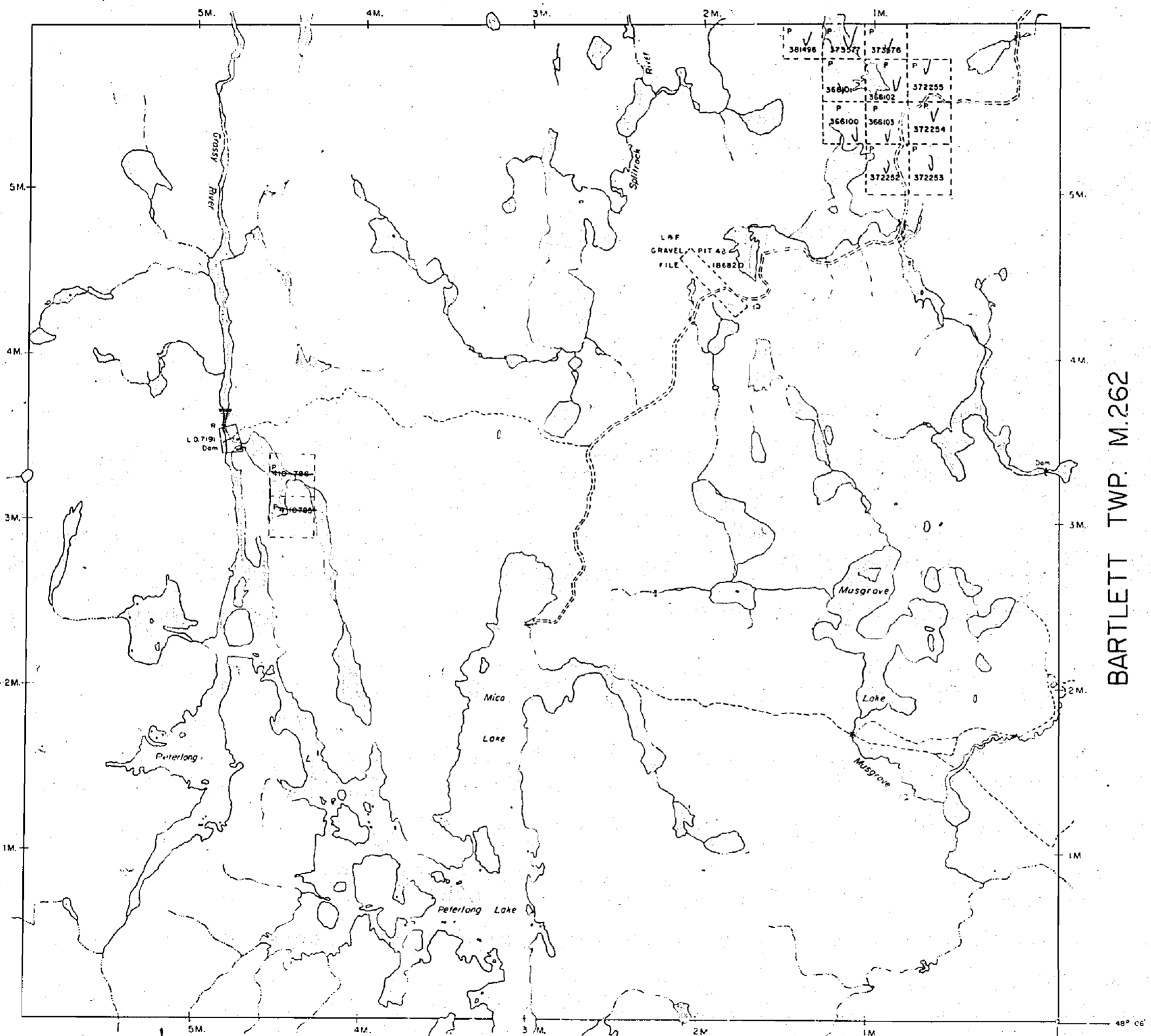

THE TOWNSHIP
OF
MUSGROVE

DISTRICT OF
TIMISKAMING

FORCUPINE
MINING DIVISION

SCALE: 1-INCH 40 CHAINS

LEGEND

PATENTED LAND	Ⓟ
CROWN LAND SALE	C.S.
LEASES	Ⓛ
LOCATED LAND	Loc.
LICENSE OF OCCUPATION	L.O.
MINING RIGHTS ONLY	M.R.O.
SURFACE RIGHTS ONLY	S.R.O.
ROADS	—
IMPROVED ROADS	—
KING'S HIGHWAYS	—
RAILWAYS	—
POWER LINES	—
MARSH OR MUSKEG	—
MINES	Ⓧ
CANCELLED	C

NOTES

400' Surface Rights Reservation around all lakes and rivers.

Flooding Rights in Peterlong C. Mica lakes assigned to HEPC L.O. 7191
File 1162 Vol. 4



PLAN NO. **M.304**

ONTARIO
MINISTRY OF NATURAL RESOURCES
SURVEYS AND MAPPING BRANCH

304

MUSGROVE

PORCUPINE MINING DIVISION

SCALE 40 CHAINS TO AN INCH

FRIPP

M. 304

MINING RECORDS
RECEIVED
NOV 30 1964

PORCUPINE
MINING DIVISION

DOYLE

BARTLETT

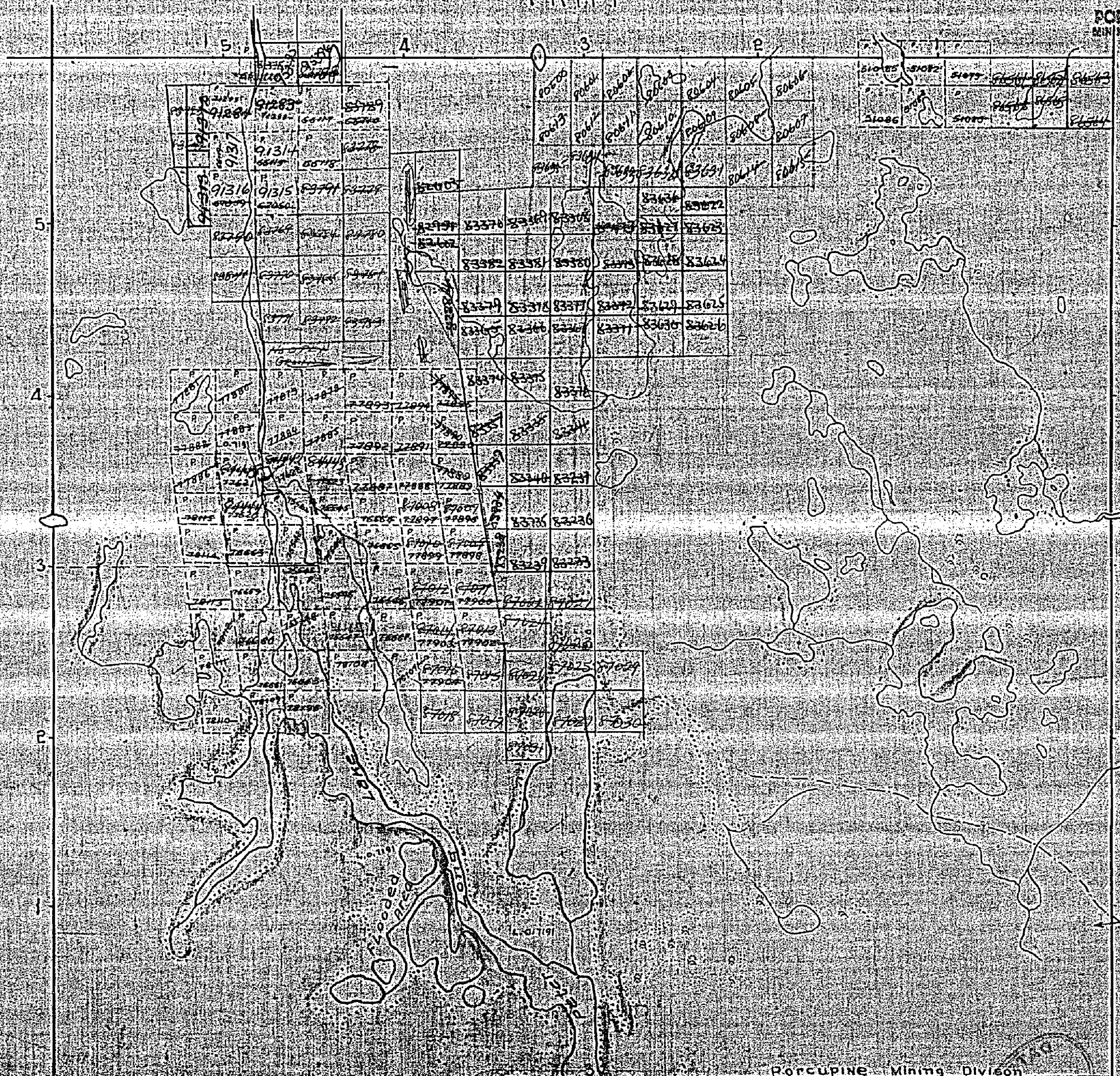

Porcupine Mining Division

Gudbury Mining Division

PATENTED LAND
CROWN LAND SALE
LOCATED LAND
LICENSE OF OCCUPATION
MINING RIGHTS

Log 105
105
105
105

304

MUSGROVE

PORCUPINE MINING DIVISION

RECEIVED
 SEP 25 1967
 AM 7 8 9 10 11 12 1 2 3 4 5 6 PM

SCALE 40 CHAINS = 1 INCH

M.304

FRIPP

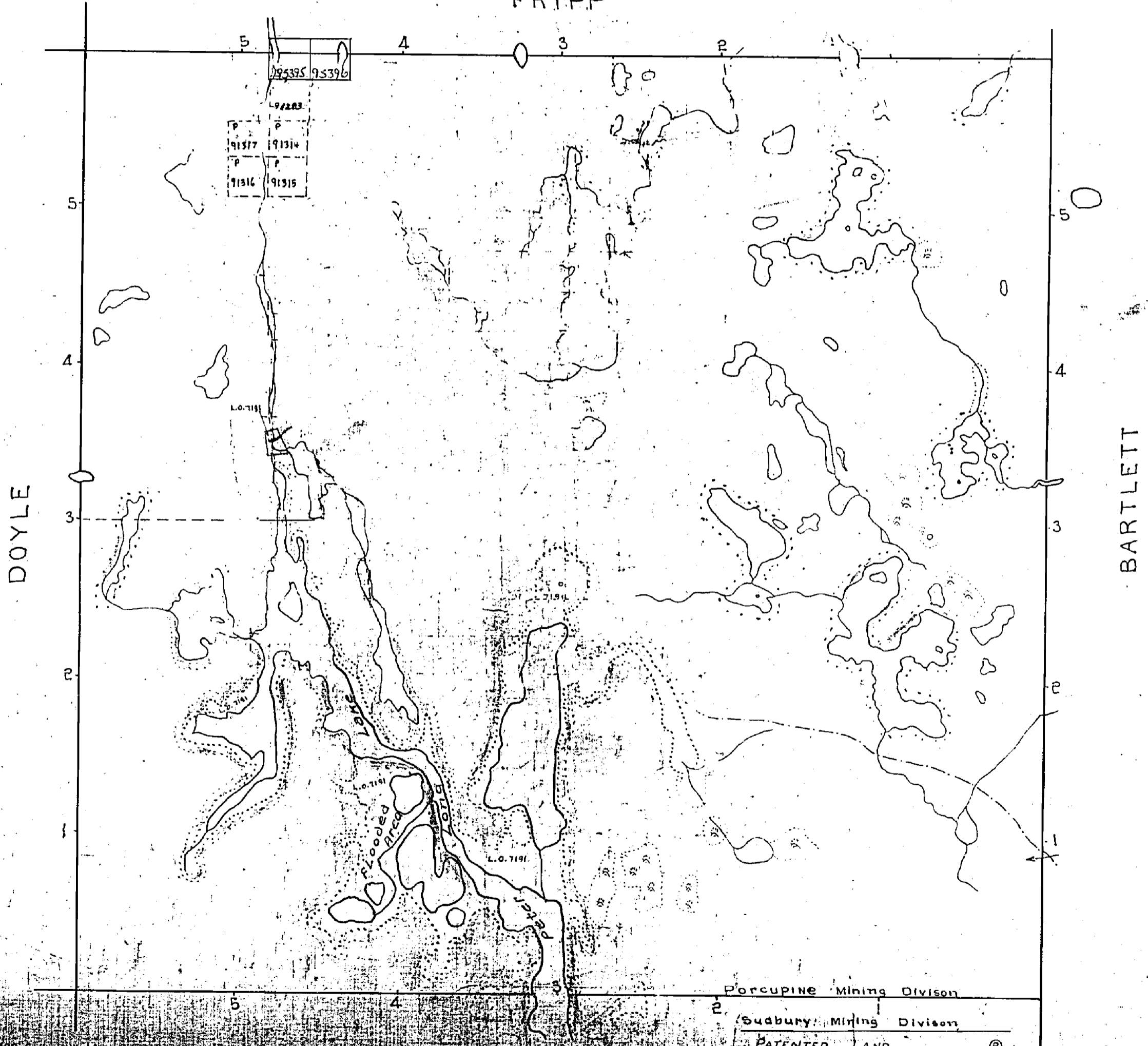

DOYLE

BARTLETT

BREMER

Porcupine Mining Division
 Sudbury Mining Division

- PATENTED LAND ©
- CROWN LAND SALE C.S.
- LEASES L
- LOCATED LAND LOC
- LICENSE OF OCCUPATION LO
- MINING RIGHTS ONLY M.R.O.
- SURFACE RIGHTS ONLY S.R.O.

Water rights reservation on ground all rivers