

NOTES

AREAS WITHDRAWN FROM DISPOSITION

M.R.O. - MINING RIGHTS ONLY

S.R.O. - SURFACE RIGHTS ONLY

M.+S. - MINING AND SURFACE RIGHTS

Description Order No. Date Disposition File

KOSNY TWP.

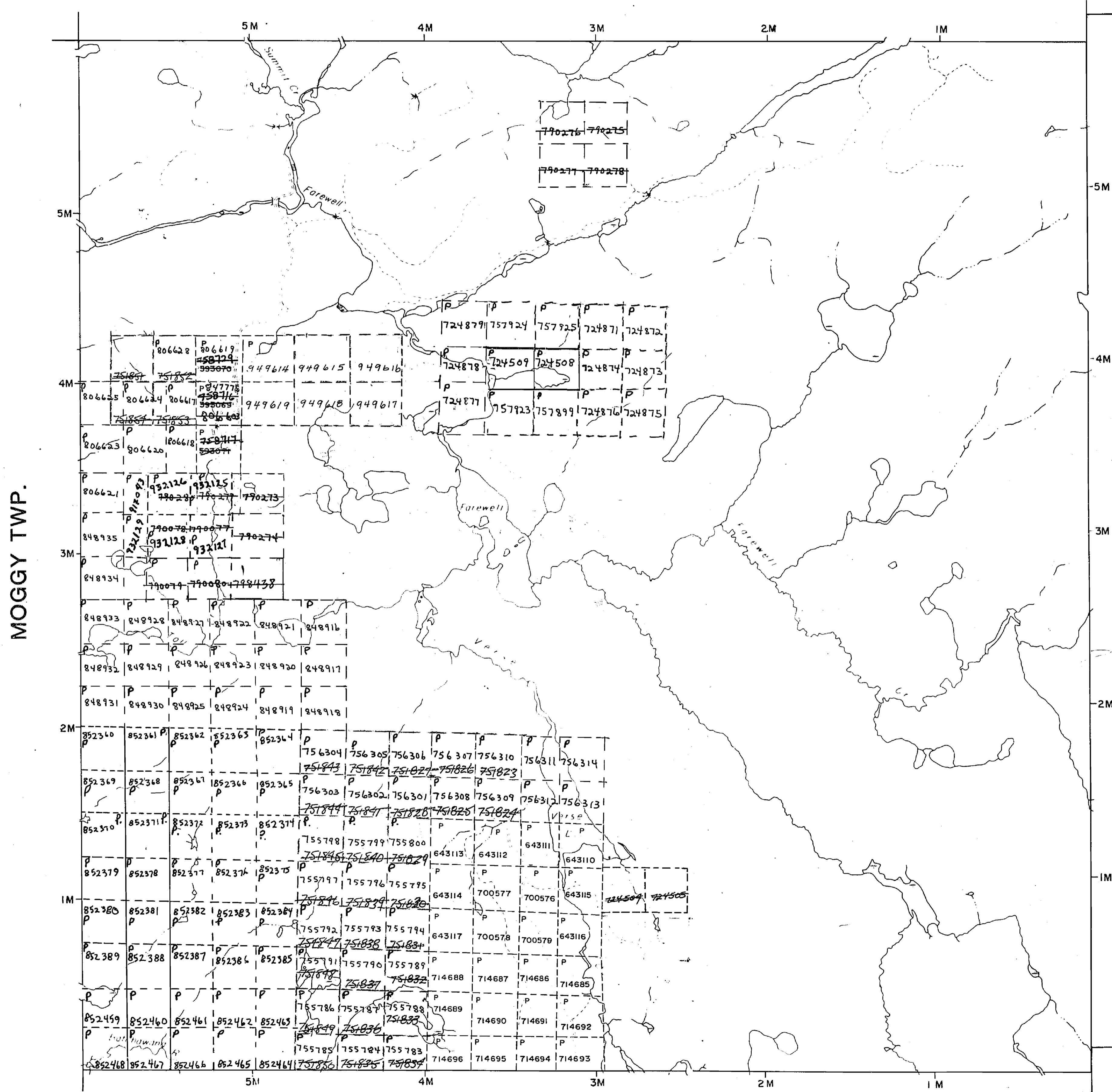

LEGEND

- HIGHWAY AND ROUTE No.
- OTHER ROADS
- TRAILS
- SURVEYED LINES:
 - TOWNSHIPS, BASE LINES, ETC.
 - LOTS, MINING CLAIMS, PARCELS, ETC.
- UNSURVEYED LINES:
 - LOT LINES
 - PARCEL BOUNDARY
 - MINING CLAIMS ETC.
- RAILWAY AND RIGHT OF WAY
- UTILITY LINES
- NON-PERENNIAL STREAM
- FLOODING OR FLOODING RIGHTS
- SUBDIVISION OR COMPOSITE PLAN
- RESERVATIONS
- ORIGINAL SHORELINE
- MARSH OR MUSKEG
- MINES
- TRAVERSE MONUMENT

DISPOSITION OF CROWN LANDS

TYPE OF DOCUMENT	SYMBOL
PATENT, SURFACE & MINING RIGHTS	
" SURFACE RIGHTS ONLY	
" MINING RIGHTS ONLY	
LEASE, SURFACE & MINING RIGHTS	
" SURFACE RIGHTS ONLY	
" MINING RIGHTS ONLY	
LICENCE OF OCCUPATION	
ORDER-IN-COUNCIL	
RESERVATION	
CANCELLED	
SAND & GRAVEL	

NOTE: MINING RIGHTS IN PARCELS PATENTED PRIOR TO MAY 6, 1913, VESTED IN ORIGINAL PATENTEE BY THE PUBLIC LANDS ACT, R.S.O. 1970, CHAP. 380, SEC. 63, SUBSEC. 1.

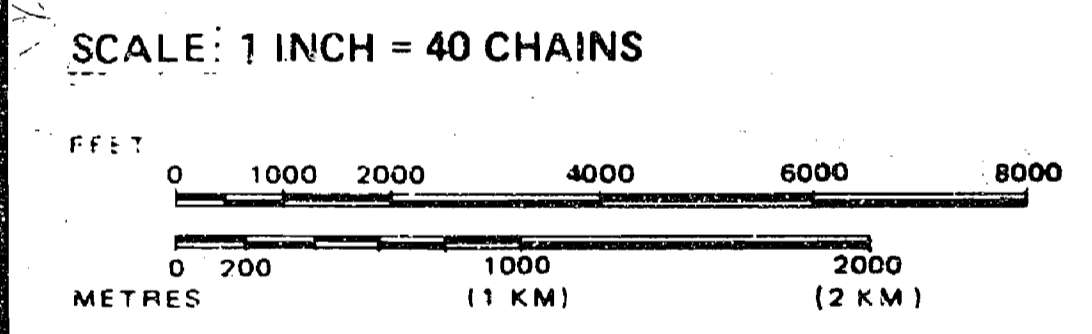

TOWNSHIP

NEILL

M.N.R. ADMINISTRATIVE DISTRICT

CHAPLEAU

MINING DIVISION

SAULT STE. MARIE

LAND TITLES / REGISTRY DIVISION

SUDBURY

Ontario Ministry of Natural Resources Land Management Branch

Date JULY, 1983 Number **G-2476**

SAULT STE. MARIE MINING DIV. RECEIVED JUL 16 1983

SHERRATT TWP.

Replaced by O.B.M. - Feb 17/88

NOTES

AREAS WITHDRAWN FROM DISPOSITION

M.R.O. - MINING RIGHTS ONLY
 S.R.O. - SURFACE RIGHTS ONLY
 M.+S. - MINING AND SURFACE RIGHTS

Description	Order No.	Date	Disposition	File

KOSNY TWP.

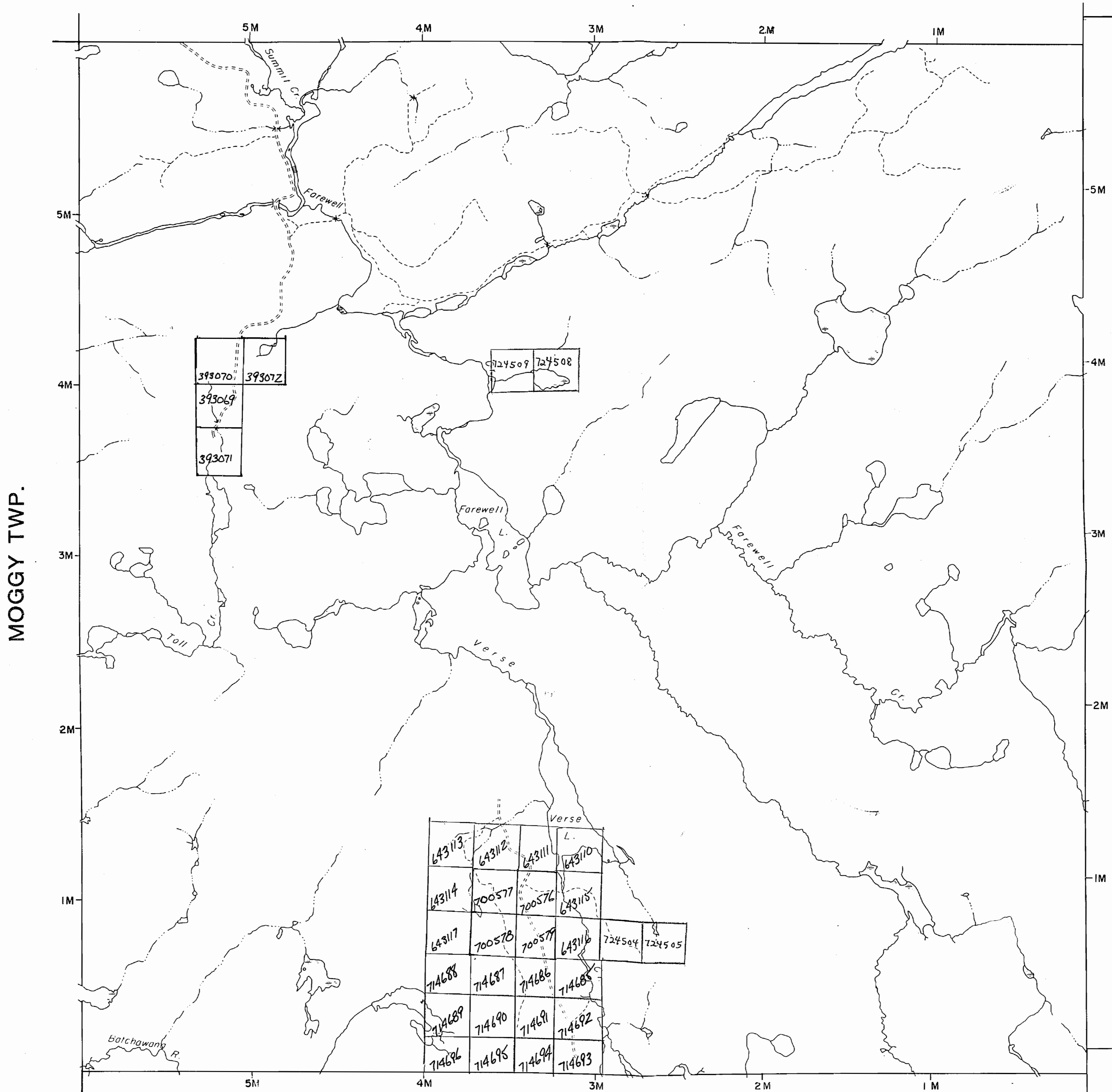

MOGGY TWP.

PATENAUDE TWP.

SHERRATT TWP.

LEGEND

HIGHWAY AND ROUTE No.	
OTHER ROADS	
TRAILS	
SURVEYED LINES:	
TOWNSHIPS, BASE LINES, ETC.	
LOTS, MINING CLAIMS, PARCELS, ETC.	
UNSURVEYED LINES:	
LOT LINES	
PARCEL BOUNDARY	
MINING CLAIMS ETC.	
RAILWAY AND RIGHT OF WAY	
UTILITY LINES	
NON-PERENNIAL STREAM	
FLOODING OR FLOODING RIGHTS	
SUBDIVISION OR COMPOSITE PLAN	
RESERVATIONS	
ORIGINAL SHORELINE	
MARSH OR MUSKEG	
MINES	
TRAVERSE MONUMENT	

DISPOSITION OF CROWN LANDS

TYPE OF DOCUMENT	SYMBOL
PATENT, SURFACE & MINING RIGHTS	
" SURFACE RIGHTS ONLY	
" MINING RIGHTS ONLY	
LEASE, SURFACE & MINING RIGHTS	
" SURFACE RIGHTS ONLY	
" MINING RIGHTS ONLY	
LICENCE OF OCCUPATION	
ORDER-IN-COUNCIL	
RESERVATION	
CANCELLED	
SAND & GRAVEL	

NOTE: MINING RIGHTS IN PARCELS PATENTED PRIOR TO MAY 6, 1913, VESTED IN ORIGINAL PATENTEE BY THE PUBLIC LANDS ACT, R.S.O. 1970, CHAP. 380, SEC. 63, SUBSEC 1.

SCALE: 1 INCH = 40 CHAINS

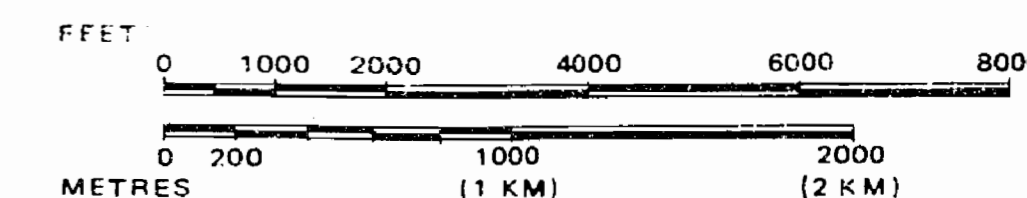

TOWNSHIP

NEILL

M.N.R. ADMINISTRATIVE DISTRICT

CHAPLEAU

MINING DIVISION

PORCUPINE

LAND TITLES / REGISTRY DIVISION

SUDBURY



Ontario

Ministry of Natural Resources
 Land Management Branch

Date JULY, 1983

Number

G-2476

INDEX TO LAND DISPOSITION

PLAN
G-2476
 TOWNSHIP

M.N.R. ADMINISTRATIVE DISTRICT
CHAPLEAU
 MINING DIVISION
SAULT STE. MARIE
 LAND TITLES/REGISTRY DIVISION
SUDBURY

NEILL

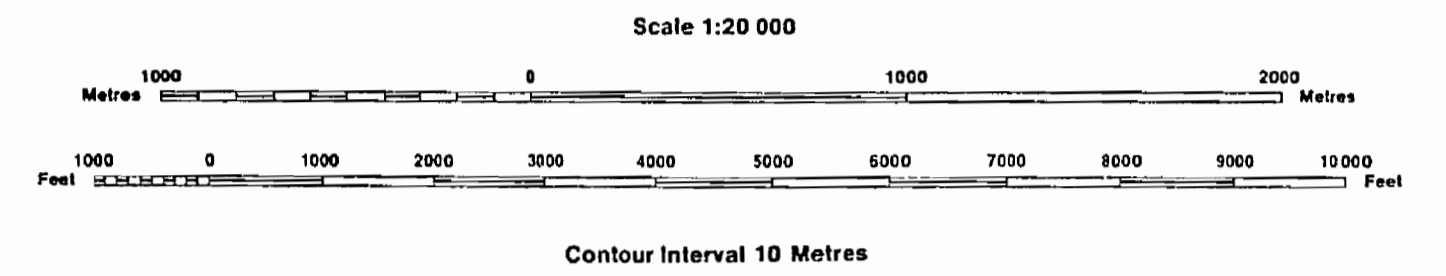

AREAS WITHDRAWN FROM DISPOSITION

MRO - Mining Rights Only
 SRO - Surface Rights Only
 M+S - Mining and Surface Rights

SYMBOLS

Description	Order No.	Date	Disposition	File
Boundary				
Township, Meridian, Baseline				
Road allowance; surveyed				
shoreline				
Lo/Concession; surveyed				
unsurveyed				
'Parcel'; surveyed				
unsurveyed				
Right-of-way; road				
railway				
utility				
Reservation				
Cliff, Pit, Pile				
Contour				
Interpolated				
Approximate				
Depression				
Control point (horizontal)				
Flooded land				
Mine head frame				
Pipeline (above ground)				
Railway; single track				
double track				
abandoned				
Road; highway, county, township				
access				
trail, bush				
Shoreline (original)				
Transmission line				
Wooded area				

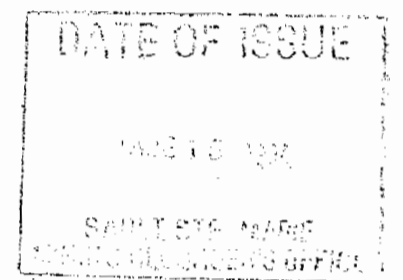

DISPOSITION OF CROWN LANDS

Patent				
Surface & Mining Rights				
Surface Rights Only				
Mining Rights Only				
Lease				
Surface & Mining Rights				
Surface Rights Only				
Mining Rights Only				
Licence of Occupation				
Order-in-Council				
Cancelled				
Reservation				
Sand & Gravel				

THE INFORMATION THAT
 APPEARS ON THIS MAP
 HAS BEEN COMPILED
 FROM VARIOUS SOURCES,
 AND ACCURACY IS NOT
 GUARANTEED. THOSE
 WISHING TO STAKE MINING
 CLAIMS SHOULD CONSULT
 WITH THE MINING
 RECORDER, MINISTRY OF
 NORTHERN DEVELOPMENT
 AND MINES, FOR ADDITIONAL
 INFORMATION ON THE STATUS OF THE
 LANDS SHOWN HEREON.

The 1973 Magnetic Bearing
 Approx. 3.5 to 10 Annual Change
 Increasing 0.1

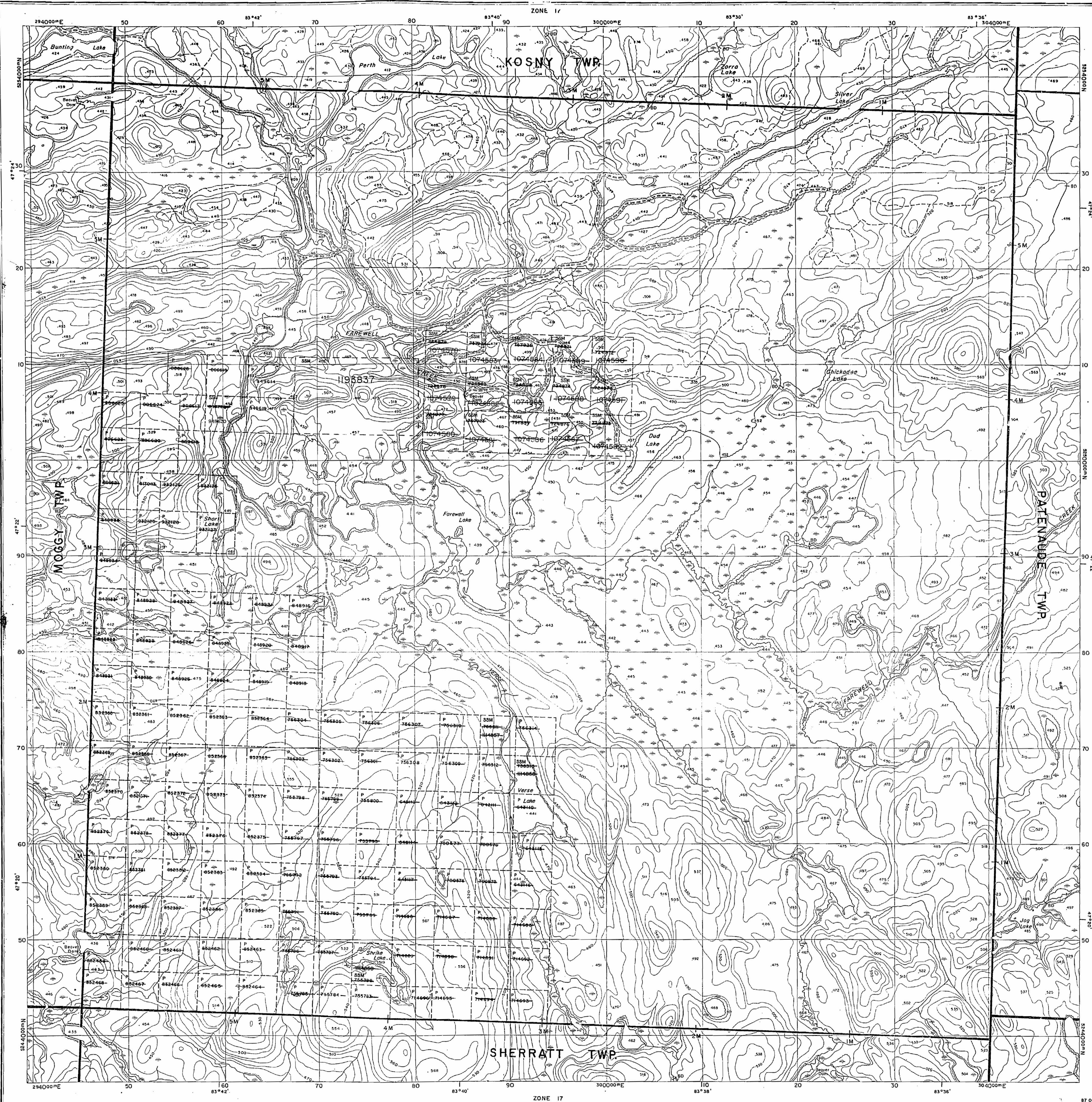



Ministry of Natural Resources

Ministry of Northern Development and Mines

INDEX TO LAND DISPOSITION

PLAN
G-2476
TOWNSHIP
NEILL

M.N.R. ADMINISTRATIVE DISTRICT
CHAPLEAU
MINING DIVISION
SAULT STE. MARIE
LAND TITLES/REGISTRY DIVISION
SUDBURY

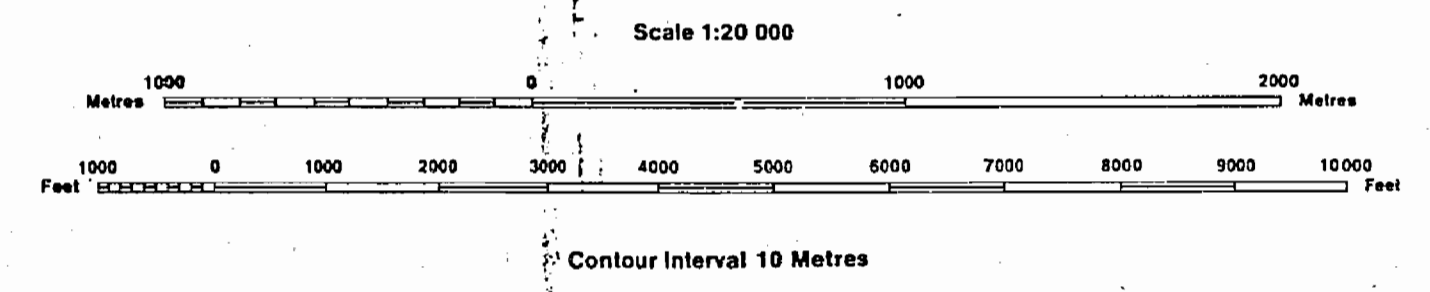

AREAS WITHDRAWN FROM DISPOSITION

- MRO - Mining Rights Only
- SRO - Surface Rights Only
- M+S - Mining and Surface Rights

SYMBOLS

Description	Order No.	Date	Disposition	File
Boundary				
Township, Meridian, Baseline				
Road allowance; surveyed				
shoreline				
Lot/Concession; surveyed				
unsurveyed				
Parcel; surveyed				
unsurveyed				
Right-of-way; road				
railway				
utility				
Reservation				
Cliff, Pit, Pile				
Contour				
Interpolated				
Approximate				
Depression				
Control point (horizontal)				
Flooded land				
Mine head frame				
Pipeline (above ground)				
Railway; single track				
double track				
abandoned				
Road; highway, county, township				
access				
trail, bush				
Shoreline (original)				
Transmission line				
Wooded area				

DATE OF ISSUE

OCT 06 1997

PROVINCIAL RECORDING
OFFICE - SUDBURY

DISPOSITION OF CROWN LANDS

Patent				
Surface & Mining Rights				
Surface Rights Only				
Mining Rights Only				
Lease				
Surface & Mining Rights				
Surface Rights Only				
Mining Rights Only				
Licence of Occupation				
Order-in-Council				
Cancelled				
Reservation				
Sand & Gravel				

THE INFORMATION THAT APPEARS ON THIS MAP HAS BEEN COMPILED FROM VARIOUS SOURCES, AND ACCURACY IS NOT GUARANTEED. THOSE WISHING TO STAKE MINING CLAIMS SHOULD CONSULT WITH THE MINING RECORDER, MINISTRY OF NORTHERN DEVELOPMENT AND MINES, FOR ADDITIONAL INFORMATION ON THE STATUS OF THE LANDS SHOWN HEREON.

The 1975 Magnetic Bearing
Approx. 22.52% Annual Change
Decreasing 0.1

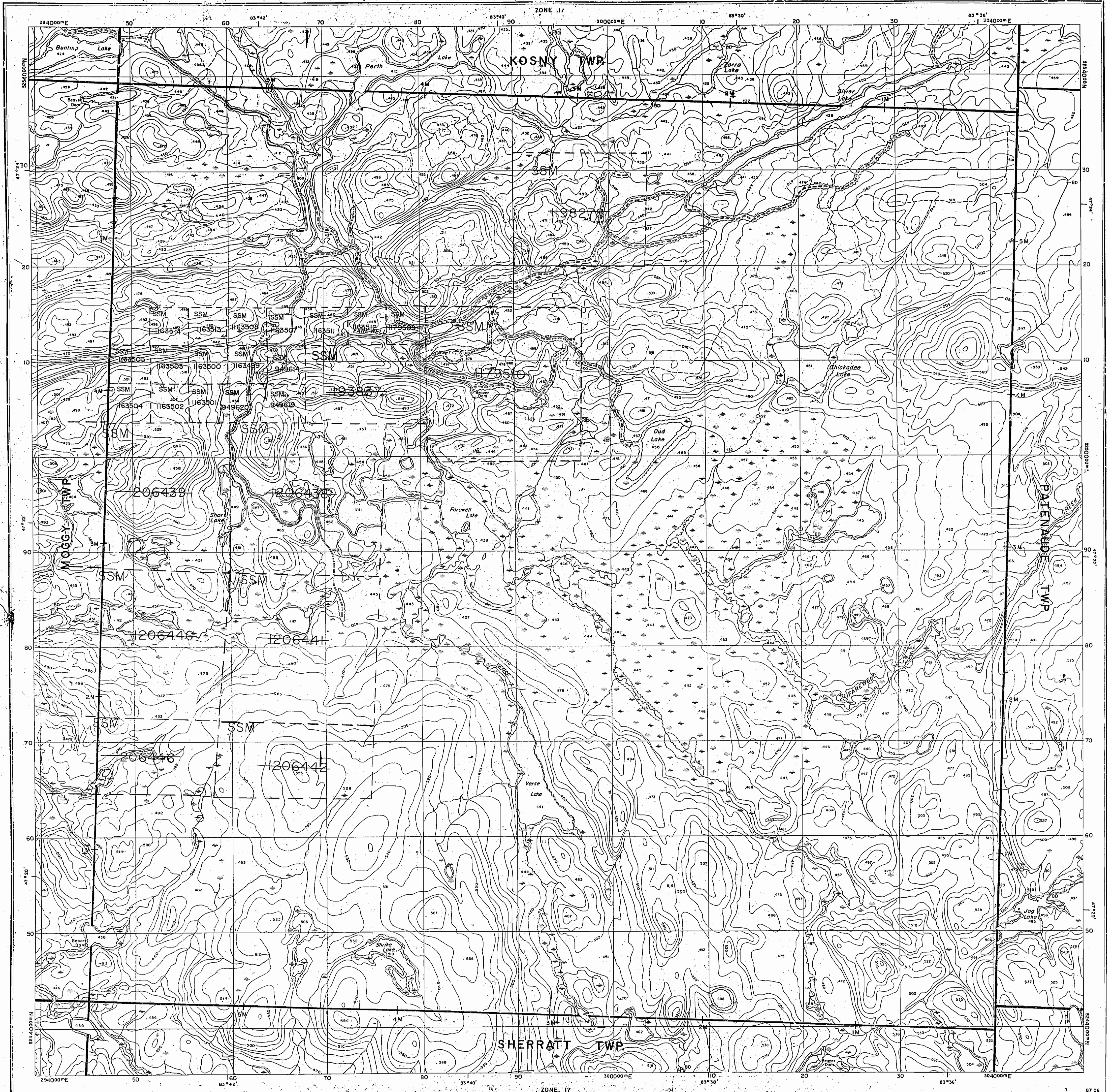



Ministry of
Natural
Resources

Ministry of
Northern Development
and Mines

INDEX TO LAND DISPOSITION

PLAN
G-2476
TOWNSHIP

NEILL

M.N.R. ADMINISTRATIVE DISTRICT
CHAPLEAU
MINING DIVISION
SAULT STE. MARIE
LAND TITLES/REGISTRY
DATE OF ISSUE
SUDBURY
JUN 08 1998
PROVINCIAL RECORDING
OFFICE - SUDBURY

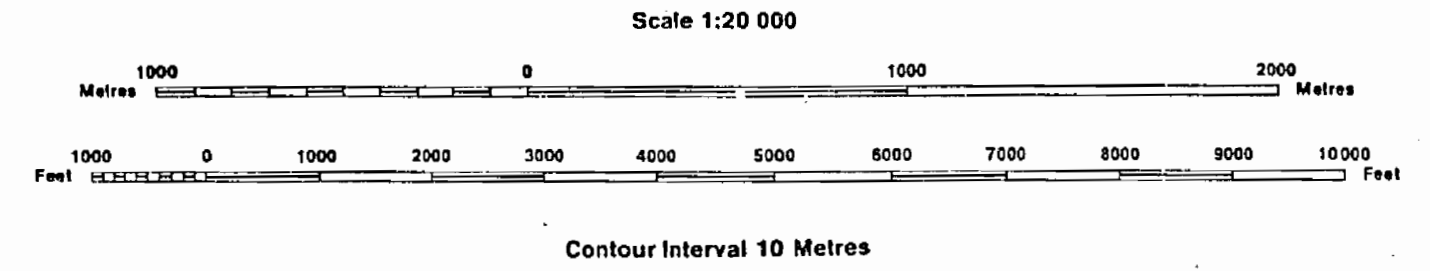

AREAS WITHDRAWN FROM DISPOSITION

MRO - Mining Rights Only
SRO - Surface Rights Only
M+S - Mining and Surface Rights

SYMBOLS

Description	Order No.	Date	Disposition	File
Boundary				
Township, Meridian, Baseline				
Road allowance; surveyed				
shoreline				
Lot/Concession; surveyed				
unsurveyed				
Parcel; surveyed				
unsurveyed				
Right-of-way; road				
railway				
utility				
Reservation				
Cliff, Pit, Pile				
Contour				
Interpolated				
Approximate				
Depression				
Control point (horizontal)				
Flooded land				
Mine head frame				
Pipeline (above ground)				
Railway; single track				
double track				
abandoned				
Road; highway, county, township				
access				
trail, bush				
Shoreline (original)				
Transmission line				
Wooded area				

DISPOSITION OF CROWN LANDS

Patent				
Surface & Mining Rights				
Surface Rights Only				
Mining Rights Only				
Lease				
Surface & Mining Rights				
Surface Rights Only				
Mining Rights Only				
Licence of Occupation				
Order-in-Council				
Cancelled				
Reservation				
Sand & Gravel				

THE INFORMATION THAT APPEARS ON THIS MAP HAS BEEN COMPILED FROM VARIOUS SOURCES, AND ACCURACY IS NOT GUARANTEED. THOSE WISHING TO STAKE MINING CLAIMS SHOULD CONSULT WITH THE MINING RECORDER, MINISTRY OF NORTHERN DEVELOPMENT AND MINES, FOR ADDITIONAL INFORMATION ON THE STATUS OF THE LANDS SHOWN HEREON.

The 1975 Magnetic Bearing
Approx. 2.2% Annual Change
Decreasing

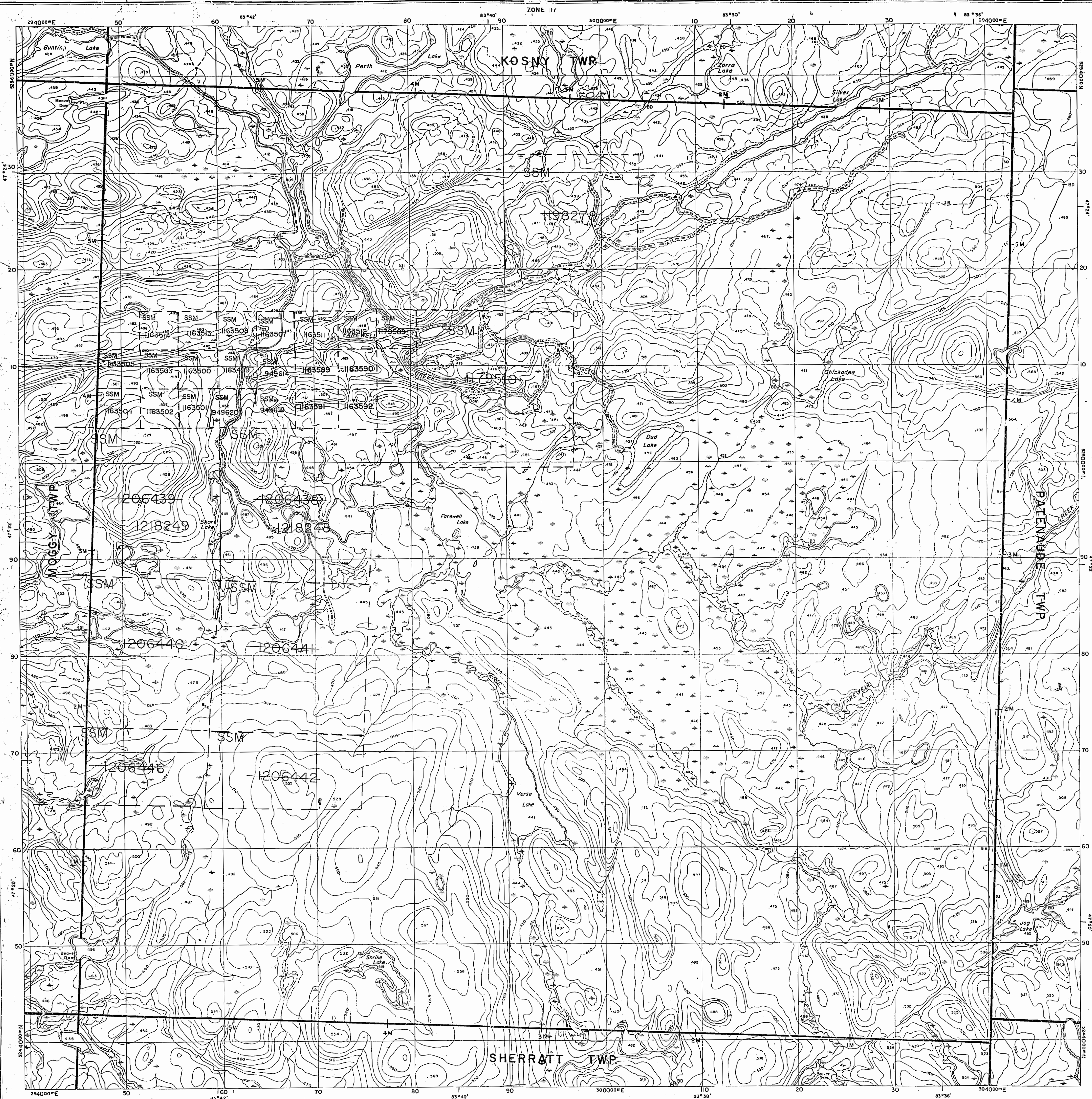



Ministry of Natural Resources

Ministry of Northern Development and Mines

INDEX TO LAND DISPOSITION

PLAN
G-2476
TOWNSHIP

NEILL

M.N.R. ADMINISTRATIVE DISTRICT
CHAPLEAU
MINING DIVISION
SAULT STE. MARIE
LAND TITLES/REGISTRY DIVISION
SUDBURY

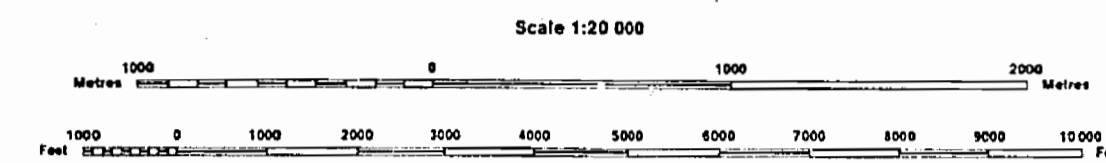

Contour Interval 10 Metres

AREAS WITHDRAWN FROM DISPOSITION

MRO - Mining Rights Only
SRO - Surface Rights Only
M + S - Mining and Surface Rights

SYMBOLS

Description	Symbol
Boundary	
Township, Meridian, Baseline	—
Road allowance; surveyed	—
shoreline	—
Lo/Concession; surveyed	—
unsurveyed	—
Parcel; surveyed	—
unsurveyed	—
Right-of-way; road	—
railway	—
utility	—
Reservation	—
Cliff, Pit, Pile	—
Contour	—
Interpolated	—
Approximate	—
Depression	—
Control point (horizontal)	—
Flooded land	—
Mine head frame	—
Pipeline (above ground)	—
Railway; single track	—
double track	—
abandoned	—
Road; highway, county, township	—
access	—
trail, bush	—
Shoreline (original)	—
Transmission line	—
Wooded area	—

F.O. 03/95 1206466, 1206467, 1206468, 1206469

DISPOSITION OF CROWN LANDS

Patent	●
Surface & Mining Rights	●
Surface Rights Only	○
Mining Rights Only	○
Lease	■
Surface & Mining Rights	■
Surface Rights Only	■
Mining Rights Only	■
Licence of Occupation	▼
Order-in-Council	OC
Cancelled	○
Reservation	○
Sand & Gravel	○

THE INFORMATION THAT APPEARS ON THIS MAP HAS BEEN COMPILED FROM VARIOUS SOURCES, AND ACCURACY IS NOT GUARANTEED. THOSE WISHING TO STAKE MINING CLAIMS SHOULD CONSULT WITH THE MINING RECORDER, MINISTRY OF NORTHERN DEVELOPMENT AND MINES, FOR ADDITIONAL INFORMATION ON THE STATUS OF THE LANDS SHOWN HEREON.

The 1975 Magnetic Bearing
Approx. 2.5 to 3.0 Annual Change
Decreasing



NOTES

AREAS WITHDRAWN FROM DISPOSITION

- M.R.O. - MINING RIGHTS ONLY
- S.R.O. - SURFACE RIGHTS ONLY
- M.+S. - MINING AND SURFACE RIGHTS

Description Order No. Date Disposition File

KOSNY TWP.

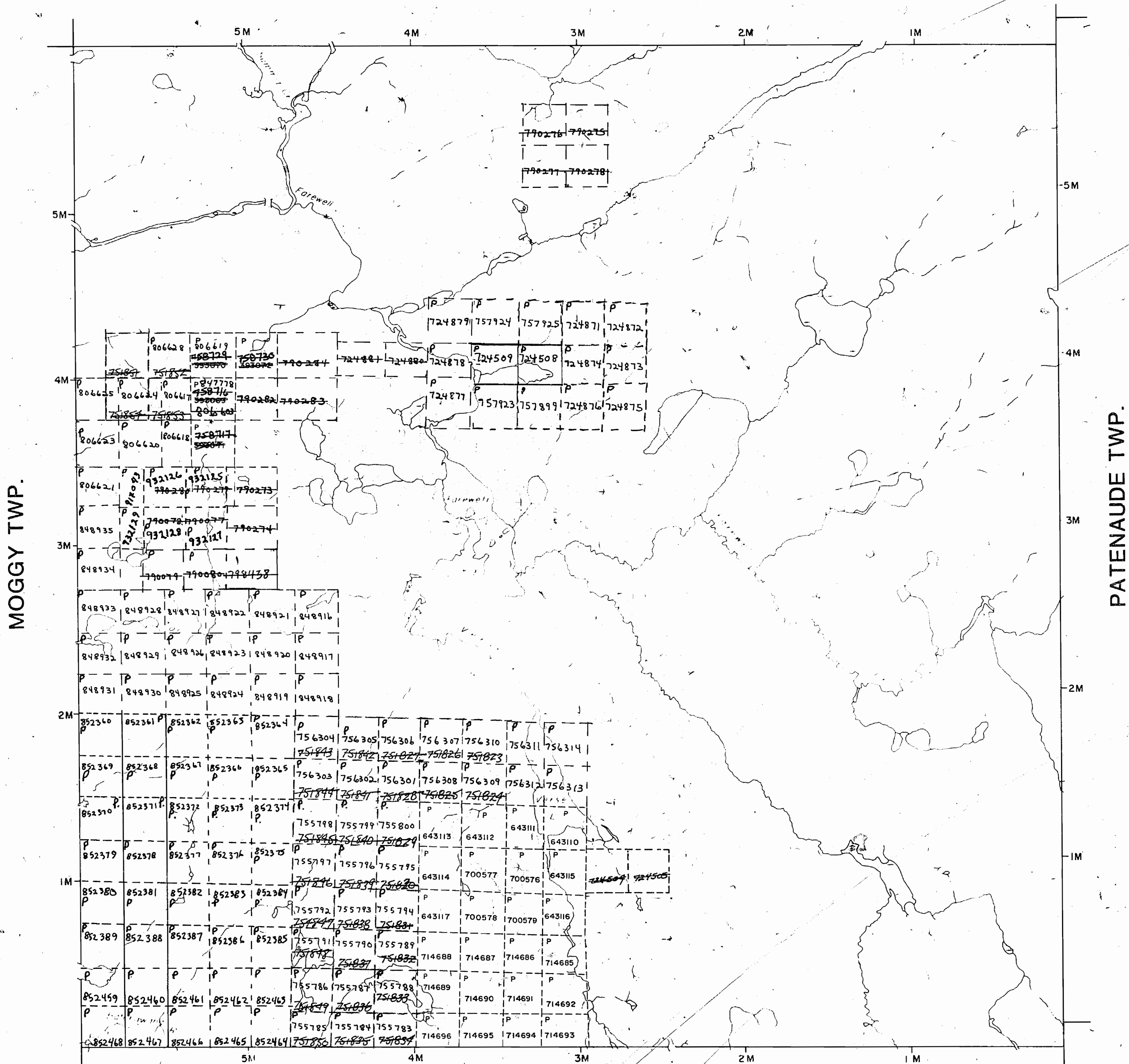

LEGEND

- HIGHWAY AND ROUTE No.
- OTHER ROADS
- TRAILS
- SURVEYED LINES:
 - TOWNSHIPS, BASE LINES, ETC.
 - LOTS, MINING CLAIMS, PARCELS, ETC.
- UNSURVEYED LINES:
 - LOT LINES
 - PARCEL BOUNDARY
 - MINING CLAIMS ETC.
- RAILWAY AND RIGHT OF WAY
- UTILITY LINES
- NON-PERENNIAL STREAM
- FLOODING OR FLOODING RIGHTS
- SUBDIVISION OR COMPOSITE PLAN
- RESERVATIONS
- ORIGINAL SHORELINE
- MARSH OR MUSKEG
- MINES
- TRAVERSE MONUMENT

DISPOSITION OF CROWN LANDS

TYPE OF DOCUMENT	SYMBOL
PATENT, SURFACE & MINING RIGHTS	
" SURFACE RIGHTS ONLY	
" MINING RIGHTS ONLY	
LEASE, SURFACE & MINING RIGHTS	
" SURFACE RIGHTS ONLY	
" MINING RIGHTS ONLY	
LICENCE OF OCCUPATION	
ORDER-IN-COUNCIL	
RESERVATION	
CANCELLED	
SAND & GRAVEL	

NOTE: MINING RIGHTS IN PARCELS PATENTED PRIOR TO MAY 6, 1913, VESTED IN ORIGINAL PATENTEE BY THE PUBLIC LANDS ACT, R.S.O. 1970, CHAP. 380, SEC. 63, SUBSEC. 1.

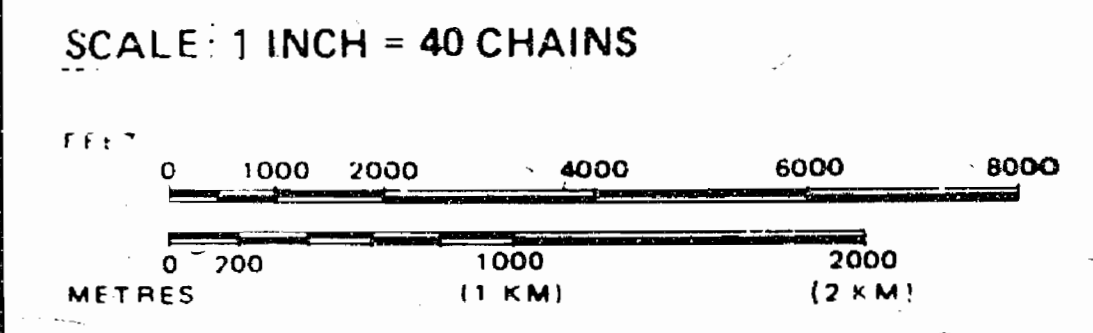

TOWNSHIP

NEILL

M.N.R. ADMINISTRATIVE DISTRICT

CHAPLEAU

MINING DIVISION

SAULT STE. MARIE

LAND TITLES / REGISTRY DIVISION

SUDBURY

Ministry of Natural Resources Land Management Branch

Date JULY, 1983 Number **G-2476**

DATE OF ISSUE
MAY 14 1987
SAULT STE MARIE
MINING RECORDER'S OFFICE

SAULT STE. MARIE
MINING DIVISION
RECEIVED
JUL 16 1983

SHERRATT TWP.

M-1443

PLAN OF TWP. 9H. NEILL

SAULT STE. MARIE MINING DIVISION. DISTRICT OF SUDBURY.

— Scale, 40 chains to an inch. —

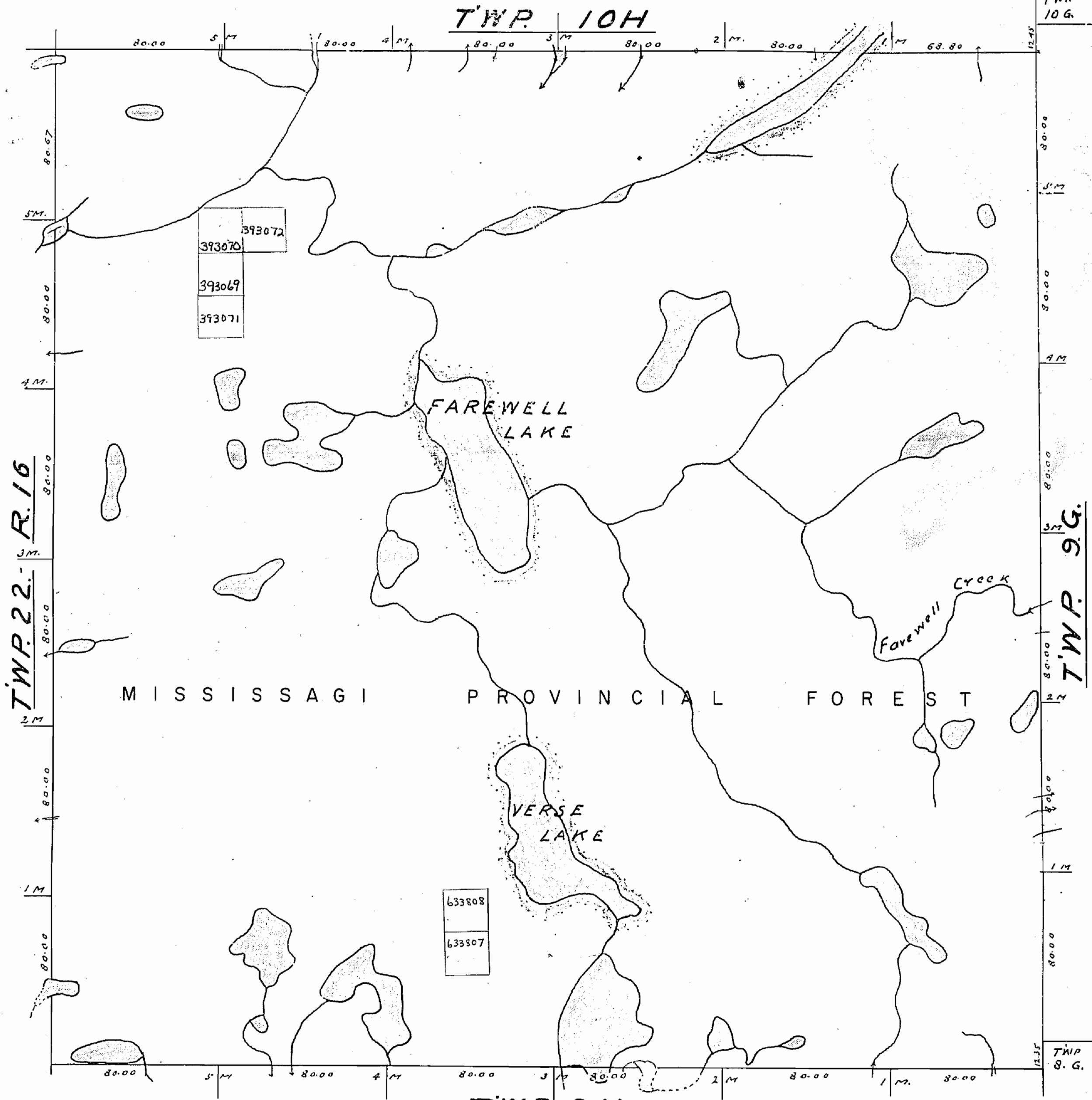
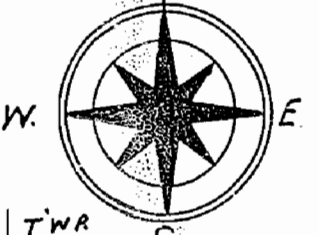

NOTES.

Railway shown thus	Non-perennial Streams
Paved Highways	Bridges
Gravel	Buildings
Other Roads	Swamps
Trails & Paths	Areas marked (P) are Patented
Highway Route Nos.	Areas marked (L) are Leased
Telephone & Telegraph Lines	L.O. are held under License of Occupation
Electric Power Lines	

400' Reserve to the Dept. of L. & R. shown thus:



Ministry of
Natural
Resources

Ministry of
Northern Development
and Mines

INDEX TO LAND DISPOSITION

PLAN
G-2476
TOWNSHIP

NEILL

M.N.R. ADMINISTRATIVE DISTRICT
CHAPLEAU
MINING DIVISION
SAULT STE. MARIE
LAND TITLES/REGISTRY DIVISION
SUDBURY

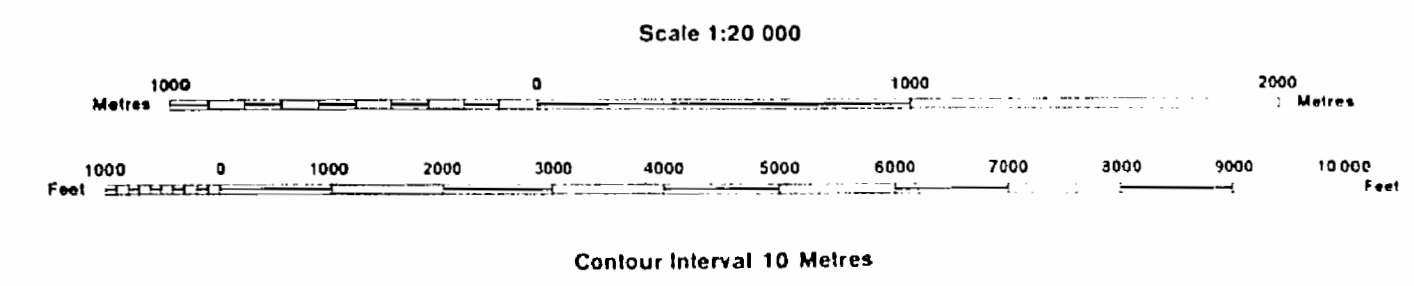

AREAS WITHDRAWN FROM DISPOSITION

MRO - Mining Rights Only
SRO - Surface Rights Only
M + S - Mining and Surface Rights

SYMBOLS

Description	Order No.	Date	Disposition	File
Boundary				
Township, Meridian, Baseline				
Road allowance; surveyed				
shoreline				
Lot/Concession; surveyed				
unsurveyed				
Parcel; surveyed				
unsurveyed				
Right-of-way; road				
railway				
utility				
Reservation				
Cliff, Pit, Pile				
Contour				
Interpolated				
Approximate				
Depression				
Control point (horizontal)				
Flooded land				
Mine head frame				
Pipeline (above ground)				
Railway; single track				
double track				
abandoned				
Road; highway, county, township				
access				
trail, bush				
Shoreline (original)				
Transmission line				
Wooded area				

DISPOSITION OF CROWN LANDS

Patent	
Surface & Mining Rights	●
Surface Rights Only	○
Mining Rights Only	○
Lease	
Surface & Mining Rights	■
Surface Rights Only	■
Mining Rights Only	■
Licence of Occupation	▼
Order-in-Council	OC
Cancelled	⊙
Reservation	⊙
Sand & Gravel	⊙

