

LOKEN LAKE G-597

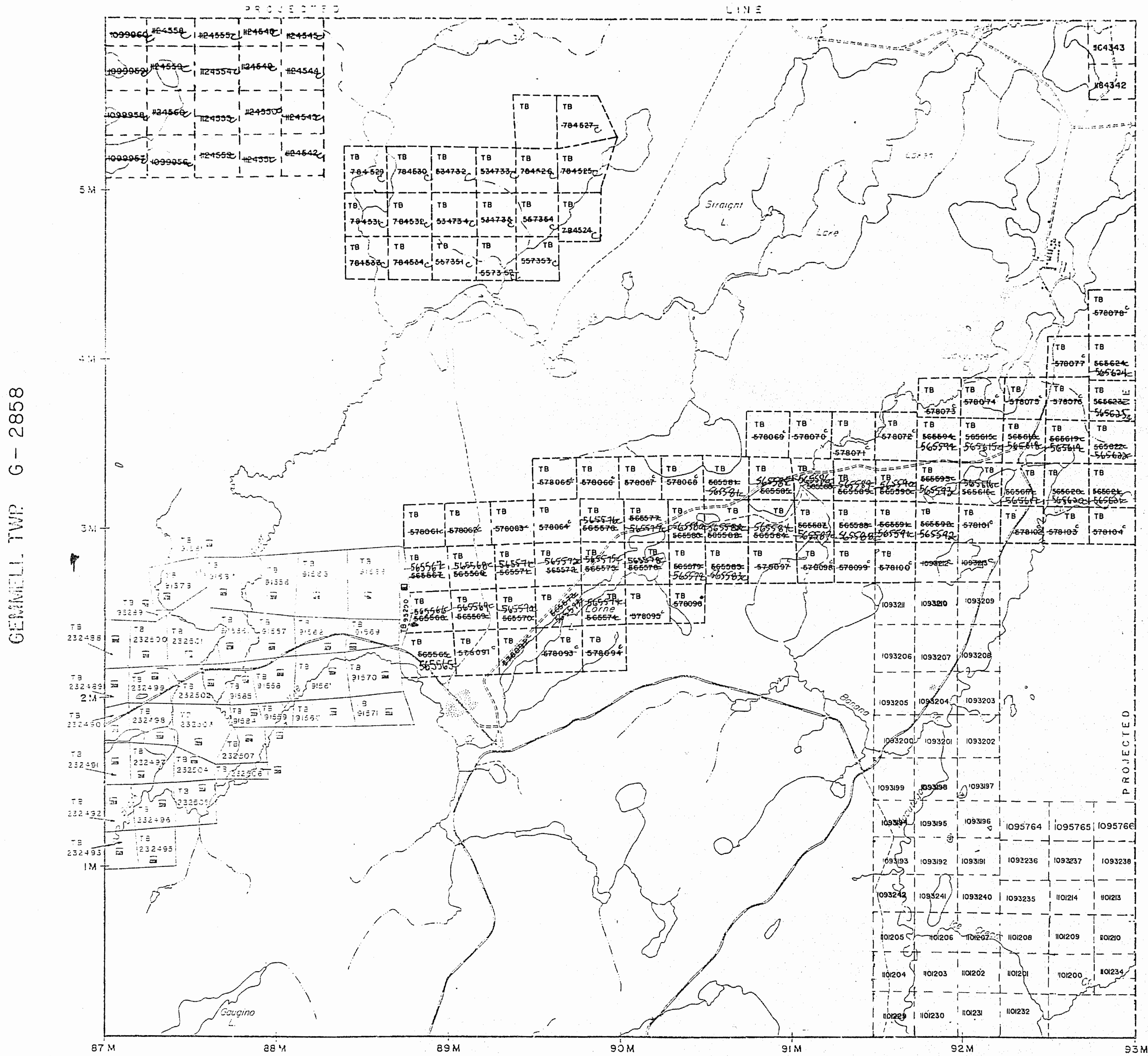

HIGHWAY AND ROUTE NO. _____

OTHER ROADS _____

TRAILS _____

DISPERSED LINES _____

BOUNDARIES, BASE LINES, ETC. _____

LOTS, MINING CLAIMS, PARCELS, ETC. _____

UNSURVEYED LINES _____

LOT LINES _____

PARCEL BOUNDARY _____

MINING CLAIMS ETC. _____

RAILWAY AND RIGHT OF WAY _____

UTILITY LINES _____

NON-PERENNIAL STREAM _____

FLOODING OR FLOODING RIGHTS _____

SUBDIVISION OR COMPOSITE PLAN _____

RESERVATIONS _____

ORIGINAL SHORELINE _____

MARSH OR MUSKEG _____

MINES _____

TRAVERSE MONUMENT _____

DISPOSITION OF CROWN LANDS

TYPE OF DOCUMENT	SYMBOL
PATENT SURFACE & MINING RIGHTS	⊖
" SURFACE RIGHTS ONLY	⊙
" MINING RIGHTS ONLY	⊚
LEASE, SURFACE & MINING RIGHTS	⊞
" SURFACE RIGHTS ONLY	⊟
" MINING RIGHTS ONLY	⊠
LICENCE OF OCCUPATION	⊡
ORDER-IN-COUNCIL	⊢
RESERVATION	⊣
CANCELLED	⊤
SAND & GRAVEL	⊥
LAND USE PERMITS FOR COMMERCIAL TOURISM, OUTPOST CAMPS	⊦

NOTE: MINING RIGHTS IN PARCELS PATENTED PRIOR TO MAY 9, 1913, VESTED IN ORIGINAL PATENTEE BY THE PUBLIC LANDS ACT, R.S.O. 1970, CHAP. 320, SEC. 63, SUBSEC. 1.

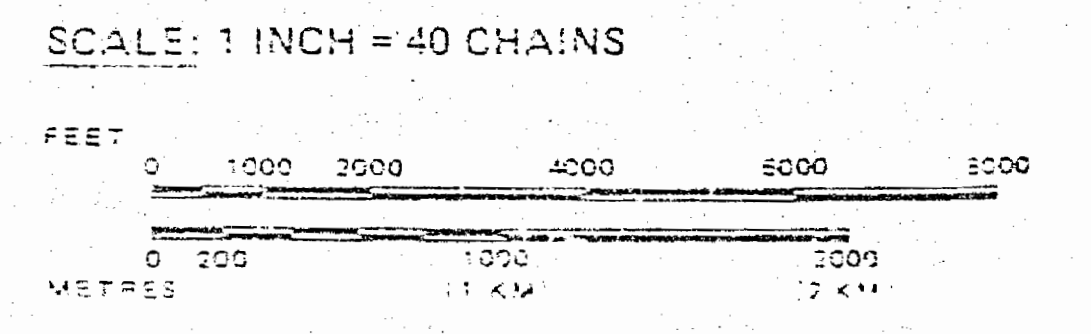

THUNDER BAY MINING DIVISION
 '93 APR 14 AM 9
 TOWNSHIP
NICKLE
 M.N.R. ADMINISTRATIVE DISTRICT
 TERRACE BAY
 MINING DIVISION
 THUNDER BAY
 LAND TITLES / REGISTRY DIVISION
 THUNDER BAY

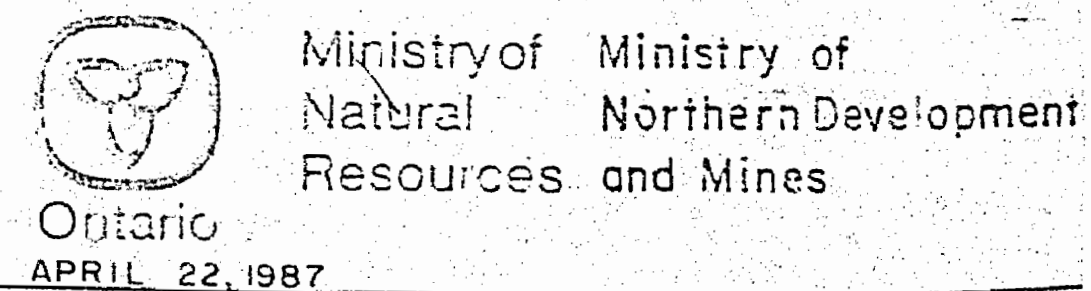

APRIL 22, 1987
 Date NOVEMBER, 1986.
 Number
G-2853

LOKEN LAKE G-597

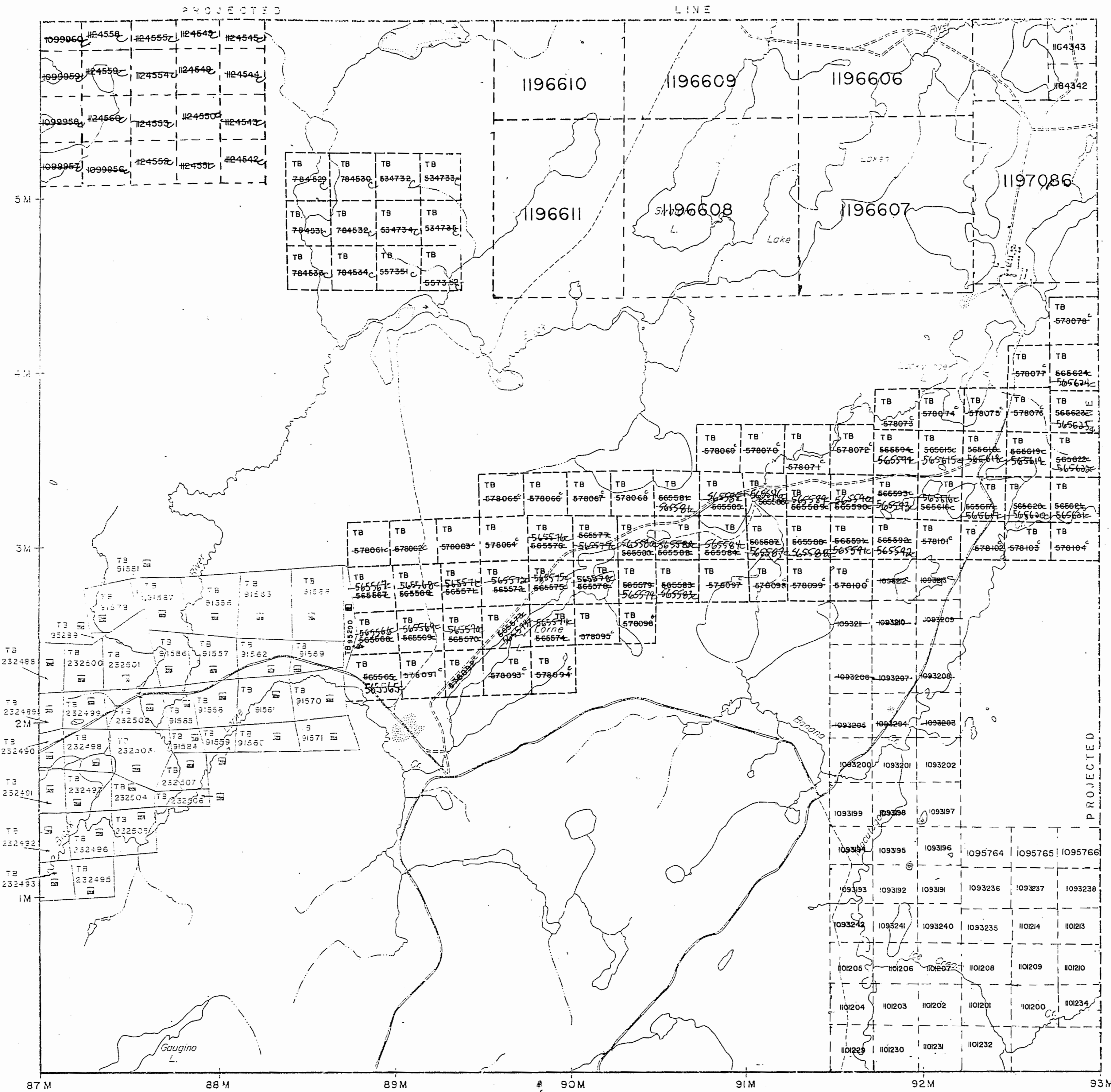

GEMMILL TWP. G-2858

HERBERT TWP. G-2860

CECIL TWP. G-2857

THE INFORMATION THAT APPEARS ON THIS MAP HAS BEEN COMPILED FROM VARIOUS SOURCES, AND ACCURACY IS NOT GUARANTEED. THOSE WISHING TO STAKE MINING CLAIMS SHOULD CONSULT WITH THE MINING RECORDER, MINISTRY OF NORTHERN DEVELOPMENT AND MINES, FOR ADDITIONAL INFORMATION ON THE STATUS OF THE LANDS SHOWN HEREON.

HIGHWAY AND ROUTE NO.	—————
OTHER ROADS	—————
TRAILS	—————
SURVEYED LINES	—————
UNSURVEYED LINES	—————
RAILWAY AND RIGHT OF WAY	—————
UTILITY LINES	—————
FLOODING OR FLOODING RIGHTS	—————
RESERVATIONS	—————
MINES	—————
TRAVERSE MONUMENT	—————

DISPOSITION OF CROWN LANDS	
TYPE OF DOCUMENT	SYMBOL
RIGHT OF SURFACE MINING RIGHTS	○
MINING RIGHTS ONLY	○
LEASE, SURFACE & MINING RIGHTS	□
" SURFACE RIGHTS ONLY	□
" MINING RIGHTS ONLY	□
LICENCE OF OCCUPATION	△
ORDER-IN-COUNCIL	OC
RESERVATION	○
CANCELLED	○
SAND & GRAVEL	○
LAND USE PERMITS FOR COMMERCIAL TOURISM, OUTPOST CAMPS	○

NOTE: MINING RIGHTS IN PARCELS PATENTED PRIOR TO MAY 6, 1912, VESTED IN ORIGINAL PATENTER BY THE PUBLIC LANDS ACT, R.S.O. 1970, CHAP. 320, SEC. 63, SUBSEC. 1.

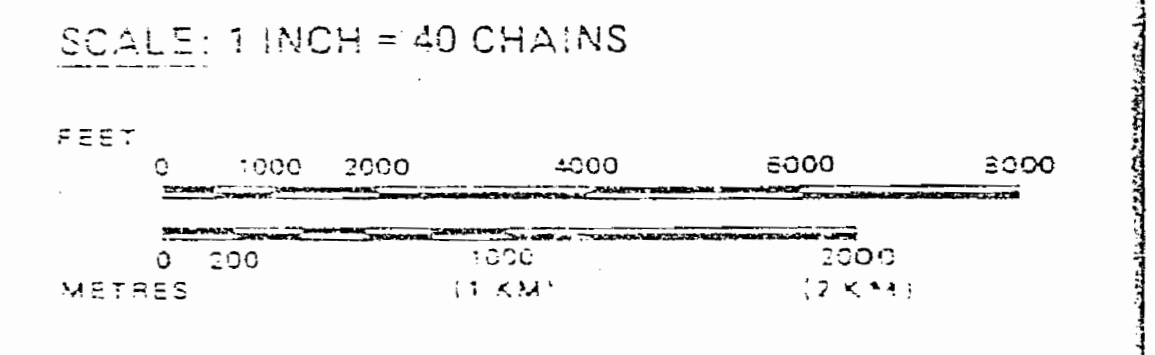

TOWNSHIP
NICKLE
M.N.R. ADMINISTRATIVE
TERRACE BAY
MINING DIVISION
THUNDER BAY
LAND TITLES / REGISTRY DIVISION
THUNDER BAY

RECEIVED
THUNDER BAY
MINING DIVISION
1ST DIVISION
'94 JUN 28 PM 2 02

Ministry of Natural Resources
Ministry of Northern Development and Mines
Ontario
APRIL 22, 1987

Number
G-2853

JUNE 28, 1994
G-2853

PLANALYSED IN REGALD DIT SYSTEM
DIT NO. G-2853 ONLY
DATE OF SURFACE RIGHTS ONLY
DATE OF MINING RIGHTS ONLY
DATE OF TRAILING AND CLAIMS RIGHTS
Date of Issue Date of Disposition File

LOKEN LAKE G-597

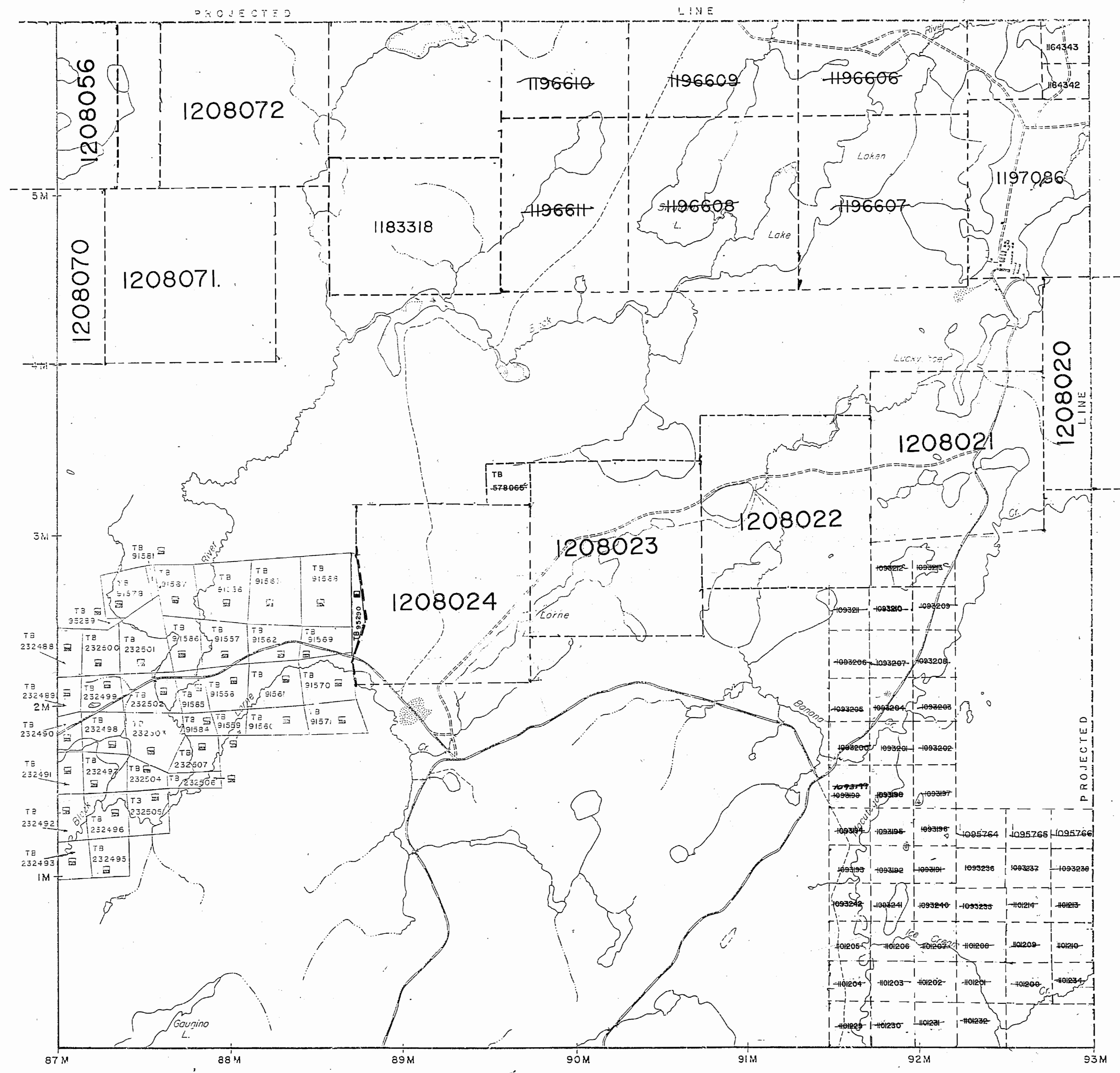

THE INFORMATION THAT APPEARS ON THIS MAP HAS BEEN COMPILED FROM VARIOUS SOURCES, AND ACCURACY IS NOT GUARANTEED. THOSE WISHING TO STAKE MINING CLAIMS SHOULD CONSULT WITH THE MINING RECORDER, MINISTRY OF NORTHERN DEVELOPMENT AND MINES, FOR ADDITIONAL INFORMATION ON THE STATUS OF THE LANDS SHOWN HEREON.

CECIL TWP G-2857

JULY 13, 1995
G-2853

LEGEND

HIGHWAY AND ROUTE No.	
OTHER ROADS	
TRAILS	
SURVEYED LINES	
TOWNSHIP, BASE LINES, ETC.	
LOTS, MINING CLAIMS, PARCELS, ETC.	
UNSURVEYED LINES	
LOT LINES	
PARCEL BOUNDARY	
MINING CLAIMS ETC.	
RAILWAY AND RIGHT OF WAY	
UTILITY LINES	
NON-PERENNIAL STREAM	
FLOODING OR FLOODING RIGHTS	
SUBDIVISION OR COMPOSITE PLAN	
RESERVATIONS	
ORIGINAL SHORELINE	
MARSH OR MUSKEG	
MINES	
TRAVERSE MONUMENT	

DISPOSITION OF CROWN LANDS

TYPE OF DOCUMENT	SYMBOL
PATENT SURFACE & MINING RIGHTS	
" SURFACE RIGHTS ONLY	
" MINING RIGHTS ONLY	
LEASE, SURFACE & MINING RIGHTS	
" SURFACE RIGHTS ONLY	
" MINING RIGHTS ONLY	
LICENCE OF OCCUPATION	
ORDER-IN-COUNCIL	
RESERVATION	
CANCELLED	
SAND & GRAVEL	
LAND USE PERMITS FOR COMMERCIAL TOURISM, OUTPOST CAMPS	

NOTE: MINING RIGHTS IN PARCELS PATENTED PRIOR TO MAY 31, 1913, TESTED IN ORIGINAL PATENTS BY THE PUBLIC LANDS ACT, R.S.O. 1970, CHAP. 380, SEC. 63, SUBSEC. 1.

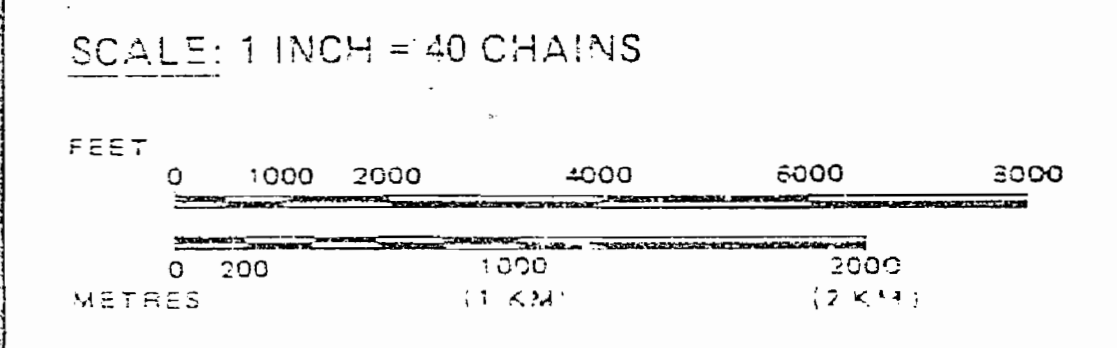

TOWNSHIP
NICKLE
M.N.R. ADMINISTRATIVE DISTRICT
TERRACE BAY
MINING DIVISION
THUNDER BAY
LAND TITLES / REGISTRY DIVISION
THUNDER BAY

Ministry of Natural Resources
Ministry of Northern Development and Mines
Ontario
APRIL 22, 1987
Date NOVEMBER, 1986. Number
G-2853
Out of Service Jul. 17/95 (LA)

REFERENCES

AREAS WITHDRAWN FROM DISPOSITION

- M.R.O. - MINING RIGHTS ONLY
 - S.R.O. - SURFACE RIGHTS ONLY
 - M.+S. - MINING AND SURFACE RIGHTS
- | Description | Order No. | Date | Disposition | File |
|-------------|-----------|------|-------------|------|
| | | | | |

LEGEND

- HIGHWAY AND ROUTE No.
- OTHER ROADS
- TRAILS
- SURVEYED LINES:
 - TOWNSHIPS, BASE LINES, ETC.
 - LOTS, MINING CLAIMS, PARCELS, ETC.
- UNSURVEYED LINES:
 - LOT LINES
 - PARCEL BOUNDARY
 - MINING CLAIMS ETC.
- RAILWAY AND RIGHT OF WAY
- UTILITY LINES
- NON-PERENNIAL STREAM
- FLOODING OR FLOODING RIGHTS
- SUBDIVISION OR COMPOSITE PLAN
- RESERVATIONS
- ORIGINAL SHORELINE
- MARSH OR MUSKEG
- MINES
- TRAVERSE MONUMENT

DISPOSITION OF CROWN LANDS

TYPE OF DOCUMENT	SYMBOL
PATENT, SURFACE & MINING RIGHTS	
" SURFACE RIGHTS ONLY	
" MINING RIGHTS ONLY	
LEASE, SURFACE & MINING RIGHTS	
" SURFACE RIGHTS ONLY	
" MINING RIGHTS ONLY	
LICENCE OF OCCUPATION	
ORDER-IN-COUNCIL	
RESERVATION	
CANCELLED	
SAND & GRAVEL	
LAND USE PERMITS FOR COMMERCIAL TOURISM, OUTPOST CAMPS	

NOTE: MINING RIGHTS IN PARCELS PATENTED PRIOR TO MAY 6, 1913, VESTED IN ORIGINAL PATENTEE BY THE PUBLIC LANDS ACT, R.S.O. 1970, CHAP. 380, SEC. 63, SUBSEC. 1.

SCALE: 1 INCH = 40 CHAINS

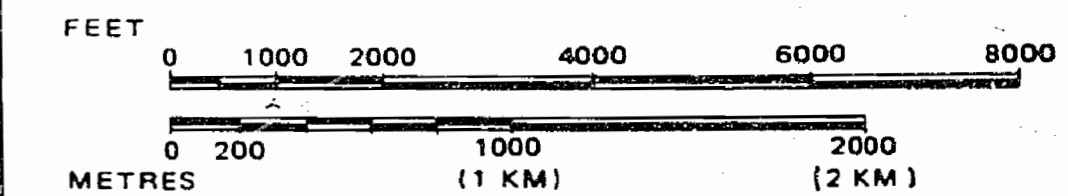

TOWNSHIP
NICKLE
 M.N.R. ADMINISTRATIVE DISTRICT
TERRACE BAY
 MINING DIVISION
THUNDER BAY
 LAND TITLES / REGISTRY DIVISION
THUNDER BAY

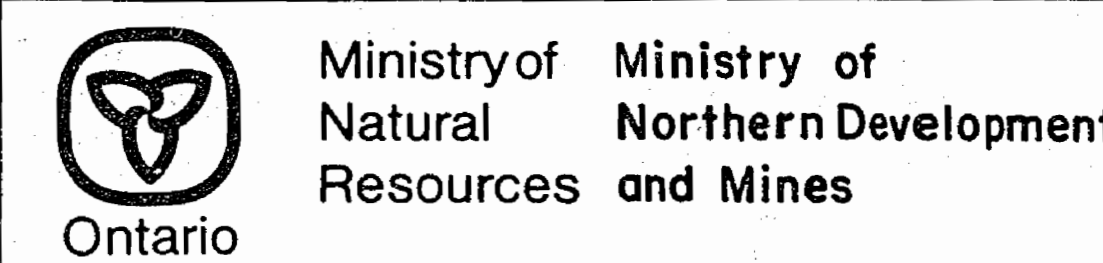

Date NOVEMBER, 1986. Number
 In Service Jul. 17/95. (LA) **G-2853**

LOKEN LAKE G-597

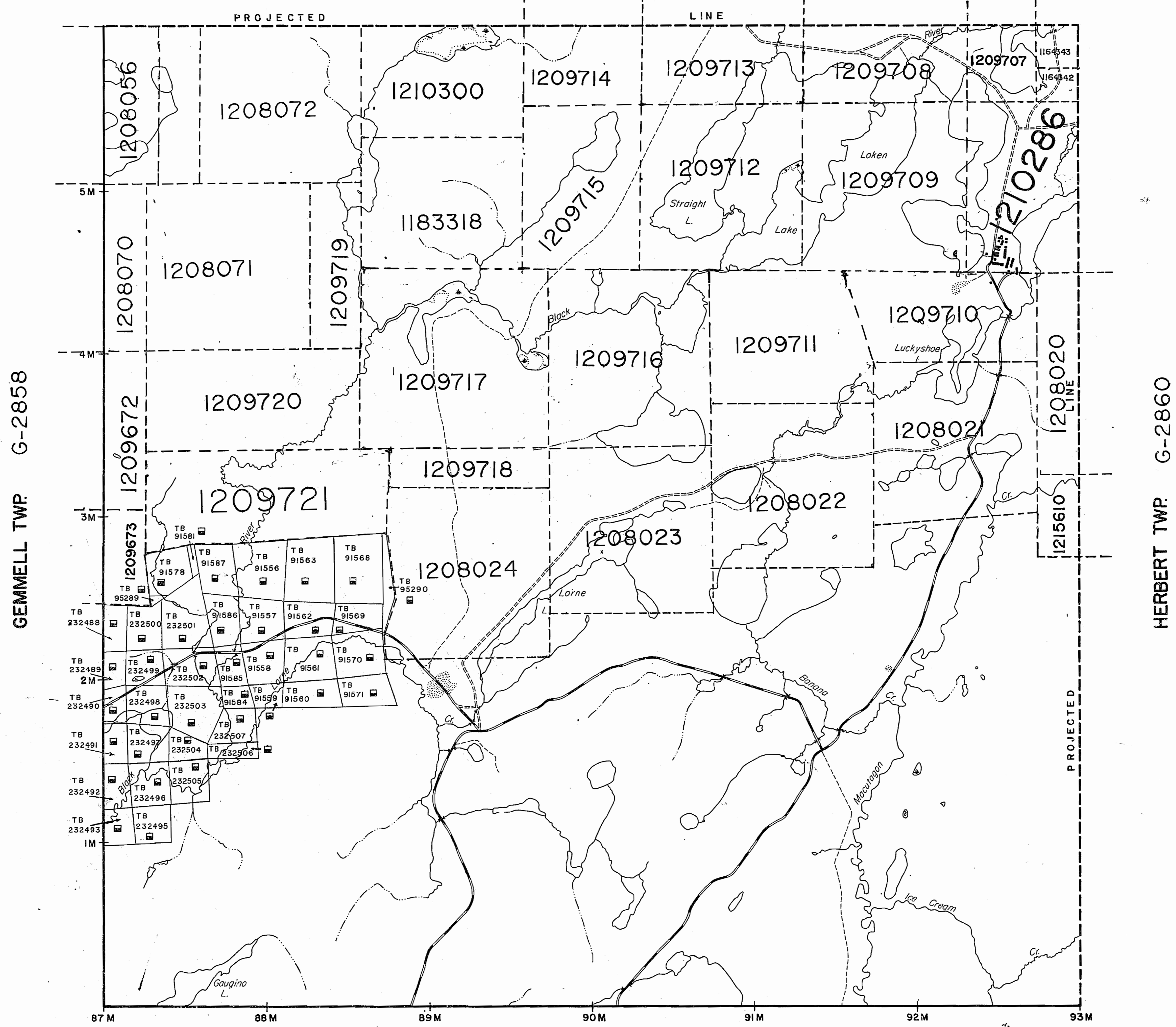

NOTICE-
 The information that appears on this map has been compiled from various sources and accuracy is not guaranteed. Those wishing to stake MINING CLAIMS should consult with the MINING RECORDER, Ministry of Northern Development and Mines, for additional information on the status of the lands shown hereon.