

**REFERENCES**

**AREAS WITHDRAWN FROM DISPOSITION**

M.R.O. - MINING RIGHTS ONLY  
 S.R.O. - SURFACE RIGHTS ONLY  
 M.+S. - MINING AND SURFACE RIGHTS

Description	Order No.	Date	Disposition	File
Sec. 43	NCR. W. 36/81	27/2/81	S.R.O.	188542
M.T.C. Reserve				
M.V.N.C.R. 26/85 S.R.O. WITHDRAWN				
Sec. 36/80	W. 1/82	8/1/82	S.R.O.	
RS Sec. 34/80	W. 1/82	8/1/82	S.R.O.	
RS Sec. 31/80	W. 1/82	8/1/82	S.R.O.	
RS Sec. 21/80	W. 1/82	8/1/82	S.R.O.	

REOPENED ORDER O-TB 2/95 NWR

**SAND and GRAVEL**

- GRAVEL PIT NO 554
- GRAVEL PIT NO 555 GRAVEL FILE 148949
- GRAVEL PIT NO 556
- GRAVEL PIT NO 557
- GRAVEL PIT NO 558
- M.T.C. PIT 2E41
- M.T.C. PIT 2E40

THE SURFACE RIGHTS LYING WITHIN 40.25 m. OF THE CENTER LINE OF THE TRANS CANADA PIPELINE RIGHT-OF-WAY ARE WITHDRAWN FROM STAKING OUT, PROSPECTING, SALE OR LEASE BY ORDER W-01911/ONT DATED SEPT. 20, 1991. SECTION 112 OF THE NATIONAL ENERGY ACT APPLIES TO THIS AREA.

THE INFORMATION THAT APPEARS ON THIS MAP HAS BEEN COMPILED FROM VARIOUS SOURCES AND ACCURACY IS NOT GUARANTEED. THOSE WISHING TO STAKE MINING CLAIMS SHOULD CONSULT WITH THE MINING RECORDER, MINISTRY OF NORTHERN DEVELOPMENT AND MINES, FOR ADDITIONAL INFORMATION ON THE STATUS OF THE LANDS SHOWN HEREON.

**ORBIT LAKE AREA G-748**

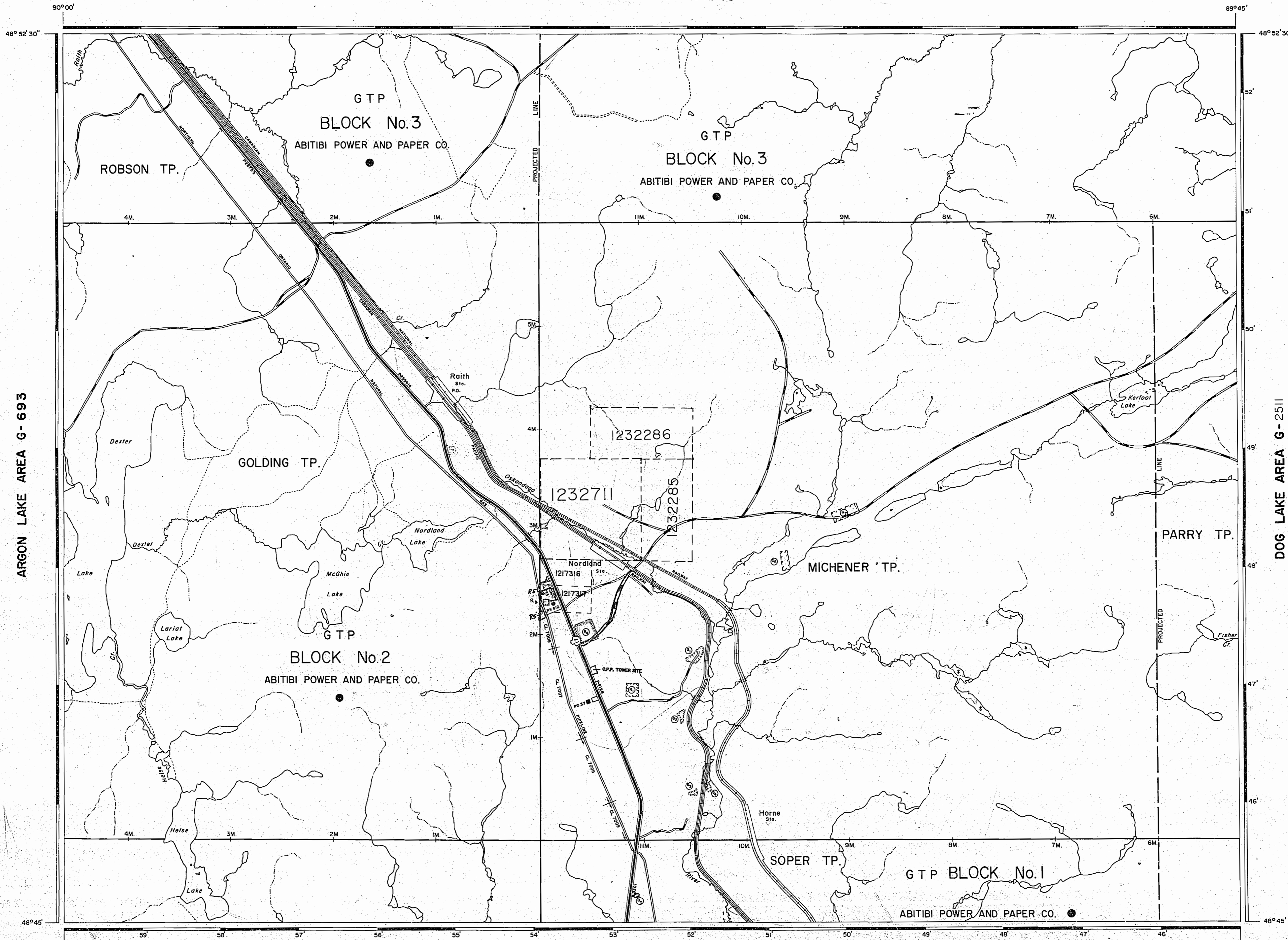

**REFERENCES**

**LEGEND**

HIGHWAY AND ROUTE No.	
OTHER ROADS	
TRAILS	
SURVEYED LINES:	
TOWNSHIPS, BASE LINES, ETC.	
LOTS, MINING CLAIMS, PARCELS, ETC.	
UNSURVEYED LINES:	
LOT LINES	
PARCEL BOUNDARY	
MINING CLAIMS ETC.	
RAILWAY AND RIGHT OF WAY	
UTILITY LINES	
NON-PERENNIAL STREAM	
FLOODING OR FLOODING RIGHTS	
SUBDIVISION OR COMPOSITE PLAN	
RESERVATIONS	
ORIGINAL SHORELINE	
MARSH OR MUSKEG	
MINES	
TRAVERSE MONUMENT	

**DISPOSITION OF CROWN LANDS**

TYPE OF DOCUMENT	SYMBOL
PATENT, SURFACE & MINING RIGHTS	
" SURFACE RIGHTS ONLY	
" MINING RIGHTS ONLY	
LEASE, SURFACE & MINING RIGHTS	
" SURFACE RIGHTS ONLY	
" MINING RIGHTS ONLY	
LICENCE OF OCCUPATION	
ORDER-IN-COUNCIL	
RESERVATION	
CANCELLED	
SAND & GRAVEL	
LAND USE PERMITS FOR COMMERCIAL TOURISM/OUTPOST CAMPS	

NOTE: MINING RIGHTS IN PARCELS PATENTED PRIOR TO MAY 6, 1913, VESTED IN ORIGINAL PATENTEE BY THE PUBLIC LANDS ACT, R.S.O. 1970, CHAP. 380, SEC 63, SUBSEC 1

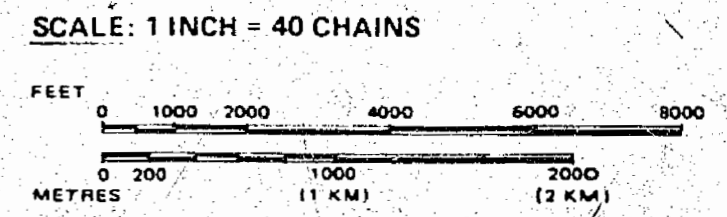

**AREA**  
**NORDLAND LAKE**  
 M.N.R. ADMINISTRATIVE DISTRICT  
**THUNDER BAY**  
 MINING DIVISION  
**THUNDER BAY**  
 LAND TITLES / REGISTRY DIVISION  
**THUNDER BAY**

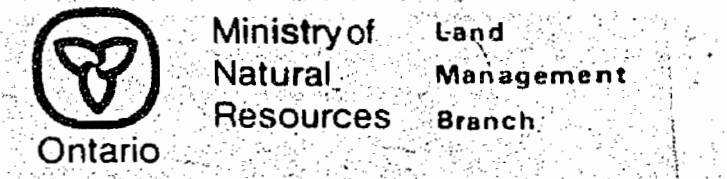

Date JANUARY, 1983. Number **G-746**  
 June 9/83

**OSKONDAGA RIVER AREA G-749**

DOG LAKE AREA G-2511

ARGON LAKE AREA G-693

NOTES

400' surface rights reservation along the shores of all lakes and rivers.

AREAS WITHDRAWN FROM STAKING

Section	Order No.	Date	Description	File
42 (R.S.O. 1970) W. 68/70	22/770	SP.	160704	
M.T.C. Reserve				
Tower Site				

3374

SAND and GRAVEL

GRAVEL PIT No. 854	all cancelled
GRAVEL PIT No. 860	
GRAVEL PIT No. 856	
GRAVEL PIT No. 858	
GRAVEL PIT No. 859	

ORBIT LAKE AREA M.1731

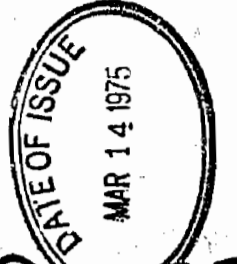
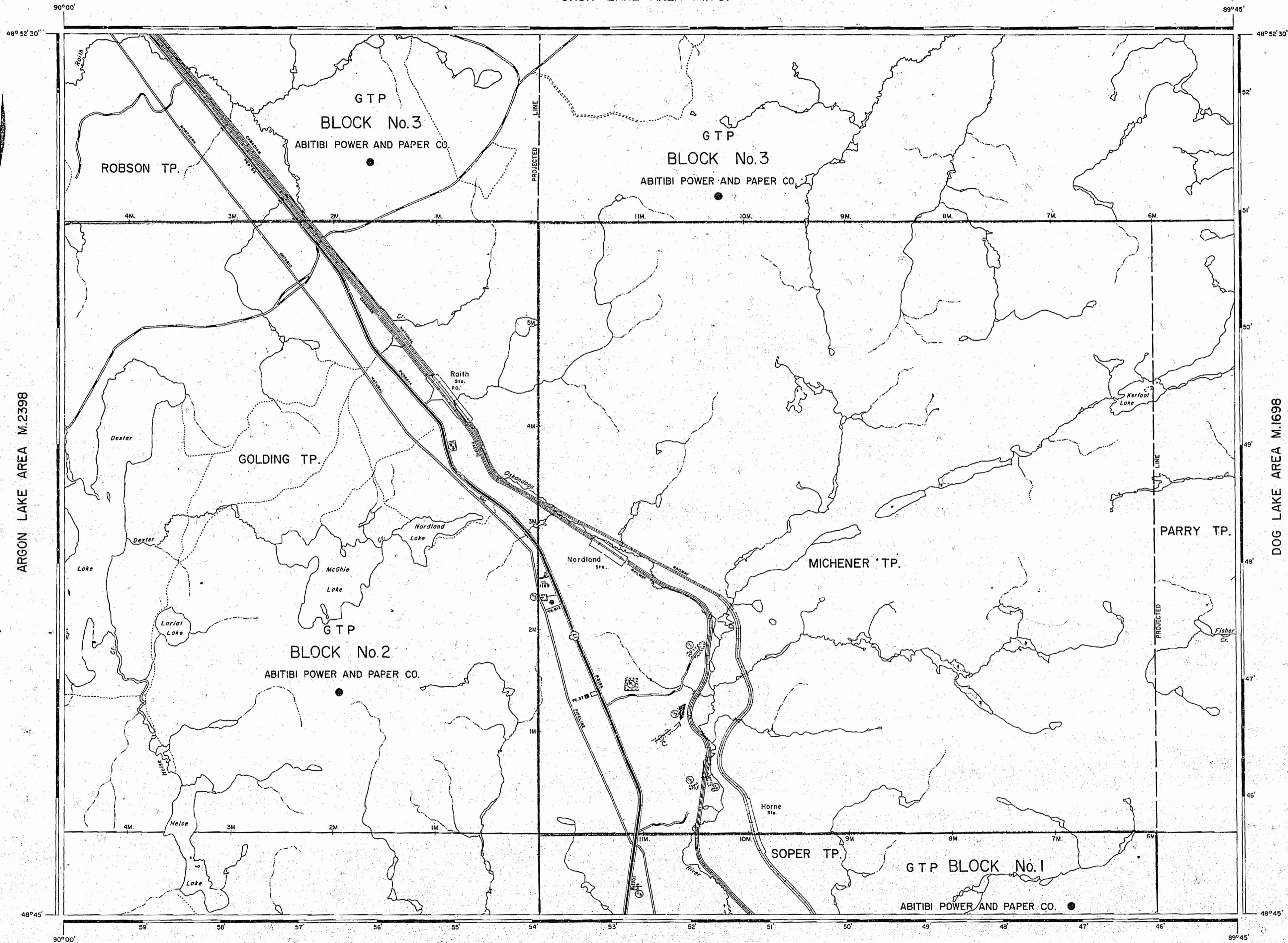

1975

LEGEND

HIGHWAY AND ROUTE No.	
OTHER ROADS	
TRAILS	
SURVEYED LINES:	
TOWNSHIPS, BASE LINES, ETC.	
LOTS, MINING CLAIMS, PARCELS, ETC.	
UNSURVEYED LINES:	
LOT LINES	
PARCEL BOUNDARY	
MINING CLAIMS ETC.	
RAILWAY AND RIGHT OF WAY	
UTILITY LINES	
NON-PERENNIAL STREAM	
FLOODING OR FLOODING RIGHTS	
SUBDIVISION	
ORIGINAL SHORELINE	
MARSH OR MUSKEG	
MINES	

DISPOSITION OF CROWN LANDS

TYPE OF DOCUMENT	SYMBOL
PATENT, SURFACE & MINING RIGHTS	
SURFACE RIGHTS ONLY	
MINING RIGHTS ONLY	
LEASE, SURFACE & MINING RIGHTS	
SURFACE RIGHTS ONLY	
MINING RIGHTS ONLY	
LICENCE OF OCCUPATION	
CROWN LAND SALE	CS
ORDER-IN-COUNCIL	OC
RESERVATION	
CANCELLED	
SAND & GRAVEL	

SCALE: 1 INCH = 40 CHAINS

0 300 600 900 1200 1500 1800 2100 2400 2700 3000 3300 3600 3900 4200 4500 4800 5100 5400 5700 6000 6300 6600 6900 7200 7500 7800 8100 8400 8700 9000 9300 9600 9900 10200

0 100 200 300 400 500 600 700 800 900 1000 1100 1200 1300 1400 1500 1600 1700 1800 1900 2000 2100 2200 2300 2400 2500 2600 2700 2800 2900 3000 3100 3200 3300 3400 3500 3600 3700 3800 3900 4000 4100 4200 4300 4400 4500 4600 4700 4800 4900 5000 5100 5200 5300 5400 5500 5600 5700 5800 5900 6000 6100 6200 6300 6400 6500 6600 6700 6800 6900 7000 7100 7200 7300 7400 7500 7600 7700 7800 7900 8000 8100 8200 8300 8400 8500 8600 8700 8800 8900 9000 9100 9200 9300 9400 9500 9600 9700 9800 9900 10000

ACRES	HECTARES
40	16

AREA  
**NORLAND LAKE**

DISTRICT  
THUNDER BAY

MINING DIVISION  
**T.B. THUNDER BAY**

Ministry of Natural Resources

Ontario Surveys and Mapping Branch

Date DEC. 17, 1974 Plan No. M.3374

National Topographical Series 52A13

OSKONDAGA RIVER AREA M.3373

NOTES

400' surface rights reservation along the shores of all lakes and rivers.

AREAS WITHDRAWN FROM STAKING

S.R. - SURFACE RIGHTS	M.R. - MINING RIGHTS			
Section	Order No.	Date	Disposition	File
42(R.S.O.1970) W. 68/70	22/7/70	SR. 160704		
M.T.C. Reserve				
Tower Site				

3374

SAND and GRAVEL

GRAVEL PIT No. 534	Cancelled
GRAVEL PIT No. 505	Cancelled
GRAVEL PIT No. 506	Cancelled
GRAVEL PIT No. 507	Cancelled
GRAVEL PIT No. 508	Cancelled

(730 M) 314  
 (730 M) 314  
 (730 M) 314

ORBIT LAKE AREA M.1731

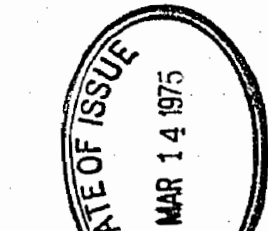
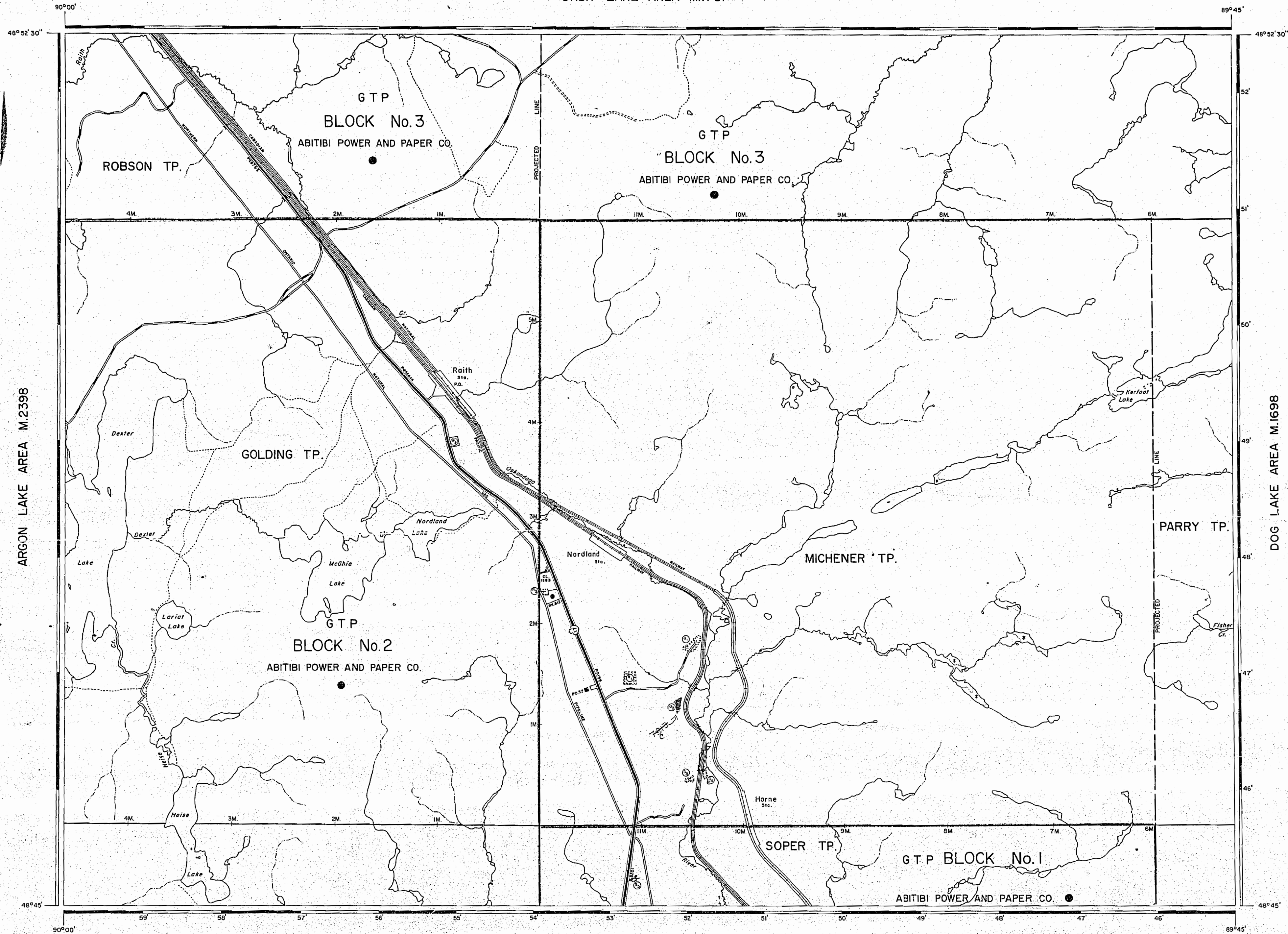

1975

LEGEND

- HIGHWAY AND ROUTE No.
- OTHER ROADS
- TRAILS
- SURVEYED LINES: TOWNSHIPS, BASE LINES, ETC.
- LOTS, MINING CLAIMS, PARCELS, ETC.
- UNSURVEYED LINES: LOT LINES
- PARCEL BOUNDARY
- MINING CLAIMS ETC.
- RAILWAY AND RIGHT OF WAY
- UTILITY LINES
- NON-PERENNIAL STREAM
- FLOODING OR FLOODING RIGHTS
- SUBDIVISION
- ORIGINAL SHORELINE
- MARSH OR MUSKEG
- MINES

DISPOSITION OF CROWN LANDS

TYPE OF DOCUMENT	SYMBOL
PATENT, SURFACE & MINING RIGHTS	
SURFACE RIGHTS ONLY	
MINING RIGHTS ONLY	
LEASE, SURFACE & MINING RIGHTS	
SURFACE RIGHTS ONLY	
MINING RIGHTS ONLY	
LICENCE OF OCCUPATION	
CROWN LAND SALE	C.S.
ORDER-IN-COUNCIL	O.C.
RESERVATION	
CANCELLED	
SAND & GRAVEL	

SCALE: 1 INCH = 40 CHAINS



ACRES      HECTARES



AREA  
**NORDLAND LAKE**  
 DISTRICT  
 THUNDER BAY  
 MINING DIVISION  
**T.B. THUNDER BAY**

Ministry of Natural Resources  
 Ontario Surveys and Mapping Branch

Date DEC. 17, 1974      Plan No.  
 National Topographical Series  
 52A13      **M.3374**

OSKONDAGA RIVER AREA M.3373