

INDEX TO LAND DISPOSITION

PLAN
G-3694
TOWNSHIP

NORTH WILLIAMS

M.N.R. ADMINISTRATIVE DISTRICT
KIRKLAND LAKE
MINING DIVISION
LARDER LAKE
LAND TITLES/REGISTRY DIVISION
TIMISKAMING

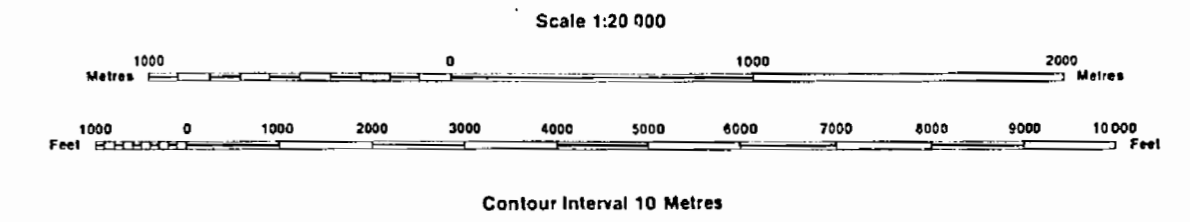

AREAS WITHDRAWN FROM DISPOSITION

Description	Order No.	Date	Disposition	File
① SFC-36/80	NRW 12/82	3/4/90	S.B.W.	

*Part of Order NRW 12/82 RE-OPENED by order O-MLO-90-NEP effective April 3, 1990 at 7:00 AM E.S.T.

SYMBOLS

- Boundary
 - Township, Meridian, Baseline
 - Road allowance; surveyed
 - shoreline
 - Lot/Concession; surveyed
 - unsurveyed
 - Parcel; surveyed
 - unsurveyed
 - Right-of-way; road
 - railway
 - utility
 - Reservation
 - Cliff, Pit, Pole
 - Contour
 - Interpolated
 - Approximate
 - Depression
 - Control point (horizontal)
 - Flooded land
 - Mine head frame
 - Pipeline (above ground)
 - Railway; single track
 - double track
 - abandoned
 - Road; highway, county, township
 - access
 - trail, bush
 - Shoreline (original)
 - Transmission line
 - Wooded area

DISPOSITION OF CROWN LANDS

- Patent
 - Surface & Mining Rights
 - Surface Rights Only
 - Mining Rights Only
- Lease
 - Surface & Mining Rights
 - Surface Rights Only
 - Mining Rights Only
- Licence of Occupation
- Order-in-Council
- Cancelled
- Reservation
- Sand & Gravel

"THIS MAP SHOWS THE APPROXIMATE LOCATION OF THE BOUNDARIES OF THE AREA WHICH IS THE SUBJECT OF CURRENT LITIGATION. THE EXACT LOCATION WILL BE SHOWN FOLLOWING CONFIRMATION BY THE PARTIES TO THE ACTION."

CIRCULATED AUG. 19, 1992 B.R.B.

THE INFORMATION THAT APPEARS ON THIS MAP HAS BEEN COMPILED FROM VARIOUS SOURCES, AND ACCURACY IS NOT GUARANTEED. THOSE WISHING TO STAKE MINING CLAIMS SHOULD CONSULT WITH THE MINING RECORDER, MINISTRY OF NORTHERN DEVELOPMENT AND MINES FOR ADDITIONAL INFORMATION ON THE STATUS OF THE LANDS SHOWN HEREON.

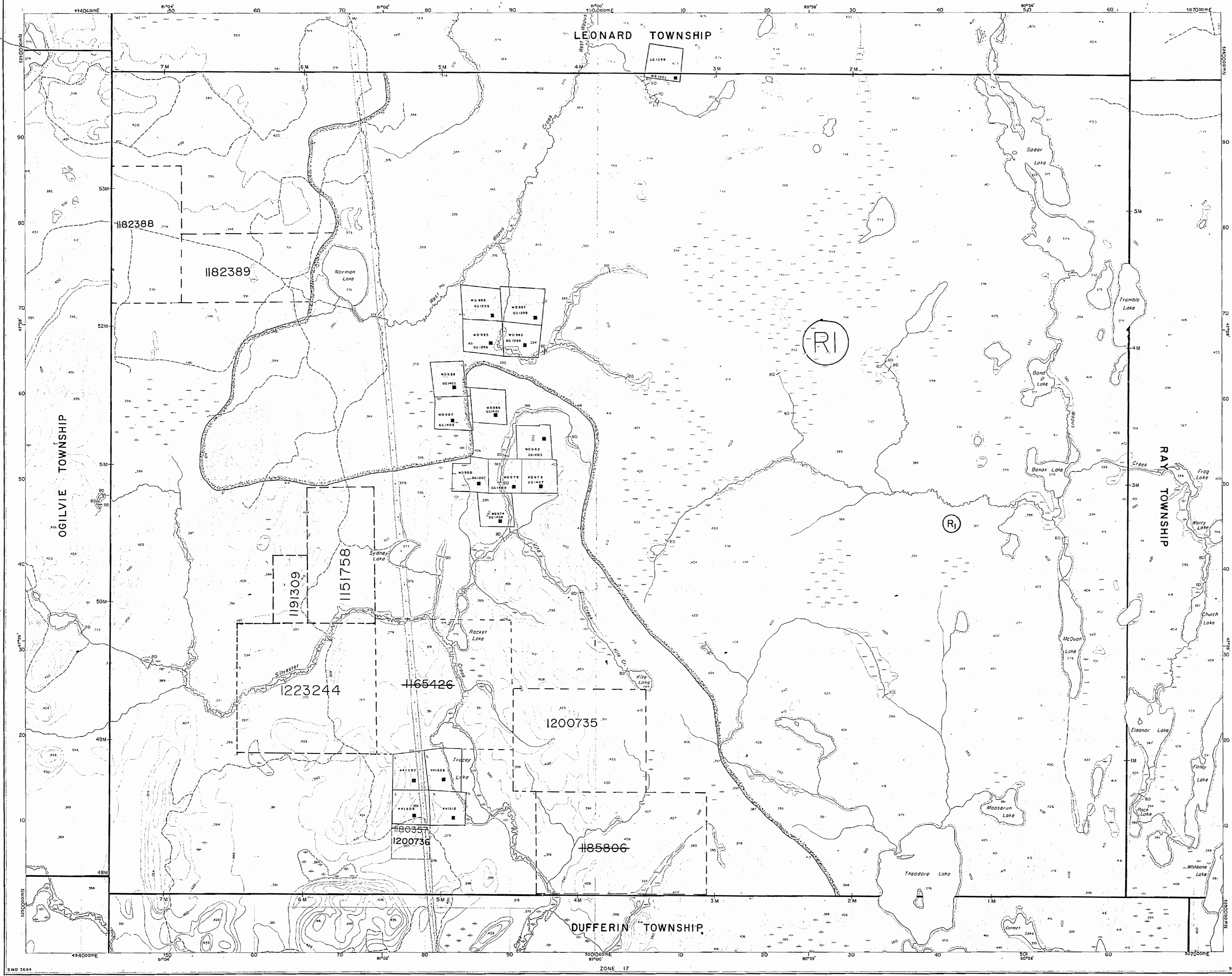

THE TOWNSHIP OF
OF
NORTH WILLIAMS

CAUTION
FILED

TIMISKAMING

LARDER LAKE
MINING DIVISION

SCALE: 1-INCH= 40 CHAINS

LEGEND

- | | |
|-----------------------|----------|
| PATENTED LAND | (P) |
| CROWN LAND SALE | (CS) |
| LEASES | (L) |
| LOCATED LAND | (Loc) |
| LICENSE OF OCCUPATION | (L.O.) |
| MINING RIGHTS ONLY | (M.R.O.) |
| SURFACE RIGHTS ONLY | (S.R.O.) |
| ROADS | (---) |
| IMPROVED ROADS | (=) |
| KING'S HIGHWAYS | (=) |
| RAILWAYS | (=) |
| POWER LINES | (=) |
| MARSH OR MUSKEG | (=) |
| MINES | (X) |

NOTES

Note: This Twp. Lies in the
TIMAGAMI PROVINCIAL FOREST

400' Surface rights reservation around all lakes and rivers.

- Timber open's 1975

LARDER LAKE
MINING DIV.
RECEIVED
FEB 20 1973
AM PM
7 8 9 10 11 12 1 2 3 4 5 6

PLAN NO - M-240

ONTARIO
MINISTRY OF NATURAL RESOURCES
SURVEYS AND MAPPING BRANCH

Leonard Twp.

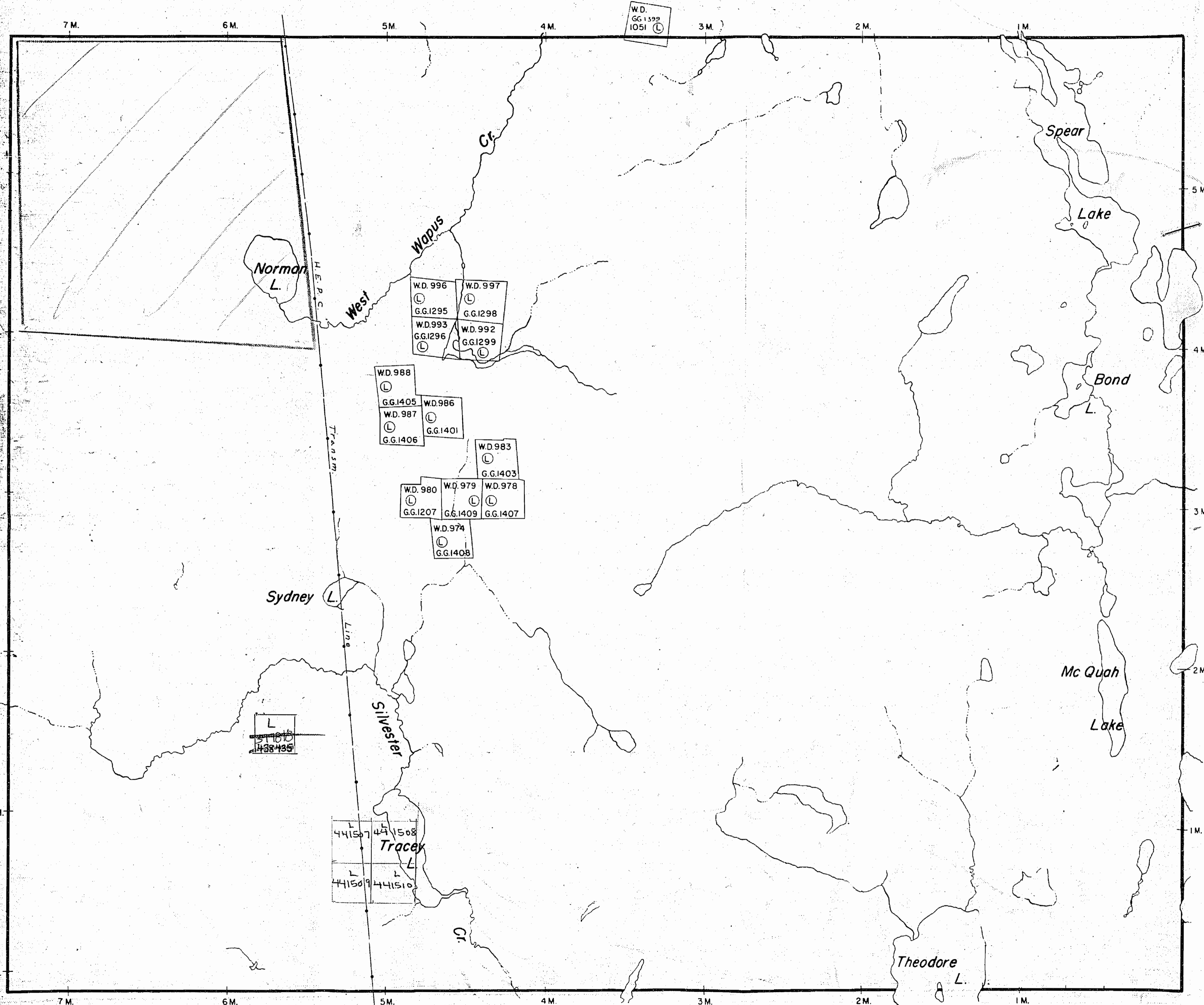

Ogilvie Twp.

Ray Twp.

Dufferin Twp.

*Revised by
June 16/80*

#6

geology reference-COBALT

RESIDENT GEO.

Leonard Twp.

THE TOWNSHIP OF
OF
NORTH WILLIAMS

DISTRICT OF
TIMISKAMING

LARDER LAKE
MINING DIVISION

SCALE: 1-INCH=40 CHAINS

LEGEND

PATENTED LAND	Ⓟ
CROWN LAND SALE	C.S.
LEASES	Ⓛ
LOCATED LAND	Loc.
LICENSE OF OCCUPATION	L.O.
MINING RIGHTS ONLY	M.R.O.
SURFACE RIGHTS ONLY	S.R.O.
ROADS	—
IMPROVED ROADS	—
KING'S HIGHWAYS	—
RAILWAYS	—
POWER LINES	—
MARSH OR MUSKEG	—
MINES	✕

NOTES

Note: This Twp. Lies in the
TIMAGAMI PROVINCIAL FOREST

400' Surface rights reservation around all lakes and rivers.

Part of Township closed to staking effective May 8, 1978, Sec. 38(f) of The Mining Act.

Ⓡ Surface and Mining Rights on all Crown Land in this township Withdrawn from prospecting, staking out, sale or lease Section 36 R.S.O. 1980, The Mining Act. Order NRW 12 / 82 effective October 19, 1982 at 12:06 pm.

***Part of order NRW 12/82 RE-OPENED by order O-ML01-90 NER effective April 3, 1990 at 7:00 AM E.S.T.

PLAN NO.- M-240

MINISTRY OF NATURAL RESOURCES
SURVEYS AND MAPPING BRANCH

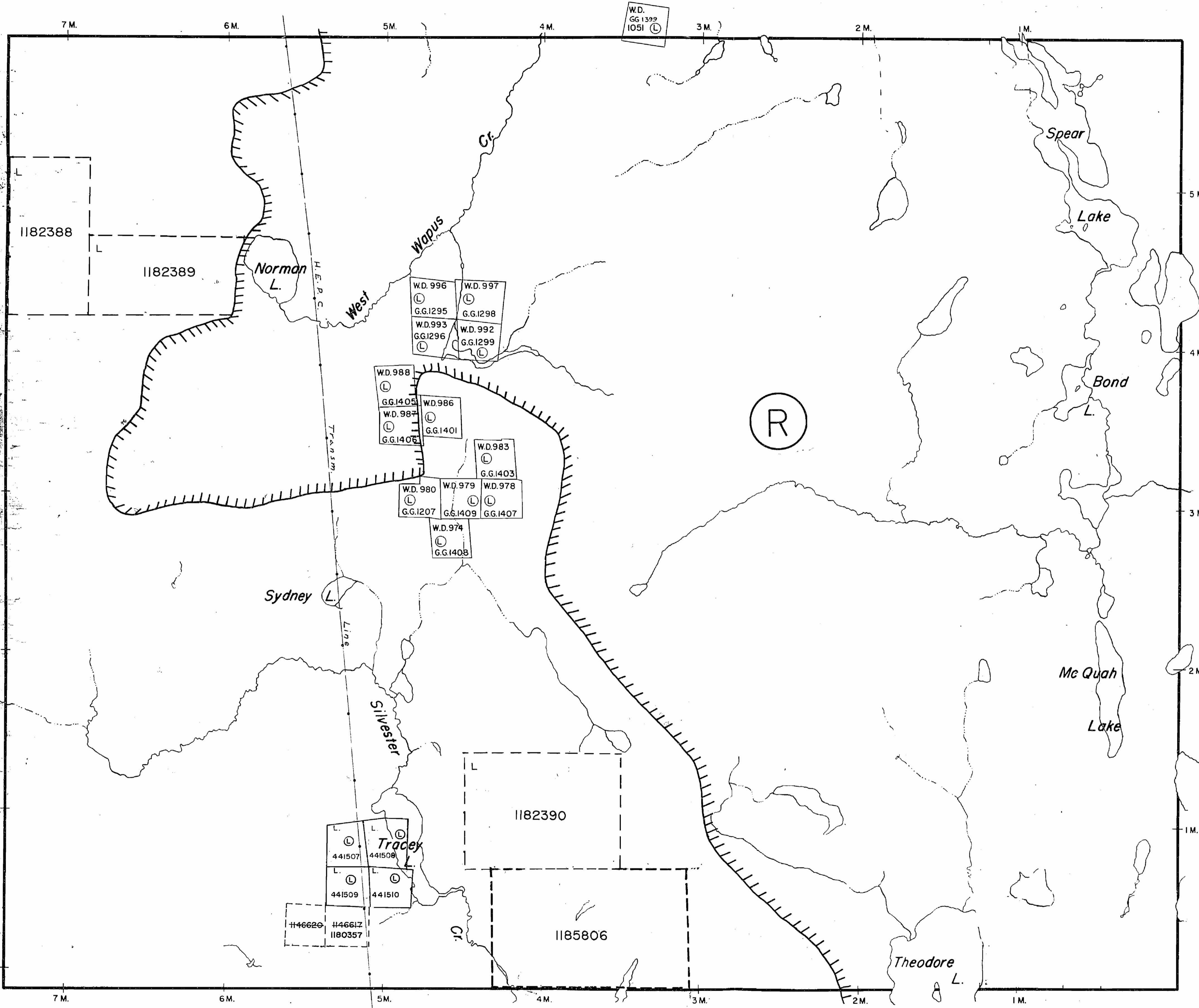

Dufferin Twp.

REPLACED AUG. 19, 1992 B.R.B.

GL

INDEX TO LAND DISPOSITION

PLAN
G-3694
 TOWNSHIP

M.N.R. ADMINISTRATIVE DISTRICT
KIRKLAND LAKE
 MINING DIVISION
LARDER LAKE
 LAND TITLES/REGISTRY DIVISION
TIMISKAMING

DATE OF ISSUE

SEP 23 1997

PROVINCIAL RECORDING
 OFFICE - SUDBURY

Scale 1:20 000

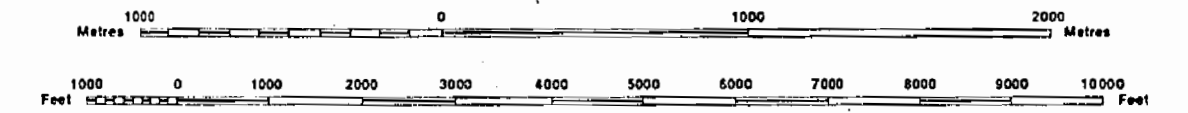

Contour Interval 10 Metres

AREAS WITHDRAWN FROM DISPOSITION

MRO - Mining Rights Only
 SRO - Surface Rights Only
 M+S - Mining and Surface Rights

SYMBOLS

Description	Order No.	Date	Disposition	File
Boundary				
Township, Meridian, Baseline				
Road allowance; surveyed				
shoreline				
Lot/Concession; surveyed				
unsurveyed				
Parcel; surveyed				
unsurveyed				
Right-of-way; road				
railway				
utility				
Reservation				
Cliff, Pit, Pile				
Contour				
Interpolated				
Approximate				
Depression				
Control point (horizontal)				
Flooded land				
Mine head frame				
Pipeline (above ground)				
Railway; single track				
double track				
abandoned				
Road; highway, county, township				
access				
trail, bush				
Shoreline (original)				
Transmission line				
Wooded area				

DISPOSITION OF CROWN LANDS

Patent	
Surface & Mining Rights	●
Surface Rights Only	○
Mining Rights Only	○
Lease	
Surface & Mining Rights	■
Surface Rights Only	□
Mining Rights Only	□
Licence of Occupation	▽
Order-in-Council	○
Cancelled	○
Reservation	○
Sand & Gravel	○

THIS MAP SHOWS THE APPROXIMATE LOCATION OF THE BOUNDARIES OF THE AREA WHICH IS THE SUBJECT OF CURRENT LITIGATION. THE EXACT LOCATION WILL BE SHOWN FOLLOWING CONFIRMATION BY THE PARTIES TO THE ACTION.

ARCHIVED SEPT. 19, 1996

ARCHIVED FEB. 22/95

CIRCULATED AUG. 19, 1992 B.R.B.

THE INFORMATION THAT APPEARS ON THIS MAP HAS BEEN COMPILED FROM VARIOUS SOURCES, AND ACCURACY IS NOT GUARANTEED. THOSE WISHING TO STAKE MINING CLAIMS SHOULD CONSULT WITH THE MINING RECORDER, MINISTRY OF NORTHERN DEVELOPMENT AND MINES, FOR ADDITIONAL INFORMATION ON THE STATUS OF THE LANDS SHOWN HEREON.

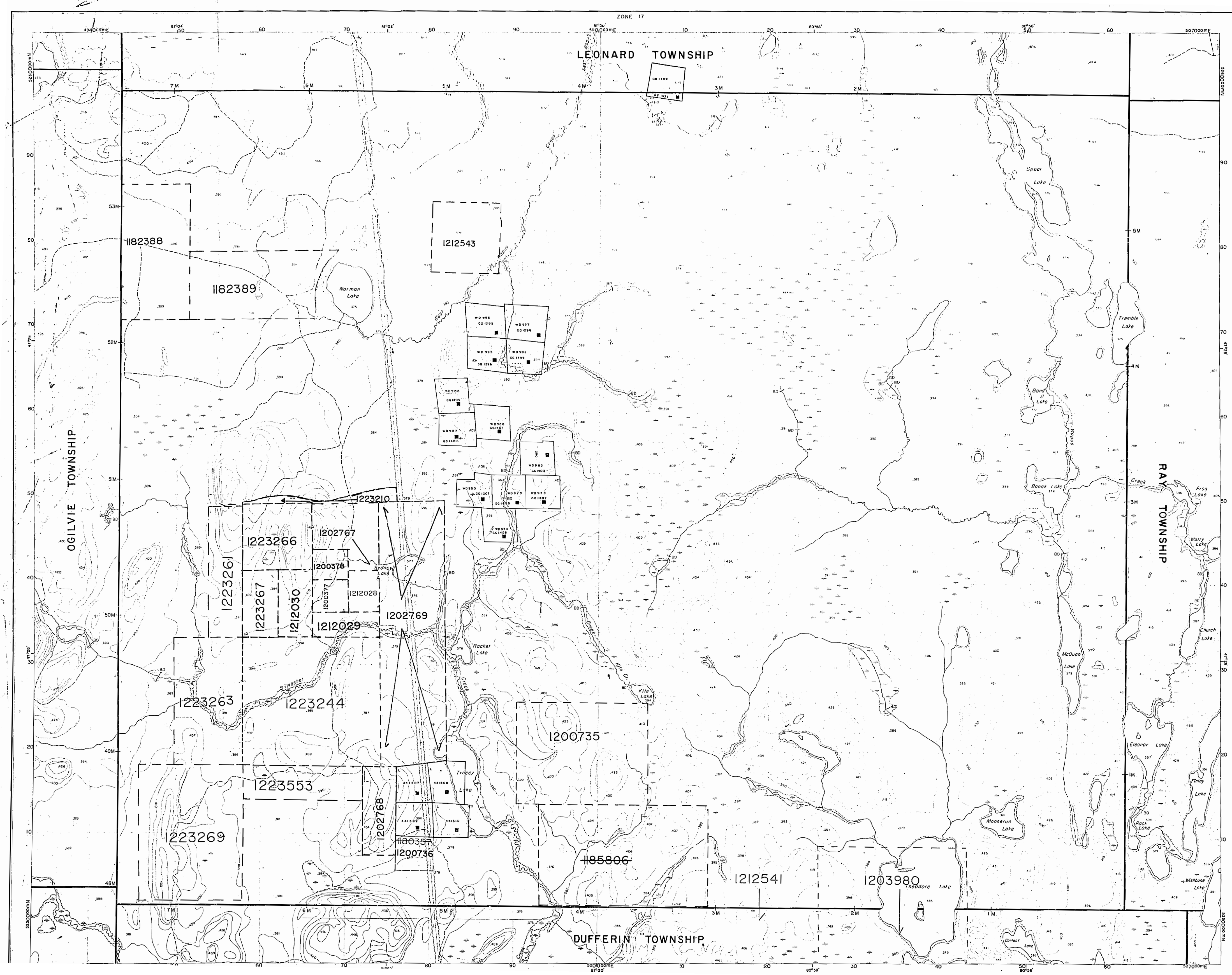

INDEX TO LAND DISPOSITION

PLAN
G-3694

TOWNSHIP
NORTH WILLIAMS

M.N.R. ADMINISTRATIVE DISTRICT
KIRKLAND LAKE

MINING DIVISION
LARDER LAKE

LAND TITLES/REGISTRY DIVISION
TIMISKAMING

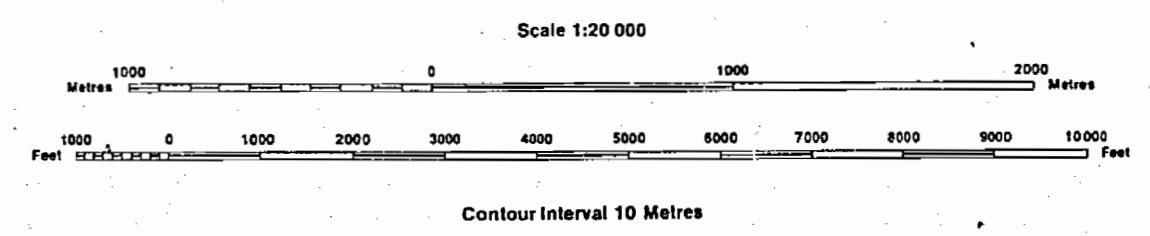

SYMBOLS

- Boundary
 - Township, Meridian, Baseline
- Road allowance, surveyed
 - shoreline
- Lot/Concession; surveyed
 - unsurveyed
- Parcel; surveyed
 - unsurveyed
- Right-of-way; road
 - railway
 - utility
- Reservation
- Cliff, Pit, Pile
- Contour
 - Interpolated
 - Approximate
 - Depression
- Control point (horizontal)
- Flooded land
- Mine head frame
- Pipeline (above ground)
- Railway; single track
 - double track
 - abandoned
- Road; highway, county, township
 - access
 - trail, bush
- Shoreline (original)
- Transmission line
- Wooded area

AREAS WITHDRAWN FROM DISPOSITION

MRO - Mining Rights Only
SRO - Surface Rights Only
M+S - Mining and Surface Rights

Description	Order No.	Date	Disposition	File
SEC.36/60	NRW12/82	3/4/90	S.R.M.	

*Part of Order NRW 12/82 RE-OPENED by order O-M.C.90-NER effective April 3, 1990 at 7:00 AM E.S.T.

DISPOSITION OF CROWN LANDS

- Patent
 - Surface & Mining Rights
 - Surface Rights Only
 - Mining Rights Only
- Lease
 - Surface & Mining Rights
 - Surface Rights Only
 - Mining Rights Only
- Licence of Occupation
- Order-in-Council
- Cancelled
- Reservation
- Sand & Gravel

THIS MAP SHOWS THE APPROXIMATE LOCATION OF THE BOUNDARIES OF THE AREA WHICH IS THE SUBJECT OF CURRENT LITIGATION. THE EXACT LOCATION WILL BE SHOWN FOLLOWING CONFIRMATION BY THE PARTIES TO THE ACTION.

ARCHIVED FEB. 22/95
CIRCULATED AUG. 19, 1992. B.R.B.

THE INFORMATION THAT APPEARS ON THIS MAP HAS BEEN COMPILED FROM VARIOUS SOURCES, AND ACCURACY IS NOT GUARANTEED. THOSE WISHING TO STAKE MINING CLAIMS SHOULD CONSULT WITH THE MINING RECORDER, MINISTRY OF NORTHERN DEVELOPMENT AND MINES, FOR ADDITIONAL INFORMATION ON THE STATUS OF THE LANDS SHOWN HEREON.

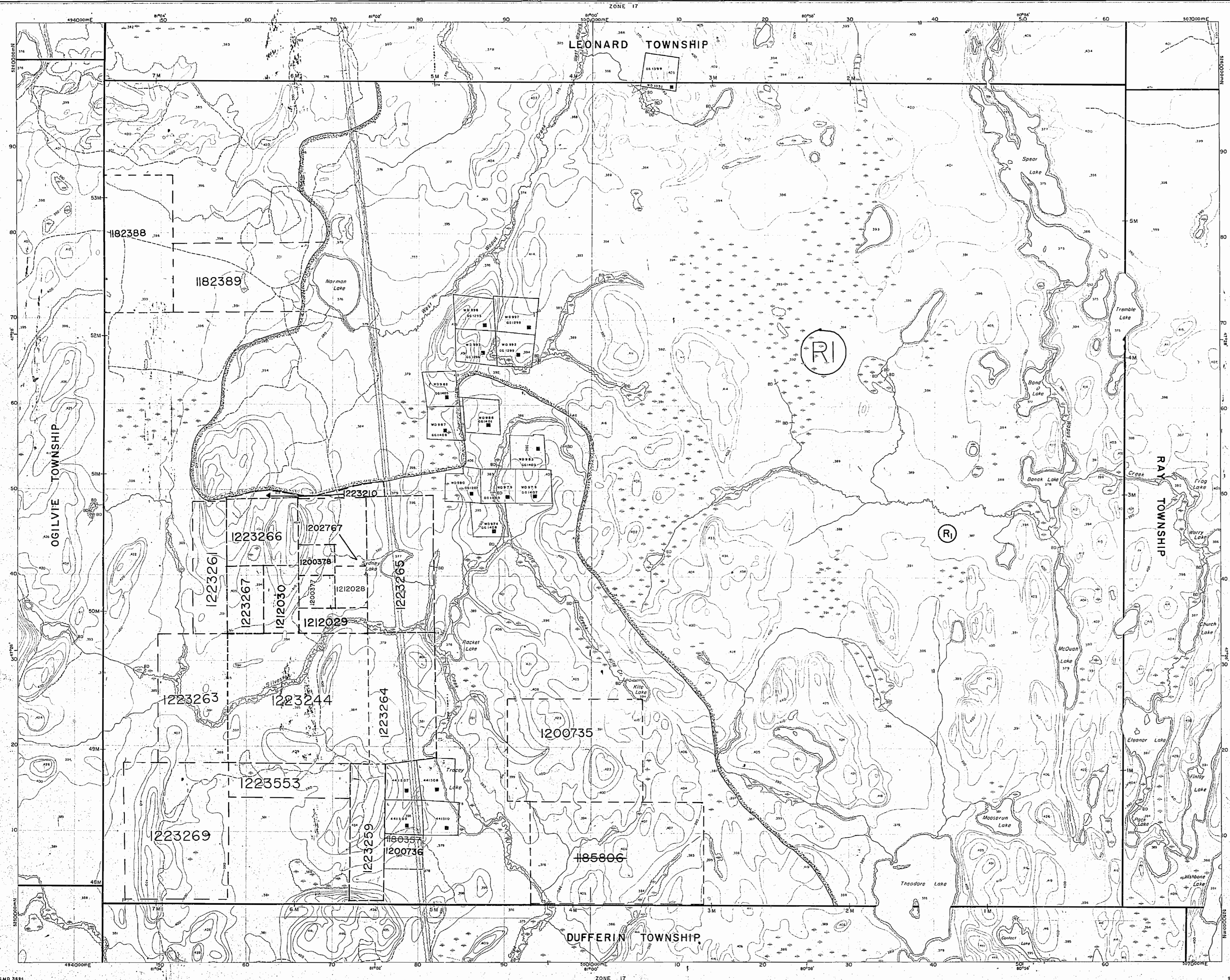

INDEX TO LAND DISPOSITION

PLAN: G-3694
 TOWNSHIP: NORTH WILLIAMS
 DATE OF ISSUE: APR 28 1998
 PROVINCIAL RECORDING OFFICE - SUDBURY
 M.N.R. ADMINISTRATIVE DISTRICT: KIRKLAND LAKE
 MINING DIVISION: LARDER LAKE
 LAND TITLES/REGISTRY DIVISION: TIMISKAMING

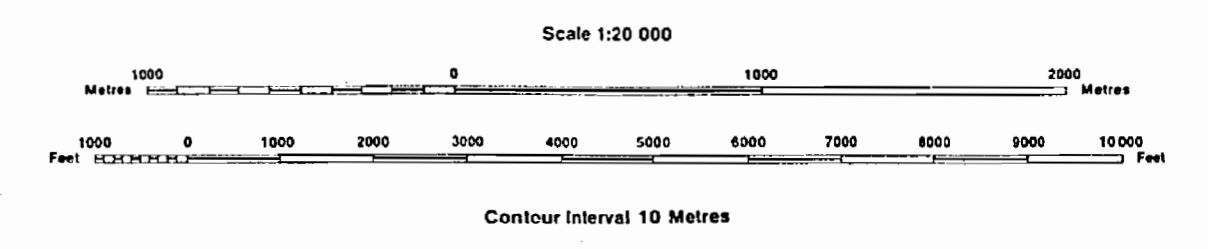

AREAS WITHDRAWN FROM DISPOSITION
 MRO - Mining Rights Only
 SRO - Surface Rights Only
 M+S - Mining and Surface Rights

SYMBOLS

Description	Order No.	Date	Disposition	File
Boundary				
Township, Meridian, Baseline				
Road allowance, surveyed				
shoreline				
Lot/Concession; surveyed				
unsurveyed				
Parcel; surveyed				
unsurveyed				
Right-of-way; road				
railway				
utility				
Reservation				
Cliff, Pit, Pile				
Contour				
Interpolated				
Approximate				
Depression				
Control point (horizontal)				
Flooded land				
Mine head frame				
Pipeline (above ground)				
Railway; single track				
double track				
abandoned				
Road; highway, county, township				
access				
trail, bush				
Shoreline (original)				
Transmission line				
Wooded area				

DISPOSITION OF CROWN LANDS

Patent	
Surface & Mining Rights	●
Surface Rights Only	○
Mining Rights Only	○
Lease	
Surface & Mining Rights	■
Surface Rights Only	□
Mining Rights Only	□
Licence of Occupation	▼
Order-in-Council	○
Cancelled	○
Reservation	○
Sand & Gravel	○

THIS MAP SHOWS THE APPROXIMATE LOCATION OF THE BOUNDARIES OF THE AREA WHICH IS THE SUBJECT OF CURRENT LITIGATION. THE EXACT LOCATION WILL BE SHOWN FOLLOWING CONFIRMATION BY THE PARTIES TO THE ACTION.
 ARCHIVED SEPT. 19, 1996
 ARCHIVED FEB. 22/95
 CIRCULATED AUG. 19, 1992 B.R.B.

THE INFORMATION THAT APPEARS ON THIS MAP HAS BEEN COMPILED FROM VARIOUS SOURCES, AND ACCURACY IS NOT GUARANTEED. THOSE WISHING TO STAKE MINING CLAIMS SHOULD CONSULT WITH THE MINING RECORDER, MINISTRY OF NORTHERN DEVELOPMENT AND MINES, FOR ADDITIONAL INFORMATION ON THE STATUS OF THE LANDS SHOWN HEREON.

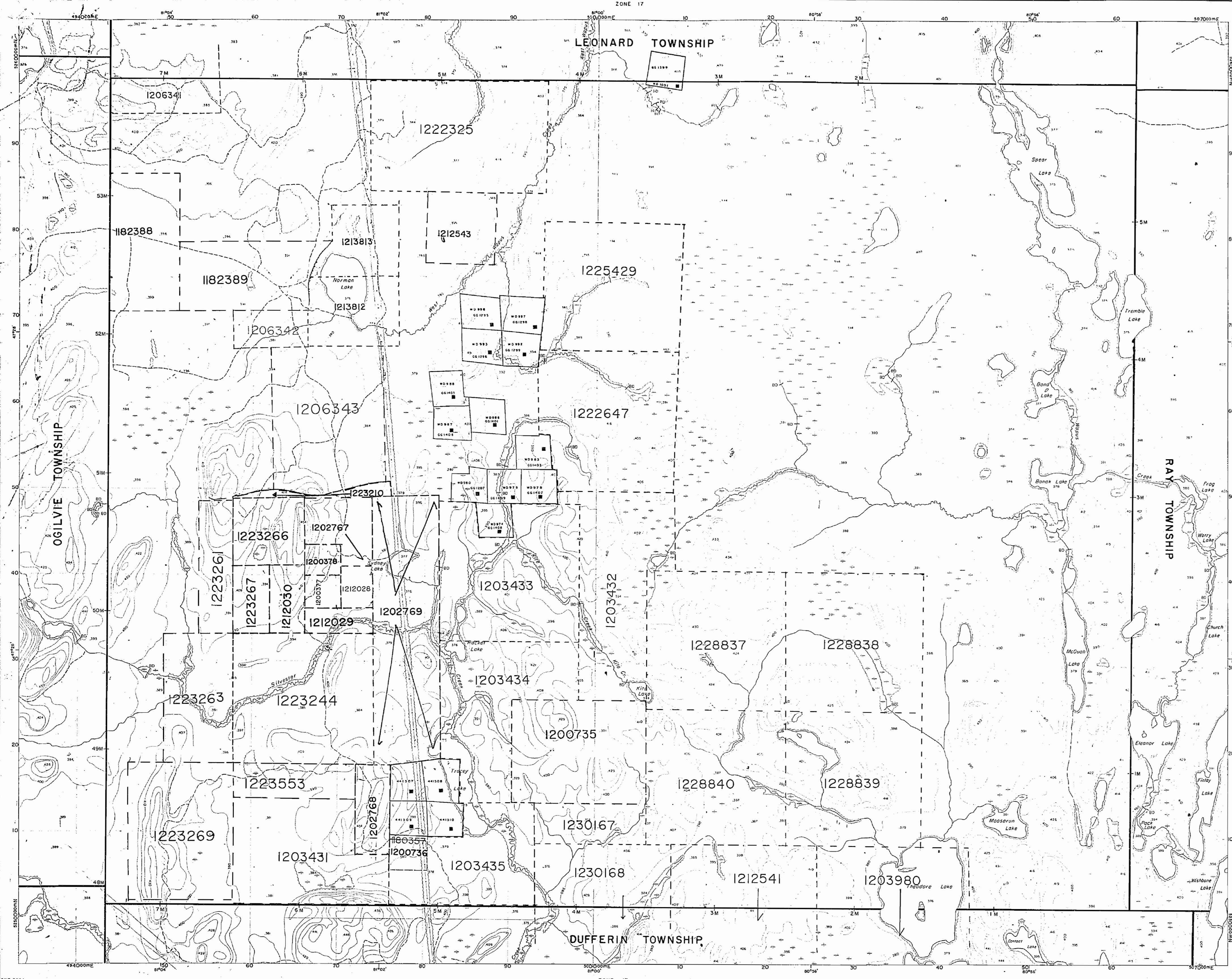

INDEX TO LAND DISPOSITION

PLAN
G-3694
TOWNSHIP

M.N.R. ADMINISTRATIVE DISTRICT
KIRKLAND LAKE
MINING DIVISION
LARDER LAKE
LAND TITLES/REGISTRY DIVISION
TIMISKAMING

NORTH WILLIAMS

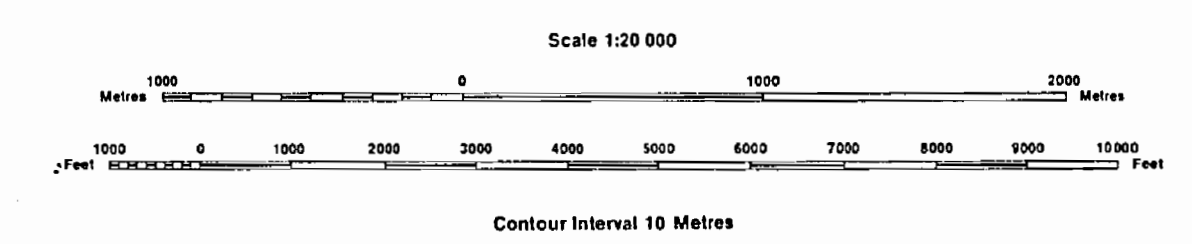

AREAS WITHDRAWN FROM DISPOSITION

MRO - Mining Rights Only
SRO - Surface Rights Only
M+S - Mining and Surface Rights

Description	Order No.	Date	Disposition	File
SEC.35/80	NRW 12/82	3/4/90	S.R.M.	

**Part of Order NRW 12/82 RE-OPENED by order
O-M.C.I.-90 NER effective April 3, 1990 at 7:00 AM E.S.T.

SYMBOLS

Boundary	Township, Meridian, Baseline	—
Road allowance; surveyed	shoreline	—
Lot/Concession; surveyed	unsurveyed	—
Parcel; surveyed	unsurveyed	—
Right-of-way; road	railway	—
	utility	—
Reservation		—
Cliff, Pit, Pile		—
Contour	Interpolated	—
	Approximate	—
	Depression	—
Control point (horizontal)		—
Flooded land		—
Mine head frame		—
Pipeline (above ground)		—
Railway; single track	double track	—
	abandoned	—
Road; highway, county, township	access	—
	trail, bush	—
Shoreline (original)		—
Transmission line		—
Wooded area		—

DISPOSITION OF CROWN LANDS

Patent	Surface & Mining Rights	●
	Surface Rights Only	○
	Mining Rights Only	◐
Lease	Surface & Mining Rights	■
	Surface Rights Only	□
	Mining Rights Only	◼
Licence of Occupation		▼
Order-in-Council		OC
Cancelled		⊙
Reservation		⊕
Sand & Gravel		⊗

THIS MAP SHOWS THE APPROXIMATE LOCATION OF THE BOUNDARIES OF THE AREA WHICH IS THE SUBJECT OF CURRENT LITIGATION. THE EXACT LOCATION WILL BE SHOWN FOLLOWING CONFIRMATION BY THE PARTIES TO THE ACTION.

ARCHIVED FEB. 22/95
CIRCULATED AUG. 19, 1992 B.R.B.

THE INFORMATION THAT APPEARS ON THIS MAP HAS BEEN COMPILED FROM VARIOUS SOURCES, AND ACCURACY IS NOT GUARANTEED. THOSE WISHING TO STAKE MINING CLAIMS SHOULD CONSULT WITH THE MINING RECORDER, MINISTRY OF NORTHERN DEVELOPMENT AND MINES, FOR ADDITIONAL INFORMATION ON THE STATUS OF THE LANDS SHOWN HEREON.

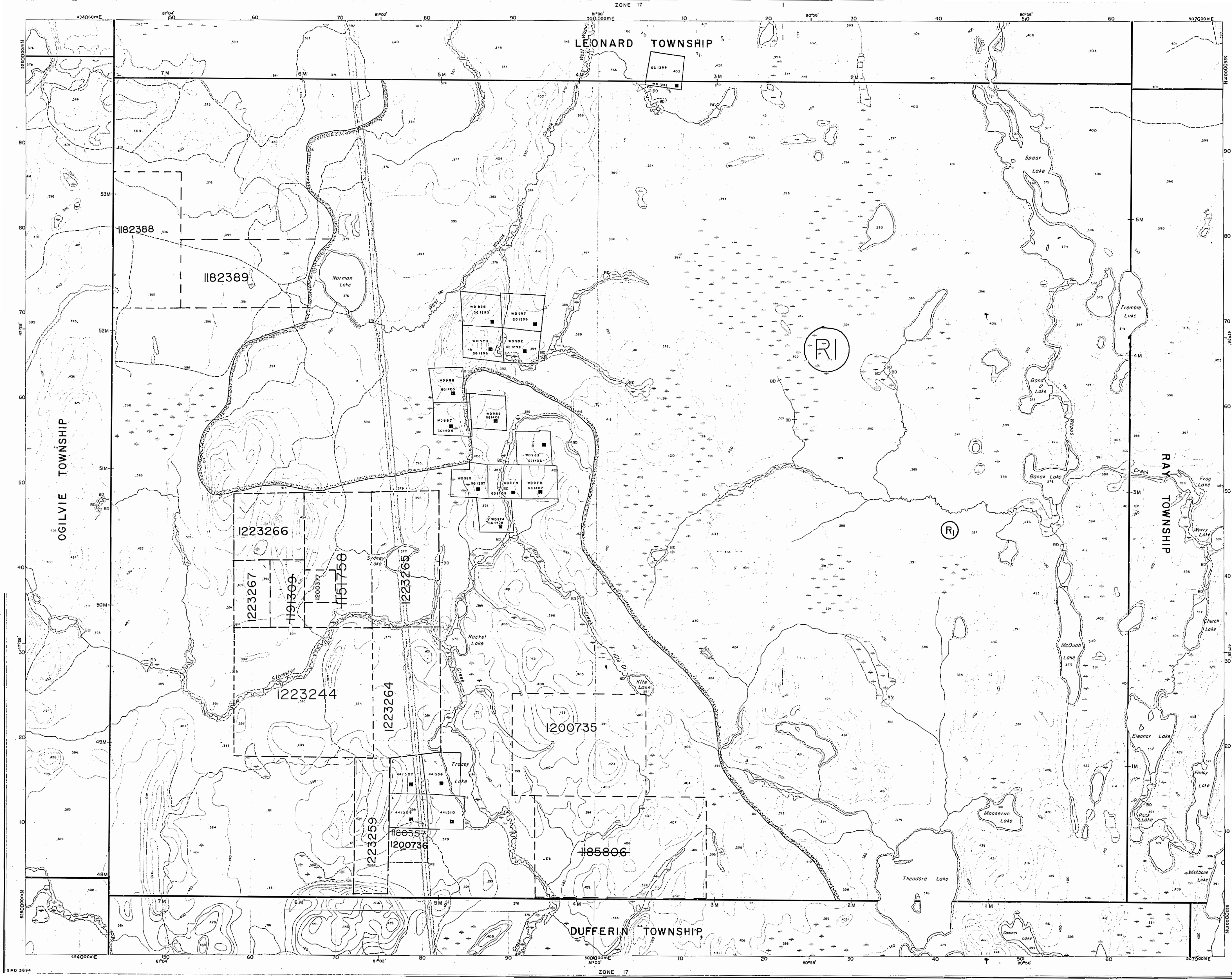

geology reference-COBALT

RESIDENT GEO.

Leonard Twp

THE TOWNSHIP OF NORTH WILLIAMS

DISTRICT OF TIMISKAMING

LARDER LAKE MINING DIVISION

SCALE 1-INCH=40 CHAINS

LEGEND

PATENTED LAND	⊙
CROWN LAND SALE	CS.
LEASES	Ⓢ
LOCATED LAND	Ⓛ
LICENSE OF OCCUPATION	L.O.
MINING RIGHTS ONLY	M-R.O.
SURFACE RIGHTS ONLY	S.R.O.
ROADS	—
IMPROVED ROADS	—
KING'S. HIGHWAYS	—
RAILWAYS	—
POWER LINES	—
MARSH OR MUSKEG	—
MINES	X

NOTES

Note This Twp. Lies in the TIMAGAMI PROVINCIAL FOREST

400' Surface rights reservation around all lakes and rivers.

Township closed to staking effective May 8 1978, Sec. 38(f) of The Mining Act.

Surface & Mining Rights on all Crown land in this township withdrawn.

Crown prospecting, staking out, sale or lease, Sec 36, RSO, 1980, The Mining Act.

Order No. NRW/12/82 Effective Oct 19, 1982, 1206

NOTICE OF FORESTRY ACTIVITY

THIS TOWNSHIP / AREA FALLS WITHIN THE ELK LAKE MANAGEMENT UNIT

AND MAY BE SUBJECT TO FORESTRY OPERATIONS. THE MNR UNIT FORESTER FOR THIS AREA CAN BE CONTACTED AT: P.O. BOX 129

SWASTIKA, ONT. POK ITO 705-642-3222

PLAN NO - M-240

MINISTRY OF NATURAL RESOURCES

SURVEY AND MAPPING BRANCH

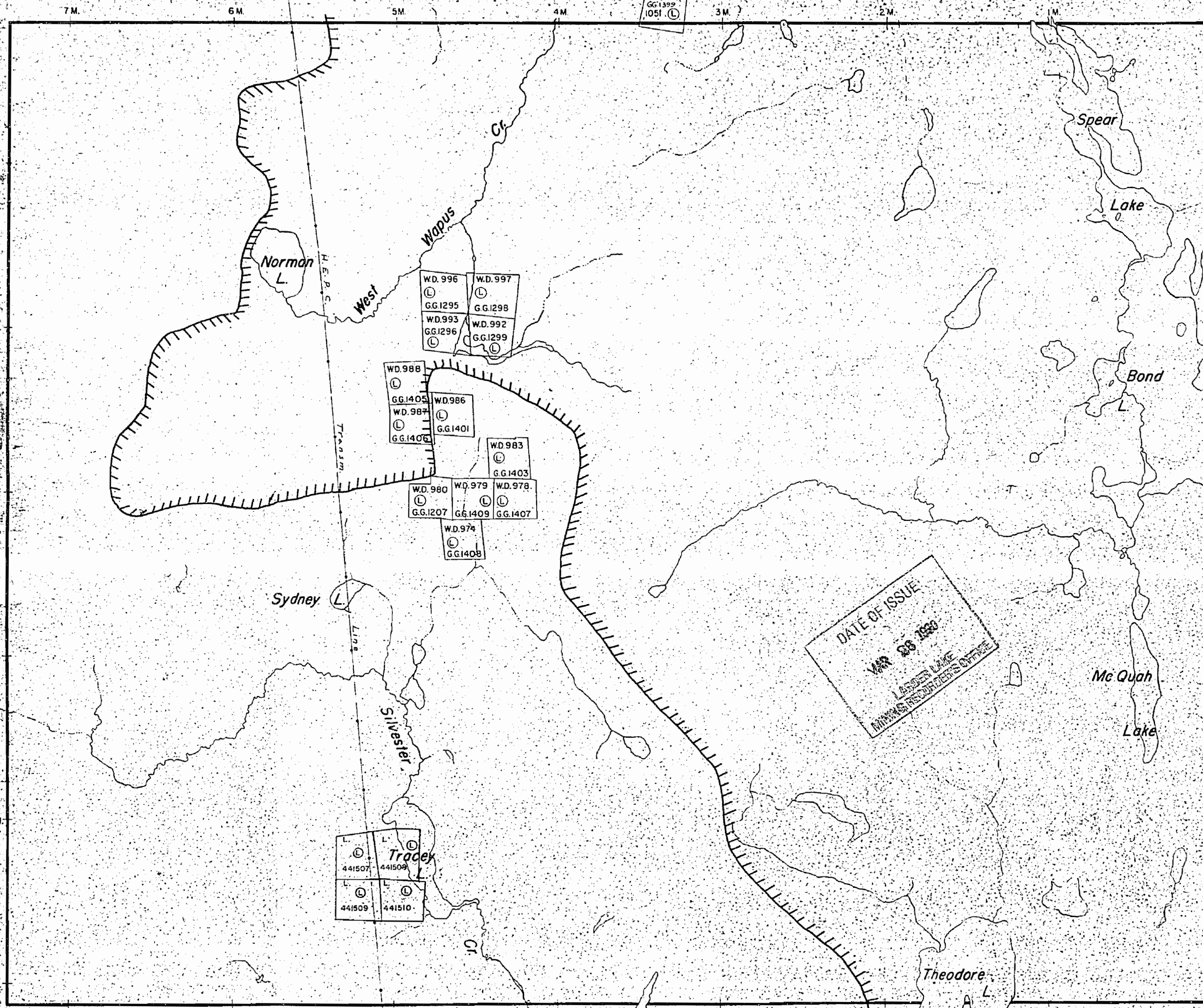

THIS MAP SHOWS THE APPROXIMATE LOCATION OF THE BOUNDARIES OF THE AREA WHICH IS THE SUBJECT OF CURRENT LITIGATION. THE EXACT

THE INFORMATION THAT APPEARS ON THIS MAP HAS BEEN COMPILED FROM VARIOUS SOURCES AND ACCURACY IS NOT GUARANTEED. THOSE WISHING TO STAKE MINING CLAIMS SHOULD CONSULT WITH THE MINING RECORDER, MINISTRY OF NORTHERN DEVELOPMENT AND MINES, FOR ADDITIONAL INFORMATION ON THE STATUS OF THE LANDS SHOWN HEREON.

INDEX TO LAND DISPOSITION

PLAN
G-3694
 TOWNSHIP

M.N.R. ADMINISTRATIVE DISTRICT
KIRKLAND LAKE
 MINING DIVISION
LARDER LAKE
 LAND TITLES/REGISTRY DIVISION
TIMISKAMING

NORTH WILLIAMS

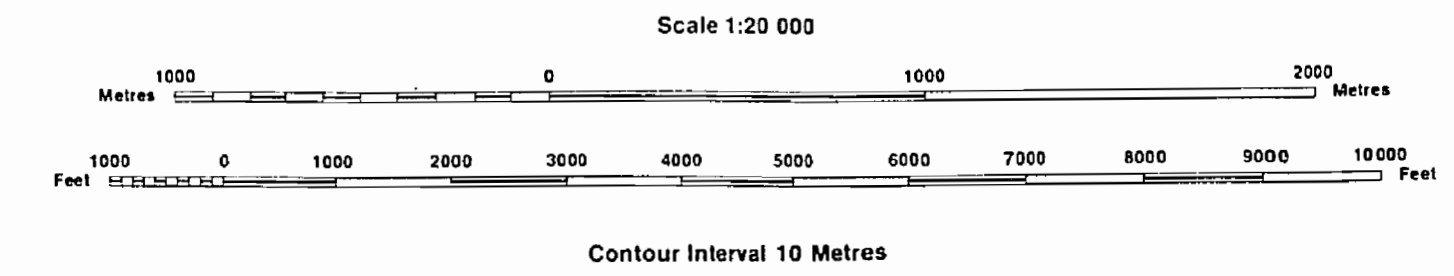

AREAS WITHDRAWN FROM DISPOSITION

MRO - Mining Rights Only
 SRO - Surface Rights Only
 M + S - Mining and Surface Rights

SYMBOLS

Description	Order No.	Date	Disposition	File
Boundary				
Township, Meridian, Baseline				
Road allowance; surveyed				
shoreline				
Lot/Concession; surveyed				
unsurveyed				
Parcel; surveyed				
unsurveyed				
Right-of-way; road				
railway				
utility				
Reservation				
Cliff, Pit, Pile				
Contour				
Interpolated				
Approximate				
Depression				
Control point (horizontal)				
Flooded land				
Mine head frame				
Pipeline (above ground)				
Railway; single track				
double track				
abandoned				
Road; highway, county, township				
access				
trail, bush				
Shoreline (original)				
Transmission line				
Wooded area				

DATE OF ISSUE

MAR 13 1998

PROVINCIAL RECORDING
 OFFICE - SUBURBY

DISPOSITION OF CROWN LANDS

Patent	
Surface & Mining Rights	●
Surface Rights Only	○
Mining Rights Only	○
Lease	
Surface & Mining Rights	■
Surface Rights Only	□
Mining Rights Only	□
Licence of Occupation	▼
Order-in-Council	OC
Cancelled	⊙
Reservation	⊙
Sand & Gravel	⊙

"THIS MAP SHOWS THE APPROXIMATE LOCATION OF THE BOUNDARIES OF THE AREA WHICH IS THE SUBJECT OF CURRENT LITIGATION. THE EXACT LOCATION WILL BE SHOWN FOLLOWING CONFIRMATION BY THE PARTIES TO THE ACTION."

APPROVED SEPT. 19, 1996
 ARCHIVED FEB. 22/95
 CIRCULATED AUG. 19, 1992 B.R.B.

THE INFORMATION THAT APPEARS ON THIS MAP HAS BEEN COMPILED FROM VARIOUS SOURCES AND ACCURACY IS NOT GUARANTEED. THOSE WISHING TO STAKE MINING CLAIMS SHOULD CONSULT WITH THE MINING RECORDER, MINISTRY OF NORTHERN DEVELOPMENT AND MINES, FOR ADDITIONAL INFORMATION ON THE STATUS OF THE LANDS SHOWN HEREON.

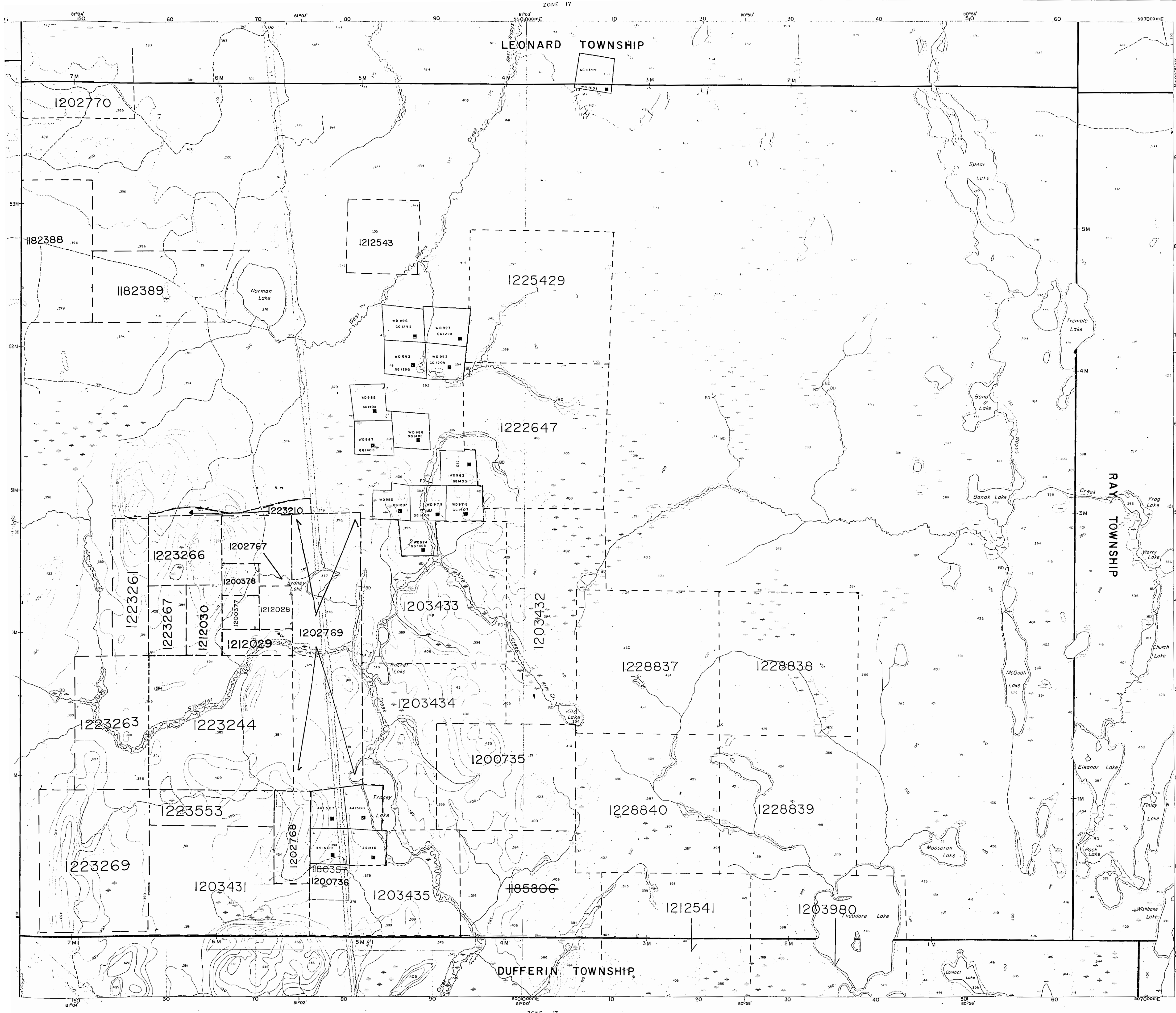

INDEX TO LAND DISPOSITION

PLAN
G-3694
 TOWNSHIP

M.N.R. ADMINISTRATIVE DISTRICT
KIRKLAND LAKE
 MINING DIVISION
LARDER LAKE
 LAND TITLES/REGISTRY DIVISION
TIMISKAMING

NORTH WILLIAMS

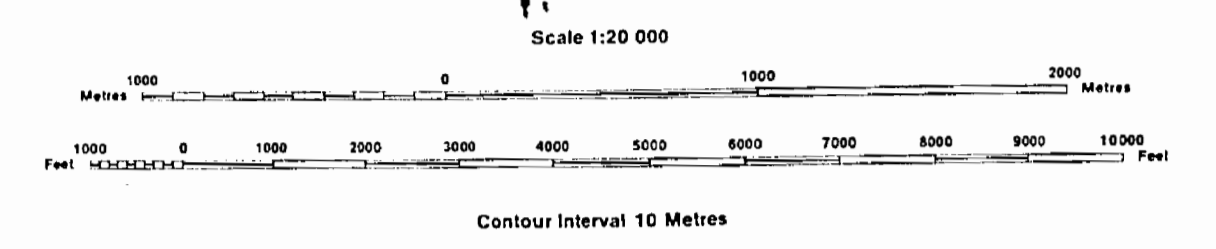

AREAS WITHDRAWN FROM DISPOSITION
 MRO - Mining Rights Only
 SRO - Surface Rights Only
 M+S - Mining and Surface Rights

SYMBOLS

Description	Order No.	Date	Disposition	File
Boundary				
Township, Meridian, Baseline				
Road allowance; surveyed				
shoreline				
Lot/Concession; surveyed				
unsurveyed				
Parcel; surveyed				
unsurveyed				
Right-of-way; road				
railway				
utility				
Reservation				
Chit, Pit, Pile				
Contour				
Interpolated				
Approximate				
Depression				
Control point (horizontal)				
Flooded land				
Mine head frame				
Pipeline (above ground)				
Railway; single track				
double track				
abandoned				
Road; highway, county, township				
access				
trail, bush				
Shoreline (original)				
Transmission line				
Wooded area				

DATE OF ISSUE

MAR 17 1998
 PROVINCE OF ONTARIO
 OFFICE, SUDBURY

DISPOSITION OF CROWN LANDS

Patent	
Surface & Mining Rights	●
Surface Rights Only	○
Mining Rights Only	○
Lease	
Surface & Mining Rights	■
Surface Rights Only	□
Mining Rights Only	□
Licence of Occupation	▼
Order-in-Council	○
Cancelled	○
Reservation	○
Sand & Gravel	○

THIS MAP SHOWS THE APPROXIMATE LOCATION OF THE BOUNDARIES OF THE AREA WHICH IS THE SUBJECT OF CURRENT LITIGATION. THE EXACT LOCATION WILL BE SHOWN FOLLOWING CONFIRMATION BY THE PARTIES TO THE ACTION.

REVISED SEPT. 19, 1996
 ARCHIVED FEB. 22/95
 CIRCULATED AUG. 19, 1992 B.R.B.

THE INFORMATION THAT APPEARS ON THIS MAP HAS BEEN COMPILED FROM VARIOUS SOURCES AND ACCURACY IS NOT GUARANTEED. THOSE WISHING TO STAKE MINING CLAIMS SHOULD CONSULT WITH THE MINING RECORDER, MINISTRY OF NORTHERN DEVELOPMENT AND MINES, FOR ADDITIONAL INFORMATION ON THE STATUS OF THE LANDS SHOWN HEREON.

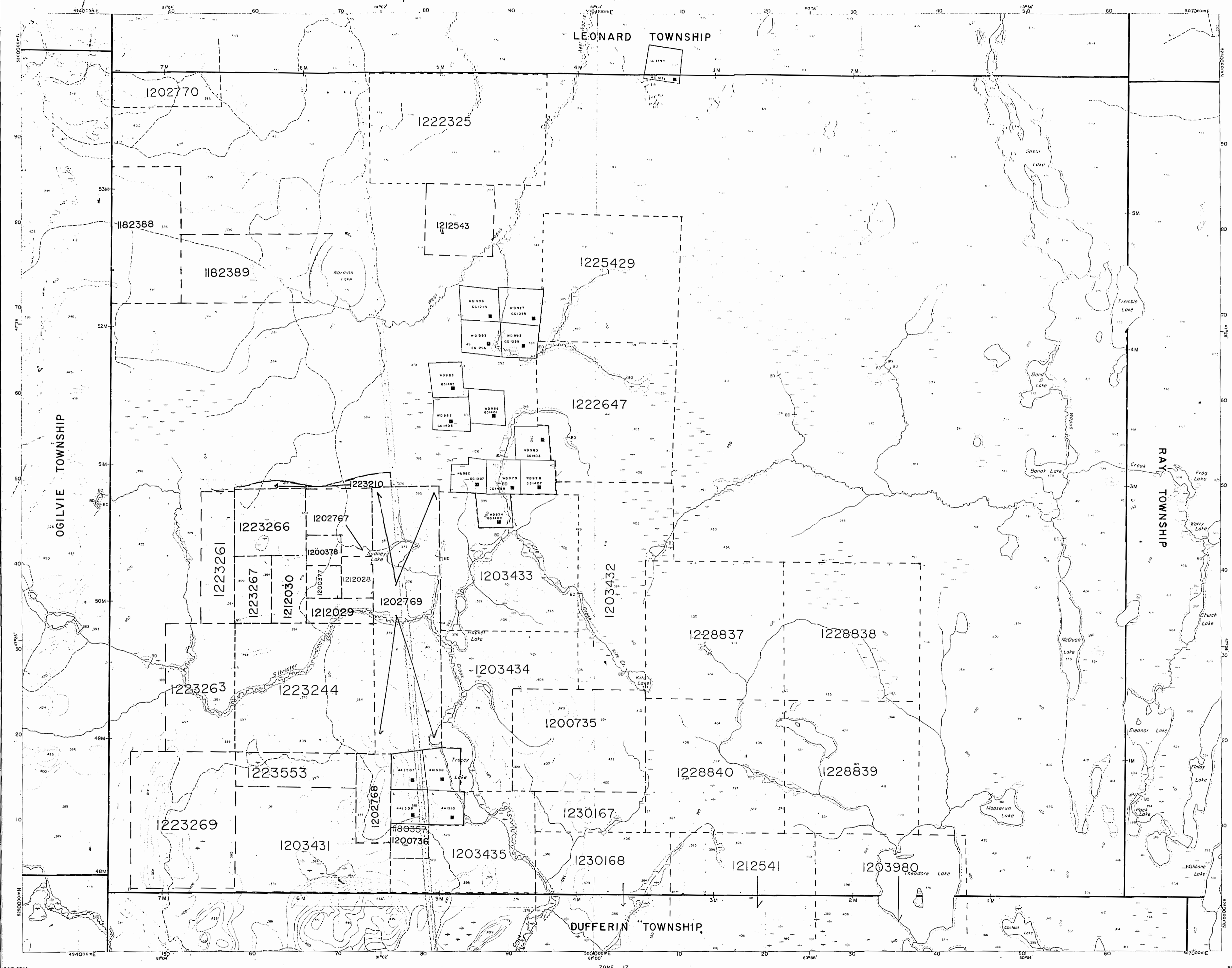

Leonard Twp

THE TOWNSHIP OF NORTH WILLIAMS

DISTRICT OF TIMISKAMING

MONTREAL RIVER MINING DIVISION

SCALE: 1-INCH=40 CHAINS

LEGEND

- PATENTED LAND Ⓟ
- CROWN LAND - SALE CS
- LEASES Ⓢ
- LOCATED LAND Loc
- LICENSE OF OCCUPATION L.O.
- MINING RIGHTS ONLY M.R.O.
- SURFACE RIGHTS ONLY S.R.O.
- ROADS — — — — —
- IMPROVED ROADS — — — — —
- KING'S HIGHWAYS — — — — —
- RAILWAYS — — — — —
- POWER LINES — — — — —
- MARSH OR MUSKEG — — — — —
- MINES X

NOTES

Note: This Twp. Lies in the TIMAGAMI PROVINCIAL FOREST

M 240

PLAN NO. - ~~M 240~~

DEPARTMENT OF MINES

— ONTARIO —

Ogilvie Twp

Ray Twp

Dufferin Twp

Revised Feb 26/13

H.E.P.C. LINE

