

2027
N. F. REDDITT
2027

2644

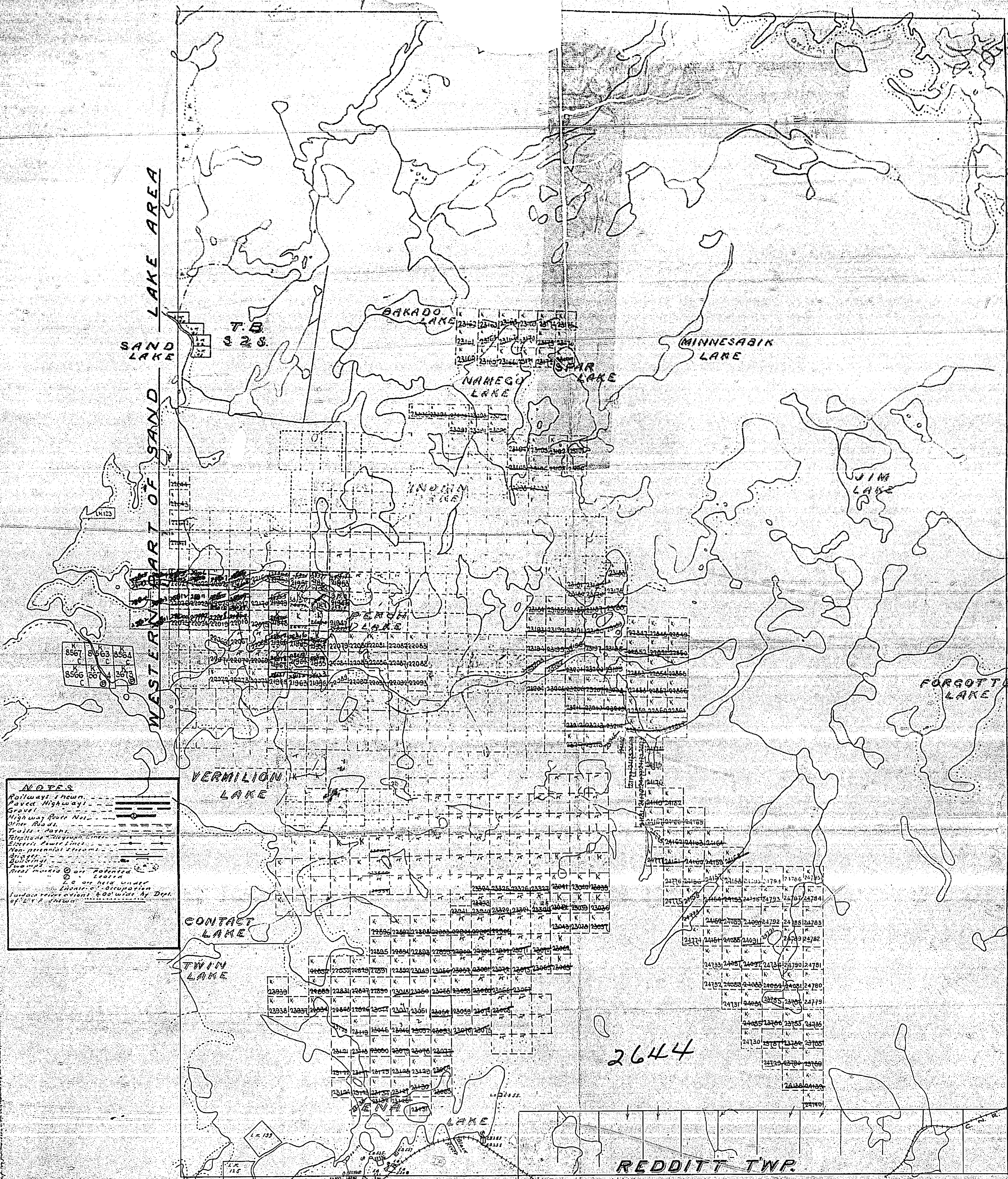
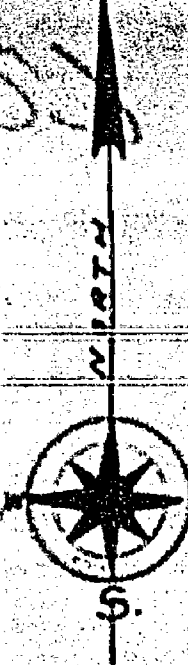

NOTES
Railways shown
Paved Highway
Gravel
Highway River Not
Other Roads
Trails Paths
Electric Highways
Electric Power Lines
Non-perennial streams
Drainage
Shading
Great marked on Potentia
L.S. on held under
License of Occupation
Surface relocations 400' wide by Dept.
of E. & F. shown

PLAN OF
AREA NORTH OF REDDITT TWP.
KENORA MINING DIVISION - DISTRICT OF KENORA
Scale 40 chains to an inch.

2027

2027
N.F. REDDITT
2027

2644

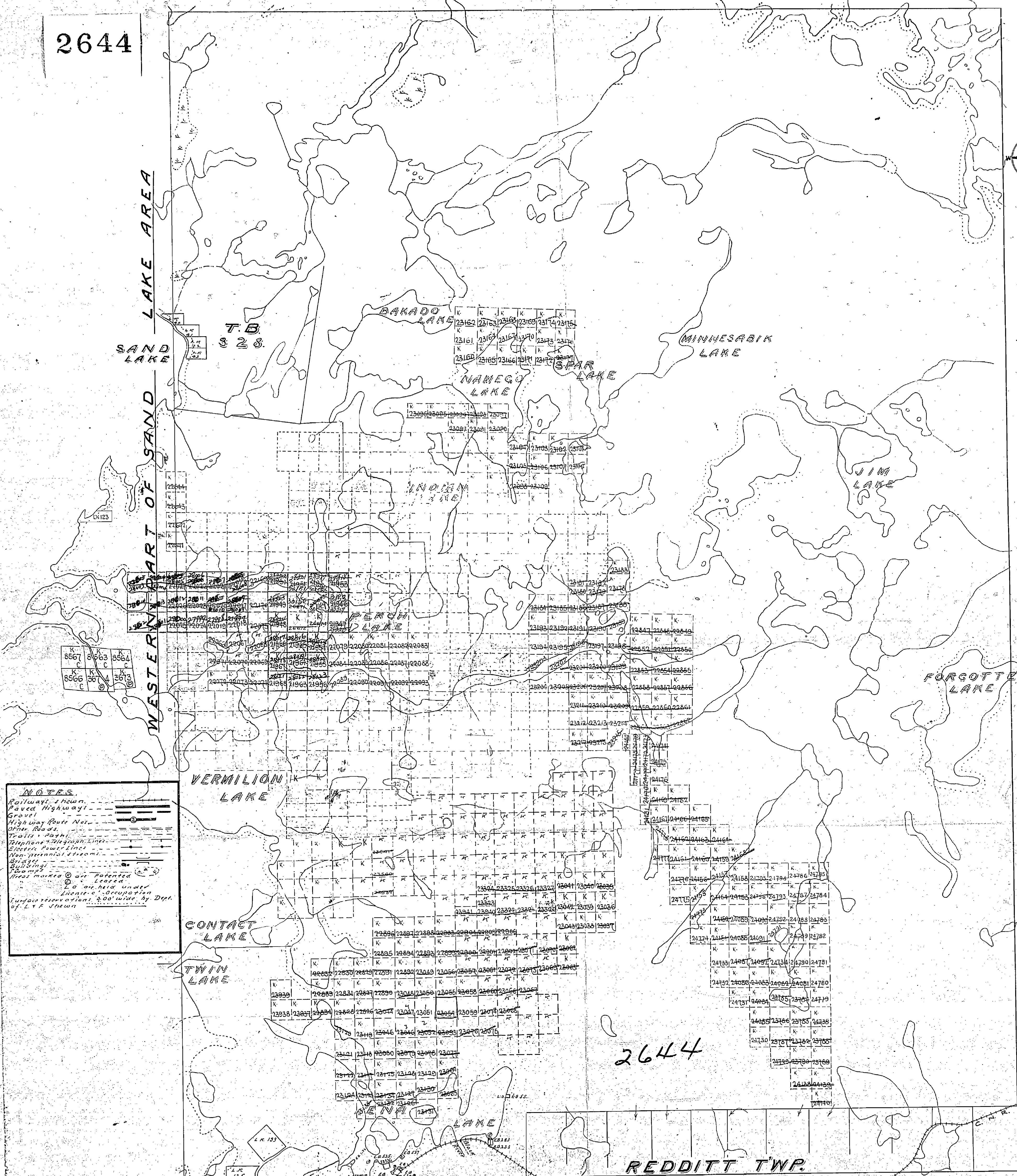
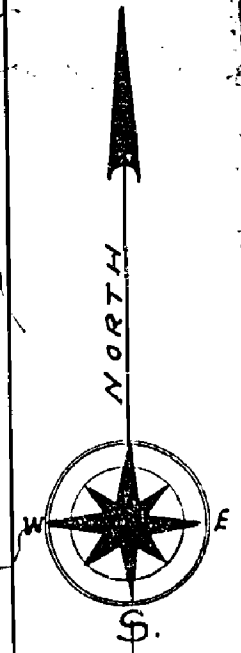

NOTES.
Railways shown
Paved Highway
Gravel
Highway Route Not
Other Roads
Trails & Paths
Telephone Lines
Electric Power Lines
Non-perennial streams
Bridges
Buildings
Ponds
Docks marked @ are patented
© are leased
Land held under
License of Occupation
Turf reservation 400' wide by Dept.
of L & F shown

PLAN OF
AREA NORTH OF REDDITT TWP.
KENORA MINING DIVISION - DISTRICT OF KENORA

2027

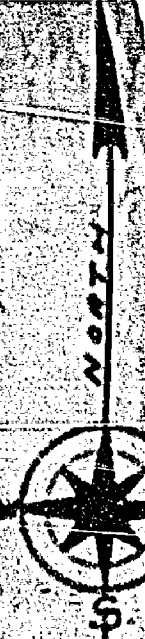

LAKE AREA

WESTERN PART OF SAND

EASTERN PART OF FARLANE AREA

SAND LAKE

7.5
826

BAKADO LAKE

MINNESABIK LAKE

NAMEGO LAKE

SPAR LAKE

JIM LAKE

FORGOTTEN LAKE

BERON LAKE

VERMILION LAKE

CONTACT LAKE

TWIN LAKE

8567	8563	8564
K	C	C
8566	8567	8563
C	C	C

NOTES
Railways shown. ---
Paved Highway. ---
Gravel Highway. ---
Highway Route No. ---
Other Roads. ---
Trails, Paths, ---
Telephone, Telegraph Lines. ---
Electric Power Lines. ---
Non-perennial streams. ---
Buildings. ---
Sheds marked with a circle. ---
L.S. on Red under ---
L.S. on Red under ---
Surface elevations 700' wide by Dept. of L.S. shown.

May 27/63
Apr. 30/65

2644

RECEIVED
MAY 15 1961

REDDITT TWP.

M2027

2027

DISTRICT OF KENORA