

NORTH PART SOUTHBLUFF CREEK

DISTRICT OF COCHRANE

PORCUPINE MINING DIVISION

SCALE: 1-INCH = 40 CHAINS

LEGEND

- PATENTED LAND Ⓟ
- CROWN LAND SALE C.S.
- LEASES Ⓛ
- LOCATED LAND Loc.
- LICENSE OF OCCUPATION L.O.
- MINING RIGHTS ONLY M.R.O.
- SURFACE RIGHTS ONLY S.R.O.
- ROADS —
- IMPROVED ROADS —
- KING'S HIGHWAYS —
- RAILWAYS —
- POWER LINES —
- MARSH OR MUSKEG —
- MINES Ⓜ
- CANCELLED C.

NOTES

400' Surface Rights Reservation around all lakes and rivers.

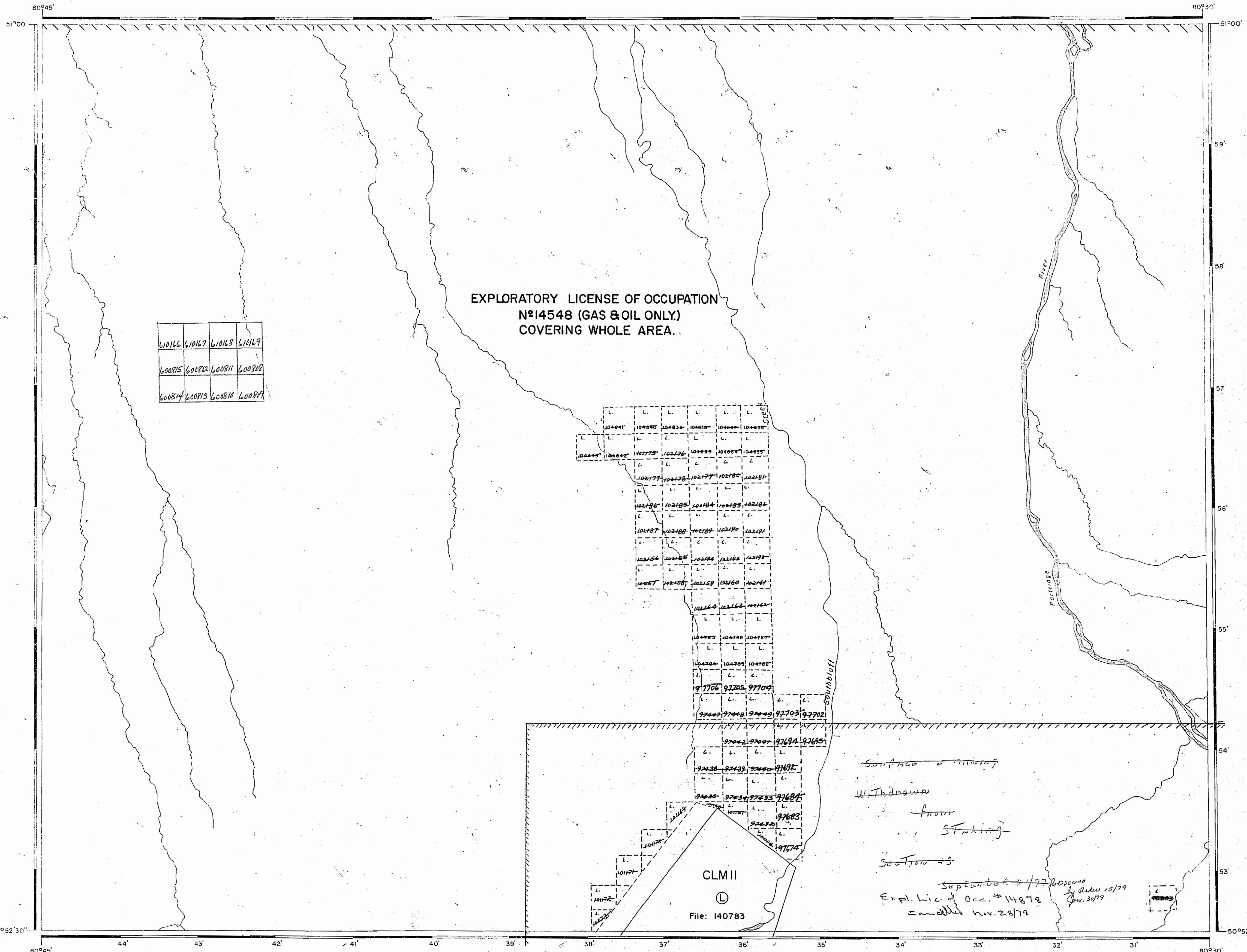

600816	600817	600818	600819
600815	600812	600811	600808
600814	600813	600810	600807

EXPLORATORY LICENSE OF OCCUPATION
 N°14548 (GAS & OIL ONLY)
 COVERING WHOLE AREA.

CLM II
 Ⓛ
 File: 140783

Surface mining
 Withdrawn
 from
 Staking
 Section 43
 September 24/77 Reopened
 by Order 15/79
 Jan. 30/79
 Exp. Lic. of Occ. # 14878
 Cancelled Nov. 28/79

26-B

RECEIVED
 OCT 24 1969
 AM 7 8 9 10 11 12 1 2 3 4 5 6 PM

PLAN NO. M.2955

DEPARTMENT OF MINES
— ONTARIO —

South of Allan Island Area - M.2953

Area - M.2936

EAST OF SOUTHBLUFF CREEK

DISTRICT OF COCHRANE

PORCUPINE MINING DIVISION

SCALE: 1-INCH = 40 CHAINS

LEGEND

- PATENTED LAND Ⓟ
- CROWN LAND SALE C.S.
- LEASES Ⓛ
- LOCATED LAND Loc.
- LICENSE OF OCCUPATION L.O.
- MINING RIGHTS ONLY M.R.O.
- SURFACE RIGHTS ONLY S.R.O.
- ROADS —
- IMPROVED ROADS —
- KING'S HIGHWAYS —
- RAILWAYS —
- POWER LINES —
- MARSH OR MUSKEG —
- MINES ✕
- CANCELLED C.

NOTES

This area represents north-west part of AEROMAGNETIC MAP 2362 G.

400' Surface Rights Reservation around all lakes and rivers.

DATE OF ISSUE
APR 28 1976
 SURVEYS AND MAPPING
 BRANCH

PORCUPINE MINING DIVISION
RECEIVED
 APR 29 1976
 AM 7 18 9 10 11 12 1 2 3 4 5 6 PM

NATIONAL TOPOGRAPHIC SERIES 42 I

PLAN NO. **M.2939**

ONTARIO
MINISTRY OF NATURAL RESOURCES
SURVEYS AND MAPPING BRANCH

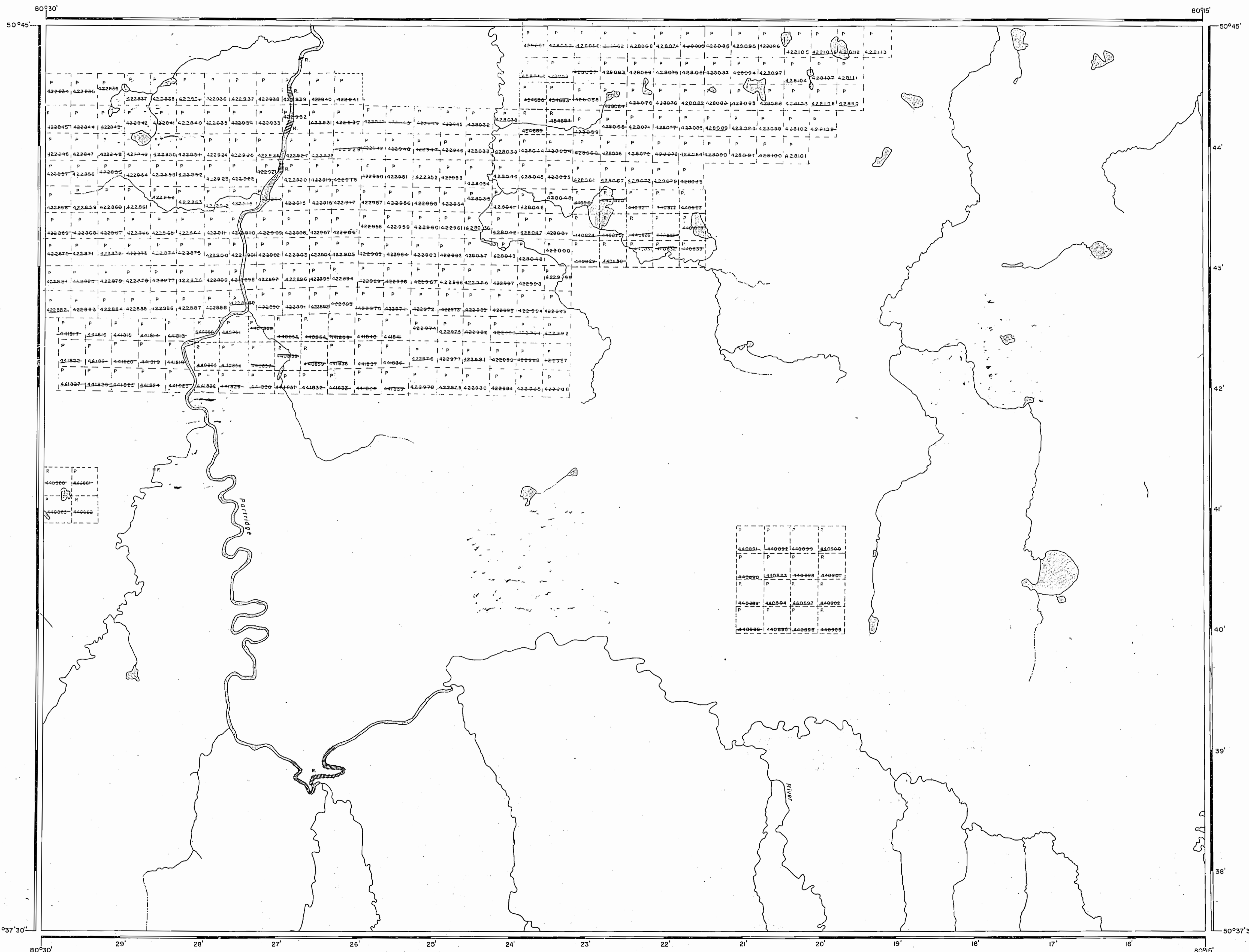

Southbluff Creek Area - M.2945

Area - M. 2940

South of Bushy Island Area - M 2934

AREA OF
NORTH PART
SOUTHBLUFF CREEK

DISTRICT OF
COCHRANE

Porcupine
LARDER LAKE
MINING DIVISION

SCALE: 1-INCH = 40 CHAINS

LEGEND

PATENTED LAND	(P)
CROWN LAND SALE	(C)
LEASE	(L)
ESTATED LAND	(E)
LICENSE BY OCCUPATION	(L.O.)
MINING RIGHTS ONLY	(M.R.O.)
SURFACE RIGHTS ONLY	(S.F.O.)
ROADS	(R)
IMPROVED ROADS	(I.R.)
RIPPLE HIGHWAYS	(R.H.)
RAILWAYS	(R.A.)
POWER LINES	(P.L.)
MASH OR MOUND	(M)
MINES	(X)
UNDEVELOPED	(U)

NOTES

400' Surface Rights Reservation around
all lakes and rivers

South of Allan Island Area - M.2953

Area - M.2936

Exploratory License 14548

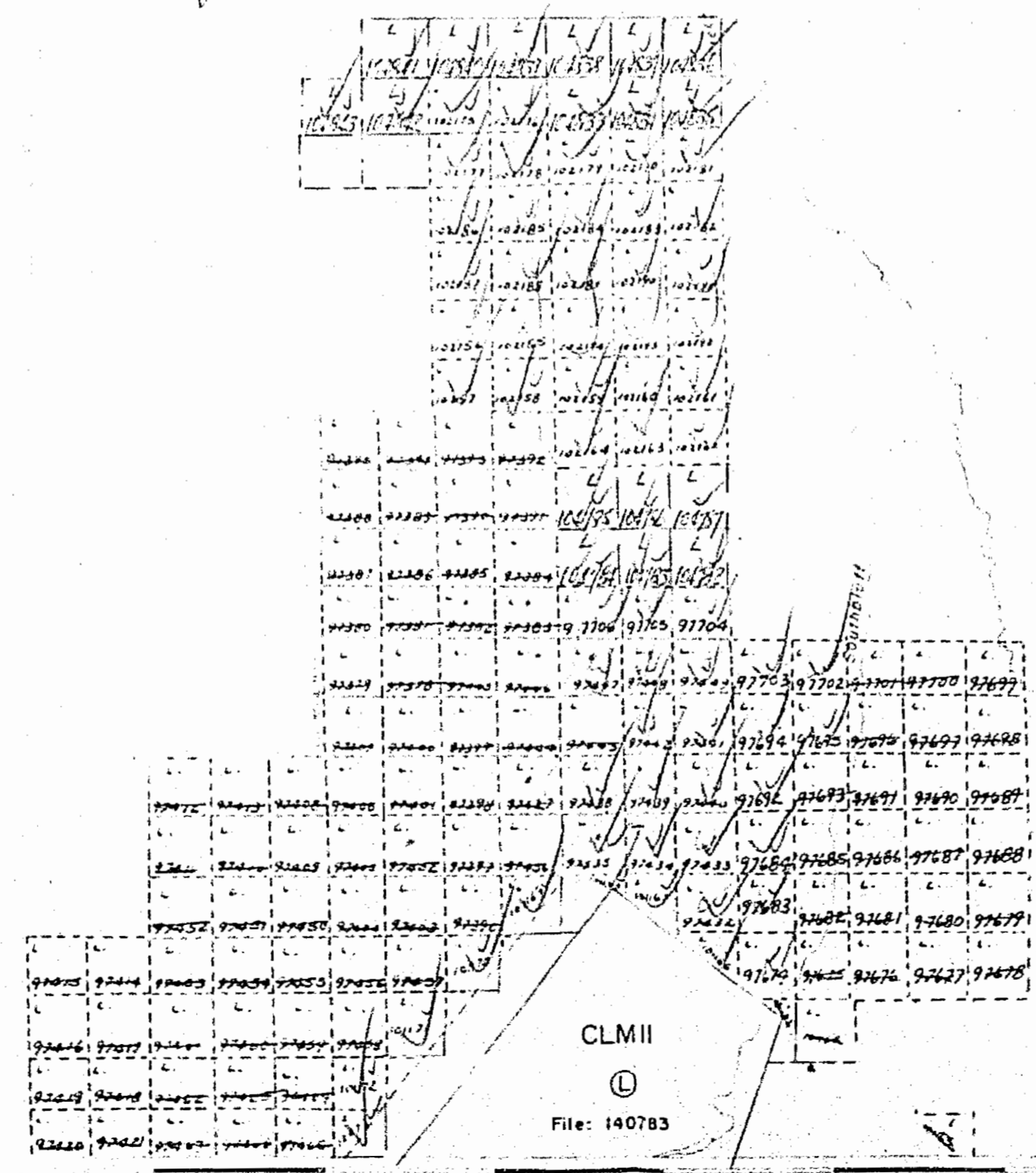

Center Part Southbluff Creek Area - M.2956

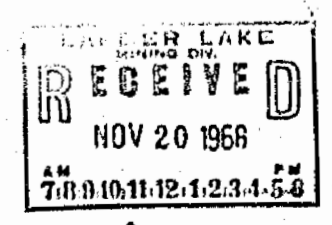

PLAN NO. M.2955

DEPARTMENT OF MINES
— ONTARIO —