

NO SEWORTHY

M 558
ONTARIO
MINISTRY OF NATURAL RESOURCES
SURVEYS AND MAPPING BRANCH

LARDER LAKE MINING DIVISION

DISTRICT OF COCHRANE

Scale - 40 Chains - 1 Inch

NOTE
400' Surface Rights Reservation
around all Lakes and Rivers.

LARDER LAKE
MINING DIV.
RECEIVED
FEB 13 1977
AM
7 18 19 10 11 12 13 14 15 16
PM

North Asly

LEGEND
CANCELLED
PATENTED LAND
CROWN LAND SALE
LEASES
LOCATED LAND
LICENSE OF OCCUPATION
MINING RIGHTS ONLY
SURFACE RIGHTS ONLY

⊙
⊙
⊙
⊙
⊙
⊙
⊙

*Replaced by Mylar
Sept 13/79*

Chabbie Lake

54M 55M 56M 57M 58M 59M 60M 61M 62M 63M

HOBLITZELL

BRADLETTE



HAVE BEEN
 TO THE
 SURFACE
 (NOT IN
 PARCEL BOUND
 MINING CLAIMS
 RAILWAY AND
 UTILITIES
 AND RESERVATION
 FLOODING OR
 SURVEYING OF
 RESERVATION
 ORIGINAL SHOR
 MINES AND
 TRAVELING

DISPOSITION OF CROWN LAND

TYPE OF DOCUMENT	SYMBOL
PATENT SURFACE MINING RIGHTS	●
SURFACE RIGHTS ONLY	○
MINING RIGHTS ONLY	◐
LEASE SURFACE & MINING RIGHTS	◑
SURFACE RIGHTS ONLY	◒
MINING RIGHTS ONLY	◓
LICENSE OF OCCUPATION	◔
ORDER IN COUNCIL	◕
RESERVATION	◖
CANCELLED	◗
SAND & GRAVEL	◘
Remote (air) set-up	◙

NOTE: MINING RIGHTS TABLES PATENTED PRIOR TO 1913
 1913: VERIFIED IN ORIGINAL PATENTEE BY THE PUBLIC
 LANDS ACT, R.S.O. 1910, CHAP. 200, SECT. 5, SUBSEC. 1

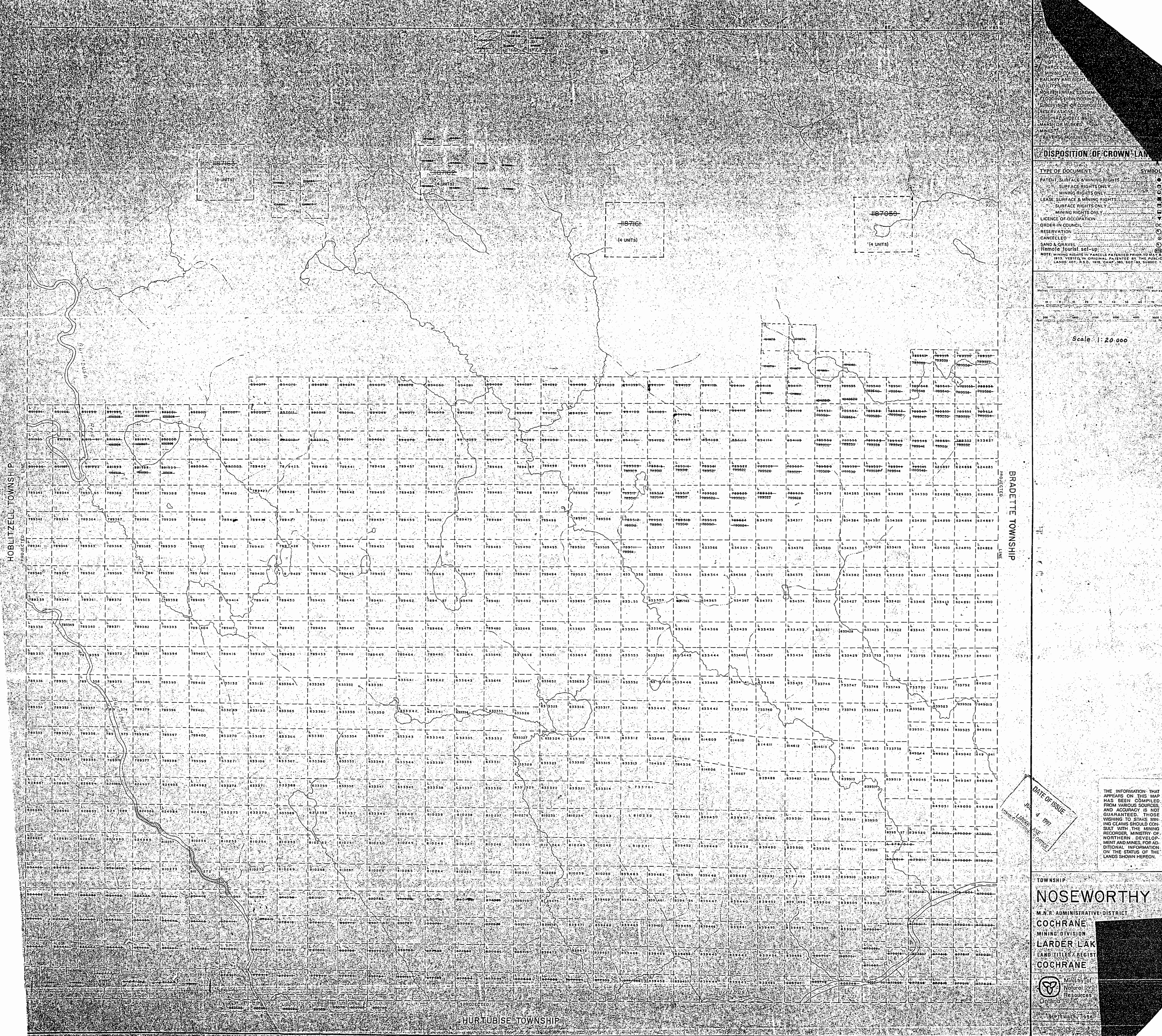
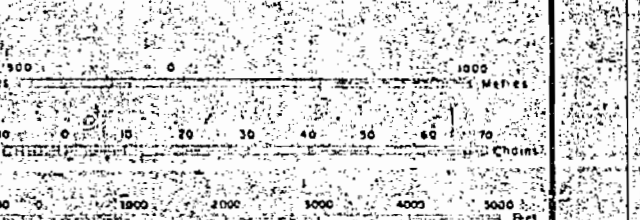

HOBLITZELL TOWNSHIP
 BRADETTE TOWNSHIP
 HURTUBISE TOWNSHIP

THE INFORMATION THAT APPEARS ON THIS MAP HAS BEEN COMPILED FROM VARIOUS SOURCES, AND ACCURACY IS NOT GUARANTEED. THOSE WISHING TO STAKE MINING CLAIMS SHOULD CONSULT WITH THE MINING RECORDER, MINISTRY OF NORTHERN DEVELOPMENT AND MINES, FOR ADDITIONAL INFORMATION ON THE STATUS OF THE LANDS SHOWN HEREON.

DATE OF ISSUE
 JULY 4, 1997
 MINING CLAIMS OFFICE

TOWNSHIP
NOSEWORTHY
 M.N.R. ADMINISTRATIVE DISTRICT
COCHRANE
 MINING DIVISION
LARDER LAK
 LAND TITLES / REGIST
COCHRANE

Ministry of
 Natural Resources
 Ontario

1997
 26 FEBRUARY 1998

AREAS WITHDRAWN FROM DISPOSITION

- MINING RIGHTS ONLY
- SURFACE RIGHTS ONLY
- MINING AND SURFACE RIGHTS

Map of Crown Lands, Ontario

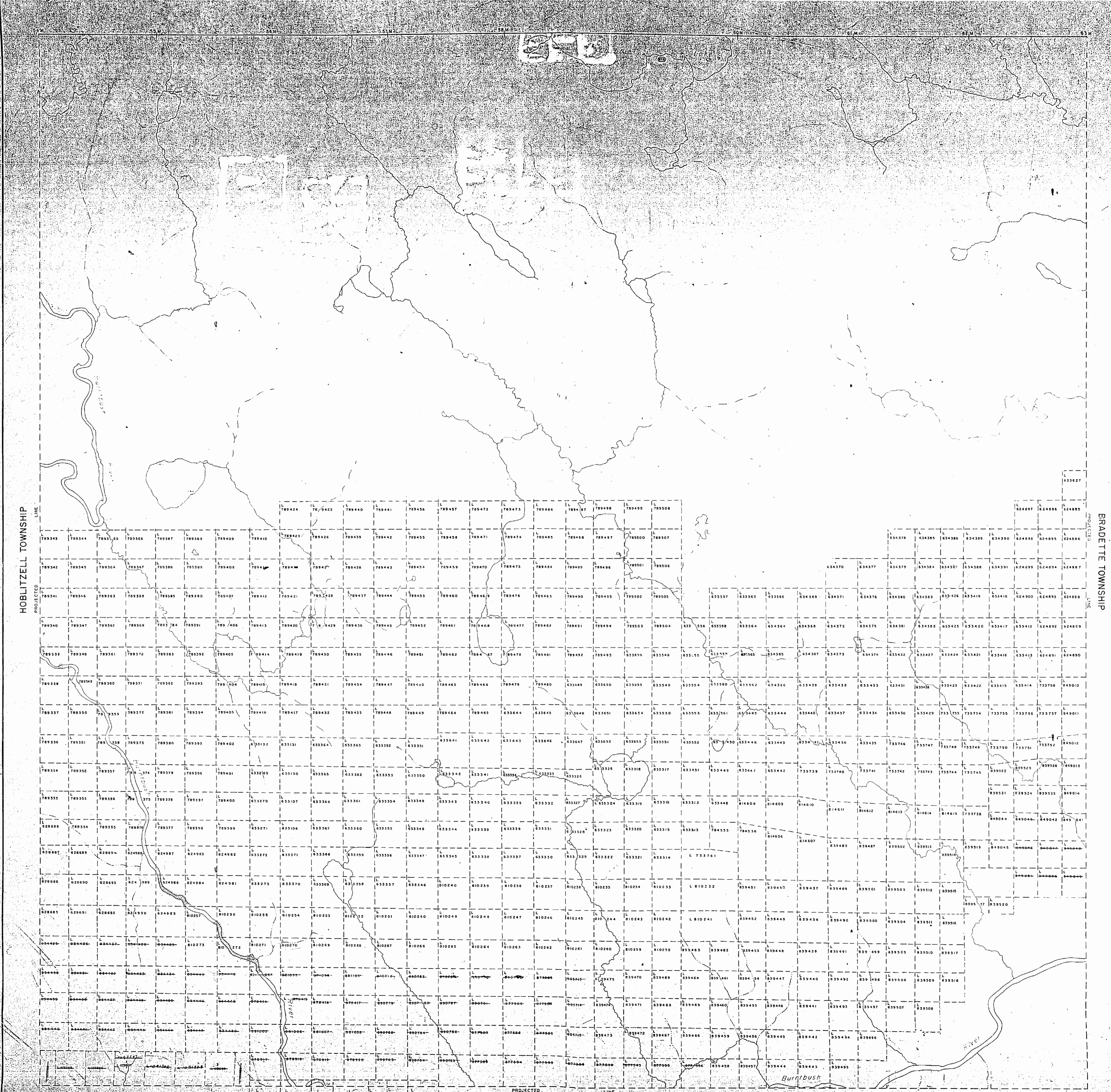

LEGEND

HIGHWAY AND	[Symbol]
RAILWAY	[Symbol]
TRAIL	[Symbol]
SURVEYED LINES	[Symbol]
TOWN, LOTS, PARCELS, ETC.	[Symbol]
LOTS, MINING PLANS, PARCELS, ETC.	[Symbol]
UNAPPROVED LINES	[Symbol]
LOT LINES	[Symbol]
PARCEL BOUNDARY	[Symbol]
MINING CLAIMS ETC.	[Symbol]
RAILWAY AND RIGHT OF WAY	[Symbol]
UTILITY LINES	[Symbol]
NON-FERROUS STREAM	[Symbol]
FLOODING OR FLOODING RIGHTS	[Symbol]
SUBDIVISION OR COMPOSITE PLAN	[Symbol]
RESERVATION	[Symbol]
ORIGINAL SHORELINE	[Symbol]
MARSH OR MUSKEG	[Symbol]
MINES	[Symbol]
TRAVERSE MONUMENT	[Symbol]

DISPOSITION OF CROWN LANDS

TYPE OF DOCUMENT	SYMBOL
PATENT, SURFACE & MINING RIGHTS	[Symbol]
SURFACE RIGHTS ONLY	[Symbol]
MINING RIGHTS ONLY	[Symbol]
LEASE, SURFACE & MINING RIGHTS	[Symbol]
SURFACE RIGHTS ONLY	[Symbol]
MINING RIGHTS ONLY	[Symbol]
LICENCE OF OCCUPATION	[Symbol]
ORDER IN COUNCIL	[Symbol]
RESERVATION	[Symbol]
CANCELLED	[Symbol]
SAND & GRAVEL	[Symbol]
Remote tourist set-up	[Symbol]

NOTE: MINING RIGHTS IN PARCELS PATENTED PRIOR TO MAY 1, 1913, VESTED IN ORIGINAL PATENTEES BY THE PUBLIC LANDS ACT R.S.O. 1910 CHAP. 130, SEC. 43, SUBSEC. 1.

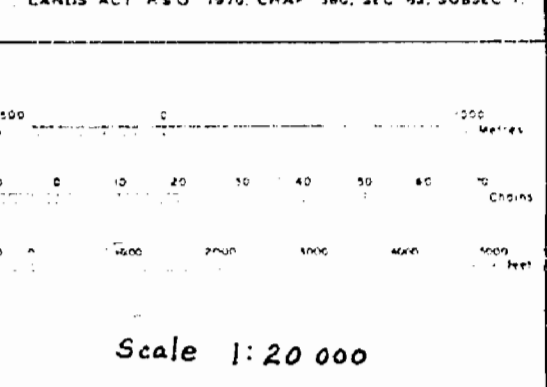

DATE OF ISSUE
 APR 29 1988
 PROVINCIAL RECORDING OFFICE - SUDBURY

THE INFORMATION THAT APPEARS ON THIS MAP HAS BEEN COMPILED FROM VARIOUS SOURCES, AND ACCURACY IS NOT GUARANTEED. THOSE WISHING TO MAKE MINING CLAIMS SHOULD CONSULT WITH THE MINING RECORDER, MINISTRY OF NORTHERN DEVELOPMENT AND MINES, FOR ADDITIONAL INFORMATION ON THE STATUS OF THE LANDS SHOWN HEREON.

TOWNSHIP
NOSEWORTHY
 M.N.R. ADMINISTRATIVE DISTRICT
COCHRANE
 MINING DIVISION
LARDER LAKE
 LAND TITLES / REGISTRY DIVISION
COCHRANE

Ministry of Natural Resources
 Ministry of Northern Development and Mines

DATE: SEPTEMBER, 1986
 Number: **G-3549**

REFERENCES

AREAS WITHDRAWN FROM DISPOSITION

M.R.O. - MINING RIGHTS ONLY
 S.R.O. - SURFACE RIGHTS ONLY
 M.S. - MINING AND SURFACE RIGHTS

Description	Order No.	Date	Disposition	File

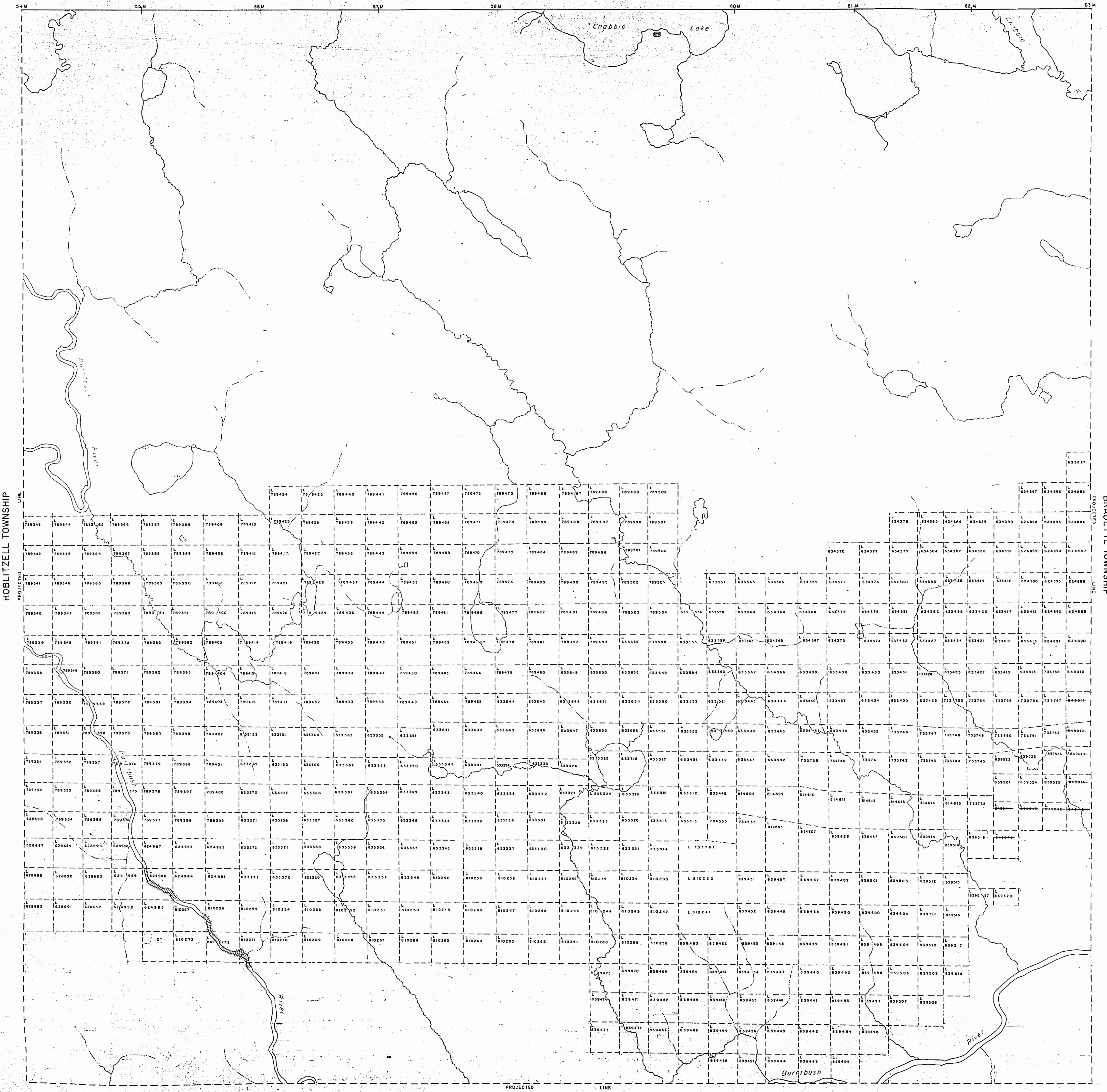

LEGEND

- HIGHWAY AND ROUTE No.
- OTHER ROADS
- TRAILS
- SURVEYED LINES
- TOWNSHIP, BASE LINES, ETC.
- LOTS, MINING CLAIMS, PARCELS, ETC.
- UNSURVEYED LINES
- LOT LINES
- PARCEL BOUNDARY
- MINING CLAIMS ETC.
- RAILWAY AND RIGHT OF WAY
- UTILITY LINES
- NON-PERENNIAL STREAM
- FLOODING OR FLOODING RIGHTS
- SUBDIVISION OR COMPOSITE PLAN
- RESERVATIONS
- ORIGINAL SHORELINE
- MARSH OR MUSKEG
- MINES
- TRAVERSE MONUMENT

DISPOSITION OF CROWN LANDS

TYPE OF DOCUMENT	SYMBOL
PATENT, SURFACE & MINING RIGHTS	●
" SURFACE RIGHTS ONLY	○
" MINING RIGHTS ONLY	◐
LEASE, SURFACE & MINING RIGHTS	◑
" SURFACE RIGHTS ONLY	◒
" MINING RIGHTS ONLY	◓
LICENCE OF OCCUPATION	◔
ORDER IN COUNCIL	OC
RESERVATION	○
CANCELLED	○
SAND & GRAVEL	○
PROMISE TO SETTLE	○

NOTE: MINING RIGHTS IN PARCELS PATENTED PRIOR TO MAY 20, 1912, VESTED IN ORIGINAL PATENTEES BY THE PUBLIC LANDS ACT, R.S.O. 1910, CHAP. 380, SEC. 63, SUBSEC. 1.

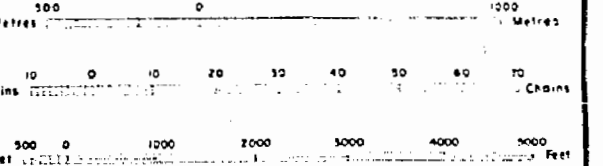

Scale 1:20 000

THE INFORMATION THAT APPEARS ON THIS MAP HAS BEEN COMPILED FROM VARIOUS SOURCES AND ACCURACY IS NOT GUARANTEED. THOSE WISHING TO STAKE MINING CLAIMS SHOULD CONSULT WITH THE MINING RECORDER, MINISTRY OF NORTHERN DEVELOPMENT AND MINES, FOR ADDITIONAL INFORMATION ON THE STATUS OF THE LANDS SHOWN HEREON.

TOWNSHIP
NOSEWORTHY
 M.N.R. ADMINISTRATIVE DISTRICT
COCHRANE
 MINING DIVISION
LARDER LAKE
 LAND TITLES / REGISTRY DIVISION
COCHRANE

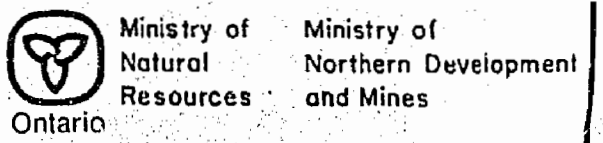

Date SEPTEMBER, 1986
 Number
G-3549

NORTH BRITISH COLUMBIA

MINISTRY OF NATURAL RESOURCES
NEW BRITAIN RANGE

LAKES AND RIVERS DIVISION

DISTRICT OF COCHRANE

Scale - 40 Chains - 1 inch

NOTE
400' Surface Rights Reservation
around all Lakes and Rivers.

#7

North Asly

LEGEND
CANCELLED PATENTED LAND
CROWN LAND SALE
LEASES
LOCATED LAND
LICENSE OF OCCUPATION
MINING RIGHTS ONLY
SURFACE RIGHTS ONLY

C
C.S.
LOC.
L.O.
M.R.O.
S.R.O.

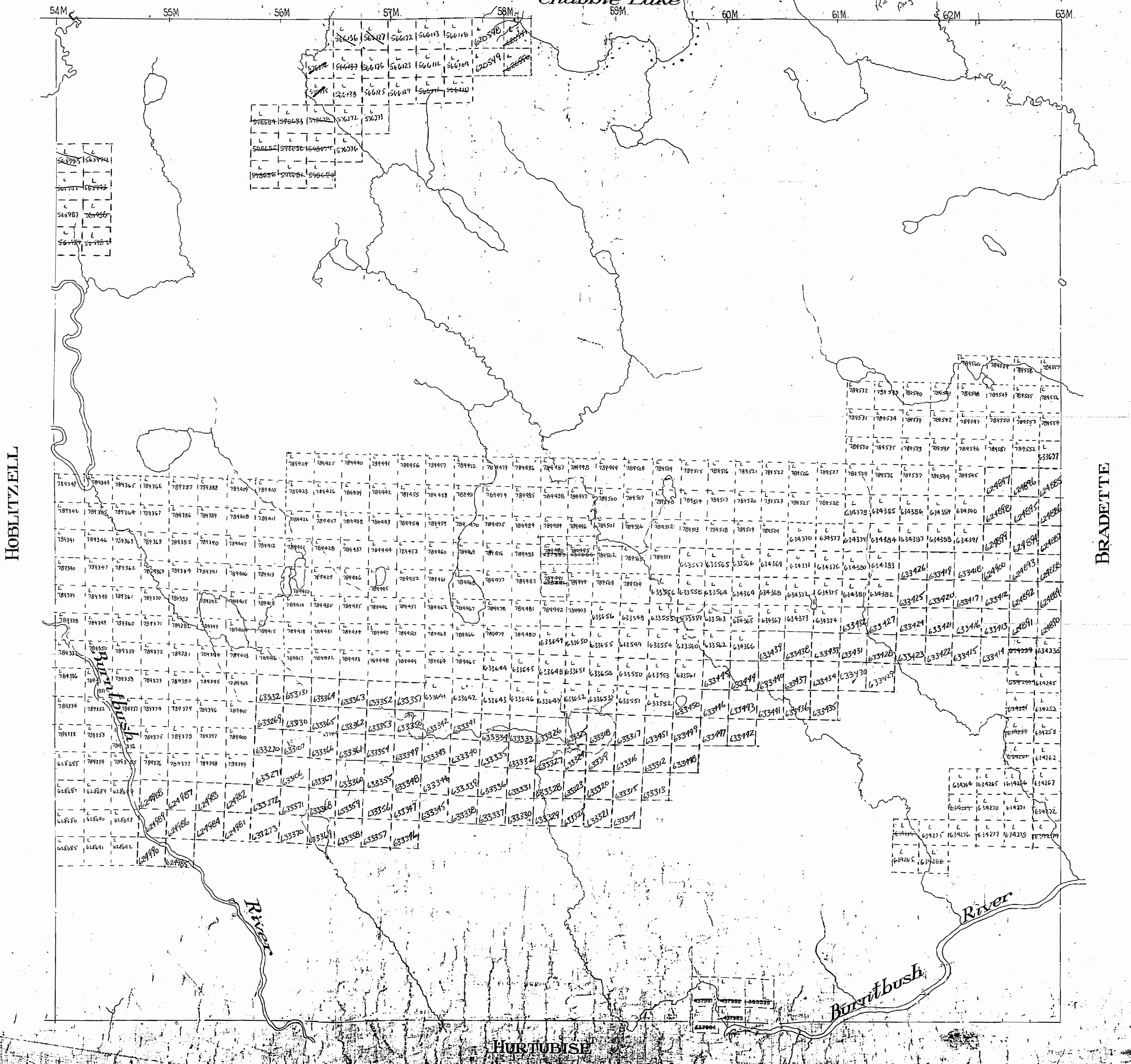

NOSEWORTHY

LARDER LAKE MINING DIVISION

DISTRICT OF COCHRANE

Scale - 40 Chains - Inch.

MINING RECORDER
RECEIVED
JUN 18 1962
KIRKLAND LAKE - ONT.

M. 558
KARDER
LAKE

Replaced
Feb. 14/70

NOTE
400' Surface Rights Reservation
around all Lakes and Rivers.

LEGEND

CANCELLED PATENTED LAND
CROWN LAND SALE
LEASES
LOCATED LAND
LICENSE OF OCCUPATION
MINING RIGHTS ONLY
SURFACE RIGHTS ONLY

⊙
C.S.
⊙
LOC.
L.O.
M.R.O.
S.R.O.

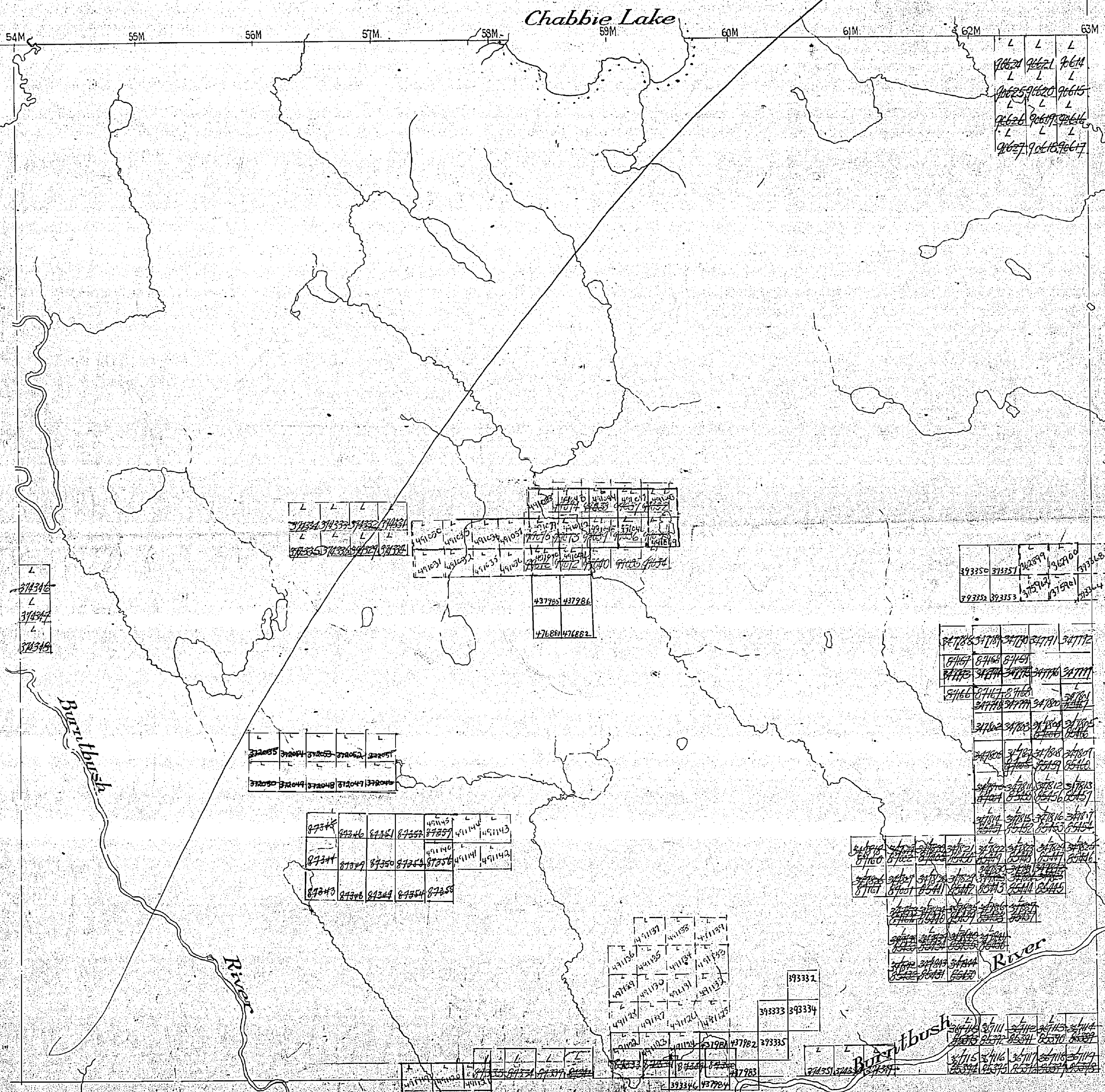

L	L	L
90621	90621	90611
L	L	L
90625	90620	90615
L	L	L
90626	90617	90614
L	L	L
90627	90616	90617

L	L	L	L
43785	43786	43787	43788
L	L	L	L
43789	43790	43791	43792
L	L	L	L
43793	43794	43795	43796
L	L	L	L
43797	43798	43799	43800

L	L	L	L
39335	39337	39339	39340
L	L	L	L
39332	39333	39334	39334

L	L	L	L
34785	34786	34787	34788
L	L	L	L
34789	34790	34791	34792
L	L	L	L
34793	34794	34795	34796
L	L	L	L
34797	34798	34799	34800

L	L	L	L
37200	37201	37202	37203
L	L	L	L
37204	37205	37206	37207

L	L	L	L
87348	87349	87350	87351
L	L	L	L
87352	87353	87354	87355
L	L	L	L
87356	87357	87358	87359

L	L	L	L
34801	34802	34803	34804
L	L	L	L
34805	34806	34807	34808
L	L	L	L
34809	34810	34811	34812
L	L	L	L
34813	34814	34815	34816

L	L	L	L
43798	43799	43800	43801
L	L	L	L
43802	43803	43804	43805
L	L	L	L
43806	43807	43808	43809

L	L	L
39332	39333	39334

L	L	L	L
43798	43799	43800	43801
L	L	L	L
43802	43803	43804	43805

L	L	L	L
34817	34818	34819	34820
L	L	L	L
34821	34822	34823	34824
L	L	L	L
34825	34826	34827	34828

NO SE WORTHY

LARDER LAKE MINING DIVISION M-558

DISTRICT OF COCHRANE

Scale - 40 Chains - 1 Inch.

Replaced July 17/53

North Asly

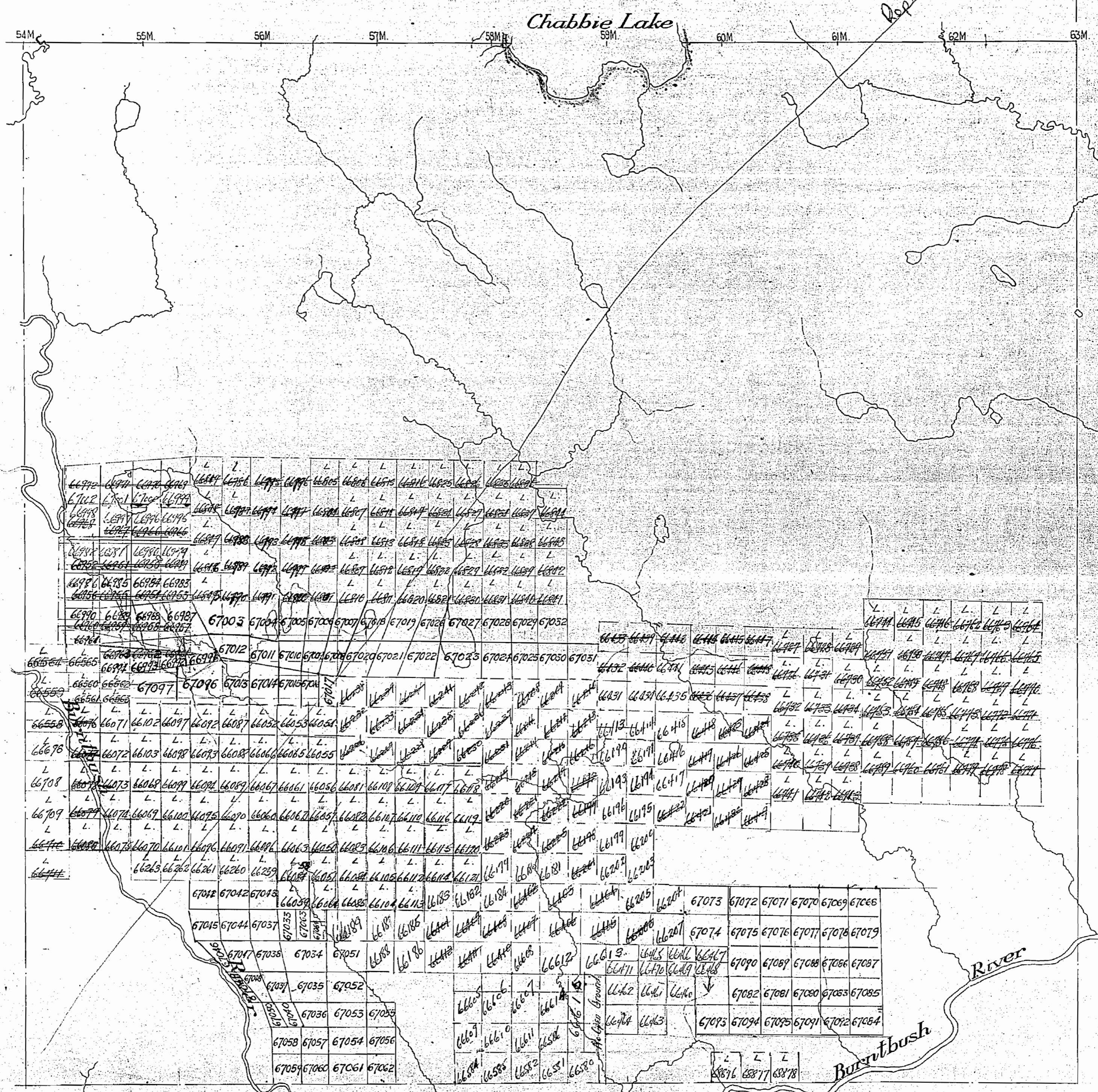

MINING RECORDER
RECEIVED
JUL 17 1959
KIRKLAND LAKE - ONT.

NO SEWORTHY

LARDER LAKE MINING DIVISION

DISTRICT OF COCHRANE

Scale - 40 Chains - 1 Inch.

M-55B

LEGEND

CANCELLED PATENTED LAND
CROWN LAND SALE
LEASES
LOCATED LAND
LICENSES OF OCCUPATION
MINING RIGHTS ONLY
SURFACE RIGHTS ONLY

CS
LOC
L.O.
M.R.O.
S.R.O.

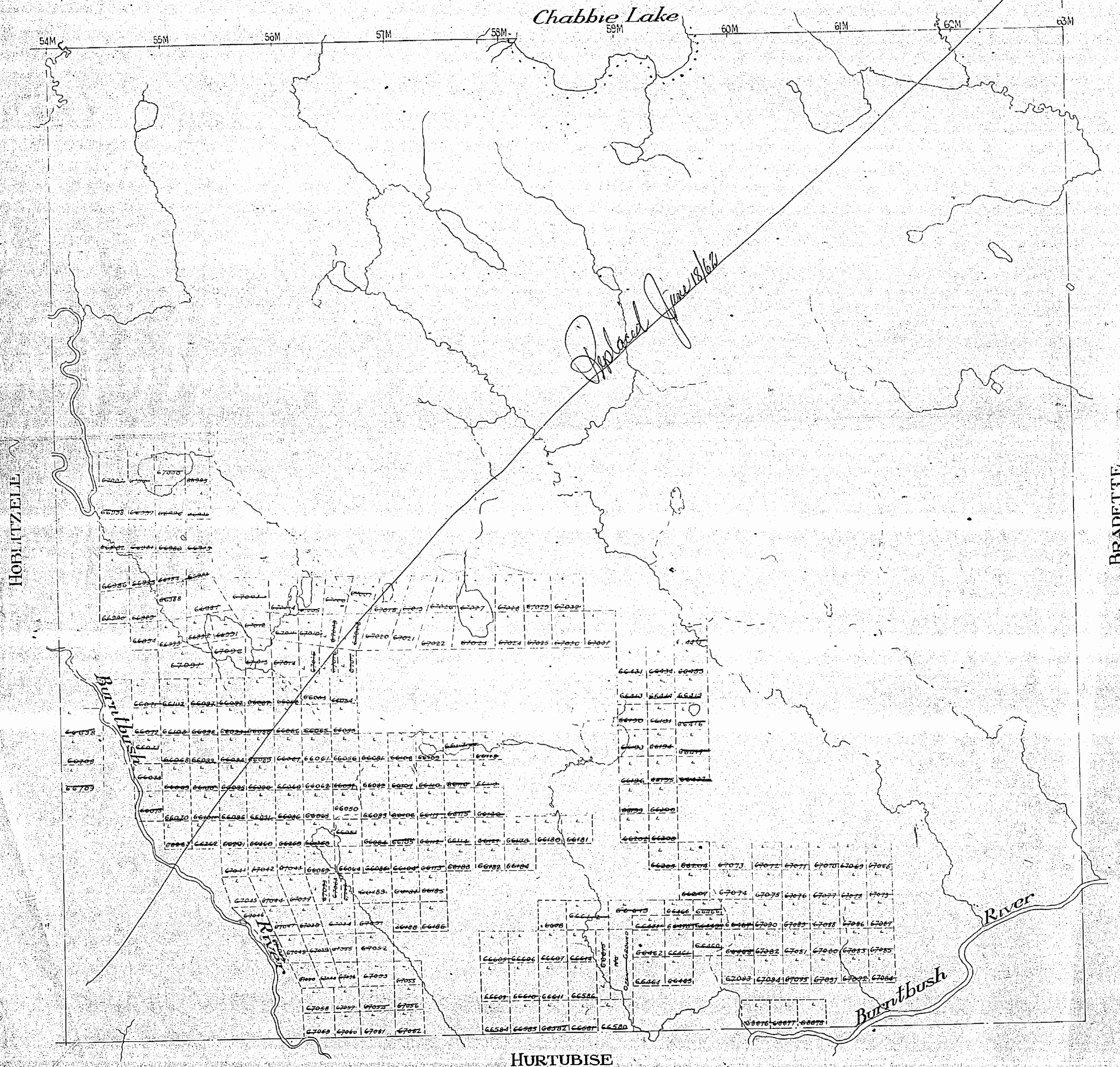

HOBBITZELLE

BRADETTE

HURTUBISE

400' Rsvd. to Dept. of L. F. Spahn Res.

Replaced
Oct. 27/46 Z.R.

17558

LEGEND

CANCELLED PATENTED LAND
CROWN LAND SALE
LEASES
LOCATED LAND
LICENSE OF OCCUPATION
MINING RIGHTS ONLY
SURFACE RIGHTS ONLY

LOC.
L.O.
M.R.O.
S.R.O.

DISTRICT OF COCHRANE

Scale - 40 Chains - Inch

NOTE
400' Surface Rights Reservation
around all Lakes and Rivers.

Chabrie Lake

RECEIVED
August 17-1934

#7
#7

North - NELY

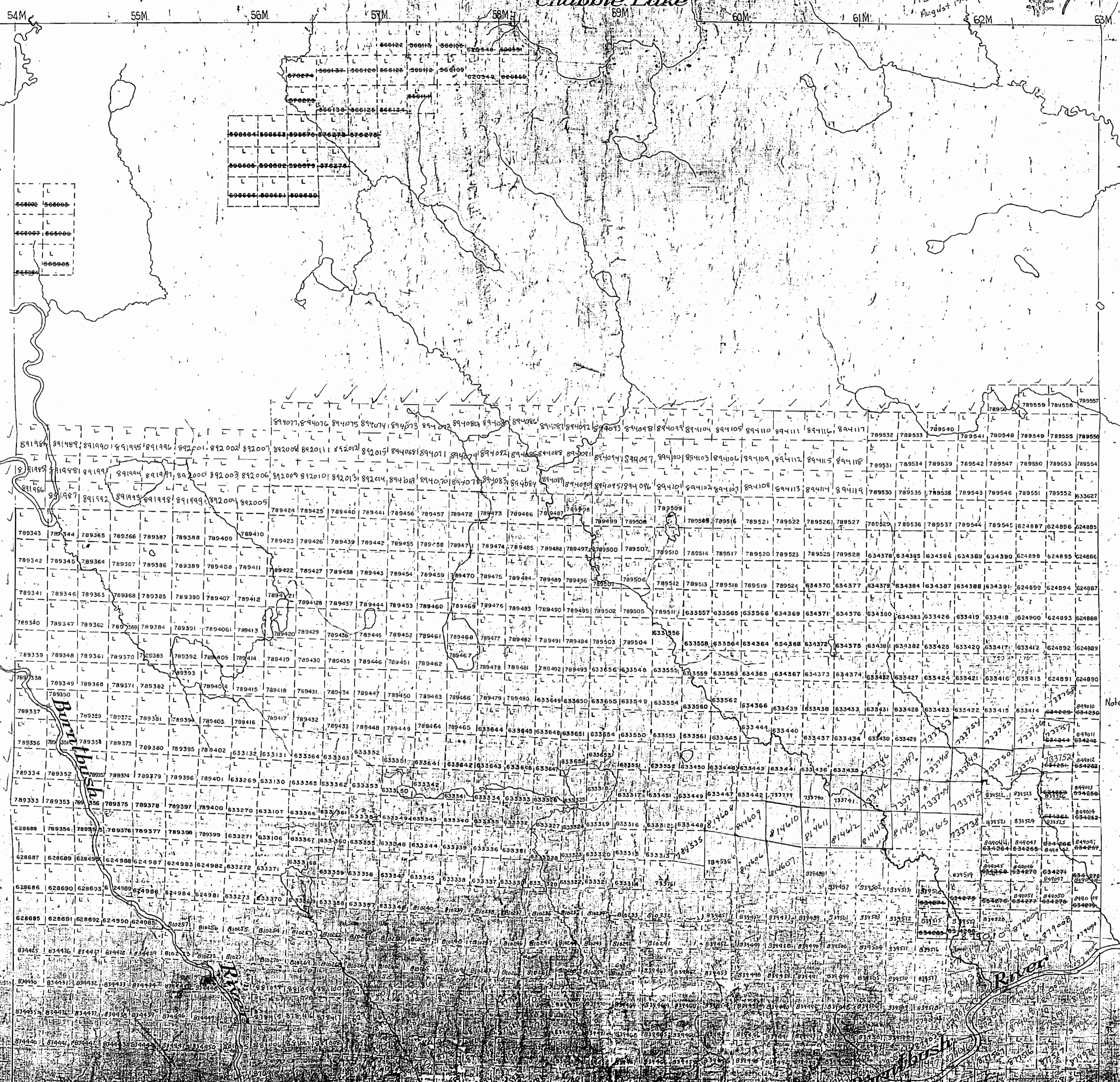

HOBITZELL

BRADETTE

Note: Claims L73376,
L81623 & L81624 not
as large as shown