

MAP SYMBOLOLOGY

Aerial Cableway	---	Pipeline	---
Boundary	---	Railroad	---
International	---	Single Track	---
International	---	Double Track	---
District, Township	---	Abandoned	---
Indian Reserve	---	Territory	---
Approximate	---	Road	---
Lot, Concession	---	Highway, County	---
Approximate	---	Township	---
Port Boundary	---	Access (road of doubtful maintenance or significant driveway)	---
Bridge	---	Trail, Beach Road (garage, alley)	---
Road, Railroad	---	Rapids	---
Building	---	Double line river with multiple rapids	---
Chimney	---	Reservoir	---
Cliff, Pit, Pile	---	River, Stream, Canal	---
Contours	---	Approximate	---
Interpreted	---	Direction of flow	---
Approximate	---	Rock	---
Depression	---	Significant	---
Control Points	---	Shoal	---
Horizontal	---	Spot Elevation	---
Vertical	---	(base elevation)	---
Culvert	---	Tower	---
Falls	---	Transmission Line	---
Double line river	---	Pylon	---
Fence, Hedge, Wall	---	Pylon	---
Feature Outline	---	Tunnel	---
(Construction features, etc.)	---	Utility Poles	---
Flooded Land	---	Wharf, Dock, Pier	---
Lock	---	Wooded Area	---
Marsh or Swamp	---		
Moat	---		
Mine Head Frame	---		
Outcrop	---		

AREAS WITHDRAWN FROM DISPOSITION

M.R.O. - MINING RIGHTS ONLY

S.R.O. - SURFACE RIGHTS ONLY

M.+ S. - MINING AND SURFACE RIGHTS

Description	Order No.	Date	Disposition	File
10 Bear Lake Dam	13/1/72	S.R.	150023	
20 Waste Disposal	19/9/74	S.R.	106080 Vol.2	
30 W-01/91/ONT. S.R.O.	SEP.20/91	L.R. FILE		
40 SEC.33/80	W-5-46/86	14/08/86	M.R.S.	182180

HAMMELL TWP.

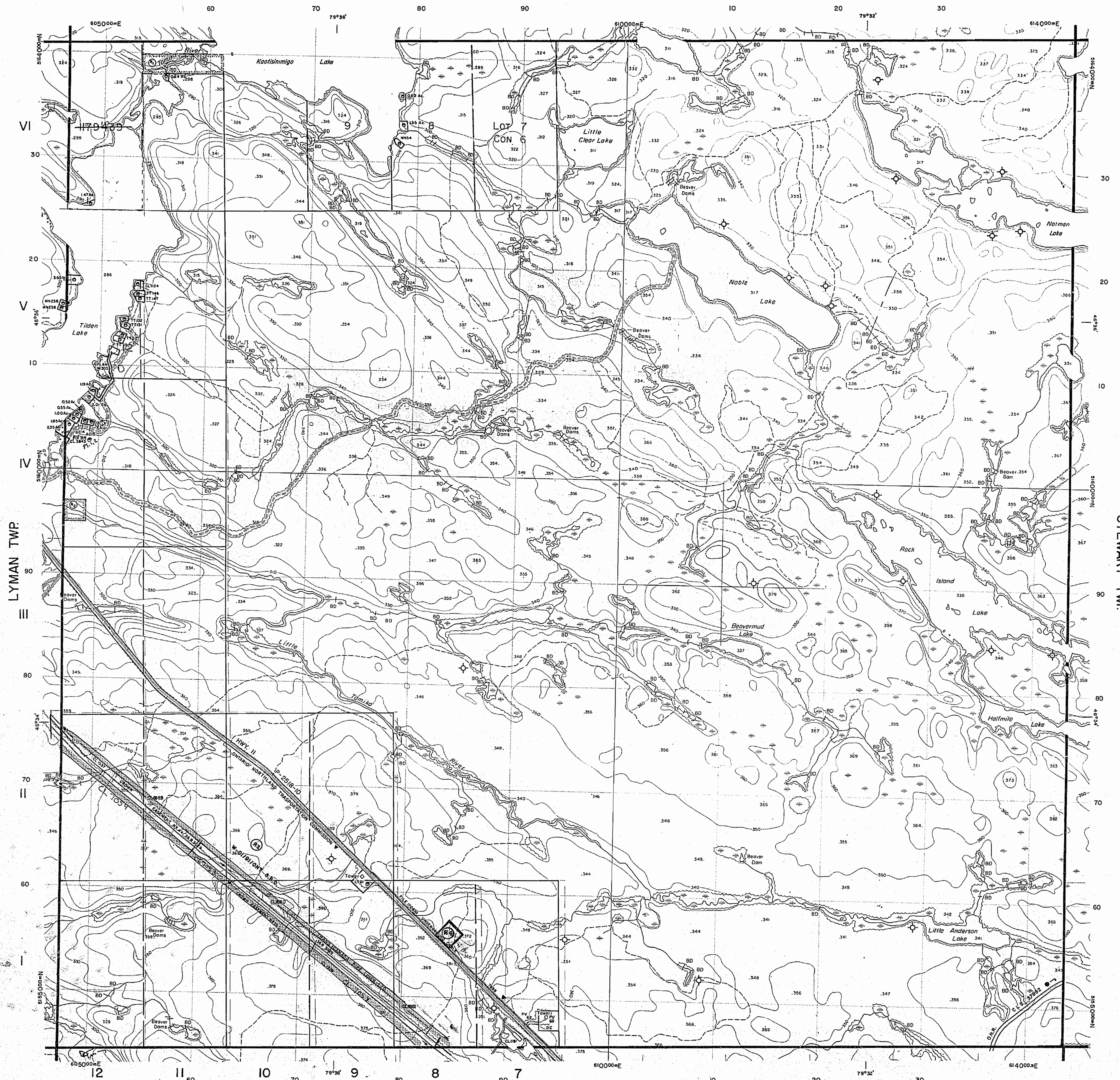

LEGEND

HIGHWAY AND ROUTE No.	---
OTHER ROADS	---
TRAILS	---
SURVEYED LINES:	---
TOWNSHIPS, BASE LINES, ETC.	---
LOTS, MINING CLAIMS, PARCELS, ETC.	---
UNSURVEYED LINES:	---
LOT LINES	---
PARCEL BOUNDARY	---
MINING CLAIMS ETC.	---
RAILWAY AND RIGHT OF WAY	---
UTILITY LINES	---
NON-PERENNIAL STREAM	---
FLOODING OR FLOODING RIGHTS	---
SUBDIVISION OR COMPOSITE PLAN	---
RESERVATIONS	---
ORIGINAL SHORELINE	---
MARSH OR MUSKIE	---
MINES	---
TRANSVERSE MONUMENT	---

DISPOSITION OF CROWN LANDS

TYPE OF DOCUMENT	SYMBOL
PATENT, SURFACE & MINING RIGHTS	---
" SURFACE RIGHTS ONLY	---
" MINING RIGHTS ONLY	---
LEASE, SURFACE & MINING RIGHTS	---
" SURFACE RIGHTS ONLY	---
" MINING RIGHTS ONLY	---
LICENCE OF OCCUPATION	---
ORDER-IN-COUNCIL	---
RESERVATION	---
CANCELLED	---
SAND & GRAVEL	---
LAND USE PERMIT	---

NOTE: MINING RIGHTS IN PARCELS PATENTED PRIOR TO MAY 9, 1913, VESTED IN ORIGINAL PATENTEE BY THE PUBLIC LANDS ACT, R.S.O. 1970, CHAP. 380, SEC. 63, SUBSEC. 1.

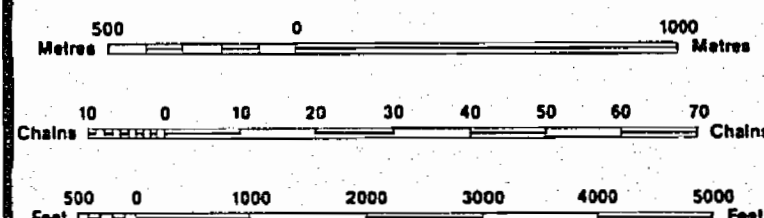

SCALE 1:20 000

GRID ZONE 17

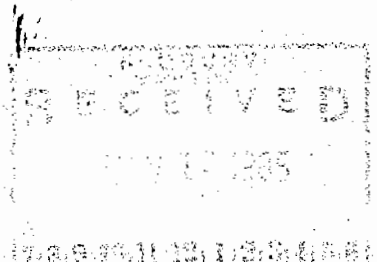

THE INFORMATION THAT APPEARS ON THIS MAP HAS BEEN COMPILED FROM VARIOUS SOURCES, AND ACCURACY IS NOT GUARANTEED. THOSE WISHING TO STAKE MINING CLAIMS SHOULD CONSULT WITH THE MINING RECORDER, MINISTRY OF NORTHERN DEVELOPMENT AND MINES, FOR ADDITIONAL INFORMATION ON THE STATUS OF THE LANDS SHOWN HEREON.

TOWNSHIP NOTMAN

M.N.R. ADMINISTRATIVE DISTRICT
NORTH BAY
MINING DIVISION
SUDBURY
LAND TITLES / REGISTRY DIVISION
NIPISSING

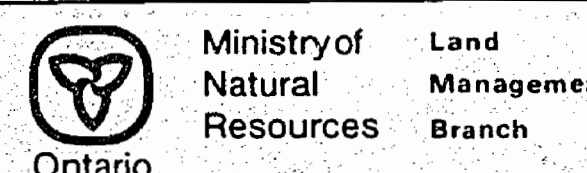

ORIGINAL September 1985
COMPILATION: G-1625

DISPOSITION OF CROWN LANDS

TYPE OF DOCUMENT	SYMBOL
PATENT, SURFACE & MINING RIGHTS	●
" SURFACE RIGHTS ONLY	○
" MINING RIGHTS ONLY	○
LEASE SURFACE & MINING RIGHTS	■
" SURFACE RIGHTS ONLY	■
" MINING RIGHTS ONLY	■
LICENCE OF OCCUPATION	▼
ORDER-IN-COUNCIL	OC
RESERVATION	⊙
CANCELLED	⊙
SAND & GRAVEL	⊙

NOTE: MINING RIGHTS IN PARCELS PATENTED PRIOR TO MAY 6, 1913, VESTED IN ORIGINAL PATENTEE BY THE PUBLIC LANDS ACT, R.S.O. 1970, CHAP. 380, SEC. 63, SUBSEC. 1.

AREAS WITHDRAWN FROM DISPOSITION

S.R. — SURFACE RIGHTS M.R. — MINING RIGHTS

Description	Order No.	Date	Disposition	File
BEAR LAKE DAM		13/1/72	S.R.	150023
WASTE DISPOSAL		19/9/74	S.R.	106080 Vol. 2

SAND AND GRAVEL

GRAVEL	File - 190418-9
GRAVEL	File - 190858

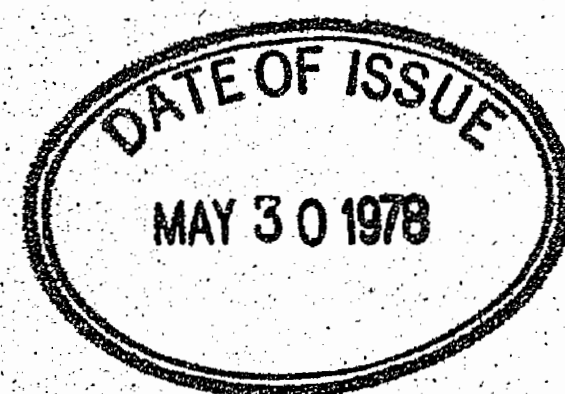

HAMMELL M. 913 OFFICE USE ONLY

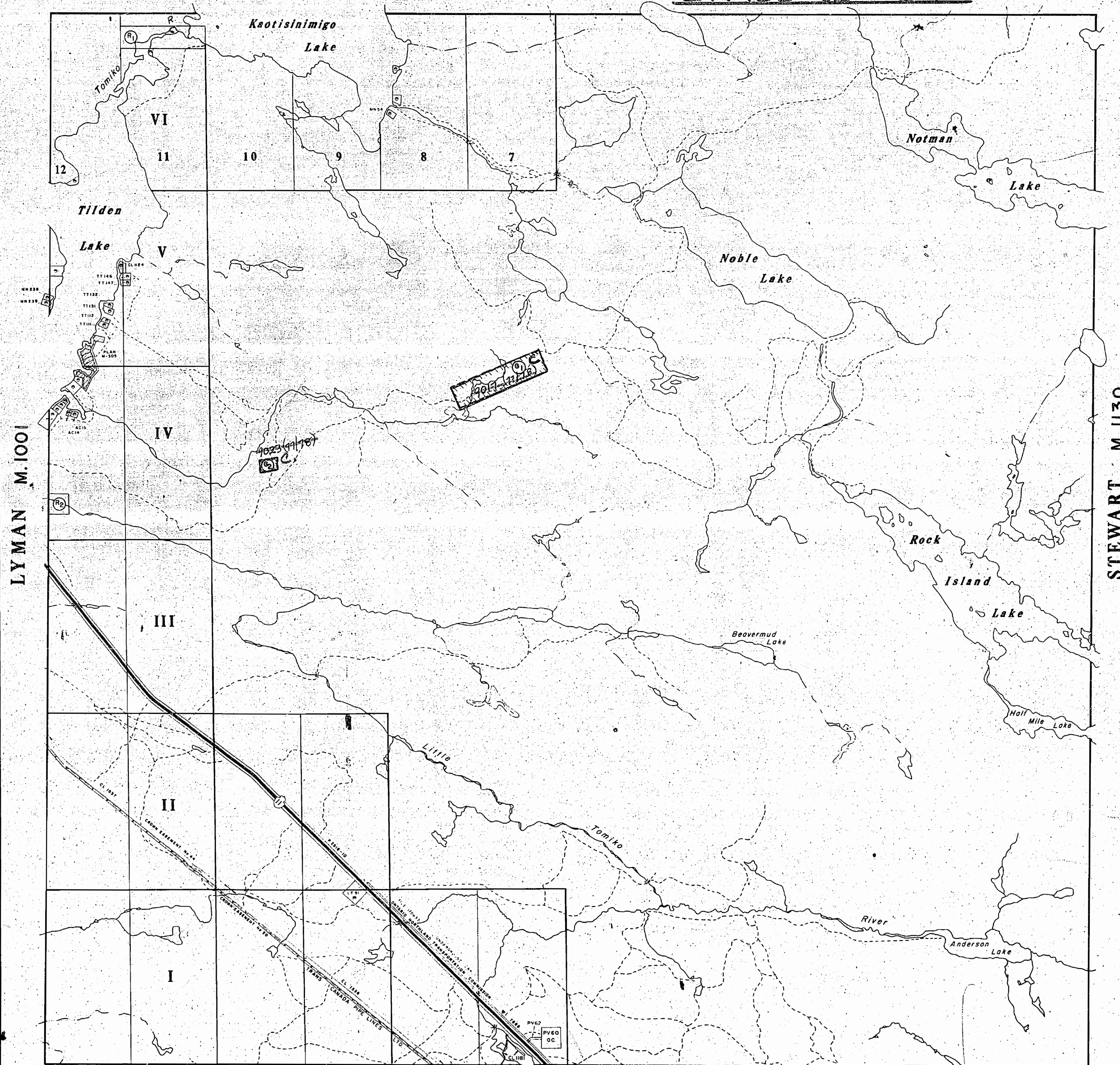

LEGEND

HIGHWAY AND ROUTE No.	
OTHER ROADS	
TRAILS	
SURVEYED LINES:	
TOWNSHIPS, BASE LINES, ETC.	
LOTS, MINING CLAIMS, PARCELS, ETC.	
UNSURVEYED LINES:	
LOT LINES	
PARCEL BOUNDARY	
MINING CLAIMS ETC.	
RAILWAY AND RIGHT OF WAY	
UTILITY LINES	
NON-PERENNIAL STREAM	
FLOODING OR FLOODING RIGHTS	
SUBDIVISION OR COMPOSITE PLAN	
RESERVATIONS	
ORIGINAL SHORELINE	
MARSH OR MUSKEG	
MINES	
TRAVERSE MONUMENT	

400' surface rights reservation along the shores of all lakes and rivers.

SCALE: 1 INCH = 40 CHAINS

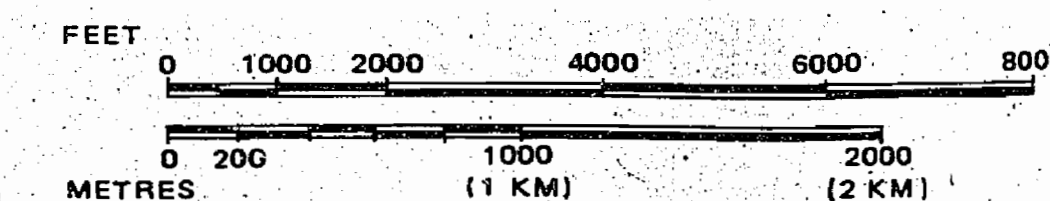

ACRES HECTARES

40

16

TOWNSHIP OF
NOTMAN
DISTRICT
NIPISSING
MINING DIVISION
SUDBURY



Ministry of
Natural
Resources

Surveys and
Mapping
Branch

Date JAN. 20 / 1978

Plan No.

National Topographic Series

M-1029

BLYTH M. 671

MAP SYMOLOGY

Aerial Cableway	---	Pipeline (above ground)	---
Boundary	---	Railroad	---
International	---	Single Track	---
Interprovincial	---	Double Track	---
District, Township	---	Abandoned	---
Indian Reserve	---	Territorial	---
Approximate	---	Road	---
Lot, Concession	---	Highway, County	---
Approximate	---	Township	---
Park Boundary	---	Access (road of doubtful maintenance or insufficient driveway)	---
Bridge	---	Trail, Back Road (path, alley)	---
Road, Railroad	---	Rapids	---
Building	---	Double line river with multiple rapids	---
Chimney	---	Double line river with multiple rapids	---
Cliff, Pit, Pile	---	Reservoir	---
Contours	---	River, Stream, Canal	---
Intersected	---	Approximate	---
Approximate	---	Direction of flow	---
Depression	---	Rock	---
Control Points	---	Shoal	---
Horizontal	---	Spot Elevation (above sea level)	---
Vertical	---	Tower	---
Culvert	---	Transmission Line	---
Falls	---	Pole	---
Double line river	---	Pylon	---
Fence, Hedge, Wall	---	Tunnel	---
Feature Outline (construction features, etc.)	---	Utility Poles	---
Flooded Land	---	Wharf, Dock, Pier	---
Lock	---	Wooded Area	---
Marsh or Swamp	---		
Mast	---		
Mine Head Frame	---		
Outcrop	---		

AREAS WITHDRAWN FROM DISPOSITION

M.R.O. - MINING RIGHTS ONLY					
S.R.O. - SURFACE RIGHTS ONLY					
M.+ S. - MINING AND SURFACE RIGHTS					
	Description	Order No.	Date	Disposition	File
(N)	Bear Lake Dam		13/1/72	S.R.	150023
(N)	Waste Disposal		19/9/74	S.R.	106080 Vol.2
(R3)	W-01/91/ONT. S.R.O. SEP.20/91 L.R. FILE				

HAMMELL TWP.

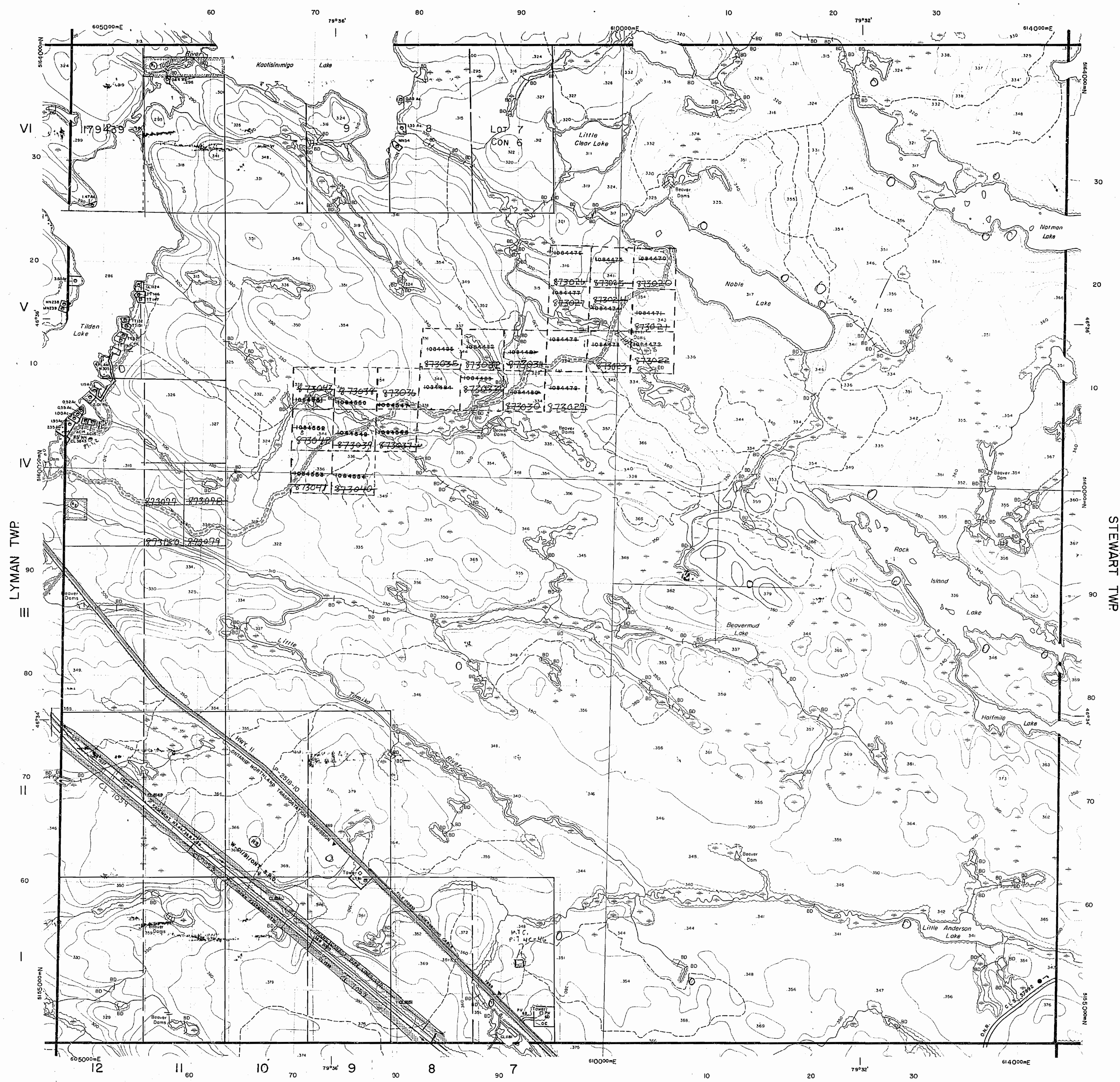

LEGEND

HIGHWAY AND ROUTE No.	---
OTHER ROADS	---
TRAILS	---
SURVEYED LINES:	---
TOWNSHIPS, BASE LINES, ETC.	---
LOTS, MINING CLAIMS, PARCELS, ETC.	---
UNSURVEYED LINES:	---
LOT LINES	---
PARCEL BOUNDARY	---
MINING CLAIMS ETC.	---
RAILWAY AND RIGHT OF WAY	---
UTILITY LINES	---
NON-PERENNIAL STREAM	---
FLOODING OR FLOODING RIGHTS	---
SUBDIVISION OR COMPOSITE PLAN	---
RESERVATIONS	---
ORIGINAL SHORELINE	---
MARSH OR MUSKEG	---
MINES	---
TRAVERSE MONUMENT	---

DISPOSITION OF CROWN LANDS

TYPE OF DOCUMENT	SYMBOL
PATENT, SURFACE & MINING RIGHTS	---
" SURFACE RIGHTS ONLY	---
" MINING RIGHTS ONLY	---
LEASE, SURFACE & MINING RIGHTS	---
" SURFACE RIGHTS ONLY	---
" MINING RIGHTS ONLY	---
LICENCE OF OCCUPATION	---
ORDER-IN-COUNCIL	---
RESERVATION	---
CANCELLED	---
SAND & GRAVEL	---

NOTE: MINING RIGHTS IN PARCELS PATENTED PRIOR TO MAY 8, 1913, VESTED IN ORIGINAL PATENTEE BY THE PUBLIC LANDS ACT, R.S.O. 1970, CHAP. 380, SEC. 63, SUBSEC. 1.

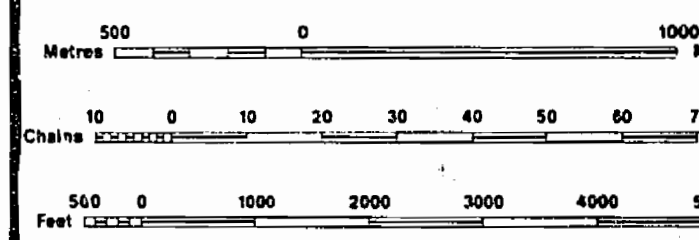

SCALE 1:20 000
GRID ZONE 17

DATE OF ISSUE
1985
SUDBURY
MINING RECORDER'S OFFICE

THE INFORMATION THAT APPEARS ON THIS MAP HAS BEEN COMPILED FROM VARIOUS SOURCES, AND ACCURACY IS NOT GUARANTEED. THOSE WISHING TO STAKE MINING CLAIMS SHOULD CONSULT WITH THE MINING RECORDER, MINISTRY OF NORTHERN DEVELOPMENT AND MINES, FOR ADDITIONAL INFORMATION ON THE STATUS OF THE LANDS SHOWN HEREON.

TOWNSHIP
NOTMAN
M.N.R. ADMINISTRATIVE DISTRICT
NORTH BAY
MINING DIVISION
SUDBURY
LAND TITLES / REGISTRY DIVISION
NIPISSING

Ministry of Natural Resources
Land Management Branch
Ontario











ORIGINAL September 1985
COMPILATION
Number
G-1625

BLYTH TWP.

DISPOSITION OF CROWN LANDS

TYPE OF DOCUMENT

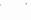
SYMBOL

PATENT, SURFACE & MINING RIGHTS	
" , SURFACE RIGHTS ONLY	
" , MINING RIGHTS ONLY	
LEASE, SURFACE & MINING RIGHTS	
" , SURFACE RIGHTS ONLY	
" , MINING RIGHTS ONLY	
LICENCE OF OCCUPATION	
ORDER-IN-COUNCIL	
RESERVATION	
CANCELLED	
SAND & GRAVEL	

NOTE: MINING RIGHTS IN PARCELS PATENTED PRIOR TO MAY 6, 1913, VESTED IN ORIGINAL PATENTEE BY THE PUBLIC LANDS ACT, R.S.O. 1970, CHAP. 380, SEC. 63, SUBSEC 1.

AREAS WITHDRAWN FROM DISPOSITION

S.R.—SURFACE RIGHTS M.R.—MINING RIGHTS

	Description	Order No.	Date	Disposition	File
(R ₁)	BEAR LAKE DAM		13/1/72	S.R.	150023
(R ₂)	WASTE DISPOSAL		19/9/74	S.R.	106080 Vol. 1

SAND AND GRAVEL



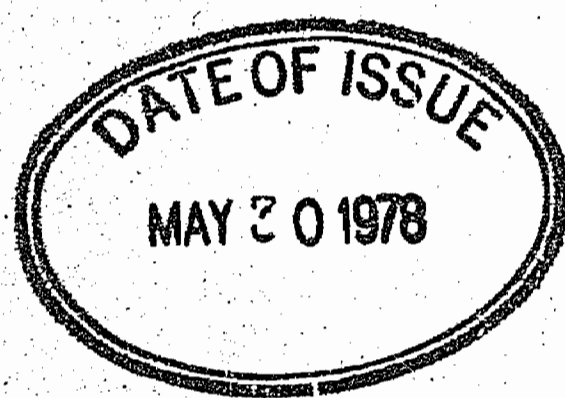



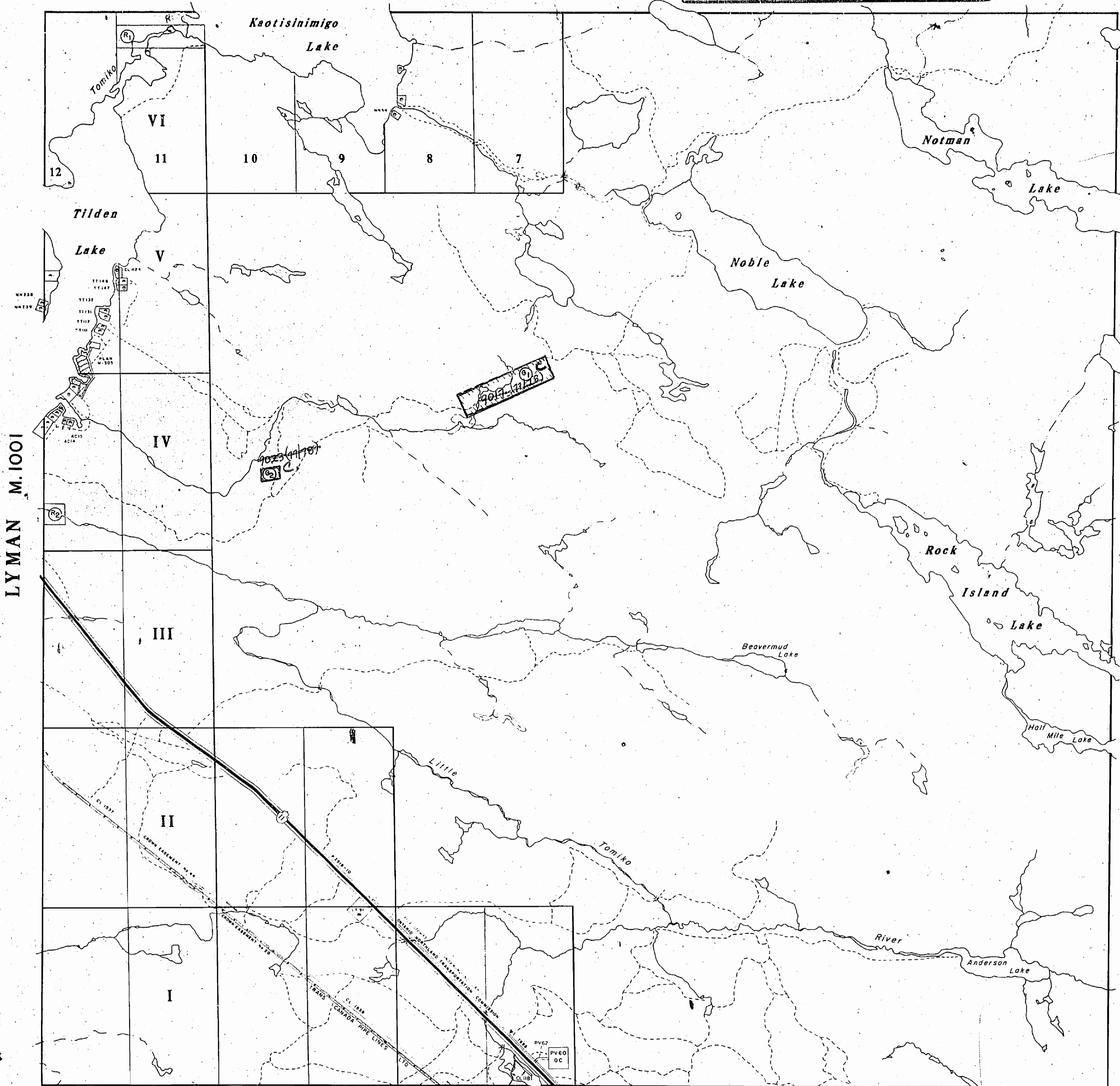









① GRAVEL File - 190418-9
② GRAVEL File - 190858



HAMMELL M. 913 OFFICE USE ONLY



LEGEND

HIGHWAY AND ROUTE No. 
OTHER ROADS 
TRAILS 
SURVEYED LINES:
TOWNSHIPS, BASE LINES, ETC. 
LOTS, MINING CLAIMS, PARCELS, ETC. 
UNSURVEYED LINES:
LOT LINES 
PARCEL BOUNDARY 
MINING CLAIMS ETC. 
RAILWAY AND RIGHT OF WAY 
UTILITY LINES 
NON-PERENNIAL STREAM 
FLOODING OR FLOODING RIGHTS 
SUBDIVISION OR COMPOSITE PLAN 
RESERVATIONS 
ORIGINAL SHORELINE 
MARSH OR MUSKEG 
MINES 
TRAVERSE MONUMENT

400' surface rights reservation along the shores of all lakes and rivers.

SCALE: 1 INCH = 40 CHAINS

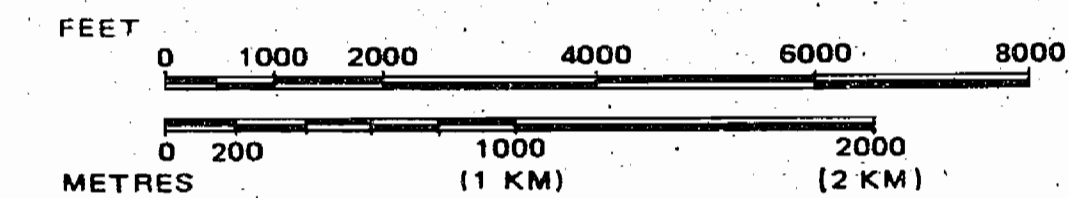

ACRES HECTARES

40

16

TOWNSHIP OF

NOTMAN

DISTRICT

NIPISSING

MINING DIVISION

SUDBURY

Ministry of
Natural
Resources

Surveys and Mapping Branch

Date JAN. 20 / 1978

Plan No.

M-1029

National Topographic Series

BLYTH M. 671

Lyman Twp.

Hammell Twp.

Blyth Twp.

Stewart Twp.

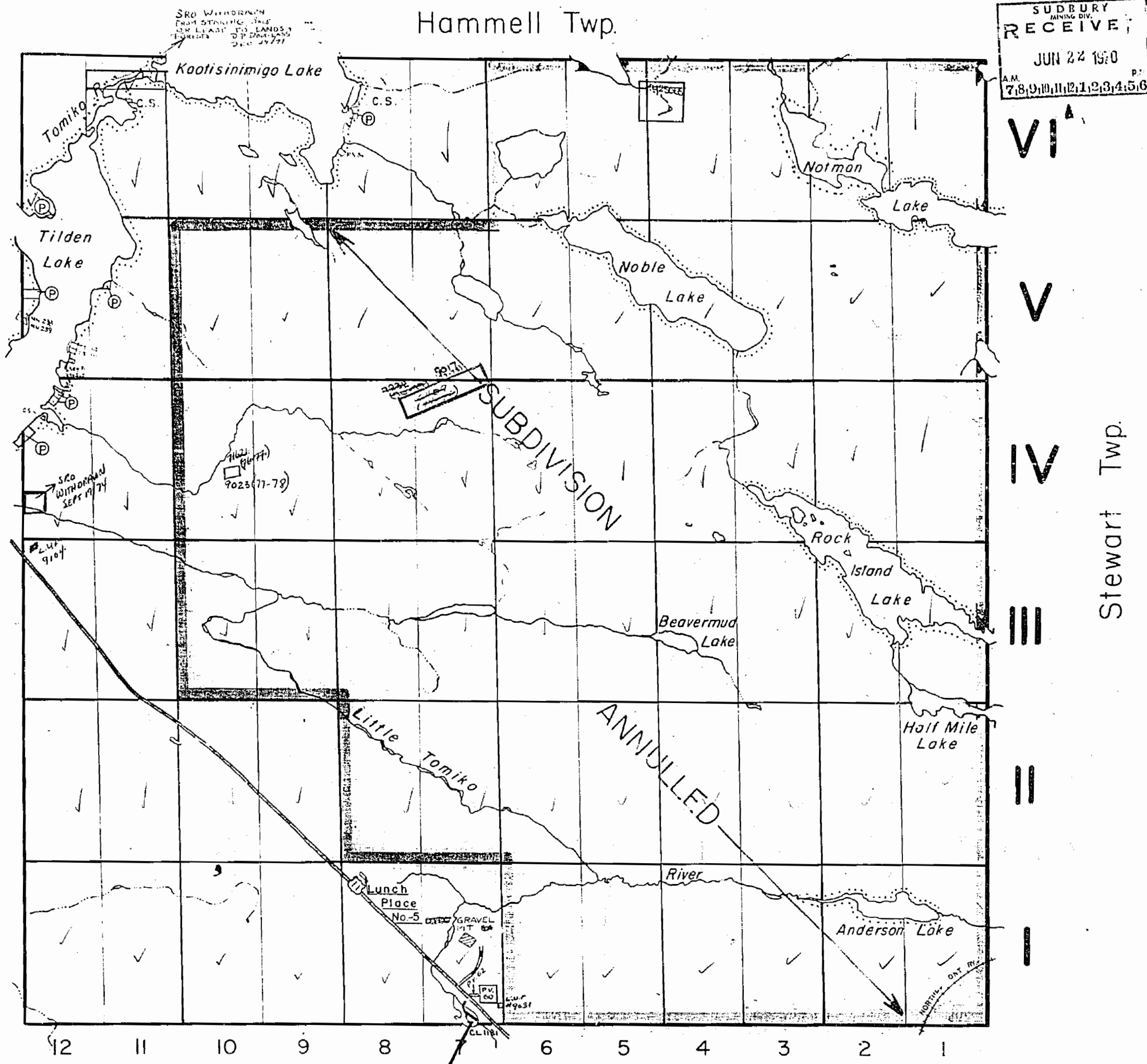

SUDBURY
MINING DIV.
RECEIVED
JUN 24 1970
A.M. 7,8,9,10,11,12,1,2,3,4,5,6 P.

VI

V

IV

III

II

I

THE TOWNSHIP
OF

NOTMAN

DISTRICT OF
NIPISSING

SUDBURY
MINING DIVISION

SCALE: 1-INCH=40 CHAINS

LEGEND

PATENTED LAND	Ⓟ
CROWN LAND SALE	C.S.
LEASES	Ⓛ
LOCATED LAND	Loc.
LICENSE OF OCCUPATION	L.O.
MINING RIGHTS ONLY	M.R.O.
SURFACE RIGHTS ONLY	S.R.O.
ROADS	— — — — —
IMPROVED ROADS	— — — — —
KING'S HIGHWAYS	— — — — —
RAILWAYS	— — — — —
POWER LINES	— — — — —
MARSH OR MUSKEG	— — — — —
MINES	— — — — —
CANCELLED	— — — — —

NOTES

400' surface rights reservation around
all lakes & rivers.

NOTMAN

PLAN NO.- M. 1029

DEPARTMENT OF MINES

— ONTARIO —

DISPOSITION OF CROWN LANDS

TYPE OF DOCUMENT	SYMBOL
PATENT, SURFACE & MINING RIGHTS	⊙
SURFACE RIGHTS ONLY	⊙
MINING RIGHTS ONLY	⊙
LEASE, SURFACE & MINING RIGHTS	⊙
SURFACE RIGHTS ONLY	⊙
MINING RIGHTS ONLY	⊙
EVIDENCE OF OCCUPATION	⊙
ORDER IN COUNCIL	OC
RESERVATION	⊙
UNFILED	⊙
SAND & GRAVEL	⊙

NOTE: MINING RIGHTS IN PARCELS PATENTED PRIOR TO MAY 6, 1913, VESTED IN ORIGINAL PATENTEE BY THE PUBLIC LANDS ACT, R.S.O. 1970, CHAP. 380, SEC. 63, SUBSEC. 1.

AREAS WITHDRAWN FROM DISPOSITION

S.R. — SURFACE RIGHTS M.R. — MINING RIGHTS

Description	Order No.	Date	Disposition	File
BEAR LAKE DAM		13/1/72	S.R.	150023
WASTE DISPOSAL		19/9/74	S.R.	106080 Vol. 2

SAND AND GRAVEL

- ① M.N.R. GRAVEL RESERVE 4C-4
- ② GRAVEL File - 190858
- ③ MNR GRAVEL RES. 4C-1
- ④ QUARRY PERMIT

4-C-46 (See Land Roll File)

HAMMELL M. 913

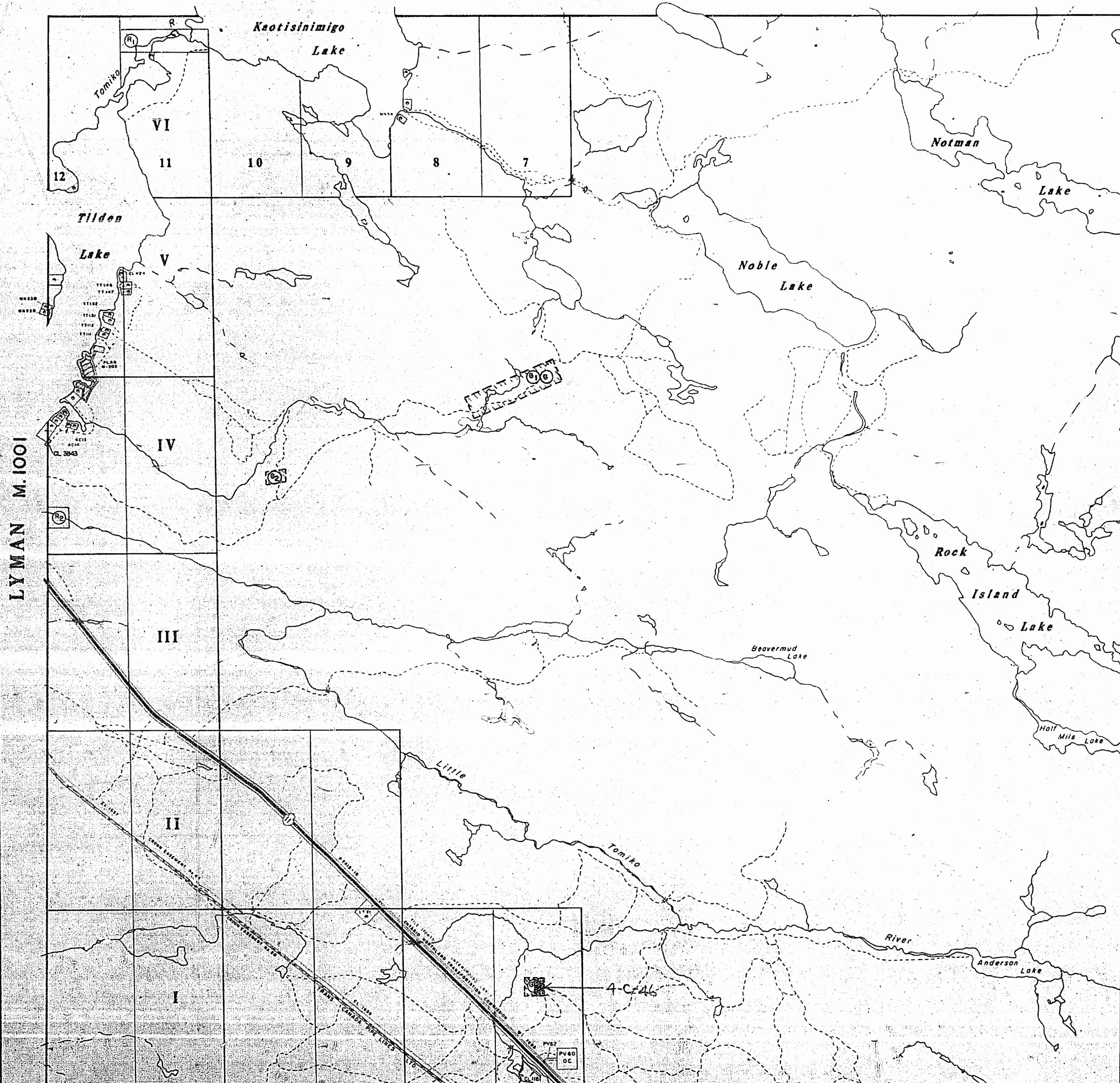

BLYTH M. 671

LEGEND

HIGHWAY AND ROUTE No.	—+—
OTHER ROADS	—
TRAILS	- - -
SURVEYED LINES:	
TOWNSHIPS, BASE LINES, ETC.	—
LOTS, MINING CLAIMS, PARCELS, ETC.	—
UNSURVEYED LINES:	
LOT LINES	- - -
PARCEL BOUNDARY	- - -
MINING CLAIMS ETC.	- - -
RAILWAY AND RIGHT OF WAY	—+—
UTILITY LINES	—+—
NON-PERENNIAL STREAM	~
FLOODING OR FLOODING RIGHTS	~~~~~
SUBDIVISION OR COMPOSITE PLAN	
RESERVATIONS	▨
ORIGINAL SHORELINE	—
MARSH OR MUSKEG	—
MINES	⊙
TRAVERSE MONUMENT	⊙

400' surface rights reservation along the shores of all lakes and rivers.

* IN SERVICE 1985 05 - 06

SCALE: 1 INCH = 40 CHAINS

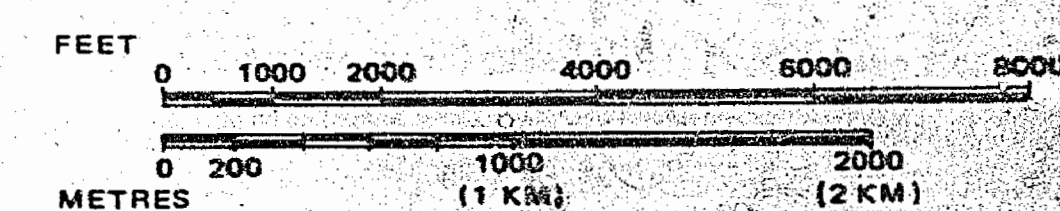

ACRES HECTARES

40	16
----	----

TOWNSHIP OF
NOTMAN
DISTRICT
NIPISSING
MINING DIVISION
SUDBURY

Ministry of Natural Resources
Ontario
Surveys and Mapping Branch

Date JAN 20 / 1978
National Topographic Series
Plan No. **M-1029**