

BELFORD TWP. (M.657)

THE TOWNSHIP OF

NOVA

DISTRICT OF COCHRANE

PORCUPINE MINING DIVISION

SCALE: 1-INCH = 40 CHAINS

LEGEND

PATENTED LAND	Ⓟ
CROWN LAND SALE	C.S.
LEASES	Ⓛ
LOCATED LAND	Loc.
LICENSE OF OCCUPATION	L.O.
MINING RIGHTS ONLY	M.R.O.
SURFACE RIGHTS ONLY	S.R.O.
ROADS	—
IMPROVED ROADS	—
KING'S HIGHWAYS	—
RAILWAYS	—
POWER LINES	—
MARSH OR MUSKEG	—
MINES	—
CANCELLED	—

NOTES

400' surface rights reservation along the shores of all lakes and rivers.

THE INFORMATION THAT APPEARS ON THIS MAP HAS BEEN COMPILED FROM VARIOUS SOURCES AND ACCURACY IS NOT GUARANTEED. THOSE WISHING TO STAKE MINING CLAIMS SHOULD CONSULT WITH THE MINING RECORDER, MINISTRY OF NORTHERN DEVELOPMENT AND MINES, FOR ADDITIONAL INFORMATION ON THE STATUS OF THE LANDS SHOWN HEREON.

Revised Feb 11/80

PLAN NO. G-1188

ONTARIO
MINISTRY OF NATURAL RESOURCES
SURVEYS AND MAPPING BRANCH

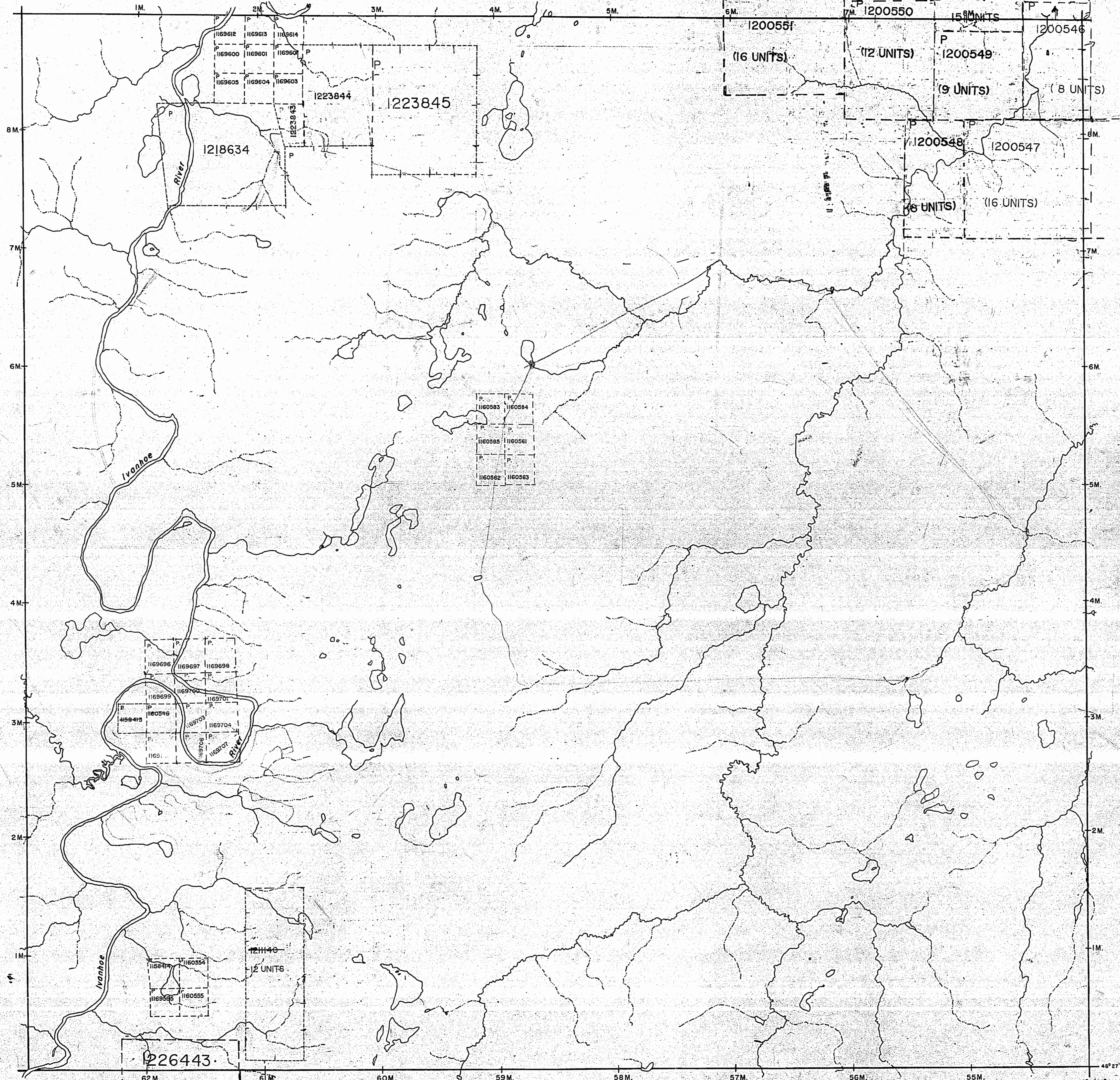

484821, 485821
484822, 485822

NOVA

SUDBURY MINING DIVISION

COCHRANE DISTRICT

Scale - 40 Chains - 1 Inch

Revised FEB. 2/66

North Asly

BELFORD

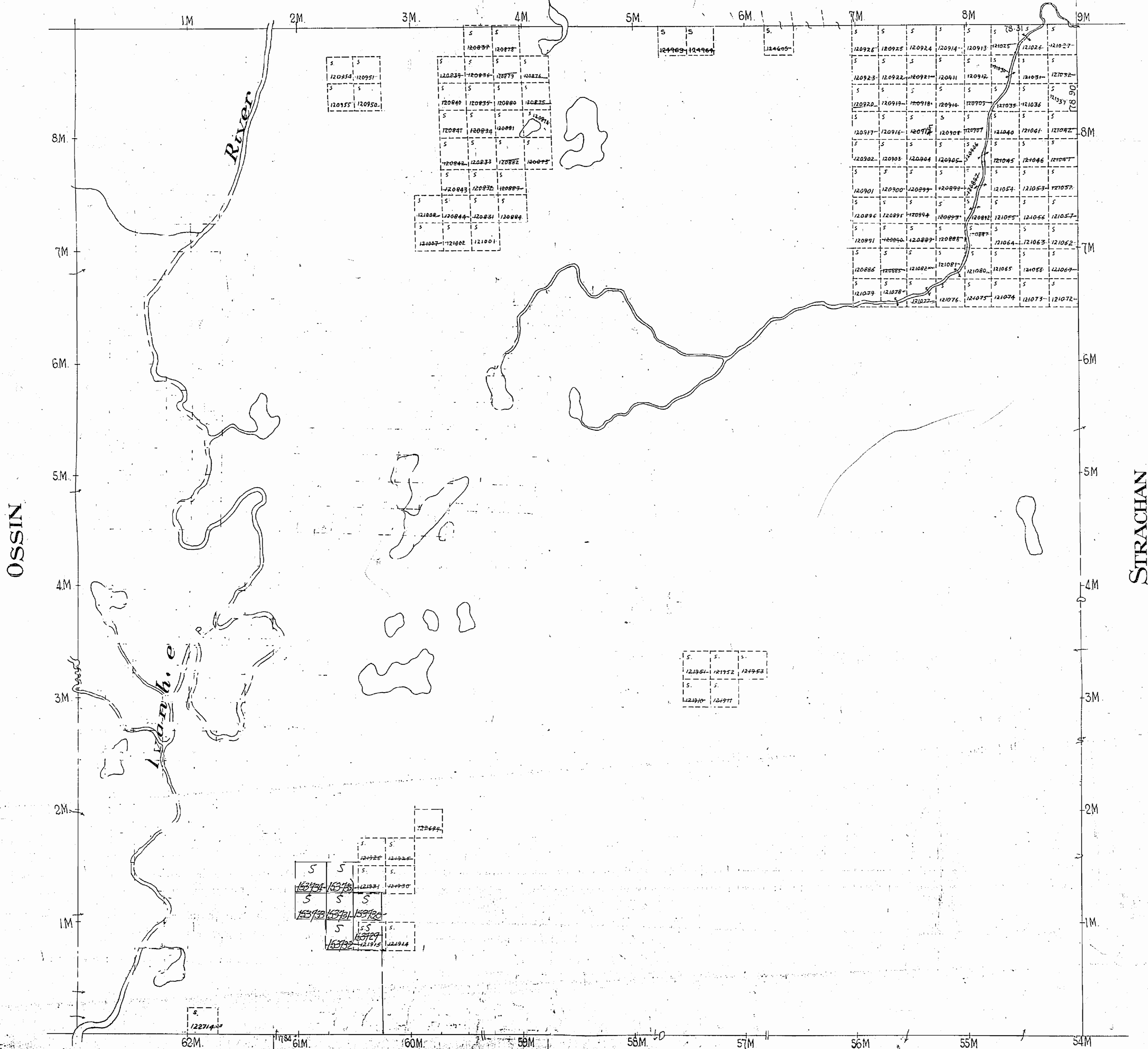

40' surface rights reservation around all lakes & rivers

NOVA

PORCUPINE MINING DIVISION

COCHRANE DISTRICT

Scale: 40 Chains - 1 inch

M-1030

BELFORD

North Asty

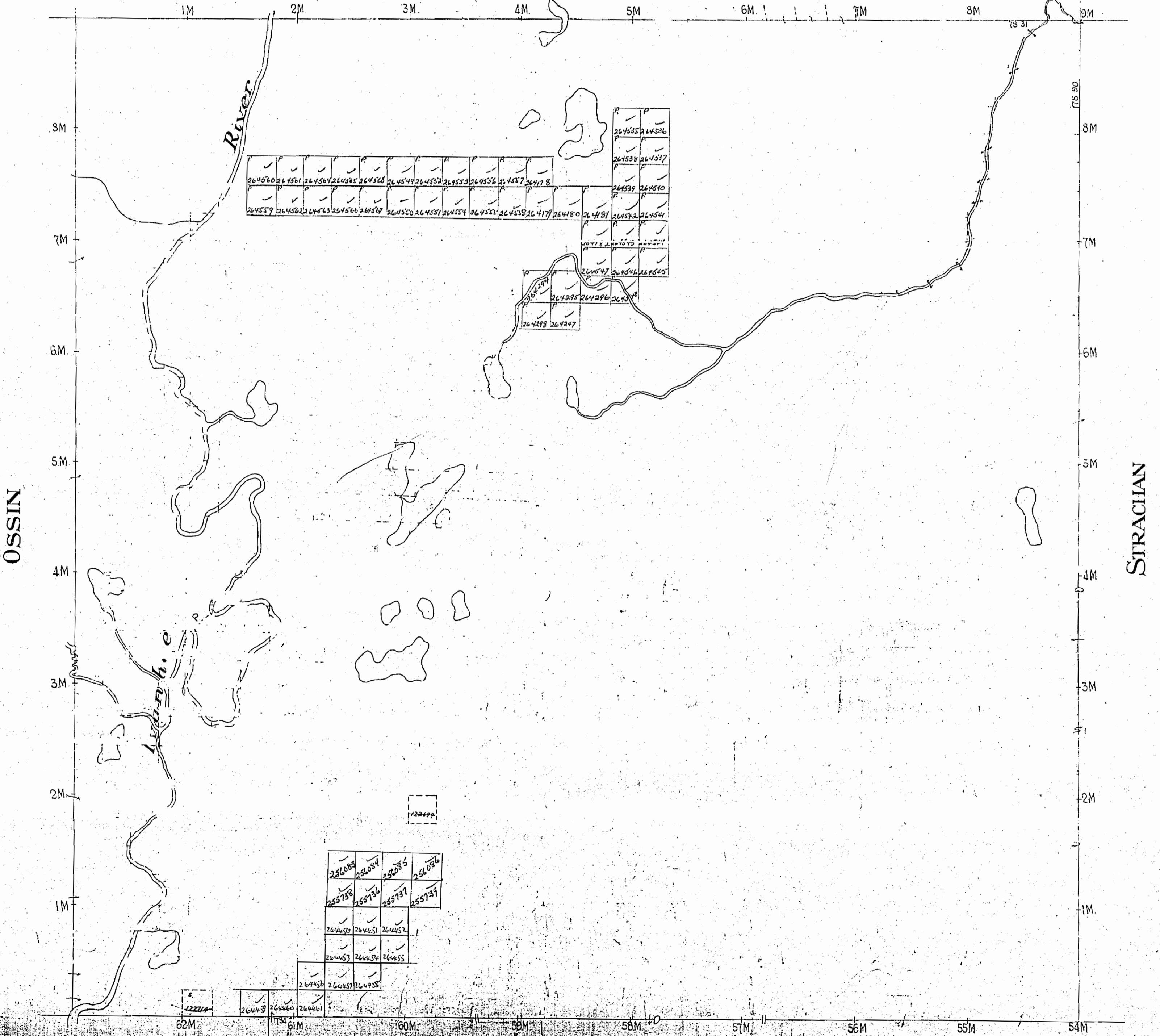

OSSIN

STRACIAN

OATES

OSWALD

400 surface rights reservation around all lakes & rivers

RECEIVED
 OCT 9 1969
 7:00 PM
 112123456

LEGEND

- PATENTED LAND Ⓟ
- CROWN LAND SALE C.S.
- LEASES Ⓛ
- LOCATED LAND Loc.
- LICENSE OF OCCUPATION L.O.
- MINING RIGHTS ONLY M.R.O.
- SURFACE RIGHTS ONLY S.R.O.
- ROADS — — — — —
- IMPROVED ROADS — — — — —
- KING'S HIGHWAYS — — — — —
- RAILWAYS — — — — —
- POWER LINES — — — — —
- MARSH OR MUSKEG — — — — —
- MINES — — — — —
- CANCELLED — — — — —

NOTES

400' surface rights reservation along the shores of all lakes and rivers.

DATE OF ISSUE
 JUN 5 1974

PORCUPINE MINING DIVISION
RECEIVED
 JUN 7 1974
 AM 7 18 19 10 11 12 1 12 1 3 1 4 5 1 6 PM

PLAN NO.- M.1030

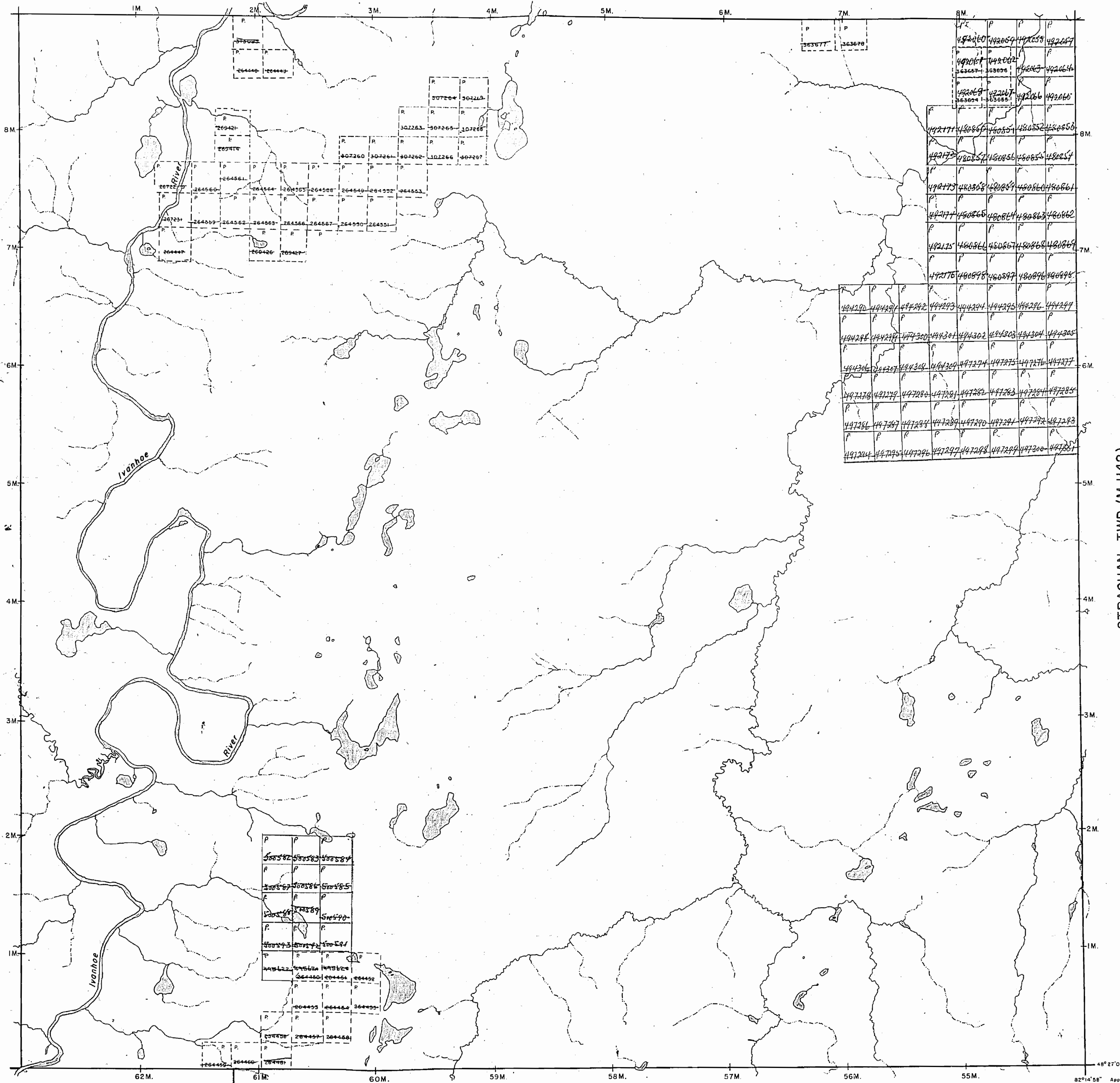

OSSIN TWP (M.1031)

STRACHAN TWP (M.1142)

OATES TWP (M.1033)

OSWALD TWP (M.1042)

BELFORD TWP (M.657)

THE TOWNSHIP OF

NOVA

DISTRICT OF COCHRANE

PORCUPINE MINING DIVISION

SCALE: 1-INCH = 40 CHAINS

LEGEND

PATENTED LAND	Ⓟ
CROWN LAND SALE	C.S.
LEASES	Ⓞ
LOCATED LAND	Loc
LICENSE OF OCCUPATION	L.O.
MINING RIGHTS ONLY	M.R.O.
SURFACE RIGHTS ONLY	S.R.O.
ROADS	—
IMPROVED ROADS	—
KING'S HIGHWAYS	—
RAILWAYS	—
POWER LINES	—
MARSH OR MUSKEG	—
MINES	—
CANCELLED	—

NOTES

400' surface rights reservation along the shores of all lakes and rivers.

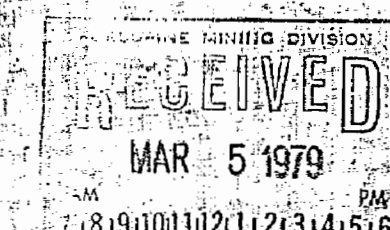

OSSIN TWP (M.1031)

STRACHAN TWP (M.1142)

OATES TWP (M.1033)

OSWALD TWP (M.1042)

PLAN NO.- M.1030

ONTARIO
MINISTRY OF NATURAL RESOURCES
SURVEYS AND MAPPING BRANCH

484821, 485821
484822, 485822

BELFORD TWP. (M.657)

THE TOWNSHIP OF

NOVA

DISTRICT OF COCHRANE

PORCUPINE MINING DIVISION

SCALE: 1-INCH = 40 CHAINS

LEGEND

PATENTED LAND	Ⓟ
CROWN LAND SALE	C.S.
LEASES	Ⓛ
LOCATED LAND	Loc.
LICENSE OF OCCUPATION	L.O.
MINING RIGHTS ONLY	M.R.O.
SURFACE RIGHTS ONLY	S.R.O.
ROADS	—
IMPROVED ROADS	—
KING'S HIGHWAYS	—
RAILWAYS	—
POWER LINES	—
MARSH OR MUSKEG	—
MINES	Ⓜ
CANCELLED	Ⓧ

NOTES

400' surface rights reservation along the shores of all lakes and rivers.

[Handwritten] THIS TWP. SUBJECT TO FORESTRY ACTIVITY IN 1994/95.

[Handwritten] THIS TWP. IS SUBJECT TO FOREST ACTIVITY IN 1995/96. FURTHER INFORMATION AVAILABLE ON FILE.

DATE OF ISSUE

NOV 20 1997

PROVINCIAL RECORDING OFFICE - SUDBURY

THE INFORMATION THAT APPEARS ON THIS MAP HAS BEEN COMPILED FROM VARIOUS SOURCES, AND ACCURACY IS NOT GUARANTEED. THOSE WISHING TO STAKE MINING CLAIMS SHOULD CONSULT WITH THE MINING RECORDER, MINISTRY OF NORTHERN DEVELOPMENT AND MINES, FOR ADDITIONAL INFORMATION ON THE STATUS OF THE LANDS SHOWN HEREON.

PLAN NO. **G-1188**

ONTARIO
MINISTRY OF NATURAL RESOURCES

SURVEYS AND MAPPING BRANCH

OSSIN TWP. (M.1031)

STRACHAN TWP. (M.1142)

OATES TWP. (M.1033)

OSWALD TWP. (M.1042)

484821, 485821
484822, 485822

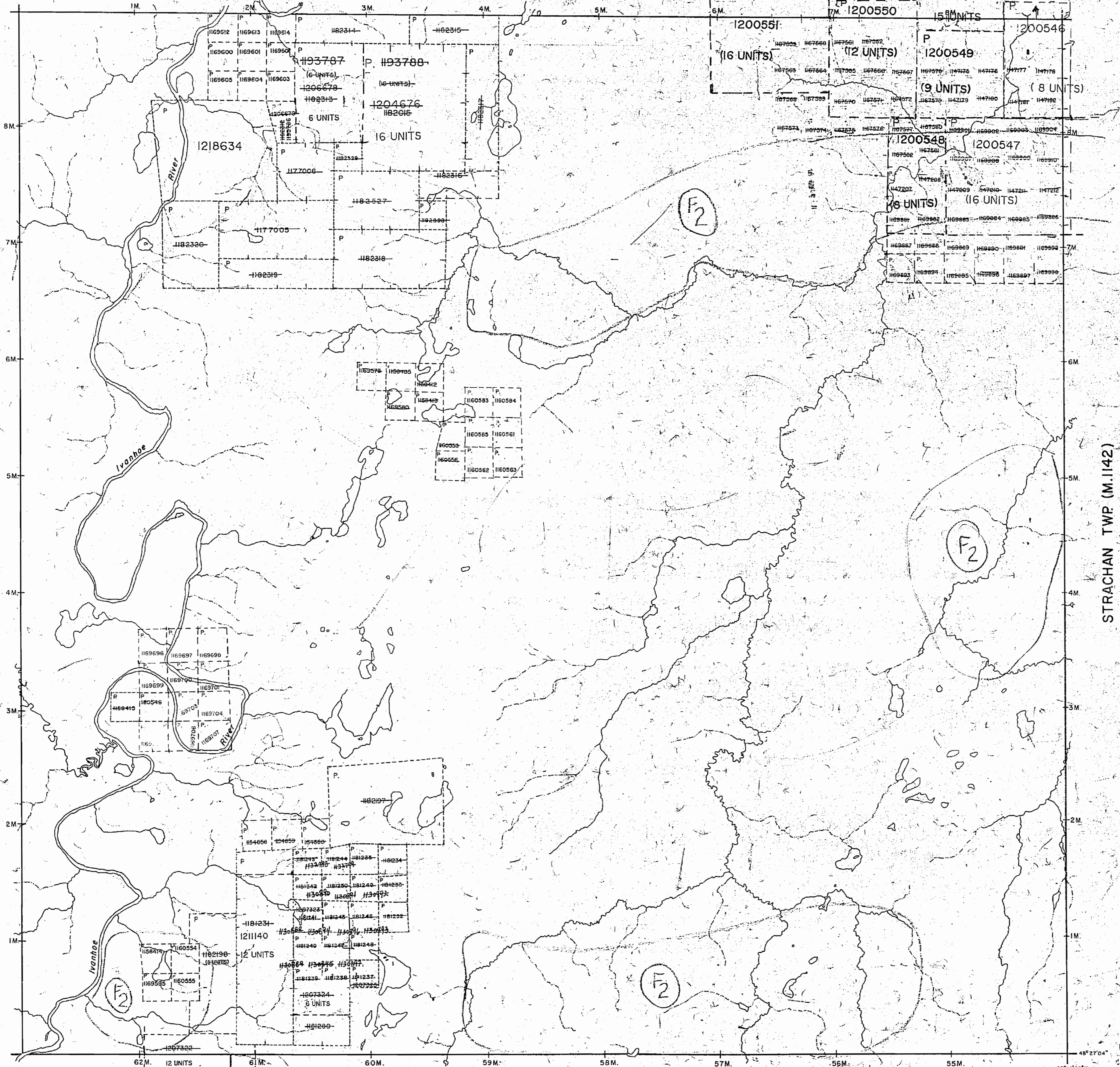

NOVA

DISTRICT OF COCHRANE

PORCUPINE MINING DIVISION

SCALE: 1-INCH = 40 CHAINS

LEGEND

PATENTED LAND	Ⓟ
CROWN LAND SALE	C.S.
LEASES	Ⓛ
LOCATED LAND	Loc.
LICENSE OF OCCUPATION	L.O.
MINING RIGHTS ONLY	M.R.O.
SURFACE RIGHTS ONLY	S.R.O.
ROADS	—
IMPROVED ROADS	—
KING'S HIGHWAYS	—
RAILWAYS	—
POWER LINES	—
MARSH OR MUSKEG	—
MINES	—
CANCELLED	—

NOTES

400' surface rights reservation along the shores of all lakes and rivers.

THIS TWP SUBJECT TO FORESTRY ACTIVITY IN 1994/95.

F2 THIS TWP. IS SUBJECT TO FOREST ACTIVITY IN 1995/96. FURTHER INFORMATION AVAILABLE ON FILE.

DATE OF ISSUE

MAY 2-0 1998

PROVINCIAL RECORDING OFFICE - SUDBURY

THE INFORMATION THAT APPEARS ON THIS MAP HAS BEEN COMPILED FROM VARIOUS SOURCES, AND ACCURACY IS NOT GUARANTEED. THOSE WISHING TO STAKE MINING CLAIMS SHOULD CONSULT WITH THE MINING RECORDER, MINISTRY OF NORTHERN DEVELOPMENT AND MINES, FOR ADDITIONAL INFORMATION ON THE STATUS OF THE LANDS SHOWN HEREON.

PLAN NO. **G-1188**

ONTARIO
MINISTRY OF NATURAL RESOURCES
SURVEYS AND MAPPING BRANCH

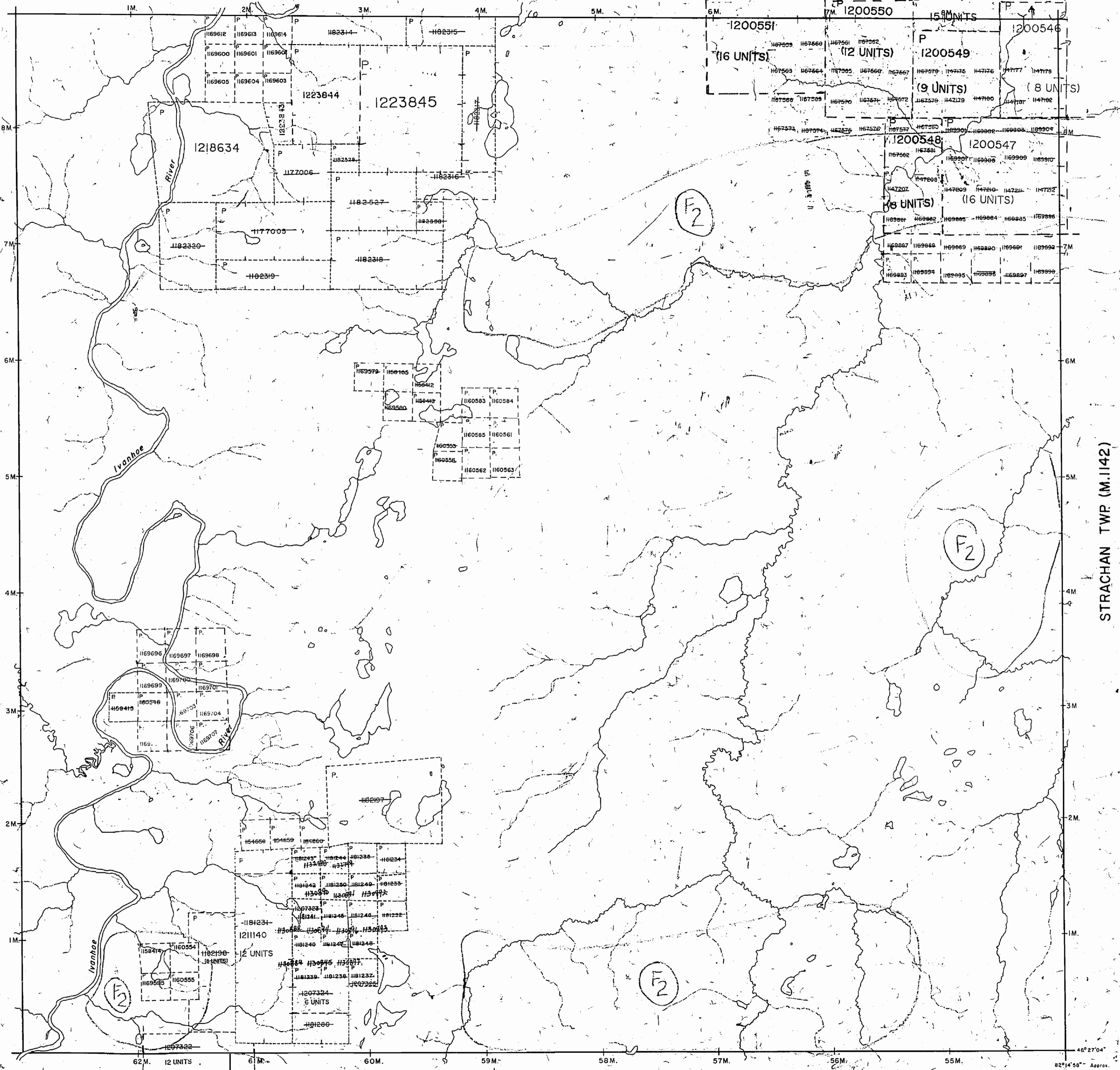

OATES TWP. (M.1033)

OSWALD TWP. (M.1042)

484821, 485821
484822, 485822

NOVA

PORCUPINE MINING DIVISION

COCHRANE DISTRICT

Scale - 40 Chains - 1 inch

M-1030

BELFORD

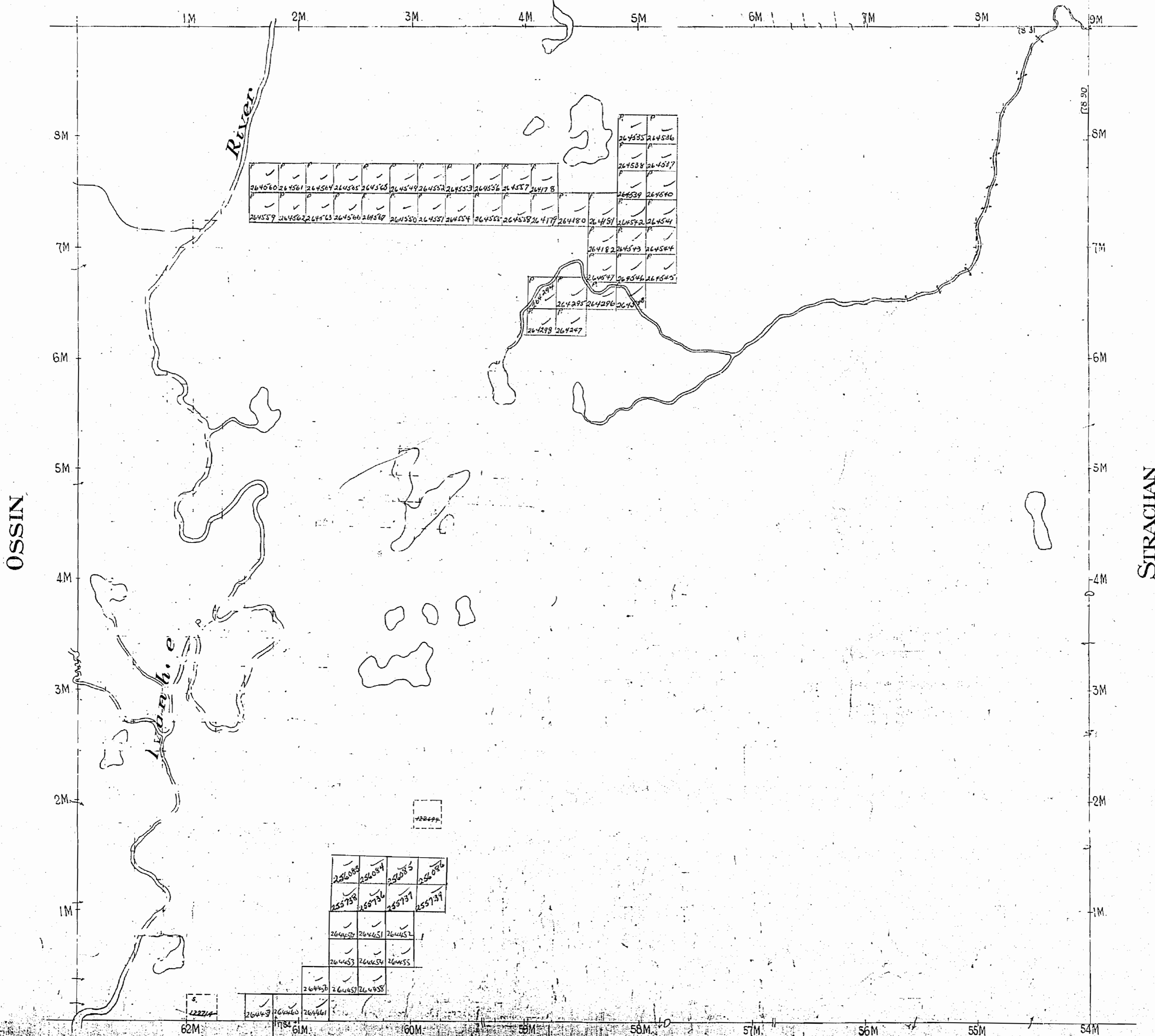

North Arrow

OSSIN

STRACIAN

OATES

OSWALD

400 surface rights reservation around all lakes & rivers

RECEIVED
 OCT 9 1969
 78910112123458