

Scale - 40 Chains = 1 Inch

TP. 24. Now Bradshaw Twp.

HIGHWAY

TP. 22. Now Ignace Twp.

TIMBER BERTH "D"

North South West and South part of East boundary by Phillips and Benner OLS 1922  
 North part of East boundary by E. Stewart OLS 1896  
 Boundaries of Timber Berth "D" by Phillips and Benner OLS 1922  
 Canadian Pacific Railway taken from Right of Way Plan 1897  
 Other Lakes and Rivers taken from the Topographical Aerial Survey (Gratic Sheet)

Surface reservations 400' wide by Dept. of L. & F.  
 Section between that and

KENORA  
 MINING DIVISION  
**RECEIVED**  
 MAR 19 1975  
 AM 789 10 11 12 1 2 3 4 5 6 7 8

DATE OF ISSUE  
 MAR 13 1975

FORMERLY TIMBER BERTH W.J. SMILEY F. 34874

OSAGUAN 2017

APR 14/66

DISTRICT OF COLUMBIA

Scale 40 Chains to 1 Inch

RECEIVED  
MAY 1 1861  
OFFICE OF THE DISTRICT ENGINEER

TP. 24. Now Bradshaw Twp.

Ditto P. 602 - 1964  
1965  
1967

HIGHWAY

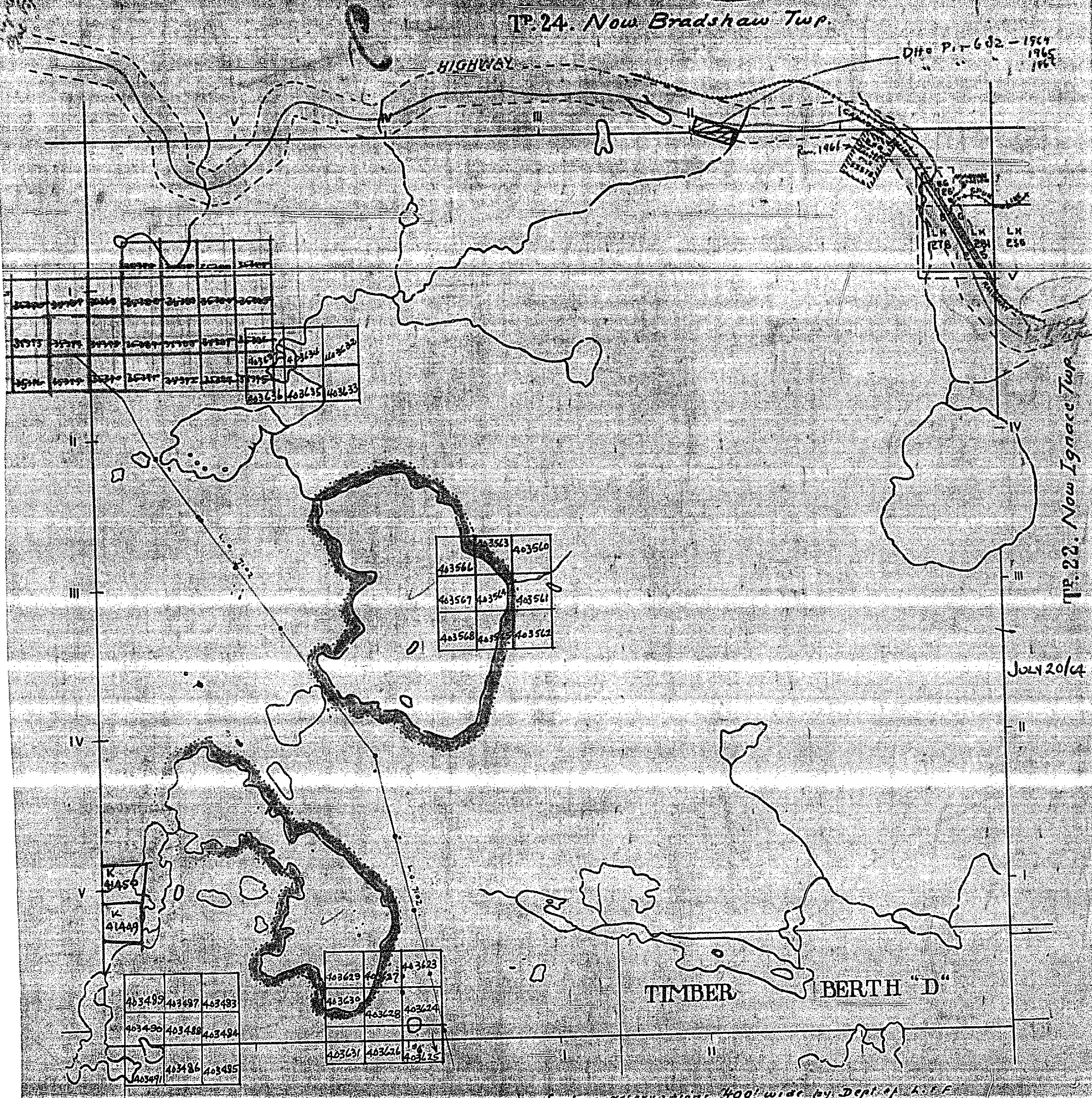

TP. 22. Now Ignace Twp.

July 20/64

TIMBER BERTH "D"

North-South, West and South part of East boundary by Phillips and Banner OLS 1822  
 North part of East boundary by E. Stewart OLS 1805  
 Boundaries of Timber Berth "D" by Phillips and Banner OLS 1822  
 Canadian Pacific Railway taken from Right of Way Plan 1897  
 Other Lakes and Rivers taken from the Topographical General Survey (Ignace Smeat)

Surface reservations 400' wide by Dept. of L.P.F.  
 taken hereon that

OS AQUAN 2017

**NOTES**

400' surface rights reservation along the shores of all lakes and rivers.

**SAND and GRAVEL**

MTC PT 682  
MTC PT 668  
File 33378

DATE OF ISSUE  
AUG 10 1976

KENORA  
MINING DIV.  
**RECEIVED**  
AUG 23 1976  
AS 7,8,9,10,11,12,1,2,3,4,5

**BRADSHAW TP M.1950**

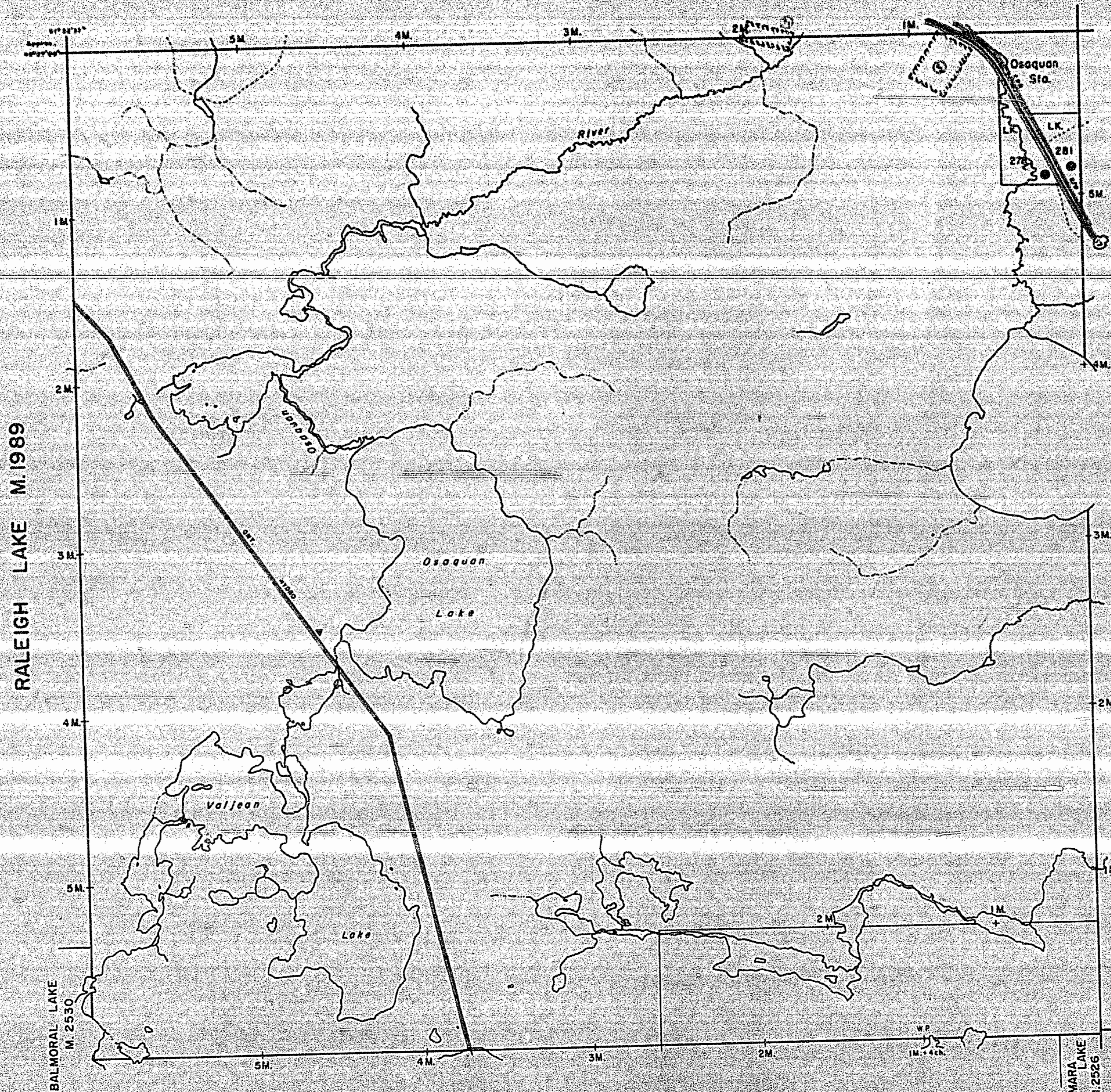

**LEGEND**

- HIGHWAY AND ROUTE No.
- OTHER ROADS
- TRAILS
- SURVEYED LINES:
  - TOWNSHIPS, BASE LINES, ETC.
  - LOTS, MINING CLAIMS, PARCELS, ETC.
- UNSURVEYED LINES:
  - LOT LINES
  - PARCEL BOUNDARY
  - MINING CLAIMS ETC.
- RAILWAY AND RIGHT OF WAY
- UTILITY LINES
- NON-PERENNIAL STREAM
- FLOODING OR FLOODING RIGHTS
- SUBDIVISION
- ORIGINAL SHORELINE
- MARSH OR MUSKEG
- MINES

**DISPOSITION OF CROWN LANDS**

- | TYPE OF DOCUMENT                | SYMBOL |
|---------------------------------|--------|
| PATENT, SURFACE & MINING RIGHTS |        |
| - SURFACE RIGHTS ONLY           |        |
| - MINING RIGHTS ONLY            |        |
| LEASE, SURFACE & MINING RIGHTS  |        |
| - SURFACE RIGHTS ONLY           |        |
| - MINING RIGHTS ONLY            |        |
| LICENCE OF OCCUPATION           |        |
| CROWN LAND SALE                 |        |
| ORDER-IN-COUNCIL                |        |
| RESERVATION                     |        |
| CANCELLED                       |        |
| SAND & GRAVEL                   |        |

SCALE: 1 INCH = 40 CHAINS



ACRES 40  
HECTARES 16

TOWNSHIP

**OSAQUAN**

DISTRICT

KENORA

MINING DIVISION

KENORA



Ministry of Natural Resources

Ontario Surveys and Mapping Branch

Date MAY 76  
Whitney Block  
Queen's Park, Toronto

Plan No. M.2017

RALEIGH LAKE M.1989

IGNACE TP M.1991

BALMORAL LAKE M.2530

WILSON LAKE M.2526

**NOTES**

400' surface rights reservation along the shores of all lakes and rivers.

**SAND and GRAVEL**

⑥ M.T.C. PIT 682  
⑥ M.T.C. PIT 668 File 33378.

**BRADSHAW TP. M.1950**

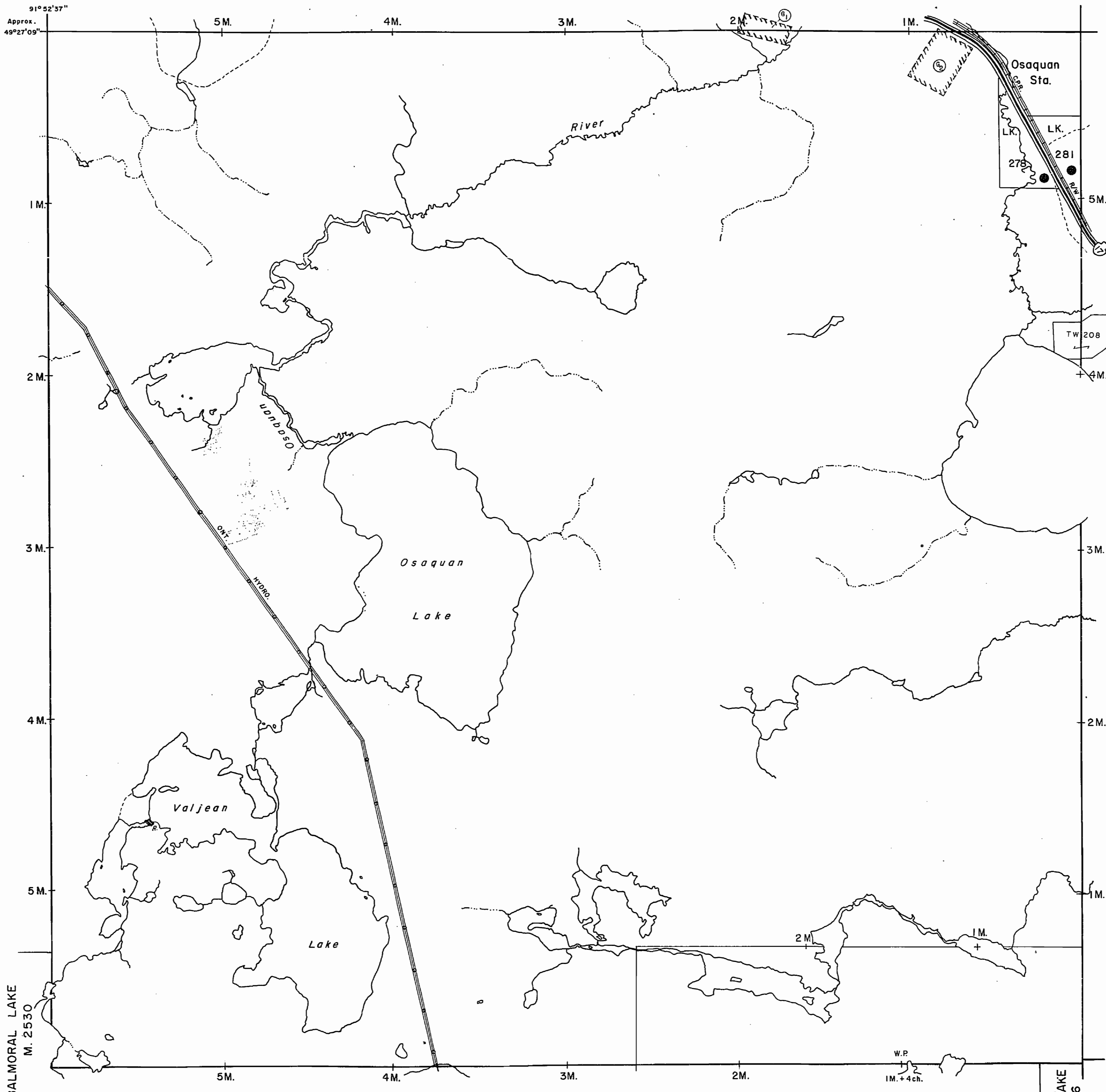

**LEGEND**

HIGHWAY AND ROUTE No.	
OTHER ROADS	
TRAILS	
SURVEYED LINES:	
TOWNSHIPS, BASE LINES, ETC.	
LOTS, MINING CLAIMS, PARCELS, ETC.	
UNSURVEYED LINES:	
LOT LINES	
PARCEL BOUNDARY	
MINING CLAIMS ETC.	
RAILWAY AND RIGHT OF WAY	
UTILITY LINES	
NON-PERENNIAL STREAM	
FLOODING OR FLOODING RIGHTS	
SUBDIVISION	
ORIGINAL SHORELINE	
MARSH OR MUSKEG	
MINES	

**DISPOSITION OF CROWN LANDS**

TYPE OF DOCUMENT	SYMBOL
PATENT, SURFACE & MINING RIGHTS	
" SURFACE RIGHTS ONLY	
" MINING RIGHTS ONLY	
LEASE, SURFACE & MINING RIGHTS	
" SURFACE RIGHTS ONLY	
" MINING RIGHTS ONLY	
LICENCE OF OCCUPATION	
CROWN LAND SALE	C.S.
ORDER-IN-COUNCIL	OC
RESERVATION	
CANCELLED	
SAND & GRAVEL	

SCALE : 1 INCH = 40 CHAINS

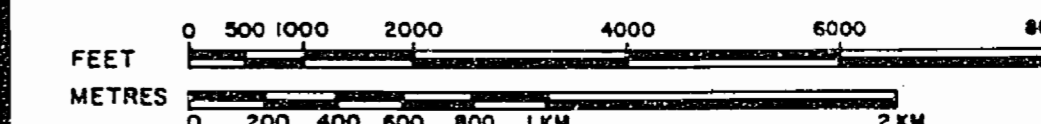

ACRES	HECTARES
40	16

TOWNSHIP

**OSAQUAN**

DISTRICT

KENORA

MINING DIVISION

KENORA



Ministry of Natural Resources

Ontario Surveys and Mapping Branch

Date MAY '76

Plan No.

Whitney Block  
Queen's Park, Toronto

**M.2017**

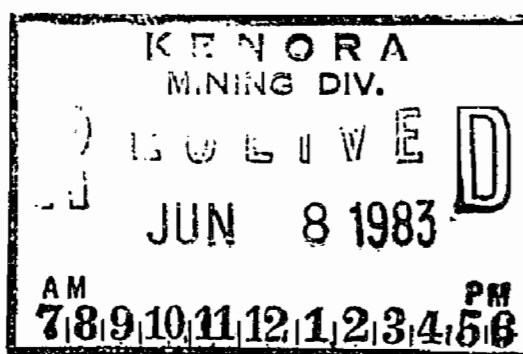

← Effective as Linen

DATE OF ISSUE  
MAY 30 1983  
Ministry of Natural Resources  
TORONTO

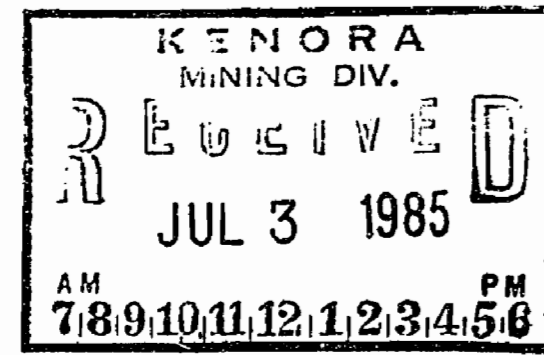

OBSELETE

RALEIGH LAKE M.1989

IGNACE TP. M.1991

BALMORAL LAKE M.2530

McNAMARA LAKE M.2526

NOTES

400' surface rights reservation along the shores of all lakes and rivers.

SAND and GRAVEL

- ④ M.T.C. PIT 682
- ⑤ M.T.C. PIT 668 - File 33378.

Ⓡ Order No. W-3/87 87/01/08 188556 S+M.R.

KENORA MINING DIV.  
JUL 3 1989  
LINES EFFECTIVE AS OF

BRADSHAW TP. M.1950

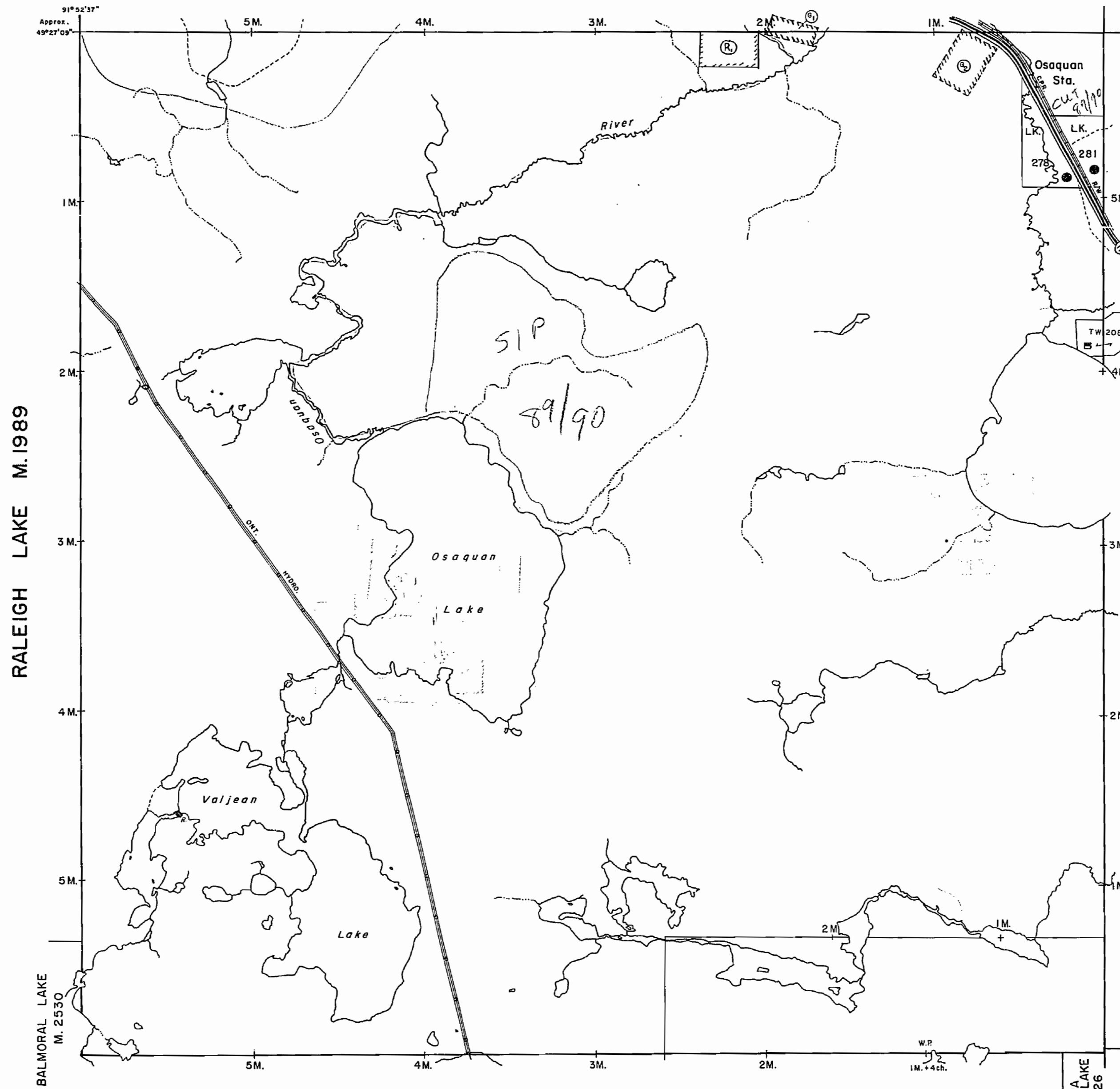

RALEIGH LAKE M.1989

BALMORAL LAKE M.2530

BALMORAL LAKE M.2530

McNAMARA LAKE M.2526

LEGEND

- HIGHWAY AND ROUTE No.
- OTHER ROADS
- TRAILS
- SURVEYED LINES:
  - TOWNSHIPS, BASE LINES, ETC.
  - LOTS, MINING CLAIMS, PARCELS, ETC.
- UNSURVEYED LINES:
  - LOT LINES
  - PARCEL BOUNDARY
  - MINING CLAIMS ETC.
- RAILWAY AND RIGHT OF WAY
- UTILITY LINES
- NON-PERENNIAL STREAM
- FLOODING OR FLOODING RIGHTS
- SUBDIVISION
- ORIGINAL SHORELINE
- MARSH OR MUSKEG
- MINES

DISPOSITION OF CROWN LANDS

TYPE OF DOCUMENT	SYMBOL
PATENT, SURFACE & MINING RIGHTS	
" SURFACE RIGHTS ONLY	
" MINING RIGHTS ONLY	
LEASE, SURFACE & MINING RIGHTS	
" SURFACE RIGHTS ONLY	
" MINING RIGHTS ONLY	
LICENCE OF OCCUPATION	
CROWN LAND SALE	C.S.
ORDER-IN-COUNCIL	OC
RESERVATION	
CANCELLED	
SAND & GRAVEL	

KENORA MINING DIV.  
RECEIVED  
MAY 29 1989  
7891011 12123456

SCALE: 1 INCH = 40 CHAINS

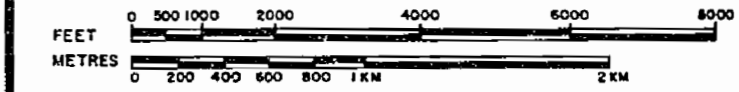

ACRES 40  
HECTARES 16

TOWNSHIP

**OSAQUAN**

DISTRICT

KENORA

MINING DIVISION

KENORA

Ministry of Natural Resources

Ontario Surveys and Mapping Branch

Date MAY '76  
Whitney Block  
Queen's Park, Toronto

Plan No. M.2017

IGNACE TP. M.1991

T10S.M

QT MAUQASO

T10S.M

T10S.M

QT MAUQASO

T10S.M

**NOTES**

400' surface rights reservation along the shores of all lakes and rivers.

SAND AND GRAVEL

G1 M.T.C. PIT 682  
G2 M.T.C. PIT 668 - FILE 33378

RESERVATIONS

R1 ORDER NO. 3/87 87/01/08 18 8555 S & M.R.

THE INFORMATION THAT APPEARS ON THIS MAP HAS BEEN COMPILED FROM VARIOUS SOURCES, AND ACCURACY IS NOT GUARANTEED. THOSE WISHING TO STAKE MINING CLAIMS SHOULD CONSULT WITH THE MINING RECORDER, MINISTRY OF NORTHERN DEVELOPMENT AND MINES, FOR ADDITIONAL INFORMATION ON THE STATUS OF THE LANDS SHOWN HEREON.

G 1304  
BRADSHAW TP. M.1950

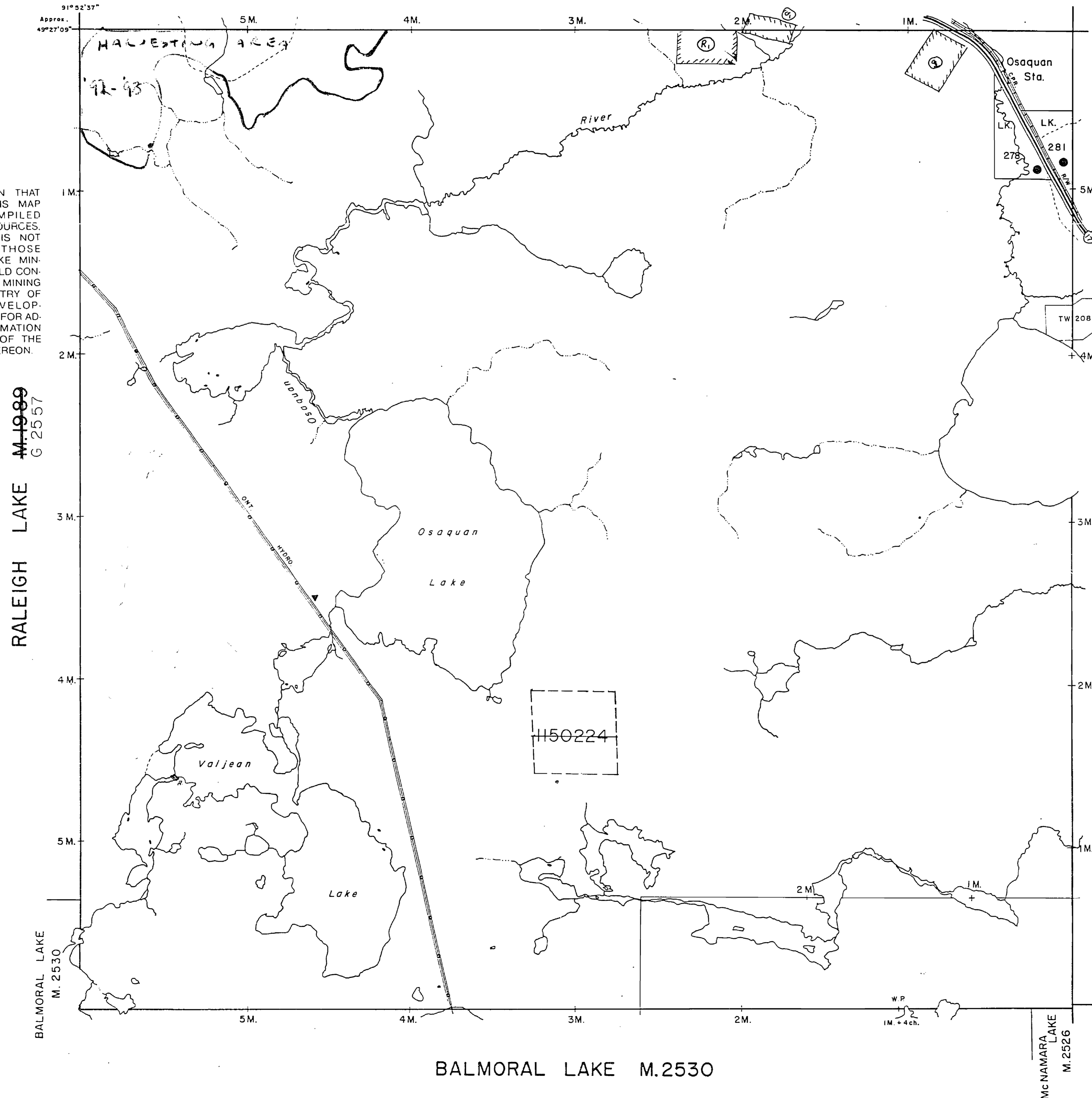

**LEGEND**

- HIGHWAY AND ROUTE No.
- OTHER ROADS
- TRAILS
- SURVEYED LINES:
  - TOWNSHIPS, BASE LINES, ETC.
  - LOTS, MINING CLAIMS, PARCELS, ETC.
- UNSURVEYED LINES:
  - LOT LINES
  - PARCEL BOUNDARY
  - MINING CLAIMS ETC.
- RAILWAY AND RIGHT OF WAY
- UTILITY LINES
- NON-PERENNIAL STREAM
- FLOODING OR FLOODING RIGHTS
- SUBDIVISION
- ORIGINAL SHORELINE
- MARSH OR MUSKEG
- MINES

**DISPOSITION OF CROWN LANDS**

TYPE OF DOCUMENT	SYMBOL
PATENT, SURFACE & MINING RIGHTS	
" SURFACE RIGHTS ONLY	
" MINING RIGHTS ONLY	
LEASE, SURFACE & MINING RIGHTS	
" SURFACE RIGHTS ONLY	
" MINING RIGHTS ONLY	
LICENCE OF OCCUPATION	
CROWN LAND SALE	C.S.
ORDER-IN-COUNCIL	OC
RESERVATION	
CANCELLED	
SAND & GRAVEL	

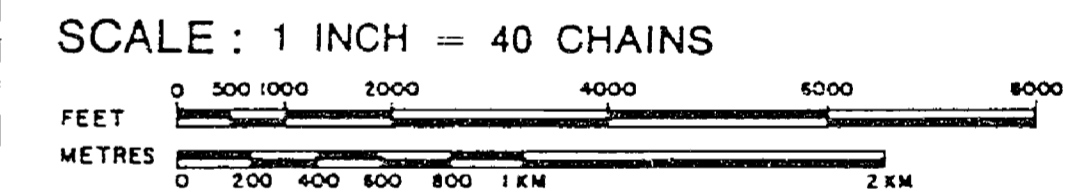

DATE OF ISSUE	ACRES	HECTARES
FEB 09 1998	40	16

PROVINCIAL RECORDING OFFICE - SUDBURY

**OSAQUAN**

DISTRICT  
KENORA  
MINING DIVISION  
KENORA

Ministry of Natural Resources  
Ontario Surveys and Mapping Branch

Date MAY '76 Plan No. M.2017

Whitney Block  
Queen's Park, Toronto

**NOTES**

400' surface rights reservation along the shores of all lakes and rivers.

**SAND AND GRAVEL**

G1 M.T.C. PIT 682  
G2 M.T.C. PIT 668 - FILE 33378

**RESERVATIONS**

R1 ORDER NO. 3/87 87/01/08 18 8555 S.B. MR.

THE INFORMATION THAT APPEARS ON THIS MAP HAS BEEN COMPILED FROM VARIOUS SOURCES, AND ACCURACY IS NOT GUARANTEED. THOSE WISHING TO STAKE MINING CLAIMS SHOULD CONSULT WITH THE MINING RECORDER, MINISTRY OF NORTHERN DEVELOPMENT AND MINES, FOR ADDITIONAL INFORMATION ON THE STATUS OF THE LANDS SHOWN HEREON.

G 1304  
**BRADSHAW TP. M.1950**

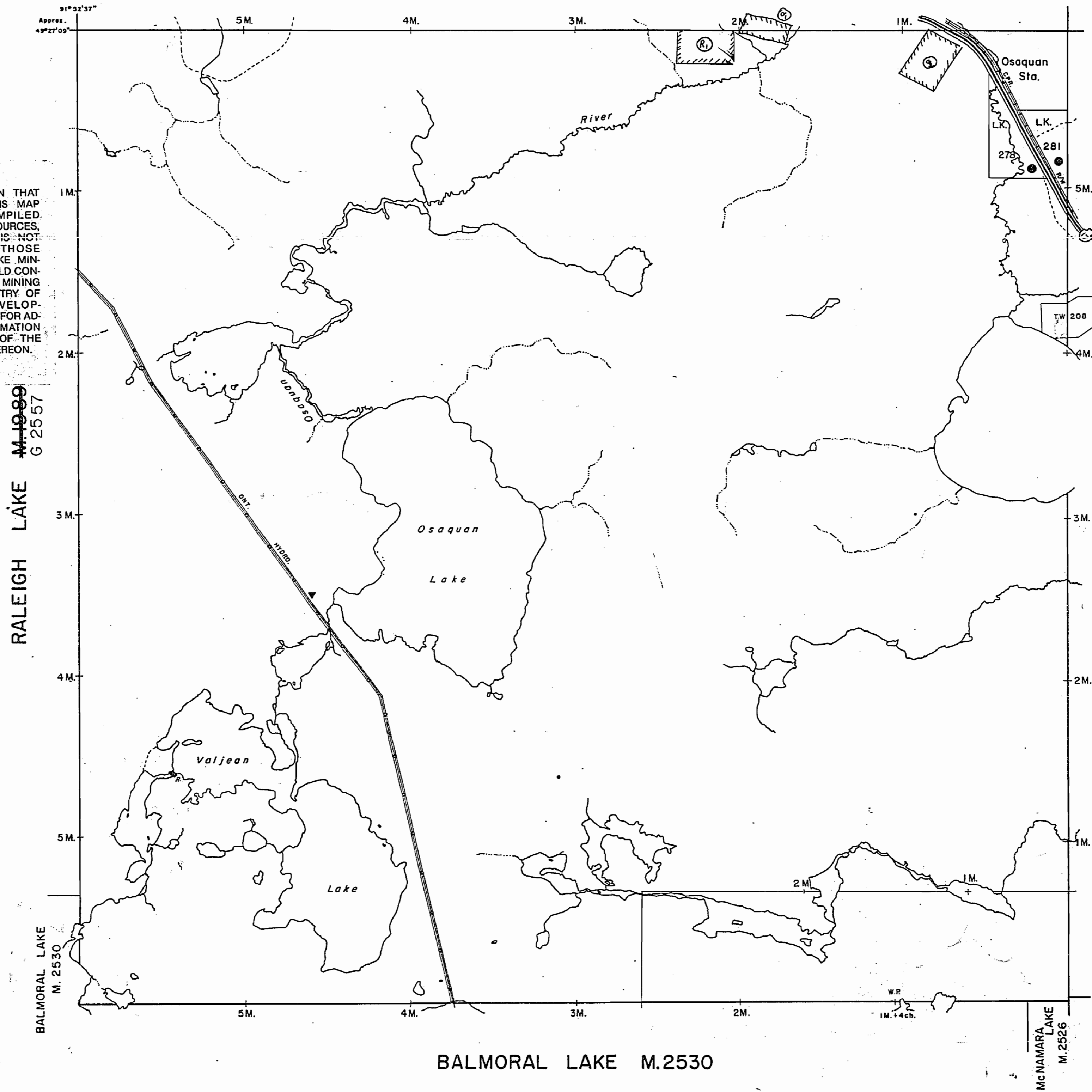

**LEGEND**

- HIGHWAY AND ROUTE No.
- OTHER ROADS
- TRAILS
- SURVEYED LINES:
  - TOWNSHIPS, BASE LINES, ETC.
  - LOTS, MINING CLAIMS, PARCELS, ETC.
- UNSURVEYED LINES:
  - LOT LINES
  - PARCEL BOUNDARY
  - MINING CLAIMS ETC.
- RAILWAY AND RIGHT OF WAY
- UTILITY LINES
- NON-PERENNIAL STREAM
- FLOODING OR FLOODING RIGHTS
- SUBDIVISION
- ORIGINAL SHORELINE
- MARSH OR MUSKEG
- MINES

**DISPOSITION OF CROWN LANDS**

TYPE OF DOCUMENT	SYMBOL
PATENT, SURFACE & MINING RIGHTS	
" SURFACE RIGHTS ONLY	
" MINING RIGHTS ONLY	
LEASE, SURFACE & MINING RIGHTS	
" SURFACE RIGHTS ONLY	
" MINING RIGHTS ONLY	
LICENCE OF OCCUPATION	
CROWN LAND SALE	
ORDER-IN-COUNCIL	
RESERVATION	
CANCELLED	
SAND & GRAVEL	

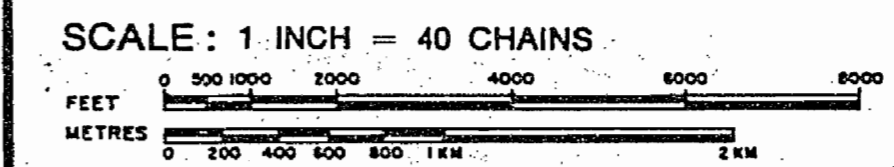
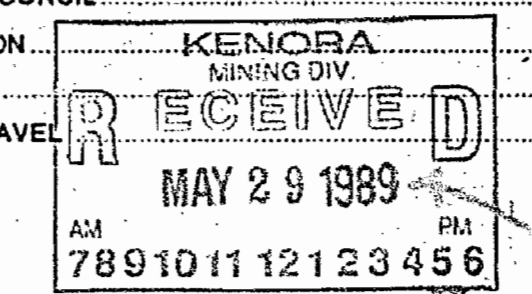

ACRES	HECTARES
40	16

TOWNSHIP  
**OSAQUAN**  
DISTRICT  
KENORA  
MINING DIVISION  
KENORA

Ministry of Natural Resources  
Ontario Surveys and Mapping Branch

Date MAY '76 Plan No. **M.2017**  
Whitney Block  
Queen's Park, Toronto

G-1320

2017

M 2017

OSAQUAN  
KENORA M.G. DIV.  
DISTRICT OF KENORA

ONTARIO  
MINISTRY OF NATURAL RESOURCES  
SURVEYS AND MAPPING BRANCH

Scale = 40 Chains = 1 Inch

TP. 24. Now Bradshaw Twp.

HIGHWAY

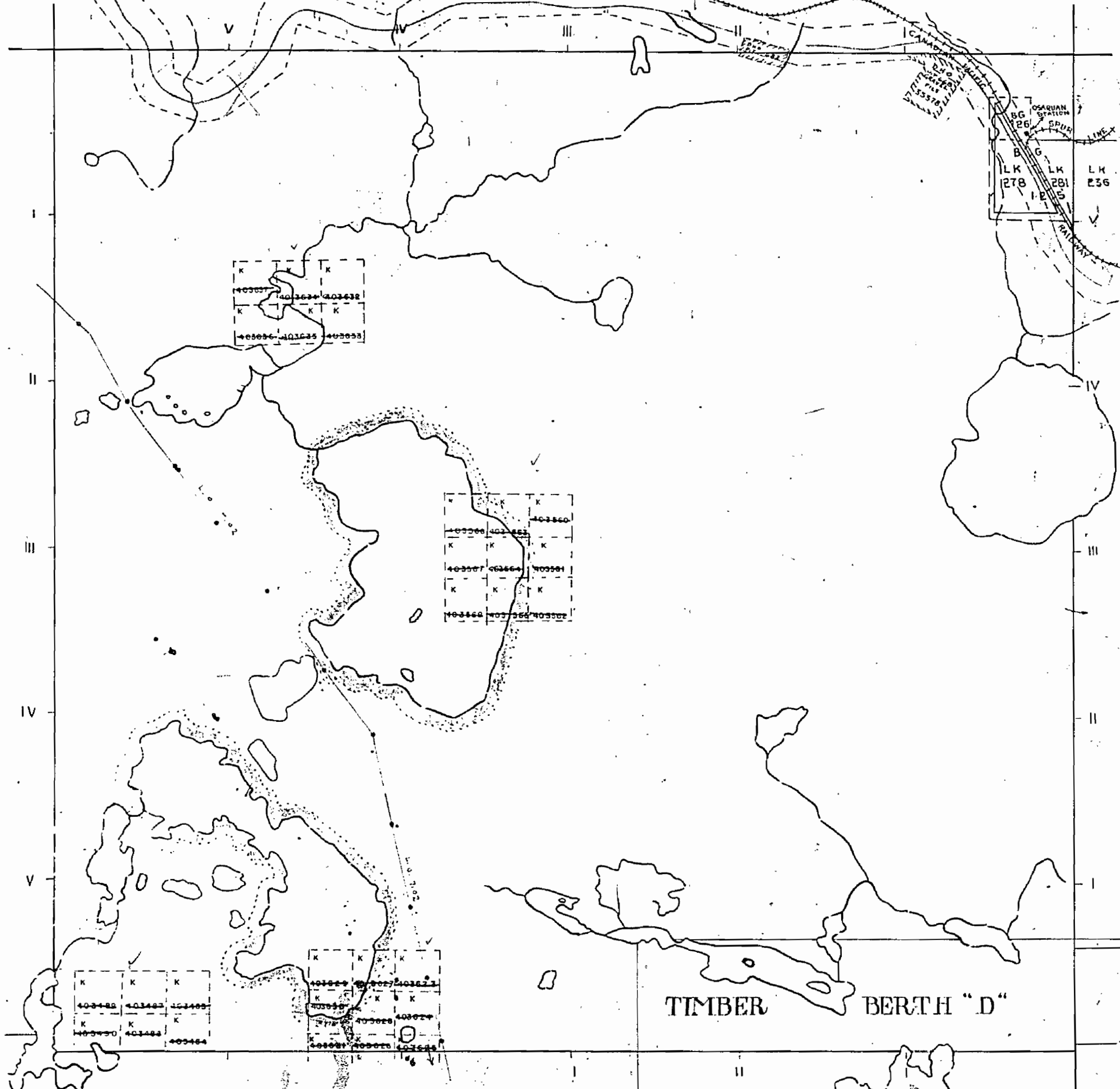

TP. 22. Now Ignace Twp.

TIMBER BERTH "D"

North South West and South part of East boundary by Phillips and Benner OLS 1922  
North part of East boundary by E. Stewart, OLS 1896  
Boundaries of Timber Berth "D" by Phillips and Benner OLS 1922  
Canadian Pacific Railway taken From Right of Way Plan 1897  
Other lakes and rivers taken from the Topographical Aerial Survey (Ignace Sheet)

Surface reservations 400' wide by Dept of L. & F  
Shown hereon thus

KENORA  
MINING DIVISION  
**RECEIVED**  
MAR 19 1975  
AM 7 8 9 10 11 12 1 2 3 4 5 6 PM

DATE OF ISSUE  
MAR 13 1975

FORMERLY TIMBER BERTH WJ SMILEY F. 34874

OSAQUAN 2017



2017

**O. SAQUAN**  
KENORA MG. DIV.  
DISTRICT OF KENORA

APR. 14/66

Scale: - 40 Chains - 1 Inch

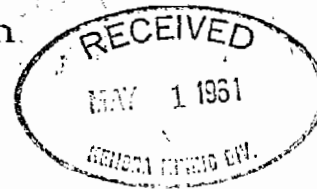

TP. 24. Now Bradshaw Twp.

DHO P.T. 682 - 1964  
1965  
1966

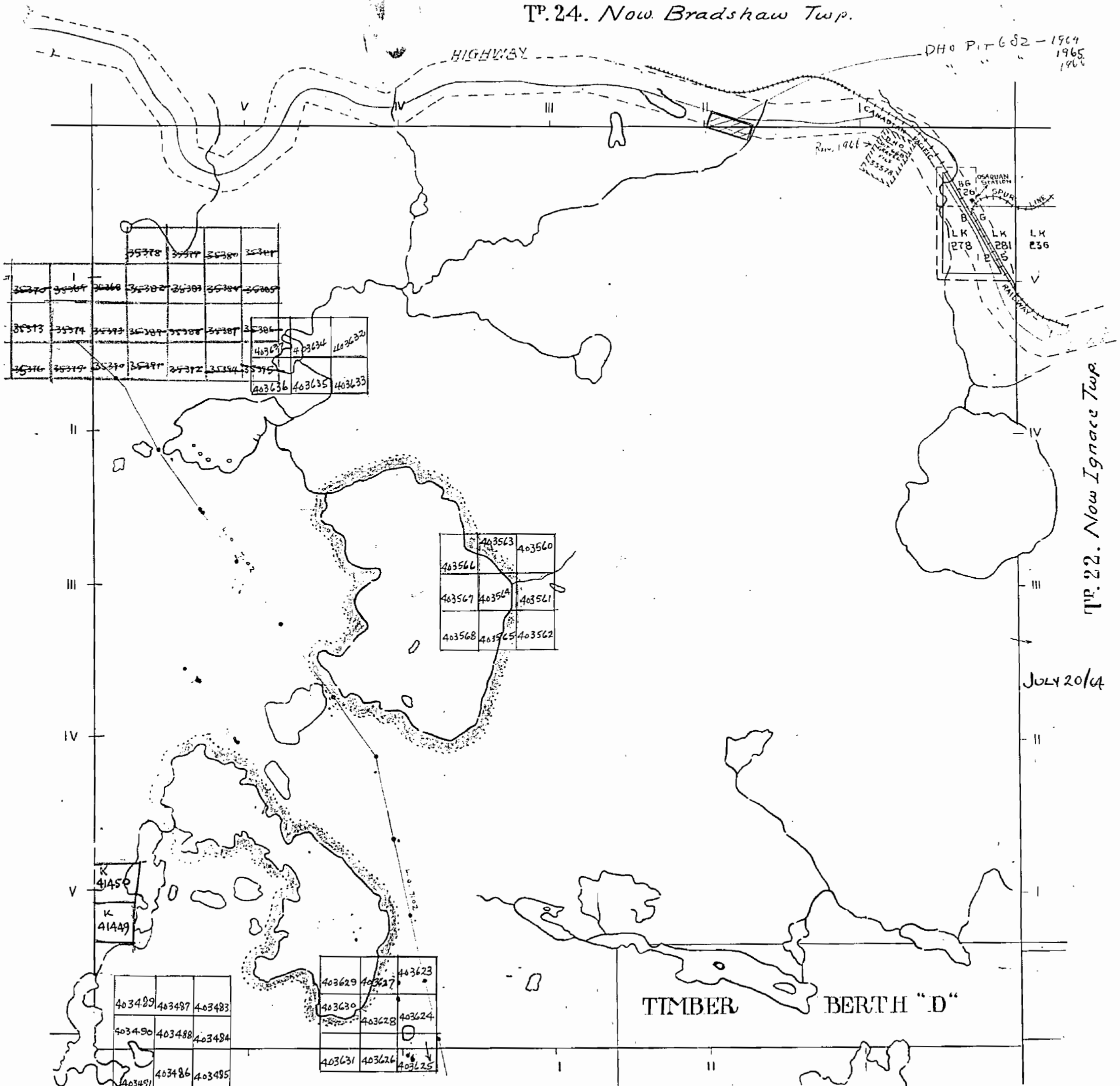

TP. 22. Now Ignace Twp.

JULY 20/64

TIMBER BERTH "D"

North South West and South part of East boundary by Phillips and Benner OLS 1922  
North part of East boundary by E. Stewart OLS 1896  
Boundarys of Timber Berth "D" by Phillips and Benner OLS 1922  
Canadian Pacific Railway taken from Right of Way Plan 1897  
Other Lakes and Rivers taken from The Topographical Aerial Survey (Ignace Sheet)

Surface reservations 400' wide by Dept of L.F.F.  
Shown hereon thus

FORMERLY TIMBER BERTH. WJ SMILEY F. 34874

O. SAQUAN 2017

2017

**OSAQUAN**  
KENORA M.C. DIV.  
DISTRICT OF KENORA  
Scale - 10 Chams. 1 Inch.

M.2017  
ONTARIO  
MINISTRY OF NATURAL RESOURCES  
SURVEYS AND MAPPING BRANCH

TP. 24. Now Bradshaw Twp.

HIGHWAY

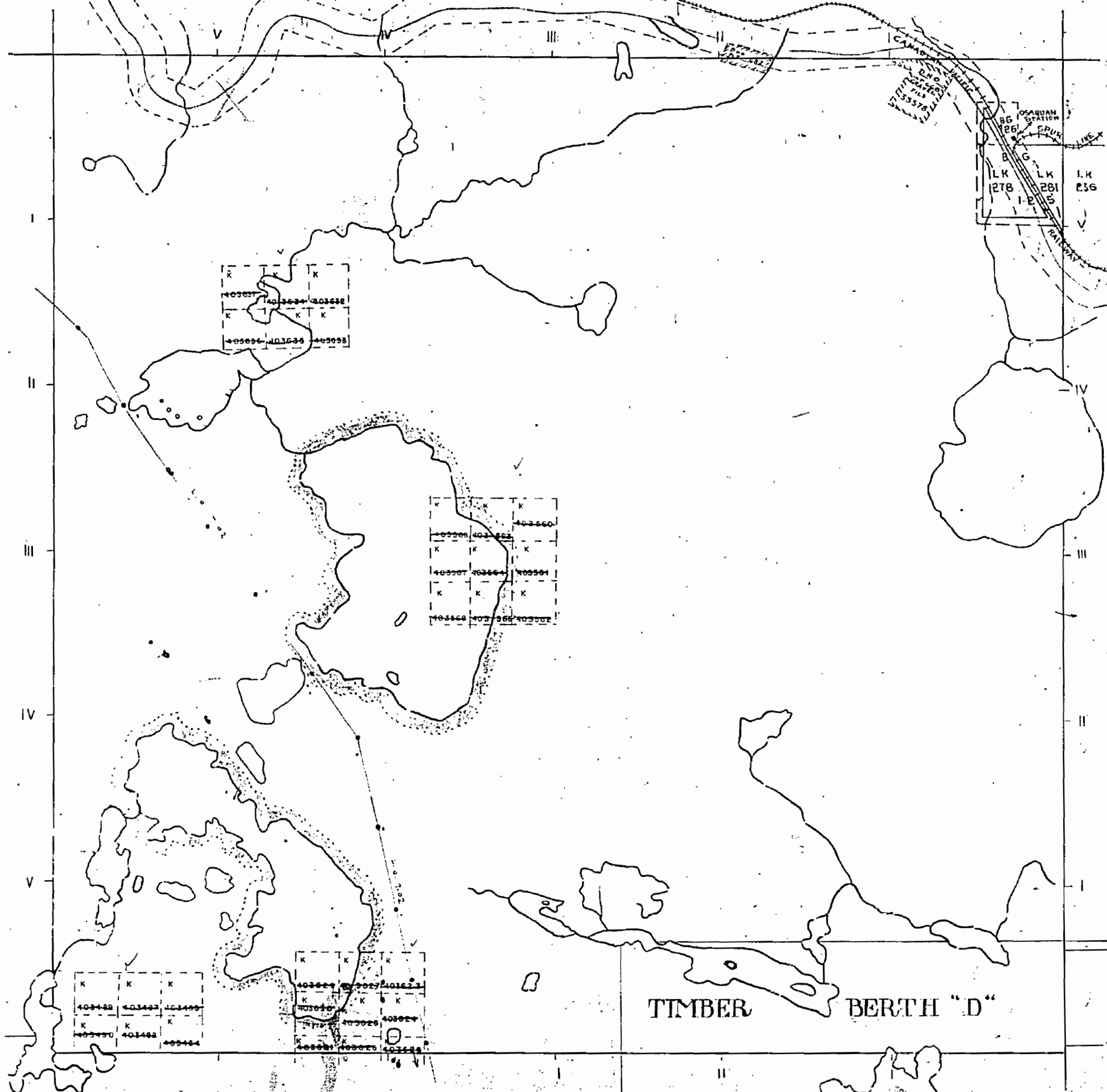

TP. 22. Now Ignace Twp.

TIMBER BERTH "D"

North South West and South part of East boundary by Phillips and Benner OLS 1922  
North part of East boundary by E. Stewart, OLS 1896  
Boundaries of Timber Berth "D" by Phillips and Benner OLS 1922  
Canadian Pacific Railway taken from Right of Way Plan 1897  
Other Lakes and Rivers taken from the Topographical Aerial Survey (Ignace Sheet)

Surface reservations 400' wide by Dept of L. & F.  
Shewn hereon thru ~~the~~ ~~map~~ ~~series~~

KENORA  
MINING DIVISION  
**RECEIVED**  
MAR 19 1975  
AM 7 8 9 10 11 12 1 2 3 4 5 6

DATE OF ISSUE  
MAR 13 1975

FORMERLY TIMBER BERTH W.J. SMILEY F. 34874

OSAQUAN 2017

2017

# OS AQUAN

KENORA MG. DIV.

DISTRICT OF KENORA

APR. 14 / 66

Scale: 40 Chains 1 Inch

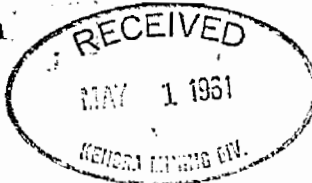

TP. 24. Now Bradshaw Twp.

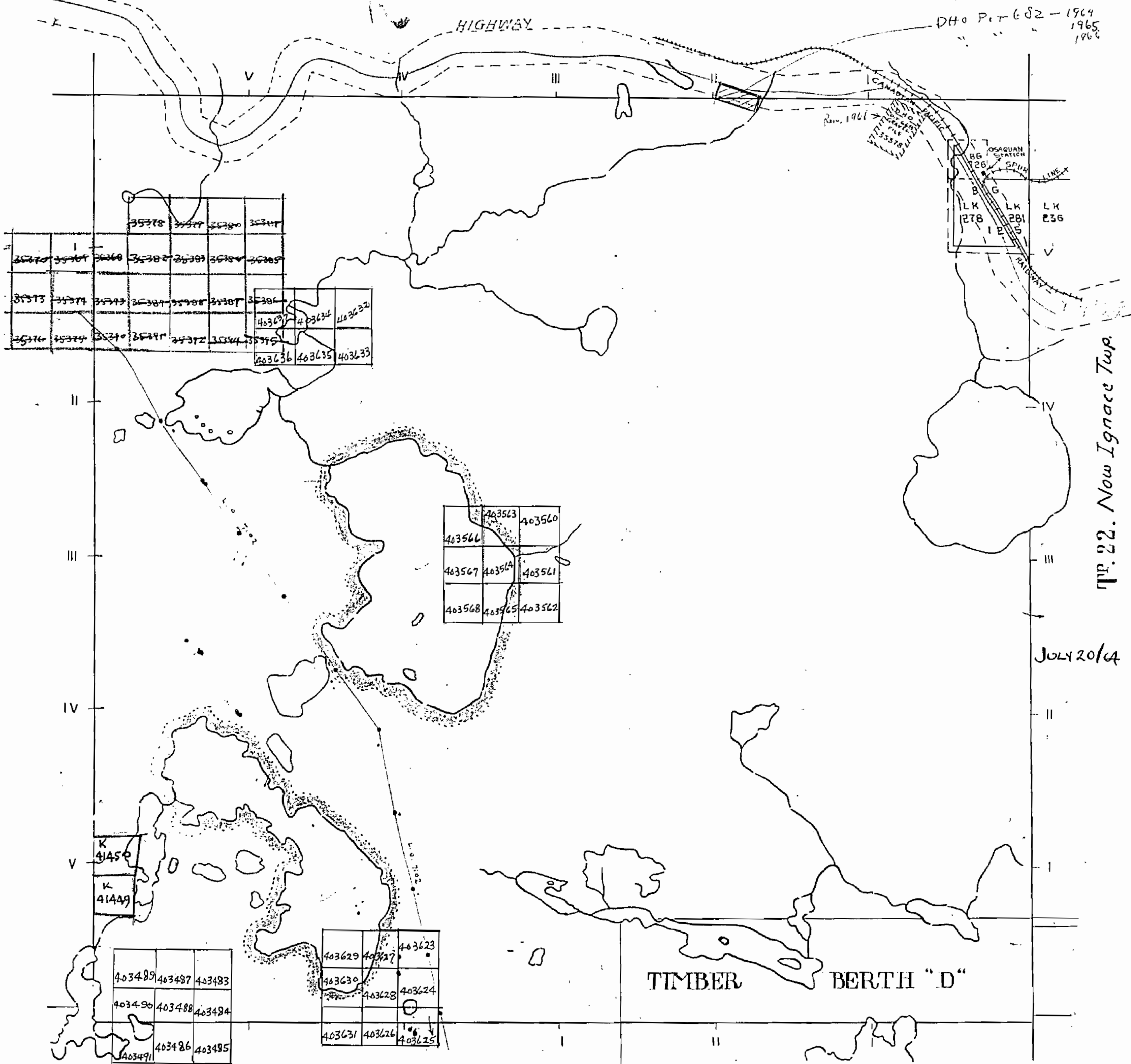

DHO P. 17652 - 1964  
1965  
1966

TP. 22. Now Ignace Twp.

JULY 20/64

TIMBER BERTH "D"

North South West and South part of East boundary by Phillips and Benner OLS 1922  
North part of East boundary by E. Stewart OLS 1896  
Boundaries of Timber-Berth "D" by Phillips and Benner OLS 1922  
Canadian Pacific Railway taken from Right of Way Plan 1897  
Other Lakes and Rivers taken from the Topographical Aerial Survey (Ignace Sheet)

Surface reservations 400' wide by Dept of L. & F  
Shown hereon thus

FORMERLY TIMBER BERTH. WJ SMILEY F. 34874

OS AQUAN 2017