

NOTES

400' surface rights reservation along the shores of all lakes and rivers.

AREAS WITHDRAWN FROM STAKING

Sec.	Order No.	Date	Disp'n	File
①	43 (R.S.O. 1970)	3/8/72	S.R.	90729
R ₂	Cancelled Aug 15/79			

- ⑥ GRAVEL FILE 183123
- ⑦ GRAVEL FILE 92156
- ⑧ GRAVEL
- R₂ Patent - lease

THE MUNICIPAL CORPORATION OF THE TOWNSHIP OF CHAPLEAU shown thus

Surface rights appl. Feb. 22/79
 R₃ ORDER # NR.W. 87/80
 SR & MR. APRIL 9/80 4:20 p.m.

MARSHALL TP.

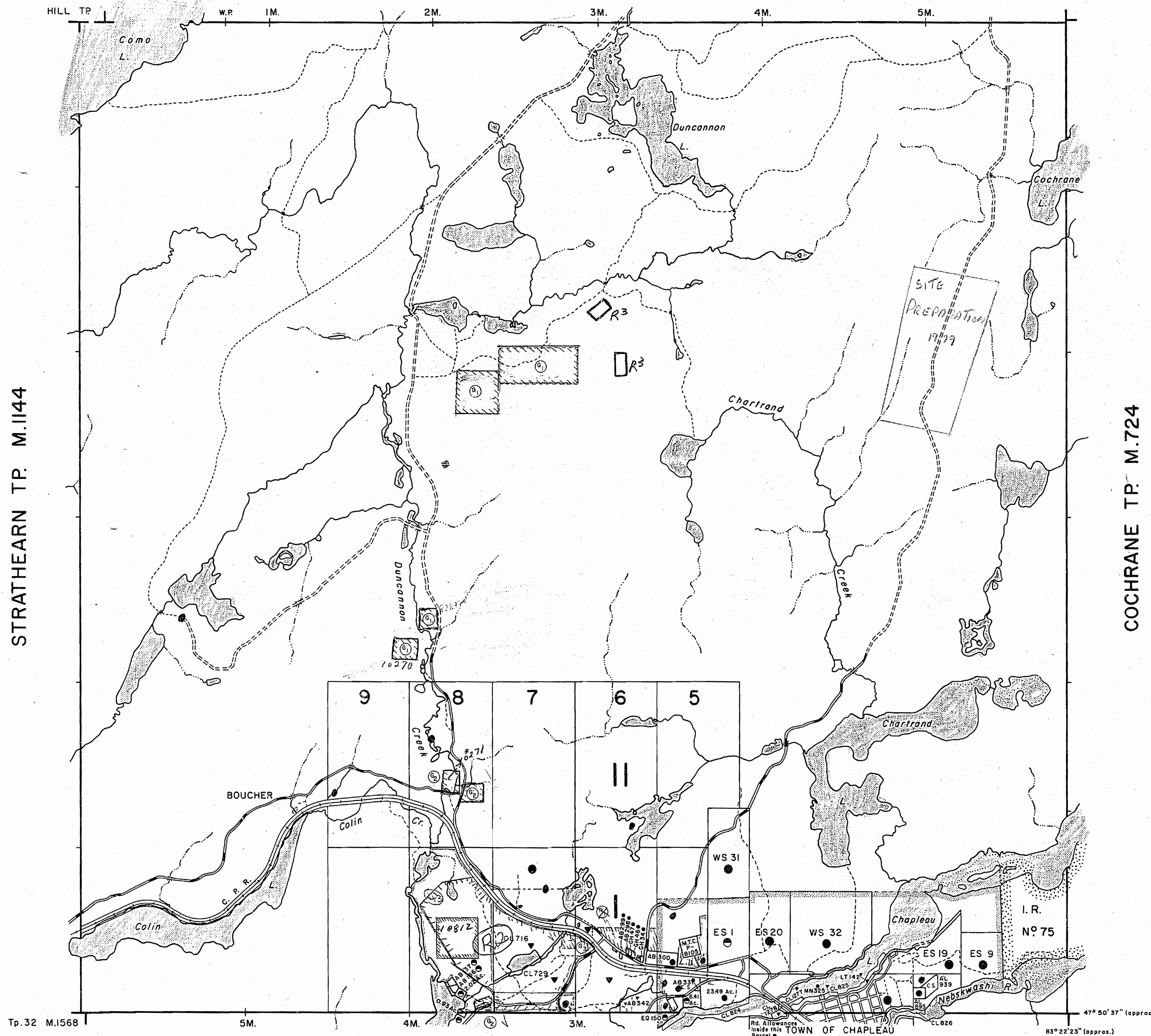

LEGEND

- HIGHWAY AND ROUTE No.
- OTHER ROADS
- TRAILS
- SURVEYED LINES:
 - TOWNSHIPS, BASE LINES, ETC.
 - LOTS, MINING CLAIMS, PARCELS, ETC.
- UNSURVEYED LINES:
 - LOT LINES
 - PARCEL BOUNDARY
 - MINING CLAIMS ETC.
- RAILWAY AND RIGHT OF WAY
- UTILITY LINES
- NON-PERENNIAL STREAM
- FLOODING OR FLOODING RIGHTS
- SUBDIVISION
- ORIGINAL SHORELINE
- MARSH OR MUSKEG
- MINES

DISPOSITION OF CROWN LANDS

TYPE OF DOCUMENT	SYMBOL
PATENT, SURFACE & MINING RIGHTS	●
" SURFACE RIGHTS ONLY	○
" MINING RIGHTS ONLY	◐
LEASE, SURFACE & MINING RIGHTS	■
" SURFACE RIGHTS ONLY	◼
" MINING RIGHTS ONLY	◻
LICENCE OF OCCUPATION	▼
CROWN LAND SALE	C.S.
ORDER-IN-COUNCIL	OC
RESERVATION	⊙
CANCELLED	⊗
SAND & GRAVEL	⊖
● L.U.P.	

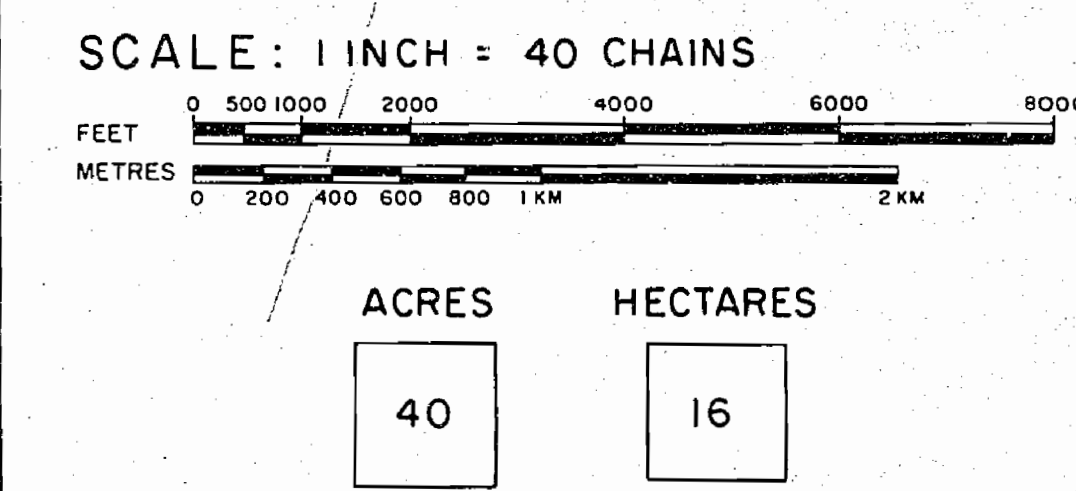

TOWNSHIP
PANET S. MARIE MINING DIV.
 RECEIVE
 MAR 13 1973
 DISTRICT
 SUDBURY
 MINING DIVISION
 SAUL STE. MARIE
 PORCUPINE

ONTARIO
 MINISTRY OF NATURAL RESOURCES
 SURVEYS AND MAPPING BRANCH

DATE FEBRUARY 14, 1973 PLAN No. M 1046

CHAPLEAU TP. M.1230

NOTES

400' surface rights reservation along the shores of all lakes and rivers.

AREAS WITHDRAWN FROM STAKING

S.R. - SURFACE RIGHTS M.R. - MINING RIGHTS
 Sec. Order No. Date Disp'n File

- ① GRAVEL FILE 183123
- ② GRAVEL FILE 97183
- ③ GRAVEL FILE 96793
- ④ " " 92156
- ⑤ QUARRY PERMIT

THE MUNICIPAL CORPORATION OF THE TOWNSHIP OF CHAPLEAU shown thus

Surface rights appl. Feb. 22/80

R³ ORDER# NR.W. 87/80
 SR & MR: APRIL 9/80 4:20 p.m.

THE INFORMATION THAT APPEARS ON THIS MAP HAS BEEN COMPILED FROM VARIOUS SOURCES, AND ACCURACY IS NOT GUARANTEED. THOSE WISHING TO STAKE MINING CLAIMS SHOULD CONSULT WITH THE MINING RECORDER, MINISTRY OF NORTHERN DEVELOPMENT AND MINES, FOR ADDITIONAL INFORMATION ON THE STATUS OF THE LANDS SHOWN HEREON.

MARSHALL TP.

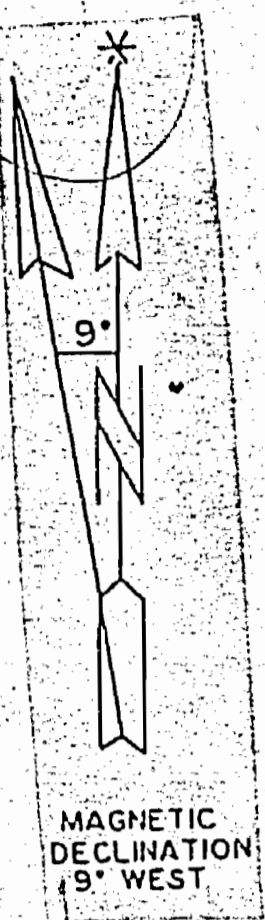
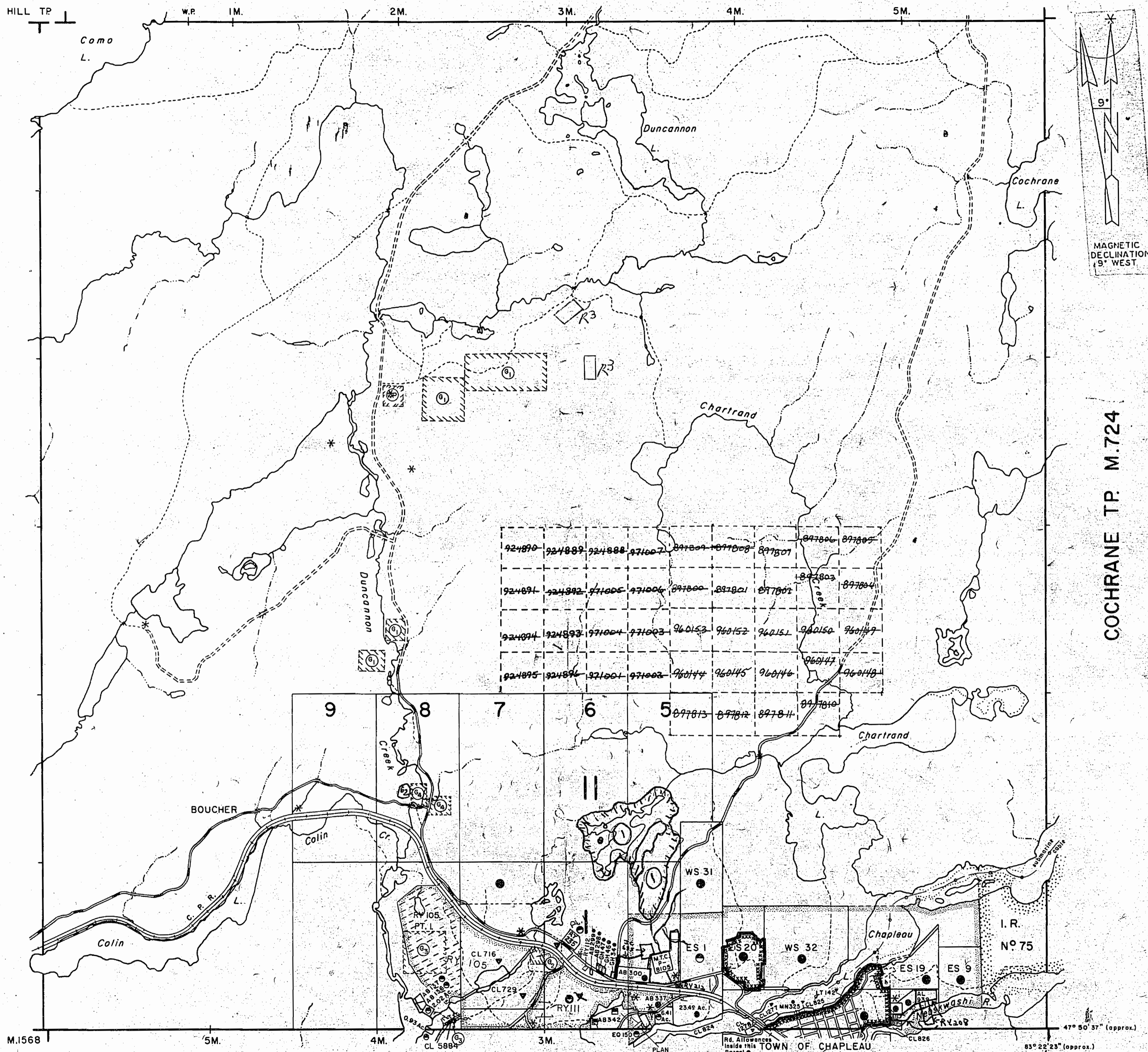

LEGEND

- HIGHWAY AND ROUTE - No.
- OTHER ROADS
- TRAILS
- SURVEYED LINES: TOWNSHIPS, BASE LINES, ETC.
- LOTS, MINING CLAIMS, PARCELS, ETC.
- UNSURVEYED LINES: LOT LINES
- PARCEL BOUNDARY
- MINING CLAIMS ETC.
- RAILWAY AND RIGHT OF WAY
- UTILITY LINES
- NON-PERENNIAL STREAM
- FLOODING OR FLOODING RIGHTS
- SUBDIVISION
- ORIGINAL SHORELINE
- MARSH OR MUSKEG
- MINES
- REGISTERED PLAN OF SUBDIVISION

DISPOSITION OF CROWN LANDS

TYPE OF DOCUMENT	SYMBOL
PATENT, SURFACE & MINING RIGHTS	●
" SURFACE RIGHTS ONLY	○
" MINING RIGHTS ONLY	◐
LEASE, SURFACE & MINING RIGHTS	■
" SURFACE RIGHTS ONLY	◼
" MINING RIGHTS ONLY	◻
LICENCE OF OCCUPATION	▼
CROWN LAND SALE	CS
ORDER-IN-COUNCIL	OC
RESERVATION	⊙
CANCELLED	⊗
SAND & GRAVEL	⊕
LAND USE PERMIT	*
PENDING DISPOSITION	⊞

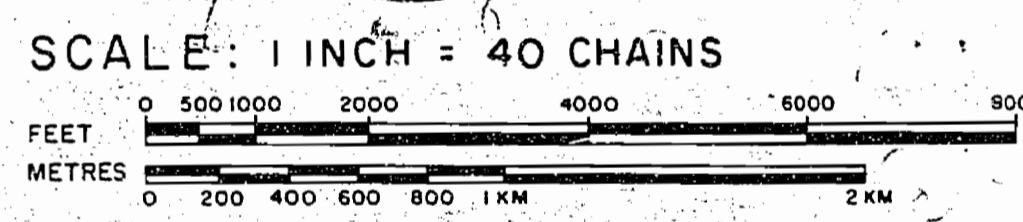

ACRES	HECTARES
40	16

TOWNSHIP
PANET
 DISTRICT
 DATE OF ISSUE
 MAY 21 1980
 PROVINCIAL RECORDING OFFICE - SUDBURY
 MINING DIVISION
 PORCUPINE

Received May 8/80
 ONTARIO
 MINISTRY OF NATURAL RESOURCES
 SURVEYS AND MAPPING BRANCH

DATE FEBRUARY 14, 1973 PLAN No. G-1193
 WHITNEY BLOCK QUEEN'S PARK, TORONTO

Tp. 32 M.1568

CHAPLEAU TP. M.1230

COCHRANE TP. M.724

PANEL

Sudbury District

Scale: 40 chains to inch

SAULT STE MARIE
MINING DIVISION

M A R S H A L L

m-1046

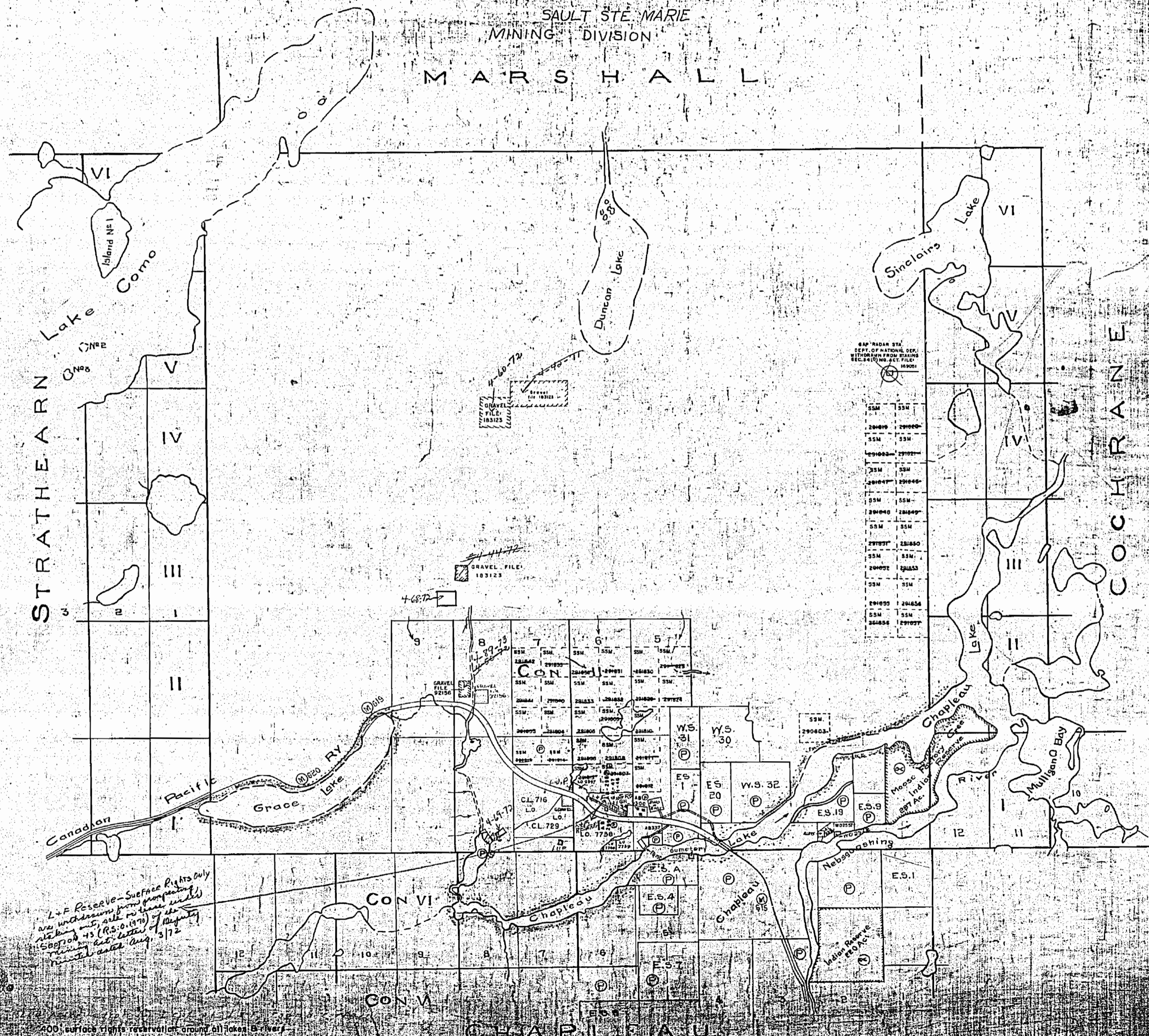

84° RADAR STA.
DEPT. OF NATIONAL DEF.
WITHDRAWN FROM STAIRS
SEC. 8410 NO. ACT. FILE
169081

SSM	SSM
204019	291000
SSM	SSM
204020	291021
SSM	SSM
204047	291046
SSM	SSM
204048	291049
SSM	SSM
297037	291850
SSM	SSM
204052	291853
SSM	SSM
291055	291854
SSM	SSM
261856	291037

L & F Reserve - Surface Rights Only
are withdrawn from prospecting
are taken out, sale or lease under
S.S. 1045 (R.S. 6.1476) of the
Mining Act, letter of the
Minister dated Aug. 3/72

400' surface rights reservation around all lakes & rivers

1046

PANET

Sudbury District

Scale: 40 chains to inch

m-1046

SAULT STE. MARIE
MINING DIVISION

M A R S H A L L

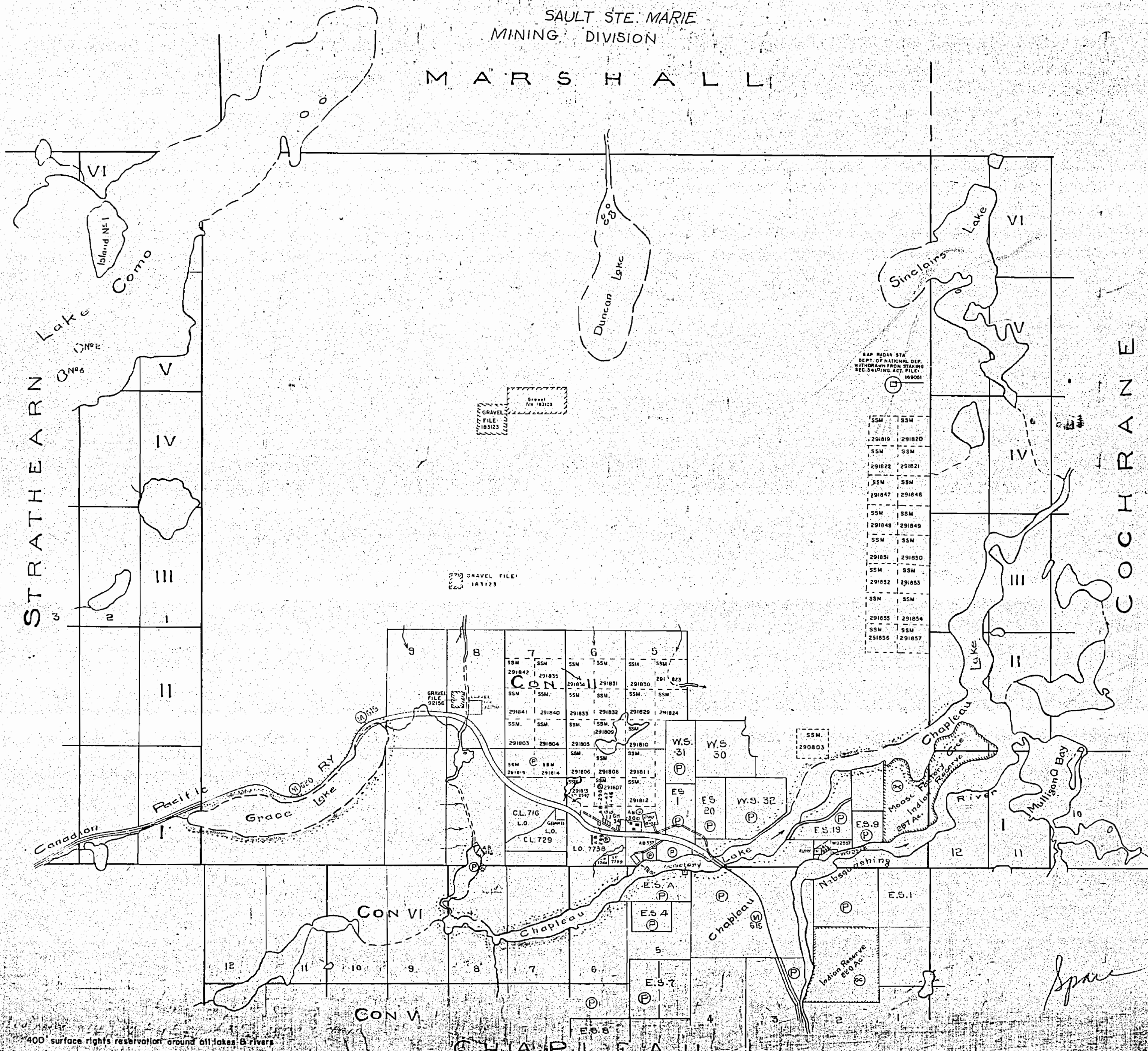

STRATHEARN

COCHRANE

CHAPLEAU

400' surface rights reservation around all lakes & rivers

Spur

PANET

m-1046

Sudbury District

Scale: 40 chains to linch

SUDBURY-SAULT STE. MARIE
MINING DIVISION

M A R S H A L L

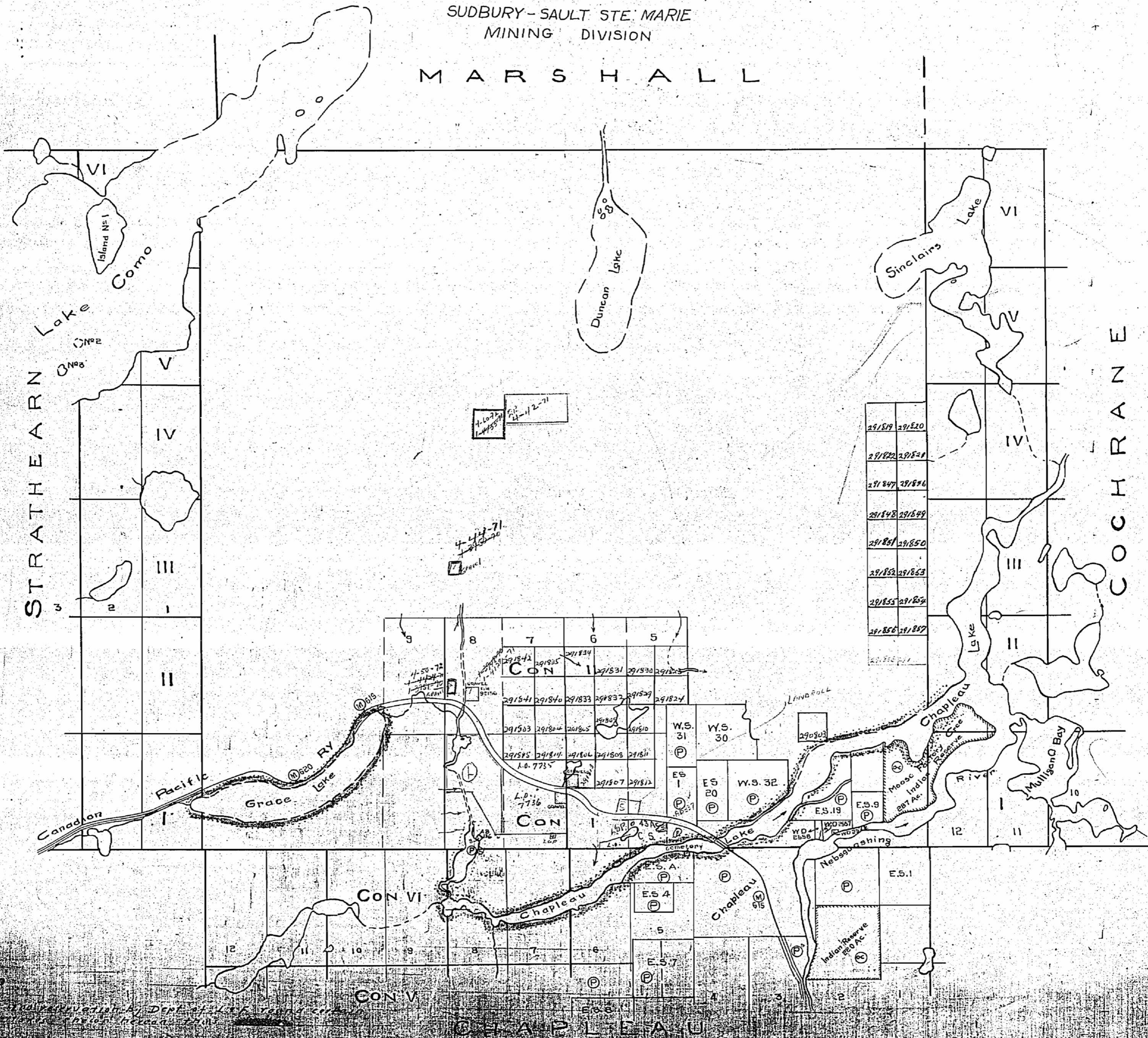

4-10-71
1-1-71

4-11-71
2-1-71

291819	291820
291821	291822
291847	291848
291849	291850
291851	291852
291853	291854
291855	291856
291857	291858

Approved by Dept. of Lands and Survey
Sudbury District

PANET

m=1046

Sudbury District

Scale: 40 chains to 1 inch

400' 1800'

Q.P. 12502

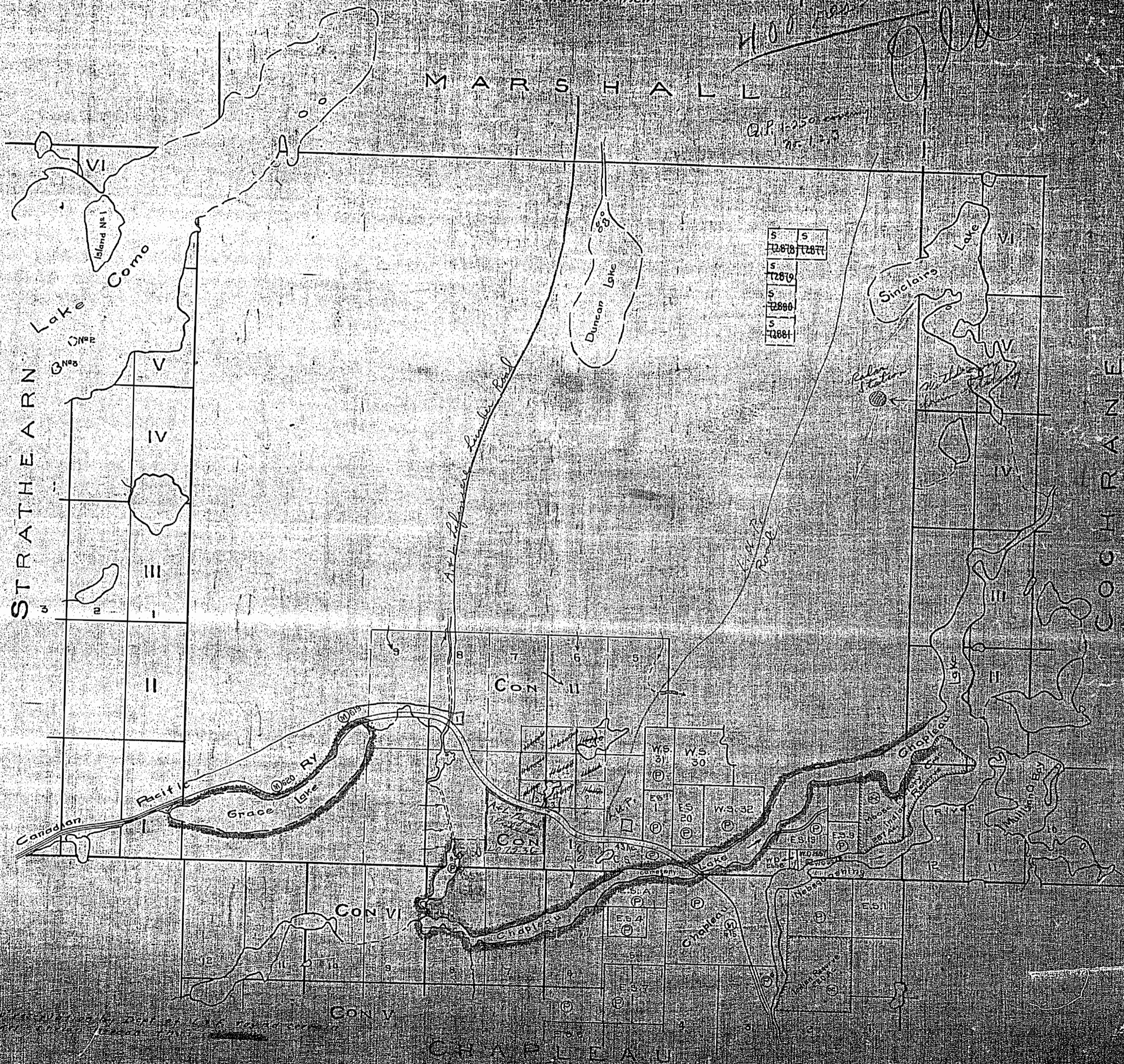

COCHRANE

CHAPLEAU

STRATHEARN

MARSHALL

Island No. 1

Lake Como

Duncan Lake

Sinclair's Lake

Lake

Pacific

Grace Lake

Choptank Lake

Choptank

Canadian

Lumber Road

Pulver Station

CON

CON VI

CON V

WS 31

WS 30

ES 1

ES 20

WS 32

ES 8

ES 9

ES 4

ES 7

ES 1

PANEL

Sudbury District
Scale: 40 chains to inch

m-1046

SAULT STE. MARIE
MINING DIVISION

MARSHALL

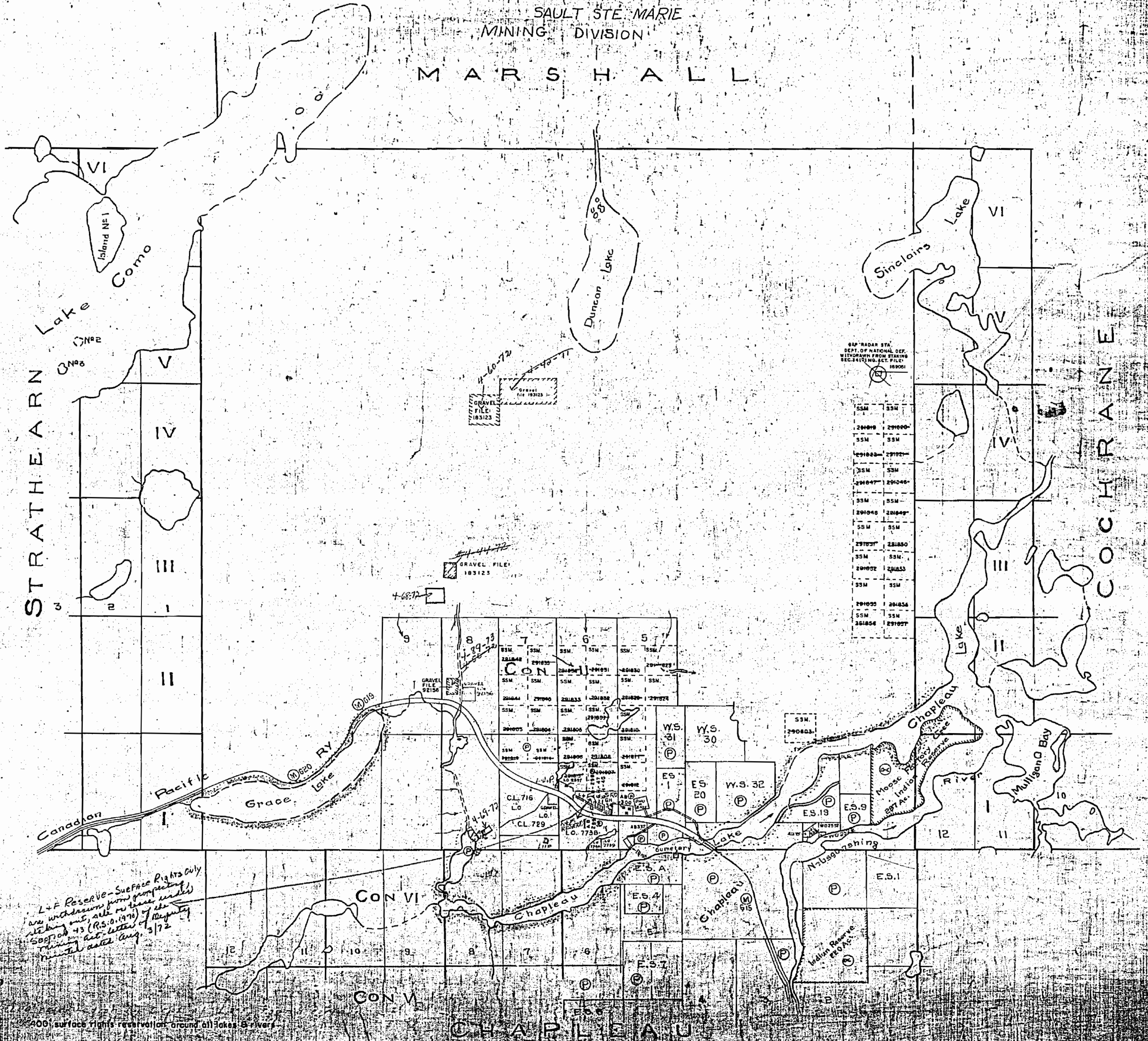

L & F Reserve - Surface Rights Only
 are withdrawn from prospecting
 and mining, etc., under the
 provisions of Act. 43 (R.S.O. 1970)
 of the Mining Act. Letter of Request
 dated Aug. 3/72

200' surface rights reservation around all lakes & rivers

1046

PANET

Sudbury District
Scale: 40 chains to an inch

m-1046

SAULT STE. MARIE
MINING DIVISION

M A R S H A L L

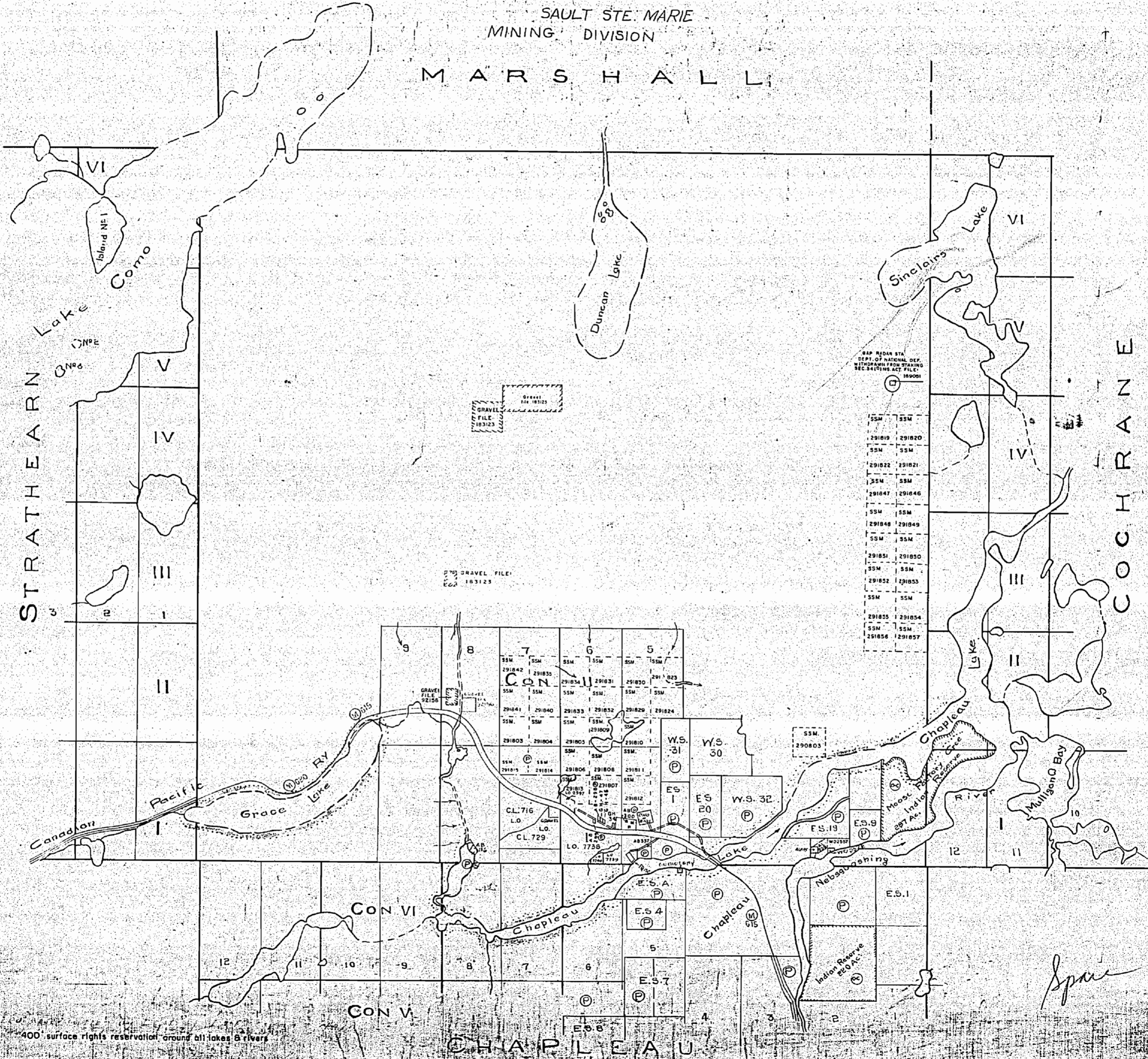

400' surface rights reservation around all lakes & rivers

CHAPLEAU

Spice

PANET

m-1046

Sudbury District

Scale: 40 chains to inch

SUDBURY-SAULT STE. MARIE
MINING DIVISION

M A R S H A L L

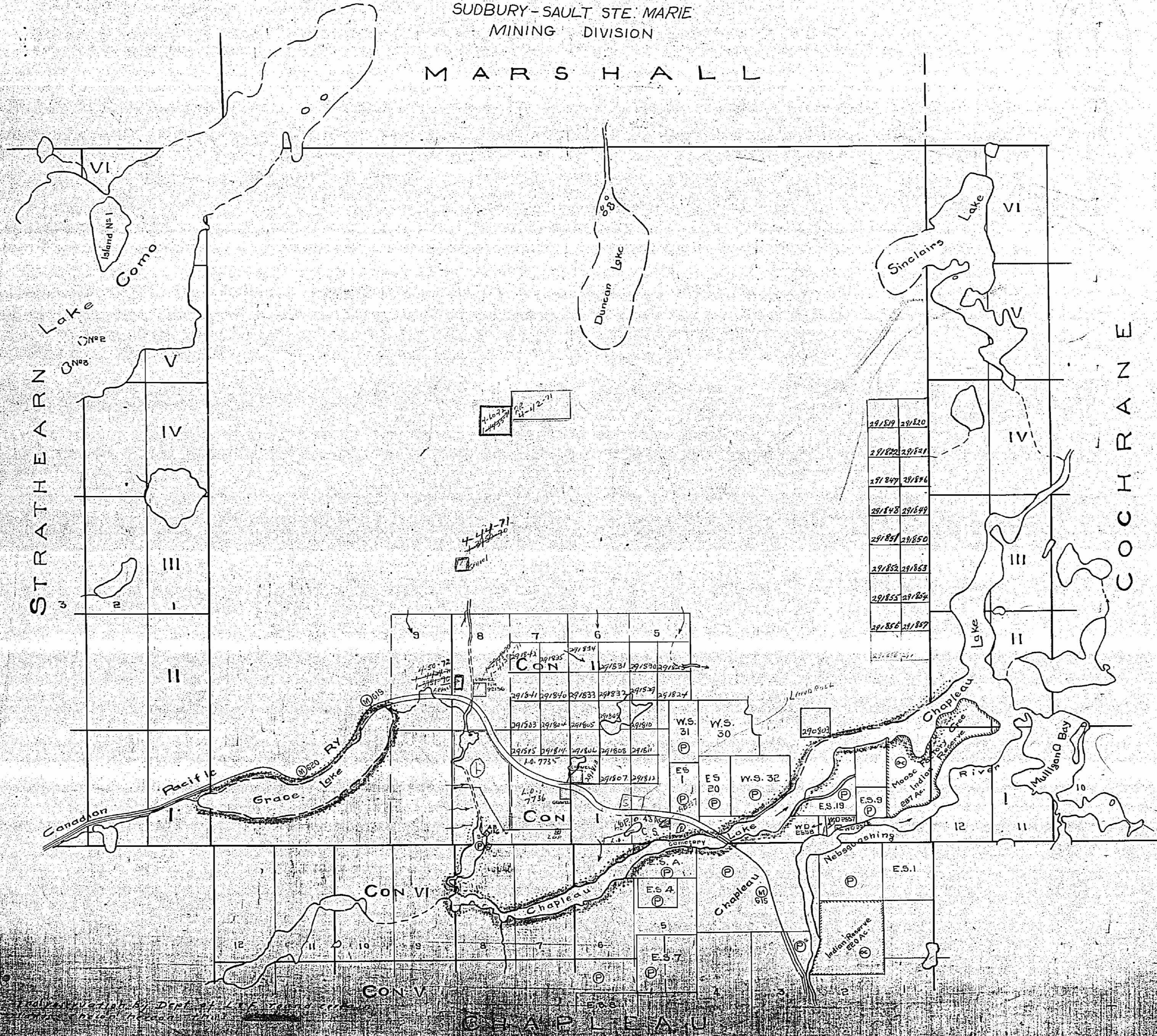

PANET

1046

Sudbury District
Scale 40 chains to inch

Handwritten: H.O. 1850
OP 1250
No. 1250

MARSHALL

5	5
72878	72877
5	5
72879	
5	5
72880	
5	5
72881	

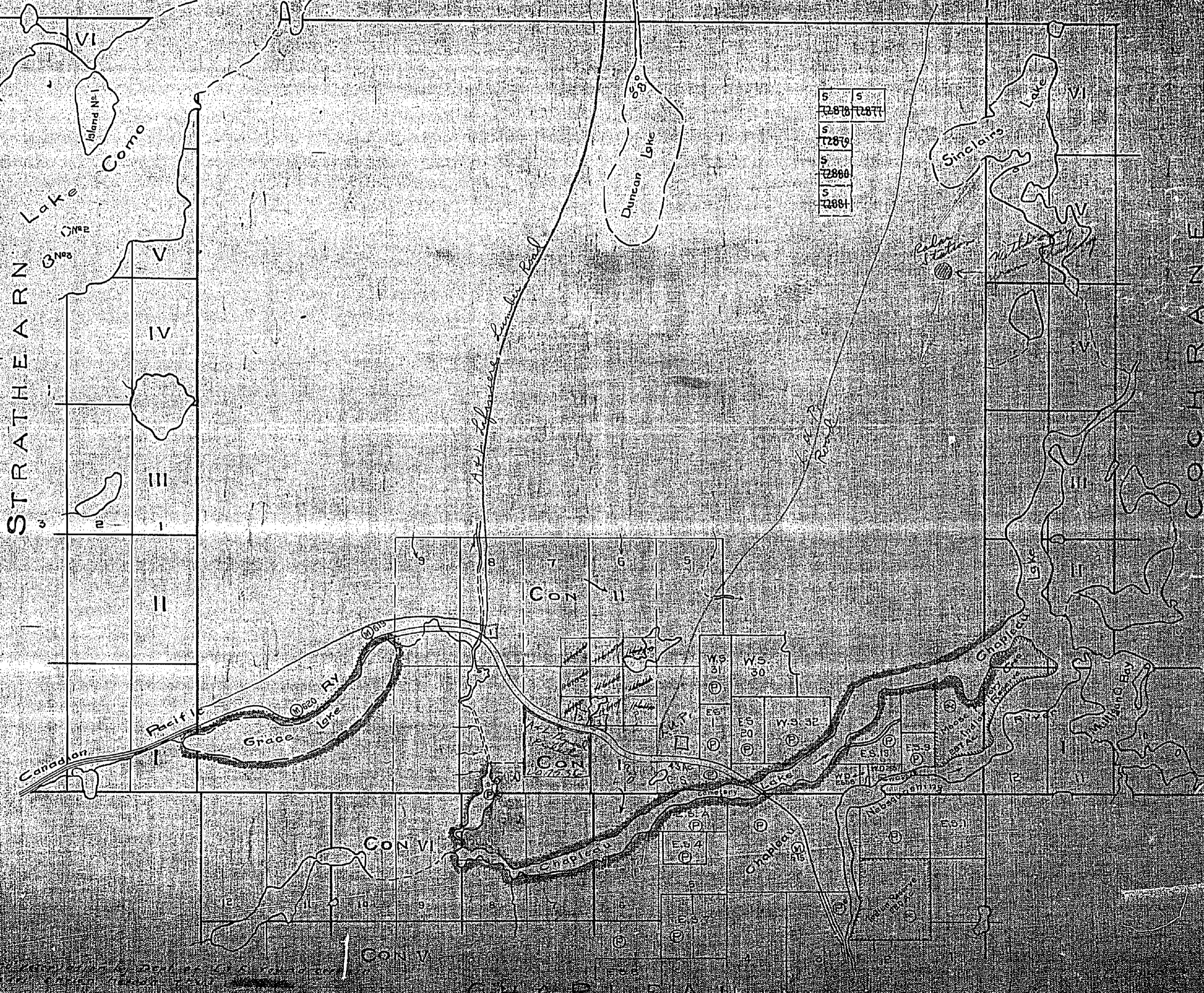

STRATHEARN

COCHRANE

CHAPLEAU

400' surface rights reservation along the shores of all lakes and rivers.

AREAS WITHDRAWN FROM STAKING

S.R. - SURFACE RIGHTS M.R. - MINING RIGHTS
 Sec. Order No. Date Disp'n File

- Ⓢ GRAVEL FILE 183123
- Ⓢ GRAVEL FILE 97183
- Ⓢ GRAVEL FILE 96793
- Ⓢ " " 92156
- Ⓢ QUARRY PERMIT

THE MUNICIPAL CORPORATION OF THE TOWNSHIP OF CHAPLEAU shown thus

Surface rights appl. Feb. 22/80

R3 ORDER# NR.W. 87/80
 SR & MR. APRIL 9/80 4:20 p.m.

THE INFORMATION THAT APPEARS ON THIS MAP HAS BEEN COMPILED FROM VARIOUS SOURCES, AND ACCURACY IS NOT GUARANTEED. THOSE WISHING TO STAKE MINING CLAIMS SHOULD CONSULT WITH THE MINING RECORDER, MINISTRY OF NORTHERN DEVELOPMENT AND MINES, FOR ADDITIONAL INFORMATION ON THE STATUS OF THE LANDS SHOWN HEREON.

MARSHALL TP.

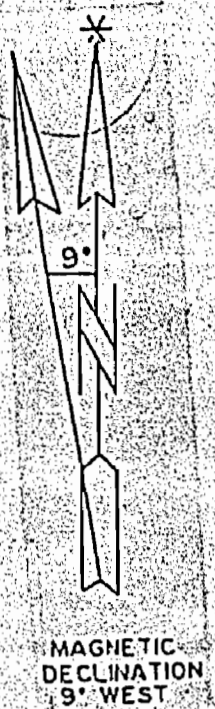
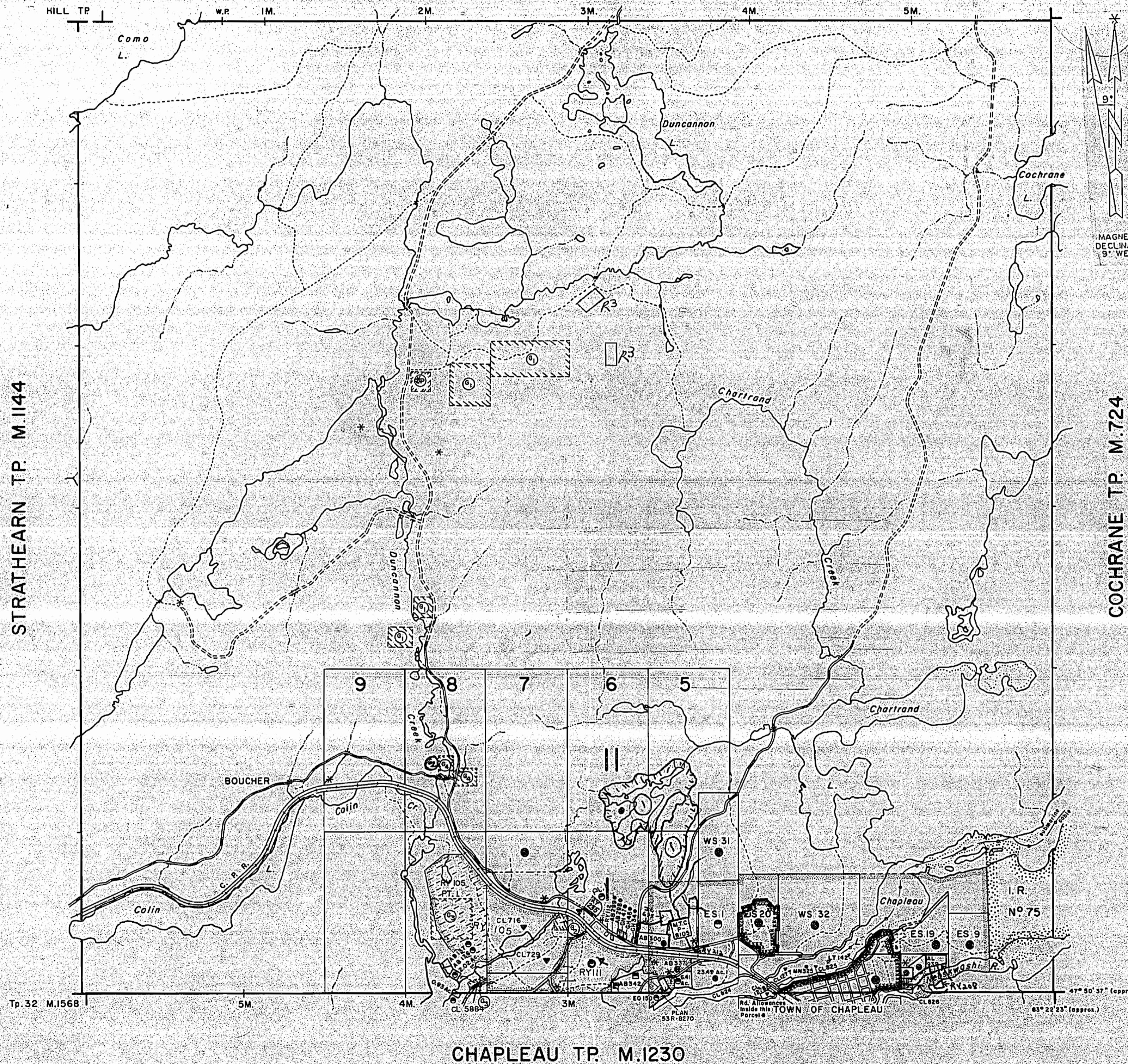

HIGHWAY AND ROUTE No.	
OTHER ROADS	
TRAILS	
SURVEYED LINES:	
TOWNSHIPS, BASE LINES, ETC.	
LOTS, MINING CLAIMS, PARCELS, ETC.	
UNSURVEYED LINES:	
LOT LINES	
PARCEL BOUNDARY	
MINING CLAIMS ETC.	
RAILWAY AND RIGHT OF WAY	
UTILITY LINES	
NON-PERENNIAL STREAM	
FLOODING OR FLOODING RIGHTS	
SUBDIVISION	
ORIGINAL SHORELINE	
MARSH OR MUSKEG	
MINES	
REGISTERED PLAN OF SUBDIVISION	

DISPOSITION OF CROWN LANDS

TYPE OF DOCUMENT	SYMBOL
PATENT, SURFACE & MINING RIGHTS	
" SURFACE RIGHTS ONLY	
" MINING RIGHTS ONLY	
LEASE, SURFACE & MINING RIGHTS	
" SURFACE RIGHTS ONLY	
" MINING RIGHTS ONLY	
LICENCE OF OCCUPATION	
CROWN LAND SALE	
ORDER-IN-COUNCIL	
RESERVATION	
CANCELLED	
SAND & GRAVEL	
LAND USE PERMIT	
PENDING DISPOSITION	

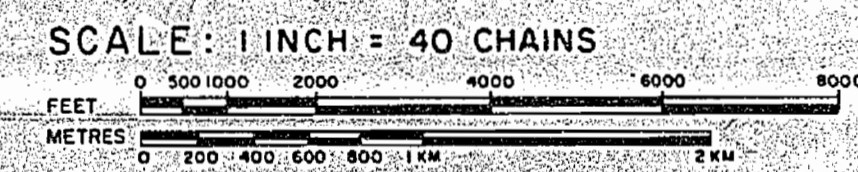

ACRES	HECTARES
40	16

TOWNSHIP
PANET
 DISTRICT
 SUDBURY
 MINING DIVISION
 PORCUPINE
 Received May 8/80
 ONTARIO
 MINISTRY OF NATURAL RESOURCES
 SURVEYS AND MAPPING BRANCH

DATE FEBRUARY 14, 1973 PLAN No. G-1193
 WHITNEY BLOCK QUEEN'S PARK, TORONTO