











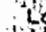

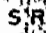
AREA OF
PIJITAWABIK BAY
a
KILKENNY TWP
DISTRICT OF
THUNDER BAY

THUNDER BAY
MINING DIVISION

SCALE: 1-INCH = 40 CHAINS

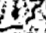
LEGEND

- PATENTED LAND 
- CROWN LAND SALE 
- LEASES 
- LOCATED LAND 
- LICENSE OF OCCUPATION 
- MINING RIGHTS ONLY 
- SURFACE RIGHTS ONLY 
- ROADS 
- IMPROVED ROADS 
- KING'S HIGHWAYS 
- RAILWAYS 
- POWER LINES 
- MARSH OR MUSKOGEE 
- MINES 
- CANCELLED 

NOTES

400' Reserve around all lakes & rivers to Dept. of Lands & Forests.

This Area Lies Within The NIPIGON PROVINCIAL FOREST

66' Reserve around the shore of Nipigon L. from 855' contour to H.E.P.C.

Areas withdrawn from staking under Section 43 of the Mining Act, R.S.O. 1970.

File	Date	Disposition
177205		S.R.O.

South Bay (Lake Nipigon) - M.3044

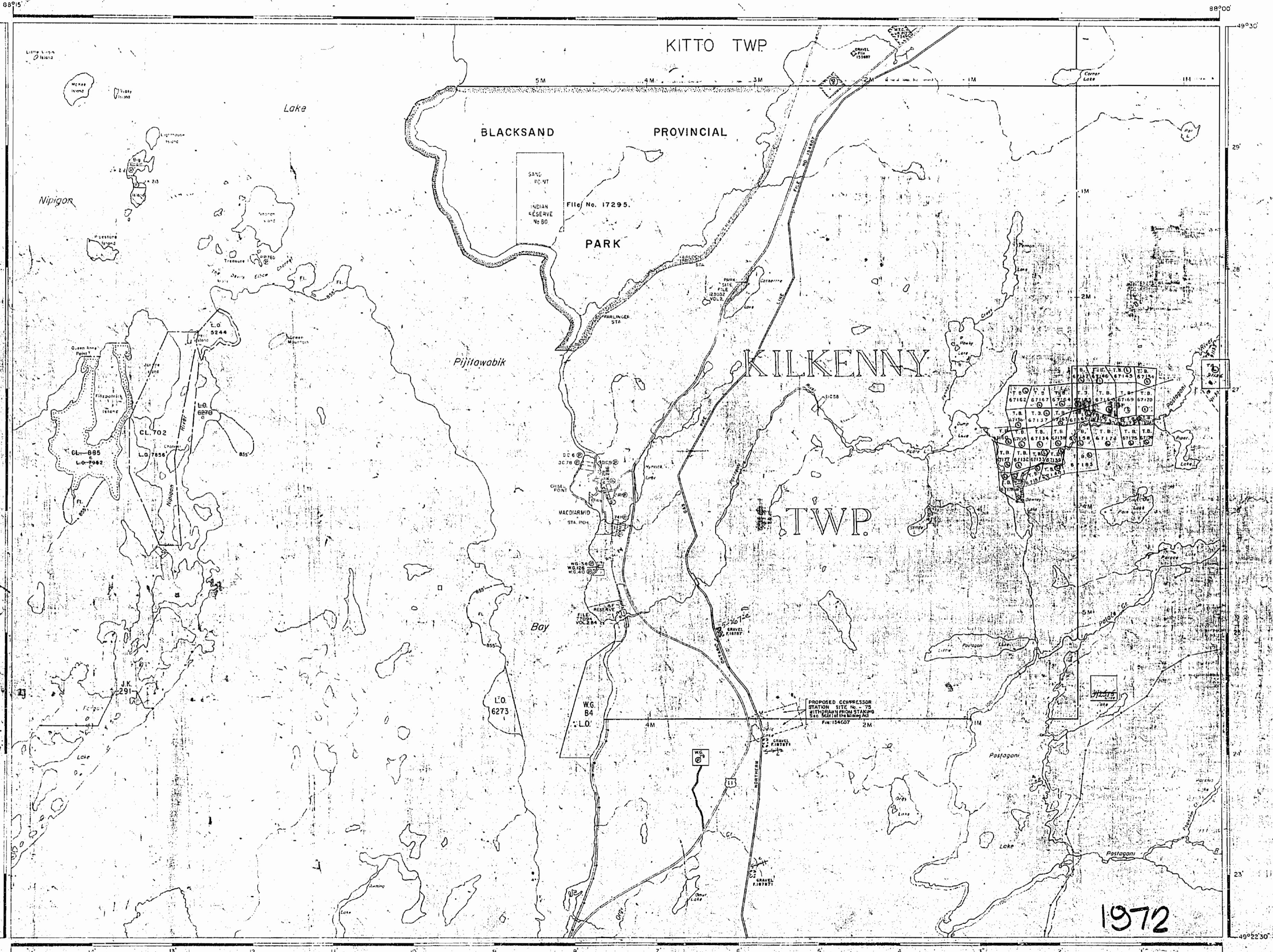

NIP
NATIONAL TOPOGRAPHIC SERIES 52 H8
PLAN NO. M-1780

ONTARIO
DEPARTMENT OF MINES
AND NORTHERN AFFAIRS

1780

KILKENNY T.P. & PIJITAWABIK BAY

NIPIGON PROVINCIAL FOREST.

DISTRICT OF THUNDER BAY.

Scale 20 Chains = 1 Inch

KITTO T.P.

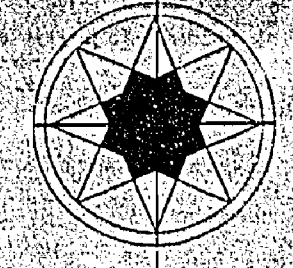

59.00 5 80.00 4 80.00 WEST 3 EAST 80.00 2 80.00 1 80.00

M1780
1945

IR NO 80
AREA 236 ACRES
FILE 11255 L.O.

LAKE NIPIGON
RESERVE FLOODING RIGHTS TO 855' CONTOUR.

FARLINGER.

FILE 11109
MILLSITE NIPIGON PRODUCTS LTD.
1153 AC.
FILE 12358 L.O.

FAIRLOCH.

POSTAGONI RIVER

DEPT. OF GAME & FIS.
L.O. FILE 19242
FILE 19242
J.K. 225 L.O.
MACDIAMID.

PIJITAWABIK BAY.

T.B. 27340
T.B. 27125
T.B. 27124

T.B. 1111

POSTAGONI LAKE

KILKENNY T.P.

NIPIGON PROVINCIAL FOREST.

DISTRICT OF THUNDER BAY.

Scale: 20 Chains = 1 Inch.

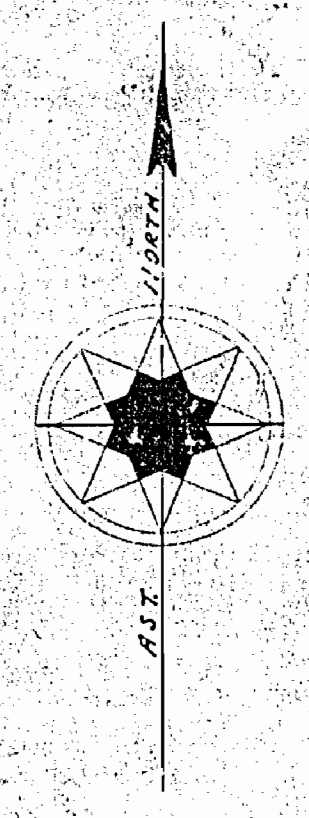

KITTO T.P.

Proposed National Park

1951

59.00 5 80.00 4 80.00 WEST 3 AST. 80.00 2 80.00

IR NO 80.
AREA 236 ACRES
FILE 11295 L.O.

FILE 11103
MILLSITE
NIPIGON PRODUCTS
L.T.

LAKE NIPIGON

RESERVE FLOODING RIGHTS TO 855' CONTOUR.

FAIRLOCH.

FARLINGER.

Note: All claims staked adjoining Lake Nipigon are subject to a reservation of the surface rights 86 ft. in perpendicular width from the present water level, approx. contour elevation of

MACDIARMID

PIJITAWABIK BAY.

63620 T.B.
27840
63619 T.B.
27135
T.B.
27122

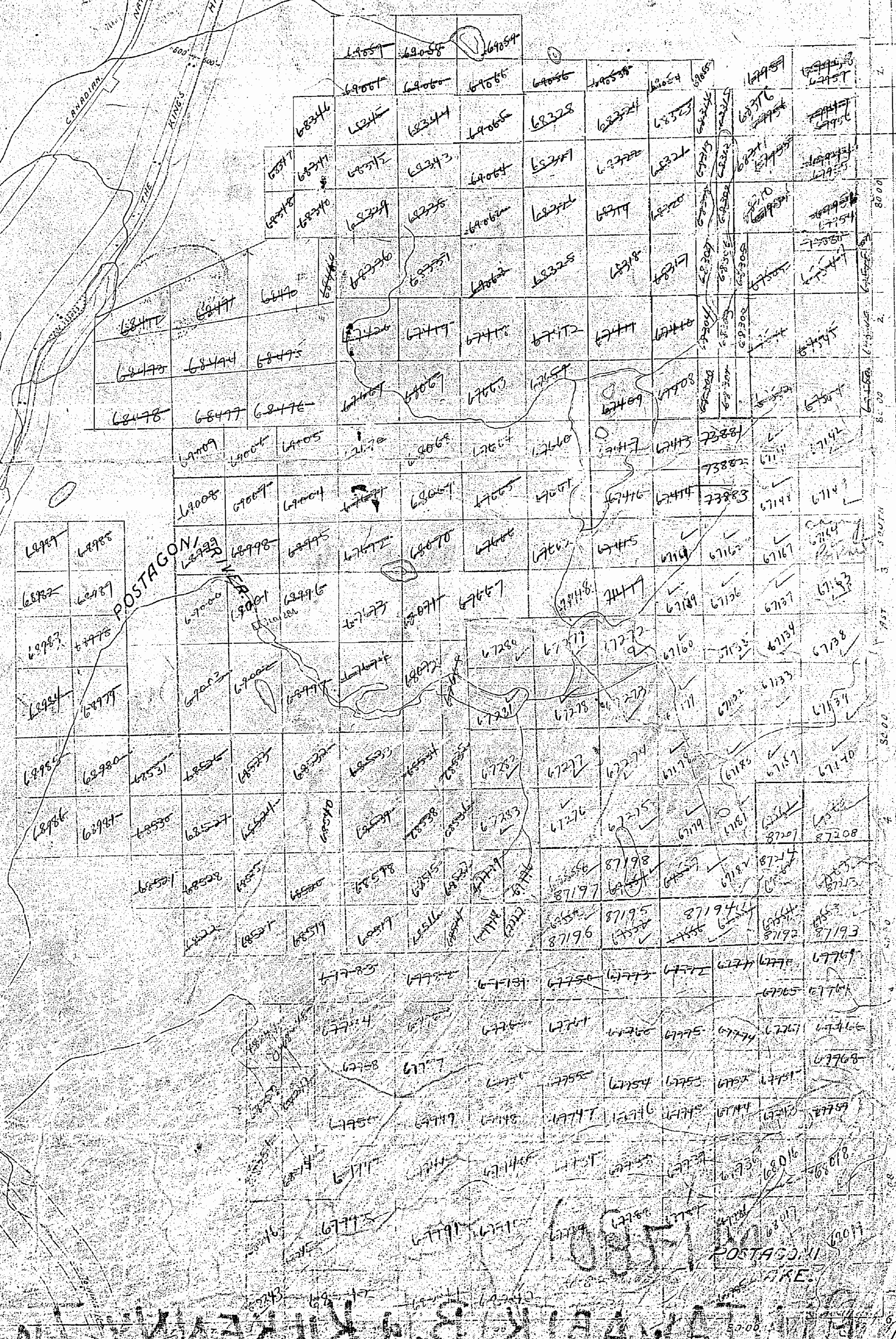

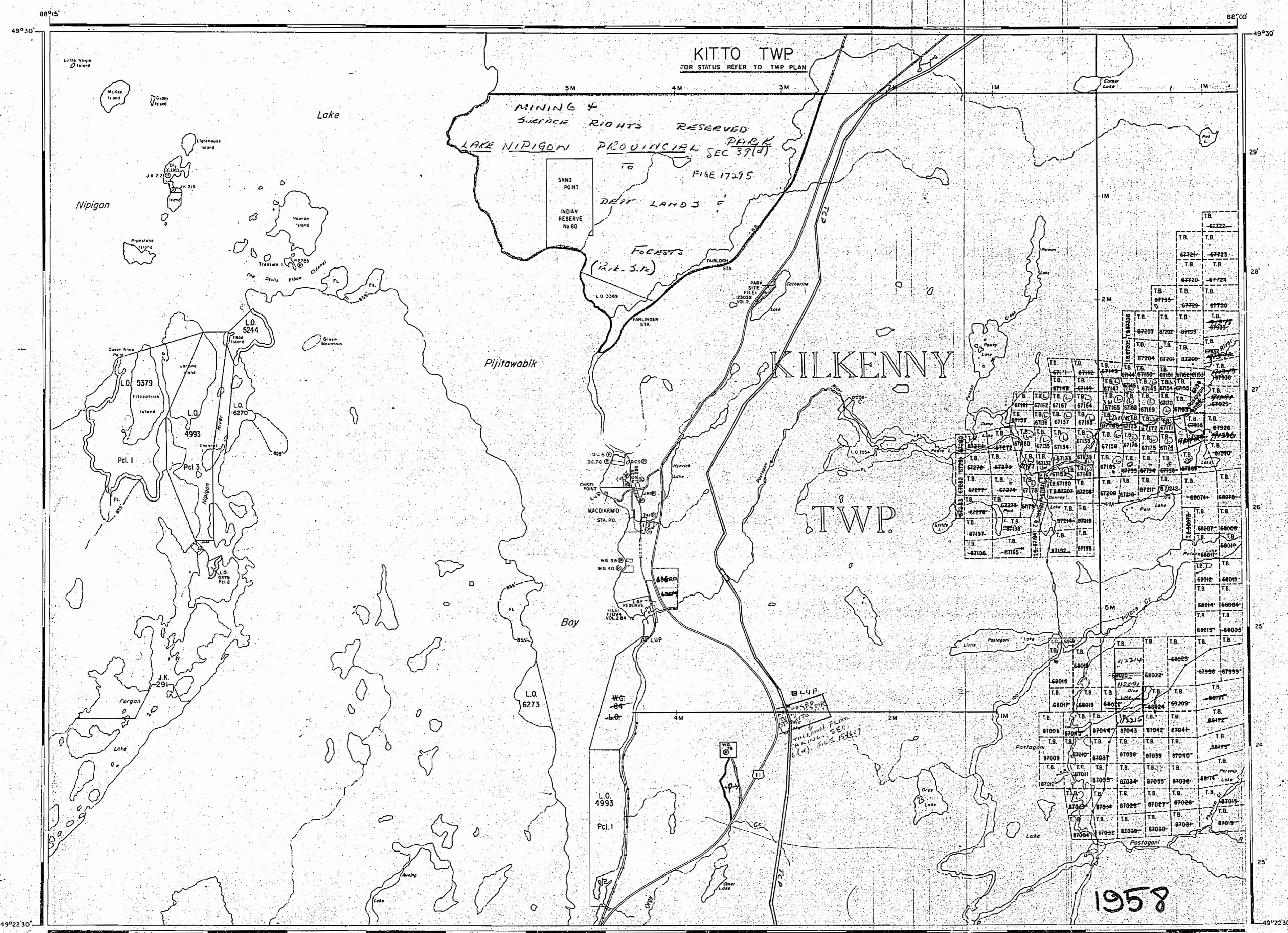

AREA OF
PIJITAWABIK BAY
 &
KILKENNY TWP.
 DISTRICT OF
 THUNDER BAY
 PORT ARTHUR
 MINING DIVISION
 SCALE: 1-INCH = 40 CHAINS

LEGEND

PATENTED LAND	⊙
CROWN LAND SALE	C.S.
LEASES	⊖
LOCATED LAND	Loc.
LICENSE OF OCCUPATION	L.O.
MINING RIGHTS ONLY	M.R.O.
SURFACE RIGHTS ONLY	S.R.O.
ROADS	—
IMPROVED ROADS	—
KING'S HIGHWAYS	—
RAILWAYS	—
POWER LINES	—
MARSH OR MUSKEG	—
MINES	⊗
CANCELLED	C.

NOTES

400' Reserve around all lakes & rivers to Dept. of Lands & Forests.

This Area Lies Within The **NIPIGON PROVINCIAL FOREST**

66' Reserve around the shore of Nipigon L. - from 855' contour - to H.E.P.C.

400' SURFACE RIGHTS RESERVATION FLOODING RIGHTS RESERVED TO DATUM 855'

66' SURFACE RESERVATION FROM DATUM 855'

LOCATION DC-58 AND FLOODING RIGHTS CANCELLED - J.R.M.G.W. FEB. 7/62



PLAN NO. **M-1780**
 DEPARTMENT OF MINES
 - ONTARIO -

56. Reservation along the shore of Nipigon Lake from 855' contour to Ont. Hydro.

AREAS WITHDRAWN FROM DISPOSITION

- S.R. - SURFACE RIGHTS M.R. - MINING RIGHTS
- ① MINING & SURFACE RIGHTS WITHDRAWN FROM STAKING ORDER W-10-03/184, NCR 84/03/14, TO PROTECT THE MINISTRY MAGDARMO SATELLITE BASE.
- ② SURFACE & MINING RIGHTS WITHDRAWN FROM STAKING ORDER W-10-03/184, NCR 84/03/14, DATED BY N.M.R. TO CONSIDER AN APPLICATION FOR A SOLID WASTE DISPOSAL SITE.
- ③ SURFACE RIGHTS ONLY WITHDRAWN FROM STAKING ORDER W-10-08/107, N.L. 87/01/3 TO PREVENT FUTURE DISPOSITION WITHIN KNOWLEDGE OF HAZARDOUS WASTE DISPOSAL SITE.
- ④ MINING & SURFACE RIGHTS WITHDRAWN FROM STAKING ORDER W-10-11/324, NCR 83/03/2, FOR ADDITIONAL LAND BASE FOR ROCKY BAY FIRST NATION AT MAGDARMO.
- ⑤ SURFACE & MINING RIGHTS WITHDRAWN WHILE THE ROCKY BAY FIRST NATION NEGOTIATE AN ADDITION TO ROCKY BAY RESERVE ORDER W-10-11/324, NCR 83/03/2.
- ⑥ SURFACE & MINING RIGHTS WITHDRAWN FROM STAKING FOR A PROPOSED ADDITION TO THE SANDPOINT BY NATION ORDER W-10-11/324, NCR 83/03/2.

LEGEND

- PATENTED LAND ● P
- CROWN LAND - SALE ○ C.S.
- LEASES ○ L
- LOCATED LAND ○ L.C.
- LICENSED LAND OCCUPATION ○ L.O.
- MINING RIGHTS ONLY ○ M.R.O.
- SURFACE RIGHTS ONLY ○ S.R.O.
- IMPROVED ROADS ———
- KING'S HIGHWAYS ———
- RAILWAYS ———
- POWER LINES ———
- MARSH OR MUSKOG ———
- MINES ———
- CANCELLED ○ C
- PATENTED ○ S.R.O.

DISPOSITION OF CROWN LANDS

- | TYPE OF DOCUMENT | SYMBOL |
|---|--------|
| PATENT SURFACE & MINING RIGHTS | ● |
| SURFACE RIGHTS ONLY | ○ |
| MINING RIGHTS ONLY | ○ |
| LEASE SURFACE & MINING RIGHTS | ■ |
| SURFACE RIGHTS ONLY | ■ |
| MINING RIGHTS ONLY | ■ |
| LICENCE OF OCCUPATION | ▽ |
| ORDER-IN-COUNCIL | OC |
| RESERVATION | ○ |
| CANCELLED | ○ |
| SAND & GRAVEL | ○ |
| LAND USE PERMITS FOR COMMERCIAL TOURISM/OUTPOST CAMPS | ○ |
- NOTE: MINING RIGHTS IN PARCELS PATENTED PRIOR TO MAY 6, 1913, VESTED IN ORIGINAL PATENTEE BY THE PUBLIC LANDS ACT, R.S.O. 1970, CHAP. 330, SEC. 63, SUBSEC. 1.

SCALE: 1 INCH = 40 CHAINS

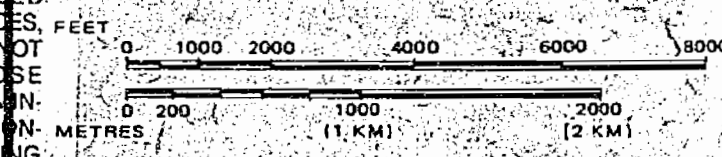

THE INFORMATION THAT APPEARS ON THIS MAP HAS BEEN COMPILED FROM VARIOUS SOURCES, AND ACCURACY IS NOT GUARANTEED. THOSE WISHING TO STAKE MINING CLAIMS SHOULD CONSULT WITH THE MINING RECORDER, MINISTRY OF NORTHERN DEVELOPMENT AND MINES, FOR ADDITIONAL INFORMATION ON THE STATUS OF THE LANDS SHOWN HEREON.

THE SURFACE RIGHTS LYING WITHIN 40.25 m. OF THE CENTER-LINE OF THE TRANS CANADA PIPELINE RIGHT-OF-WAY ARE WITHDRAWN FROM STAKING OUT, PROSPECTING, SALE OR LEASE BY ORDER W-10/19/1/ONT, DATED SEPT 20, 1991. SECTION 112 OF THE NATIONAL ENERGY ACT APPLIES TO THIS AREA.

AREA PIJITAWABIK BAY

M. N. R. ADMINISTRATIVE DISTRICT
NIPIGON
 MINING DIVISION
THUNDER BAY
 LAND TITLES/REGISTRY DIVISION
THUNDER BAY

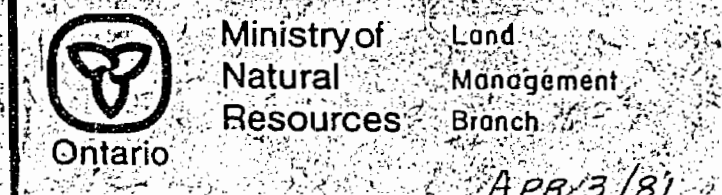

Date FEBRUARY 1981

SOUTH BAY (LAKE NIPIGON) AREA G-129

LAKE JEAN AREA G-64

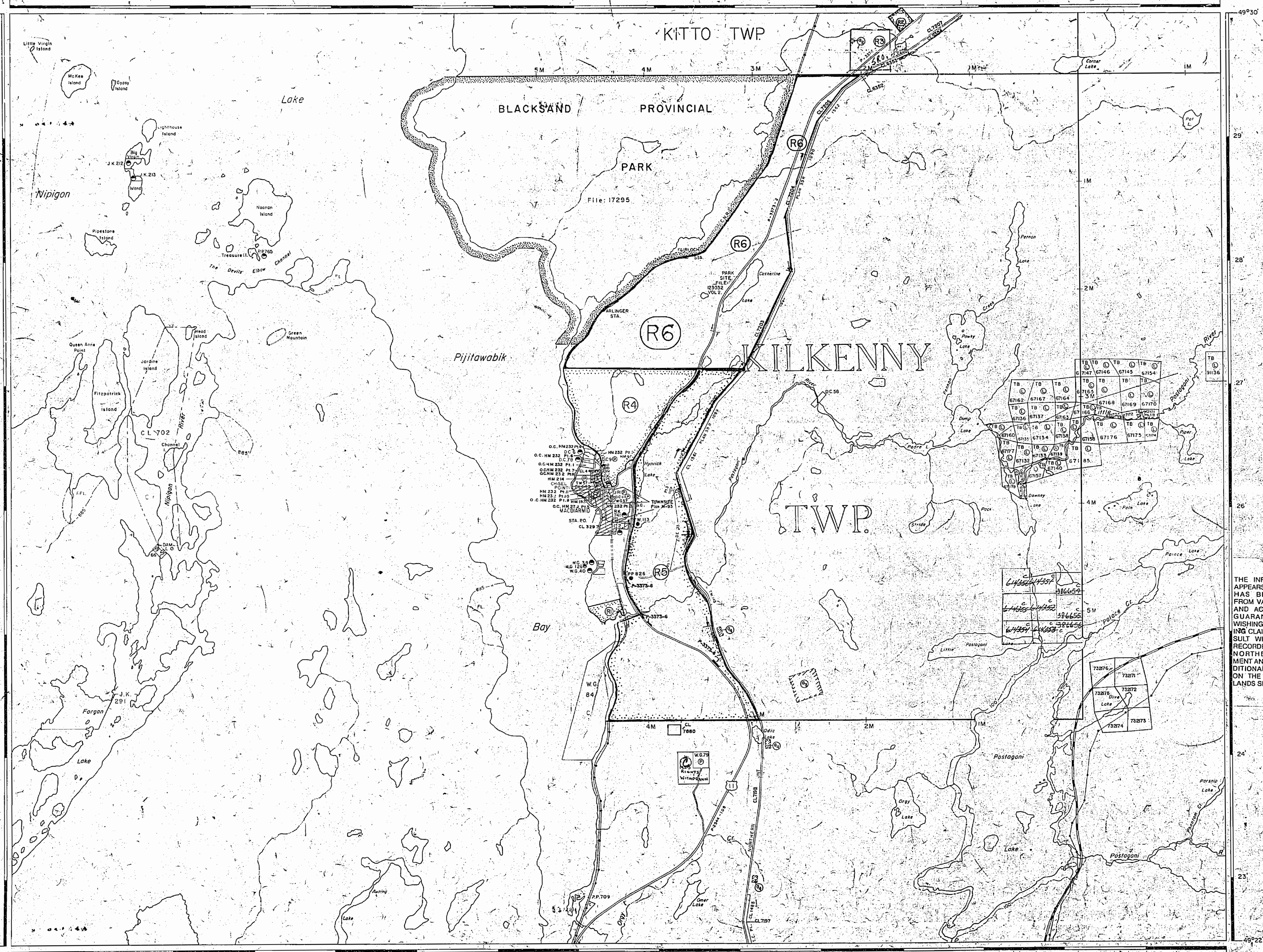

KILKENNY T.P.

NIPIGON PROVINCIAL FOREST.

DISTRICT OF THUNDER BAY.

Scale: 20 Chains = 1 Inch.

KITTO T.P.

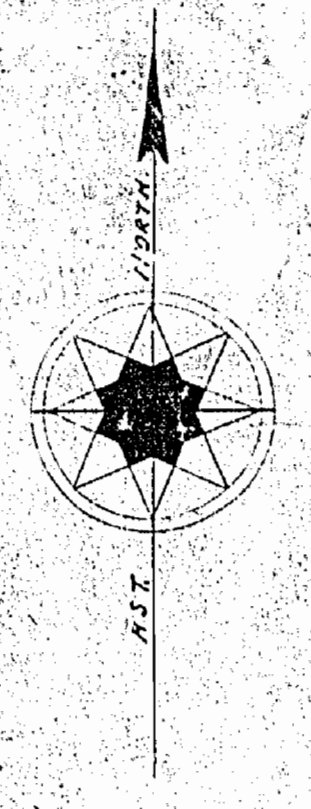

1951

IR NO 80

AREA 236 ACRES

LAKE

RESERVE FLOODING RIGHTS TO 855' CONTOUR.

NIPIGON

Note: All claims staked adjoining Lake Nipigon are subject to a reservation of the surface rights 86 ft. in perpendicular width from the present water level, approx. contour elevation 6

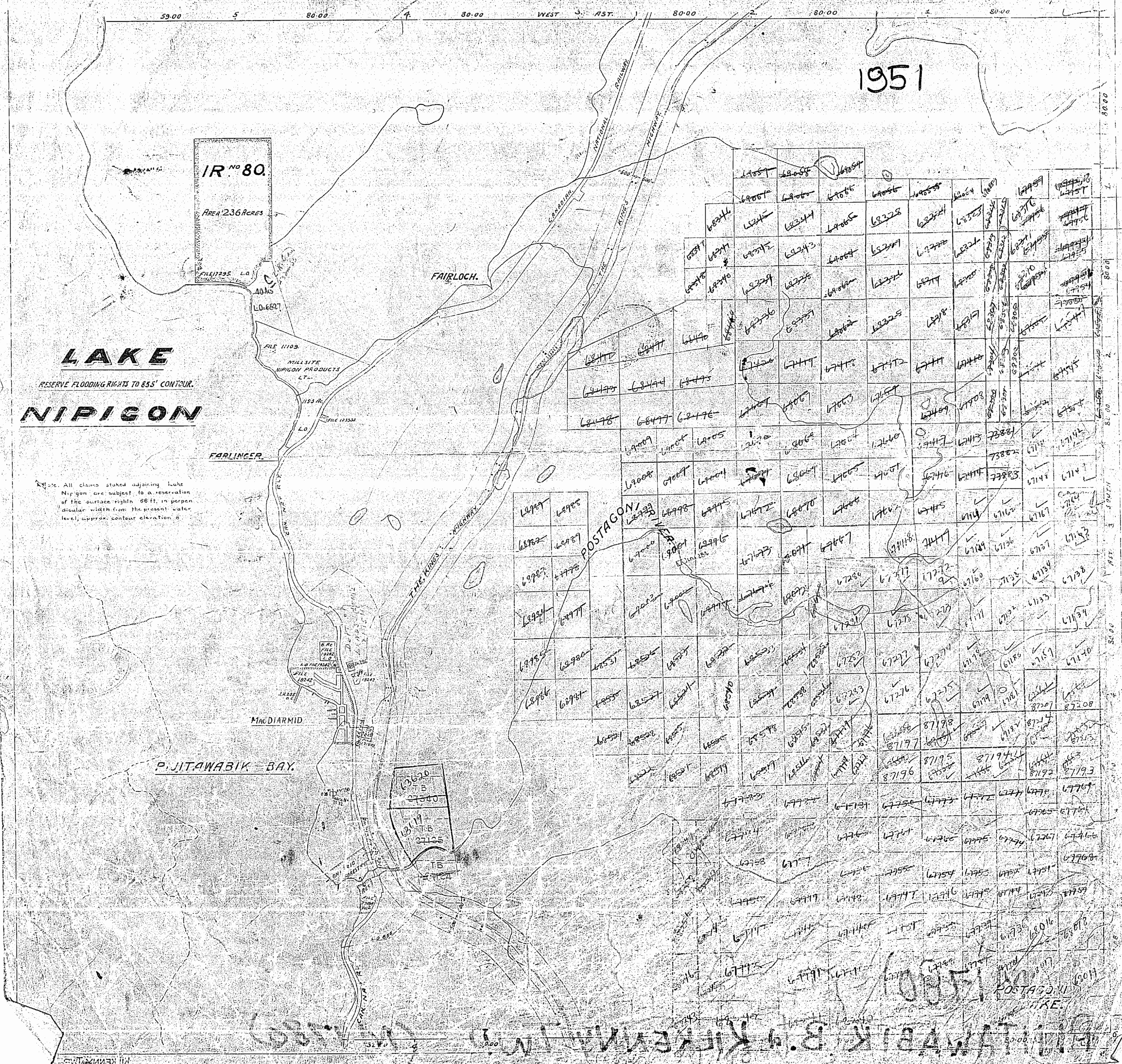

AREA OF
PIJITAWABIK BAY
 &
KILKENNY TWP
 DISTRICT OF
 THUNDER BAY
 THUNDER BAY
 MINING DIVISION

SCALE: 1-INCH = 40 CHAINS

LEGEND

PATENTED LAND	Ⓟ
CROWN LAND SALE	Ⓞ
LEASES	Ⓢ
LOCATED LAND	Ⓛ
LICENSE OF OCCUPATION	Ⓛ
MINING RIGHTS ONLY	Ⓜ
SURFACE RIGHTS ONLY	Ⓢ
ROADS	—
IMPROVED ROADS	—
KING'S HIGHWAYS	—
RAILWAYS	—
POWER LINES	—
MARSH OR MUSKEG	—
MINES	—
CANCELLED	—

NOTES

400' Reserve around all lakes & rivers to Dept. of Lands & Forests.

This Area Lies Within The
NIPIGON PROVINCIAL FOREST

66' Reserve around the shore of Nipigon L. from 855' contour to H.E.P.C.

Areas withdrawn from staking under Section 43 of the Mining Act, R.S.O. 1970:

File	Date	Disposition
177203		S.R.O.

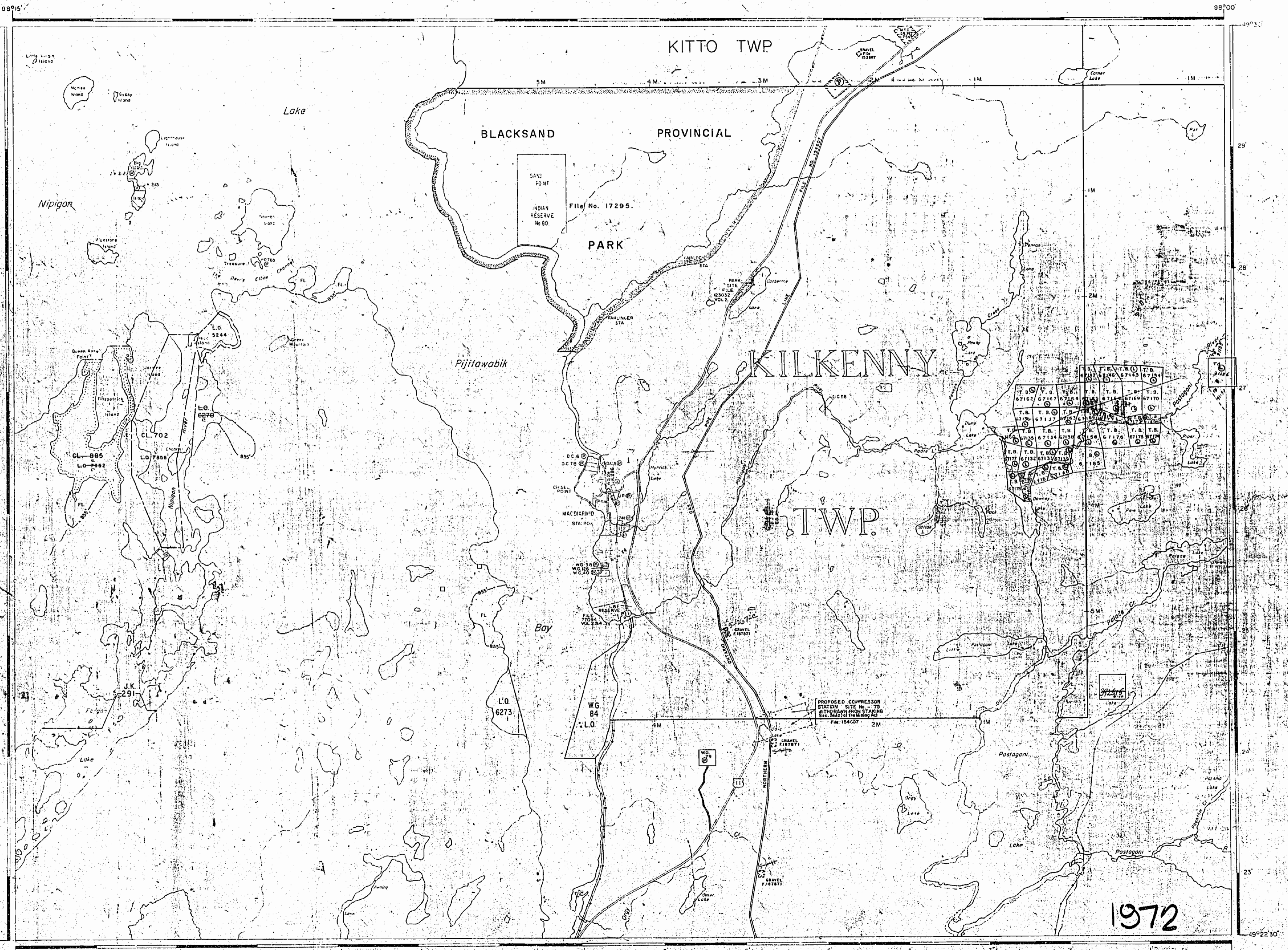

South Bay (Lake Nipigon) - M.3044

NIP
 NATIONAL TOPOGRAPHIC SERIES 52H8
 PLAN NO. **M-1780**

ONTARIO
 DEPARTMENT OF MINES
 AND NORTHERN AFFAIRS

1780

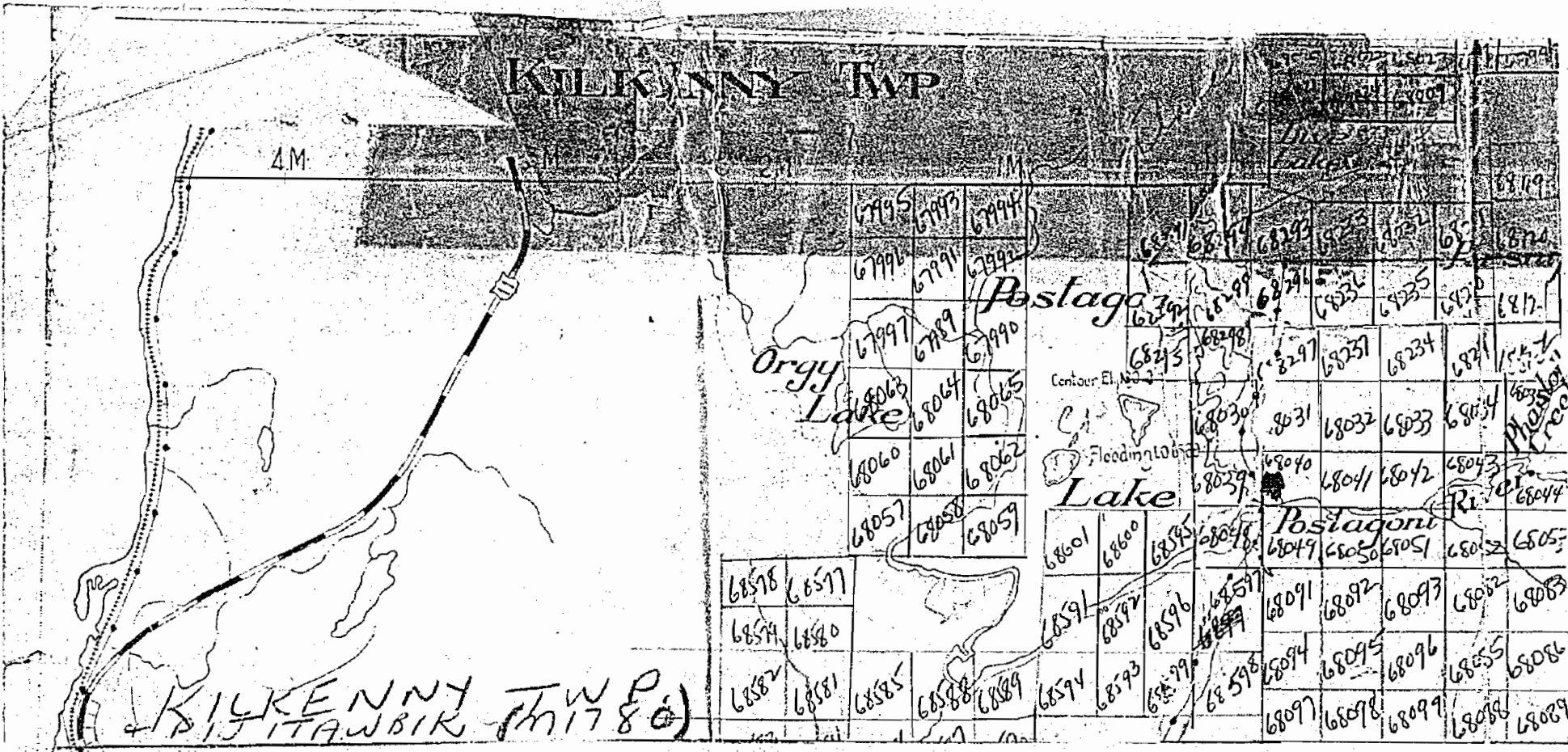

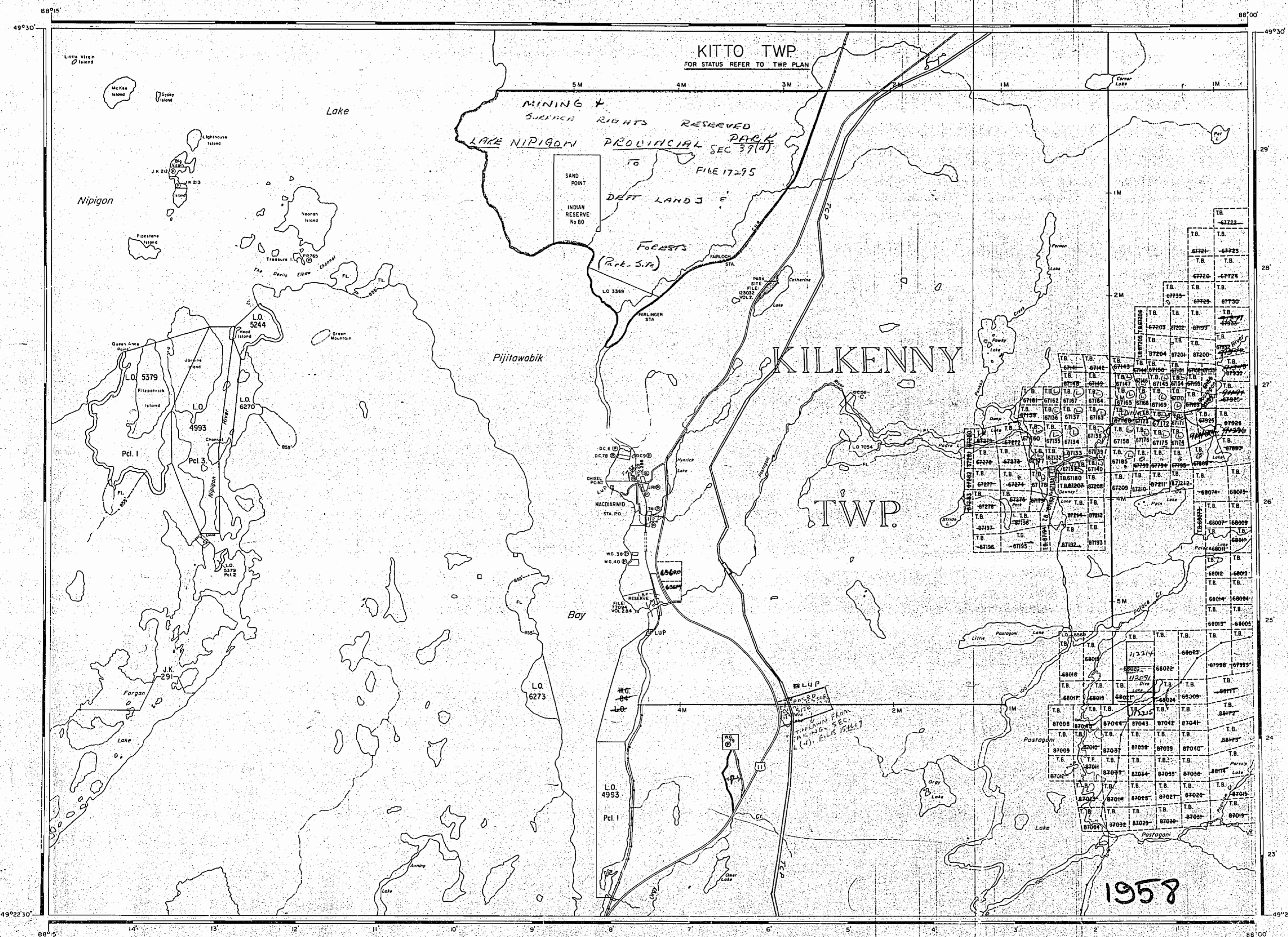

AREA OF
PIJITAWABIK BAY
 &
KILKENNY TWP.
 DISTRICT OF
 THUNDER BAY
 PORT ARTHUR
 MINING DIVISION
 SCALE: 1-INCH = 40 CHAINS

LEGEND

PATENTED LAND	Ⓟ
CROWN LAND SALE	C.S.
LEASES	Ⓛ
LOCATED LAND	Loc.
LICENSE OF OCCUPATION	L.O.
MINING RIGHTS ONLY	M.R.O.
SURFACE RIGHTS ONLY	S.R.O.
ROADS	—
IMPROVED ROADS	—
KING'S HIGHWAYS	—
RAILWAYS	—
POWER LINES	—
MARSH OR MUSKEG	—
MINES	Ⓜ
CANCELLED	C.

NOTES

400' Reserve around all lakes & rivers to Dept. of Lands & Forests.

This Area Lies Within The NIPIGON PROVINCIAL FOREST

66' Reserve around the shore of Nipigon L. - from 855' contour - to H.E.P.C.

400' SURFACE RIGHTS RESERVATION FLOODING RIGHTS REVOKED TO DRTUMESS.

66' SURFACE REKVATION FROM DRTUM 855'.

LOCATION DC-58 AND FLOODING RIGHTS CANCELLED. J.R.M.G.M. FEB. 9/62



1958

PLAN NO. M-1780

DEPARTMENT OF MINES
 - ONTARIO -

KILKENNY TWP & PIJITAWABIK BAY

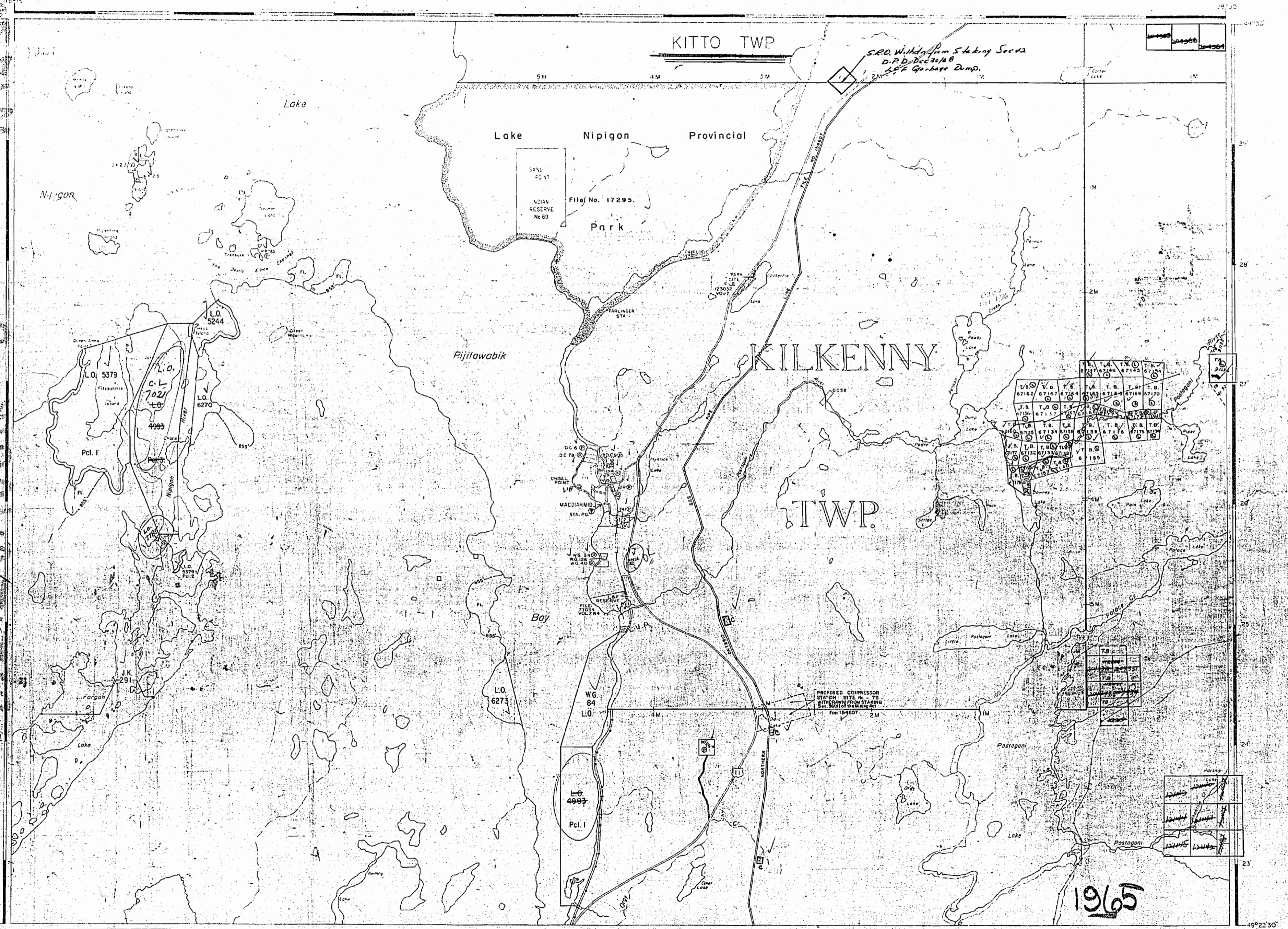

AREA OF
PIJITAWABIK BAY
 &
KILKENNY TWP
 DISTRICT OF
 THUNDER BAY
 PORT ARTHUR
 MINING DIVISION
 SCALE: 1-INCH = 40 CHAINS

LEGEND

PATENTED LAND	⊙
CROWN LAND SALE	C.S.
LEASES	⊖
LOCATED LAND	LOC.
LICENSE OF OCCUPATION	L.O.
MINING RIGHTS ONLY	M.R.O.
SURFACE RIGHTS ONLY	S.R.O.
ROADS	—
IMPROVED ROADS	—
KING'S HIGHWAYS	—
RAILWAYS	—
POWER LINES	—
MARSH OR MUSKOG	—
MINES	—
CANCELLED	—

NOTES

400' Reserve around all lakes & rivers to Dept. of Lands & Forests.

This Area Lies Within The
NIPIGON PROVINCIAL FOREST

66' Reserve around the shore of Nipigon L. from 855' contour - to H.E.R.C.

See L. Res. 42301 Jan 7 - cancelled Dec 7 1965

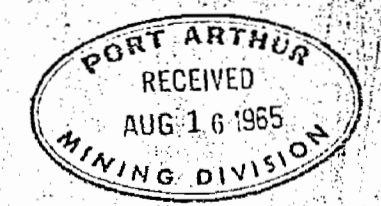

PLAN NO. **M-1780**

DEPARTMENT OF MINES
 - ONTARIO -

1965

Kitto Twp.

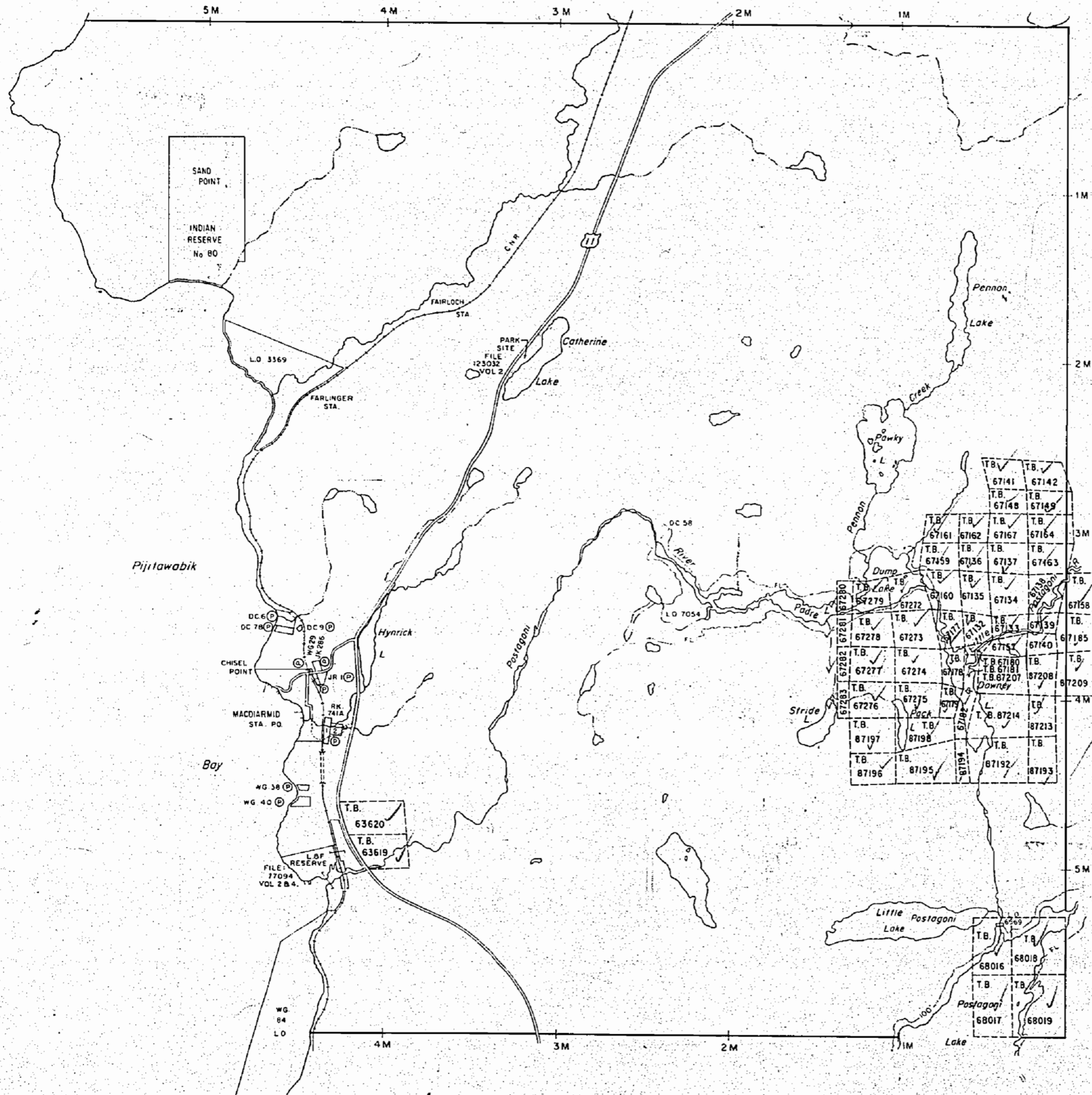

THE TOWNSHIP OF KILKENNY

DISTRICT OF
THUNDER BAY

PORT ARTHUR
MINING DIVISION

SCALE: 1-INCH=40 CHAINS

LEGEND

PATENTED LAND	Ⓟ
CROWN LAND SALE	C.S.
LEASES	Ⓞ
LOCATED LAND	Loc.
LICENSE OF OCCUPATION	L.O.
MINING RIGHTS ONLY	M.R.O.
SURFACE RIGHTS ONLY	S.R.O.
ROADS	—
IMPROVED ROADS	—
KING'S HIGHWAYS	—
RAILWAYS	—
POWER LINES	—
MARSH OR MUSKEG	—
MINES	ⓧ
CANCELLED	C.

NOTES

400' Reserve around all lakes & rivers to Dept. of Lands & Forests.

This Twp. Lies Within The
NIPIGON PROVINCIAL FOREST



PLAN NO.-M-1780

DEPARTMENT OF MINES

— ONTARIO —

1780

Corner Lake

Pol L

M-1780

KILKENNY

2M

3M

4M

5M

87200 87203 87202 87129
87205 87204 87201 87200

87209 87210 87211 87212

68075
Pain Lake
68007 68008

68011 68010
Palace L
68012 68013 68002

68014 68004 68001

68015 68005 68000

68017 68022 68023 67998 67999 68006

Dive Lake

Pipe Lake

67122 67121

67121 67123 67120

67120 67124 67119

67135 67129 67130 67128

67143 67144 67150 67151 67152 67153

67147 67146 67145 67154 67155 67156

67165 67168 67169 67170 67183 67184

67166 67173 67172 67171 67174 67175

67158 67176 67175 67174 67173 67172

67925

67889

68007 68008

68011 68010

68012 68013 68002

68014 68004 68001

68015 68005 68000

68017 68022 68023 67998 67999 68006

1780

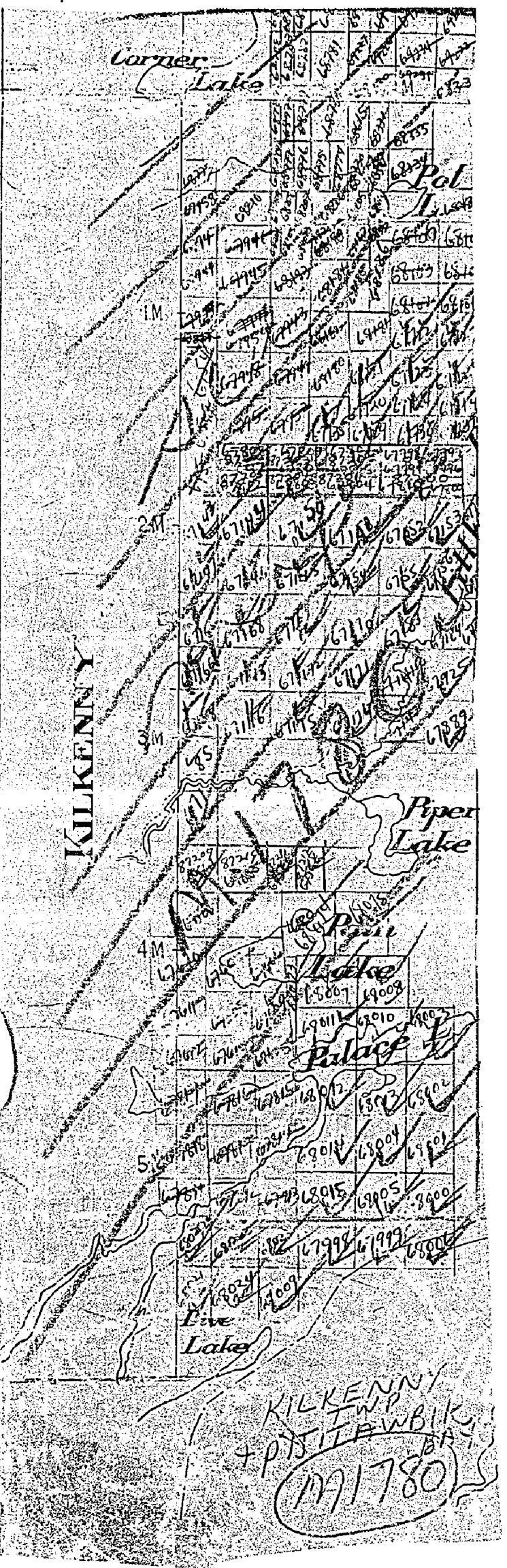

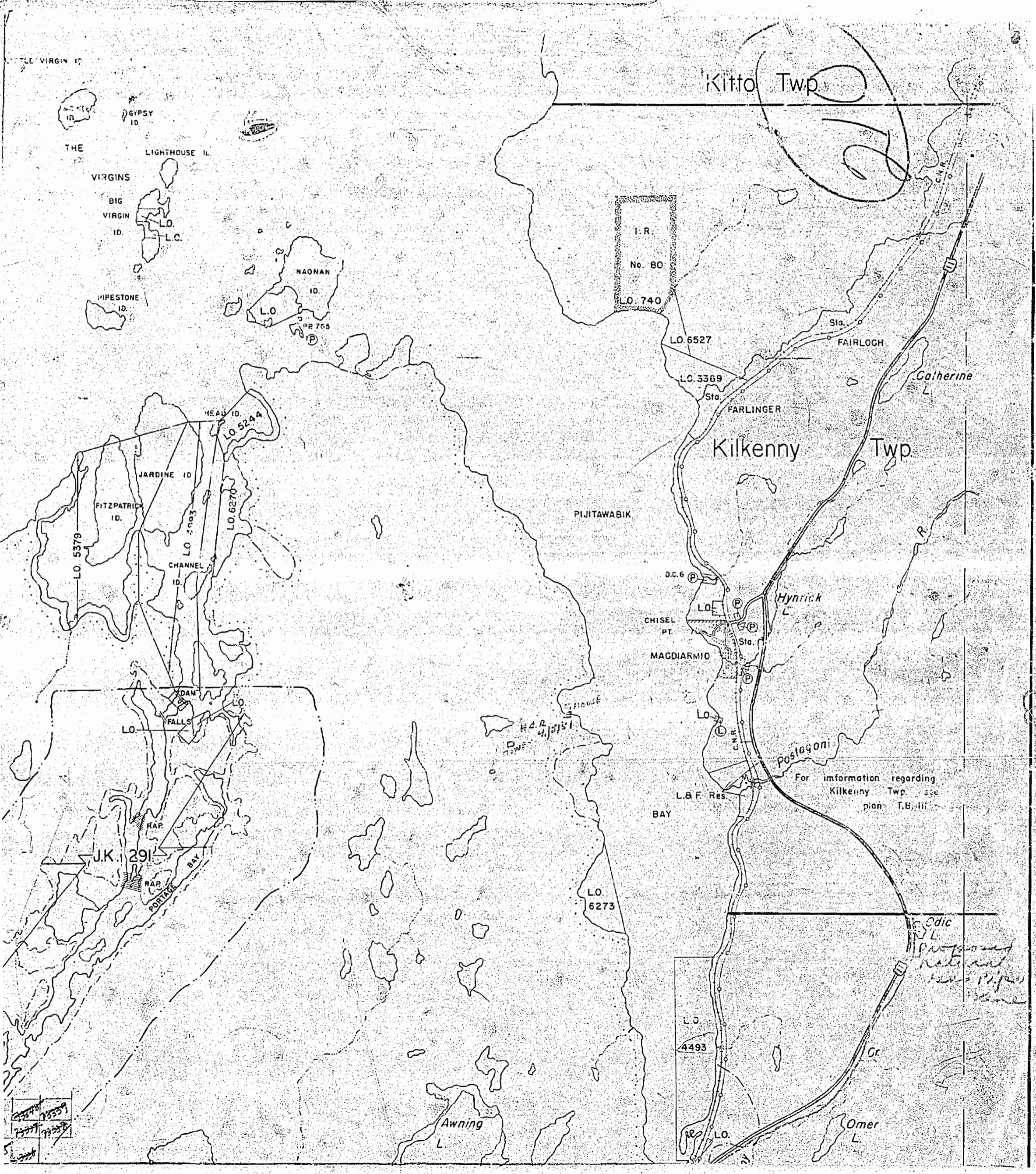

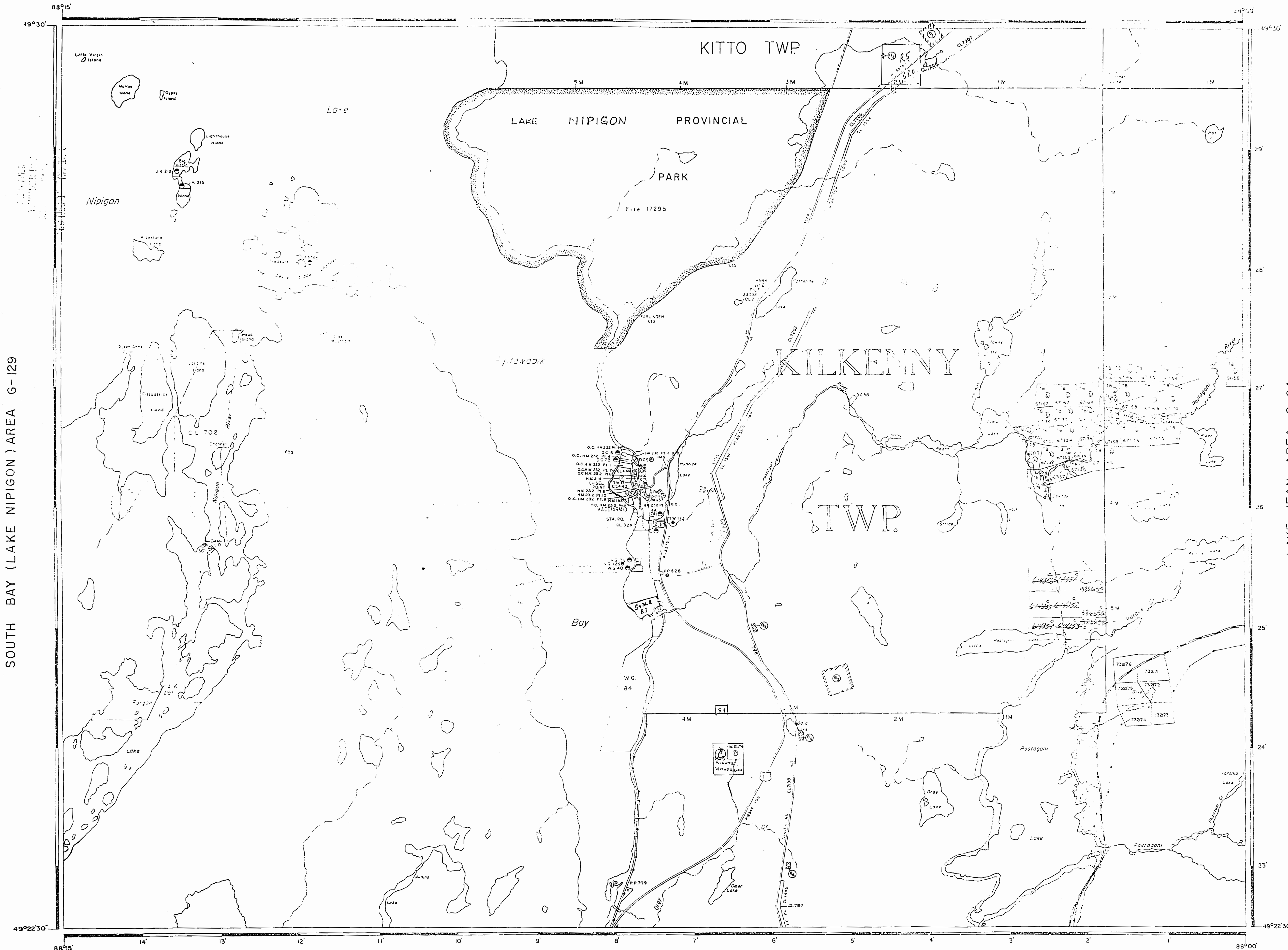

SOUTH BAY (LAKE NIPIGON) AREA G-129

LAKE JEAN AREA G-64

56' reservation along the shore of Nipigon Lake from 1955 contour to Ont. Hydro

AREAS WITHDRAWN FROM DISPOSITION

Description	Order No.	Date	Disposition	File
SECT 43 (1860) TO 1955 OPENED ON CR. 18720				217750
M.N.R. RESERVE				77034 VOL 284
R3 S.M.R. WITHDRAWN W/CR 1114				
R4 S.M.R. WITHDRAWN W/CR 13737				
SAND & GRAVEL				
NYC PIT 754				
GRAVEL FILE 153687				
MTC PIT No. 20-14 FILE 187871				
GRAVEL FILE 187871				
R5 - S.M.R. WITHDRAWN 9, 17 - See Register of Mining				

LEGEND

PATENTED LAND	⊕
CROWN LAND SALE	C.S.
LEASES	L.
LOCATED LAND	L.O.
LICENSE OF OCCUPATION	L.O.
MINING RIGHTS ONLY	M.R.O.
SURFACE RIGHTS ONLY	S.R.O.
ROADS	—
IMPROVED ROADS	—
KING'S HIGHWAYS	—
RAILWAYS	—
POWER LINES	—
MARSH OR MUSKEG	—
MINES	—
CANCELLED PATENTED S.R.O.	⊖
Cancelled Order of Sale	⊖

DISPOSITION OF CROWN LANDS

TYPE OF DOCUMENT	SYMBOL
PATENT, SURFACE & MINING RIGHTS	⊕
SURFACE RIGHTS ONLY	⊖
MINING RIGHTS ONLY	⊙
LEASE SURFACE & MINING RIGHTS	⊞
SURFACE RIGHTS ONLY	⊞
MINING RIGHTS ONLY	⊞
LICENSE OF OCCUPATION	⊞
ORDER-IN-COUNCIL	OC
RESERVATION	⊖
CANCELLED	⊖
SAND & GRAVEL	⊖

NOTE: MINING RIGHTS IN PARCELS PATENTED PRIOR TO MAY 6 1912, VESTED IN ORIGINAL PATENTEE BY THE PUBLIC LANDS ACT, R.S.O. 1970, CHAP. 380, SEC. 63, SUBSEC. 1

SCALE: 1 INCH = 40 CHAINS

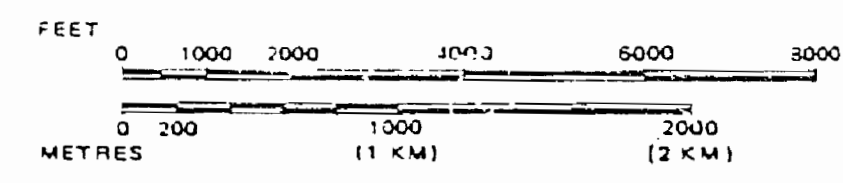

4 per Revised

AREA PIJITAWABIK BAY

M.N.R. ADMINISTRATIVE DISTRICT
NIPIGON
 MINING DIVISION
THUNDER BAY
 LAND TITLES/REGISTRY DIVISION
THUNDER BAY

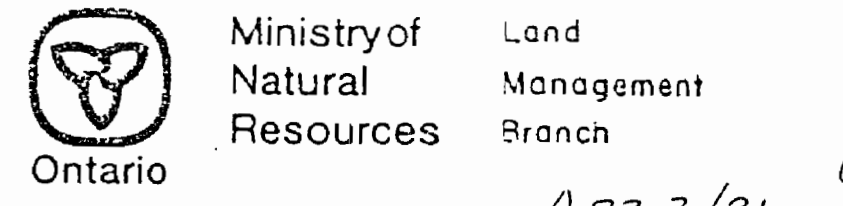

Date FEBRUARY 1981 Number APR 3/81

Kitto Twp.

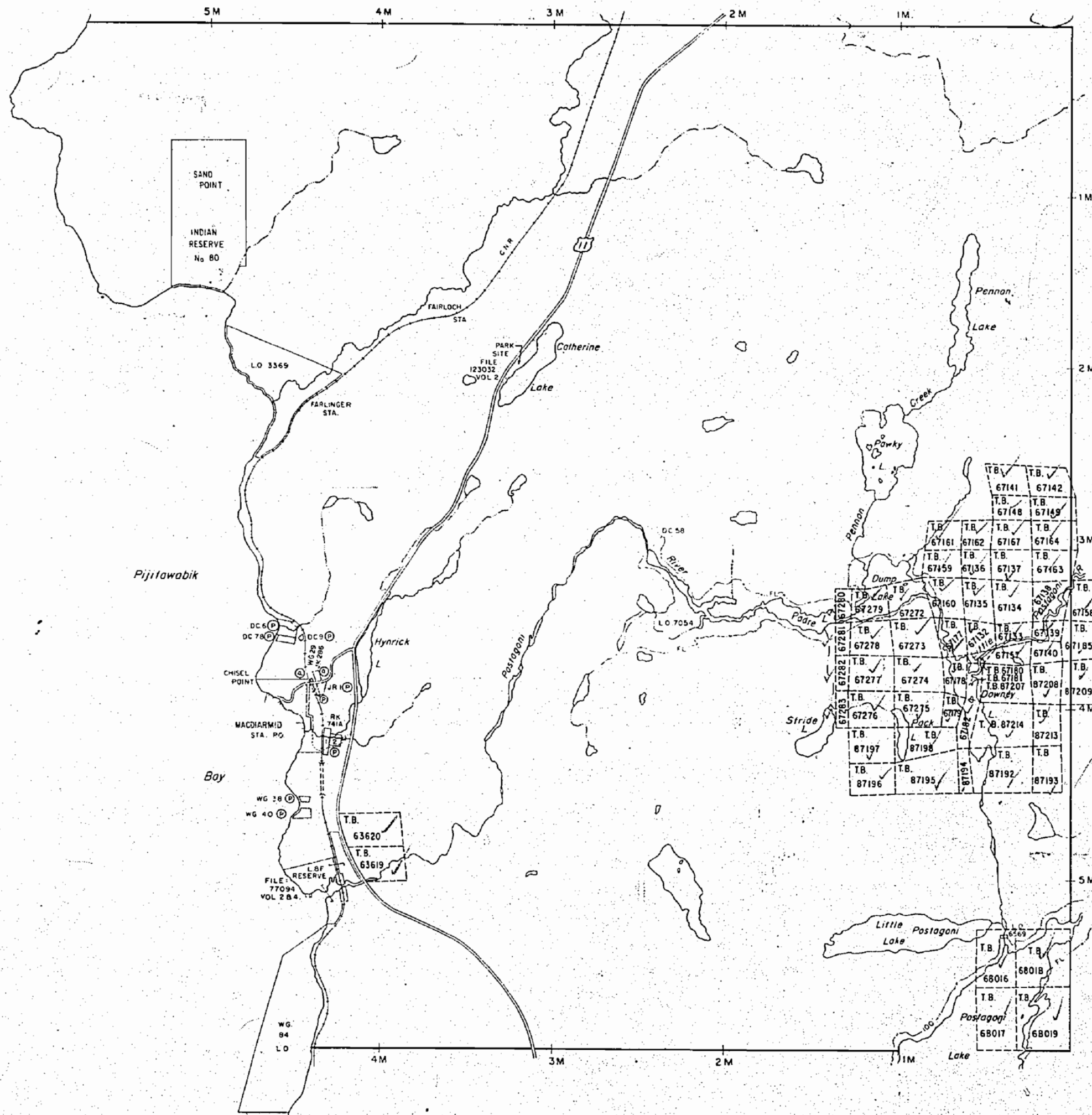

THE TOWNSHIP OF
OF

KILKENNY

DISTRICT OF
THUNDER BAY

PORT ARTHUR
MINING DIVISION

SCALE: 1-INCH=40 CHAINS

LEGEND

PATENTED LAND	Ⓟ
CROWN LAND SALE	C.S.
LEASES	Ⓛ
LOCATED LAND	Loc.
LICENSE OF OCCUPATION	L.O.
MINING RIGHTS ONLY	M.R.O.
SURFACE RIGHTS ONLY	S.R.O.
ROADS	—
IMPROVED ROADS	—
KING'S HIGHWAYS	—
RAILWAYS	—
POWER LINES	—
MARSH OR MUSKEG	—
MINES	Ⓧ
CANCELLED	C.

NOTES

400' Reserve around all lakes & rivers to
Dept. of Lands & Forests.

This Twp. Lies Within The
NIPIGON PROVINCIAL FOREST



PLAN NO. M-1780

DEPARTMENT OF MINES

— ONTARIO —

1780

Corner Lake

Pol A

M-1780

KILKENNY

2M

67143	67144	67150	67151	67152	67153
67147	67146	67145	67154	67155	67156
67165	67168	67169	67170	67183	67184
67166	67173	67172	67171		67925
67158	67176	67175	67174		67889

3M

67209	67210	67211	67212
-------	-------	-------	-------

4M

68004	68005				
68007	68008				
68011	68010				
68012	68013	68002			
68014	68004	68001			
68015	68005	68000			
68020	68022	68023	67998	67999	68006

5M

Dive Lake

Pain Lake

Palace Lake

Pipe Lake

1780

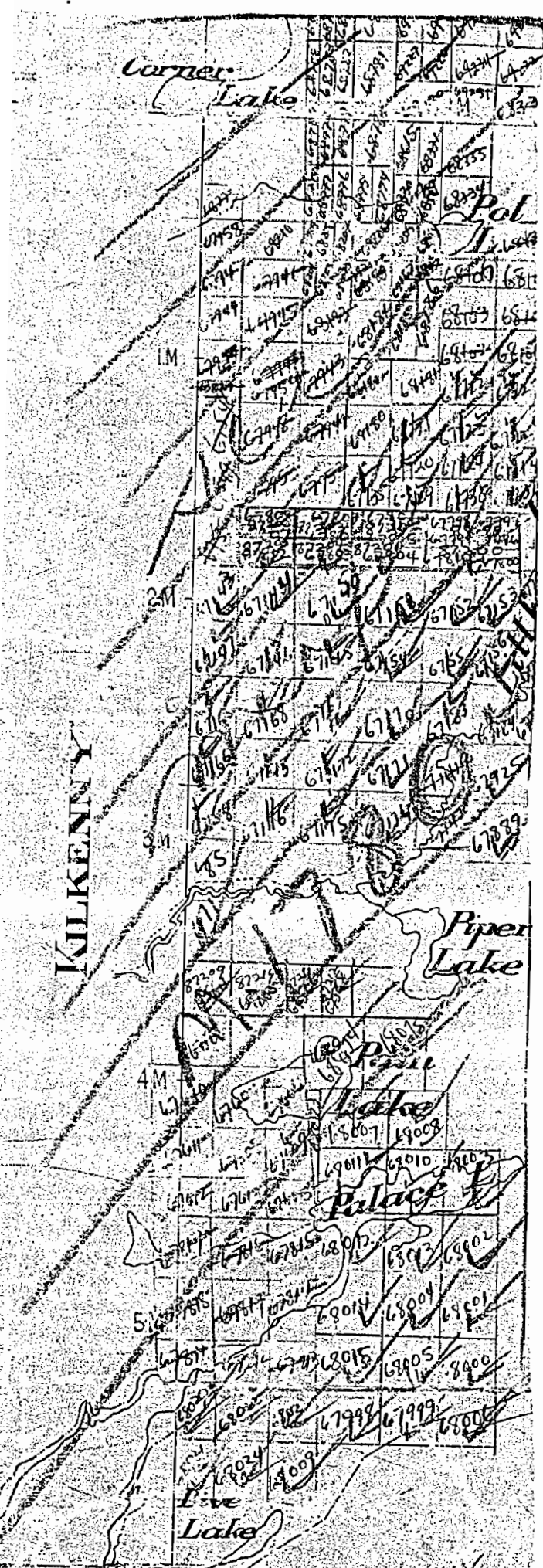

KILKENNY

KILKENNY
 TWP
 + PISTAWBIK
 (1780)

MARYJANE LAKE AREA G-80

NOTES
66' reservation along the shore of Nipigon Lake from 855 contour to Ont. Hydro.

AREAS WITHDRAWN FROM DISPOSITION

- S.R. - SURFACE RIGHTS M.R. - MINING RIGHTS
- | Description | Order No. | Date | Disposition | File |
|--|-----------|------|-------------|------|
| MINING & SURFACE RIGHTS WITHDRAWN FROM STAKING ORDER W-TB-01/84, MCR 84/03/84, TO PROTECT THE MINISTRY MACDONALD SATELLITE BASE | | | | |
| SURFACE & MINING RIGHTS WITHDRAWN FROM STAKING ORDER W-TB-02/84, MCR 84/03/84, TO PROTECT THE MINISTRY MACDONALD SATELLITE BASE | | | | |
| SURFACE & MINING RIGHTS WITHDRAWN FROM STAKING ORDER W-TB-08/87, MCR 87/01/87, TO PREVENT FUTURE DISPOSITION WITHOUT KNOWLEDGE OF HAZARDOUS WASTE DISPOSAL SITES | | | | |
| MINING & SURFACE RIGHTS WITHDRAWN FROM STAKING ORDER W-TB-14/83/MNR 83/03/82, FOR ADDITIONAL LAND BASE FOR ROCKY BAY FIRST NATION AT MACDONALD | | | | |
| SURFACE & MINING RIGHTS WITHDRAWN WHILE THE ROCKY BAY FIRST NATION NEGOTIATE AN ADDITION TO ROCKY BAY RESERVE ORDER W-TB-3/80 85/06/80 MNR | | | | |
| SURFACE & MINING RIGHTS WITHDRAWN FROM STAKING FOR A PROPOSED ADDITION TO THE SANDPOINT FIRST NATION ORDER W-TB-63/85 MNR, 85/06/85 | | | | |

LEGEND

- | | |
|-----------------------|----------|
| PATENTED LAND | ⊙ or ⊕ |
| CROWN LAND SALE | ⊙ C.S. |
| LEASES | ⊙ Loc. |
| LOCATED LAND | ⊙ L.O. |
| LICENSE OF OCCUPATION | ⊙ M.R.O. |
| MINING RIGHTS ONLY | ⊙ S.R.O. |
| SURFACE RIGHTS ONLY | ⊙ |
| ROADS | — |
| IMPROVED ROADS | — |
| KING'S HIGHWAYS | — |
| RAILWAYS | — |
| POWER LINES | — |
| MARSH OR MUSKEG | — |
| MINES | — |
| CANCELLED | ⊙ |
| PATENTED | ⊙ S.R.O. |

DISPOSITION OF CROWN LANDS

- | TYPE OF DOCUMENT | SYMBOL |
|---|--------|
| PATENT, SURFACE & MINING RIGHTS | ⊙ |
| SURFACE RIGHTS ONLY | ⊙ |
| MINING RIGHTS ONLY | ⊙ |
| LEASE, SURFACE & MINING RIGHTS | ⊙ |
| SURFACE RIGHTS ONLY | ⊙ |
| MINING RIGHTS ONLY | ⊙ |
| LICENCE OF OCCUPATION | ⊙ |
| ORDER-IN-COUNCIL | ⊙ |
| RESERVATION | ⊙ |
| CANCELLED | ⊙ |
| SAND & GRAVEL | ⊙ |
| LAND USE PERMITS FOR COMMERCIAL TOURISM/OUTPOST CAMPS | ⊙ |
- NOTE: MINING RIGHTS IN PARCELS PATENTED PRIOR TO MAY 6, 1913, VESTED IN ORIGINAL PATENTEE BY THE PUBLIC LANDS ACT, R.S.O. 1970, CHAP. 380, SEC. 63, SUBSEC. 1.

SCALE 1 INCH = 40 CHAINS

FEET 0 1000 2000 4000 6000 8000

METRES 0 200 1000 2000 (2 KM)

THE SURFACE RIGHTS LYING WITHIN 40.25 m. OF THE CENTER LINE OF THE TRANS CANADA PIPELINE RIGHT-OF-WAY ARE WITHDRAWN FROM STAKING ON THE STATUS OF THE LANDS SHOWN HEREON DATED SEPT. 20, 1991. SECTION 112 OF THE NATIONAL ENERGY ACT APPLIES TO THIS AREA.

AREA PIJITAWABIK BAY

M. N. R. ADMINISTRATIVE DISTRICT
NIPIGON
MINING DIVISION
THUNDER BAY
LAND TITLES/REGISTRY DIVISION
THUNDER BAY

Ministry of Land Management
Natural Resources Branch
Ontario

Date FEBRUARY 1981
Number
APR 3/81
G-111

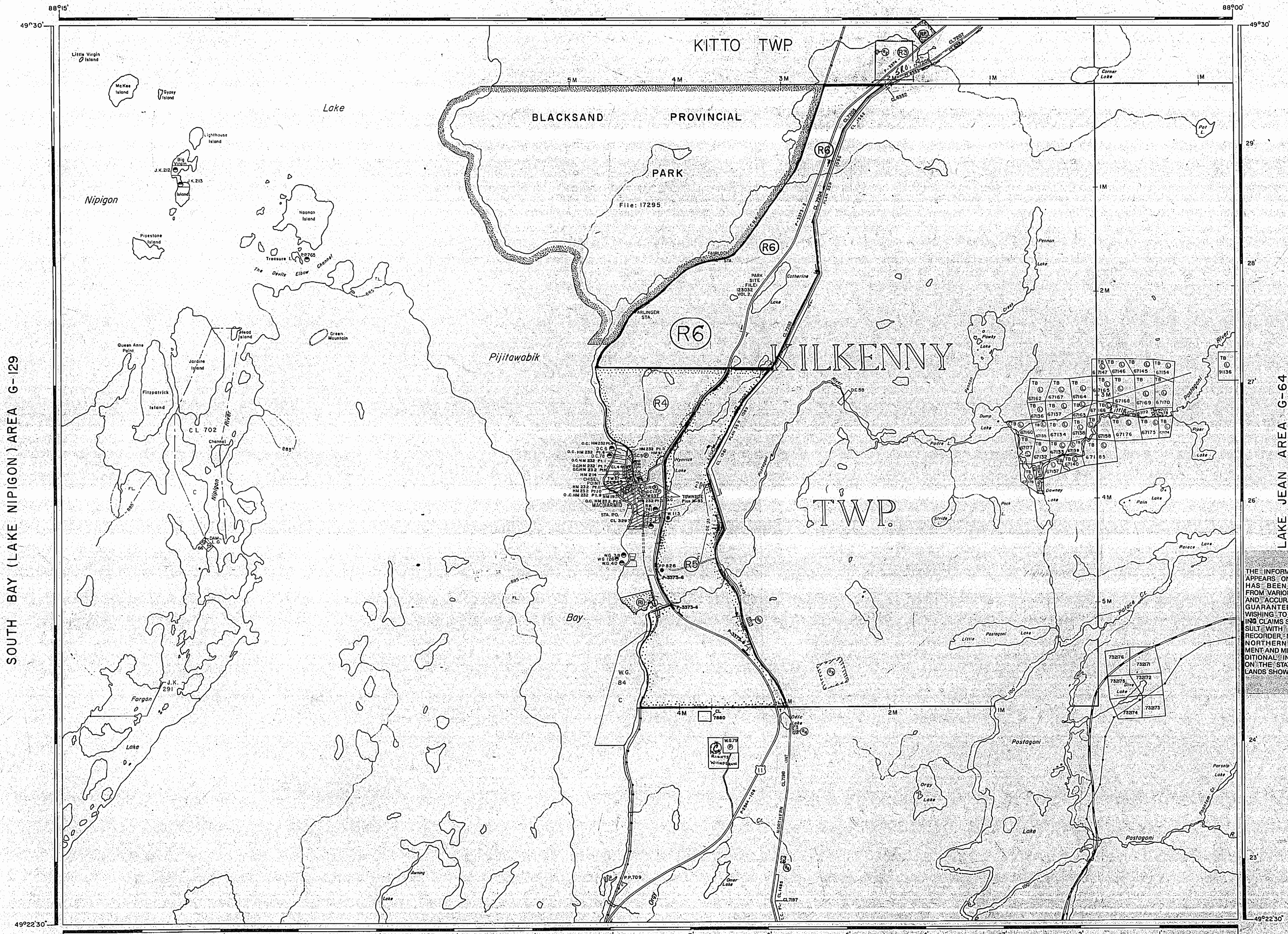

SOUTH BAY (LAKE NIPIGON) AREA G-129

LAKE JEAN AREA G-64

KEEMLE LAKE AREA G-63

KILKENNY TWP & PIJITAWABIK BAY

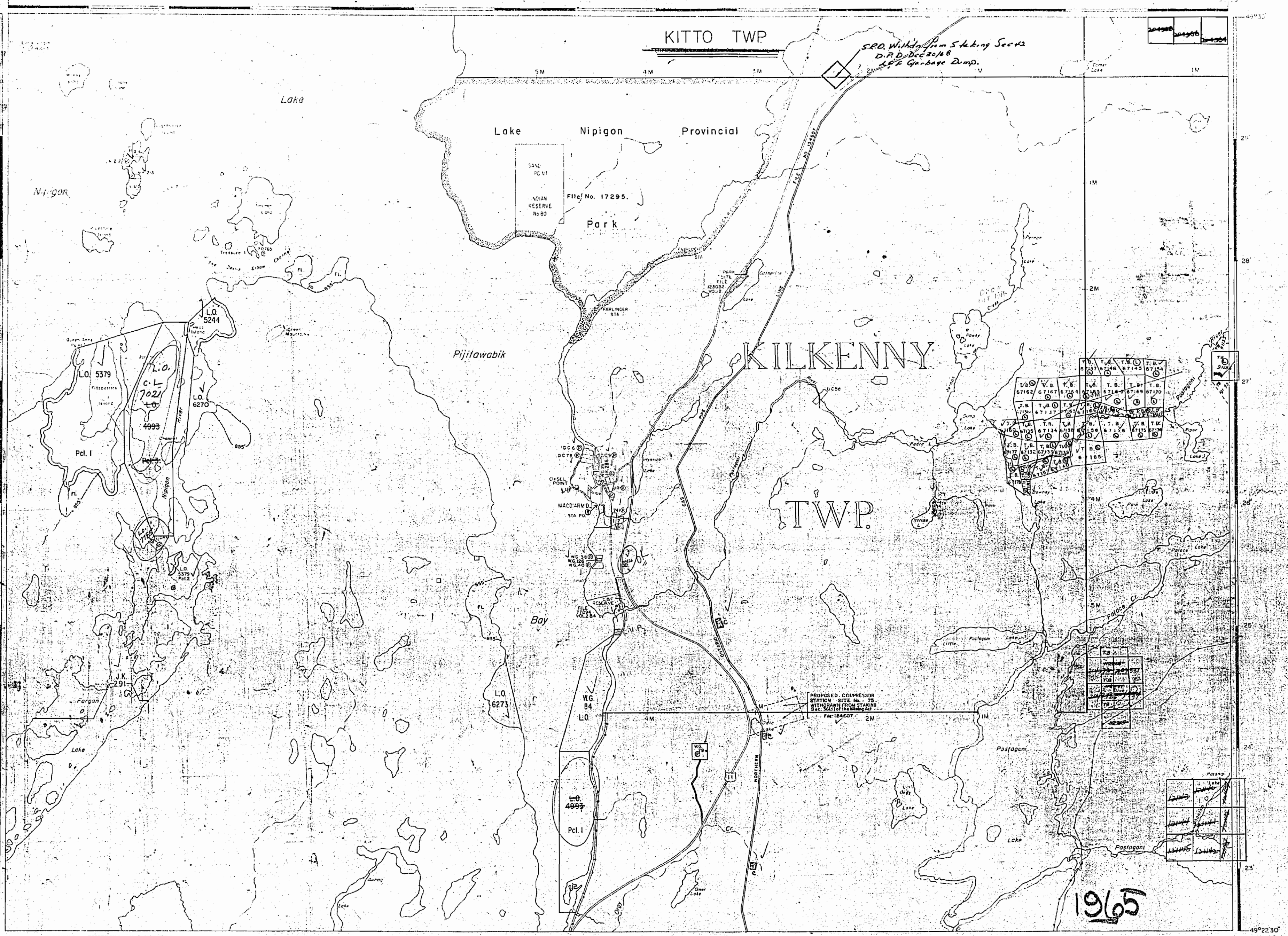

AREA OF
PIJITAWABIK BAY
 &
KILKENNY TWP
 DISTRICT OF
 THUNDER BAY
 PORT ARTHUR
 MINING DIVISION
 SCALE: 1-INCH = 40 CHAINS

LEGEND

PATENTED LAND	(P)
CROWN LAND SALE	C.S.
LEASES	(L)
LOCATED LAND	Loc
LICENSE OF OCCUPATION	L.O.
MINING RIGHTS ONLY	M.R.O.
SURFACE RIGHTS ONLY	S.R.O.
ROADS	(R)
IMPROVED ROADS	(R)
KING'S HIGHWAYS	(K)
RAILWAYS	(R)
POWER LINES	(P)
MARSH OR MUSKEG	(M)
MINES	(M)
CANCELLED	(C)

NOTES
 400' Reserve around all lakes & rivers to Dept. of Lands & Forests.
 This Area Lies Within The NIPIGON PROVINCIAL FOREST
 66' Reserve around the shore of Nipigon L. from 855' contour to H.E.P.C.

*See L. Res. H-301 Jan 7
 cancel Dec. 11, 1965*



PLAN NO. **M-1780**
 DEPARTMENT OF MINES
 - ONTARIO -