

# TOWNSHIP OF PROCTOR.

SUBBURY MINING DIVISION.

DISTRICT OF ALGOMA.

Scale, 40 chains to an inch.

TWP 143. M. 1064

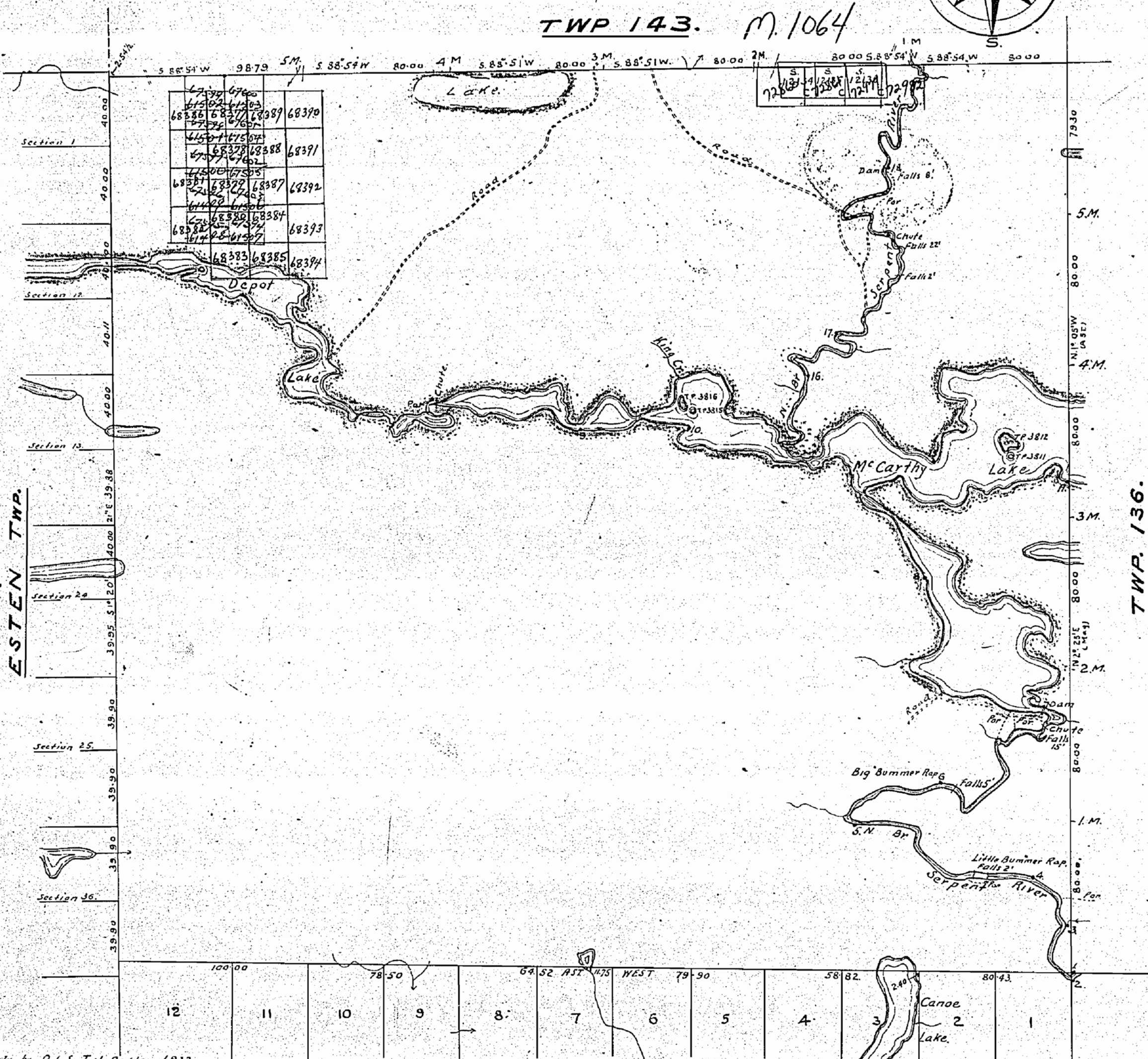
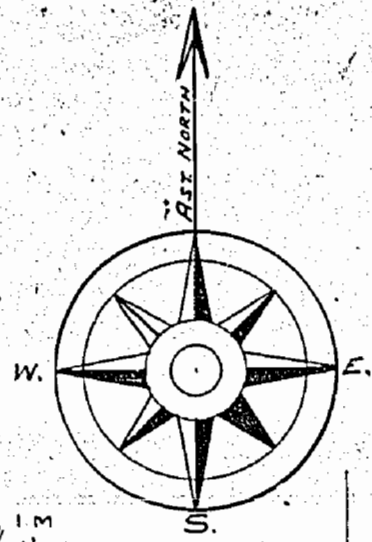

67539	67600		
68386	68387	68389	68390
67538	67601		
67537	67602		
67536	67603		
67535	67604		
67534	67605		
67533	67606		
67532	67607		
67531	67608		
67530	67609		
67529	67610		
67528	67611		
67527	67612		
67526	67613		
67525	67614		
67524	67615		
67523	67616		
67522	67617		
67521	67618		
67520	67619		
67519	67620		
67518	67621		
67517	67622		
67516	67623		
67515	67624		
67514	67625		
67513	67626		
67512	67627		
67511	67628		
67510	67629		
67509	67630		
67508	67631		
67507	67632		
67506	67633		
67505	67634		
67504	67635		
67503	67636		
67502	67637		
67501	67638		
67500	67639		
67499	67640		
67498	67641		
67497	67642		
67496	67643		
67495	67644		
67494	67645		
67493	67646		
67492	67647		
67491	67648		
67490	67649		
67489	67650		
67488	67651		
67487	67652		
67486	67653		
67485	67654		
67484	67655		
67483	67656		
67482	67657		
67481	67658		
67480	67659		
67479	67660		
67478	67661		
67477	67662		
67476	67663		
67475	67664		
67474	67665		
67473	67666		
67472	67667		
67471	67668		
67470	67669		
67469	67670		
67468	67671		
67467	67672		
67466	67673		
67465	67674		
67464	67675		
67463	67676		
67462	67677		
67461	67678		
67460	67679		
67459	67680		
67458	67681		
67457	67682		
67456	67683		
67455	67684		
67454	67685		
67453	67686		
67452	67687		
67451	67688		
67450	67689		
67449	67690		
67448	67691		
67447	67692		
67446	67693		
67445	67694		
67444	67695		
67443	67696		
67442	67697		
67441	67698		
67440	67699		
67439	67700		

N. Bdy. by O.L.S. T.J. Patten 1932.  
 W. P.L.S. C. Unwin 1861.  
 S. H. Little 1882.  
 E. D. Beatty 1892.  
 Traverse of McCarthy Lake & Serpentine River by O.L.S. T.J. Patten 1932.  
 Posts shown thus etc.  
 Other Lakes & Rivers from Dominion Geological Survey, Blind River Sheet, 1925.  
 Parcels marked 'P' are Patented  
 'L' Leased.  
 'L.O.' License of Occupation

LEWIS TWP.

Surface reservations 200' wide by Dept. of L & F shown hereon thus

Department of Survey  
 Parliament Buildings  
 Toronto, Ontario, Canada

Revised, June 1933.

ESTEN TWP.

TWP. 136.

ESP 2 QWT  
PROCTOR TWP 25P  
No. 147  
GRAVEL PERMIT  
to Dept  
OF  
HIGHWAYS  
EXP  
MAR 31/55

Q.P.  
101 of  
Hwy 5  
JFM MAY 11/56  
GRAVEL  
TO DEPT  
OF HIGHWAYS  
SEE JFM  
NOV 15/55  
Q.P. 412

Twp: 143

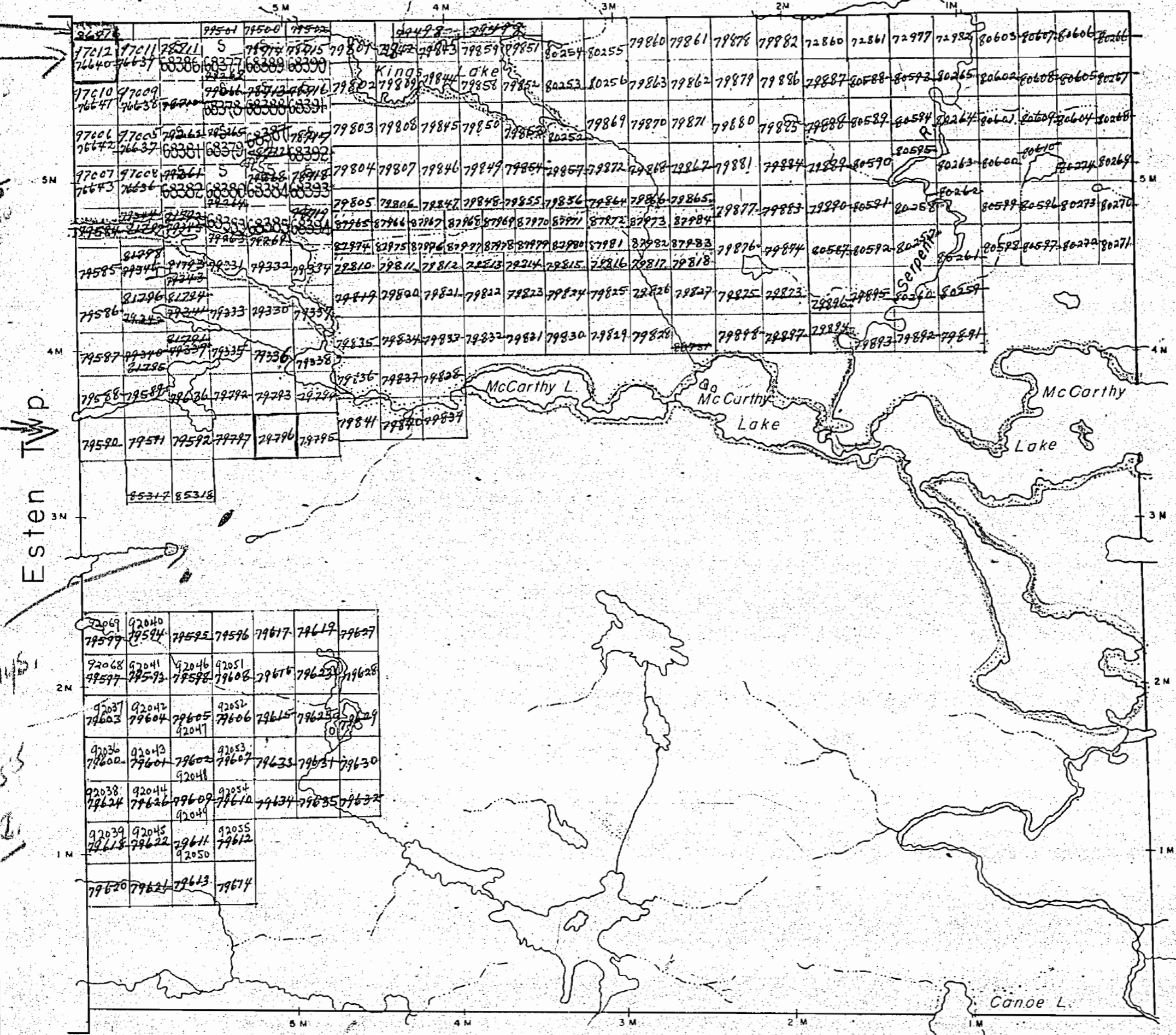

THE TOWNSHIP  
OF  
**PROCTOR**  
DISTRICT OF  
ALGOMA  
SUDBURY  
MINING DIVISION  
SCALE: 1-INCH=40 CHAINS

**LEGEND**

PATENTED LAND	⊙
CROWN LAND SALE	C.S.
LEASES	⊕
LOCATED LAND	Loc.
LICENSE OF OCCUPATION	L.O.
MINING RIGHTS ONLY	M.R.O.
SURFACE RIGHTS ONLY	S.R.O.
ROADS	—
IMPROVED ROADS	—
KING'S - HIGHWAYS	—
RAILWAYS	—
POWER LINES	—
MARSH OR MUSKEG	—
MINES	⋈
CANCELLED	c.

**NOTES**  
200' Reserve To Department Of Land  
and Forest Shown Thus

400' Res.  
Sand & Gravel Collected

M. 1064  
PLAN NO. - S 423  
DEPARTMENT OF MINES  
— ONTARIO —

Twp. 143 - M.1215

*Withdrawn from staking  
Sept. 7/67*

C.P. # 1-3063  
Corpn. Town Hill Lake

*P.P. 4-75-72*

*P.P. 4-81-72*

Esten Twp. - M.792

Deagle Twp. - M.750

Lewis Twp. - M.988

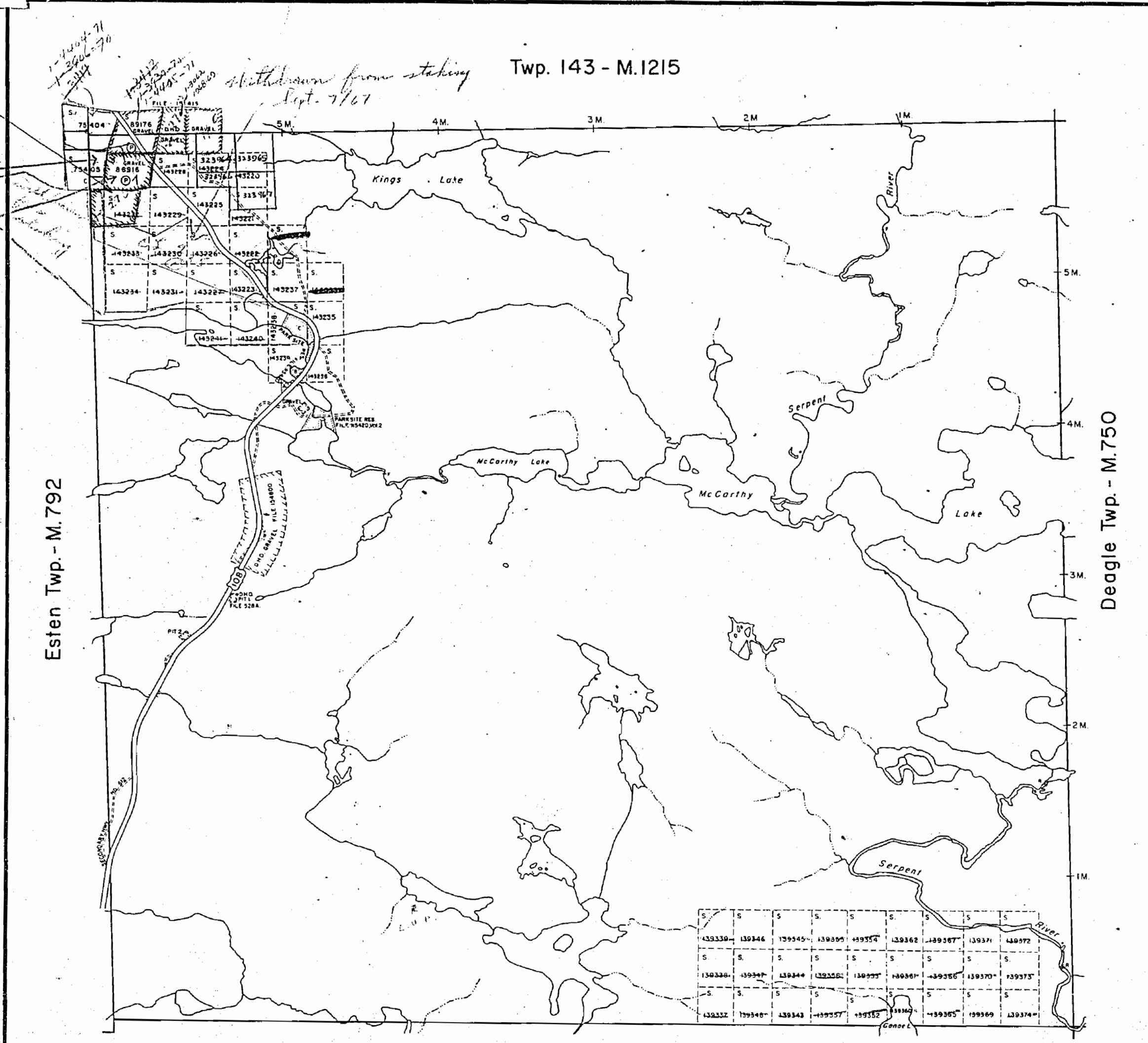

THE TOWNSHIP  
OF  
**PROCTOR**

DISTRICT OF  
ALGOMA

SUDBURY  
MINING DIVISION

SCALE: 1-INCH 40 CHAINS

**LEGEND**

- PATENTED LAND Ⓟ
- CROWN LAND SALE C.S.
- LEASES Ⓛ
- LOCATED LAND Loc.
- LICENSE OF OCCUPATION L.O.
- MINING RIGHTS ONLY M.R.O.
- SURFACE RIGHTS ONLY S.R.O.
- ROADS — — — — —
- IMPROVED ROADS — — — — —
- KING'S HIGHWAYS — — — — —
- RAILWAYS — — — — —
- POWER LINES — — — — —
- MARSH OR MUSKEG — — — — —
- MINES ✕
- CANCELLED C

**NOTES**

400' surface rights reservation around all lakes and rivers.

*July 30/68*

PLAN NO. **M.1064**

DEPARTMENT OF MINES

— ONTARIO —

Twp. 143 - M.1215

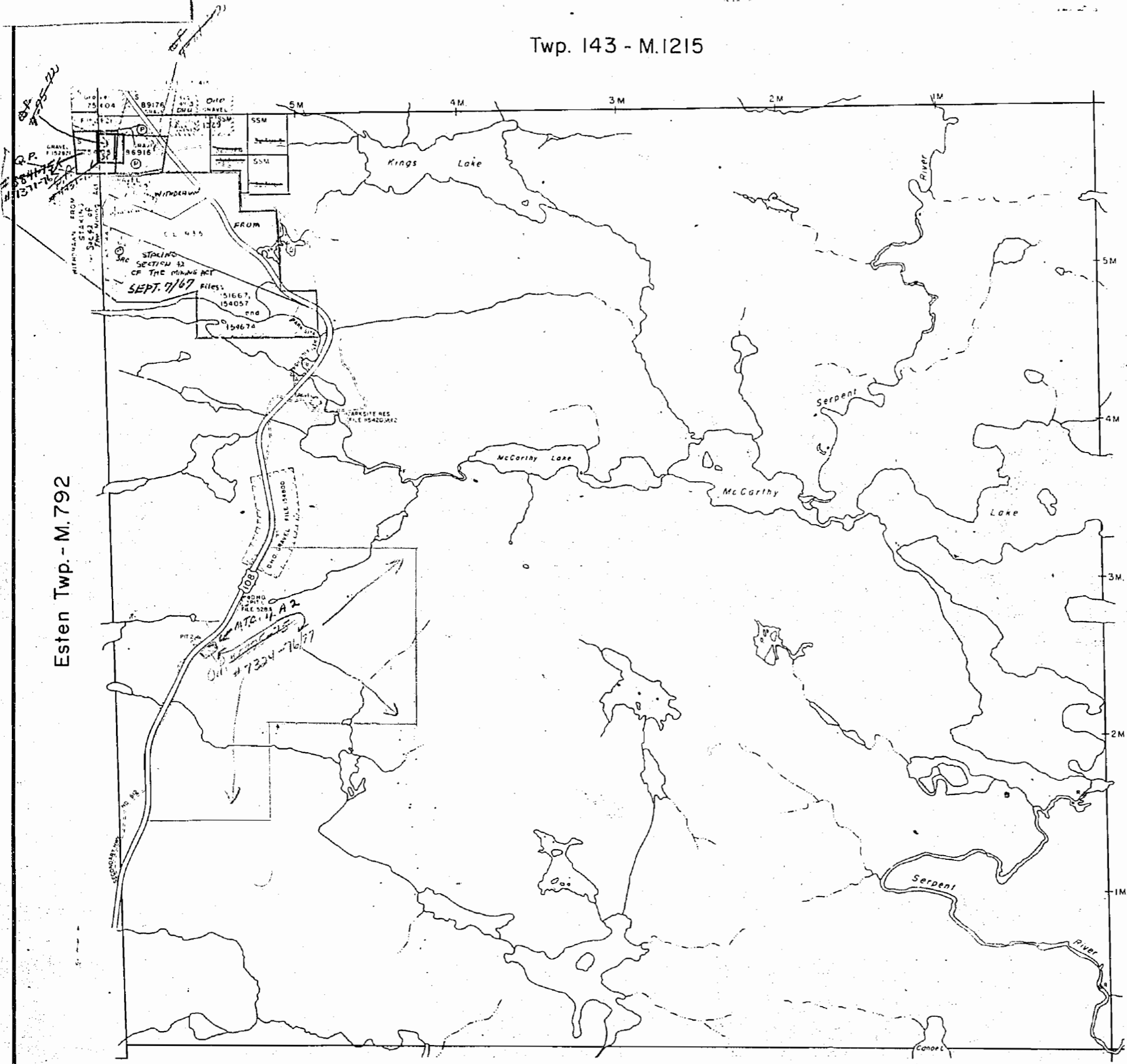

THE TOWNSHIP OF  
OF  
**PROCTOR**  
DISTRICT OF  
ALGOMA

SAULT STE MARIE  
MINING DIVISION

SCALE: 1-INCH 40 CHAINS

**LEGEND**

PATENTED LAND	Ⓟ
CROWN LAND SALE	C.S.
LEASES	Ⓛ
LOCATED LAND	Loc.
LICENSE OF OCCUPATION	L.O.
MINING RIGHTS ONLY	M.R.O.
SURFACE RIGHTS ONLY	S.R.O.
ROADS	—
IMPROVED ROADS	—
KING'S HIGHWAYS	—
RAILWAYS	—
POWER LINES	—
MARSH OR MUSKEG	—
MINES	ⓧ
CANCELLED	Ⓞ

**NOTES**

400' surface rights reservation around all lakes and rivers.

AREA OUTLINED IN RED IS COVERED BY P.P. # 5825 - FABRI LUMBER LTD. THRU 2/75 see file - "Multiple PIT Permit"

PLAN NO. **M.1064**

ONTARIO  
MINISTRY OF NATURAL RESOURCES  
SURVEYS AND MAPPING BRANCH

Esten Twp. - M.792

Deagle Twp. - M.750

Lewis Twp. - M.988

THE TOWNSHIP  
OF

# PROCTOR

DISTRICT OF  
ALGOMA

SAULT STE MARIE  
MINING DIVISION

SCALE: 1-INCH = 40 CHAINS

### LEGEND

PATENTED LAND	Ⓟ
CROWN LAND SALE	C.S.
LEASES	Ⓛ
LOCATED LAND	Loc.
LICENSE OF OCCUPATION	L.O.
MINING RIGHTS ONLY	M.R.O.
SURFACE RIGHTS ONLY	S.R.O.
ROADS	—
IMPROVED ROADS	—
KING'S HIGHWAYS	—
RAILWAYS	—
POWER LINES	—
MARSH OR MUSKEG	—
MINES	—
CANCELLED	—

### NOTES

400' surface rights reservation around all lakes and rivers.

AREA OUTLINED IN RED IS COVERED BY Q.P. #1324 - FABRIS LUMBER LTD. MAY 1976 SEE FILE - "MULTIPLE PIT PERMIT"

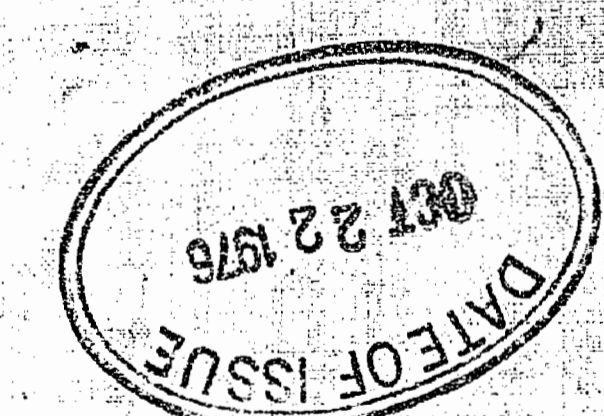

NOTE: Surface Rights only are reopened for prospecting, staking out, sale or lease. See ORDER # 0.3/79 - UNDER SECTION 43.  
NOTE: Surface Rights Only are withdrawn from prospecting, staking out, sale or lease under section 43 of mining act. ORDER OF DEPUTY MINISTER #W.1879.

## G-3315

PLAN NO. **M.1064**

ONTARIO  
MINISTRY OF NATURAL RESOURCES  
SURVEYS AND MAPPING BRANCH

This AREA is Pending Disposition under the Public Lands Act - to be excluded FROM any mining claims that are staked Twp. 143 - M.1215 (B.R. File - Oct. 3/80)

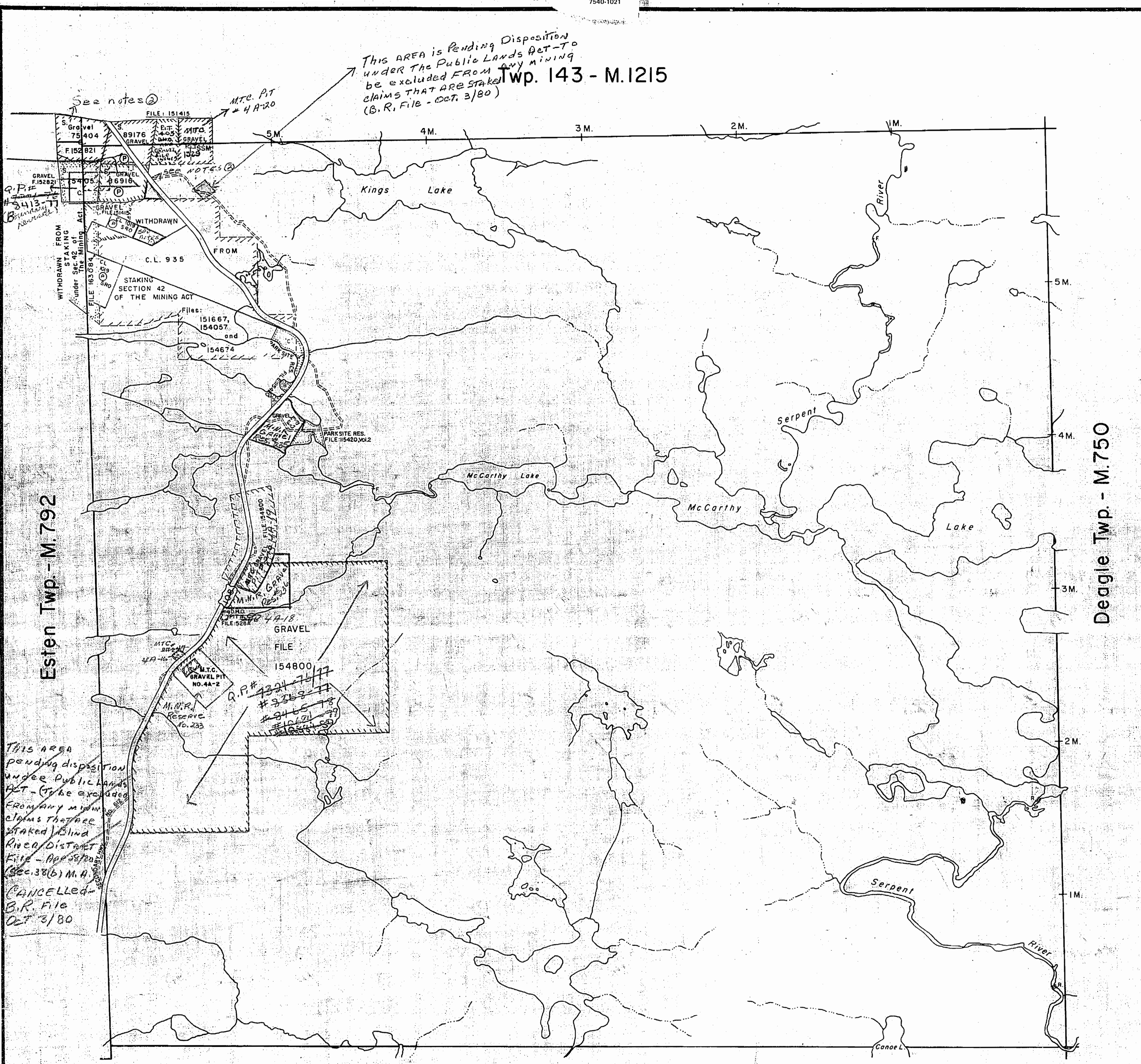

Esten Twp. - M.792

Deagle Twp. - M.750

Lewis Twp. - M.988

This area pending disposition under Public Lands Act - (to be excluded from any mining claims that are staked) under Renco District File - 100000000 (Sec. 38(b) M.A. CANCELLED - B.R. File Oct 3/80

GRAVEL FILE 154800  
M.T.C. PIT NO. 4A-2  
M.R.O. Reserve No. 233  
Q.P. # 1324  
# 3358  
# 1065  
# 1067  
# 1068

GRAVEL FILE 151415  
M.T.C. PIT # 4A-20  
C.L. 935  
STAKING SECTION 42 OF THE MINING ACT  
FILES: 151667, 154057 and 154674  
PARK SITE RES. FILE: 15420, 1012

See notes 2  
GRAVEL FILE 15282  
GRAVEL FILE 15281  
GRAVEL FILE 15280  
GRAVEL FILE 15279  
GRAVEL FILE 15278  
GRAVEL FILE 15277  
GRAVEL FILE 15276  
GRAVEL FILE 15275  
GRAVEL FILE 15274  
GRAVEL FILE 15273  
GRAVEL FILE 15272  
GRAVEL FILE 15271  
GRAVEL FILE 15270  
GRAVEL FILE 15269  
GRAVEL FILE 15268  
GRAVEL FILE 15267  
GRAVEL FILE 15266  
GRAVEL FILE 15265  
GRAVEL FILE 15264  
GRAVEL FILE 15263  
GRAVEL FILE 15262  
GRAVEL FILE 15261  
GRAVEL FILE 15260  
GRAVEL FILE 15259  
GRAVEL FILE 15258  
GRAVEL FILE 15257  
GRAVEL FILE 15256  
GRAVEL FILE 15255  
GRAVEL FILE 15254  
GRAVEL FILE 15253  
GRAVEL FILE 15252  
GRAVEL FILE 15251  
GRAVEL FILE 15250  
GRAVEL FILE 15249  
GRAVEL FILE 15248  
GRAVEL FILE 15247  
GRAVEL FILE 15246  
GRAVEL FILE 15245  
GRAVEL FILE 15244  
GRAVEL FILE 15243  
GRAVEL FILE 15242  
GRAVEL FILE 15241  
GRAVEL FILE 15240  
GRAVEL FILE 15239  
GRAVEL FILE 15238  
GRAVEL FILE 15237  
GRAVEL FILE 15236  
GRAVEL FILE 15235  
GRAVEL FILE 15234  
GRAVEL FILE 15233  
GRAVEL FILE 15232  
GRAVEL FILE 15231  
GRAVEL FILE 15230  
GRAVEL FILE 15229  
GRAVEL FILE 15228  
GRAVEL FILE 15227  
GRAVEL FILE 15226  
GRAVEL FILE 15225  
GRAVEL FILE 15224  
GRAVEL FILE 15223  
GRAVEL FILE 15222  
GRAVEL FILE 15221  
GRAVEL FILE 15220  
GRAVEL FILE 15219  
GRAVEL FILE 15218  
GRAVEL FILE 15217  
GRAVEL FILE 15216  
GRAVEL FILE 15215  
GRAVEL FILE 15214  
GRAVEL FILE 15213  
GRAVEL FILE 15212  
GRAVEL FILE 15211  
GRAVEL FILE 15210  
GRAVEL FILE 15209  
GRAVEL FILE 15208  
GRAVEL FILE 15207  
GRAVEL FILE 15206  
GRAVEL FILE 15205  
GRAVEL FILE 15204  
GRAVEL FILE 15203  
GRAVEL FILE 15202  
GRAVEL FILE 15201  
GRAVEL FILE 15200  
GRAVEL FILE 15199  
GRAVEL FILE 15198  
GRAVEL FILE 15197  
GRAVEL FILE 15196  
GRAVEL FILE 15195  
GRAVEL FILE 15194  
GRAVEL FILE 15193  
GRAVEL FILE 15192  
GRAVEL FILE 15191  
GRAVEL FILE 15190  
GRAVEL FILE 15189  
GRAVEL FILE 15188  
GRAVEL FILE 15187  
GRAVEL FILE 15186  
GRAVEL FILE 15185  
GRAVEL FILE 15184  
GRAVEL FILE 15183  
GRAVEL FILE 15182  
GRAVEL FILE 15181  
GRAVEL FILE 15180  
GRAVEL FILE 15179  
GRAVEL FILE 15178  
GRAVEL FILE 15177  
GRAVEL FILE 15176  
GRAVEL FILE 15175  
GRAVEL FILE 15174  
GRAVEL FILE 15173  
GRAVEL FILE 15172  
GRAVEL FILE 15171  
GRAVEL FILE 15170  
GRAVEL FILE 15169  
GRAVEL FILE 15168  
GRAVEL FILE 15167  
GRAVEL FILE 15166  
GRAVEL FILE 15165  
GRAVEL FILE 15164  
GRAVEL FILE 15163  
GRAVEL FILE 15162  
GRAVEL FILE 15161  
GRAVEL FILE 15160  
GRAVEL FILE 15159  
GRAVEL FILE 15158  
GRAVEL FILE 15157  
GRAVEL FILE 15156  
GRAVEL FILE 15155  
GRAVEL FILE 15154  
GRAVEL FILE 15153  
GRAVEL FILE 15152  
GRAVEL FILE 15151  
GRAVEL FILE 15150  
GRAVEL FILE 15149  
GRAVEL FILE 15148  
GRAVEL FILE 15147  
GRAVEL FILE 15146  
GRAVEL FILE 15145  
GRAVEL FILE 15144  
GRAVEL FILE 15143  
GRAVEL FILE 15142  
GRAVEL FILE 15141  
GRAVEL FILE 15140  
GRAVEL FILE 15139  
GRAVEL FILE 15138  
GRAVEL FILE 15137  
GRAVEL FILE 15136  
GRAVEL FILE 15135  
GRAVEL FILE 15134  
GRAVEL FILE 15133  
GRAVEL FILE 15132  
GRAVEL FILE 15131  
GRAVEL FILE 15130  
GRAVEL FILE 15129  
GRAVEL FILE 15128  
GRAVEL FILE 15127  
GRAVEL FILE 15126  
GRAVEL FILE 15125  
GRAVEL FILE 15124  
GRAVEL FILE 15123  
GRAVEL FILE 15122  
GRAVEL FILE 15121  
GRAVEL FILE 15120  
GRAVEL FILE 15119  
GRAVEL FILE 15118  
GRAVEL FILE 15117  
GRAVEL FILE 15116  
GRAVEL FILE 15115  
GRAVEL FILE 15114  
GRAVEL FILE 15113  
GRAVEL FILE 15112  
GRAVEL FILE 15111  
GRAVEL FILE 15110  
GRAVEL FILE 15109  
GRAVEL FILE 15108  
GRAVEL FILE 15107  
GRAVEL FILE 15106  
GRAVEL FILE 15105  
GRAVEL FILE 15104  
GRAVEL FILE 15103  
GRAVEL FILE 15102  
GRAVEL FILE 15101  
GRAVEL FILE 15100  
GRAVEL FILE 15099  
GRAVEL FILE 15098  
GRAVEL FILE 15097  
GRAVEL FILE 15096  
GRAVEL FILE 15095  
GRAVEL FILE 15094  
GRAVEL FILE 15093  
GRAVEL FILE 15092  
GRAVEL FILE 15091  
GRAVEL FILE 15090  
GRAVEL FILE 15089  
GRAVEL FILE 15088  
GRAVEL FILE 15087  
GRAVEL FILE 15086  
GRAVEL FILE 15085  
GRAVEL FILE 15084  
GRAVEL FILE 15083  
GRAVEL FILE 15082  
GRAVEL FILE 15081  
GRAVEL FILE 15080  
GRAVEL FILE 15079  
GRAVEL FILE 15078  
GRAVEL FILE 15077  
GRAVEL FILE 15076  
GRAVEL FILE 15075  
GRAVEL FILE 15074  
GRAVEL FILE 15073  
GRAVEL FILE 15072  
GRAVEL FILE 15071  
GRAVEL FILE 15070  
GRAVEL FILE 15069  
GRAVEL FILE 15068  
GRAVEL FILE 15067  
GRAVEL FILE 15066  
GRAVEL FILE 15065  
GRAVEL FILE 15064  
GRAVEL FILE 15063  
GRAVEL FILE 15062  
GRAVEL FILE 15061  
GRAVEL FILE 15060  
GRAVEL FILE 15059  
GRAVEL FILE 15058  
GRAVEL FILE 15057  
GRAVEL FILE 15056  
GRAVEL FILE 15055  
GRAVEL FILE 15054  
GRAVEL FILE 15053  
GRAVEL FILE 15052  
GRAVEL FILE 15051  
GRAVEL FILE 15050  
GRAVEL FILE 15049  
GRAVEL FILE 15048  
GRAVEL FILE 15047  
GRAVEL FILE 15046  
GRAVEL FILE 15045  
GRAVEL FILE 15044  
GRAVEL FILE 15043  
GRAVEL FILE 15042  
GRAVEL FILE 15041  
GRAVEL FILE 15040  
GRAVEL FILE 15039  
GRAVEL FILE 15038  
GRAVEL FILE 15037  
GRAVEL FILE 15036  
GRAVEL FILE 15035  
GRAVEL FILE 15034  
GRAVEL FILE 15033  
GRAVEL FILE 15032  
GRAVEL FILE 15031  
GRAVEL FILE 15030  
GRAVEL FILE 15029  
GRAVEL FILE 15028  
GRAVEL FILE 15027  
GRAVEL FILE 15026  
GRAVEL FILE 15025  
GRAVEL FILE 15024  
GRAVEL FILE 15023  
GRAVEL FILE 15022  
GRAVEL FILE 15021  
GRAVEL FILE 15020  
GRAVEL FILE 15019  
GRAVEL FILE 15018  
GRAVEL FILE 15017  
GRAVEL FILE 15016  
GRAVEL FILE 15015  
GRAVEL FILE 15014  
GRAVEL FILE 15013  
GRAVEL FILE 15012  
GRAVEL FILE 15011  
GRAVEL FILE 15010  
GRAVEL FILE 15009  
GRAVEL FILE 15008  
GRAVEL FILE 15007  
GRAVEL FILE 15006  
GRAVEL FILE 15005  
GRAVEL FILE 15004  
GRAVEL FILE 15003  
GRAVEL FILE 15002  
GRAVEL FILE 15001  
GRAVEL FILE 15000

Tw. 143 - M.1215

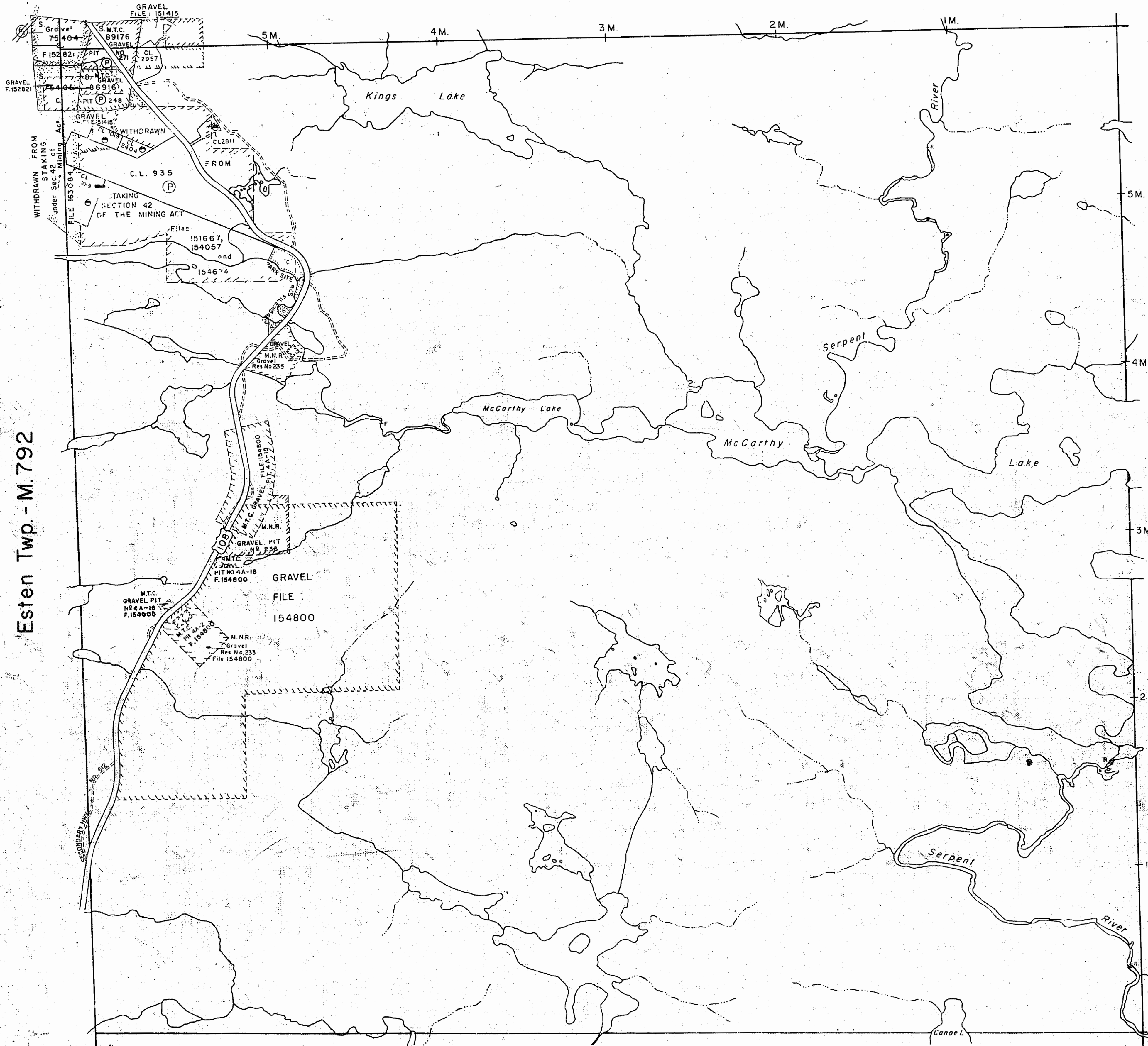

THE TOWNSHIP  
OF  
**PROCTOR**

DISTRICT OF  
**ALGOMA**

SAULT STE MARIE  
MINING DIVISION

SCALE: 1-INCH = 40 CHAINS

**LEGEND**

PATENTED LAND	● or (P)
CROWN LAND SALE	C.S.
LEASES	(L)
LOCATED LAND	Loc.
LICENSE OF OCCUPATION	L.O.
MINING RIGHTS ONLY	M.R.O.
SURFACE RIGHTS ONLY	S.R.O.
ROADS	—
IMPROVED ROADS	—
KING'S HIGHWAYS	—
RAILWAYS	—
POWER LINES	—
MARSH OR MUSKEG	—
MINES	—
CANCELLED	—
PATENTED for S.R.O.	—

**NOTES**

400' surface rights reservation around all lakes and rivers

Areas withdrawn from staking under Section 43 of the Mining Act (R.S.O. 1970).

Order No	File	Date	Disposition
1879	151415	3/10/29	S.R.O. Repealed Aug 1/84 - ORDE # 0.5/84

DATE OF ISSUE  
AUG 3 1982  
Ministry of Natural Resources  
TORONTO

**G-3315**

PLAN NO. **M.1064**

ONTARIO  
MINISTRY OF NATURAL RESOURCES  
SURVEYS AND MAPPING BRANCH

Esten Twp. - M. 792

Deagle Twp. - M. 750

Lewis Twp. - M. 988

Replaced by G-3315 - March 17/82

**INDEX TO LAND DISPOSITION**

PLAN  
**G - 3315**  
 TOWNSHIP  
**PROCTOR**

M.N.R. ADMINISTRATIVE DISTRICT  
**BLIND RIVER**  
 MINING DIVISION  
**SAULT STE. MARIE**  
 LAND TITLES/REGISTRY DIVISION  
**ALGOMA**

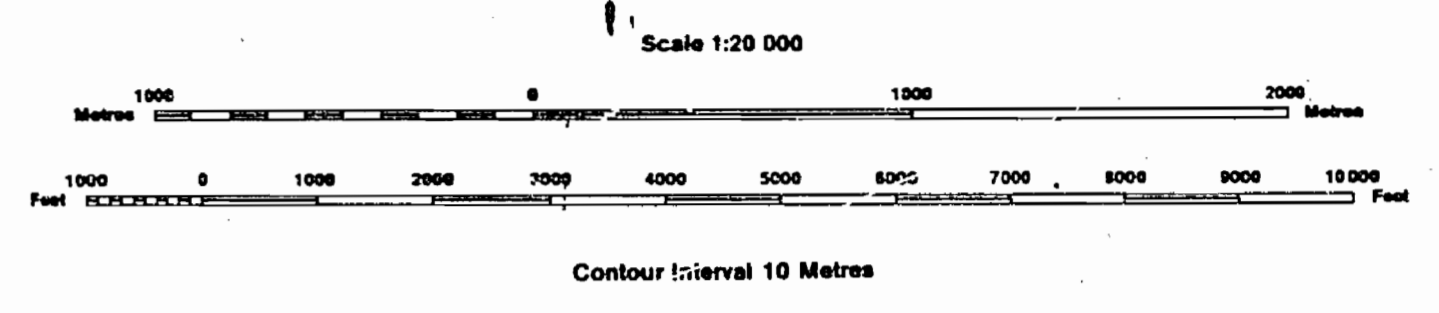

**AREAS WITHDRAWN FROM DISPOSITION**

- MRO - Mining Rights Only
- SRO - Surface Rights Only
- M + S - Mining and Surface Rights

**SYMBOLS**

Boundary	
Township, Meridian, Baseline	.....
Road allowance; surveyed	.....
shoreline	.....
Lot/Concession; surveyed	.....
unsurveyed	.....
Parcel; surveyed	.....
unsurveyed	.....
Right-of-way; road	.....
railway	.....
utility	.....
Reservation	.....
Cliff, Pit, Pile	.....
Contour	.....
Interpolated	.....
Approximate	.....
Depression	.....
Control point (horizontal)	.....
Flooded land	.....
Mine head frame	.....
Pipeline (above ground)	.....
Railway; single track	.....
double track	.....
abandoned	.....
Road; highway, county, township	.....
access	.....
trail, bush	.....
Shoreline (original)	.....
Transmission line	.....
Wooded area	.....

**NOTES**

THIS TOWNSHIP LIES WITHIN THE IMPROVEMENT DISTRICT OF ELLIOT LAKE.  
 \* Application under LVR Improvement Act (Dam + Power House) See B.R. letter dated Aug 27/87.

**DISPOSITION OF CROWN LANDS**

Patent	
Surface & Mining Rights	.....
Surface Rights Only	.....
Mining Rights Only	.....
Lease	
Surface & Mining Rights	.....
Surface Rights Only	.....
Mining Rights Only	.....
Licence of Occupation	.....
Order-in-Council	.....
Cancelled	.....
Reservation	.....
Sand & Gravel	.....

**DATE OF ISSUE**

JUN 08 1988  
 PROVINCIAL RECORDING OFFICE - SUDBURY

THE INFORMATION THAT APPEARS ON THIS MAP HAS BEEN COMPILED FROM VARIOUS SOURCES, AND ACCURACY IS NOT GUARANTEED. THOSE WISHING TO STAKE MINING CLAIMS SHOULD CONSULT WITH THE MINING RECORDER, MINISTRY OF NORTHERN DEVELOPMENT AND MINES, FOR ADDITIONAL INFORMATION ON THE STATUS OF THE LANDS SHOWN HEREON.

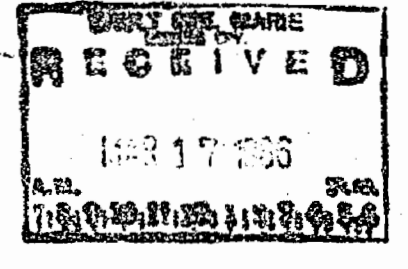

The 1975 Magnetic Bearing Approx. 12.5 Annual Change Increasing 1.30

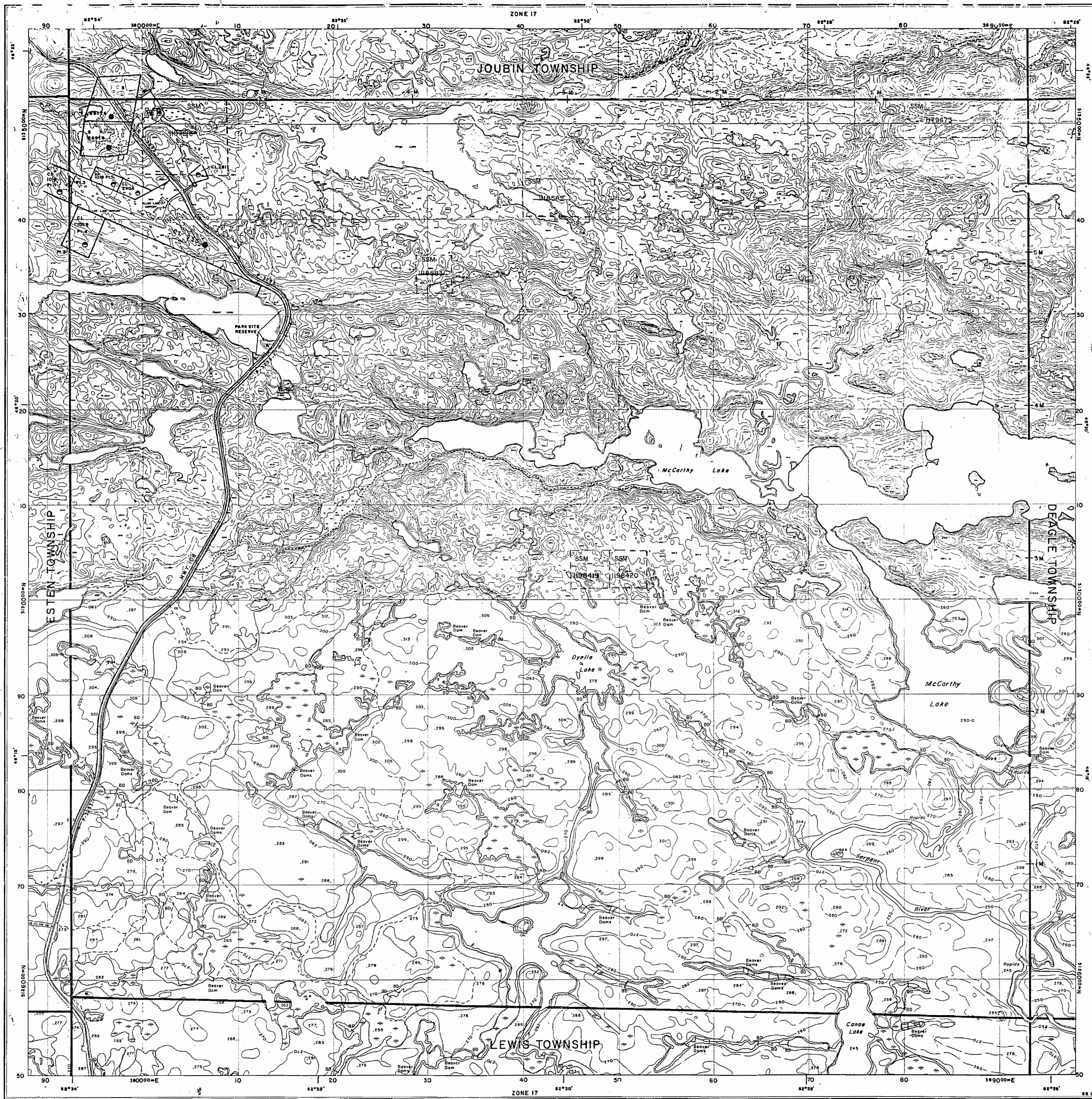

SECTION 17 1/2 TWP 143 N 10 W

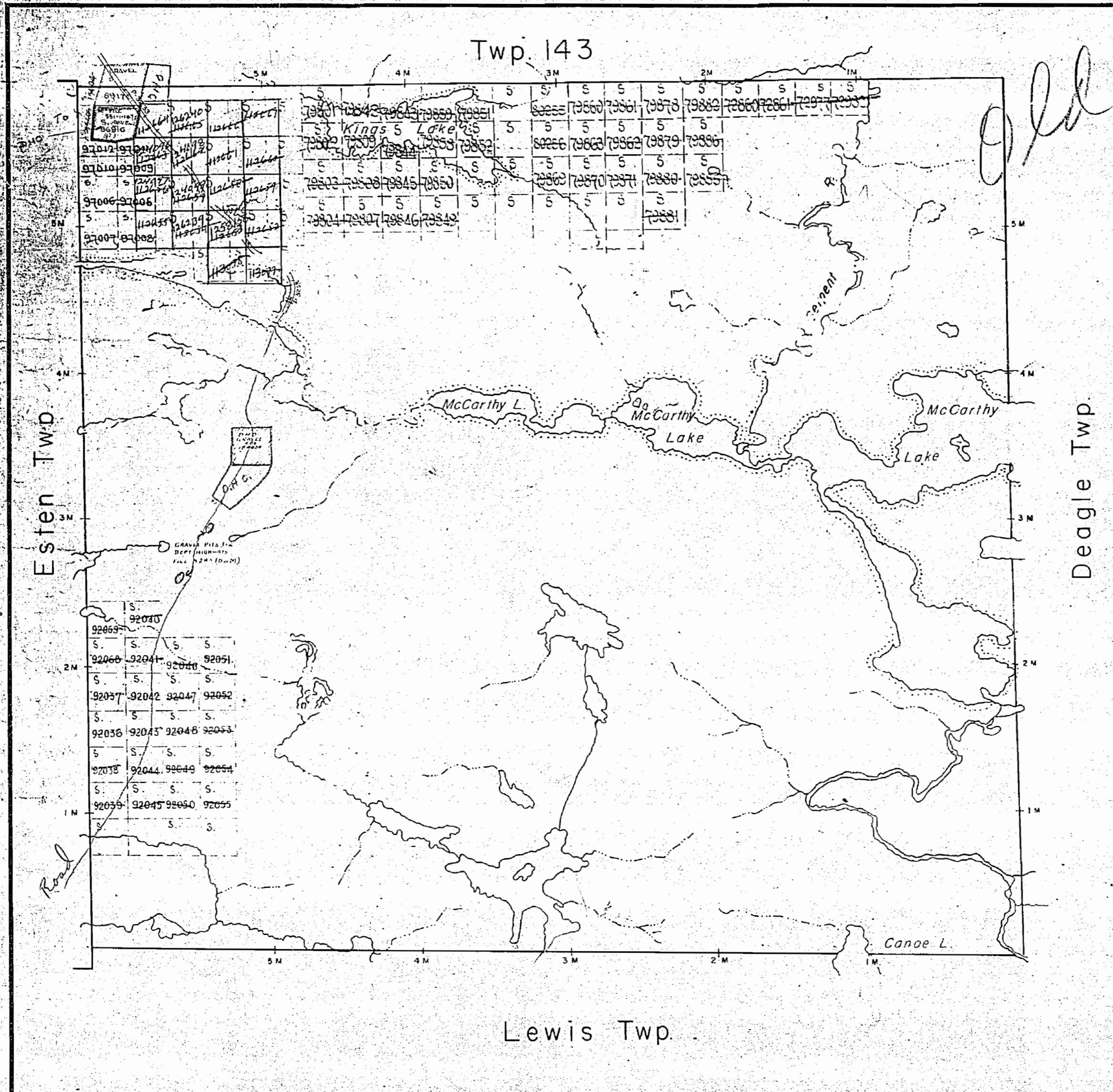

THE TOWNSHIP  
OF  
**PROCTOR**  
DISTRICT OF  
ALGOMA  
SUDBURY  
MINING DIVISION  
SCALE: 1-INCH=40 CHAINS

LEGEND

PATENTED LAND	⊕
CROWN LAND SALE	C.S.
LEASES	⊙
LOCATED LAND	Loc.
LICENSE OF OCCUPATION	L.O.
MINING RIGHTS ONLY	M.R.O.
SURFACE RIGHTS ONLY	S.R.O.
ROADS	—
IMPROVED ROADS	—
KING'S HIGHWAYS	—
RAILWAYS	—
POWER LINES	—
MARSH OR MUSKEG	—
MINES	⊗
CANCELLED	C.

NOTES

400' Reserve To Department Of Land and Forest Shown Thus:

---

Sand & Gravel on all unpatented mining claims in this Township, reserved to the Crown.

PLAN NO. M-1064  
DEPARTMENT OF MINES  
— ONTARIO —



**INDEX TO LAND DISPOSITION**

PLAN  
**G - 3315**  
 TOWNSHIP

M.N.R. ADMINISTRATIVE DISTRICT  
**BLIND RIVER**  
 MINING DIVISION  
**SAULT STE. MARIE**  
 LAND TITLES/REGISTRY DIVISION  
**ALGOMA**

**PROCTOR**

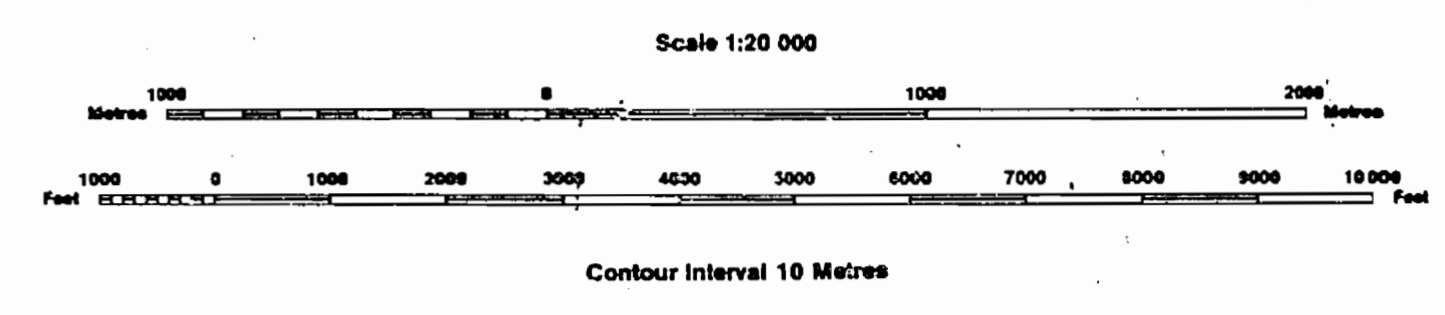

**AREAS WITHDRAWN FROM DISPOSITION**

- MRO - Mining Rights Only
- SRO - Surface Rights Only
- M + S - Mining and Surface Rights

**SYMBOLS**

Description	Order No.	Date	Disposition	File
Boundary				
Township, Meridian, Baseline				
Road allowance; surveyed				
shoreline				
Lot/Concession; surveyed				
unsurveyed				
Parcel; surveyed				
unsurveyed				
Right-of-way; road				
railway				
utility				
Reservation				
Cliff, Pit, Pile				
Contour				
Interpolated				
Approximate				
Depression				
Control point (horizontal)				
Flooded land				
Mine head frame				
Pipeline (above ground)				
Railway; single track				
double track				
abandoned				
Road; highway, county, township				
access				
trail, bush				
Shoreline (original)				
Transmission line				
Wooded area				

**NOTES**

THIS TOWNSHIP LIES WITHIN THE IMPROVEMENT DISTRICT OF ELLIOT LAKE.  
 \* Application under LVR Improvement Act (Dam + Power House) See B.R. letter dated Aug 27/87

**DISPOSITION OF CROWN LANDS**

Patent	
Surface & Mining Rights	●
Surface Rights Only	○
Mining Rights Only	○
Lease	
Surface & Mining Rights	■
Surface Rights Only	■
Mining Rights Only	■
Licence of Occupation	▼
Order-in-Council	OC
Cancelled	○
Reservation	○
Sand & Gravel	○

THE INFORMATION THAT APPEARS ON THIS MAP HAS BEEN COMPILED FROM VARIOUS SOURCES, AND ACCURACY IS NOT GUARANTEED. THOSE WISHING TO STAKE MINING CLAIMS SHOULD CONSULT WITH THE MINING RECORDER, MINISTRY OF NORTHERN DEVELOPMENT AND MINES, FOR ADDITIONAL INFORMATION ON THE STATUS OF THE LANDS SHOWN HEREON.

The 1975 Magnetic Bearing  
 Approx. 1.2 W Annual Change  
 Increasing 1.30

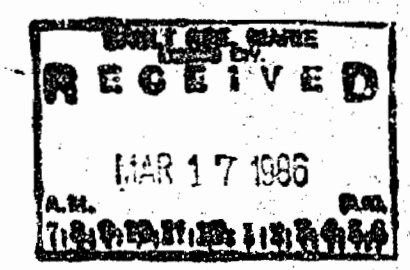

**INDEX TO LAND DISPOSITION**

PLAN  
**G-3315**  
 TOWNSHIP

M.N.R. ADMINISTRATIVE DISTRICT  
**BLIND RIVER**  
 MINING DIVISION  
**SAULT STE. MARIE**  
 LAND TITLES/REGISTRY DIVISION  
**ALGOMA**

**PROCTOR**

Scale 1:20 000

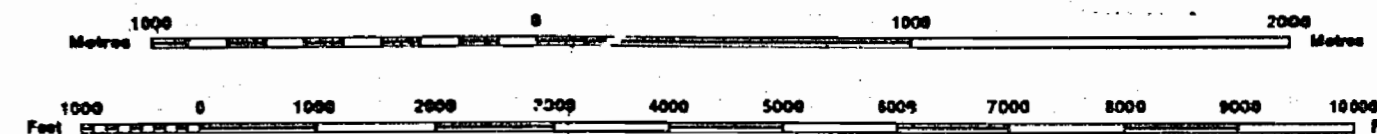

Contour Interval 10 Metres

**AREAS WITHDRAWN FROM DISPOSITION**

- MRO - Mining Rights Only
- SRO - Surface Rights Only
- M + S - Mining and Surface Rights

Description	Order No.	Date	Disposition	File

**SYMBOLS**

Boundary	
Township, Meridian, Baseline	
Road allowance: surveyed	
shoreline	
Lot/Concession: surveyed	
unsurveyed	
Parcel: surveyed	
unsurveyed	
Right-of-way: road	
railway	
utility	
Reservation	
Cliff, Pit, Pile	
Contour	
Interpolated	
Approximate	
Depression	
Control point (horizontal)	
Flooded land	
Mine head frame	
Pipeline (above ground)	
Railway: single track	
double track	
abandoned	
Road: highway, county, township	
access	
trail, bush	
Shoreline (original)	
Transmission line	
Woody area	

**NOTES**

THIS TOWNSHIP LIES WITHIN THE IMPROVEMENT DISTRICT OF ELLIOT LAKE.

\* Application under L.V.R. Improvement Act (Dun & Power Houses)  
See B.R. letter dated Aug 27/87.

**DISPOSITION OF CROWN LANDS**

Patent	
Surface & Mining Rights	
Surface Rights Only	
Mining Rights Only	
Lease	
Surface & Mining Rights	
Surface Rights Only	
Mining Rights Only	
Licence of Occupation	
Order-in-Council	
Cancelled	
Reservation	
Sand & Gravel	

The 1975 Magnetic Bearing  
Approx.   W   Annual Change  
Increasing   1.30"  

THE INFORMATION THAT APPEARS ON THIS MAP HAS BEEN COMPILED FROM VARIOUS SOURCES, AND ACCURACY IS NOT GUARANTEED. THOSE WISHING TO STAKE MINING CLAIMS SHOULD CONSULT WITH THE MINING RECORDER, MINISTRY OF NORTHERN DEVELOPMENT AND MINES, FOR ADDITIONAL INFORMATION ON THE STATUS OF THE LANDS SHOWN HEREON.

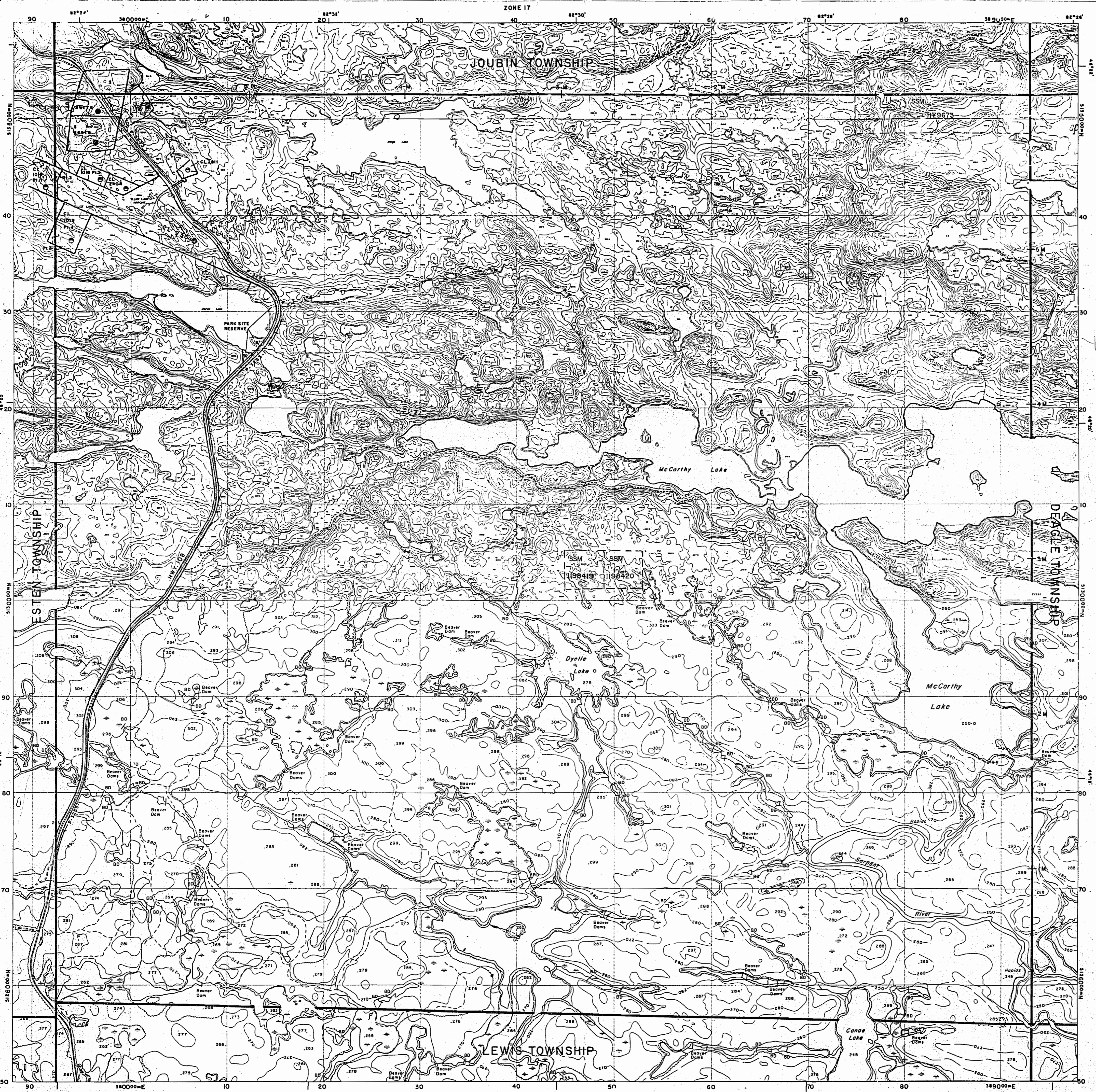
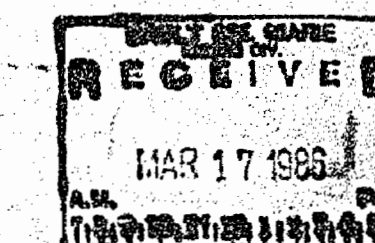

SECTION TWP. 1064

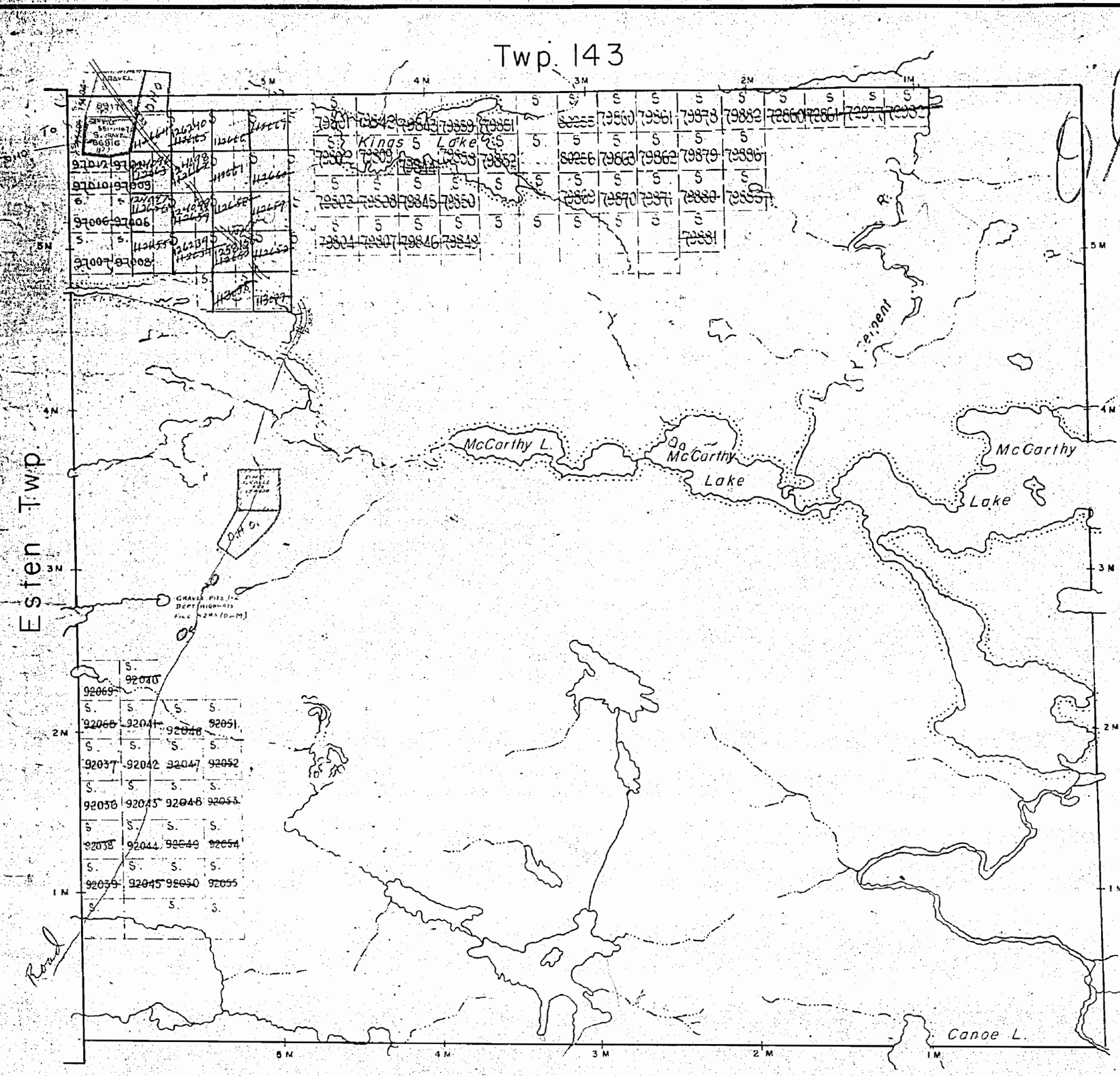

Esten Twp.

Deagle Twp.

Twp. 143

THE TOWNSHIP OF  
OF  
**PROCTOR**  
DISTRICT OF  
ALGOMA  
SUDBURY  
MINING DIVISION  
SCALE: 1-INCH=40 CHAINS

LEGEND

- |                       |        |
|-----------------------|--------|
| PATENTED LAND         | ⊙      |
| CROWN LAND SALE       | C.S.   |
| LEASES                | ⊙      |
| LOCATED LAND          | Loc.   |
| LICENSE OF OCCUPATION | L.O.   |
| MINING RIGHTS ONLY    | M.R.O. |
| SURFACE RIGHTS ONLY   | S.R.O. |
| ROADS                 | —      |
| IMPROVED ROADS        | —      |
| KING'S HIGHWAYS       | —      |
| RAILWAYS              | —      |
| POWER LINES           | —      |
| MARSH OR MUSKOGEE     | —      |
| MINES                 | X      |
| CANCELLED             | C.     |

NOTES

400' Reserve To Department Of Land  
and Forest Shown Thus:

Sand & Gravel on all unpatented mining claims  
in this Township, reserved to the Crown.

PLAN NO. M-1064

DEPARTMENT OF MINES

— ONTARIO —

Lewis Twp.

Twp. 143

THE TOWNSHIP  
OF  
**PROCTOR**  
DISTRICT OF  
ALGOMA  
SUDBURY  
MINING DIVISION  
SCALE: 1-INCH=40 CHAINS

LEGEND

- PATENTED LAND Ⓟ
- CROWN LAND SALE C.S.
- LEASES Ⓛ
- LOCATED LAND Loc.
- LICENSE OF OCCUPATION L.O.
- MINING RIGHTS ONLY M.R.O.
- SURFACE RIGHTS ONLY S.R.O.
- ROADS — — — — —
- IMPROVED ROADS = = = = =
- KING'S HIGHWAYS — [ ] —
- RAILWAYS — [ ] —
- POWER LINES — [ ] —
- MARSH OR MUSKEG [ ]
- MINES [ ]
- CANCELLED [ ]

NOTES

400' surface rights reservation ground all lakes & rivers.

Sand & Gravel on all unpatented mining claims in this Township, reserved to the Crown

Deagle Twp.

Lewis Twp.

PLAN NO.-M-1064

DEPARTMENT OF MINES

— ONTARIO —

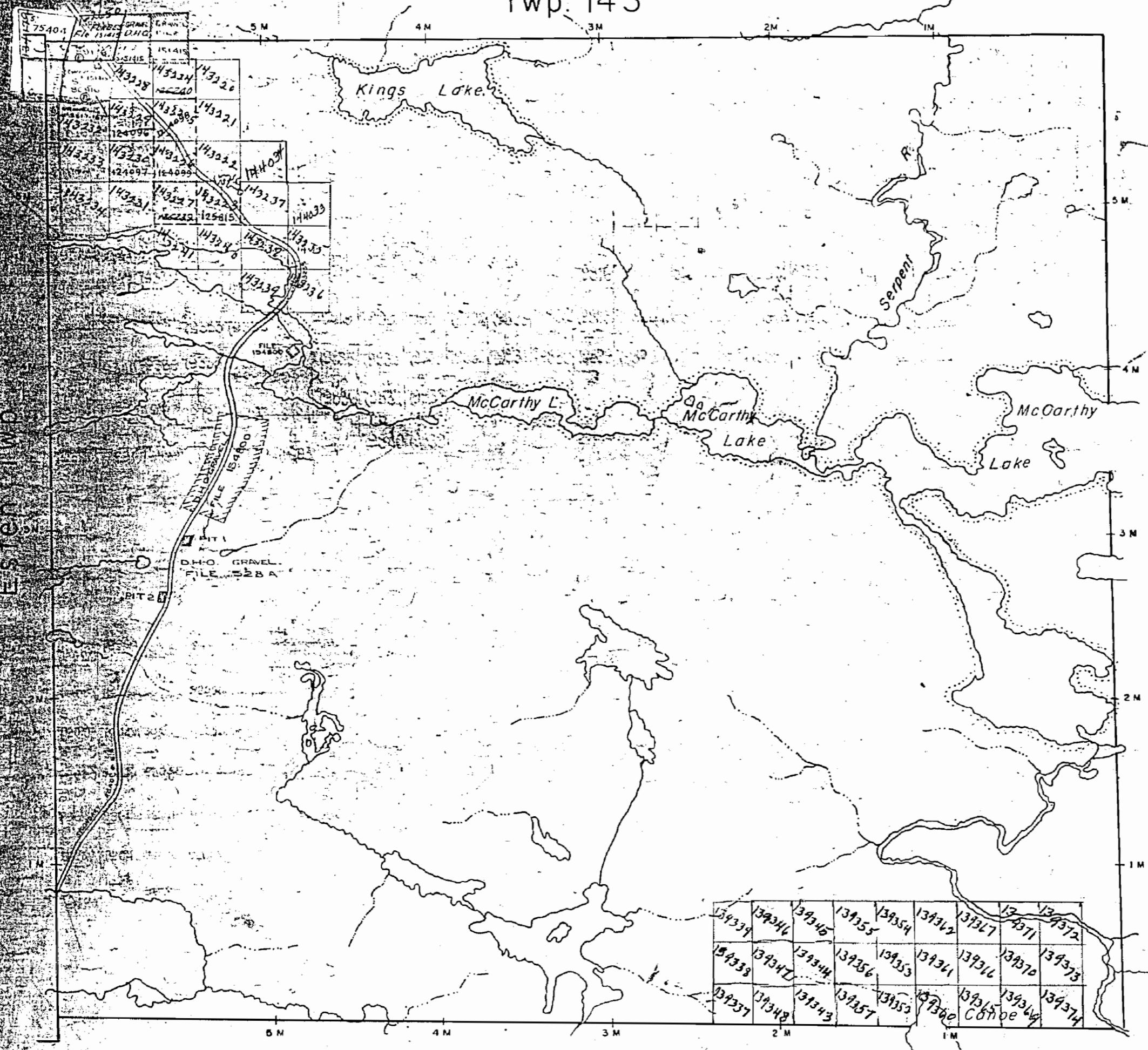

Twp. 143

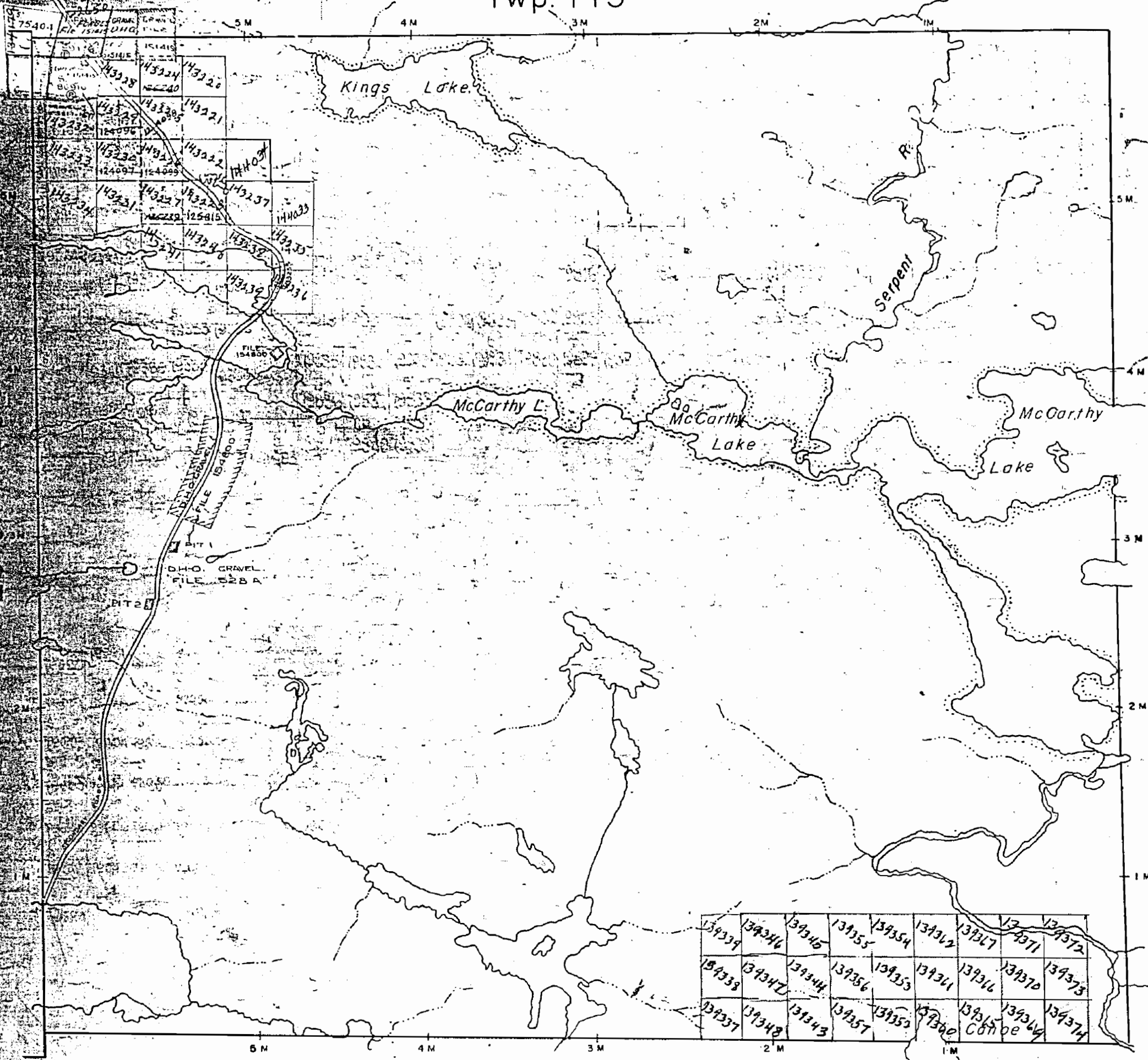

Deagle Twp.

Lewis Twp.

THE TOWNSHIP OF  
OF  
**PROCTOR**  
DISTRICT OF  
ALGOMA  
SUDBURY  
MINING DIVISION  
SCALE: 1-INCH=40 CHAINS

LEGEND

PATENTED LAND	Ⓟ
CROWN LAND SALE	C.S.
LEASES	Ⓛ
LOCATED LAND	Loc.
LICENSE OF OCCUPATION	L.O.
MINING RIGHTS ONLY	M.R.O.
SURFACE RIGHTS ONLY	S.R.O.
ROADS	—
IMPROVED ROADS	—
KING'S HIGHWAYS	—
RAILWAYS	—
POWER LINES	—
MARSH OR MUSKEG	—
MINES	—
CANCELLED	—

NOTES

400' surface rights reservation around all lakes & rivers.

---

Sand & Gravel on all unpatented mining claims in this Township, reserved to the Crown

PLAN NO. M-1064  
DEPARTMENT OF MINES  
— ONTARIO —

PROCTOR TWP S 453  
As 15-147  
GRAVEL Form  
to DEPT OF  
Highway 15  
EXP  
MAR 31/55

OP  
Dept  
Highways  
JFM. MAY 11/56

GRAVEL  
TO DEPT  
OF HIGHWAY  
SAC JFM  
NOV 15/55  
OP 1/2

Twp: 143

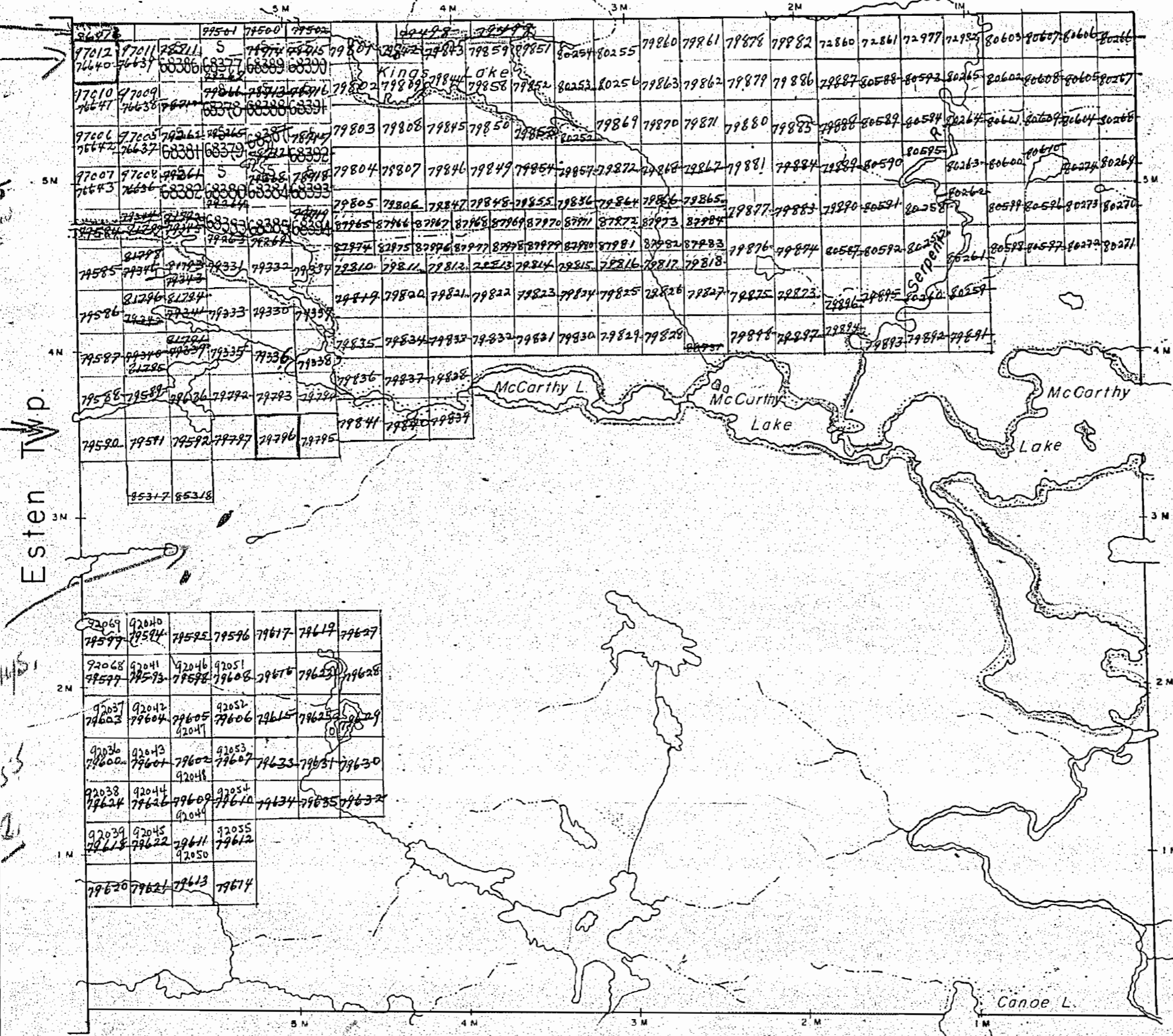

THE TOWNSHIP OF

# PROCTOR

DISTRICT OF  
ALGOMA  
SUDBURY

MINING DIVISION

SCALE: 1-INCH=40 CHAINS

### LEGEND

- PATENTED LAND ⊕
- CROWN LAND SALE C.S.
- LEASES ⊙
- LOCATED LAND Loc.
- LICENSE OF OCCUPATION L.O.
- MINING RIGHTS ONLY M.R.O.
- SURFACE RIGHTS ONLY S.R.O.
- ROADS
- IMPROVED ROADS
- KING'S - HIGHWAYS
- RAILWAYS
- POWER LINES
- MARSH OR MUSKEG
- MINES
- CANCELLED X

### NOTES

200' Reserve To Department Of Land and Forest Shown Thus.

400' Res.  
Sand & Gravel Excluded

M. 1064

PLAN NO. - S 423

DEPARTMENT OF MINES

— ONTARIO —

(29)

# TOWNSHIP OF PROCTOR.

SUDBURY MINING DIVISION.

DISTRICT OF ALGOMA.

Scale, 40 chains to an inch.

TWP 143. M. 1064

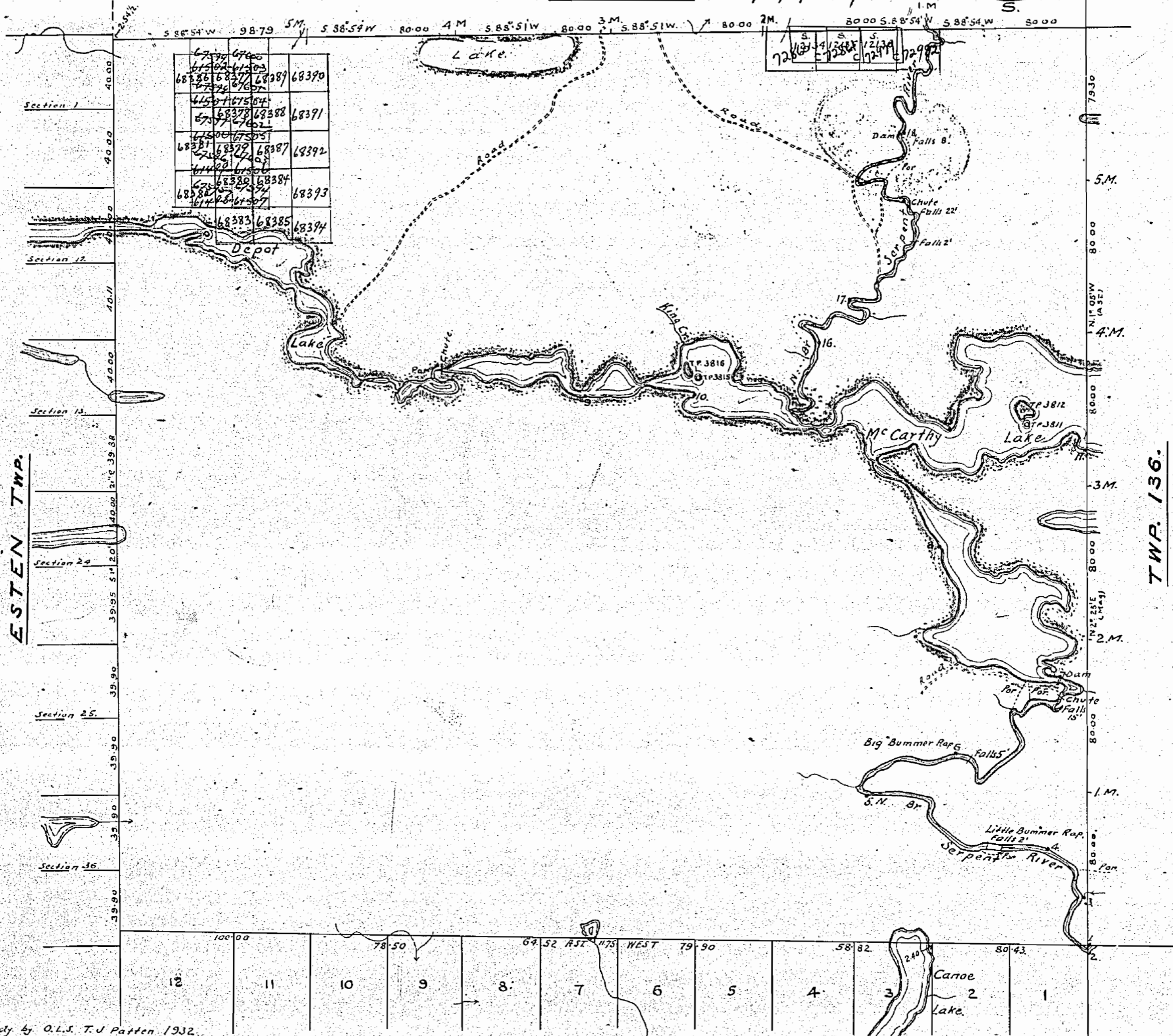
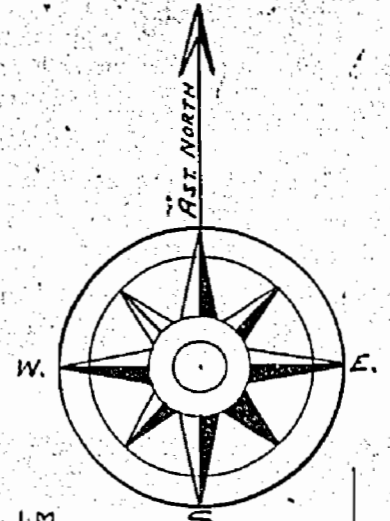

N. Bdy by O.L.S. T.J. Patten 1932.  
 W. " " R.L.S. C. Unwin 1861.  
 S. " " H. Little 1882.  
 E. " " D. Beatty 1892.  
 Traverse of McCarthy Lake & Serpentine River by O.L.S. T.J. Patten 1932.  
 Posts shown thus etc.  
 Other Lakes & Rivers from Dominion Geological Survey, Blind River Sheet, 1925.

LEWIS TWP.

Department of Surveys  
 Parliament Buildings  
 Toronto, Ontario, Canada

Revised, June 1933.

Surface reservations 200' wide by Dept. of L.I.F.  
 Section hereon thus

ESTEN TWP.

TWP. 136.

Twp. 143 - M.1215

THE TOWNSHIP  
OF

## PROCTOR

DISTRICT OF  
ALGOMA

SAULT STE MARIE  
MINING DIVISION

SCALE: 1-INCH 40 CHAINS

### LEGEND

PATENTED LAND	Ⓟ
CROWN LAND SALE	C.S
LEASES	Ⓛ
LOCATED LAND	Loc.
LICENSE OF OCCUPATION	L.O.
MINING RIGHTS ONLY	M.R.O.
SURFACE RIGHTS ONLY	S.R.O.
ROADS	—
IMPROVED ROADS	—
KING'S HIGHWAYS	—
RAILWAYS	—
POWER LINES	—
MARSH OR MUSKEG	—
MINES	Ⓧ
CANCELLED	Ⓞ

### NOTES

400' surface rights reservation around all lakes and rivers.

Area outlined in red is covered by P.P. # 5825 - FABRI LUMBER LTD. Timmins  
see file - "Multiple PIT Permit"

Esten Twp. - M.792

Deagle Twp. - M.750

Lewis Twp. - M.988

PLAN NO. **M.1064**

ONTARIO  
MINISTRY OF NATURAL RESOURCES  
SURVEYS AND MAPPING BRANCH

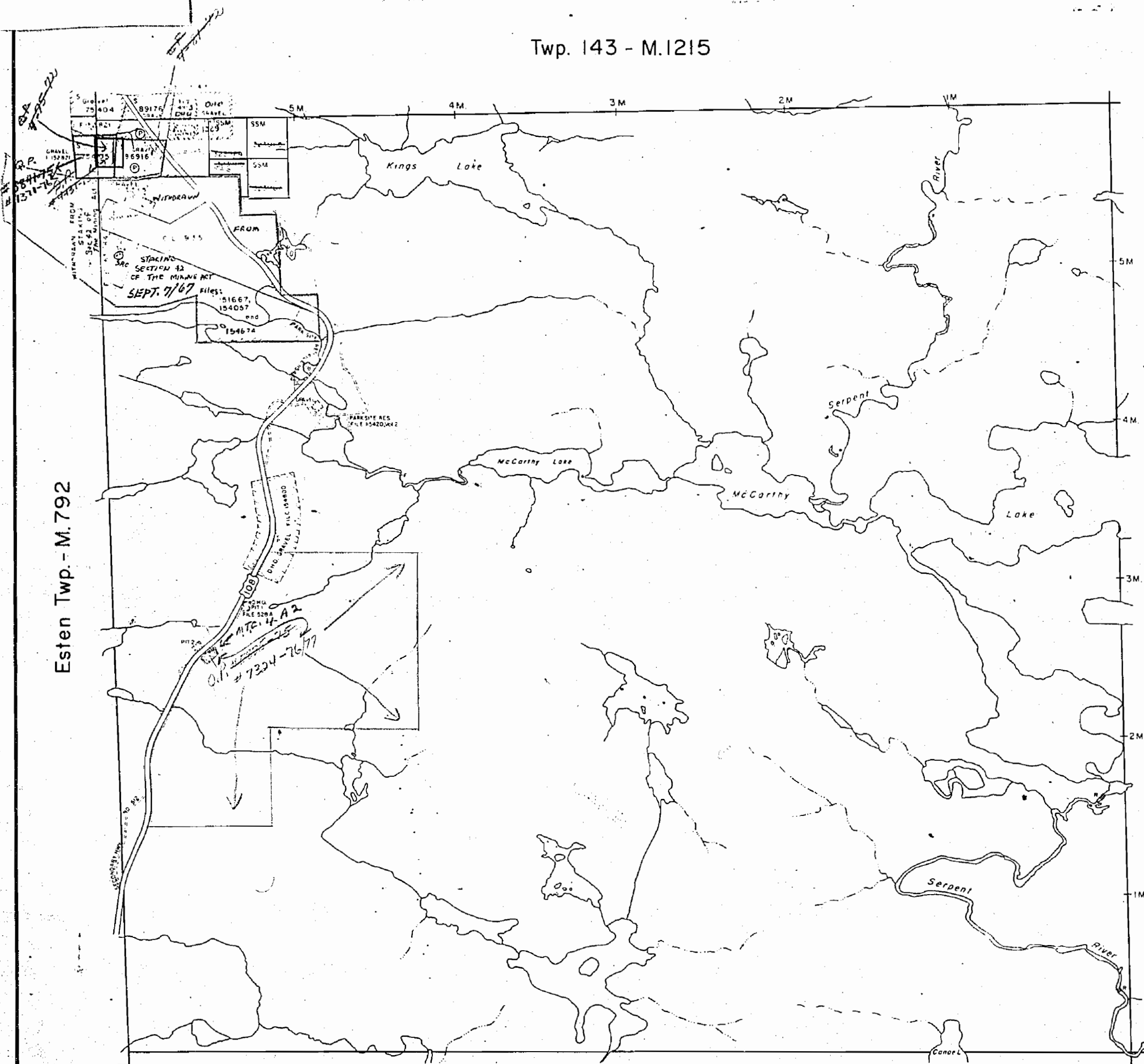



Twp. 143 - M.1215

*Withdrawn from staking  
Oct. 7/67*

O.P. # 1-3063  
Crown Land Elliot Lake

O.P. # 475-72

O.P. # 4-81-72

Esten Twp. - M.792

Deagle Twp. - M.750

Lewis Twp. - M.988

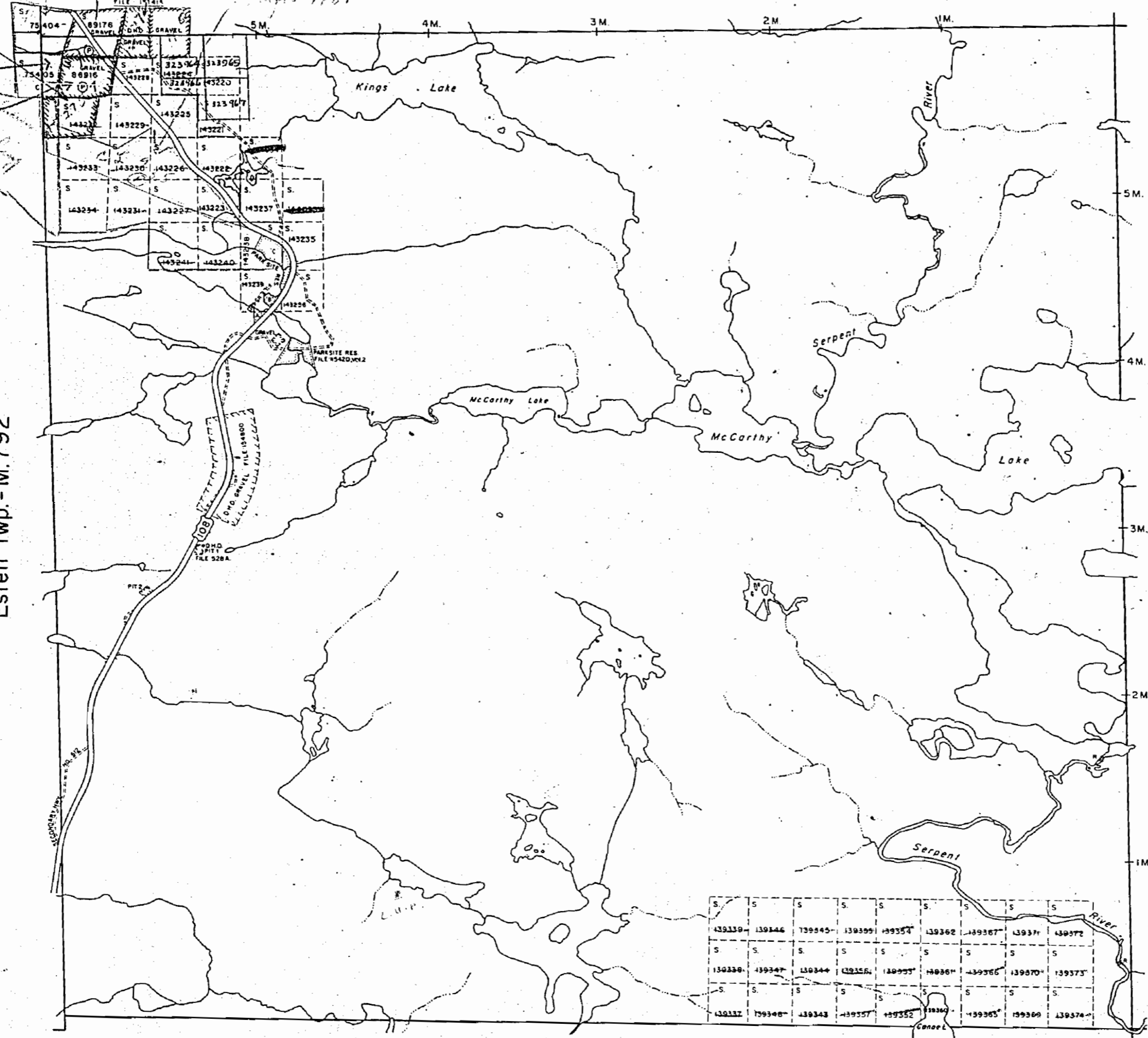

THE TOWNSHIP  
OF

# PROCTOR

DISTRICT OF  
ALGOMA

SUDBURY  
MINING DIVISION

SCALE: 1-INCH 40 CHAINS

### LEGEND

- PATENTED LAND Ⓟ
- CROWN LAND SALE C.S.
- LEASES Ⓞ
- LOCATED LAND Loc.
- LICENSE OF OCCUPATION L.O.
- MINING RIGHTS ONLY M.R.O.
- SURFACE RIGHTS ONLY S.R.O.
- ROADS — — — — —
- IMPROVED ROADS — — — — —
- KING'S HIGHWAYS — — — — —
- RAILWAYS — — — — —
- POWER LINES — — — — —
- MARSH OR MUSKEG — — — — —
- MINES X
- CANCELLED C

### NOTES

400' surface rights reservation around all lakes and rivers.

*July 30/68*

PLAN NO. **M.1064**

DEPARTMENT OF MINES

— ONTARIO —

**INDEX TO LAND DISPOSITION**

PLAN  
**G-3315**  
 TOWNSHIP

M.N.R. ADMINISTRATIVE DISTRICT  
**BLIND RIVER**  
 MINING DIVISION  
**SAULT STE. MARIE**  
 LAND TITLES/REGISTRY DIVISION  
**ALGOMA**

**PROCTOR**

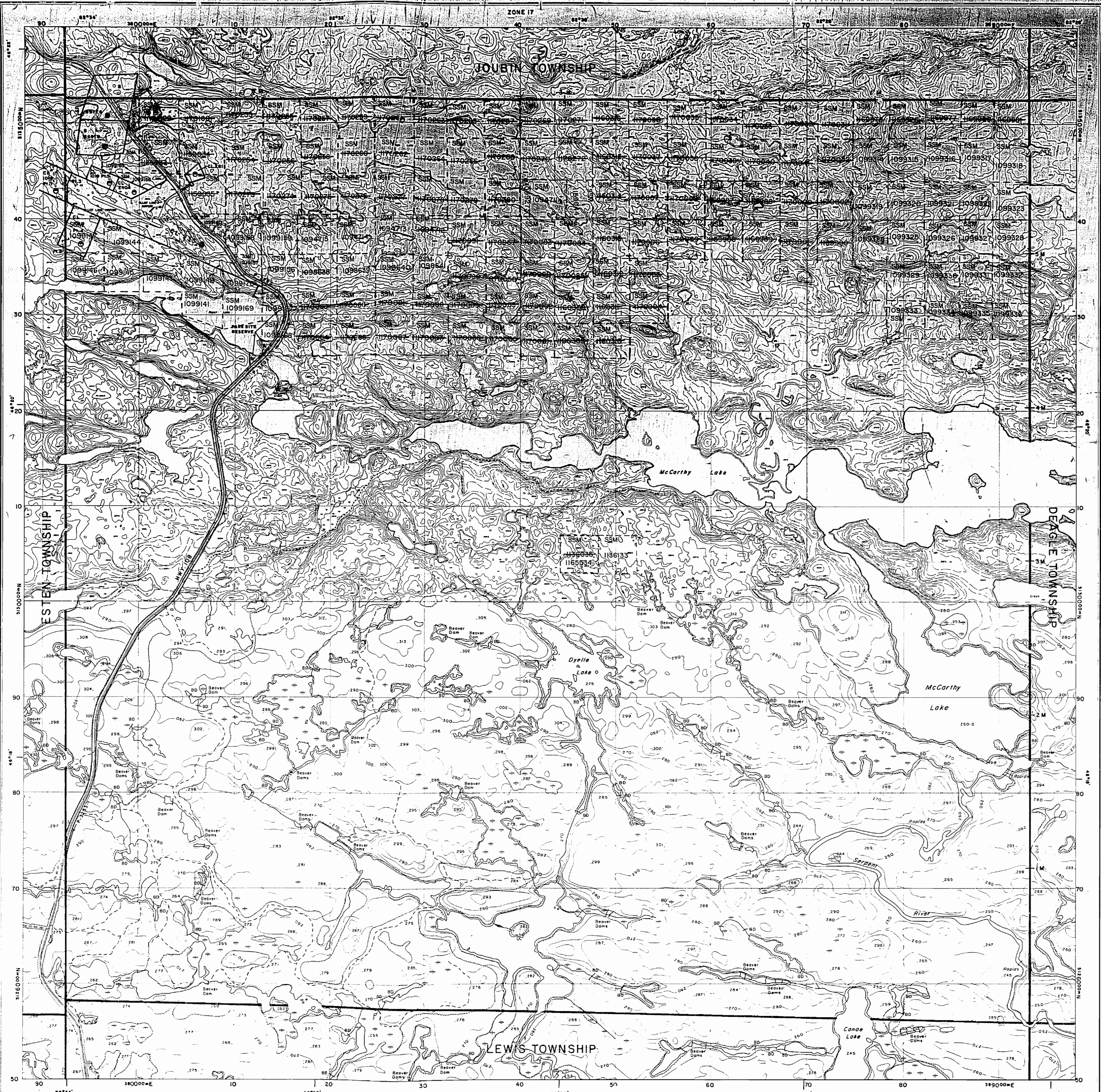
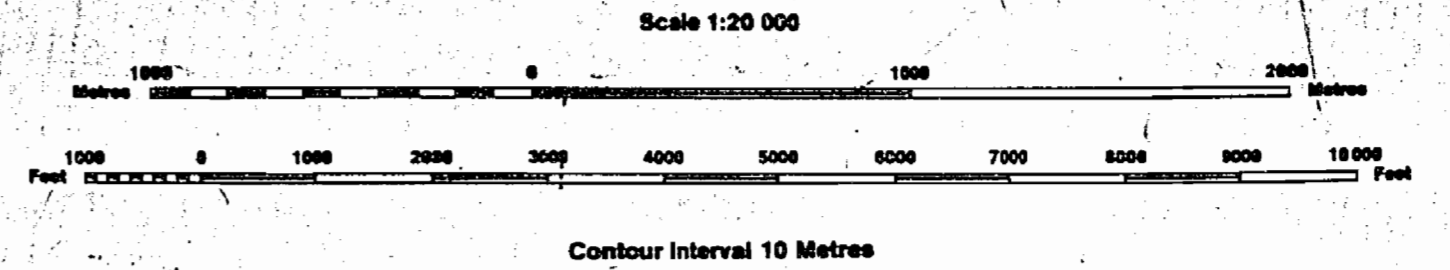

**AREAS WITHDRAWN FROM DISPOSITION**

- MRO - Mining Rights Only
- SRO - Surface Rights Only
- M+S - Mining and Surface Rights

**SYMBOLS**

Description	Order No.	Date	Disposition	File
Boundary				
Township, Meridian, Baseline				
Road allowance; surveyed				
shoreline				
Lot/Concession; surveyed				
unsurveyed				
Parcel; surveyed				
unsurveyed				
Right-of-way; road				
railway				
utility				
Reservation				
Cliff, Pit, Pile				
Contour				
Interpolated				
Approximate				
Depression				
Control point (horizontal)				
Flooded land				
Mine head frame				
Pipeline (above ground)				
Railway; single track				
double track				
abandoned				
Road; highway, county, township				
access				
trail, bush				
Shoreline (original)				
Transmission line				
Wooded area				

**NOTES**

THIS TOWNSHIP LIES WITHIN THE IMPROVEMENT DISTRICT OF ELLIOT LAKE.  
 \* Application under LVR Improvement Act (Down + Power Houses) See B.R. letter dated Aug 27/87.

**DISPOSITION OF CROWN LANDS**

Patent	
Surface & Mining Rights	●
Surface Rights Only	○
Mining Rights Only	○
Lease	
Surface & Mining Rights	■
Surface Rights Only	□
Mining Rights Only	□
Licence of Occupation	▼
Order-in-Council	OC
Cancelled	○
Reservation	○
Sand & Gravel	○

THE INFORMATION THAT APPEARS ON THIS MAP HAS BEEN COMPILED FROM VARIOUS SOURCES AND ACCURACY IS NOT GUARANTEED. THOSE WISHING TO STAKE MINING CLAIMS SHOULD CONSULT WITH THE MINING RECORDER, MINISTRY OF NORTHERN DEVELOPMENT AND MINES, FOR ADDITIONAL INFORMATION ON THE STATUS OF THE LANDS SHOWN HEREON.