

INDEX TO LAND DISPOSITION

PLAN G-3833 TOWNSHIPS SHENSTON and ROSEBERRY

THIS MYLAR PUT INTO SERVICE EFFECTIVE MARCH 30, 1995.

M.N.R. ADMINISTRATIVE DISTRICT FORT FRANCES MINING DIVISION KENORA LAND TITLES/REGISTRY DIVISION RAINY RIVER

THE INFORMATION THAT APPEARS ON THIS MAP HAS BEEN COMPILED FROM VARIOUS SOURCES AND ACCURACY IS NOT GUARANTEED. THOSE WISHING TO STAKE MINING CLAIMS SHOULD CONSULT WITH THE MINING RECORDER, MINISTRY OF NORTHERN DEVELOPMENT AND MINES FOR ADDITIONAL INFORMATION ON THE STATUS OF THE LANDS SHOWN HEREON.

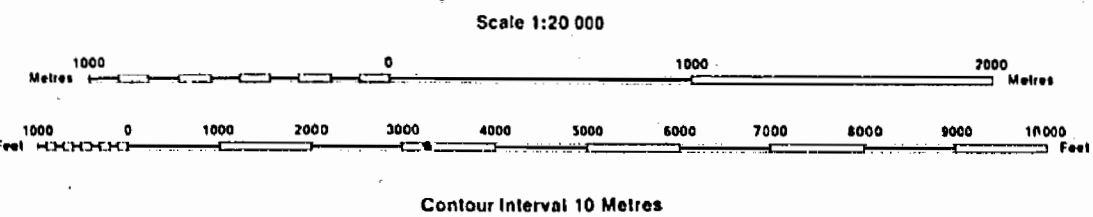

Map base and land disposition drafting by Surveys and Mapping Branch, Ministry of Natural Resources.

The disposition of land, location of lot fabric and parcel boundaries on this index was compiled for administrative purposes only.

SYMBOLS

- Boundary Township, Meridian, Baseline... Road allowance, surveyed... shoreline... Lot/Concession, surveyed... unsurveyed... Parcel, surveyed... unsurveyed... Right-of-way, road... railway... utility... Reservation... Cliff, Pit, Pile... Contour Interpolated... Approximate... Depression... Control point (horizontal)... Flooded land... Mine head frame... Pipeline (above ground)... Railway, single track... double track... abandoned... Road, highway, county, township... access... trail, bush... Shoreline (original)... Transmission line... Wooded area...

DISPOSITION OF CROWN LANDS

- Patent Surface & Mining Rights... Surface Rights Only... Mining Rights Only... Lease Surface & Mining Rights... Surface Rights Only... Mining Rights Only... Licence of Occupation... Order-in-Council... Cancelled... Reservation... Sand & Gravel

AREAS WITHDRAWN FROM DISPOSITION

- MRO - Mining Rights Only SRO - Surface Rights Only M+S - Mining and Surface Rights

Table with columns: Description, Order No., Date, Disposition, File

NOTES

LONG SAULT INDIAN LANDS SURRENDERED TO FEDERAL GOVERNMENT BY ORDER-IN-COUNCIL DATED APRIL 7, 1913 THIS TOWNSHIP LIES WITHIN THE CORPORATION OF THE TOWNSHIP OF CHAPPEL. FOR LOCATION OF LAND WITHIN SECTIONS 34 TO 36 REFER TO LOTS 1 TO 18 'RAIN' RIVER RANGE.

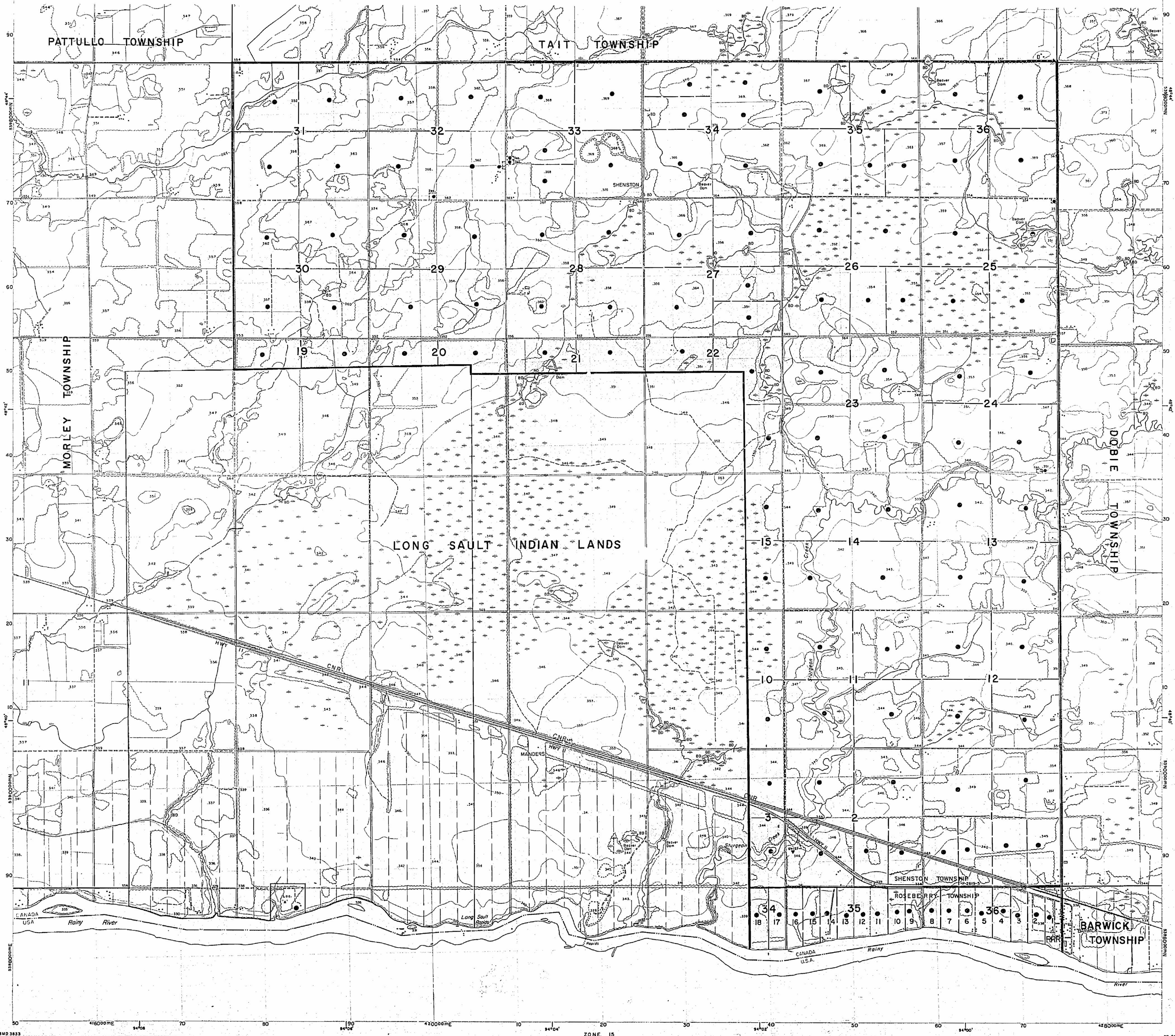



NOTES

400' surface rights reservation along the shores of all lakes and rivers.

Long Sault Indian Lands surrendered to Federal Government by Order-in-Council dated April 7, 1915

This Township lies within the Corporation of the Township of Chapple.

For location of land within Sections 34 to 36 refer to Lots 1 to 18 Rainy River Range

TAIT Tp. M.2124

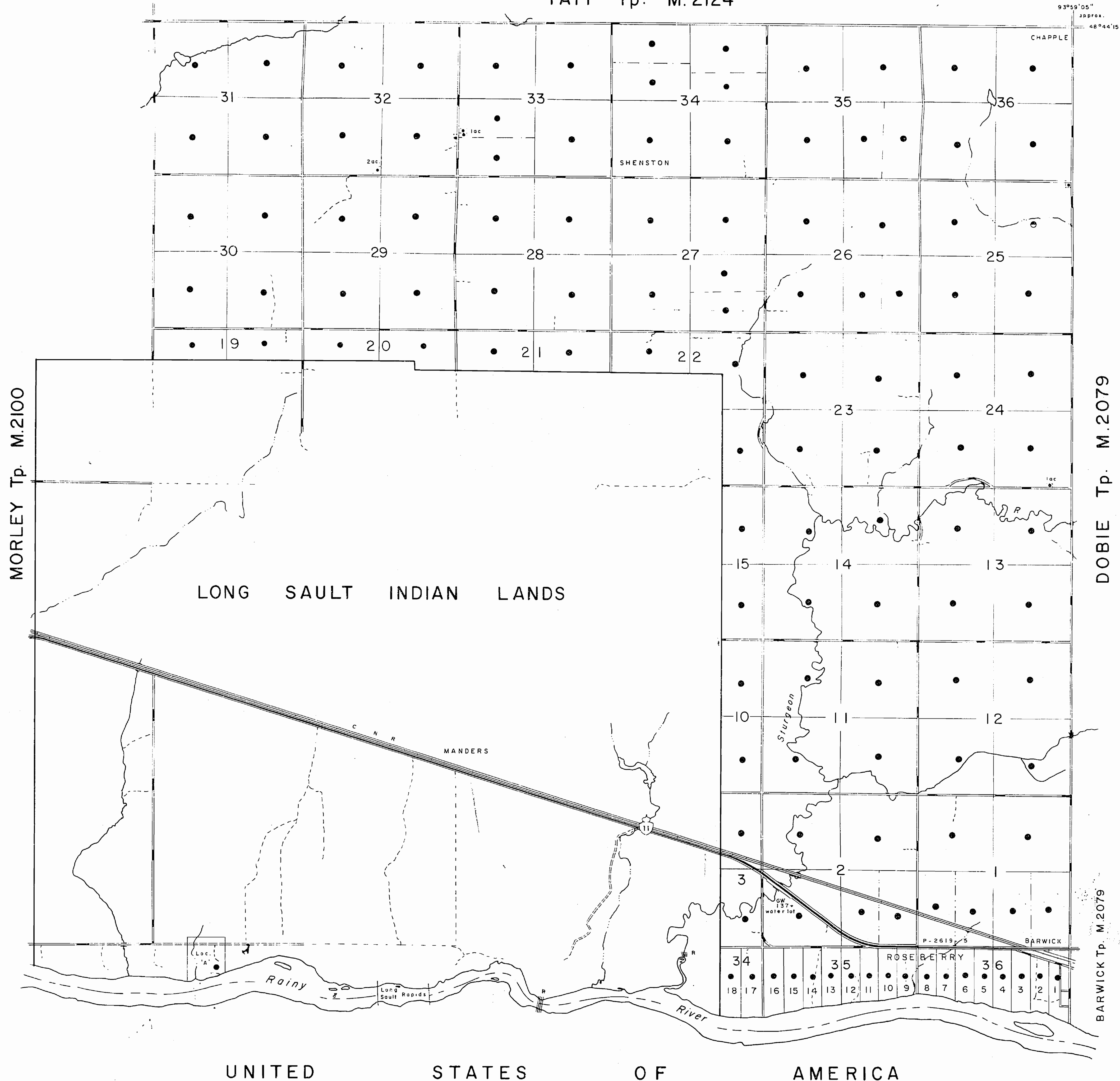

LEGEND

- HIGHWAY AND ROUTE No.
- OTHER ROADS
- TRAILS
- SURVEYED LINES:
  - TOWNSHIPS, BASE LINES, ETC.
  - LOTS, MINING CLAIMS, PARCELS, ETC.
- UNSURVEYED LINES:
  - LOT LINES
  - PARCEL BOUNDARY
  - MINING CLAIMS ETC.
- RAILWAY AND RIGHT OF WAY
- UTILITY LINES
- NON-PERENNIAL STREAM
- FLOODING OR FLOODING RIGHTS
- SUBDIVISION
- ORIGINAL SHORELINE
- MARSH OR MUSKEG
- MINES

DISPOSITION OF CROWN LANDS

TYPE OF DOCUMENT	SYMBOL
PATENT, SURFACE & MINING RIGHTS	
SURFACE RIGHTS ONLY	
MINING RIGHTS ONLY	
LEASE, SURFACE & MINING RIGHTS	
SURFACE RIGHTS ONLY	
MINING RIGHTS ONLY	
LICENCE OF OCCUPATION	
CROWN LAND SALE	C.S.
ORDER-IN-COUNCIL RESERVATION	OC
CANCELLED	
SAND & GRAVEL	

THE INFORMATION THAT APPEARS ON THIS MAP HAS BEEN COMPILED FROM VARIOUS SOURCES, AND ACCURACY IS NOT GUARANTEED. THOSE WISHING TO STAKE MINING CLAIMS SHOULD CONSULT WITH THE MINING RECORDER, MINISTRY OF NORTHERN DEVELOPMENT AND MINES, FOR ADDITIONAL INFORMATION ON THE STATUS OF THE LANDS SHOWN HEREON.

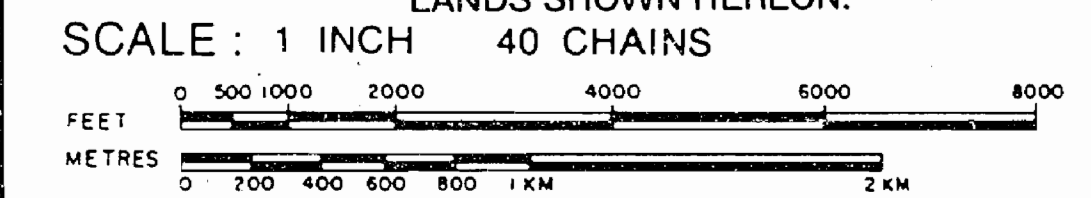

ACRES	HECTARES
40	16

TOWNSHIPS  
**SHENSTON and ROSEBERRY**  
 DISTRICT  
 RAINY RIVER  
 MINING DIVISION  
 KENORA

Ministry of Natural Resources  
 Ontario Surveys and Mapping Branch

Date 9-75 Plan No. **M.2120**

THIS MYLAR OUT OF SERVICE EFFECTIVE MAR.30/95

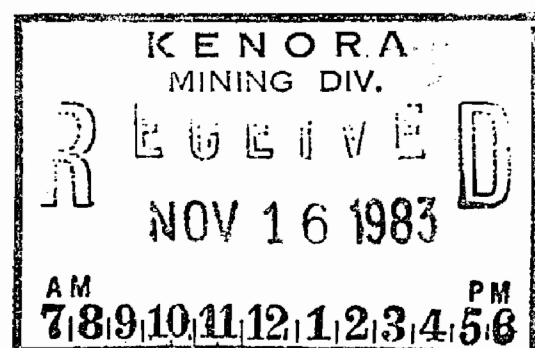

UNITED STATES OF AMERICA

NOTES

400' surface rights reservation along the shores of all lakes and rivers.

Long Sault Indian Lands surrendered to Federal Government by Order-in-Council dated April 7, 1915.

This Township lies within the Corporation of the Township of Chapple.

For location of land within Sections 34 to 36 refer to Lots 1 to 18 Rainy River Range

DATE OF ISSUE  
MAY 30 1983  
Ministry of Natural Resources  
TORONTO

Linen effective →  
KENORA MINING DIV.  
**RECEIVED**  
JUN 2 1983  
AM 7:8 9:10 11:12 1:2 3:4 5:6 PM

TAIT Tp. M.2124

MORLEY Tp. M.2100

DOBIE Tp. M.2079

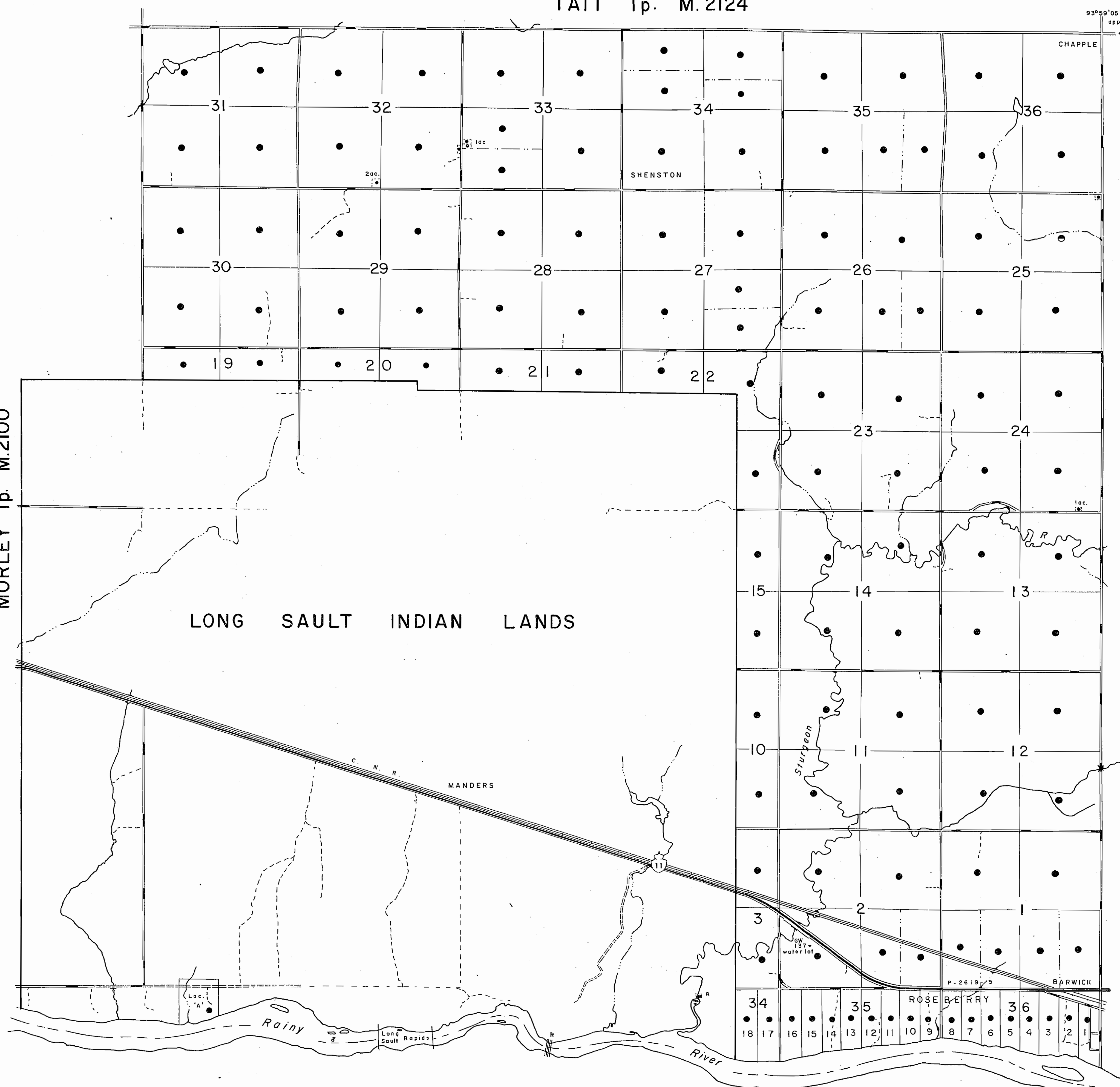

LEGEND

- HIGHWAY AND ROUTE No.
- OTHER ROADS
- TRAILS
- SURVEYED LINES:  
TOWNSHIPS, BASE LINES, ETC.
- LOTS, MINING CLAIMS, PARCELS, ETC.
- UNSURVEYED LINES:  
LOT LINES
- PARCEL BOUNDARY
- MINING CLAIMS ETC.
- RAILWAY AND RIGHT OF WAY
- UTILITY LINES
- NON-PERENNIAL STREAM
- FLOODING OR FLOODING RIGHTS
- SUBDIVISION
- ORIGINAL SHORELINE
- MARSH OR MUSKEG
- MINES

DISPOSITION OF CROWN LANDS

TYPE OF DOCUMENT	SYMBOL
PATENT, SURFACE & MINING RIGHTS	●
" SURFACE RIGHTS ONLY	○
" MINING RIGHTS ONLY	◐
LEASE, SURFACE & MINING RIGHTS	■
" SURFACE RIGHTS ONLY	□
" MINING RIGHTS ONLY	◻
LICENCE OF OCCUPATION	▼
CROWN LAND SALE	C.S.
ORDER-IN-COUNCIL	OC
RESERVATION	⊙
CANCELLED	⊗
SAND & GRAVEL	⊕

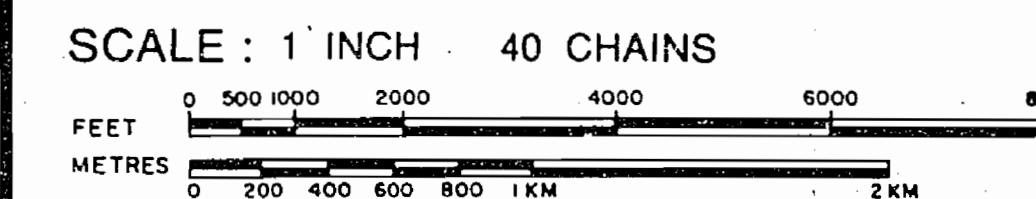

ACRES	HECTARES
40	16

TOWNSHIPS  
**SHENSTON and ROSEBERRY**

DISTRICT  
RAINY RIVER  
MINING DIVISION  
KENORA

Ministry of Natural Resources  
Ontario Surveys and Mapping Branch

Date 9-75 Plan No. M.2120  
Whitney Block  
Queen's Park, Toronto

UNITED STATES OF AMERICA

BARWICK Tp. M.2079