

1100



# SEMPLÉ

SUDBURY MINING DIVISION

Scale 40 Chains = 1 Inch

ENGLISH

MOHER

HUTT

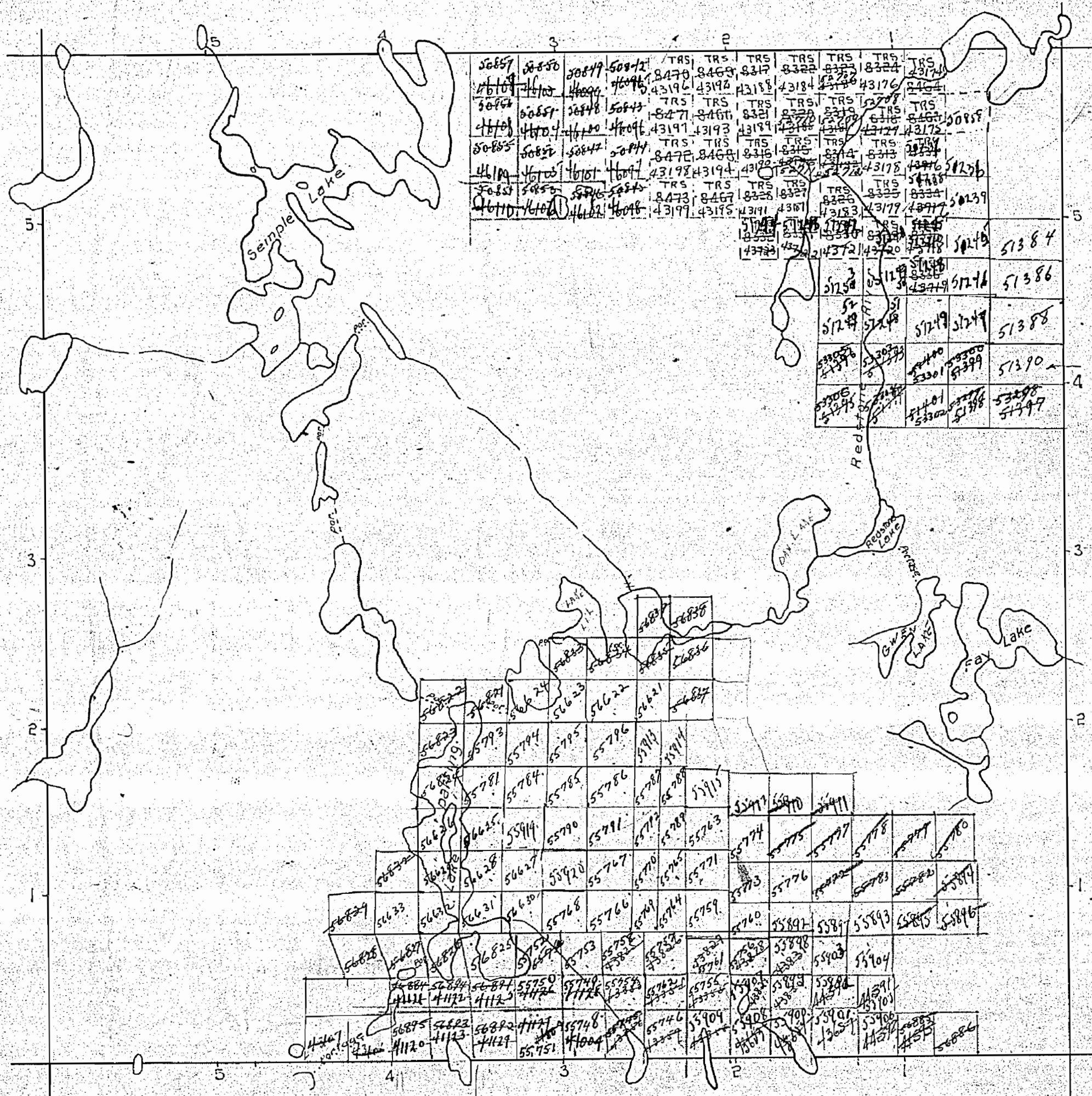

SOTHMAN

M1100



1100

ENGLISH TWP. M-787

NOTES

400' surface rights reservation along the shores of all lakes and rivers.

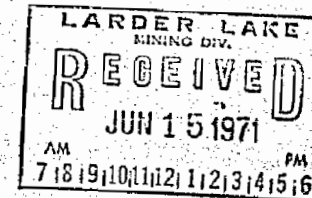
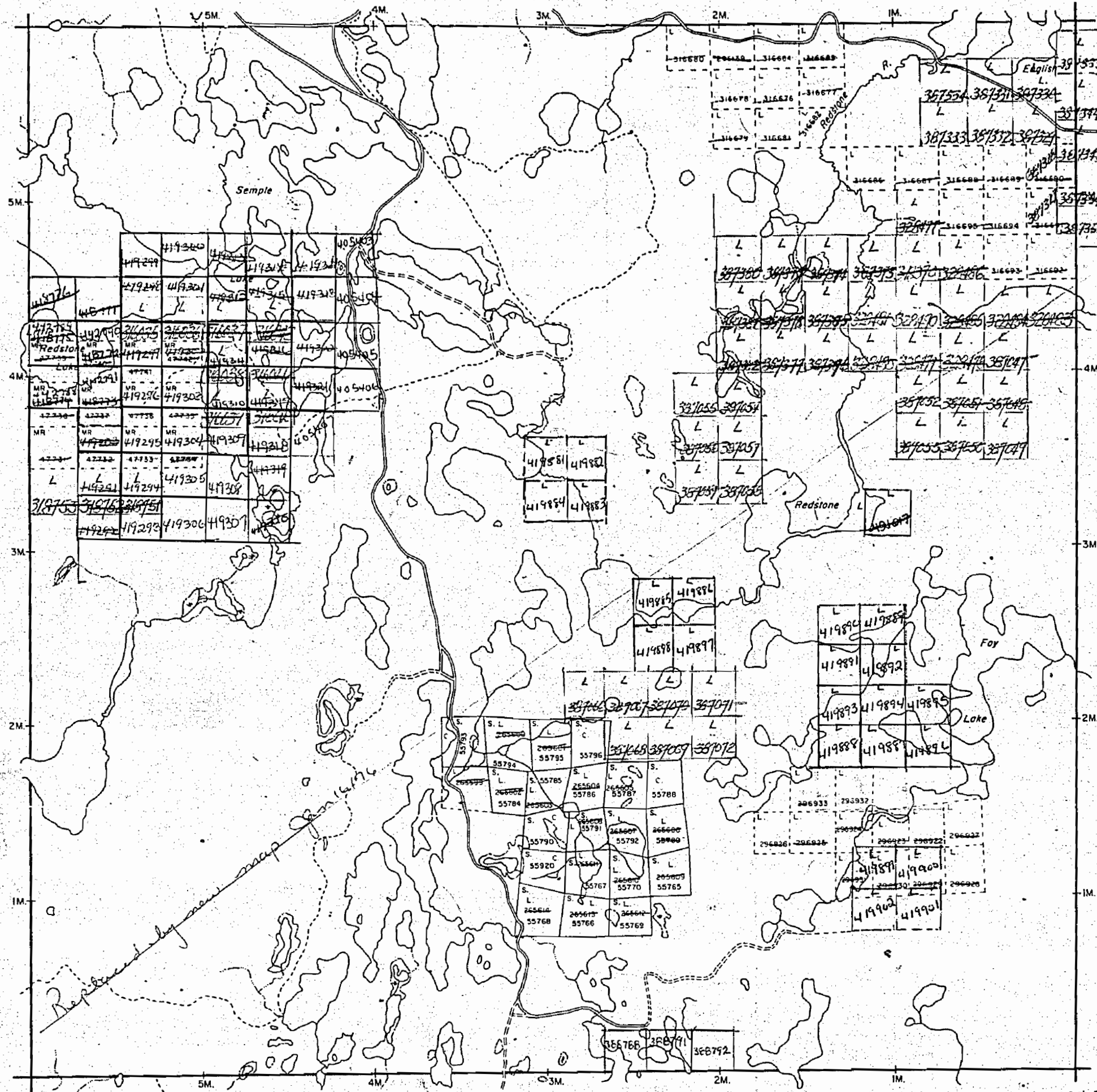

LEGEND

- PATENTED LAND P or ●
  - PATENTED FOR SURFACE RIGHTS ONLY ○
  - LEASE L
  - LICENSE OF OCCUPATION L.O.
  - CROWN LAND SALES C.S.
  - LOCATED LAND Loc.
  - CANCELLED C.
  - MINING RIGHTS ONLY M.R.O.
  - SURFACE RIGHTS ONLY S.R.O.
  - HIGHWAY & ROUTE NO.
  - ROADS
  - TRAILS
  - RAILWAYS
  - POWER LINES
  - MARSH OR MUSKEG
  - MINES
- \*used only with summer resort locations or when space is limited

TOWNSHIP OF

**SEMPLÉ**

DISTRICT OF  
SUDBURY

LARDER LAKE  
MINING DIVISION

SCALE: 1 INCH = 40 CHAINS (1/2 MILE)

DR. R.W. NOBLE  
DATE APR. 22, 71

PLAN NO. **M-1100**

ONTARIO #9  
DEPARTMENT OF MINES  
AND NORTHERN AFFAIRS

0011-M

0011-M

ENGLISH TWP. M-787

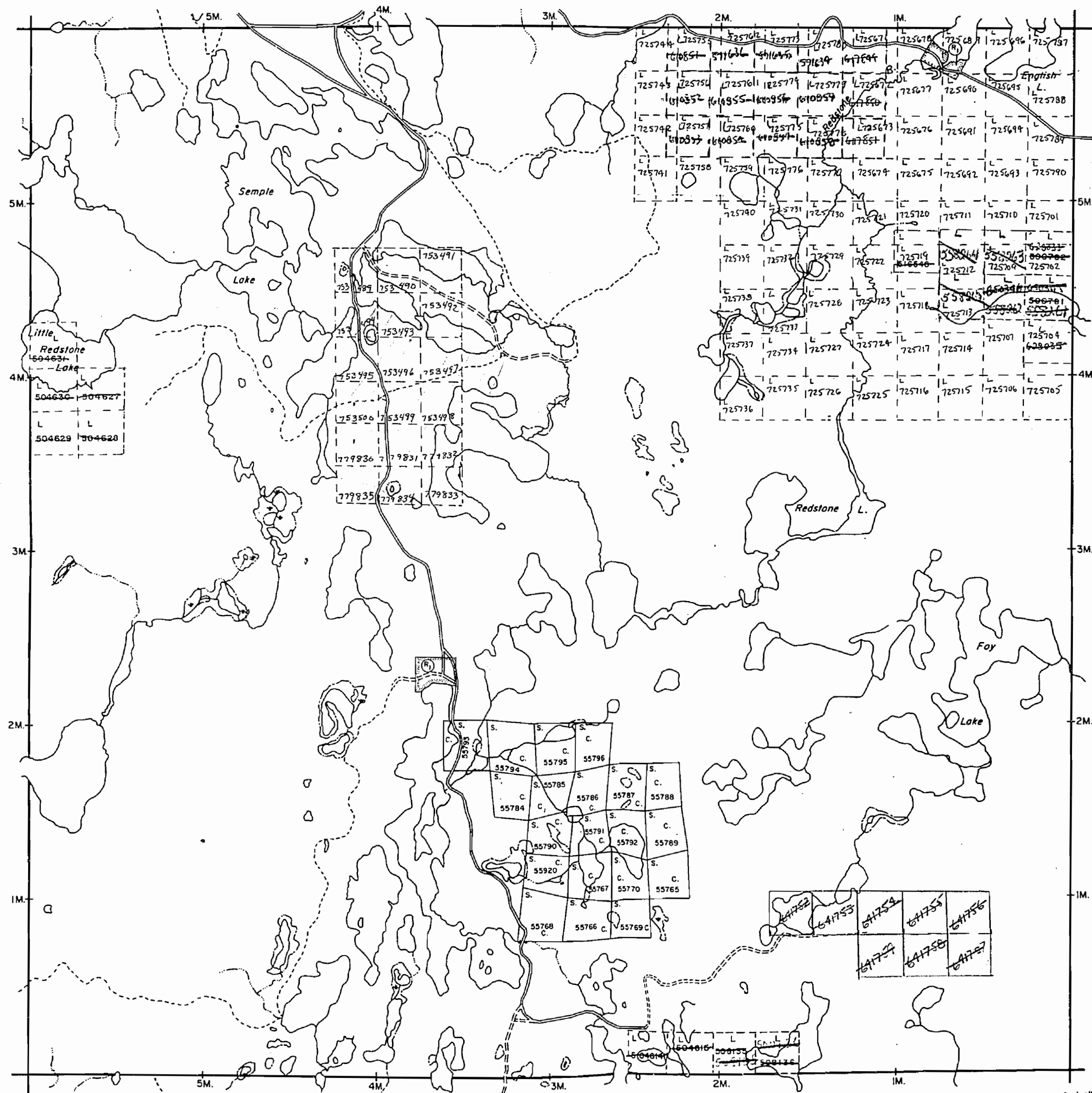

NOTES

400' surface rights reservation along the shores of all lakes and rivers.

Areas withdrawn from staking under Section 43 - of the Mining Act, (R.S.O. 1970)

Order #	File	Date	Disposition
W.19/78	188543	10/4/78	S.R.O.

Area of prescribed burn 1982

LEGEND

- PATENTED LAND ⊙ or ●
  - PATENTED FOR SURFACE RIGHTS ONLY ⊙
  - LEASE ⊙
  - LICENSE OF OCCUPATION L.O.
  - CROWN LAND SALES C.S.
  - LOCATED LAND Loc.
  - CANCELLED C.
  - MINING RIGHTS ONLY M.R.O.
  - SURFACE RIGHTS ONLY S.R.O.
  - HIGHWAY & ROUTE NO. 17
  - ROADS —
  - TRAILS - - -
  - RAILWAYS =
  - POWER LINES —
  - MARSH OR MUSKEG ~
  - MINES \*
- \*used only with summer resort locations or when space is limited

TOWNSHIP OF

SEMPLÉ

DISTRICT OF SUDBURY

LARDER LAKE MINING DIVISION

SCALE: 1 INCH = 40 CHAINS (1/2 MILE)

DR. R.W. NOBLE  
DATE APR. 22, 71

PLAN NO. M-1100

ONTARIO  
MINISTRY OF NATURAL RESOURCES  
SURVEYS AND MAPPING BRANCH

SEMPLÉ TWP

SEMPLÉ TWP

M-1100

M-1100

47°55'45" APPROX.  
81°12'15"

# 9

REPLACED August 27-1984



Removed From Service Apr. 24/90

ENGLISH TWP. M-787

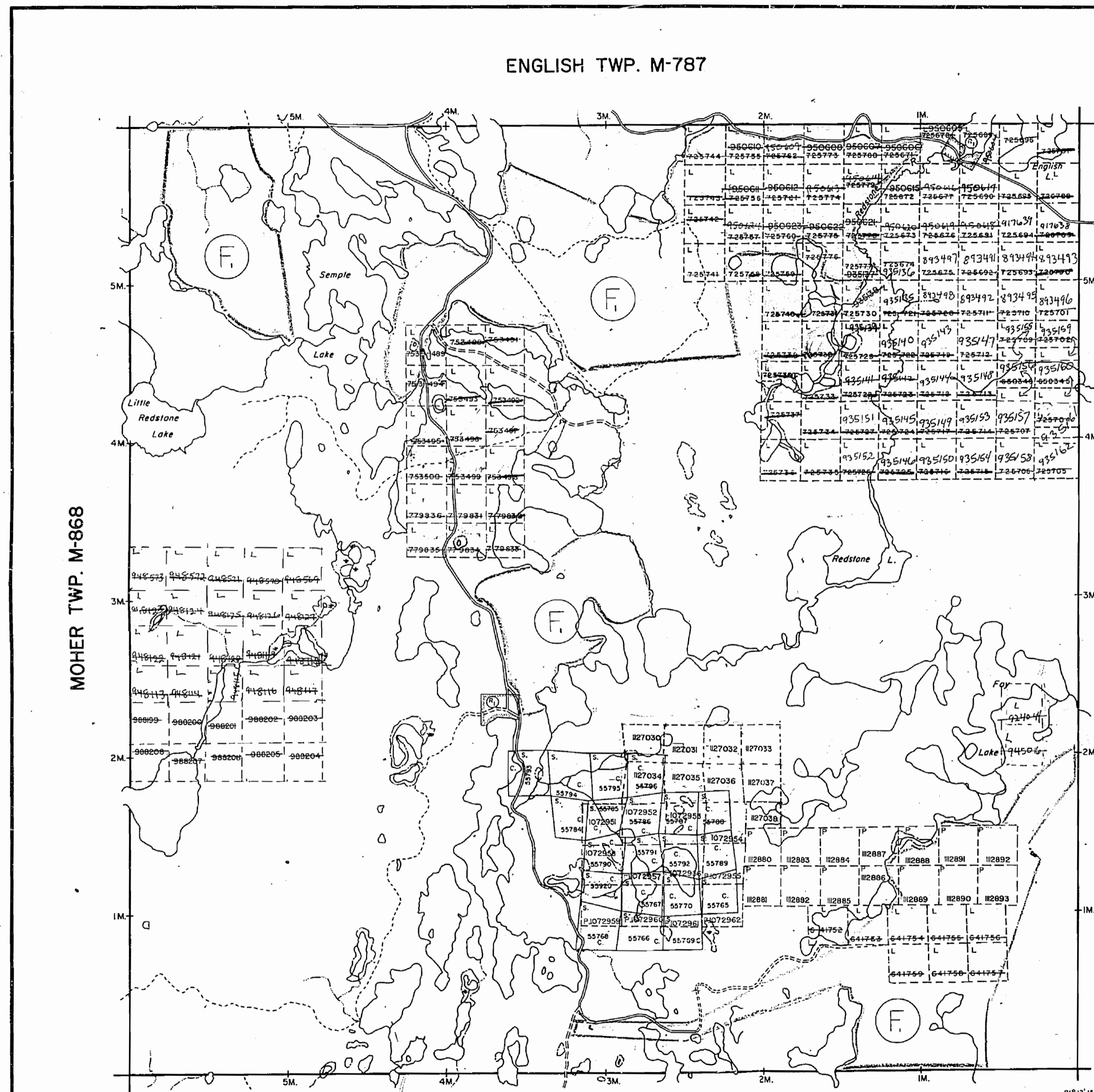

**NOTES**

400' surface rights reservation along the shores of all lakes and rivers.

Areas withdrawn from staking under Section 43 of the Mining Act, (R.S.O. 1970)

Order	File	Date	Disposition
(A) W.19/78	188543	10/4/78	S.R.O.

(F) THIS TWP. IS SUBJECT TO FOREST ACTIVITIES IN 1990. FURTHER INFORMATION AVAILABLE ON FILE.

THE INFORMATION THAT APPEARS ON THIS MAP HAS BEEN COMPILED FROM VARIOUS SOURCES, AND ACCURACY IS NOT GUARANTEED. THOSE WISHING TO STAKE MINING CLAIMS SHOULD CONSULT WITH THE MINING RECORDER, MINISTRY OF NORTHERN DEVELOPMENT AND MINES, FOR ADDITIONAL INFORMATION ON THE STATUS OF THE LANDS SHOWN HEREON.

**LEGEND**

PATENTED LAND	(P) or *
PATENTED FOR SURFACE RIGHTS ONLY	(P)
LEASE	(L)
LICENSE OF OCCUPATION	L.O.
CROWN LAND SALES	C.S.
LOCATED LAND	Loc.
CANCELLED	C.
MINING RIGHTS ONLY	M.R.O.
SURFACE RIGHTS ONLY	S.R.O.
HIGHWAY & ROUTE NO.	17
ROADS	—
TRAILS	---
RAILWAYS	—+—
POWER LINES	—+—+—
MARSH OR MUSKEG	(M)
MINES	X

\*used only with summer resort locations or when space is limited

TOWNSHIP OF  
**SEMPL E**  
 DISTRICT OF  
 SUDBURY  
**PORCUPINE**  
 MINING DIVISION  
 SCALE: 1 INCH = 40 CHAINS (1/2 MILE) #9

DR. R.W. NOBLE  
 DATE APR. 22, 71  
 PLAN NO. **M-1100**

ONTARIO  
 MINISTRY OF NATURAL RESOURCES  
 SURVEYS AND MAPPING BRANCH

SOTHMAN TWP. M-1121

Rec'd. August 20/84 NB.

0011-M

SEMPL E TWP

M-1100

0011-M

SEMPL E TWP

0011-M

ENGLISH TWP. M-787

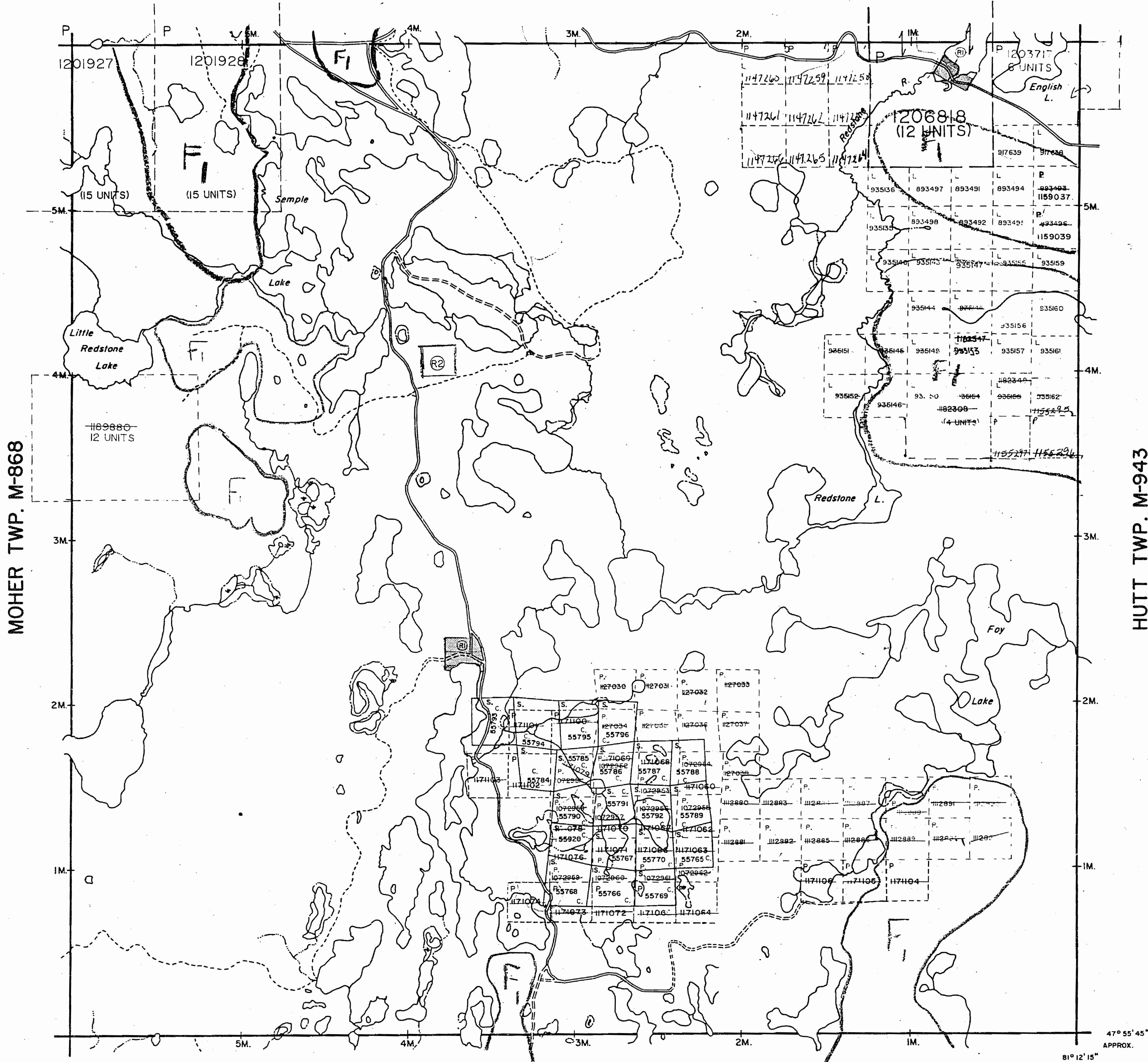

NOTES

400' surface rights reservation along the shores of all lakes and rivers.

SUBJECT TO FORESTRY ACTIVITY IN 1994/95 1995/96

Areas withdrawn from staking under Section 43 of the Mining Act(R.S.O. 1970)

Order	File	Date	Disposition
(R1)	W.19 / 78	188543	10 / 4 / 76 S.R.O.
(R2)	MINING AND SURFACE RIGHTS WITHDRAWN FROM PROSPECTING, STAKING OUT, SALE OR LEASE UNDER SECTION 35 OF THE MINING ACT R.S.O. 1990 ORDER NO. W-P 44/94 NER DATED 94-MAY-02		

ACTIVATED APRIL 24, 1990 D.C.

LEGEND

- PATENTED LAND (P or \*)
  - PATENTED FOR SURFACE RIGHTS ONLY (P or \*)
  - LEASE (L)
  - LICENSE OF OCCUPATION (L.O.)
  - CROWN LAND SALES (C.S.)
  - LOCATED LAND (Loc.)
  - CANCELLED (C)
  - MINING RIGHTS ONLY (M.R.O.)
  - SURFACE RIGHTS ONLY (S.R.O.)
  - HIGHWAY & ROUTE NO. (17)
  - ROADS (— — — — —)
  - TRAILS (— · — · — · —)
  - RAILWAYS (— + — + — + —)
  - POWER LINES (— — — — —)
  - MARSH OR MUSKEG (— ~ — ~ — ~ —)
  - MINES (X)
- \*used only with summer resort locations or when space is limited

TOWNSHIP OF

**SEMPLÉ**

DATE OF ISSUE NOV 25 1997 DISTRICT OF SUDBURY

PROVINCIAL RECORDING OFFICE - SUDBURY PORCUPINE MINING DIVISION

SCALE : 1 INCH = 40 CHAINS (1/2 MILE)

DR. R.W. NOBLF PLAN NO. **M-1100**  
DATE APR. 22, 71

ONTARIO DEPARTMENT OF MINES AND NORTHERN AFFAIRS

SOTHMAN TWP. M-1121

IN THAT THIS MAP IS COMPILED FROM SOURCES WHICH ARE NOT GUARANTEED TO BE MINIMUM CONSTRUCTION OF VELOCITY FOR ADJUSTMENT OF THE RECORD.

47° 55' 45" APPROX.  
81° 12' 15"



ENGLISH TWP. M-787

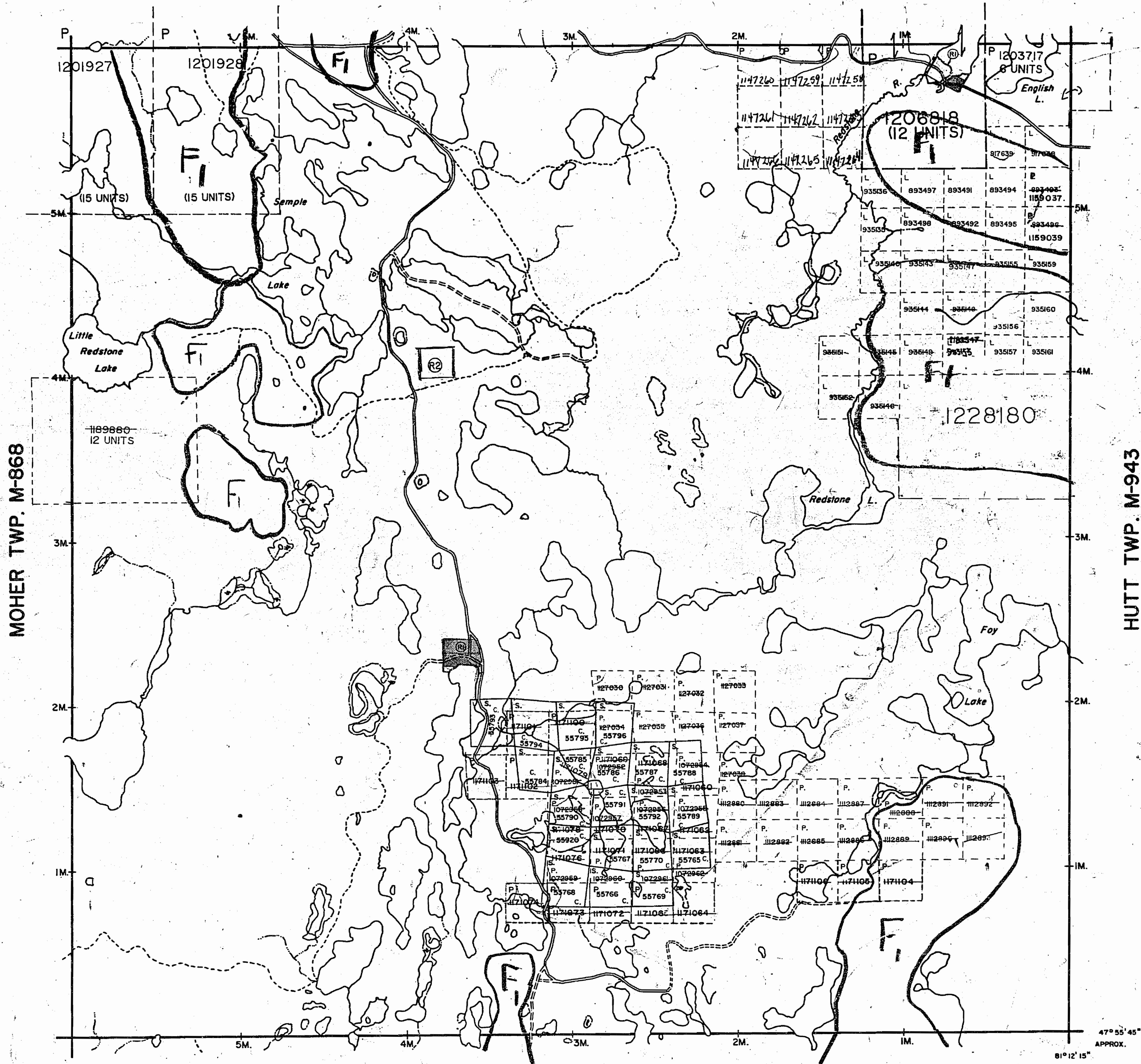

MOHER TWP. M-868

HUTT TWP. M-943

SOTHMAN TWP. M-121

NOTES

400' surface rights reservation along the shores of all lakes and rivers.

F - SUBJECT TO FORESTRY ACTIVITY IN 1994/95 1995/96

Areas withdrawn from staking under Section 43 of the Mining Act (R.S.O. 1970)

Order	File	Date	Disposition
(R)	W.19 / 78	188543	10 / 4 / 78 S.R.O.
(R2)	MINING AND SURFACE RIGHTS WITHDRAWN FROM PROSPECTING, STAKING OUT, SALE OR LEASE UNDER SECTION 35 OF THE MINING ACT R.S.O. 1990 ORDER NO. W-P 44/94 NER DATED 94-MAY-02		

(R) W.19 / 78 188543 10 / 4 / 78 S.R.O.

(R2) MINING AND SURFACE RIGHTS WITHDRAWN FROM PROSPECTING, STAKING OUT, SALE OR LEASE UNDER SECTION 35 OF THE MINING ACT R.S.O. 1990 ORDER NO. W-P 44/94 NER DATED 94-MAY-02

DATE OF ISSUE

MAY 5 1998

PROVINCIAL RECORDING OFFICE SUDBURY

ACTIVATED APRIL 24, 1990 D.C.

LEGEND

- PATENTED LAND (P) or \*
- PATENTED FOR SURFACE RIGHTS ONLY (P) or \*
- LEASE (L)
- LICENSE OF OCCUPATION L.O.
- CROWN LAND SALES C.S.
- LOCATED LAND Loc.
- CANCELLED C.
- MINING RIGHTS ONLY M.R.O.
- SURFACE RIGHTS ONLY S.R.O.
- HIGHWAY & ROUTE NO. (17)
- ROADS ---
- TRAILS ---
- RAILWAYS ---
- POWER LINES ---
- MARSH OR MUSKEG ---
- MINES ---

\*used only with summer resort locations or when space is limited

TOWNSHIP OF

**SEMPLÉ**

DISTRICT OF SUDBURY

PORCUPINE MINING DIVISION

SCALE : 1 INCH = 40 CHAINS (1/2 MILE)

DR. R.W. NOBLE

DATE APR. 22, 71

PLAN NO. **M-1100**

ONTARIO DEPARTMENT OF MINES AND NORTHERN AFFAIRS

ATION THAT THIS MAP COMPILED S SOURCES, CY IS NOT D. THOSE STAKE MIN- HOULD CON- THE MINING INDUSTRY OF DEVELOP- NES, FOR AD- FORMATION US OF THE N HEREON.

47° 55' 45" 81° 12' 15" APPROX.



1100

# SEMPLE

MONTREAL RIVER MINING DIVISION

Scale 40 Chains = 1 inch

M-1100

ENGLISH

MOHER

HUTT

SOTHMAN

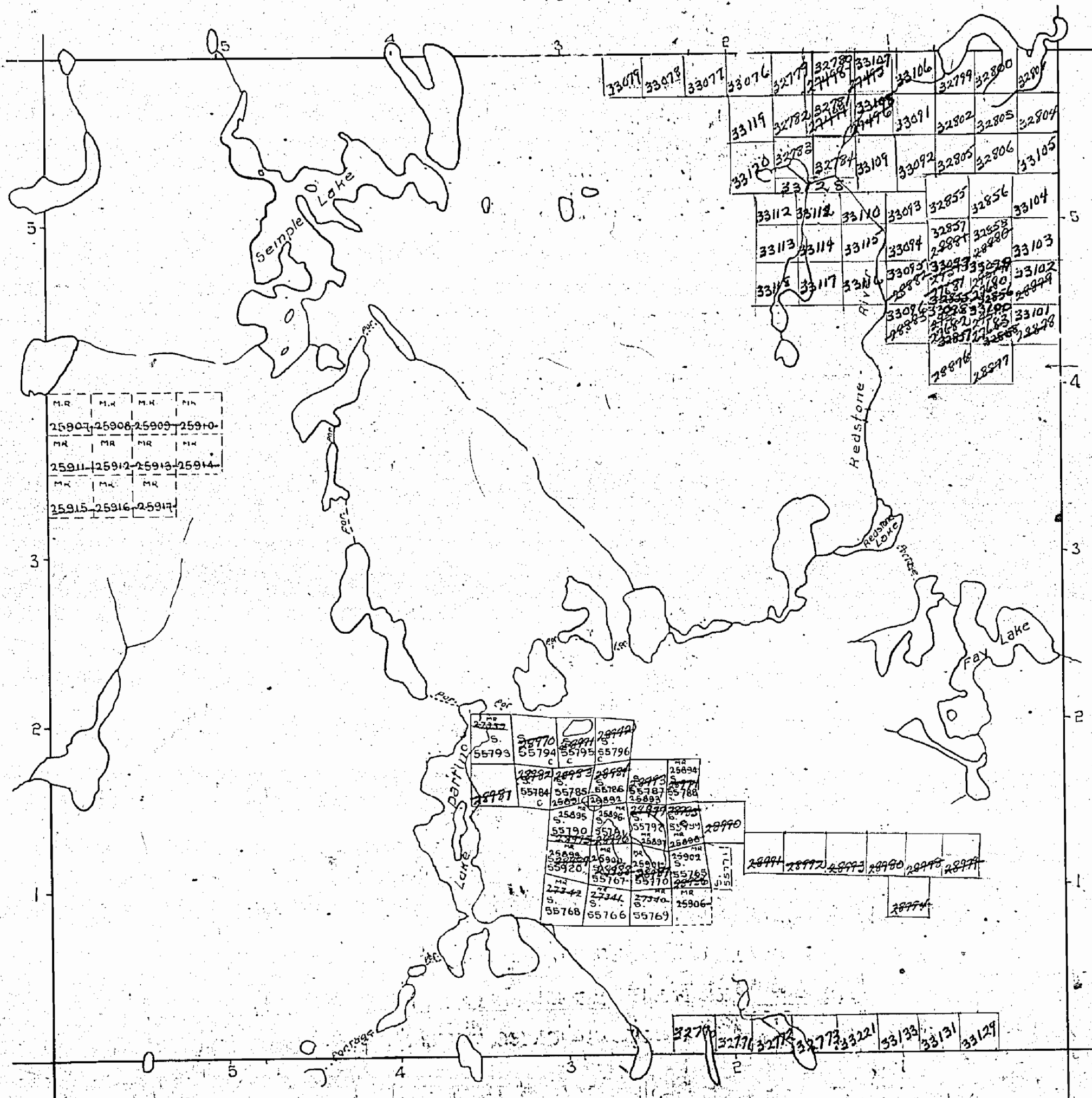



1100

MONTREAL RIVER MINNEAPOLIS  
ENGLISH

MOHER

HUTT

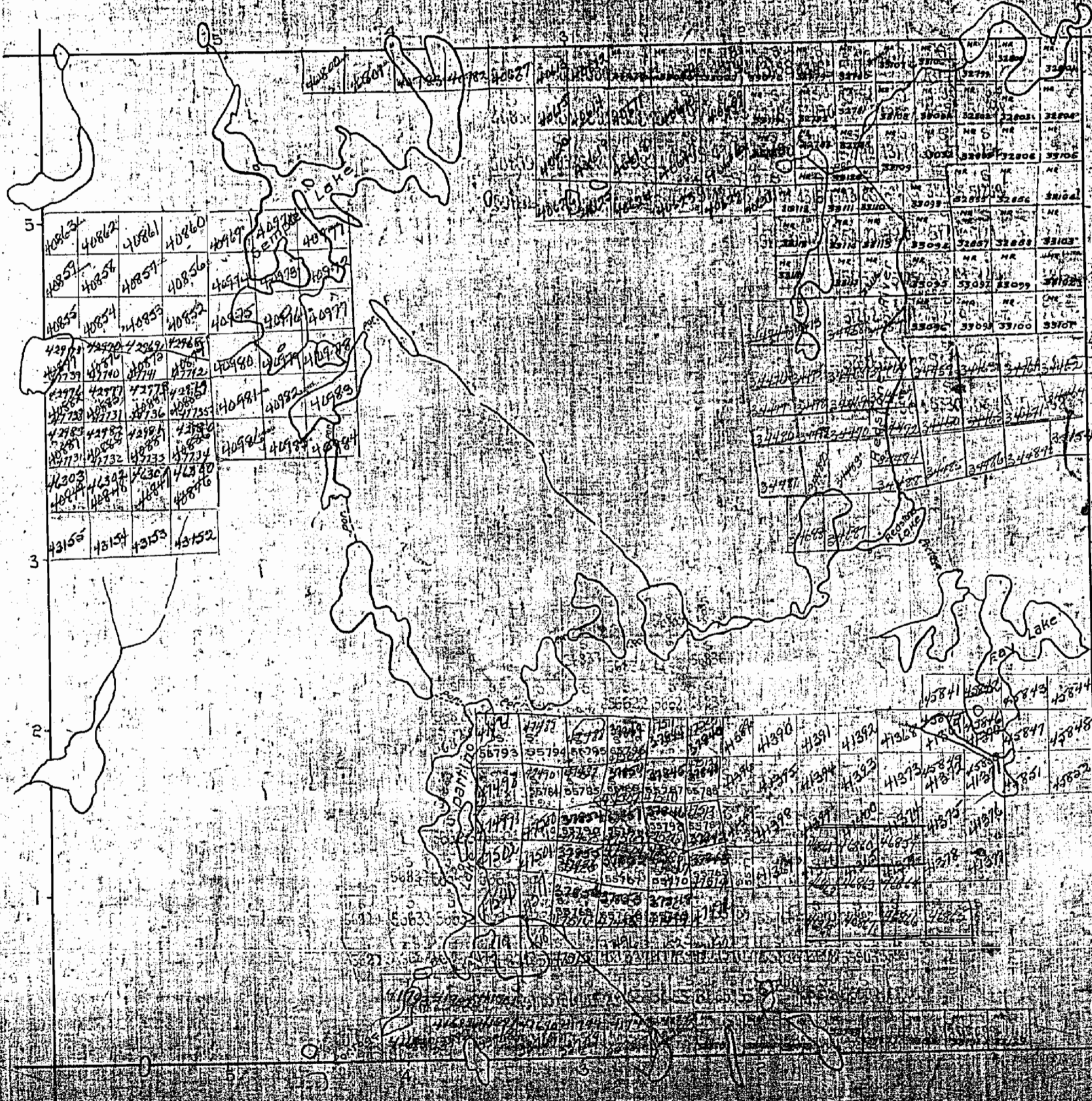







1100

# SEMPLE

SUDBURY MINING DIVISION

Scale 40 Chains = 1 Inch

M-1100

ENGLISH

SEMPLE

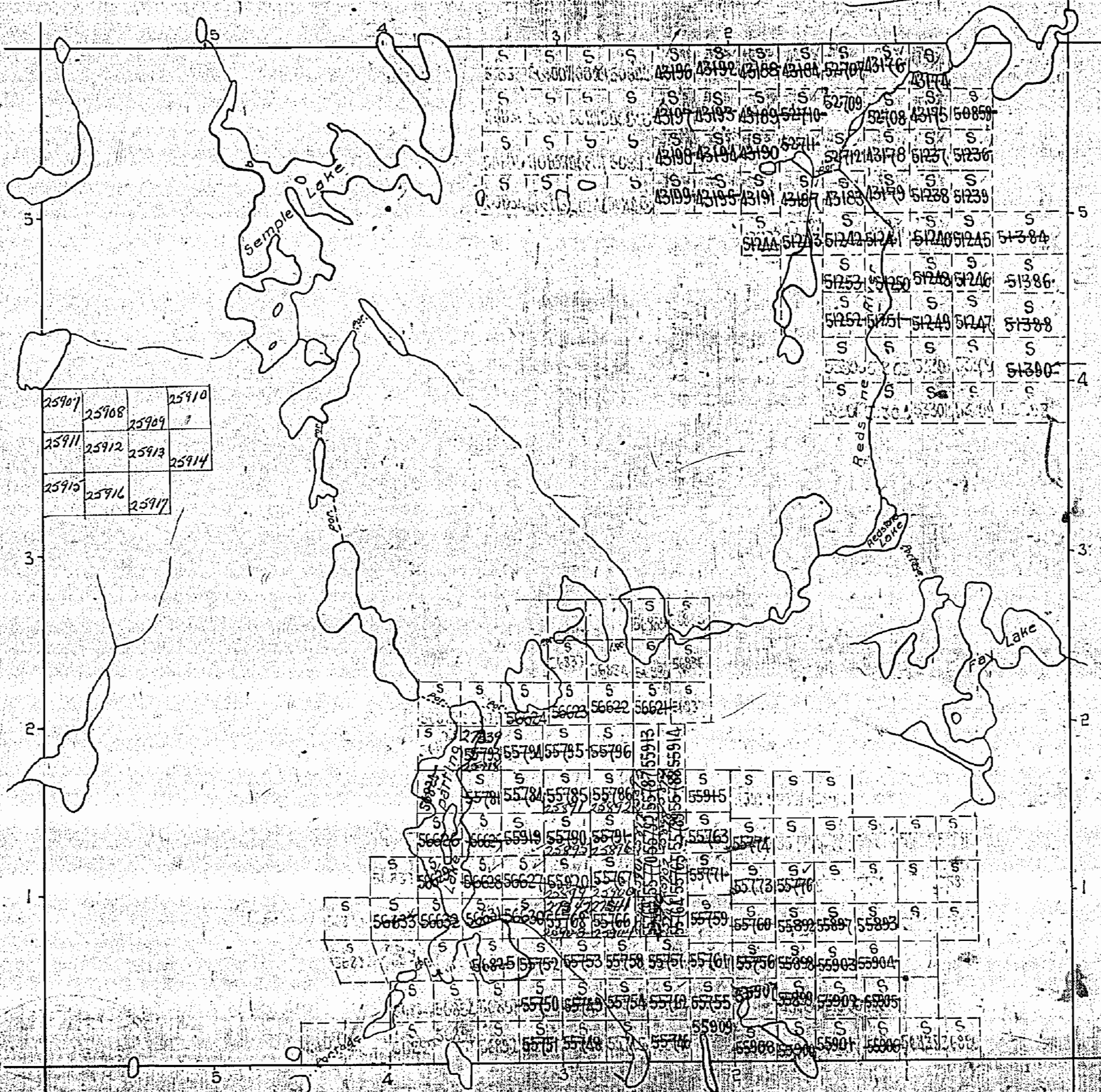

MOHER

HUTT

SOTHMAN



ENGLISH TWP. M-787

NOTES

400' surface rights reservation along the shores of all lakes and rivers.

F - SUBJECT TO FORESTY ACTIVITY IN 1994/95 1995/96

Areas withdrawn from staking under Section 43 of the Mining Act (R.S.O. 1970)

Order File Date Disposition

(R1) W.19 / 78 188543 10 / 4 / 78 S.R.O.

(R2) MINING AND SURFACE RIGHTS WITHDRAWN FROM PROSPECTING, STAKING OUT, SALE OR LEASE UNDER SECTION 35 OF THE MINING ACT R.S.O. 1990 ORDER NO. W-P 44/94 NER DATED 94-MAY-02

ACTIVATED APRIL 24, 1990 D.C.

LEGEND

- PATENTED LAND (P or ●\*)
- PATENTED FOR SURFACE RIGHTS ONLY (●\*)
- LEASE (L)
- LICENSE OF OCCUPATION (L.O.)
- CROWN LAND SALES (C.S.)
- LOCATED LAND (Loc.)
- CANCELLED (C.)
- MINING RIGHTS ONLY (M.R.O.)
- SURFACE RIGHTS ONLY (S.R.O.)
- HIGHWAY & ROUTE NO. (17)
- ROADS (—)
- TRAILS (---)
- RAILWAYS (—+—)
- POWER LINES (—+—)
- MARSH OR MUSKEG (—+—)
- MINES (X)

\*used only with summer resort locations or when space is limited

TOWNSHIP OF

**SEMPLÉ**

DISTRICT OF  
SUBBURY

PORCUPINE  
MINING DIVISION

SCALE : 1 INCH = 40 CHAINS (1/2 MILE)

DR. R.W. NOBLE  
DATE APR. 22, 71

PLAN NO. **M-1100**

ONTARIO  
DEPARTMENT OF MINES  
AND NORTHERN AFFAIRS

MOHER TWP. M-868

HUTT TWP. M-943

SOTHMAN TWP. M-121

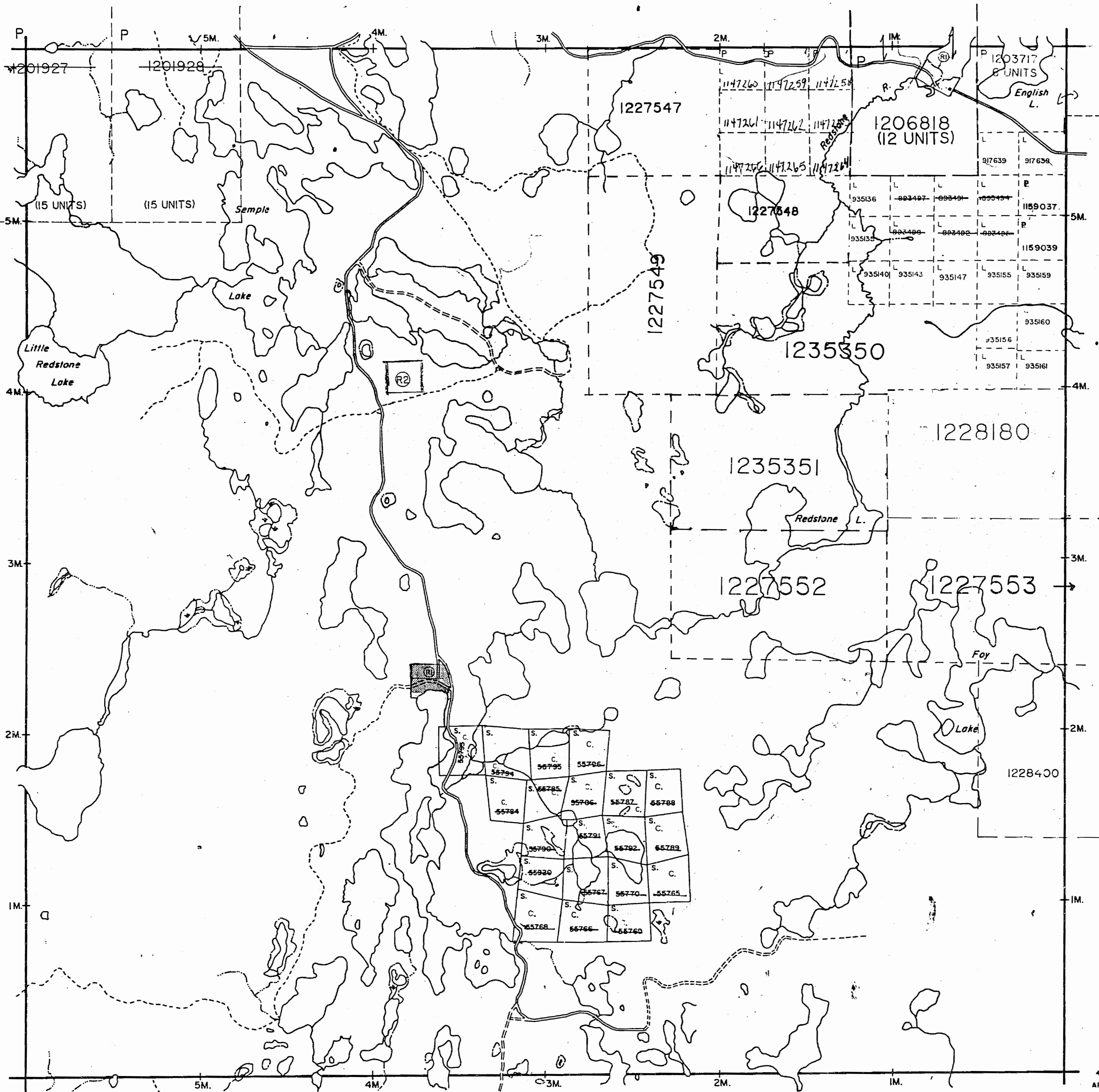

ION THAT  
THIS MAP  
COMPILED  
SOURCES.  
Y IS NOT  
. THOSE  
TAKE MIN-  
OULD CON-  
HE MINING  
NISTRY OF  
DEVELOP-  
ES, FOR AD-  
ORMATION  
S OF THE  
HEREON.

PROV  
OF



ENGLISH TWP. M-787

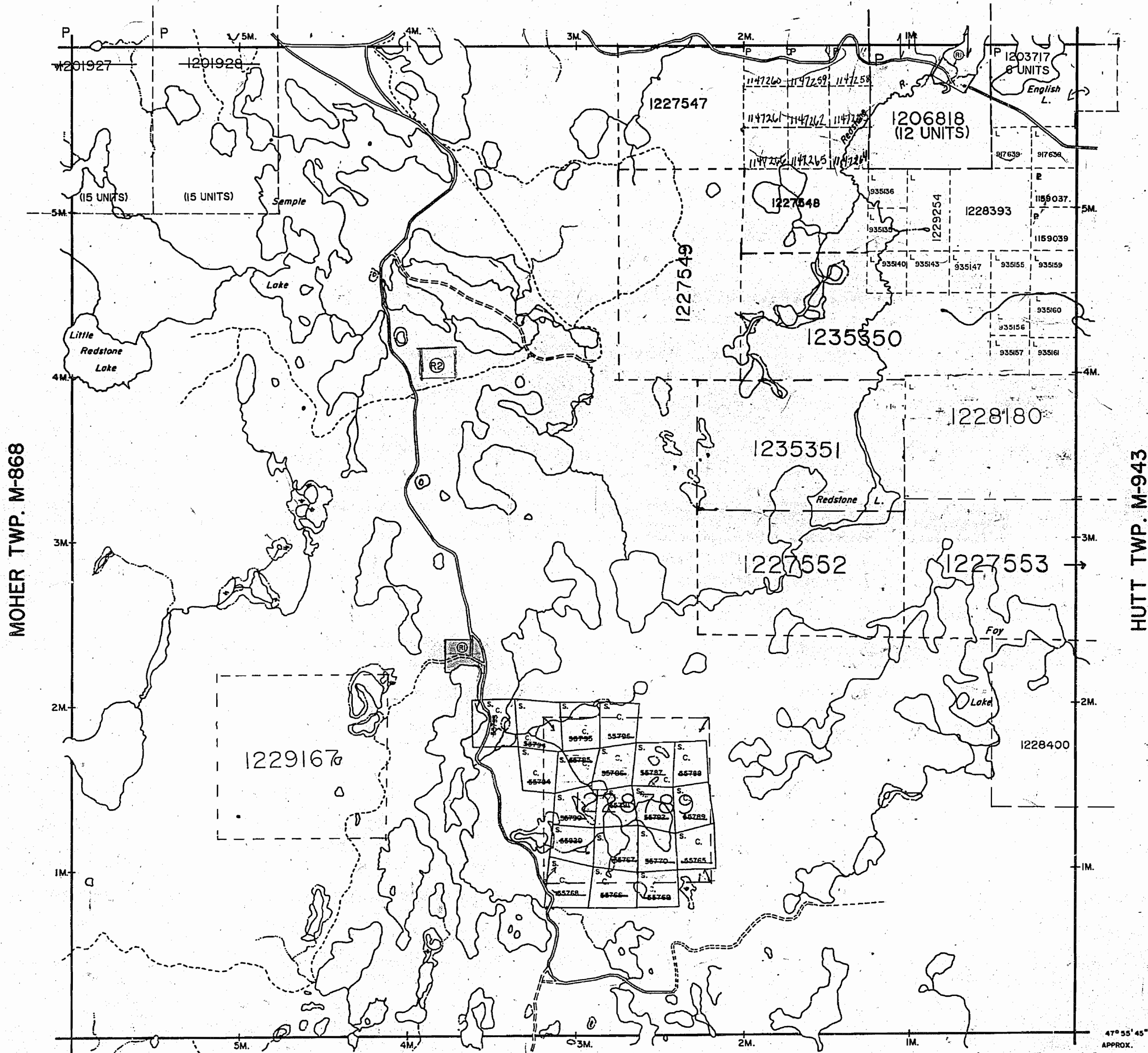

MOHER TWP. M-868

HUTT TWP. M-943

SOTHMAN TWP. M-1121

NOTES

400' surface rights reservation along the shores of all lakes and rivers.

- SUBJECT TO FORESTY ACTIVITY IN 1994/95 1995/96

Areas withdrawn from staking under Section 43 of the Mining Act (R.S.O. 1970)

Order File Date Disposition

(R) W.19 / 78 1885 10 / 74 / 78 S.R.O.

(R) MINING AND SURFACE RIGHTS WITHDRAWN FROM PROSPECTING, STAKING OUT, SALE OR LEASE UNDER SECTION 35 OF THE MINING ACT R.S.O. 1990 ORDER NO. W-P 44 / 94 NER DATED 94-MAY-02

ACTIVATED APRIL 24, 1990 D.C.

LEGEND

- PATENTED LAND (P or \*)
- PATENTED FOR SURFACE RIGHTS ONLY (P)
- LEASE (L)
- LICENSE OF OCCUPATION (L.O.)
- CROWN LAND SALES (C.S.)
- LOCATED LAND (Loc.)
- CANCELLED (C.)
- MINING RIGHTS ONLY (M.R.O.)
- SURFACE RIGHTS ONLY (S.R.O.)
- HIGHWAY & ROUTE NO. (17)
- ROADS (— — — — —)
- TRAILS (— · — · — · —)
- RAILWAYS (— + — + — + —)
- POWER LINES (— — — — —)
- MARSH OR MUSKEG (— · — · — · —)
- MINES (M)

\*used only with summer resort locations or when space is limited

TOWNSHIP OF  
**SEMPLÉ**

DISTRICT OF  
SUDBURY

PORCUPINE  
MINING DIVISION

SCALE: 1 INCH = 40 CHAINS (1/2 MILE)

DR. R.W. NOBLE  
DATE APR. 22, 71 PLAN NO. **M-1100**

ONTARIO  
DEPARTMENT OF MINES  
AND NORTHERN AFFAIRS

ON THAT HIS MAP MPILED SOURCES, IS NOT THOSE KE-MIN-ULD CON-MINING STRY OF EVELOP- FOR AD- MATION OF THE EREON.

47° 55' 45" APPROX.  
81° 12' 15"











1100

MONTREAL MINING DIVISION

528 440 02272

M-1100

ENGLISH

MOHER

HUTT

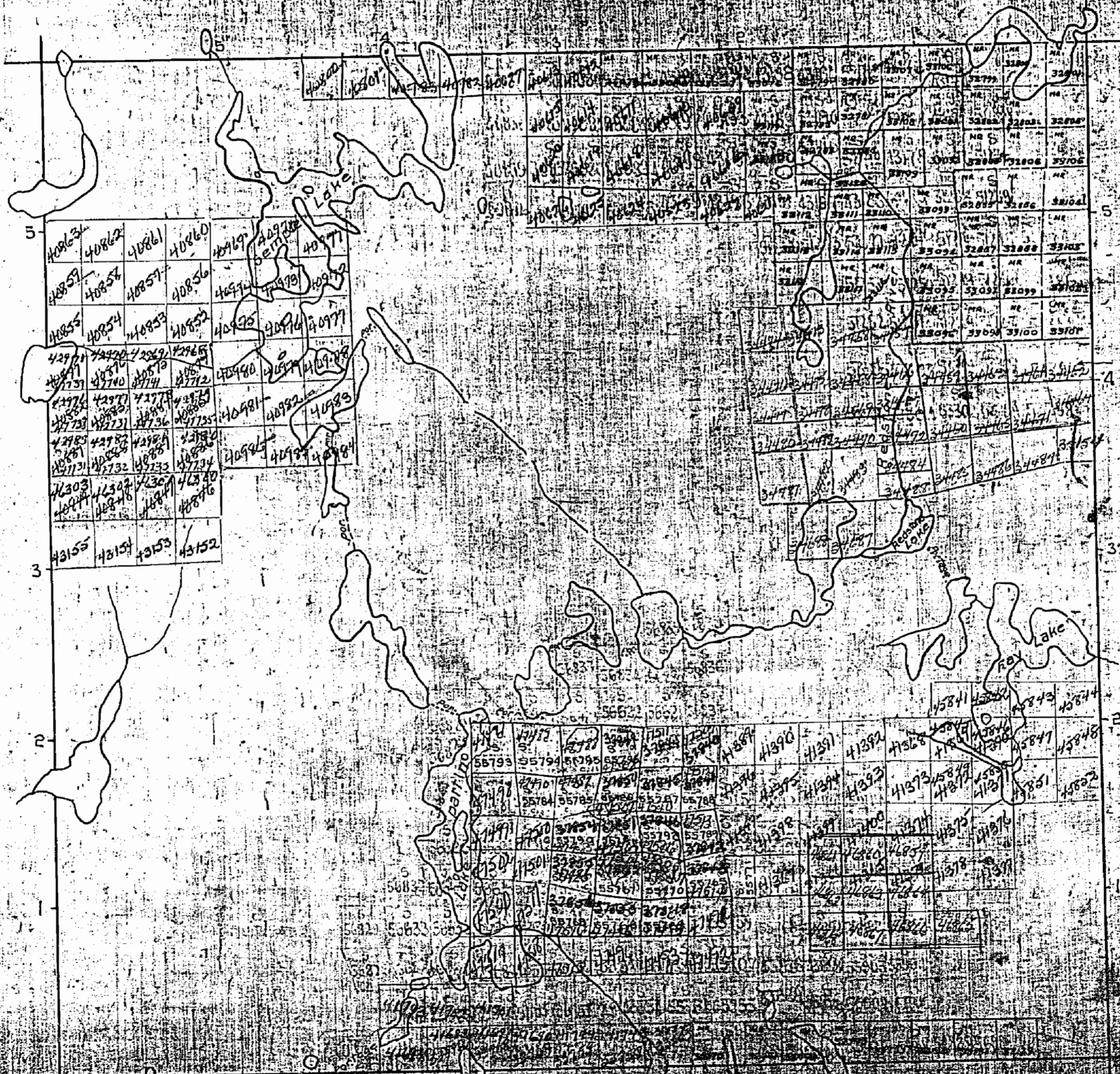



1100

MONTREAL RIVER MINING DIVISION

Scale 40 Chains = 1 inch

M 1100

400' surface rights reservation around all lakes & rivers

ENGLISH

MOHER

HUTT

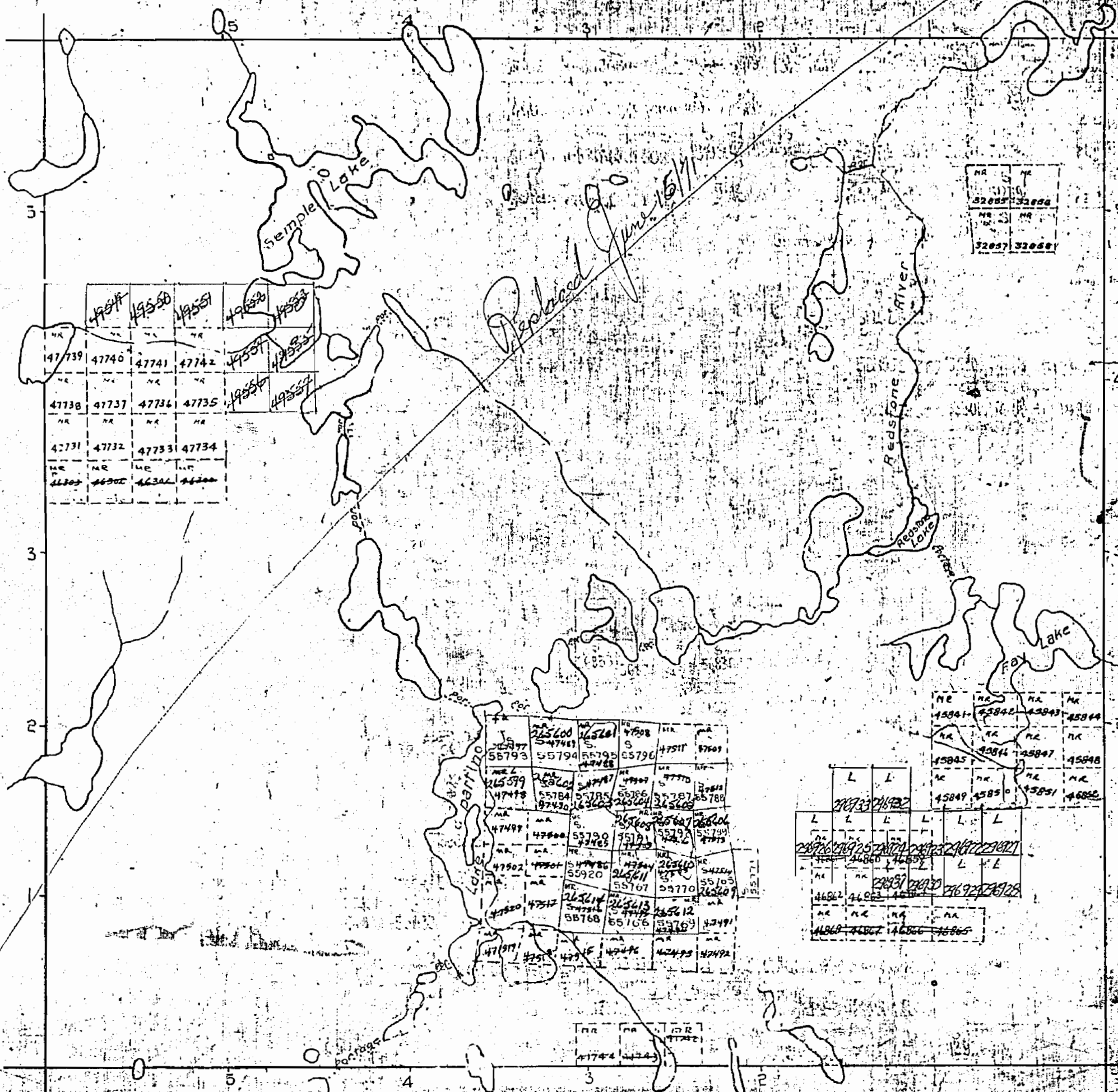

SOUTHMAN

MONTREAL RIVER  
MINING DIV.  
**RECEIVED**  
OCT 18 1967  
AM 28.910.1112.1.2.3.4



1100

ENGLISH TWP. M-787

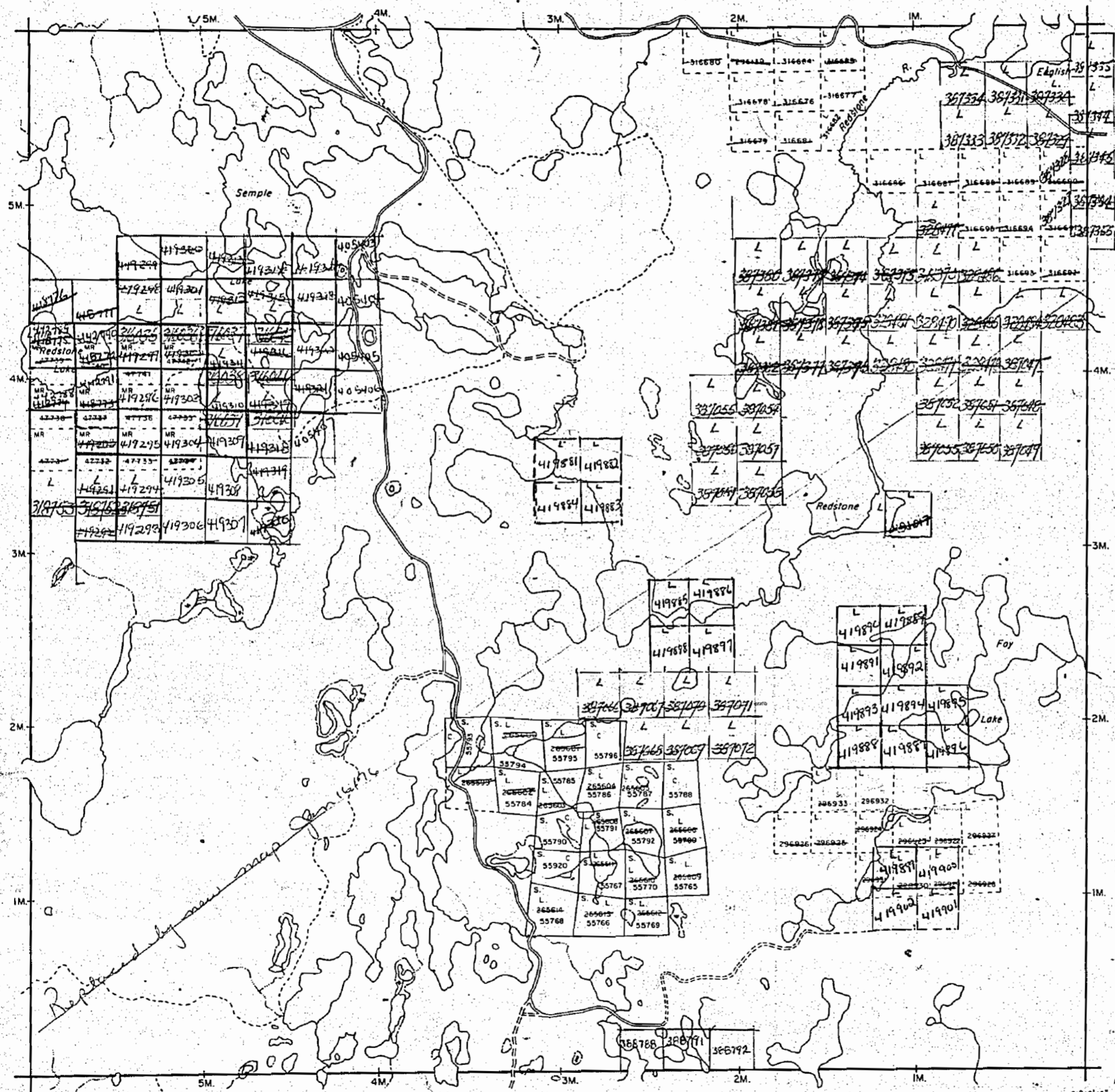

MOHER TWP. M-868

HUTT TWP. M-943

SOTHMAN TWP. M-1121

NOTES

400' surface rights reservation along the shores of all lakes and rivers.

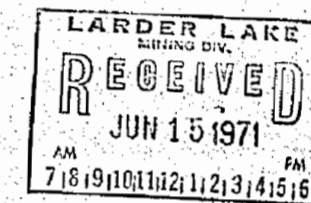

LEGEND

- PATENTED LAND (P) or (●)
- PATENTED FOR SURFACE RIGHTS ONLY (○)
- LEASE (L)
- LICENSE OF OCCUPATION L.O.
- CROWN LAND SALES C.S.
- LOCATED LAND Loc.
- CANCELLED C.
- MINING RIGHTS ONLY M.R.O.
- SURFACE RIGHTS ONLY S.R.O.
- HIGHWAY & ROUTE NO. (with road symbol)
- ROADS (with road symbol)
- TRAILS (with trail symbol)
- RAILWAYS (with railway symbol)
- POWER LINES (with power line symbol)
- MARSH OR MUSKEG (with marsh symbol)
- MINES (with mine symbol)

\*used only with summer resort locations or when space is limited.

TOWNSHIP OF  
**SEMPL**

DISTRICT OF  
SUDBURY

LARDER LAKE  
MINING DIVISION

SCALE: 1 INCH = 40 CHAINS (1/2 MILE)

DR. R.W. NOBLE  
DATE APR. 22, 71

PLAN NO. **M-1100**

ONTARIO #9  
DEPARTMENT OF MINES  
AND NORTHERN AFFAIRS



1100

# SEMPL



SUDBURY MINING DIVISION

Scale 40 Chains = 1 inch

ENGLISH

MOHER

HUTT

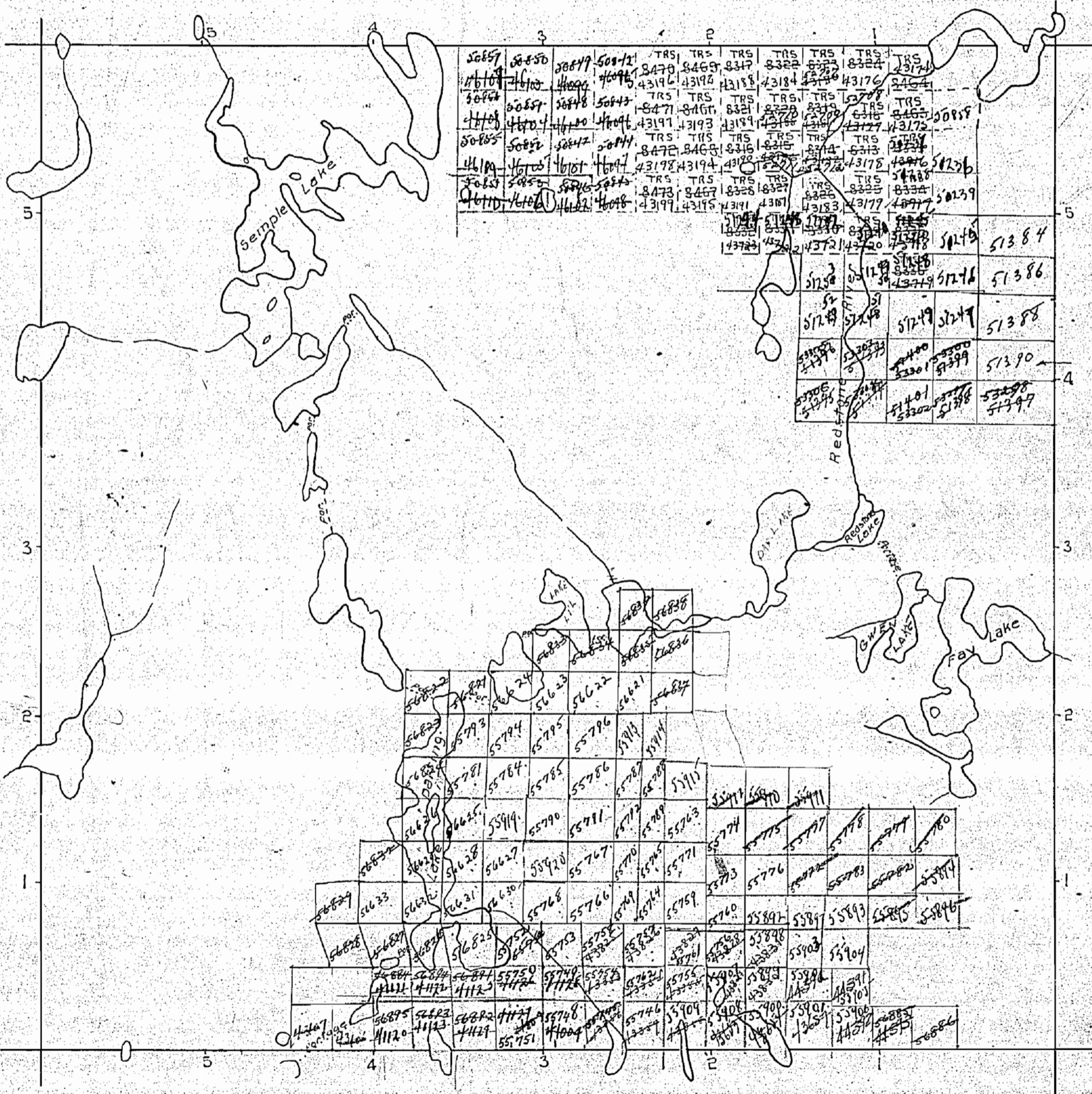

SOTHMAN

M1100