

BELMONT

North 74° 00' East

Sec. 21.5 Code
Report to the
Commissioner in
1726/92. See
also O.L.S. Code
Certificate
file 2695/93

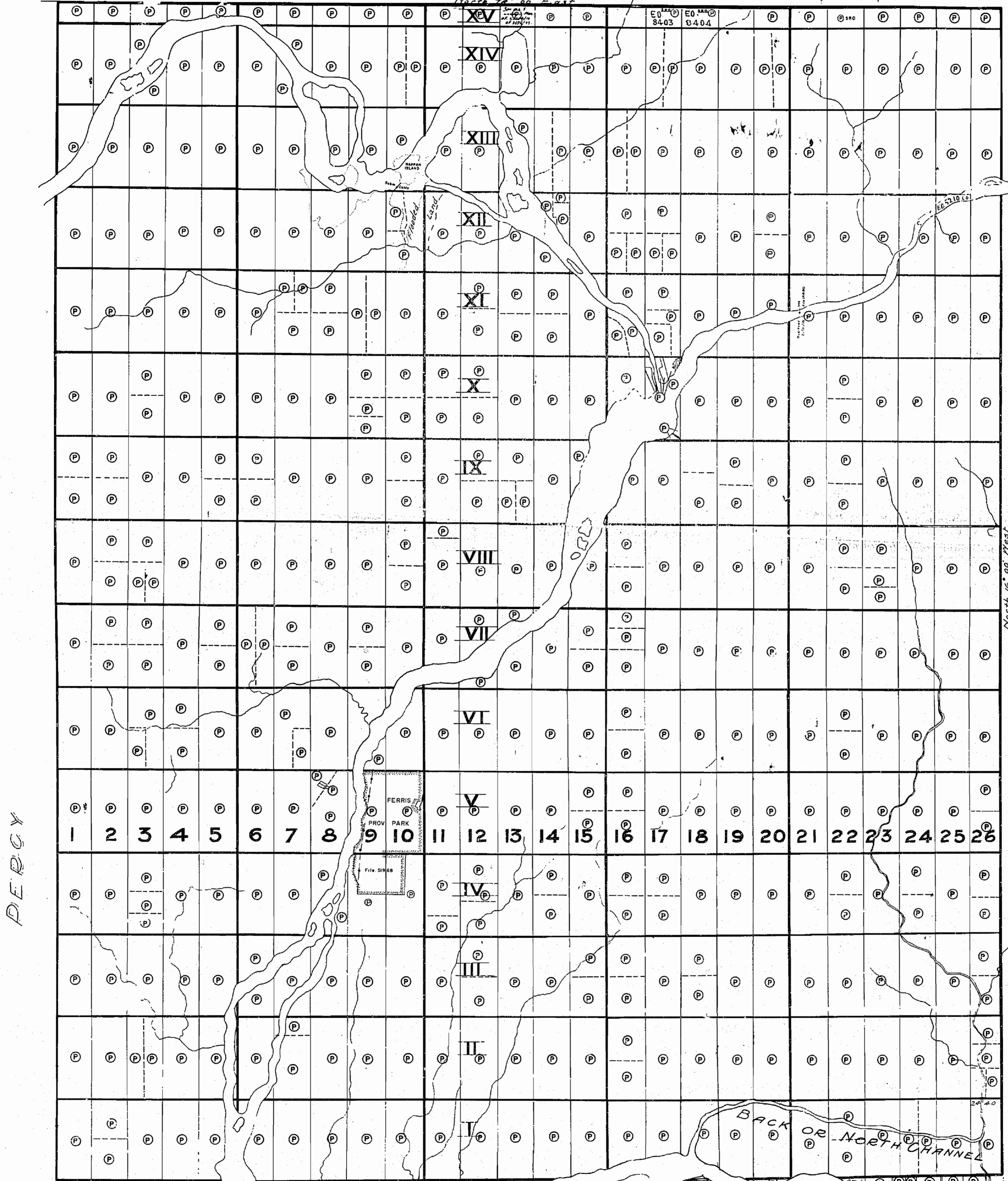

This GORE detached from MURRAY and annexed to SEYMOUR Oct. 1831
4. 5 1/2 Sec 5
TRENT RIVER
400' Surface rights reservation around all lakes & rivers.

SEYMOUR

Scale: 40 chains to an inch

THE INFORMATION THAT APPEARS ON THIS MAP HAS BEEN COMPILED FROM VARIOUS SOURCES, AND ACCURACY IS NOT GUARANTEED. THOSE WISHING TO STAKE MINING CLAIMS SHOULD CONSULT WITH THE MINING RECORDER, MINISTRY OF NORTHERN DEVELOPMENT AND MINES, FOR ADDITIONAL INFORMATION ON THE STATUS OF THE LANDS SHOWN HEREON.

LEGEND

- CANCELLED PATENTED LAND
- CROWN LAND SALE
- LEASES
- LOCATED LAND
- LICENCE OF OCCUPATION
- MINING RIGHTS ONLY
- SURFACE RIGHTS ONLY

- CS
- CS
- LOC
- LO
- MRO
- SR

See Plan of Survey No. 35
1931

See Plan of Survey
in 1831
Survey of 1831
See also 72
Same

BELMONT

North 74° 30' East

See O.L.S. Caddy's
Plan to tenth
concession file
1726/92. Sales
also O.L.S. Caddy's
Certificate
file 2695/93

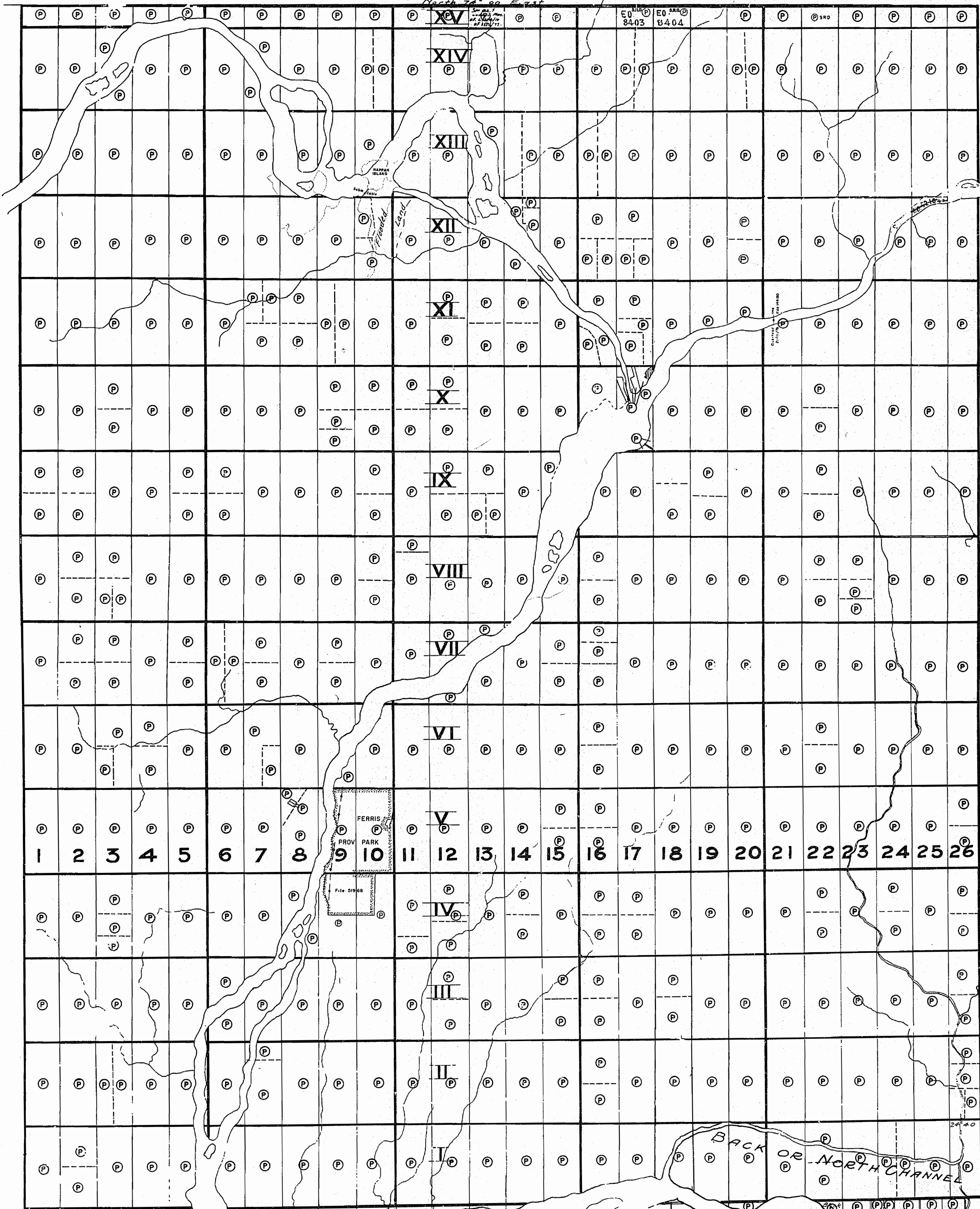

This GORE detached from MURRAY and annexed to SEYMOUR Oct. 1851

TRENT RIVER

400' Surface rights reservation around all lakes & rivers.

SEYMOUR

Scale: 40 chains to an inch

See Plan of Survey
No. 35
1851

THE INFORMATION THAT APPEARS ON THIS MAP HAS BEEN COMPILED FROM VARIOUS SOURCES, AND ACCURACY IS NOT GUARANTEED. THOSE WISHING TO STAKE MINING CLAIMS SHOULD CONSULT WITH THE MINING RECORDER, MINISTRY OF NORTHERN DEVELOPMENT AND MINES, FOR ADDITIONAL INFORMATION ON THE STATUS OF THE LANDS SHOWN HEREON.

LEGEND

- CANCELLED PATENTED LAND
- CROWN LAND SALE LEASES
- LOCATED LAND
- LICENCE OF OCCUPATION
- MINING RIGHTS ONLY
- SURFACE RIGHTS ONLY

- CS
- LO
- MRO
- SR0

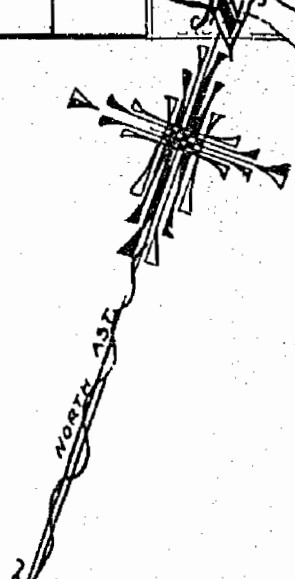

DELMONT

North 74° 00' East

See O.L.S. Condy's
Plan to tenth
concession file
1726/192. 2012
also O.L.S. Condy's
Certificate
file 2095/93

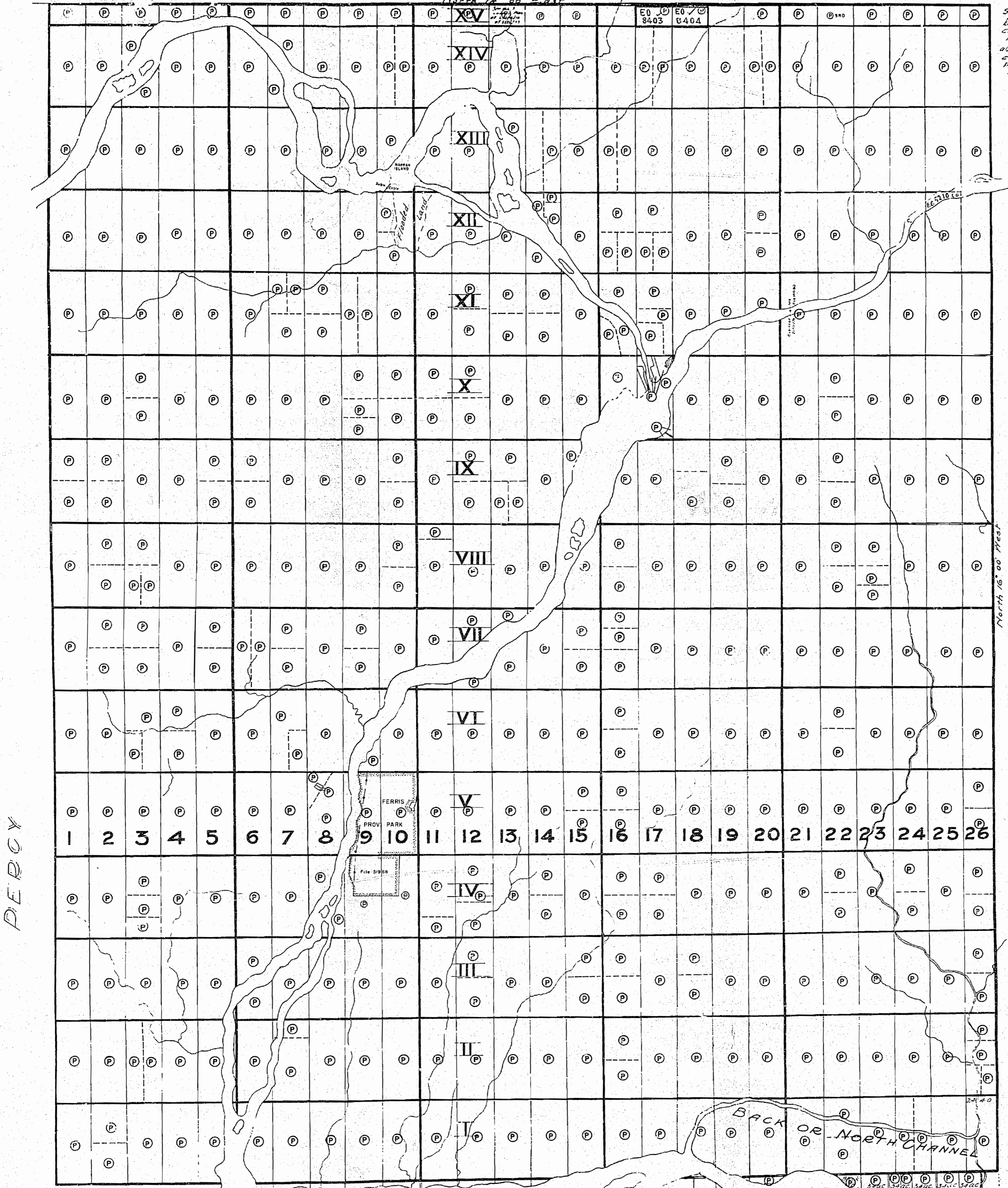

This GORE detached from MURRAY and annexed to SEYMOUR Oct. 31st
4. 5. 1931

TRENT RIVER
400' Surface rights reservation around all lakes & rivers.

12 11 10 9 8 7 6 5 4 3 2 1
Con. X. of Tp. of MURRAY

See also on
1726/192. 2012
Survey of
Gore
See also on
Sample

SEYMOUR

Scale: 40 chains to an inch

DATE OF ISSUE
JUN 01 1988
SOUTHERN ONTARIO
MINING DIVISION

LEGEND

- CANCELLED PATENTED LAND C
- CROWN LAND SALE CS
- LEASES LO
- LOCATED LAND MR
- LICENCE OF OCCUPATION MRO
- MINING RIGHTS O.Y.
- SURFACE RIGHTS S.R.

Plan No. 35
207. 1931

BELMONT

DATE OF ISSUE
FEB 10 1970
ONTARIO DEPT. OF MINES

See 025 10047
Plan to be
referred to the
100/100 files
100/100 10047
100/100 10047

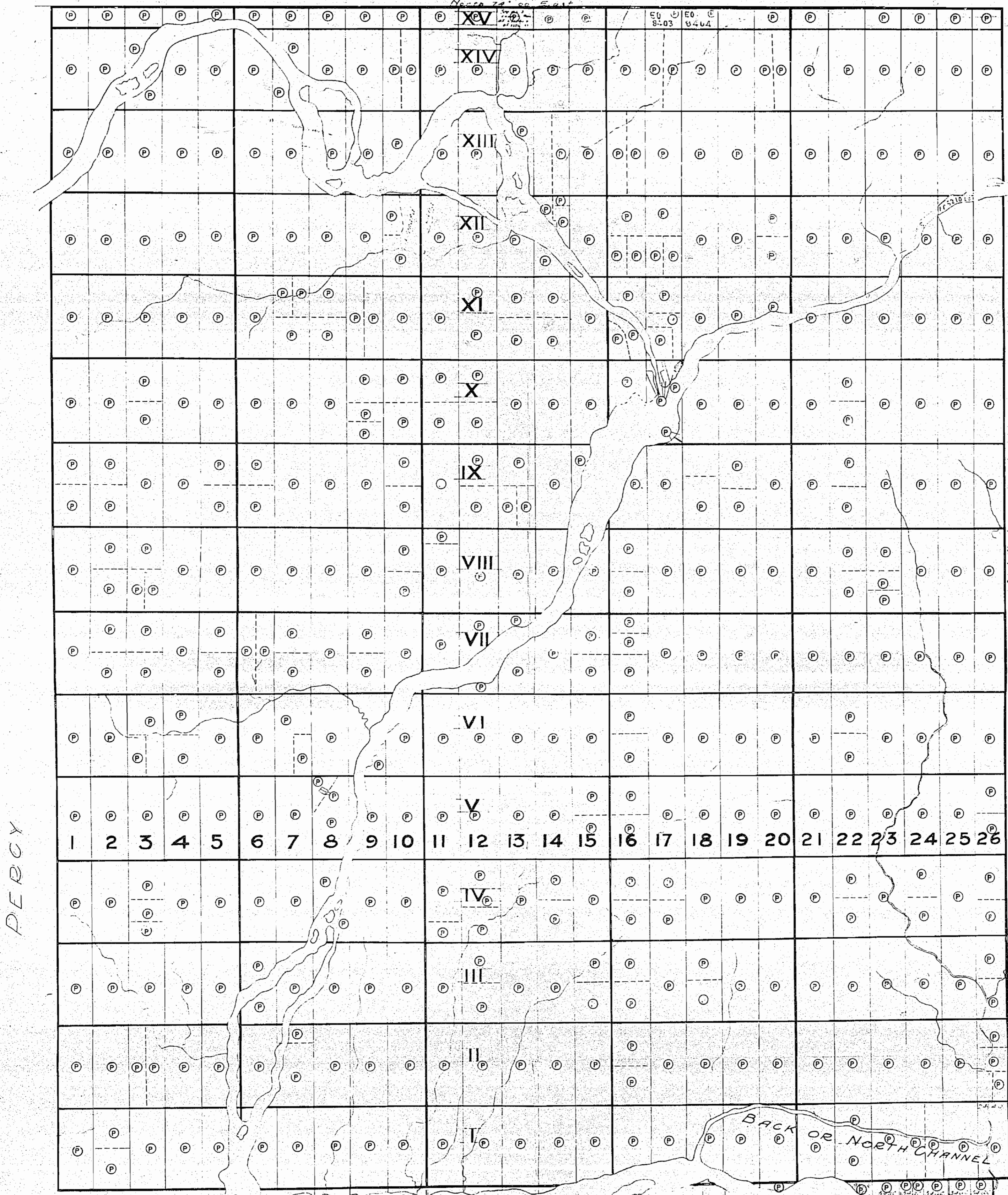

TRENT RIVER
400' Surface rights reservation around all lakes & rivers.

12 11 10 9 8 7 6 5 4 3 2 1
Cen. X = Tp. of MURRAY

See Plan No. 10047
in 100/100 files
Bound of Plan No. 10047
Cen. X = Tp. of MURRAY
See also the notes
in same file
Survey
2011 103

SEYMOUR

Note: Plan prepared from Patent plan No. 35
205 1231

Scale: 40 chains to an inch

LEGEND

- CANCELLED PATENTED LAND
- CROWN LAND SALE
- LEASES
- LOCATED LAND
- LICENSE OF OCCUPATION
- MINING RIGHTS ONLY
- SURFACE RIGHTS ONLY

- C
- ⊗
- CS
- ⊙
- LOC
- LO
- MRO
- SRO

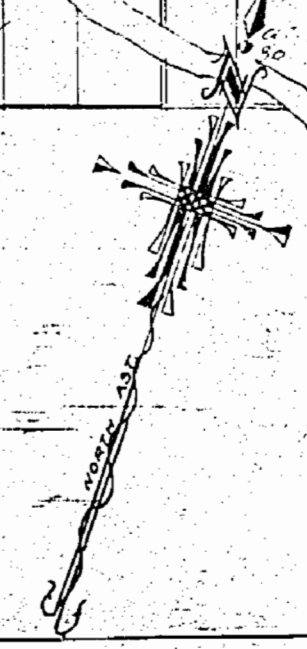

BELMONT

North 74° 00' East

EO 8403 EO 8404

See O.L.S. Coffey's
1874-75 tenth
Concession file
1724/92. Sites
310-315 Coffey's
Certificate
file 2435/93

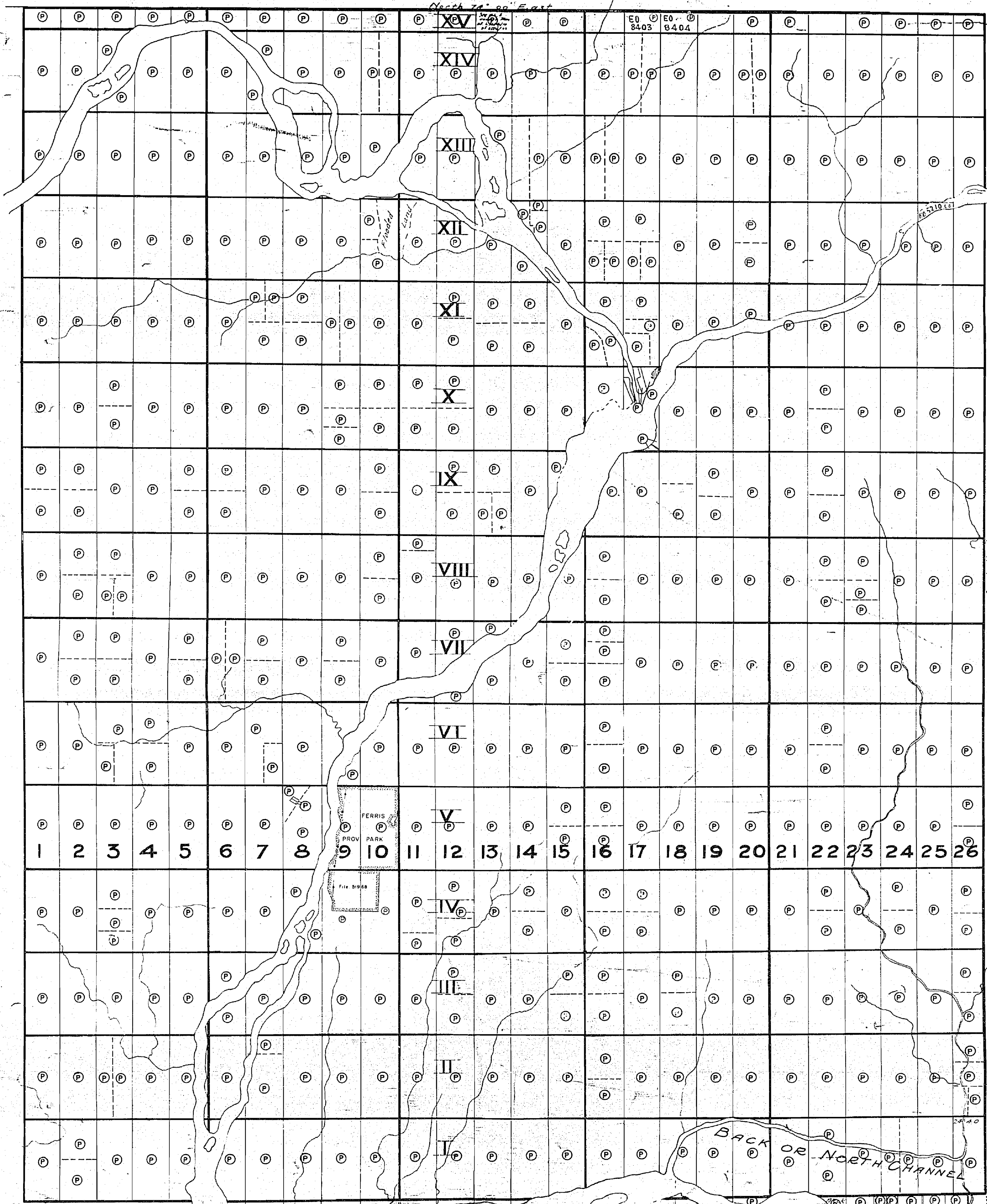

PERCY

North 76° 00' West

BAYDON

This GORE detached from MURRAY and annexed to SEYMOUR Oct. 1851

TRENT RIVER

400' Surface rights reservation around all lakes & rivers.

12 11 10 9 8 7 6
Cor. X of Tp. of MURRAY

See Plan by J. Whitson
in 1836/35. Sales for
Gore of Seymour
See also his memo
on same file.

MINING LANDS
DATE OF ISSUE
FEB. 5 1973
MINISTRY
OF NATURAL RESOURCES

SEYMOUR

Note Plan prepared from Patents plan No. 35
April 1931

Scale 40 chains to an inch

LEGEND

- CANCELLED PATENTED LAND
- CROWN LAND SALE
- LEASES
- LOCATED LAND
- LICENSE OF OCCUPATION
- MINING RIGHTS ONLY
- SURFACE RIGHTS ONLY



DELMONT

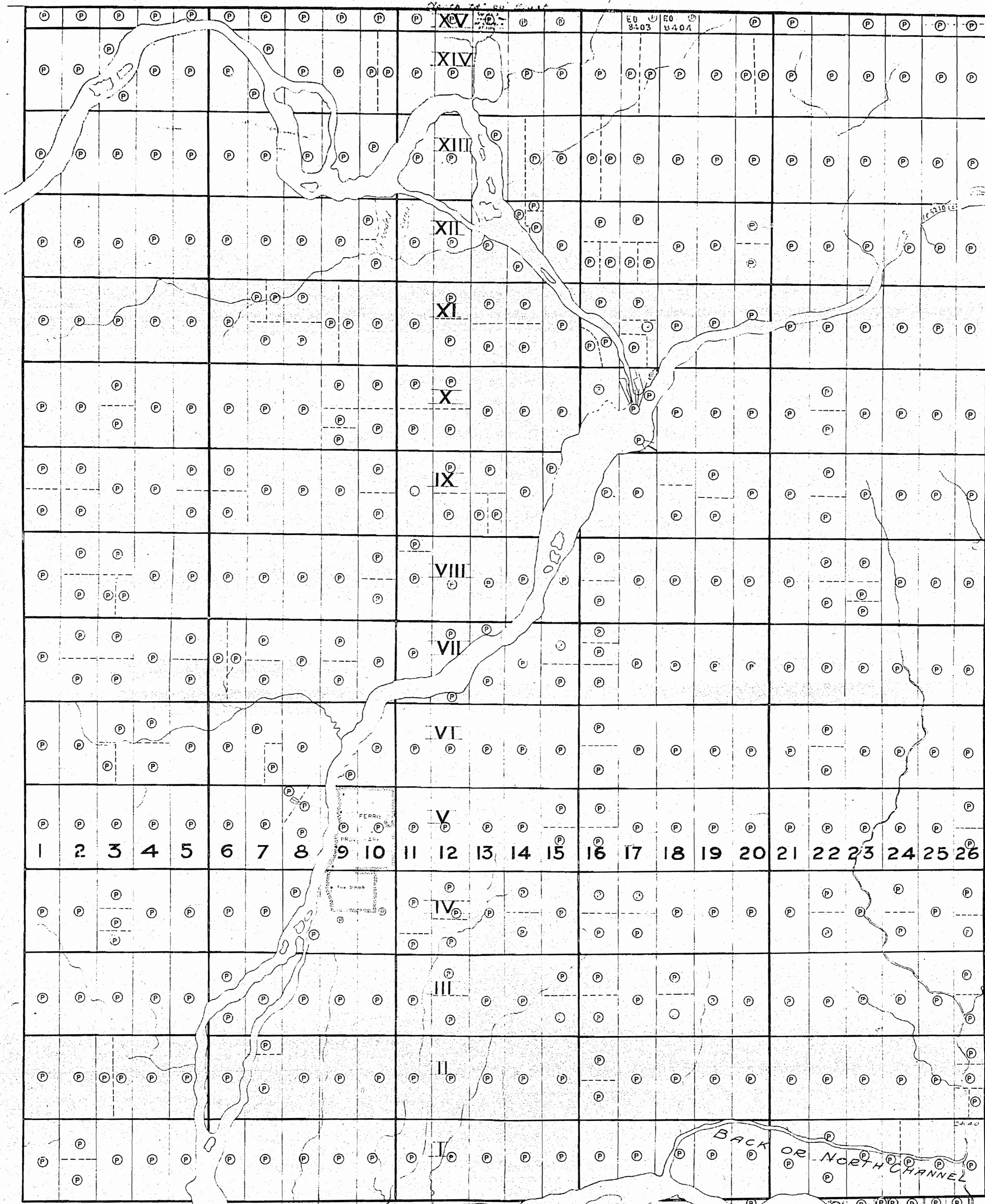

See also GORE's
Plan to Town
Survey on file
M.149 of GORE's
Plan to Town
Survey on file
M.149 of GORE's
Plan to Town
Survey on file

North 16° 00' West

BAYDON

PERCY

TRENT RIVER
400' Surface rights reservation around all lakes & rivers.

MINING LANDS
DATE OF ISSUE
FEB 27 1974
MINISTRY
OF NATURAL RESOURCES

SEYMOUR

Scale: 40 chains to an inch

Note: Plan prepared from Patent plan N.35.
Apr. 1931

See also GORE's
Plan to Town
Survey on file
M.149 of GORE's
Plan to Town
Survey on file
M.149 of GORE's
Plan to Town
Survey on file

LEGEND

- CANCELLED
- PATENTED LAND
- CROWN LAND SALE
- LEASES
- LOCATED LAND
- LICENSE OF OCCUPATION
- MINING RIGHTS ONLY
- SURFACE RIGHTS ONLY
- C
- CS
- CS
- LOC
- LO
- MRO
- S.R.

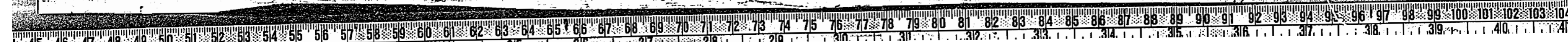
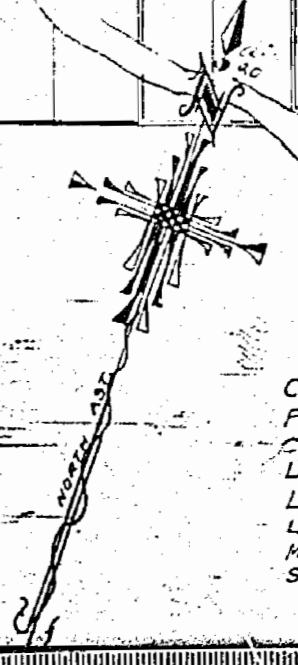

BELMONT

North 74° 00' East

See 0.25 Gaddy's
25000 20 tenth
Concession File
1726/92 Sales
4.2 1.28 Gaddy's
Serrilliana
File 2025/93

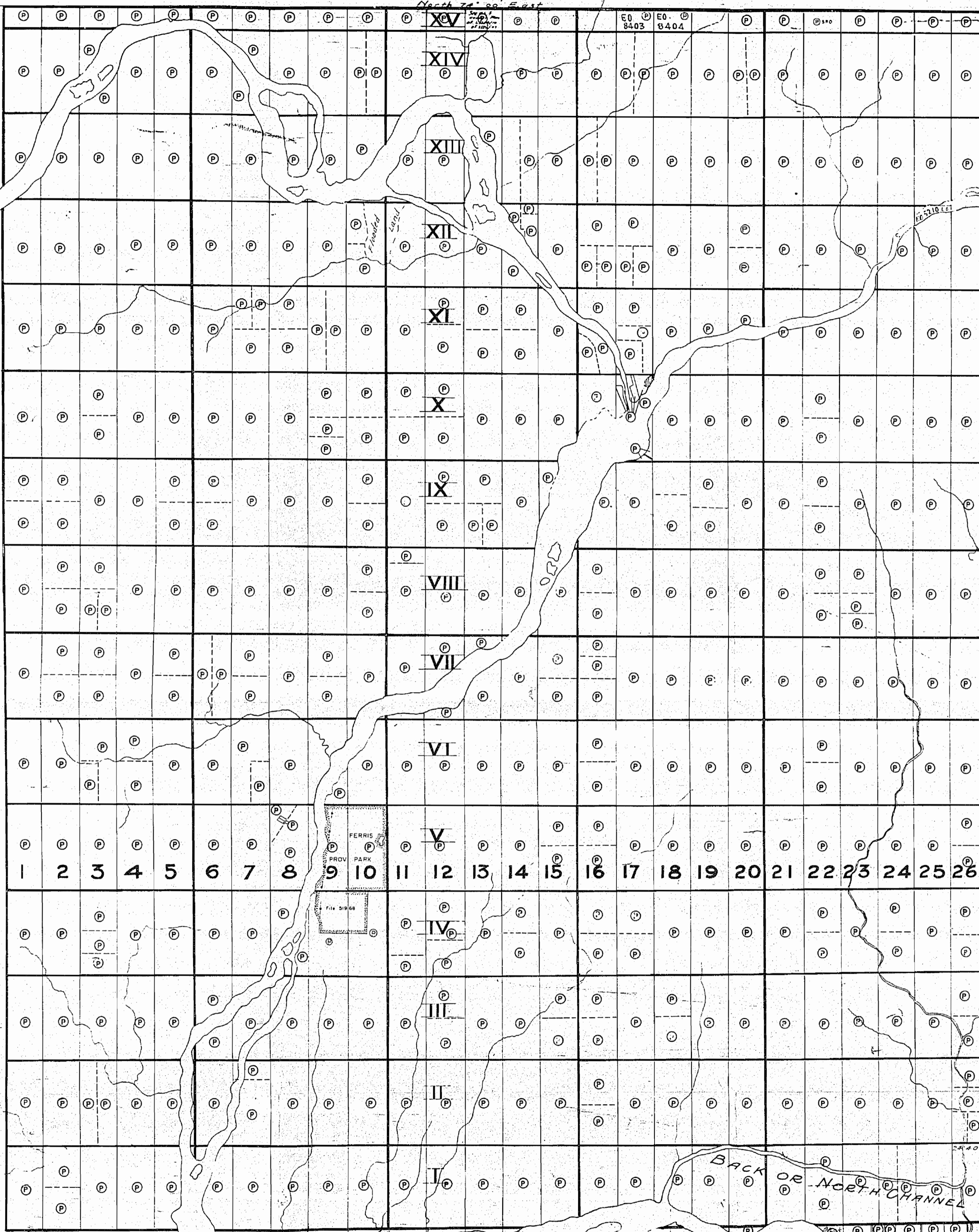

This GORE detached from MURRAY and annexed to SEYMOUR 20-1891

TRENT RIVER
400' Surface rights reservation around all lakes & rivers.

E
M149

12 11 10 9 8 7 6
Con. X of Tp. of MURRAY

See Plan by Whitson
in 1836/35 Sales of
Survey of Part of the
Gore of Seymour
See also his memo.
on same file.
Surveyed
April 1831

MINING LANDS -
DATE OF ISSUE
NOV 19 1975
MINISTRY
OF NATURAL RESOURCES

SEYMOUR

Scale: 40 chains to an inch

Note Plan prepared from Patents plan N° 35.
April 1931

LEGEND

CANCELLED	C
PATENTED LAND	P
CROWN LAND SALE	C.S.
LEASES	L
LOCATED LAND	LOC.
LICENSE OF OCCUPATION	L.O.
MINING RIGHTS ONLY	M.R.O.
SURFACE RIGHTS ONLY	S.R.O.



BELMONT

North 74° 00' East

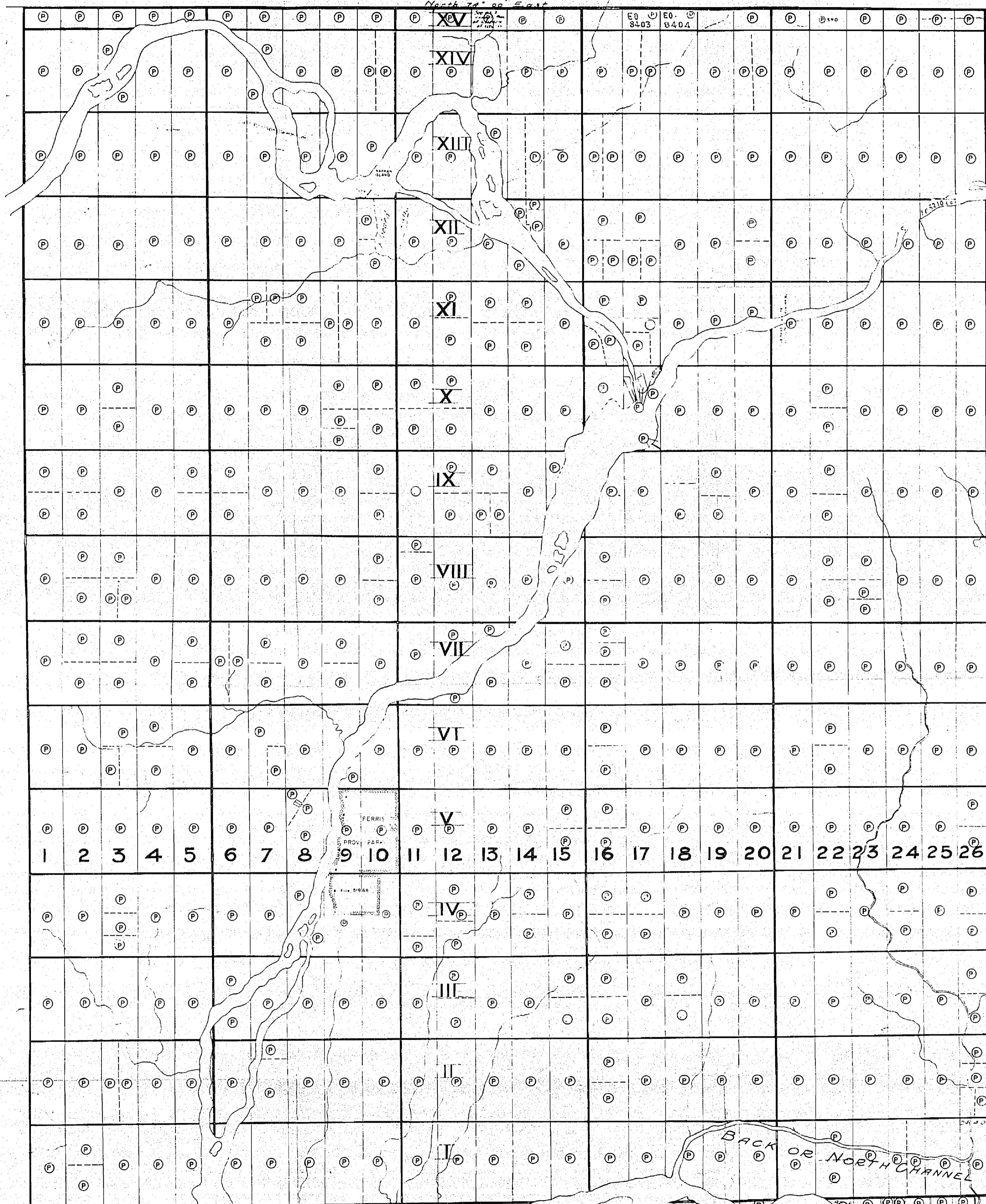

See 125' Conty's
1870-72 Conty's
Concession file
1726/192-1925
1870-72 Conty's
Concession
file 2025/93

PERCY

BAWDON

7 1/2 GORE detached from M.149 and added to SEYMOUR M.149
at 2 1/2 1/2 5 5/8 1/2 1/2

TRENT RIVER

400' Surface rights reservation around all lakes & rivers.

E - M-149

SEYMOUR

Scale 40 chains to an inch

DATE OF ISSUE
SEP. 23 1980
SURVEYS AND MAPPING
BRANCH

Note Plan prepared from Patent plan N°35
April 1931

12 11 10 9 8 7 6 5 4 3 2 1
Cont X of Tp. of MURRAY

See Plan 241-11100
in 230/125 1/2 1/2
Survey of Conty's
Conty's 1870-72
See also the MURRAY
in same file.
Survey
20th 1931

LEGEND

- CANCELLED C
- PAID-UP LAND C
- CROWN LAND SALE C.S.
- LEASES L
- LOCATED LAND LOC
- LICENSE OF OCCUPATION L.O.
- MINING RIGHTS ONLY M.R.O.
- SURFACE RIGHTS ONLY S.R.O.

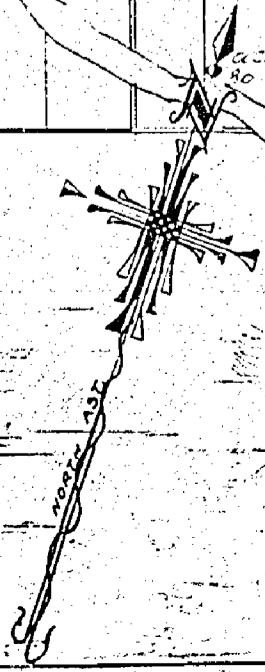

BELMONT

North 15° 00' West

See O.S. 104/93
2000 ft. 100 ft.
Concession file
1726/93, 8165
also O.S. 104/93
concession file
No. 2695/93

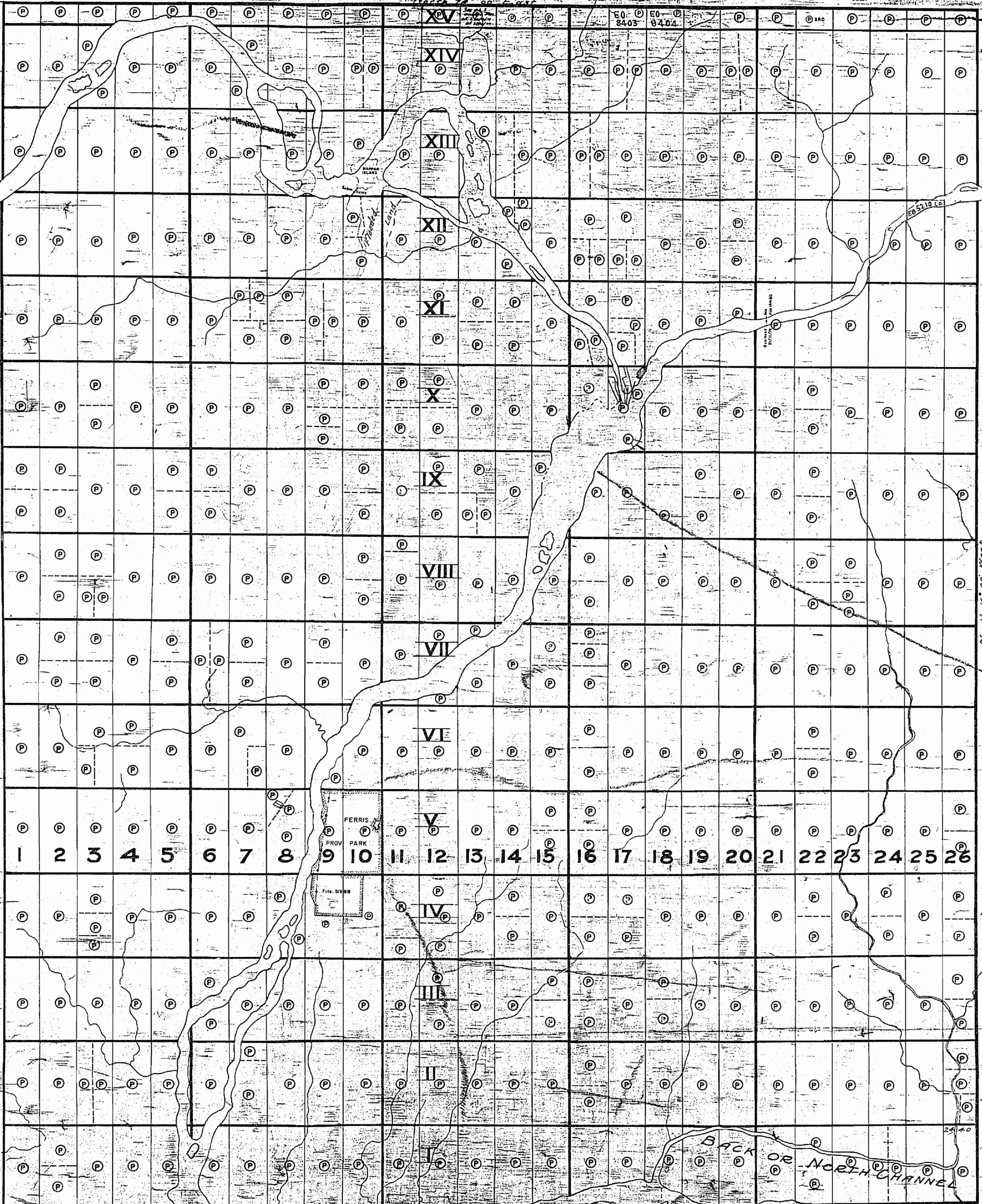

PERCY

North 15° 00' West
RANDON

This GORE detached from MURRAY and annexed to SEYMOUR

SEYMOUR RIVER

M-149
D.M. NAPANCE

SEYMOUR

DATE OF ISSUE
JUL 23 1982
Ministry of Natural Resources
TORONTO

12	11	10	9	8	7	6	5	4	3	2	1
Con. X of T. of MURRAY											

See also by J.F. Watson
11-1234/93. Sales for
Survey of Part of the
Gore of Seymour.
See also this memo
on same file.



LEGEND

DELMONT

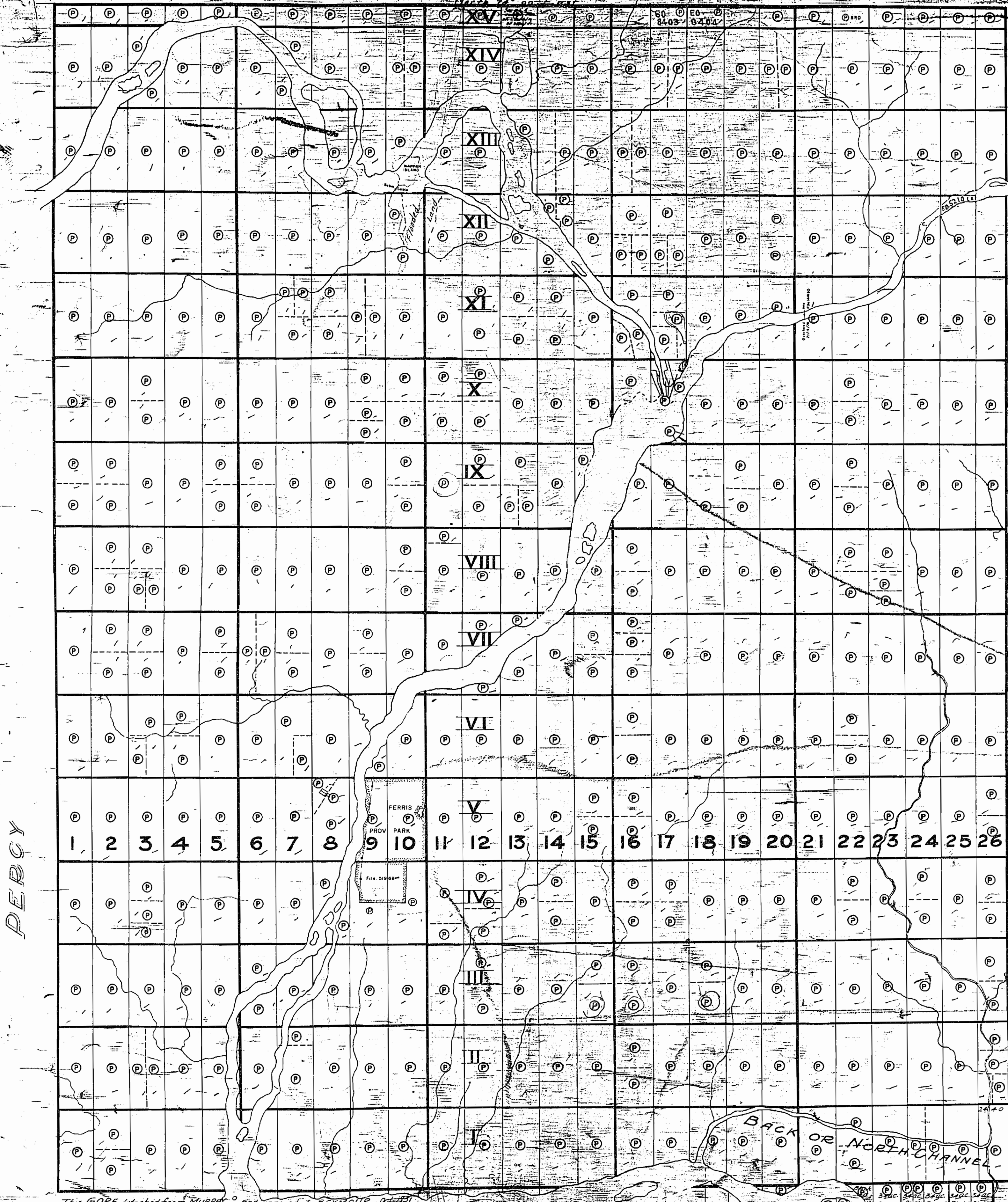

See also Caddy's
27th & 28th
Concession file
1726/92, 5045
also C.L.S. Caddy's
correction
file 2695/93.

North 16° 00' West

RAYDON

PERCY

DATE OF ISSUE
JUL 21 1983
Ministry of Natural Resources
TORONTO

This GORE detached from MURRAY and annexed to SEYMOUR

TRENT RIVER
SEYMOUR

12 11 10 9 8 7 6
Con X of Tp of MURRAY

See Plan by J.F. Whitson
in 1836/38, sales for
Survey of Part of the
Gore of Seymour
See also his memo on
same file.

LEGEND



Plan prepared from Potentials N-56
April 1981

Scale 1:50,000

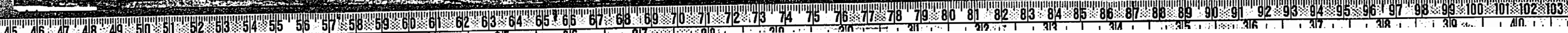

BELMONT

North 24° 00' East

See also maps
to refer
to the
location of
the
sites
on the
same
file.

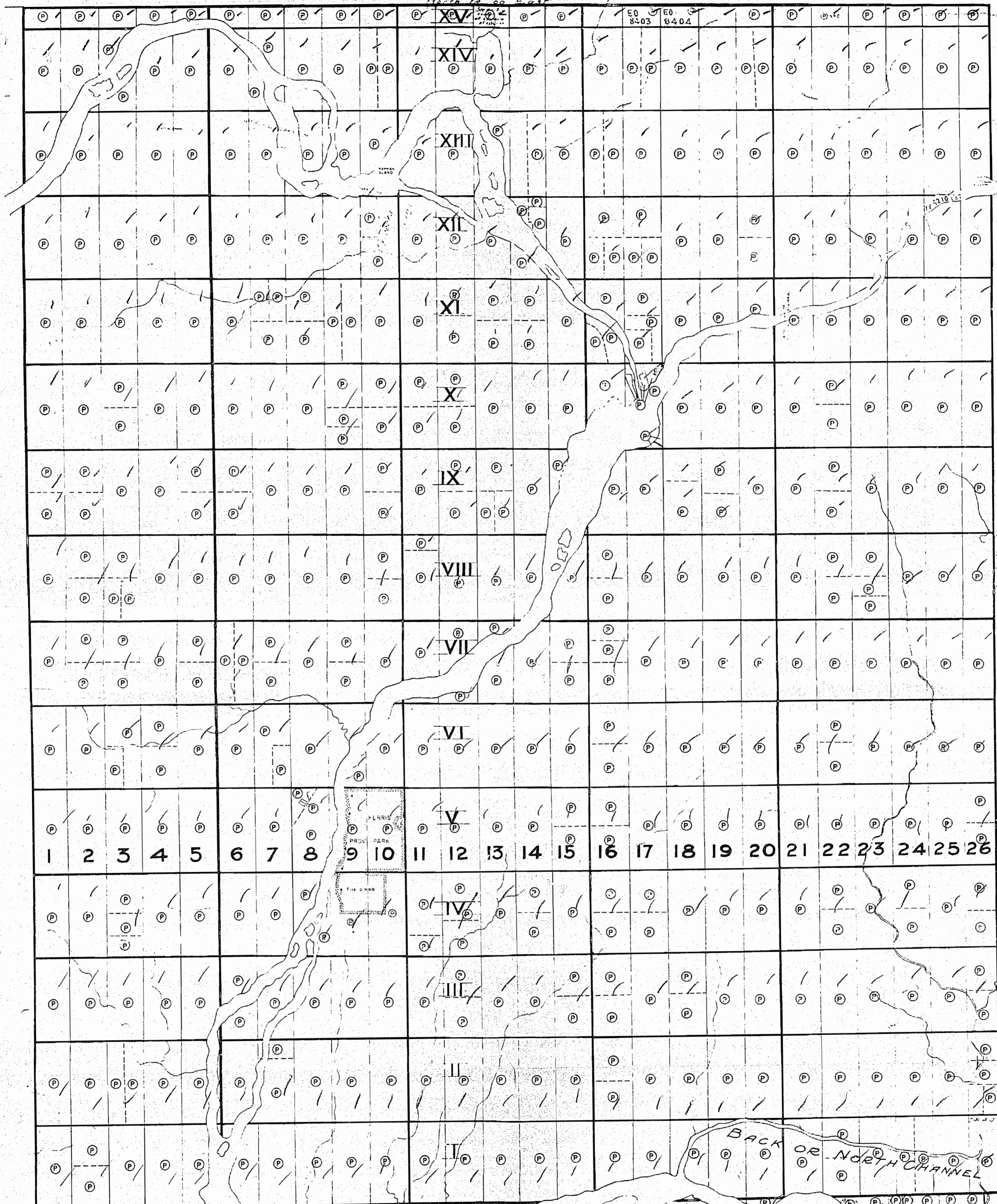

North 16° 00' West
BANDON

PERCY

This GORE detached from Ministry of Lands and Forests, Ontario, 1931
TRENT RIVER
400' Surface rights reservation around all lakes & rivers.

12 11 10 9 8 7 6 5 4 3 2 1
Com. X of Tp. of MURRAY
See also maps to refer to the location of the sites on the same file.

SEYMOUR

E
M149

Scale: 40 chains to an inch

SOUTHERN ONTARIO

NAPANEE DISTRICT
RESIDENT GEOLOGIST-TWEED

LEGEND

CANCELLED	C
PAVILITED LAND	CS
CROWN LAND SALE	CS
LEASES	CS
LOCATED LAND	LOC
LICENSE OF OCCUPATION	LO
MINING RIGHTS ONLY	MR
SURFACE RIGHTS ONLY	SR

Note: Plan prepared from Patents plan N°35
April, 1931

MINING RECORDS OFFICE - TORONTO
RECEIVED
JUL - 3 1985
AN 78970.11.12.13.14.15.16

