

INDEX TO LAND DISPOSITION

PLAN
 G-4104
 TOWNSHIP
SHEPPARD

M.N.R. ADMINISTRATIVE DISTRICT
SUBURRY
 MINING DIVISION
SUBURRY
 LAND TITLES/REGISTRY DIVISION
SUBURRY

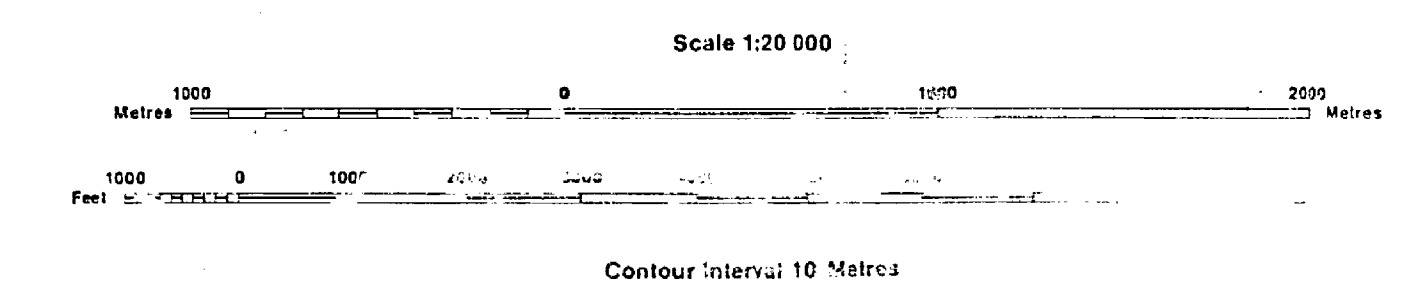

DATE OF ISSUE
FEB 10 1990
 SUBURRY
 MINING RECORDER'S OFFICE

SYMBOLS

- Boundary
- Township, Meridian, Baseline
- Road allowance: surveyed
- shoreline
- Lot/Concession: surveyed
- unsurveyed
- Parcel: surveyed
- unsurveyed
- Right-of-way: road
- railway
- utility
- Reservation
- Crib, Pit, Pile
- Contour
- interpolated
- Approximate
- Depression
- Control point (horizontal)
- Flooded land
- Mine frame
- Pipeline (above ground)
- Railway: single track
- double track
- abandoned
- Road: highway, county, township
- trig. ch.
- trig. pt. (original)
- trig. pt. (relocated)

- AREAS WITHDRAWN FROM DISPOSITION**
- MRO - Mining Rights Only
 - SRO - Surface Rights Only
 - M+S - Mining and Surface Rights
- | Description | Order No. | Date | Disposition |
|--------------------------------|-----------|---------|--|
| SEC. 36/90 | N. 1/82 | 1/05/82 | 1-3 |
| STURGEON RIVER PROVINCIAL PARK | | | ONTARIO REGULATION NO. 1
MAY 8, 1989 SCHEDULE NO. |
| OSABAKA RIVER PROVINCIAL PARK | | | ONTARIO REGULATION NO. 1
MAY 8, 1989 SCHEDULE 22 |

NOTE:
 "THIS MAP SHOWS THE APPROXIMATE LOCATION OF THE BOUNDARIES OF THE AREA WHICH IS THE SUBJECT OF CURRENT LITIGATION. THE EXACT LOCATION WILL BE SHOWN FOLLOWING CONFIRMATION BY THE PARTIES TO THE ACTION"

DISPOSITION OF CROWN LANDS

- Patent
- Surface & Mining Rights
- Surface Rights Only
- Mining Rights Only
- Lease
- Surface & Mining Rights
- Surface Rights Only
- Mining Rights Only
- Licence of Occupation
- Order-in-Council
- Cancelled
- Reservation
- Stand & Javel
- LAND USE PERMIT

THE INFORMATION THAT APPEARS ON THIS MAP HAS BEEN COMPILED FROM VARIOUS SOURCES, AND ACCURACY IS NOT GUARANTEED. THOSE WISHING TO STAKE MINING CLAIMS SHOULD CONSULT WITH THE MINING RECORDER, MINISTRY OF NORTHERN DEVELOPMENT AND MINES, FOR ADDITIONAL INFORMATION ON THE STATUS OF THE LANDS SHOWN HEREON.

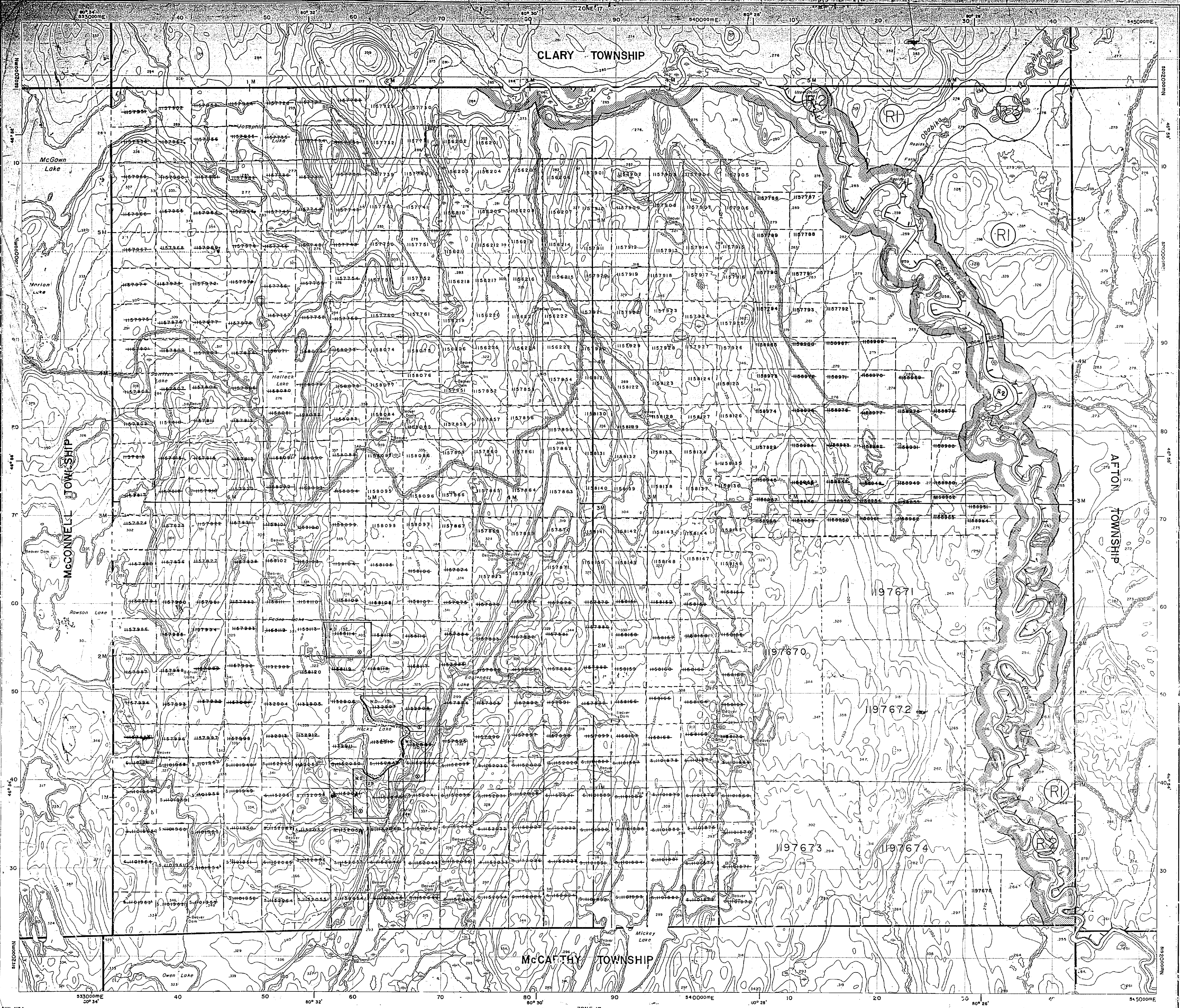



Ministry of Natural Resources

Ministry of Northern Development and Mines

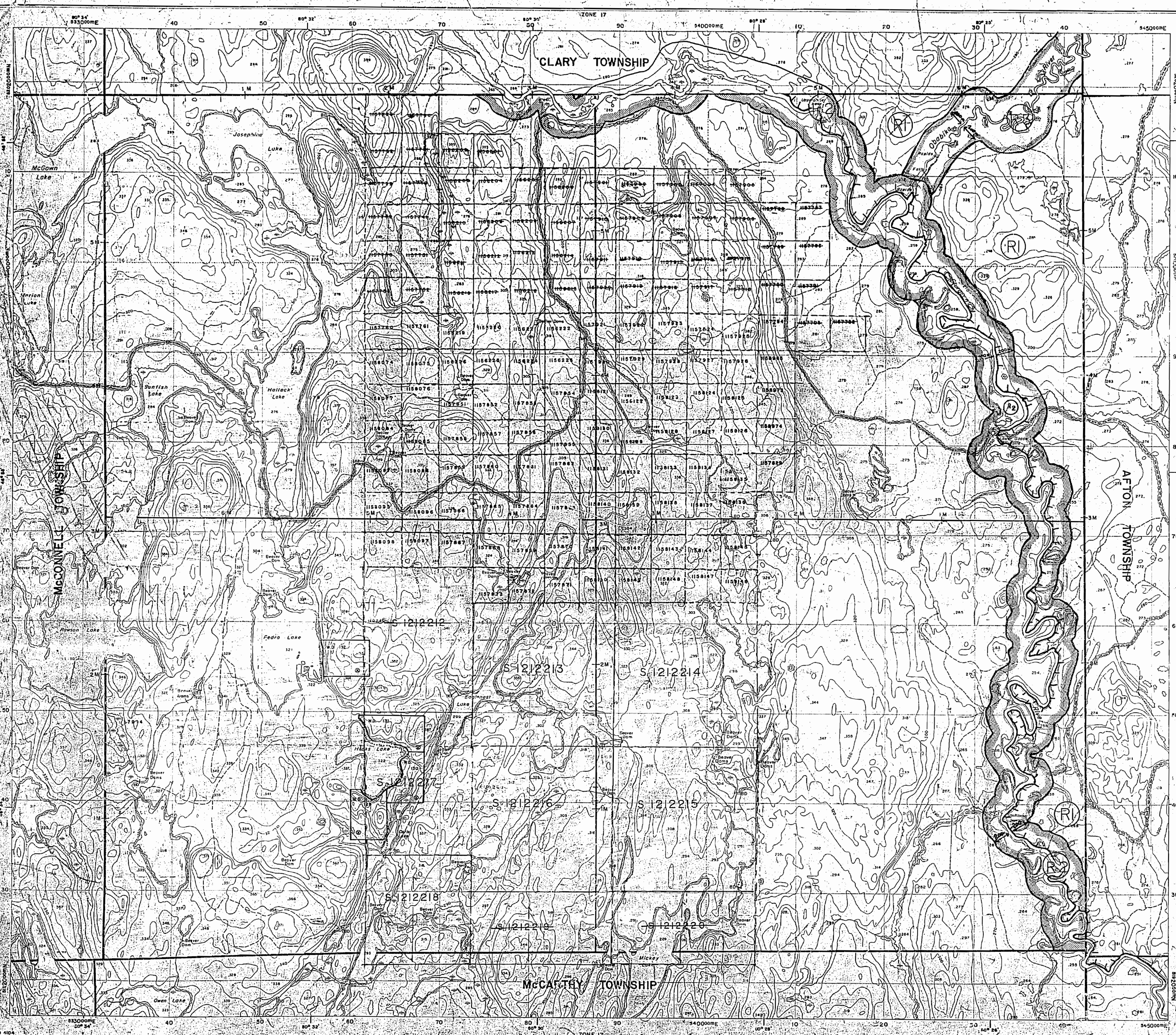

INDEX TO LAND DISPOSITION

PLAN
G-4104
TOWNSHIP
SHEPPARD

M.N.R. ADMINISTRATIVE DISTRICT
SUDBURY
MINING DIVISION
SUDBURY
LAND TITLES/REGISTRY DIVISION
SUDBURY

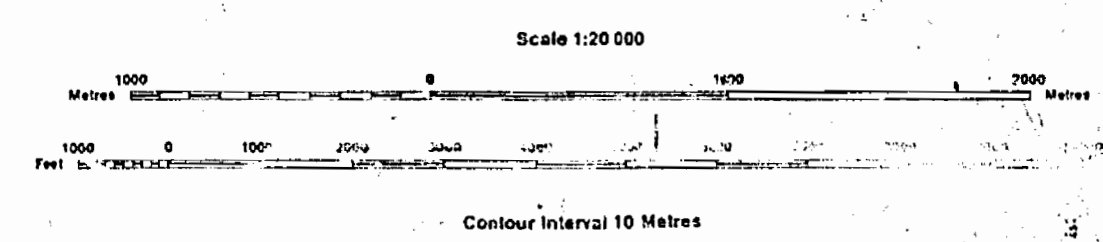

SYMBOLS

Boundary
Township, Meridian, Baseline
Road allowance; surveyed
shoreline
Lot/Concession; surveyed
unsurveyed
Parcel; surveyed
unsurveyed
Right-of-way, road
railway
utility
Reservation
Cliff, Pit, Pile
Contour
interpolated
Approximate
Depression
Control point (horizontal)
Flooded land
Mine hole frame
Pipeline (above ground)
Railway; single track
double track
abandoned
Road; highway, county, township
access
trail, path
Shoreline (rigid)
Transmission line
.....

AREAS WITHDRAWN FROM DISPOSITION

- MRO - Mining Rights Only
 - SRO - Surface Rights Only
 - M + S - Mining and Surface Rights
- | Description | Order No. | Date | Disposition | File |
|-----------------------------------|-----------|----------|-------------------------------|-------|
| 1. PARK RESERVE | 4107/83 | 12/20/83 | | |
| 2. STURGEON RIVER PROVINCIAL PARK | | | ONTARIO REGULATION NO. 258/89 | |
| | | | MAY 8, 1989 SCHEDULE NO. 230 | |
| 3. OSABIXA RIVER PROVINCIAL PARK | | | ONTARIO REGULATION NO. 258/89 | |
| | | | MAY 8, 1989 SCHEDULE NO. 220 | |

Part of order W 1182 REPEALED by order
O.M.L. 01/80 HER attached April 23/90 at 7:00 AM EAST.

DATE OF ISSUE

JUN 22 1990
PROVINCIAL RECORDING
OFFICE - SUDBURY

DISPOSITION OF CROWN LANDS

Patent
Surface & Mining Rights
Surface Rights Only
Mining Rights Only
Lease
Surface & Mining Rights
Surface Rights Only
Mining Rights Only
Licence of Occupation
Order-in-Council
Cancelled
Reservation
Sand & Gravel
LAND USE PERMIT

OSABIXA RIVER PROVINCIAL PARK
ONTARIO REGULATION NO. 258/89 SCHEDULE NO. 220
NOTE - THE LIMITS OF THE PARK ARE POSITION 200 METERS IN PERPENDICULAR DISTANCE FROM THE HIGH WATER MARK UNLESS OTHERWISE STATED ON THE SCHEDULE.

STURGEON RIVER PROVINCIAL PARK
ONTARIO REGULATION NO. 258/89 SCHEDULE NO. 230
NOTE - THE LIMITS OF THE PARK ARE POSITION 200 METERS IN PERPENDICULAR DISTANCE FROM THE HIGH WATER MARK UNLESS OTHERWISE STATED ON THE SCHEDULE.

THE INFORMATION THAT APPEARS ON THIS MAP HAS BEEN COMPILED FROM VARIOUS SOURCES AND ACCURACY IS NOT GUARANTEED. THOSE WISHING TO STAKE MINING CLAIMS SHOULD CONSULT WITH THE MINING RECORDER, MINISTRY OF NORTHERN DEVELOPMENT AND MINES, FOR ADDITIONAL INFORMATION ON THE STATUS OF THE LANDS SHOWN HEREON.

SHEPPARD TWP

G-116



Ministry of Natural Resources
Ministry of Northern Development and Mines

INDEX TO LAND DISPOSITION

PLAN
G-4104
TOWNSHIP
SHEPPARD

M.N.R. ADMINISTRATIVE DISTRICT
SUBURRY
MINING DIVISION
SUBURRY
LAND TITLES REGISTRY DIVISION
SUBURRY

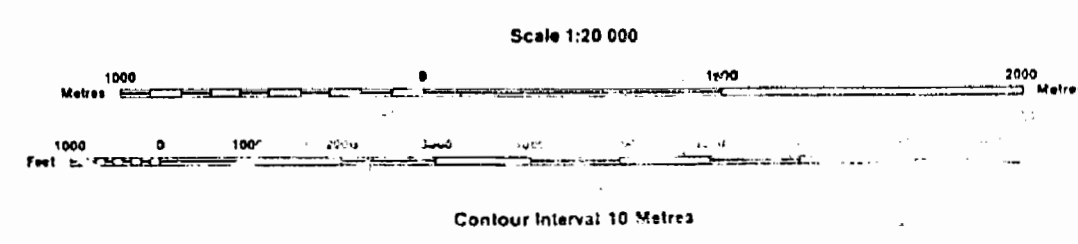

SYMBOLS

- Boundary Township, Meridian, Baseline
- Road allowance; surveyed
- Lot/Concession; surveyed
- Parcel; surveyed
- Right-of-way; road
- Reservation
- Cliff, Pit, Pile
- Contour
- Control point (horizontal)
- Flooded land
- Mine
- Pipeline (above ground)
- Railway; single track
- Road; highway, county, township
- Town

AREAS WITHDRAWN FROM DISPOSITION

Description	Order No.	Date	Disposition
SEC. 36/80	N. 1/82	8/25/82	24-5
STURGEON RIVER PROVINCIAL PARK	ONTARIO REGULATION NO. 208/88	MAY 8, 1989	SCHEDULE NO. 230
OBADIXA RIVER PROVINCIAL PARK	ONTARIO REGULATION NO. 208/88	MAY 8, 1989	SCHEDULE 228

NOTE:
"THIS MAP SHOWS THE APPROXIMATE LOCATION OF THE BOUNDARIES OF THE AREA WHICH IS THE SUBJECT OF CURRENT LITIGATION, THE EXACT LOCATION WILL BE SHOWN FOLLOWING CONFIRMATION BY THE PARTIES TO THE ACTION"

DISPOSITION OF CROWN LANDS

- Patent
- Lease
- Order-in-Council
- Cancelled
- Reservation
- Sand & Gravel

DATE OF ISSUE
JAN 14 1994
SUBURRY
MINING RECORDERS OFFICE

THE INFORMATION THAT APPEARS ON THIS MAP HAS BEEN COMPILED FROM VARIOUS SOURCES, AND ACCURACY IS NOT GUARANTEED. THOSE WISHING TO STAKE MINING CLAIMS SHOULD CONSULT WITH THE MINING RECORDER, MINISTRY OF NORTHERN DEVELOPMENT AND MINES, FOR ADDITIONAL INFORMATION ON THE STATUS OF THE LANDS SHOWN HEREON.

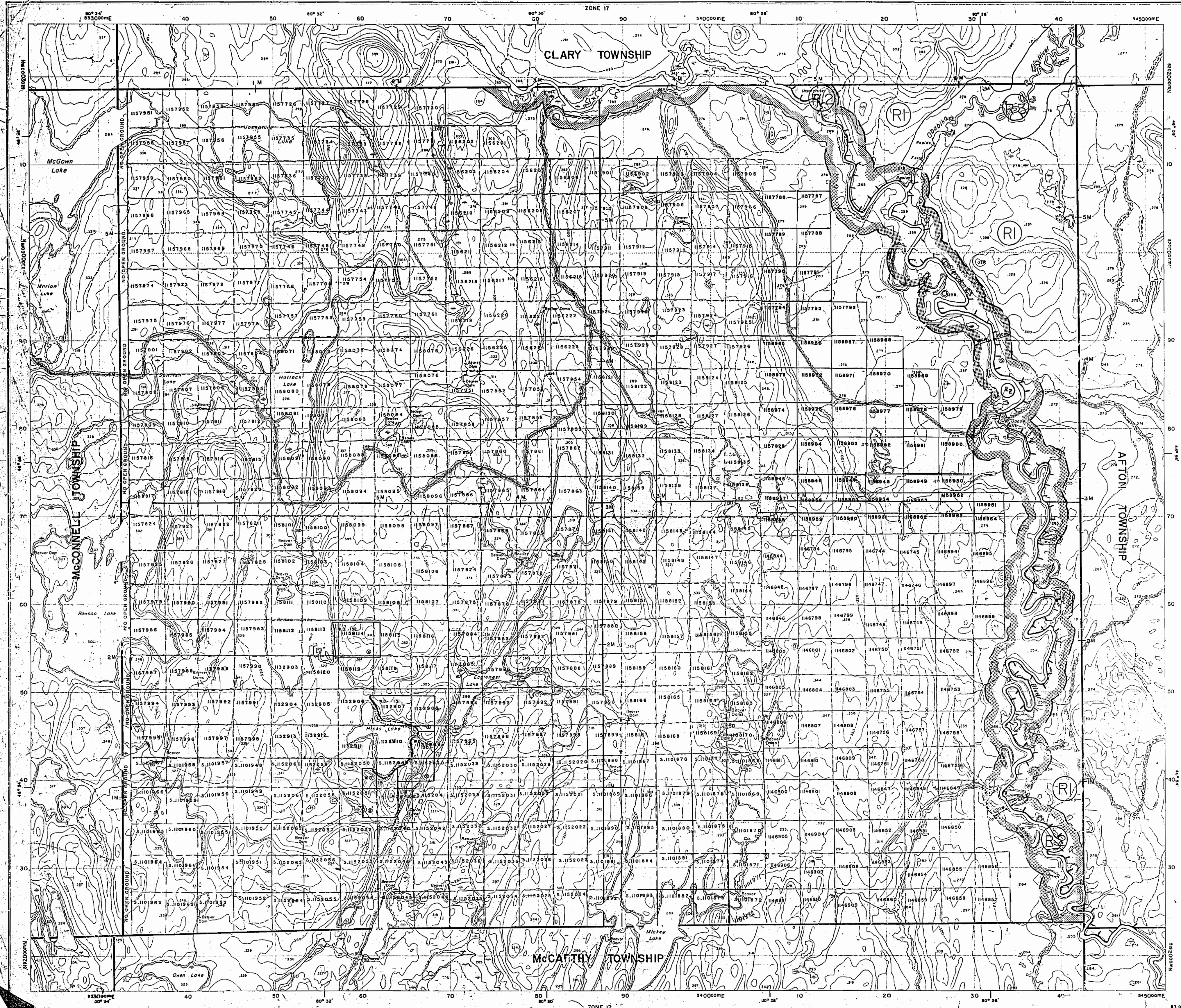

SHEPPARD TWP

G-4104

1113

SHEPPARD

DISTRICT OF SUDBURY

600 RECEIVED
JAN 18 1936
MINING DISTRICT

C L A R Y

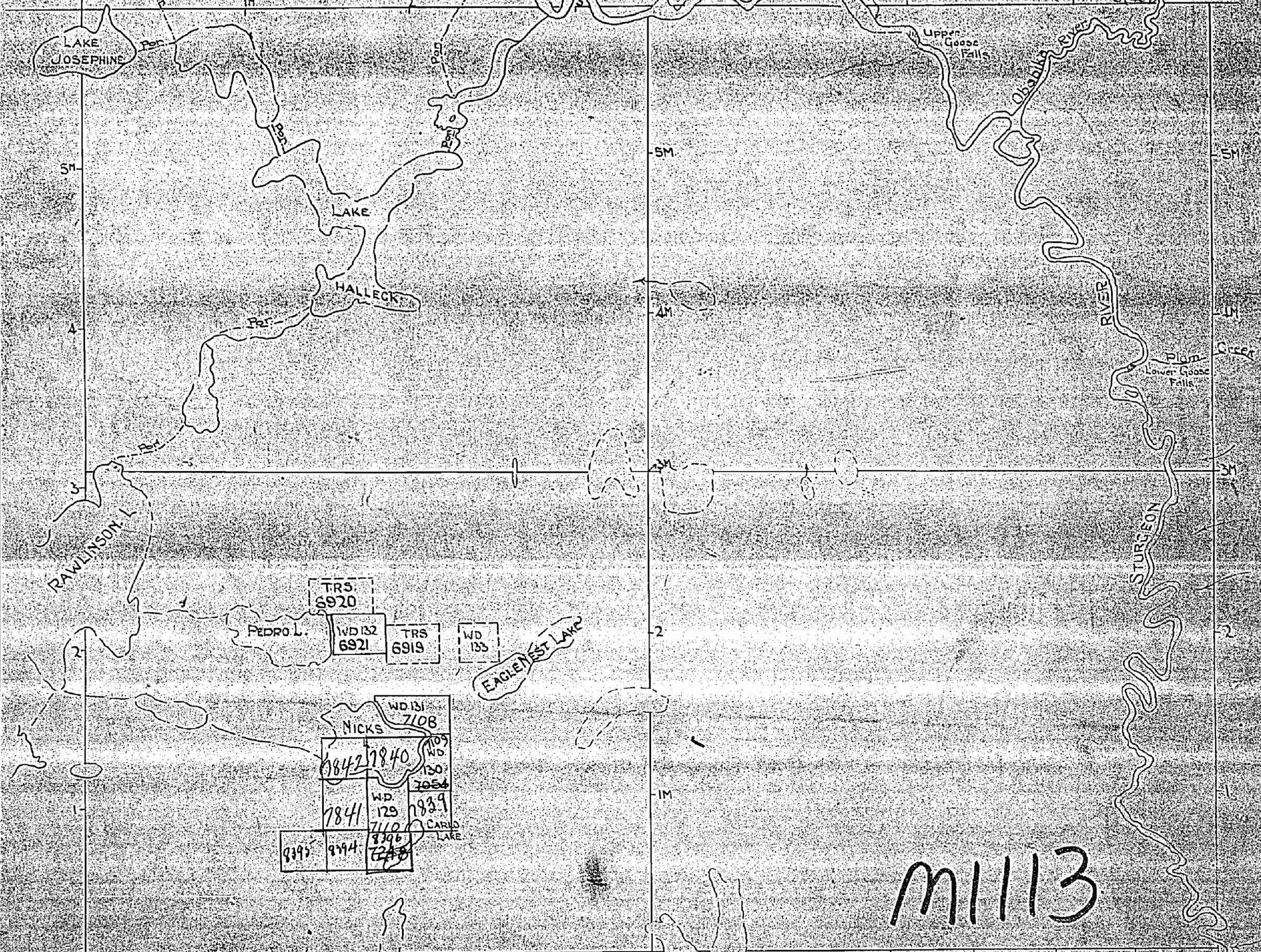

M1113

M^c C A R T H Y

DATE OF ISSUE
JAN 17 1935
NORTH BAY, ONT.

SUDBURY MINING DIVISION

scale 20 chains = 1 inch

PIT I = Reserved by Dept. of Highways
PIT II = Res. by Dept. of Highways
PIT III = Res. by Dept. of Highways

Q.P. 1-156
Expires 31/3/56

400' res

150' reserved on each side of Highway

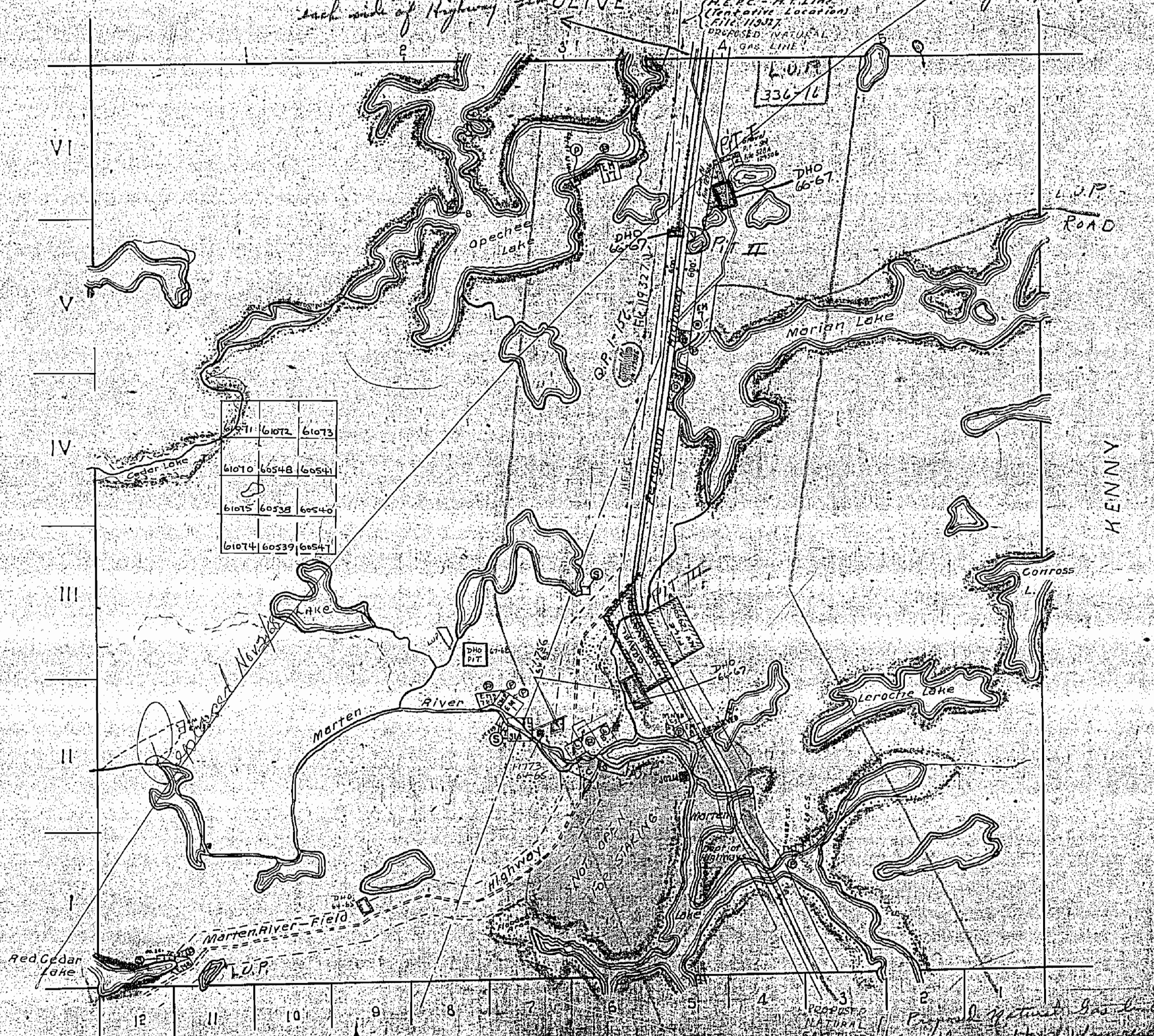

61071	61072	61073
61070	60548	60541
61075	60538	60540
61074	60539	60547

MCGALLUM

KENNY

MCLAREN

surface reservations 400 wide by Dept. of L.U.P. shown hereon thus

Proposed Natural Gas line
1 mile right of Highway reserved
on all sides on each side
of Natural Gas line
J. T. H. Dept. 1/55



Ministry of Natural Resources
Ministry of Northern Development and Mines

INDEX TO LAND DISPOSITION

PLAN
G-4104
TOWNSHIP

SHEPPARD

M.N.R. ADMINISTRATIVE DISTRICT
SUDBURY
MINING DIVISION
SUDBURY
LAND TITLES/REGISTRY DIVISION
SUDBURY

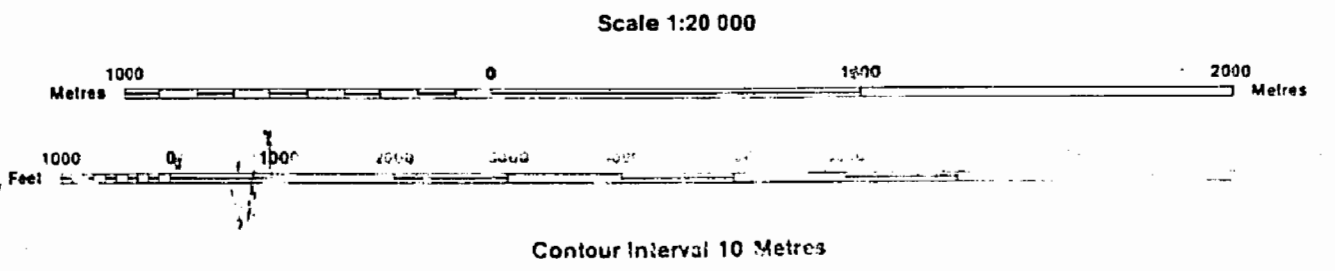

DATE OF ISSUE
MAY 6 1989
SUDBURY
MINING RECORDER'S OFFICE

AREAS WITHDRAWN FROM DISPOSITION

Description	Order No.	Date	Disposition
SEC. 35/80	W. 1/82	8/05/82	1-1-5
STURGEON RIVER PROVINCIAL PARK	ONTARIO REGULATION NO. 256/89	MAY 8, 1989	SCHEDULE NO. 230
OSABIKA RIVER PROVINCIAL PARK	ONTARIO REGULATION NO. 256/89	MAY 8, 1989	SCHEDULE 225

SYMBOLS

- Boundary Township, Meridian, Baseline
- Road allowances; surveyed shoreline
- Loi/Concession; surveyed/unsurveyed
- Parcel; surveyed/unsurveyed
- Right-of-way; road/railway/utility
- Reservation
- Cliff, Pit, Pile
- Contour interpolated/Approximate
- Depression
- Control point (horizontal)
- Flooded land
- Mine name
- Pipeline (above ground)
- Railway; single track/double track/abandoned
- Road; highway, county, township
- Transmission line

DISPOSITION OF CROWN LANDS

- Patent Surface & Mining Rights
- Surface Rights Only
- Mining Rights Only
- Lease Surface & Mining Rights
- Surface Rights Only
- Mining Rights Only
- Licence of Occupation
- Order-in-Council
- Cancelled
- Reservation
- Sand & Gravel
- LAND USE PERMIT

NOTE:
"THIS MAP SHOWS THE APPROXIMATE LOCATION OF THE BOUNDARIES OF THE AREA WHICH IS THE SUBJECT OF CURRENT LITIGATION. THE EXACT LOCATION WILL BE SHOWN FOLLOWING CONFIRMATION BY THE PARTIES TO THE ACTION"

THE INFORMATION THAT APPEARS ON THIS MAP HAS BEEN COMPILED FROM VARIOUS SOURCES, AND ACCURACY IS NOT GUARANTEED. THOSE WISHING TO STAKE MINING CLAIMS SHOULD CONSULT WITH THE MINING RECORDER, MINISTRY OF NORTHERN DEVELOPMENT AND MINES, FOR ADDITIONAL INFORMATION ON THE STATUS OF THE LANDS SHOWN HEREON.

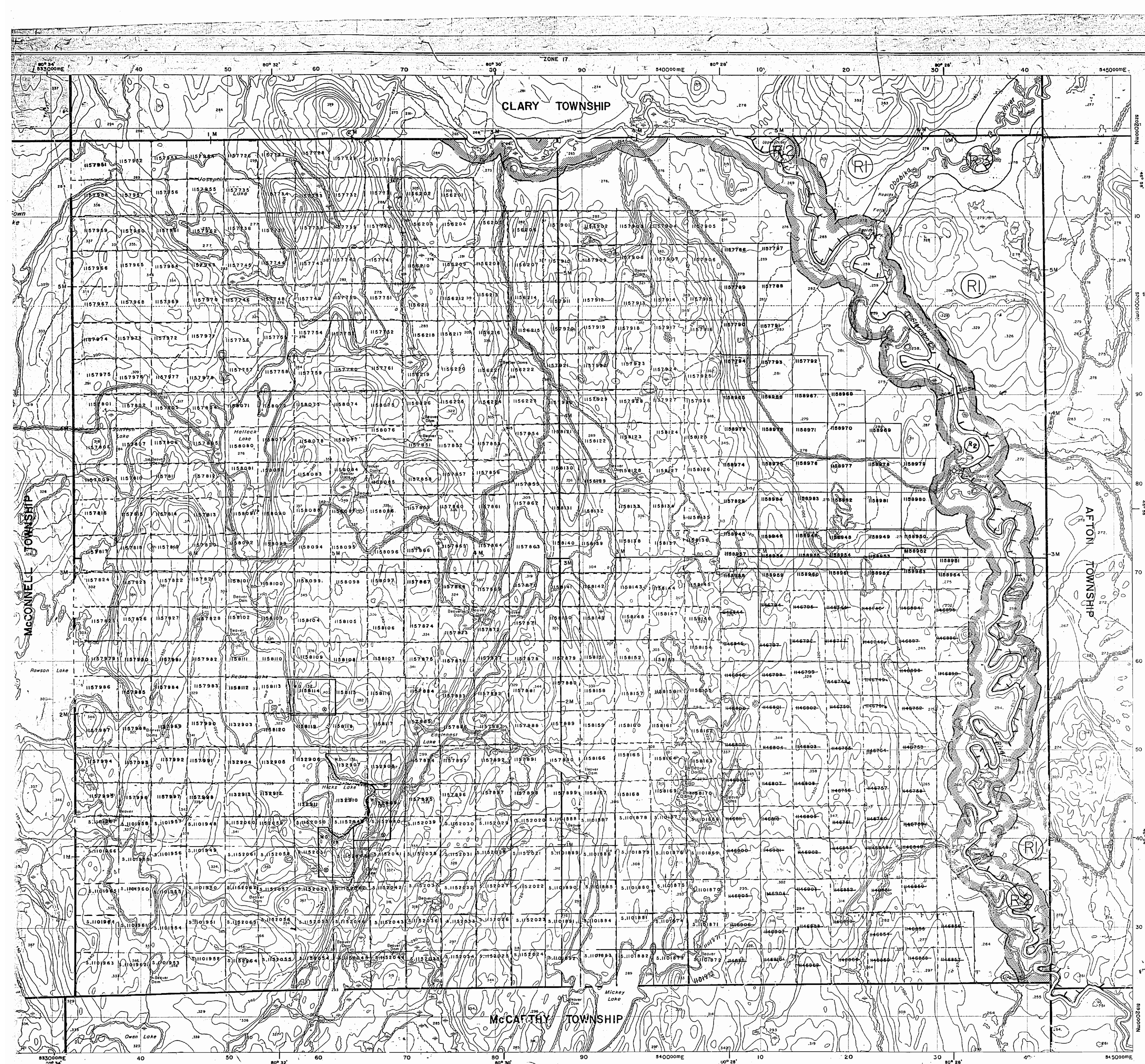

SHEPPARD TWP.

G-4104

1113

PLAN OF SHEPPARD TWP.

SUDBURY MINING DIVISION. DISTRICT OF SUDBURY

NOTE

400' Surface Rights Reservation
around all lakes & rivers.

Scale, 40 chains to an inch.

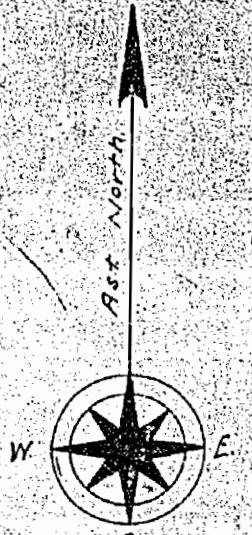

CLARY TWP.

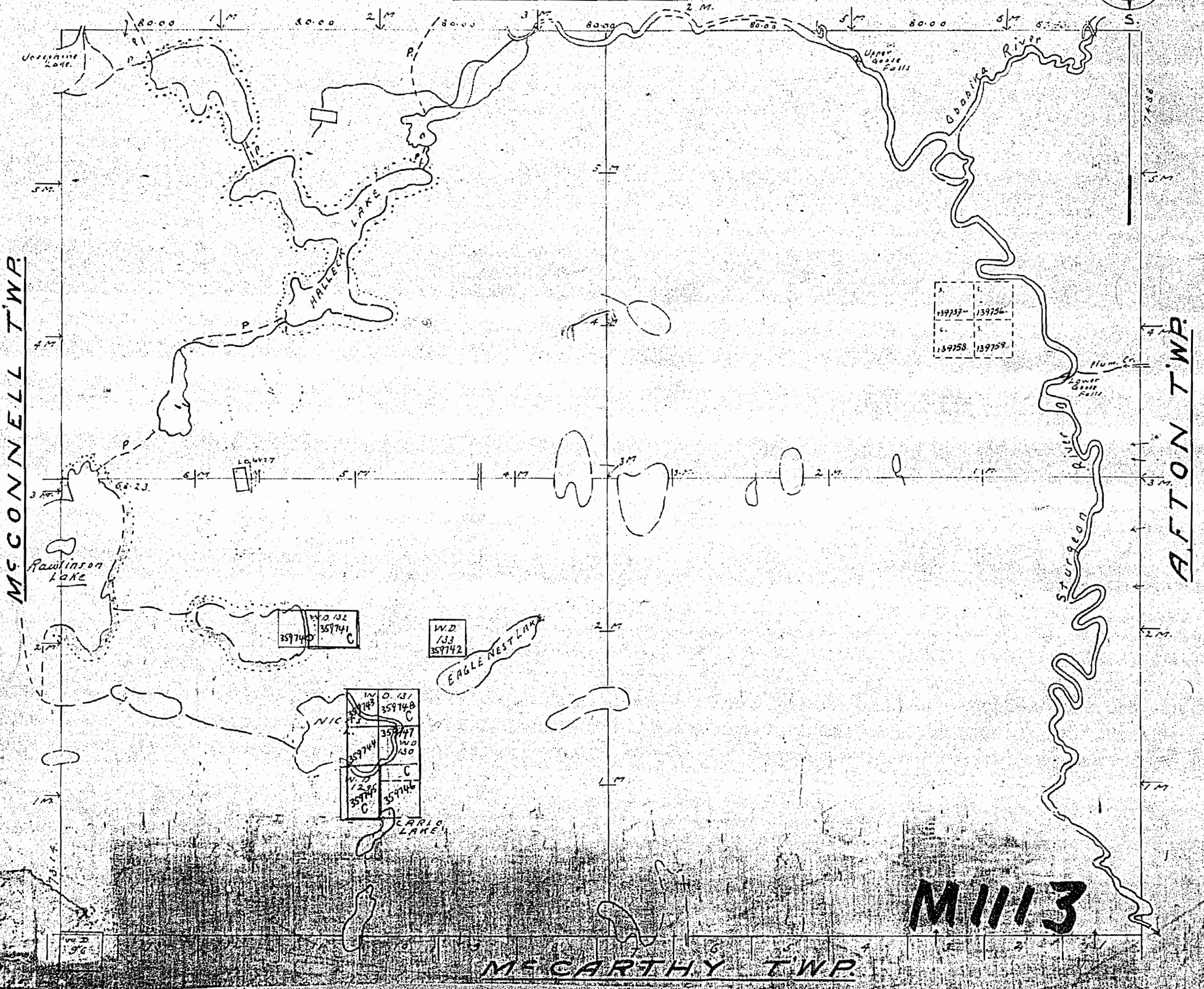

M1113

1113

SHEPPARD

DISTRICT OF SUDBURY

CLARY

Tom Res.

400 Res
200 Res
[Signature]

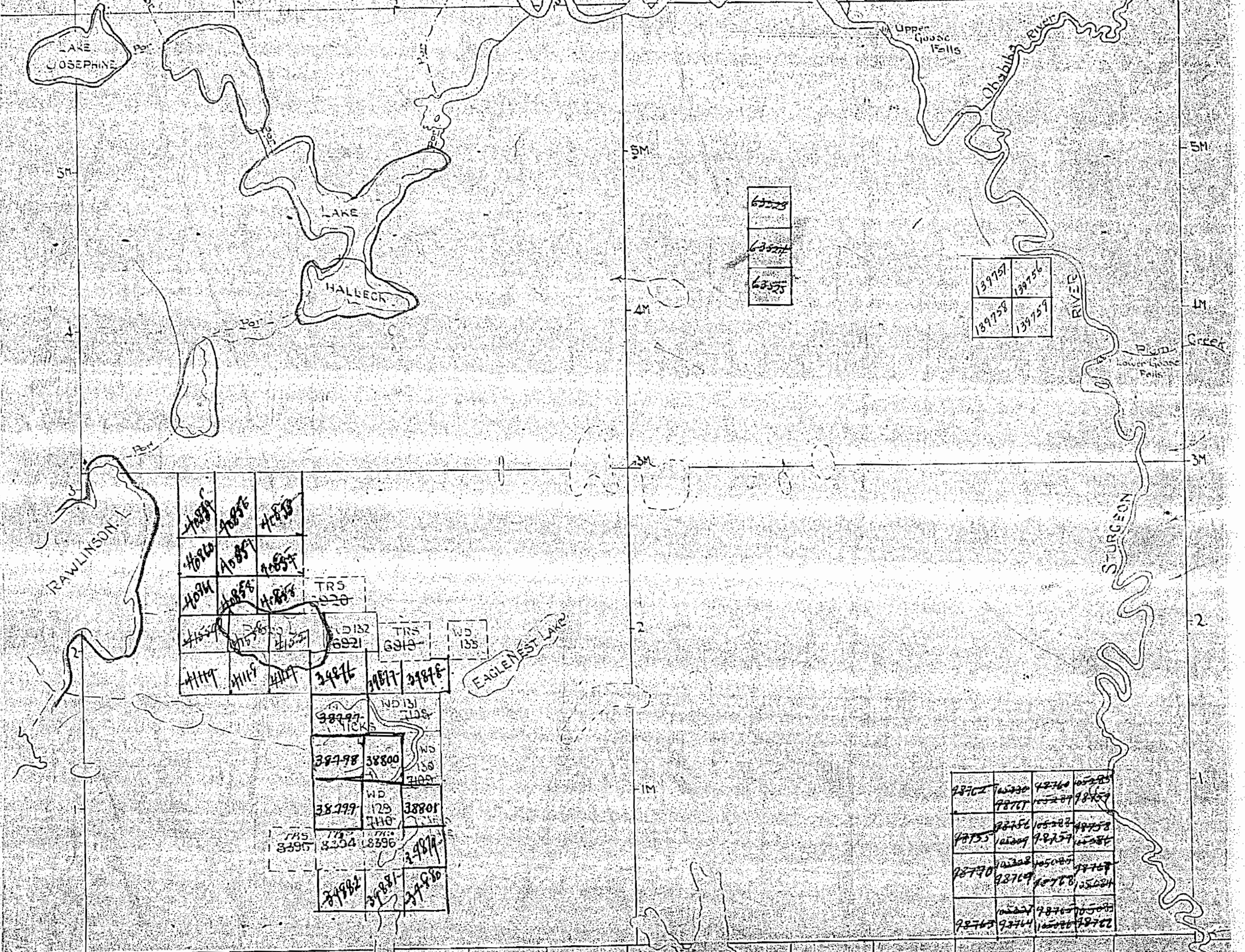

WD96

14

13

12

11

10

9

8

7

6

5

4

3

2

1

M^c C A R T H Y

M 1113

INDEX TO LAND DISPOSITION

PLAN
G-4104
TOWNSHIP
SHEPPARD

M.N.R. ADMINISTRATIVE TITLES
SUDBURY
MINING DIVISION
SUDBURY
LAND TITLES/PROSPECTIVITY DIVISION
SUDBURY

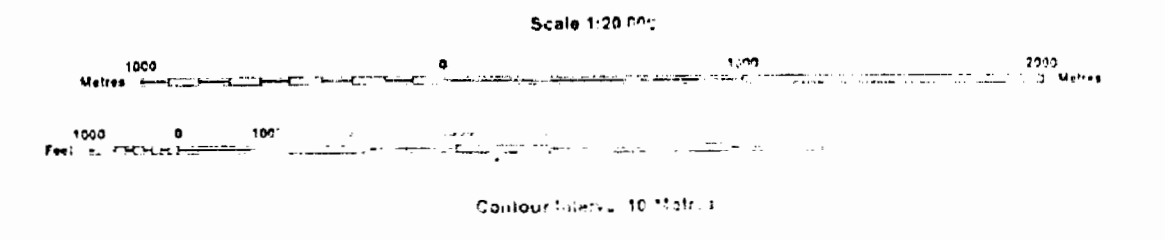

SYMBOLS

Table of symbols for various land features: Boundary, Township, Meridian, Baseline, Flood allowance, Lot/Concession, Parcel, Right-of-way, Reservation, Cliff, Contour, Pipeline, Railway, Road, etc.

AREAS WITHDRAWN FROM DISPOSITION

Table listing areas withdrawn from disposition: Sturgeon River Provincial Park, Obabika River Provincial Park, with their respective Ontario Regulations and Schedules.

DISPOSITION OF CROWN LANDS

Table of symbols for Crown Land dispositions: Patent, Lease, Licence of Occupation, Under-in-Council, Cancelled, Reservation, Strid & Jarvel, LAND USE PERMIT.

OBABIKA RIVER PROVINCIAL PARK
ONTARIO REGULATION NO.256/89 SCHEDULE NO.230
NOTE - THE LIMITS OF THE PARK ARE POSITION 200 METERS IN PERPENDICULAR DISTANCE FROM THE HIGH WATER MARK UNLESS OTHERWISE STATED ON THE SCHEDULE.

STURGEON RIVER PROVINCIAL PARK
ONTARIO REGULATION NO.256/89 SCHEDULE NO.230
NOTE - THE LIMITS OF THE PARK ARE POSITION 200 METERS IN PERPENDICULAR DISTANCE FROM THE HIGH WATER MARK UNLESS OTHERWISE STATED ON THE SCHEDULE.

THE INFORMATION THAT APPEARS ON THIS MAP HAS BEEN COMPILED FROM VARIOUS SOURCES AND ACCURACY IS NOT GUARANTEED. THOSE WISHING TO STAKE MINING CLAIMS SHOULD CONSULT WITH THE MINING RECORDER, MINISTRY OF NORTHERN DEVELOPMENT AND MINES, FOR ADDITIONAL INFORMATION ON THE STATUS OF THE LANDS SHOWN HEREON.

NOTES

400' surface rights reservation along the shores of all lakes and rivers.

Township closed to staking effective May 8/78, Section 38(f) of the Mining Act.

Ⓜ Section 36/80 WJ/82 11/05/82 M & S

Ⓜ Park Reserve WJO/83 12/10/83 M & S

CLARY TP. M. 721

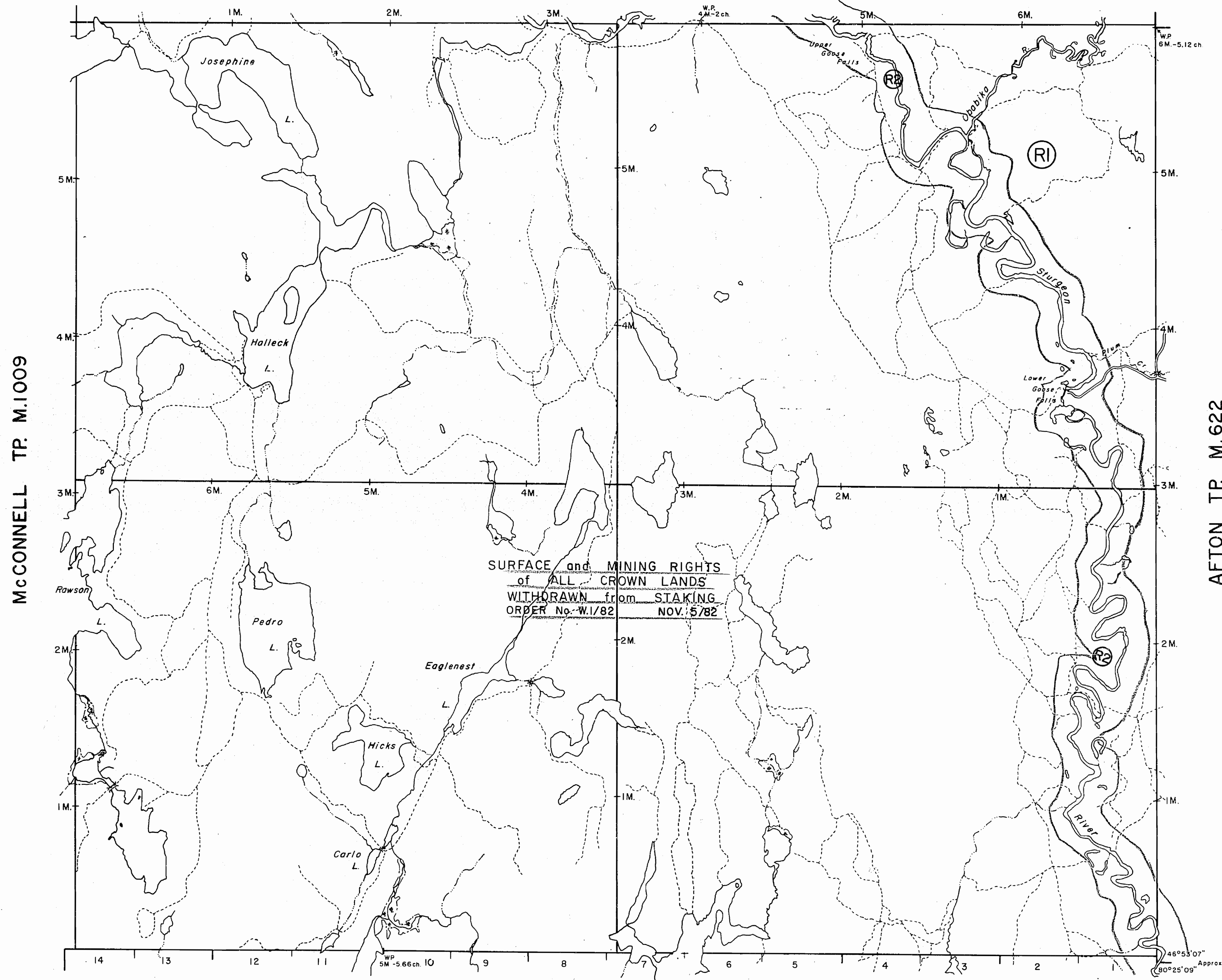

SURFACE and MINING RIGHTS
of ALL CROWN LANDS
WITHDRAWN from STAKING
ORDER No. W.1/82 NOV. 5/82

McCarthy TP. M.1007

LEGEND

- HIGHWAY AND ROUTE No.
- OTHER ROADS
- TRAILS
- SURVEYED LINES:
 - TOWNSHIPS, BASE LINES, ETC.
 - LOTS, MINING CLAIMS, PARCELS, ETC.
- UNSURVEYED LINES:
 - LOT LINES
 - PARCEL BOUNDARY
 - MINING CLAIMS ETC.
- RAILWAY AND RIGHT OF WAY
- UTILITY LINES
- NON-PERENNIAL STREAM
- FLOODING OR FLOODING RIGHTS
- SUBDIVISION
- ORIGINAL SHORELINE
- MARSH OR MUSKEG
- MINES

DISPOSITION OF CROWN LANDS

TYPE OF DOCUMENT	SYMBOL
PATENT, SURFACE & MINING RIGHTS	
" SURFACE RIGHTS ONLY	
" MINING RIGHTS ONLY	
LEASE, SURFACE & MINING RIGHTS	
" SURFACE RIGHTS ONLY	
" MINING RIGHTS ONLY	
LICENCE OF OCCUPATION	
CROWN LAND SALE	C.S.
ORDER-IN-COUNCIL	OC
RESERVATION	
CANCELLED	
SAND & GRAVEL	

SCALE: 1 INCH = 40 CHAINS

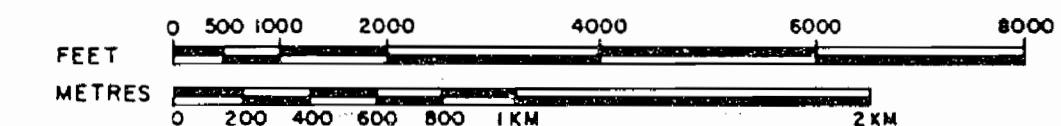

ACRES HECTARES

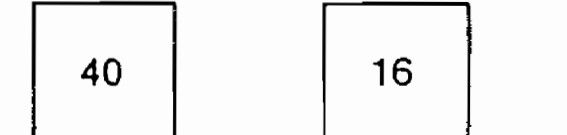

TOWNSHIP

SHEPPARD

DISTRICT

SUDBURY

MINING DIVISION

SUDBURY



Ministry of Natural Resources

Ontario Surveys and Mapping Branch

Date FEB 1/74

Plan No.

Whitney Block
Queen's Park, Toronto

M. 1113

PLAN OF SHEPPARD TWP.

SUDBURY MINING DIVISION. DISTRICT OF SUDBURY

NOTE

400' Surface Rights Reservation
around all lakes & rivers.

Scale, 40 chains to an inch.

CLARY TWP.

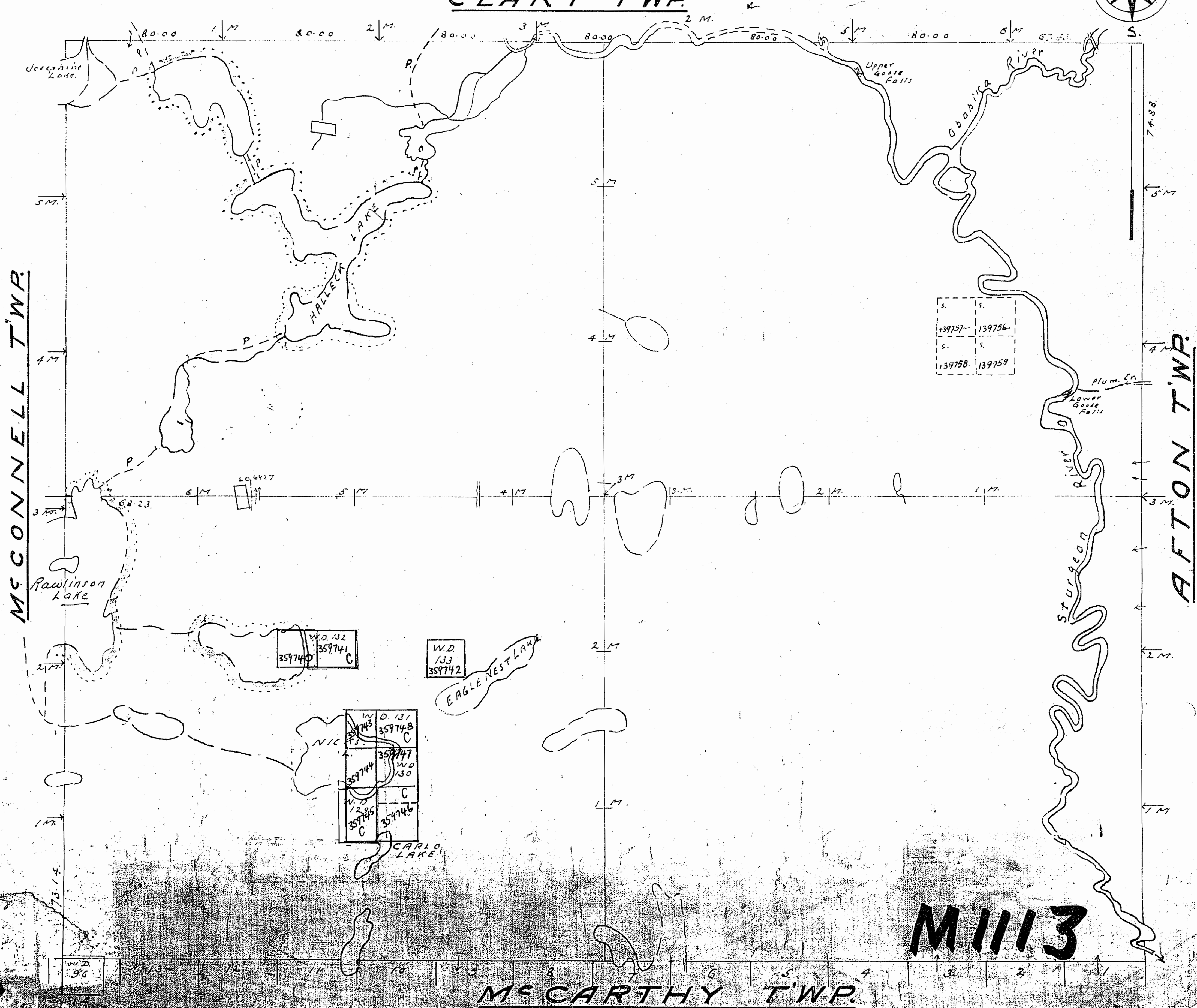
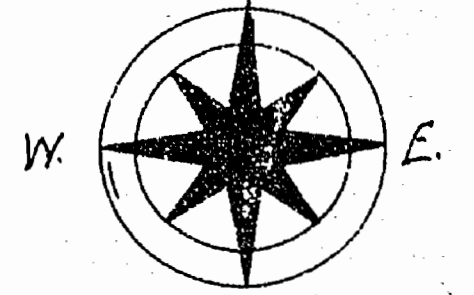

MCCARTHY TWP.

SHEPPARD

DISTRICT OF SUDBURY

Tom Res.

*400' Res.
200' Res.*

C L A R Y

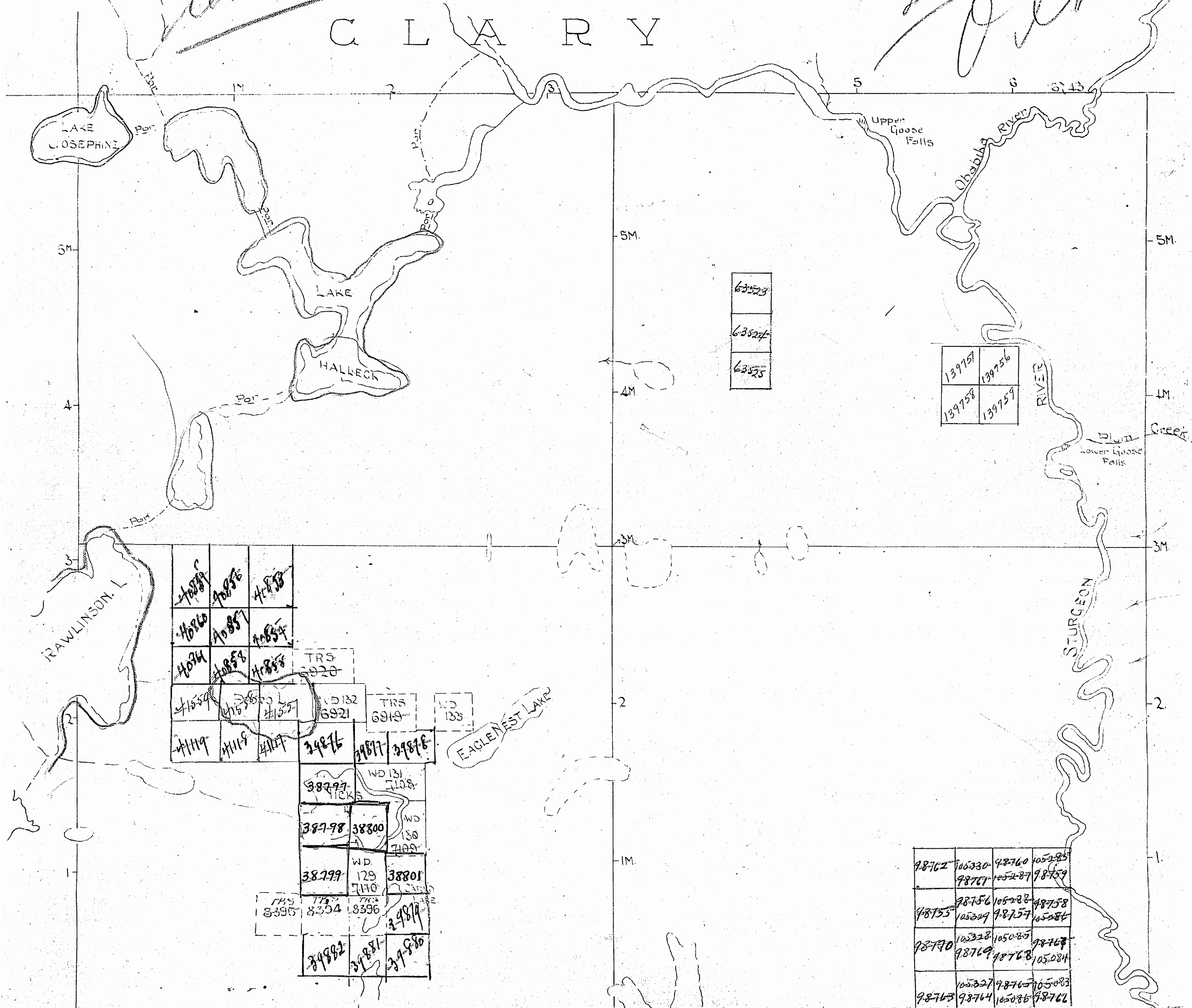

WD96

14

13

12

11

10

9

8

6

5

4

3

2

1

M^c C A R T

1113

M1113

INDEX TO LAND DISPOSITION

PLAN G-4104 SHEPPARD

M.N.R. ADMINISTRATIVE DISTRICT SUDBURY MINING DIVISION SUDBURY LAND TITLES/REGISTRY DIVISION SUDBURY

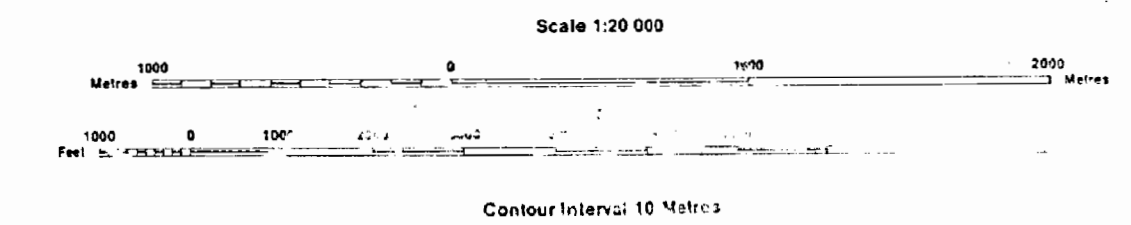

SYMBOLS

Table of symbols for Boundary, Township, Meridian, Baseline, Road allowance, Lot/Concession, Parcel, Right-of-way, Reservation, Contour, Flooded land, Mine, Pipeline, Railway, Road, etc.

AREAS WITHDRAWN FROM DISPOSITION. Table with columns: Description, Order No., Date, Disposition. Includes Sturgeon River Provincial Park and Obabika River Provincial Park.

NOTE: THIS MAP SHOWS THE APPROXIMATE LOCATION OF THE BOUNDARIES OF THE AREA WHICH IS THE SUBJECT OF CURRENT LITIGATION...

DISPOSITION OF CROWN LANDS

Table of Crown Land Dispositions: Patent, Lease, Licence of Occupation, Order-in-Council, Cancelled, Reservation, Sand & Gravel, LAND USE PERMIT.

DATE OF ISSUE: JAN 27 1989. SUDBURY MINING RECORDERS OFFICE.

THE INFORMATION THAT APPEARS ON THIS MAP HAS BEEN COMPILED FROM VARIOUS SOURCES, AND ACCURACY IS NOT GUARANTEED...

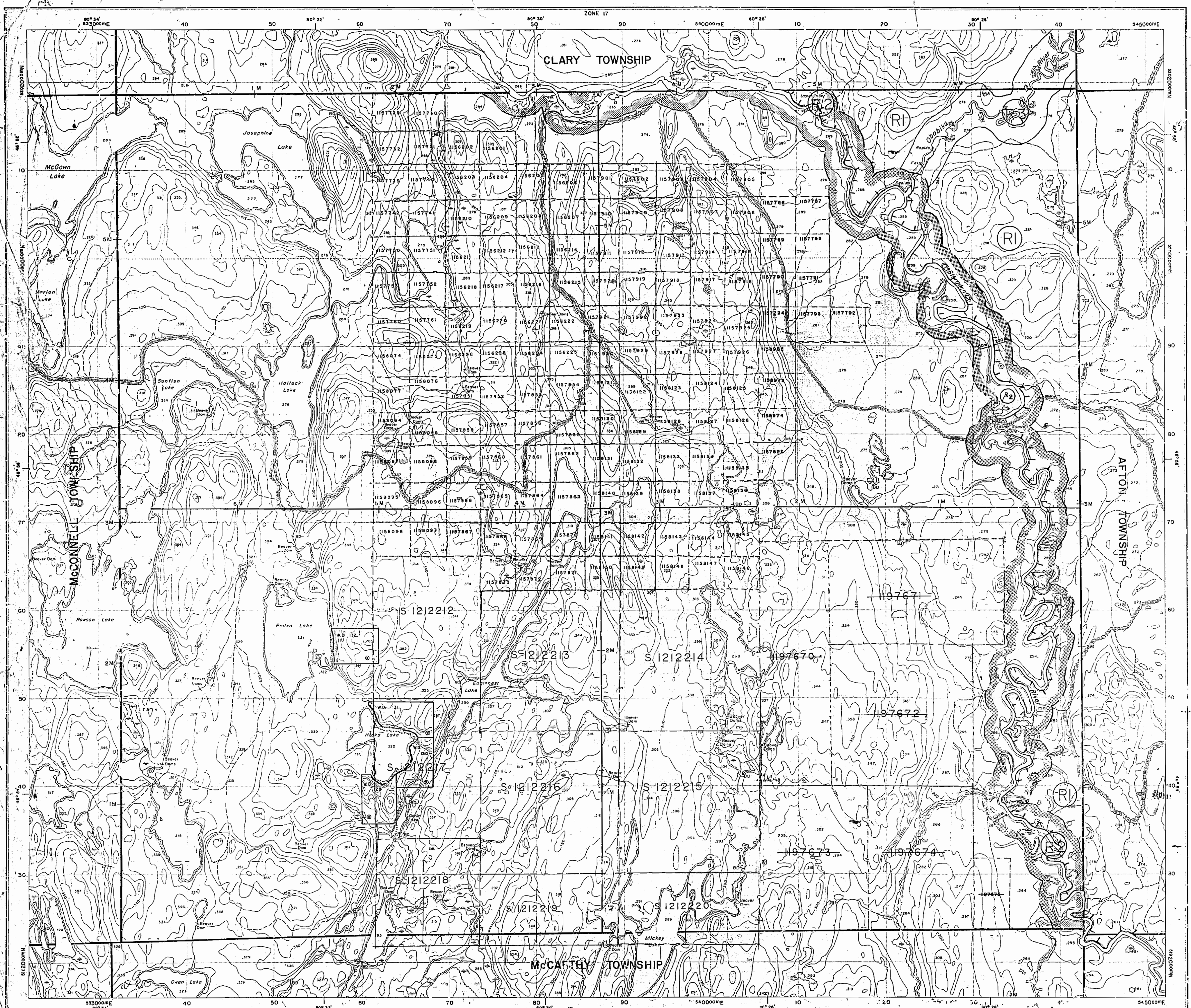

SHEPPARD TWP

G-4104

1113

SHEPPARD

DISTRICT OF SUDBURY

RECEIVED
JAN 18 1936
MINING DISTRICT

CLARY

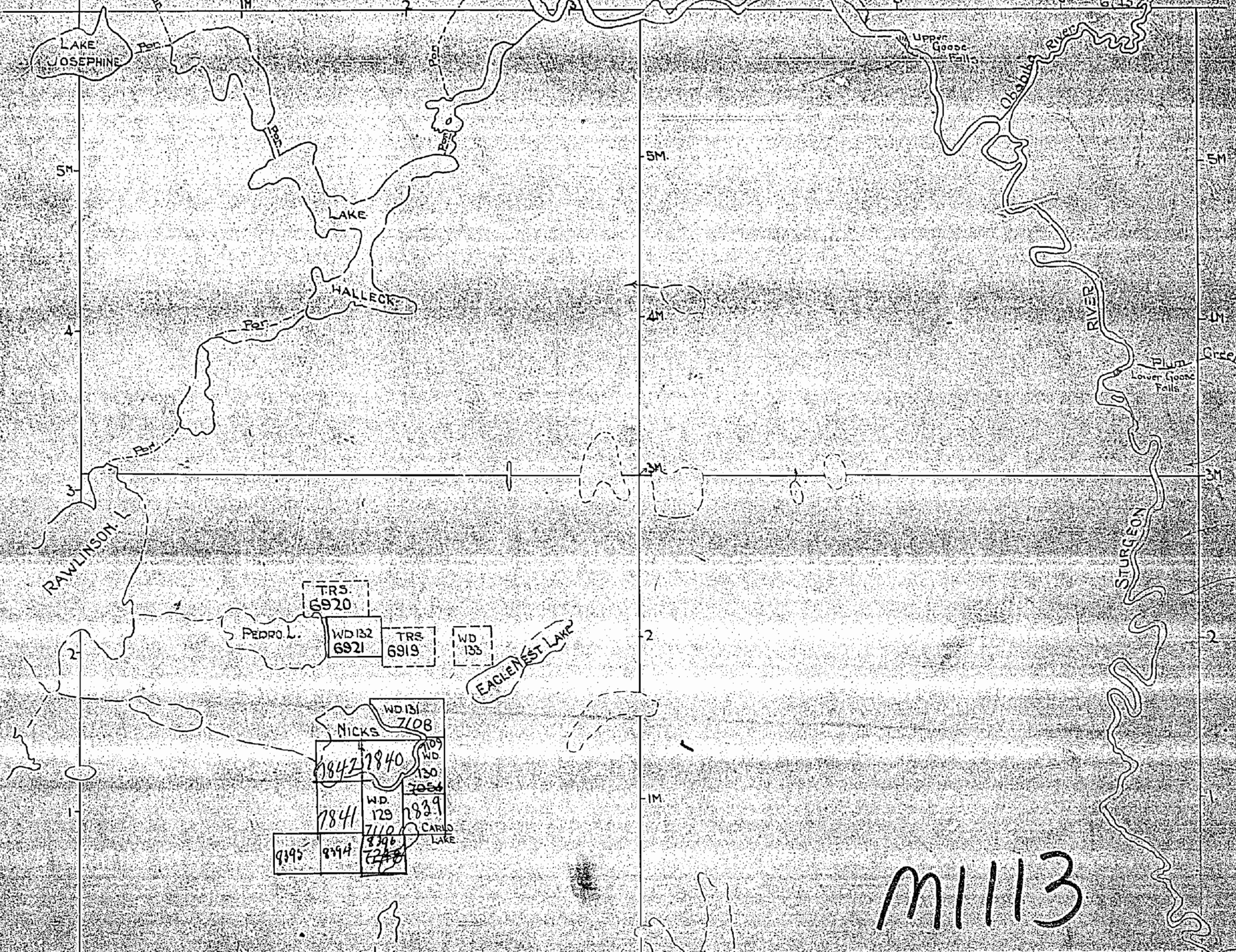

M1113

ND 96

14 13 12 11 10 9 8 7 6 5 4 3 2 1

M^c C A R T H Y

DATE OF ISSUE
JAN 17 1935
NORTH BAY, ONT.

1113

PLAN OF SHEPPARD TWP.

SUDBURY MINING DIVISION.
DISTRICT OF SUDBURY

NOTE

400' Surface Rights Reservation
around all lakes & rivers.

Scale, 40 chains to an inch.

CLARY TWP.

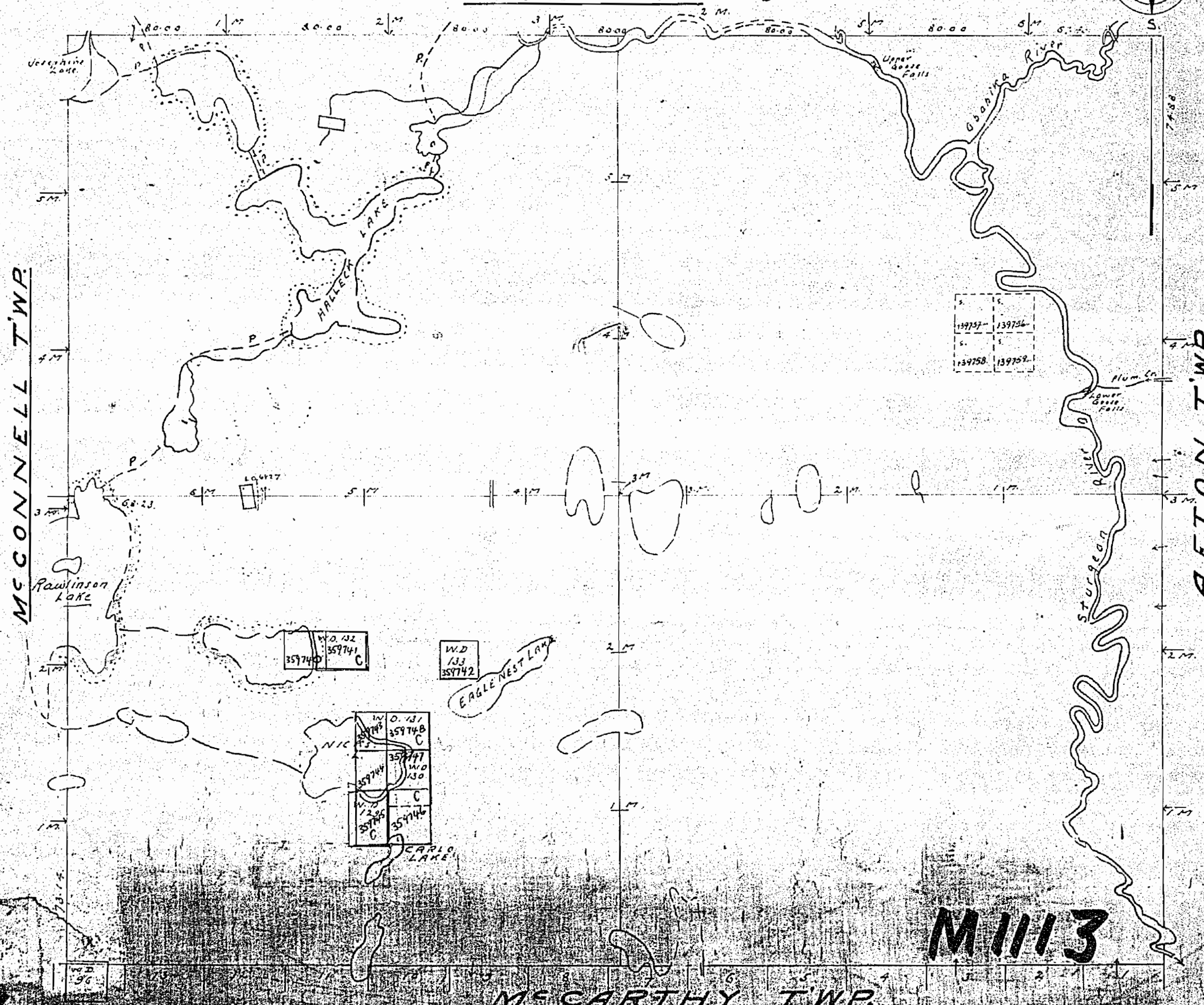
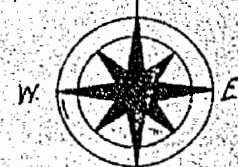

MCCONNELL TWP.

AFTON TWP.

MCCARTHY TWP.

1113

NOTES

400' surface rights reservation along the shores of all lakes and rivers.

Township closed to staking effective May 8/78, Section 38(f) of the Mining Act.

CLARY TP. M. 721

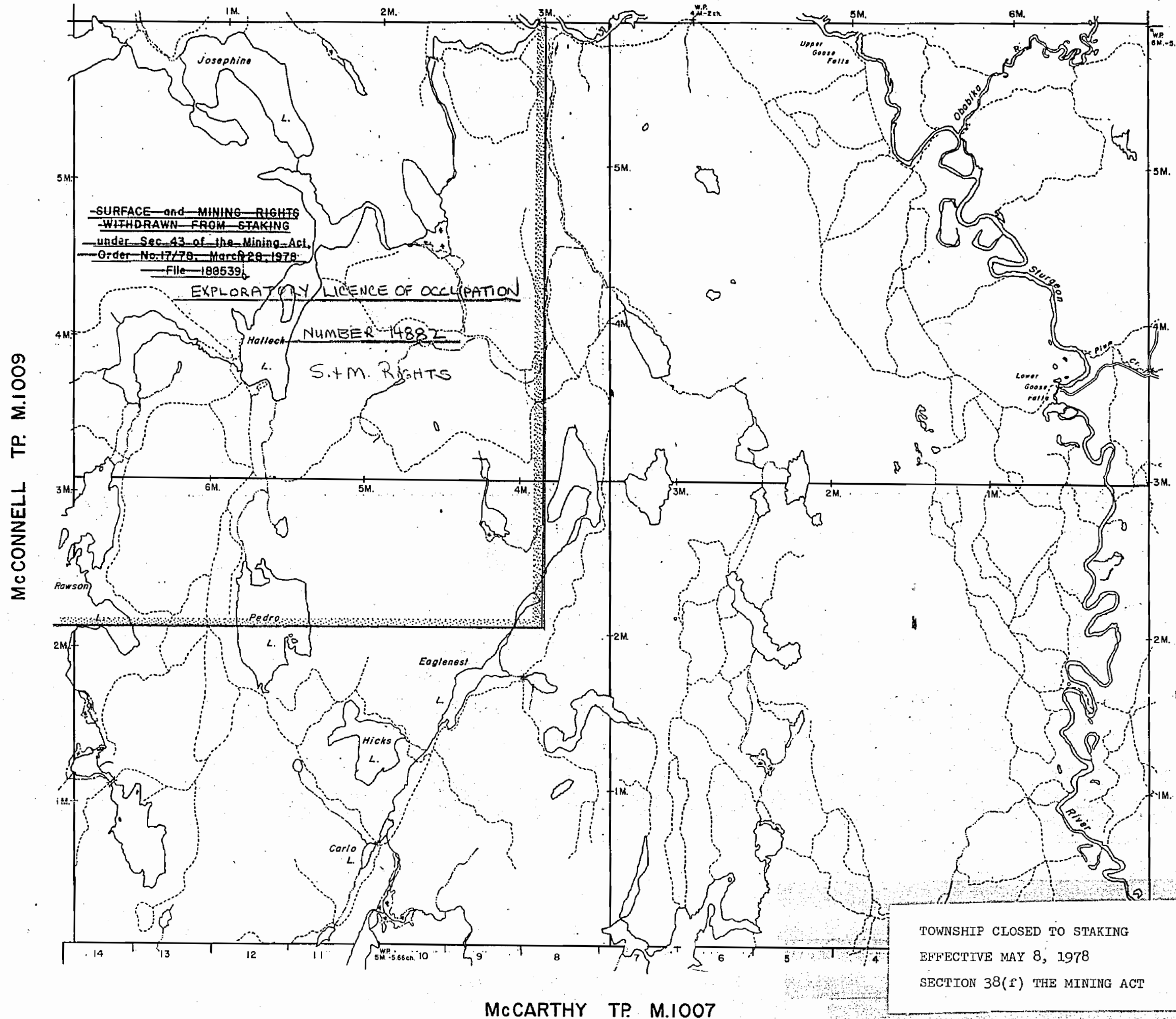

DATE OF ISSUE
JUN 2 1978

TOWNSHIP CLOSED TO STAKING
EFFECTIVE MAY 8, 1978
SECTION 38(f) THE MINING ACT

McCARTHY TP. M.1007

LEGEND

- HIGHWAY AND ROUTE No.
- OTHER ROADS
- TRAILS
- SURVEYED LINES:
TOWNSHIPS, BASE LINES, ETC.
- LOTS, MINING CLAIMS, PARCELS, ETC.
- UNSURVEYED LINES:
LOT LINES
- PARCEL BOUNDARY
- MINING CLAIMS ETC.
- RAILWAY AND RIGHT OF WAY
- UTILITY LINES
- NON-PERENNIAL STREAM
- FLOODING OR FLOODING RIGHTS
- SUBDIVISION
- ORIGINAL SHORELINE
- MARSH OR MUSKEG
- MINES

DISPOSITION OF CROWN LANDS

TYPE OF DOCUMENT	SYMBOL
PATENT, SURFACE & MINING RIGHTS	
" SURFACE RIGHTS ONLY	
" MINING RIGHTS ONLY	
LEASE, SURFACE & MINING RIGHTS	
" SURFACE RIGHTS ONLY	
" MINING RIGHTS ONLY	
LICENCE OF OCCUPATION	
CROWN LAND SALE	
ORDER-IN-COUNCIL	
RESERVATION	
CANCELLED	
SAND & GRAVEL	

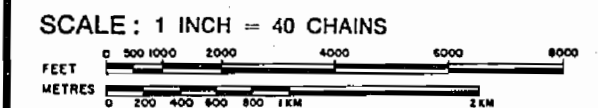

ACRES	HECTARES
40	16

TOWNSHIP
SHEPPARD
DISTRICT
SUBBURY
MINING DIVISION
SUBBURY

Ministry of Natural Resources
Ontario Surveys and Mapping Branch
Date FEB. 1/74. Plan No. M. 1113
Whitney Block Queen's Park, Toronto

NOTES

400' surface rights reservation along the shores of all lakes and rivers.

DATE OF ISSUE
MAY 31 1974

CLARY TP. M. 721

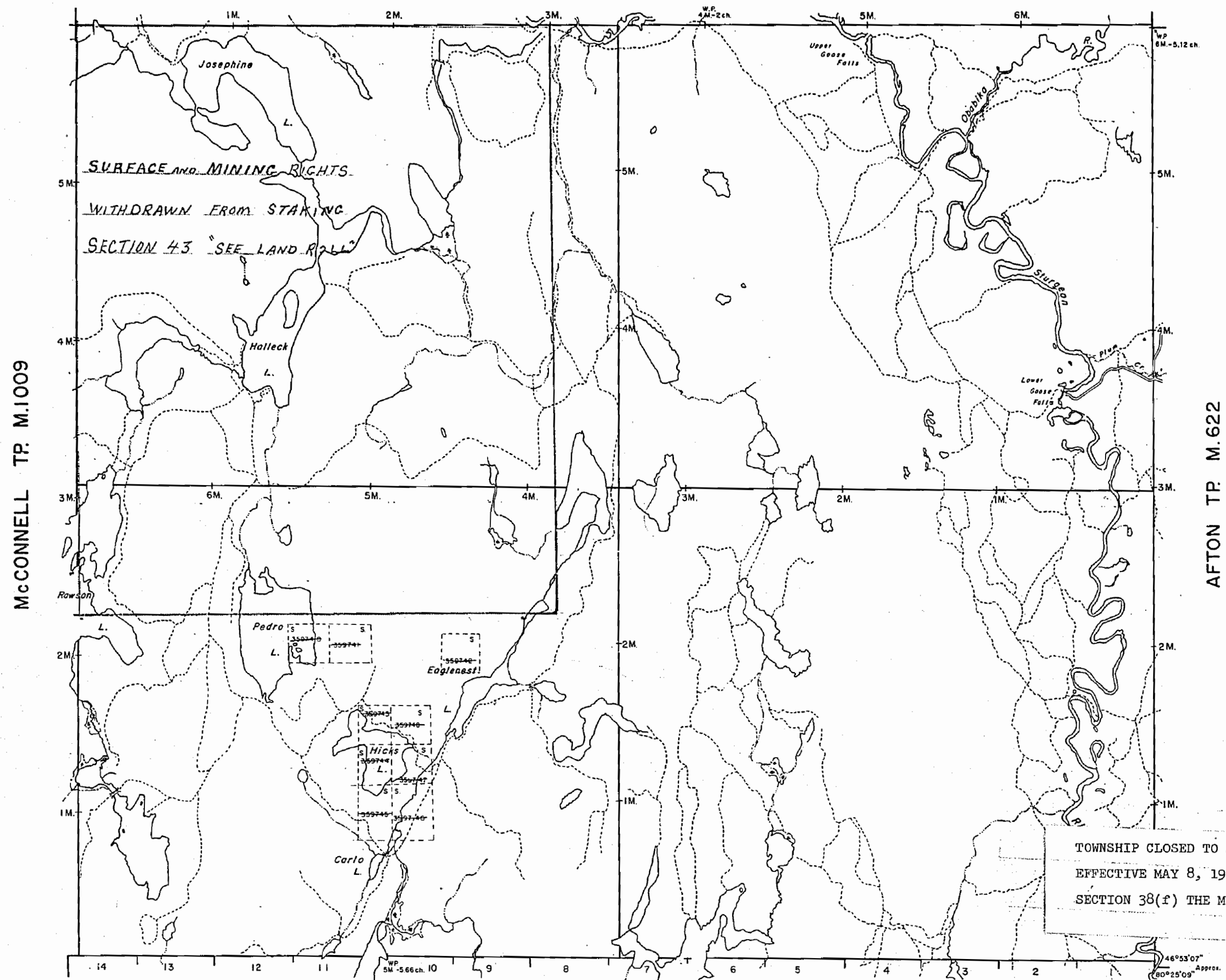

SURFACE AND MINING RIGHTS
WITHDRAWN FROM STAKING
SECTION 43 "SEE LAND ROLL"

TOWNSHIP CLOSED TO STAKING
EFFECTIVE MAY 8, 1978
SECTION 38(f) THE MINING ACT

LEGEND

- HIGHWAY AND ROUTE No.
- OTHER ROADS
- TRAILS
- SURVEYED LINES:
TOWNSHIPS, BASE LINES, ETC.
- LOTS, MINING CLAIMS, PARCELS, ETC.
- UNSURVEYED LINES:
LOT LINES
- PARCEL BOUNDARY
- MINING CLAIMS ETC.
- RAILWAY AND RIGHT OF WAY
- UTILITY LINES
- NON-PERENNIAL STREAM
- FLOODING OR FLOODING RIGHTS
- SUBDIVISION
- ORIGINAL SHORELINE
- MARSH OR MUSKEG
- MINES

DISPOSITION OF CROWN LANDS

TYPE OF DOCUMENT	SYMBOL
PATENT, SURFACE & MINING RIGHTS	
" SURFACE RIGHTS ONLY	
" MINING RIGHTS ONLY	
LEASE, SURFACE & MINING RIGHTS	
" SURFACE RIGHTS ONLY	
" MINING RIGHTS ONLY	
LICENCE OF OCCUPATION	
CROWN LAND SALE	C.S.
ORDER-IN-COUNCIL	O.C.
RESERVATION	
CANCELLED	
SAND & GRAVEL	

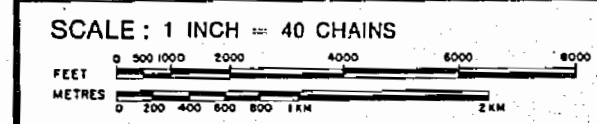

ACRES	HECTARES
40	16

TOWNSHIP
SHEPPARD

SUDBURY
DIVISION
SUDBURY

McCARTHY TP. M.1007

Ministry of Natural Resources
Ontario Surveys and Mapping Branch
Date FEB 1/74 Plan No. M.1113
Whitney Block Queen's Park, Toronto

1113

SHEPPARD

DISTRICT OF SUDBURY

Thorn Res.

*400' Res.
500' Res.*

C L A R Y

LAKE JOSEPHINE

LAKE

HALBECK

Upper Goose Falls

Chabibla River

RIVER

Lower Goose Falls

STURGEON RIVER

RAWLINSON

EAGLENEST LAKE

4089	4086	4083	
4080	4087	4084	
4084	4085	4088	TRS 3020
4154	4155	4157	4152
4119	4118	4117	4151
		3466	3467
		3468	3469
		3470	3471
		3472	3473
		3474	3475
		3476	3477
		3478	3479
		3480	3481
		3482	3483
		3484	3485
		3486	3487
		3488	3489
		3490	3491
		3492	3493
		3494	3495
		3496	3497
		3498	3499
		3500	3501
		3502	3503
		3504	3505
		3506	3507
		3508	3509
		3510	3511
		3512	3513
		3514	3515
		3516	3517
		3518	3519
		3520	3521
		3522	3523
		3524	3525
		3526	3527
		3528	3529
		3530	3531
		3532	3533
		3534	3535
		3536	3537
		3538	3539
		3540	3541
		3542	3543
		3544	3545
		3546	3547
		3548	3549
		3550	3551
		3552	3553
		3554	3555
		3556	3557
		3558	3559
		3560	3561
		3562	3563
		3564	3565
		3566	3567
		3568	3569
		3570	3571
		3572	3573
		3574	3575
		3576	3577
		3578	3579
		3580	3581
		3582	3583
		3584	3585
		3586	3587
		3588	3589
		3590	3591
		3592	3593
		3594	3595
		3596	3597
		3598	3599
		3600	3601
		3602	3603
		3604	3605
		3606	3607
		3608	3609
		3610	3611
		3612	3613
		3614	3615
		3616	3617
		3618	3619
		3620	3621
		3622	3623
		3624	3625
		3626	3627
		3628	3629
		3630	3631
		3632	3633
		3634	3635
		3636	3637
		3638	3639
		3640	3641
		3642	3643
		3644	3645
		3646	3647
		3648	3649
		3650	3651
		3652	3653
		3654	3655
		3656	3657
		3658	3659
		3660	3661
		3662	3663
		3664	3665
		3666	3667
		3668	3669
		3670	3671
		3672	3673
		3674	3675
		3676	3677
		3678	3679
		3680	3681
		3682	3683
		3684	3685
		3686	3687
		3688	3689
		3690	3691
		3692	3693
		3694	3695
		3696	3697
		3698	3699
		3700	3701
		3702	3703
		3704	3705
		3706	3707
		3708	3709
		3710	3711
		3712	3713
		3714	3715
		3716	3717
		3718	3719
		3720	3721
		3722	3723
		3724	3725
		3726	3727
		3728	3729
		3730	3731
		3732	3733
		3734	3735
		3736	3737
		3738	3739
		3740	3741
		3742	3743
		3744	3745
		3746	3747
		3748	3749
		3750	3751
		3752	3753
		3754	3755
		3756	3757
		3758	3759
		3760	3761
		3762	3763
		3764	3765
		3766	3767
		3768	3769
		3770	3771
		3772	3773
		3774	3775
		3776	3777
		3778	3779
		3780	3781
		3782	3783
		3784	3785
		3786	3787
		3788	3789
		3790	3791
		3792	3793
		3794	3795
		3796	3797
		3798	3799
		3800	3801
		3802	3803
		3804	3805
		3806	3807
		3808	3809
		3810	3811
		3812	3813
		3814	3815
		3816	3817
		3818	3819
		3820	3821
		3822	3823
		3824	3825
		3826	3827
		3828	3829
		3830	3831
		3832	3833
		3834	3835
		3836	3837
		3838	3839
		3840	3841
		3842	3843
		3844	3845
		3846	3847
		3848	3849
		3850	3851
		3852	3853
		3854	3855
		3856	3857
		3858	3859
		3860	3861
		3862	3863
		3864	3865
		3866	3867
		3868	3869
		3870	3871
		3872	3873
		3874	3875
		3876	3877
		3878	3879
		3880	3881
		3882	3883
		3884	3885
		3886	3887
		3888	3889
		3890	3891
		3892	3893
		3894	3895
		3896	3897
		3898	3899
		3900	3901
		3902	3903
		3904	3905
		3906	3907
		3908	3909
		3910	3911
		3912	3913
		3914	3915
		3916	3917
		3918	3919
		3920	3921
		3922	3923
		3924	3925
		3926	3927
		3928	3929
		3930	3931
		3932	3933
		3934	3935
		3936	3937
		3938	3939
		3940	3941
		3942	3943
		3944	3945
		3946	3947
		3948	3949
		3950	3951
		3952	3953
		3954	3955
		3956	3957
		3958	3959
		3960	3961
		3962	3963
		3964	3965
		3966	3967
		3968	3969
		3970	3971
		3972	3973
		3974	3975
		3976	3977
		3978	3979
		3980	3981
		3982	3983
		3984	3985
		3986	3987
		3988	3989
		3990	3991
		3992	3993
		3994	3995
		3996	3997
		3998	3999
		4000	4001

63523
63524
63525

139757	139756
139758	139759

WD96

14 13 12 11 10 9 8 7 6 5 4 3 2 1

M^c C A R T H Y

M1113

TWP

NOTES

400' surface rights reservation along the shores of all lakes and rivers.

Township closed to staking effective May 8/78, Section 38(1) of the Mining Act.

TOWNSHIP CLOSED TO STAKING
EFFECTIVE MAY 8, 1978
SECTION 38(1) THE MINING ACT

Township Closed to Staking
Effective Nov. 5, 1982,
Section 36(1) (a) The Mining Act.



OFFICE USE ONLY

CLARY TP. M. 721

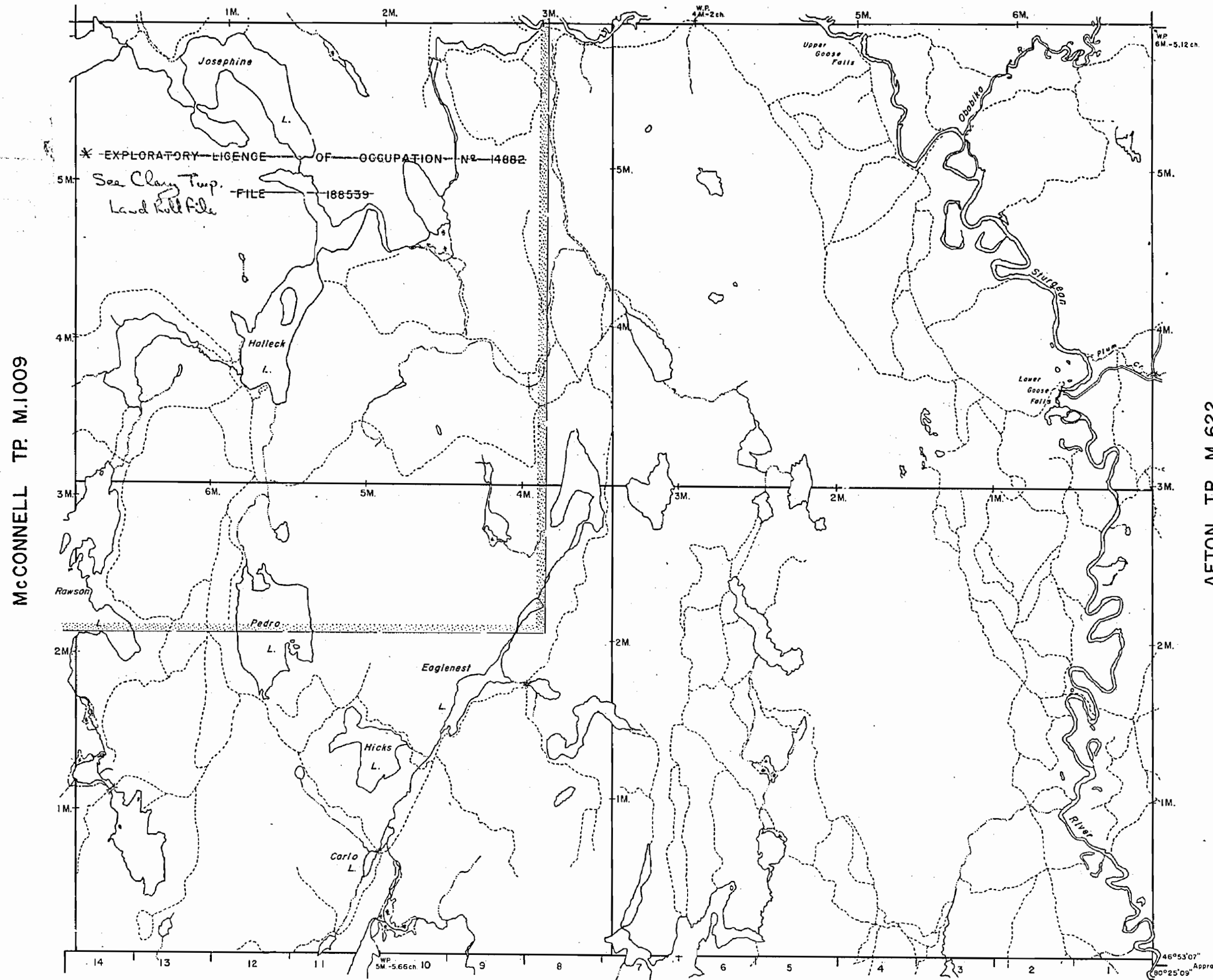

LEGEND

- HIGHWAY AND ROUTE No.
- OTHER ROADS
- TRAILS
- SURVEYED LINES:
 - TOWNSHIPS, BASE LINES, ETC.
 - LOTS, MINING CLAIMS, PARCELS, ETC.
- UNSURVEYED LINES:
 - LOT LINES
 - PARCEL BOUNDARY
 - MINING CLAIMS ETC.
- RAILWAY AND RIGHT OF WAY
- UTILITY LINES
- NON-PERENNIAL STREAM
- FLOODING OR FLOODING RIGHTS
- SUBDIVISION
- ORIGINAL SHORELINE
- MARSH OR MUSKEG
- MINES

DISPOSITION OF CROWN LANDS

TYPE OF DOCUMENT	SYMBOL
PATENT, SURFACE & MINING RIGHTS	
" SURFACE RIGHTS ONLY	
" MINING RIGHTS ONLY	
LEASE, SURFACE & MINING RIGHTS	
" SURFACE RIGHTS ONLY	
" MINING RIGHTS ONLY	
LICENCE OF OCCUPATION	
CROWN LAND SALE	
ORDER-IN-COUNCIL	
RESERVATION	
CANCELLED	
SAND & GRAVEL	

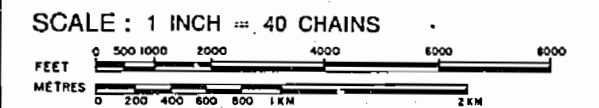

TOWNSHIP
SHEPPARD

DISTRICT
SUDBURY

MINING DIVISION
SUDBURY

Ministry of Natural Resources
Ontario Surveys and Mapping Branch

Date FEB. 1/74. Plan No. M.1113

Whitney Block
Queen's Park, Toronto

AFTON TP. M. 622

MCCARTHY TP. M.1007