

Sweatman Twp.







THE TOWNSHIP OF
OF
SHERRING

DISTRICT OF
COCHRANE

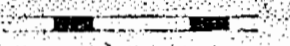
LARDER LAKE
MINING DIVISION

SCALE: 1-INCH=40 CHAINS

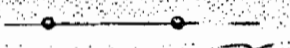
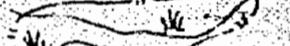
LEGEND

- PATENTED LAND Ⓟ
- CROWN LAND SALE C.S.
- LEASES Ⓛ
- LOCATED LAND Loc.
- LICENSE OF OCCUPATION L.O.
- ROADS 
- IMPROVED ROADS 
- KING'S HIGHWAY 
- RAILWAYS 
- POWER LINES 
- MARSH OR MUSKEG 
- MINES 

NOTES

Lands subject to Flooding Rts. on shores of Mistango R. & Edwards Cr. shown thus

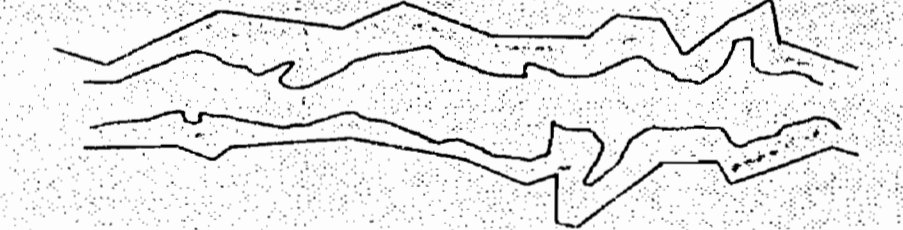

400' Surface Rights Reservation around all Lakes and Rivers.

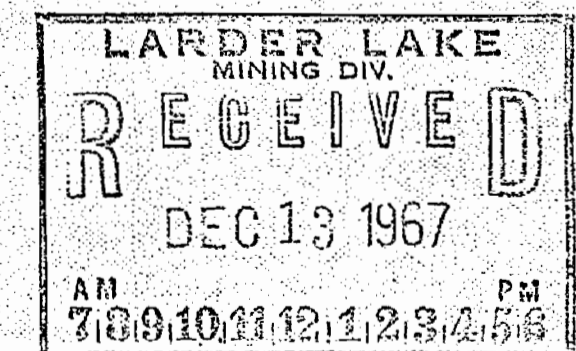

*Revised by MFL
1/17/80*

PLAN NO. — M-589

DEPARTMENT OF MINES
— ONTARIO — #13

Mortimer Twp.

Marathon Twp.

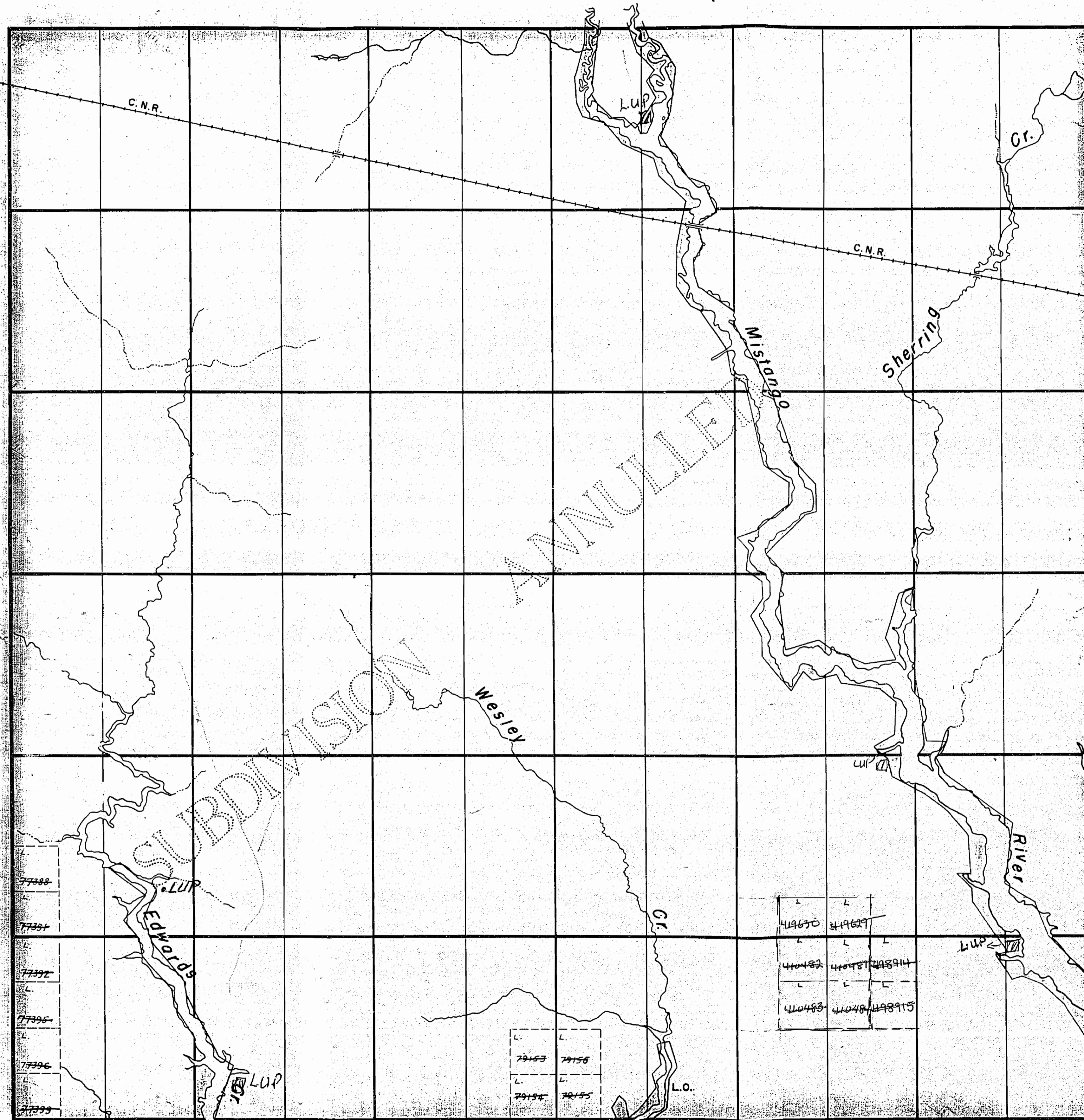

VI
V
IV
III
II
I

12 11 10 9 8 7 6 5 4 3 2 1

Wesley Twp.



Sweatman Twp.

THE TOWNSHIP OF
OF
SHERRING

DISTRICT OF
COCHRANE

LARDER LAKE
MINING DIVISION

SCALE: 1-INCH=40 CHAINS

Mortimer Twp.

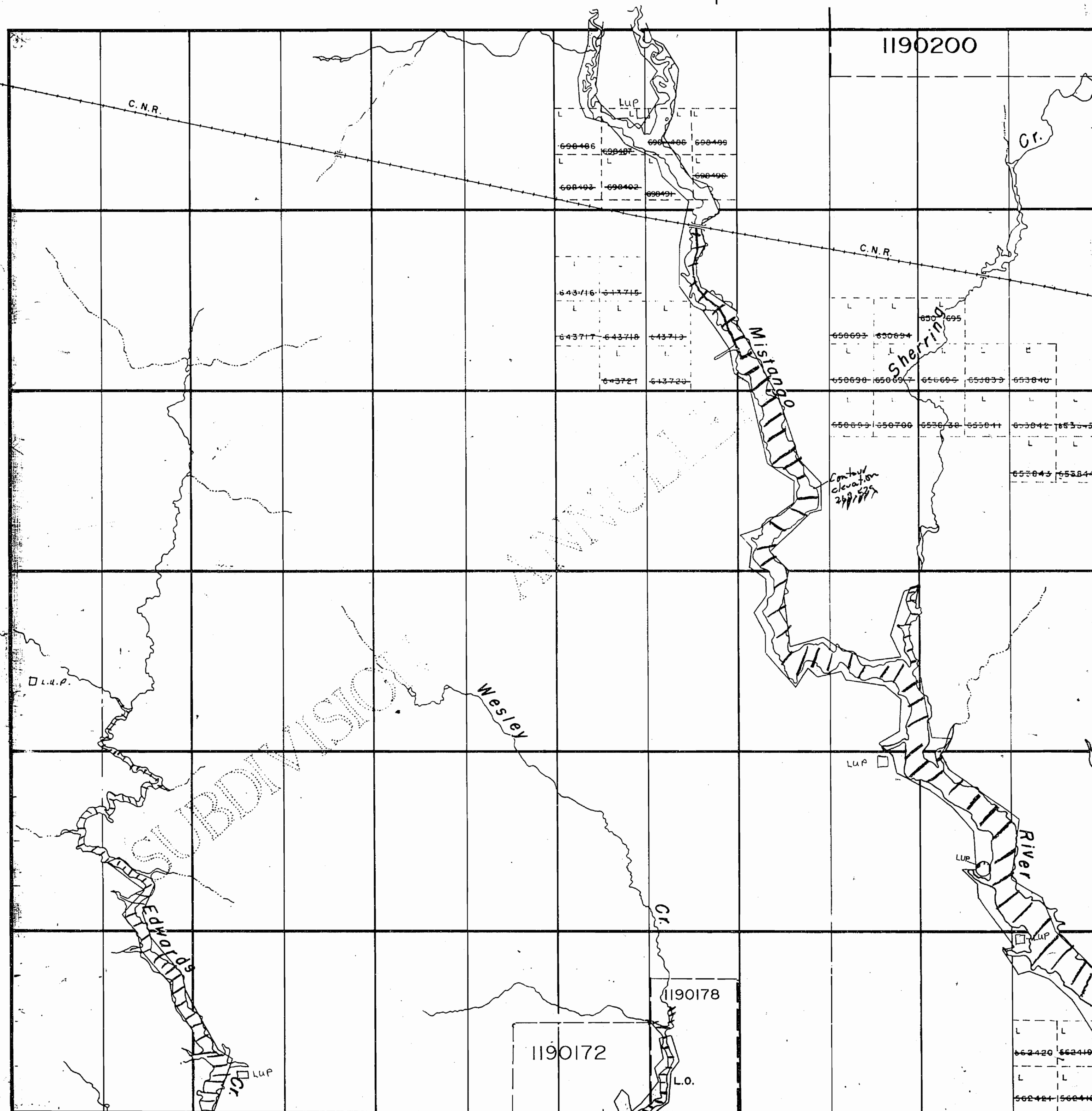

VI

V

IV

III

II

I

Marathon Twp.

LEGEND

- PATENTED LAND
- CROWN LAND SALE
- LEASES
- LOCATED LAND
- LICENSE OF OCCUPATION
- ROADS
- IMPROVED ROADS
- KING'S HIGHWAY
- RAILWAYS
- POWER LINES
- MARSH OR MUSKEG
- MINES

- P
- C.S.
- L
- Loc.
- L.O.

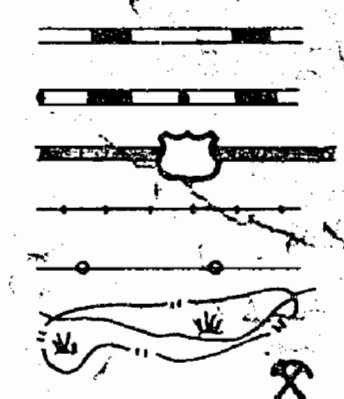

NOTES

Lands subject to Flooding Rts. on shores of Mistango R. & Edwards Cr. shown thus:



to contour levels below 826' & 881' covered by L.O. 8674.

400' Surface Rights Reservation around all Lakes and Rivers.

ABITIBI DeTroyes Provincial Park
** To Contour elevation 268.529

DEC. 2/92

PLAN NO. — M-589

THE INFORMATION THAT APPEARS ON THIS MAP HAS BEEN COMPILED FROM VARIOUS SOURCES, AND ACCURACY IS NOT GUARANTEED. THOSE WISHING TO STAKE MINING CLAIMS SHOULD CONSULT WITH THE MINING RECORDER, MINISTRY OF

Wesley Twp.

REMOVED FROM CIRCULATION AND ARCHIVED ON DEC.02/92

RECEIVED August 16-1984

ONTARIO
MINISTRY OF NATURAL RESOURCES
SURVEYS AND MAPPING BRANCH

Sweatman Twp

THE TOWNSHIP OF
OF
SHERRING

DISTRICT OF
COCHRANE

LARDER LAKE
MINING DIVISION

SCALE: 1-INCH=40 CHAINS

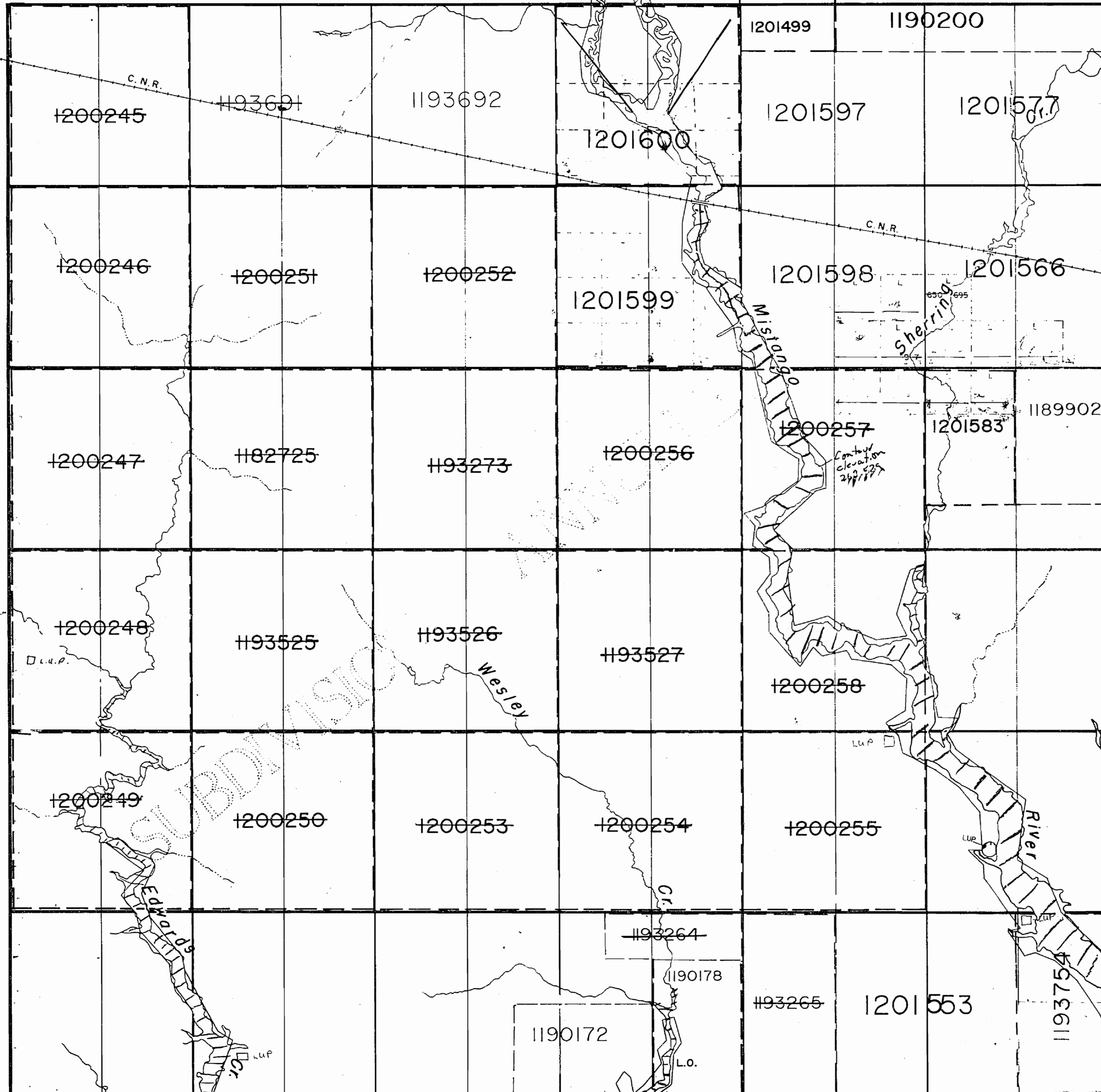

Mortimer Twp.

Marathon Twp.

VI
V
IV
III
II
I

LEGEND

- PATENTED LAND (P)
- CROWN LAND SALE C.S.
- LEASES (L)
- LOCATED LAND Loc.
- LICENSE OF OCCUPATION L.O.
- ROADS
- IMPROVED ROADS
- KING'S HIGHWAY
- RAILWAYS
- POWER LINES
- MARSH OR MUSKEG
- MINES

NOTES

Lands subject to Flooding Rts. on shores of Mistango R. & Edwards Cr. shown thus:

to contour levels below 826' & 881' covered by L.O. 8674.

400' Surface Rights Reservation around all Lakes and Rivers.

ABITIBI DeTroyes Provincial Park
** To Contour elevation 268.529

12 11 10 9 8 7 6 5 4 3 2 1

Wesley Twp.

THE INFORMATION THAT APPEARS ON THIS MAP HAS BEEN COMPILED FROM VARIOUS SOURCES, AND ACCURACY IS NOT GUARANTEED. THOSE WISHING TO STAKE MINING CLAIMS SHOULD CONSULT WITH THE MINING RECORDER, MINISTRY OF NORTHERN DEVELOPMENT AND MINES, FOR AD-

COPY OF THIS MYLAR ARCHIVED DEC. 02/92

RECEIVED August 16-1984

PLAN NO. — M-589

ONTARIO
MINISTRY OF NATURAL RESOURCES
SURVEYS AND MAPPING BRANCH

THE TOWNSHIP
OF
SHERRING

DISTRICT OF
COCHRANE
LARDER LAKE
MINING DIVISION

SCALE: 1-INCH=40 CHAINS

LEGEND

- PATENTED LAND
- CROWN LAND SALE
- LEASES
- LOCATED LAND
- LICENSE OF OCCUPATION
- ROADS
- IMPROVED ROADS
- KING'S HIGHWAY
- RAILWAYS
- POWER LINES
- MARSH OR MUSKEG
- MINES

P
C.S.
L
Loc.
L.O.

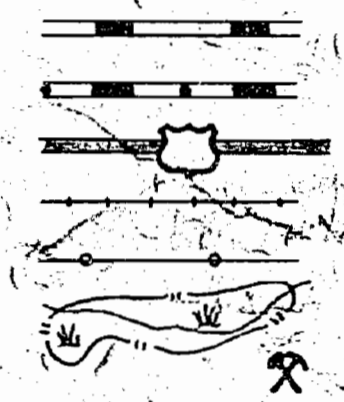

NOTES

Lands subject to Flooding Rts. on shores of Mistango R. & Edwards Cr. shown thus:



to contour levels below 826' & 888' covered by L.O. 8674.

400' Surface Rights Reservation around all Lakes and Rivers.

ABITIBI
DeTroyes
Provincial Park
* * To Contour elevation 268.529

PLAN NO. M-589

ONTARIO
MINISTRY OF NATURAL RESOURCES
SURVEYS AND MAPPING BRANCH

Sweatman Twp.

Mortimer Twp.

Marathon Twp.

Wesley Twp.

THE INFORMATION THAT APPEARS ON THIS MAP HAS BEEN COMPILED FROM VARIOUS SOURCES, AND ACCURACY IS NOT GUARANTEED. THOSE WISHING TO STAKE MINING CLAIMS SHOULD CONSULT WITH THE MINING RECORDER, MINISTRY OF NORTHERN DEVELOPMENT AND MINES FOR AD.

COPY OF THIS MYLAR
ARCHIVED DEC. 02/92

RECEIVED August 16-1984

ARCHIVED JULY-11/97

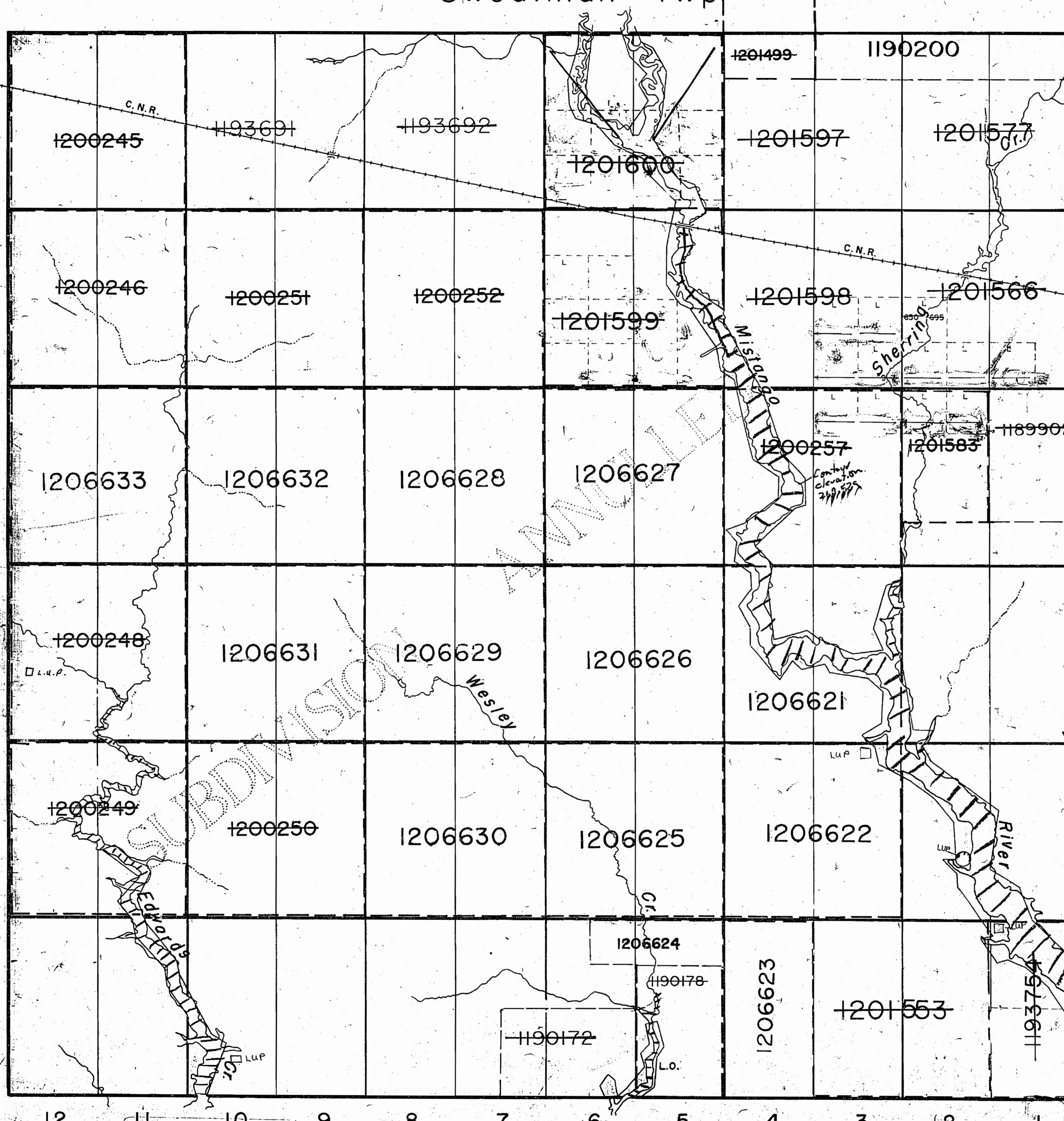

12 11 10 9 8 7 6 5 4 3 2 1

Sweatman Twp.

THE TOWNSHIP OF
OF
SHERRING

DISTRICT OF COCHRANE
LARDER LAKE MINING DIVISION
SCALE: 1-INCH=40 CHAINS

LEGEND

- PATENTED LAND (P)
- CROWN LAND SALE (C.S.)
- LEASES (L)
- LOGGED LAND (Loc.)
- LICENSE OF OCCUPATION (L.O.)
- ROADS
- IMPROVED ROADS
- KING'S HIGHWAY
- RAILWAYS
- POWER LINES
- MARSH OR MUSKEG
- MINES

NOTES

Lands subject to Flooding Rts. on shores of Mistango R. & Edwards Cr shown thus:



to contour levels below 826' & 881' covered by L.O. 8674.

400' Surface Rights Reservation around all Lakes and Rivers

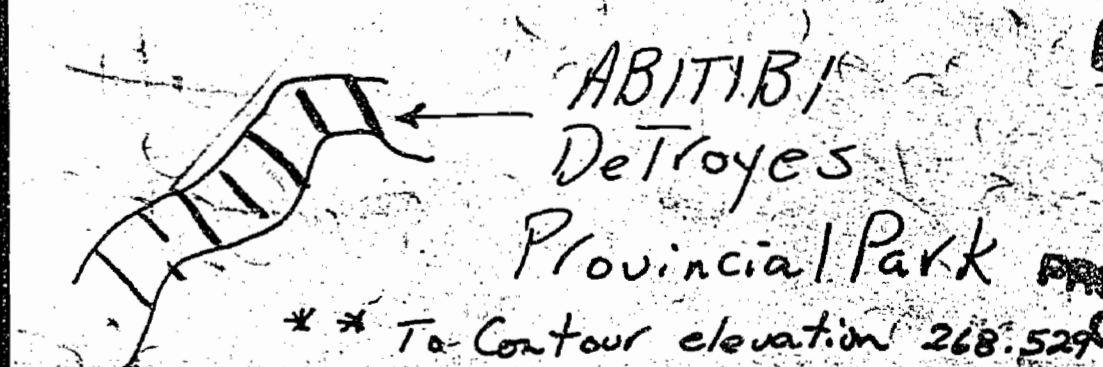

PLAN NO. — M-589

ONTARIO
MINISTRY OF NATURAL RESOURCES
SURVEYS AND MAPPING BRANCH

Mortimer Twp.

Marathon Twp.

VI

V

IV

III

II

I

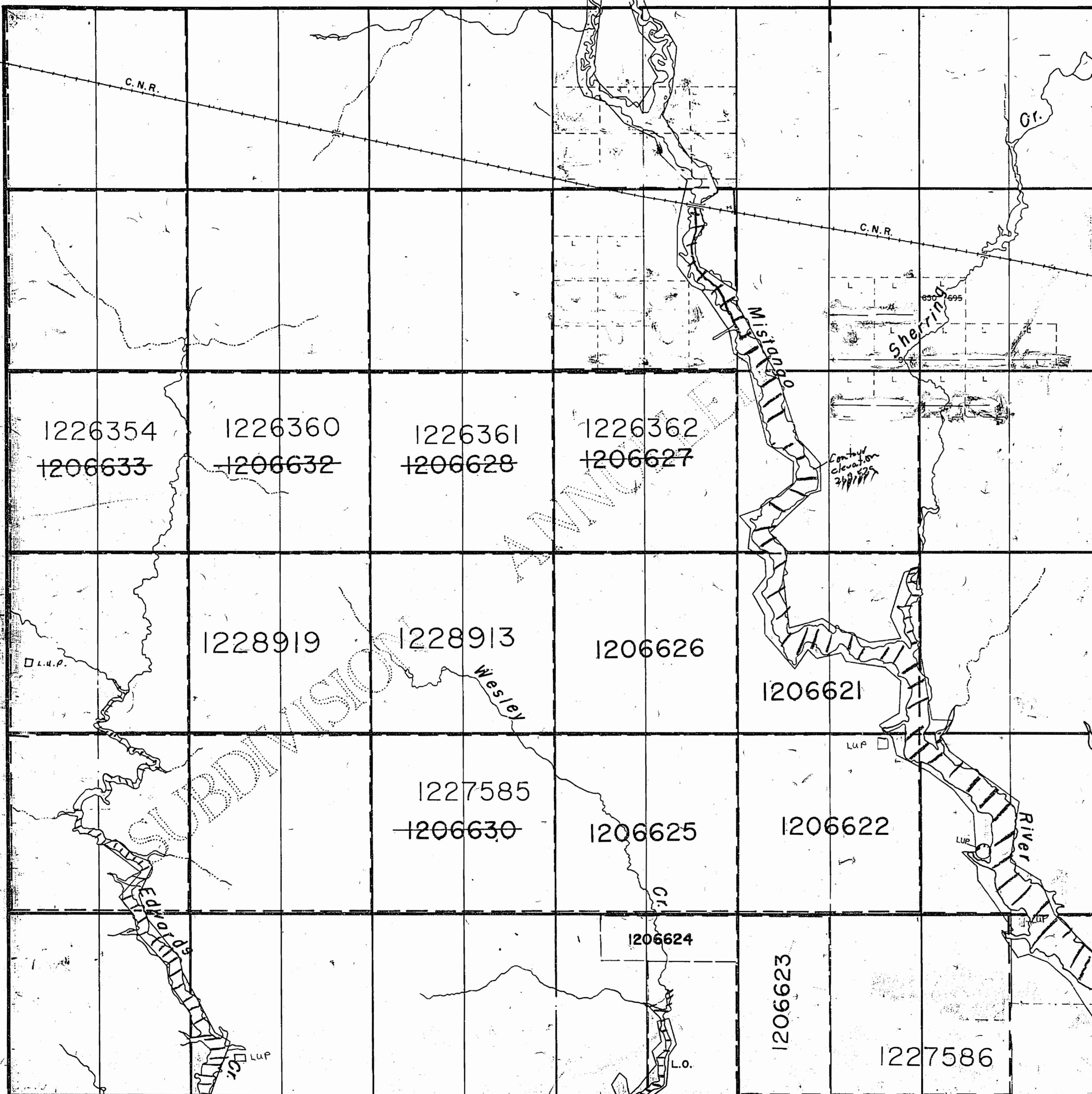

12 11 10 9 8 7 6 5 4 3 2 1

Wesley Twp.

THE INFORMATION THAT APPEARS ON THIS MAP HAS BEEN COMPILED FROM VARIOUS SOURCES, AND ACCURACY IS NOT GUARANTEED. THOSE WISHING TO STAKE MINING CLAIMS SHOULD CONSULT WITH THE MINING RECORDER, MINISTRY OF NORTHERN DEVELOPMENT AND MINES, FOR ADDITIONAL INFORMATION

COPY OF THIS MYLAR ARCHIVED DEC. 02/92

RECEIVED August 16-1984

ARCHIVED JULY 11/97

DATE APR 30 1984 PROVINCIAL OFFICE

Sweatman Twp.

THE TOWNSHIP OF
OF
SHERRING

DISTRICT OF
COCHRANE
LARDER LAKE
MINING DIVISION

SCALE: 1" INCH = 40 CHAINS

VI
V
IV
III
II
I

Mortimer Twp.

Marathon Twp.

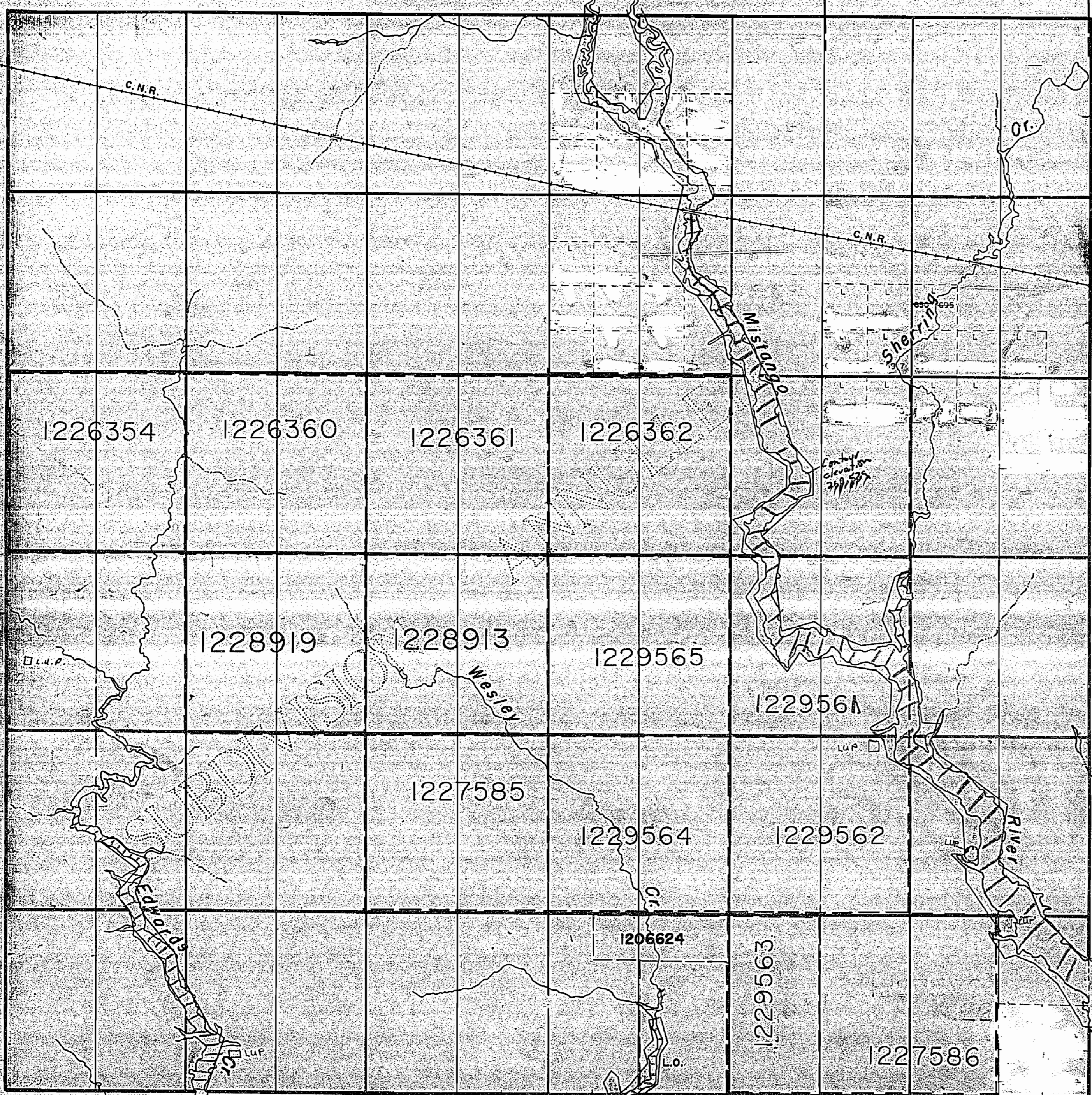

LEGEND

- PATENTED LAND (P)
- CROWN LAND SALE (C.S.)
- LEASES (L)
- LOCATED LAND (Loc)
- LICENSE OF OCCUPATION (L.O.)
- ROADS
- IMPROVED ROADS
- KING'S HIGHWAY
- RAILWAYS
- POWER LINES
- MARSH OR MUSKEG
- MINES

NOTES

Lands subject to Flooding Rts. on shores of Mistango R. & Edwards Cr. shown thus:

to contour levels below 826' & 881' covered by L.O. 8674.

400' Surface Rights Reservation around all Lakes and Rivers.

*ABITIBI
DeTroyes
Provincial Park*
* * To Contour elevation 268.529

13

PLAN NO. — M-589

ONTARIO
MINISTRY OF NATURAL RESOURCES
SURVEYS AND MAPPING BRANCH

THE INFORMATION THAT APPEARS ON THIS MAP HAS BEEN COMPILED FROM VARIOUS SOURCES AND ACCURACY IS NOT GUARANTEED. THOSE WISHING TO STAKE MINING CLAIMS SHOULD CONSULT WITH THE MINING RECORDER, MINISTRY OF NORTHERN DEVELOPMENT AND MINES, FOR ADDITIONAL INFORMATION ON THE STATUS OF THE

COPY OF THIS MYLAR
ARCHIVED DEC. 02/92

RECEIVED August 16-1984
ARCHIVED JULY 11/97

Sweatman Twp.

THE TOWNSHIP
OF
SHERRING

DISTRICT OF
COCHRANE

LARDER LAKE
MINING DIVISION

SCALE: 1-INCH=40 CHAINS

Mortimer Twp.

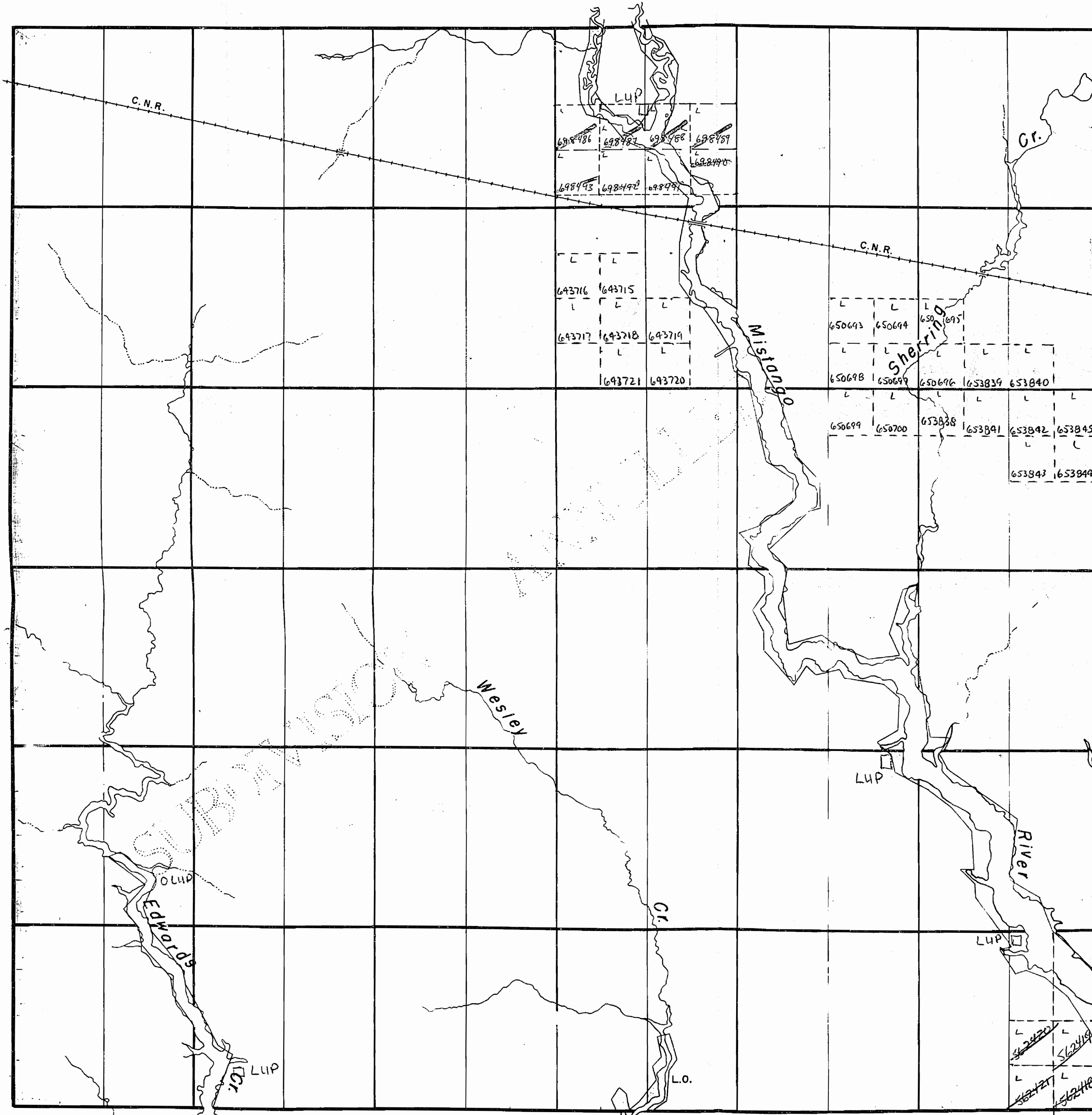

VI

V

IV

III

II

I

Marathon Twp.

LEGEND

- PATENTED LAND (P)
- CROWN LAND SALE (C.S.)
- LEASES (L)
- LOCATED LAND (Loc.)
- LICENSE OF OCCUPATION (L.O.)
- ROADS
- IMPROVED ROADS
- KING'S HIGHWAY
- RAILWAYS
- POWER LINES
- MARSH OR MUSKEG
- MINES

NOTES

Lands subject to Flooding Rts on shores of Mistango R. & Edwards Cr. shown thus



to contour levels below 826' & 881' covered by L.O. 3674.

400' Surface Rights Reservation around all Lakes and Rivers.

Wesley Twp.

PLAN NO. — M-589

AR # 13

MINISTRY OF NATURAL RESOURCES

SURVEYS AND MAPPING BRANCH

REPLACED August 16-84









Sweatman Twp.

THE TOWNSHIP OF
OF
SHERRING

DISTRICT OF
COCHRANE
LARDER LAKE
MINING DIVISION

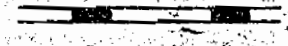
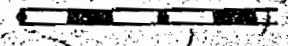
SCALE: 1-INCH=40 CHAINS

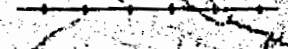
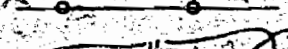
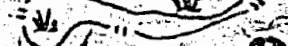
LEGEND

- PATENTED LAND 
- CROWN LAND SALE 
- LEASES 
- LOCATED LAND 
- LICENSE OF OCCUPATION 
- ROADS 
- IMPROVED ROADS 
- KING'S HIGHWAY 
- RAILWAYS 
- POWER LINES 
- MARSH OR MUSKEG 
- MINES 

NOTES

Lands subject to Flooding Rts. on shores of Mistango R. & Edwards Cr. shown thus:



to contour levels below 826' & 881' covered by L.O. 8674.

400' Surface Rights Reservation around all Lakes and Rivers.

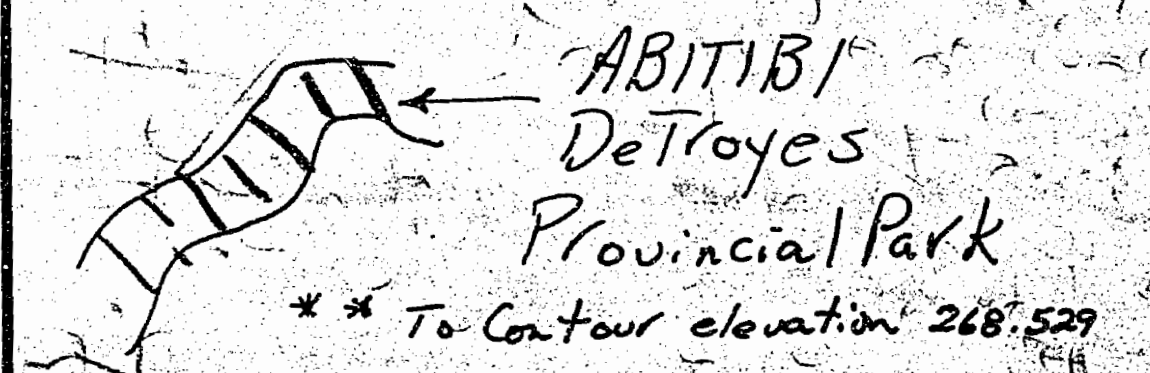

Mortimer Twp.

Marathon Twp.

VI

V

IV

III

II

I

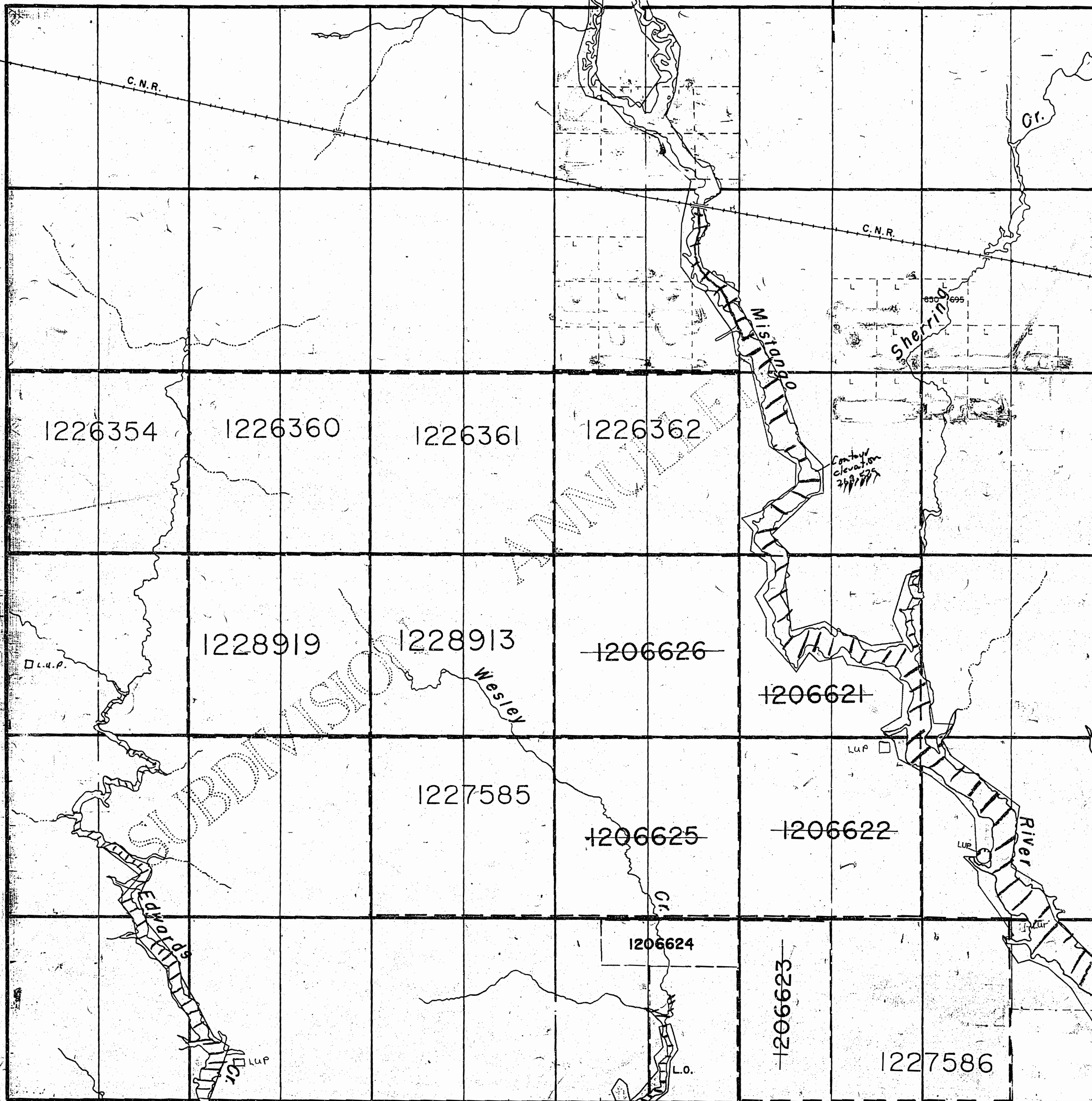

THE INFORMATION THAT APPEARS ON THIS MAP HAS BEEN COMPILED FROM VARIOUS SOURCES, AND ACCURACY IS NOT GUARANTEED. THOSE WISHING TO STAKE MINING CLAIMS SHOULD CONSULT WITH THE MINING RECORDER, MINISTRY OF NORTHERN DEVELOPMENT AND MINES, FOR AD-

Wesley Twp.

DATE OF ISSUE

JUL 17 1998

COPY OF THIS MYLAR ARCHIVED DEC. 02/92 PROVINCIAL RECORDING OFFICE - SUDBURY

RECEIVED August 16 1984

ARCHIVED JULY 11/97

PLAN NO. - M-589

ONTARIO
MINISTRY OF NATURAL RESOURCES
SURVEYS AND MAPPING BRANCH

SHERRING TWP. M-589

Mortimer Twp.

Sweatman Twp.

Marathon Twp.

Wesley Twp.

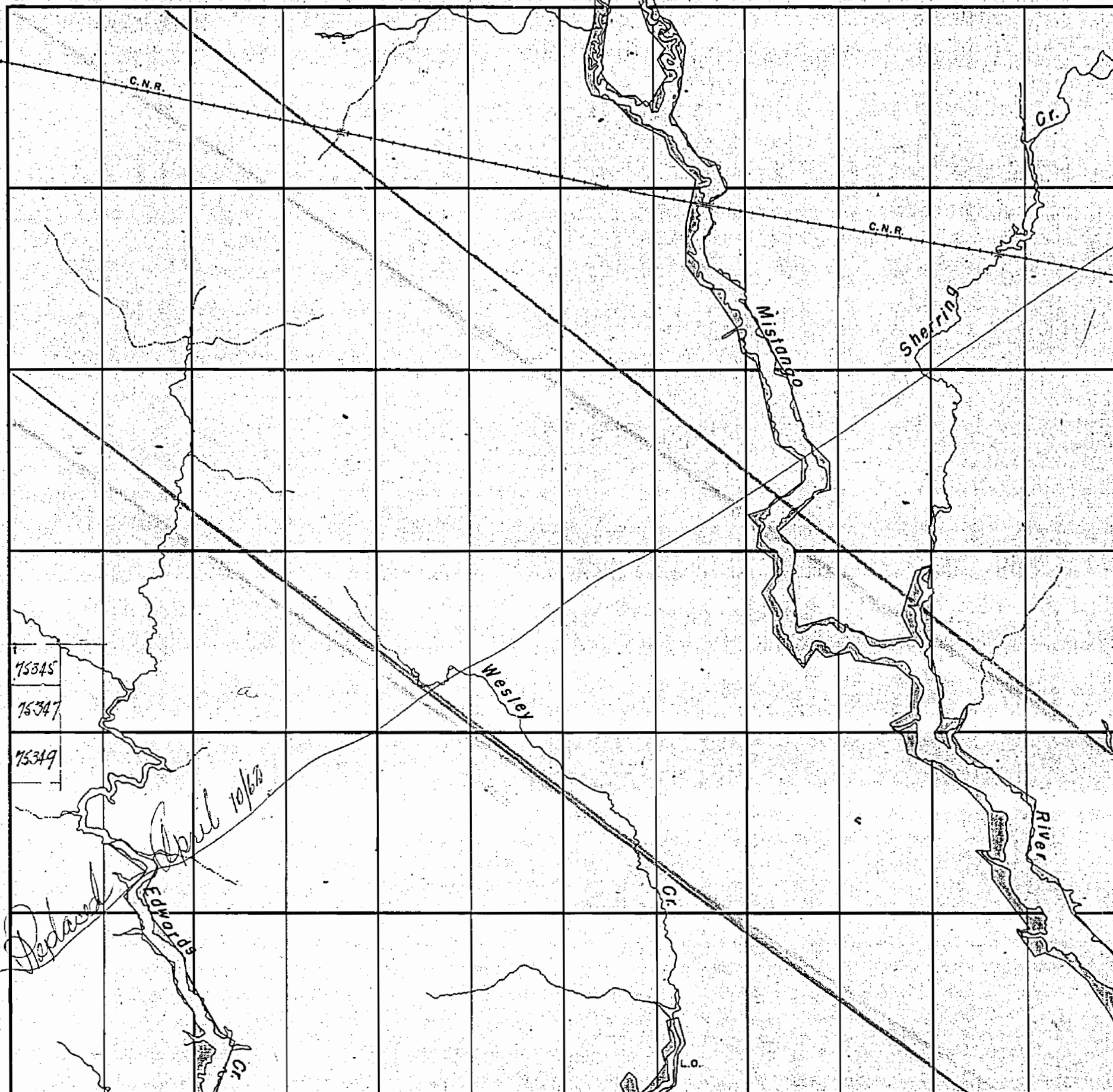









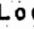

15345
15347
15349

12 11 10 9 8 7 6 5 4 3 2 1

THE TOWNSHIP
OF
SHERRING
DISTRICT OF
COCHRANE
LARDER LAKE
MINING DIVISION
SCALE: 1-INCH=40 CHAINS

LEGEND

- PATENTED LAND 
- CROWN LAND SALE 
- LEASES 
- LOCATED LAND 
- LICENSE OF OCCUPATION 
- ROADS 
- IMPROVED ROADS 
- KING'S HIGHWAY 
- RAILWAYS 
- POWER LINES 
- MARSH OR MUSKEG 
- MINES 

NOTES

Lands subject to Flooding Rts. on shores
of Mistango R. & Edwards Cr. shown thus:



MINING RECORDER
RECEIVED
APR 23 1953
SWASTIKA ONE

Withdrawn temporarily
McGinn OCT 20/61

PLAN NO. — M-589

DEPARTMENT OF MINES
— ONTARIO —

589

SHERRING TWP. W-2

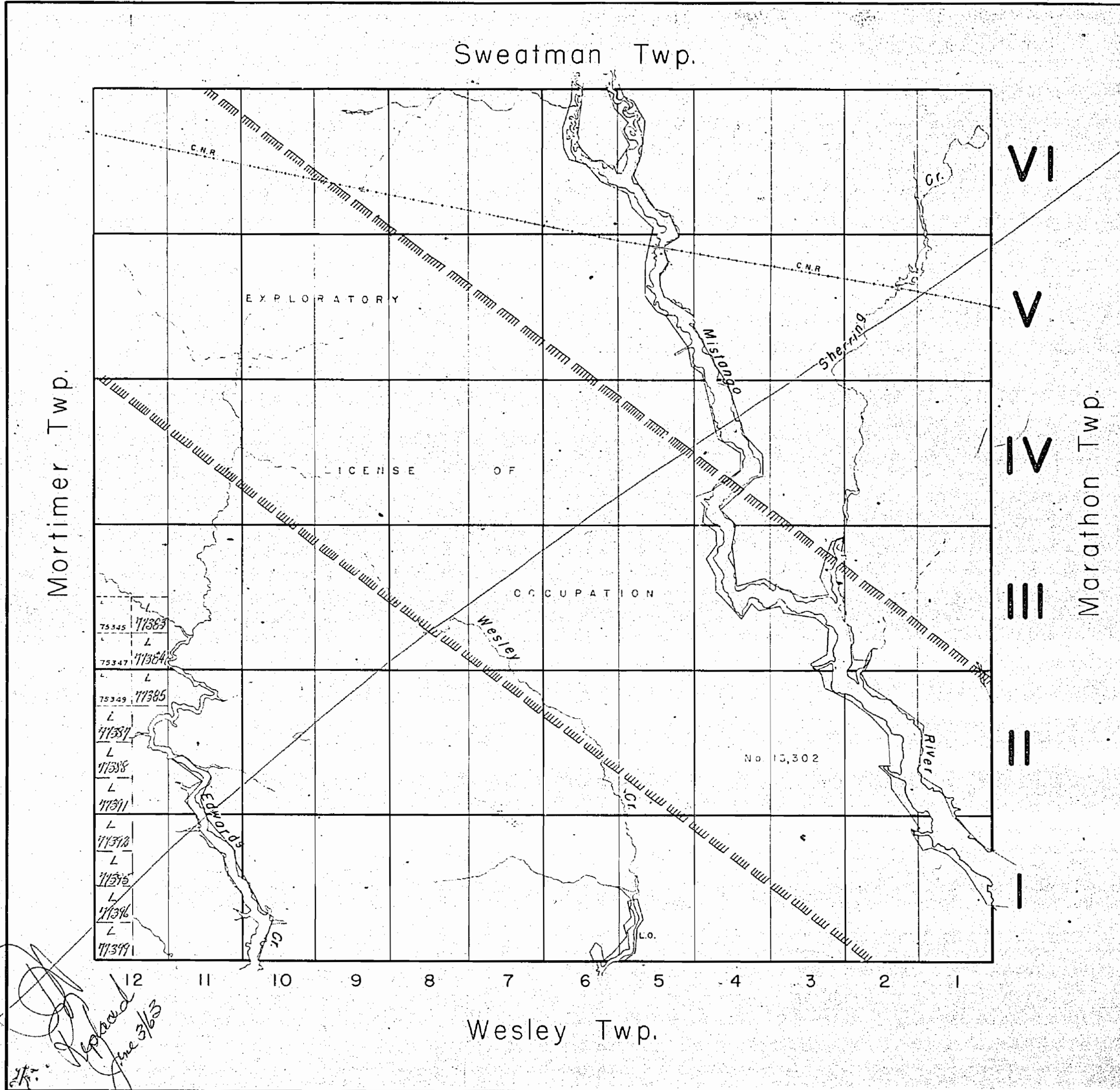

LEGEND

PATENTED LAND	(P)
CROWN LAND SALE	(C.S.)
LEASES	(L)
LOCATED LAND	(Loc.)
LICENSE OF OCCUPATION	(L.O.)
ROADS	(---)
IMPROVED ROADS	(=)
KING'S HIGHWAY	(=)
RAILWAYS	(=)
POWER LINES	(=)
MARSH OR MUSKEG	(=)
MINES	(X)

NOTES

Lands subject to Flooding Rts on shores of Mistango R. & Edwards Cr shown thus

Area temporarily withdrawn from staking indicated thus:

400' Surface Rights Reservation around all Lakes and Rivers.

MINING RECORDER
 RECEIVED
 APR 10 1962
 KIRKLAND LAKE - ONT.

PLAN NO. - M-589
 DEPARTMENT OF MINES
 - ONTARIO -

RECEIVED
JAN 22 1951
TIMISKAMING
MINING DIVISION

THE TOWNSHIP OF
OF
SHERRING
DISTRICT OF COCHRANE
TIMISKAMING
MINING DIVISION
SCALE: 1-INCH=40 CHAINS

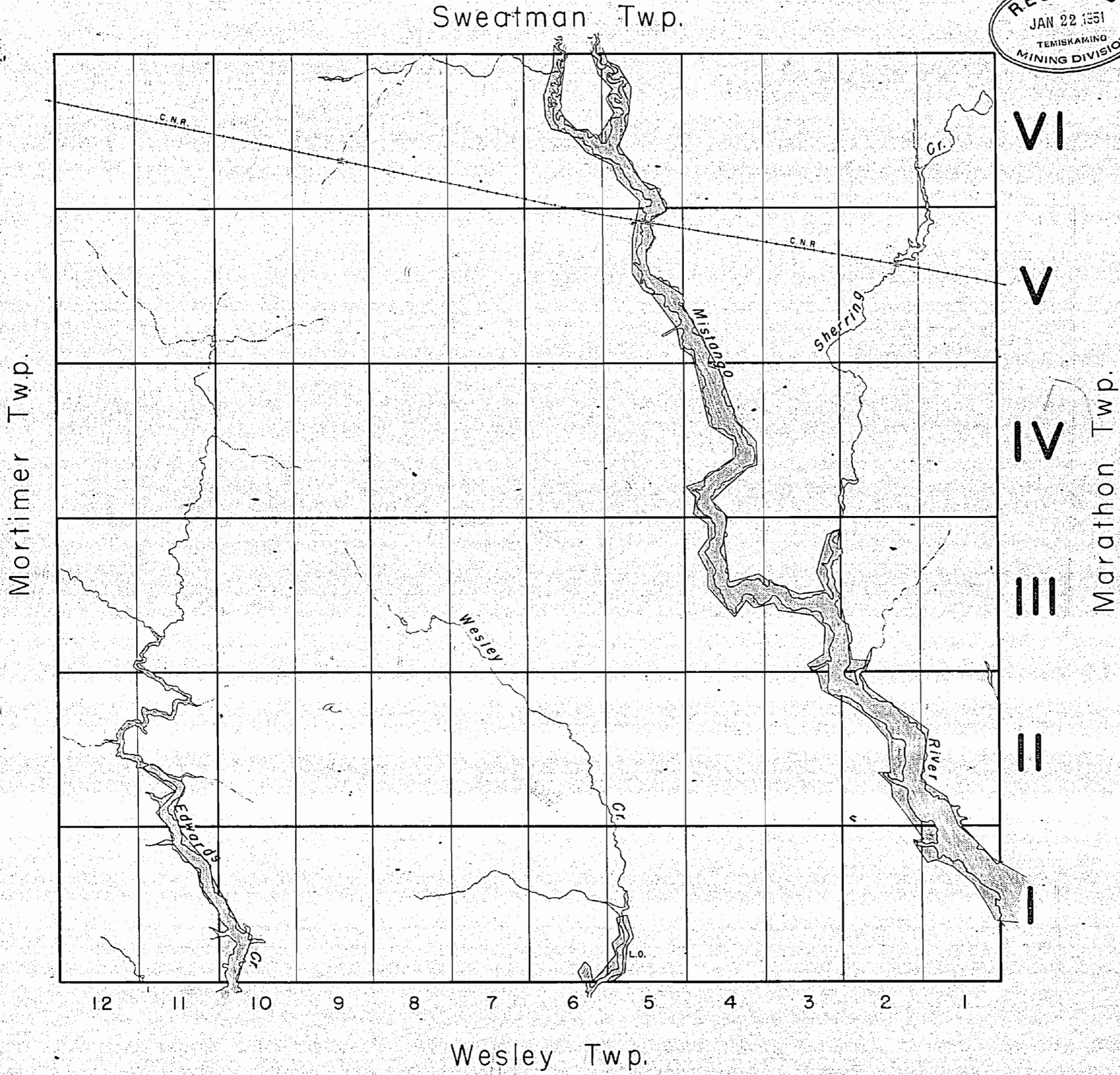

LEGEND

- PATENTED LAND Ⓟ
- CROWN LAND SALE C.S.
- LEASES Ⓞ
- LOCATED LAND Loc.
- LICENSE OF OCCUPATION L.O.
- ROADS
- IMPROVED ROADS
- KING'S HIGHWAY
- RAILWAYS
- POWER LINES
- MARSH OR MUSKEG
- MINES

NOTES

Lands subject to Flooding Rts. on shores of Mistanogo R. & Edwards Cr. shown thus:

M-589

PLAN NO. T.167

DEPARTMENT OF MINES
— ONTARIO —

THE TOWNSHIP
OF
SHERRING
DISTRICT OF
COCHRANE
LARDER LAKE
MINING DIVISION
SCALE: 1-INCH=40 CHAINS

Mortimer Twp.

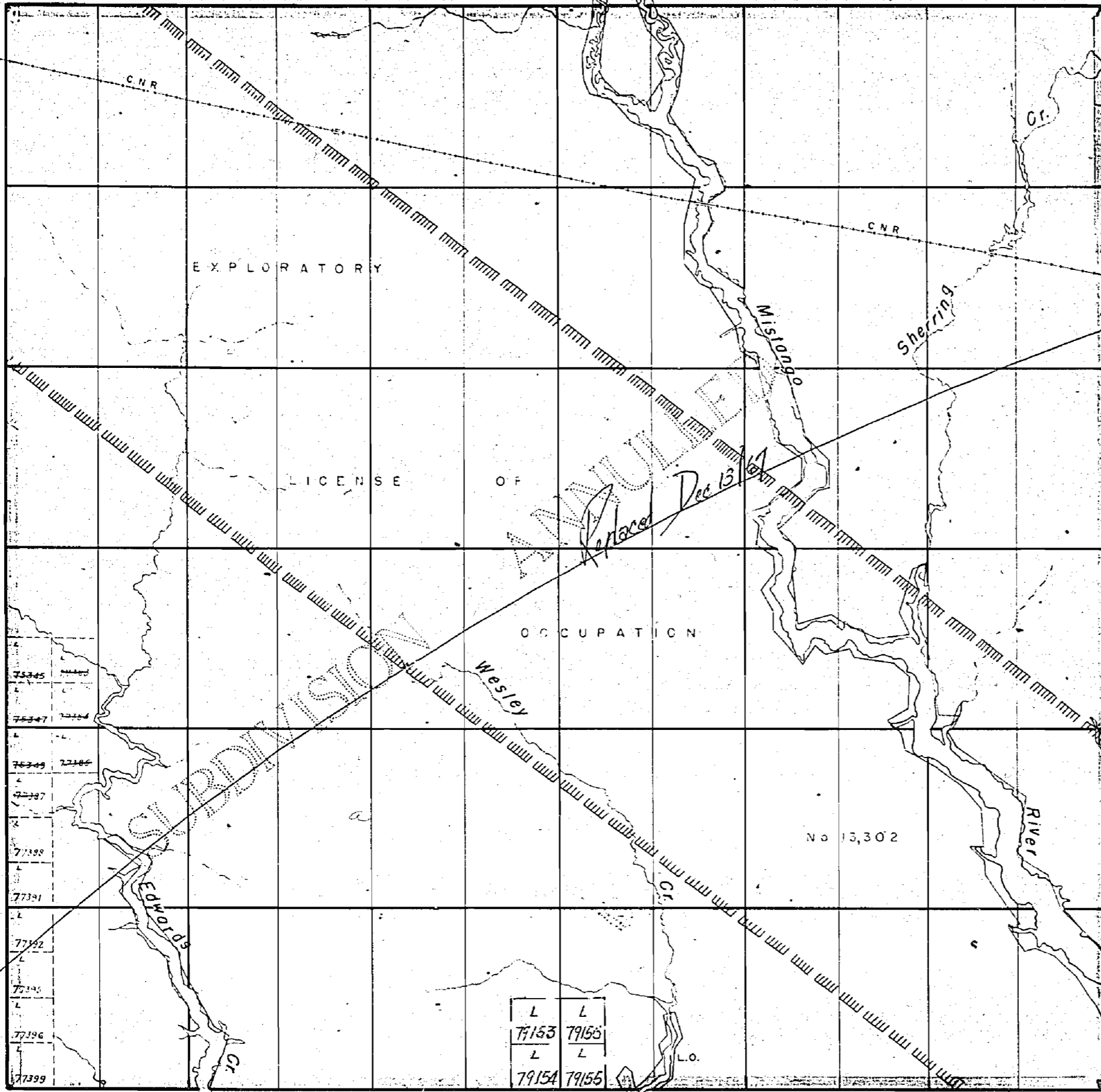

VI

V

IV

III

II

I

Marathon Twp.

LEGEND

- PATENTED LAND (P)
- CROWN LAND SALE (C.S.)
- LEASES (L)
- LOCATED LAND (Loc.)
- LICENSE OF OCCUPATION (L.O.)
- ROADS
- IMPROVED ROADS
- KING'S HIGHWAY
- RAILWAYS
- POWER LINES
- MARSH OR MUSKEG
- MINES

NOTES

Lands subject to Flooding Rts. on shores of Mistango R. & Edwards Cr shown thus:

Area temporarily withdrawn from staking indicated thus: L.O. 13,302.

400' Surface Rights* Reservation around all Lakes and Rivers.

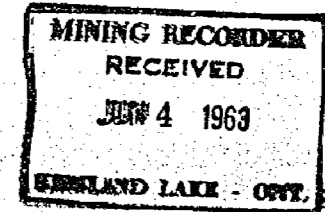

Wesley Twp.

PLAN NO. — M-589

DEPARTMENT OF MINES
— ONTARIO —