

# SINGER

LARDER LAKE MINING DIVISION

DISTRICT OF COCHRANE

Scale - 40 Chains = 1 Inch

m 590

*Revised by W.H.  
Jan 17/80*

North Ast.

**NOTE**

400' Surface Rights Reservation  
around all Lakes and Rivers.

HURTUBISE

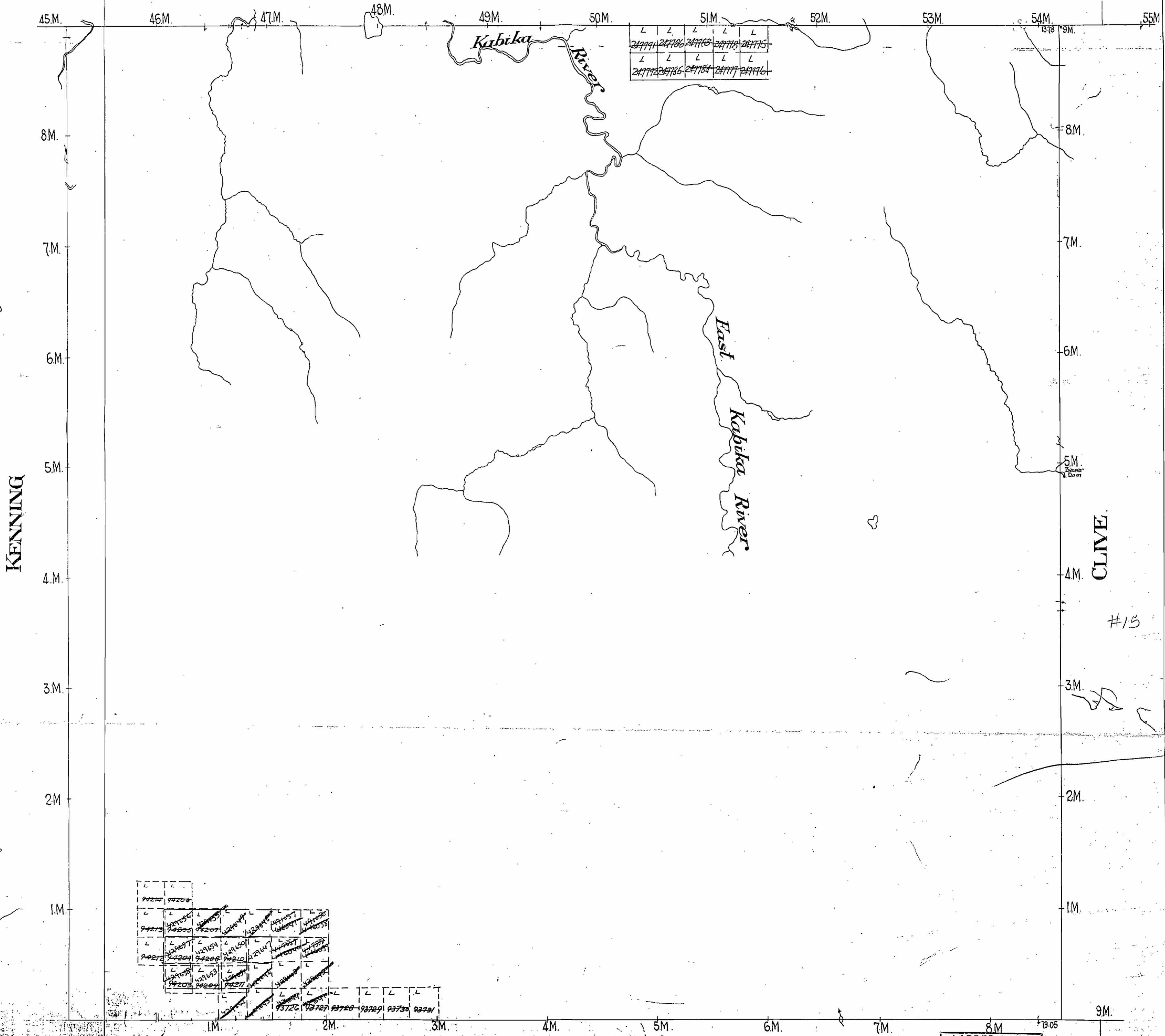

L	L	L	L	L	L
24999	24786	24768	24778	24775	
L	L	L	L	L	L
24772	24786	24784	24777	24776	

L	L	L	L	L	L
94214	94204				
L	L	L	L	L	L
94213	94205	94207	94208	94209	94210
L	L	L	L	L	L
94212	94204	94206	94211	94212	94213
L	L	L	L	L	L
94203	94202	94211	94214	94215	94216
L	L	L	L	L	L
93720	93727	93728	93729	93730	93731

ABBOTSFORD

LARDER LAKE  
MINING DIV.  
**RECEIVED**  
JAN - 5 1966  
4 10.10.11.12.1.2.3.4.5.6 P.M.

NOV 21/91

# SINGER

MINISTRY OF NATURAL RESOURCES  
SURVEYS AND MAPPING BRANCH

LARDER LAKE MINING DIVISION

G.3570

DISTRICT OF COCHRANE

Scale - 40 Chains = 1 Inch

THE INFORMATION THAT APPEARS ON THIS MAP HAS BEEN COMPILED FROM VARIOUS SOURCES, AND ACCURACY IS NOT GUARANTEED. THOSE WISHING TO STAKE MINING CLAIMS SHOULD CONSULT WITH THE MINING RECORDER, MINISTRY OF NORTHERN DEVELOPMENT AND MINES, FOR ADDITIONAL INFORMATION ON THE STATUS OF THE LANDS SHOWN HEREON.

### NOTICE OF FORESTRY ACTIVITY

THIS TOWNSHIP / AREA FALLS WITHIN THE  
ROQUOIS FALLS MANAGEMENT UNIT  
AND MAY BE SUBJECT TO FORESTRY OPERATIONS.  
THE MNR UNIT FORESTER FOR THIS AREA CAN BE  
CONTACTED AT: P.O. BOX 730  
2 THIRD AVE.  
COCHRANE, ONT.  
POL 1C0  
705-272-4365

### NOTE

400' Surface Rights Reservation  
around all Lakes and Rivers.

HURTUBISE

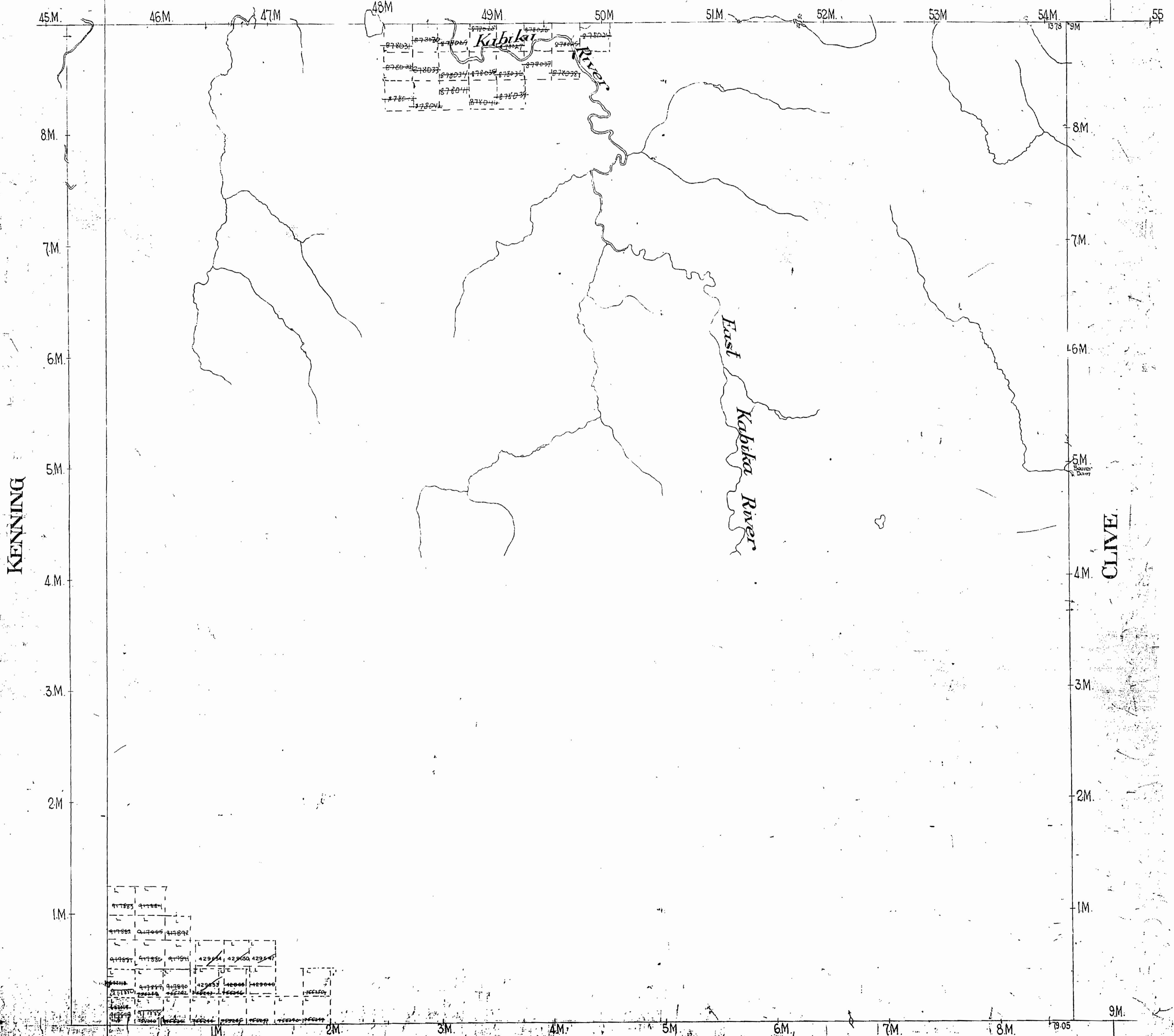

ABBOTSFORD

REMOVED FROM CIRCULATION  
AND ARCHIVED ON NOV 21/91

# SINGER

MINISTRY OF NATURAL RESOURCES  
SURVEYS AND MAPPING BRANCH

LARDER LAKE MINING DIVISION

G.3570

DISTRICT OF COCHRANE

Scale - 40 Chains = 1 Inch

THE INFORMATION THAT APPEARS ON THIS MAP HAS BEEN COMPILED FROM VARIOUS SOURCES, AND ACCURACY IS NOT GUARANTEED. THOSE WISHING TO STAKE MINING CLAIMS SHOULD CONSULT WITH THE MINING RECORDER, MINISTRY OF NORTHERN DEVELOPMENT AND MINES, FOR ADDITIONAL INFORMATION ON THE STATUS OF THE LANDS SHOWN HEREON.

**NOTICE OF FORESTRY ACTIVITY**  
THIS TOWNSHIP / AREA FALLS WITHIN THE IROQUOIS FALLS MANAGEMENT UNIT AND MAY BE SUBJECT TO FORESTRY OPERATIONS. THE MNR UNIT FORESTER FOR THIS AREA CAN BE CONTACTED AT: P.O. BOX 730, 2 THIRD AVE., COCHRANE, ONT., P.O. 1C0, 705-272-4365

**NOTE**  
400' Surface Rights Reservation around all Lakes and Rivers.

North Ast.

# 15

HURTUBISE

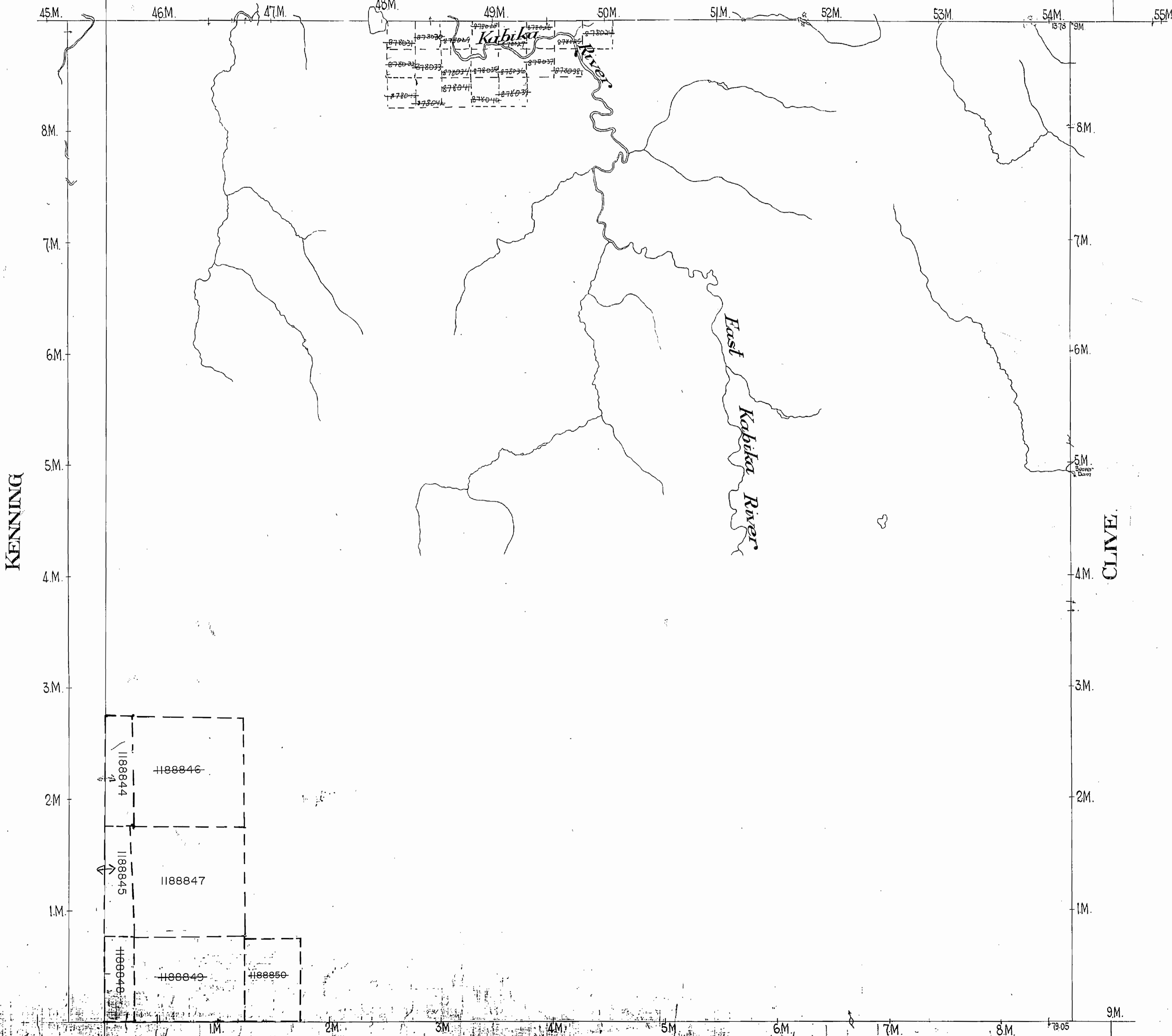

ABBOTSFORD

COPY OF THIS MYLAR  
ARCHIVED NOV 21/91  
ARCHIVED DECEMBER 29, 1994

HURTUBISE TOWNSHIP

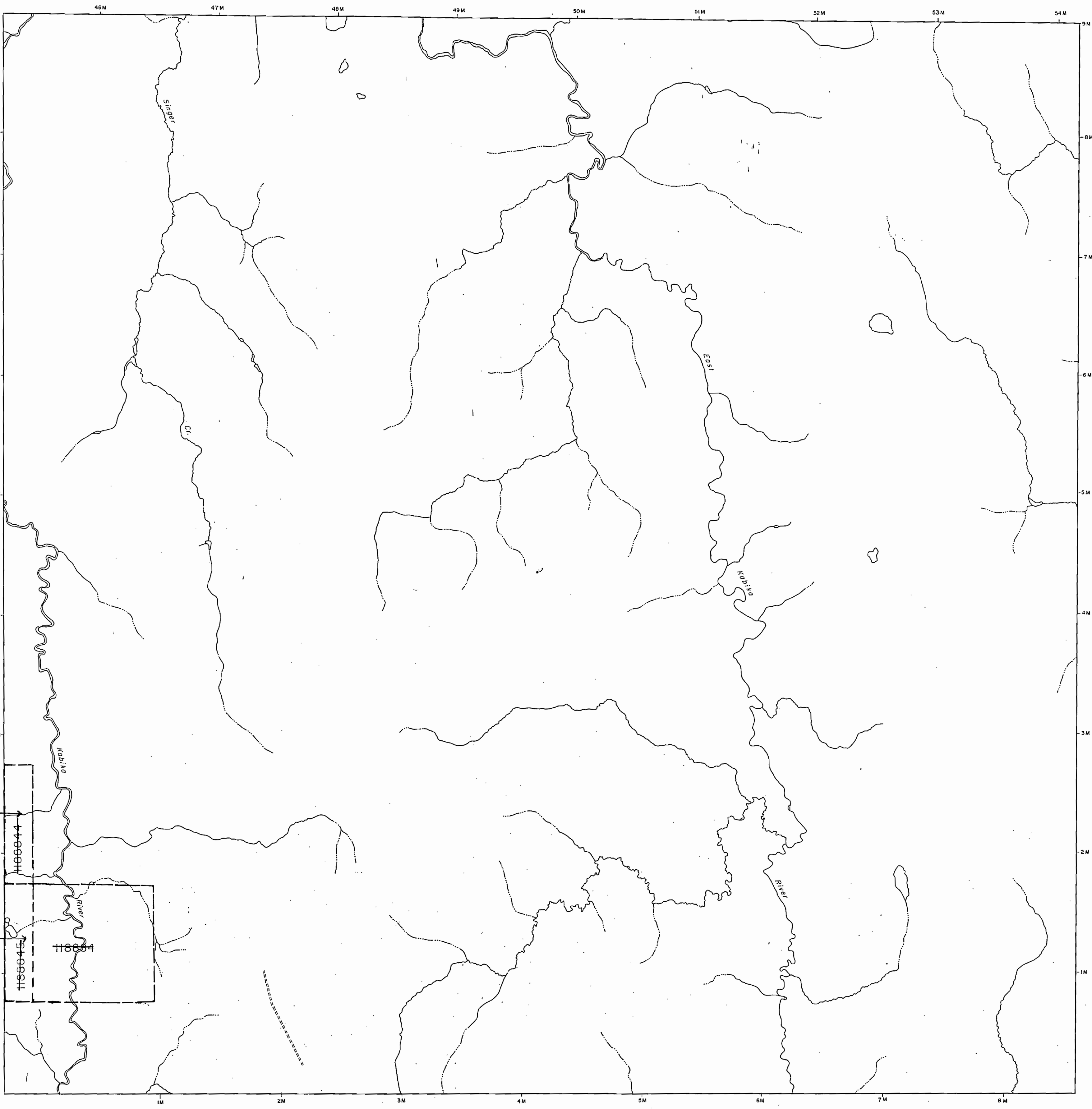

LEGEND

- HIGHWAY AND ROUTE No.
- OTHER ROADS
- TRAILS
- SURVEYED LINES:
  - TOWNSHIPS, BASE LINES, ETC.
  - LOTS, MINING CLAIMS, PARCELS, ETC.
- UNSURVEYED LINES:
  - LOT LINES
  - PARCEL BOUNDARY
  - MINING CLAIMS ETC.
- RAILWAY AND RIGHT OF WAY
- UTILITY LINES
- NON-PERENNIAL STREAM
- FLOODING OR FLOODING RIGHTS
- SUBDIVISION OR COMPOSITE PLAN
- RESERVATIONS
- ORIGINAL SHORELINE
- MARSH OR MUSKEG
- MINES
- TRAVERSE MONUMENT

DISPOSITION OF CROWN LANDS

TYPE OF DOCUMENT	SYMBOL
PATENT, SURFACE & MINING RIGHTS	●
" SURFACE RIGHTS ONLY	○
" MINING RIGHTS ONLY	◐
LEASE, SURFACE & MINING RIGHTS	◑
" SURFACE RIGHTS ONLY	◒
" MINING RIGHTS ONLY	◓
LICENCE OF OCCUPATION	▼
ORDER-IN-COUNCIL	OC
RESERVATION	⊙
CANCELLED	⊘
SAND & GRAVEL	⊚

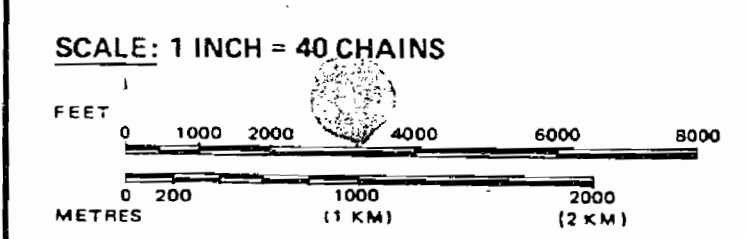

NOTICE OF FORESTRY ACTIVITY

THIS TOWNSHIP / AREA FALLS WITHIN THE \_\_\_\_\_

IROQUOIS FALLS MANAGEMENT UNIT

AND MAY BE SUBJECT TO FORESTRY OPERATIONS.

THE MNR UNIT FORESTER FOR THIS AREA CAN BE CONTACTED AT: P.O. BOX 730

2 THIRD AVE.

COCHRANE, ONT.

POL 1C0

705-272-4365

THE INFORMATION THAT APPEARS ON THIS MAP HAS BEEN COMPILED FROM VARIOUS SOURCES AND ACCURACY IS NOT GUARANTEED. THOSE WISHING TO STAKE MINING CLAIMS SHOULD CONSULT WITH THE MINING RECORDER, MINISTRY OF NORTHERN DEVELOPMENT AND MINES, FOR ADDITIONAL INFORMATION ON THE STATUS OF THE LANDS SHOWN HEREON.

TOWNSHIP

**SINGER**

M.N.R. ADMINISTRATIVE DISTRICT

COCHRANE

MINING DIVISION

LARDER LAKE

LAND TITLES / REGISTRY DIVISION

COCHRANE

Ministry of Natural Resources Ontario

Ministry of Northern Development and Mines

Date FEBRUARY 1990

Number **G-3570**

ABBOTSFORD TOWNSHIP

COMPULATED DECEMBER 29, 1994 ML

ARCHIVED JULY 11/97.

KENNING TOWNSHIP

CLIVE TOWNSHIP

SINGER TWP

G-3570

HURTUBISE TOWNSHIP

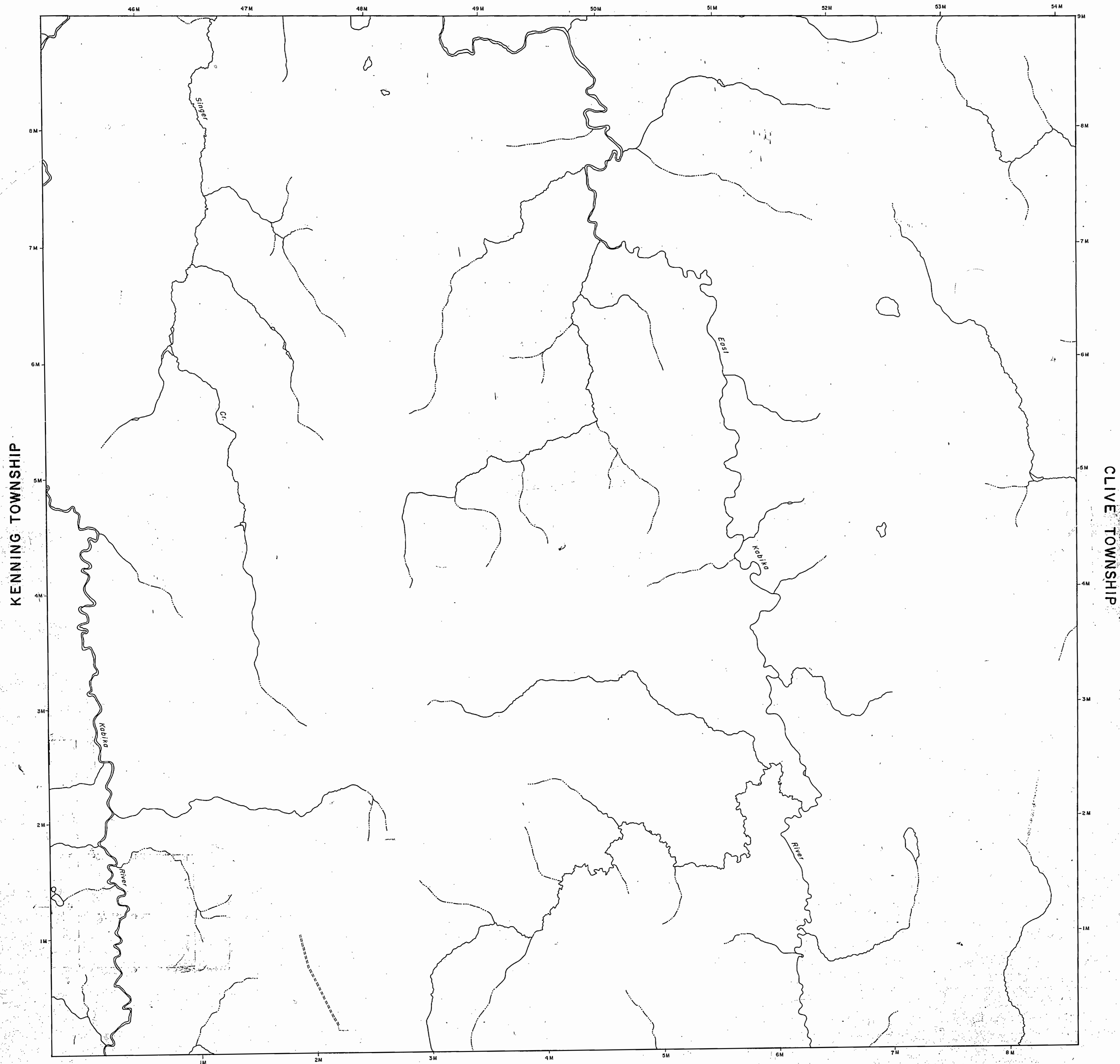

LEGEND

- HIGHWAY AND ROUTE No.
- OTHER ROADS
- TRAILS
- SURVEYED LINES:
  - TOWNSHIPS, BASE LINES, ETC.
  - LOTS, MINING CLAIMS, PARCELS, ETC.
- UNSURVEYED LINES:
  - LOT LINES
  - PARCEL BOUNDARY
  - MINING CLAIMS ETC.
- RAILWAY AND RIGHT OF WAY
- UTILITY LINES
- NON-PERENNIAL STREAM
- FLOODING OR FLOODING RIGHTS
- SUBDIVISION OR COMPOSITE PLAN RESERVATIONS
- ORIGINAL SHORELINE
- MARSH OR MUSKEG
- MINES
- TRAVERSE MONUMENT

DISPOSITION OF CROWN LANDS

TYPE OF DOCUMENT	SYMBOL
PATENT, SURFACE & MINING RIGHTS	
" SURFACE RIGHTS ONLY	
" MINING RIGHTS ONLY	
LEASE, SURFACE & MINING RIGHTS	
" SURFACE RIGHTS ONLY	
" MINING RIGHTS ONLY	
LICENCE OF OCCUPATION	
ORDER-IN-COUNCIL	
RESERVATION	
CANCELLED	
SAND & GRAVEL	

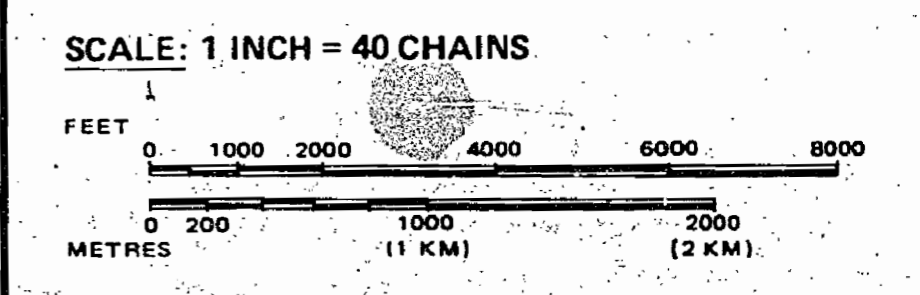

NOTICE OF FORESTRY ACTIVITY

THIS TOWNSHIP / AREA FALLS WITHIN THE \_\_\_\_\_

IROQUOIS FALLS MANAGEMENT UNIT

AND MAY BE SUBJECT TO FORESTRY OPERATIONS.

THE MNR UNIT FORESTER FOR THIS AREA CAN BE CONTACTED AT: P.O. BOX 730

2 THIRD AVE.

COCHRANE, ONT.

POL ICO

705-272-4365

THE INFORMATION THAT APPEARS ON THIS MAP HAS BEEN COMPILED FROM VARIOUS SOURCES, AND ACCURACY IS NOT GUARANTEED. THOSE WISHING TO STAKE MINING CLAIMS SHOULD CONSULT WITH THE MINING RECORDER, MINISTRY OF NORTHERN DEVELOPMENT AND MINES, FOR ADDITIONAL INFORMATION ON THE STATUS OF THE LANDS SHOWN HEREON.

TOWNSHIP

**SINGER**

M.N.R. ADMINISTRATIVE DISTRICT

COCHRANE

MINING DIVISION

LARDER LAKE

LAND TITLES / REGISTRY DIVISION

COCHRANE

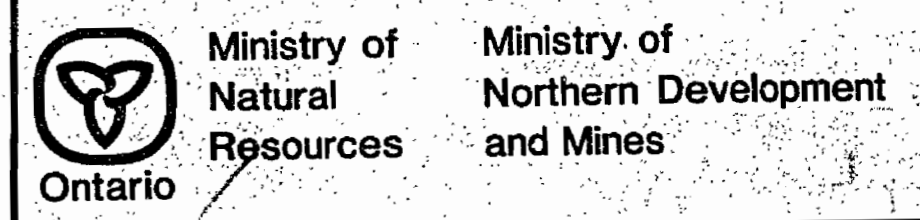

Date FEBRUARY 1990

Number **G-3570**

ABBOTSFORD TOWNSHIP

590

REORDER RECEIVED  
APR 28 1953  
SWASTIKA - ONT.

# SINGER

LARDER LAKE MINING DIVISION

DISTRICT OF COCHRANE

Scale - 40 Chains - 1 Inch

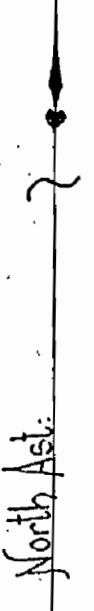

M 590

HURTUBISE

45M. 46M. 47M. 48M. 49M. 50M. 51M. 52M. 53M. 54M. 55M.

Kabika River

East Kabika River

KENNING

CLIVE

8M.

7M.

6M.

5M.

4M.

3M.

2M.

1M.

8M.

7M.

6M.

5M.

4M.

3M.

2M.

1M.

64319	64319						
64317	64314	64315					
		74214	94206				
64312	64311	64306	64305	64304	64305		
		74218	74219	74220	74221		
64310	64309	64302	64296	64297	64298	64299	
		74210	74211	74212	74213	74214	
64298	64284	64285	64280	64281	64282	64283	
		74203	74209	74211			
64297	64296	64294	64295	64296	64297	64298	
93712	93721	93728	93729	93750	93751	93751	

ABBOTSFORD