

1117

DATE OF ISSUE
DEC 6 1976

SLACK

M.1117
ONTARIO
MINISTRY OF NATURAL RESOURCES
SURVEYS AND MAPPING BRANCH

DISTRICT OF SUDBURY
PORCUPINE MINING DIVISION
SCALE 40 CHAINS TO ONE INCH

CASSELMAN

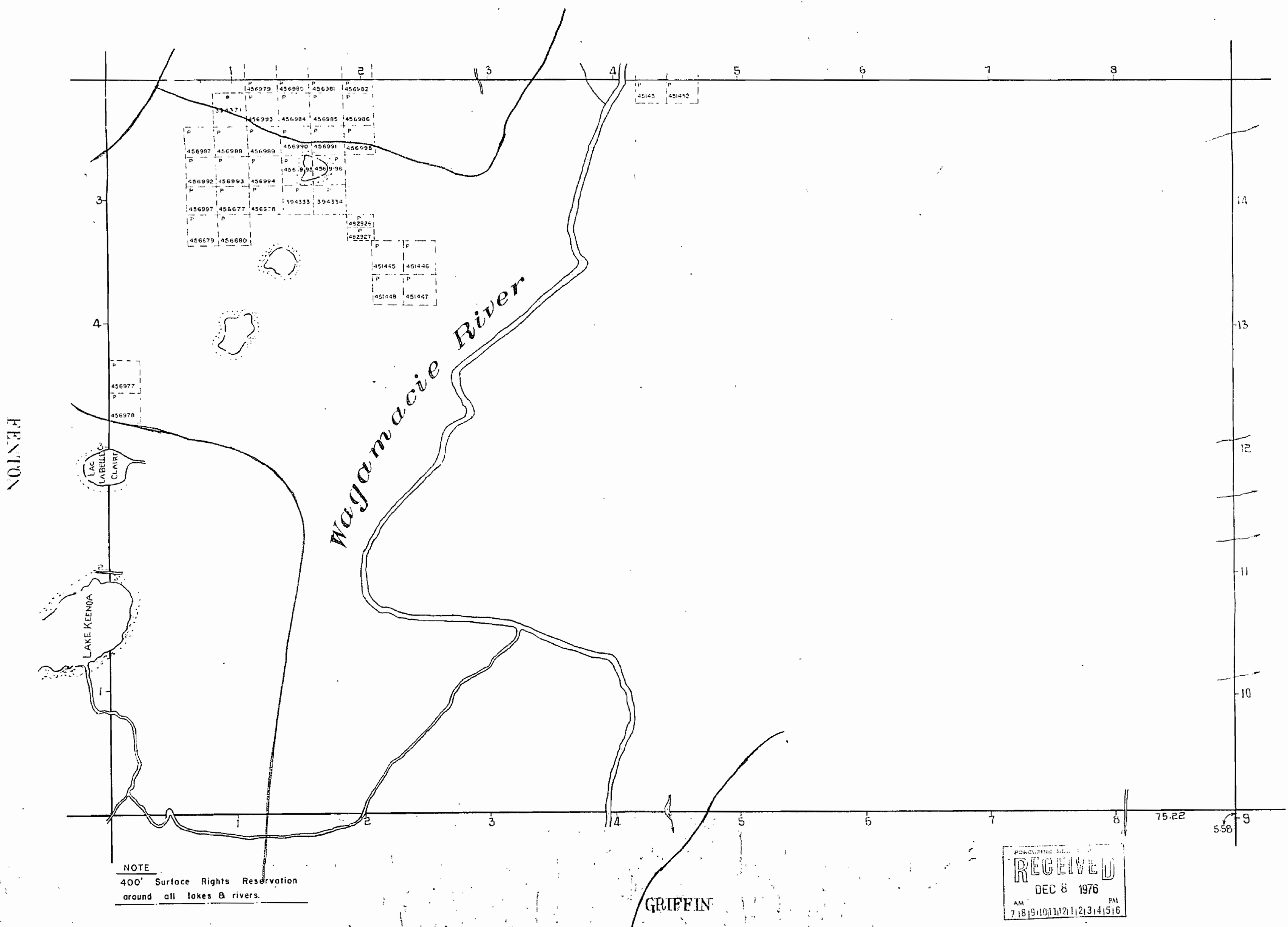

RECEIVED
DEC 8 1976
AM 7 18 PM 5 16

NOTES

400' surface rights reservation along the shores of all lakes and rivers.

DATE OF ISSUE
FEB 22 1977

PORCUPINE MINING DIVISION
RECEIVED
FEB 23 1977
AM 7 18 19 10 11 12 1 2 3 4 5 6 PM

CASSELMAN TP. M.708

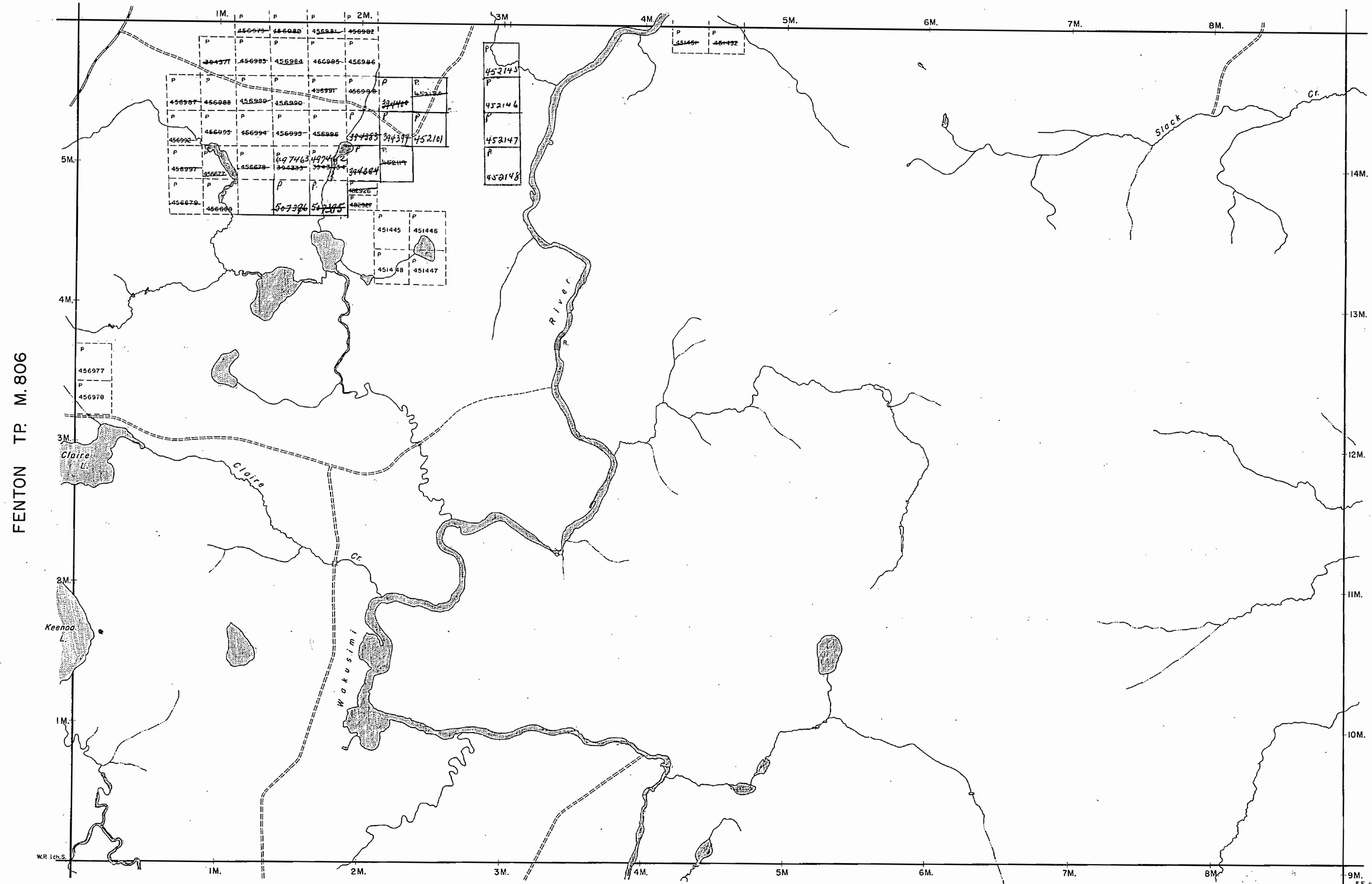

LEGEND

- HIGHWAY AND ROUTE No.
- OTHER ROADS
- TRAILS
- SURVEYED LINES:
 - TOWNSHIPS, BASE LINES, ETC.
 - LOTS, MINING CLAIMS, PARCELS, ETC.
- UNSURVEYED LINES:
 - LOT LINES
 - PARCEL BOUNDARY
 - MINING CLAIMS ETC.
- RAILWAY AND RIGHT OF WAY
- UTILITY LINES
- NON-PERENNIAL STREAM
- FLOODING OR FLOODING RIGHTS
- SUBDIVISION
- ORIGINAL SHORELINE
- MARSH OR MUSKEG
- MINES

DISPOSITION OF CROWN LANDS

TYPE OF DOCUMENT	SYMBOL
PATENT, SURFACE & MINING RIGHTS	
" SURFACE RIGHTS ONLY	
" MINING RIGHTS ONLY	
LEASE, SURFACE & MINING RIGHTS	
" SURFACE RIGHTS ONLY	
" MINING RIGHTS ONLY	
LICENCE OF OCCUPATION	
CROWN LAND SALE	C.S.
ORDER-IN-COUNCIL	OC
RESERVATION	
CANCELLED	
SAND & GRAVEL	

SCALE: 1 INCH = 40 CHAINS

FEET 0 500 1000 2000 4000 6000 8000
METRES 0 200 400 600 800 1KM 2KM

ACRES 40
HECTARES 16

TOWNSHIP
SLACK

DISTRICT
COCHRANE

MINING DIVISION
PORCUPINE

Ministry of Natural Resources
Ontario Surveys and Mapping Branch

Date JAN 1977 Plan No. M.1117
Whitney Block Queen's Park, Toronto

GRIFFIN TP. M.896

S.E. corner co-ordinates (approx.)
Lat. 48°58'22" Dep. 62°14'54"

M.III.M
STACK LB
9T K2A12
M.III.M

NOTES

400' surface rights reservation along the shores of all lakes and rivers.

R.1 Order of the Minister #69/87 dated July 20/87 withdraws Mining & Surface Rights, under Section 36, of the Mining Act, R. S. O. 1980.

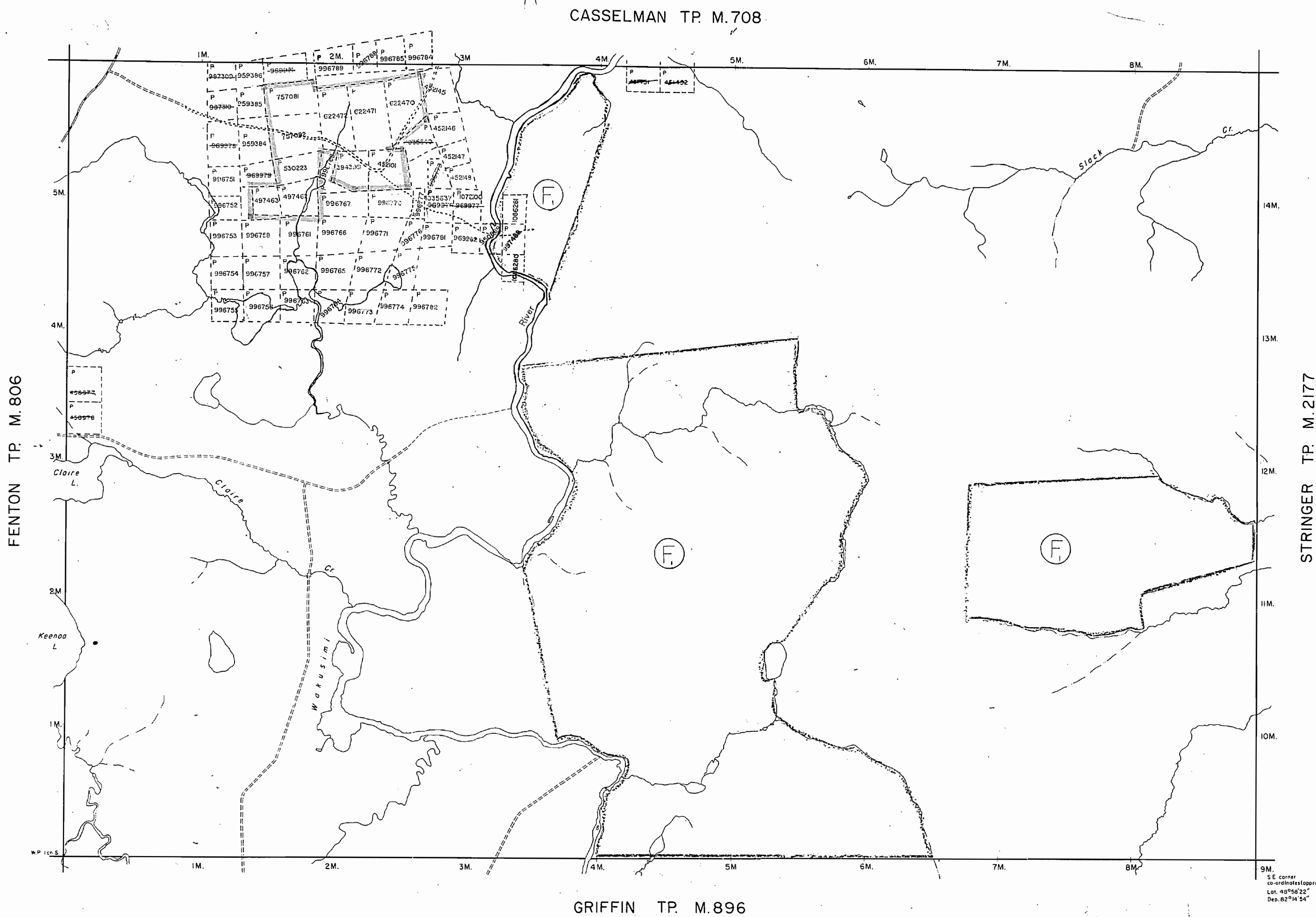

LEGEND

- HIGHWAY AND ROUTE No.
- OTHER ROADS
- TRAILS
- SURVEYED LINES:
 - TOWNSHIPS, BASE LINES, ETC.
 - LOTS, MINING CLAIMS, PARCELS, ETC.
- UNSURVEYED LINES:
 - LOT LINES
 - PARCEL BOUNDARY
 - MINING CLAIMS ETC.
- RAILWAY AND RIGHT OF WAY
- UTILITY LINES
- NON-PERENNIAL STREAM
- FLOODING OR FLOODING RIGHTS
- SUBDIVISION
- ORIGINAL SHORELINE
- MARSH OR MUSKEG
- MINES

DISPOSITION OF CROWN LANDS

TYPE OF DOCUMENT	SYMBOL
PATENT, SURFACE & MINING RIGHTS	
" SURFACE RIGHTS ONLY	
" MINING RIGHTS ONLY	
LEASE, SURFACE & MINING RIGHTS	
" SURFACE RIGHTS ONLY	
" MINING RIGHTS ONLY	
LICENCE OF OCCUPATION	
CROWN LAND SALE	C.S.
ORDER-IN-COUNCIL	OC
RESERVATION	
CANCELLED	
SAND & GRAVEL	
L.U.P.	

NOTES

(F) THIS TWP. IS SUBJECT TO FOREST ACTIVITIES IN 1990. FURTHER INFORMATION AVAILABLE ON FILE.

SCALE: 1 INCH = 40 CHAINS

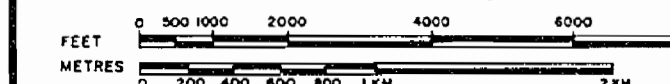

ACRES	HECTARES
40	16

TOWNSHIP

SLACK

DISTRICT

COCHRANE

MINING DIVISION

PORCUPINE

Rec. Feb. 4/80

Ministry of Natural Resources

Ontario - Surveys and Mapping Branch

Date JAN 1977

Plan No.

Whitney Block
Queen's Park, Toronto

M.III7

SE corner
co-ordinates (approx.)
Lat. 48°56'22"
Dep. 82°14'54"

GRIFFIN TP. M.896

CASSELMAN TP. M.708

FENTON TP. M.806

STRINGER TP. M.2177

M.III.M
STACK LB
9T K2A12
M.III.M

NOTES

400' surface rights reservation along the shores of all lakes and rivers.

(R) MINING AND SURFACE RIGHTS WITHDRAWN UNDER SECTION 36 OF THE MINING ACT R.S.O. 1980. ORDER NO. W-69-167-NR DATED JULY 20, 1987.

(F) THIS TWP. IS SUBJECT TO FOREST ACTIVITIES IN 1990. FURTHER INFORMATION AVAILABLE ON FILE.

(D) MINING AND SURFACE RIGHTS RE-OPENED TO PROSPECTING STAKING OUT, SALE OR LEASE UNDER SECTION 36 OF THE MINING ACT R.S.O. 1980, EFFECTIVE 9-DEC-03 AT 7 AM E.S.T. ORDER NO. O-P 6/91 NR DATED 9-NOV-12 (MINING CLAIMS P-334359, P-45201, P-497462, P-530223, P-622470, 7172, P-757081 AND P-757082)

THE INFORMATION THAT APPEARS ON THIS MAP HAS BEEN COMPILED FROM VARIOUS SOURCES, AND ACCURACY IS NOT GUARANTEED. THOSE WISHING TO STAKE MINING CLAIMS SHOULD CONSULT WITH THE MINING RECORDER, MINISTRY OF NORTHERN DEVELOPMENT AND MINES, FOR ADDITIONAL INFORMATION ON THE STATUS OF THE LANDS SHOWN HEREON.

CASSELMAN TP. M.708

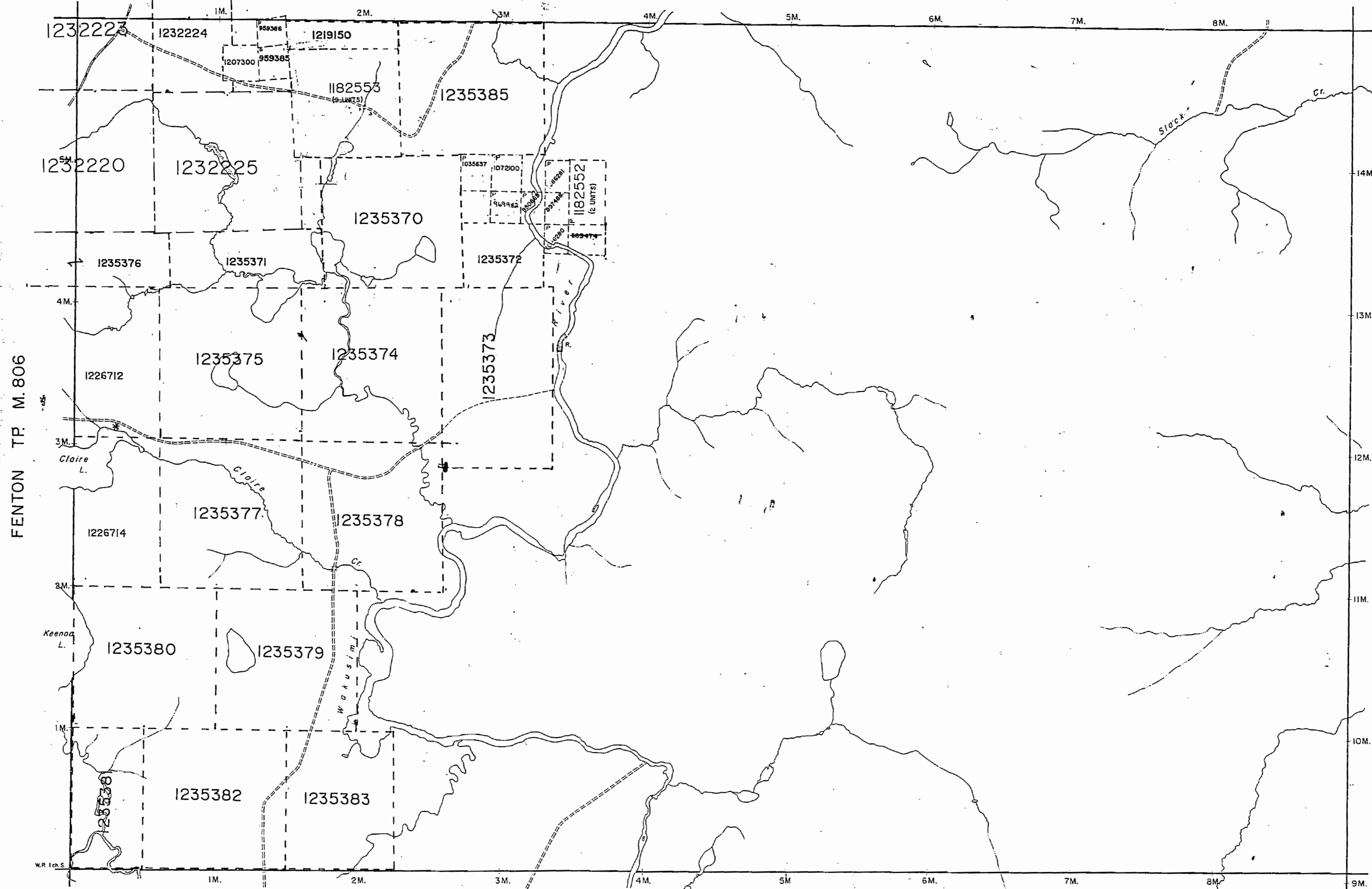

GRIFFIN TP. M.896

LEGEND

- HIGHWAY AND ROUTE No.
- OTHER ROADS
- TRAILS
- SURVEYED LINES:
 - TOWNSHIPS, BASE LINES, ETC.
 - LOTS, MINING CLAIMS, PARCELS, ETC.
- UNSURVEYED LINES:
 - LOT LINES
 - PARCEL BOUNDARY
 - MINING CLAIMS ETC.
- RAILWAY AND RIGHT OF WAY
- UTILITY LINES
- NON-PERENNIAL STREAM
- FLOODING OR FLOODING RIGHTS SUBDIVISION
- ORIGINAL SHORELINE
- MARSH OR MUSKEG
- MINES

DISPOSITION OF CROWN LANDS

TYPE OF DOCUMENT	SYMBOL
PATENT, SURFACE & MINING RIGHTS	
" SURFACE RIGHTS ONLY	
" MINING RIGHTS ONLY	
LEASE, SURFACE & MINING RIGHTS	
" SURFACE RIGHTS ONLY	
" MINING RIGHTS ONLY	
LICENCE OF OCCUPATION	
CROWN LAND SALE	C.S.
ORDER-IN-COUNCIL	OC
RESERVATION	
CANCELLED	
SAND & GRAVEL	
* Land Use Permit	

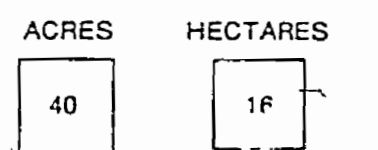
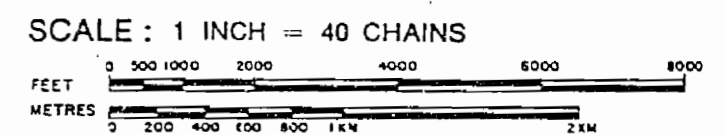

TOWNSHIP
SLACK

DISTRICT
COCHRANE

MINING DIVISION
PORCUPINE

Ministry of Natural Resources
Ontario Surveys and Mapping Branch

Date JAN 1977 Plan No. M.1117

Whitney Block
Queen's Park, Toronto
Checked: B.G. 1/18/85

S.E. corner
co-ordinates (approx.)
Lat. 48°58'22"
Dep. 82°14'54"

NOTES

400' surface rights reservation along the shores of all lakes and rivers.

(R) MINING AND SURFACE RIGHTS WITHDRAWN UNDER SECTION 36 OF THE MINING ACT R.S.O. 1980. ORDER NO. W-69-187 NR DATED JULY 20, 1987.

(K) THIS TWP. IS SUBJECT TO FOREST ACTIVITIES IN 1990. FURTHER INFORMATION AVAILABLE ON FILE.

(D) MINING AND SURFACE RIGHTS RE-OPENED TO PROSPECTING STAKING OUT, SALE OR LEASE UNDER SECTION 36 OF THE MINING ACT R.S.O. 1980, EFFECTIVE 91-DEC-03 AT 7 AM E.S.T. ORDER NO. O-P 6191 NR DATED 91-NOV-12. (MINING CLAIMS P-394399, P-452101, P-497462, P-530223, P-622470, P-757081 AND P-757082)

THE INFORMATION THAT APPEARS ON THIS MAP HAS BEEN COMPILED FROM VARIOUS SOURCES, AND ACCURACY IS NOT GUARANTEED. THOSE WISHING TO STAKE MINING CLAIMS SHOULD CONSULT WITH THE MINING RECORDER, MINISTRY OF NORTHERN DEVELOPMENT AND MINES, FOR ADDITIONAL INFORMATION ON THE STATUS OF THE LANDS SHOWN HEREON.

CASSELMAN TP. M.708

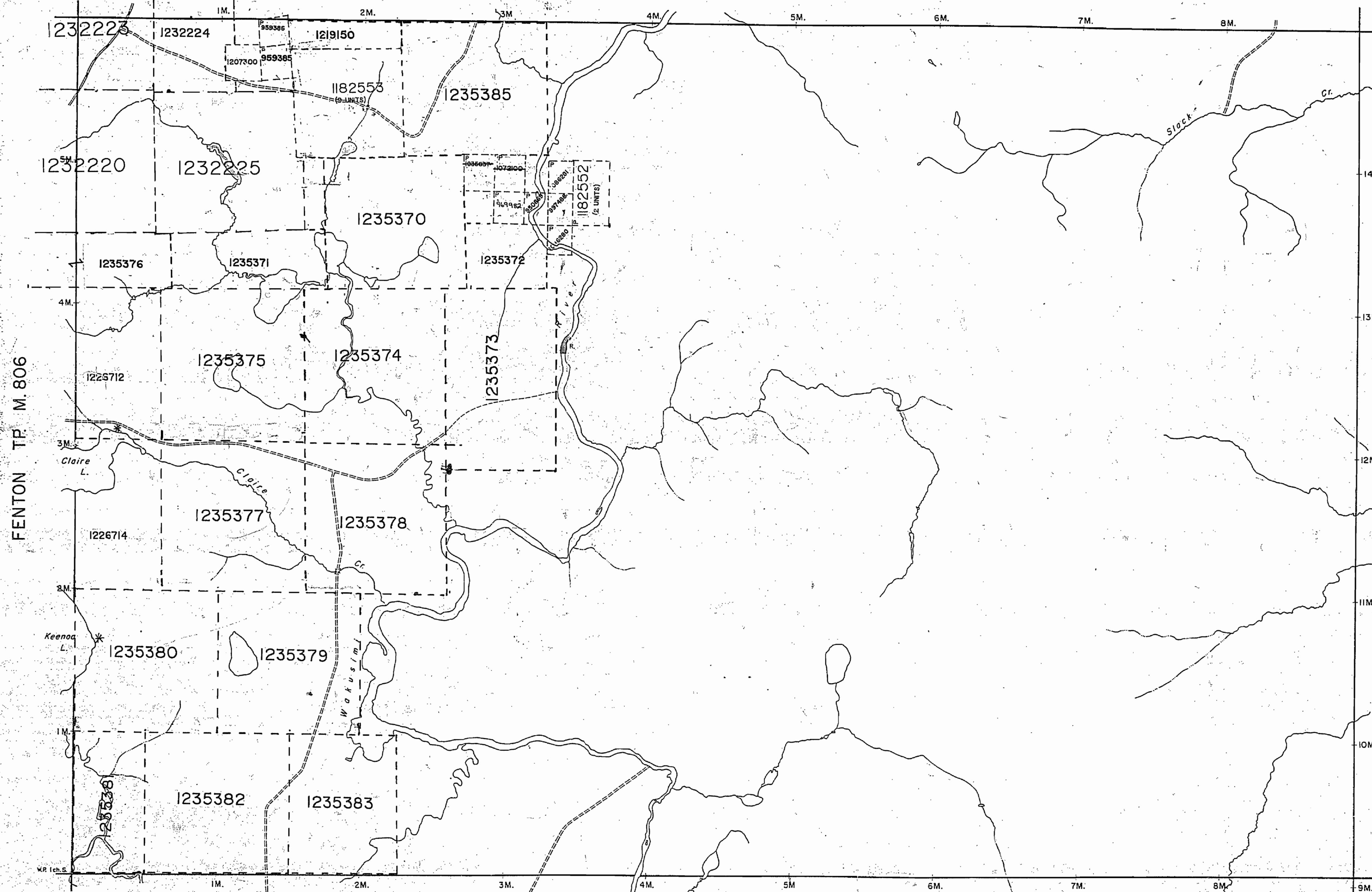

S.E. corner
Co-ordinates (approx.)
Lat. 48°58'22"
Dep. 82°14'54"

LEGEND

- HIGHWAY AND ROUTE No.
- OTHER ROADS
- TRAILS
- SURVEYED LINES:
TOWNSHIPS, BASE LINES, ETC.
- LOTS, MINING CLAIMS, PARCELS, ETC.
- UNSURVEYED LINES:
LOT LINES
- PARCEL BOUNDARY
- MINING CLAIMS ETC.
- RAILWAY AND RIGHT OF WAY
- UTILITY LINES
- NON-PERENNIAL STREAM
- FLOODING OR FLOODING RIGHTS
- SUBDIVISION
- ORIGINAL SHORELINE
- MARSH OR MUSKEG
- MINES

DISPOSITION OF CROWN LANDS

TYPE OF DOCUMENT	SYMBOL
PATENT, SURFACE & MINING RIGHTS	
" SURFACE RIGHTS ONLY	
" MINING RIGHTS ONLY	
LEASE, SURFACE & MINING RIGHTS	
" SURFACE RIGHTS ONLY	
" MINING RIGHTS ONLY	
LICENCE OF OCCUPATION	
CROWN LAND SALE	
ORDER-IN-COUNCIL	
RESERVATION	
CANCELLED	
SAND & GRAVEL	
* Land Use Permit.	

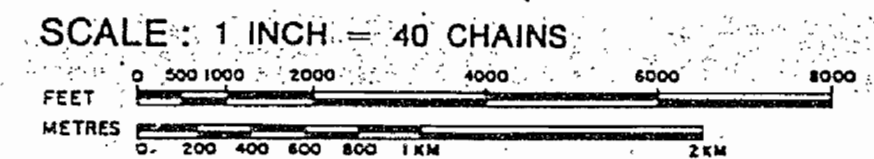

ACRES	HECTARES
40	16

TOWNSHIP
SLACK

DISTRICT
COCHRANE

MINING DIVISION
PORCUPINE

Ministry of Natural Resources
Ontario Surveys and Mapping Branch

Date JAN 1977
Plan No. M.1117
Whitney Block
Queen's Park, Toronto
CHECKED: RB APR 11th 1975

GRIFFIN TP. M.896

FENTON TP. M.806

STRINGER TP. M.2177

NOTES

400' surface rights reservation along the shores of all lakes and rivers.

MINING AND SURFACE RIGHTS WITHDRAWN UNDER SECTION 36 OF THE MINING ACT R.S.O. 1980, ORDER NO. W-59 147 NR. DATED JULY 20, 1987.

THIS TWP. IS SUB. LOT TO FOREST WITH THE FURTHER INFORMATION AVAILABLE ON FILE.

MINING AND SURFACE RIGHTS RE-OPENED TO PROSPECTING STAKING OUT, SALE OR LEASE UNDER SECTION 36 OF THE MINING ACT R.S.O. 1980, EFFECTIVE 9:15:00 AM AT 7 AM EST. ORDER NO. C-7 6111 NR. DATED 9/16/87. MINING CLAIMS F-294399, F-452101, F-494026, F-530023, F-022470, F-757011 NR. 1/17/88.

CASSELMAN TP. M.708

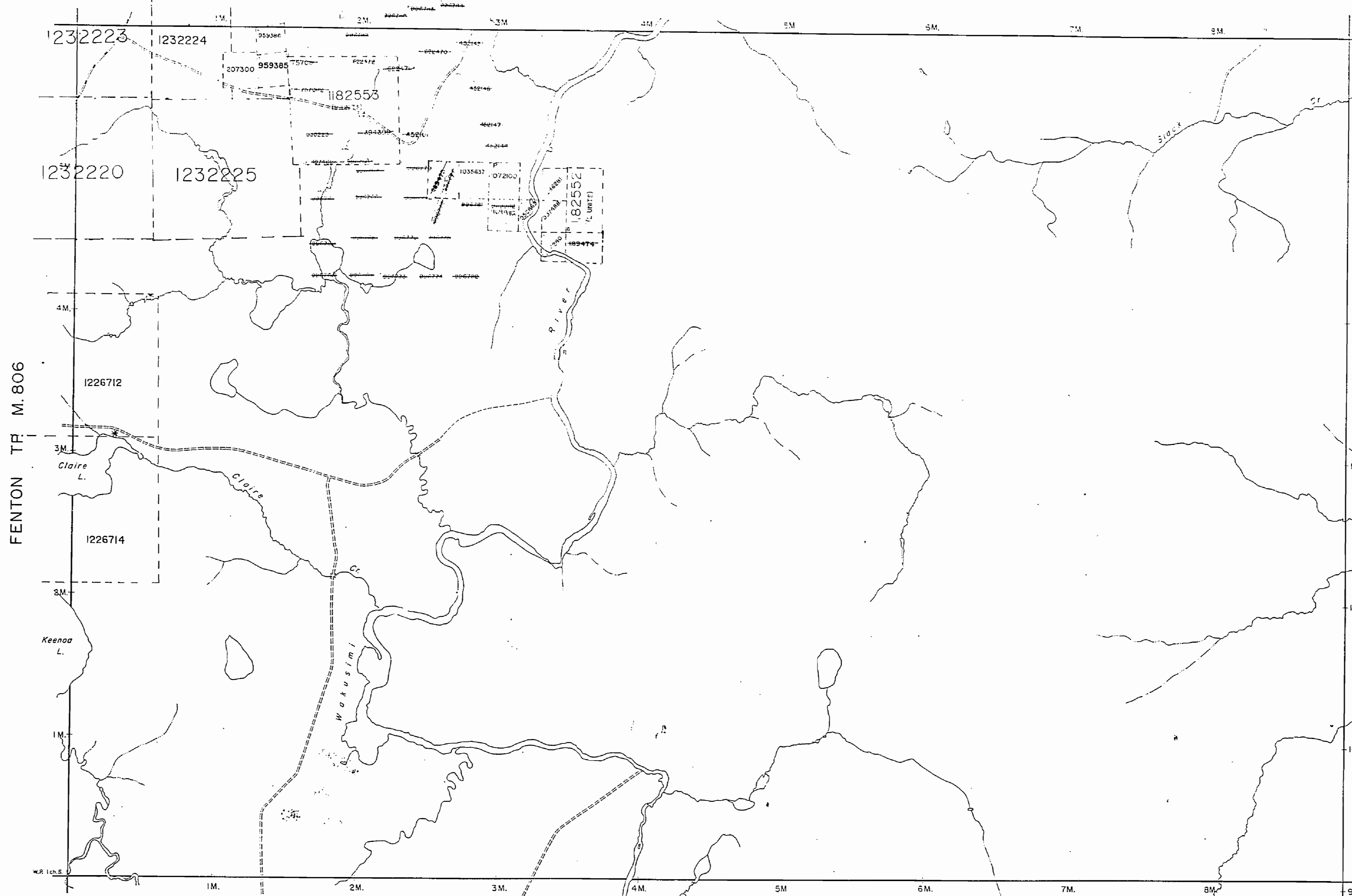

FENTON TP. M.806

STRINGER TP. M.2177

GRIFFIN TP. M.896

LEGEND

- HIGHWAY AND ROUTE No.
- OTHER ROADS
- TRAILS
- SURVEYED LINES:
 - TOWNSHIPS, BASE LINES, ETC.
 - LOTS, MINING CLAIMS, PARCELS, ETC.
- UNSURVEYED LINES:
 - LOT LINES
 - PARCEL BOUNDARY
 - MINING CLAIMS ETC.
- RAILWAY AND RIGHT OF WAY
- UTILITY LINES
- NON-PERENNIAL STREAM
- FLOODING OR FLOODING RIGHTS SUBDIVISION
- ORIGINAL SHOPELINE
- MARSH OR MUSKEG
- MINES

DISPOSITION OF CROWN LANDS

TYPE OF DOCUMENT	SYMBOL
PATENT, SURFACE & MINING RIGHTS	
" SURFACE RIGHTS ONLY	
" MINING RIGHTS ONLY	
LEASE, SURFACE & MINING RIGHTS	
" SURFACE RIGHTS ONLY	
" MINING RIGHTS ONLY	
LICENCE OF OCCUPATION	
CROWN LAND SALE	
ORDER-IN-COUNCIL	
RESERVATION	
CANCELLED	
SAND & GRAVEL	
* Land Use Permit	

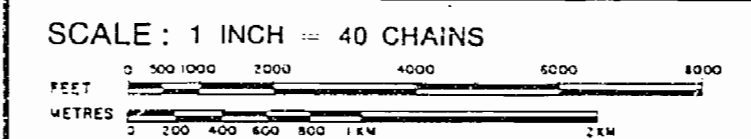

ACRES	HECTARES
40	1F

TOWNSHIP
SLACK
DISTRICT
COCHRAN
MINING DIVISION
PORCUPINE

PROVINCIAL RECORDING OFFICE - SUDBURY
MAY 19 1988
DATE OF ISSUE

Ministry of Natural Resources
Ontario Surveys and Mapping Branch

Date JAN 1977 Plan No. M.1117

Whitney Block
Queen's Park, Toronto
Checked: RB MR JH 83

THE INFORMATION THAT APPEARS ON THIS MAP HAS BEEN COMPILED FROM VARIOUS SOURCES, AND ACCURACY IS NOT GUARANTEED. THOSE WISHING TO STAKE MINING CLAIMS SHOULD CONSULT WITH THE MINING RECORDER, MINISTRY OF NORTHERN DEVELOPMENT AND MINES, FOR ADDITIONAL INFORMATION ON THE STATUS OF THE LANDS SHOWN HEREON.

S.E. corner co-ordinates (approx)
Lat. 48°58'22" N
Dep. 02°14'54" W

1117

DME OF ISSUE
DEC 6 1976

SLACK

M. 117
MINISTRY OF NATURAL RESOURCES
SURVEYS AND MAPPING BRANCH

DISTRICT OF SUDBURY
PORCUPINE MINING DIVISION
SCALE 40 CHAINS TO ONE INCH

CASSELMAN

FENTON

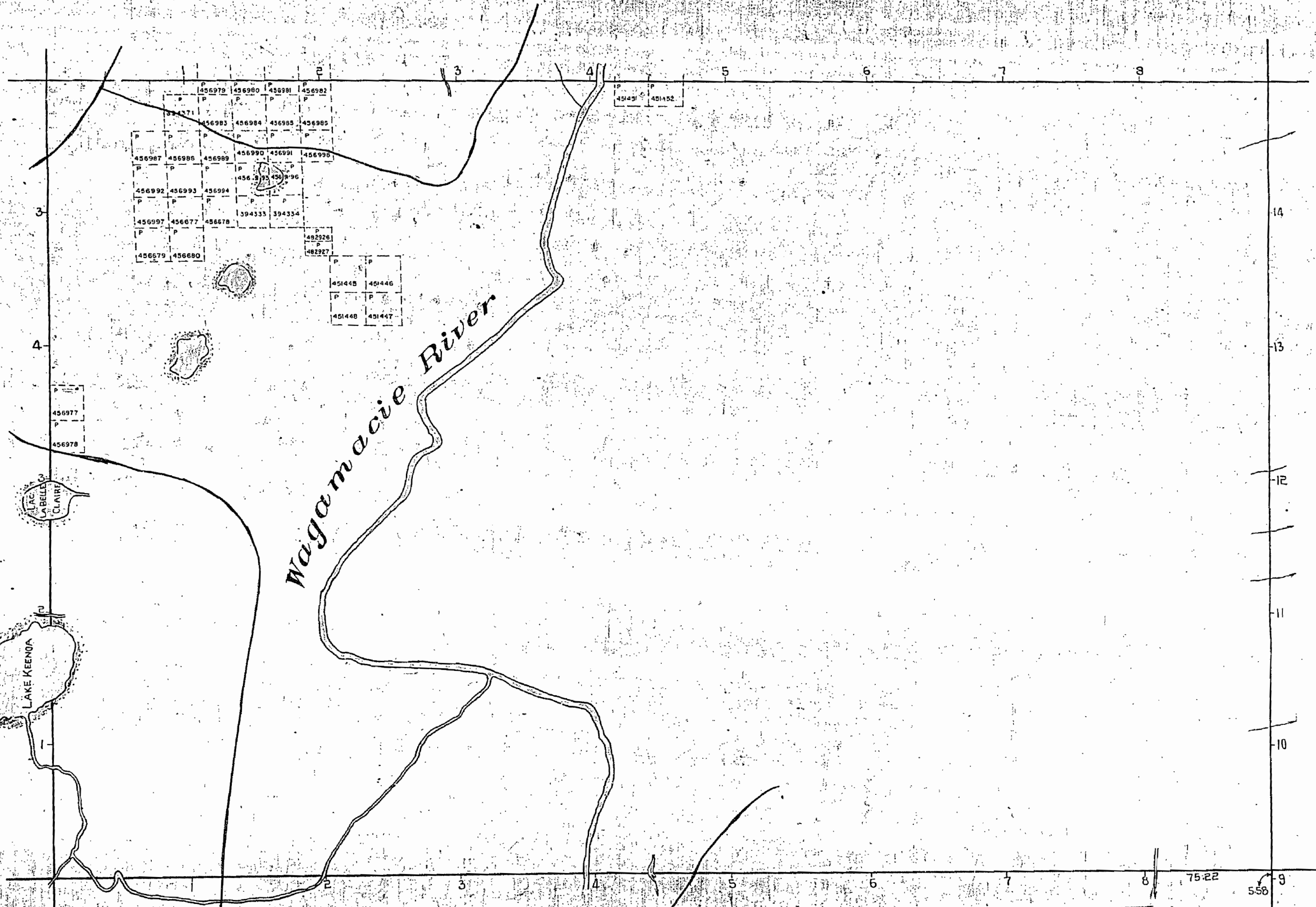

NOTE
400' Surface Rights Reservation
around all lakes & rivers.

GRIFFIN

RECEIVED
DEC 8 1976
AM 7 18 19 10 11 12 1 2 3 4 5 6 PM

75:22
558

NOTES

400' surface rights reservation along the shores of all lakes and rivers.

(R) MINING AND SURFACE RIGHTS WITHDRAWN UNDER SECTION 36 OF THE MINING ACT R.S.O. 1990; ORDER NO. W-69-167 NR. DATED JULY 20, 1967.

(F) THIS TWP. IS SUBJECT TO FOREST ACTIVITIES IN 1990. FURTHER INFORMATION AVAILABLE ON FILE.

(D) MINING AND SURFACE RIGHTS RE-OPENED TO PROSPECTING STAKING OUT, SALE OR LEASE UNDER SECTION 36 OF THE MINING ACT R.S.O. 1990, EFFECTIVE 91-DEC-03 AT 7 AM E.S.T. ORDER NO. O-P 6/91 NR DATED 91-NOV-12 MINING CLAIMS P-394399, P-452101, P-497462, P-530223, P-622470, P-757081 AND P-757082

THE INFORMATION THAT APPEARS ON THIS MAP HAS BEEN COMPILED FROM VARIOUS SOURCES, AND ACCURACY IS NOT GUARANTEED. THOSE WISHING TO STAKE MINING CLAIMS SHOULD CONSULT WITH THE MINING RECORDER, MINISTRY OF NORTHERN DEVELOPMENT AND MINES, FOR ADDITIONAL INFORMATION ON THE STATUS OF THE LANDS SHOWN HEREON.

CASSELMAN TP. M.708

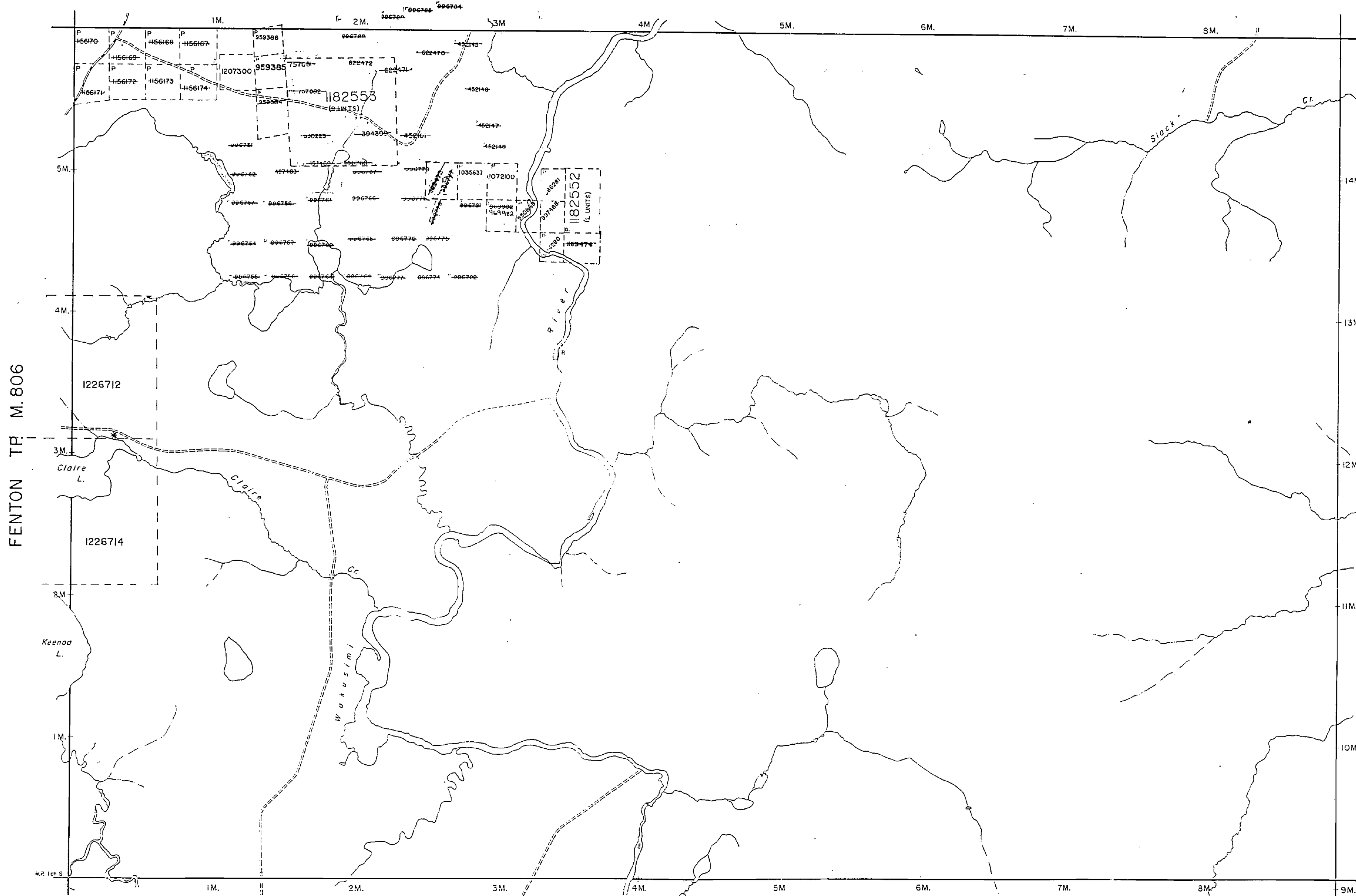

FENTON TP. M.806

STRINGER TP. M.2177

GRIFFIN TP. M.896

S.E. corner co-ordinates (approx.)
 Lat. 48°58' 22"
 Dep. 82°14' 54"

LEGEND

- HIGHWAY AND ROUTE No.
- OTHER ROADS
- TRAILS
- SURVEYED LINES:
 - TOWNSHIPS, BASE LINES, ETC.
 - LOTS, MINING CLAIMS, PARCELS, ETC.
- UNSURVEYED LINES:
 - LOT LINES
 - PARCEL BOUNDARY
 - MINING CLAIMS ETC.
- RAILWAY AND RIGHT OF WAY
- UTILITY LINES
- NON-PERENNIAL STREAM
- FLOODING OR FLOODING RIGHTS SUBDIVISION
- ORIGINAL SHORELINE
- MARSH OR MUSKEG
- MINES

DISPOSITION OF CROWN LANDS

TYPE OF DOCUMENT	SYMBOL
PATENT, SURFACE & MINING RIGHTS	
" SURFACE RIGHTS ONLY	
" MINING RIGHTS ONLY	
LEASE, SURFACE & MINING RIGHTS	
" SURFACE RIGHTS ONLY	
" MINING RIGHTS ONLY	
LICENCE OF OCCUPATION	
CROWN LAND SALE	
ORDER-IN-COUNCIL	
RESERVATION	
CANCELLED	
SAND & GRAVEL	
* Land Use Permit	

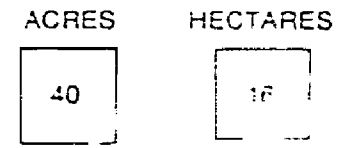
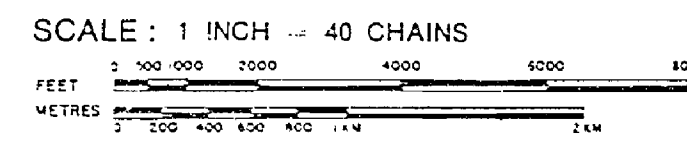

TOWNSHIP
SLACK
 DISTRICT
 COCHRANE
 MINING DIVISION
 PORCUPINE

Ministry of Natural Resources
 Ontario Surveys and Mapping Branch
 Date JAN 1977 Plan No.

1117

SLACK

DISTRICT OF SUDBURY
PORCUPINE MINING DIVISION
SCALE 40 CHAINS TO ONE INCH

CASSELMAN

FENTON

STRINGER

GRIFFIN

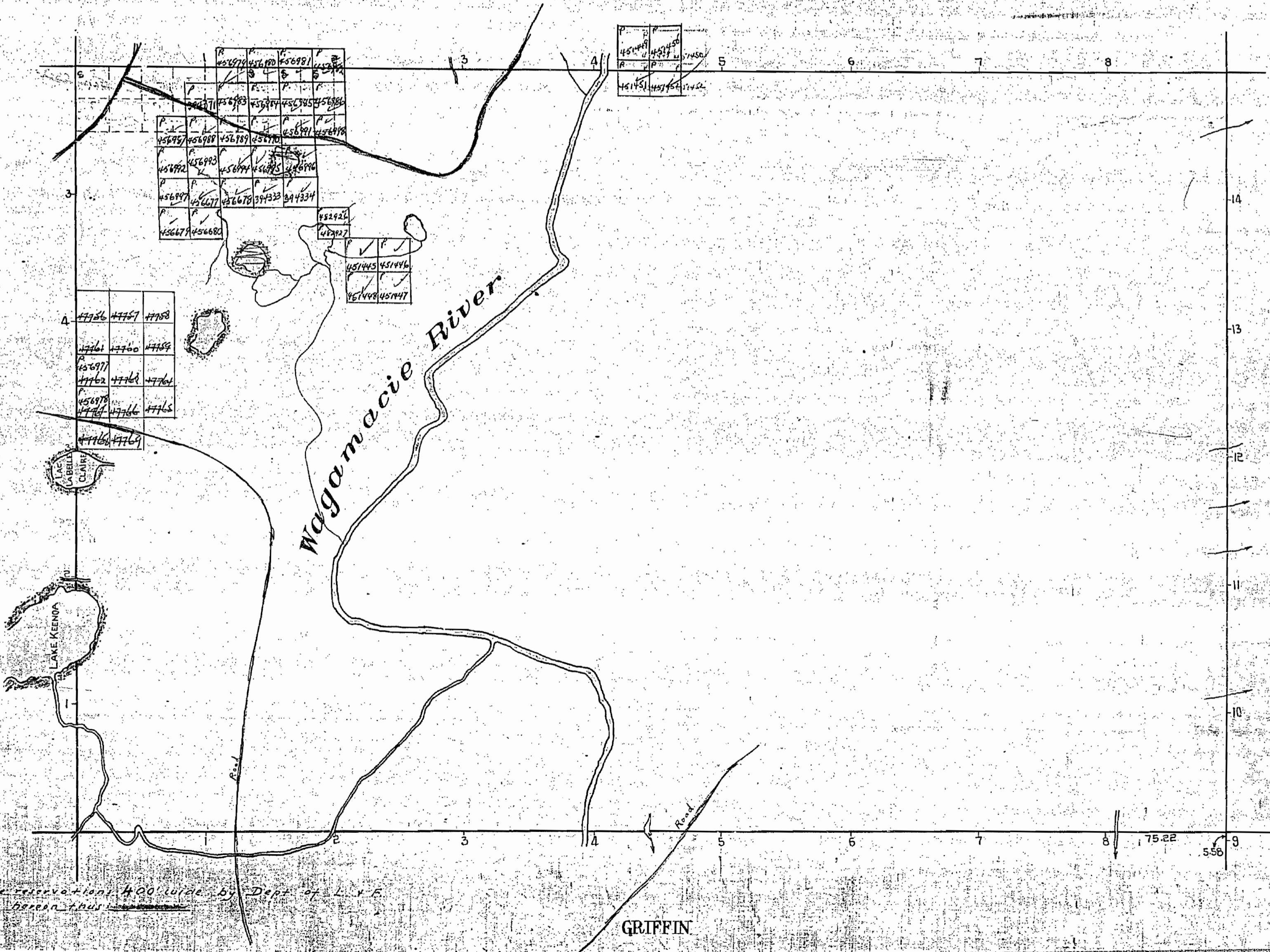

Surface reservations 400' wide by Dept of L & F
Shelton Green this

75.22
558

1117

DATE OF ISSUE
DEC 6 1975

SLACK

M 1117
ONTARIO
MINISTRY OF NATURAL RESOURCES
SURVEYS AND MAPPING BRANCH

DISTRICT OF SUDBURY
PORCUPINE MINING DIVISION
SCALE 40 CHAINS TO ONE INCH

CASSELMAN

HENTON

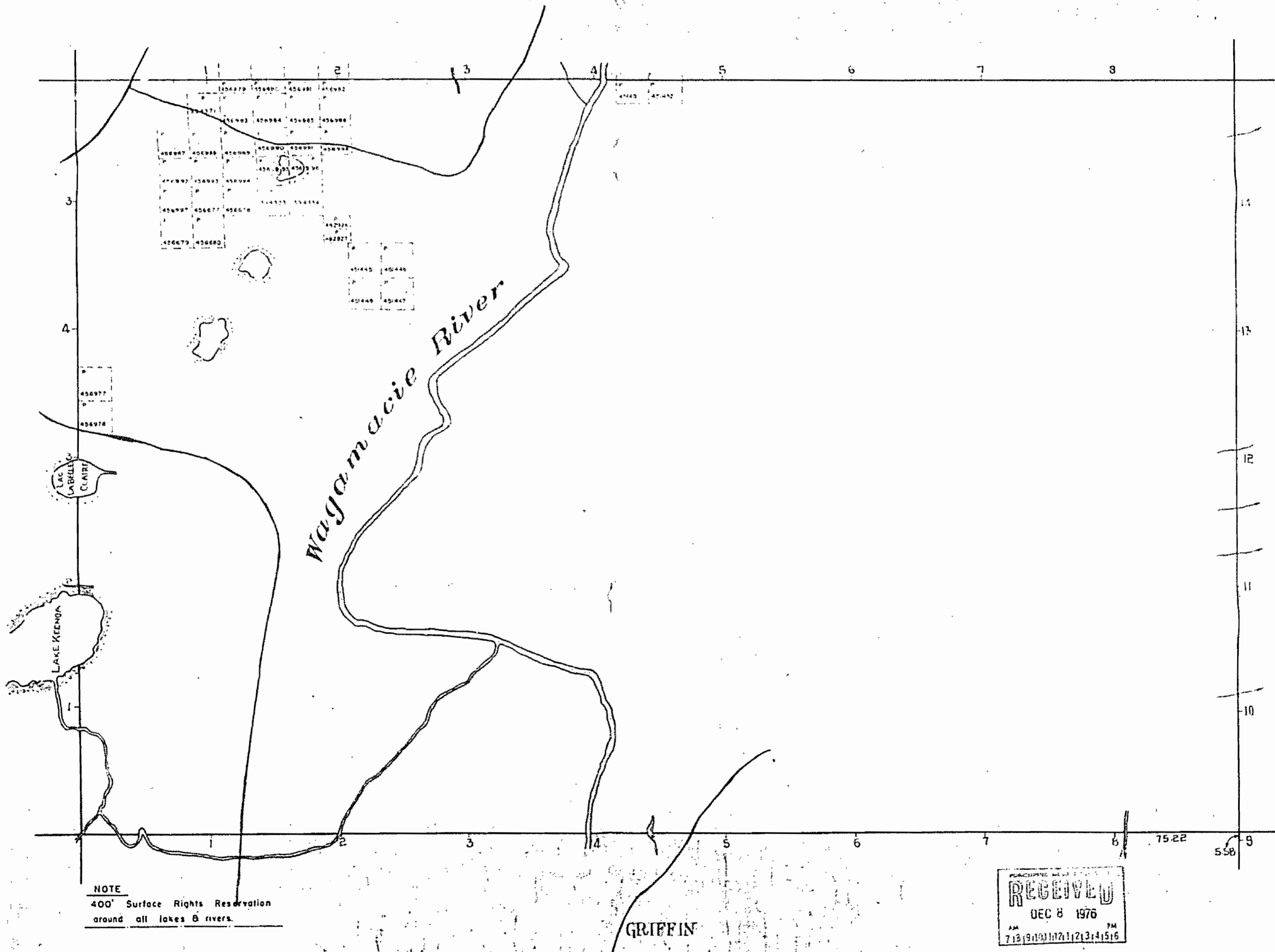

NOTE
400' Surface Rights Reservation
around all lakes & rivers.

RECEIVED
DEC 8 1975
7:13 PM

1117

SLACK

M 117

DISTRICT OF SUDBURY
PORCUPINE MINING DIVISION
SCALE 40 CHAINS TO ONE INCH

CASSELMAN

FENTON

STRINGER

GRIFFIN

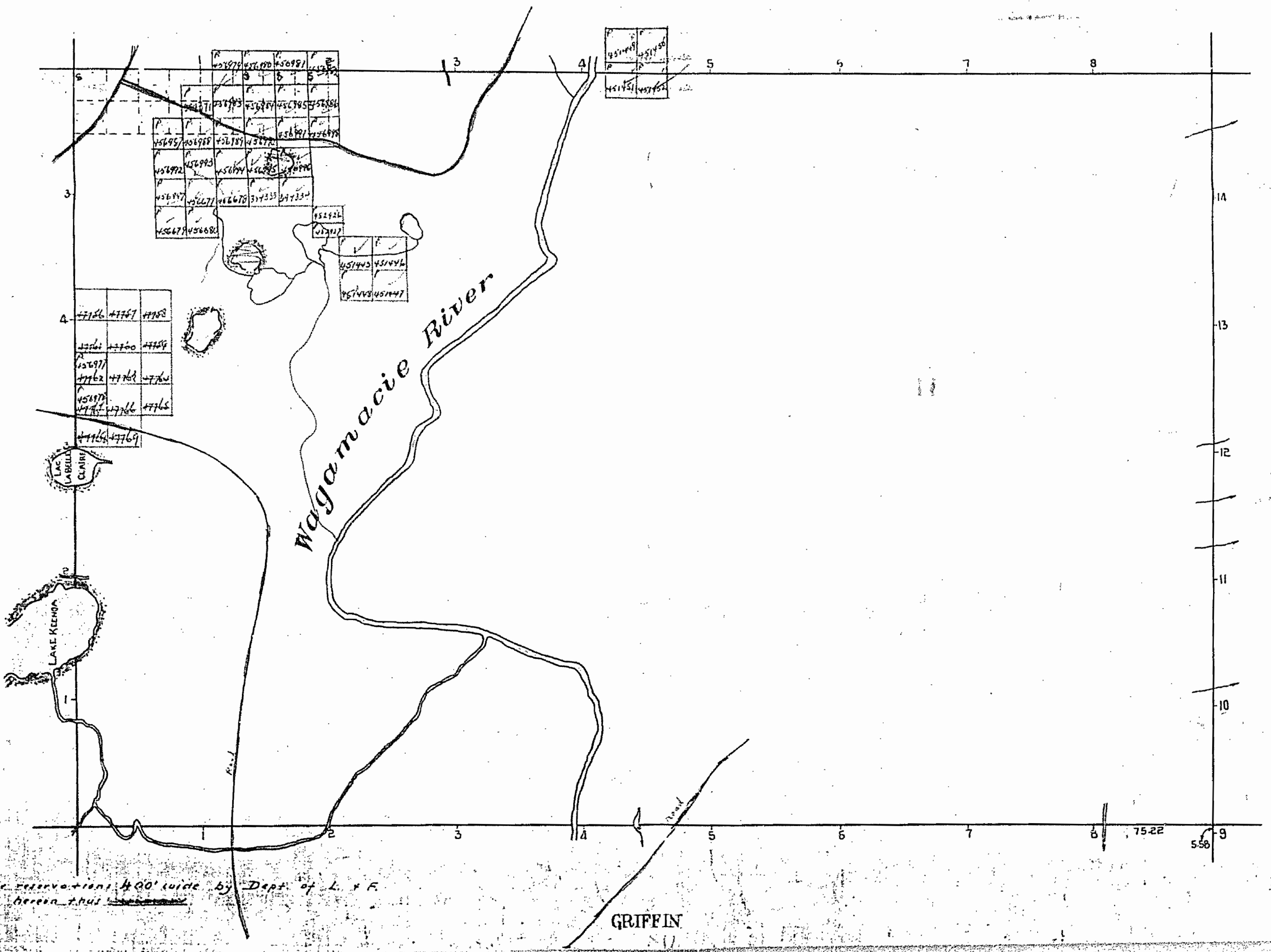

Surface reservations 400' wide by Dept. of L. & F.
shown herein thus ~~-----~~

1117

SLACK

M-117

DISTRICT OF SUDBURY
PORCUPINE MINING DIVISION
SCALE 40 CHAINS TO ONE INCH

CASSELMAN

FENTON

STRINGER

GRIFFIN

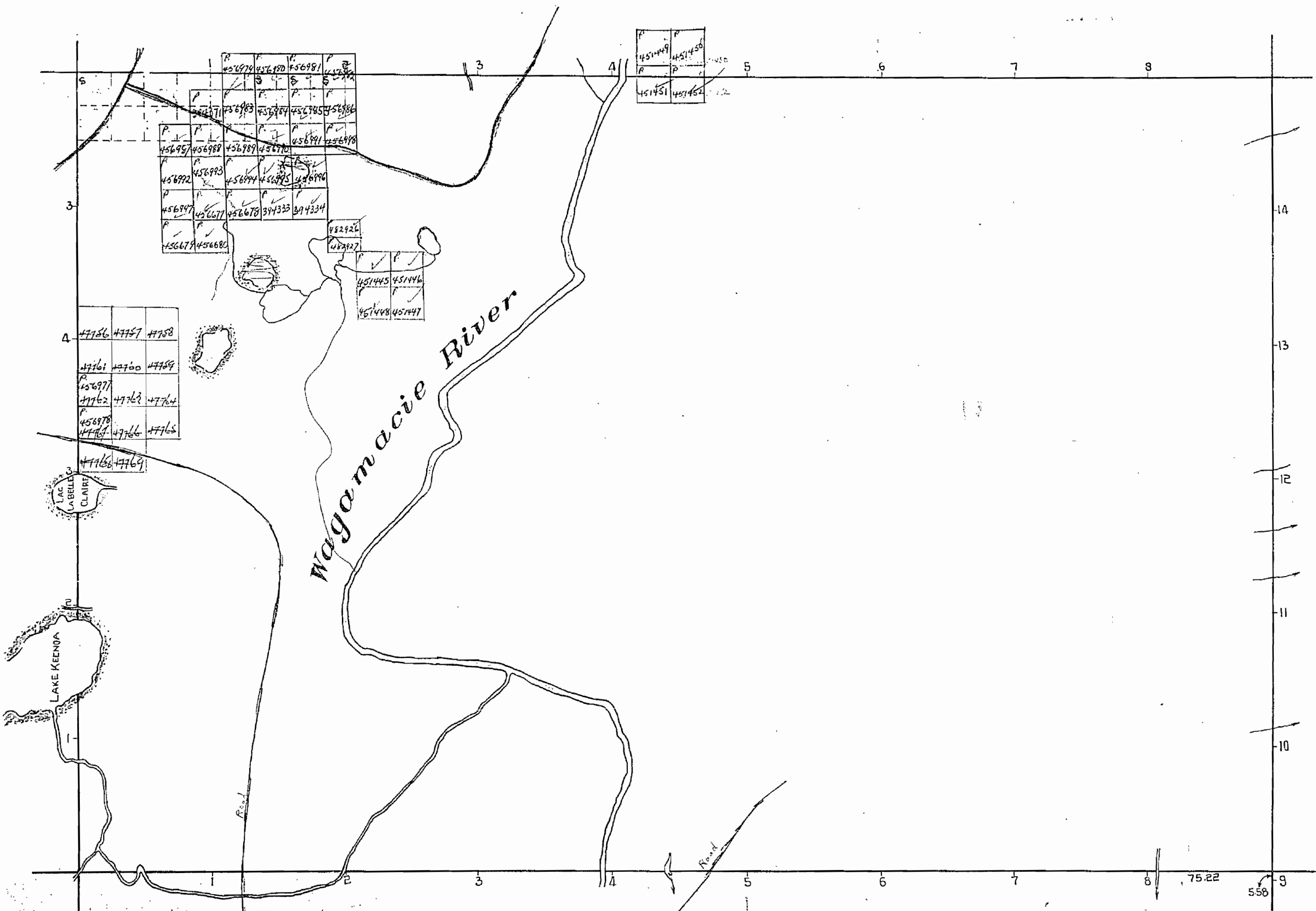

Surface reservations 400' wide by Dept. of L. & F.
shown hereon thus