

NOTES

400' surface rights reservation along the shores of all lakes and rivers.

Tp. 28 R. 15 M. 1530

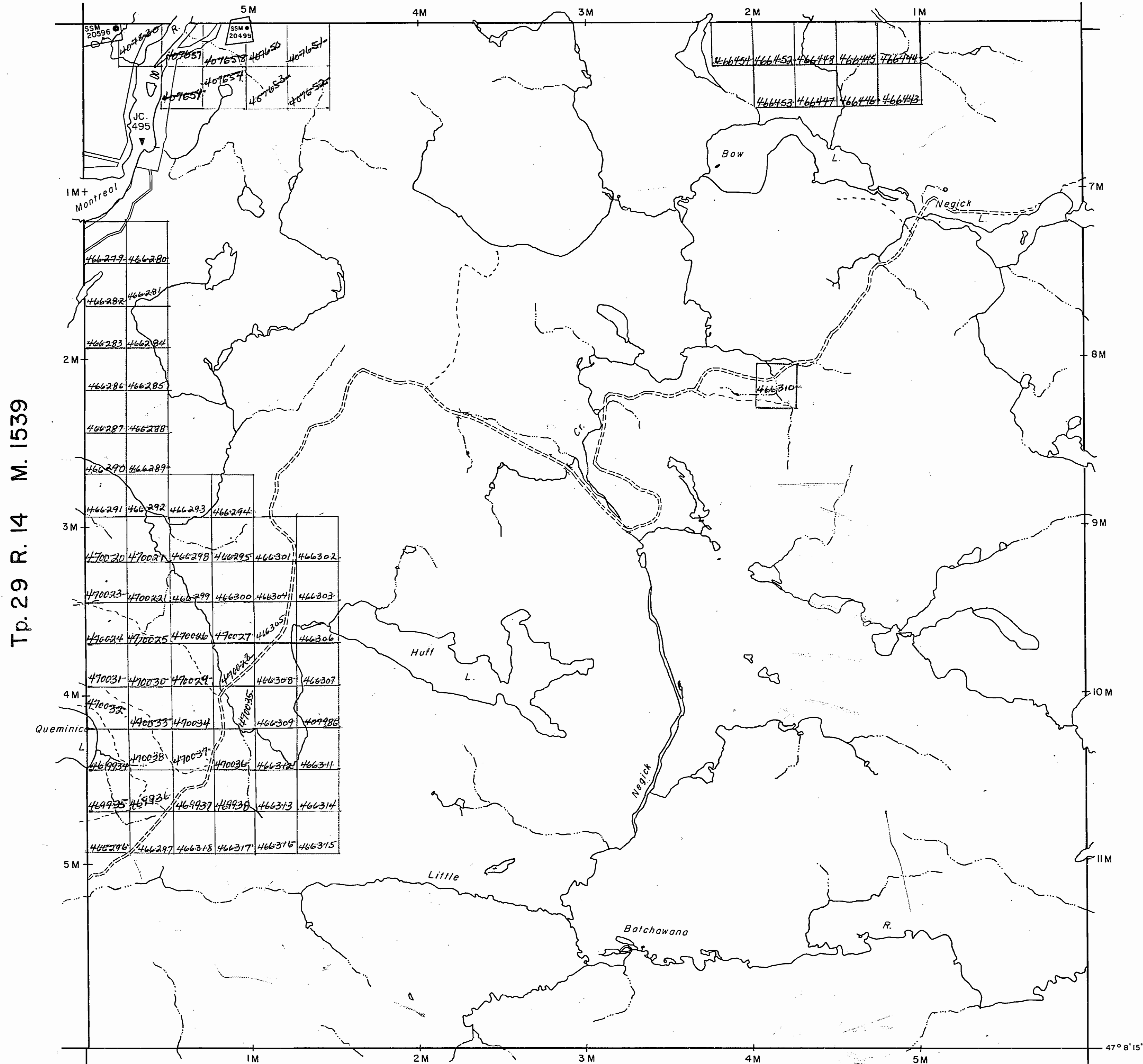

LEGEND

- HIGHWAY AND ROUTE No.
- OTHER ROADS
- TRAILS
- SURVEYED LINES:
 - TOWNSHIPS, BASE LINES, ETC.
 - LOTS, MINING CLAIMS, PARCELS, ETC.
- UNSURVEYED LINES:
 - LOT LINES
 - PARCEL BOUNDARY
 - MINING CLAIMS ETC.
- RAILWAY AND RIGHT OF WAY
- UTILITY LINES
- NON-PERENNIAL STREAM
- FLOODING OR FLOODING RIGHTS
- SUBDIVISION
- ORIGINAL SHORELINE
- MARSH OR MUSKEG
- MINES

DISPOSITION OF CROWN LANDS

TYPE OF DOCUMENT	SYMBOL
PATENT, SURFACE & MINING RIGHTS	●
" SURFACE RIGHTS ONLY	○
" MINING RIGHTS ONLY	◐
LEASE, SURFACE & MINING RIGHTS	■
" SURFACE RIGHTS ONLY	◼
" MINING RIGHTS ONLY	◻
LICENCE OF OCCUPATION	▼
CROWN LAND SALE	CS
ORDER-IN-COUNCIL	OC
RESERVATION	⊙
CANCELLED	⊗
SAND & GRAVEL	⊕

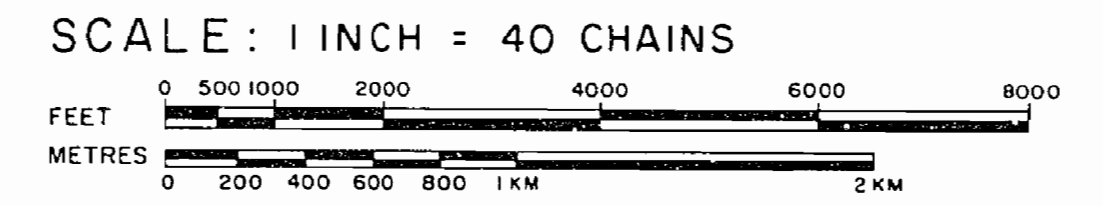

ACRES	HECTARES
40	16

TOWNSHIP (SMILSKY)

Tp. 28 R. 14

DISTRICT **ALGOMA**

MINING DIVISION

SAULT STE. MARIE

ONTARIO
MINISTRY OF NATURAL RESOURCES
SURVEYS AND MAPPING BRANCH

DATE Jan '73 PLAN No. **M. 1520**
WHITNEY BLOCK QUEEN'S PARK, TORONTO

Tp. 28 R. 13 M. 1527

NOTE: Part of this twp. is covered by Unspecified Pit # 844 ROGER LABELLE LOGGING COMPANY. (see file for details).

G. 3128

NOTES

400' surface rights reservation along the shores of all lakes and rivers.

R₁ - the surface & Mining Rights of 18 acres (7.28 ha) withdrawn from prospecting, staking out, sale or lease under Section 36 of M.A. Order No. W-4/83-Sault Ste. Marie dated August 2, 1983

PEEVER TP. M. 1530

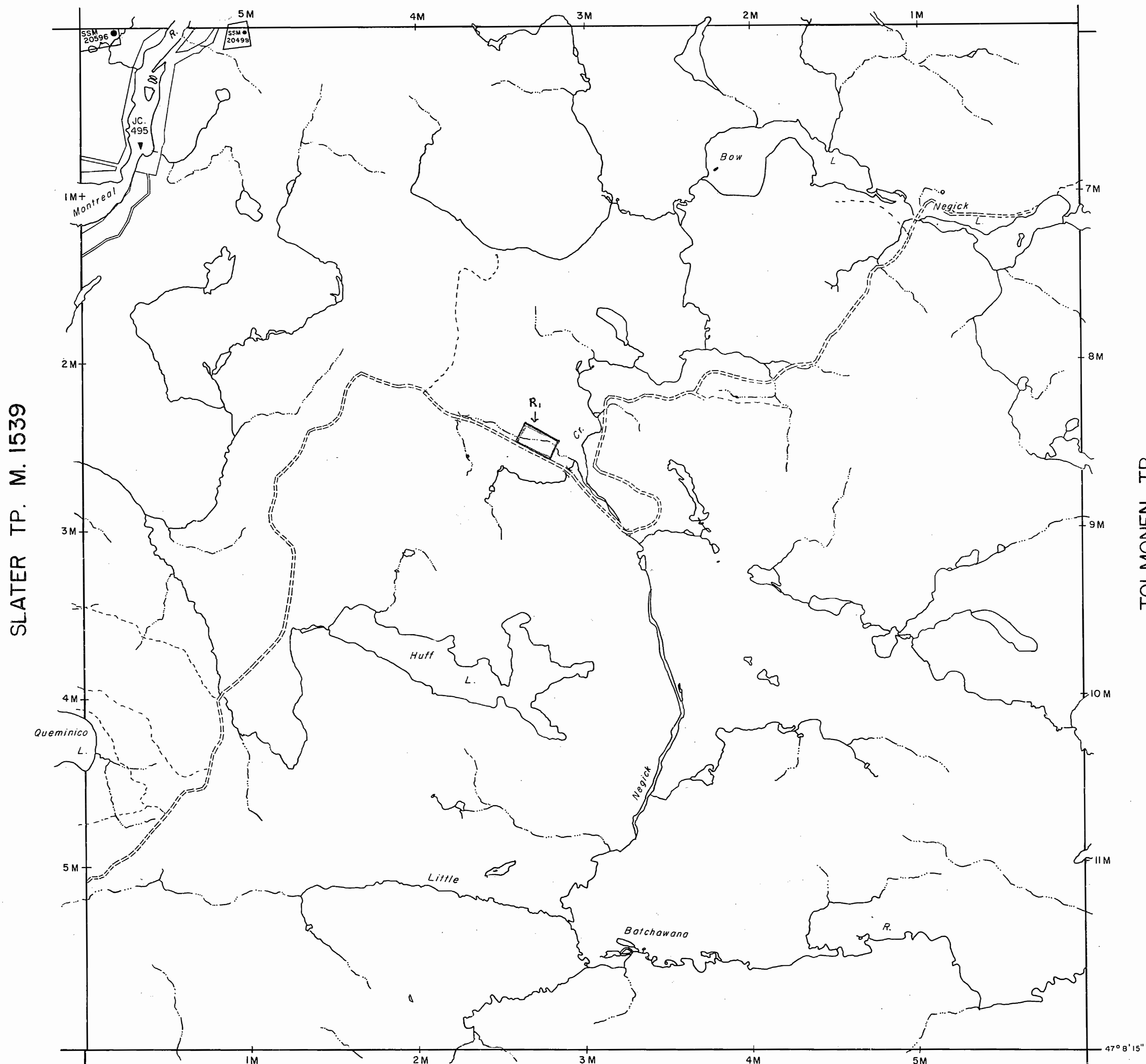

SLATER TP. M. 1539

TOLMONEN TP.

NICOLET TP. M. 1527

NOTE: PART OF THIS TWP IS COVERED BY "UNSPECIFIED PIT" #4444 ROBER LABELLE LOGGING CO. (SEE FILE FOR DETAILS)

Replaced by mylan July 12/84

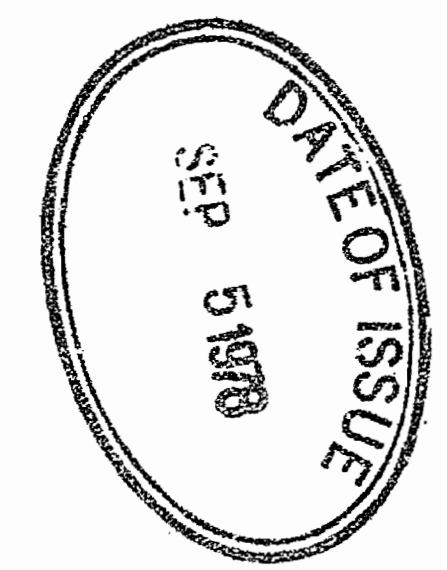

LEGEND

- HIGHWAY AND ROUTE No.
- OTHER ROADS
- TRAILS
- SURVEYED LINES:
 - TOWNSHIPS, BASE LINES, ETC.
 - LOTS, MINING CLAIMS, PARCELS, ETC.
- UNSURVEYED LINES:
 - LOT LINES
 - PARCEL BOUNDARY
 - MINING CLAIMS ETC.
- RAILWAY AND RIGHT OF WAY
- UTILITY LINES
- NON-PERENNIAL STREAM
- FLOODING OR FLOODING RIGHTS
- SUBDIVISION
- ORIGINAL SHORELINE
- MARSH OR MUSKEG
- MINES

DISPOSITION OF CROWN LANDS

TYPE OF DOCUMENT	SYMBOL
PATENT, SURFACE & MINING RIGHTS	●
" SURFACE RIGHTS ONLY	○
" MINING RIGHTS ONLY	◐
LEASE, SURFACE & MINING RIGHTS	■
" SURFACE RIGHTS ONLY	◼
" MINING RIGHTS ONLY	◻
LICENCE OF OCCUPATION	▼
CROWN LAND SALE	C.S.
ORDER-IN-COUNCIL	OC
RESERVATION	⊙
CANCELLED	⊗
SAND & GRAVEL	⊕

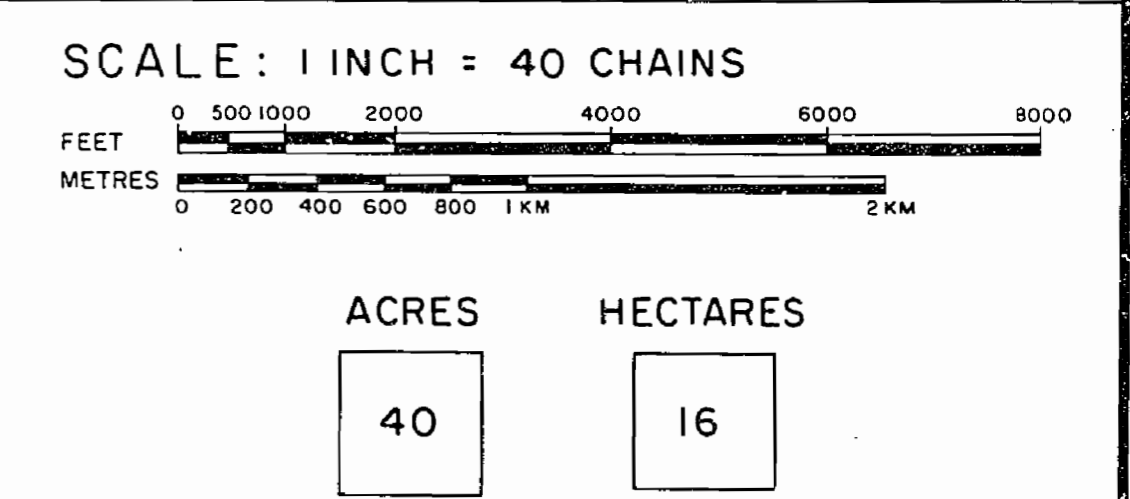

TOWNSHIP
SMILSKY
 (TP. 28 R. 14)
 DISTRICT
ALGOMA
 MINING DIVISION
SAULT STE. MARIE

ONTARIO
 MINISTRY OF NATURAL RESOURCES
 SURVEYS AND MAPPING BRANCH

DATE Jan '73 PLAN No. **M. 1529**
 WHITNEY BLOCK QUEEN'S PARK, TORONTO

G. 3128

REFERENCES

AREAS WITHDRAWN FROM DISPOSITION

- M.R.O. - MINING RIGHTS ONLY
- S.R.O. - SURFACE RIGHTS ONLY
- M.+S. - MINING AND SURFACE RIGHTS

Description	Order No.	Date	Disposition	File
SEC 26/80	W 1/83	2/8/83	M & S	

PEEVER TWP.

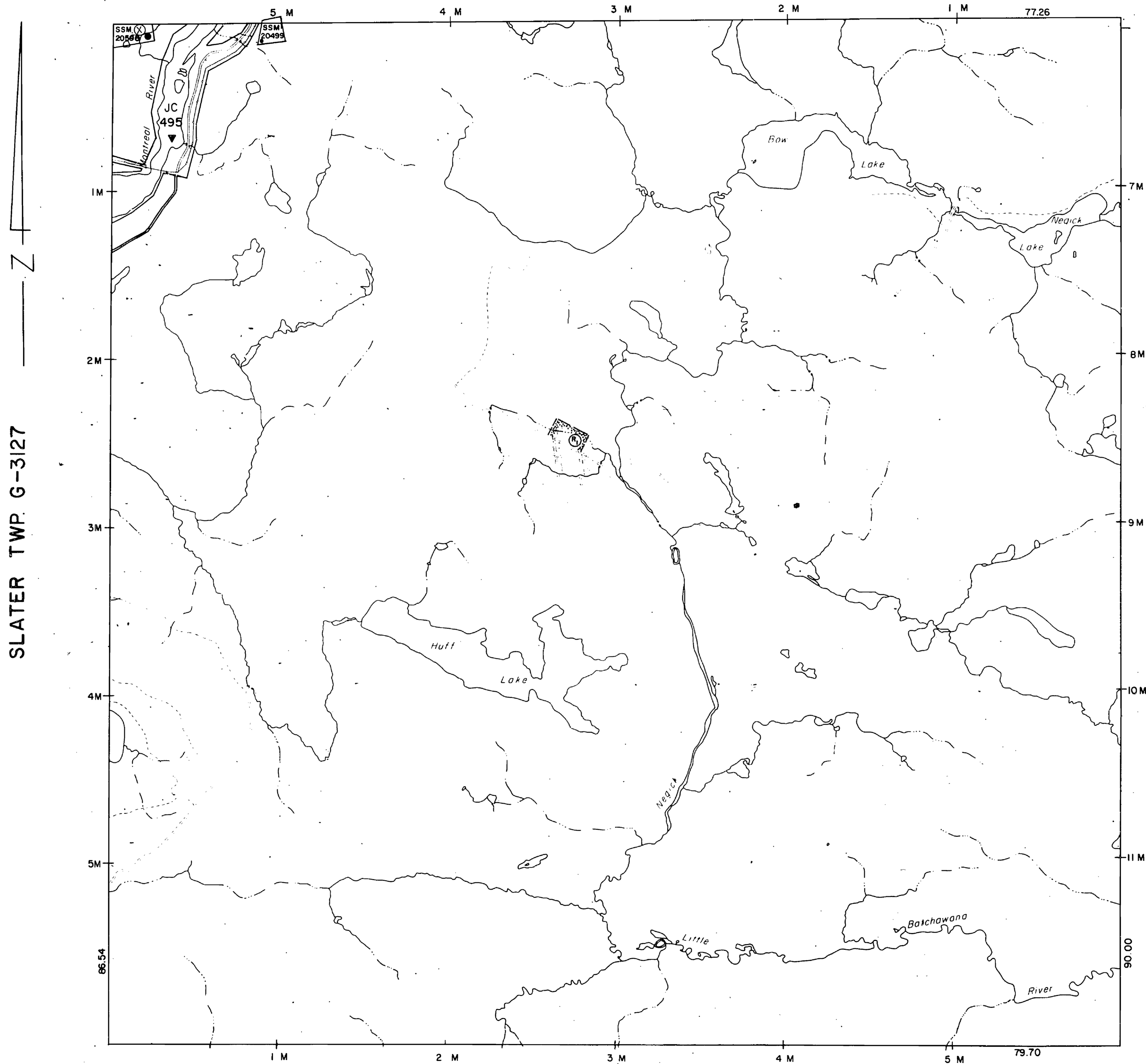

SLATER TWP. G-3127

TOLMONEN TWP.

NICOLET TWP. G-3119

LEGEND

- HIGHWAY AND ROUTE No.
- OTHER ROADS
- TRAILS
- SURVEYED LINES:
 - TOWNSHIPS, BASE LINES, ETC.
 - LOTS, MINING CLAIMS, PARCELS, ETC.
- UNSURVEYED LINES:
 - LOT LINES
 - PARCEL BOUNDARY
 - MINING CLAIMS ETC.
- RAILWAY AND RIGHT OF WAY
- UTILITY LINES
- NON-PERENNIAL STREAM
- FLOODING OR FLOODING RIGHTS
- SUBDIVISION OR COMPOSITE PLAN
- RESERVATIONS
- ORIGINAL SHORELINE
- MARSH OR MUSKEG
- MINES
- TRAVERSE MONUMENT

DISPOSITION OF CROWN LANDS

TYPE OF DOCUMENT	SYMBOL
PATENT, SURFACE & MINING RIGHTS	●
" SURFACE RIGHTS ONLY	○
" MINING RIGHTS ONLY	◐
LEASE, SURFACE & MINING RIGHTS	■
" SURFACE RIGHTS ONLY	□
" MINING RIGHTS ONLY	◻
LICENCE OF OCCUPATION	◌
ORDER-IN-COUNCIL	OC
RESERVATION	⊙
CANCELLED	⊖
SAND & GRAVEL	⊙

NOTE: MINING RIGHTS IN PARCELS PATENTED PRIOR TO MAY 6, 1913, VESTED IN ORIGINAL PATENTEE BY THE PUBLIC LANDS ACT, R.S.O. 1970, CHAP. 380, SEC. 63, SUBSEC. 1.

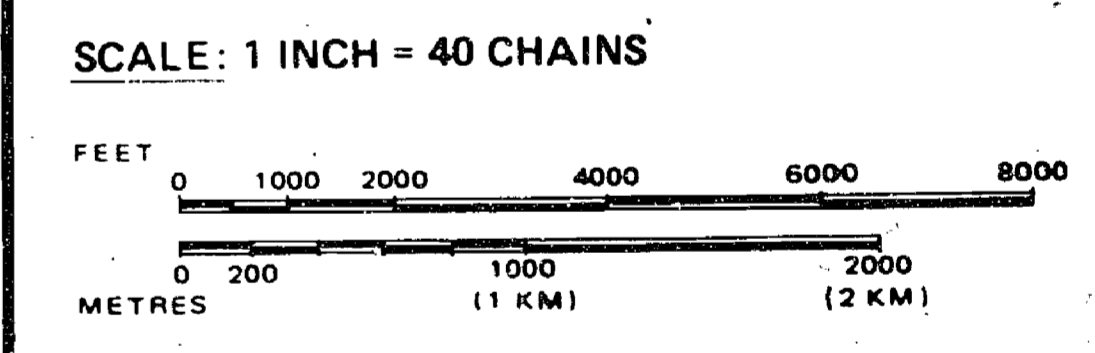

TOWNSHIP
SMILSKY
 M.N.R. ADMINISTRATIVE DISTRICT
SAULT STE MARIE
 MINING DIVISION
SAULT STE MARIE
 LAND TITLES / REGISTRY DIVISION
ALGOMA

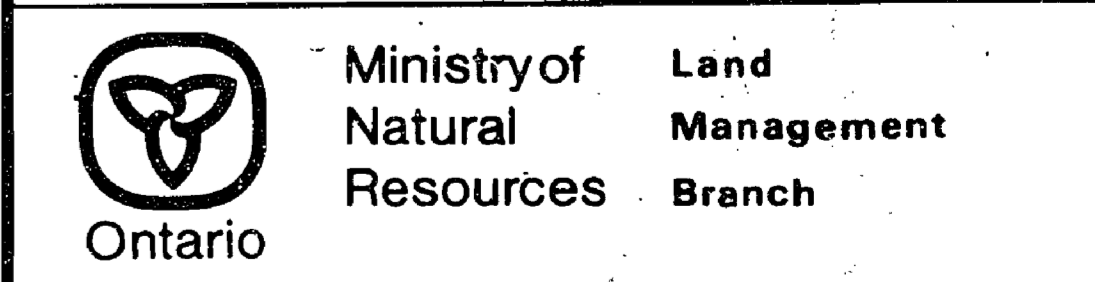

Date MAY, 1984
 Number **G-3128**

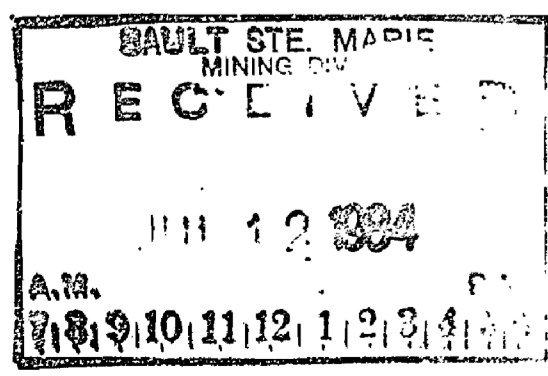

replaced by new map Dec. 1/89

INDEX TO LAND DISPOSITION

PLAN
G-3128
TOWNSHIP
SMILSKY

M.N.R. ADMINISTRATIVE DISTRICT
SAULT STE MARIE
MINING DIVISION
SAULT STE MARIE
LAND TITLES/REGISTRY DIVISION
ALGOMA

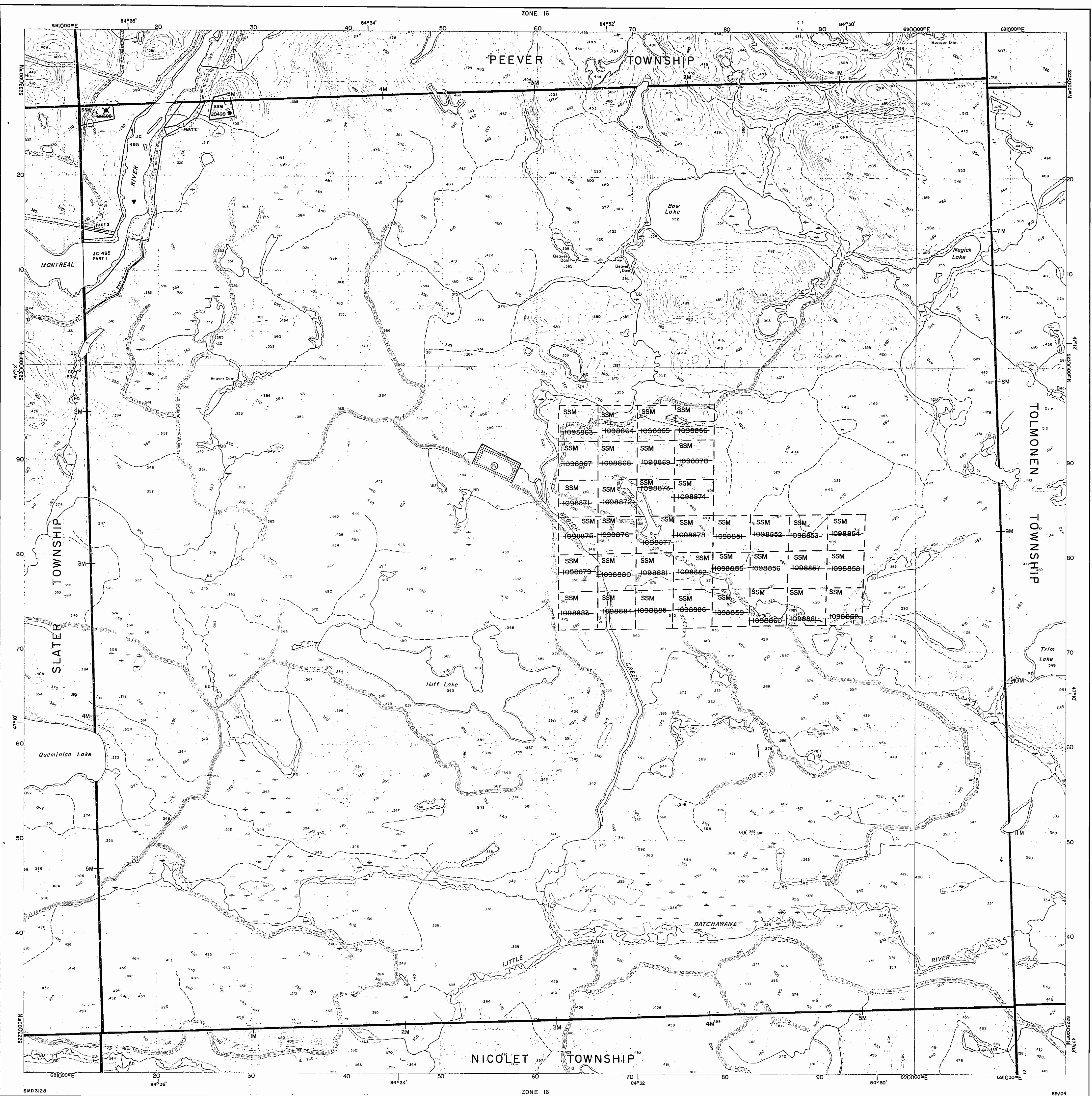
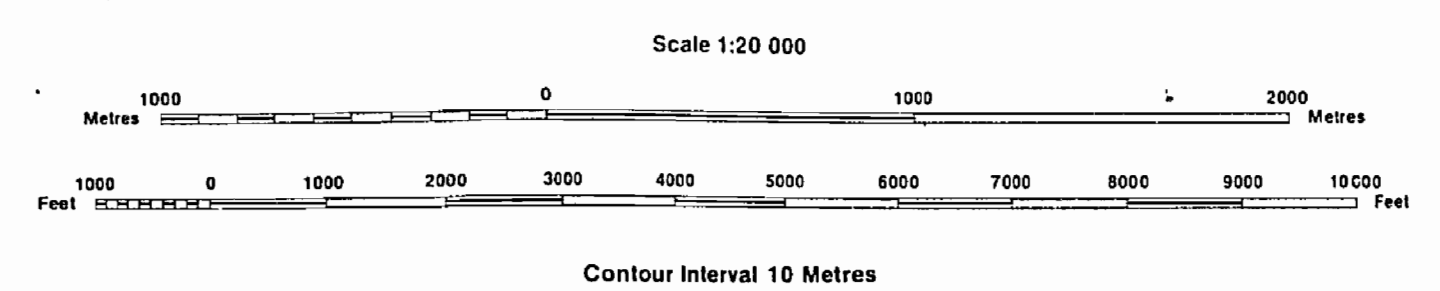

AREAS WITHDRAWN FROM DISPOSITION

- MRO - Mining Rights Only
- SRO - Surface Rights Only
- M+S - Mining and Surface Rights

Description	Order No.	Date	Disposition	File
SEC. 36/80	W-4/83	2/8/83	M.S.S.	

SYMBOLS

- Boundary
 - Township, Meridian, Baseline
- Road allowance; surveyed
 - shoreline
- Lot/Concession; surveyed
 - unsurveyed
- Parcel; surveyed
 - unsurveyed
- Right-of-way; road
 - railway
 - utility
- Reservation
- Cliff, Pit, Pile
- Contour
 - Interpolated
 - Approximate
 - Depression
- Control point (horizontal)
- Flooded land
- Mine head frame
- Pipeline (above ground)
- Railway; single track
 - double track
 - abandoned
- Road; highway, county, township
 - access
 - trail, bush
- Shoreline (original)
- Transmission line
- Wooded area

The 1980 Magnetic Bearing
Approximate Annual Change
Increasing 1.00

DISPOSITION OF CROWN LANDS

- Patent
 - Surface & Mining Rights
 - Surface Rights Only
 - Mining Rights Only
- Lease
 - Surface & Mining Rights
 - Surface Rights Only
 - Mining Rights Only
- Licence of Occupation
- Order-in-Council
- Cancelled
- Reservation
- Sand & Gravel

THE INFORMATION THAT APPEARS ON THIS MAP HAS BEEN COMPILED FROM VARIOUS SOURCES, AND ACCURACY IS NOT GUARANTEED. THOSE WISHING TO STAKE MINING CLAIMS SHOULD CONSULT WITH THE MINING RECORDER, MINISTRY OF NORTHERN DEVELOPMENT AND MINES, FOR ADDITIONAL INFORMATION ON THE STATUS OF THE LANDS SHOWN HEREON.

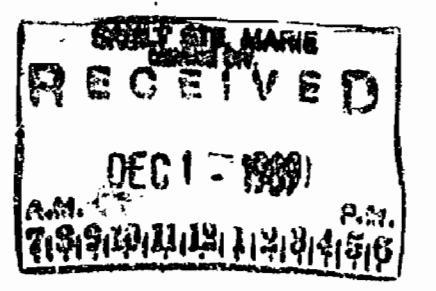

Map base and land disposition drafting by Surveys and Mapping Branch, Ministry of Natural Resources.

The disposition of land, location of lot fabric and parcel boundaries on this index was compiled for administrative purposes only.

INDEX TO LAND DISPOSITION

PLAN
 G-3128
 TOWNSHIP

M.N.R. ADMINISTRATIVE DISTRICT
SAULT STE MARIE
 MINING DIVISION
SAULT STE MARIE
 LAND TITLES/REGISTRY DIVISION
ALGOMA

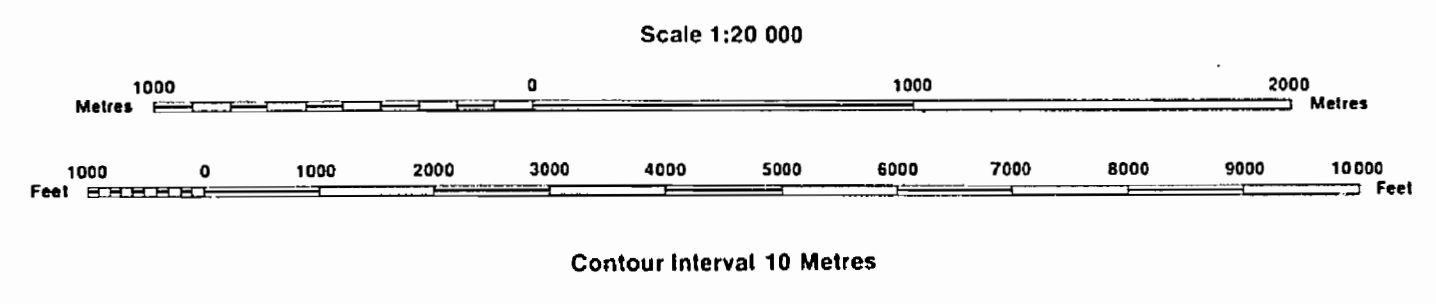

AREAS WITHDRAWN FROM DISPOSITION

- MRO - Mining Rights Only
- SRO - Surface Rights Only
- M + S - Mining and Surface Rights

Description	Order No.	Date	Disposition	File
SEC. 36/80		W. 4/83	2/8/83	M.B.S.

SYMBOLS

- Boundary
 - Township, Meridian, Baseline
 - Road allowance; surveyed
 - shoreline
 - Lot/Concession; surveyed
 - unsurveyed
 - Parcel; surveyed
 - unsurveyed
 - Right-of-way; road
 - railway
 - utility
- Reservation
- Cliff, Pit, Pile
- Contour
 - Interpolated
 - Approximate
 - Depression
- Control point (horizontal)
- Flooded land
- Mine head frame
- Pipeline (above ground)
- Railway; single track
- double track
- abandoned
- Road; highway, county, township
- access
- trail, bush
- Shoreline (original)
- Transmission line
- Wooded area

The 1980 Magnetic Bearing
 Approx. Annual Change
 Increasing

DISPOSITION OF CROWN LANDS

- Patent
 - Surface & Mining Rights
 - Surface Rights Only
 - Mining Rights Only
- Lease
 - Surface & Mining Rights
 - Surface Rights Only
 - Mining Rights Only
- Licence of Occupation
- Order-in-Council
- Cancelled
- Reservation
- Sand & Gravel

THE INFORMATION THAT
 APPEARS ON THIS MAP
 HAS BEEN COMPILED
 FROM VARIOUS SOURCES,
 AND ACCURACY IS NOT
 GUARANTEED. THOSE
 WISHING TO STAKE
 MINING CLAIMS SHOULD
 CONSULT WITH THE
 MINING RECORDER, MINISTRY OF
 NORTHERN DEVELOPMENT
 AND MINES, FOR ADDITIONAL
 INFORMATION ON THE STATUS OF
 THE LANDS SHOWN HEREON.

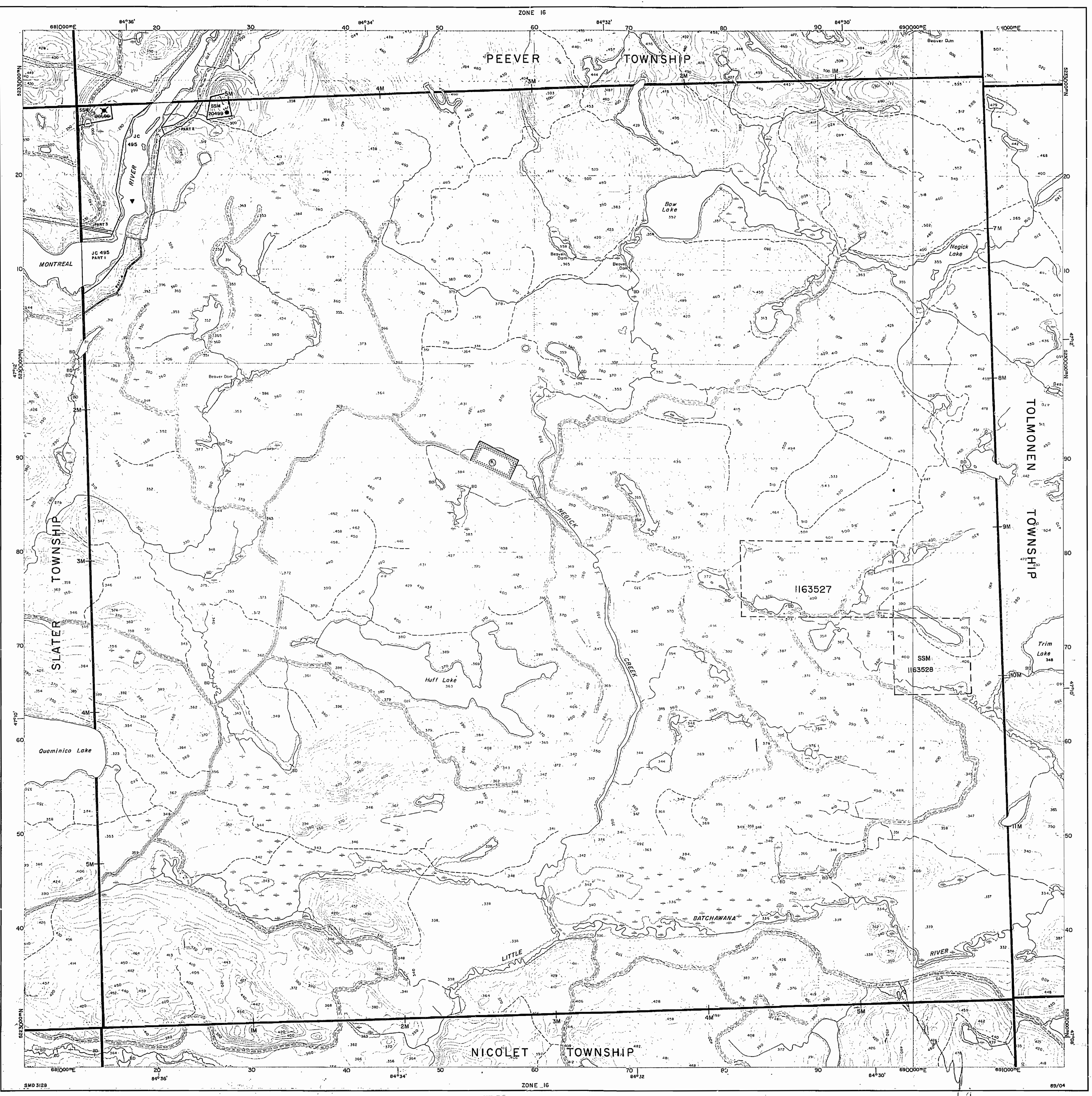
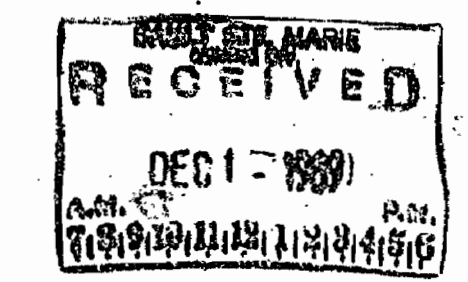

28-14

TWP 28 R. 14.

DISTRICT OF ALGOMA

(SMILSKY)

m. 1529

Scale - 40 Chains - 1 Inch

OFFICE MAP

NORTH AST.

TWP 28 R. 15.

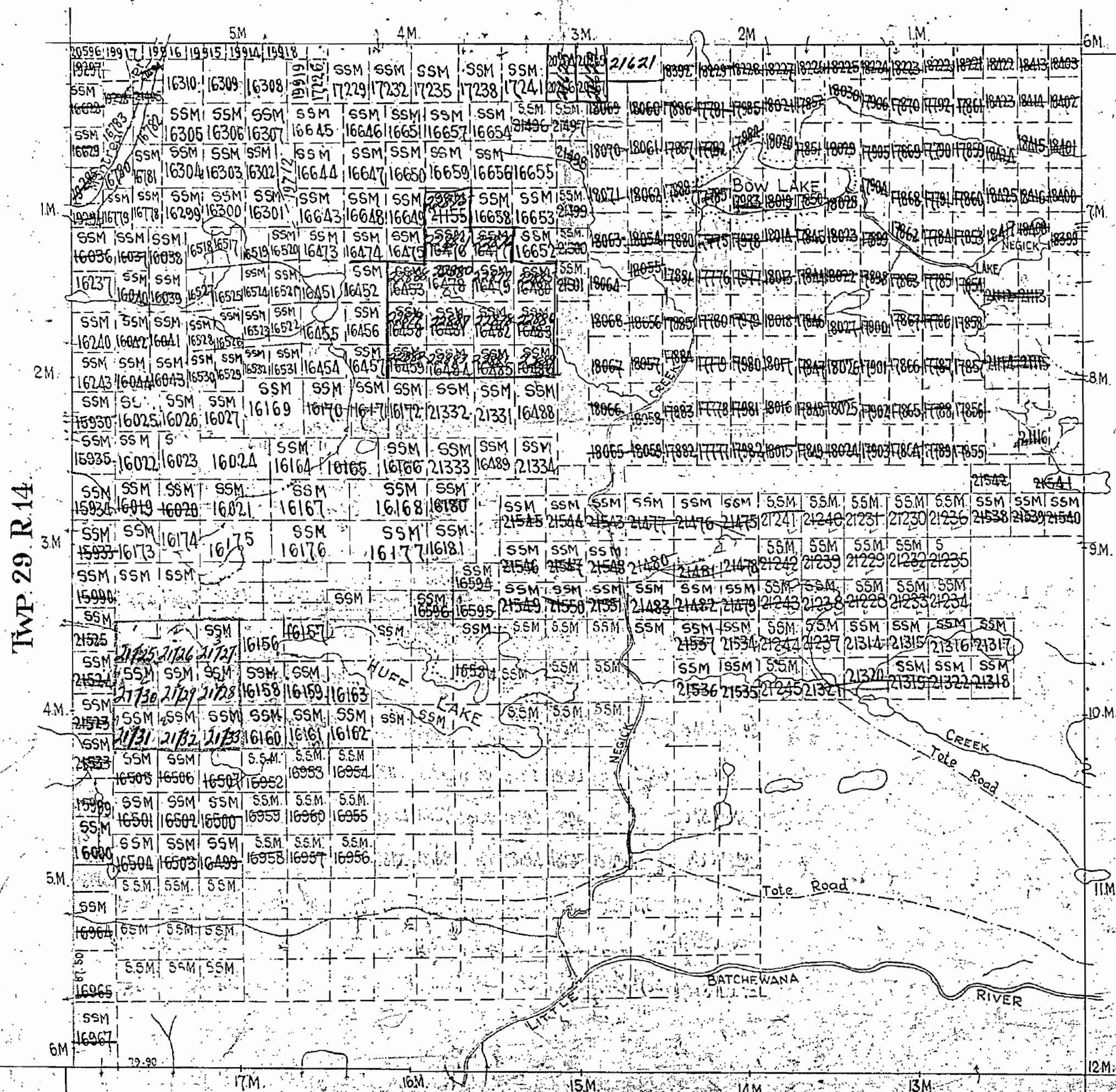

TWP 29 R. 14.

TWP 27 R. 14.

TWP 28 R. 13.

Surface reservations 200' wide by Dept. of L. & F. shown hereon thus

28-14

TWP 28 R.14.

DISTRICT OF ALGOMA

Scale: - 40 Chams - 1 Inch

(SMILSKY)
M. 1529

TWP 28 R.15.

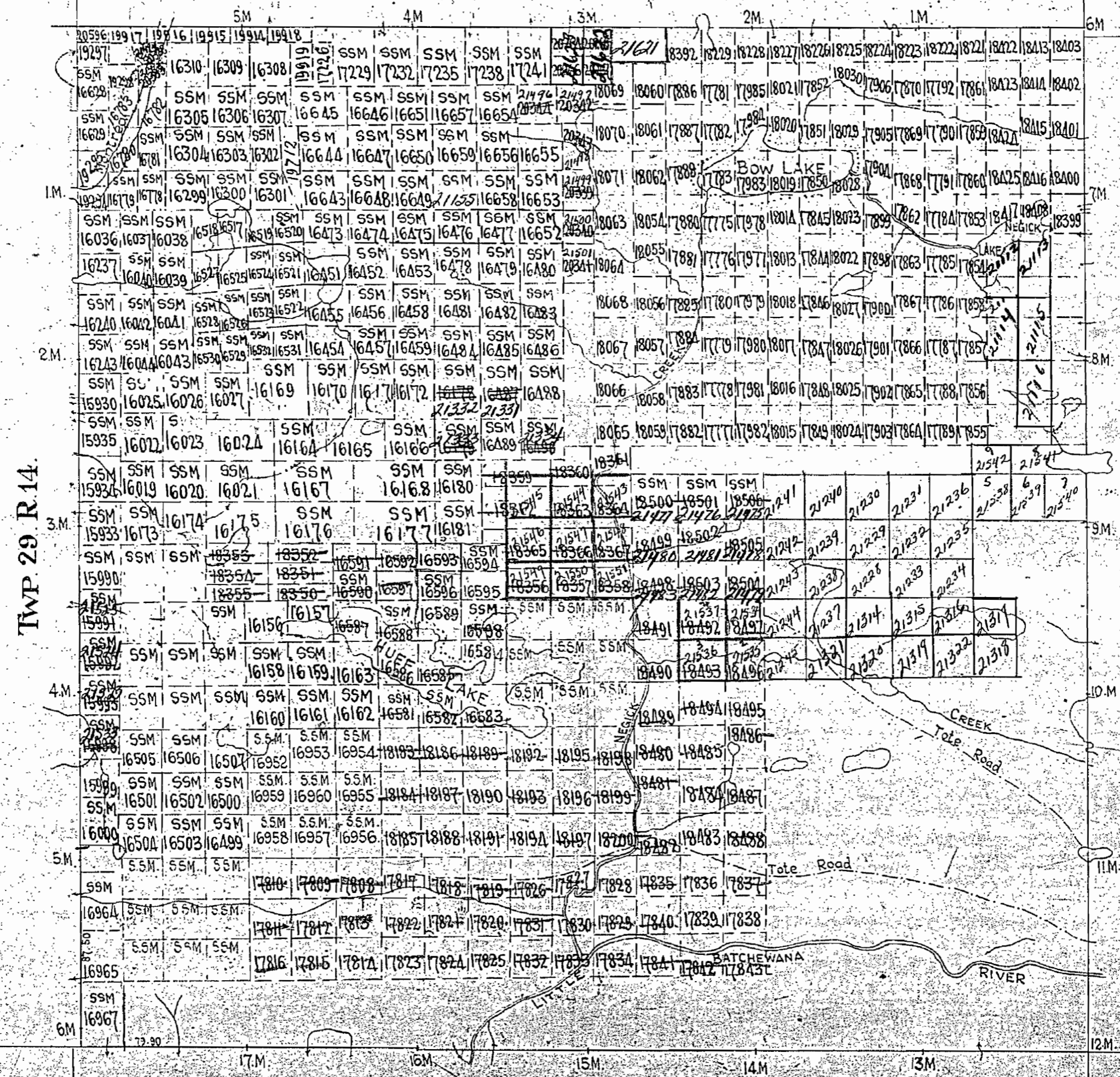

TWP 29 R.14.

TWP 27 R.14

TWP 28 R.13

Surface reservations 200' wide by Dept of L. & S. shown hereon thus

28-14

TWP 28 R.14.

DISTRICT OF ALGOMA

(SMILSKY)

Scale - 40 Chains - 1 Inch

M.1529

NORTH AST

TWP 28 R 15.

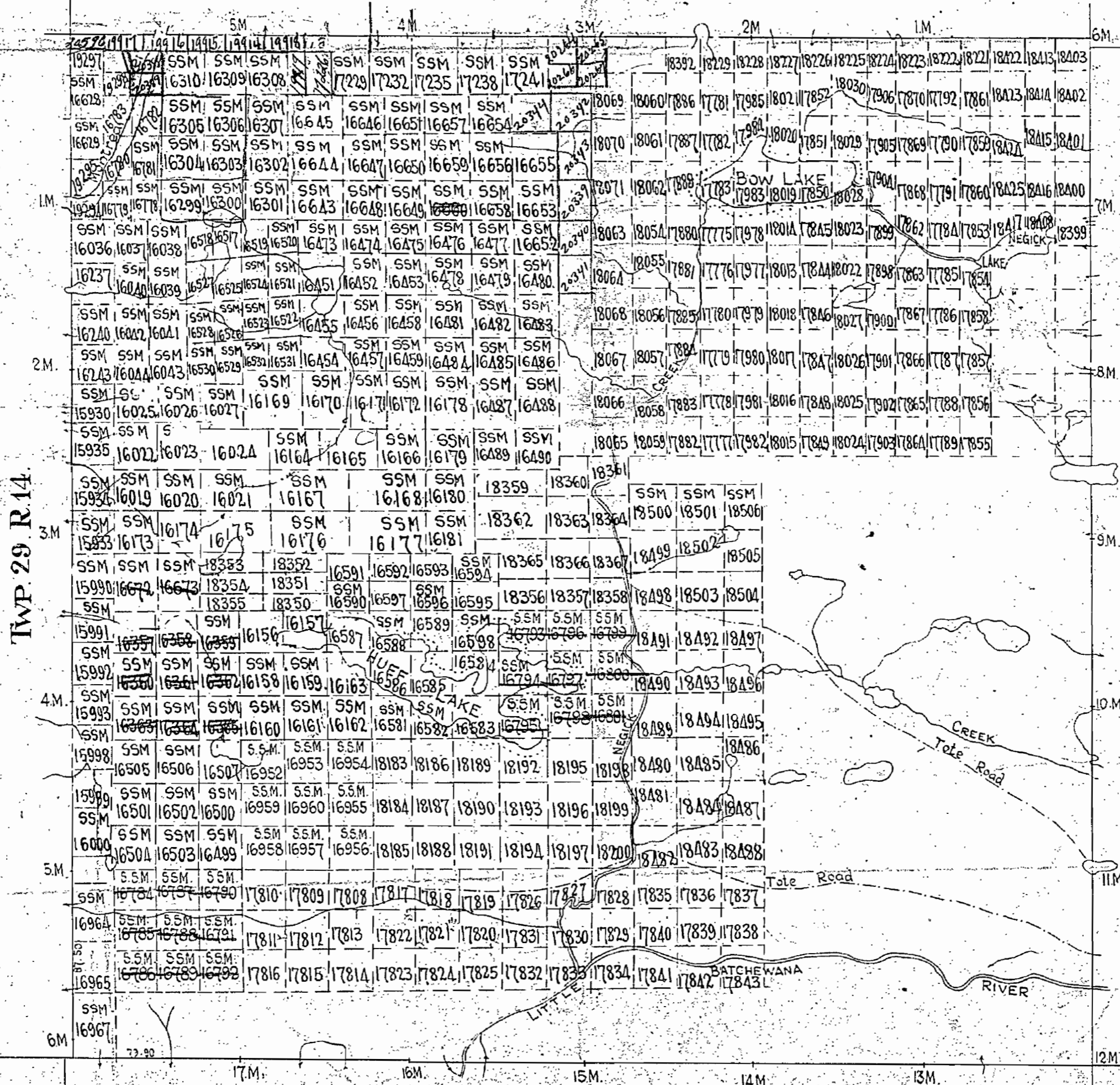

TWP 29 R.14.

TWP 27 R.14.

TWP 28 R 13

Surface reservations 200' wide by Dept. of L & F shown hereon thus

PLAN OF
TWP. 28. R.14. (SMILESKY)
SAULT STE. MARIE MINING DIVISION
DISTRICT OF ALGOMA

Scale, 20 chains to an inch.

M 1529



TWP. 28. R. 15.

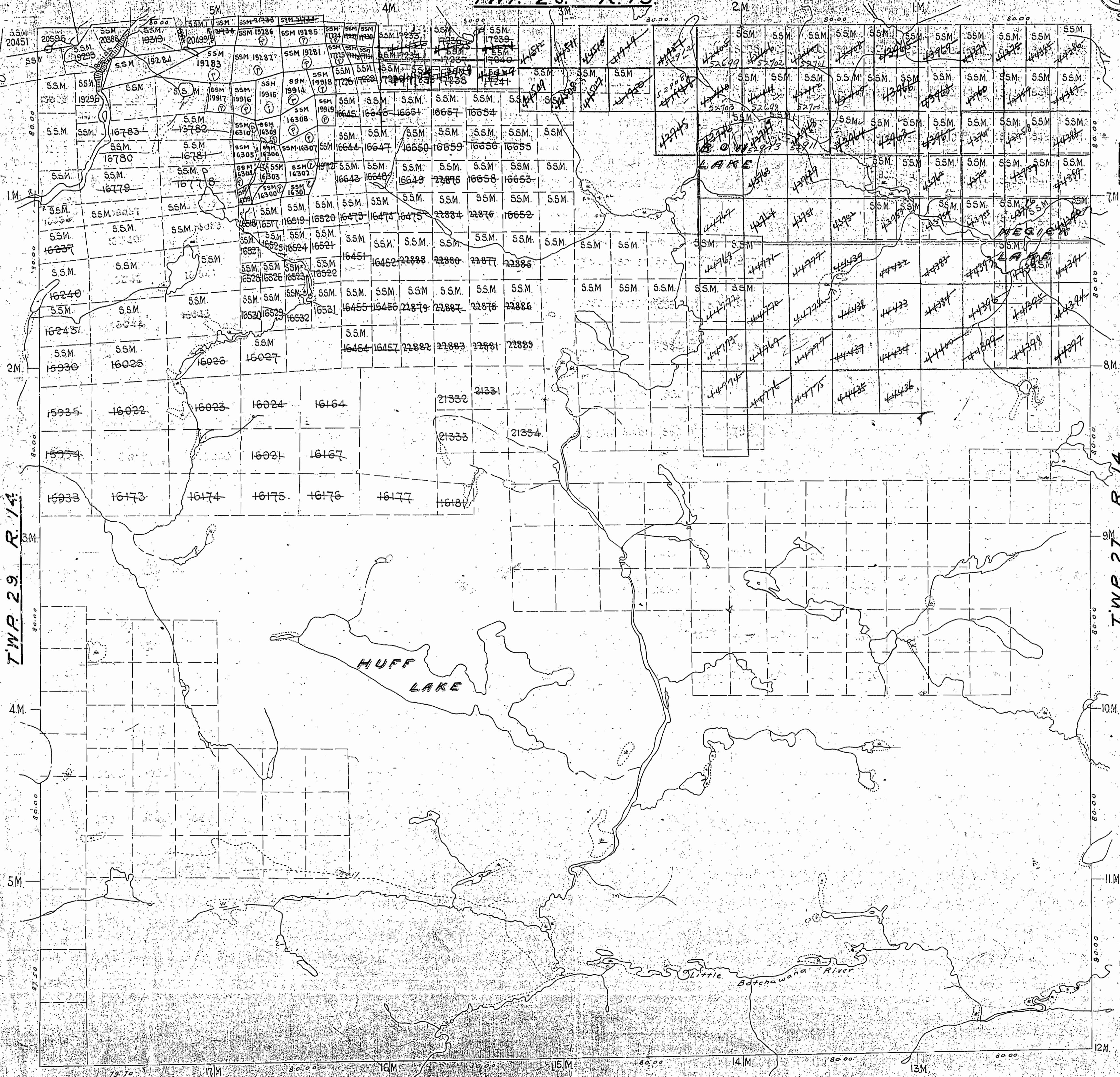

TWP. 29. R. 14.

TWP. 27. R. 14.

TWP. 28. R. 13.

28-14

TWP 28. R.14.

DISTRICT OF ALGOMA

(SMILSKY)

Scale - 40 Chains - 1 Inch

m. 1529

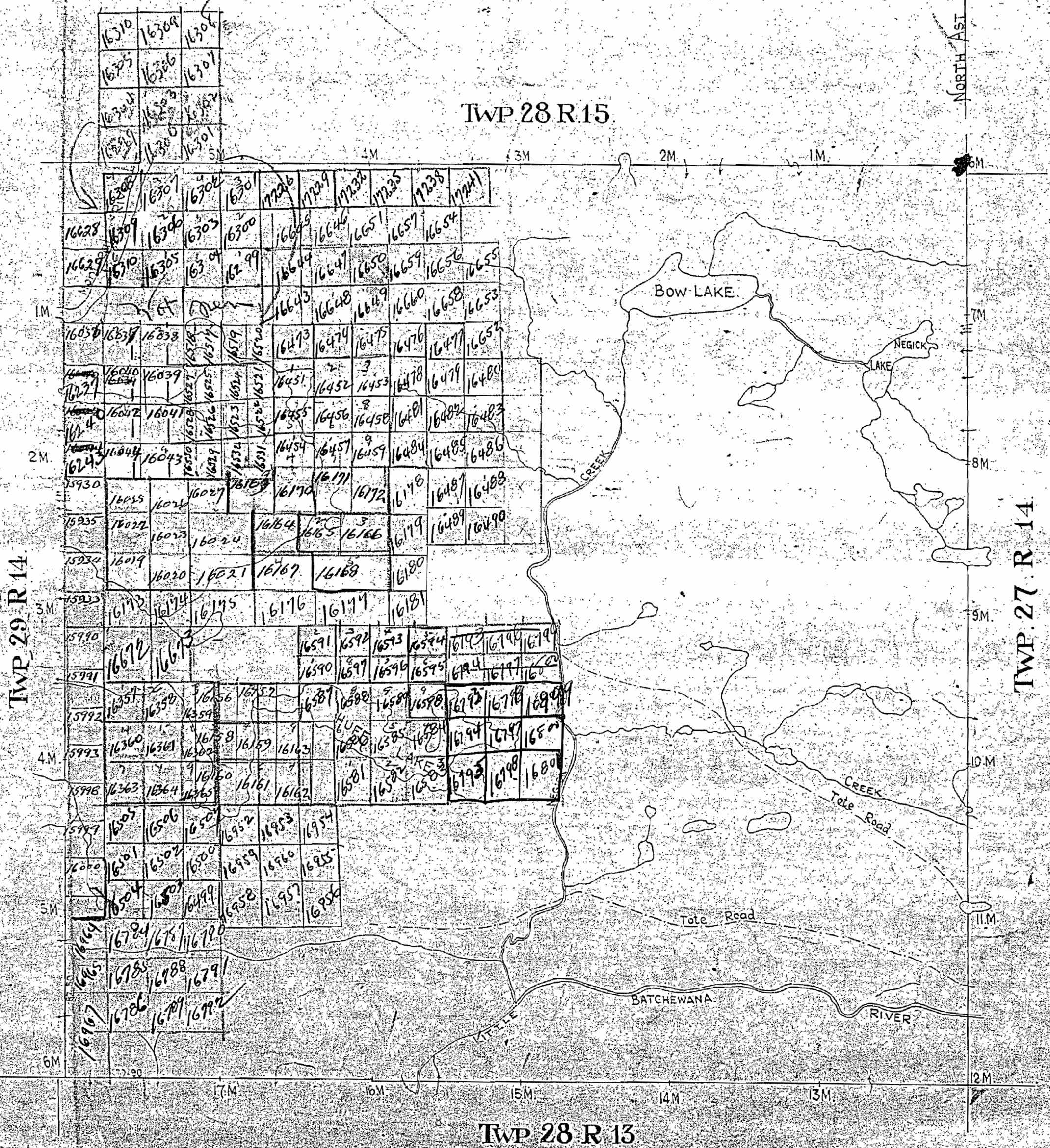

PLAN OF TWP. 28. R.14. (SMILSKY)

SAULT STE. MARIE MINING DIVISION.
DISTRICT OF ALGOMA.

Scale, 20 chains to an inch.

1915-29

TWP. 28. R.15.

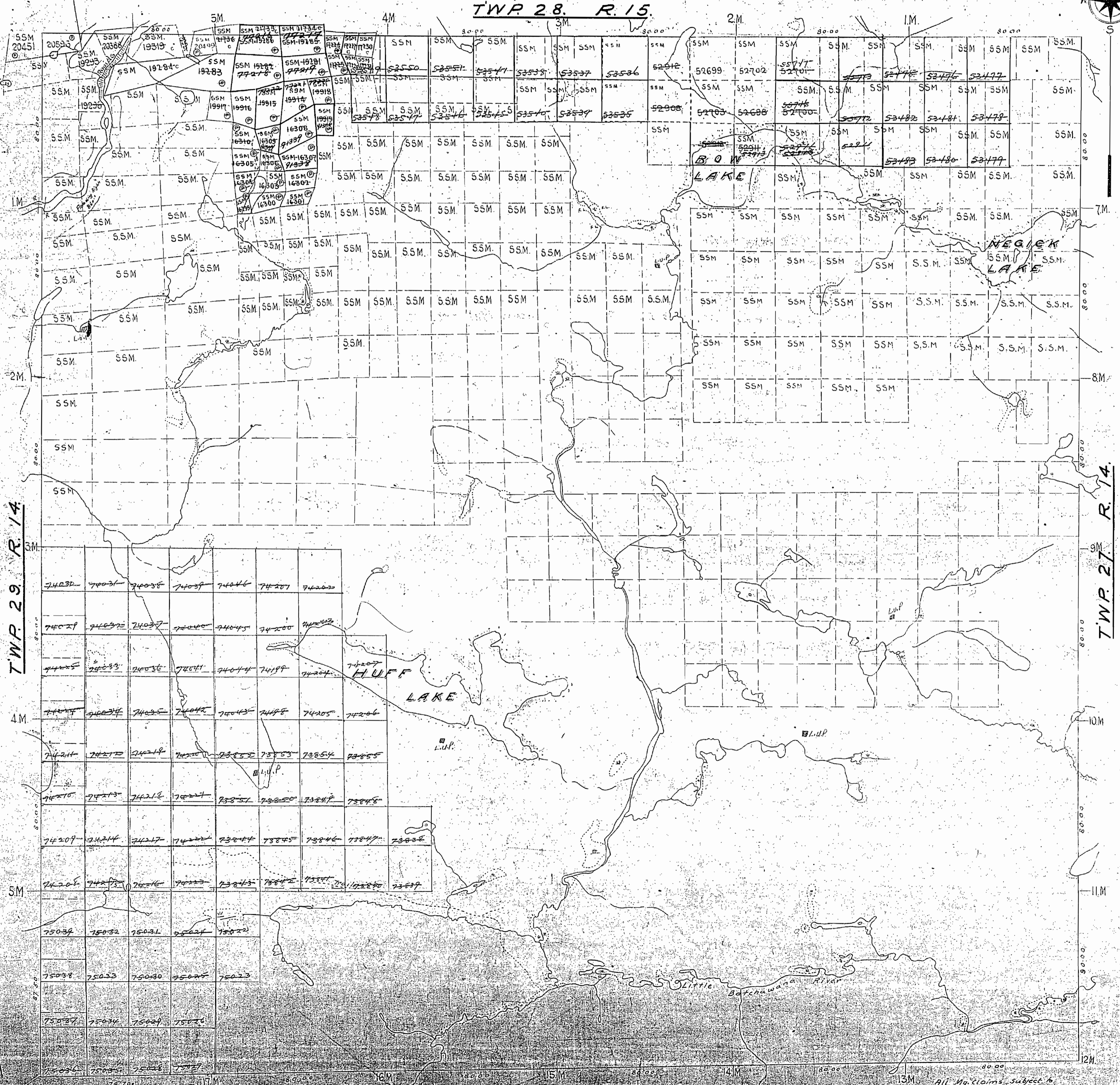

TWP. 28. R.13.

All My claims subject to
Flooded River to an elev. of 964 (Monong. Riv.)
1000 Record in Dept. of L.P. Spurn. Min.

TWP 28 R 14

DISTRICT OF ALGOMA

(SMILSKY)

Scale - 40 Chains - 1 Inch

M. 1529

TWP 28 R 15

NORTH AST

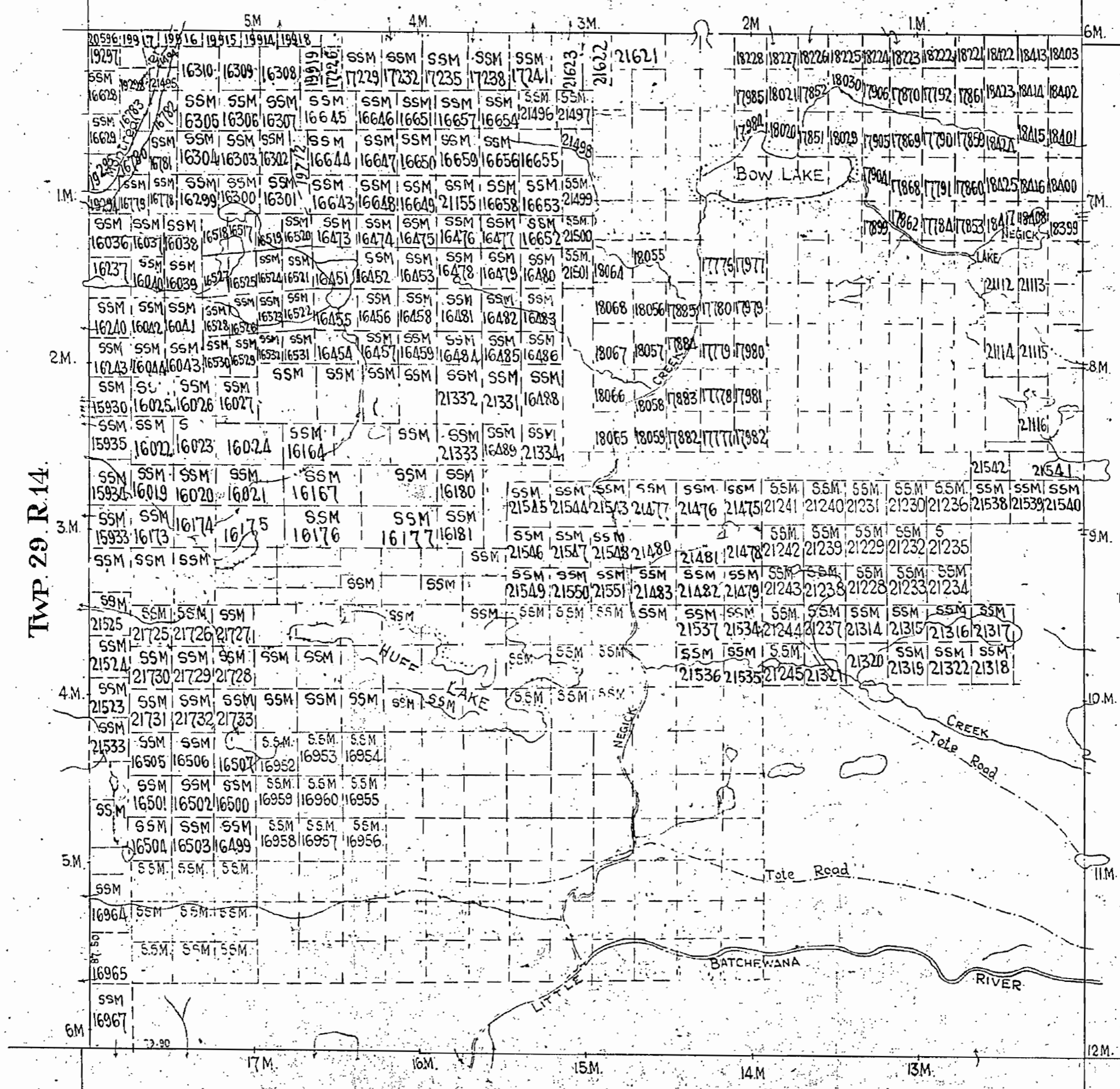

Surface reservations 200 wide by Dept. of L. & F. shown hereon thus

28-14

TWP 28 R. 14.

DISTRICT OF ALGOMA

(SMILSKY)

m. 1529

Scale - 40 Chains - 1 Inch

OFFICE MAP

TWP 28 R. 15

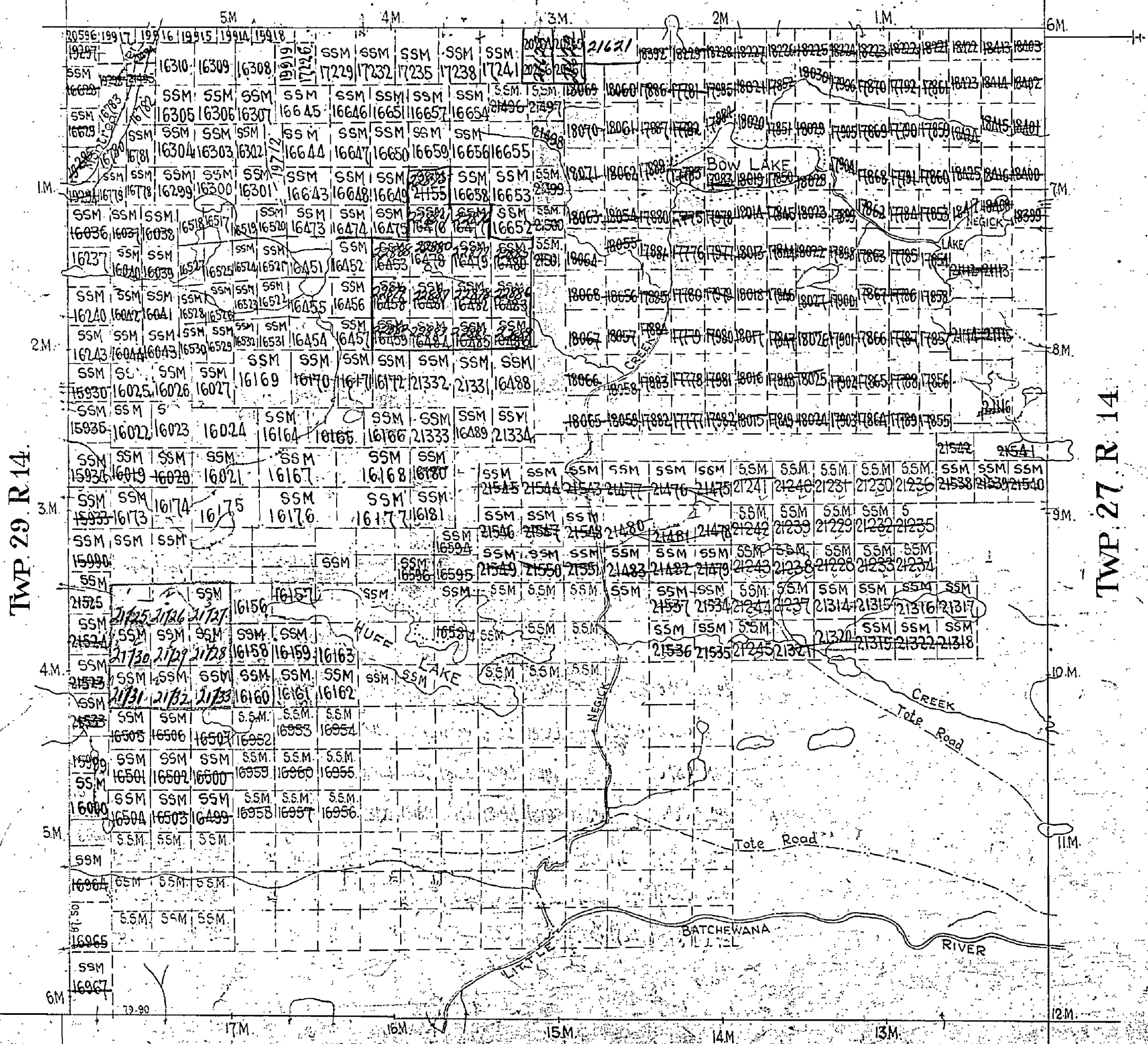

TWP 29 R. 14.

TWP 27 R. 14

TWP 28 R. 13

Surface reservations 200 wide by Dept. of L. & F. shown hereon thus

28-14

TWP 28 R.14.

(SMILSKY)

DISTRICT OF ALGOMA

M. 1529

Scale: 40 Chams - 1 Inch

NORTH AST

TWP 28 R.15.

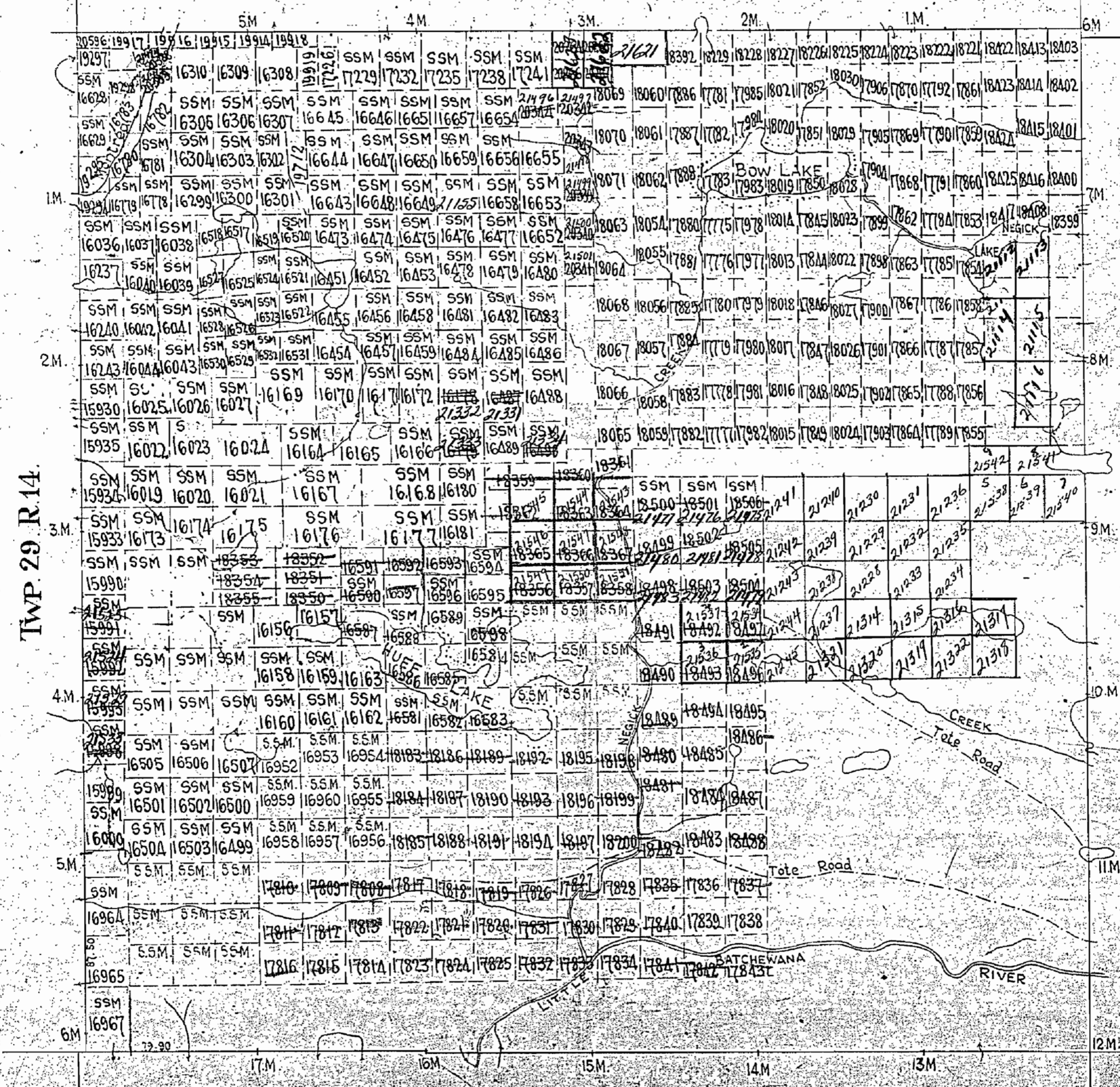

TWP 29 R.14.

TWP 27 R.14

TWP 28 R.15

Surface reservations 200 wide by Dept of L & F shown hereon thus.

28-14

TWP 28 R.14.

DISTRICT OF ALGOMA

(SMILSKY)

Scale - 40 Chains - 1 Inch

M. 1529

NORTH AST

TWP 28 R.15.

TWP 29 R.14.

TWP 27 R 14

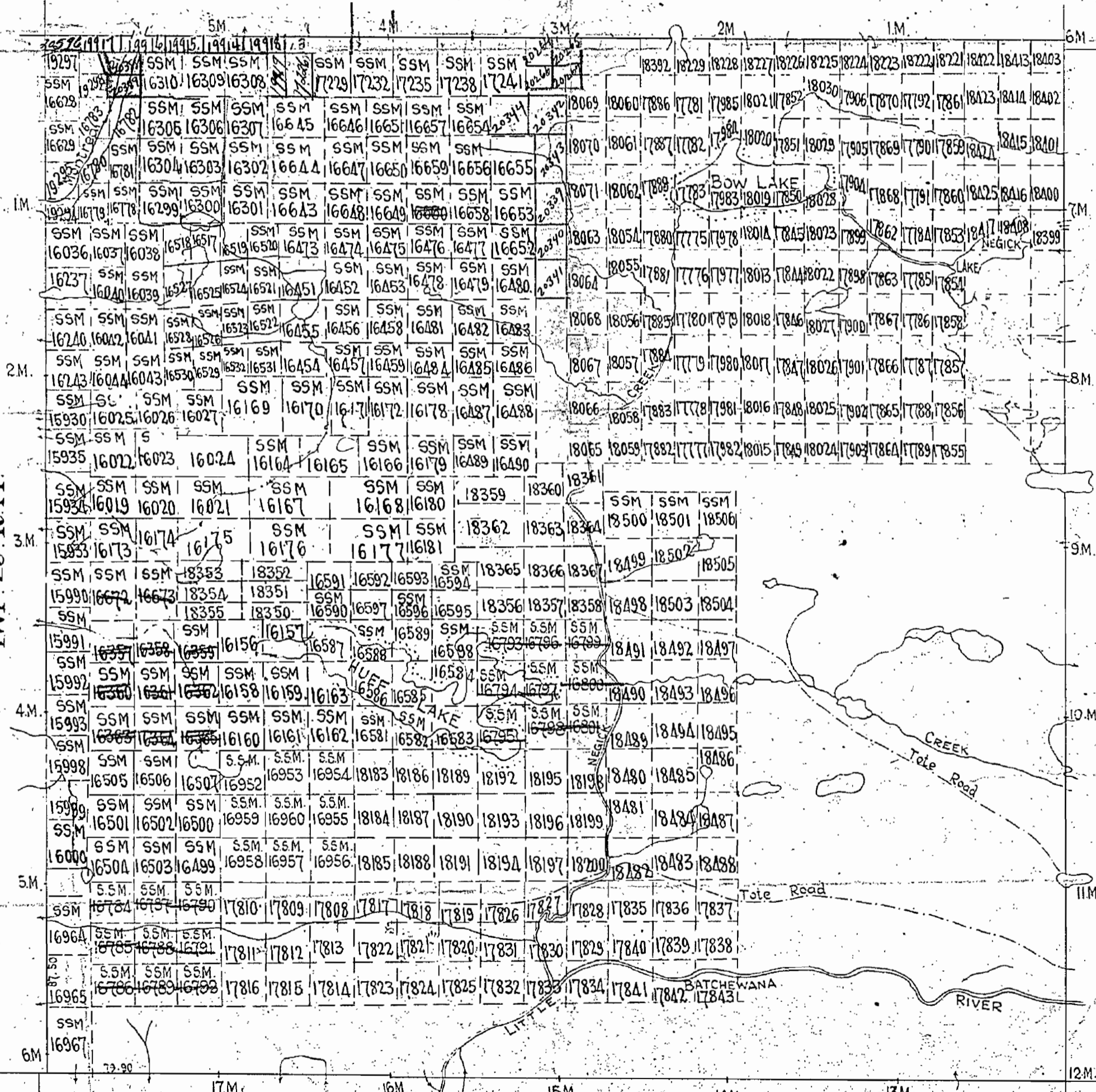

TWP 28 R 13

Surface reservations 200' wide by Dept. of L & F shown hereon thus

651 W
1529

PLAN OF TWP. 28. R.14. (SMILSKY)

SAULT STE. MARIE MINING DIVISION. DISTRICT OF ALGOMA.

Scale, 20 chains to an inch.

M. 1529

TWP 28. R. 15.

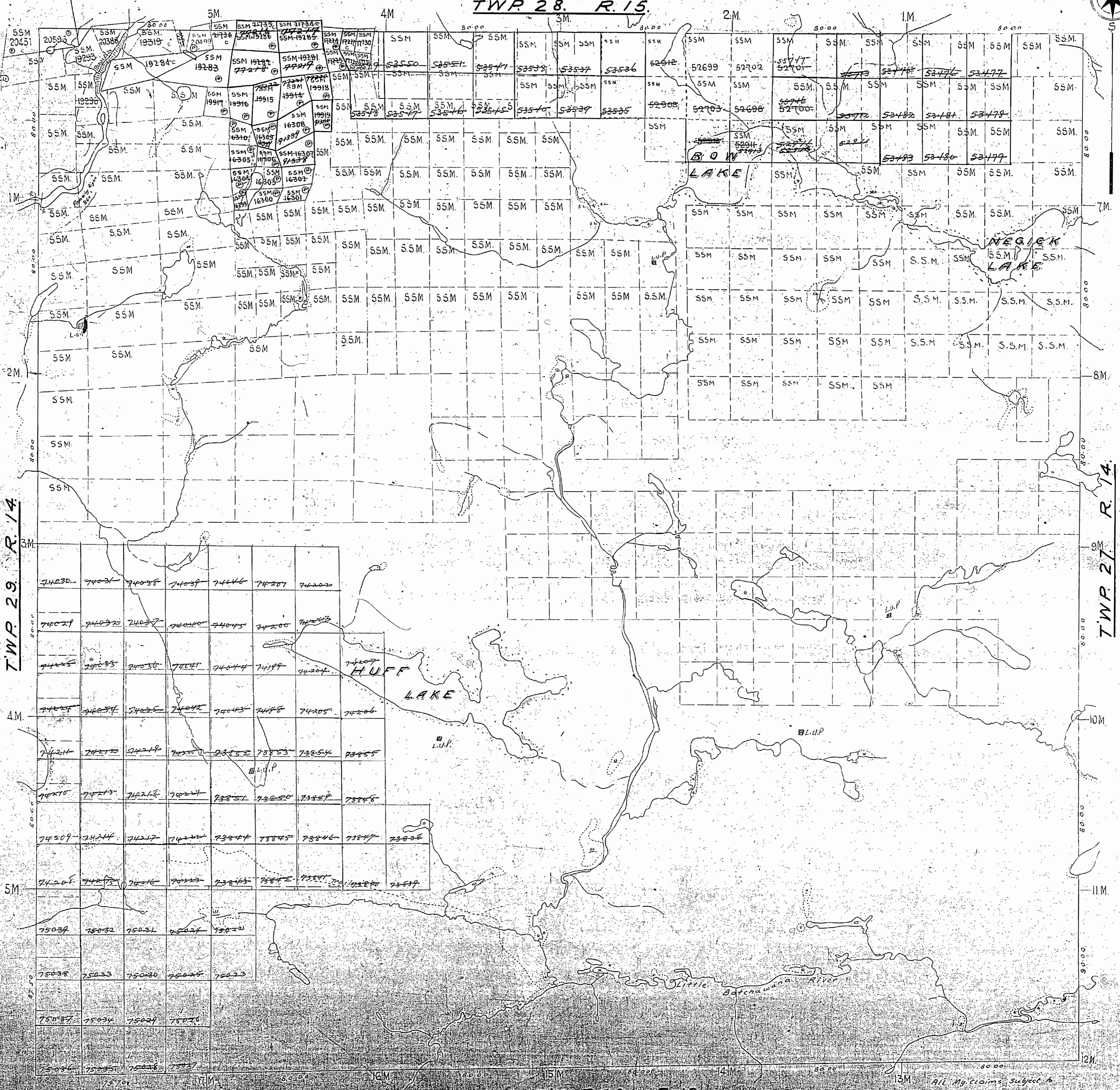

TWP 29. R. 14.

TWP 27. R. 14.

TWP 28. R. 13.

All Map Claims Subject to
Hooding Rights to an extent of 861 (Montreal Act)
100. Record of Dept. of L.S. open for

