

Partridge River Area - M.2949

AREA OF
**SOUTH OF
PARTRIDGE RIVER**

DISTRICT OF
COCHRANE

PORCUPINE
MINING DIVISION

SCALE: 1-INCH = 40 CHAINS

LEGEND

- PATENTED LAND Ⓟ
- CROWN LAND SALE C.S.
- LEASES Ⓛ
- LOCATED LAND Loc.
- LICENSE OF OCCUPATION L.O.
- MINING RIGHTS ONLY M.R.O.
- SURFACE RIGHTS ONLY S.R.O.
- ROADS — — — — —
- IMPROVED ROADS — — — — —
- KING'S HIGHWAYS — — — — —
- RAILWAYS — — — — —
- POWER LINES — — — — —
- MARSH OR MUSKEG ⊞
- MINES *
- CANCELLED C.

NOTES

400' Surface Rights Reservation around
around all lakes and rivers.

REPLACED AUG. 23/83

RECEIVED
OCT 20 1969
AM 7 8 9 10 11 12 1 2 3 4 5 6 PM

PLAN NO. **M.2951**

DEPARTMENT OF MINES
— ONTARIO —

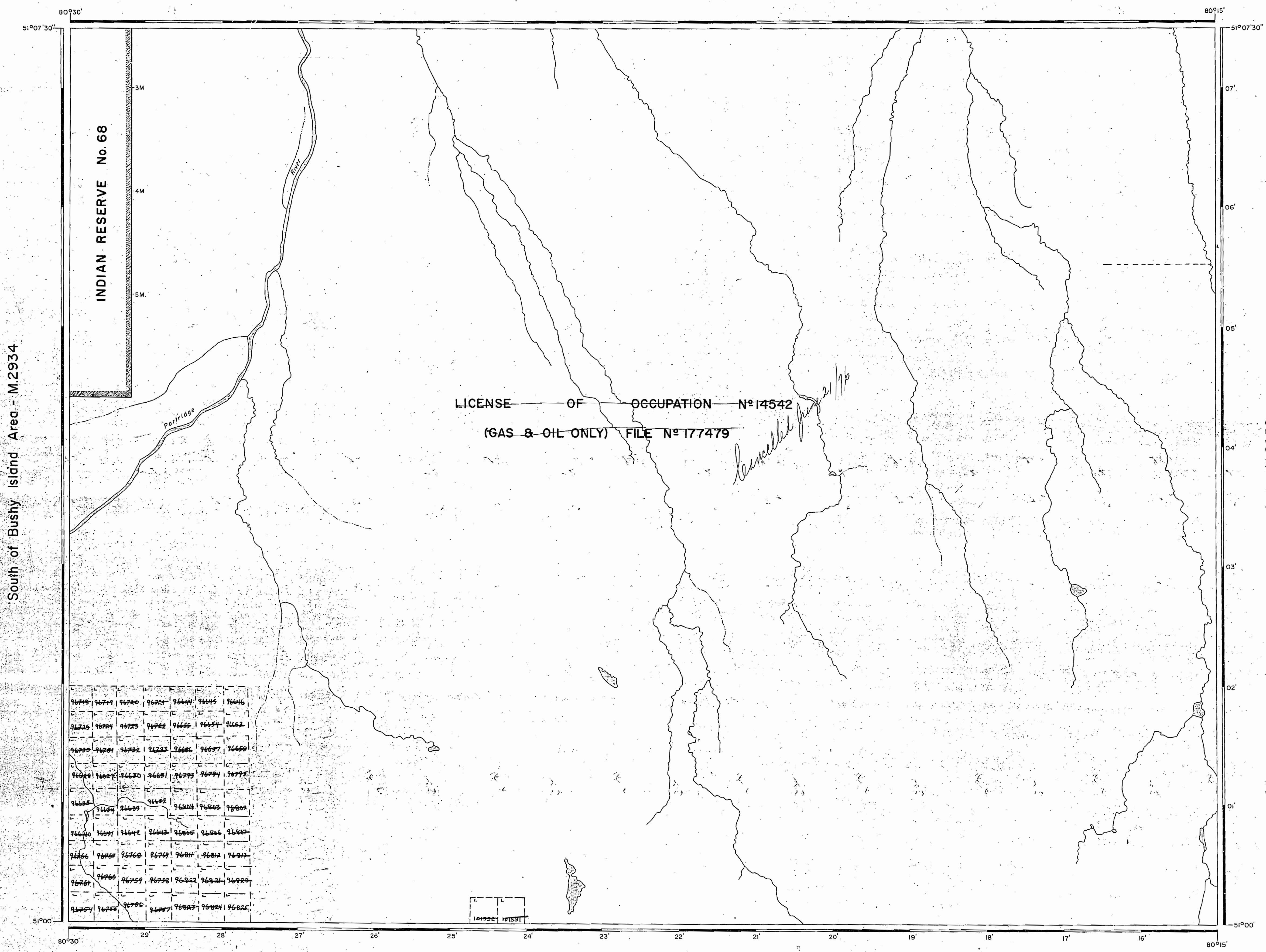

Area - M.2936

Area - M.2952

SOUTH OF PARTRIDGE RIVER

292

Partridge River Area - M.2949

South of Bushy Island Area - M.2934

Area - M.2952

Area - M.2936

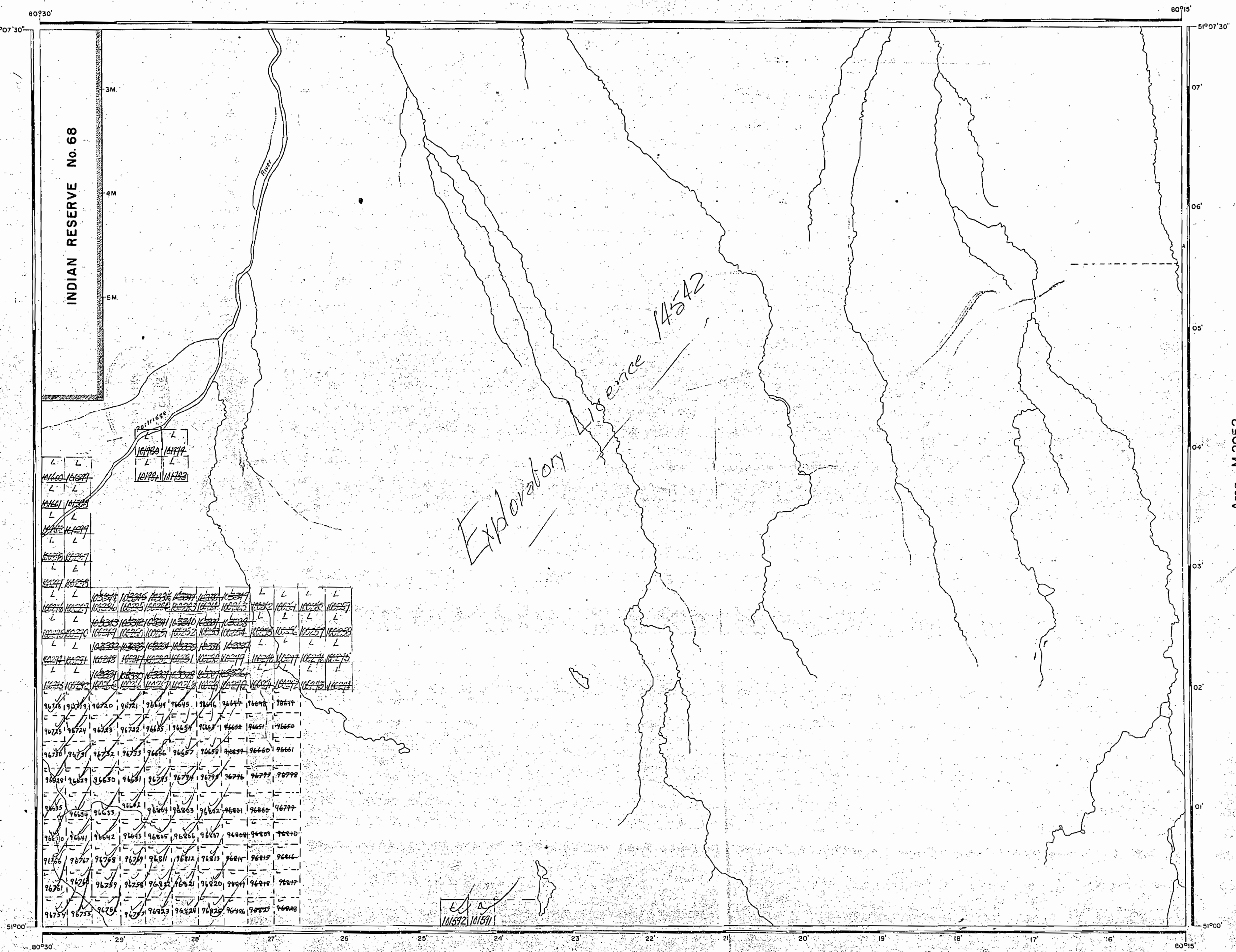

AREA OF
**SOUTH OF
 PARTRIDGE RIVER**

DISTRICT OF
 COCHRANE
Porcupine
 LARDE LAKE
 MINING DIVISION

SCALE: 1-INCH = 40' CHAINS

LEGEND

- PATENTED LAND (P)
- CROWN LAND SALE (C.S.)
- LEASES (L)
- LOCATED LAND (Loc.)
- LICENSE OF OCCUPATION (L.O.)
- MINING RIGHTS ONLY (M.R.O.)
- SURFACE RIGHTS ONLY (S.R.O.)
- ROADS
- IMPROVED ROADS
- KING'S HIGHWAYS
- RAILWAYS
- POWER LINES
- MARSH OR MUSKEG
- MINES
- CANCELLED (C)

NOTES

400' Surface Rights Reservation around
around all lakes and rivers.

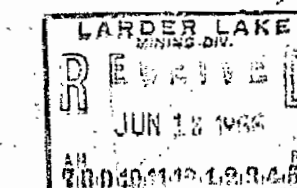

PLAN NO. **M.2951**

DEPARTMENT OF MINES
— ONTARIO —

Partridge River Area - M.2949

South of Bushy Island Area - M.2934

Area - M.2952

Area - M.2936

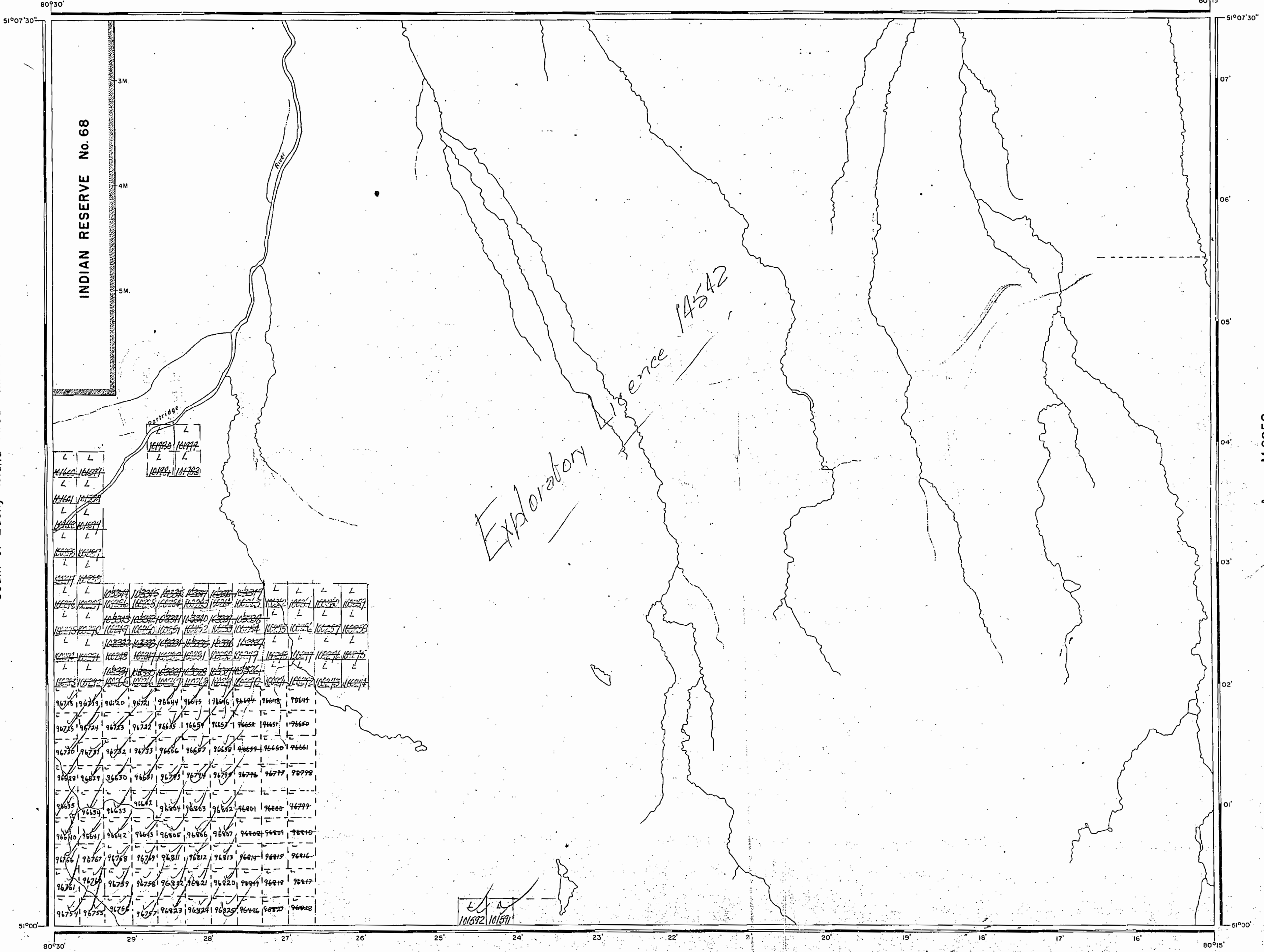

AREA OF
SOUTH OF PARTRIDGE RIVER

DISTRICT OF COCHRANE
Porcupine
 LARDER LAKE
 MINING DIVISION

SCALE: 1-INCH = 40 CHAINS

LEGEND

- PATENTED LAND Ⓟ
- CROWN LAND SALE C.S.
- LEASES Ⓛ
- LOCATED LAND Loc.
- LICENSE OF OCCUPATION L.O.
- MINING RIGHTS ONLY M.R.O.
- SURFACE RIGHTS ONLY S.R.O.
- ROADS —
- IMPROVED ROADS —
- KING'S HIGHWAYS —
- RAILWAYS —
- POWER LINES —
- MARSH OR MUSKEG —
- MINES Ⓜ
- CANCELLED C.

NOTES

400' Surface Rights Reservation around
 around all lakes and rivers.

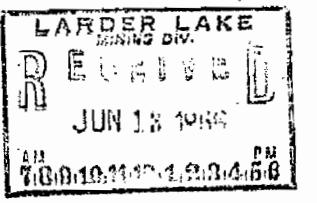

PLAN NO. **M.2951**

DEPARTMENT OF MINES
 — ONTARIO —

Partridge River Area - G-1556

REFERENCES

AREAS WITHDRAWN FROM DISPOSITION

M.R.O. - MINING RIGHTS ONLY
 S.R.O. - SURFACE RIGHTS ONLY
 M.+S. - MINING AND SURFACE RIGHTS

Description	Order No.	Date	Disposition	File
RECEIVED AUG. 23 1983				

RECEIVED AUG. 23 1983

LEGEND

HIGHWAY AND ROUTE No.	
OTHER ROADS	
TRAILS	
SURVEYED LINES:	
TOWNSHIPS, BASE LINES, ETC.	
LOTS, MINING CLAIMS, PARCELS, ETC.	
UNSURVEYED LINES:	
LOT LINES	
PARCEL BOUNDARY	
MINING CLAIMS ETC.	
RAILWAY AND RIGHT OF WAY	
UTILITY LINES	
NON-PERENNIAL STREAM	
FLOODING OR FLOODING RIGHTS	
SUBDIVISION OR COMPOSITE PLAN	
RESERVATIONS	
ORIGINAL SHORELINE	
MARSH OR MUSKEG	
MINES	
TRAVERSE MONUMENT	

DISPOSITION OF CROWN LANDS

TYPE OF DOCUMENT	SYMBOL
PATENT, SURFACE & MINING RIGHTS	
" SURFACE RIGHTS ONLY	
" MINING RIGHTS ONLY	
LEASE, SURFACE & MINING RIGHTS	
" SURFACE RIGHTS ONLY	
" MINING RIGHTS ONLY	
LICENCE OF OCCUPATION	
ORDER-IN-COUNCIL	
RESERVATION	
CANCELLED	
SAND & GRAVEL	

NOTE: MINING RIGHTS IN PARCELS PATENTED PRIOR TO MAY 6, 1913, VESTED IN ORIGINAL PATENTEES BY THE PUBLIC LANDS ACT, R.S.O. 1970, CHAP. 380, SEC. 43, SUBSEC. 1.

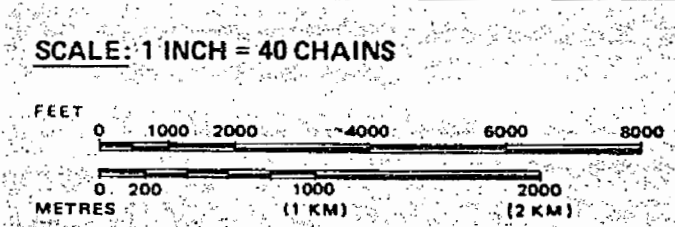

TOWNSHIP

AREA
SOUTH OF PARTRIDGE RIVER
 M.N.R. ADMINISTRATIVE DISTRICT
MOOSONEE
 MINING DIVISION
PORCUPINE
 LAND TITLES / REGISTRY DIVISION
COCHRANE

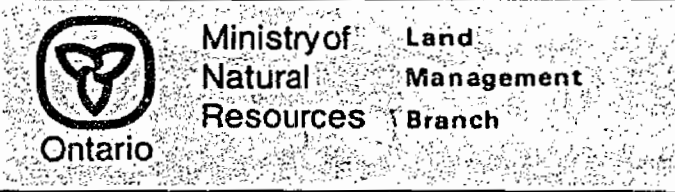

Date: NOVEMBER, 1982
 Number: **G-1584**

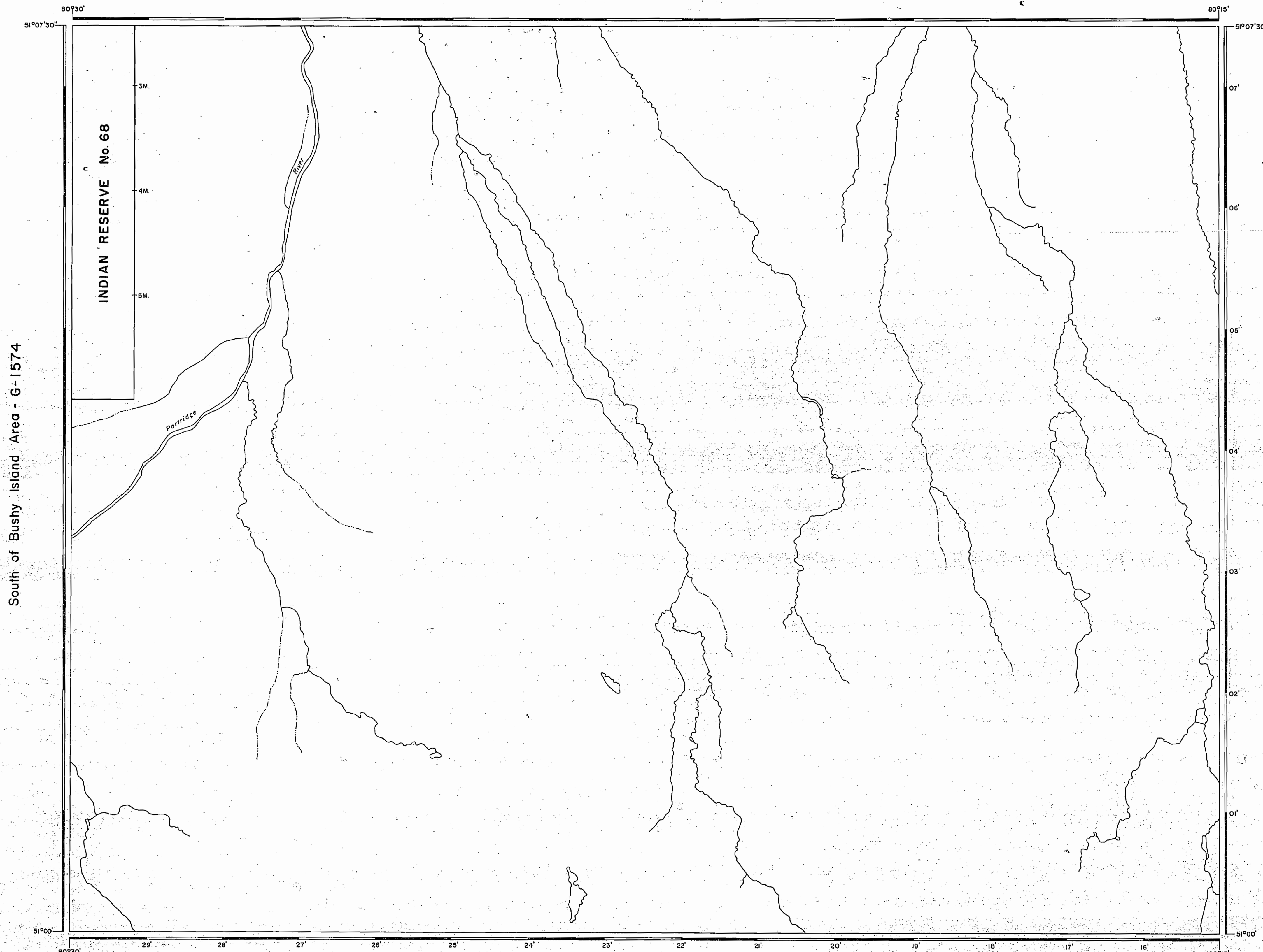

South of Bushy Island Area - G-1574

Area - G-1601

Area - G-1490