

Barber Twp.

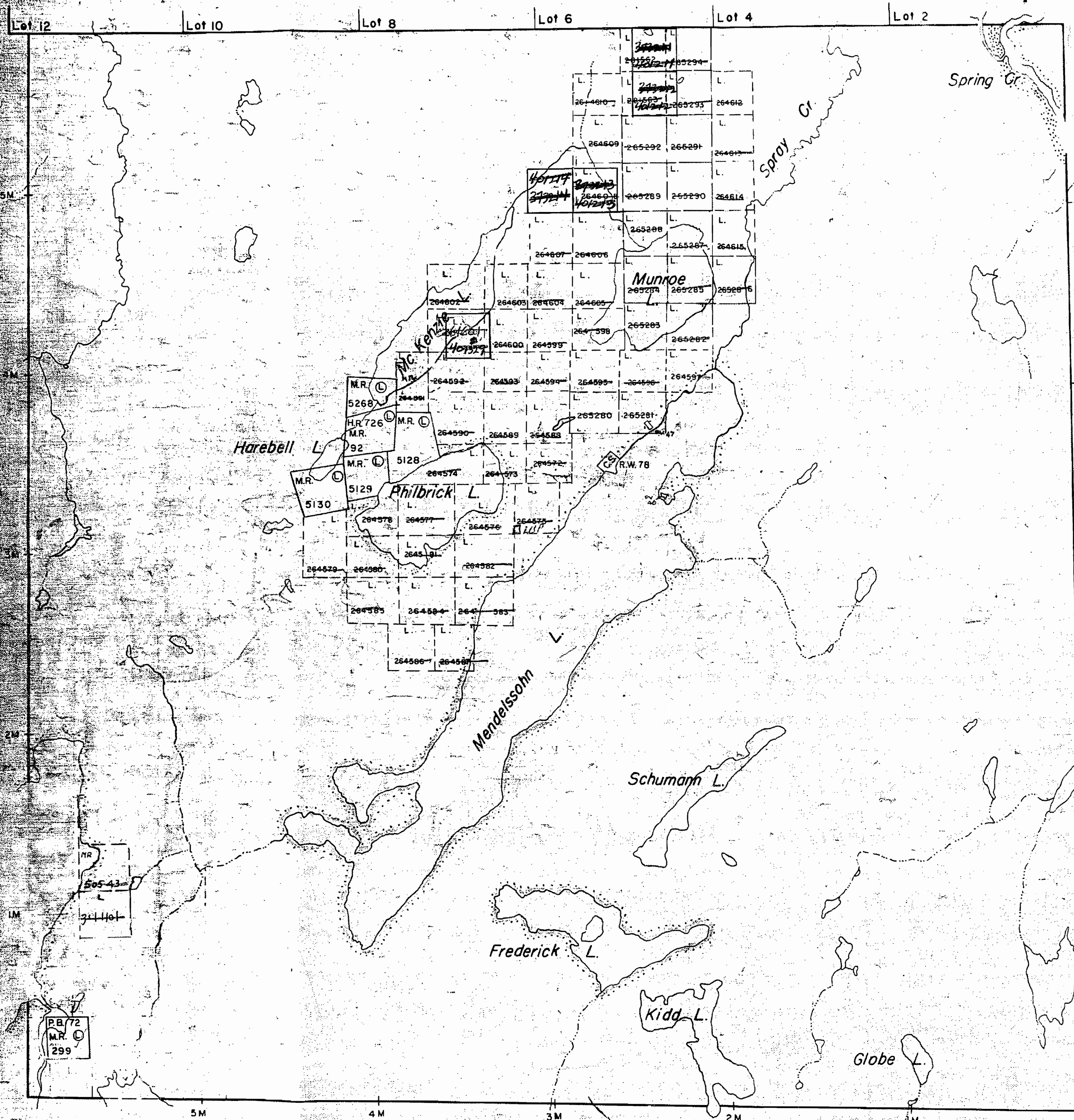

THE TOWNSHIP  
OF

**SPEIGHT**

DISTRICT OF  
TIMISKAMING

LARDER LAKE  
MINING DIVISION

SCALE: 1 INCH = 40 CHAINS

**LEGEND**

PATENTED LAND	Ⓟ
CROWN LAND SALE	C.S.
LEASES	Ⓛ
LOCATED LAND	Loc.
LICENSE OF OCCUPATION	L.O.
MINING RIGHTS ONLY	M.R.O.
SURFACE RIGHTS ONLY	S.R.O.
ROADS	—
IMPROVED ROADS	—
KING'S HIGHWAYS	—
RAILWAYS	—
POWER LINES	—
MARSH OR MUSKEG	—
MINES	—
CANCELLED	—

**NOTES**

400' Surface rights reservation around all lakes and rivers.

Timagami Forest Reserve shown thus: —

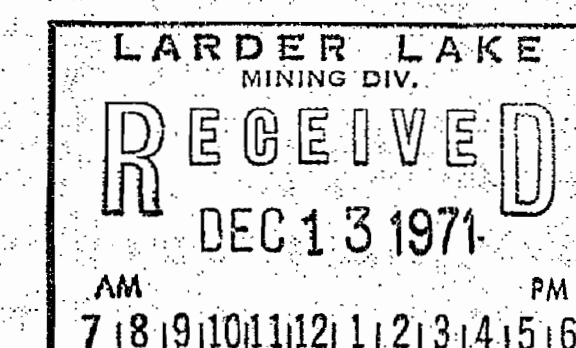

**SPEIGHT**

PLAN NO. - M-249

ONTARIO  
DEPARTMENT OF MINES  
AND NORTHERN AFFAIRS

249



OFFICE USE ONLY  
Barber Twp.

1974

THE TOWNSHIP OF  
OF

**SPEIGHT**

DISTRICT OF  
TIMISKAMING

SUDBURY  
MINING DIVISION

SCALE: 1-INCH=40 CHAINS

LEGEND

PATENTED LAND	Ⓟ
CROWN LAND SALE	C.S.
LEASES	Ⓛ
LOCATED LAND	Loc.
LICENSE OF OCCUPATION	L.O.
MINING RIGHTS ONLY	M.R.O.
SURFACE RIGHTS ONLY	S.R.O.
ROADS	—
IMPROVED ROADS	—
KING'S HIGHWAYS	—
RAILWAYS	—
POWER LINES	—
MARSH OR MUSKEG	—
MINES	✕
CANCELLED	C.

NOTES

400' Surface rights reservation around all lakes and rivers.

Timagami Forest Reserve shown thus: —

\* TOWNSHIP CLOSED TO STAKING  
EFFECTIVE MAY 8, 1978  
SECTION 38(f) THE MINING ACT

\* TOWNSHIP CLOSED TO STAKING  
MARCH 16, 1984, Section 36 of  
the Mining Act

**SPEIGHT**

PLAN NO.- M-249

ONTARIO  
MINISTRY OF NATURAL RESOURCES  
SURVEYS AND MAPPING BRANCH

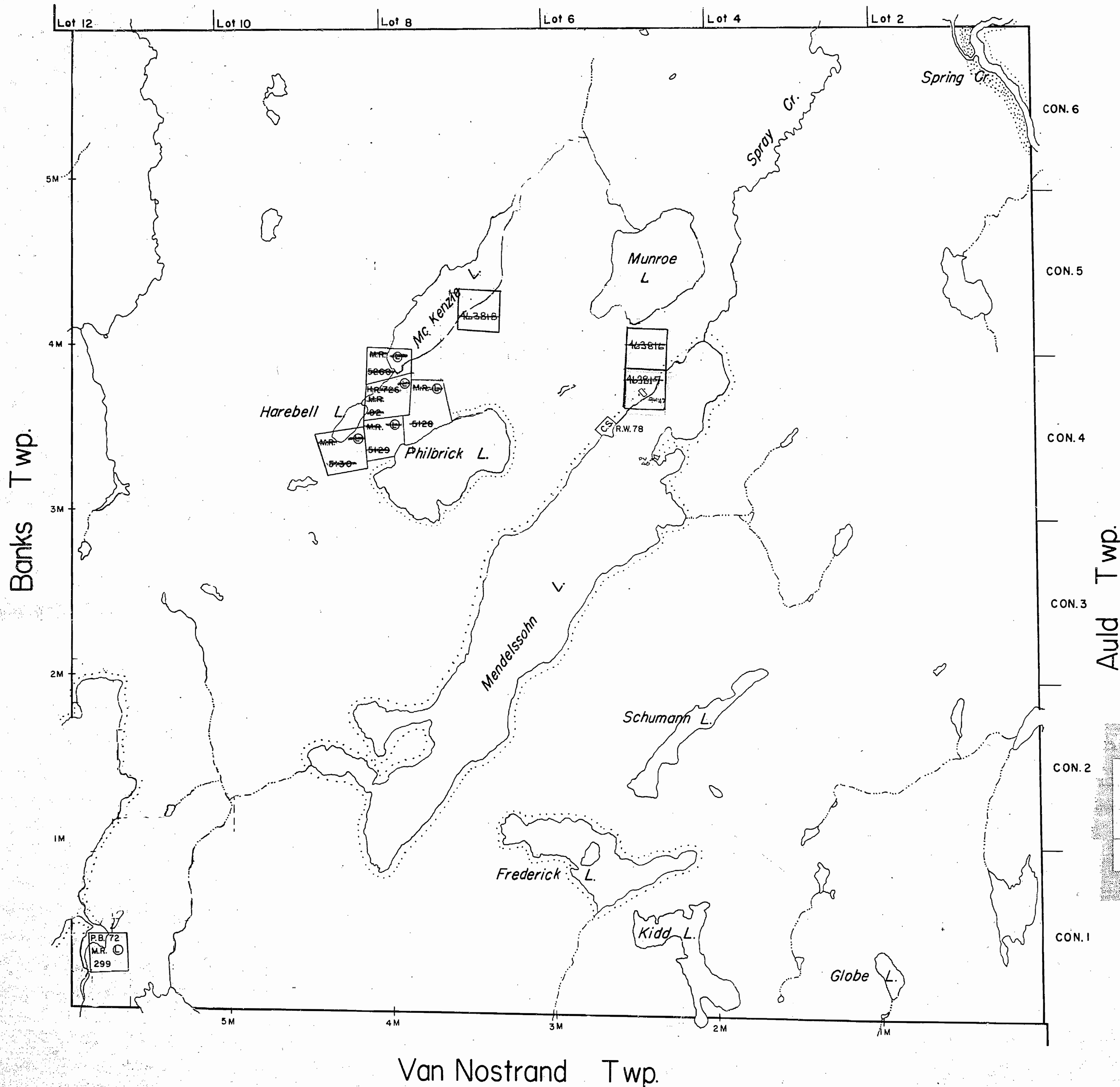



OFFICE USE ONLY  
Barber Twp.

1974

THE TOWNSHIP  
OF

**SPEIGHT**

DISTRICT OF  
TIMISKAMING

SUDBURY  
MINING DIVISION

SCALE: 1-INCH=40 CHAINS

LEGEND

PATENTED LAND	Ⓟ
CROWN LAND SALE	C.S.
LEASES	Ⓛ
LOCATED LAND	Loc.
LICENSE OF OCCUPATION	L.O.
MINING RIGHTS ONLY	M.R.O.
SURFACE RIGHTS ONLY	S.R.O.
ROADS	—
IMPROVED ROADS	—
KING'S HIGHWAYS	—
RAILWAYS	—
POWER LINES	—
MARSH OR MUSKEG	+
MINES	✕
CANCELLED	C.

NOTES

400' Surface rights reservation around all lakes and rivers.

Timagami Forest Reserve shown thus: —

\* TOWNSHIP CLOSED TO STAKING  
EFFECTIVE MAY 8, 1978  
SECTION 38(F) THE MINING ACT

\* TOWNSHIP CLOSED TO STAKING  
MARCH 16, 1984, Section 36 of  
the Mining Act

**SPEIGHT**

PLAN NO.- M-249

ONTARIO  
MINISTRY OF NATURAL RESOURCES

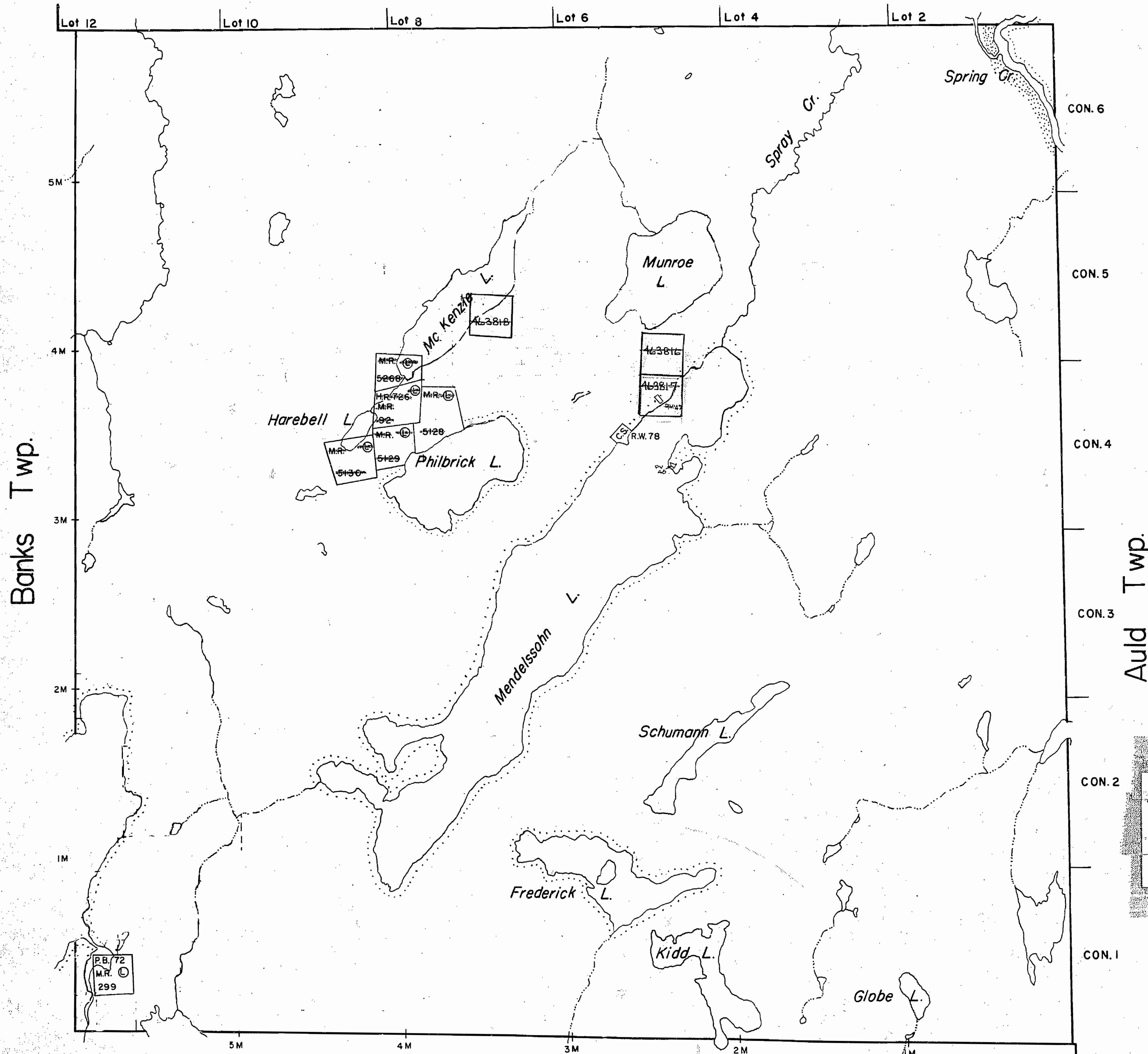

W. 54 S. M

26 EIGHT 1b.

W. 54 S. M

Barber Twp.

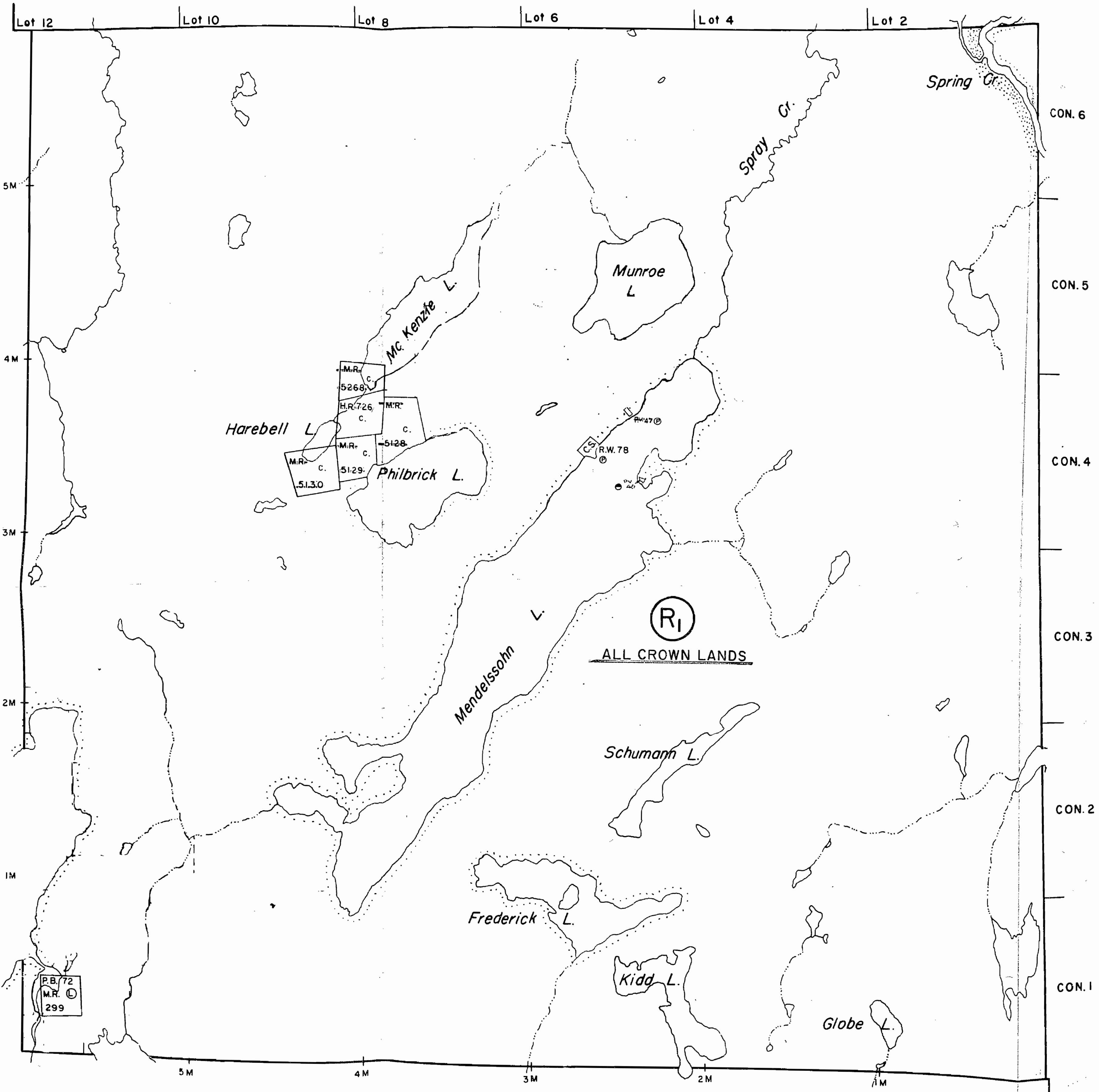

THE TOWNSHIP OF  
OF  
**SPEIGHT**

DISTRICT OF  
TIMISKAMING

LARDER LAKE  
MINING DIVISION

SCALE: 1-INCH=40 CHAINS

LEGEND

PATENTED LAND	Ⓢ
CROWN LAND SALE	C.S.
LEASES	Ⓛ
LOCATED LAND	Loc.
LICENSE OF OCCUPATION	L.O.
MINING RIGHTS ONLY	M.R.O.
SURFACE RIGHTS ONLY	S.R.O.
ROADS	—
IMPROVED ROADS	—
KING'S HIGHWAYS	—
RAILWAYS	—
POWER LINES	—
MARSH OR MUSKEG	—
MINES	—
CANCELLED	—

NOTES

400' Surface rights reservation around all lakes and rivers.

Timagami Forest Reserve shown thus: —

Township closed to staking effective May 8, 1978, Sec. 87(f) of The Mining Act.

AREAS WITHDRAWN FROM DISPOSITION

M.R.O. — MINING RIGHTS ONLY  
S.R.O. — SURFACE RIGHTS ONLY  
M.+ S. — MINING AND SURFACE RIGHTS

Description	Order No.	Date	Disposition	File
Ⓢ Sec. 36/80	W. 2 / 84	16/3/84	M. & S.	188540

REPLACED JANUARY 8, 1988

**SPEIGHT**  
PLAN NO.- M-249

ONTARIO  
MINISTRY OF NATURAL RESOURCES  
SURVEYS AND MAPPING BRANCH

W. 54 S. M

26 EIGHT 1b.

W. 54 S. M





Ministry of Natural Resources  
Ministry of Northern Development and Mines

geology reference-COBALT  
RESIDENT GEO.

INDEX TO LAND DISPOSITION

PLAN  
G-3449  
TOWNSHIP

M.N.R. ADMINISTRATIVE DISTRICT  
TEMAGAMI  
MINING DIVISION  
LARDER LAKE  
LAND TITLES/REGISTRY DIVISION  
TIMISKAMING

SFEIGHT

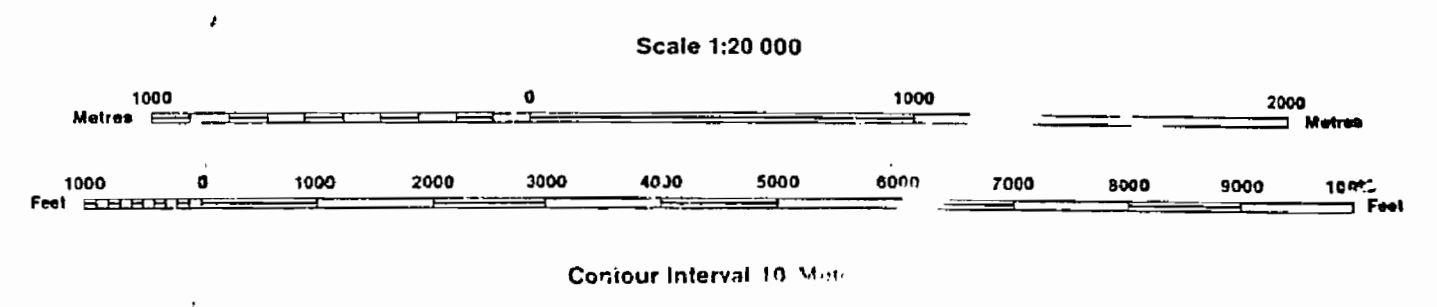

AREAS WITHDRAWN FROM DISPOSITION

MRO - Mining Rights Only  
SRC - Surface Rights Only  
M + S - Mining and Surface Rights

Description	Order No.	Date	Disposition	File
Sec. 34/80	W2/84	16/3/84	M + S	188540
SURFACE AND MINING RIGHTS WITHDRAWN FROM PROSPECTING, STAKING, SALE OR LEASE, SECTION 35 OF THE MINING ACT R.S.O. 1990, C. 12, s. 35(1) EFFECTIVE MAY 27/84, 4:05 PM				
W	SEC.35/90	W.L.29/96 NER	17/09/96	MRS

W AREA DEEMED IN NEED OF PROTECTION BY THE CROWN AND WILL REMAIN WITHDRAWN INDEFINITELY.

NOTES

TOWNSHIP CLOSED FOR STAKING EFFECTIVE MAY 9, 1979, SEC. 87 (1) OF THE MINING ACT.

DATE OF ISSUE  
SEP 13 1996  
LARDER LAKE  
MINING RECORDER'S OFFICE

CIRCULATED JANUARY 8, 1988

DISPOSITION OF CROWN LANDS

Patent	
Surface & Mining Rights	○
Surface Rights Only	○
Mining Rights Only	○
Lease	
Surface & Mining Rights	■
Surface Rights Only	■
Mining Rights Only	■
Licence of Occupation	▼
Order-in-Council	OC
Cancelled	○
Reservation	○
Sand & Gravel	○

THE INFORMATION THAT APPEARS ON THIS MAP HAS BEEN COMPILED FROM VARIOUS SOURCES, AND ACCURACY IS NOT GUARANTEED. THOSE WISHING TO STAKE MINING CLAIMS SHOULD CONSULT WITH THE MINING RECORDER, MINISTRY OF NORTHERN DEVELOPMENT AND MINES, FOR ADDITIONAL INFORMATION ON THE STATUS OF THE LANDS SHOWN HEREON.

Map base and land disposition drafting by Surveys and Mapping Branch, Ministry of Natural Resources.

The disposition of land, location of lot fabric and parcel boundaries on this map was compiled for administrative purposes only.





249

Barber Twp.

THE TOWNSHIP  
OF  
**SPEIGHT**

DISTRICT OF  
TIMISKAMING

LARDER LAKE  
MINING DIVISION

SCALE: 1 INCH = 40 CHAINS

LEGEND

PATENTED LAND	⊙
CROWN LAND SALE	C.S.
LEASES	⊙
LOCATED LAND	Loc.
LICENSE OF OCCUPATION	L.O.
MINING RIGHTS ONLY	M.R.O.
SURFACE RIGHTS ONLY	S.R.O.
ROADS	—
IMPROVED ROADS	—
KING'S HIGHWAYS	—
RAILWAYS	—
POWER LINES	—
MARSH OR MUSKEG	—
MINES	⋈
CANCELLED	C.

NOTES

400' Surface rights reservation around all lakes and rivers.

Timagami Forest Reserve shown thus -

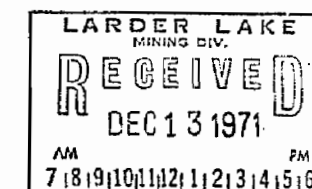

**SPEIGHT**

PLAN NO.- M-249

ONTARIO  
DEPARTMENT OF MINES  
AND NORTHERN AFFAIRS

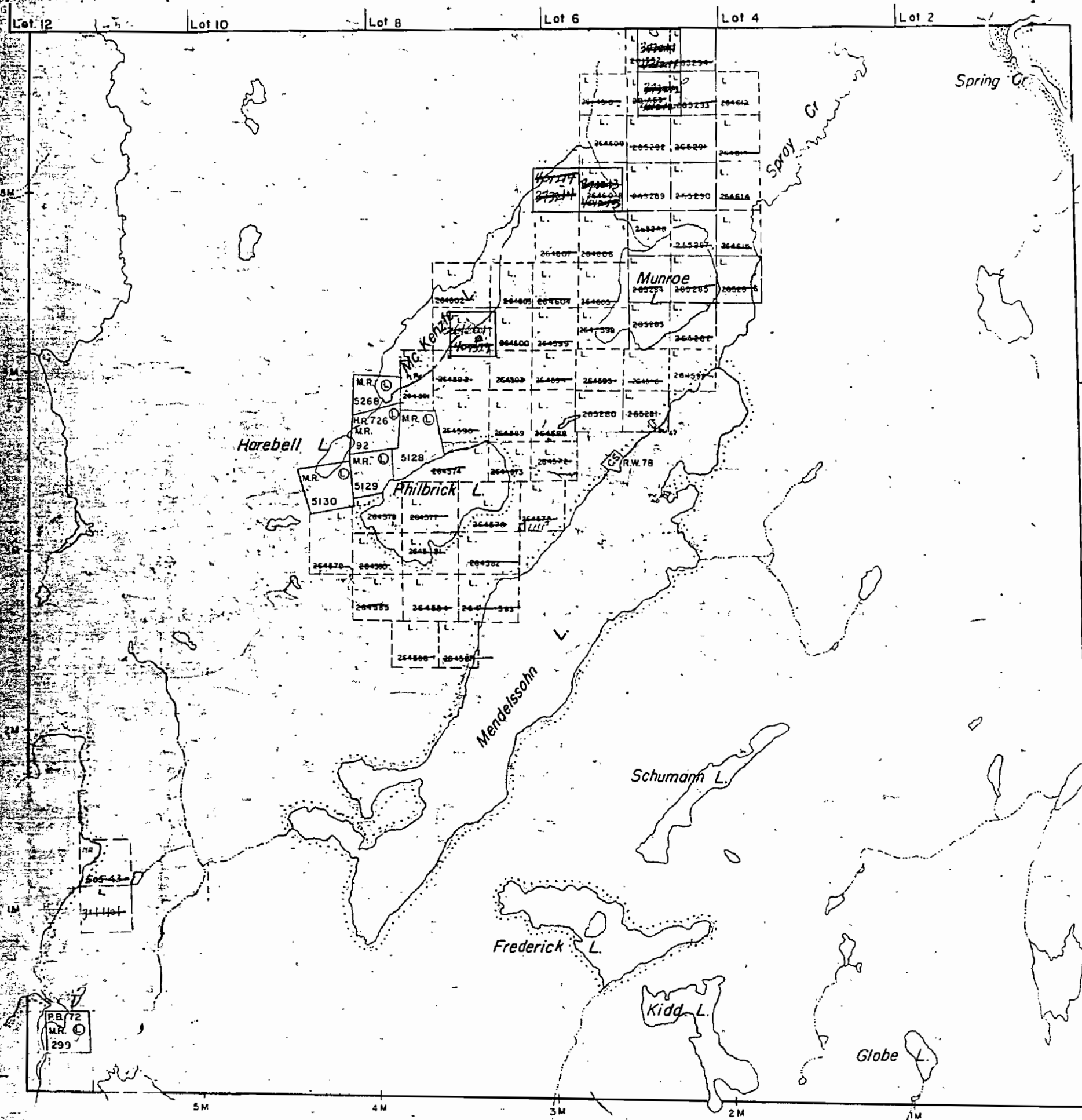

Van Nostrand Twp.



DEPARTMENT OF MINES  
— ONTARIO —



# SPEIGHT

# DISTRICT OF TIMISKAMING

SCALE 40 CHAINS • 1 INCH

**BARBER**

CONFIDENTIAL

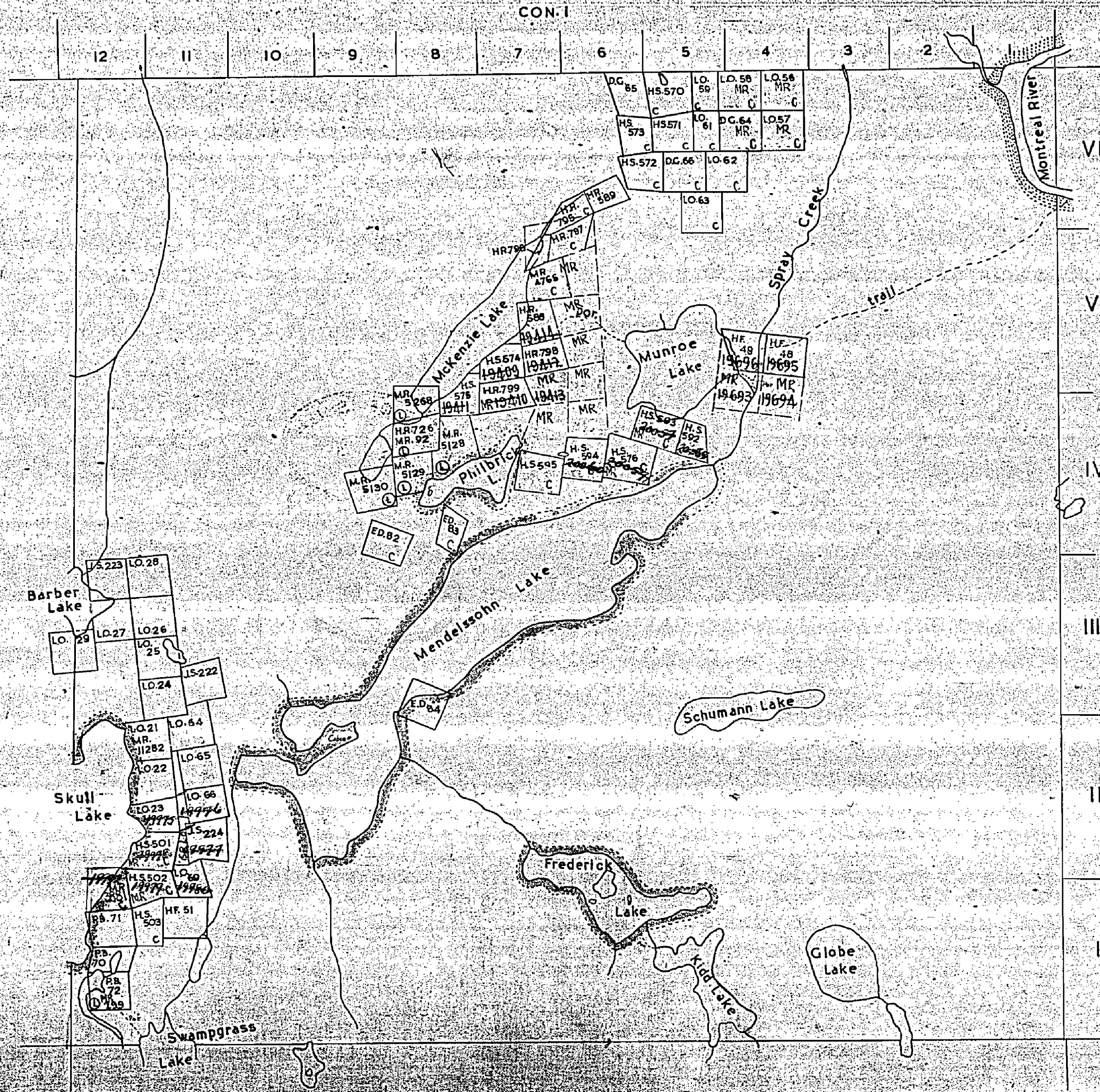

# BANKS

AULD

Claims Leased Marked Thru  
 Licensed  
 Cancelled

# VANNOSTRAND

2nd Wild reservation on surface by Dept of L & F  
Sheldon Heron thru



Barber Twp.

Replaced Dec. 13/71

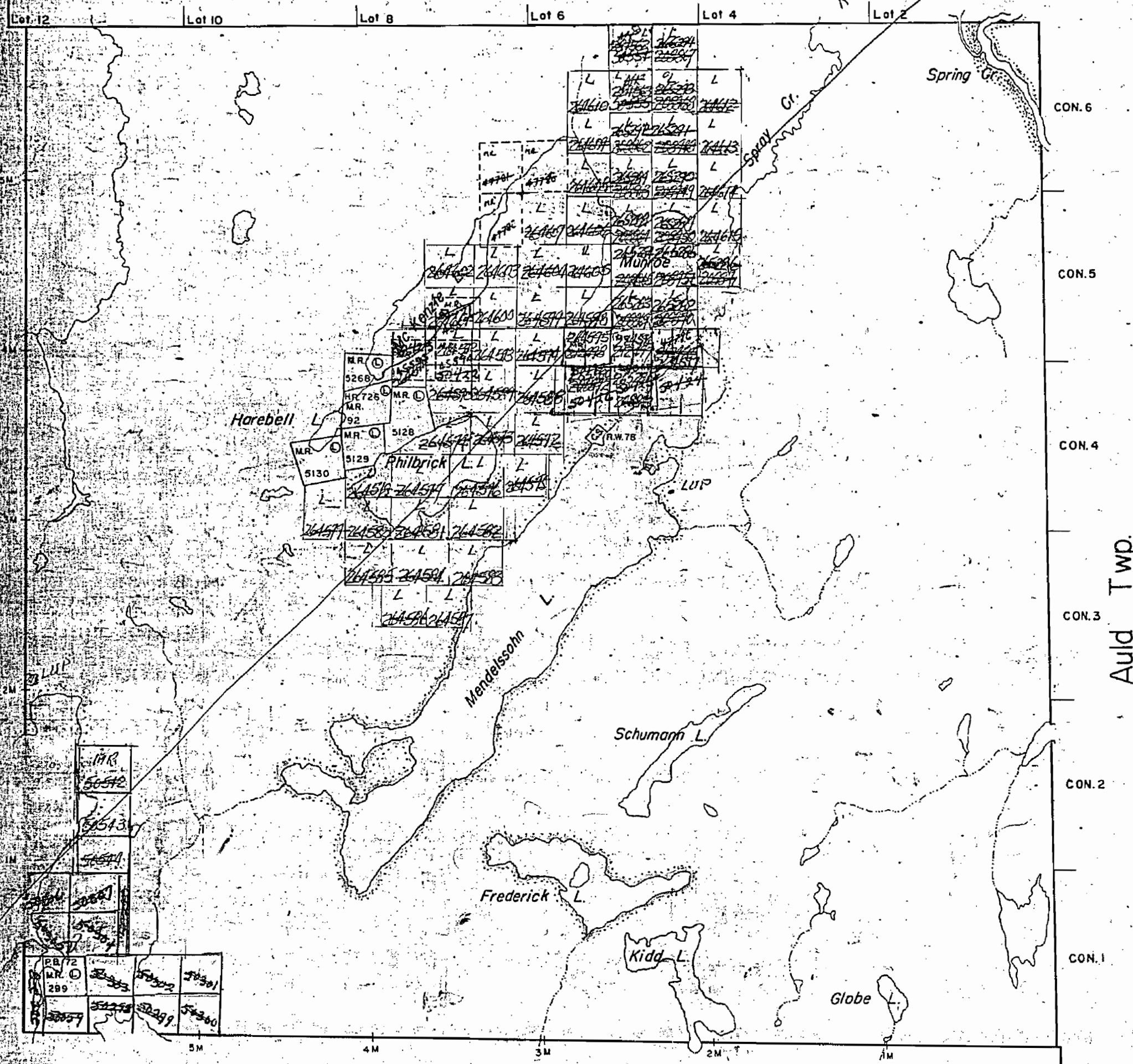

THE TOWNSHIP  
OF  
**SPEIGHT**

DISTRICT OF  
TIMISKAMING

MONTREAL RIVER  
MINING DIVISION

SCALE: 1-INCH=40 CHAINS

LEGEND

PATENTED LAND	Ⓟ
CROWN LAND SALE	C.S.
LEASES	Ⓢ
LOCATED LAND	Loc.
LICENSE OF OCCUPATION	L.O.
MINING RIGHTS ONLY	M.R.O.
SURFACE RIGHTS ONLY	S.R.O.
ROADS	—
IMPROVED ROADS	—
KING'S HIGHWAYS	—
RAILWAYS	—
POWER LINES	—
MARSH OR MUSKEG	—
MINES	—
CANCELLED	—

NOTES

400' Surface rights reservation around all lakes and rivers.

Timagami Forest Reserve shown thus: —

MONTREAL RIVER  
MINING DIV.  
RECEIVED  
OCT 18 1967  
PH  
100-10112, 12, 3, 4, 5, 6

PLAN NO.- M-249

DEPARTMENT OF MINES  
— ONTARIO —





Barber Twp.

Van Nostrand Twp.

THE TOWNSHIP  
OF







# SPEIGHT

# DISTRICT OF TIMISKAMING

MONTREAL RIVER  
MINING DIVISION

SCALE: 1-INCH=40 CHAINS

## LEGEND

PATENTED LAND	(P)
CROWN LAND SALE	C.S.
LEASES	(L)
LOCATED LAND	Loc.
LICENSE OF OCCUPATION	L.O.
MINING RIGHTS ONLY	M.R.O.
SURFACE RIGHTS ONLY	S.R.O.
ROADS	
IMPROVED ROADS	
KING'S HIGHWAYS	
RAILWAYS	
POWER LINES	
MARSH OR MUSKEG	
MINES	
CANCELLED	X C.

## NOTES

200' Reserve to the Dept. of Lands & Forests shown  
thus:-

Timagami Forest Reserve shown thus

PLAN NO.- MR. M 249

DEPARTMENT OF MINES

— ONTARIO —





— ONTARIO —





Ministry of Natural Resources  
Ministry of Northern Development and Mines

geology reference-COBALT  
RESIDENT GEO.

INDEX TO LAND DISPOSITION

FILE NO  
G-3449  
TOWNSHIP

M.A.C. ADMINISTRATIVE DISTRICT  
TEMAGAMI  
MINING DIVISION  
LARDER LAKE  
LAND TITLES/REGISTRY DIVISION  
TIMISKAMING

SFEIGHT

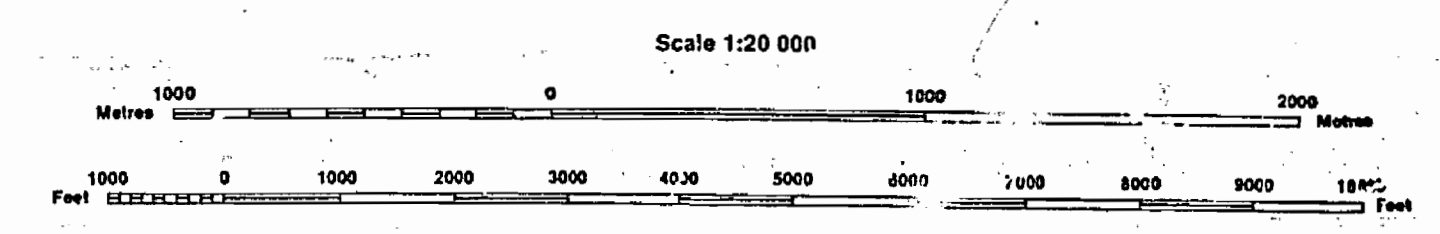

AREAS WITHDRAWN FROM DISPOSITION  
MRO - Mining Rights Only  
SRC - Surface Rights Only  
M+S - Mining and Surface Rights

SYMBOLS

- Boundary  
Township, Meridian, Baseline
- Road allowance; surveyed  
shoreline
- Lot/Concession; surveyed  
unsurveyed
- Parcel; surveyed  
unsurveyed
- Right-of-way; road  
railway  
utility
- Reservation
- Cliff, Pit, Pile
- Contour
- Interpolated
- Ap, proximate
- Depression
- Control point (horizontal)
- Flooded land
- Mine head frame
- Pipeline (above ground)
- Railway, single track  
double track  
abandoned
- Road; highway, county, township  
access  
trail, bush
- Shoreline (original)
- Transmission line
- Wooded area

Description	Order No.	Date	Disposition	RP
SEC 35/98	W-1-56/96	NER	11/05/96	MRS

AREA DEEMED IN NEED OF PROTECTION BY THE CROWN AND WILL REMAIN WITHDRAWN INDEFINITELY.

NOTES

TOWNSHIP CLOSED FOR STAKING EFFECTIVE MAY 8, 1978, SEC. 97 (1) OF THE MINING ACT.

REG 349/98

NOTICE  
WORK PERMITS FOR MINERAL EXPLORATION ACTIVITY  
EFFECTIVE September 15<sup>th</sup> 1998  
The area outlined as 'X' on this map will be subject to Ontario Regulation 349/98 made under the Public Lands Act. Depending on the type and timing of your exploration work you may require a Work Permit. For further information please contact Gerhard Meyer, Regional Resident Geologist at (705) 567-5242 or Jim Ireland, Regional Manager at (705) 235-1612

CIRCULATED JANUARY 8, 1986

DISPOSITION OF CROWN LANDS

- Patent  
Surface & Mining Rights  
Surface Rights Only  
Mining Rights Only
- Lease  
Surface & Mining Rights  
Surface Rights Only  
Mining Rights Only
- Licence of Occupation
- Order-in-Council
- Cancelled
- Reservation
- Sand & Gravel

ARCHIVED SEPT. 18, 1996

Map base and land disposition drafting by Surveys and Mapping Branch, Ministry of Natural Resources.

The disposition of land, location of lot fabric and parcel boundaries on this map was compiled for administrative purposes only.

THE INFORMATION THAT APPEARS ON THIS MAP HAS BEEN COMPILED FROM VARIOUS SOURCES AND ACCURACY IS NOT GUARANTEED. THOSE WISHING TO STAKE MINING CLAIMS SHOULD CONSULT WITH THE MINING RECORDER, MINISTRY OF NORTHERN DEVELOPMENT AND MINES, FOR ADDITIONAL INFORMATION ON THE STATUS OF THE LANDS SHOWN HEREON.

G-3449  
SFEIGHT TWP  
G-3449