

INDEX TO LAND DISPOSITION

PLAN
G-3329

TOWNSHIP
SPRAGGE

M.N.R. ADMINISTRATIVE DISTRICT
BLIND RIVER
MINING DIVISION
SAULT STE. MARIE
LAND TITLES/REGISTRY DIVISION
ALGOMA

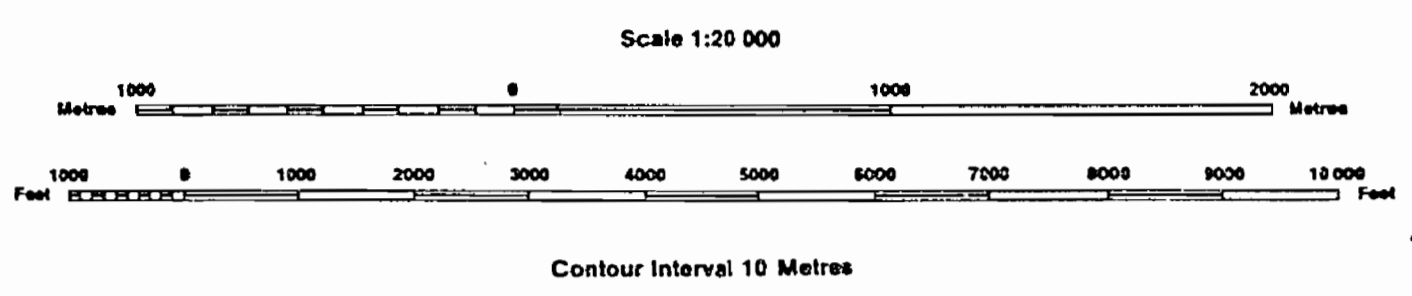

DATE OF ISSUE
JUN 08 1998
 PROVINCIAL RECORDING
 OFFICE - SUBSURY

AREAS WITHDRAWN FROM DISPOSITION
 MRO - Mining Rights Only
 SRO - Surface Rights Only
 M + S - Mining and Surface Rights

SYMBOLS

| | |
|---------------------------------|-------|
| Boundary | |
| Township, Meridian, Baseline | ————— |
| Road allowance; surveyed | ——— |
| shoreline | ~~~~~ |
| Lot/Concession; surveyed | ——— |
| unsurveyed | |
| Parcel; surveyed | ——— |
| unsurveyed | |
| Right-of-way; road | ——— |
| railway | ——— |
| utility | ——— |
| Reservation | |
| Cliff, Pit, Pile | |
| Contour | |
| Interpolated | |
| Approximate | |
| Depression | |
| Control point (horizontal) | |
| Flooded land | |
| Mine head frame | |
| Pipeline (above ground) | |
| Railway; single track | |
| double track | |
| abandoned | |
| Road; highway, county, township | |
| access | |
| trail, bush | |
| Shoreline (original) | |
| Transmission line | |
| Wooded area | |

| Description | Order No. | Date | Disposition | File |
|-------------|---------------|----------|-------------|--------|
| SEC.35 | W-5-30/97 NER | 23/12/97 | M+S | 195150 |

ANNULMENT

SUBDIVISION OF THIS TOWNSHIP INTO LOTS AND CONCESSIONS WAS PARTIALLY ANNULLED ON JANUARY 15, 1954.

NOTES

THIS TOWNSHIP LIES WITHIN THE IMPROVEMENT DISTRICT OF THE NORTH SHORE.
 ALL MINING CLAIMS STAKED IN THIS TOWNSHIP ARE SUBJECT TO SECTION 54 OF THE MINING ACT, (R.S.O. 1970)

ISLANDS IN LAKE HURON FRONTING THIS TOWNSHIP ARE WITHDRAWN FROM STAKING W/203 BL, OCTOBER 4, 1983, FILE 168305.

DISPOSITION OF CROWN LANDS

| | |
|-------------------------|-------|
| Patent | |
| Surface & Mining Rights | |
| Surface Rights Only | |
| Mining Rights Only | |
| Lease | |
| Surface & Mining Rights | |
| Surface Rights Only | |
| Mining Rights Only | |
| Licence of Occupation | |
| Order-in-Council | |
| Cancelled | |
| Reservation | |
| Sand & Gravel | |

THE INFORMATION THAT APPEARS ON THIS MAP HAS BEEN COMPILED FROM VARIOUS SOURCES AND ACCURACY IS NOT GUARANTEED. THOSE WISHING TO STAKE MINING CLAIMS SHOULD CONSULT WITH THE MINING RECORDER, MINISTRY OF NORTHERN DEVELOPMENT AND MINES, FOR ADDITIONAL INFORMATION ON THE STATUS OF THE LANDS SHOWN HEREON.

FOR STATUS OF ISLANDS SEE AREA PLANS
 McCRACKEN ISLAND
 SNIDER ISLAND
 WILHELMSBACH G-3349

G-3329

2BACGE 1M6

G-3350

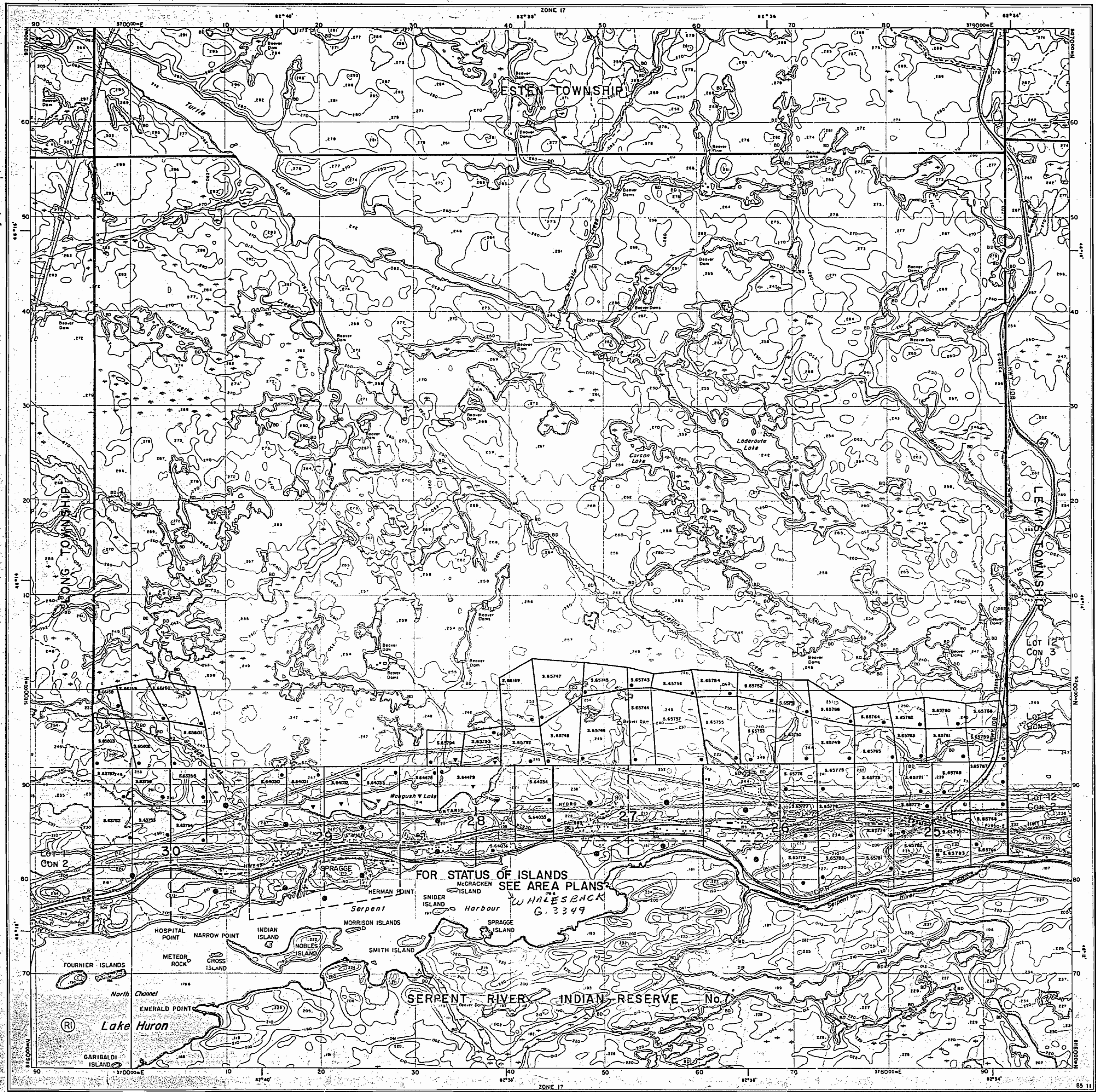

Ministry of Natural Resources
Ontario

Ministry of Northern Development and Mines

INDEX TO LAND DISPOSITION

PLAN
G-3329

TOWNSHIP
SPRAGGE

M.N.R. ADMINISTRATIVE DISTRICT
BLIND RIVER
MINING DIVISION
SAULT STE. MARIE
LAND TITLES/REGISTRY DIVISION
ALGOMA

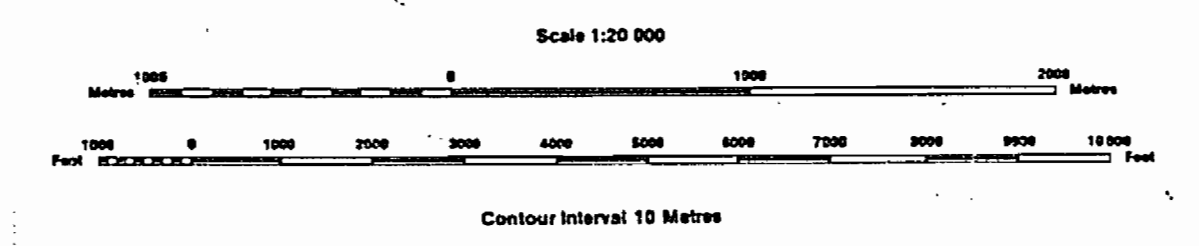

AREAS WITHDRAWN FROM DISPOSITION

MRO - Mining Rights Only
SRO - Surface Rights Only
M+S - Mining and Surface Rights

SYMBOLS

- Boundary
- Township, Meridian, Baseline
- Road allowance; surveyed
- shoreline
- Lot/Concession; surveyed
- unsurveyed
- Parcel; surveyed
- unsurveyed
- Right-of-way; road
- railway
- utility
- Reservation
- Cliff, Pit, Pile
- Contour
- Interpolated
- Approximate
- Depression
- Control point (horizontal)
- Flooded land
- Mine head frame
- Pipeline (above ground)
- Railway; single track
- double track
- abandoned
- Road; highway, county, township
- access
- trail, bush
- Shoreline (original)
- Transmission line
- Wooded area

| Description | Order No. | Date | Disposition | File |
|-------------|-----------|----------|-------------|-------|
| SECL3 | W-5-30/87 | 23.02/87 | M+S | 19550 |

ANNULMENT

SUBDIVISION OF THIS TOWNSHIP INTO LOTS AND CONCESSIONS WAS PARTIALLY ANNULLED ON JANUARY 13, 1994.

NOTES

THIS TOWNSHIP LIES WITHIN THE IMPROVEMENT DISTRICT OF THE NORTH SHORE.

ALL MINING CLAIMS STAKED IN THIS TOWNSHIP ARE SUBJECT TO SECTION 54 OF THE MINING ACT, (R.S.O. 1970).

ISLANDS IN LAKE HURON FRONTING THIS TOWNSHIP ARE WITHDRAWN FROM STAKING W/2163 DL OCTOBER 4, 1983 FILE 189505

DISPOSITION OF CROWN LANDS

- Patent
- Surface & Mining Rights
- Surface Rights Only
- Mining Rights Only
- Lease
- Surface & Mining Rights
- Surface Rights Only
- Mining Rights Only
- Licence of Occupation
- Order-in-Council
- Cancelled
- Reservation
- Sand & Gravel

THE INFORMATION THAT APPEARS ON THIS MAP HAS BEEN COMPILED FROM VARIOUS SOURCES, AND ACCURACY IS NOT GUARANTEED. THOSE WISHING TO STAKE MINING CLAIMS SHOULD CONSULT WITH THE MINING RECORDER, MINISTRY OF NORTHERN DEVELOPMENT AND MINES, FOR ADDITIONAL INFORMATION ON THE STATUS OF THE LANDS SHOWN HEREON.

C. S. MARIE
RECEIVED
MAR 1 8 1993
7400012123456

The 1975 Magnetic Bearing is approximately 1.30" Annual Change increasing

Map base and land disposition drafting by Surveys and Mapping Branch, Ministry of Natural Resources.

The disposition of land, location of lot fabric and parcel boundaries on this index was compiled for administrative purposes only.

Esten Twp - M.792

Long Twp - M.1300

Lewis Twp - M.988

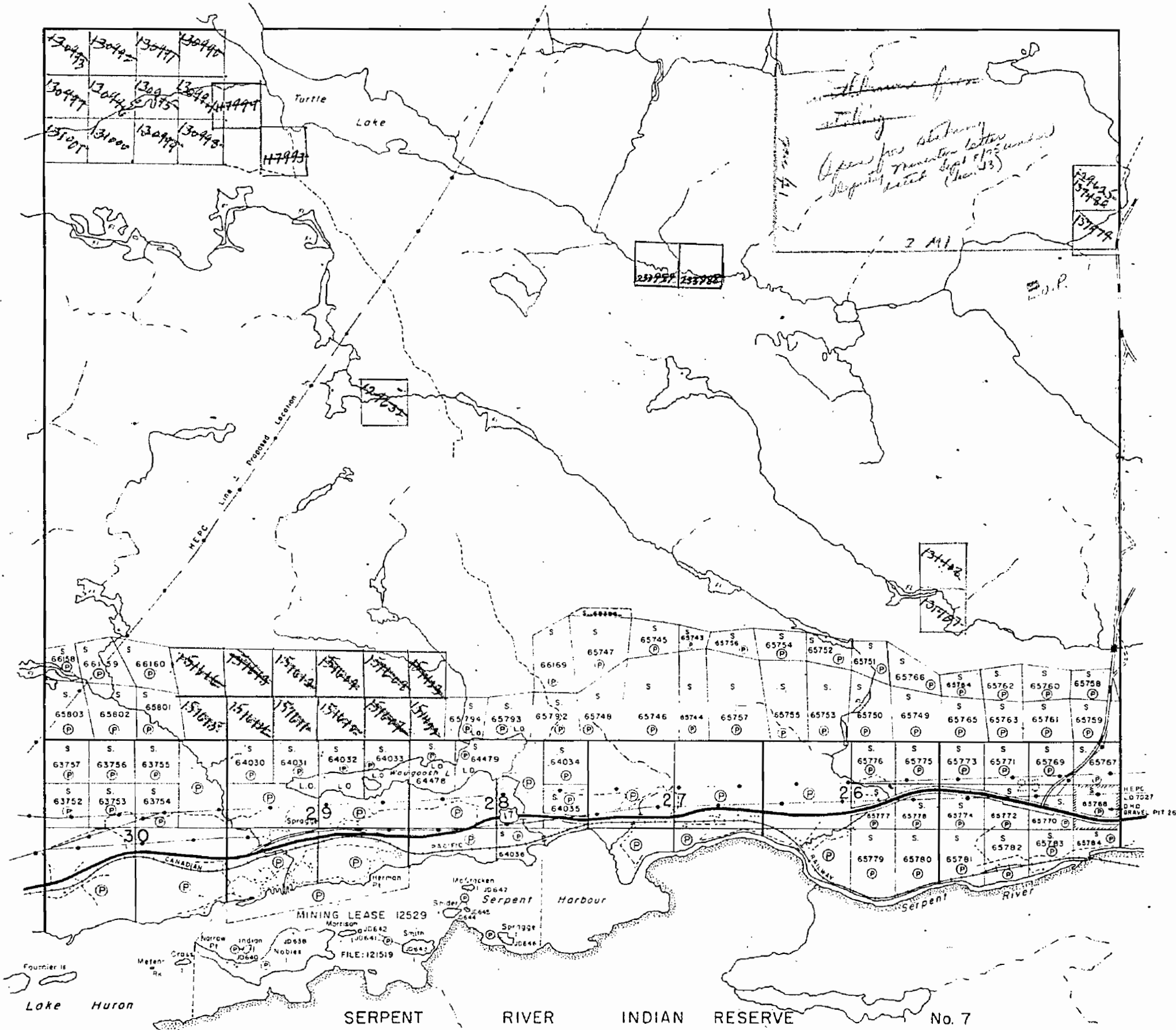

THE TOWNSHIP OF

SPRAGGE

DISTRICT OF ALGOMA

SUDBURY MINING DIVISION

SCALE: 1-INCH=40 CHAINS

LEGEND

| | |
|-----------------------|--------|
| PATENTED LAND | Ⓟ |
| CROWN LAND SALE | C.S. |
| LEASES | Ⓞ |
| LOCATED LAND | L.C. |
| LICENSE OF OCCUPATION | L.O. |
| MINING RIGHTS ONLY | M.R.O. |
| SURFACE RIGHTS ONLY | S.R.O. |
| ROADS | — |
| IMPROVED ROADS | — |
| KING'S HIGHWAYS | — |
| RAILWAYS | — |
| POWER LINES | — |
| MARSH OR MUSKEG | — |
| MINES | Ⓧ |
| CANCELLED | c. |

NOTES

400' Reserve around all Lakes & Rivers to Dept. of Lands & Forests.

Land under water in Lake Huron withdrawn from staking by Order in Council dated April 30, 1912.

Sand and gravel on all unpatented mining claims in this Twp. reserved to the Crown.

Islands in Lake Huron withdrawn from staking - File: 58528.

All mining claims staked within this Twp. subject to Section 53 of the Mining Act.

PLAN NO. - M.1122

DEPARTMENT OF MINES

— ONTARIO —

M.2773

SSIIIM

1.122

SSIIIM

SPRAGGE TWP

SPRAGGE TWP

SSIIIM

SSIIIM

Esten Twp.-M.792

Long Twp.- M.1300

Lewis Twp. - M.988

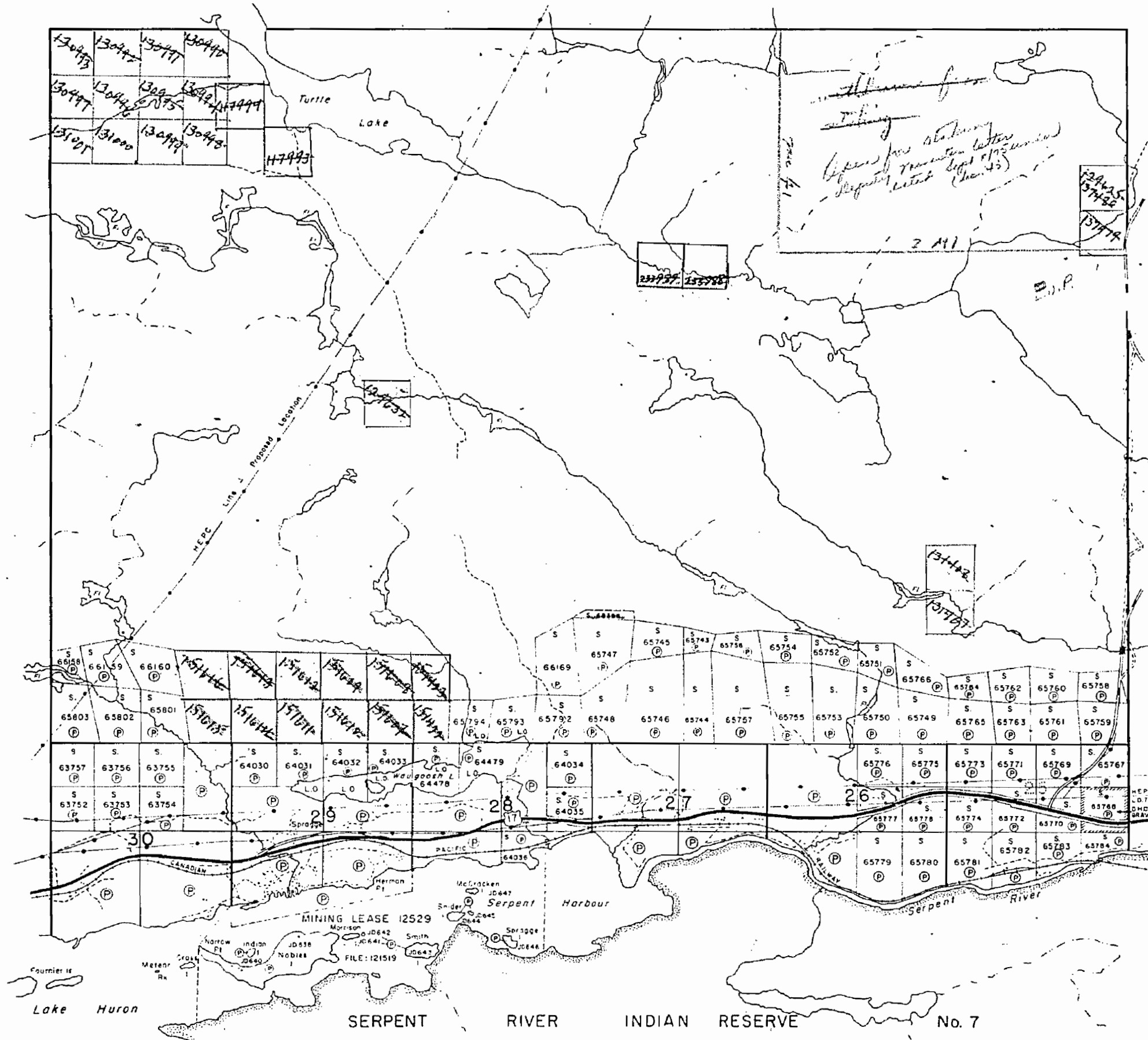

M.2773

THE TOWNSHIP OF

SPRAGGE

DISTRICT OF ALGOMA

SUDBURY MINING DIVISION

SCALE: 1-INCH=40 CHAINS

LEGEND

| | |
|-----------------------|--------|
| PATENTED LAND | Ⓟ |
| CROWN LAND SALE | C.S. |
| LEASES | Ⓛ |
| LOCATED LAND | Loc. |
| LICENSE OF OCCUPATION | L.O. |
| MINING RIGHTS ONLY | M.R.O. |
| SURFACE RIGHTS ONLY | S.R.O. |
| ROADS | — |
| IMPROVED ROADS | — |
| KING'S HIGHWAYS | — |
| RAILWAYS | — |
| POWER LINES | — |
| MARSH OR MUSKEG | — |
| MINES | X |
| CANCELLED | C |

NOTES

- 400' Reserve around all Lakes & Rivers to Dept. of Lands & Forests.
- Land under water in Lake Huron withdrawn from staking by Order in Council dated April 30, 1912.
- Sand and gravel on all unpatented mining claims in this Twp. reserved to the Crown.
- Islands in Lake Huron withdrawn from staking - File 58528.
- All mining claims staked within this Twp. subject to Section 53 of the Mining Act.

PLAN NO.- M.1122

DEPARTMENT OF MINES

— ONTARIO —

1.122

ESTEN TWP.

old
sect. 53

THE TOWNSHIP OF
OF
SPRAGGE

DISTRICT OF ALGOMA
SUDBURY
MINING DIVISION

SCALE: 1 INCH = 40 CHAINS

LEGEND

- PATENTED LAND (P)
- CROWN LAND SALE (S)
- LOCATED LAND L.O.
- LICENSE OF OCCUPATION L.O.
- ROADS [Symbol]
- IMPROVED ROADS [Symbol]
- RAILWAYS [Symbol]
- POWER LINES [Symbol]
- MARSH OR MUSKEG [Symbol]
- KING'S HIGHWAY [Symbol]

NOTES

SURFACE RESERVATIONS 400 FT. WIDE BY DEPT. OF L. & F. SHOWN HEREON THUS: [Symbol]

ISLANDS A to K PATENTED (P)

MINING CLAIMS TO BE ACCEPTED SUBJECT TO SECTION 53 OF THE MINING ACT

Land under Lake Huron withdrawn from staking by Order in Council dated April 30, 1912.

Sand and gravel on all unpatented mining claims in this township reserved to the crown

Islands in Lake Huron withdrawn from staking Nov. 23/26 Sect. 39 sub. (c)

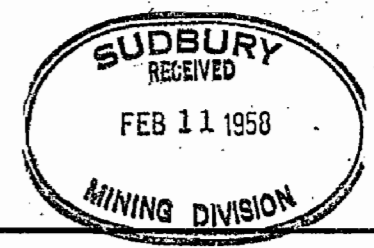

PLAN NO. - M-1122 -

DEPARTMENT OF MINES
- ONTARIO -

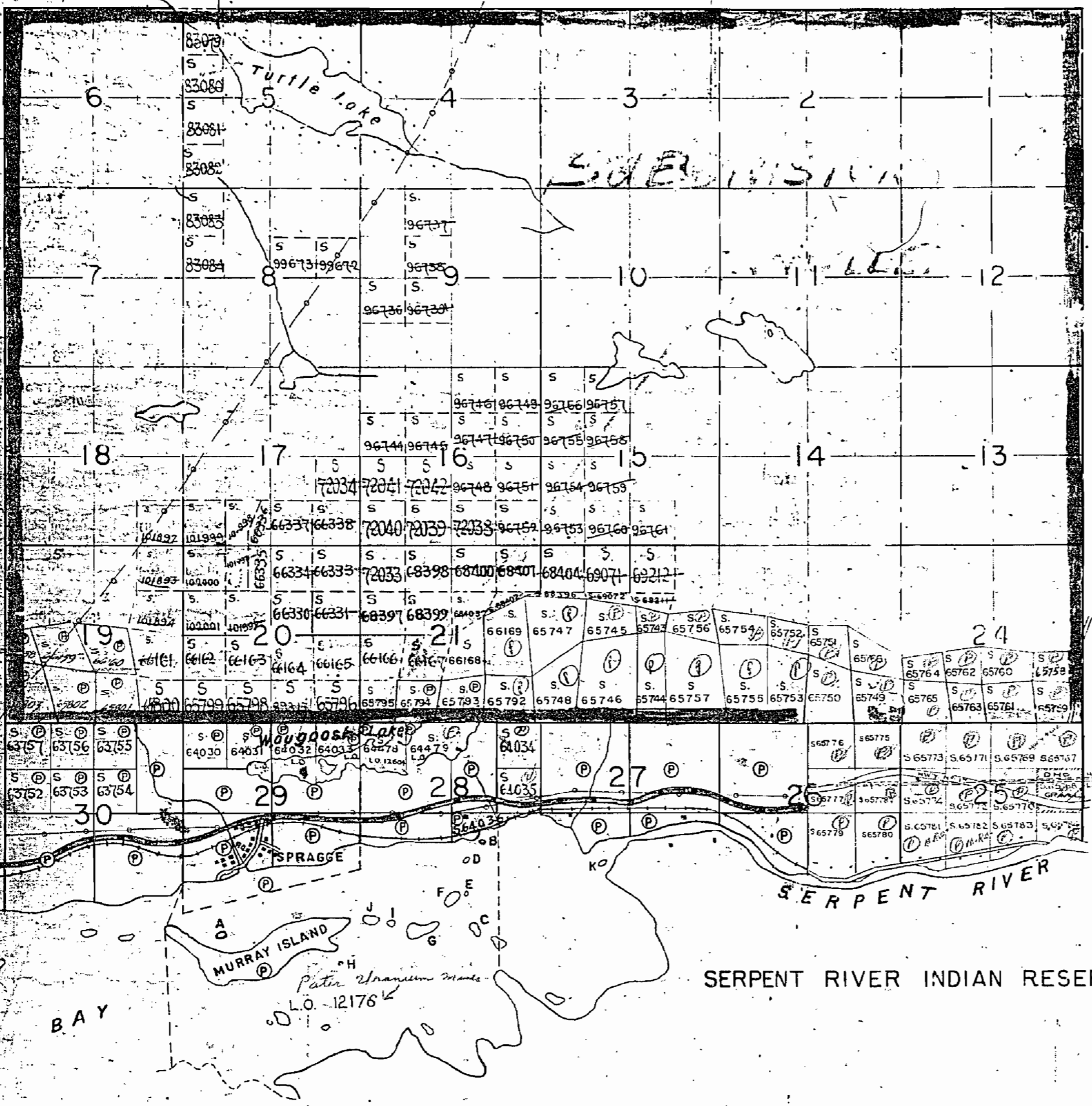

LONG TWP.

LEWIS TWP.

SERPENT RIVER INDIAN RESERVE

MURRAY ISLAND
Pat. Uranium mine
L.O. 12176

1122

SPRAGGE

West

Scale, 40 Chains one Inch

WEST



LAKE HURON

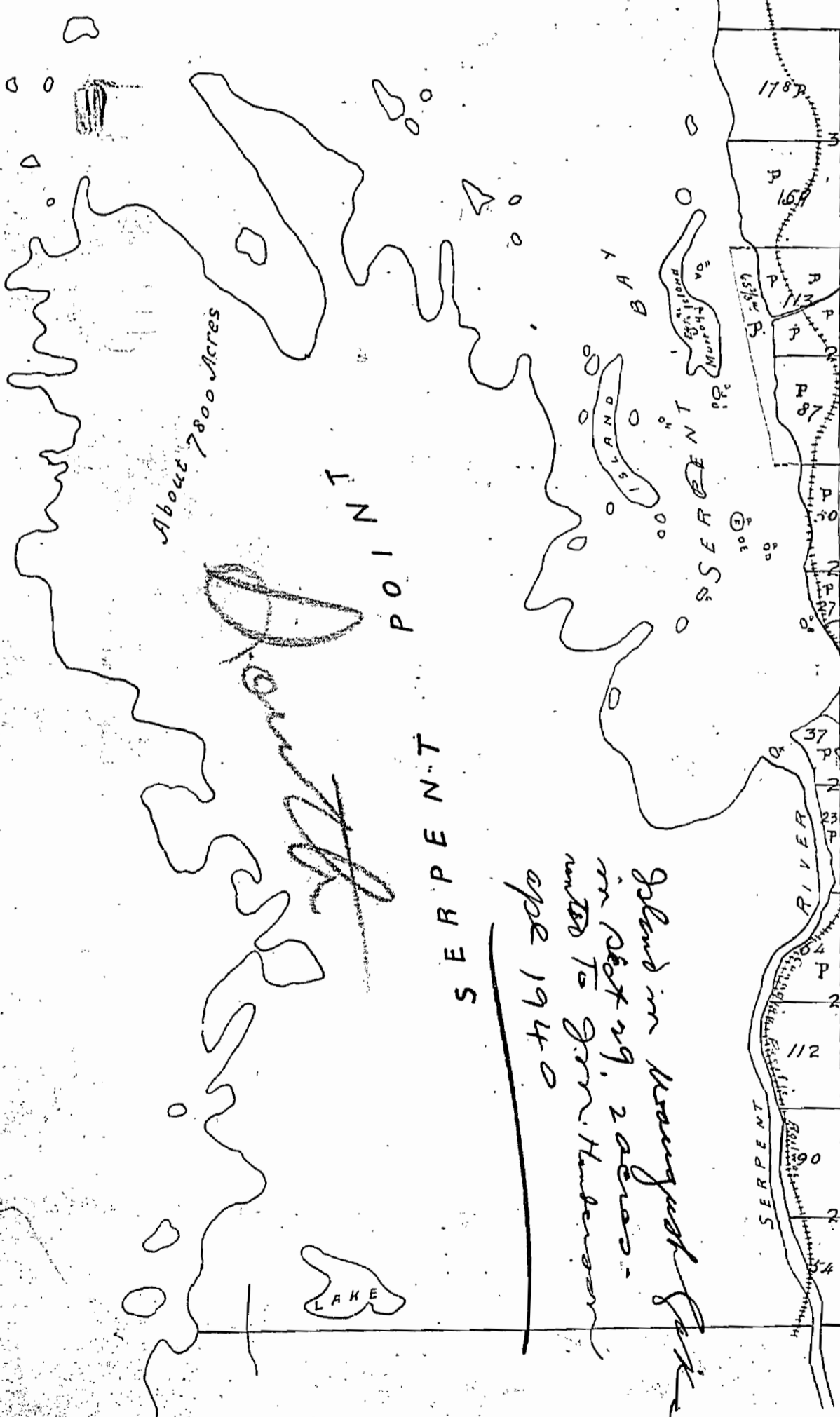

SERPENTINE

Island in Keweenaw Park
in Oct 29, 20 acres
added to Gen. Huron
Apr 1940

| | | | | | | | | | |
|------|------|-----|-----|-----|-----|-----|-----|-----|-----|
| 1787 | 162 | 162 | 161 | 161 | 160 | 160 | 160 | 161 | 160 |
| 30 | 162 | 162 | 161 | 161 | 160 | 160 | 161 | 158 | |
| 164 | 160 | 159 | 159 | 159 | 159 | 159 | 154 | 59 | |
| 73 | 160 | 159 | 159 | 159 | 159 | 159 | 113 | 40 | |
| 80 | 160 | 161 | 161 | 161 | 160 | 161 | 159 | 95 | |
| 28 | 143 | 157 | 161 | 161 | 161 | 160 | 161 | 158 | |
| 37 | 158P | 159 | 159 | 160 | 153 | 154 | 160 | 161 | |
| 23 | 159 | 159 | 159 | 160 | 151 | 149 | 160 | 161 | |
| 64 | 160 | 160 | 160 | 160 | 154 | 76 | 159 | 160 | |
| 26 | 112 | 160 | 160 | 160 | 159 | 157 | 159 | 160 | |
| 30 | 160 | 160 | 160 | 161 | 161 | 161 | 161 | 162 | |
| 25 | 160 | 160 | 160 | 161 | 161 | 161 | 161 | 162 | |
| 64 | 160 | 160 | 160 | 161 | 161 | 161 | 161 | 162 | |

Handwritten signature 'D. Spragg' on the right side of the map.

Handwritten signature 'D. Spragg' at the bottom center.

M1122

135

ESTEN TWP.

*Sand & Gravel for cement
Sept. Dec. 53
400' Res.
Old*

THE TOWNSHIP OF
OF
SPRAGGE
DISTRICT OF ALGOMA
SUDBURY MINING DIVISION
SCALE: 1 INCH = 40 CHAINS

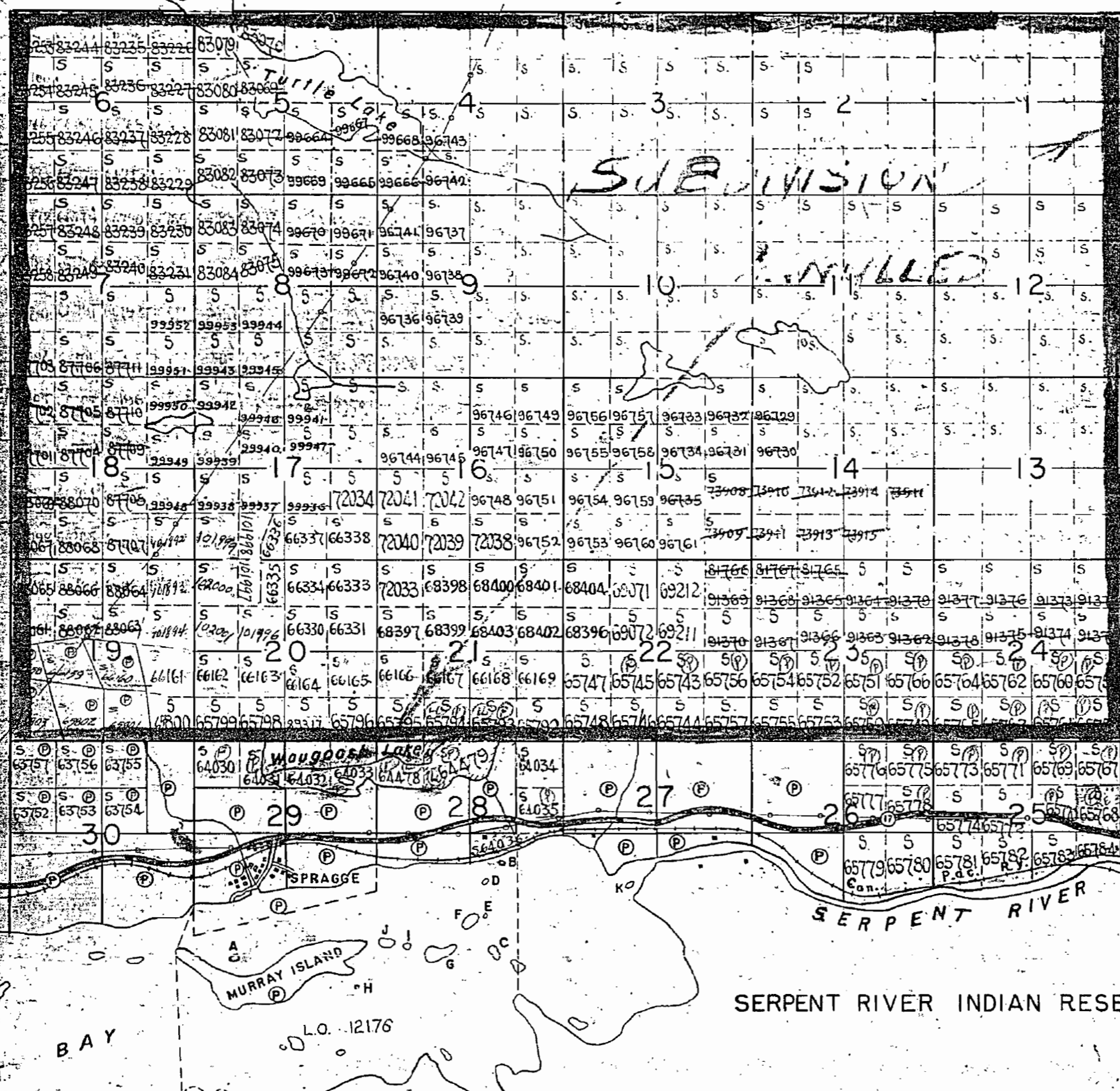

LEWIS TWP.

LEGEND

- PATENTED LAND. (P)
- CROWN LAND SALE. (S)
- LOCATED LAND. Loc.
- LICENSE OF OCCUPATION. L. O.
- ROADS. [Symbol]
- IMPROVED ROADS. [Symbol]
- RAILWAYS. [Symbol]
- POWER LINES. [Symbol]
- MARSH OR MUSKEG. [Symbol]
- KING'S HIGHWAY. [Symbol]

NOTES

SURFACE RESERVATIONS 400 FT. WIDE BY DEPT. of L. & F. SHOWN HEREON THUS: [Symbol]

ISLANDS A to K. PATENTED. (P)

MINING CLAIMS TO BE ACCEPTED SUBJECT TO SECTION 53 OF THE MINING ACT.

Land under Lake Huron withdrawn from staking by Order in Council dated April 30, 1912.

Sand and gravel on all unpatented mining claims in this township reserved to the crown.

*Amalgamated
Reserve*

ESTEN TWP.

*Sub. Sec. 53
Cancelled.*

THE TOWNSHIP OF
OF
SPRAGGE
DISTRICT OF
ALGOMA
SUDBURY
MINING DIVISION
SCALE: 1 INCH = 40 CHAINS

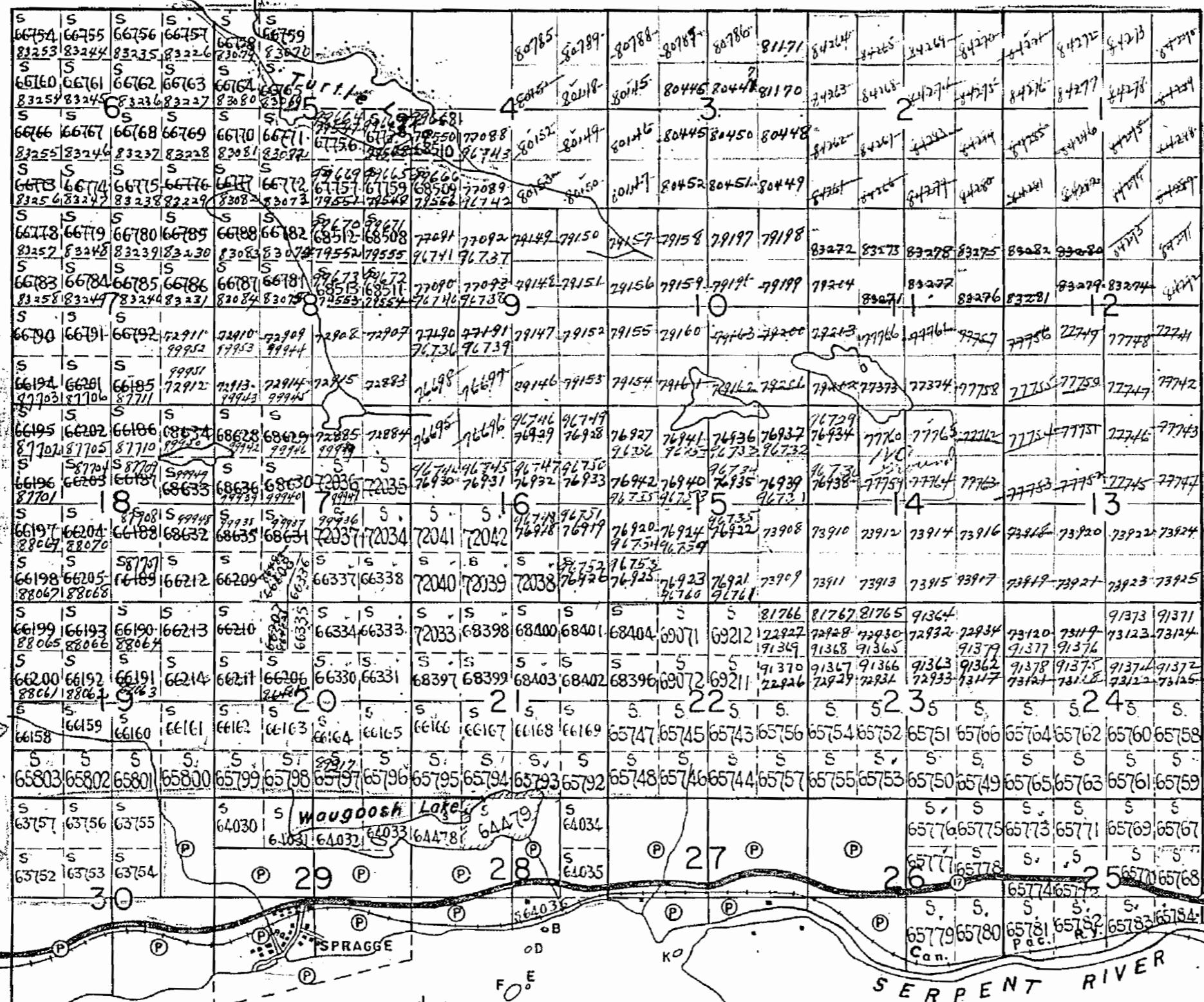

LEGEND

- PATENTED LAND (P)
- CROWN LAND SALE (S)
- LOCATED LAND Loc.
- LICENSE OF OCCUPATION L.O.
- ROADS [Symbol]
- IMPROVED ROADS [Symbol]
- RAILWAYS [Symbol]
- POWER LINES [Symbol]
- MARSH OR MUSKIEG [Symbol]
- KING'S HIGHWAY [Symbol]

NOTES

SURFACE RESERVATIONS 200 FT. WIDE BY DEPT. OF L. & F. SHOWN HEREON THUS :-

ISLANDS A to K PATENTED (P)

MINING CLAIMS TO BE ACCEPTED SUBJECT TO SECTION 53 OF THE MINING ACT.

400' Res

SPRAGGE TWP.

LONG TWP.

LEWIS TWP.

SERPENT RIVER INDIAN RESERVE

SERPENT BAY

M. 1122

PLAN NO. -S. 479-

DEPARTMENT OF MINES
-ONTARIO-

1122

ESTEN TWP. *all claims*











Subs Sec 53

THE TOWNSHIP OF
OF
SPRAGGE

DISTRICT OF
ALGOMA
SUDBURY
MINING DIVISION

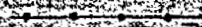
SCALE: 1 INCH = 40 CHAINS

LEGEND

- PATENTED LAND 
- CROWN LAND SALE 
- LOCATED LAND 
- LICENSE OF OCCUPATION 
- ROADS 
- IMPROVED ROADS 
- RAILWAYS 
- POWER LINES 
- MARSH OR MUSKEG 
- KING'S HIGHWAY 

NOTES

SURFACE RESERVATIONS - 200 FT. WIDE BY DEPT. OF L. & F. SHOWN HEREON THUS 

ISLANDS ARE PATENTED 

MINING CLAIMS TO BE ACCEPTED SUBJECT TO SECTION 53 OF THE MINING ACT

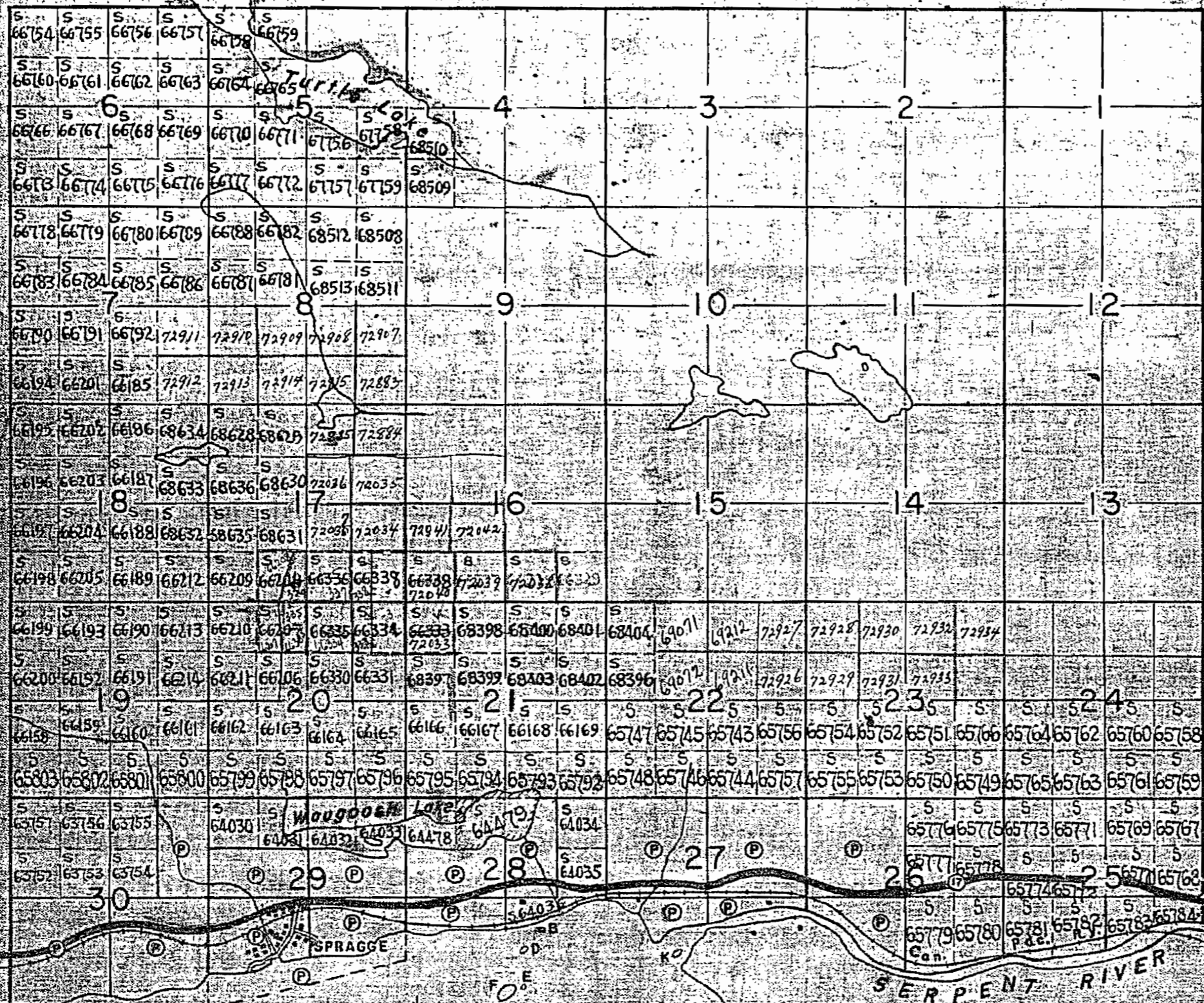

SERPENT RIVER INDIAN RESERVE

M 1122

PLAN NO. S 479

DEPARTMENT OF MINES
- ONTARIO -

AM

G-3329

SPRAGGE TWP

G-3329

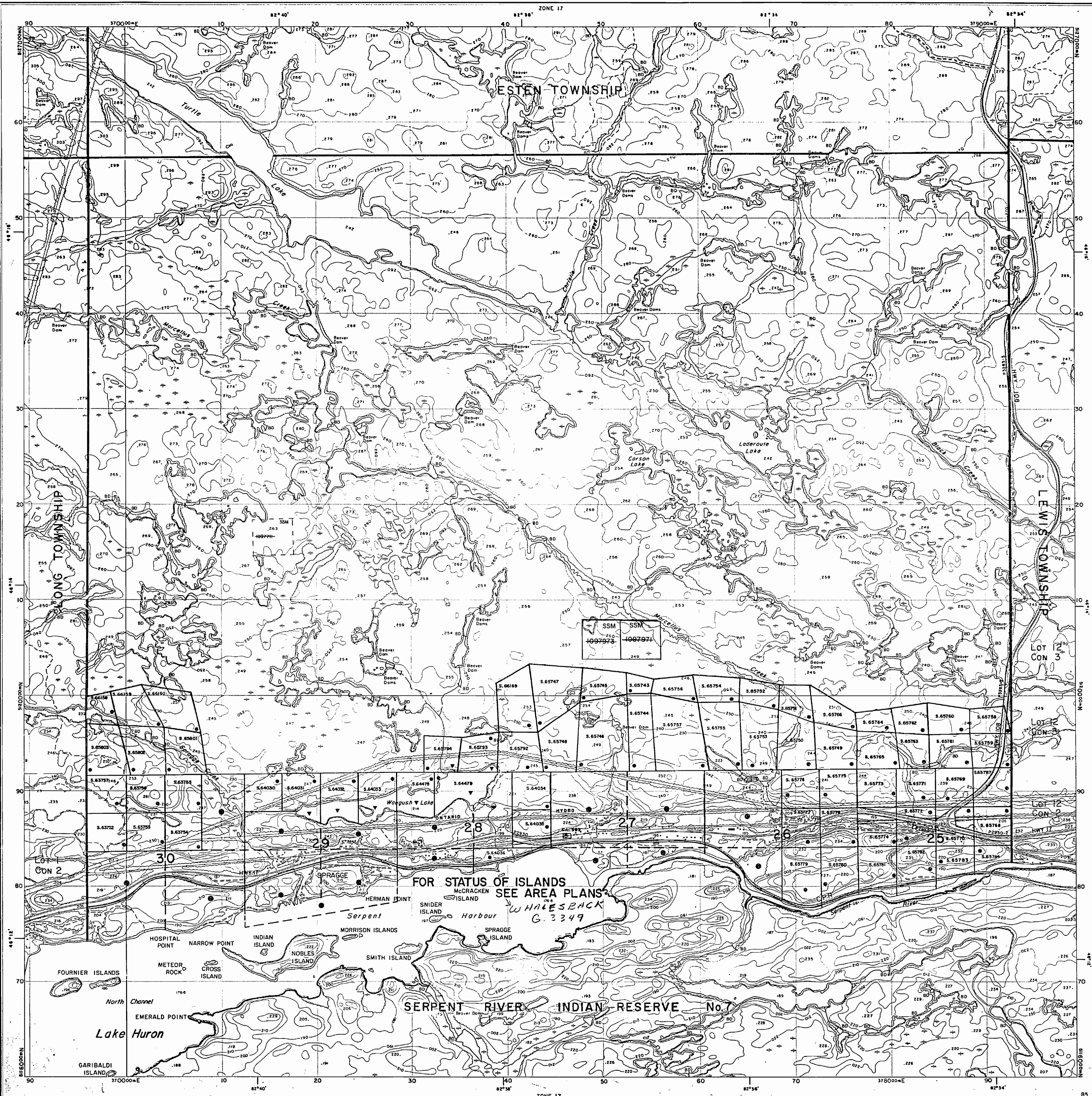

INDEX TO LAND DISPOSITION
 PLAN
G-3329
 TOWNSHIP
SPRAGGE

M.N.R. ADMINISTRATIVE DISTRICT
BLIND RIVER
 MINING DIVISION
SAULT STE. MARIE
 LAND TITLES/REGISTRY DIVISION
ALGOMA

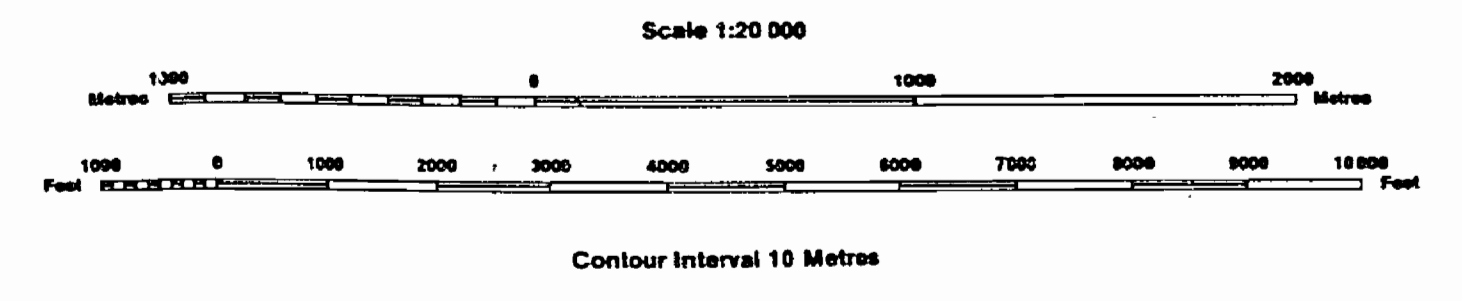

SYMBOLS

| | |
|---------------------------------|-------|
| Boundary | |
| Township, Meridian, Baseline | |
| Road allowance; surveyed | |
| shoreline | |
| Lot/Concession; surveyed | |
| unsurveyed | |
| Parcel; surveyed | |
| unsurveyed | |
| Right-of-way; road | |
| railway | |
| utility | |
| Reservation | |
| Cliff, Pit, Pile | |
| Contour | |
| Interpolated | |
| Approximate | |
| Depression | |
| Control point (horizontal) | |
| Flooded land | |
| Mine head frame | |
| Pipeline (above ground) | |
| Railway; single track | |
| double track | |
| abandoned | |
| Road; highway, county, township | |
| access | |
| trail, bush | |
| Shoreline (original) | |
| Transmission line | |
| Wooded area | |

AREAS WITHDRAWN FROM DISPOSITION
 MRO - Mining Rights Only
 SRO - Surface Rights Only
 M+S - Mining and Surface Rights

| Description | Order No. | Date | Disposition | File |
|-------------|-----------|------|-------------|------|
| | | | | |

ANNULMENT
 SUBDIVISION OF THIS TOWNSHIP INTO LOTS AND CONCESSIONS WAS PARTIALLY ANNULLED ON JANUARY 9, 1954.

NOTES
 THIS TOWNSHIP LIES WITHIN THE IMPROVEMENT DISTRICT OF THE NORTH SHORE.
 ALL MINING CLAIMS STAKED IN THIS TOWNSHIP ARE SUBJECT TO SECTION 54 OF THE MINING ACT, (R.S.O. 1970).

ISLANDS IN LAKE HURON FRONTING THIS TOWNSHIP ARE WITHDRAWN FROM STAKING W/183 PL. OCTOBER 4, 1963, FILE 188505

DISPOSITION OF CROWN LANDS

| | |
|-------------------------|-------|
| Patent | |
| Surface & Mining Rights | |
| Surface Rights Only | |
| Mining Rights Only | |
| Lease | |
| Surface & Mining Rights | |
| Surface Rights Only | |
| Mining Rights Only | |
| Licence of Occupation | |
| Order-in-Council | |
| Cancelled | |
| Reservation | |
| Sand & Gravel | |

THE INFORMATION THAT APPEARS ON THIS MAP HAS BEEN COMPILED FROM VARIOUS SOURCES AND ACCURACY IS NOT GUARANTEED. THOSE WISHING TO STAKE MINING CLAIMS SHOULD CONSULT WITH THE MINING RECORDER, MINISTRY OF NORTHERN DEVELOPMENT AND MINES, FOR ADDITIONAL INFORMATION ON THE STATUS OF THE LANDS SHOWN HEREON.

S. S. MARIE
RECEIVED
 MAR 11 1964
 12103456

The 1975 Magnetic Bearing Approx. Annual Change is increasing 1.40"

Esten Twp.-M.792

THE TOWNSHIP OF OF

SPRAGGE

DISTRICT OF ALGOMA

SAULT STE. MARIE MINING DIVISION

SCALE:1-INCH=40 CHAINS

LEGEND

| | |
|-----------------------|---------|
| PATENTED LAND | ● or ⊕ |
| CROWN LAND SALE | C.S. |
| LEASES | Ⓛ |
| LOCATED LAND | Loc. |
| LICENSE OF OCCUPATION | L.O. |
| MINING RIGHTS ONLY | M.R.O. |
| SURFACE RIGHTS ONLY | S.R.O. |
| ROADS | — — — — |
| IMPROVED ROADS | — — — — |
| KING'S HIGHWAYS | — — — — |
| RAILWAYS | — — — — |
| POWER LINES | — — — — |
| MARSH OR MUSKEG | * * * |
| MINES | Ⓧ |
| CANCELLED | Ⓧ |
| PATENTED S.R.O. | Ⓧ |

NOTES

400' surface rights reservation along the shores of all lakes and rivers.

Land under water in Lake Huron withdrawn from staking by Order in Council dated April 30, 1912.

All mining claims staked in this township subject to Sec. 54 of the Mining Act (R.S.O. 1970).

This township lies within the Township of the North Shore.

G.3329

PLAN NO.- M.1122

ONTARIO

MINISTRY OF NATURAL RESOURCES

SURVEYS AND MAPPING BRANCH

Long Twp.-M.1300

Lewis Twp.-M.988

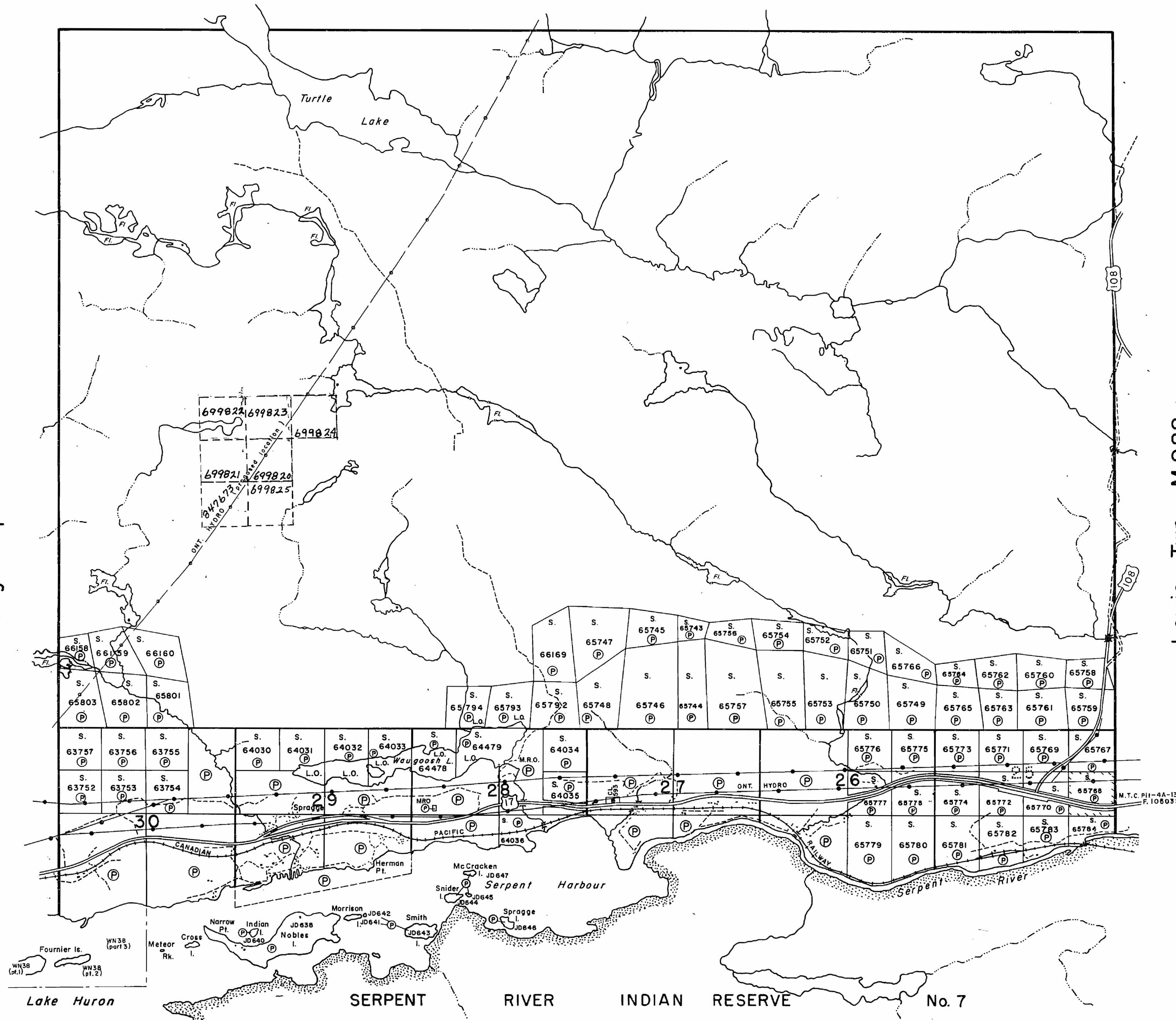

NOTE
SURFACE AND MINING RIGHTS OF ISLANDS IN THE NORTH CHANNEL OF LAKE HURON FRONTING THIS TOWNSHIP ARE WITHDRAWN FROM STAKING - ORDER W.12/83 OCT. 4, 1983 FILE 188505

M.2773

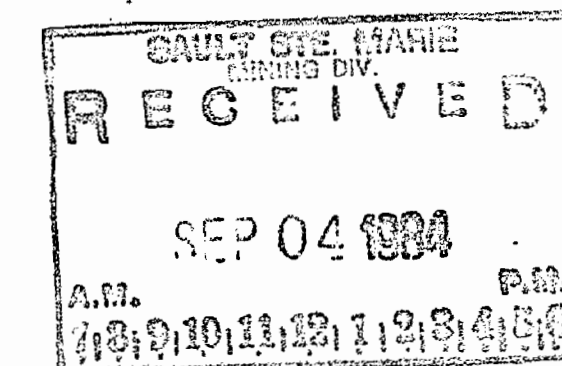

Revised by G.3329 - March 17/86 M.H.

THE TOWNSHIP
OF

SPRAGGE

DISTRICT OF
ALGOMA

SAULT STE. MARIE
MINING DIVISION

SCALE: 1-INCH=40 CHAINS

LEGEND

| | |
|-----------------------|--------|
| PATENTED LAND | (P) |
| CROWN LAND SALE | C.S. |
| LEASES | (L) |
| LOCATED LAND | Loc. |
| LICENSE OF OCCUPATION | L.O. |
| MINING RIGHTS ONLY | M.R.O. |
| SURFACE RIGHTS ONLY | S.R.O. |
| ROADS | — |
| IMPROVED ROADS | — |
| KING'S HIGHWAYS | — |
| RAILWAYS | — |
| POWER LINES | — |
| MARSH OR MUSKEG | — |
| MINES | ✕ |
| CANCELLED | C. |

NOTES

400' Surface Rights Reservation around
all lakes & rivers

Land under water in Lake Huron withdrawn
from staking by Order in Council dated
April 30, 1912.

Sand and gravel on all unpatented mining
claims in this Twp. reserved to the Crown.

Islands in Lake Huron withdrawn from
staking File 58528

All mining claims staked within this Twp.
subject to Section 53 of the Mining Act.

DATE OF ISSUE
SEP 22 1975
SR+MR of
Islands in
North Channel
are withdrawn from staking
See ORDER # W. 12/83 - Oct 1983
of Islands in the
North Channel of Lake Huron are reserved for
prospecting see ORDER # 2-4152 dated Feb 24/82
Blind River

PLAN NO. - **M.1122**

MINISTRY OF NATURAL RESOURCES

SURVEYS AND MAPPING BRANCH

Esten Twp - M.792

Long Twp - M.1300

Lewis Twp - M.988

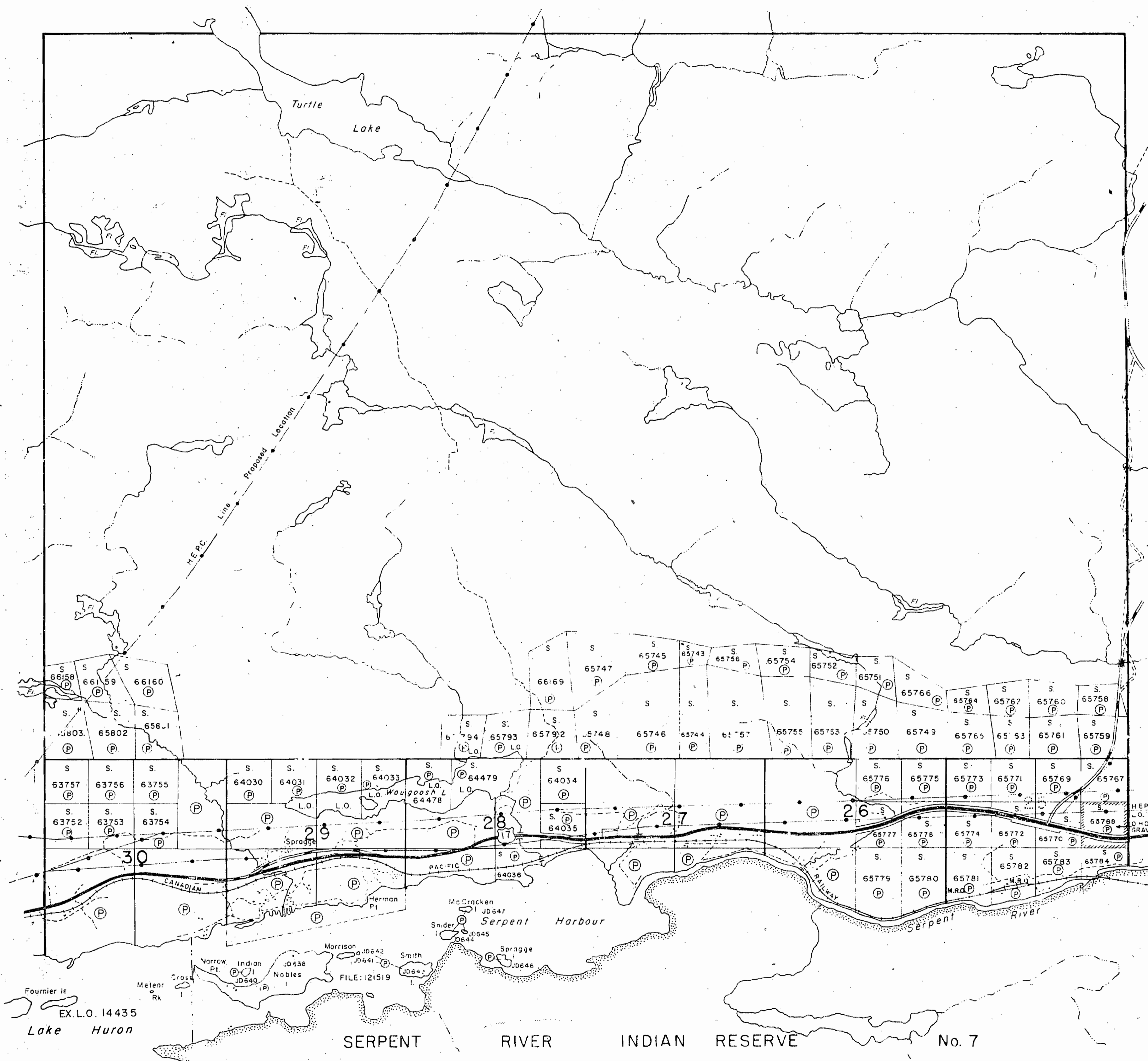

M.2773

Replaced by mylar Sept 4/84

G.3329

1122

ESTEN TWP.

old
sect. 53

THE TOWNSHIP
OF
SPRAGGE
DISTRICT OF
ALGOMA
SUDBURY
MINING DIVISION
SCALE: 1 INCH = 40 CHAINS

LEGEND

- PATENTED LAND (P)
- CROWN LAND SALE (S)
- LOCATED LAND Loc.
- LICENSE OF OCCUPATION L.O.
- ROADS [Symbol]
- IMPROVED ROADS [Symbol]
- RAILWAYS [Symbol]
- POWER LINES [Symbol]
- MARSH OR MUSKEG [Symbol]
- KING'S HIGHWAY [Symbol]

NOTES

SURFACE RESERVATIONS 400 FT. WIDE BY DEPT. OF L. & F. SHOWN HEREON THUS: [Symbol]

ISLANDS A to K PATENTED (P)

MINING CLAIMS TO BE ACCEPTED SUBJECT TO SECTION 53 OF THE MINING ACT.

Land under Lake Huron withdrawn from staking by Order in Council dated April 30, 1912.

Sand and gravel on all unpatented mining claims in this township reserved to the crown.

Islands in Lake Huron withdrawn from staking Nov. 23/26 Sect. 39 Sub. (c)

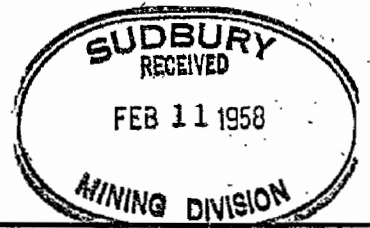

PLAN NO. - M-1122 -

DEPARTMENT OF MINES
- ONTARIO -

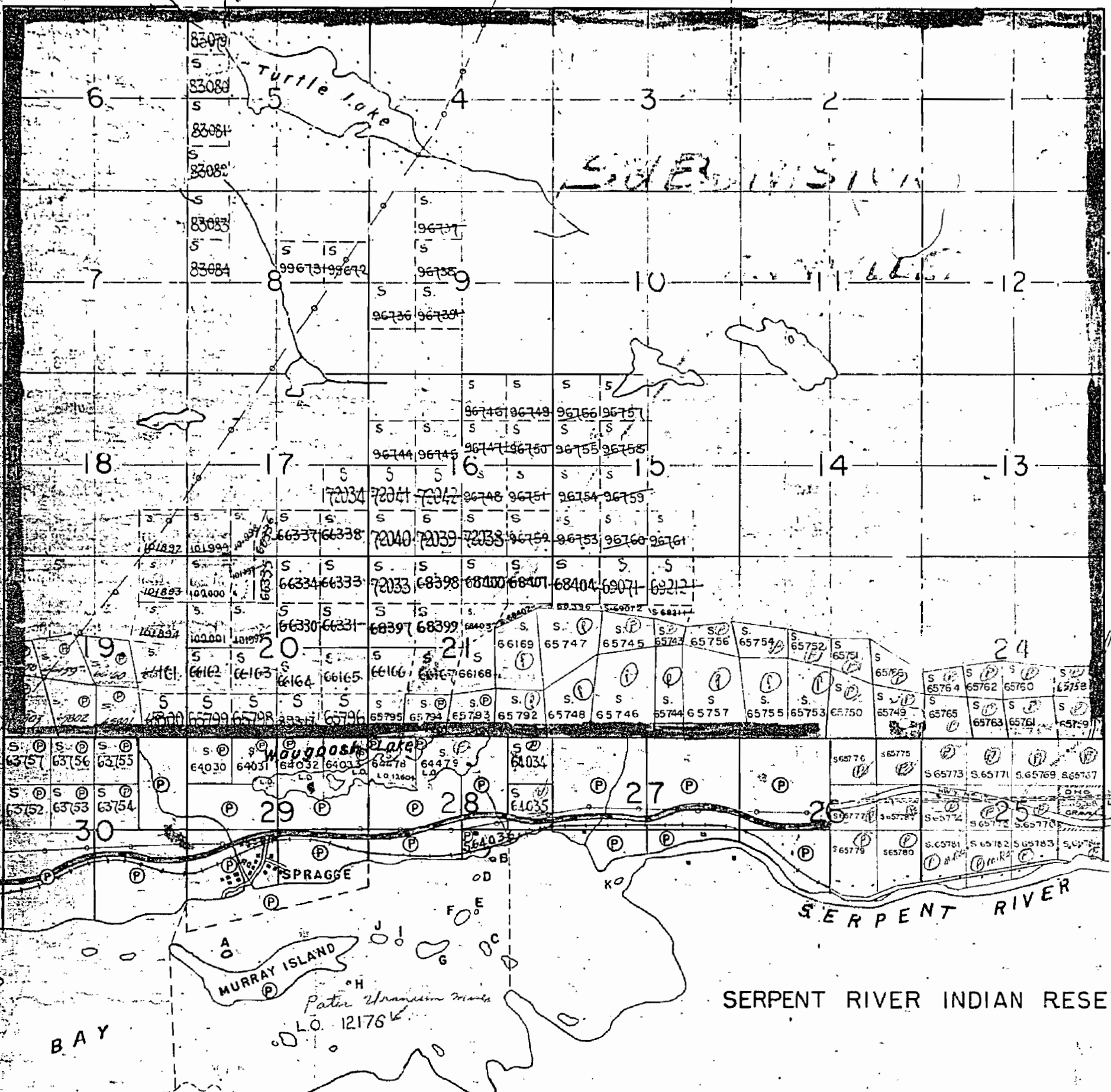

LONG TWP.

LEWIS TWP.

SERPENT RIVER INDIAN RESERVE

ESTEN TWP.

*Sand & Gravel for cleared
July 4, Sec. 53
400' Res.*

Old

THE TOWNSHIP
OF
SPRAGGE
DISTRICT OF
ALGOMA
SUDBURY
MINING DIVISION
SCALE: 1 INCH = 40 CHAINS

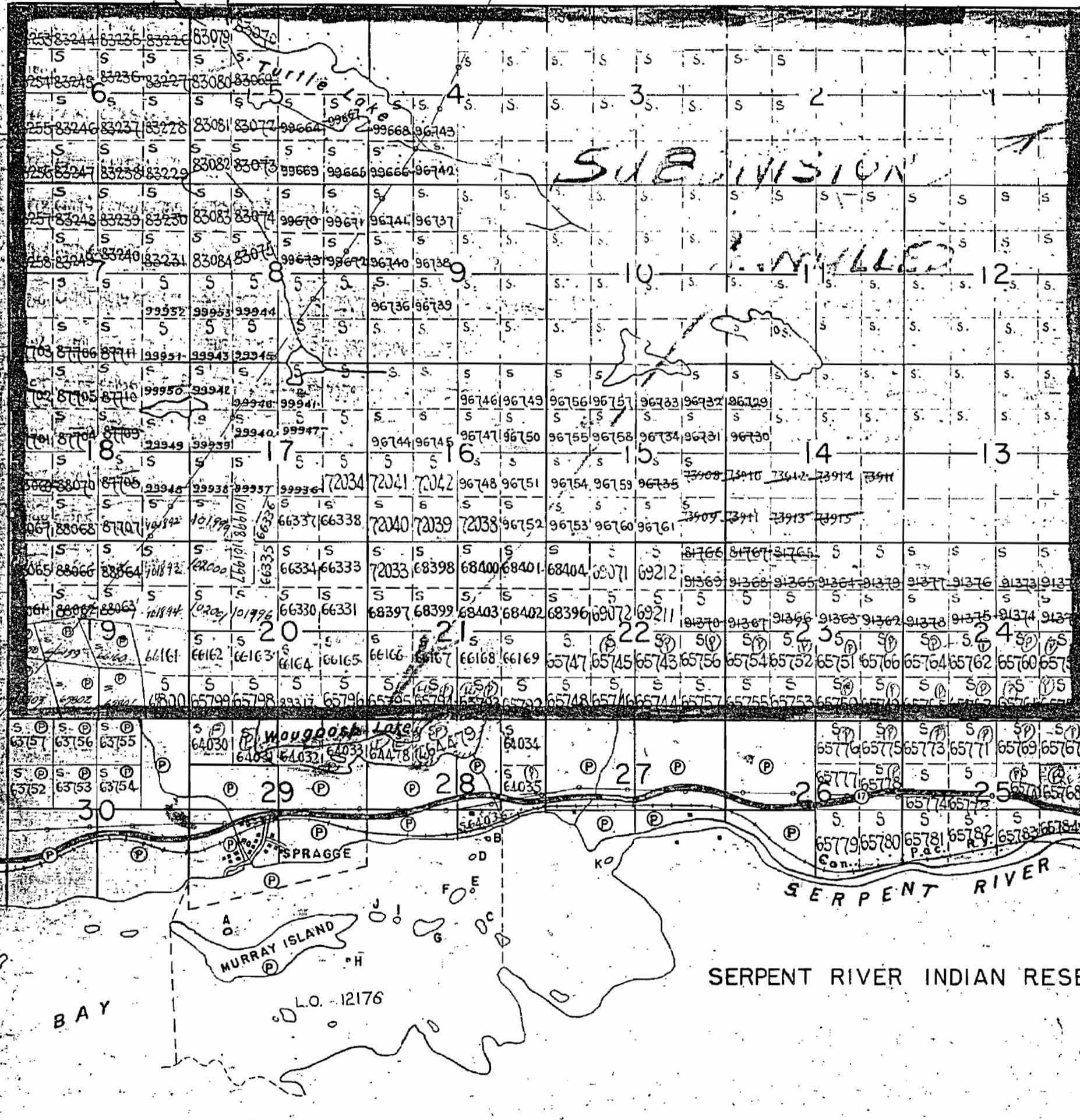

LEGEND

- PATENTED LAND (P)
- CROWN LAND SALE (S)
- LOCATED LAND Loc.
- LICENSE OF OCCUPATION L.O.
- ROADS [Symbol]
- IMPROVED ROADS [Symbol]
- RAILWAYS [Symbol]
- POWER LINES [Symbol]
- MARSH OR MUSKEG [Symbol]
- KING'S HIGHWAY [Symbol]

NOTES

SURFACE RESERVATIONS 400 FT. WIDE BY DEPT. OF L. & F. SHOWN HEREON THUS: -

ISLANDS A to K. PATENTED (P)

MINING CLAIMS TO BE ACCEPTED SUBJECT TO SECTION 53 OF THE MINING ACT.

Land under Lake Huron withdrawn from sinking by Order in Council dated April 30, 1912.

Sand and gravel on all unpatented mining claims in this township reserved to the crown.

PLAN NO. - M-1122 -

DEPARTMENT of MINES
- ONTARIO -

1122

ESTEN TWP. *all claims Subj Sec 53*

THE TOWNSHIP OF
OF
SPRAGGE

DISTRICT OF
ALGOMA

SUDBURY
MINING DIVISION

SCALE 1 INCH = 40 CHAINS

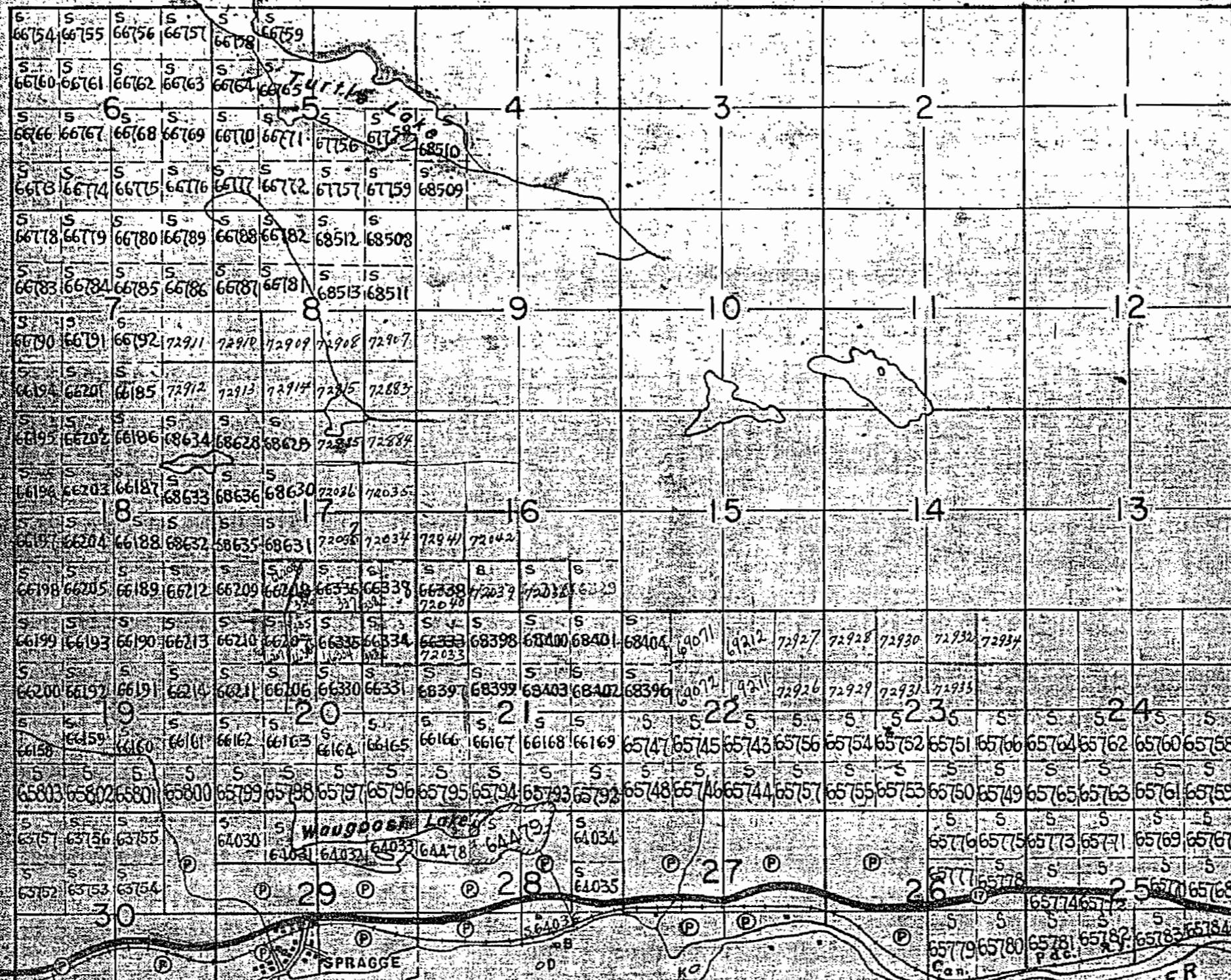

LEGEND

- PATENTED LAND
- CROWN LAND SALE
- LOCATED LAND L.O.
- LICENSE OF OCCUPATION L.O.
- ROADS
- IMPROVED ROADS
- RAILWAYS
- POWER LINES
- MARSH OR MUSKEG
- KING'S HIGHWAY

NOTES

SURFACE RESERVATIONS 200 FT. WIDE BY DEPT. OF L. & F. SHOWN HEREON THUS

ISLANDS ALSO PATENTED

MINING CLAIMS TO BE ACCEPTED SUBJECT TO SECTION 53 OF THE MINING ACT

M 1122

PLAN NO. S 479

DEPARTMENT OF MINES
—ONTARIO—

*Amalgamated
Subdivision*

*Subd. Sec. 53
Annulled.*

ESTEN TWR

SPRAGGE TWP

LONG TWP

LEWIS TWP

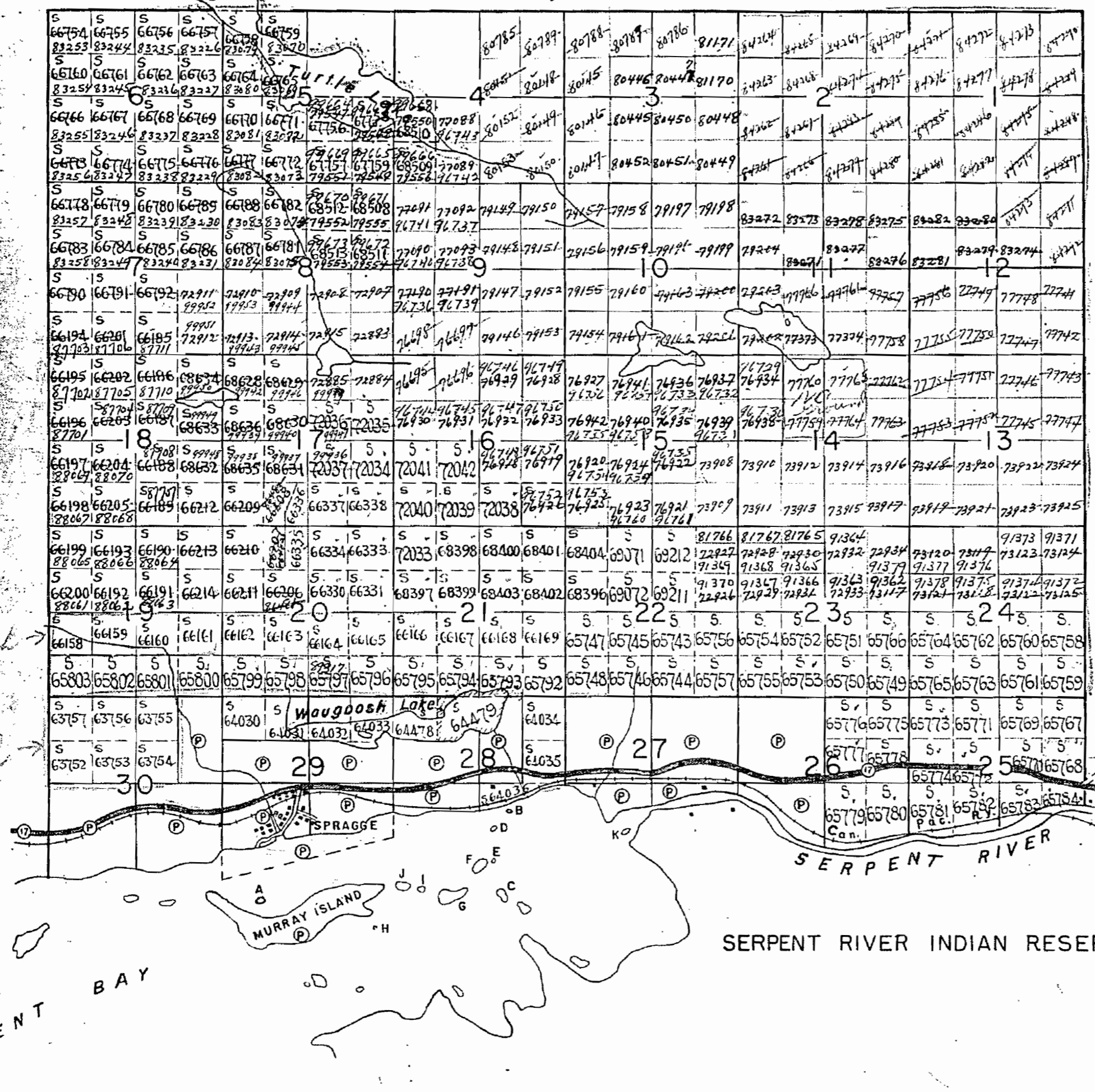

THE TOWNSHIP OF
OF
SPRAGGE
DISTRICT OF ALGOMA
SUDBURY MINING DIVISION
SCALE: 1 INCH = 40 CHAINS

LEGEND

| | |
|-----------------------|-----------|
| PATENTED LAND | Ⓟ |
| CROWN LAND SALE | Ⓢ |
| LOCATED LAND | Loc. |
| LICENSE OF OCCUPATION | L.O. |
| ROADS | — — — — — |
| IMPROVED ROADS | — — — — — |
| RAILWAYS | — — — — — |
| POWER LINES | — — — — — |
| MARSH OR MUSKIEG | — — — — — |
| KING'S HIGHWAY | — — — — — |

NOTES

SURFACE RESERVATIONS 200 FT. WIDE BY DEPT. OF L. & F. SHOWN HEREON THUS: —

ISLANDS A to K PATENTED Ⓟ

MINING CLAIMS TO BE ACCEPTED SUBJECT TO SECTION 53 OF THE MINING ACT.

*only more clearing
— 400' Res*

M. 1122

PLAN NO. —S. 479—
DEPARTMENT OF MINES
—ONTARIO—

SPRAGGE

West

Scale, 40 Chains one Inch

WEST

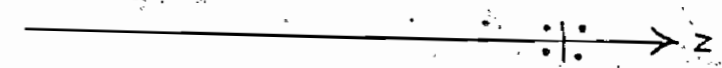

LAKE HURON

About 7800 Acres

Point

POINT

SERPENT

*Island in Waungash Lake
in Oct 29, 2000.
under to Gen. Harrison
Apr 1940*

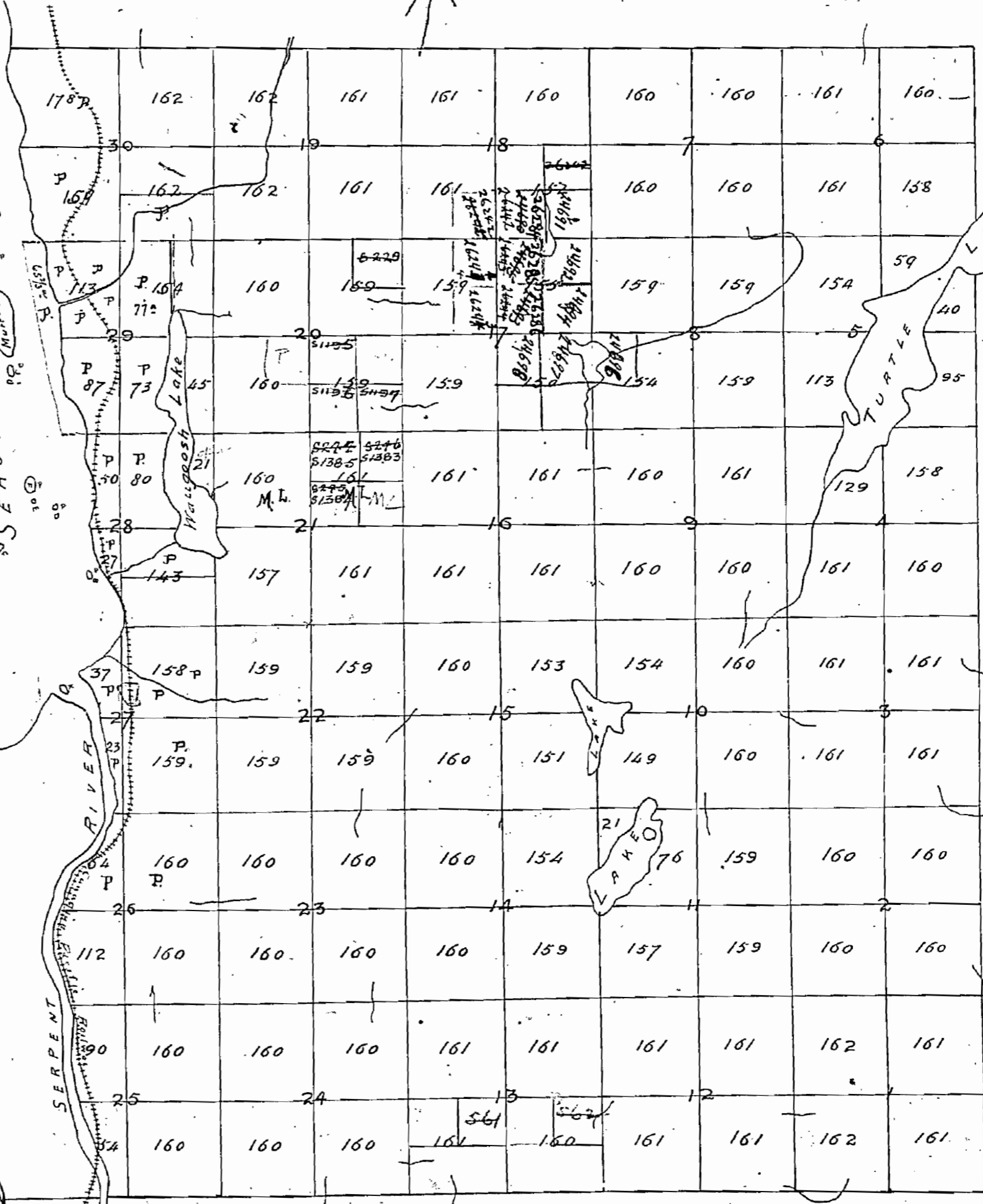

Mark

S

E

M1122