

OF
SPRINGER
 DISTRICT OF
 NIPISSING
 SUDBURY
 MINING DIVISION
 SCALE: 1-INCH=40 CHAINS

LEGEND

PATENTED LAND	(P)
CROWN LAND SALE	C.S.
LEASES	(L)
LOCATED LAND	Loc.
LICENSE OF OCCUPATION	L.O.
ROADS	(---)
IMPROVED ROADS	(=)
KING'S HIGHWAY	(=)
RAILWAYS	(=)
POWER LINES	(=)
MARSH OR MUSKEG	(---)

NOTES

400' Surface Rights Reservation around all lakes & rivers.

Geodetic survey posts shown thus: (Δ)

All land under water in Town of Sturgeon Falls part of the original bed of Sturgeon R. 14.30 acres, patented - Abitibi Power and Paper Company.

Lake Nipissing:
 - Land under water withdrawn from staking by Order in Council dated April 30, 1912.
 - Islands - withdrawn from staking. File: 67051.

Flooding Rights reserved to elevation 645.00 C.G.S. Datum. File: 81049

CL. 2518 WATER LOT LOCATION (PT. Bed of STURGEON RIVER) opposite Lots C and D TOWN OF STURGEON FALLS.

CL. 2753 WATER LOT LOCATION IN STURGEON RIVER IN FRONT OF LOTS, Col. C

CL. 2802 WATER LOT LOCATION IN STURGEON RIVER IN FRONT OF LOTS, Col. B

DT-152 PLAN 36R-6577 WATER LOT LOCATION LOT, CON A 'LAND ROLL FILE'

DATE OF ISSUE
 JUN 2 1978

OFFICE USE ONLY

SPRINGER
 PLAN NO. - M-1123
 ONTARIO
 MINISTRY OF NATURAL RESOURCES
 SURVEYS AND MAPPING BRANCH

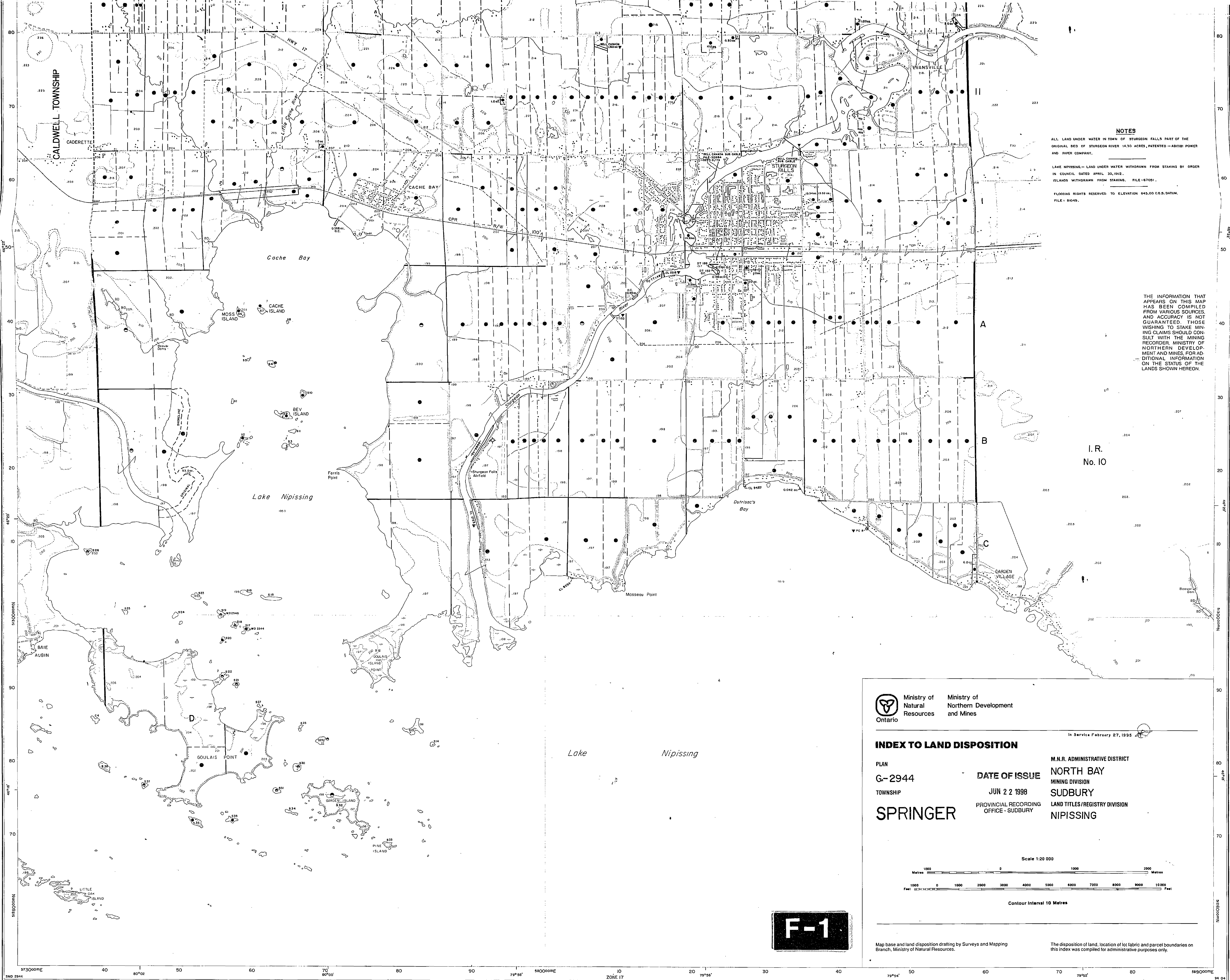

NOTES

ALL LAND UNDER WATER IN TOWN OF STURGEON FALLS PART OF THE ORIGINAL BED OF STURGEON RIVER 14.30 ACRES, PATENTED - ARBITR POWER AND PAPER COMPANY.

LAKE NIPISSING - LAND UNDER WATER WITHDRAWN FROM STAKING BY ORDER IN COUNCIL DATED APRIL 30, 1912.

ISLANDS WITHDRAWN FROM STAKING. FILE 187051.

FLOODING RIGHTS RESERVED TO ELEVATION 645.00 C.G.S. DATUM. FILE 181049.

THE INFORMATION THAT APPEARS ON THIS MAP HAS BEEN COMPILED FROM VARIOUS SOURCES AND ACCURACY IS NOT GUARANTEED. THOSE WISHING TO STAKE MINING CLAIMS SHOULD CONSULT WITH THE MINING RECORDER, MINISTRY OF NORTHERN DEVELOPMENT AND MINES FOR ADDITIONAL INFORMATION ON THE STATUS OF THE LANDS SHOWN HEREON.

I. R.
No. 10



Ministry of Natural Resources
Ontario

Ministry of Northern Development and Mines

In Service February 27, 1993

INDEX TO LAND DISPOSITION

<p>PLAN G-2944</p> <p>TOWNSHIP SPRINGER</p>	<p>DATE OF ISSUE JUN 2 2 1998</p> <p>PROVINCIAL RECORDING OFFICE - SUDBURY</p>	<p>M.N.R. ADMINISTRATIVE DISTRICT NORTH BAY</p> <p>MINING DIVISION SUDBURY</p> <p>LAND TITLES/REGISTRY DIVISION NIPISSING</p>
---	---	--

Scale 1:20 000

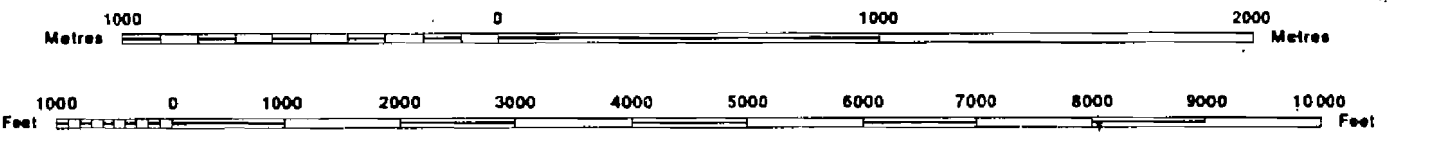

Metres: 0 1000 2000 3000 4000 5000 6000 7000 8000 9000 10000

Feet: 0 1000 2000 3000 4000 5000 6000 7000 8000 9000 10000

Contour Interval 10 Metres

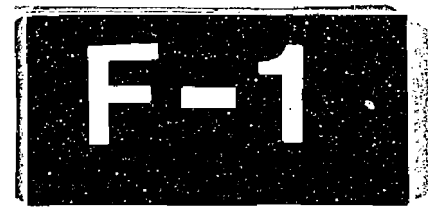

Map base and land disposition drafting by Surveys and Mapping Branch, Ministry of Natural Resources.

The disposition of land, location of lot, fabric and parcel boundaries on this index was compiled for administrative purposes only.

Field Twp.

14 13 12 11 10 9 8 7 6 5 4 3 2 1

THE TOWNSHIP
OF
SPRINGER
DISTRICT OF
NIPISSING
SUDBURY
MINING DIVISION
SCALE: 1-INCH=40 CHAINS

LEGEND

PATENTED LAND	(P)
CROWN LAND SALE	(C.S.)
LEASES	(L)
LOCATED LAND	(L.O.)
LICENSE OF OCCUPATION	(L.O.)
ROADS	—
IMPROVED ROADS	—
KING'S HIGHWAY	—
RAILWAYS	—
POWER LINES	—
MARSH OR MUSKEG	(M)

NOTES

450'
200' Reserve to Dept. of Lands & Forests shown thus:

Geodetic survey posts shown thus:

All land under water in Town of Sturgeon Falls part of the original bed of Sturgeon R. 14.30 acres, patented - Abitibi Power and Paper Company.

*Eng. Pits in pt. lot 6 in pt. lot 7 in lot 11
at 144 Chain 75
pt. lot 11 in lot 1
open June 1/10
at 10/10*

400' Res.

Caldwell Twp.

VI
V
IV
III
II
I
A
B
C

Pedley Twp.

INDIAN RESERVE

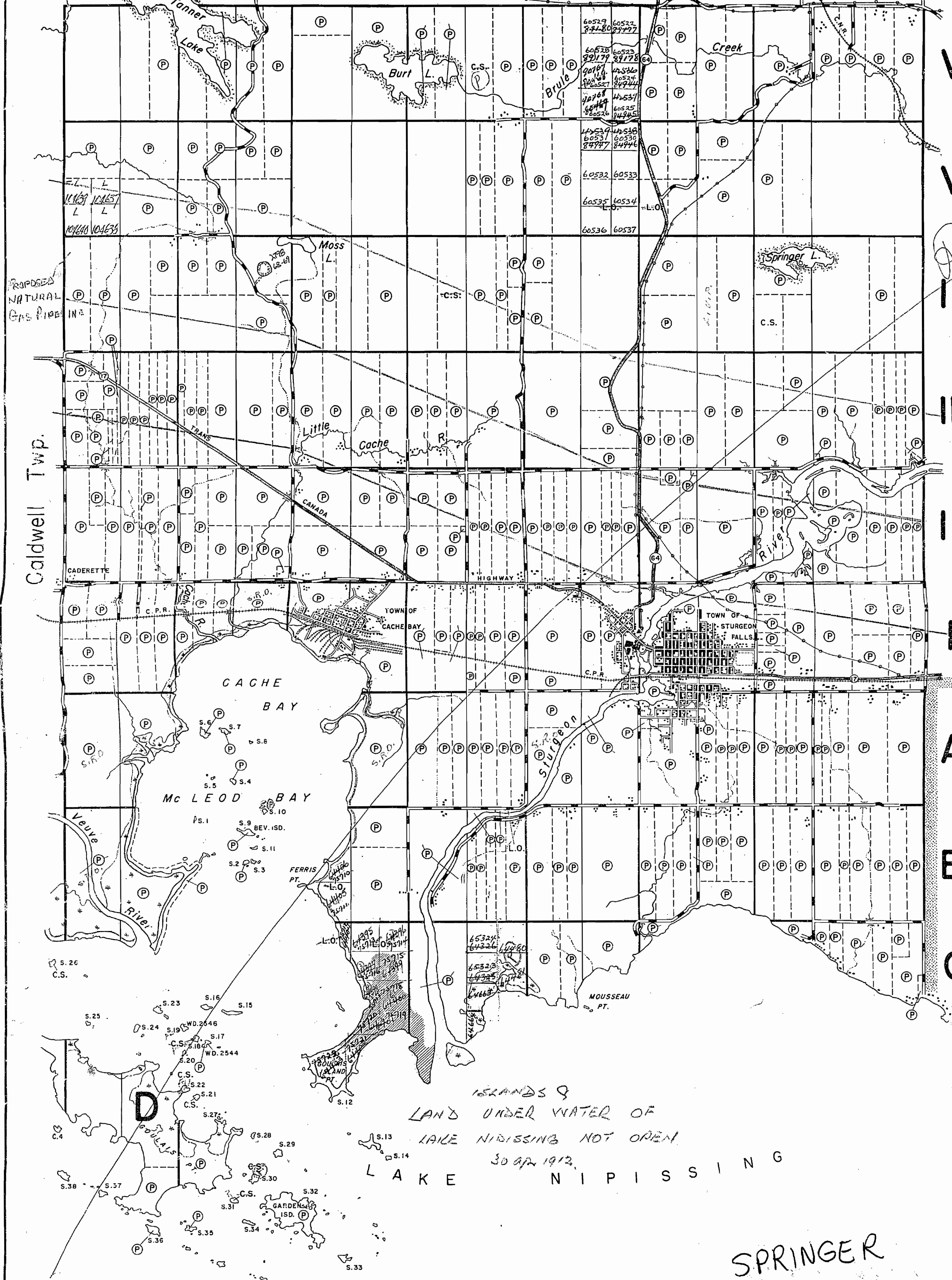

ISLANDS &
LAND UNDER WATER OF
LAKE NIPISSING NOT OPEN
30 APR 1912.
LAKE NIPISSING

SPRINGER

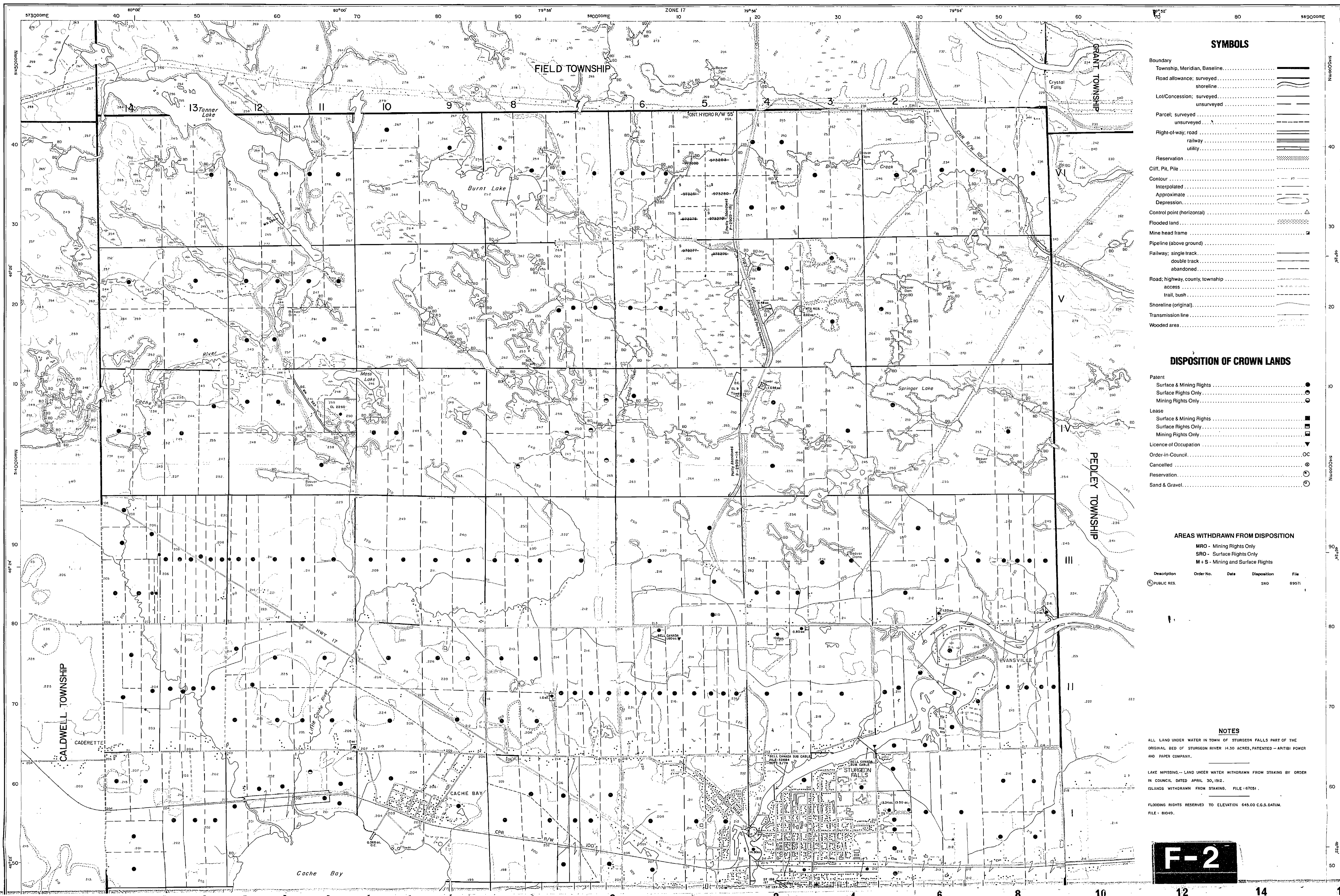

SYMBOLS

- Boundary Township, Meridian, Baseline
- Road allowance: surveyed shoreline
- Lot/Concession: surveyed unsurveyed
- Parcel: surveyed unsurveyed
- Right-of-way: road railway utility
- Reservation
- Cliff, Pit, Pile
- Contour Interpolated Approximate Depression
- Control point (horizontal)
- Flooded land
- Mine head frame
- Pipeline (above ground)
- Railway: single track double track abandoned
- Road: highway, county, township access trail, bush
- Shoreline (original)
- Transmission line
- Wooded area

DISPOSITION OF CROWN LANDS

- Patent Surface & Mining Rights Surface Rights Only Mining Rights Only
- Lease Surface & Mining Rights Surface Rights Only Mining Rights Only
- Licence of Occupation
- Order-in-Council
- Cancelled
- Reservation
- Sand & Gravel

AREAS WITHDRAWN FROM DISPOSITION

MRO - Mining Rights Only
SRO - Surface Rights Only
M + S - Mining and Surface Rights

Description	Order No.	Date	Disposition	File
PUBLIC RES.			SRO	89571

NOTES

ALL LAND UNDER WATER IN TOWN OF STURGEON FALLS PART OF THE ORIGINAL BED OF STURGEON RIVER 14.30 ACRES, PATENTED - ARITBI POWER AND PAPER COMPANY.

LAKE NIPISSING - LAND UNDER WATER WITHDRAWN FROM STAKING BY ORDER IN COUNCIL DATED APRIL 30, 1912.

ISLANDS WITHDRAWN FROM STAKING. FILE 67051.

FLOODING RIGHTS RESERVED TO ELEVATION 645.00 C.G.S. DATUM. FILE 81049.

F-2

Temp file

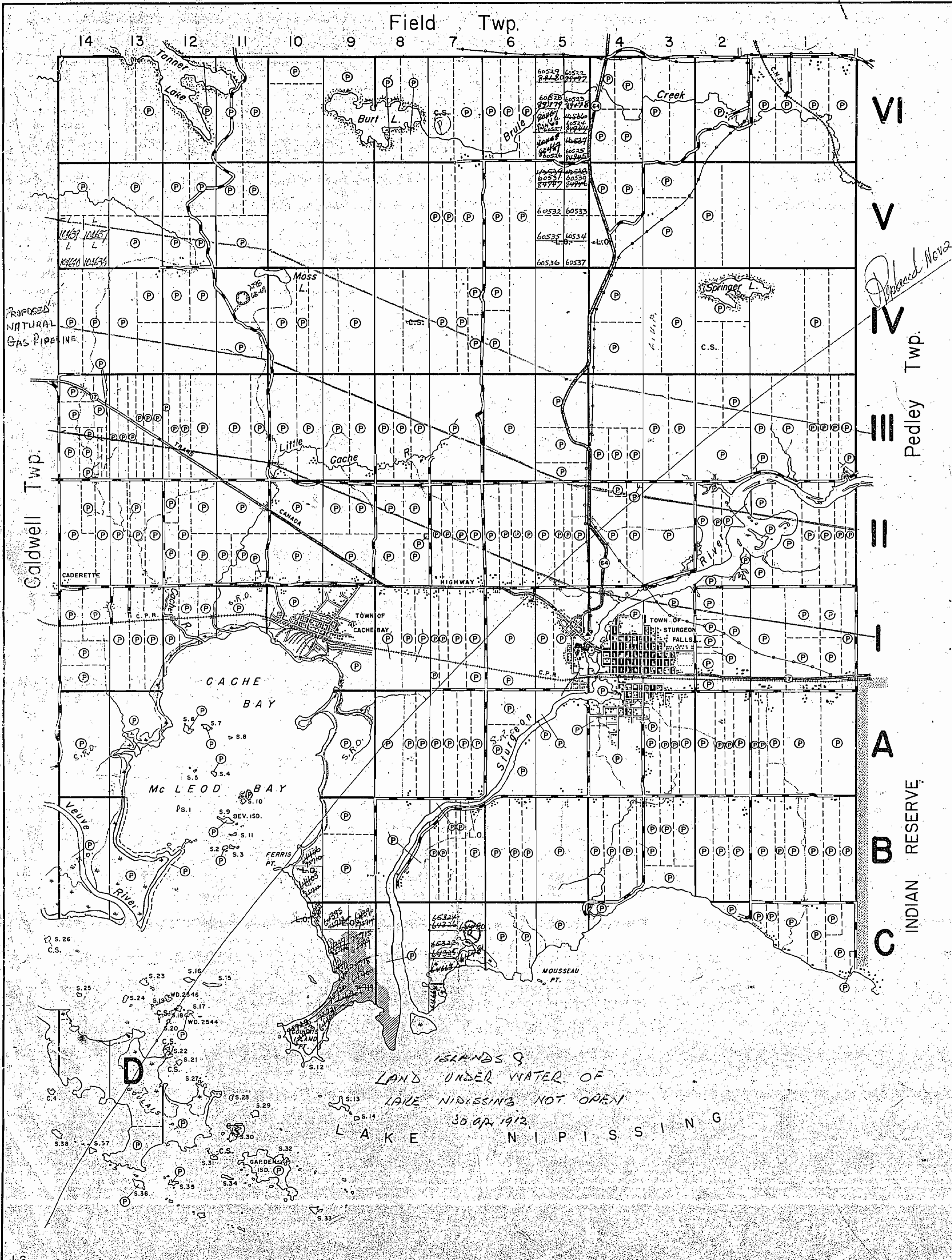

THE TOWNSHIP OF
SPRINGER
DISTRICT OF NIPISSING
SUBBURY MINING DIVISION
SCALE: 1-INCH=40 CHAINS

LEGEND

PATENTED LAND	Ⓟ
CROWN LAND SALE	C.S.
LEASES	Ⓛ
LOCATED LAND	L.O.
LICENSE OF OCCUPATION	L.O.
ROADS	—
IMPROVED ROADS	—
KING'S HIGHWAY	—
RAILWAYS	—
POWER LINES	—
MARSH OR MUSKEG	—

NOTES

200' Reserve to Dept. of Lands & Forests shown thus: —

Geodetic survey posts shown thus: ⚓

All land under water in Town of Sturgeon Falls part of the original bed of Sturgeon R. 14.30 acres, patented - Abitibi Power and Paper Company.

*Arg. Pts in T. lot 6 line 4
PT. lot 9 line 11
lot 14 line 13
PT. lot 11 line 1
over June 1/52 - 1/53
at Sturgeon Falls 16/52*

400' Res.

ISLANDS & LAND UNDER WATER OF LAKE NIPISSING NOT OPEN 30 APR 1912

PLAN NO. - S.480
DEPARTMENT OF MINES - ONTARIO -

SPRINGER

DISTRICT OF
NIPISSING

SUDBURY
MINING DIVISION

SCALE 1-INCH=40 CHAINS

LEGEND

PATENTED LAND	⊙
CROWN LAND SALE	C.S.
LEASES	⊖
LOCATED LAND	Loc.
LICENSE OF OCCUPATION	L.O.
ROADS	—
IMPROVED ROADS	—
KING'S HIGHWAY	—
RAILWAYS	—
POWER LINES	—
MARSH OR MUSKEG	—
LAND USE PERMIT	—

NOTES

400' Surface Rights Reservation around all lakes & rivers.

Geodetic survey posts shown thus: Δ

All land under water in Town of Sturgeon Falls part of the original bed of Sturgeon R. 14.30 acres, patented - Abitibi Power and Paper Company.

Lake Nipissing:
- Land under water withdrawn from staking by Order in Council dated April 30, 1912.
- Islands withdrawn from staking. File: 67051.

Flooding Rights reserved to elevation 645.00 C.G.S. Datum. File: 81049

THE INFORMATION THAT APPEARS ON THIS MAP HAS BEEN COMPILED FROM VARIOUS SOURCES, AND ACCURACY IS NOT GUARANTEED. THOSE WISHING TO STAKE MINING CLAIMS SHOULD CONSULT WITH THE MINING RECORDER, MINISTRY OF NORTHERN DEVELOPMENT AND MINES, FOR ADDITIONAL INFORMATION ON THE STATUS OF THE LANDS SHOWN HEREON.

Out of Service February 27, 1995

SPRINGER

PLAN NO. - M-1123

MINING
RESOURCES
BRANCH 1

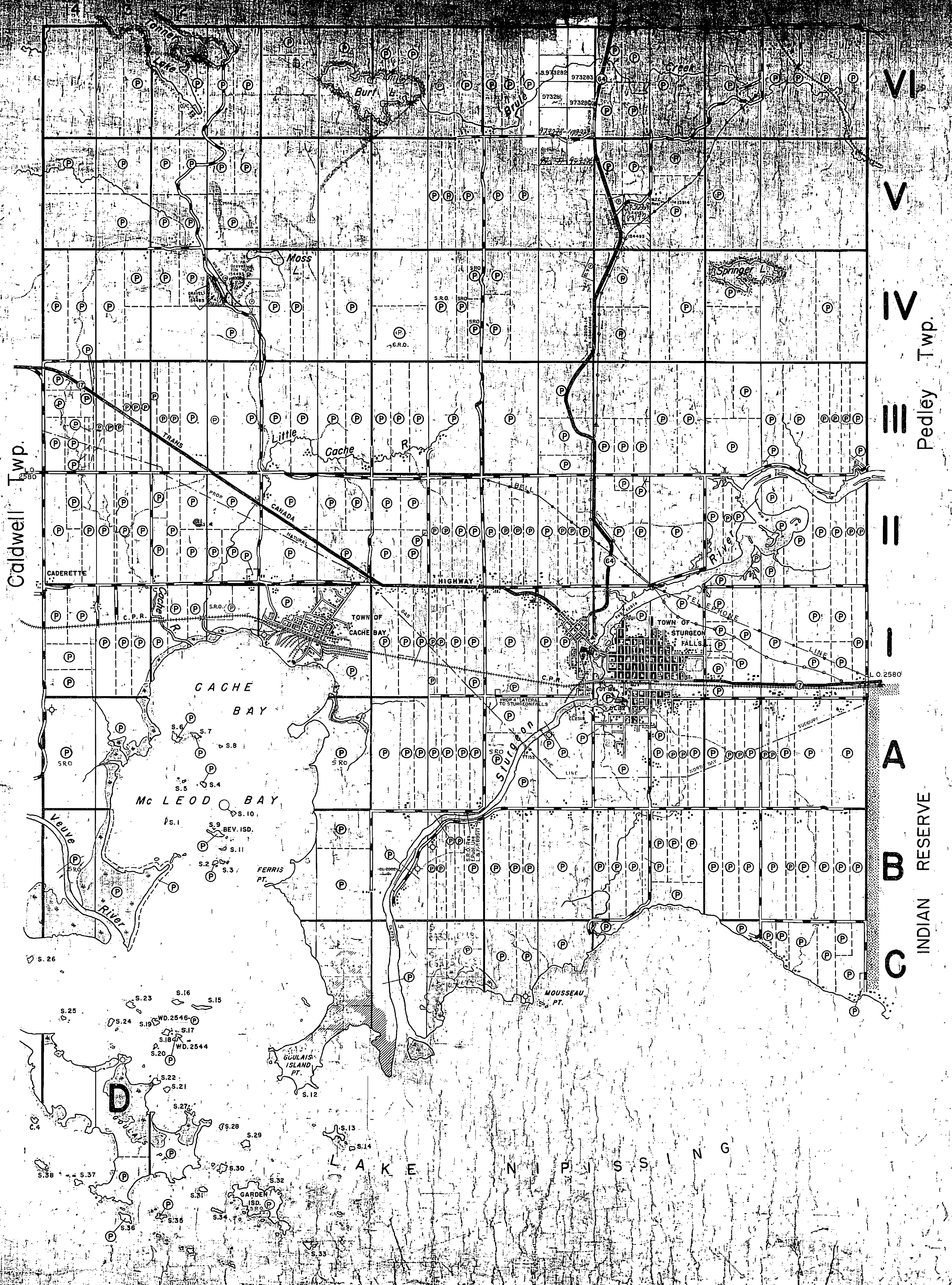

THE TOWNSHIP
OF
SPRINGER
DISTRICT OF
NIPISSING
SUDBURY
MINING DIVISION
SCALE: 1-INCH=40 CHAINS

LEGEND

- | | |
|-----------------------|------|
| PATENTED LAND | (P) |
| CROWN LAND SALE | C.S. |
| LEASES | (L) |
| LOCATED LAND | Loc. |
| LICENSE OF OCCUPATION | L.O. |
| ROADS | (—) |
| IMPROVED ROADS | (—) |
| KING'S HIGHWAY | (—) |
| RAILWAYS | (—) |
| POWER LINES | (—) |
| MARSH OR MUSKEG | (—) |

NOTES

- 400' Surface Rights Reservation around all lakes & rivers.
- Geodetic survey posts shown thus: (triangle symbol)
- All land under water in Town of Sturgeon Falls part of the original bed of Sturgeon R. 14.30 acres, patented - Abitibi Power and Paper Company.
- Lake Nipissing:
 - Land under water withdrawn from staking by Order in Council dated April 30, 1912.
 - Islands withdrawn from staking. File: 67051.
- Flooding Rights reserved to elevation 645.00 C.G.S. Datum. File: 81049
- CL. 2518 WATER LOT LOCATION (PT Bed of Sturgeon River) opposite LOTS Couch TOWN OF STURGEON FALLS.
- CL. 2753 WATER LOT LOCATION IN STURGEON RIVER IN FRONT OF LOTS, CONC. C
- CL. 2802 WATER LOT LOCATION IN STURGEON RIVER IN FRONT OF LOTS, CONC. B
- DT-152 PLAN 36R-6577 WATER LOT LOCATION LOT, CON A "LAND ROLL FILE"

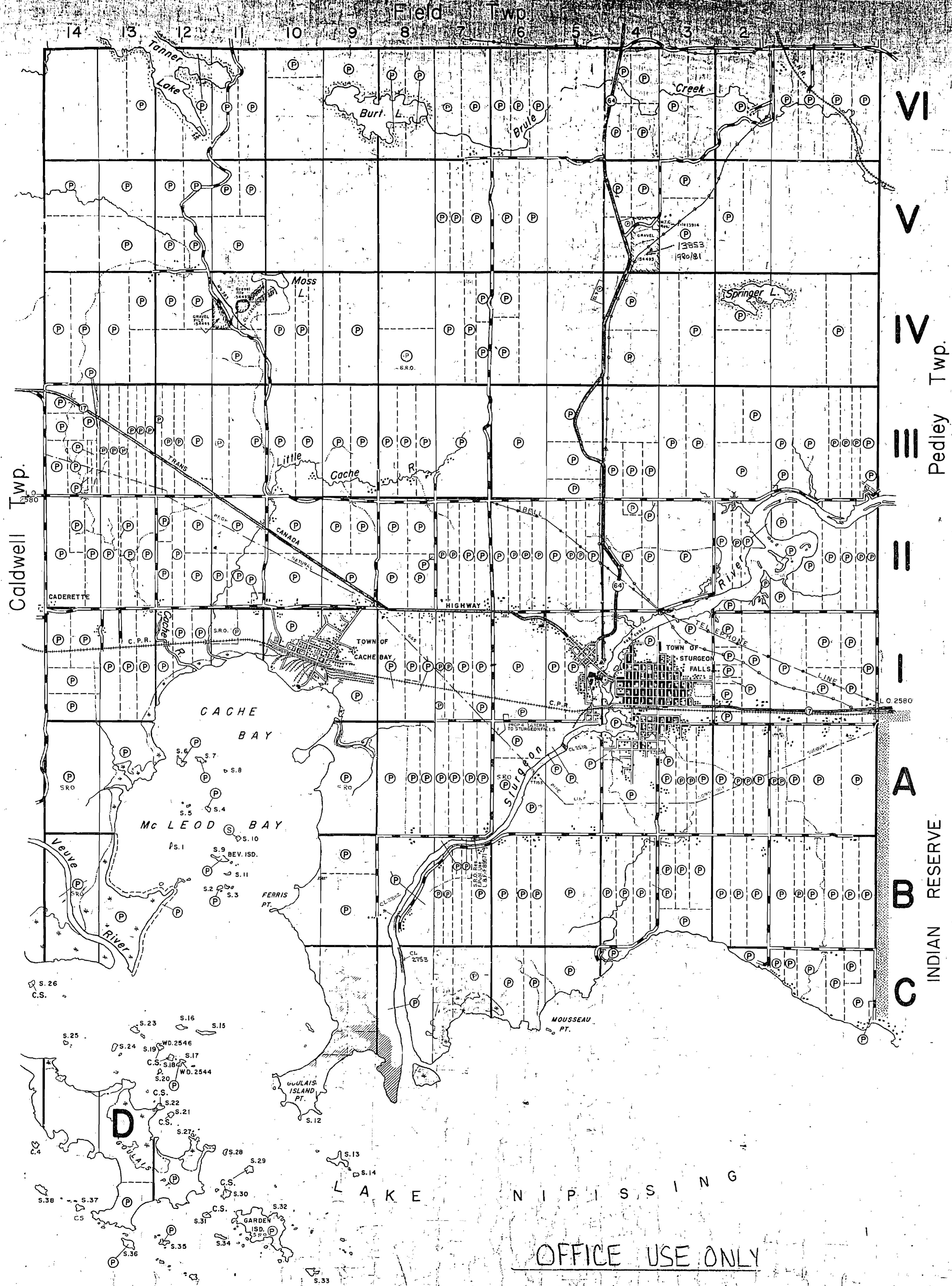

DATE OF ISSUE
JUN 2 1978

OFFICE USE ONLY

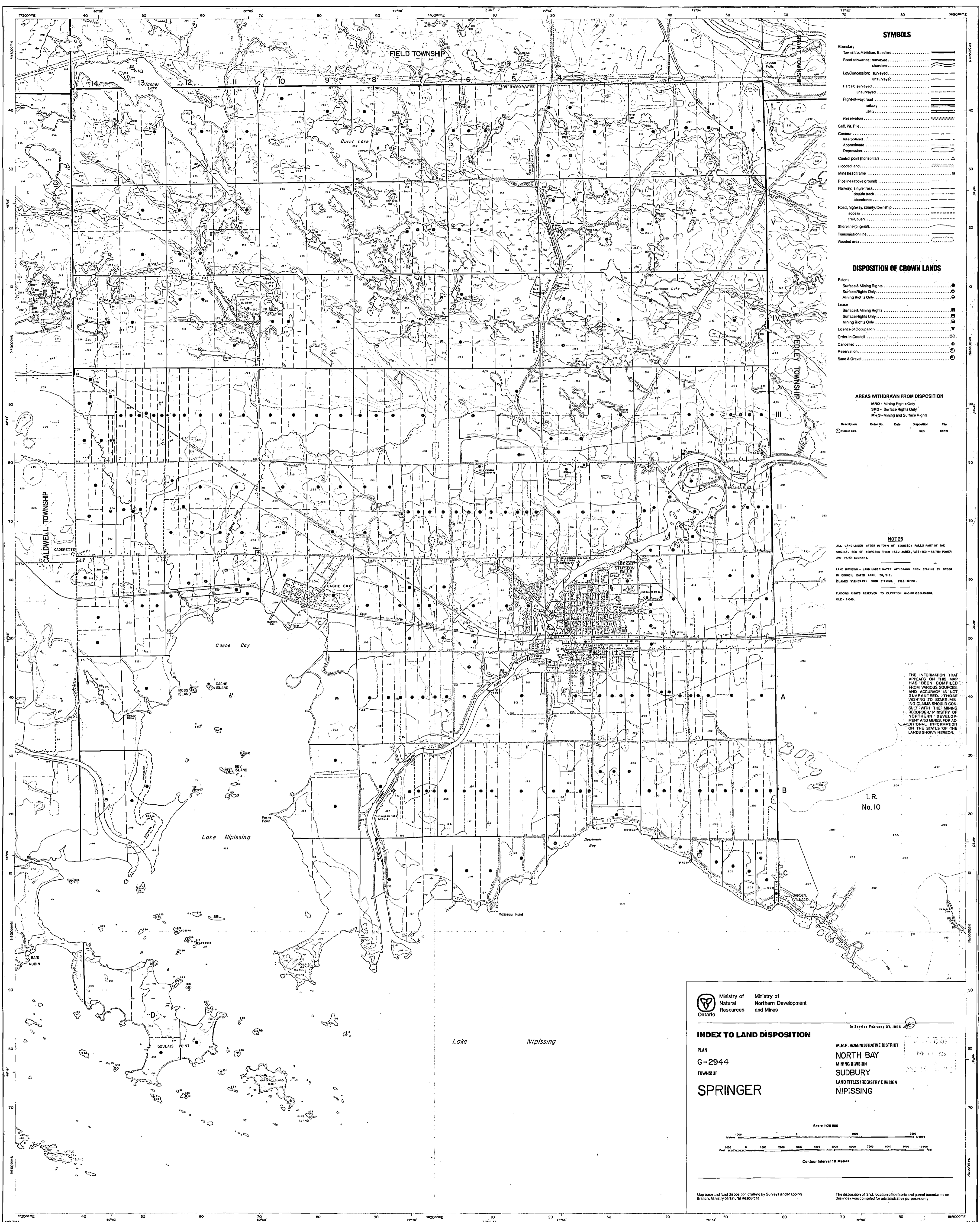

SYMBOLS

- Boundary: Township, Meridian, Baseline
- Road allowance, surveyed
- Road allowance, unsurveyed
- Lot/Concession, surveyed
- Lot/Concession, unsurveyed
- Parcel, surveyed
- Parcel, unsurveyed
- Right-of-way, road
- Right-of-way, railway
- Right-of-way, utility
- Reservation
- Call, Pt., Pile
- Contour
- Interpolated
- Approximate
- Depression
- Control point (horizontal)
- Flooded land
- Mine head frame
- Track, built
- Pipeline (above ground)
- Railway, single track
- Railway, double track
- Railway, abandoned
- Road, highway, county, township
- Access
- Shoreline (original)
- Transmission line
- Wooded area

DISPOSITION OF CROWN LANDS

- Patent
 - Surface & Mining Rights
 - Surface Rights Only
 - Mining Rights Only
- Lease
 - Surface & Mining Rights
 - Surface Rights Only
 - Mining Rights Only
- Licence of Occupation
- Order-in-Council
- Cancelled
- Reservation
- Sand & Gravel

AREAS WITHDRAWN FROM DISPOSITION

- MRO - Mining Rights Only
- SRO - Surface Rights Only
- M+S - Mining and Surface Rights

Description	Order No.	Date	Disposition	File
PUBLIC RES.			S&O	89371

NOTES

ALL LAND UNDER WATER IN TOWN OF SPRINGER FALLS PART OF THE ORIGINAL 600 OF STURGEON RIVER WAS ACQUIRED, INTERESTED - WATER POWER AND PAPER COMPANY.

LAKE NIPISSING - LAND UNDER WATER WITHDRAWN FROM STAKING BY ORDER IN COUNCIL, DATED APRIL 30, 1912.

ISLANDS WITHDRAWN FROM STAKING, FILE 47051.

FLOODING RIGHTS RESERVED TO ELEVATION 643.00 C.E.S.D.A.T.A. FILE 8049.

THE INFORMATION THAT APPEARS ON THIS MAP HAS BEEN COMPILED FROM VARIOUS SOURCES AND ACCURACY IS NOT GUARANTEED. THOSE WORKING TO MAKE MINING CLAIMS SHOULD CONSULT WITH THE MINING RECORDER, MINISTRY OF NORTHERN DEVELOPMENT AND MINES, FOR ADDITIONAL INFORMATION ON THE STATUS OF THE LANDS SHOWN HEREON.

I. R. No. 10

Ministry of Natural Resources
 Ministry of Northern Development and Mines

In Service February 27, 1993

INDEX TO LAND DISPOSITION

PLAN
 G-2944
 TOWNSHIP
SPRINGER

M.N.R. ADMINISTRATIVE DISTRICT
NORTH BAY
 MINING DIVISION
SUDBURY
 LAND TITLES/REGISTRY DIVISION
NIPISSING

Scale 1:20 000

1000 0 1000 2000 3000 4000 5000 6000 7000 8000 9000 10000
 METERS
 3000 0 1000 2000 3000 4000 5000 6000 7000 8000 9000 10000
 FEET

Contour Interval 10 Metres

Map base and land disposition drafted by Surveys and Mapping Branch, Ministry of Natural Resources.

The disposition of land, location of lot/tenure and parcel boundaries on this index was compiled for administrative purposes only.

THE TOWNSHIP
OF
SPRINGER

DISTRICT OF
NIPISSING

LARDER LAKE
MINING DIVISION

SCALE: 1-INCH=40 CHAINS

LEGEND

PATENTED LAND	Ⓟ
CROWN LAND SALE	C.S.
LEASES	Ⓛ
LOCATED LAND	Loc.
LICENSE OF OCCUPATION	L.O.
ROADS	—
IMPROVED ROADS	—
KING'S HIGHWAY	—
RAILWAYS	—
POWER LINES	—
MARSH OR MUSKEG	—

NOTES

400' Surface Rights Reservation around all lakes & rivers.

Geodetic survey posts shown thus: ⚠

All land under water in Town of Sturgeon Falls part of the original bed of Sturgeon R. 14.30 acres, patented - Abitibi Power and Paper Company.

LAND UNDER LAKE NIPISSING WITHDRAWN FROM STAKING BY ORDER IN COUNCIL DATED APRIL 30, 1912

Flooding Rights reserved to elevation 645.00 C.G.S. Datum. File: 81049.

ISLANDS IN LAKE NIPISSING WITHDRAWN FROM STAKING FILE 67051

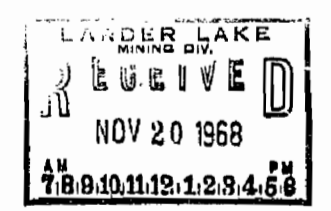
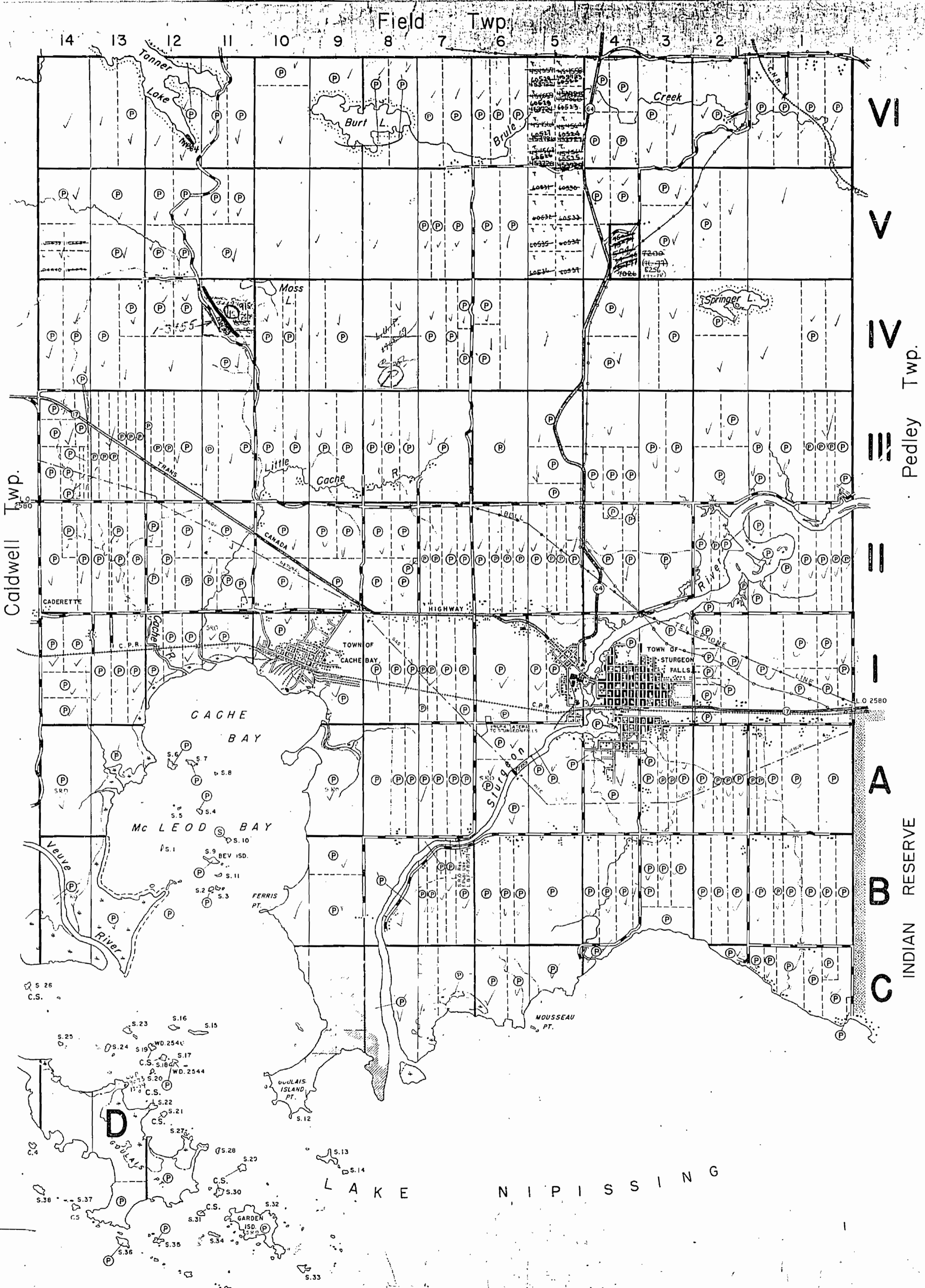

SPRINGER
PLAN NO. - M-1123
DEPARTMENT OF MINES
—ONTARIO—