

# ST. GERMAIN

(TP.33 R.24)

## SAULT STE MARIE MINING DIVISION. DISTRICT OF ALGOMA.

Scale, 40 chains to an inch.

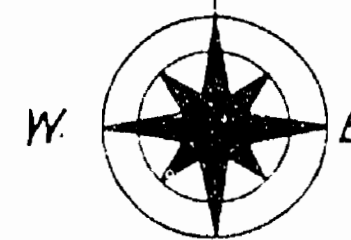

LEGARDE TP.

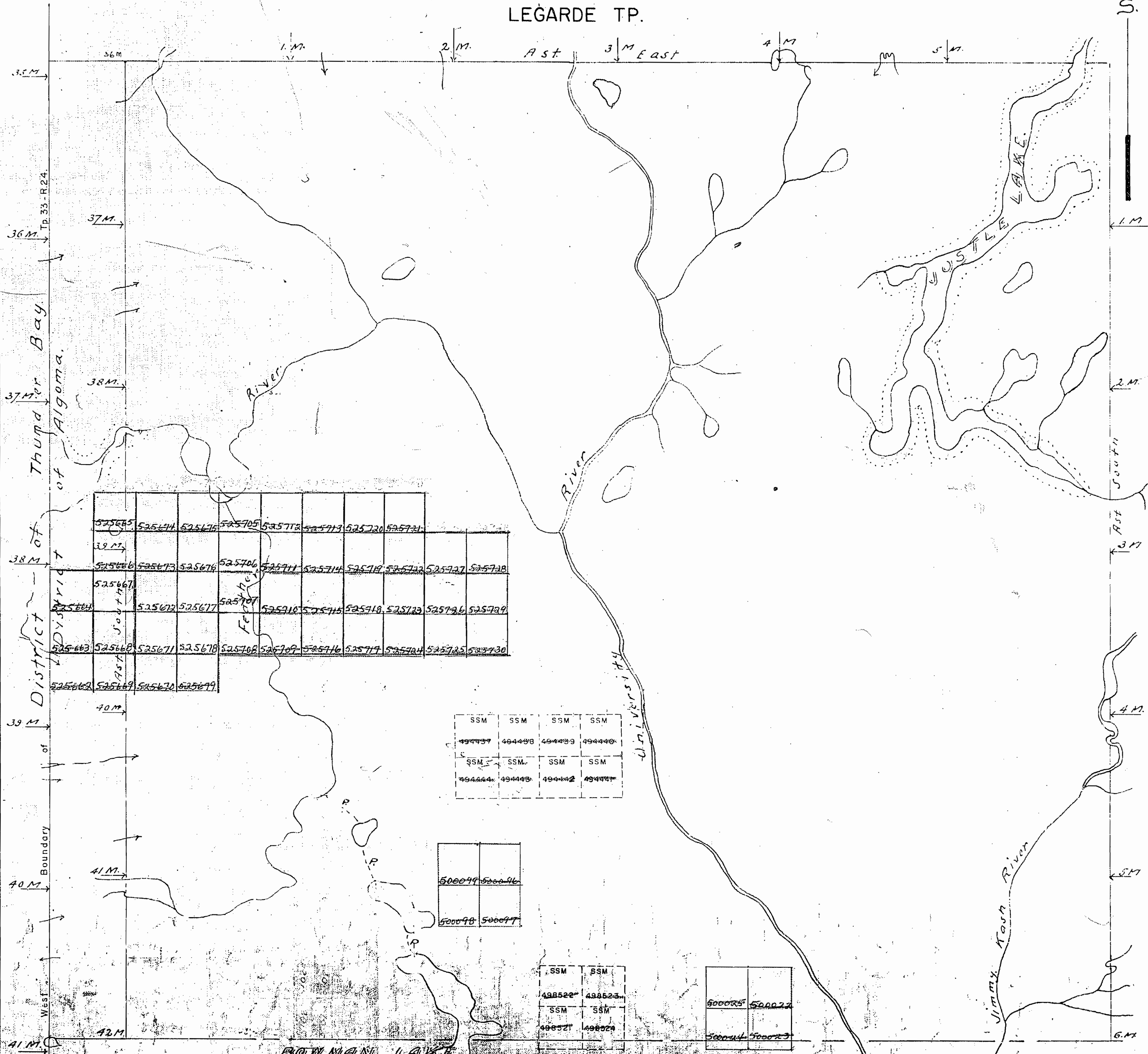

District of Thunder Bay of Algoma.

WARPULA TP. M.1570

525665	525674	525676	525705	525718	525719	525720	525721			
525666	525673	525674	525706	525711	525714	525719	525722	525727	525728	
525667	525672	525677	525707	525710	525715	525718	525723	525726	525729	
525668	525668	525671	525678	525708	525709	525716	525717	525724	525725	525730
525669	525669	525670	525679							

SSM	SSM	SSM	SSM
494437	494438	494439	494440
SSM	SSM	SSM	SSM
494444	494445	494442	494447

500047	500046
500048	500047

SSM	SSM
498522	498523
SSM	SSM
498521	498524

500025	500022
500044	500023

Surface reservations 400' wide by Dept of L. Y. F. shown hereon thru

GROSEILLIERS TP. M.1573

NOTE: This township lies within PUKASKWA WILDERNESS AREA under Ont. Reg. 251/63.

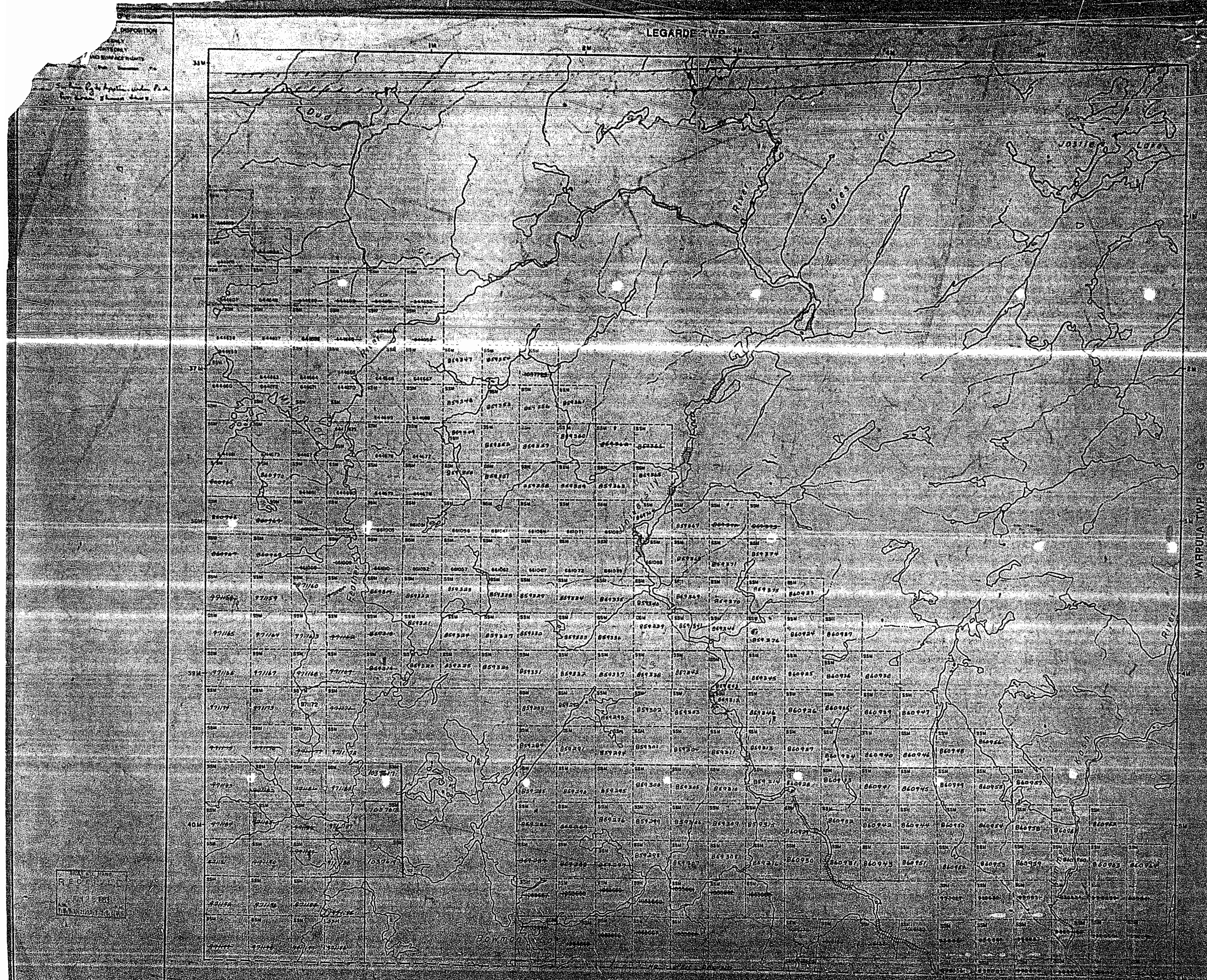

POPULATION  
 1850  
 1860  
 1870  
 1880  
 1890  
 1900  
 1910  
 1920  
 1930  
 1940  
 1950  
 1960  
 1970  
 1980  
 1990  
 2000  
 2010  
 2020

THE INFORMATION ON THIS MAP WAS OBTAINED FROM THE RECORDS OF THE COUNTY CLERK AND THE COUNTY ENGINEER. THE COUNTY ENGINEER HAS BEEN ADVISED OF THE CONTENTS OF THIS MAP AND HAS NOTED THAT THE INFORMATION IS CORRECT AND COMPLETE AS FAR AS THE RECORDS OF THE COUNTY CLERK AND THE COUNTY ENGINEER ARE CONCERNED. THE COUNTY ENGINEER HAS NOTED THAT THE INFORMATION IS CORRECT AND COMPLETE AS FAR AS THE RECORDS OF THE COUNTY CLERK AND THE COUNTY ENGINEER ARE CONCERNED. THE COUNTY ENGINEER HAS NOTED THAT THE INFORMATION IS CORRECT AND COMPLETE AS FAR AS THE RECORDS OF THE COUNTY CLERK AND THE COUNTY ENGINEER ARE CONCERNED.

**LEGEND**

UNIMPROVED LAND	...
IMPROVED LAND	...
WATER	...
ROADS	...
RAILROADS	...
UTILITY LINES	...
NON-CORRECTIONAL STREAM	...
CORRECTIONAL STREAM	...
UNIMPROVED CROWN LAND	...
IMPROVED CROWN LAND	...
UNIMPROVED STATE LAND	...
IMPROVED STATE LAND	...
UNIMPROVED FEDERAL LAND	...
IMPROVED FEDERAL LAND	...
UNIMPROVED COUNTY LAND	...
IMPROVED COUNTY LAND	...
UNIMPROVED TOWNSHIP LAND	...
IMPROVED TOWNSHIP LAND	...
UNIMPROVED PRIVATE LAND	...
IMPROVED PRIVATE LAND	...
UNIMPROVED SCHOOL LAND	...
IMPROVED SCHOOL LAND	...
UNIMPROVED CHURCH LAND	...
IMPROVED CHURCH LAND	...
UNIMPROVED COLLEGE LAND	...
IMPROVED COLLEGE LAND	...
UNIMPROVED HOSPITAL LAND	...
IMPROVED HOSPITAL LAND	...
UNIMPROVED MENTAL ASYLUM LAND	...
IMPROVED MENTAL ASYLUM LAND	...
UNIMPROVED PENITENTIARY LAND	...
IMPROVED PENITENTIARY LAND	...
UNIMPROVED MILITARY LAND	...
IMPROVED MILITARY LAND	...
UNIMPROVED NATIONAL MONUMENT LAND	...
IMPROVED NATIONAL MONUMENT LAND	...
UNIMPROVED NATIONAL RESERVE LAND	...
IMPROVED NATIONAL RESERVE LAND	...
UNIMPROVED NATIONAL MONUMENT AND RESERVE LAND	...
IMPROVED NATIONAL MONUMENT AND RESERVE LAND	...
UNIMPROVED NATIONAL MONUMENT AND RESERVE LAND	...
IMPROVED NATIONAL MONUMENT AND RESERVE LAND	...

**DISPOSITION OF CROWN LANDS**

TYPE OF DISPOSITION	SYMBOL
UNIMPROVED CROWN LAND	...
IMPROVED CROWN LAND	...
UNIMPROVED STATE LAND	...
IMPROVED STATE LAND	...
UNIMPROVED FEDERAL LAND	...
IMPROVED FEDERAL LAND	...
UNIMPROVED COUNTY LAND	...
IMPROVED COUNTY LAND	...
UNIMPROVED TOWNSHIP LAND	...
IMPROVED TOWNSHIP LAND	...
UNIMPROVED PRIVATE LAND	...
IMPROVED PRIVATE LAND	...
UNIMPROVED SCHOOL LAND	...
IMPROVED SCHOOL LAND	...
UNIMPROVED CHURCH LAND	...
IMPROVED CHURCH LAND	...
UNIMPROVED COLLEGE LAND	...
IMPROVED COLLEGE LAND	...
UNIMPROVED HOSPITAL LAND	...
IMPROVED HOSPITAL LAND	...
UNIMPROVED MENTAL ASYLUM LAND	...
IMPROVED MENTAL ASYLUM LAND	...
UNIMPROVED PENITENTIARY LAND	...
IMPROVED PENITENTIARY LAND	...
UNIMPROVED MILITARY LAND	...
IMPROVED MILITARY LAND	...
UNIMPROVED NATIONAL MONUMENT LAND	...
IMPROVED NATIONAL MONUMENT LAND	...
UNIMPROVED NATIONAL RESERVE LAND	...
IMPROVED NATIONAL RESERVE LAND	...
UNIMPROVED NATIONAL MONUMENT AND RESERVE LAND	...
IMPROVED NATIONAL MONUMENT AND RESERVE LAND	...
UNIMPROVED NATIONAL MONUMENT AND RESERVE LAND	...
IMPROVED NATIONAL MONUMENT AND RESERVE LAND	...

SCALE 1 INCH = 320 CHAINS  
 TOWNSHIP  
**ST. GERMAIN**  
 STATE OF WISCONSIN  
 COUNTY OF WAUSAU  
 SAULT STE. MARIE  
 ALCONA

G-2290

TOWNSHIP OF  
**ST. GERMAIN**  
(TP. 33 R. 24)

~~M.1574~~  
**G.2290**

**SAULT STE MARIE MINING DIVISION.  
DISTRICT OF ALGOMA.**

DATE OF ISSUE  
MAR 9 1981

Scale, 40 chains to an inch.

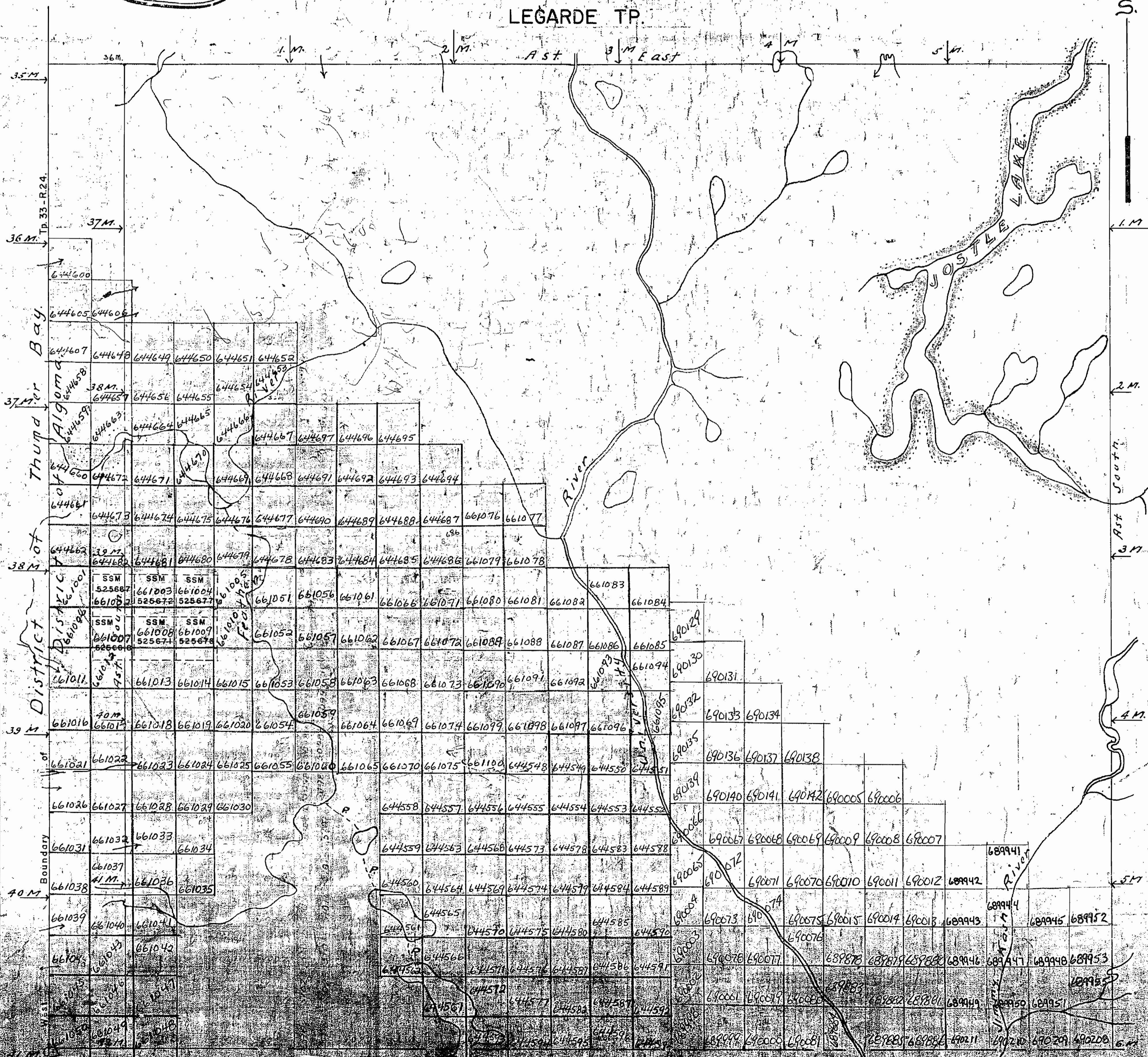
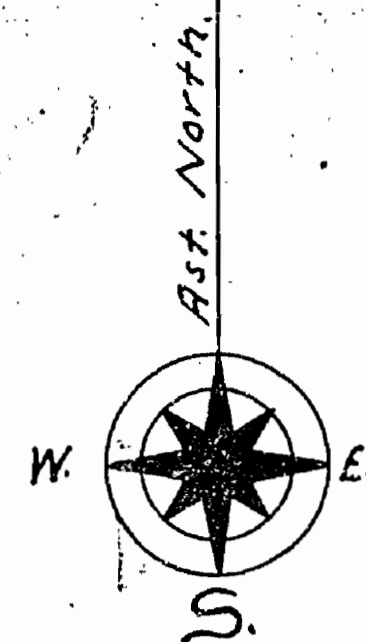

NOTE

This township lies within PUKASKWA WILDERNESS AREA under Ont. Reg. 251/83

GRANDE PRAIRIE TWP. M.1573

G.2290 - 0/100 28/123

M.1574

REFERENCE

AREAS WITHDRAWN FROM DISPOSITION

- M.R.O. - MINING RIGHTS ONLY
- S.R.O. - SURFACE RIGHTS ONLY
- M+S. - MINING AND SURFACE RIGHTS

Description Order No. Date Disposition File

Surface Rgts. Applied under P.L.A. for area shown there.

LEGARDE TWP. G-

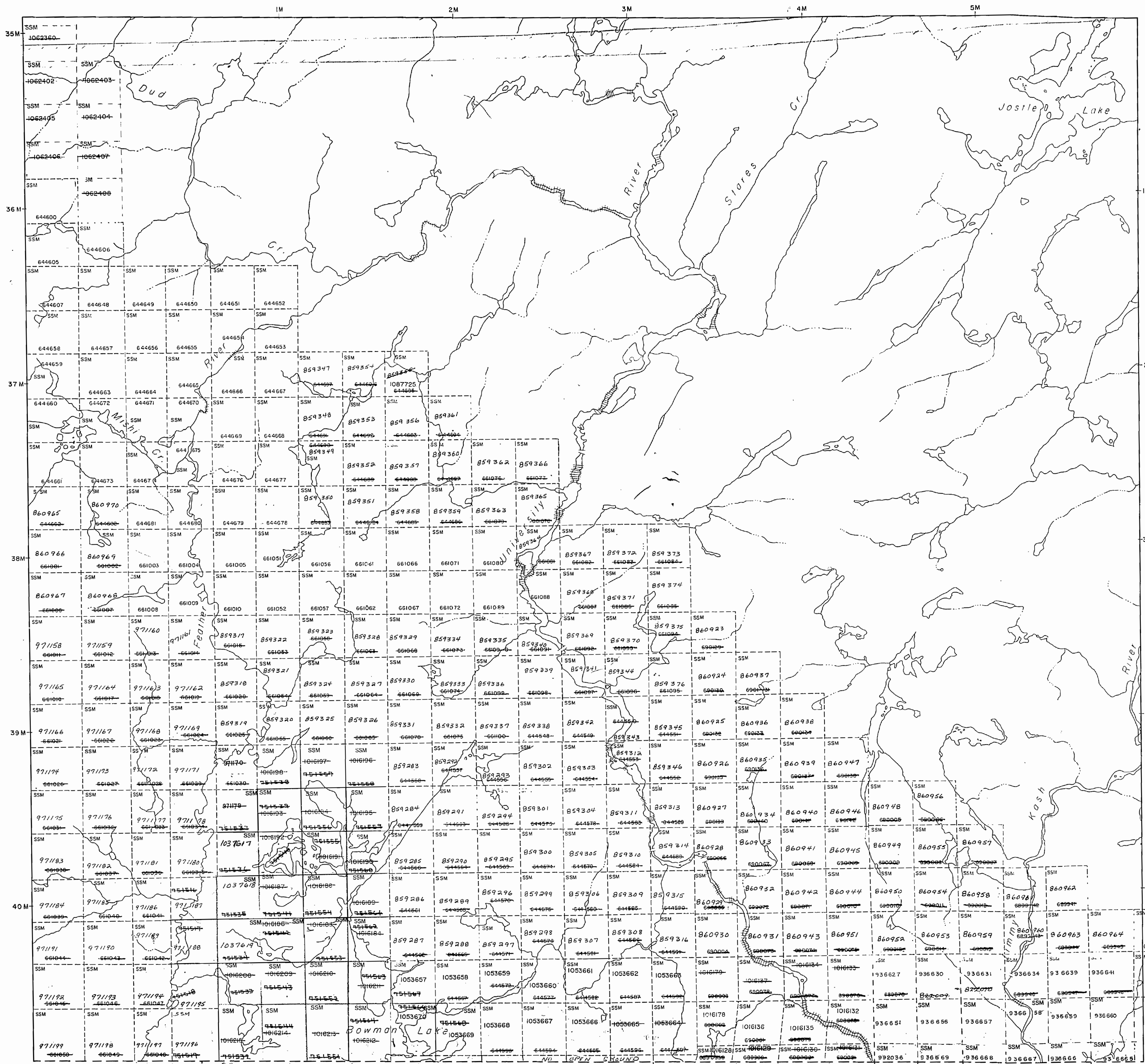

GROSEILLIERS TWP. G-2281

REFERENCE

The 1925 Magnetic Bearing Approx. Annual Change increasing 1/6"

THE INFORMATION THAT APPEARS ON THIS MAP HAS BEEN COMPILED FROM VARIOUS SOURCES AND ACCURACY IS NOT GUARANTEED. THOSE WISHING TO STAKE MINING CLAIMS SHOULD CONSULT WITH THE MINING RECORDER, MINISTRY OF NORTHERN DEVELOPMENT AND MINES, FOR ADDITIONAL INFORMATION ON THE STATUS OF THE LANDS SHOWN HEREON.

LEGEND

- HIGHWAY AND ROUTE No.
- OTHER ROADS
- TRAILS
- SURVEYED LINES: TOWNSHIPS, BASE LINES, ETC.
- LOTS, MINING CLAIMS, PARCELS, ETC.
- UNSURVEYED LINES: LOT LINES
- PARCEL BOUNDARY
- MINING CLAIMS ETC.
- RAILWAY AND RIGHT OF WAY
- UTILITY LINES
- NON PERENNIAL STREAM
- FLOODING OR FLOODING RIGHTS SUBDIVISION OR COMPOSITE PLAN
- RESERVATIONS
- ORIGINAL SHORELINE
- MARSH OR MUSKEG
- MINES
- TRAVERSE MONUMENT

DISPOSITION OF CROWN LANDS

TYPE OF DOCUMENT	SYMBOL
PATENT, SURFACE & MINING RIGHTS	●
... SURFACE RIGHTS ONLY	○
... MINING RIGHTS ONLY	○
LEASE, SURFACE & MINING RIGHTS	○
... SURFACE RIGHTS ONLY	○
... MINING RIGHTS ONLY	○
LICENCE OF OCCUPATION	○
ORDER-IN-COUNCIL RESERVATION	OC
CANCELLED	○
SAND & GRAVEL	○

SCALE: 1 INCH = 20 CHAINS

TOWNSHIP

**ST. GERMAIN**

M.N.R. ADMINISTRATIVE DISTRICT

**WAWA**

MINING DIVISION

**SAULT STE. MARIE**

LAND TITLES / REGISTRY DIVISION

**ALGOMA**

Ministry of Natural Resources

Land Management Branch

Date: DECEMBER, 1982

Number: G-2290

RECEIVED

JUN 24 1983

REFERENCE

AREAS WITHDRAWN FROM DISPOSITION

M.R.O. - MINING RIGHTS ONLY  
S.R.O. - SURFACE RIGHTS ONLY  
M + S. - MINING AND SURFACE RIGHTS  
Description Order No. Date Disposition File

LEGARDE TWP. G-

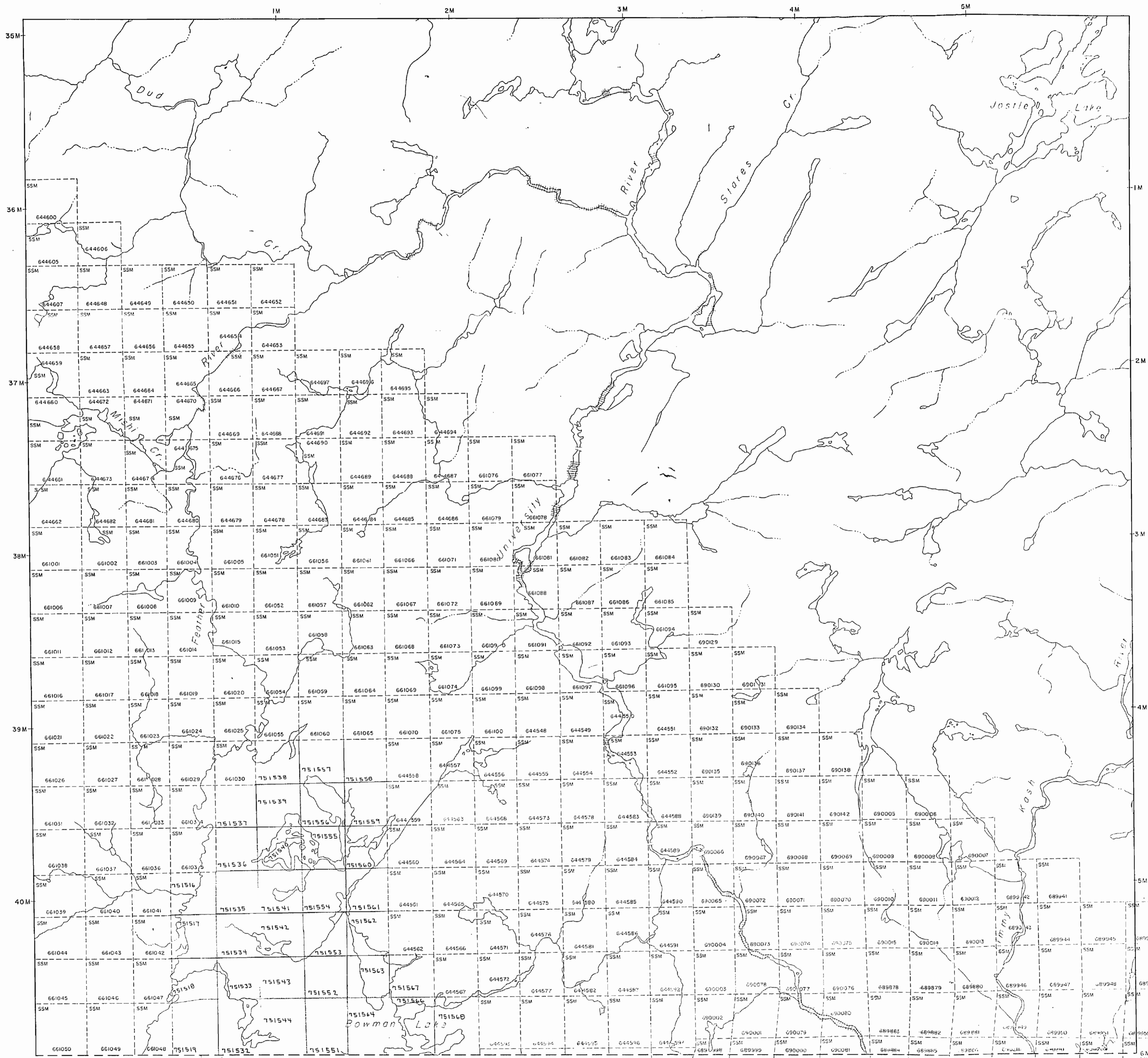

REFERENCE

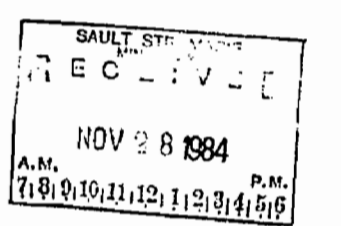

LEGEND

- HIGHWAY AND ROUTE NO.
- OTHER ROADS
- TRAILS
- SURVEYED LINES
- TOWNSHIP'S BASE LINES ETC.
- LOTS, MINING CLAIMS PARCELS ETC.
- UNSURVEYED LINES
- LOT LINES
- PARCEL BOUNDARY
- MINING CLAIMS ETC.
- RAILWAY AND RIGHT OF WAY
- UTILITY LINES
- NON PERENNIAL STREAM
- FLOODING OR FLOODING RIGHTS
- SUBDIVISION, OR COMPAS E PLAN.
- RESERVATIONS
- ORIGINAL SHORELINE
- MARSH OR MUSKEG
- MINES
- TRAVERSE MONUMENT

DISPOSITION OF CROWN LANDS

TYPE OF DOCUMENT	SYMBOL
PATENT, SURFACE & MINING RIGHTS	●
.. SURFACE RIGHTS ONLY	○
.. MINING RIGHTS ONLY	○
LEASE, SURFACE & MINING RIGHTS	○
.. SURFACE RIGHTS ONLY	○
.. MINING RIGHTS ONLY	○
LICENCE OF OCCUPATION	○
ORDER IN COUNCIL	○
RESERVATION	○
CANCELLED	○
SAND & GRAVEL	○

SCALE 1 INCH = 20 CHAINS

TOWNSHIP  
**ST. GERMAIN**  
M. N. R. ADMINISTRATIVE DISTRICT  
**WAWA**  
MINING DIVISION  
**SAULT STE. MARIE**  
LAND TITLES / REGISTRY DIVISION  
**ALGOMA**

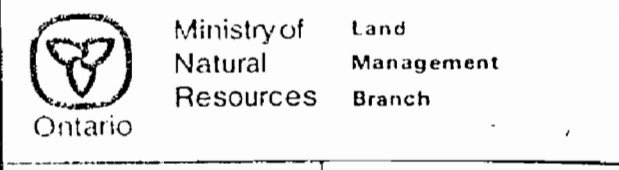

Date: DECEMBER, 1982 Number  
**G-2290**

GROSELLIERS TWP. G-2281

REFERENCE

AREAS WITHDRAWN FROM DISPOSITION

- M.R.O. - MINING RIGHTS ONLY
- S.R.O. - SURFACE RIGHTS ONLY
- M+S. - MINING AND SURFACE RIGHTS

Surface Rights Applied under P.A.A. for area shown this

LEGARDE TWP. G-

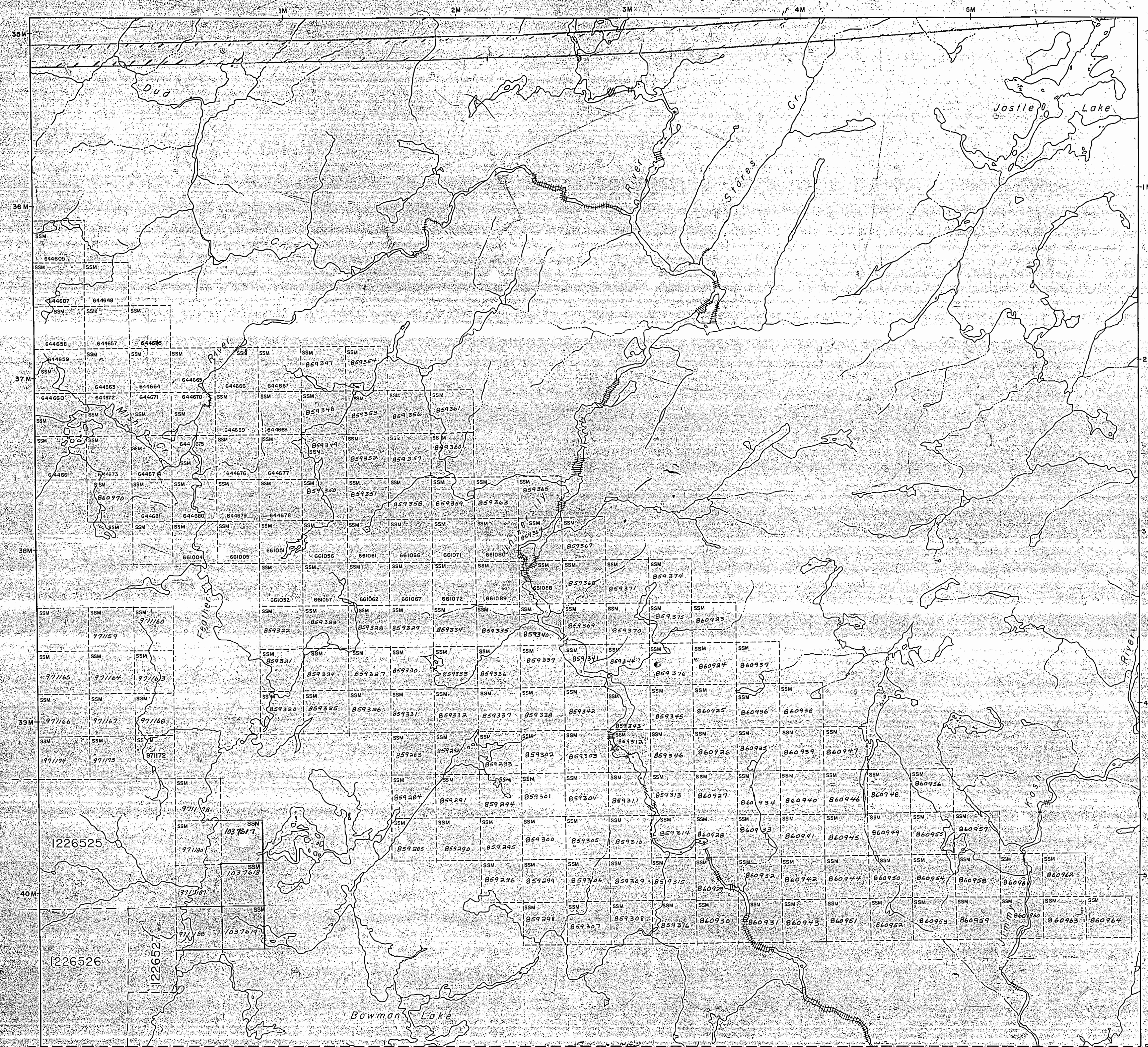

REFERENCE

The 1925 Magnetic Bearing Approx. 2.0 Annual Change Increasing 70

THE INFORMATION THAT APPEARS ON THIS MAP HAS BEEN COMPILED FROM VARIOUS SOURCES AND ACCURACY IS NOT GUARANTEED. THOSE WISHING TO STAKE MINING CLAIMS SHOULD CONSULT WITH THE MINING RECORDS DIVISION OF NORTHERN DEVELOPMENT AND MINES, FOR ADDITIONAL INFORMATION ON THE STATUS OF THE LANDS SHOWN HEREON.

LEGEND

- HIGHWAY AND ROUTE No.
- OTHER ROADS
- TRAILS
- SURVEYED LINES: TOWNSHIPS, BASE LINES, ETC.
- LOTS, MINING CLAIMS, PARCELS, ETC.
- UNSURVEYED LINES: LOT LINES
- PARCEL BOUNDARY
- MINING CLAIMS ETC.
- RAILWAY AND RIGHT OF WAY
- UTILITY LINES
- NON-PERENNIAL STREAM
- FLOODING OR FLOODING RIGHTS SUBDIVISION OR COMPOSITE PLAN
- RESERVATIONS
- ORIGINAL SHORELINE
- MARSH OR MUSKEG
- MINES
- TRAVERSE MONUMENT

DISPOSITION OF CROWN LANDS

TYPE OF DOCUMENT	SYMBOL
PATENT, SURFACE & MINING RIGHTS	●
SURFACE RIGHTS ONLY	○
MINING RIGHTS ONLY	□
LEASE, SURFACE & MINING RIGHTS	■
SURFACE RIGHTS ONLY	◻
MINING RIGHTS ONLY	◼
LICENCE OF OCCUPATION	▽
ORDER-IN-COUNCIL	○
RESERVATION	○
CANCELLED	○
SAND & GRAVEL	○

SCALE: 1 INCH = 20 CHAINS

TOWNSHIP  
**ST. GERMAIN**  
M.N.R. ADMINISTRATIVE DISTRICT  
**WAWA**  
MINING DIVISION  
**SAULT STE. MARIE**  
LAND TITLES / REGISTRY DIVISION  
**ALGOMA**



Date: DECEMBER, 1982  
Number: **G-2290**

SAULT STE. MARIE  
RECEIVED  
JUN 28 1983  
A.M. 10:09, 10:11, 12:11, 2:08, 4:05 P.M.

GROSEILLIERS TWP. G-2281

1574

This Camp lies within  
Pukaskewa Wilderness Area  
open for staking P.V.S. as per 24/6/05

M. 1574

# PLAN OF TWP. 33-R.24. (ST. GERMAIN)

## SAULT STE MARIE MINING DIVISION. DISTRICT OF ALGOMA.

Scale 40 chains to an inch.



TWP 33.- R. 25

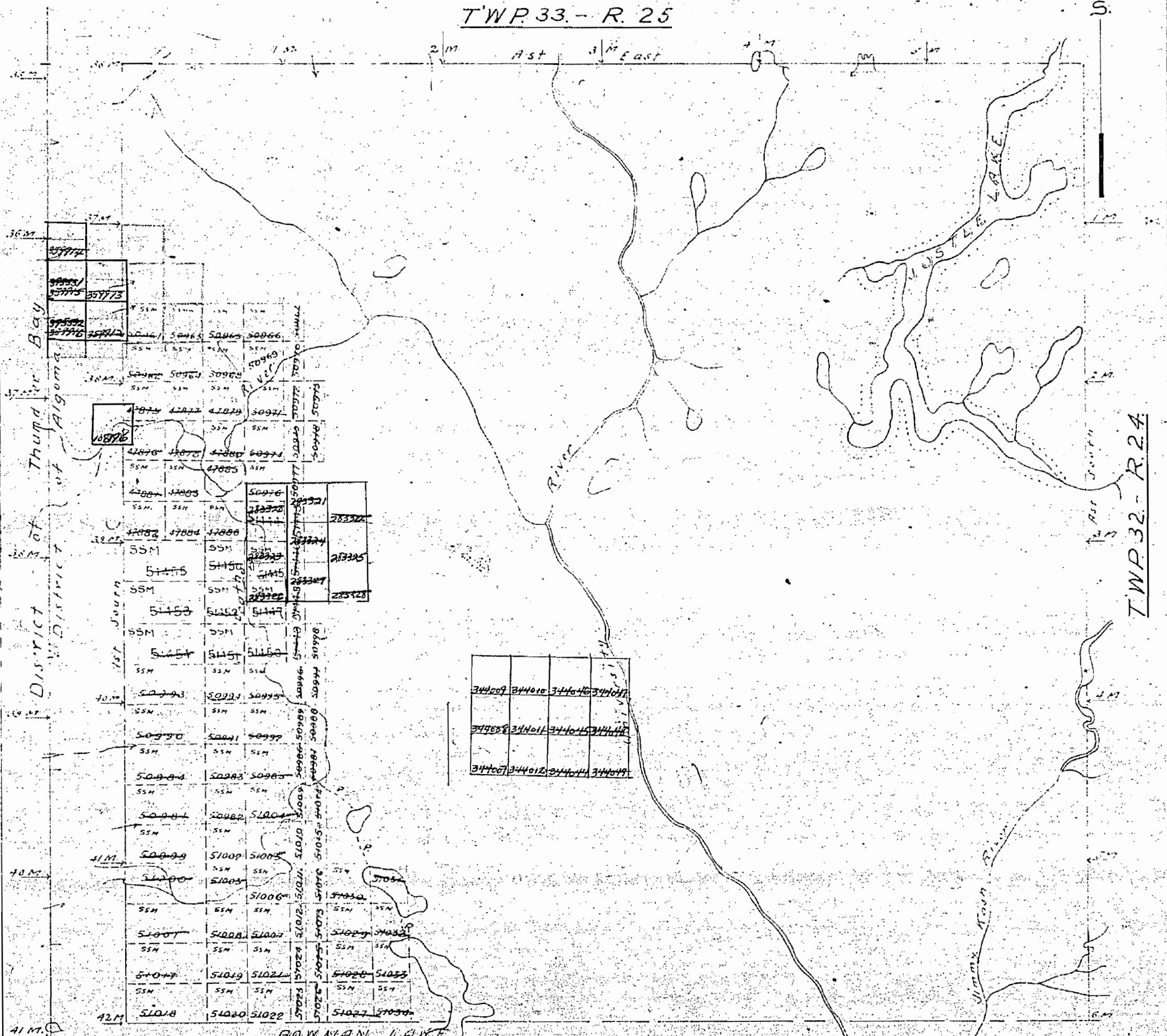

34407	34408	34409	34410
34411	34412	34413	34414
34415	34416	34417	34418

TWP 32.- R. 24

TWP 33.- R. 23

Surface reservations 400' wide by Dept of  
L. & F. shown hereon thus

TWP 33 R St M-1254

DATE OF ISSUE  
JUL 16 1975

ST. GERMAIN

(TP. 33 R. 24)

SAULT STE MARIE MINING DIVISION.  
DISTRICT OF ALGOMA.

Scale, 40 chains to an inch.

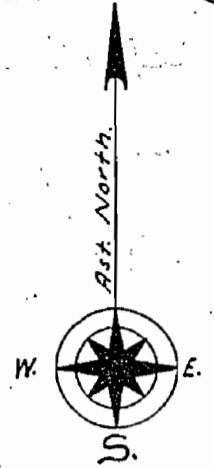

LEGARDE TP.

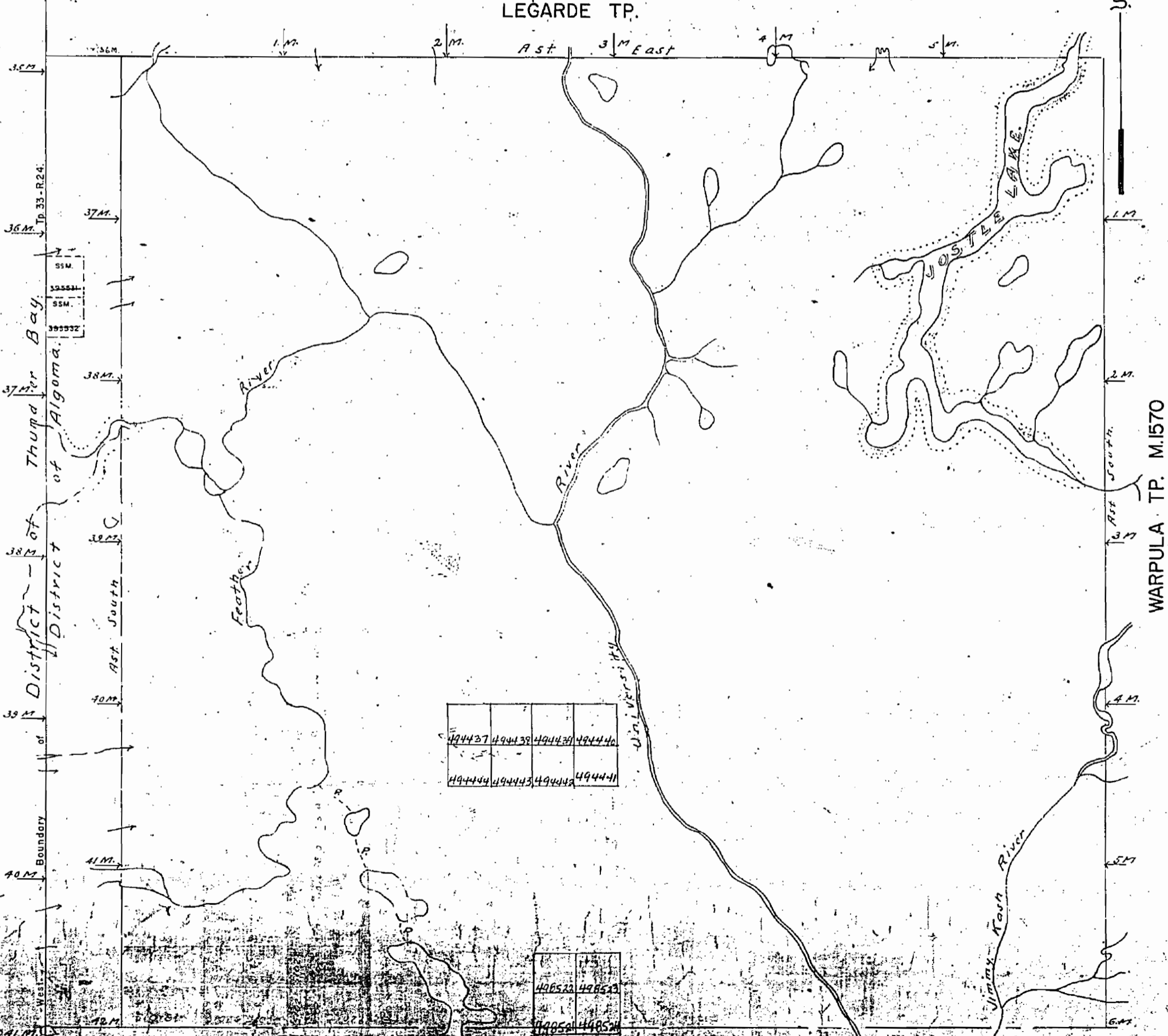

494437	494438	494439	494440
494441	494442	494443	494444

498522	498523
498524	498525

WARPULA TP. M.1570

GROSELLIERS, TP. M.1573

NOTE: This township lies within PUKASKWA WILDERNESS AREA under Ont. Reg. 251/63.



1574

(ST. GERMAIN)

PLAN OF

*Office Map.*

# TWP. 33-R.24.

SAULT STE MARIE MINING DIVISION.  
DISTRICT OF ALGOMA.

Scale, 40 chains to an inch.

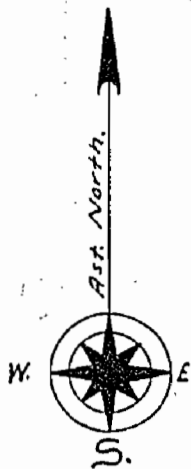

M. 1574

TWP. 33. - R. 25

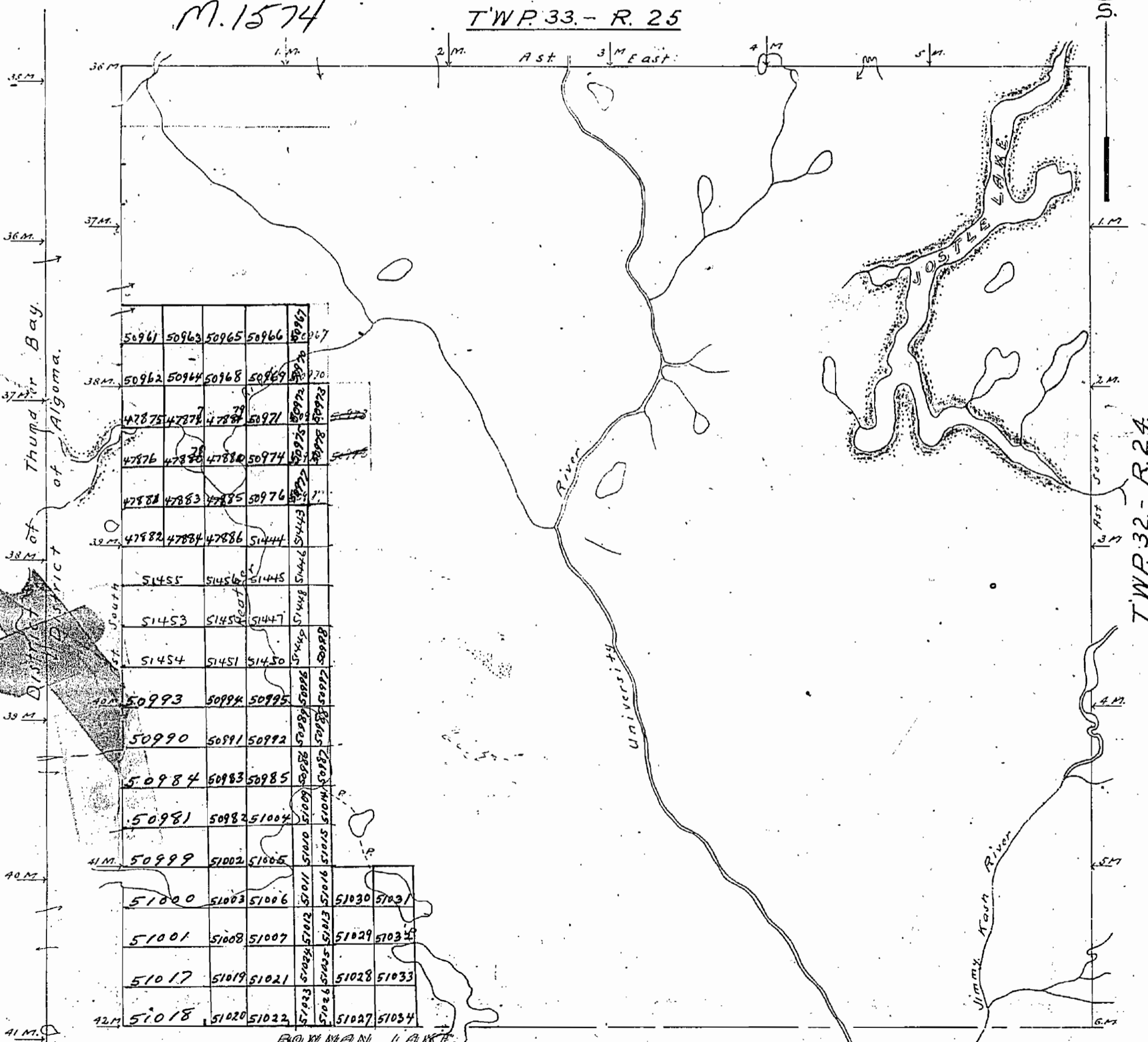

50961	50962	50963	50964	50965	50966	50967
50968	50969	50970	50971	50972	50973	50974
50975	50976	50977	50978	50979	50980	50981
50982	50983	50984	50985	50986	50987	50988
50989	50990	50991	50992	50993	50994	50995
50996	50997	50998	50999	51000	51001	51002
51003	51004	51005	51006	51007	51008	51009
51010	51011	51012	51013	51014	51015	51016
51017	51018	51019	51020	51021	51022	51023
51024	51025	51026	51027	51028	51029	51030
51031	51032	51033	51034	51035	51036	51037

Surface reservations 400' wide by Dept of L. & F. shown hereon thus

TWP. 33. - R. 23.

M-1574 TWP. 33 R. 24

This Twp. lies within  
Pukaskewa wilderness area  
open for staking P.V.S. as per 24/6/04

PLAN OF  
**TWP. 33-R.24.** (ST. GERMAIN)  
SAULT STE MARIE MINING DIVISION.  
DISTRICT OF ALGOMA.

Scale 40 chains to an inch.



TWP. 33. - R. 25

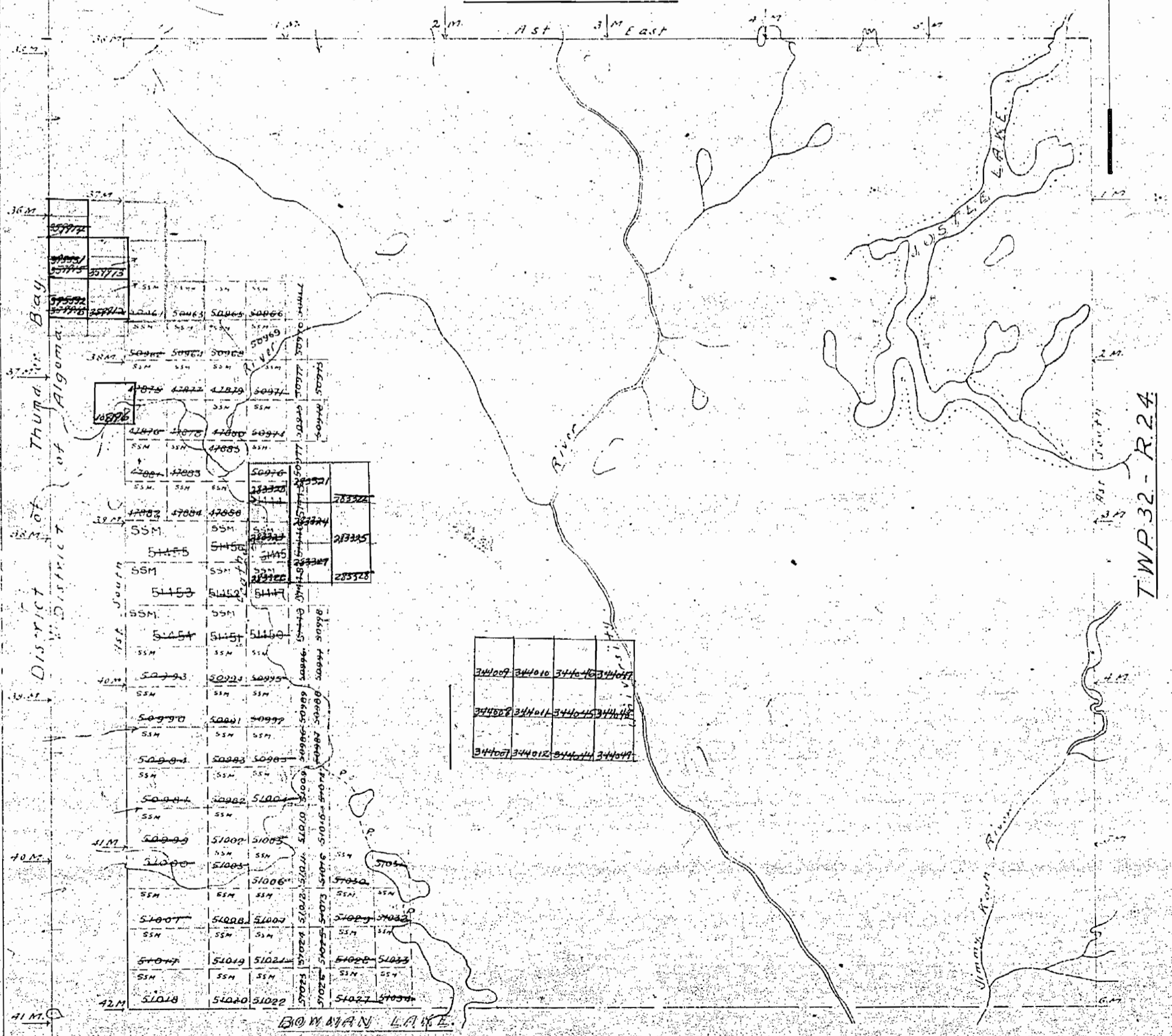

344009	344010	344011	344012	344013
344014	344015	344016	344017	344018
344019	344020	344021	344022	344023

TWP. 32 - R. 24

Surface reservations 400' wide by Dept of  
L. Y. F. shown hereon thus

TWP. 33. - R. 23

DATE OF ISSUE  
JUL 16 1975

# ST. GERMAIN

(TP. 33 R. 24)

## SAULT STE MARIE MINING DIVISION. DISTRICT OF ALGOMA.

Scale, 40 chains to an inch.

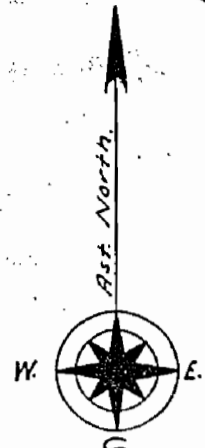

LEGARDE TP.

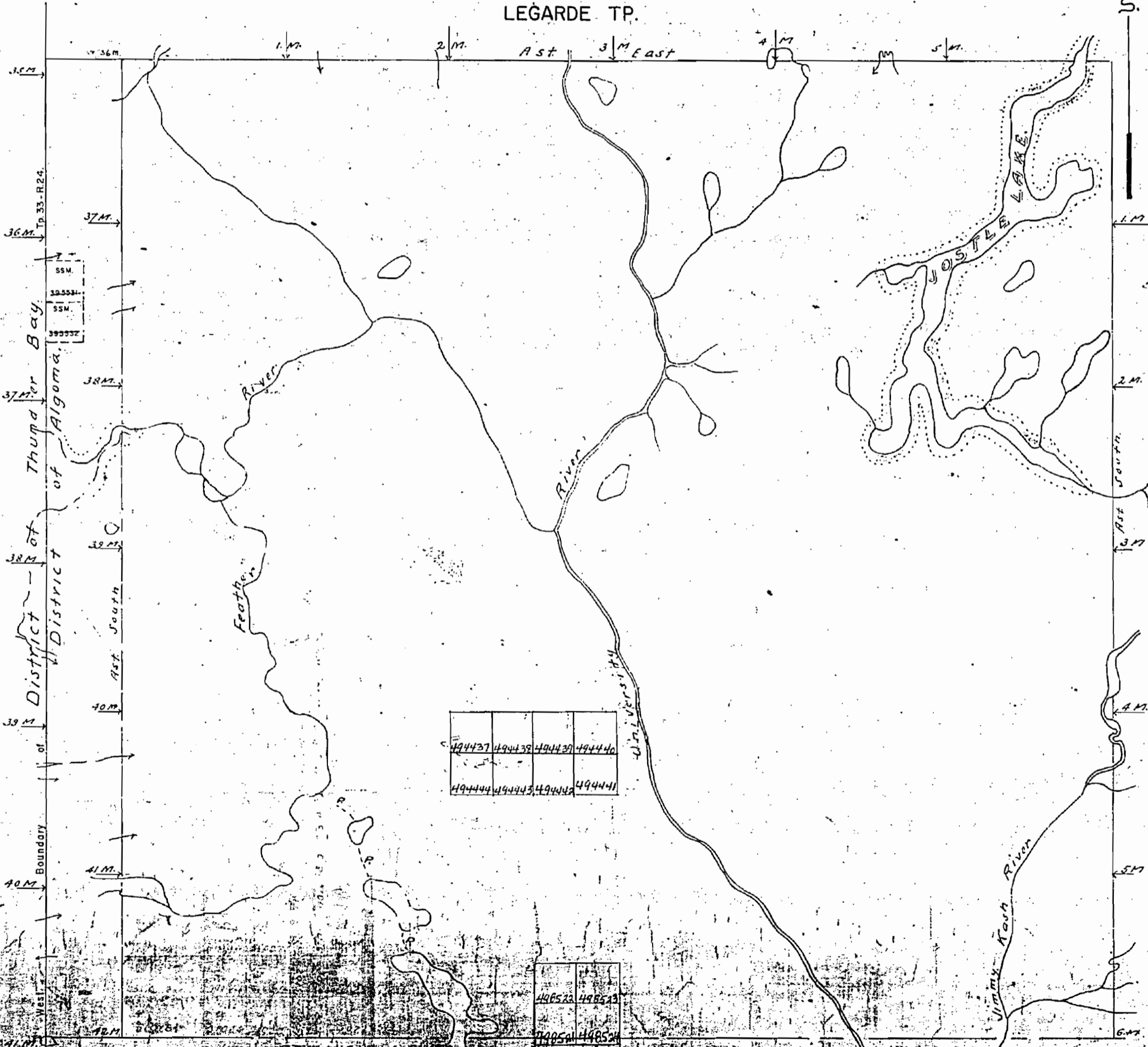

WARPULA TP. M.1570

494437	494438	494439	494440
494441	494442	494443	494444

498523	498524
498525	498526

NOTE: This township lies within PUKASKWA WILDERNESS AREA under Ont. Reg. 251/63.

GROSEILLIERS TP. M.1573

1574

(ST. GERMAIN)

PLAN OF

*Office Map.*

# TWP. 33-R.24.

SAULT STE MARIE MINING DIVISION.  
DISTRICT OF ALGOMA.

Scale, 40 chains to an inch.

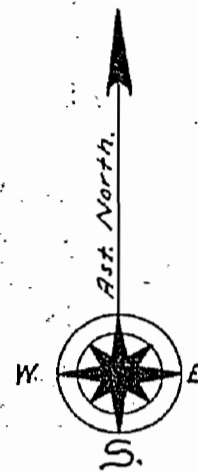

M. 1574

TWP. 33. - R. 25

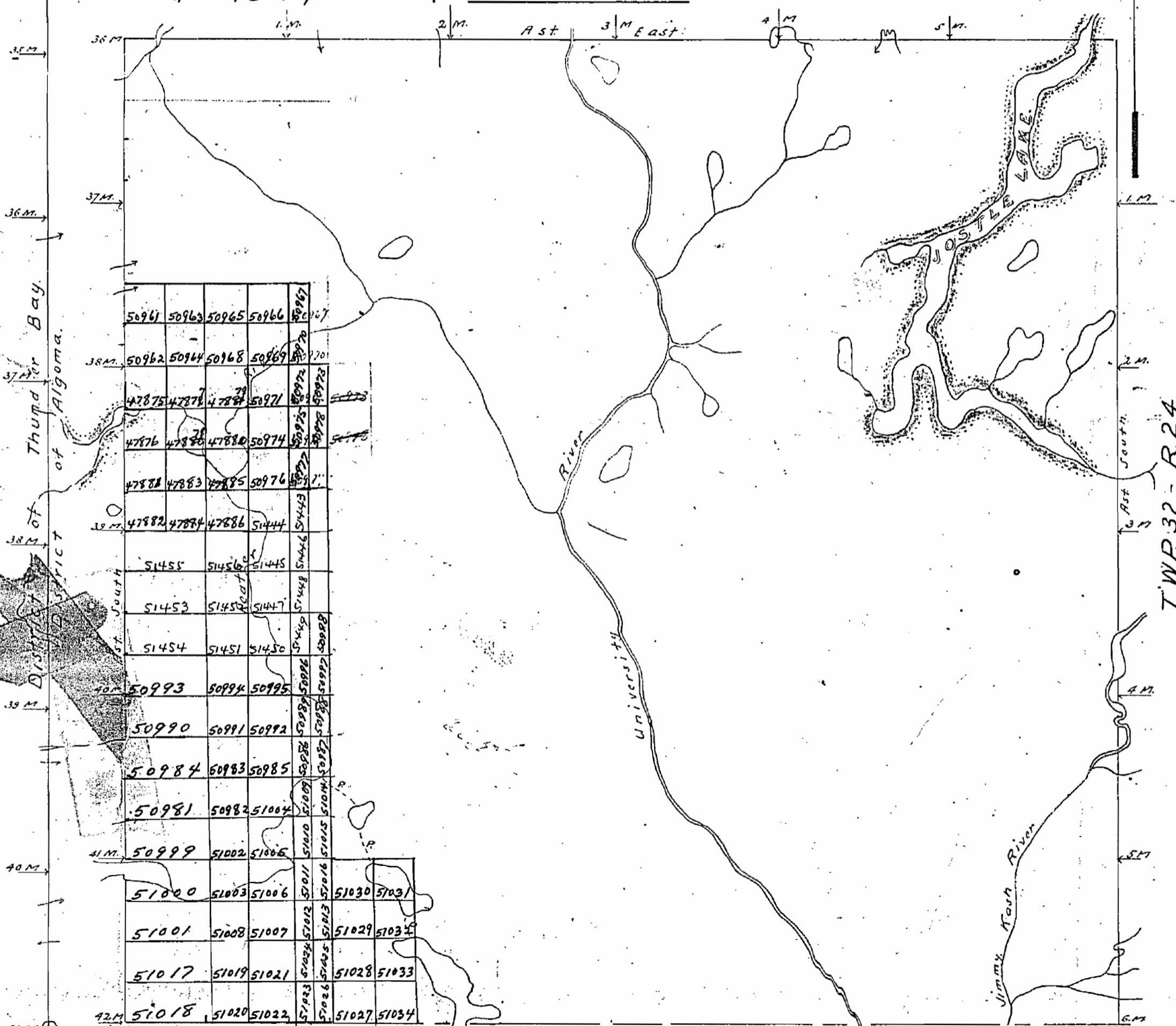

BOWMAN LAKE.

Surface reservations 400' wide by Dept of L. & F. shown hereon thus

TWP. 33. - R. 23.

M. 1574 TWP. 33. R. 24