

JACK TWP. M.954

NOBLE TWP.
M. 1026

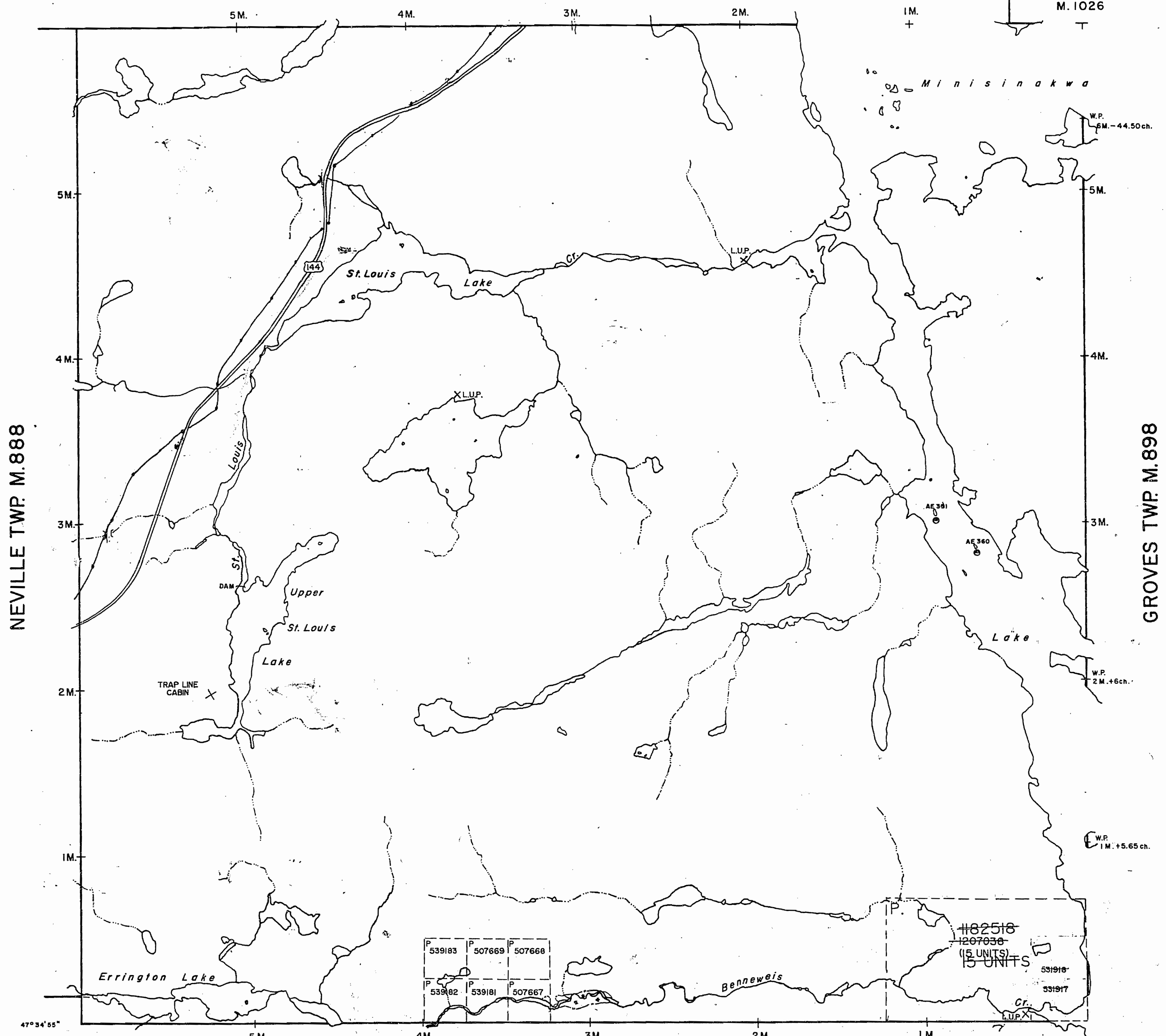

NEVILLE TWP. M.888

GROVES TWP. M.898

BENNEWEIS TWP. M.658

NOTES

400' surface rights reservation along the shores of all lakes and rivers.

LEGEND

- PATENTED LAND Ⓟ or ●*
 - PATENTED FOR SURFACE RIGHTS ONLY Ⓞ
 - LEASE Ⓛ
 - LICENSE OF OCCUPATION L.O.
 - CROWN LAND SALES C.S.
 - LOCATED LAND Loc.
 - CANCELLED C.
 - MINING RIGHTS ONLY M.R.O.
 - SURFACE RIGHTS ONLY S.R.O.
 - HIGHWAY & ROUTE NO.
 - ROADS
 - TRAILS
 - RAILWAYS
 - POWER LINES
 - MARSH OR MUSKEG
 - MINES
- *used only with summer resort locations or when space is limited

TOWNSHIP OF

ST. LOUIS

DATE OF ISSUE

MAY 25 1998

DISTRICT OF SUDBURY PROVINCIAL RECORDING OFFICE - SUDBURY

SUDBURY MINING DIVISION

SCALE : 1 INCH = 40 CHAINS (1/2 MILE)

DR. *K.K.I.* PLAN NO. **M.1127**

DATE JAN. '72

PLAN ACTIVATED 90-JUL-19. #

ONTARIO DEPARTMENT OF MINES AND NORTHERN AFFAIRS

THAT MAP FILED RECES. NOT HOSE MIN- CON- TAINING Y. OF LOP- OR AD- THE ON.

47°34'55" Approx. 01°50'51"

Received Jan 9/80

JACK TWP. M.954

NOBLE TWP. M.1026

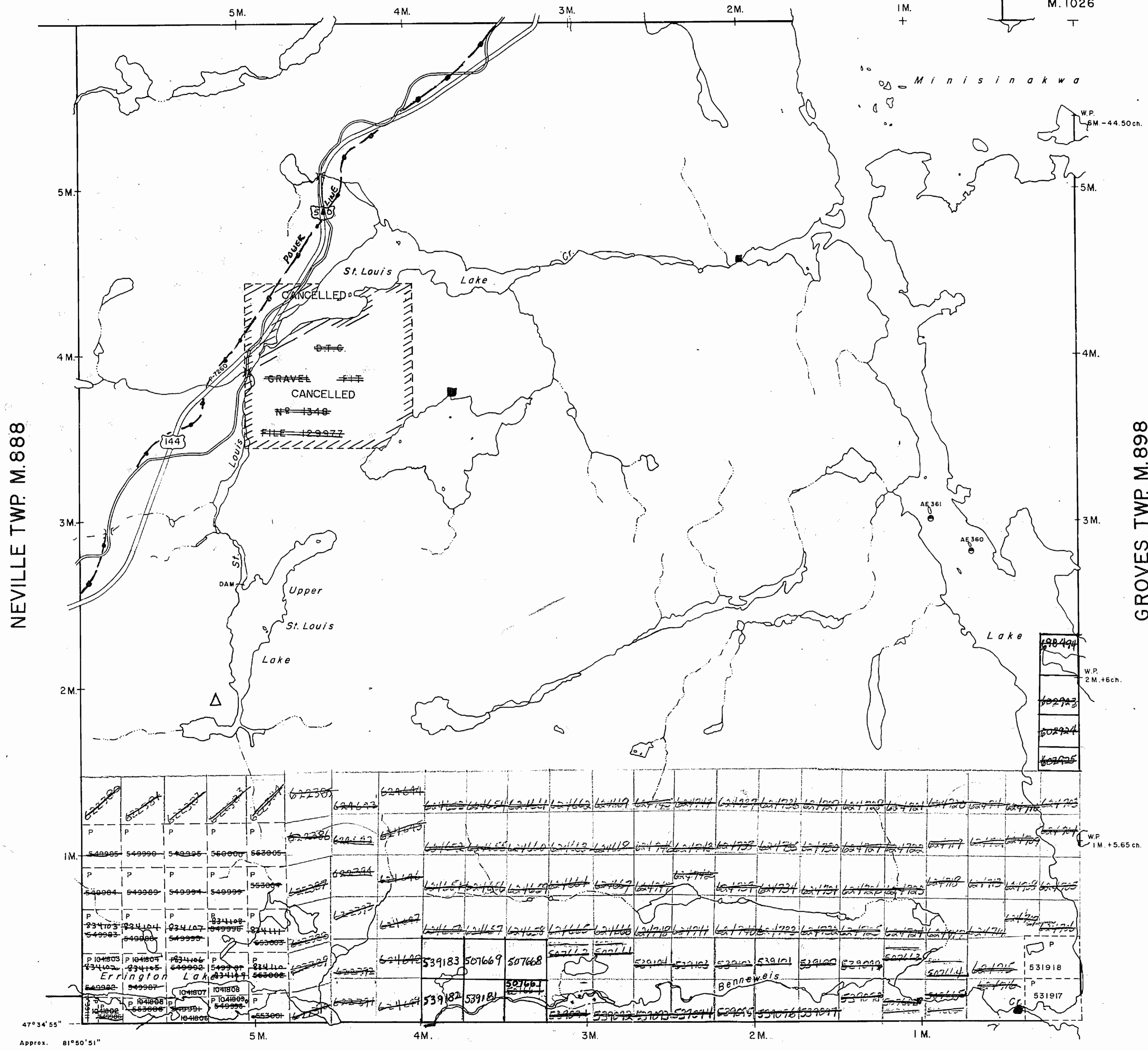

NEVILLE TWP. M.888

GROVES TWP. M.898

NOTES

400' surface rights reservation along the shores of all lakes and rivers.



△ Trapline Camp
 ■ d.u.p.

LEGEND

- PATENTED LAND (P or ●*)
 - PATENTED FOR SURFACE RIGHTS ONLY (●*)
 - LEASE (L)
 - LICENSE OF OCCUPATION (L.O.)
 - CROWN LAND SALES (C.S.)
 - LOCATED LAND (Loc.)
 - CANCELLED (C.)
 - MINING RIGHTS ONLY (M.R.O.)
 - SURFACE RIGHTS ONLY (S.R.O.)
 - HIGHWAY & ROUTE NO. (17)
 - ROADS
 - TRAILS
 - RAILWAYS
 - POWER LINES
 - MARSH OR MUSKEG
 - MINES
- *used only with summer resort locations or when space is limited

TOWNSHIP OF
ST. LOUIS
 DISTRICT OF
 SUDBURY

PORCUPINE
 MINING DIVISION

SCALE : 1 INCH -- 40 CHAINS (1/2 MILE)

DR. K X I
 DATE JAN. '72
 PLAN NO. **M.1127**

REMOVED FROM ACTIVE FILES 90-JUL-19-78
 ONTARIO
 MINISTRY OF NATURAL RESOURCES
 SURVEYS AND MAPPING BRANCH

BENNEWEIS TWP. M.658

THAT MAP LED CES, NOT OSE MIN-CON-NING OF OP-AD-TION THE ON.

47°34'55" Approx. 81°50'51"

1127

ST. LOUIS M-1127

SUDBURY MINING DIVISION

Scale 40 Chains = 1 inch

JACK

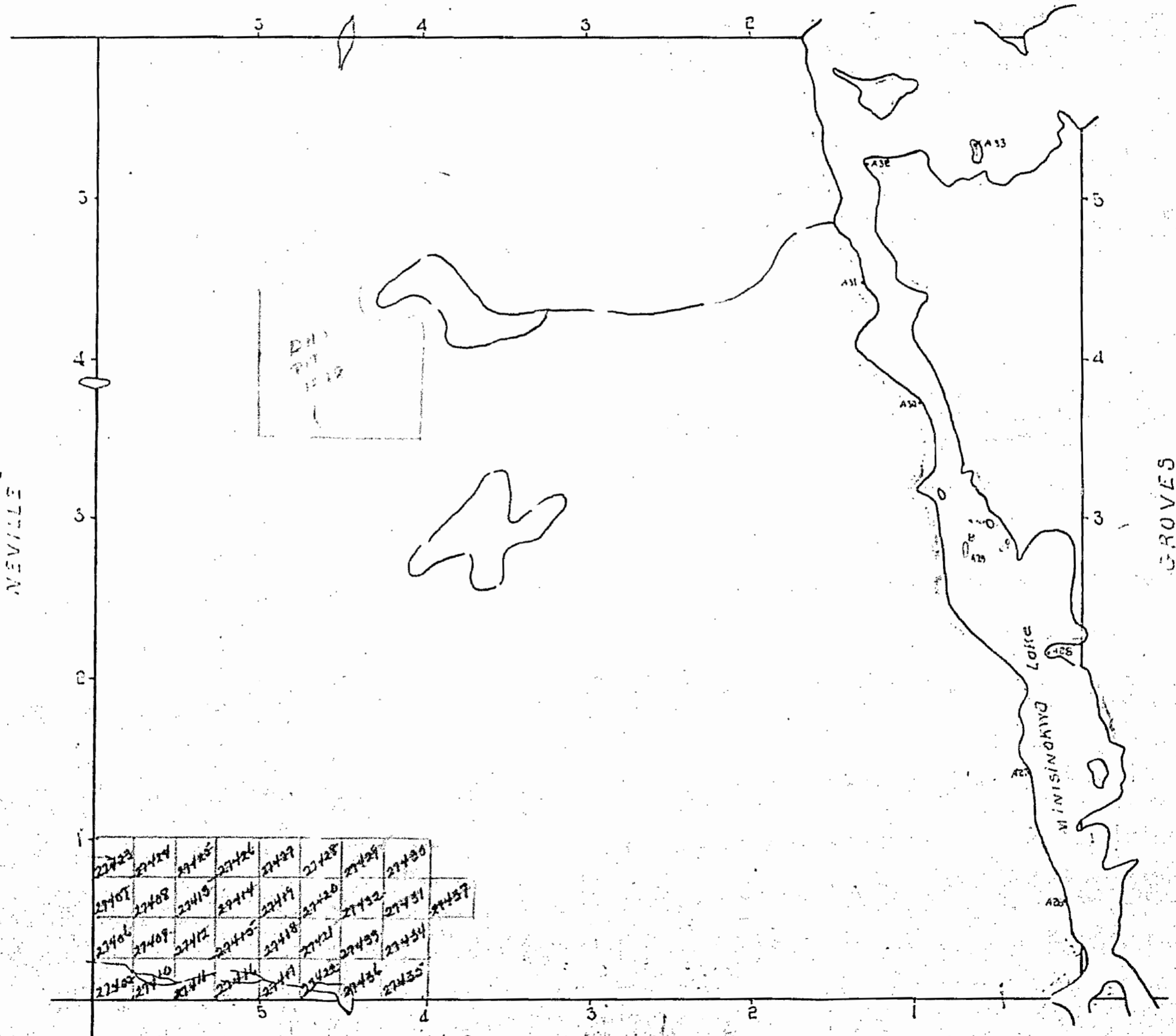

Surface elevations and lines by Dept. of L. & S. Shown herein that ~~is~~

BENNEWEISS

JACK TWP. M.954

NOBLE TWP.
M. 1026









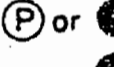

NEVILLE TWP. M.888

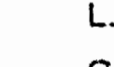
GROVES TWP. M.898

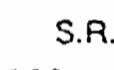
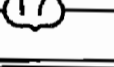
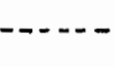
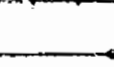
BENNEWEIS TWP. M.658

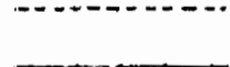
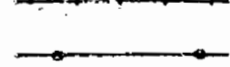
NOTES
400' surface rights reservation along the shores of all lakes and rivers.

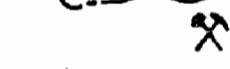
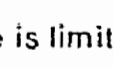
LEGEND

- PATENTED LAND 
- PATENTED FOR SURFACE RIGHTS ONLY 
- LEASE 
- LICENSE OF OCCUPATION 
- CROWN LAND SALES 
- LOCATED LAND 
- CANCELLED 
- MINING RIGHTS ONLY 
- SURFACE RIGHTS ONLY 
- HIGHWAY & ROUTE NO. 
- ROADS 
- TRAILS 
- RAILWAYS 
- POWER LINES 
- MARSH OR MUSKEG 
- MINES 
-  *r.u.p.*
*used only with summer resort locations or when space is limited

TOWNSHIP OF
ST. LOUIS
DISTRICT OF
SUDBURY

SUDBURY
MINING DIVISION

SCALE : 1 INCH = 40 CHAINS (1/2 MILE)

DR. *K.K.I.*
DATE *JAN. '72*
PLAN NO. **M.1127**

ONTARIO
DEPARTMENT OF MINES
AND NORTHERN AFFAIRS

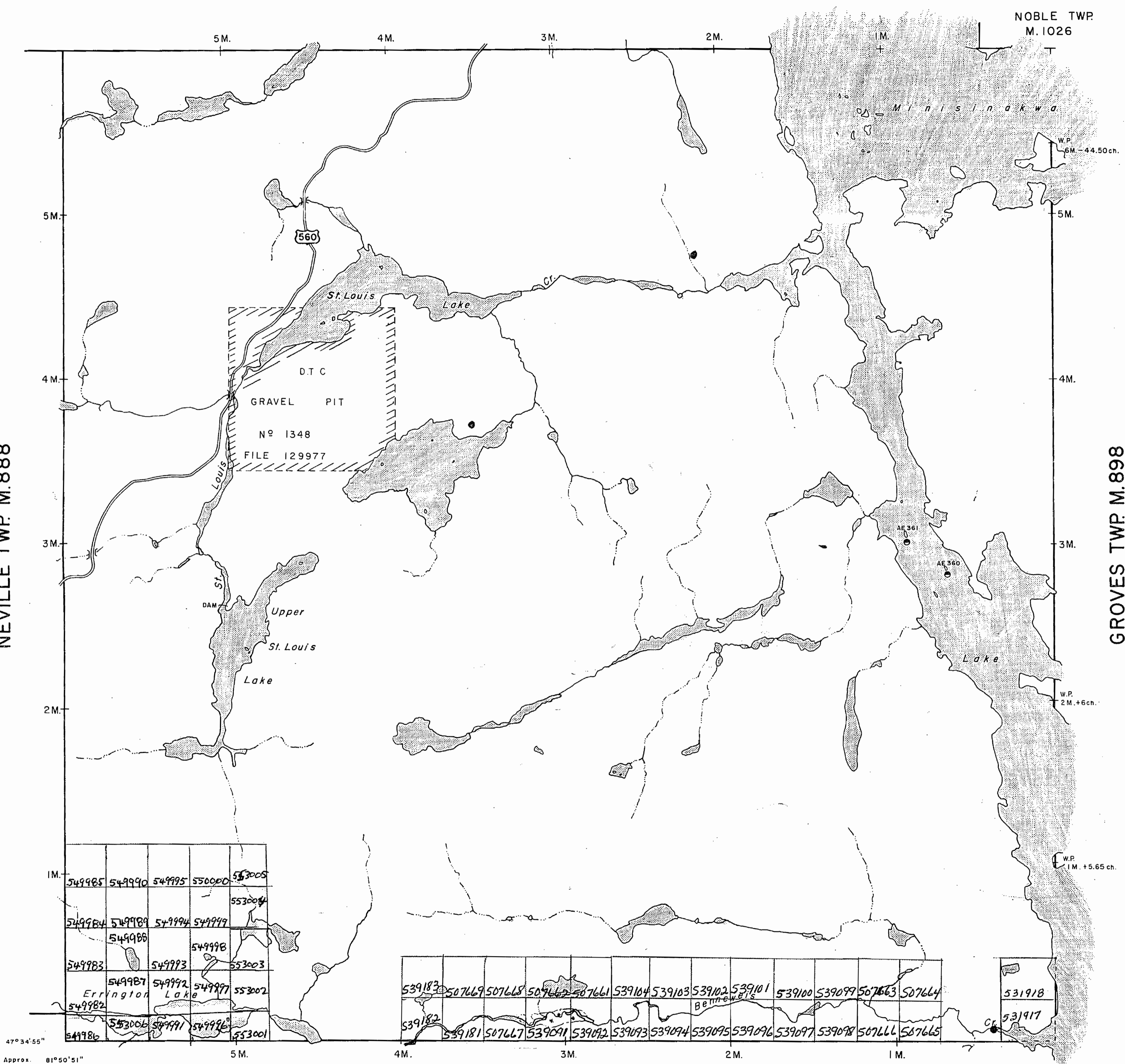

549985	549990	549995	550000	553005
				553004
549984	549989	549994	549999	
	549986			
549983		549993		553003
	549987	549992	549997	553002
549982				
549980	553006	549991	549996	553001

539183	507669	507668	507667	507666	539104	539103	539102	539101	539100	539099	507663	507664	531918
539182	539181	507667	539091	539092	539093	539094	539095	539096	539097	539098	507665	507665	531917

47° 34' 55"
Approx. 81° 50' 51"

1127

ST. LOUIS M-1127

SADBURY MINING DIVISION

Scale 40 Chains = 1 inch

JACK

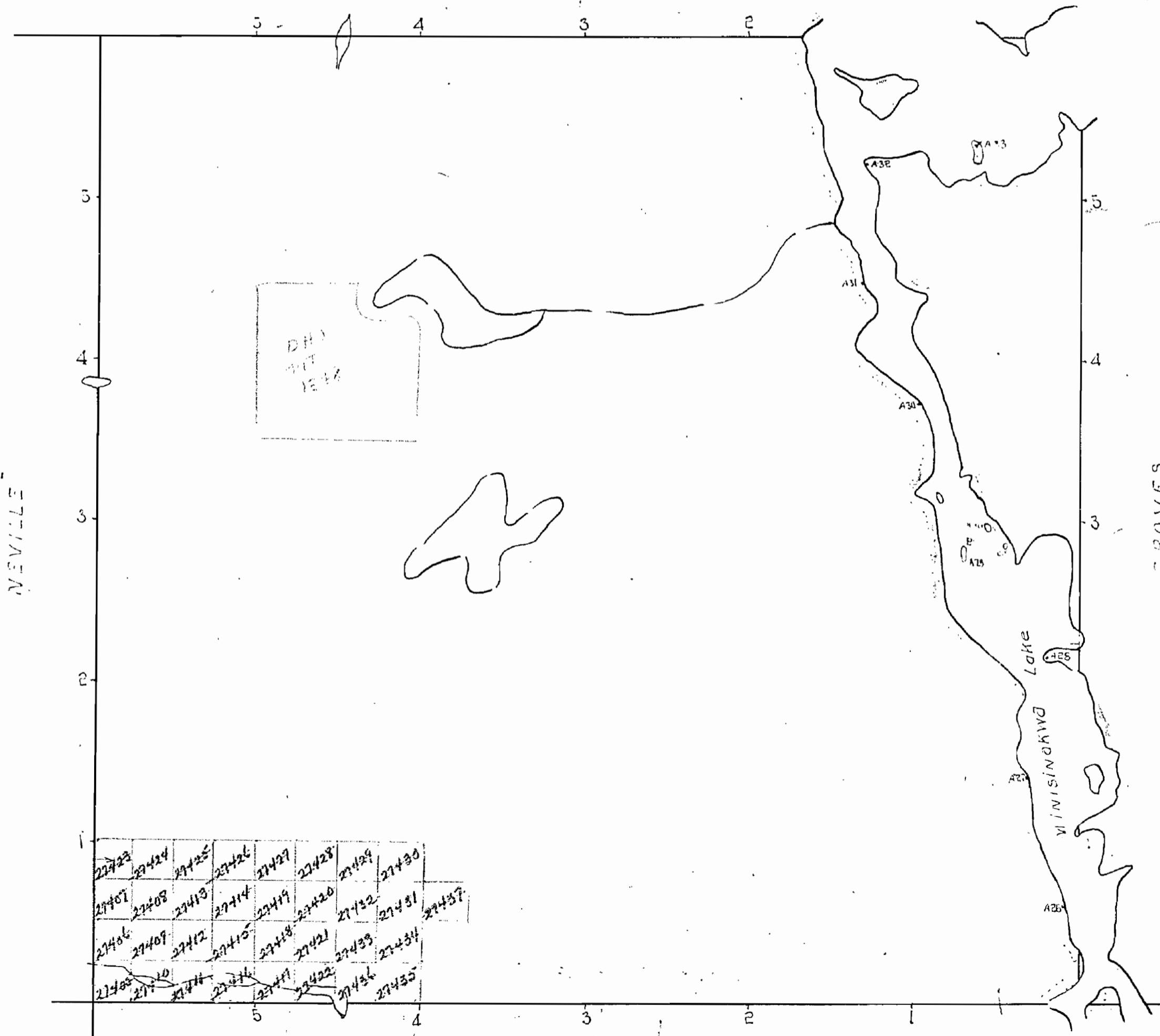

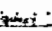
Surface reservations A.D. 1838 by Dept. of L. & F.
Shown herein thus 

BENNEWEISS

1127

ST. LOUIS

M1127

SUDBURY MINING DIVISION

Scale 40 Chains = 1 inch

JACK

ST. LOUIS

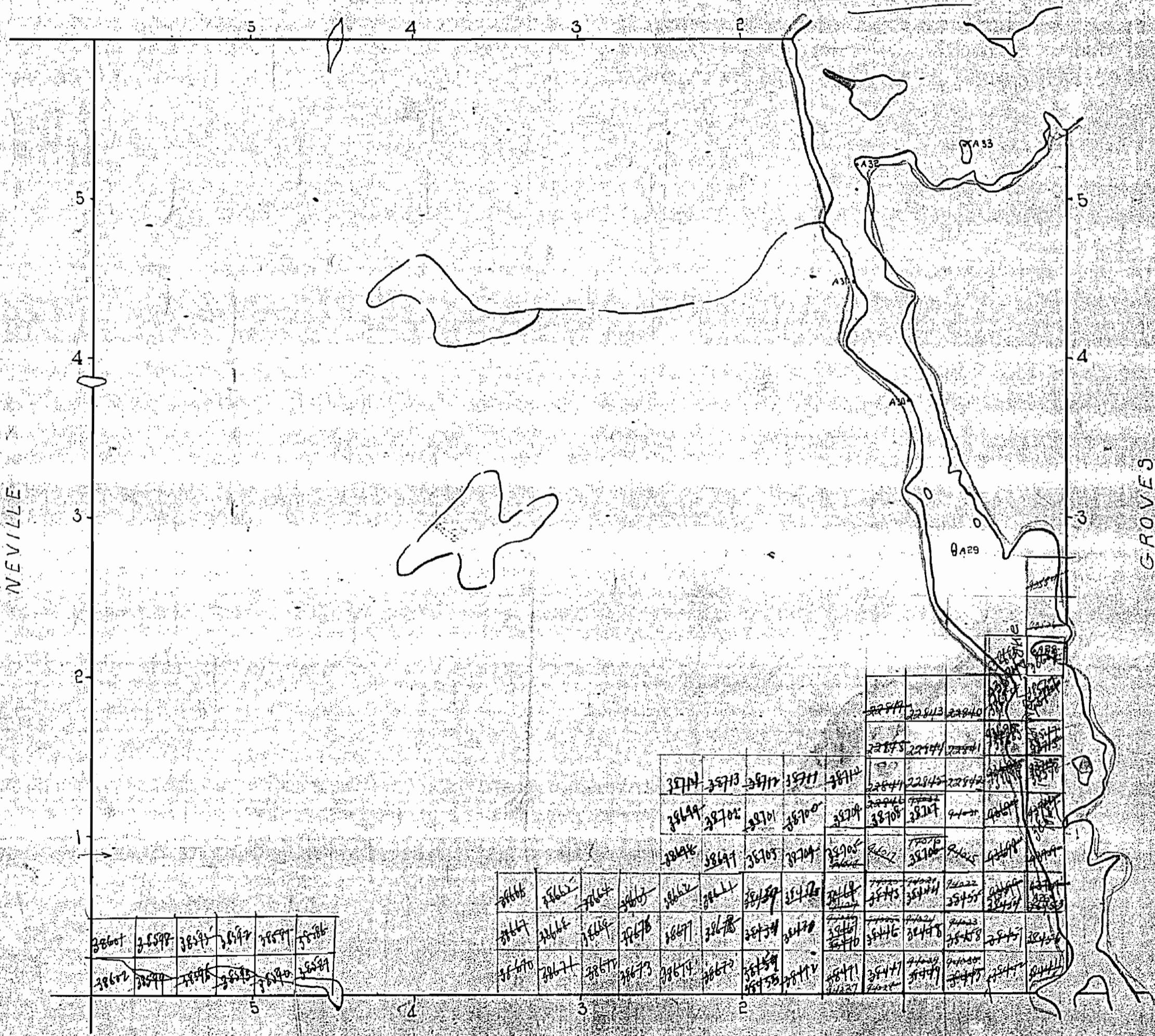

NEVILLE

GROVES

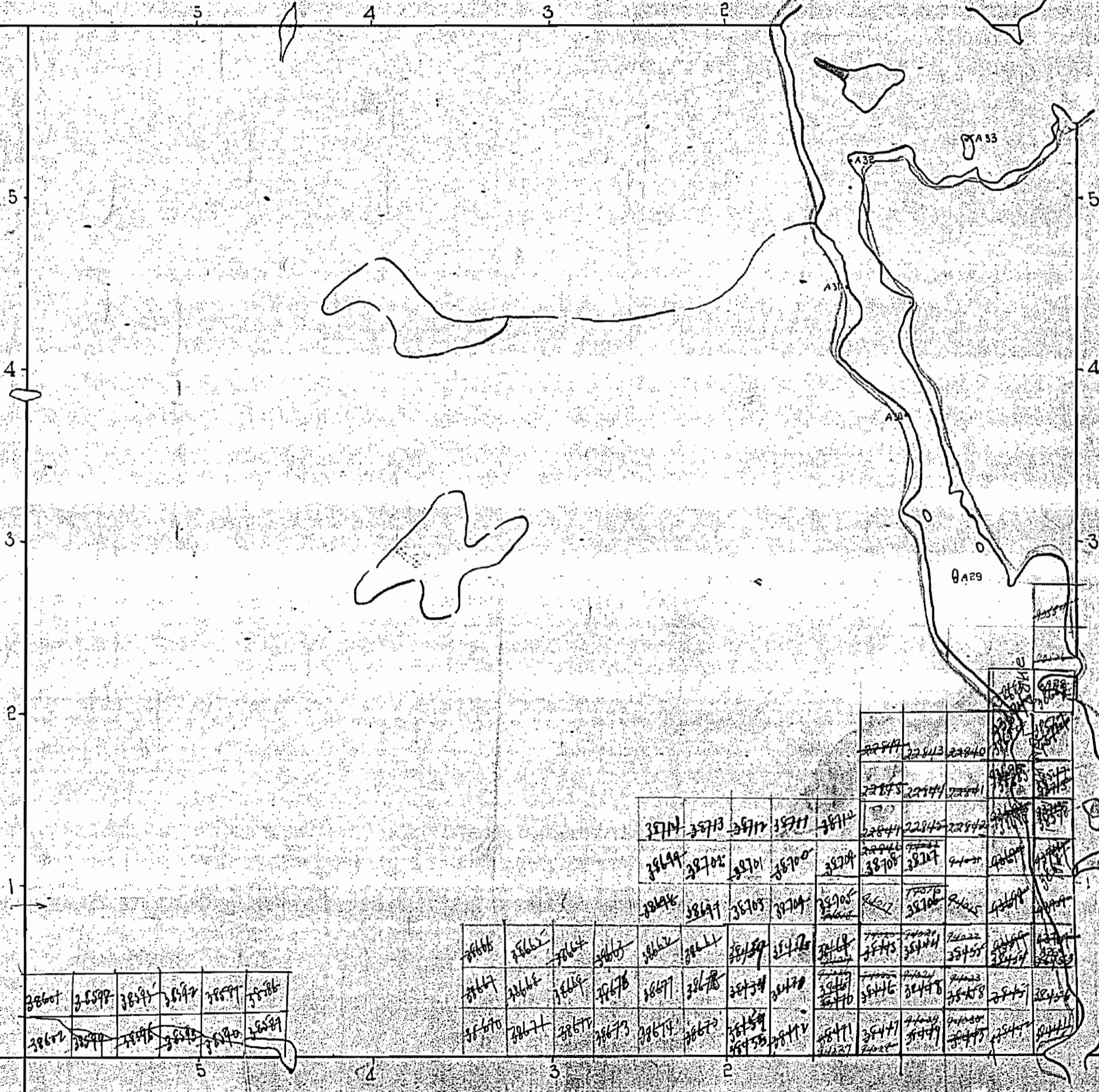

BENNEWEISS

1127

ST. LOUIS

M-1127

SUDBURY MINING DIVISION

Scale 40 Chains = 1 inch

JACK

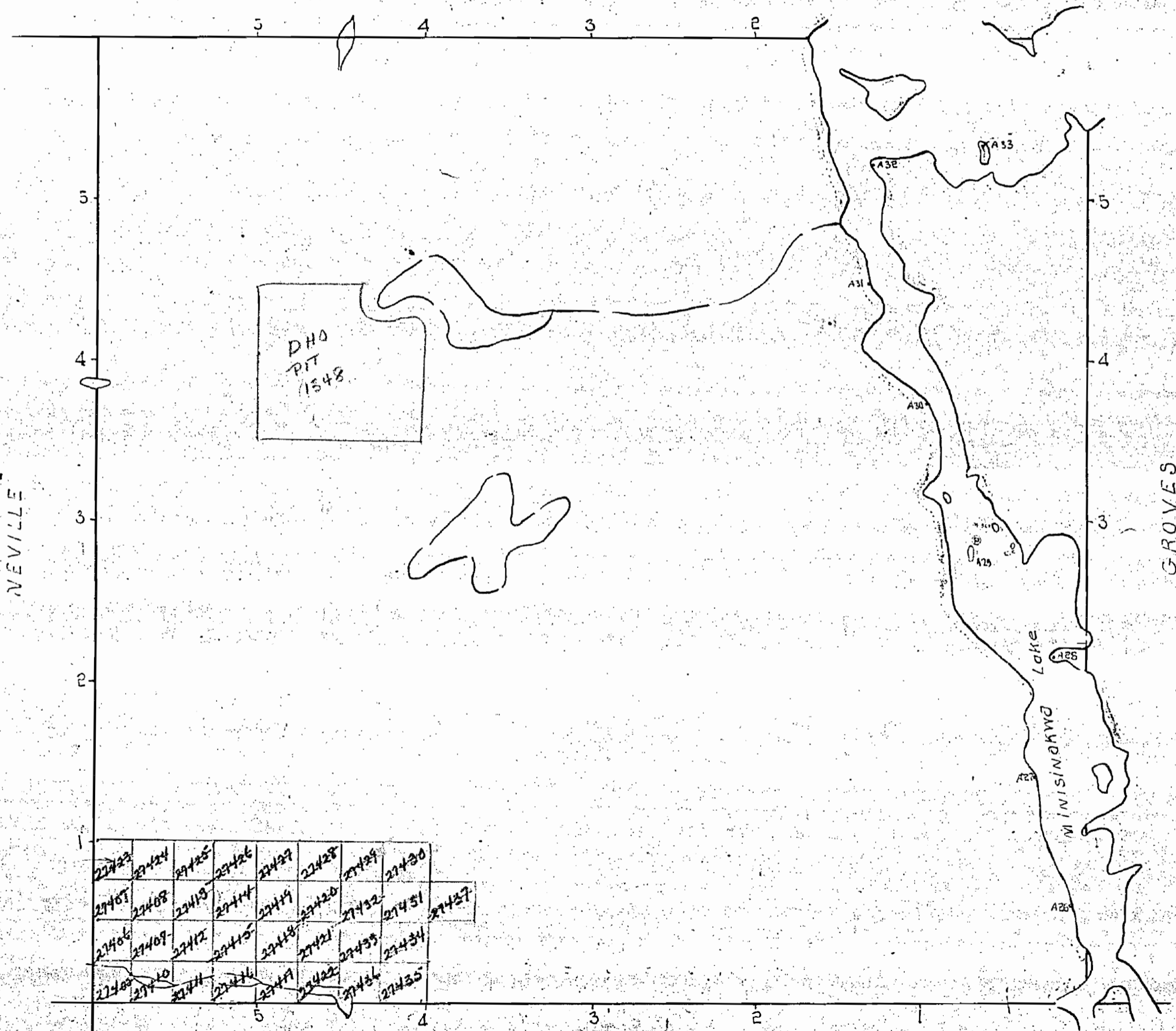

27423	27424	27425	27426	27427	27428	27429	27430
27431	27432	27433	27434	27435	27436	27437	27438
27439	27440	27441	27442	27443	27444	27445	27446
27447	27448	27449	27450	27451	27452	27453	27454
27455	27456	27457	27458	27459	27460	27461	27462

Surface reservations and voids by Dept. of L. & E. shown hereon thus

BENNEWEISS

JACK TWP. M.954

NOBLE TWP.
M. 1026

NOTES

400' surface rights reservation along the shores of all lakes and rivers.

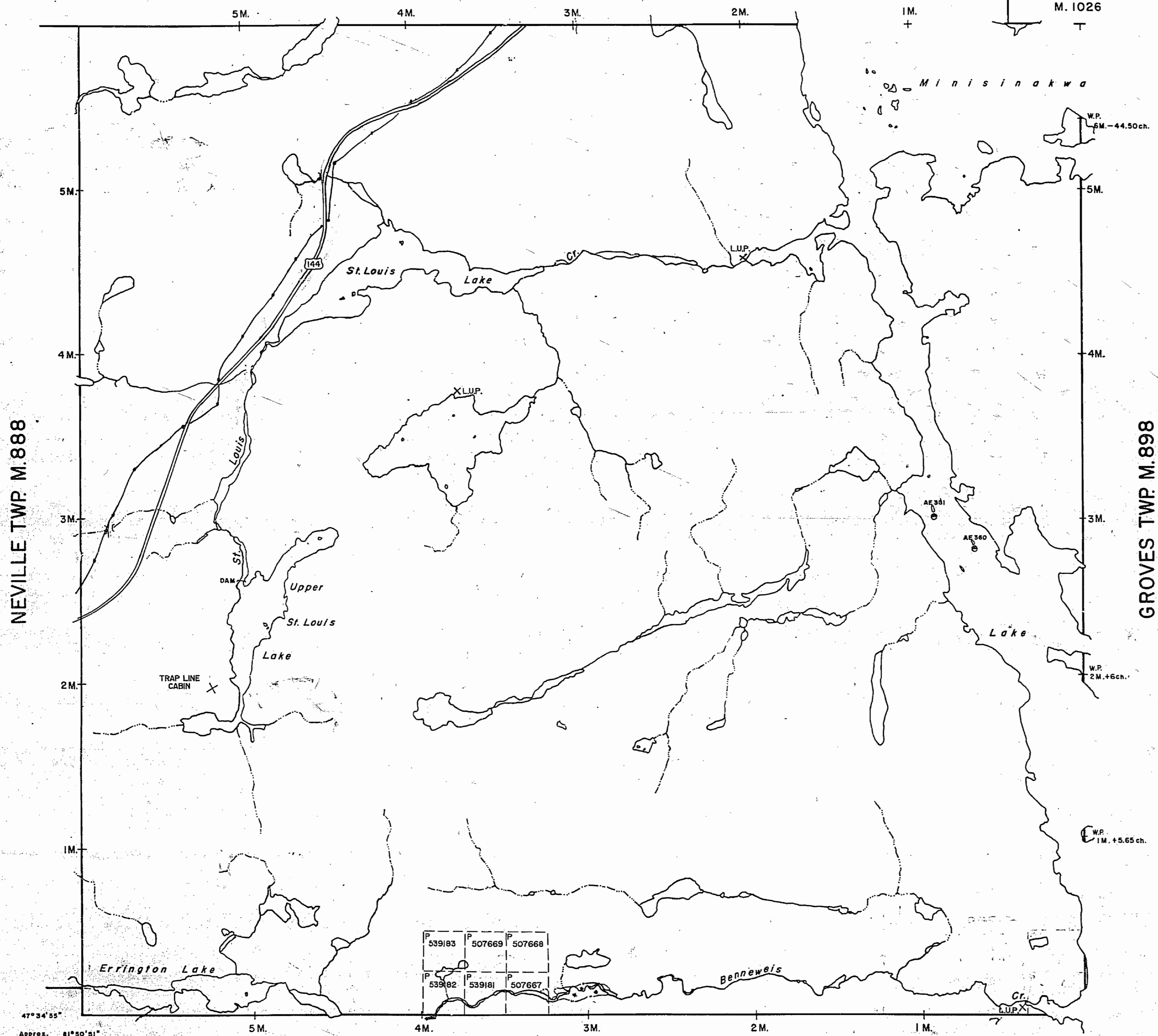

LEGEND

- PATENTED LAND Ⓟ or ●
- PATENTED FOR SURFACE RIGHTS ONLY Ⓟ
- LEASE Ⓞ
- LICENSE OF OCCUPATION L.O.
- CROWN LAND SALES C.S.
- LOCATED LAND Loc.
- CANCELLED C.
- MINING RIGHTS ONLY M.R.O.
- SURFACE RIGHTS ONLY S.R.O.
- HIGHWAY & ROUTE NO.
- ROADS
- TRAILS
- RAILWAYS
- POWER LINES
- MARSH OR MUSKEG
- MINES

*used only with summer resort locations or when space is limited

TOWNSHIP OF

ST. LOUIS

DISTRICT OF
SUDBURY

SUDBURY
MINING DIVISION

SCALE : 1 INCH = 40 CHAINS (1/2 MILE)

DR. *K.K.I.* PLAN NO. **M.1127**

DATE *JAN '72.*

PLAN ACTIVATED 90-JUL-19-*72*

ONTARIO
DEPARTMENT OF MINES
AND NORTHERN AFFAIRS

BENNEWIS TWP. M.658

THAT MAP
LED
CES,
NOT
OSE
MIN
CON-
NING
OF
OP-
RAD-
TION
THE
ON.

47° 34' 55"
Approx. 81° 50' 51"