

NOTES

400' surface rights reservation along the shores of all lakes and rivers.

AREAS WITHDRAWN FROM STAKING

Section	Order No	Date	Disposition	File
4318 5D 10701	W 54/76	10/7/76	S.R.	70461

Withdrawal Order No. W.13/80
 Proposed July 24, 1980
 See Memo of Dir. to M.C.

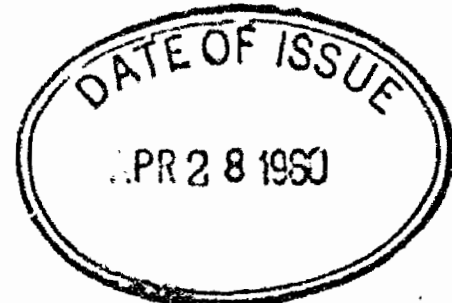

DIEPPE TP. M-761

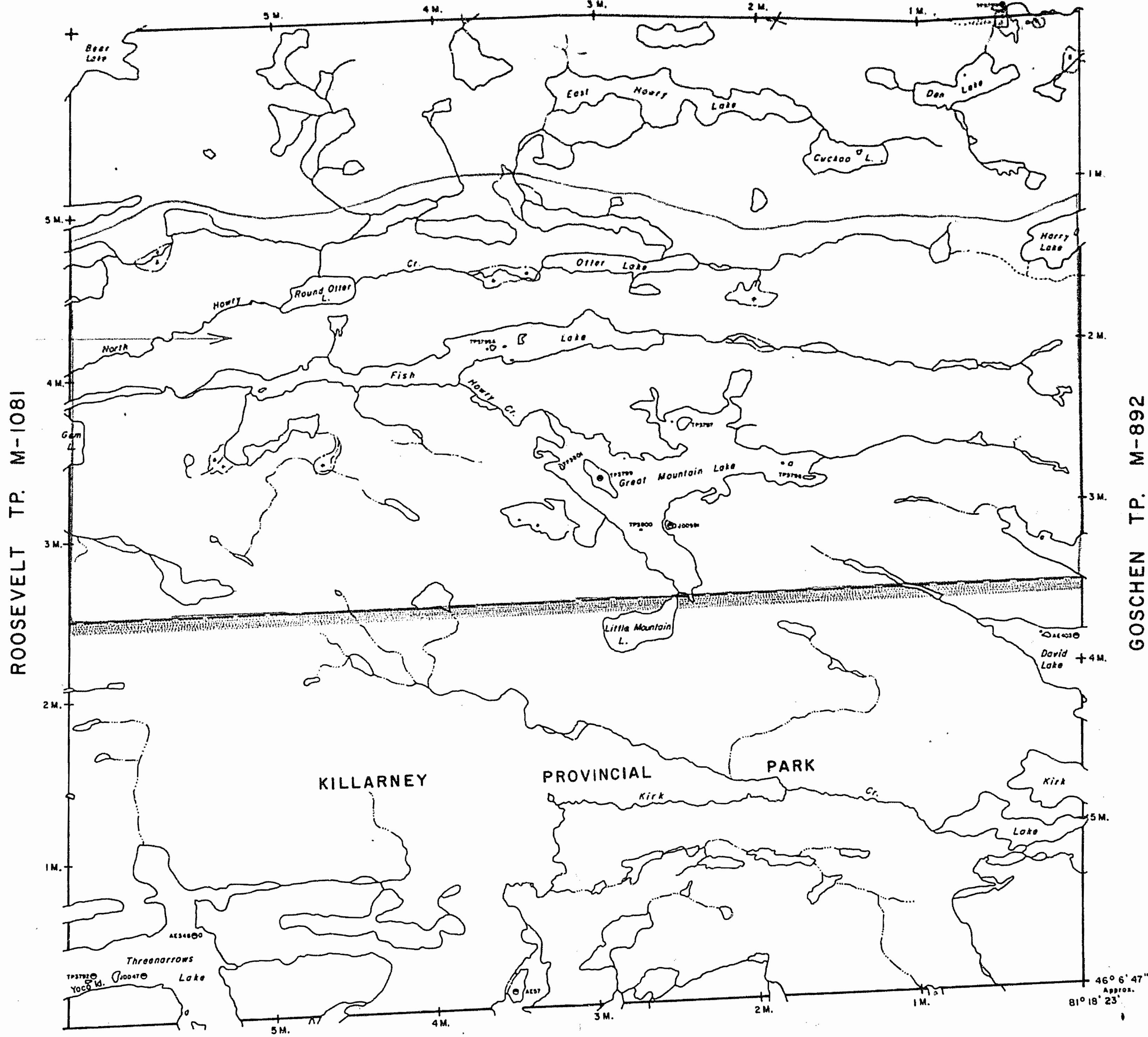

KILLARNEY TP. M-969

LEGEND

- ROADWAY AND ROUTE Nos.
- OTHER ROADS
- TRAILS
- SURVEYED LINES: TOWNSHIPS, BASE LINES, ETC.
- LOTS, MINING CLAIMS, PARCELS, ETC.
- UNSURVEYED LINES: LOT LINES
- PARCEL BOUNDARY MINING CLAIMS ETC.
- RAILWAY AND RIGHT OF WAY
- UTILITY LINES
- NON-PERENNIAL STREAM
- FLOODING OR FLOODING RIGHTS SUBDIVISION
- ORIGINAL SHORELINE
- MARSH OR MUSKOG
- MINES

DISPOSITION OF CROWN LANDS

TYPE OF DOCUMENT	SYMBOL
PATENT, SURFACE & MINING RIGHTS	
- SURFACE RIGHTS ONLY	
- MINING RIGHTS ONLY	
LEASE, SURFACE & MINING RIGHTS	
- SURFACE RIGHTS ONLY	
- MINING RIGHTS ONLY	
LICENCE OF OCCUPATION	
CROWN LAND SALE	
ORDER-IN-COUNCIL	
RESERVATION	
CANCELLED	
SAND & GRAVEL	

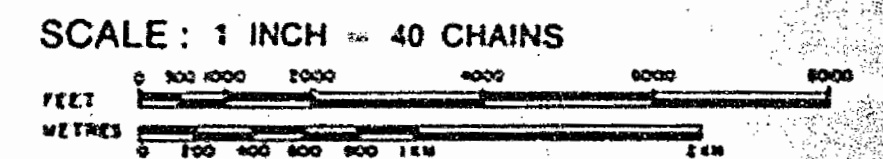

ACRES	HECTARES
40	16

TOWNSHIP
STALIN
 DISTRICT
 SUDBURY
 MINING DIVISION
 SUDBURY

Ministry of Natural Resources

Ontario Surveys and Mapping Branch

Date OCT. 1974

Plan No.

Whitney Block
 Queen's Park, Toronto

M-1124

NOTES

400' surface rights reservation along the shores of all lakes and rivers.

AREAS WITHDRAWN FROM DISPOSITION

- M.R.O. - MINING RIGHTS ONLY
- S.R.O. - SURFACE RIGHTS ONLY
- M.S. - MINING AND SURFACE RIGHTS

Description	Order No.	Date	Disposition	Folio
42NR5019701	W14/76	10/19/76	S.R.O.	10441

DIEPPE TP. M-761

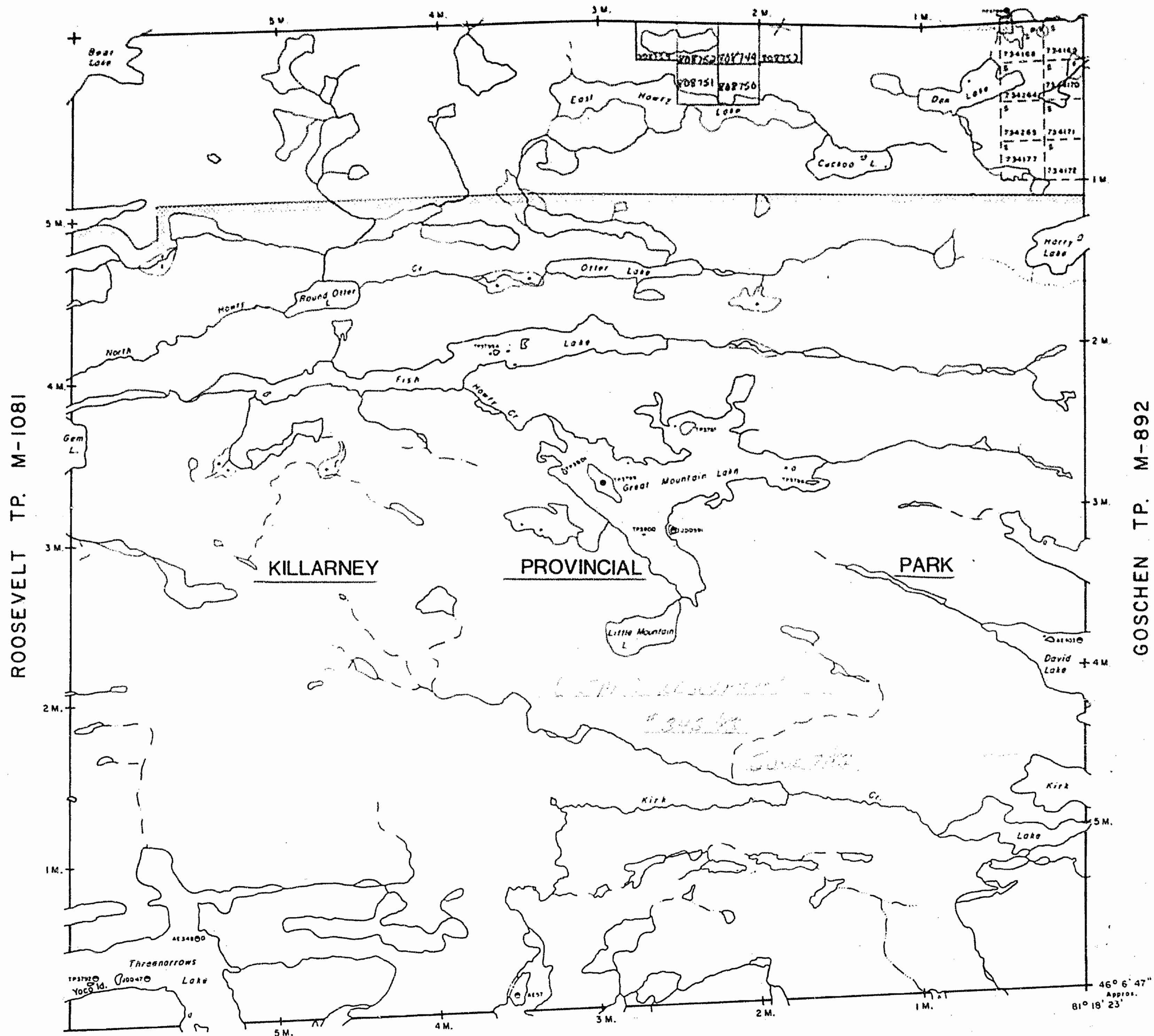

ROOSEVELT TP. M-1081

GOSCHEN TP. M-892

KILLARNEY TP. M-969

LEGEND

- HIGHWAY AND ROUTE Nos
- OTHER ROADS
- TRAILS
- SURVEYED LINES
- TOWNSHIP, BASE LINES, ETC
- LOTS, MINING CLAIMS, PARCELS, ETC
- UNSURVEYED LINES
- LOT LINES
- PARCEL BOUNDARY
- MINING CLAIMS ETC
- RAILWAY AND RIGHT OF WAY
- UTILITY LINES
- NON-PERENNIAL STREAM
- FLOODING OR FLOODING RIGHTS
- SUBDIVISION
- ORIGINAL SHORELINE
- MARSH OR MUSHEG
- MINES

DISPOSITION OF CROWN LANDS

TYPE OF DOCUMENT	SYMBOL
PATENT, SURFACE & MINING RIGHTS	●
SURFACE RIGHTS ONLY	○
MINING RIGHTS ONLY	◐
LEASE, SURFACE & MINING RIGHTS	■
SURFACE RIGHTS ONLY	□
MINING RIGHTS ONLY	◑
LICENCE OF OCCUPATION	▼
CROWN LAND SALE	CS
ORDER-IN-COUNCIL	OC
RESERVATION	⊙
CANCELLED	⊖
SAND & GRAVEL	⊙

* IN SERVICE 1984 04 - 06

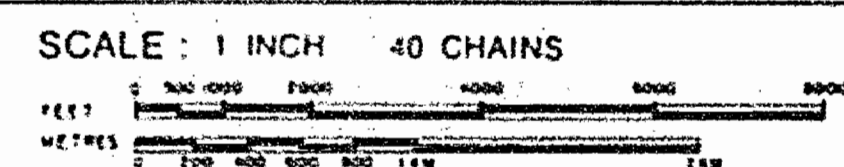

ACRES	HECTARES
40	16

TOWNSHIP
STALIN
DISTRICT
SUBBURY
MINING DIVISION
SUBBURY

Ministry of Natural Resources
 Ontario Surveys and Mapping Branch
 Date **OCT. 1974** Plan No. **M-1124**
 Whitney Block
 Queen's Park, Toronto

MAP SYMBOLOLOGY

Aerial Cableway	Pipeline
Boundary	Railroad
International	Single Track
District, Township	Abandoned
Indian Reserve	Turntable
Approximate	Road
Lot, Concession	Highway, County
Approximate	Township
Perk Boundary	Access (road of doubtful
Bridge	significance or
Beam, Ballroad	significant driveway)
Building	Trail, Bush Road
Chimney	(single, alley)
Cliff, Pit, Pile	Rapids
Contours	Double line river
Interpreted	with multiple rapids
Approximate	Double line river
Depression	with multiple rapids
Control Points	Reservoir
Horizontal	River, Stream, Canal
Vertical	Approximate
Culvert	Shoals
Falls	Spot Elevation
Double line river	(lake elevations)
Fence, Hedge, Wall	Tower
Feature Outline	Transmission Line
(Construction Features, etc.)	Poles
Flooded Land	Pipeline
Lock	Tunnel
Marsh or Swamp	Utility Poles
Mast	Wharf, Dock, Pier
Mine Head Frame	Wooded Area
Outcrop	

AREAS WITHDRAWN FROM DISPOSITION

M.R.O. -- MINING RIGHTS ONLY
 S.R.O. -- SURFACE RIGHTS ONLY
 M.S. -- MINING AND SURFACE RIGHTS

Description	Order No.	Date	Disposition	File
43 IRSD 19701	W54/76	10/9/76	M.S.	70441

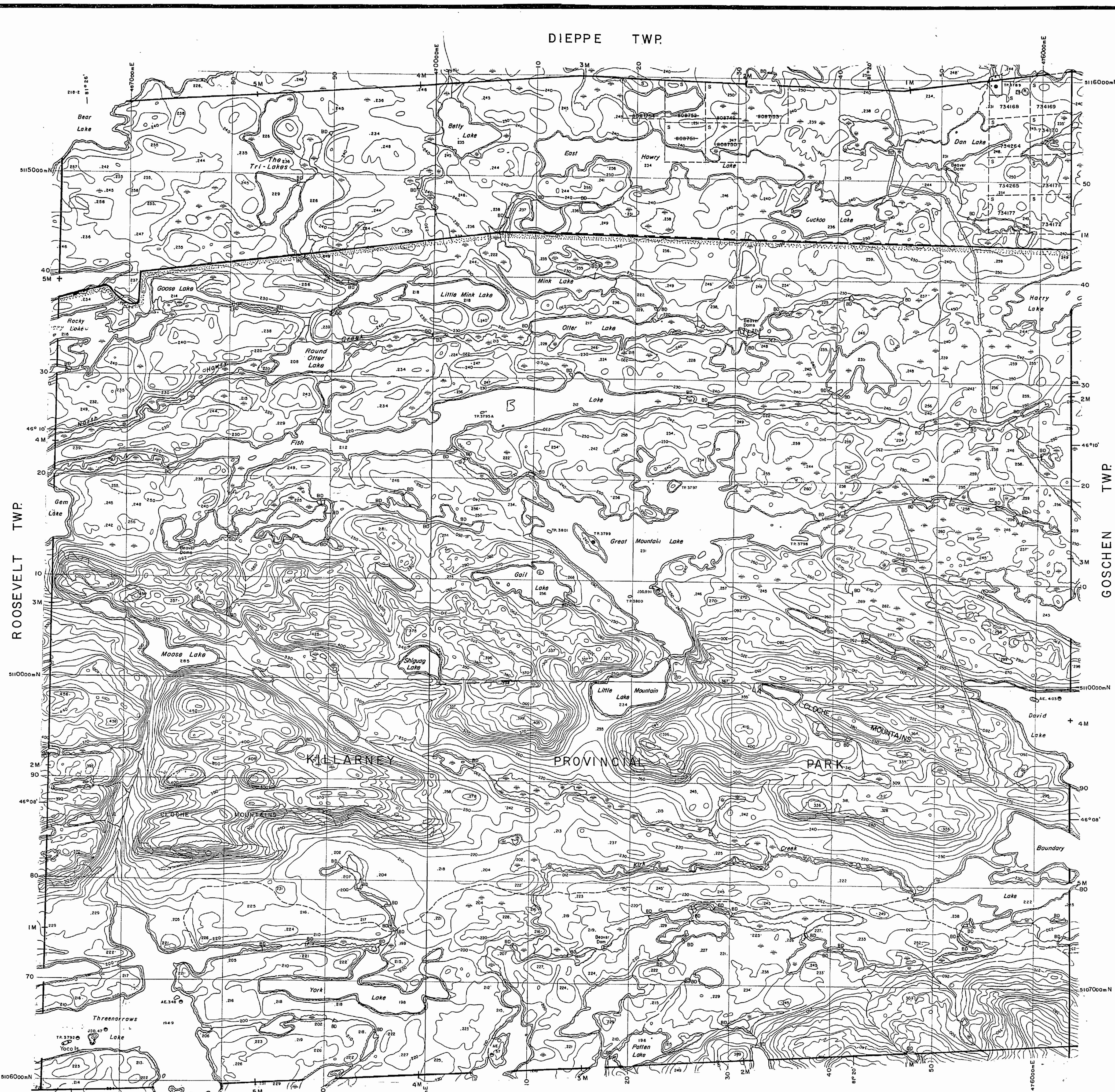

LEGEND

HIGHWAY AND ROUTE No.
 OTHER ROADS

TRAILS

SURVEYED LINES:
 TOWNSHIPS, BASE LINES, ETC.
 LOTS, MINING CLAIMS, PARCELS, ETC.

UNSURVEYED LINES:
 LOT LINES
 PARCEL BOUNDARY
 MINING CLAIMS ETC.

RAILWAY AND RIGHT OF WAY

UTILITY LINES

NON PERENNIAL STREAM

FLOODING OR FLOODING RIGHTS

SUBDIVISION OR COMPOSITE PLAN

RESERVATIONS

ORIGINAL SHORELINE

MARSH OR MUSKEG

MINES

TRAVERSE MONUMENT

DISPOSITION OF CROWN LANDS

TYPE OF DOCUMENT	SYMBOL
PATENT, SURFACE & MINING RIGHTS	○
" SURFACE RIGHTS ONLY	○
" MINING RIGHTS ONLY	○
LEASE, SURFACE & MINING RIGHTS	■
" SURFACE RIGHTS ONLY	■
" MINING RIGHTS ONLY	■
LICENCE OF OCCUPATION	○
ORDER-IN-COUNCIL	OC
RESERVATION	○
CANCELLED	○
SAND & GRAVEL	○

NOTE: MINING RIGHTS IN PARCELS PATENTED PRIOR TO MAY 8, 1913, VESTED IN ORIGINAL PATENTEES BY THE PUBLIC LANDS ACT, R.S.O. 1970, CHAP. 390, SEC. 83, SUBSEC. 1.

Scale bars in Meters (0-1000), Chains (0-70), and Feet (0-5000).

SCALE 1:20 000
 GRID ZONE : 17

RECEIVED
 JUL 29 1985

TOWNSHIP
STALIN
 M.N.R. ADMINISTRATIVE DISTRICT
 SUDBURY
 MINING DIVISION
 SUDBURY
 LAND TITLES / REGISTRY DIVISION
 SUDBURY

Ministry of Natural Resources
 Ontario

Land Management Branch

Original Compilation: JUNE, 1985

Number
G-3198

1124

STALIN TWP. TOWNSHIP 82.

FORMERLY

FORMERLY TIMBER BERTH

DISTRICT OF SUDBURY

Scale 40 Chains = 1 Inch

TWP 83

400' *Old*

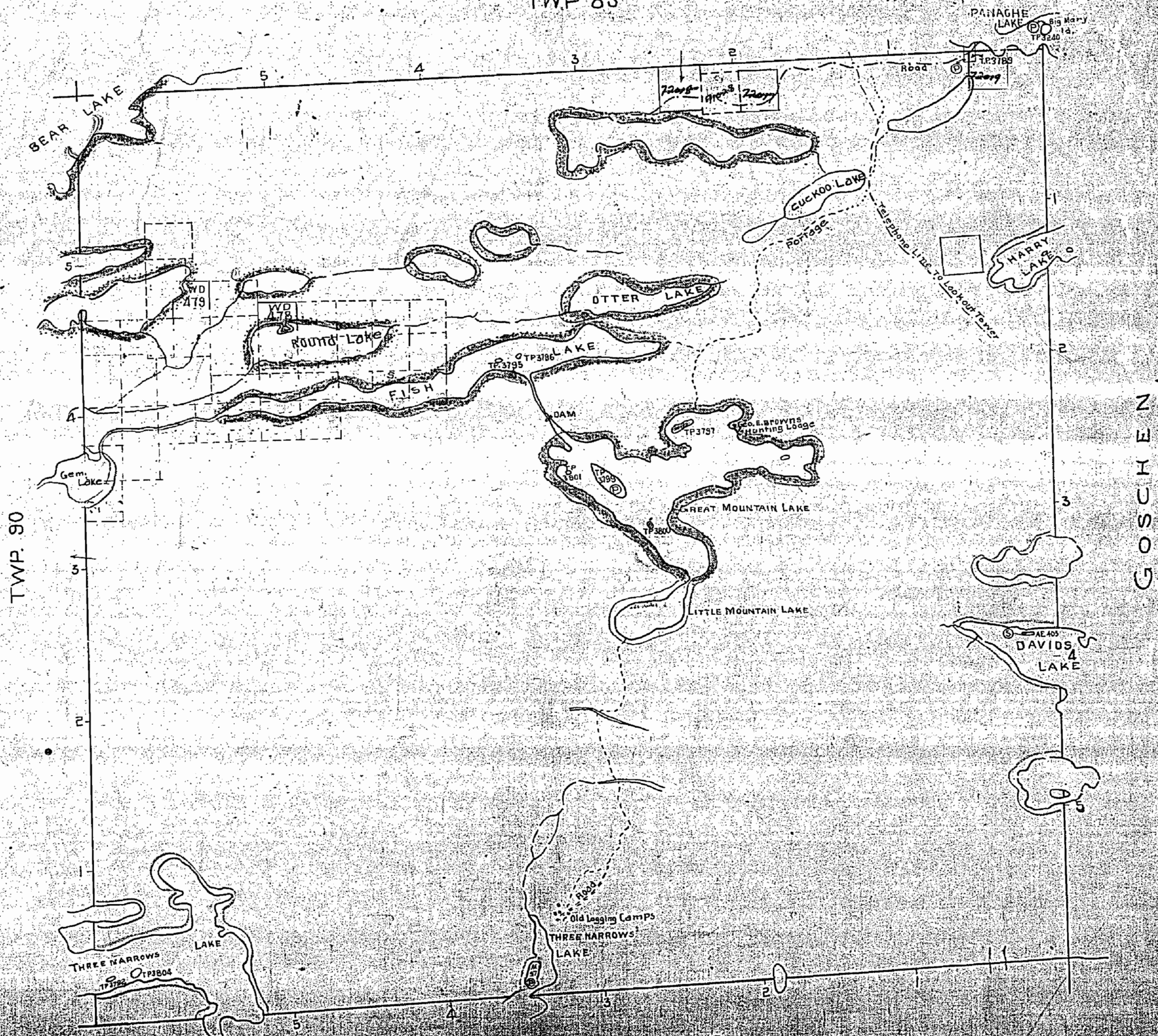

GOSCHEN

TIMBER BERTH 10

M 1124

*Survey of the...
from...*

1124

STALIN TWP. TOWNSHIP 82.

FORMERLY

FORMERLY TIMBER BERTH

DISTRICT OF SUDBURY

Scale 40 Chains = 1 Inch

TWP 83

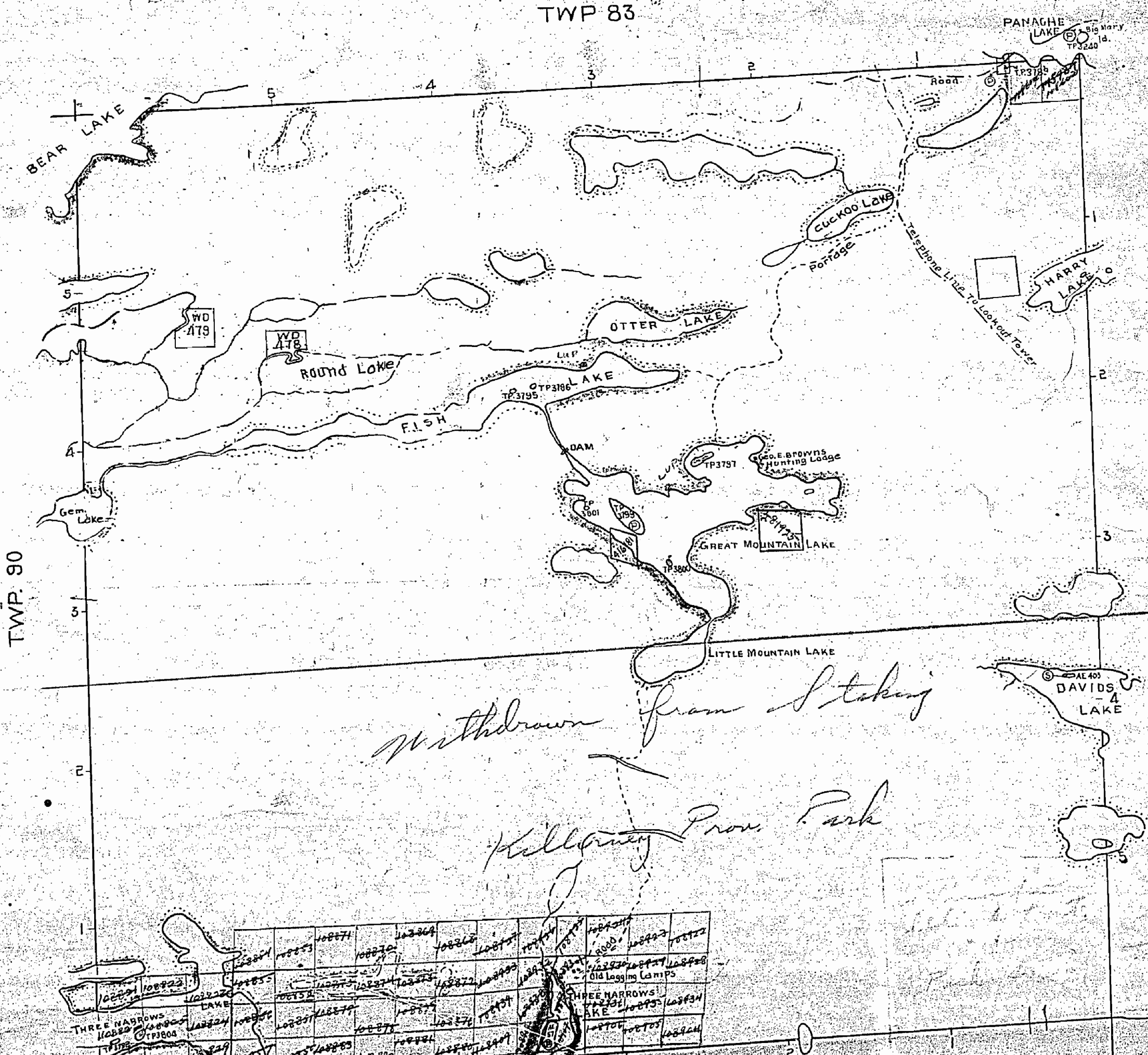

TWP. 90

GOSCHEN

Withdrawn from Staking
Hillberry Prov. Park

108221	108222	108223	108224	108225	108226	108227	108228	108229	108230	108231	108232	108233	108234	108235	108236	108237	108238	108239	108240
108241	108242	108243	108244	108245	108246	108247	108248	108249	108250	108251	108252	108253	108254	108255	108256	108257	108258	108259	108260
108261	108262	108263	108264	108265	108266	108267	108268	108269	108270	108271	108272	108273	108274	108275	108276	108277	108278	108279	108280
108281	108282	108283	108284	108285	108286	108287	108288	108289	108290	108291	108292	108293	108294	108295	108296	108297	108298	108299	108300

M1124

TIMBER BERTH 10

STALIN

STALIN TWP. FORMERLY TOWNSHIP 82.

FORMERLY TIMBER BERTH
DISTRICT OF SUDBURY

Scale 40 Chains = 1 Inch

TWP 83

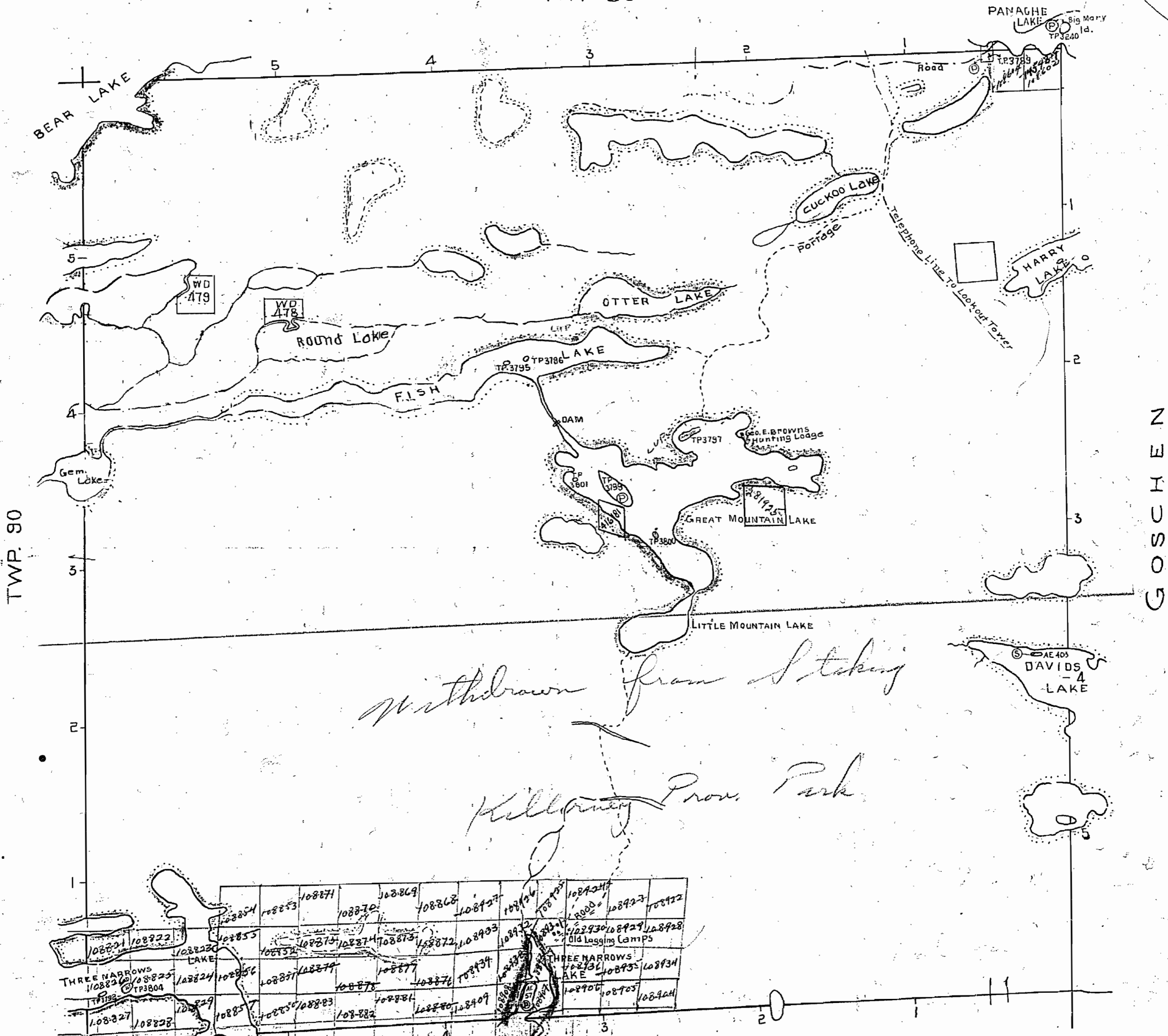

Withdrawn from Staking

Killbuck Prox. Park

108821	108822	108823	108824	108825	108826	108827	108828	108829	108830	108831	108832	108833	108834	108835	108836	108837	108838	108839	108840	108841	108842	108843	108844	108845	108846	108847	108848	108849	108850	108851	108852	108853	108854	108855	108856	108857	108858	108859	108860	108861	108862	108863	108864	108865	108866	108867	108868	108869	108870	108871	108872	108873	108874	108875	108876	108877	108878	108879	108880	108881	108882	108883	108884	108885	108886	108887	108888	108889	108890	108891	108892	108893	108894	108895	108896	108897	108898	108899	108900	108901	108902	108903	108904	108905	108906	108907	108908	108909	108910	108911	108912	108913	108914	108915	108916	108917	108918	108919	108920	108921	108922	108923	108924	108925	108926	108927	108928	108929	108930	108931	108932	108933	108934	108935	108936	108937	108938	108939	108940	108941	108942	108943	108944	108945	108946	108947	108948	108949	108950	108951	108952	108953	108954	108955	108956	108957	108958	108959	108960	108961	108962	108963	108964	108965	108966	108967	108968	108969	108970	108971	108972	108973	108974	108975	108976	108977	108978	108979	108980	108981	108982	108983	108984	108985	108986	108987	108988	108989	108990	108991	108992	108993	108994	108995	108996	108997	108998	108999	109000
--------	--------	--------	--------	--------	--------	--------	--------	--------	--------	--------	--------	--------	--------	--------	--------	--------	--------	--------	--------	--------	--------	--------	--------	--------	--------	--------	--------	--------	--------	--------	--------	--------	--------	--------	--------	--------	--------	--------	--------	--------	--------	--------	--------	--------	--------	--------	--------	--------	--------	--------	--------	--------	--------	--------	--------	--------	--------	--------	--------	--------	--------	--------	--------	--------	--------	--------	--------	--------	--------	--------	--------	--------	--------	--------	--------	--------	--------	--------	--------	--------	--------	--------	--------	--------	--------	--------	--------	--------	--------	--------	--------	--------	--------	--------	--------	--------	--------	--------	--------	--------	--------	--------	--------	--------	--------	--------	--------	--------	--------	--------	--------	--------	--------	--------	--------	--------	--------	--------	--------	--------	--------	--------	--------	--------	--------	--------	--------	--------	--------	--------	--------	--------	--------	--------	--------	--------	--------	--------	--------	--------	--------	--------	--------	--------	--------	--------	--------	--------	--------	--------	--------	--------	--------	--------	--------	--------	--------	--------	--------	--------	--------	--------	--------	--------	--------	--------	--------	--------	--------	--------	--------	--------	--------	--------	--------	--------	--------	--------	--------

TIMBER BERTH 10

M 1124

Surface reservations 200 wide by Dept of L & F
shown hereon thus ~~represented~~

STALIN

STALIN TWP. TOWNSHIP 82.

FORMERLY

FORMERLY TIMBER BERTH

DISTRICT OF SUDBURY

Scale 40 Chains = 1 Inch

TWP 83

400' Plus
add

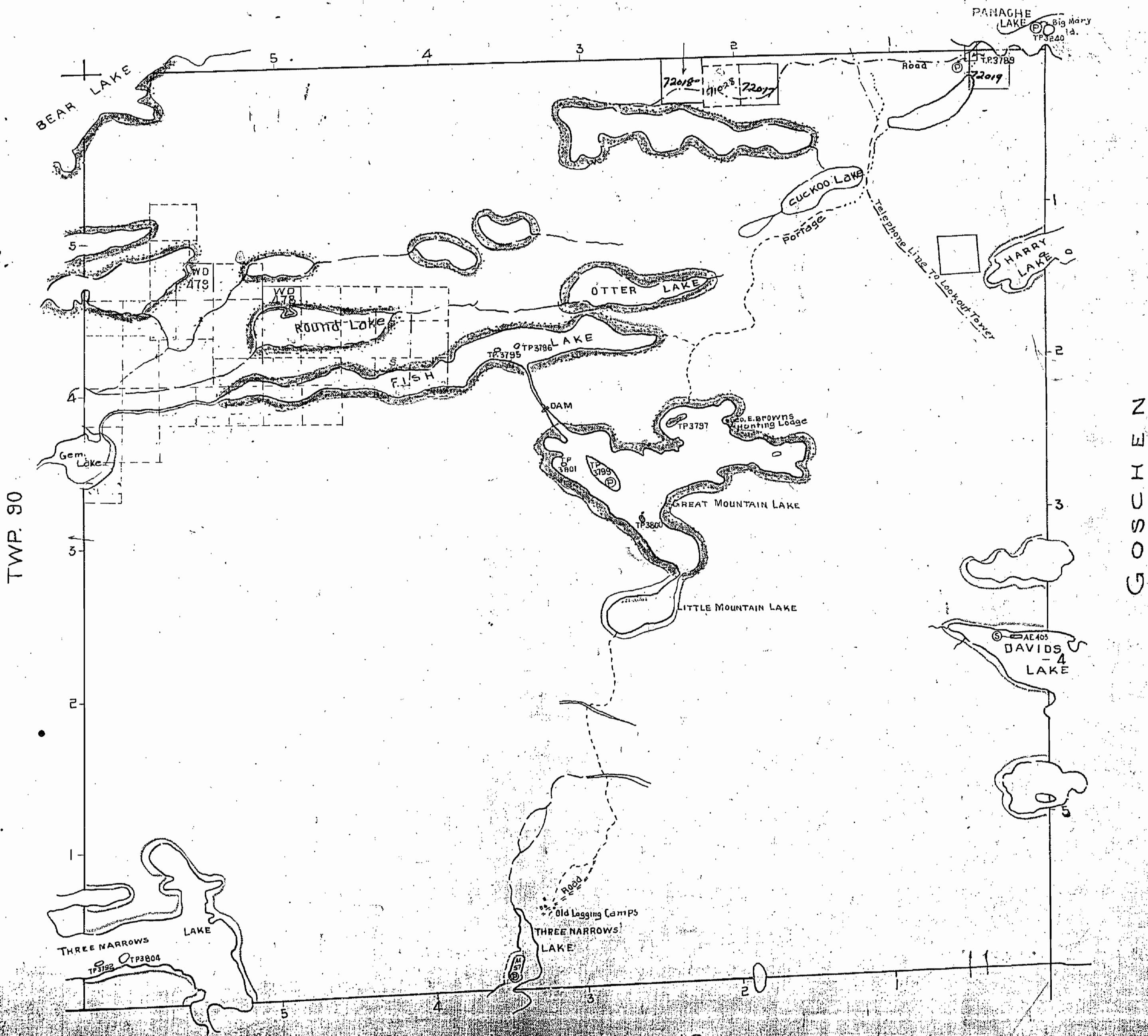

TWP. 90

N
E
H
U
S
O
G

TIMBER BERTH 10

M 1124

1124

*Surface reservations 200' wide by D.A. ...
Sheldon Birgeon - July*

1124

STALIN TWP. FORMERLY TOWNSHIP 82.

FORMERLY

FORMERLY TIMBER BERTH

DISTRICT OF SUDBURY

Scale 40 Chains = 1 Inch

TWP 83

400' Bar
Old

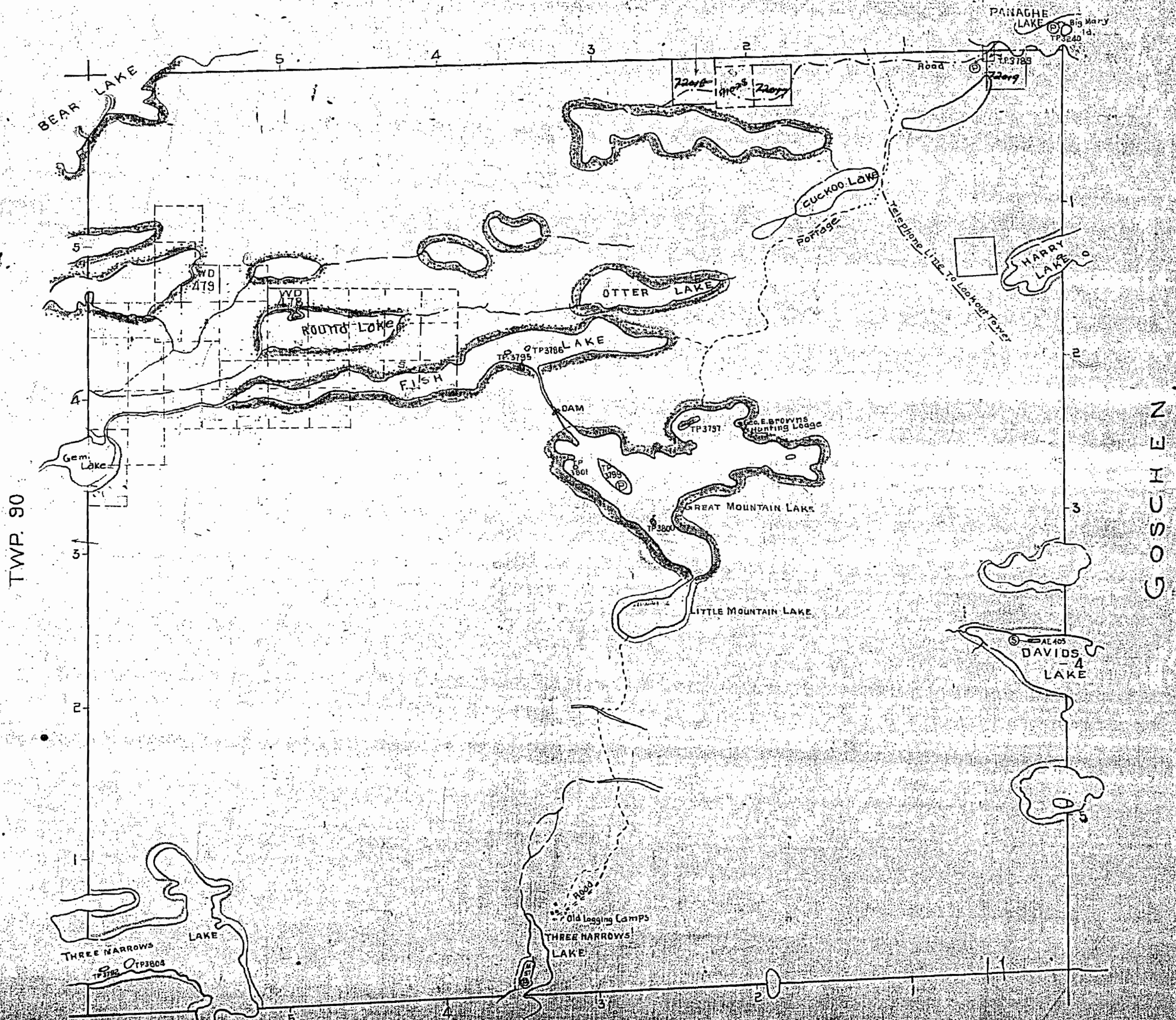

GOSHEN

TIMBER BERTH 10

M 1124

*Surface elevations 20 feet
above sea level.*

1124

STALIN TWP. TOWNSHIP 82.

FORMERLY

FORMERLY TIMBER BERTH

DISTRICT OF SUDBURY

Scale 40 Chains = 1 Inch

TWP 83



*Withdrawn from Staking
Hulltown Prov. Park*

108871	108872	108873	108874	108875	108876	108877	108878	108879	108880	108881	108882	108883	108884	108885	108886	108887	108888	108889	108890	108891	108892	108893	108894	108895	108896	108897	108898	108899	108900
108901	108902	108903	108904	108905	108906	108907	108908	108909	108910	108911	108912	108913	108914	108915	108916	108917	108918	108919	108920	108921	108922	108923	108924	108925	108926	108927	108928	108929	108930
108931	108932	108933	108934	108935	108936	108937	108938	108939	108940	108941	108942	108943	108944	108945	108946	108947	108948	108949	108950	108951	108952	108953	108954	108955	108956	108957	108958	108959	108960

TIMBER BERTH 10

M1124

STALIN

NOTES

400' surface rights reservation along the shores of all lakes and rivers.

~~R1~~ S.R. + M.R. WITHDRAWN FROM STAKING W/13/80 see Carlyle Twp. Land Roll

* Replaced by Ontario Regulation No. 343/83. (June 7/1983)

OFFICE USE ONLY

DIEPPE TP. M-761

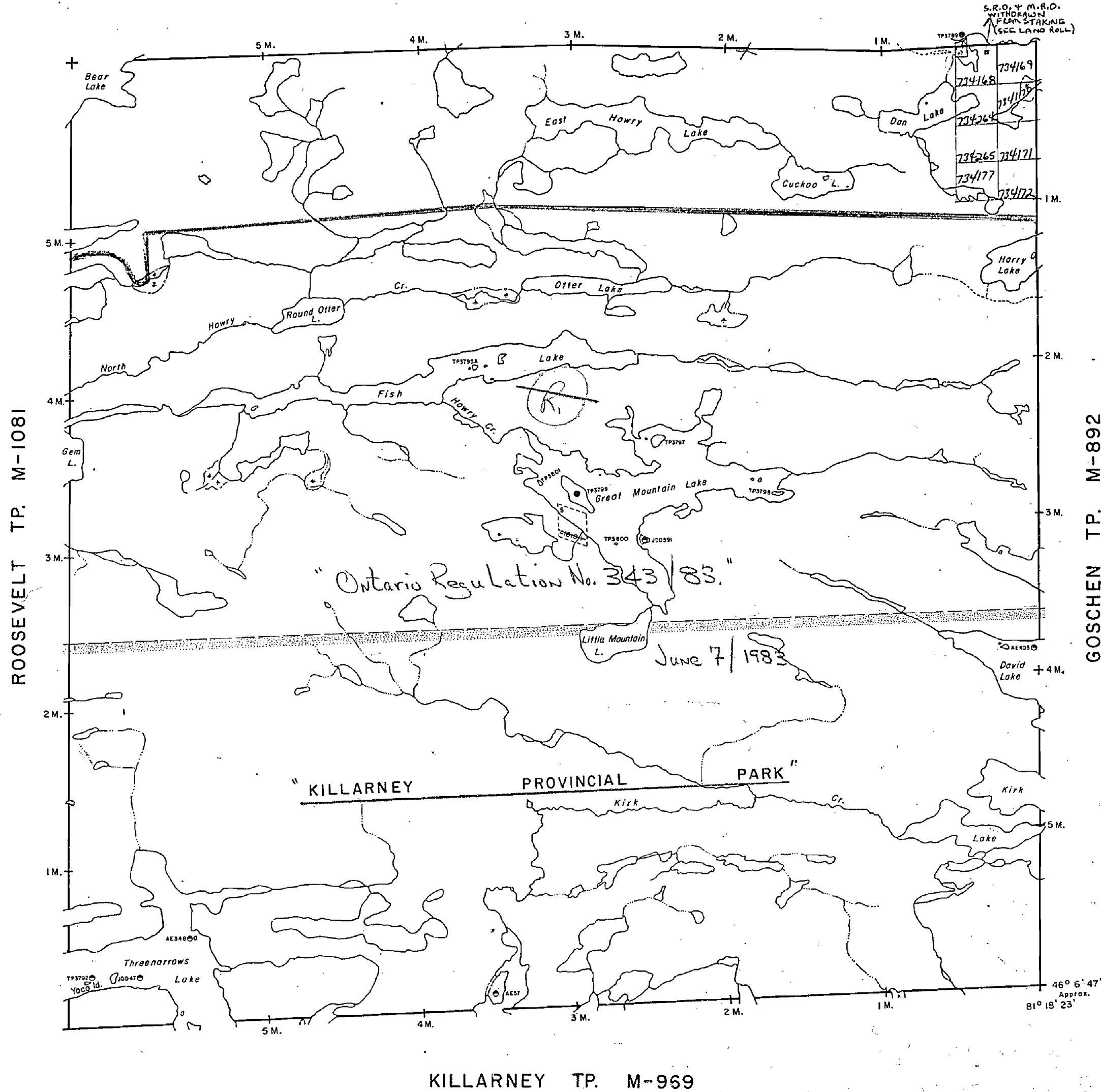

LEGEND

- HIGHWAY AND ROUTE No.
- OTHER ROADS
- TRAILS
- SURVEYED LINES:
 - TOWNSHIPS, BASE LINES, ETC.
 - LOTS, MINING CLAIMS, PARCELS, ETC.
- UNSURVEYED LINES:
 - LOT LINES
 - PARCEL BOUNDARY
 - MINING CLAIMS ETC.
- RAILWAY AND RIGHT OF WAY
- UTILITY LINES
- NON-PERENNIAL STREAM
- FLOODING OR FLOODING RIGHTS
- SUBDIVISION
- ORIGINAL SHORELINE
- MARSH OR MUSKEG
- MINES

DISPOSITION OF CROWN LANDS

TYPE OF DOCUMENT	SYMBOL
PATENT, SURFACE & MINING RIGHTS	
" SURFACE RIGHTS ONLY	
" MINING RIGHTS ONLY	
LEASE, SURFACE & MINING RIGHTS	
" SURFACE RIGHTS ONLY	
" MINING RIGHTS ONLY	
LICENCE OF OCCUPATION	
CROWN LAND SALE	C.S.
ORDER-IN-COUNCIL	OC
RESERVATION	
CANCELLED	
SAND & GRAVEL	

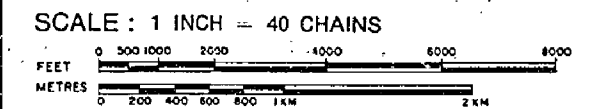

ACRES	HECTARES
40	16

TOWNSHIP

STALIN

DISTRICT

SUDBURY

MINING DIVISION

SUDBURY

Ministry of Natural Resources

Ontario Surveys and Mapping Branch

Date OCT. 1974

Plan No.

Whitney Block
Queen's Park, Toronto

M-1124

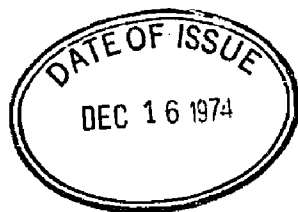

KILLARNEY TP. M-969

NOTES

400' surface rights reservation along the shores of all lakes and rivers.

AREAS WITHDRAWN FROM DISPOSITION

- M.R.O. - MINING RIGHTS ONLY
- S.R.O. - SURFACE RIGHTS ONLY
- M.+S. - MINING AND SURFACE RIGHTS

Description	Order No.	Date	Disposition	File
43(RSO1970)	W 54/76	10/9/76	S.R.O.	70441

DIEPPE TP. M-761

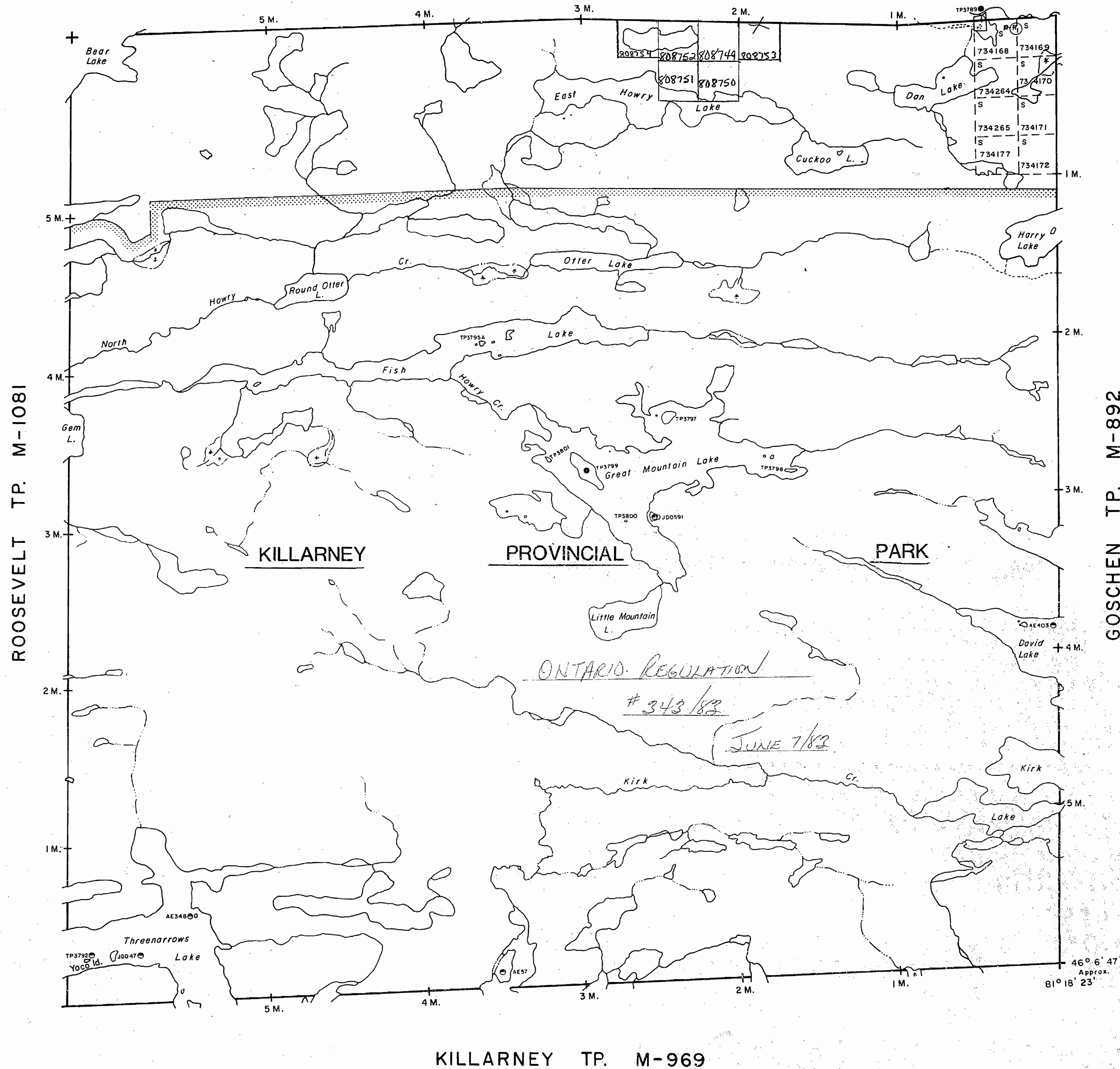

LEGEND

- HIGHWAY AND ROUTE No.
- OTHER ROADS
- TRAILS
- SURVEYED LINES:
 - TOWNSHIPS, BASE LINES, ETC.
 - LOTS, MINING CLAIMS, PARCELS, ETC.
- UNSURVEYED LINES:
 - LOT LINES
 - PARCEL BOUNDARY
 - MINING CLAIMS ETC.
- RAILWAY AND RIGHT OF WAY
- UTILITY LINES
- NON-PERENNIAL STREAM
- FLOODING OR FLOODING RIGHTS
- SUBDIVISION
- ORIGINAL SHORELINE
- MARSH OR MUSKEG
- MINES

DISPOSITION OF CROWN LANDS

TYPE OF DOCUMENT	SYMBOL
PATENT, SURFACE & MINING RIGHTS	
" SURFACE RIGHTS ONLY	
" MINING RIGHTS ONLY	
LEASE, SURFACE & MINING RIGHTS	
" SURFACE RIGHTS ONLY	
" MINING RIGHTS ONLY	
LICENCE OF OCCUPATION	
CROWN LAND SALE	C.S.
ORDER-IN-COUNCIL	OC
RESERVATION	
CANCELLED	
S.R.O. & GRAVEL	

* IN SERVICE 1984 04 - 10

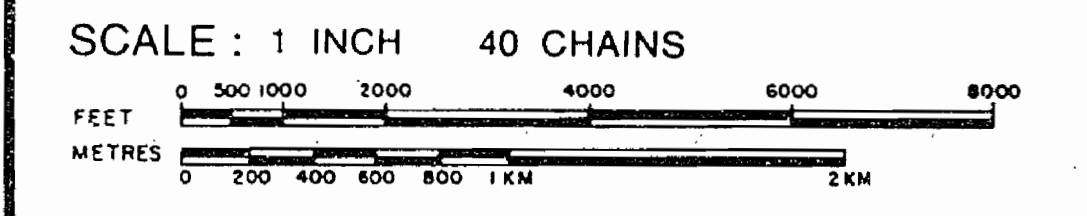

ACRES	HECTARES
40	16

TOWNSHIP
STALIN

DISTRICT
SUDBURY

MINING DIVISION
SUDBURY

Ministry of Natural Resources
Ontario Surveys and Mapping Branch

Date: OCT. 1974 Plan No. M-1124

Whitney Block
Queen's Park, Toronto

KILLARNEY TP. M-969