

PLAN OF SOUTH STURGEON LAKE AREA.

PORT ARTHUR MINING DIVISION.

DISTRICT OF THUNDER BAY.

SCALE 40 CHAINS TO AN INCH.

N. PT. of STURGEON LAKE AREA.

PORT ARTHUR
RECEIVED
FEB 29 1902
MINING DIVISION

PORT ARTHUR
RECEIVED
FEB 29 1902
MINING DIVISION

DISTRICT OF KENORA
RED LAKE MINING DIVISION
S.W. PT. of STURGEON LAKE AREA

HARMON LAKE AREA

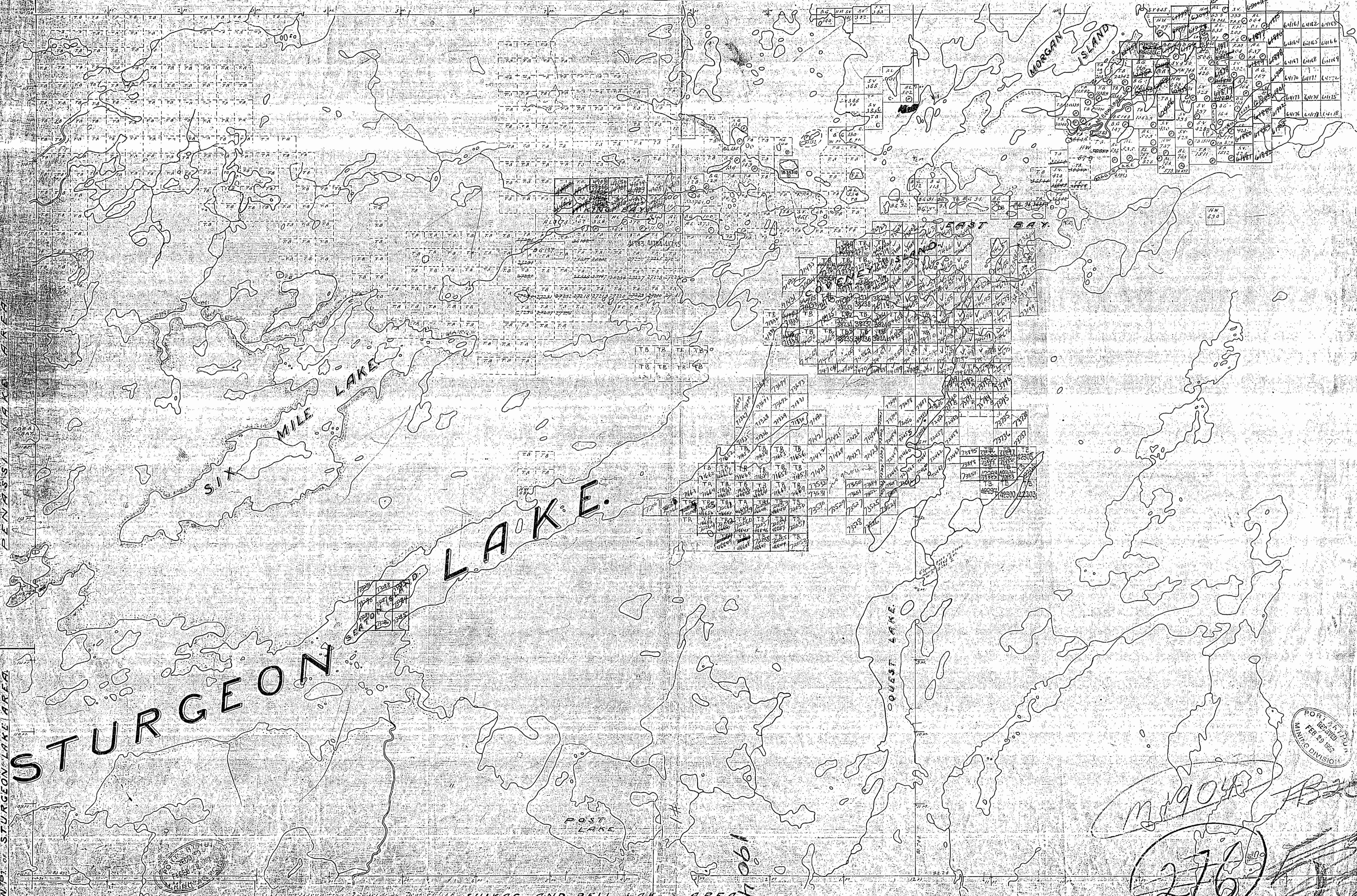

STURGEON LAKE.

SIX MILE LAKE.

MORGAN ISLAND.

QUEST LAKE.

POST LAKE.

SHIKAG. AND BELL LAKE'S AREA.

PORT ARTHUR
RECEIVED
FEB 29 1902
MINING DIVISION

PORT ARTHUR
RECEIVED
FEB 29 1902
MINING DIVISION

M 1904
276
AB 205

1906

THE INFORMATION THAT APPEARS ON THIS MAP HAS BEEN COMPILED FROM VARIOUS SOURCES AND ACCURACY IS NOT GUARANTEED. THOSE WISHING TO STAKE CLAIMS SHOULD CONSULT WITH THE MINING RECORDER, THE MINING NORTHERN DEVELOPMENT AND MINES, FOR ADDITIONAL INFORMATION ON THE STATUS OF THE LANDS SHOWN HEREON.

This area lies within Quetico Prov. Park Withdrawn from staking.

LEGEND

- HIGHWAY AND ROUTE No.
- OTHER ROADS
- TRAILS
- SURVEYED LINES:
 - TOWNSHIPS, BASE LINES, ETC.
 - LOTS, MINING CLAIMS, PARCELS, ETC.
- UNSURVEYED LINES:
 - LOT LINES
 - PARCEL BOUNDARY
 - MINING CLAIMS ETC.
- RAILWAY AND RIGHT OF WAY
- UTILITY LINES
- NON-PERENNIAL STREAM
- FLOODING OR FLOODING RIGHTS
- SUBDIVISION OR COMPOSITE PLAN
- RESERVATIONS
- ORIGINAL SHORELINE
- MARSH OR MUSKEG
- MINES
- TRAVERSE MONUMENT

DISPOSITION OF CROWN LANDS

TYPE OF DOCUMENT	SYMBOL
PATENT, SURFACE & MINING RIGHTS	
SURFACE RIGHTS ONLY	
MINING RIGHTS ONLY	
LEASE, SURFACE & MINING RIGHTS	
SURFACE RIGHTS ONLY	
MINING RIGHTS ONLY	
LICENCE OF OCCUPATION	
ORDER-IN-COUNCIL	
RESERVATION	
CANCELLED	
SAND & GRAVEL	
LAND USE PERMITS FOR COMMERCIAL TOURISM/OUTPOST CAMPS	

NOTE: MINING RIGHTS IN PARCELS PATENTED PRIOR TO MAY 1913, VESTED IN ORIGINAL PATENTEE BY THE PUBLIC LANDS ACT, R.S.O. 1970, CHAP. 380, SEC. 63, SUBSEC. 1.

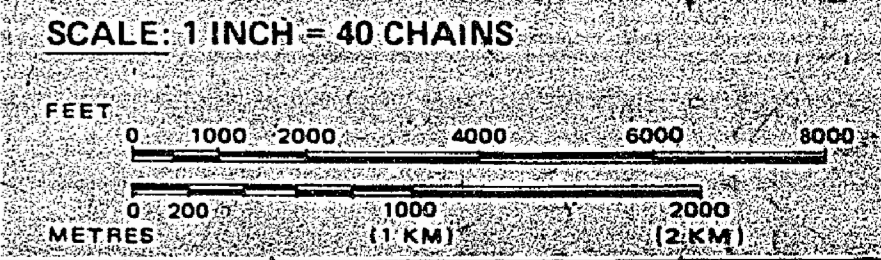

AREA
STURGEON LAKE
 M.N.R. ADMINISTRATIVE DISTRICT
ATIKOKAN
 MINING DIVISION
THUNDER BAY
 LAND TITLES / REGISTRY DIVISION
RAINY RIVER

Ontario Ministry of Natural Resources Land Management Branch
 Date: **MARCH 22, 1982**

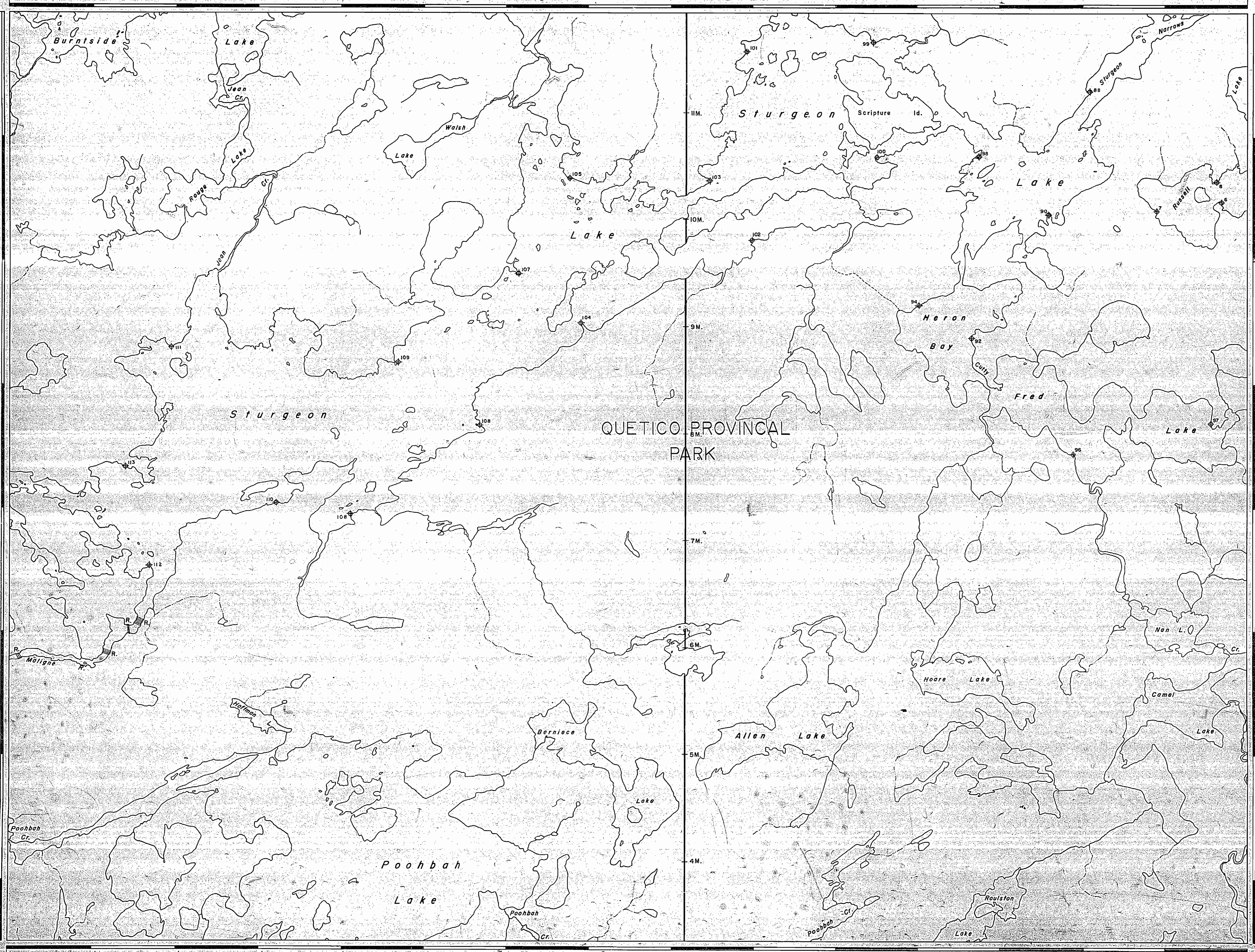

Snow Lake G-559

Alice Lake G-508

2350

2611

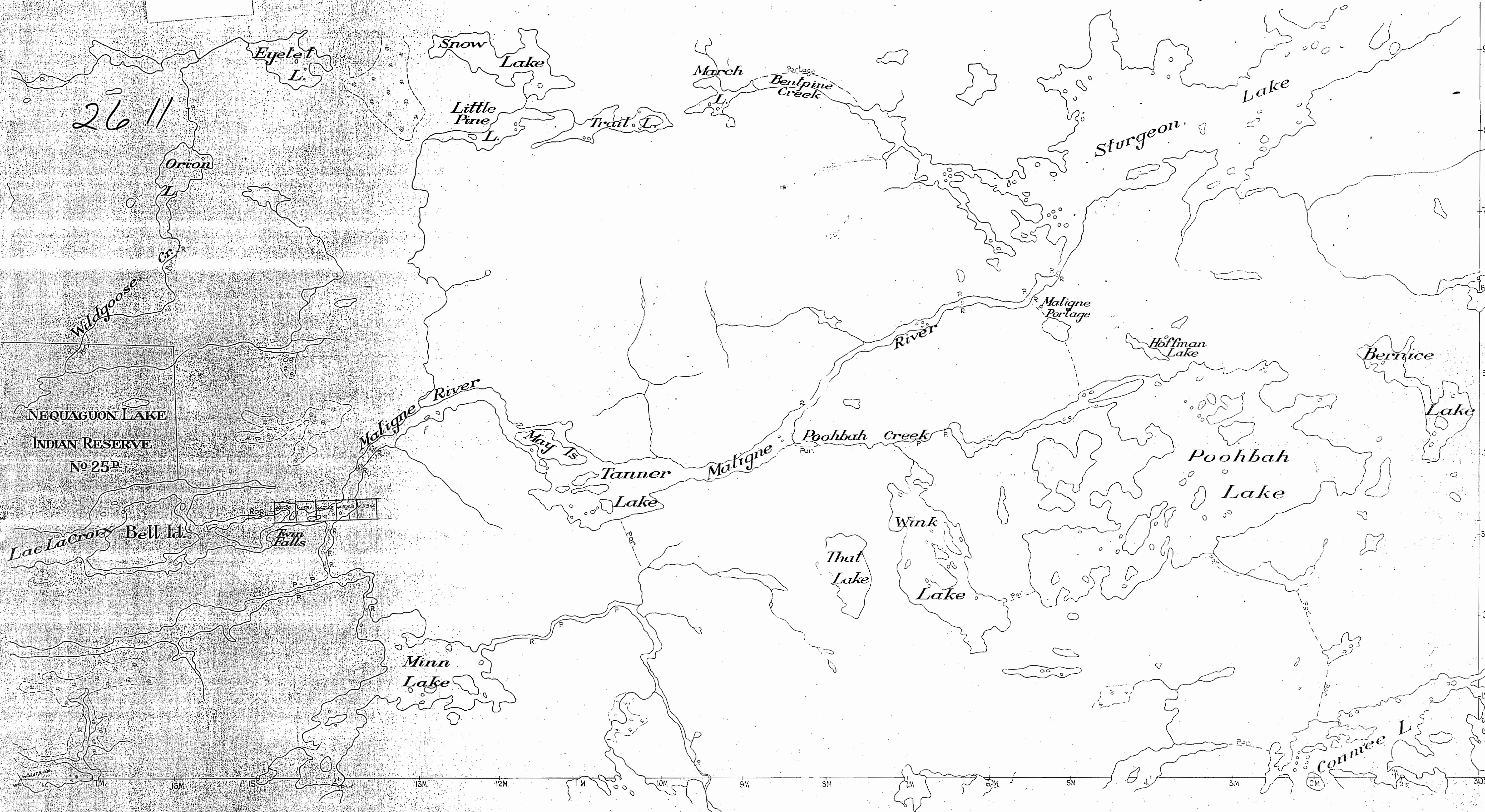

Scale - 40 Chains = 1 Inch

FF.60.A.

BOUCHER

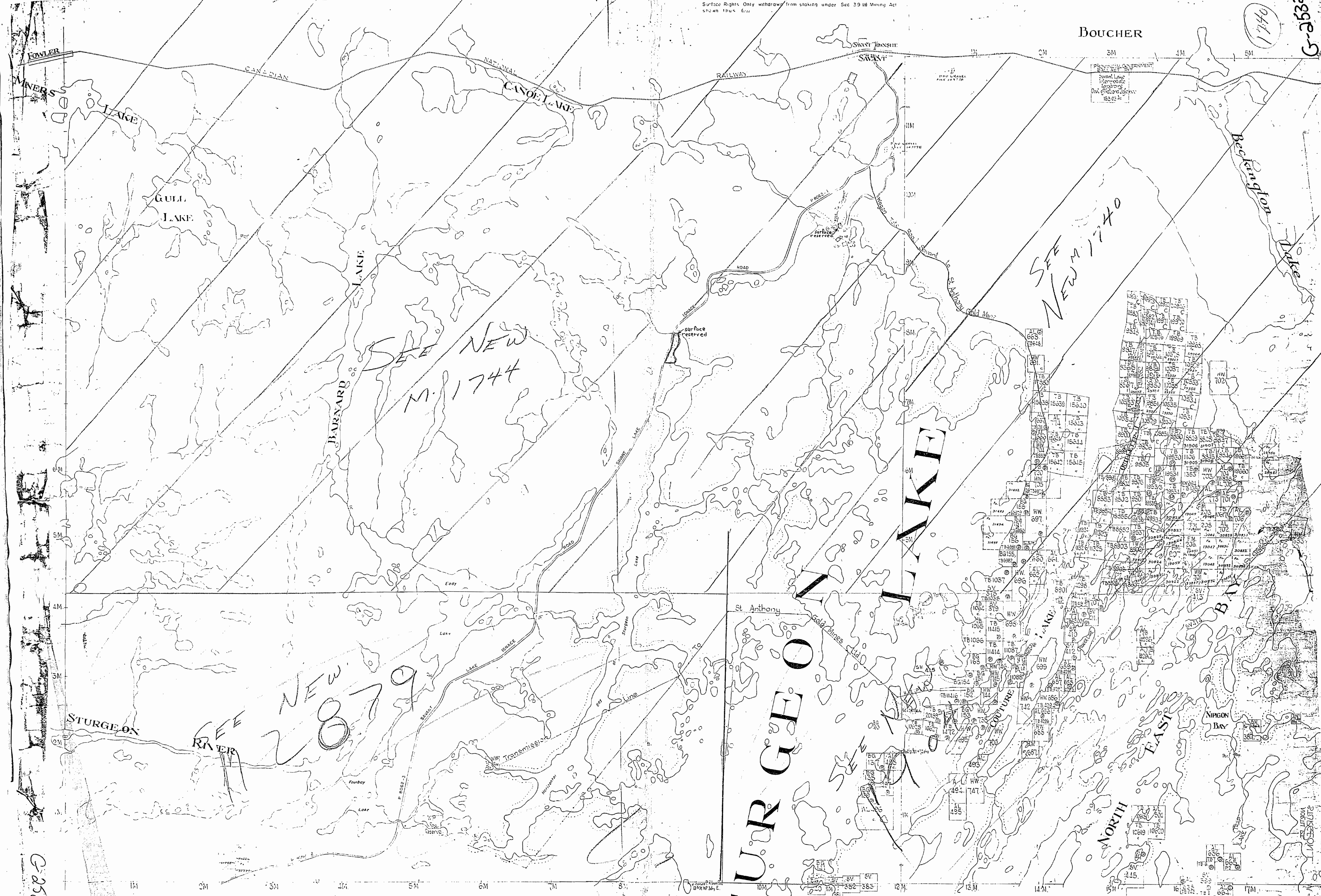

SEE NEW
M. 1744

SEE
NEW M. 1740

NEW
2879

STURGEON LAKE

N.P.T. STURGEON LAKE

Contours shown at 400' and by 200' of 1:2 are shown
contour lines. This information is applicable
along the contour lines of a mountain lying within the area
represented above, but not to any forested area.

0461

0461

G-2532

Surface Rights Only withdrawn from staking under Sec 39 of Mining Act shown thus

BOUCHER

6-2532

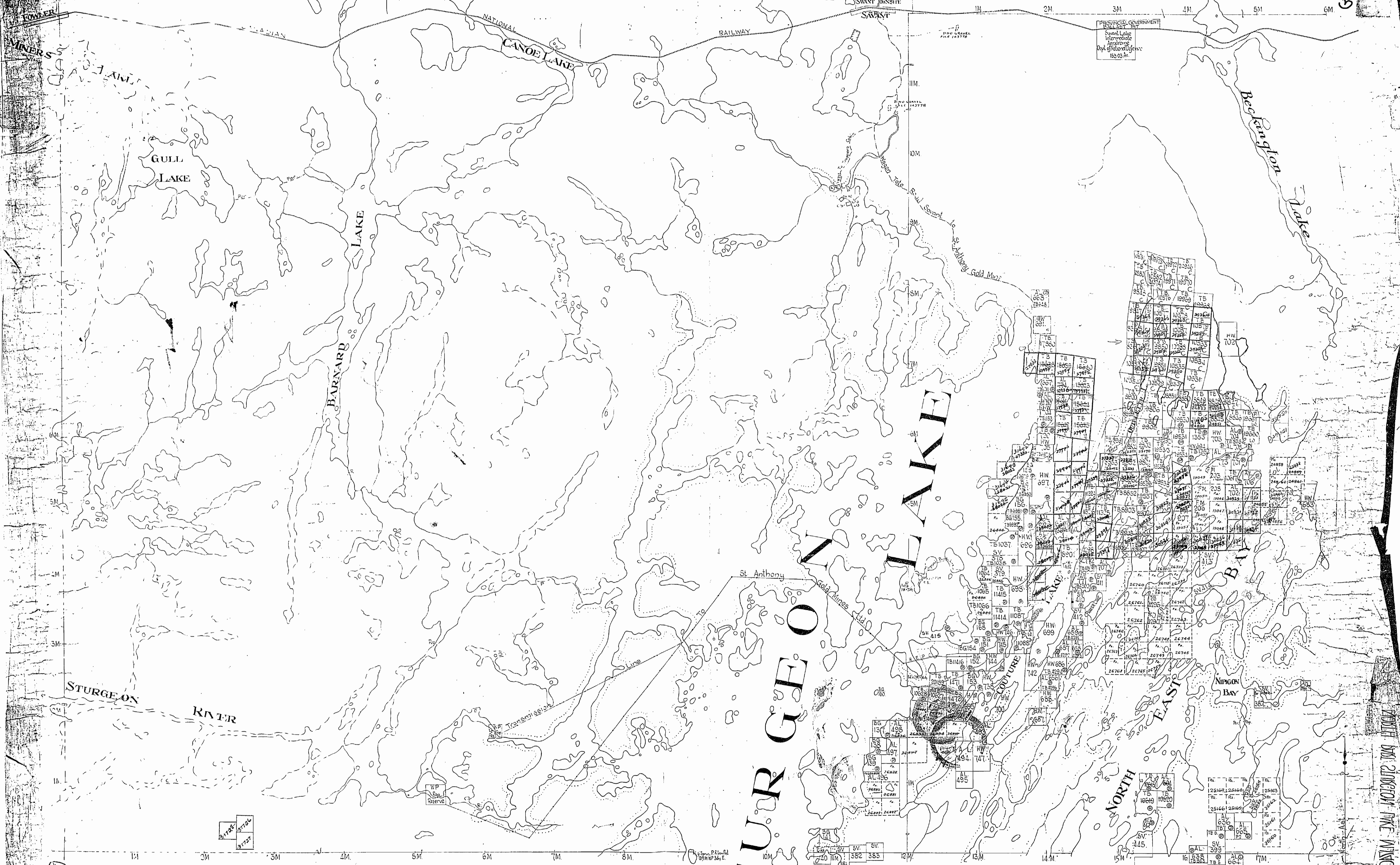

21724
21725
21727

As any reservations 400' wide by Dept of L.R. are shown on this map, this reservation to apply also along the shore line of all islands lying within the area delineated above, but not to any patented area.

STURGEON LAKE

M-1740
N.P. STURGEON LAKE M-1740
PATRICIA MINING DIVISION Scale 40 Chains = 1 Inch

6-2532

NORTH STURGEON LAKE AREA

NORTH STURGEON LAKE AREA

2350

2611

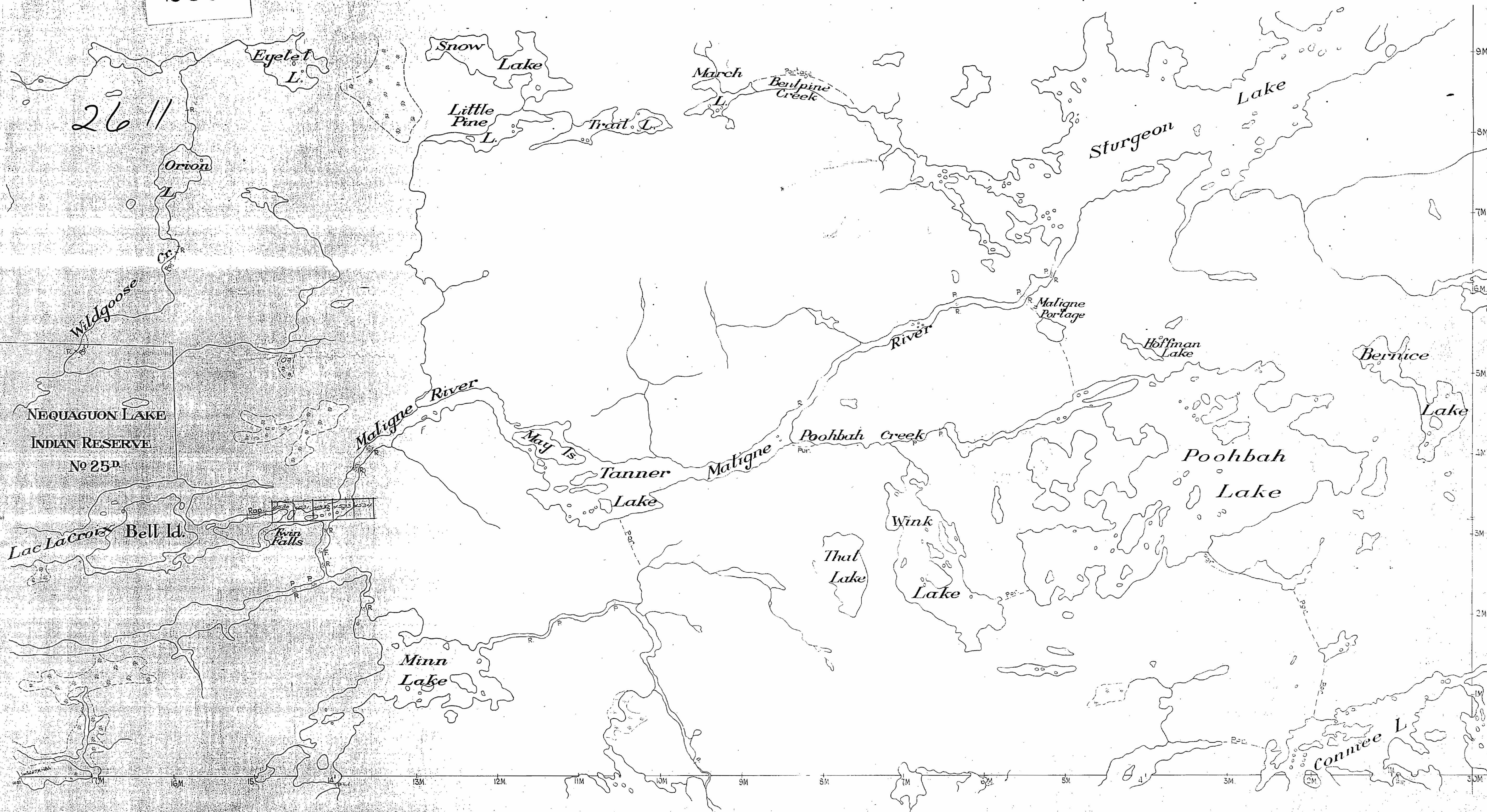

NEQUAGUON LAKE
 INDIAN RESERVE
 No 25D

Scale - 40 Chains = 1 Inch

FF.60.A

2350

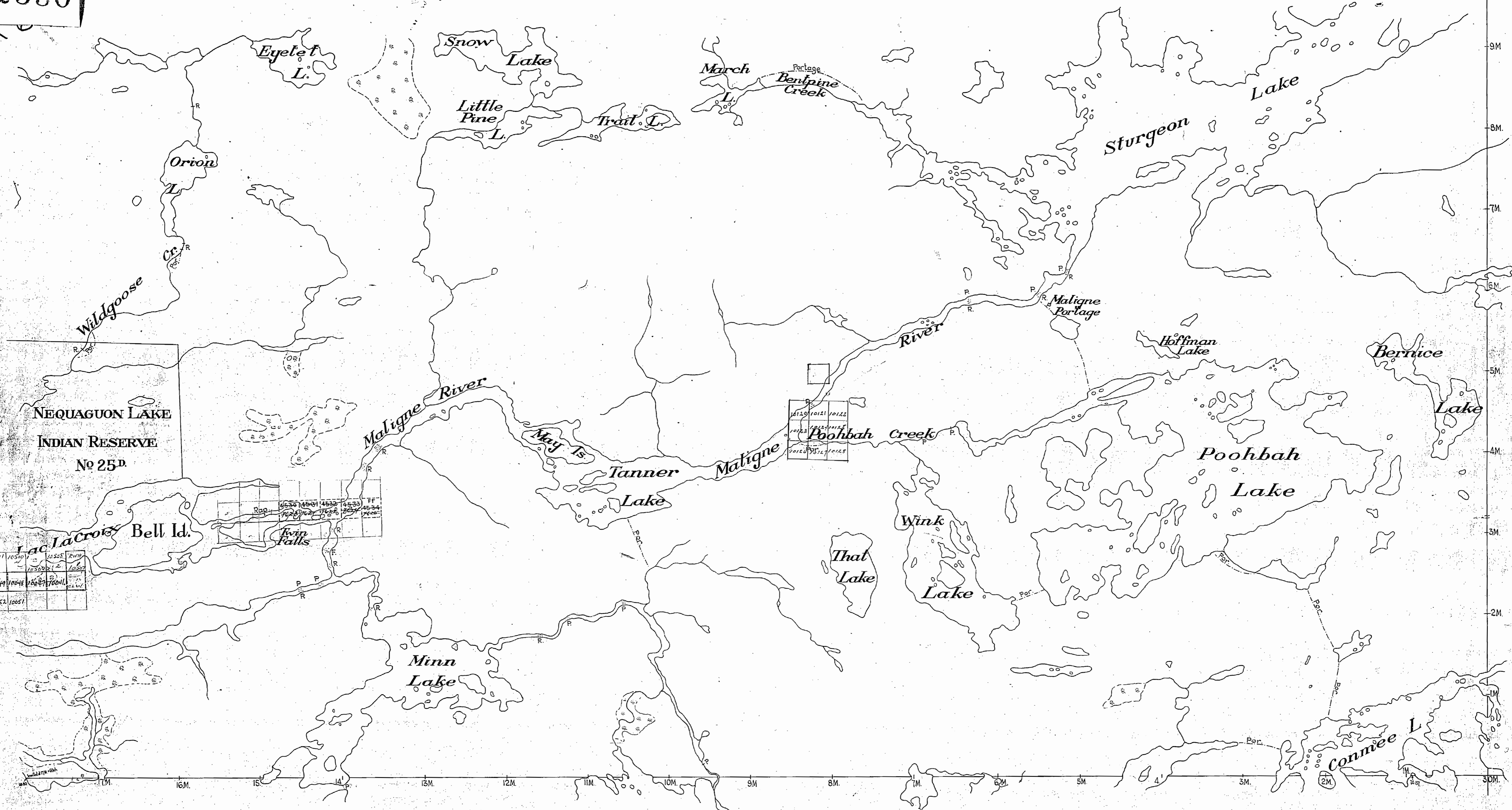

NEQUAGUON LAKE
INDIAN RESERVE
No 25 D.

10519	10520	10521	10522	10523	10524	10525	10526	10527	10528	10529	10530
10531	10532	10533	10534	10535	10536	10537	10538	10539	10540	10541	10542
10543	10544	10545	10546	10547	10548	10549	10550	10551	10552	10553	10554
10555	10556	10557	10558	10559	10560	10561	10562	10563	10564	10565	10566

10530	10531	10532	10533	10534	10535	10536	10537	10538	10539	10540	10541	10542	10543	10544	10545	10546	10547	10548	10549	10550	10551	10552	10553	10554	10555	10556	10557	10558	10559	10560	10561	10562	10563	10564	10565	10566	10567	10568	10569	10570	10571	10572	10573	10574	10575	10576	10577	10578	10579	10580	10581	10582	10583	10584	10585	10586	10587	10588	10589	10590	10591	10592	10593	10594	10595	10596	10597	10598	10599	10600
-------	-------	-------	-------	-------	-------	-------	-------	-------	-------	-------	-------	-------	-------	-------	-------	-------	-------	-------	-------	-------	-------	-------	-------	-------	-------	-------	-------	-------	-------	-------	-------	-------	-------	-------	-------	-------	-------	-------	-------	-------	-------	-------	-------	-------	-------	-------	-------	-------	-------	-------	-------	-------	-------	-------	-------	-------	-------	-------	-------	-------	-------	-------	-------	-------	-------	-------	-------	-------	-------	-------

Scale - 40 Chains = 1 Inch.

2350

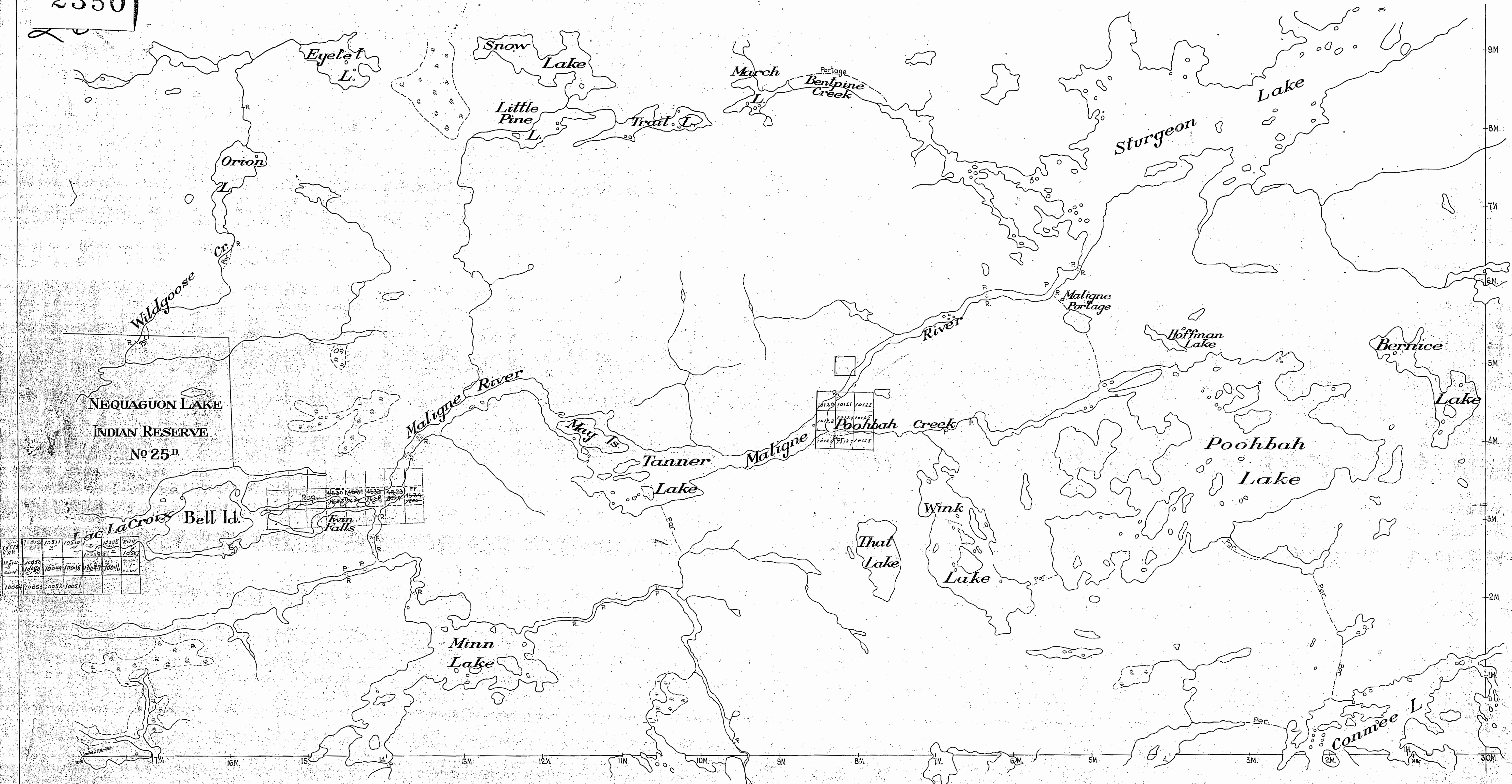

10512	10513	10514	10515	10516	10517	10518	10519	10520	10521	10522	10523	10524	10525	10526	10527	10528	10529	10530
10531	10532	10533	10534	10535	10536	10537	10538	10539	10540	10541	10542	10543	10544	10545	10546	10547	10548	10549
10550	10551	10552	10553	10554	10555	10556	10557	10558	10559	10560	10561	10562	10563	10564	10565	10566	10567	10568

Scale: 40 Chains = 1 Inch.