

PLAN OF
SWEENEY TWP.

SUDBURY MINING DIVISION.

DISTRICT OF SUDBURY

M.1151

— Scale, 40 chains to an inch. —

FRECHETTE TWP. OFFICE USE ONLY

MINISTRY OF NATURAL RESOURCES
SURVEYS AND MAPPING BRANCH

1973

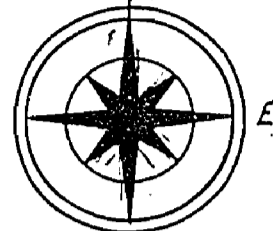

DUNBAR TWP.

BEAUMONT TWP.

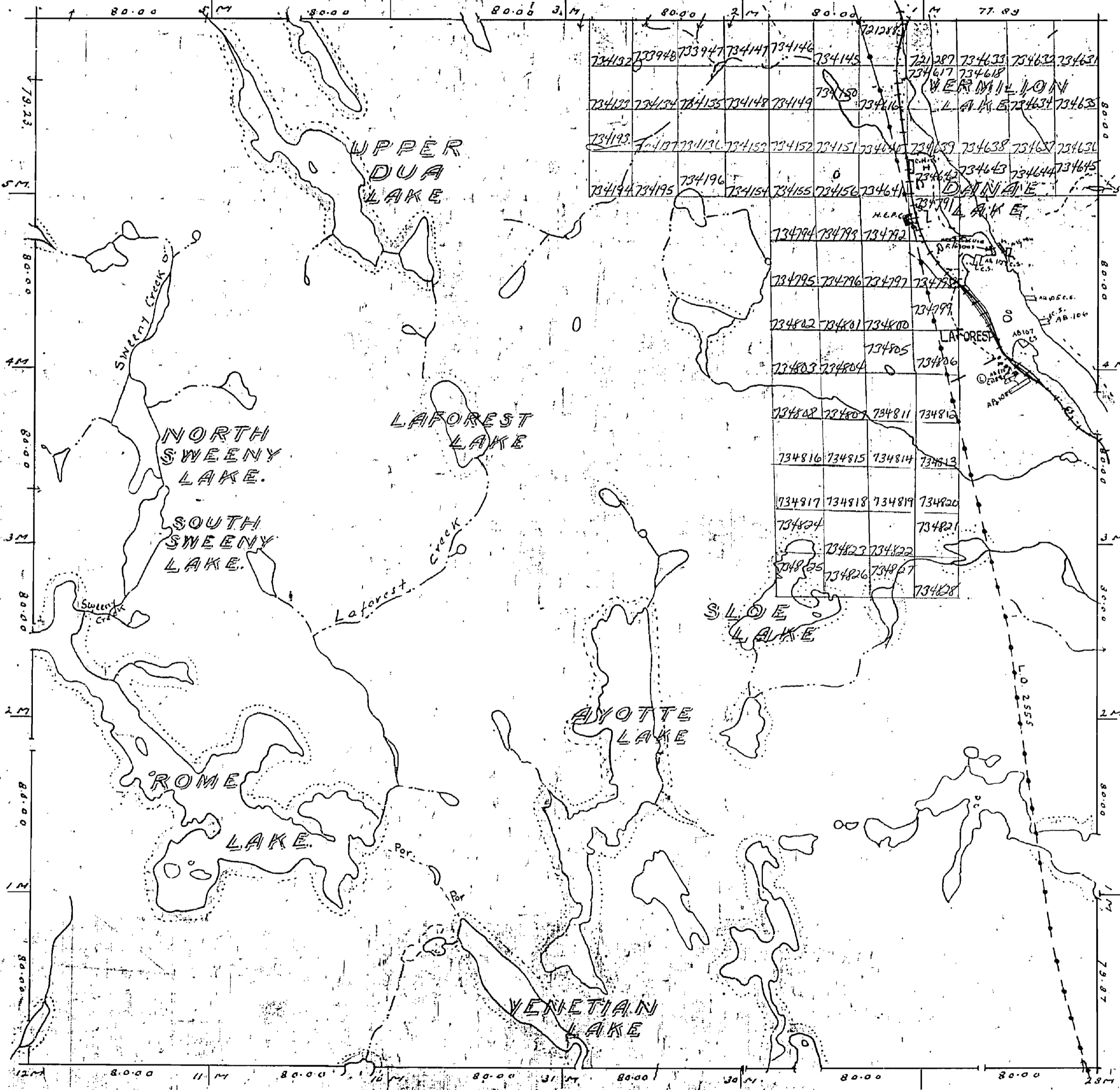

BOTHA TWP.

NOTES

Railways shown thus
Paved Highways
Gravel
Highway Route No.
Other Roads
Trails
Telephone Right of Way
Electric Power Lines
400' Survey Right of Way
Boundary of Lake & River

Non-perennial streams
Bridges
Buildings
Swamps
Areas marked
Patented
Leased
Held under
Occupancy

* Issued 1973 - VCM

SWEENEY

PLAN OF SWEENY TWP

SUDBURY MINING DIVISION

DISTRICT OF SUDBURY

M.1151

—Scale, 40 chains to an inch.—

FRECHETTE TWP.

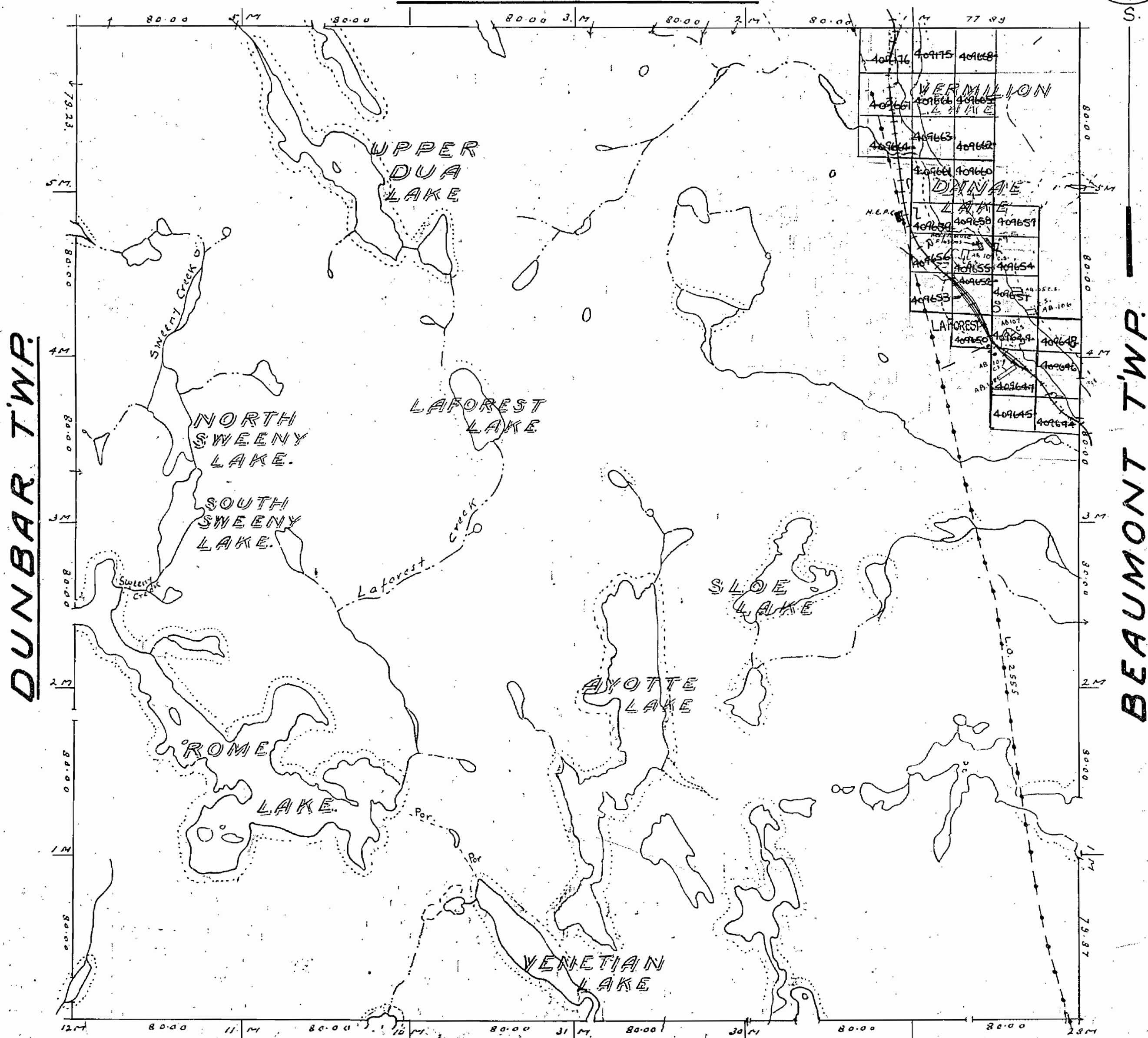

NOTES

Railways Shewn thus
Paved Highways
Gravel
Highway Route Nos.
Other Roads
Trails & Paths
Telephone & Telegraph Lines
Electric Power Lines

500' Surface Rights Reservation
around all lakes & rivers

Non-perennial streams
Bridges
Buildings
Swamps
Areas marked

② are Patented
③ are held under
rights of occupation

M.1151

SWEENY

PLAN OF SWEENEY TWP.

SUDBURY MINING DIVISION.

DISTRICT OF SUDBURY.

M.1151

Scale, 40 chains to an inch.

FRECHETTE TWP. OFFICE USE ONLY

MINISTRY OF NATURAL RESOURCES
SURVEYS AND MAPPING BRANCH

1973

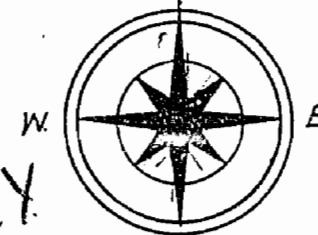

DUNBAR TWP.

BEAUMONT TWP.

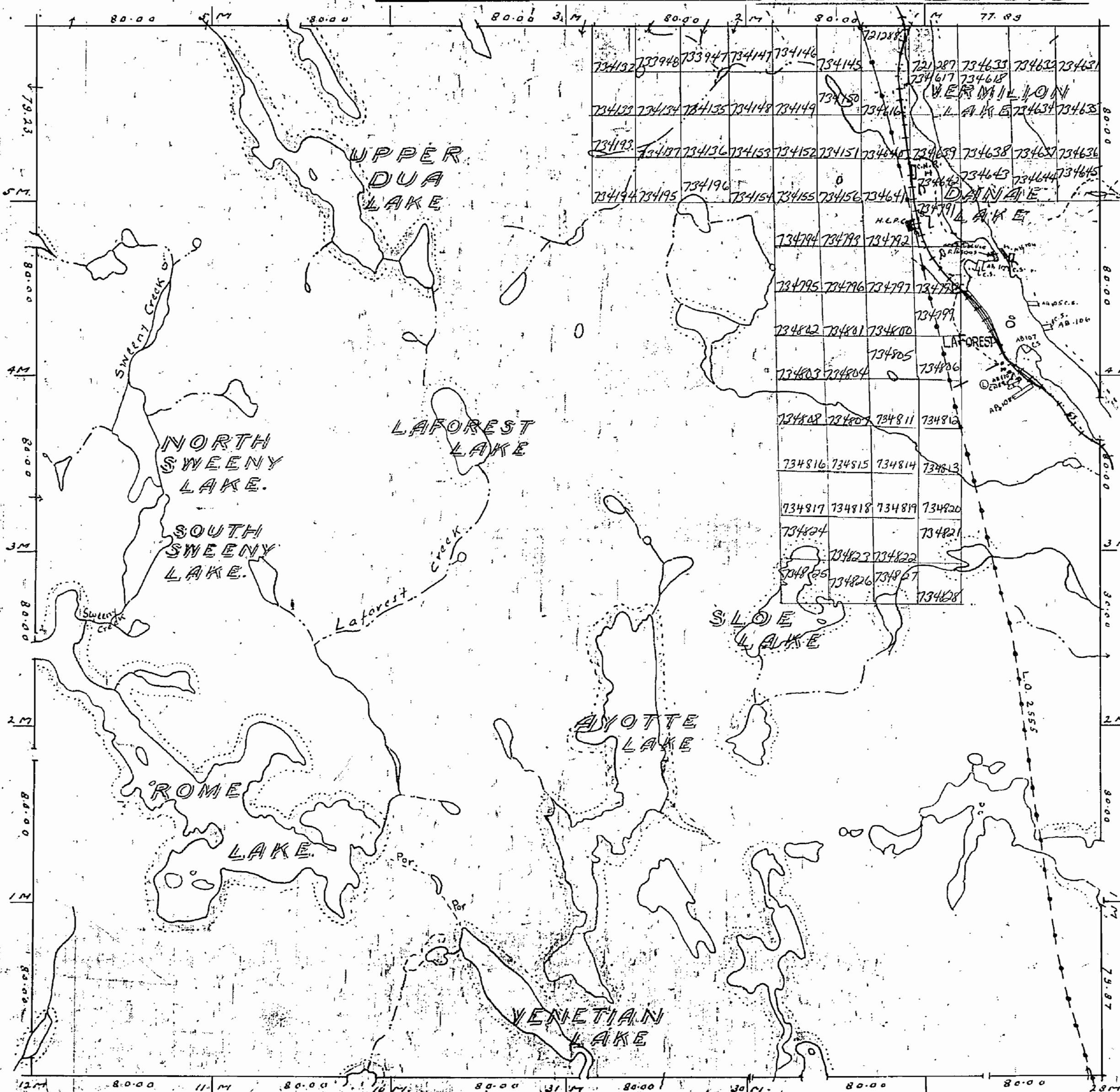

BOTHA TWP.

* Issued 1973-VCM

NOTES

Railways shown thus
Paved Highways
Gravel
Highway Route Mark
Other Roads
Trails
Municipal Boundaries
County Boundaries

Non-perennial streams
Bridges
Buildings
Subsiding
Areas marked

are patented
held under
claim of occupation

Swampy Rights Reserved
Abundant Forest & Rivers

SWEENEY

Aug. 22/87

ONTARIO

W-1121

MINISTRY OF NATURAL RESOURCES
SURVEYS AND MAPPING BRANCH

PLAN OF SWEENY TWP.

SUDBURY MINING DIVISION.

DISTRICT OF SUDBURY.

M.1151

—Scale, 40 chains to an inch.—

FRECHETTE TWP.

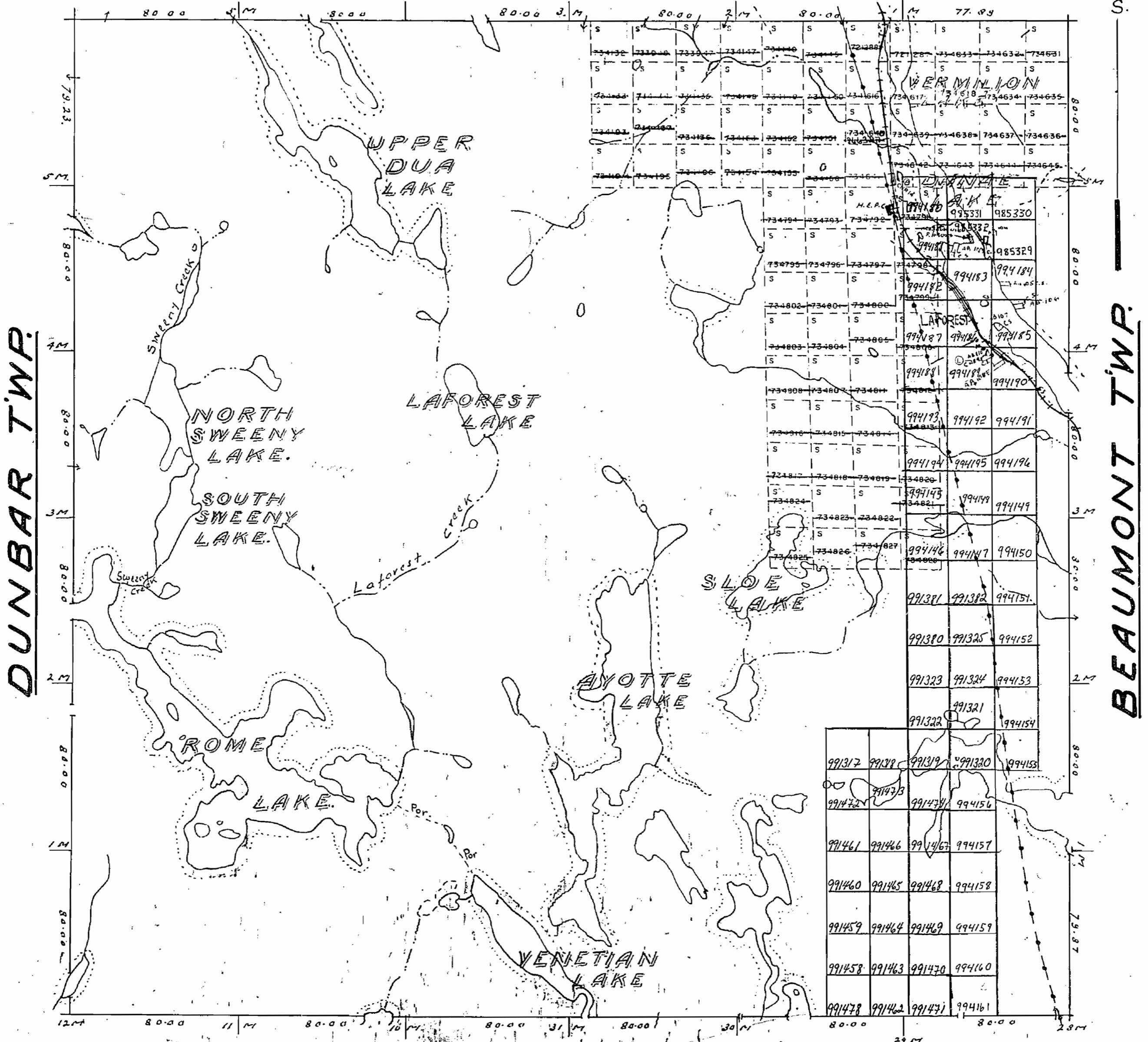
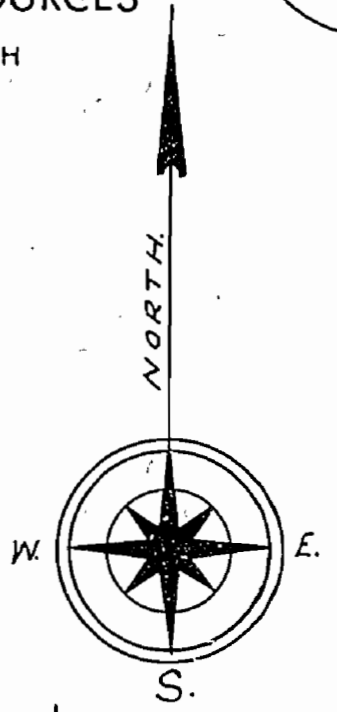

NOTES

Railways shown thus
Paved Highways
Gravel
Highway Route No.
Other Roads
Trails
Telephone & Telegraph Lines
Electric Power Lines
400' Surface Rights Reservation
around all lakes & rivers

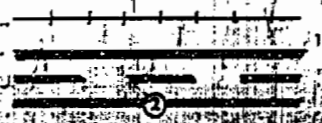

Non-perennial streams
Bridges
Buildings
Swamps
Areas marked
Patented
Leased
Held under
Right of Occupation

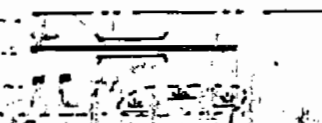

SWEENY



INDEX TO LAND DISPOSITION

PLAN
G-411C
TOWNSHIP
SWEENEY

H.N.R. ADMINISTRATIVE DISTRICT
SUDBURY
MINING DIVISION
SUDBURY
LAND TITLES/REGISTRY DIVISION
SUDBURY

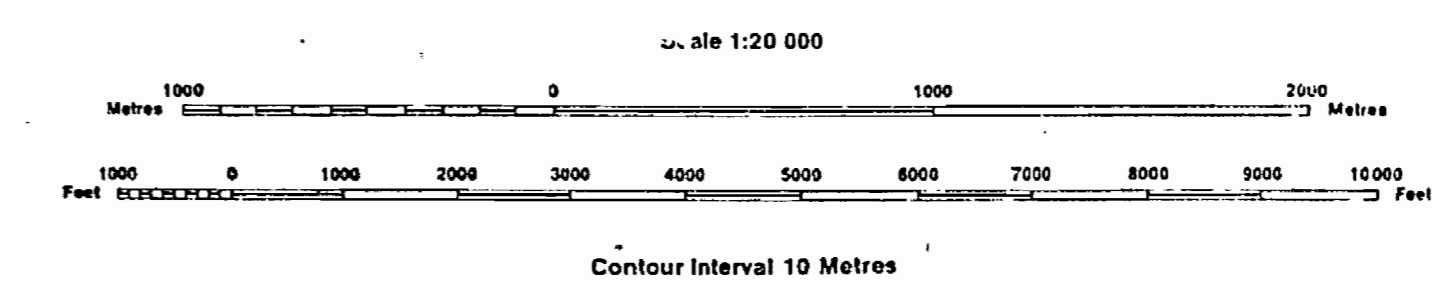

- SYMBOLS**
- Boundary
 - Township, Meridian, Baseline
 - Road allowance; surveyed
 - shoreline
 - Lot/Concession; surveyed
 - unsurveyed
 - Parcel; surveyed
 - unsurveyed
 - Right-of-way; road
 - railway
 - utility
 - Reservation
 - Cliff, Pit, Pile
 - Contour
 - Interpolated
 - Approximate
 - Depression
 - Control point (horizontal)
 - Flooded land
 - Mine head frame
 - Pipeline (above ground)
 - Railway; single track
 - double track
 - abandoned
 - Road; highway, county, township
 - access
 - trail, bush
 - Shoreline (original)
 - Transmission line
 - Wooded area
 - REMOTE TOURIST SET-UP

AREAS WITHDRAWN FROM DISPOSITION

MRO - Mining Rights Only
SRO - Surface Rights Only
M + S - Mining and Surface Rights

Description	Order No.	Date	Disposition	File
M.N.R. RESERVE			S.R.O.	169005

DATE OF ISSUE
DEC 23 1993
SUDBURY
MINING RECORDER'S OFFICE

DISPOSITION OF CROWN LANDS

- Patent
- Surface & Mining Rights
 - Surface Rights Only
 - Mining Rights Only
- Lease
- Surface & Mining Rights
 - Surface Rights Only
 - Mining Rights Only
- Licence of Occupation
- Order-in-Council
 - Canceled
 - Reservation
 - Sand & Gravel

THE INFORMATION THAT APPEARS ON THIS MAP HAS BEEN COMPILED FROM VARIOUS SOURCES, AND ACCURACY IS NOT GUARANTEED. THOSE WISHING TO STAKE MINING CLAIMS SHOULD CONSULT WITH THE MINING RECORDER, MINISTRY OF NORTHERN DEVELOPMENT AND MINES, FOR ADDITIONAL INFORMATION ON THE STATUS OF THE LANDS SHOWN HEREON.

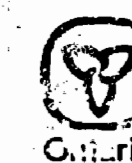
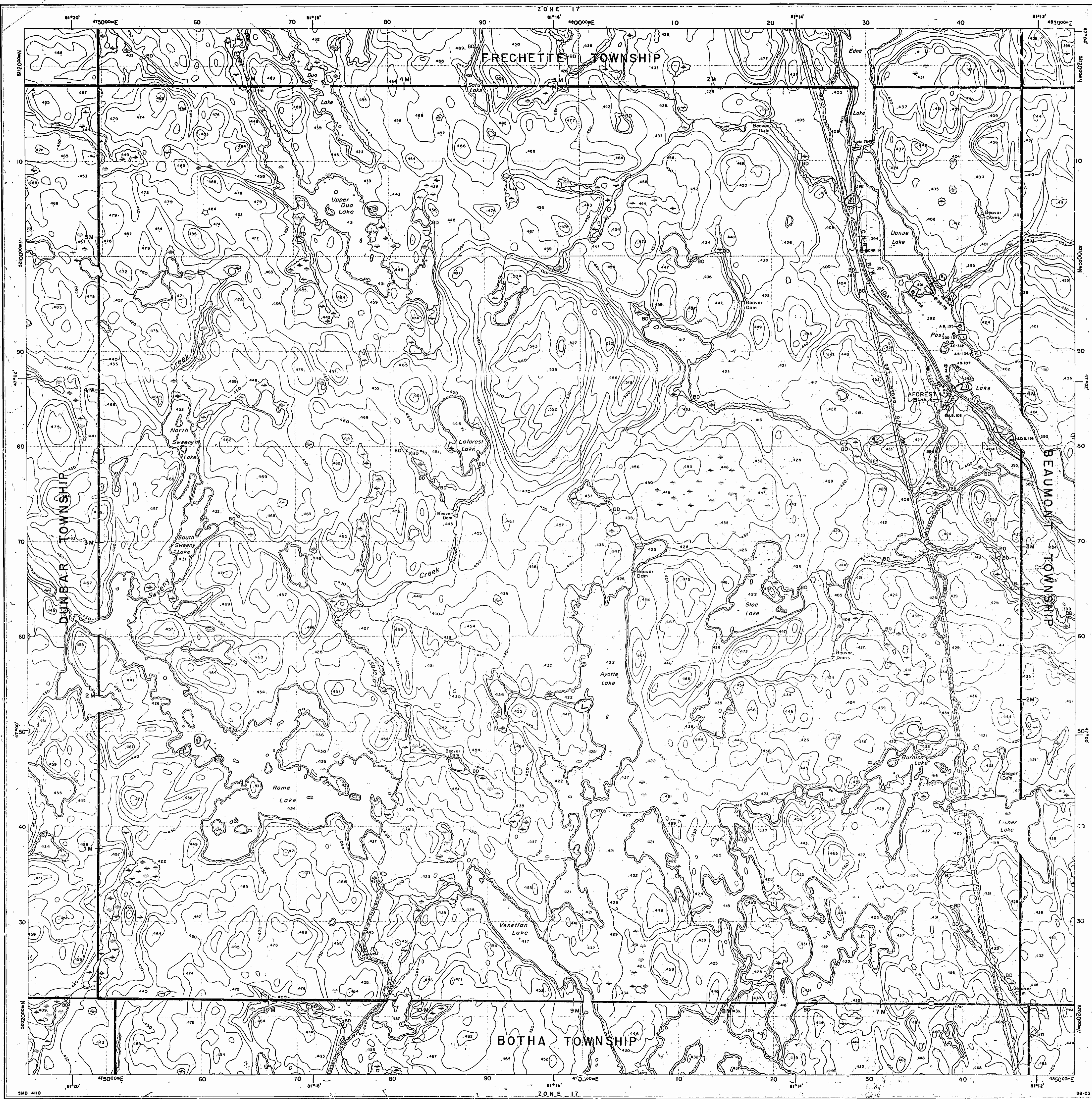

Ministry of
Natural
Resources
Ministry of
Northern Development
and Mines
IN SERVICE APRIL 27, 1989

Block # 3

INDEX TO LAND DISPOSITION

PLAN
G-411C
TOWNSHIP
SWEENEY

M.N.R. ADMINISTRATIVE DISTRICT
SUDBURY
MINING DIVISION
SUDBURY
LAND TITLES/REGISTRY DIVISION
SUDBURY

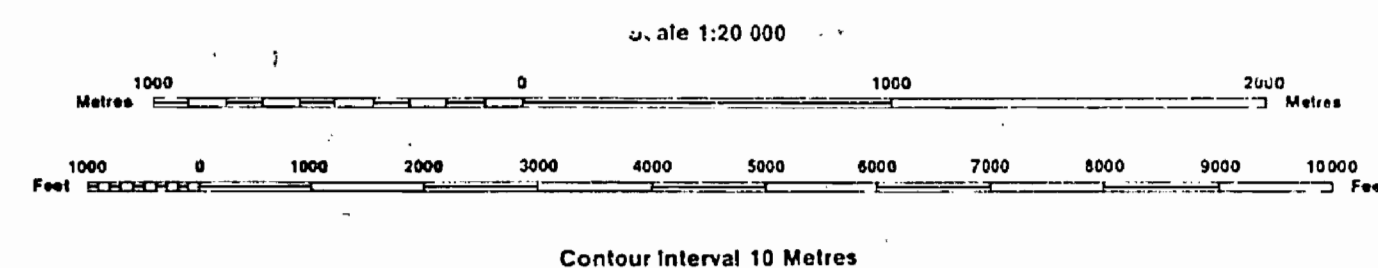

AREAS WITHDRAWN FROM DISPOSITION

MRO - Mining Rights Only
SRO - Surface Rights Only
M + S - Mining and Surface Rights

Description	Order No.	Date	Diagram	File
M.N.R. RESERVE			S.R.O.	169 025

SYMBOLS

Boundary	
Township, Meridian, Baseline
Road allowance; surveyed
shoreline
Lot/Concession; surveyed
unsurveyed
Parcel; surveyed
unsurveyed
Right-of-way; road
railway
utility
Reservation
Cliff, Pit, Pile
Contour
Interpolated
Approximate
Depression
Control point (horizontal)
Flooded land
Mine head frame
Pipeline (above ground)
Railway; single track
double track
abandoned
Road; highway, county, township
access
trail, bush
Shoreline (original)
Transmission line
Wooded area

REMOTE TOURIST SET-UP

DISPOSITION OF CROWN LANDS

Patent	
Surface & Mining Rights
Surface Rights Only
Mining Rights Only
Lease	
Surface & Mining Rights
Surface Rights Only
Mining Rights Only
Licence of Occupation
Order-in-Council
Cancelled
Reservation
Sand & Gravel

THE INFORMATION THAT
APPEARS ON THIS MAP
HAS BEEN COMPILED
FROM VARIOUS SOURCES
AND ACCURACY IS NOT
GUARANTEED. THOSE
WISHING TO STAKE MIN-
ING CLAIMS SHOULD CON-
SULT WITH THE MINING
RECORDS, MINISTRY OF
NORTHERN DEVELOP-
MENT AND MINES, FOR AD-
DITIONAL INFORMATION
ON THE STATUS OF THE
LANDS SHOWN HEREON.

Map base and land disposition drafting by Surveys and Mapping
Branch, Ministry of Natural Resources.

The disposition of land, for other than the purposes of this index, was compiled for administrative purposes only.

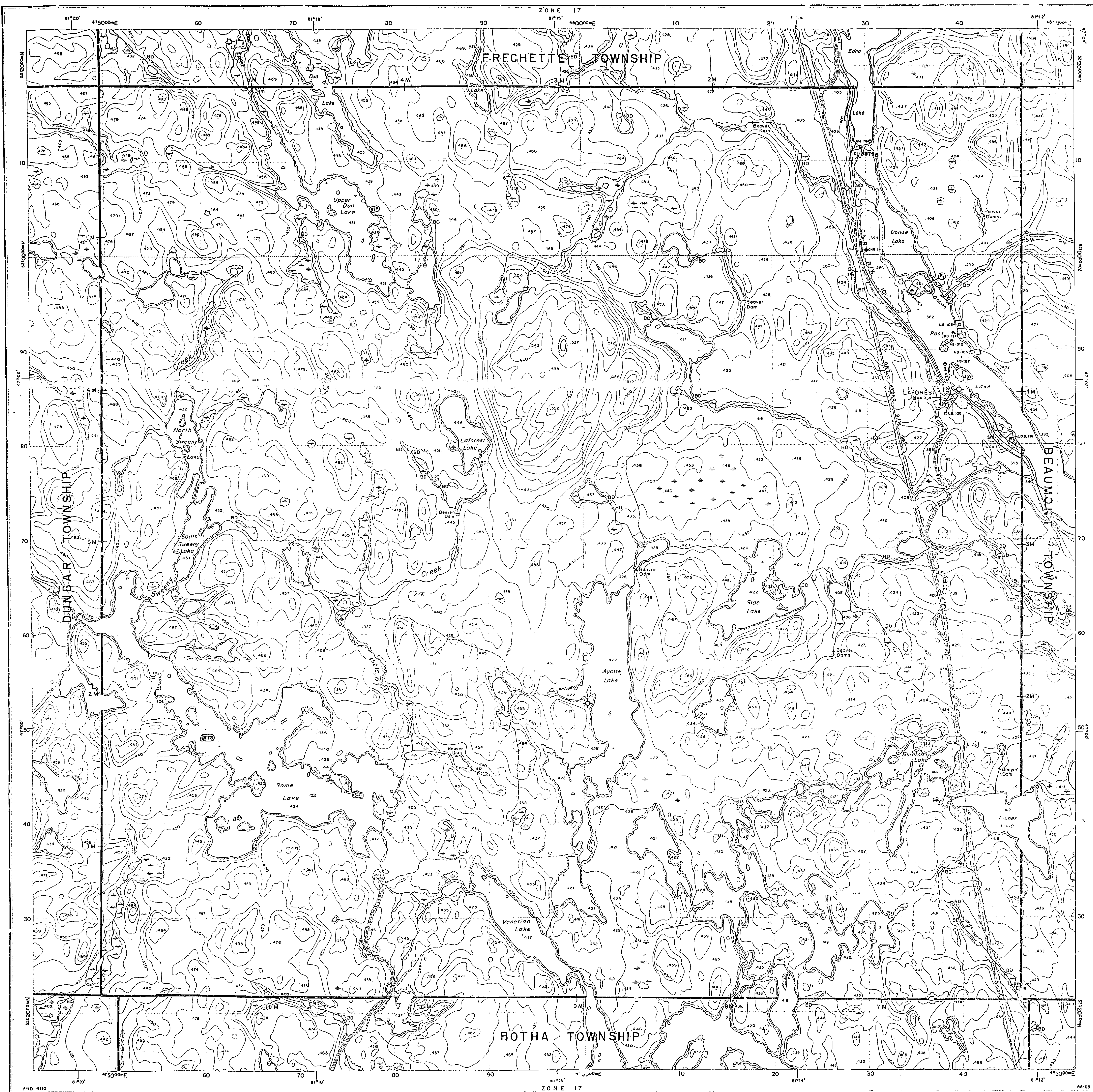

Ministry of Natural Resources	Ministry of Northern Development and Mines
-------------------------------------	--

IN SERVICE APRIL 27, 1989

INDEX TO LAND DISPOSITION

PLAN

G-411C

TOWNSHIP

SWEENEY

1. N.B. ADMINISTRATIVE DISTRICT

SUDBURY

MINING DIVISION

SUDBURY

LAND TITLES/REGISTRY DIVISION

SUDBURY

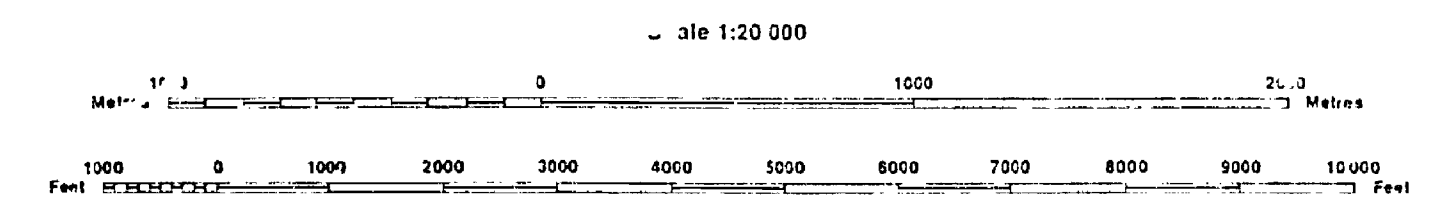

Contour Interval 10 Metres

AREAS WITHDRAWN FROM DISPOSITION

MRO - Mining Rights Only

SRO - Surface Roughness

M + S - Mining and Surface Rights

Description	Order No.	Date	Disposition	File
(8) M.N.R. RESERVE			S.R.O.	159005

SYMBOLS

Boundary	
Township, Meridian, Baseline	
Road allowance; surveyed	
shoreline	
Lot/Concession; surveyed	
unsurveyed	
Parcel; surveyed	
unsurveyed	
Right-of-way; road	
railway	
utility	
Reservation	
Cliff, Pit, Pile	
Contour	
Interpolated	
Approximate	
Depression	
Control point (horizontal)	
Flooded land	
Mine head frame	
Pipeline (above ground)	
Railway; double track	
single track	
abandoned	
Road; highway, county, township	
access	
trail, bush	
Shoreline (original)	
Transmission line	
Wooded area	

DISPOSITION OF CROWN LANDS

Patent	
Surface & Mining Rights
Surface Rights Only
Mining Rights Only
Lease	
Surface & Mining Rights
Surface Rights Only
Mining Rights Only
Licence of Occupation
Order-in-Council
Canceled
Reservation
Sand & Gravel
LAND USE PERMIT	
REMOTE TOURIST SET-UP

THE INFORMATION THAT APPEARS ON THIS MAP HAS BEEN COMPILED FROM VARIOUS SOURCES, AND ACCURACY IS NOT GUARANTEED. THOSE WISHING TO STAKE MINING CLAIMS SHOULD CONSULT WITH THE MINING RECORDER, MINISTRY OF NORTHERN DEVELOPMENT AND MINES, FOR ADDITIONAL INFORMATION ON THE STATUS OF THE LANDS SHOWN HEREON.

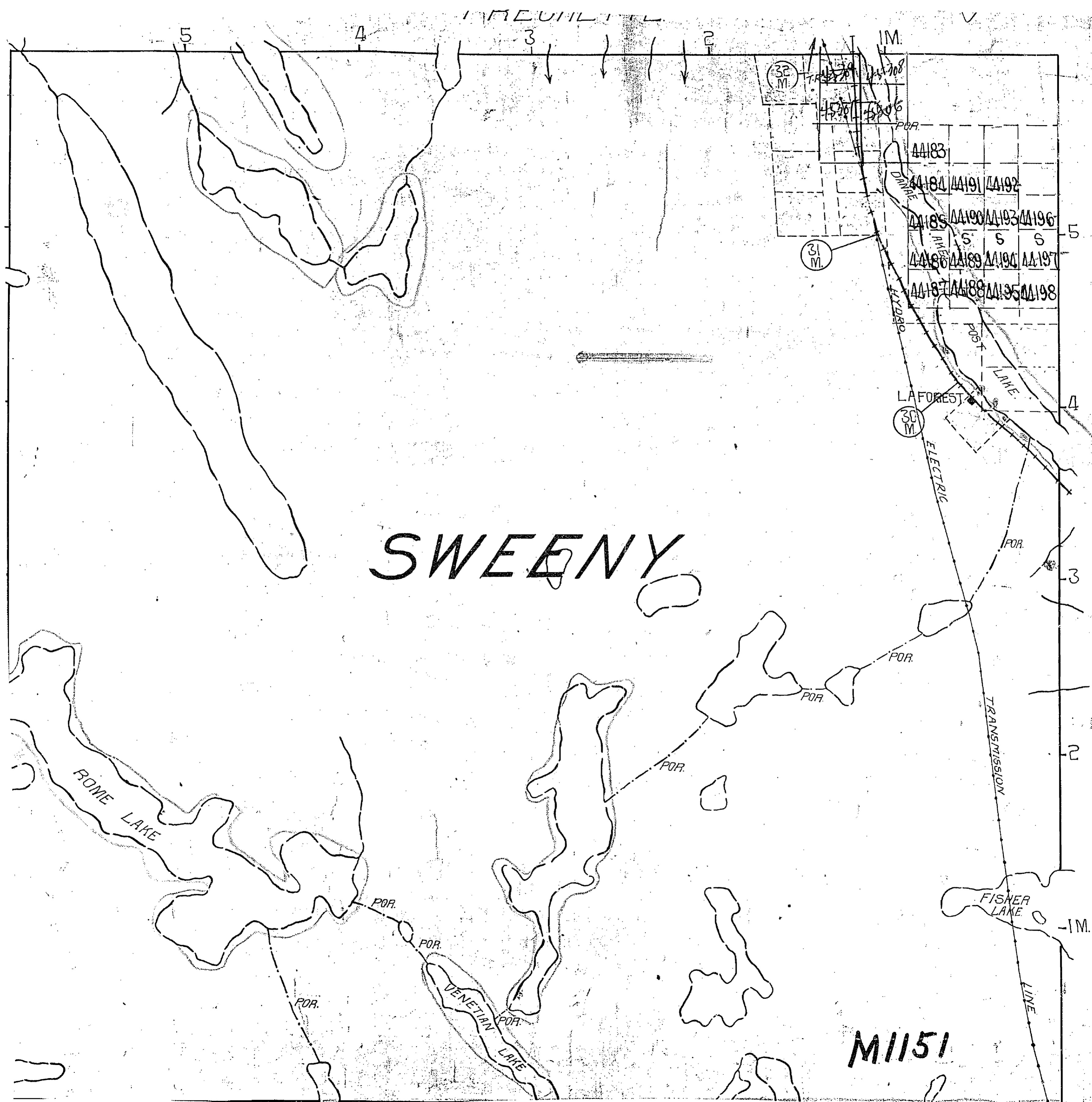

PLAN OF SWEENY TWP. SUDBURY MINING DIVISION. DISTRICT OF SUDBURY.

—Scale, 40 chains to an inch.—

FRECHETTE TWP.

DUNBAR TWP.

BEAUMONT TWP.

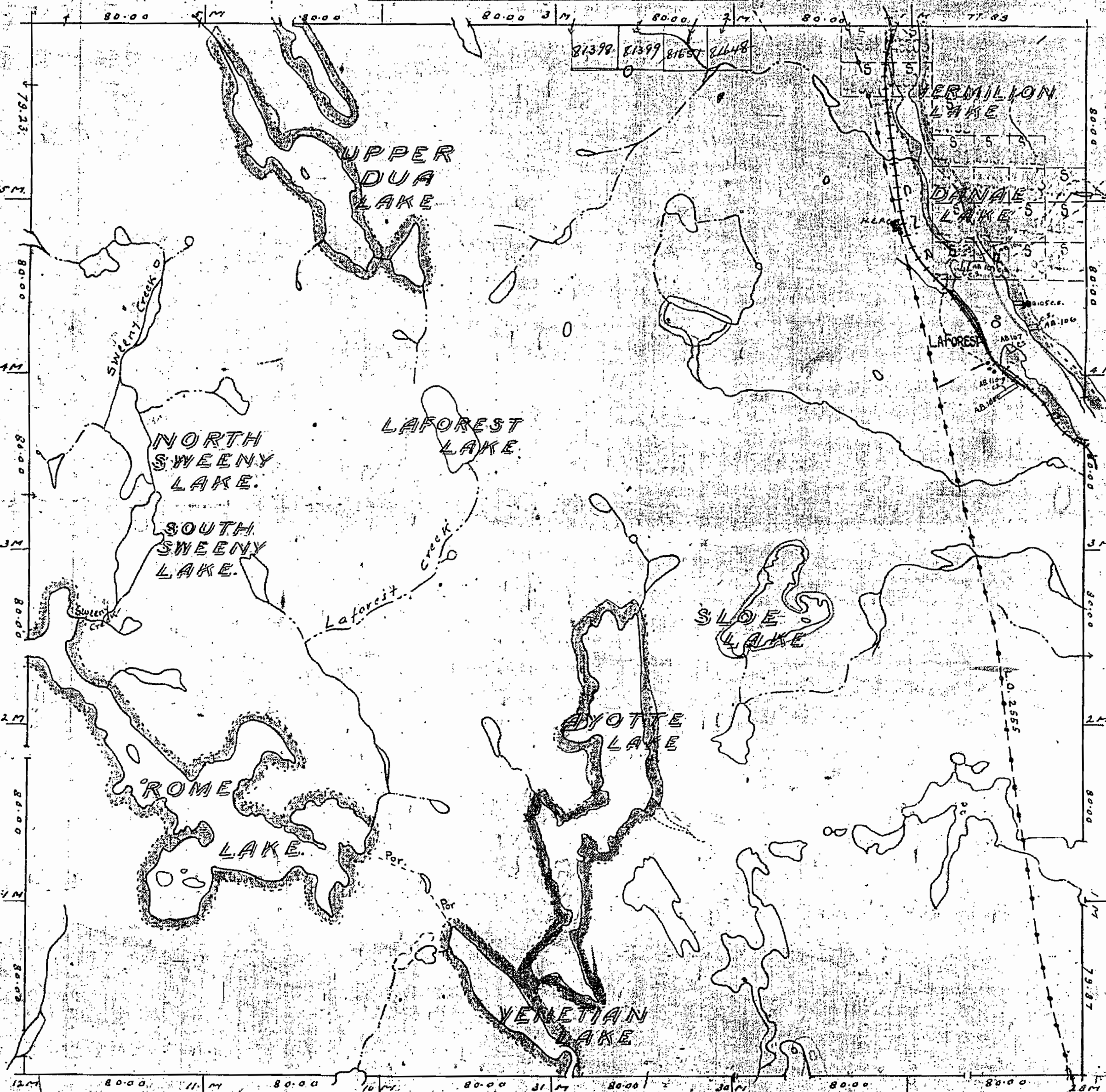

NOTES

Railways shown thus
Paved Highways
Gravel
Highway Route Nos.
Other Roads
Trails & Paths
Telephone & Telegraph Lines
Electric Power Lines
Surface reservations 200 wide by Dept. of L. & F. shown hereon thus

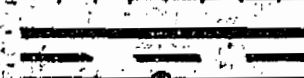

Non-perennial streams
Bridges
Buildings
Swamps
Areas marked

all patented
leased
held under
license of occupation

SWEENY
M. 1151

1151

1151

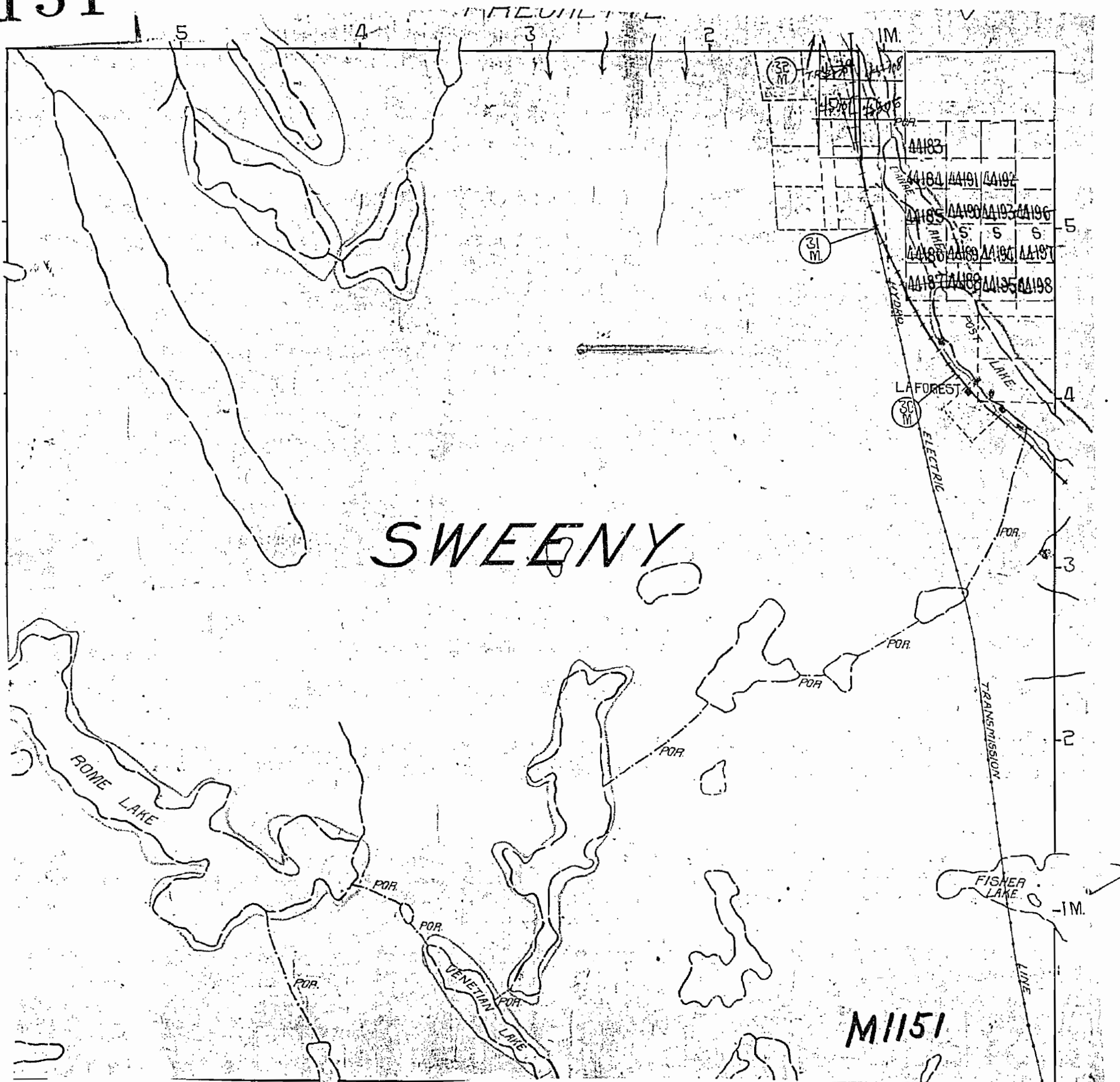

PLAN OF SWEENY TWP.

SUDBURY MINING DIVISION.

DISTRICT OF SUDBURY.

M.1151

—Scale 40 chains to an inch.—

FRECHETTE TWP.

SUDBURY MINING DIV.
RECEIVED
MAR 8 1971
A.M. P.M.
7 8 9 10 11 12 1 2 3 4 5 6

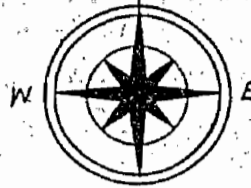

DUNBAR TWP.

BEAUMONT TWP.

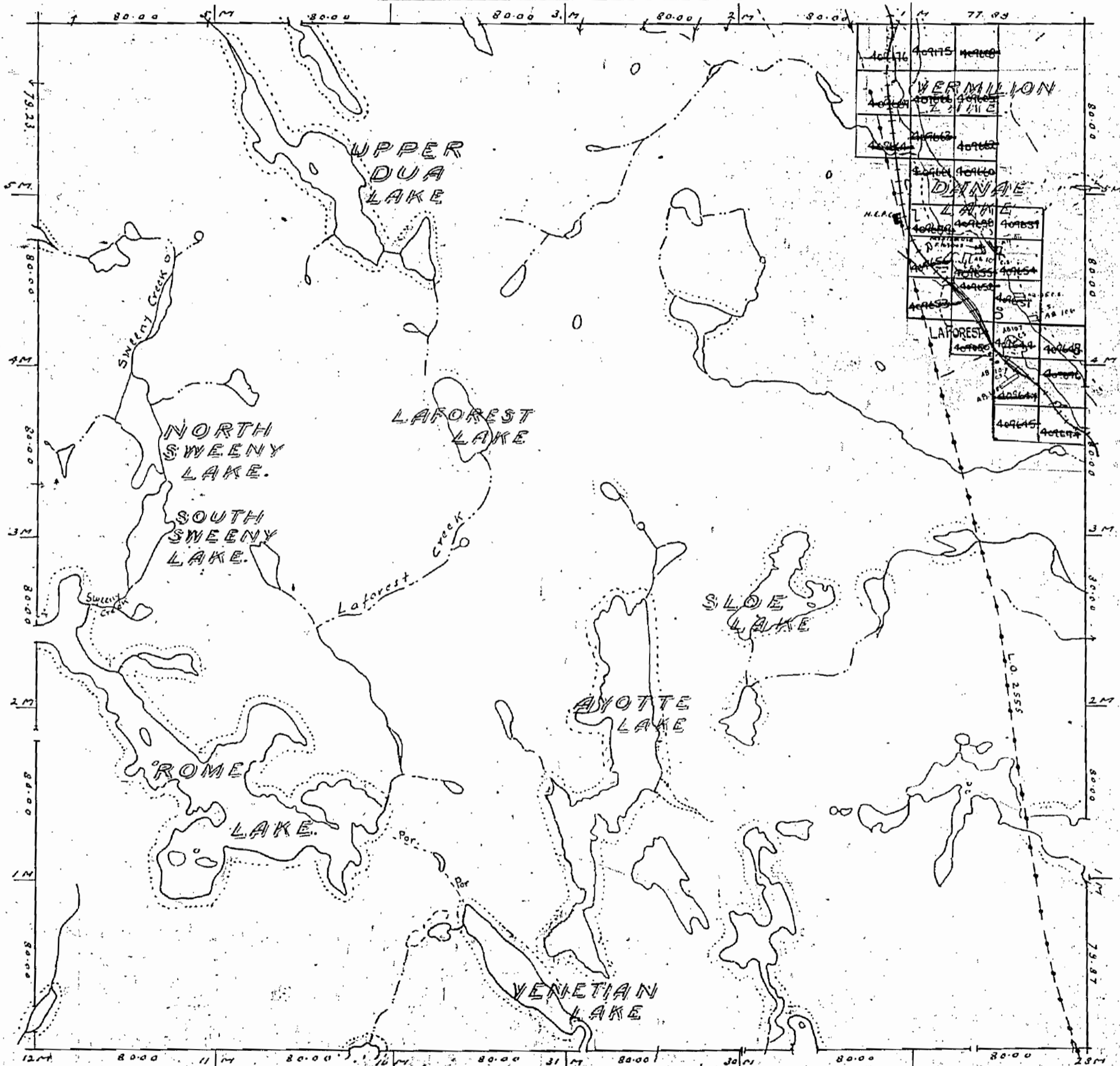

BOTHA TWP.

NOTES

- Railways shown thus
- Paved Highways
- Gravel
- Highway Route No.
- Other Roads
- Trails & Paths
- Telephone & Telegraph Lines
- Electric Power Lines
- 500' Surface Rights Reservation around all Lakes & Rivers



- Non-perennial streams
- Bridges
- Buildings
- Swamps
- Areas marked

- Patented
- Leased
- held under
- right of occupation

M.1151

SWEENY

1151

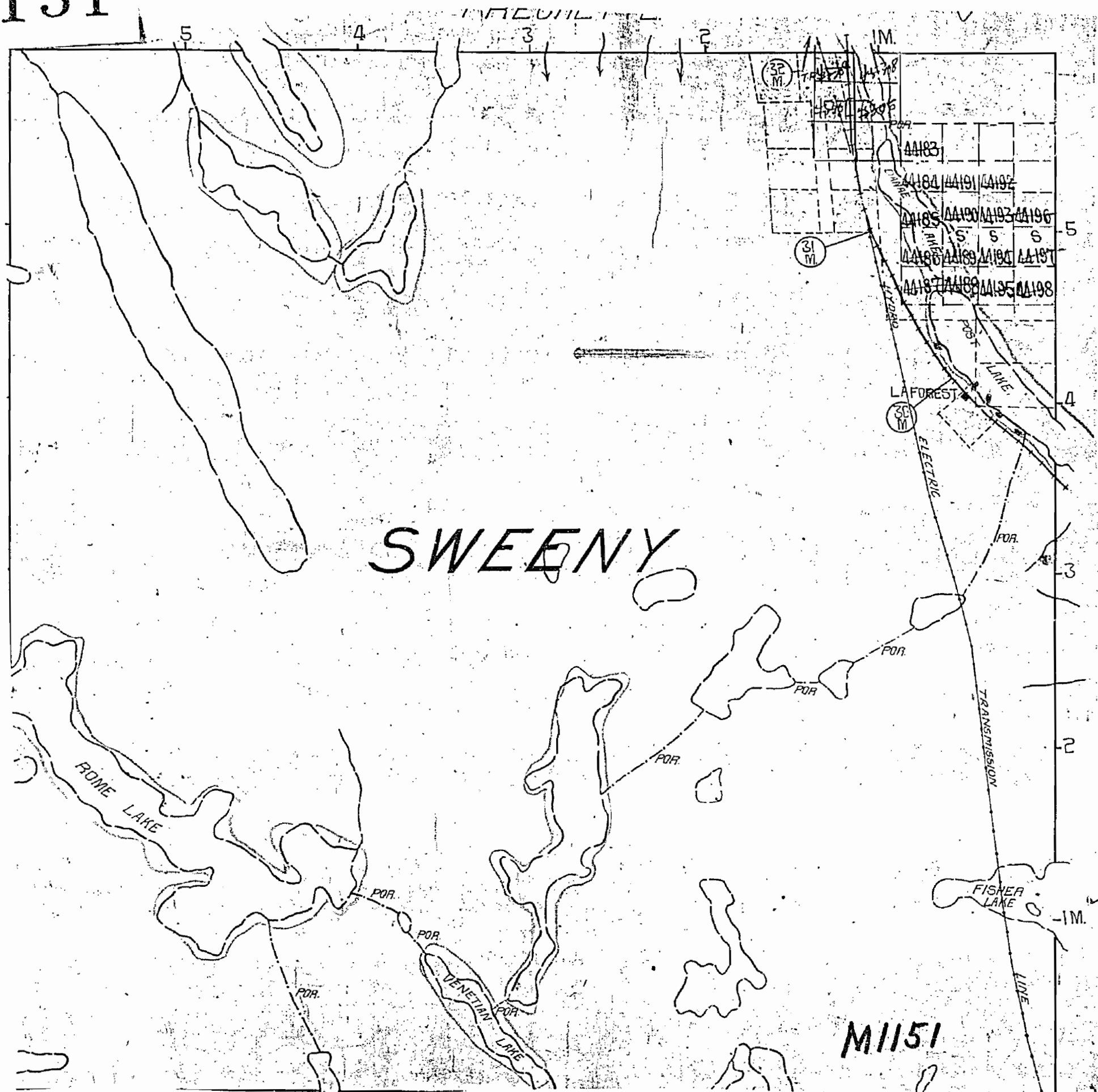

1151

PLAN OF SWEENY TWP

SUDBURY MINING DIVISION
DISTRICT OF SUDBURY

SUDBURY
MINING DIV.
RECEIVED
MAR 8 1971
A.M. 7,8,9,10,11,12,1,2,3,4,5,6 P.M.

M.1151

—Scale 40 chains to an inch.—

FRECHETTE TWP



DUNBAR TWP

BEAUMONT TWP

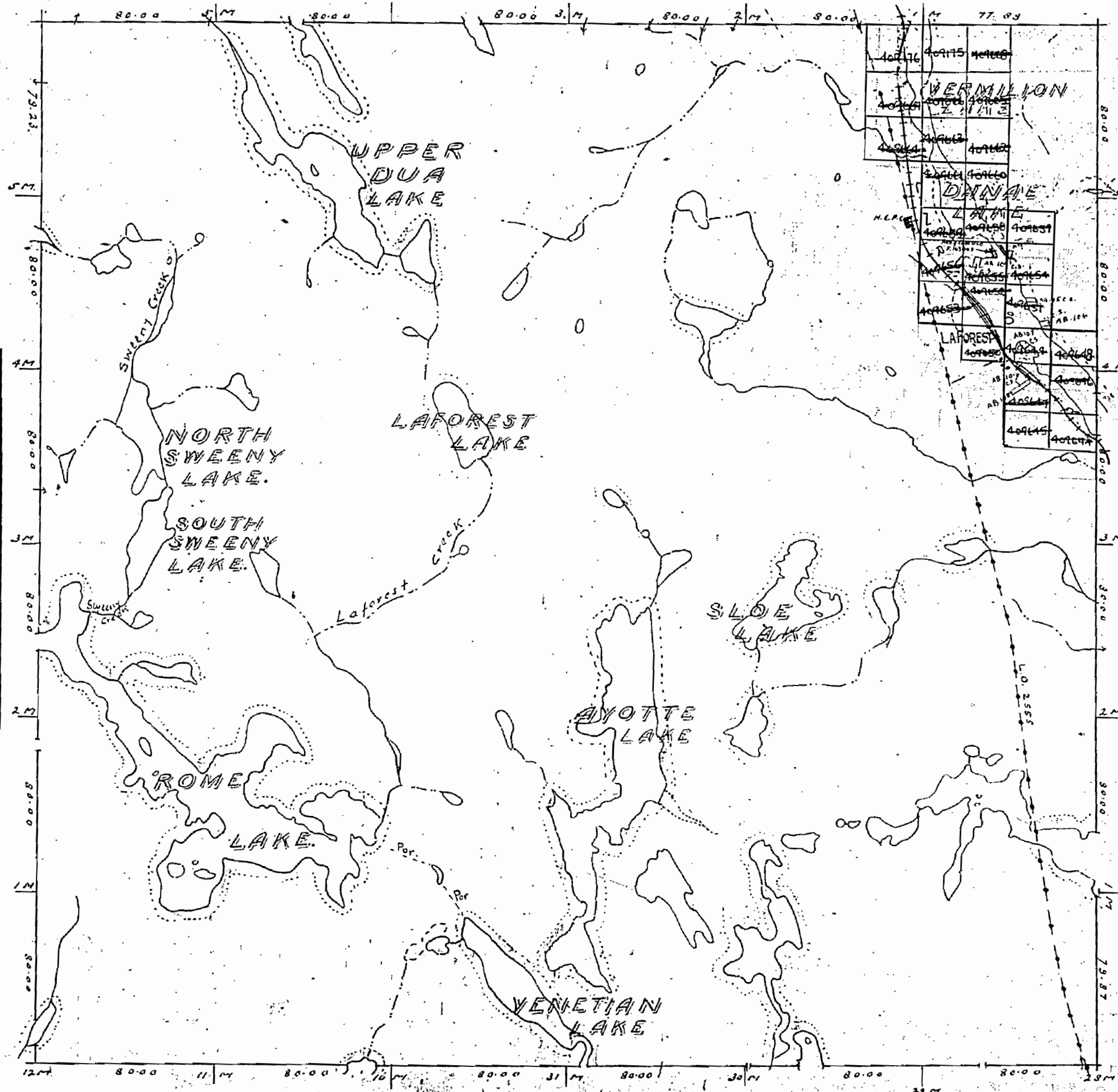

BOTHA TWP

NOTES

Railways shown thus
Paved Highways
Gravel
Highway Route No.
Other Roads
Trails
Telephone & Telegraph Lines
Electric Power Lines

Non-perennial streams
Bridges
Buildings
Swamps
Areas marked

Patented
Leased
Held under
Right of Occupation

See Surface Rights of Reservation
around all lakes & rivers

M.1151

SWEENY

PLAN OF SWEENY TWP. SUDBURY MINING DIVISION DISTRICT OF SUDBURY.

—Scale, 40 chains to an inch.—

FRECHETTE TWP.



DUNBAR TWP.

BEAUMONT TWP.

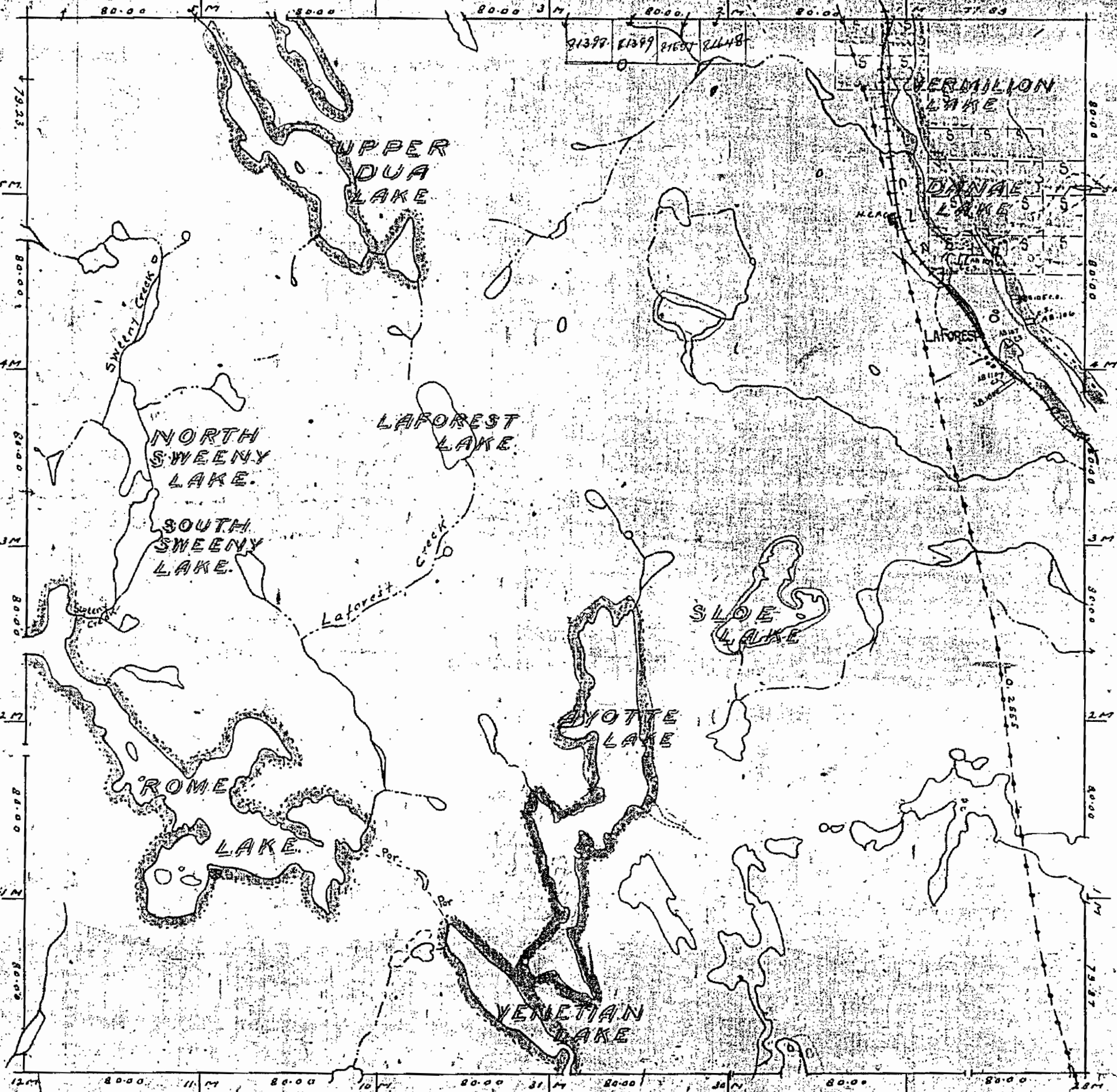

BOTHA TWP.

NOTES

- | | |
|---|------------------------|
| Railways shown thus | Non-perennial streams |
| Paved Highways | Bridges |
| Gravel | Buildings |
| Highway Route Nos. | Swamps |
| Other Roads | Areas marked |
| Trails & Paths | Patented |
| Telephone & Telegraph Lines | Leases |
| Electric Power Lines | Hold Over |
| Surface reservations 200' wide by Dept. of L.R. shown hereafter | Licenses of Occupation |

SWEENY
M1151