

DISPOSITION OF CROWN LANDS

TYPE OF DOCUMENT	SYMBOL
PATENT, SURFACE & MINING RIGHTS	●
" SURFACE RIGHTS ONLY	○
" MINING RIGHTS ONLY	○
LEASE, SURFACE & MINING RIGHTS	■
" SURFACE RIGHTS ONLY	■
" MINING RIGHTS ONLY	■
LICENCE OF OCCUPATION	▼
ORDER-IN-COUNCIL	OC
RESERVATION	⊙
CANCELLED	⊙
SAND & GRAVEL	⊙

NOTE: MINING RIGHTS IN PARCELS PATENTED PRIOR TO MAY 6, 1913, VESTED IN ORIGINAL PATENTEE BY THE PUBLIC LANDS ACT, R.S.O. 1970, CHAP. 380, SEC. 63, SUBSEC 1.

AREAS WITHDRAWN FROM DISPOSITION

- M.R.O. - MINING RIGHTS ONLY
- S.R.O. - SURFACE RIGHTS ONLY
- M.+S. - MINING AND SURFACE RIGHTS

Description	Order No.	Date	Disposition	File

NOTES

FLOODING RIGHTS ALONG ABITIBI RIVER BELOW CONTOUR ELEVATIONS 826' & 881' COVERED BY L.O. 8674.

THE INFORMATION THAT APPEARS ON THIS MAP HAS BEEN COMPILED FROM VARIOUS SOURCES, AND ACCURACY IS NOT GUARANTEED. THOSE WISHING TO STAKE MINING CLAIMS SHOULD CONSULT WITH THE MINING RECORDER, MINISTRY OF NORTHERN DEVELOPMENT AND MINES, FOR ADDITIONAL INFORMATION ON THE STATUS OF THE LANDS SHOWN HEREON.

EDWARDS TWP.

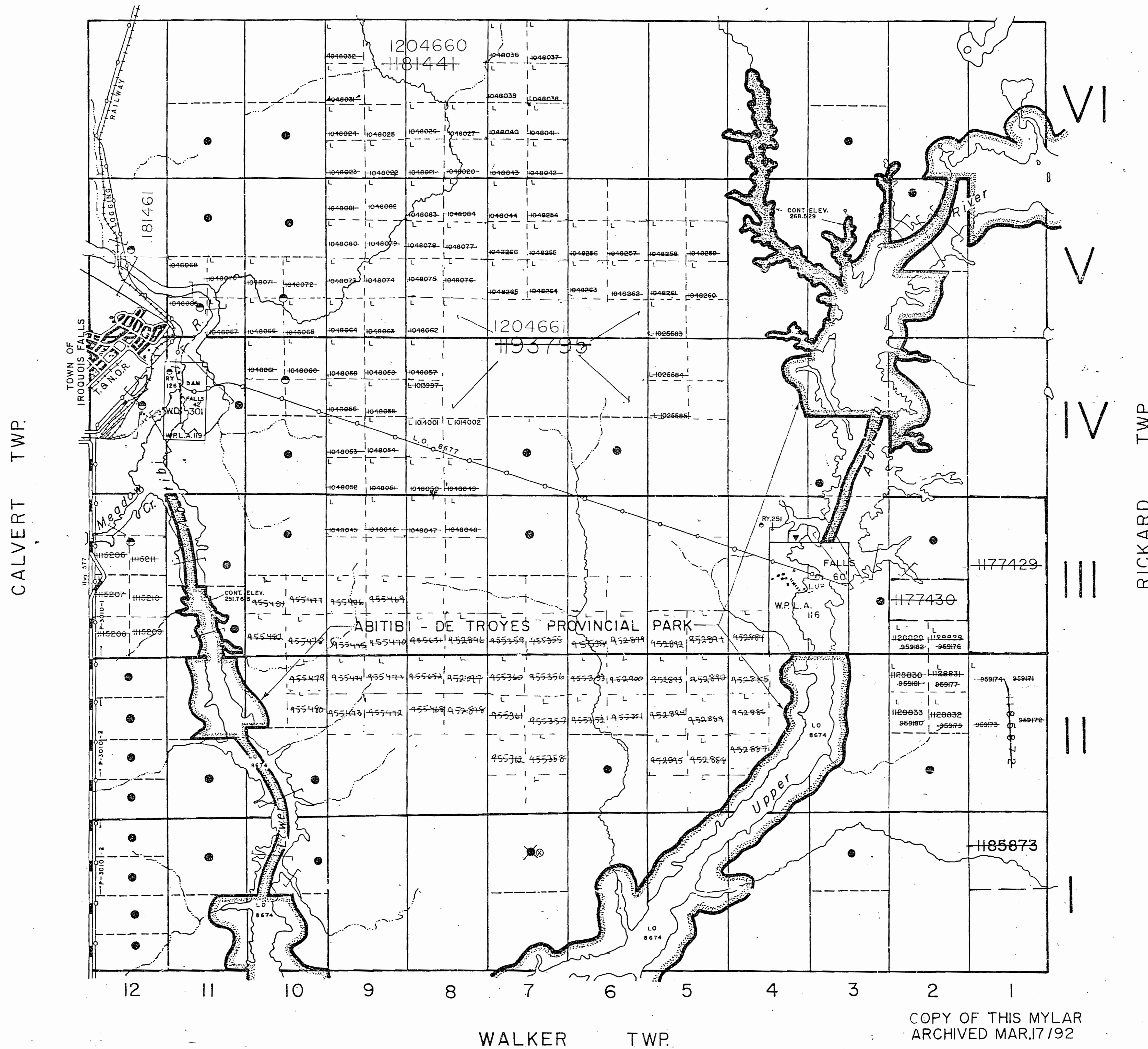

LEGEND

HIGHWAY AND ROUTE No.	
OTHER ROADS	
TRAILS	
SURVEYED LINES:	
TOWNSHIPS, BASE LINES, ETC.	
LOTS, MINING CLAIMS, PARCELS, ETC.	
UNSURVEYED LINES:	
LOT LINES	
PARCEL BOUNDARY	
MINING CLAIMS ETC.	
RAILWAY AND RIGHT OF WAY	
UTILITY LINES	
NON-PERENNIAL STREAM	
FLOODING OR FLOODING RIGHTS	
SUBDIVISION OR COMPOSITE PLAN	
RESERVATIONS	
ORIGINAL SHORELINE	
MARSH OR MUSKEG	
MINES	
TRAVERSE MONUMENT	

NOTICE OF FORESTRY ACTIVITY

THIS TOWNSHIP / AREA FALLS WITHIN THE IROQUOIS FALLS MANAGEMENT UNIT AND MAY BE SUBJECT TO FORESTRY OPERATIONS. THE MNR UNIT FORESTER FOR THIS AREA CAN BE CONTACTED AT: P.O. BOX 730, 2 THIRD AVE., COCHRANE, ONT. POL ICO, 705-272-4365

SCALE: 1 INCH = 40 CHAINS

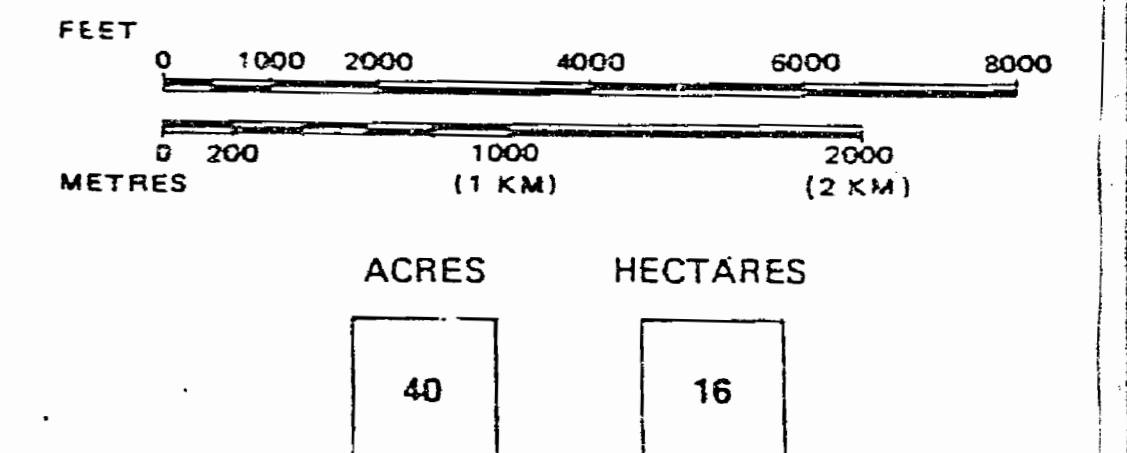

TOWNSHIP OF
TEEFY
DISTRICT OF
COCHRANE
MINING DIVISION
LARDER LAKE

Ministry of Natural Resources
Ministry of Northern Development and Mines

Date: OCTOBER '86

Plan No.

G-3576

COPY OF THIS MYLAR
ARCHIVED MAR.17/92
ARCHIVED NOV.08/95

DISPOSITION OF CROWN LANDS

TYPE OF DOCUMENT	SYMBOL
PATENT, SURFACE & MINING RIGHTS	●
" SURFACE RIGHTS ONLY	○
" MINING RIGHTS ONLY	○
LEASE, SURFACE & MINING RIGHTS	■
" SURFACE RIGHTS ONLY	■
" MINING RIGHTS ONLY	■
LICENCE OF OCCUPATION	OC
RESERVATION	⊙
CANCELLED	⊗
SAND & GRAVEL	⊕

NOTE: MINING RIGHTS IN PARCELS PATENTED PRIOR TO MAY 6, 1913, VESTED IN ORIGINAL PATENTEE BY THE PUBLIC LANDS ACT, R.S.O. 1970, CHAP. 380, SEC. 63, SUBSEC. 1.

AREAS WITHDRAWN FROM DISPOSITION

- M.R.O. - MINING RIGHTS ONLY
- S.R.O. - SURFACE RIGHTS ONLY
- M.+S. - MINING AND SURFACE RIGHTS

Description	Order No.	Date	Disposition	File

NOTES

FLOODING RIGHTS ALONG ABITIBI RIVER BELOW CONTOUR ELEVATIONS 826' & 881' COVERED BY L.O. 8674.

THE INFORMATION THAT APPEARS ON THIS MAP HAS BEEN COMPILED FROM VARIOUS SOURCES, AND ACCURACY IS NOT GUARANTEED. THOSE WISHING TO STAKE MINING CLAIMS SHOULD CONSULT WITH THE MINING RECORDER, MINISTRY OF NORTHERN DEVELOPMENT AND MINES, FOR ADDITIONAL INFORMATION ON THE STATUS OF THE LANDS SHOWN HEREON.

EDWARDS TWP.

CALVERT TWP.

RICKARD TWP.

WALKER TWP.

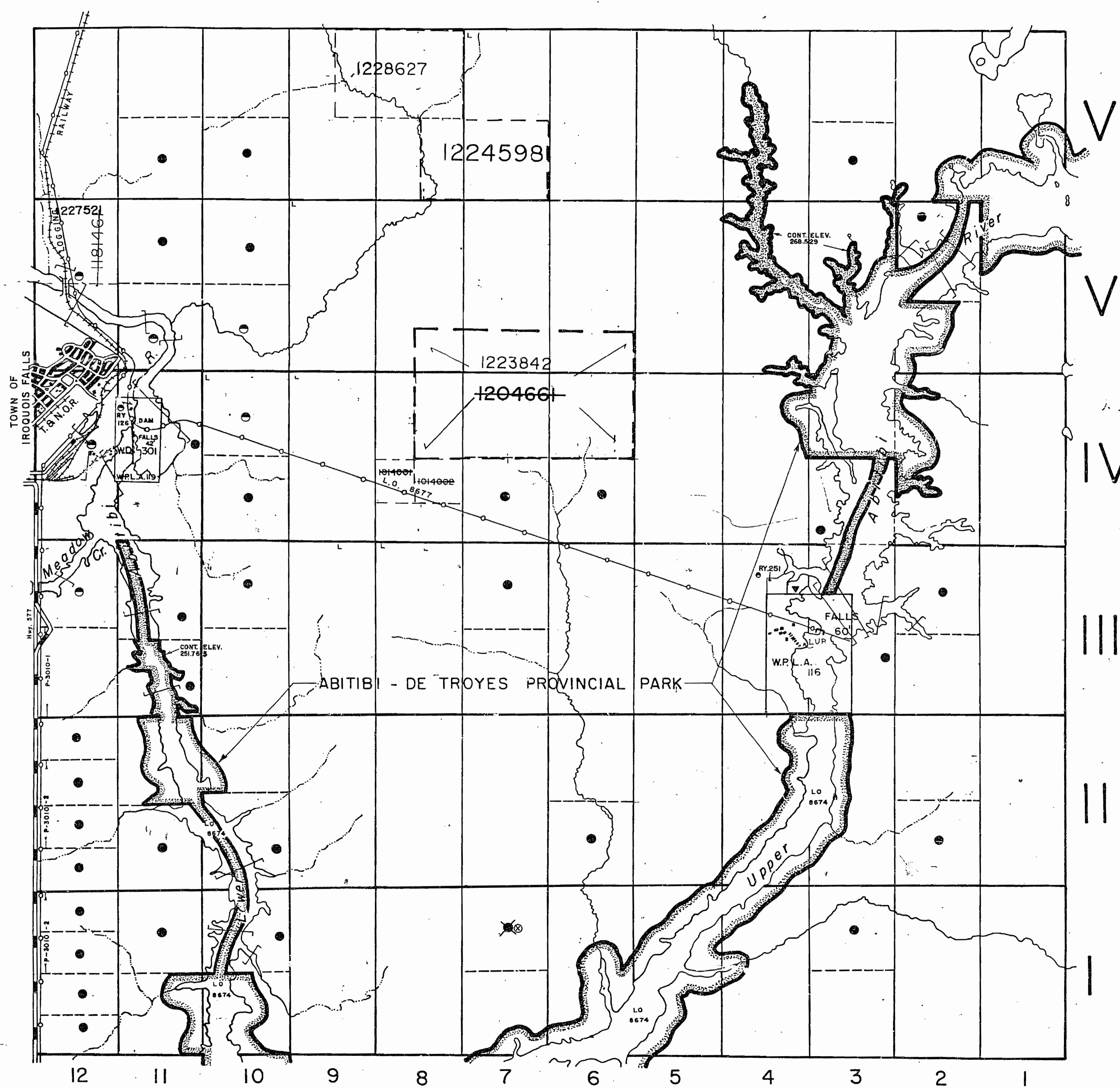

LEGEND

HIGHWAY AND ROUTE No.	
OTHER ROADS	
TRAILS	
SURVEYED LINES	
TOWNSHIP BOUNDARIES	
LOTS, MINING CLAIMS, PARCELS, ETC.	
UNSURVEYED LINES:	
LOT LINES	
PARCEL BOUNDARY	
MINING CLAIMS ETC.	
RAILWAY AND RIGHT OF WAY	
UTILITY LINES	
NON-PERENNIAL STREAM	
FLOODING OR FLOODING RIGHTS	
SUBDIVISION OR COMPOSITE PLAN	
RESERVATIONS	
ORIGINAL SHORELINE	
MARSH OR MUSKEG	
MINES	
TRAVERSE MONUMENT	

NOTICE OF FORESTRY ACTIVITY

THIS TOWNSHIP / AREA FALLS WITHIN THE IROQUOIS FALLS MANAGEMENT UNIT AND MAY BE SUBJECT TO FORESTRY OPERATIONS. THE MNR UNIT FORESTER FOR THIS AREA CAN BE CONTACTED AT: P.O. BOX 730, 2 THIRD AVE., COCHRANE, ONT. POL 1C0, 705-272-4365

SCALE: 1 INCH = 40 CHAINS

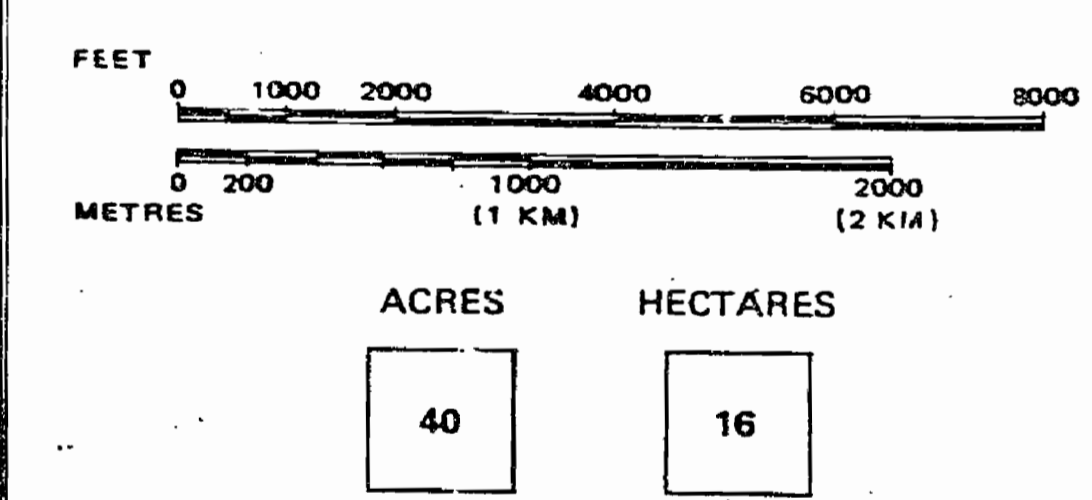

TOWNSHIP OF
TEEFY
DISTRICT OF COCHRANE
DATE OF ISSUE: 30 1998
MINING DIVISION
PROVINCIAL RECORDING OFFICE - SUDBURY
LARDER LAKE

Ministry of Natural Resources Ontario
Ministry of Northern Development and Mines

Date: OCTOBER '86
Plan No.: G-3576

COPY OF THIS MYLAR ARCHIVED MAR.17/92 ARCHIVED NOV.08/95

Edwards Twp.

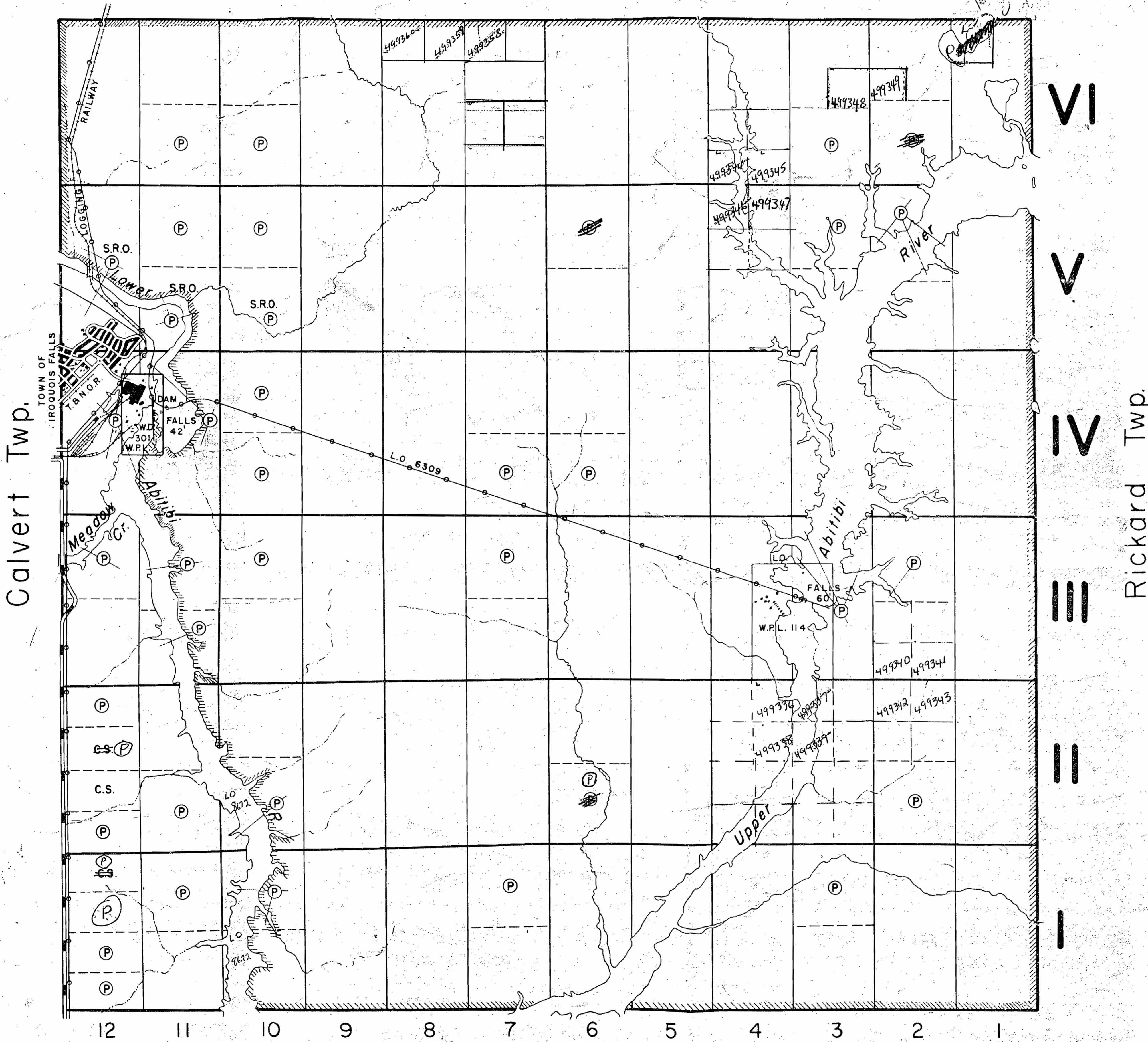

THE TOWNSHIP
OF

TEEFY

DISTRICT OF
COCHRANE

LARDER LAKE
MINING DIVISION

SCALE 1-INCH=40 CHAINS

LEGEND

PATENTED LAND	(P)
CROWN LAND SALE	C.S.
LEASES	(L)
LOCATED LAND	Loc
LICENSE OF OCCUPATION	L.O.
ROADS	—
IMPROVED ROADS	—
RAILWAYS	—
POWER LINES	—
MARSH OR MUSKEG	—
SURFACE RIGHTS ONLY	S.R.O.

NOTES

Flooding rights along shores of Abitibi River.
 License of Occupation No. 937 to cover all unpatented land along shores of Abitibi River
 Water Power Lease: W.P.L.
 Area shown thus withdrawn from staking and prospecting under Section 42 of the Mining Act. Opened for staking and prospecting. See Order 6.27/77

**MINING RECORDER
RECEIVED**
 MAY 10 1957
 SWASTIKA - ONT.

*Rep by Mylon
Sep 12/79*

PLAN NO. — M.600

DEPARTMENT OF MINES
—ONTARIO— #4

Walker Twp.

DISPOSITION OF CROWN LANDS

TYPE OF DOCUMENT	SYMBOL
PATENT, SURFACE & MINING RIGHTS	●
" " SURFACE RIGHTS ONLY	○
" " MINING RIGHTS ONLY	◐
LEASE SURFACE & MINING RIGHTS	■
" " SURFACE RIGHTS ONLY	◼
" " MINING RIGHTS ONLY	◑
EVIDENCE OF OCCUPATION	OC
ORDER IN COUNCIL	⊙
RESERVATION	⊗
CANCELLED	⊘
SAND & GRAVEL	⊙

NOTE: MINING RIGHTS IN PARCELS PATENTED PRIOR TO MAY 6, 1961, VESTED IN ORIGINAL PATENTEES BY THE PUBLIC LANDS ACT, 1920 (CHAP. 100) SEC. 61, SUBSECT. 1

EDWARDS TWP.

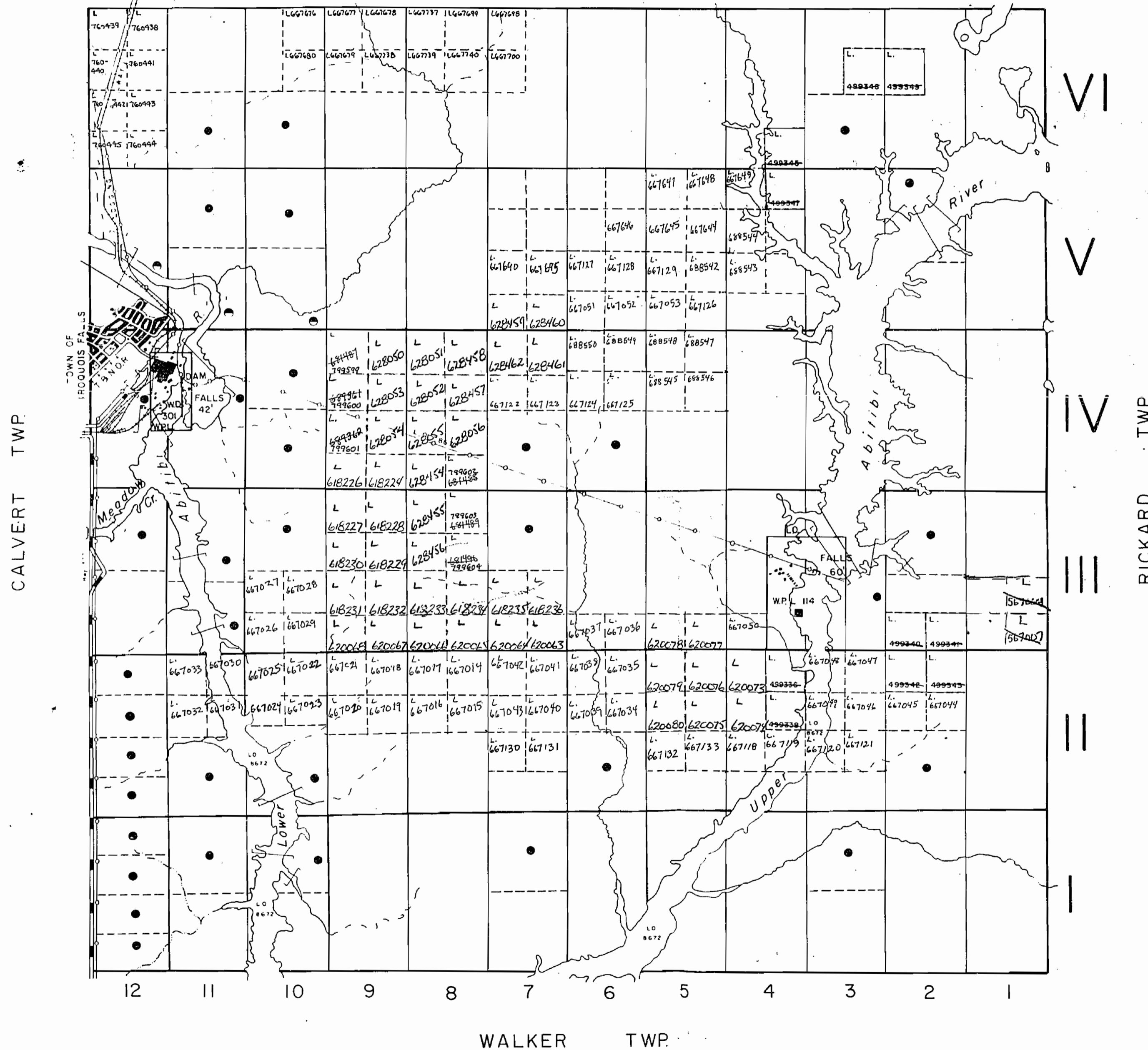

LEGEND

HIGHWAY AND ROUTE No.	
OTHER ROADS	
TRAILS	
SURVEYED LINES:	
TOWNSHIPS, BASE LINES, ETC.	
LOTS, MINING CLAIMS, PARCELS, ETC.	
UNSURVEYED LINES:	
LOT LINES	
PARCEL BOUNDARY	
MINING CLAIMS ETC.	
RAILWAY AND RIGHT OF WAY	
UTILITY LINES	
NON-PERENNIAL STREAM	
FLOODING OR FLOODING RIGHTS	
SUBDIVISION OR COMPOSITE PLAN	
RESERVATIONS	
ORIGINAL SHORELINE	
MARSH OR MUSKEG	
MINES	
TRAVERSE MONUMENT	

NOTES

400' Surface Rights Reservation around all lakes and rivers.

Water Power Lease: W.P.L.

Flooding rights along shores of Abitibi River below contour levels 826' & 881' covered by L.O. 8674.

SCALE: 1 INCH = 40 CHAINS

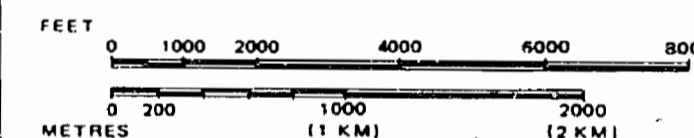

ACRES	HECTARES
40	16

TOWNSHIP OF
TEEFY
DISTRICT OF
COCHRANE
MINING DIVISION
LARDER LAKE

Ministry of Natural Resources
Ontario
Surveys and Mapping Branch #4

Date 10/03/1980

Plan No.

National Topographic Series

M.600

Replaced August 20-1984

DISPOSITION OF CROWN LANDS

TYPE OF DOCUMENT	SYMBOL
PATENT, SURFACE & MINING RIGHTS	●
" SURFACE RIGHTS ONLY	○
" MINING RIGHTS ONLY	○
LEASE SURFACE & MINING RIGHTS	■
" SURFACE RIGHTS ONLY	□
" MINING RIGHTS ONLY	□
LICENCE OF OCCUPATION	▽
ORDER IN COUNCIL	OC
RESERVATION	⊙
CANCELLED	⊗
SAND & GRAVEL	⊕

NOTE: MINING RIGHTS IN PARCELS PATENTED PRIOR TO MAY 6, 1913, VESTED IN ORIGINAL PATENTEE BY THE PUBLIC LANDS ACT, R.S.O. 1970, CHAP. 190, SEC. 63, SUBSEC. 1

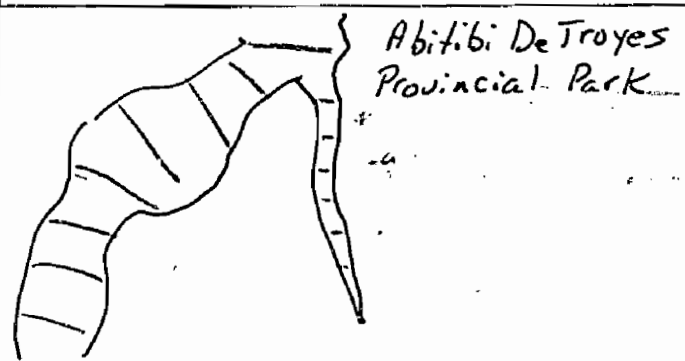

CALVERT TWP.

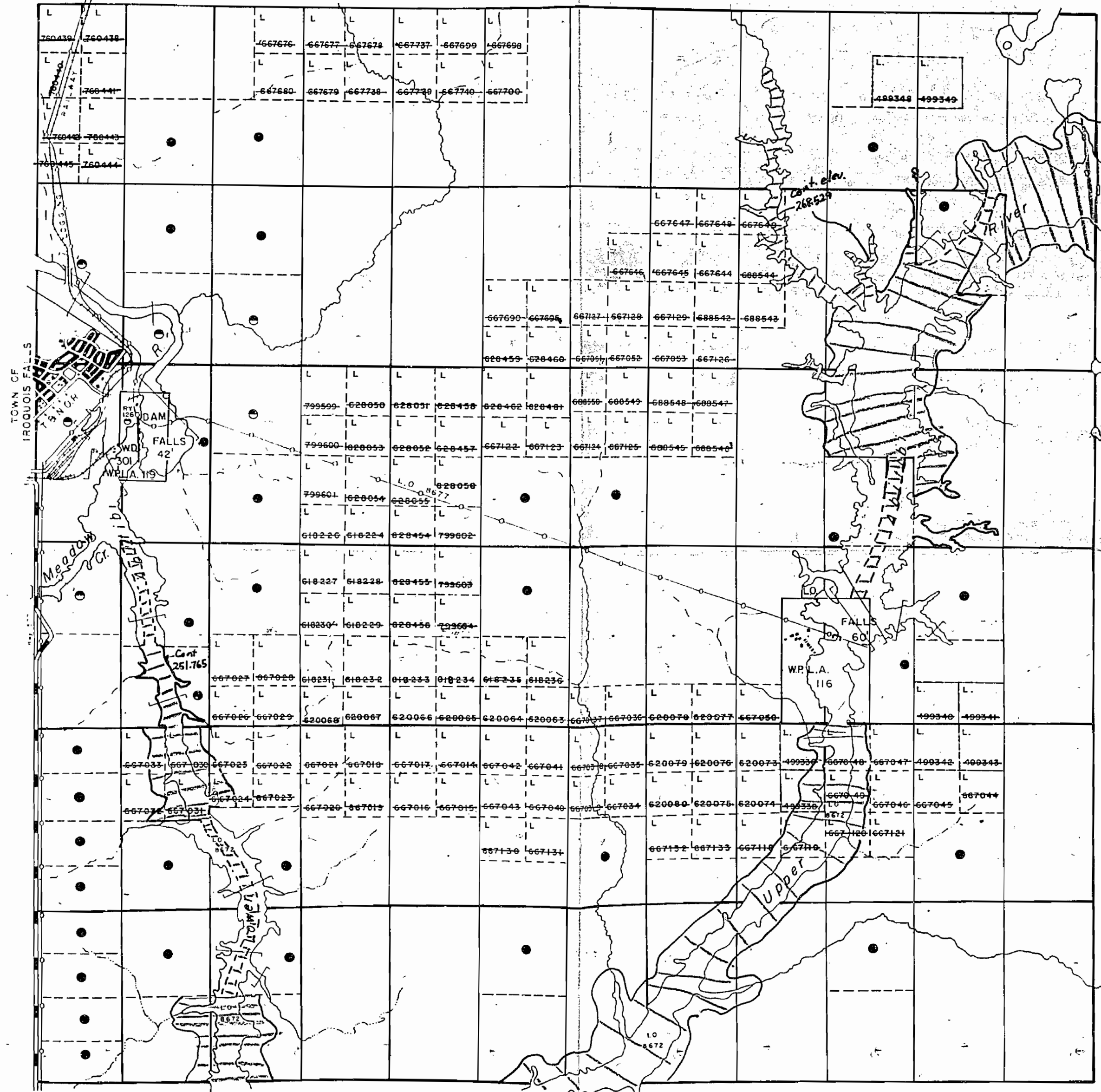

EDWARDS TWP.

WALKER TWP.

VI

V

IV

III

II

I

RICKARD TWP.

LEGEND

HIGHWAY AND ROUTE No.	
OTHER ROADS	
TRAILS	
SURVEYED LINES:	
TOWNSHIPS, BASE LINES, ETC.	
LOTS, MINING CLAIMS, PARCELS, ETC.	
UNSURVEYED LINES:	
LOT LINES	
PARCEL BOUNDARY	
MINING CLAIMS ETC.	
RAILWAY AND RIGHT OF WAY	
UTILITY LINES	
NON-PERENNIAL STREAM	
FLOODING OR FLOODING RIGHTS	
SUBDIVISION OR COMPOSITE PLAN	
RESERVATIONS	
ORIGINAL SHORELINE	
MARSH OR MUSKEG	
MINES	
TRAVERSE MONUMENT	

NOTES

400' Surface Rights Reservation around all lakes and rivers.

Water Power Lease: W.P.L.

Flooding rights along shores of Abitibi River below contour levels 826' & 881' covered by L.O. 8674.

SCALE: 1 INCH = 40 CHAINS

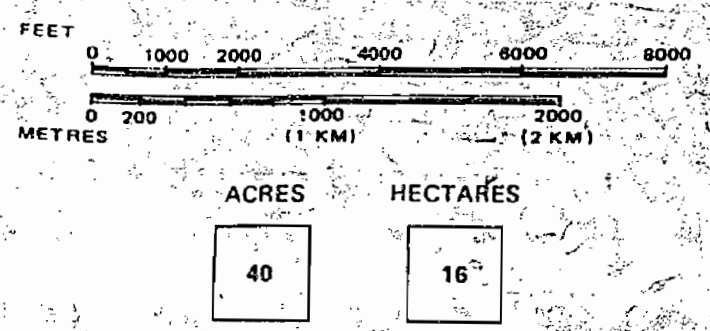

TOWNSHIP OF *Replaced*
TEEFY *Nov 13, 1962*

DISTRICT OF COCHRANE

MINING DIVISION

LARDER LAKE

Ministry of Natural Resources
Ontario

Surveys and Mapping Branch #4

Date 10/03/1980
National Topographic Series

Plan No. M.600

DISPOSITION OF CROWN LANDS

TYPE OF DOCUMENT	SYMBOL
PATENT, SURFACE & MINING RIGHTS	●
" SURFACE RIGHTS ONLY	○
" MINING RIGHTS ONLY	○
LEASE SURFACE & MINING RIGHTS	■
" SURFACE RIGHTS ONLY	■
" MINING RIGHTS ONLY	■
LICENCE OF OCCUPATION	▼
ORDER-IN-COUNCIL	OC
RESERVATION	⊙
CANCELLED	⊖
SAND & GRAVEL	⊕

NOTE: MINING RIGHTS IN PARCELS PATENTED PRIOR TO MAY 6, 1913 VESTED IN ORIGINAL PATENTEE BY THE PUBLIC LANDS ACT, R.S.O. 1970, CHAP. 380, SEC. 63, SUBSEC. 1.

AREAS WITHDRAWN FROM DISPOSITION

- M.R.O. - MINING RIGHTS ONLY
- S.R.O. - SURFACE RIGHTS ONLY
- M.+S. - MINING AND SURFACE RIGHTS

Description	Order No.	Date	Disposition	File

NOTES

FLOODING RIGHTS ALONG ABITIBI RIVER BELOW CONTOUR ELEVATIONS 826' & 881' COVERED BY L.O. 9674.

THE INFORMATION THAT APPEARS ON THIS MAP HAS BEEN COMPILED FROM VARIOUS SOURCES, AND ACCURACY IS NOT GUARANTEED. THOSE WISHING TO STAKE MINING CLAIMS SHOULD CONSULT WITH THE MINING RECORDER, MINISTRY OF NORTHERN DEVELOPMENT AND MINES, FOR ADDITIONAL INFORMATION ON THE STATUS OF THE LANDS SHOWN HEREON.

EDWARDS TWP.

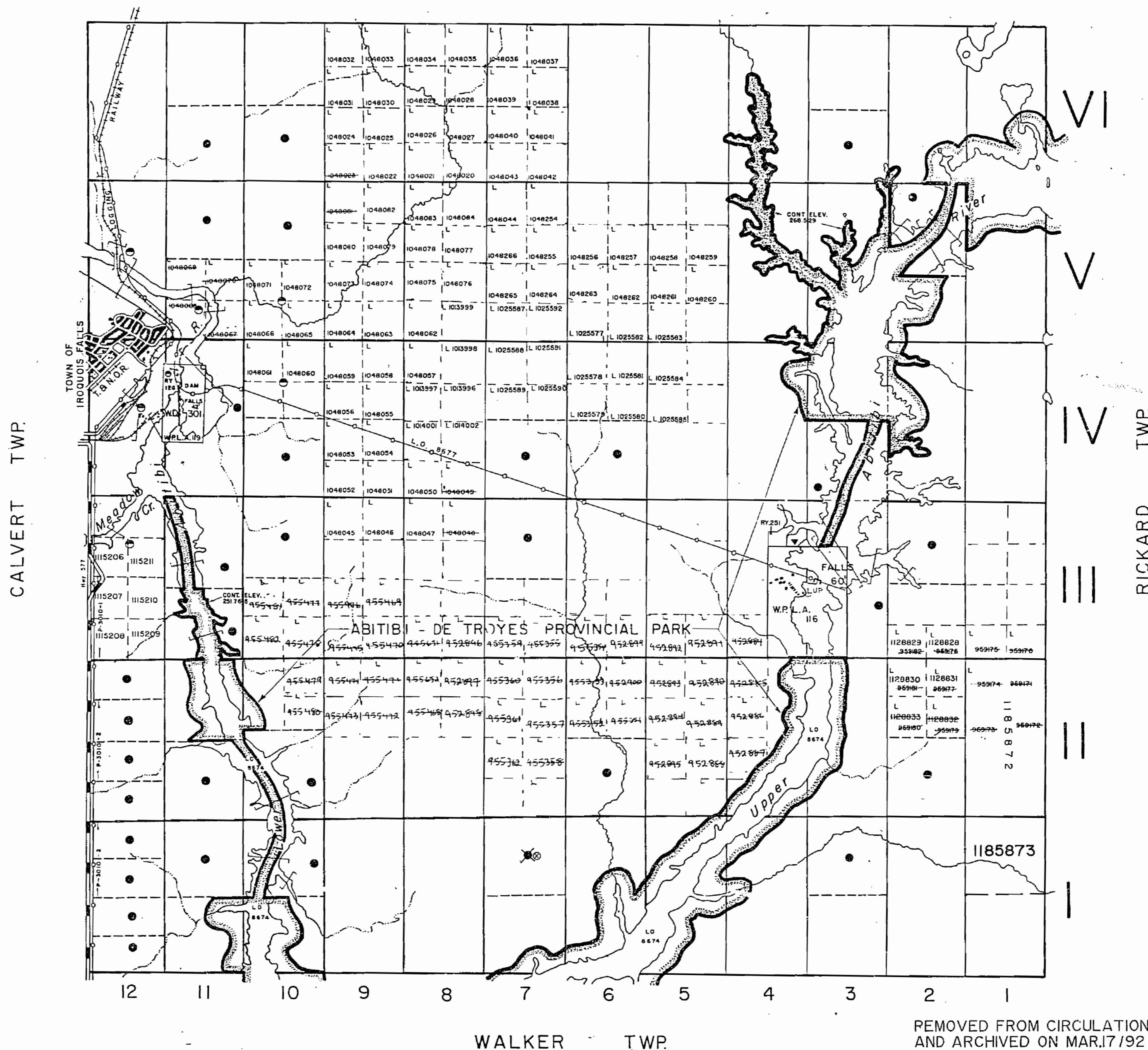

LEGEND

HIGHWAY AND ROUTE No.	
OTHER ROADS	
TRAILS	
SURVEYED LINES:	
TOWNSHIPS, BASE LINES, ETC.	
LOTS, MINING CLAIMS, PARCELS, ETC.	
UNSURVEYED LINES:	
LOT LINES	
PARCEL BOUNDARY	
MINING CLAIMS ETC.	
RAILWAY AND RIGHT OF WAY	
UTILITY LINES	
NON-PERENNIAL STREAM	
FLOODING OR FLOODING RIGHTS	
SUBDIVISION OR COMPOSITE PLAN	
RESERVATIONS	
ORIGINAL SHORELINE	
MARSH OR MUSKEG	
MINES	
TRAVERSE MONUMENT	

NOTICE OF FORESTRY ACTIVITY

THIS TOWNSHIP / AREA FALLS WITHIN THE IROQUOIS FALLS MANAGEMENT UNIT AND MAY BE SUBJECT TO FORESTRY OPERATIONS. THE MNR UNIT FORESTER FOR THIS AREA CAN BE CONTACTED AT: P.O. BOX 730, 2 THIRD AVE., COCHRANE, ONT. P.O. BOX 730, COCHRANE, ONT. POL 1C0 705-272-4365

SCALE: 1 INCH = 40 CHAINS

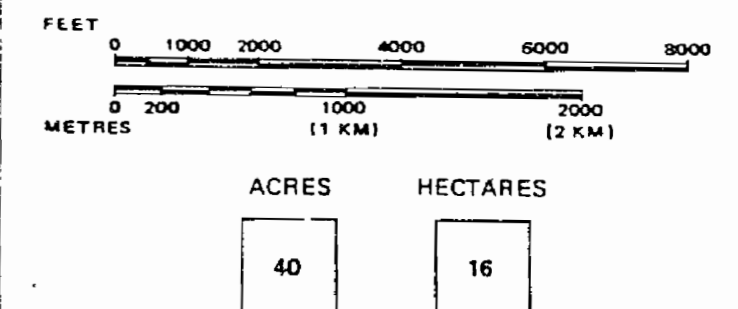

TOWNSHIP OF
TEEFY
DISTRICT OF
COCHRANE
MINING DIVISION
LARDER LAKE

Ministry of Natural Resources
Ontario
Ministry of Northern Development and Mines

REMOVED FROM CIRCULATION AND ARCHIVED ON MAR.17/92

Date OCTOBER '86

Plan No.

G-3576

600

TEEFY

DISTRICT OF COCHRANE

SCALE 40 CHAINS = 1 INCH

M-600

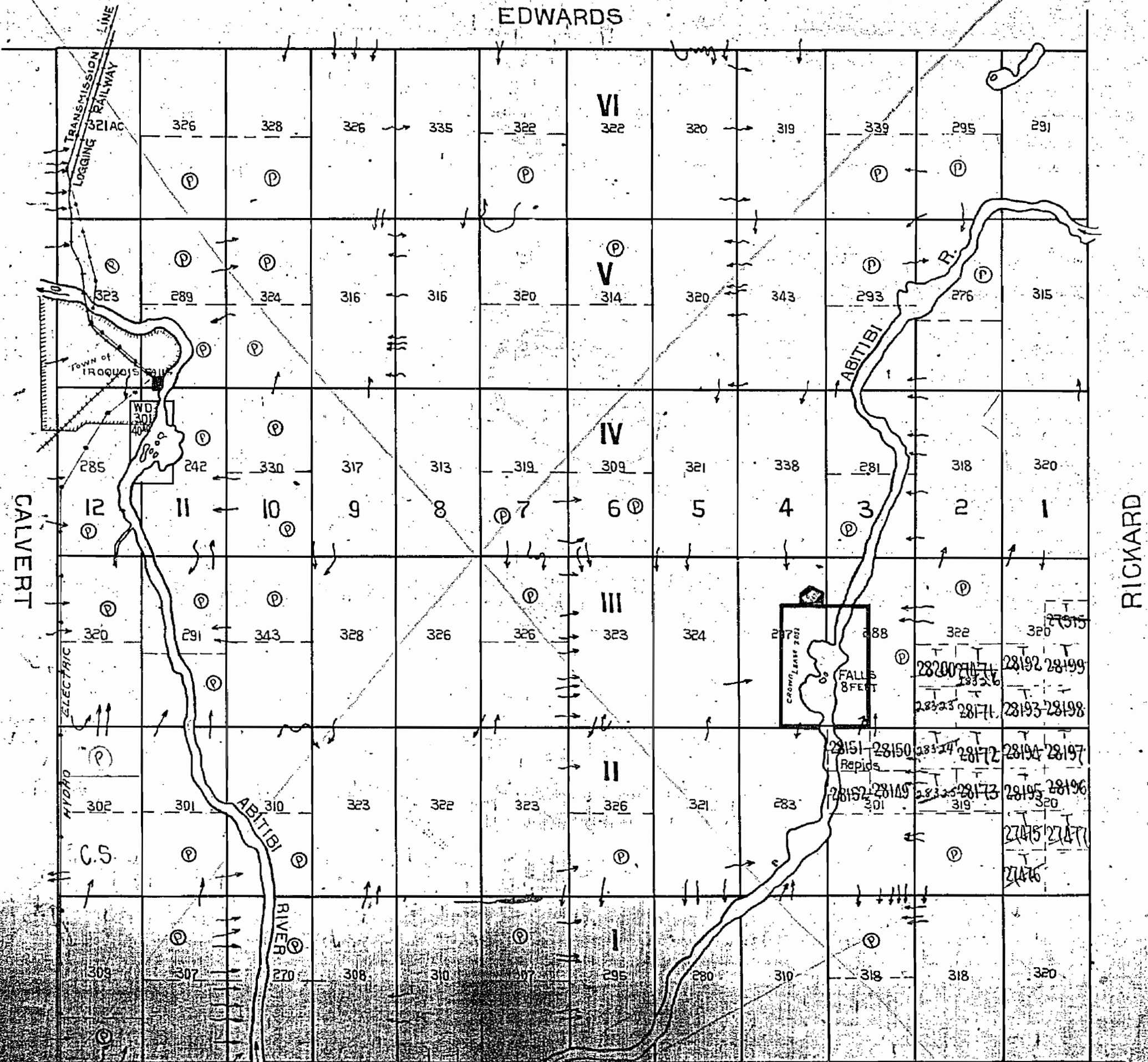

600

Temiskaming

TEEFY.

DISTRICT OF NIPISSING

Scale: 40 Chains to an inch

M-600 *cy*

EDWARDS

AURORA

WESLEY

CALVERT

RICKARD

CLERGUE

WALKER

WILKIE

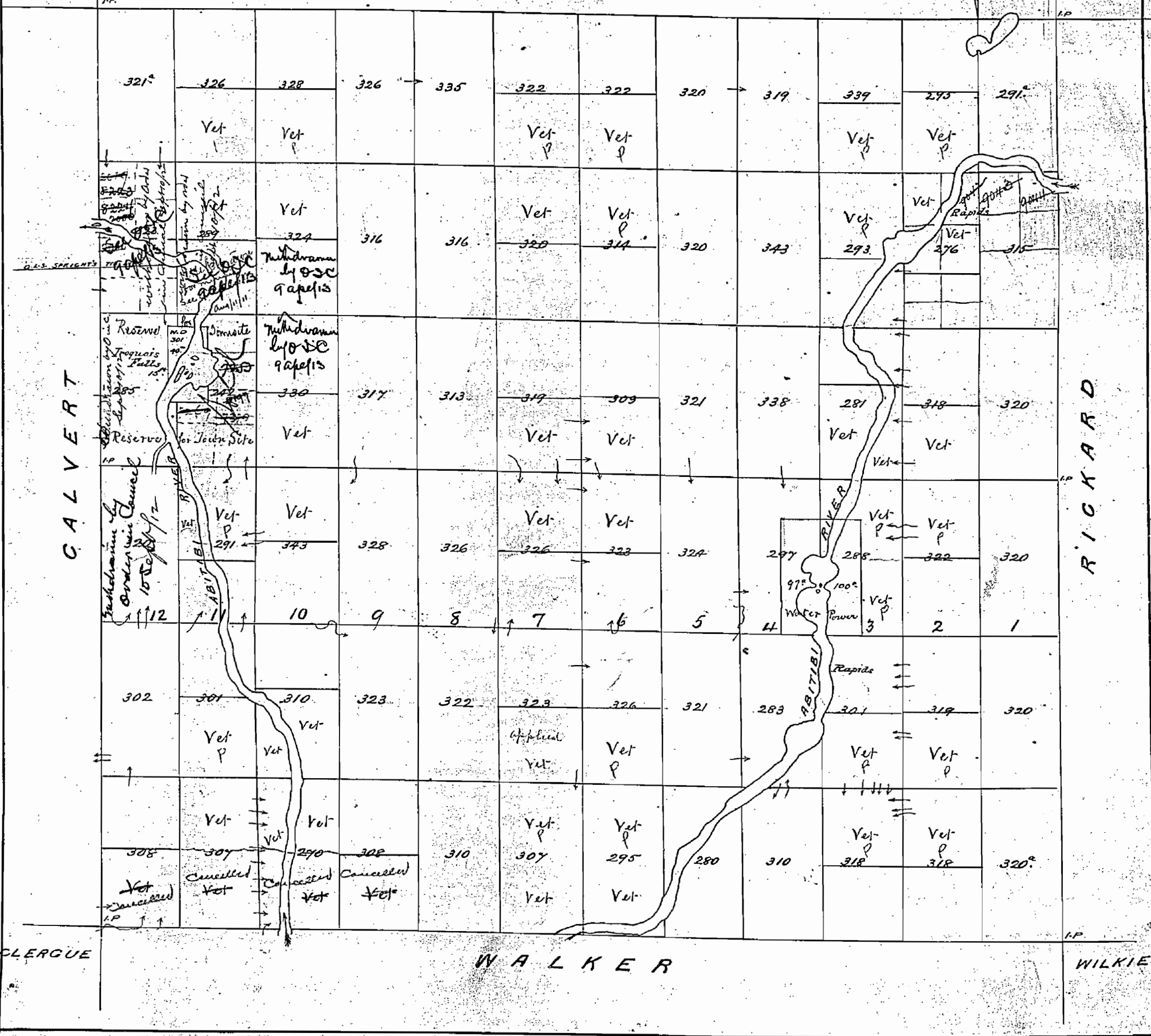

600

TEEEY IWB IIN

No. 3.

Edwards Twp.

Calvert Twp.

Walker Twp.



THE TOWNSHIP OF

TEEFY

DISTRICT OF COCHRANE

TIMISKAMING MINING DIVISION

SCALE: 1-INCH=40 CHAINS

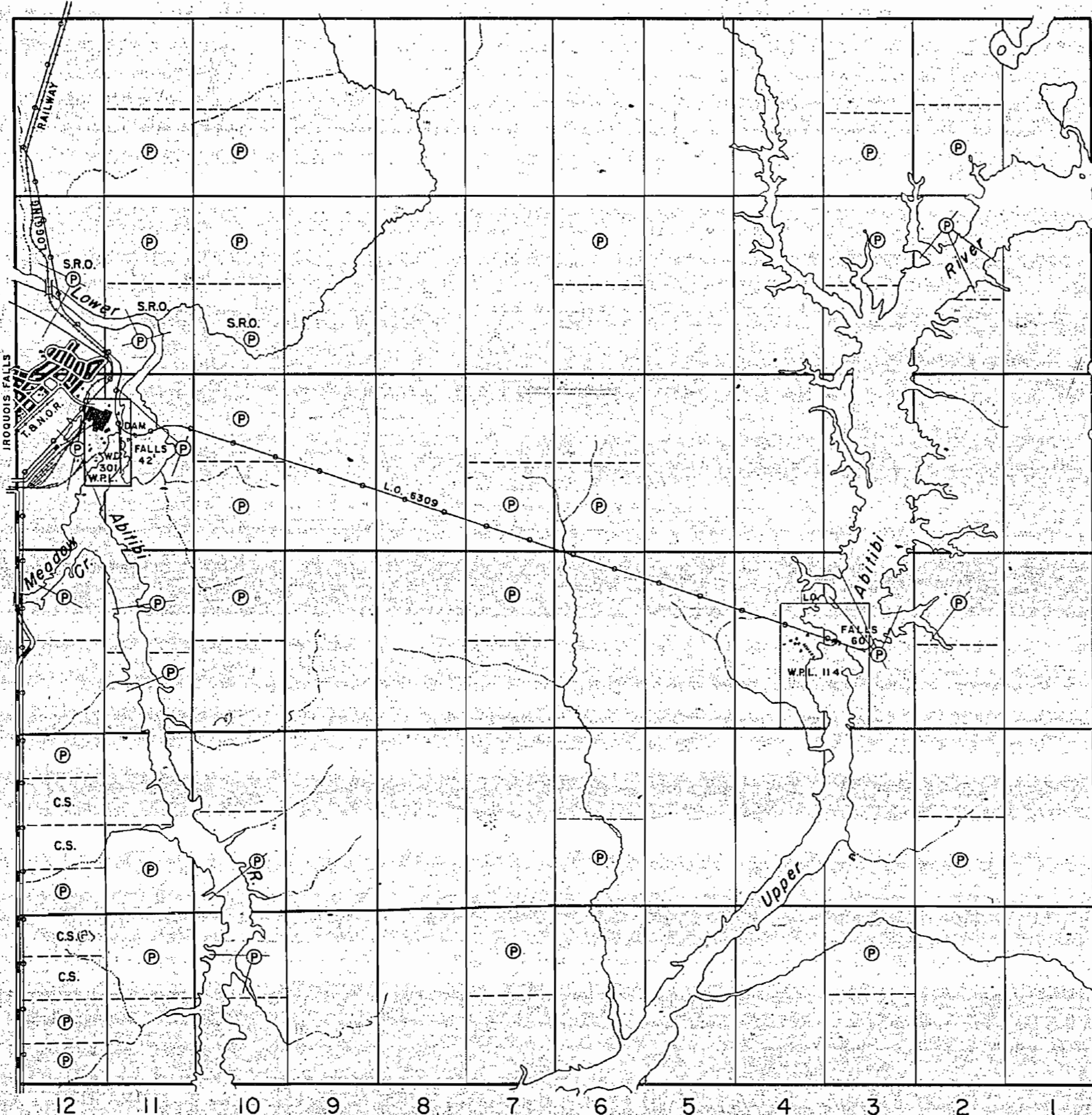

VI

V

IV

III

II

I

Rickard Twp.

LEGEND

PATENTED LAND	Ⓟ
CROWN LAND SALE	C.S.
LEASES	Ⓞ
LOCATED LAND	Loc.
LICENSE OF OCCUPATION	L.O.
ROADS	—
IMPROVED ROADS	—
RAILWAYS	—
POWER LINES	—
MARSH OR MUSKEG	—
SURFACE RIGHTS ONLY	S.R.O.

NOTES

Flooding rights along shores of Abitibi River.
 License of Occupation No. 937 to cover all unpatented land along shores of Abitibi River.
 Water Power Lease: W.P.L.

M-600

PLAN NO. T-177

DEPARTMENT OF MINES — ONTARIO —

JEELY. J.W.

Edwards Twp.

Calvert Twp.

Rickard Twp.

Walker Twp.

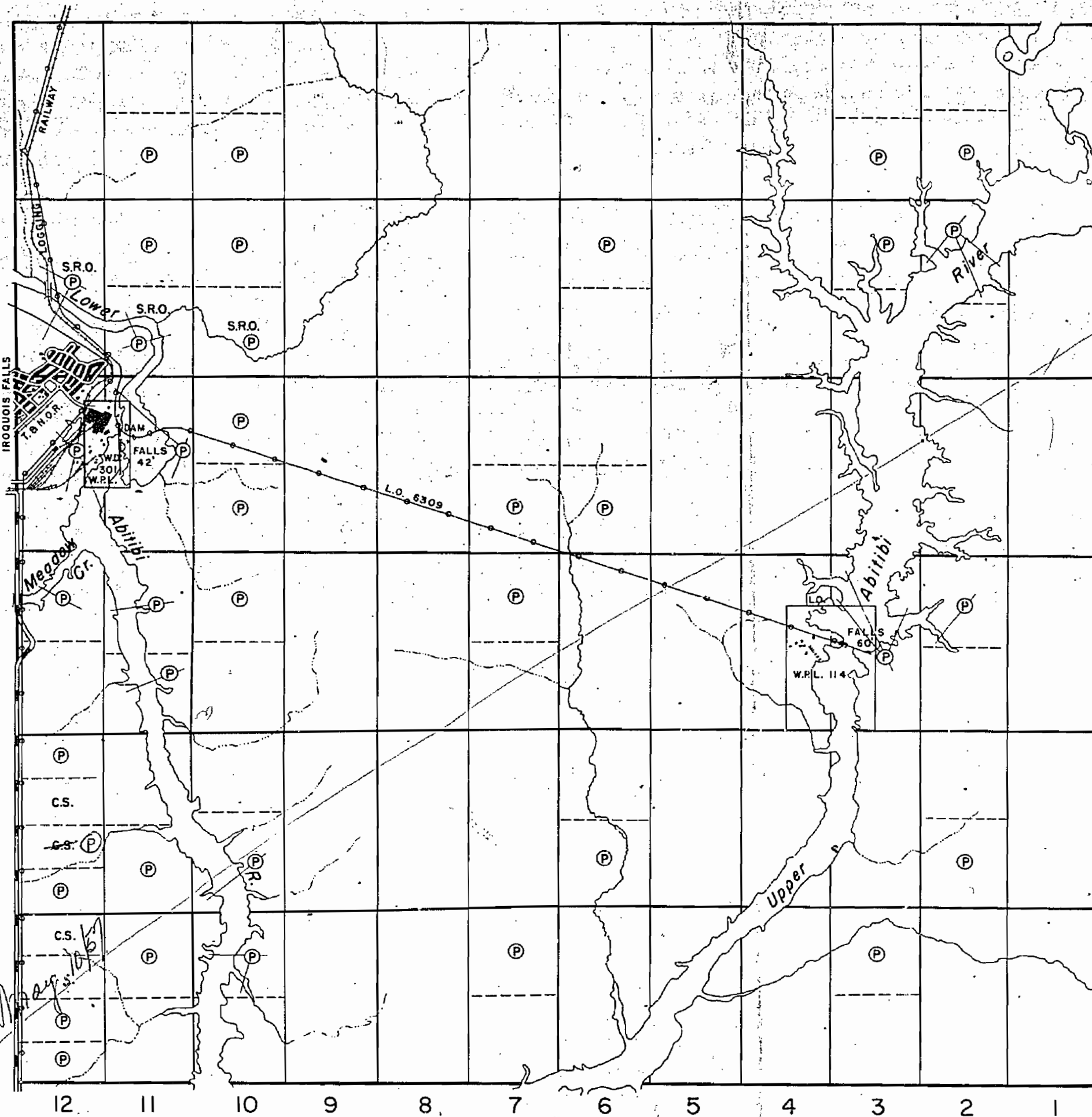

THE TOWNSHIP
OF
TEEFY

DISTRICT OF
COCHRANE
TIMISKAMING
MINING DIVISION

SCALE: 1-INCH=40 CHAINS

LEGEND

PATENTED LAND	Ⓟ
CROWN LAND SALE	C.S.
LEASES	Ⓞ
LOCATED LAND	Loc.
LICENSE OF OCCUPATION	L.O.
ROADS	— — — — —
IMPROVED ROADS	— — — — —
RAILWAYS	— — — — —
POWER LINES	— — — — —
MARSH OR MUSKEG	— — — — —
SURFACE RIGHTS ONLY	S.R.O.

NOTES

Flooding rights along shores of Abitibi River.
License of Occupation No. 937 to cover all
unpotented land along shores of Abitibi River.
Water Power Lease: W.P.L.

**MINING RECORDER
RECEIVED**
APR 12 1953
SWASTIKA . ONT.

PLAN NO. — M. 600

DEPARTMENT OF MINES
— ONTARIO —

DISPOSITION OF CROWN LANDS

TYPE OF DOCUMENT	SYMBOL
PATENT, SURFACE & MINING RIGHTS	●
" SURFACE RIGHTS ONLY	○
" MINING RIGHTS ONLY	○
LEASE, SURFACE & MINING RIGHTS	■
" SURFACE RIGHTS ONLY	■
" MINING RIGHTS ONLY	■
LICENCE OF OCCUPATION	▼
ORDER-IN-COUNCIL	OC
RESERVATION	⊙
CANCELLED	⊙
SAND & GRAVEL	⊙

NOTE: MINING RIGHTS IN PARCELS PATENTED PRIOR TO MAY 6, 1913, VESTED IN ORIGINAL PATENTEE BY THE PUBLIC LANDS ACT, R.S.O. 1970, CHAP. 380, SEC. 63, SUBSEC 1.

AREAS WITHDRAWN FROM DISPOSITION

- M.R.O. - MINING RIGHTS ONLY
- S.R.O. - SURFACE RIGHTS ONLY
- M.+S. - MINING AND SURFACE RIGHTS

Description	Order No.	Date	Disposition	File

NOTES

FLOODING RIGHTS ALONG ABITIBI RIVER BELOW CONTOUR ELEVATIONS 826' & 881' COVERED BY L.O. 8674.

THE INFORMATION THAT APPEARS ON THIS MAP HAS BEEN COMPILED FROM VARIOUS SOURCES AND ACCURACY IS NOT GUARANTEED. THOSE WISHING TO STAKE MINING CLAIMS SHOULD CONSULT WITH THE MINING RECORDER, MINISTRY OF NORTHERN DEVELOPMENT AND MINES FOR ADDITIONAL INFORMATION ON THE STATUS OF THE LANDS SHOWN HEREON.

EDWARDS TWP.

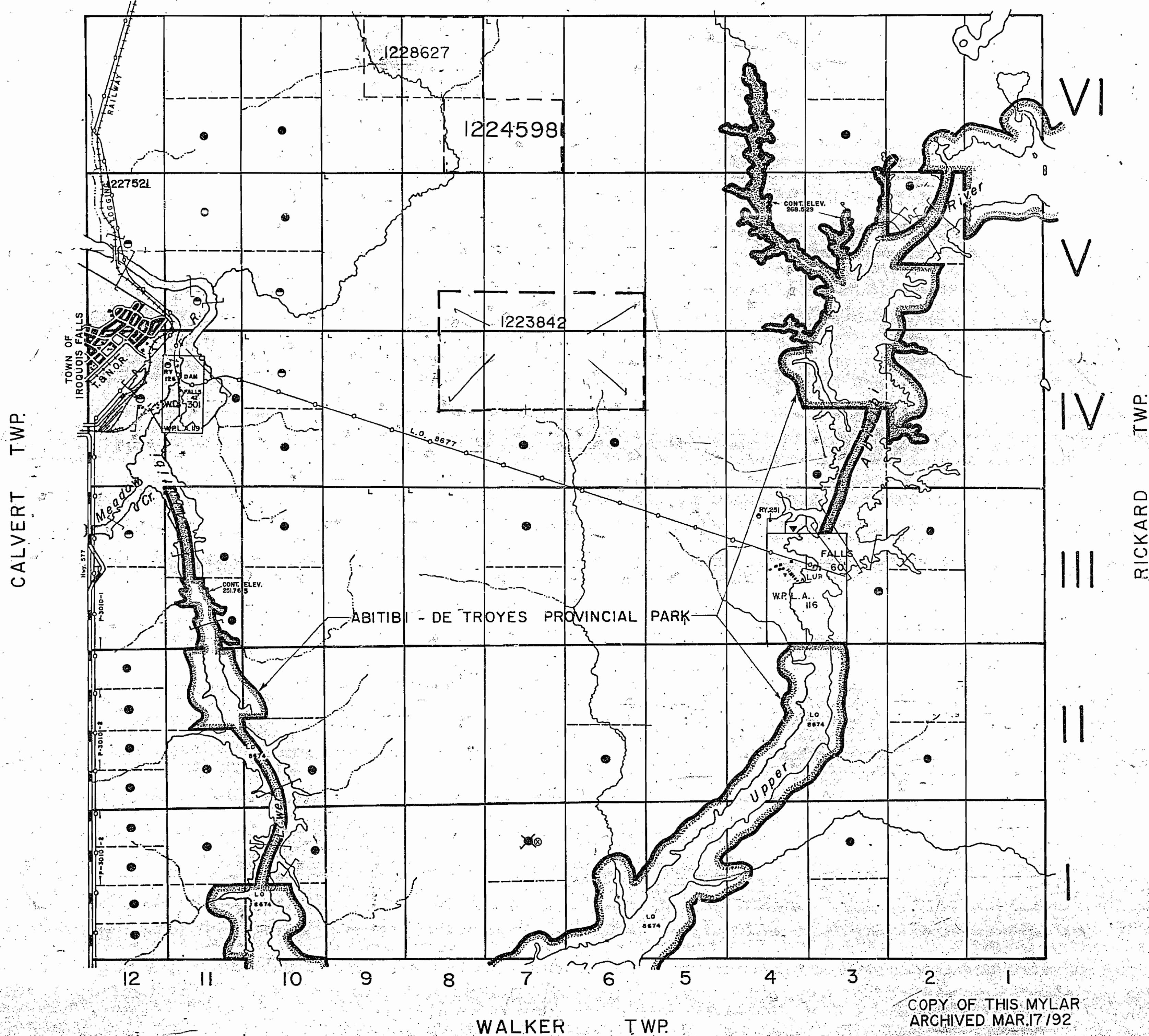

LEGEND

HIGHWAY AND ROUTE No.	
OTHER ROADS	
TRAILS	
SURVEYED LINES:	
TOWNSHIPS, BASE LINES, ETC.	
LOTS, MINING CLAIMS, PARCELS, ETC.	
UNSURVEYED LINES:	
LOT LINES	
PARCEL BOUNDARY	
MINING CLAIMS ETC.	
RAILWAY AND RIGHT OF WAY	
UTILITY LINES	
NON-PERENNIAL STREAM	
FLOODING OR FLOODING RIGHTS	
SUBDIVISION OR COMPOSITE PLAN	
RESERVATIONS	
ORIGINAL SHORELINE	
MARSH OR MUSKEG	
MINES	
TRAVERSE MONUMENT	

NOTICE OF FORESTRY ACTIVITY

THIS TOWNSHIP / AREA FALLS WITHIN THE IROQUOIS FALLS MANAGEMENT UNIT AND MAY BE SUBJECT TO FORESTRY OPERATIONS. THE MNR UNIT FORESTER FOR THIS AREA CAN BE CONTACTED AT: P.O. BOX 730, 2 THIRD AVE, COCHRANE, ONT. POL 1C0, 705-272-4365

SCALE: 1 INCH = 40 CHAINS

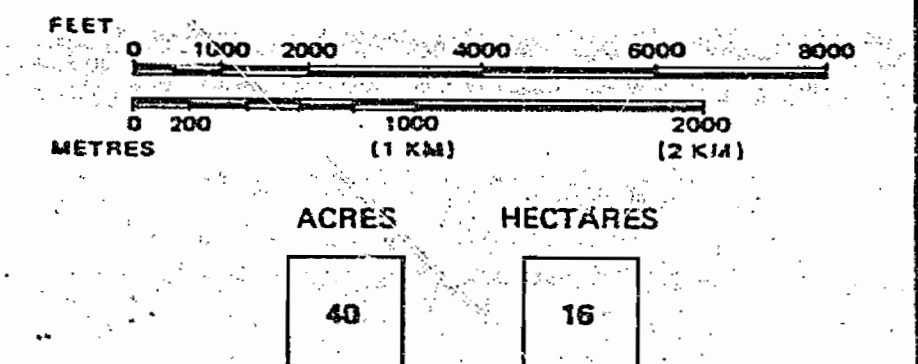

TOWNSHIP OF
TEEFY
DISTRICT OF
COCHRANE
MINING DIVISION
LARDER LAKE

Ontario Ministry of Natural Resources Ministry of Northern Development and Mines

Date: OCTOBER '86 Plan No.: G-3576

COPY OF THIS MYLAR ARCHIVED MAR.17/92 ARCHIVED NOV.08/95