

AREA OF

TREELINED LAKE

DISTRICT OF
KENORA

KENORA
MINING DIVISION

SCALE: 1-INCH = 40 CHAINS

LEGEND

PATENTED LAND	⊙
CROWN LAND SALE	CS
LEASES	⊖
LOCATED LAND	LO
LICENSE OF OCCUPATION	LO
MINING RIGHTS ONLY	MRO
SURFACE RIGHTS ONLY	SRO
ROADS	—
IMPROVED ROADS	—
KING'S HIGHWAYS	—
RAILWAYS	—
POWER LINES	—
MARSH OR MUSKEG	—
MINES	X
CANCELLED	C

NOTES

400' reserve around all lakes and rivers to Dept. of Lands & Forests.

Flooding reserve to H.E.P.C. to contour 1065' adjacent to Treelined Lake; to contour 1049' adjacent to Separation Lake & Sturgeon River.

Feb. 21/63

MAR 2 1965

APRIL 5, 1965

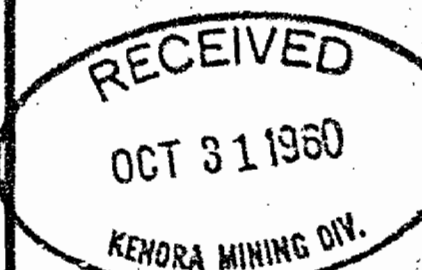

PLAN NO. M.2694

DEPARTMENT OF MINES
— ONTARIO —

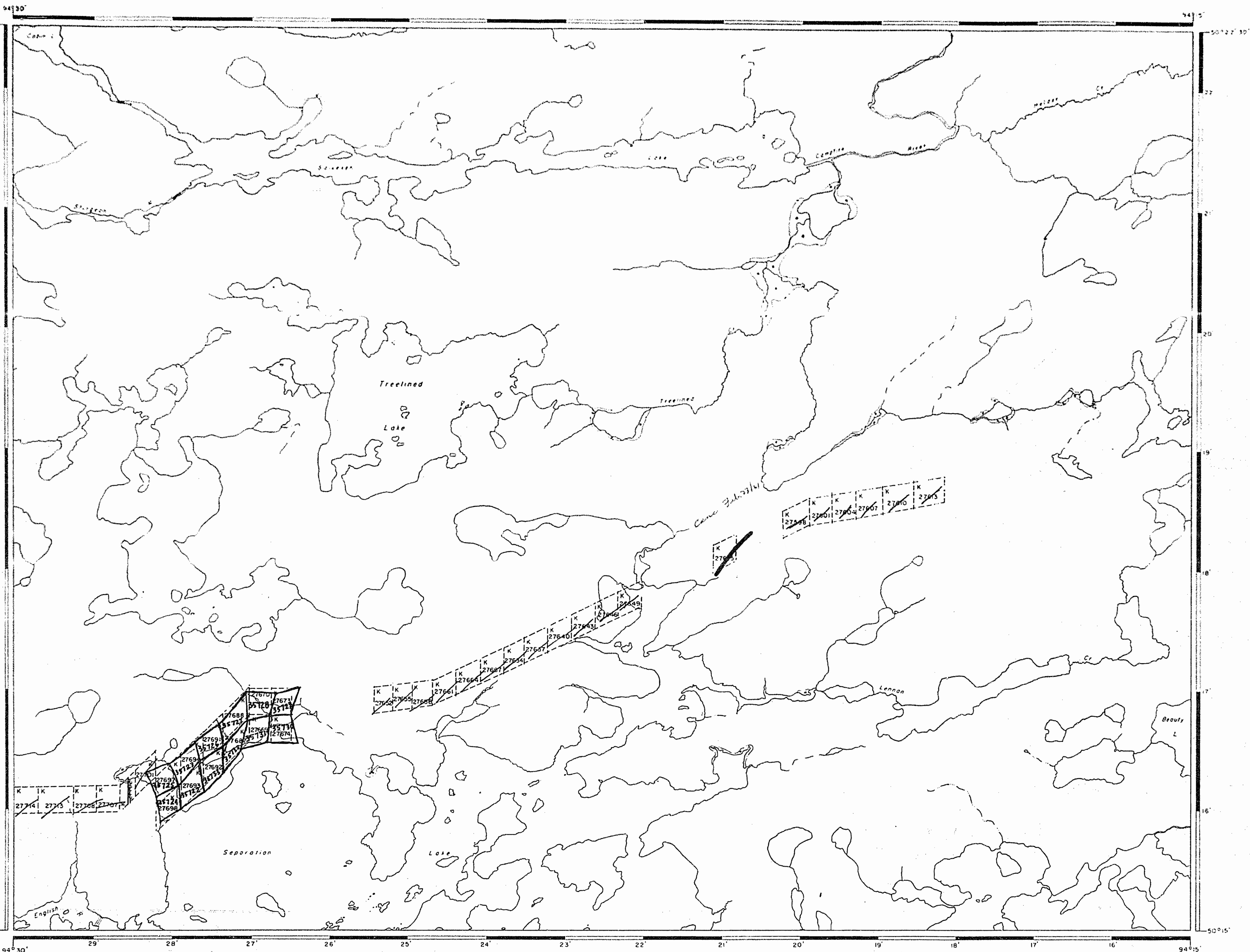

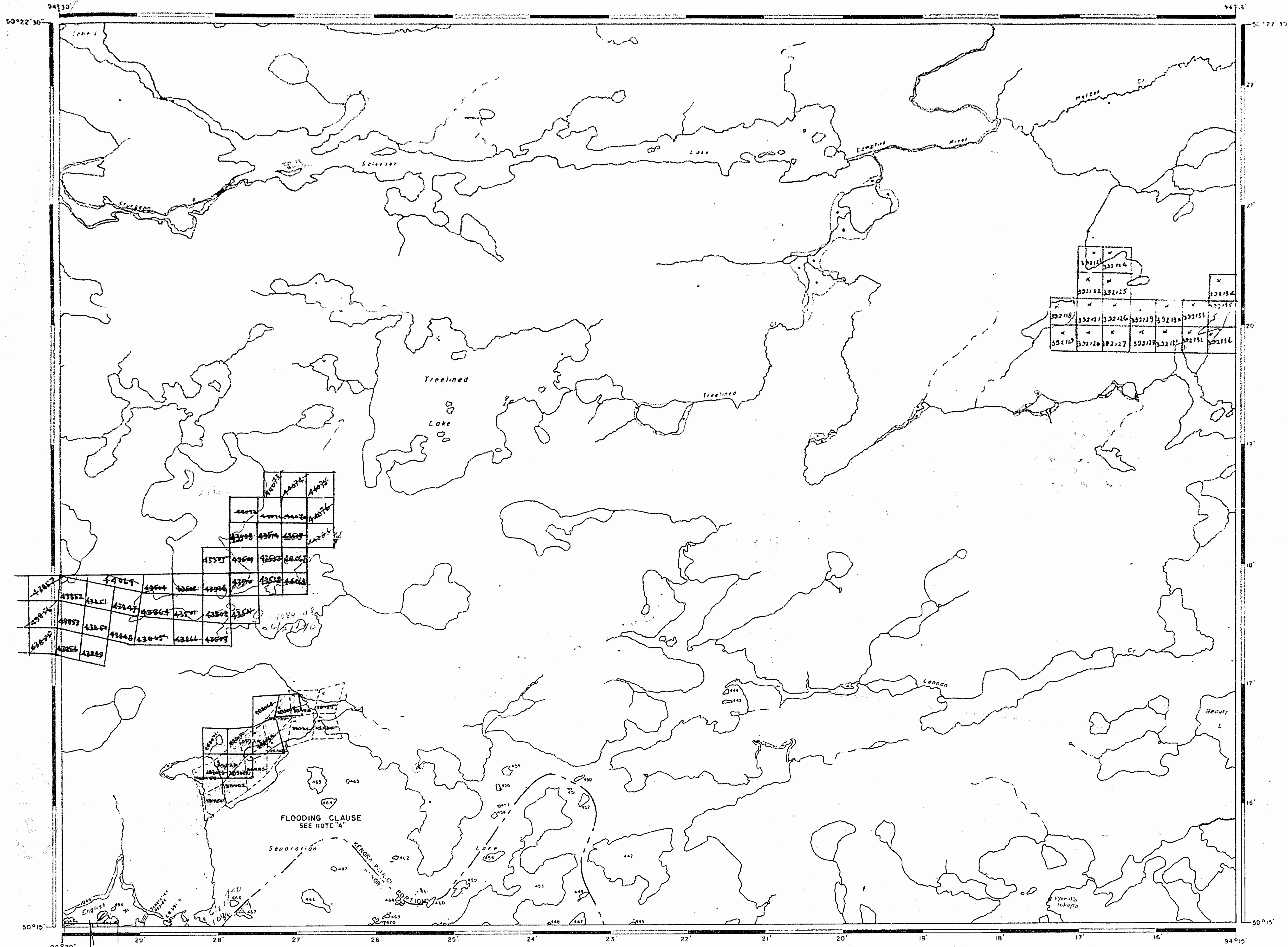

AREA OF
TREELINED LAKE

DISTRICT OF
KENORA, KENORA
(PATRICIA PORTION)

KENORA
MINING DIVISION

SCALE: 1-INCH = 40 CHAINS

LEGEND

- PATENTED LAND Ⓟ
- CROWN LAND SALE CS
- LEASES Ⓛ
- LOCATED LAND LoL
- LICENSE OF OCCUPATION LO
- MINING RIGHTS ONLY MRO
- SURFACE RIGHTS ONLY SRO
- ROADS —
- IMPROVED ROADS —
- KING'S HIGHWAYS —
- RAILWAYS —
- POWER LINES —
- MARSH OR MUSKEG —
- MINES X
- CANCELLED C

NOTES

400' reserve around all lakes and rivers to Dept. of Lands & Forests.

FLOODING NOTE "A"
Flooding rights on the English River from Maynar Falls to Separation Rapids to contour 5 feet above high water mark to Ont. H.E.P.C. 30 Nov. 1956. File: 34179, 69309.

Note "B"
Flooding rights on the English River from Separation Rapids to Caribou Falls to contour elevation 1049' G.S.C. to Ont. H.E.P.C. 30 Nov. 1956. File: 34179 Vol. 2. Page U2 27.

KENORA

FILED:
REC'D. APR 15 1965
RECEIPT No.
MINING DIVISION

May 10/66
Aug 3/68
Sept 20/68
Oct 7/68
Oct. 30
Dec. 17/69
Feb 24/70
Jan 5/74
July 29/74

PLAN NO. **M.2694**

DEPARTMENT OF MINES
— ONTARIO —

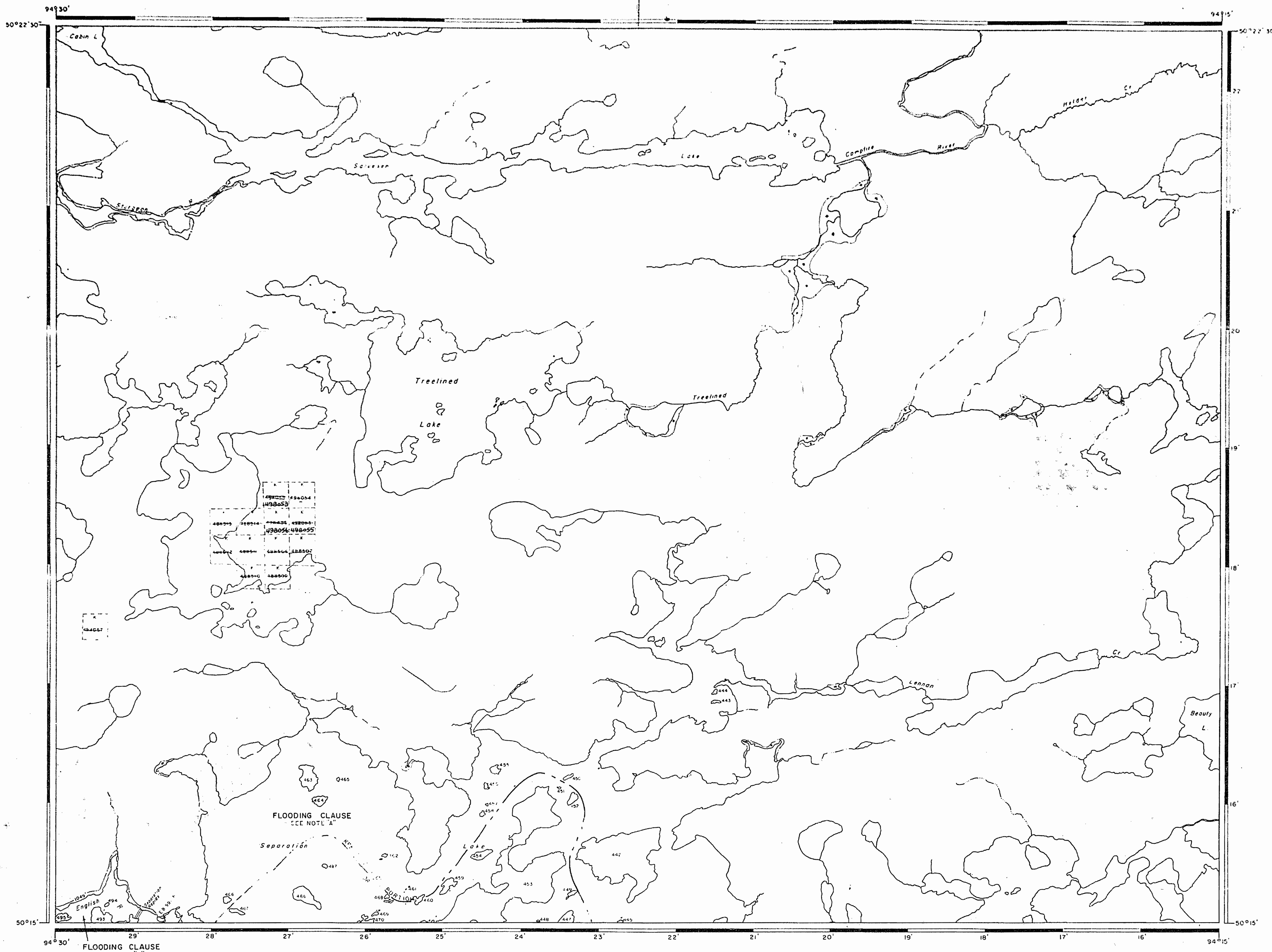

AREA OF
TREELINED LAKE

DISTRICT OF
KENORA, KENORA
(PATRICIA PORTION)

KENORA
MINING DIVISION

SCALE: 1-INCH = 40 CHAINS

LEGEND

PATENTED LAND	CS
CROWN LAND SALE	CS
LEASES	LC
LOCATED LAND	LO
LICENSE OF OCCUPATION	LO
MINING RIGHTS ONLY	MRO
SURFACE RIGHTS ONLY	SRO
ROADS	—
IMPROVED ROADS	—
KING'S HIGHWAYS	—
RAILWAYS	—
POWER LINES	—
MARSH OR MUSKEG	—
MINES	X
CANCELLED	C

NOTES

400' reserve around all lakes and rivers
to Dept. of Lands & Forests.

FLOODING
NOTE "A"
FLOODING RIGHTS on the English River from Maynar Falls to Separation Rapids to contain the high water mark to Ont. H.E.P.C. 30 Nov 1956 = 3479, 69309.

NOTE "B"
FLOODING RIGHTS on the English River from Sandaun Falls to Caribou Falls to contain the high water mark to Ont. H.E.P.C. 30 Nov 1956 = 479 Mc C. P. U. 2.

Obsolete May 11/84

DATE OF ISSUE
NOV 23 1977

SURVEYS AND MAPPING
BRANCH

KENORA
EUBANK
NOV 28 1977
2180-10112-123458

NATIONAL TOPOGRAPHIC SERIES 52 L

PLAN NO. **M.2694**

ONTARIO
MINISTRY OF NATURAL RESOURCES
SURVEYS AND MAPPING BRANCH.

Stop Lake Area - M.3006

M-2695

AREA OF
TREELINED LAKE

DISTRICT OF
KENORA, KENORA
(PATRICIA PORTION)

KENORA
MINING DIVISION

SCALE: 1-INCH = 40 CHAINS

LEGEND

- PATENTED LAND (P)
- CROWN LAND SALE (CS)
- LEASES (L)
- LOCATED LAND (LOC)
- LICENSE OF OCCUPATION (LO)
- MINING RIGHTS ONLY (MRO)
- SURFACE RIGHTS ONLY (SRO)
- ROADS
- IMPROVED ROADS
- KING'S HIGHWAYS
- RAILWAYS
- POWER LINES
- MARSH OR MUSKEG
- MINES
- CANCELLED (C)

NOTES

400' reserve around all lakes and rivers to Dept. of Lands & Forests.

FLOODING
NOTE "A"
Flooding rights on the English River from Maynar Falls to Separation Rapids to contour 400' high water mark to Ont. H.E.P.C. 30 Nov 1956 No. 3-179, 69309.

Note "B"
Flooding rights on the English River from Separation Rapids to Garbau Falls to contour 400' on 1049 U.S.C. to Ont. H.E.P.C. 30 Nov 1956 No. 4-79, 69309.

KENORA
RECEIVED
AUG 26 1974
7:8-9-10-11-12-13-14-15

DATE OF ISSUE
AUG 22 1974

Sept 16/74
Feb 14/74
Oct 24/77

NATIONAL TOPOGRAPHIC SERIES 52 L

PLAN NO. M.2694

ONTARIO
MINISTRY OF NATURAL RESOURCES
SURVEYS AND MAPPING BRANCH

503942

TREELINED LK M-2694

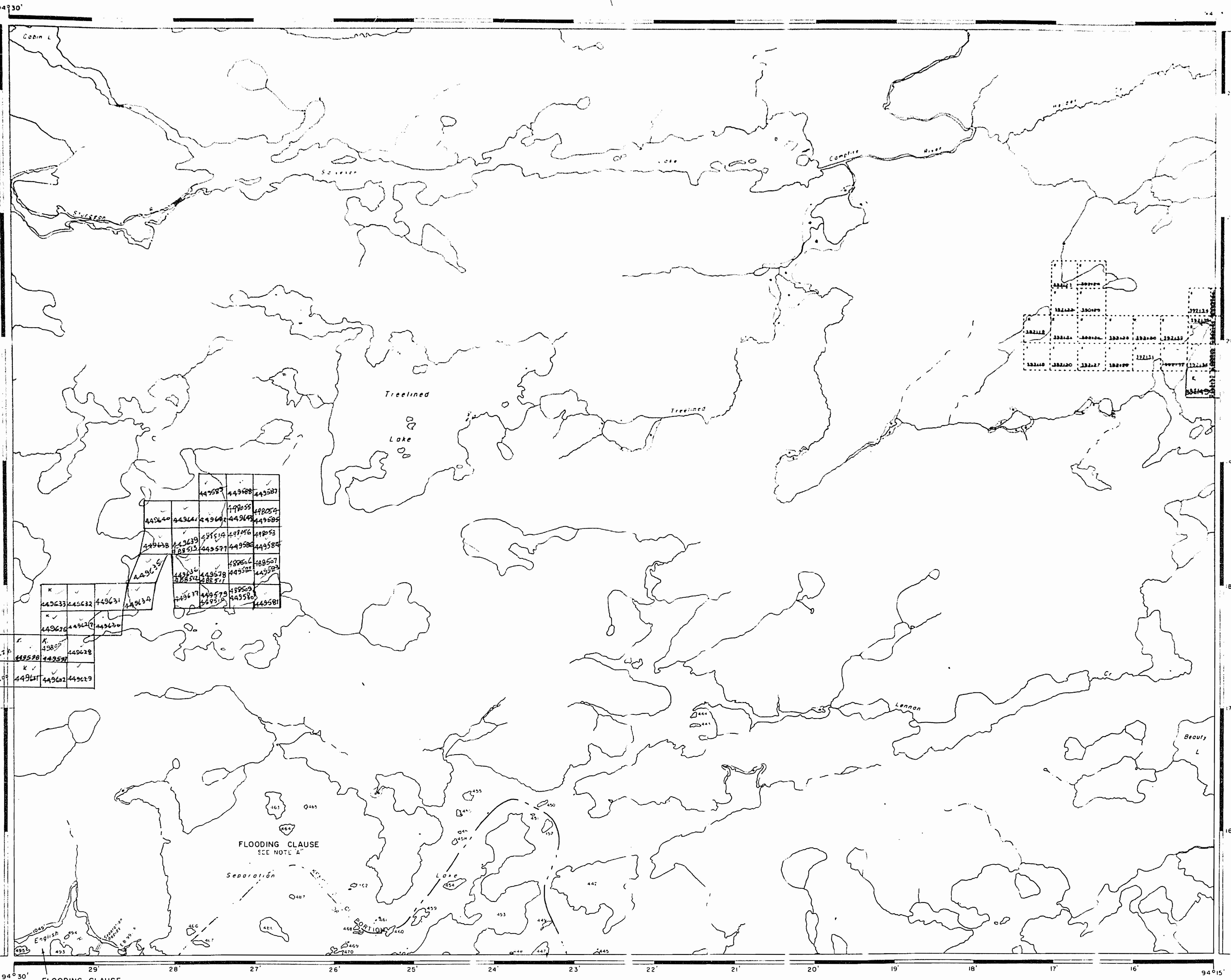

Stop Lake Area - M.3006

G-5021

TREE-LINED LAKE

G-5021

TRIM LINE

G-5021

TREE-LINED LAKE

G-5021

G1864 ROGER LAKE

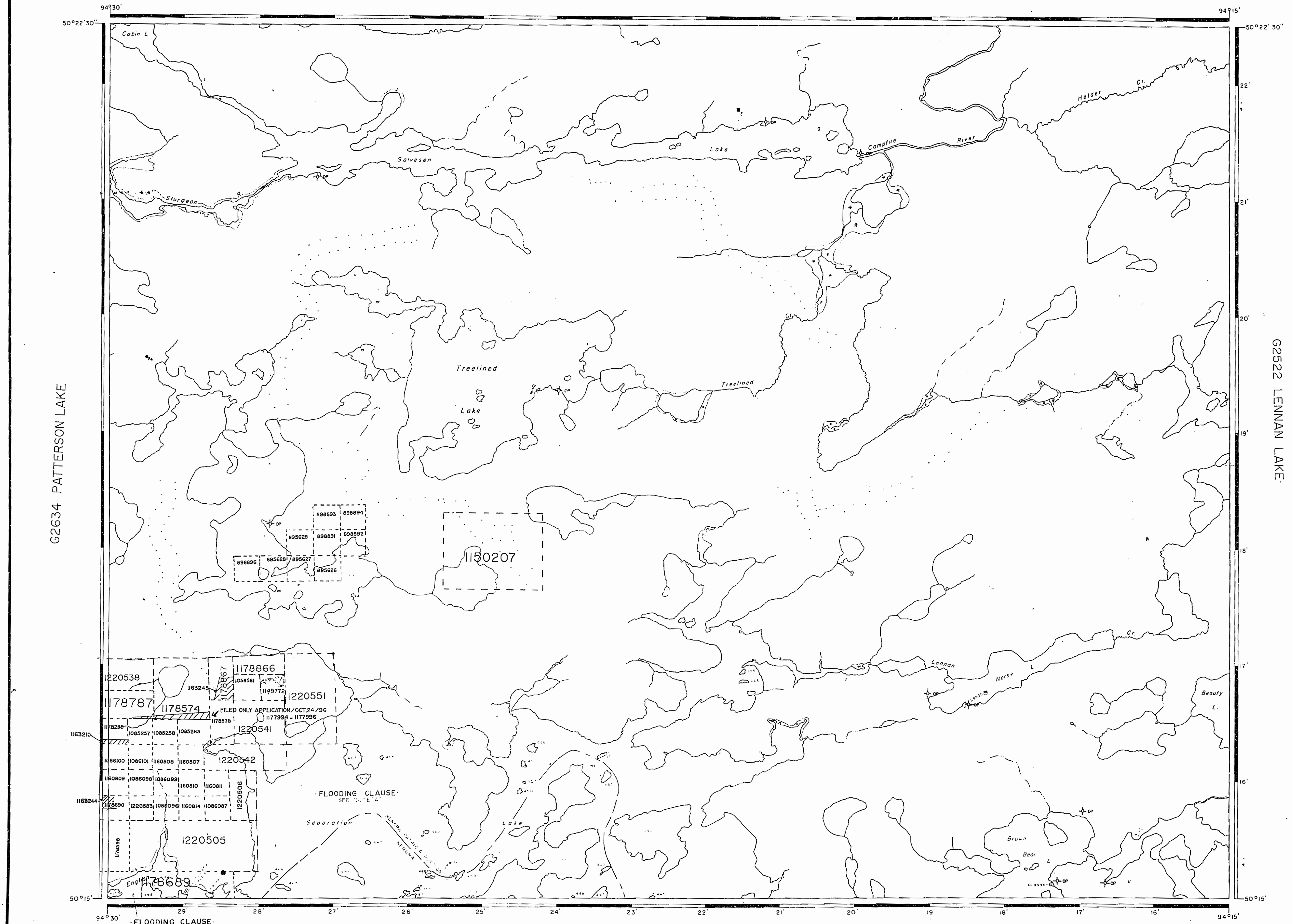

LEGEND

- HIGHWAY AND ROUTE No.
- OTHER ROADS
- TRAILS
- SURVEYED LINES:
 - TOWNSHIPS, BASE LINES, ETC.
 - LOTS, MINING CLAIMS, PARCELS, ETC.
- UNSURVEYED LINES:
 - LOT LINES
 - PARCEL BOUNDARY
 - MINING CLAIMS ETC.
- RAILWAY AND RIGHT OF WAY
- UTILITY LINES
- NON-PERENNIAL STREAM
- FLOODING OR FLOODING RIGHTS
- SUBDIVISION OR COMPOSITE PLAN
- RESERVATIONS
- ORIGINAL SHORELINE
- MARSH OR MUSKEG
- MINES
- TRAVERSE MONUMENT

DISPOSITION OF CROWN LANDS

TYPE OF DOCUMENT	SYMBOL
PATENT, SURFACE & MINING RIGHTS	
" SURFACE RIGHTS ONLY	
" MINING RIGHTS ONLY	
LEASE, SURFACE & MINING RIGHTS	
" SURFACE RIGHTS ONLY	
" MINING RIGHTS ONLY	
LICENCE OF OCCUPATION	
ORDER IN COUNCIL	
RESERVATION	
CANCELLED	
SAND & GRAVEL	

NOTE: MINING RIGHTS IN PARCELS PATENTED PRIOR TO MAY 6 1913, VESTED IN ORIGINAL PATENTEE BY THE PUBLIC LANDS ACT, R.S.O. 1910, CHAP. 380, SEC. 83, SUBSEC. 1.

REFERENCES

AREAS WITHDRAWN FROM DISPOSITION

Description	Order No.	Date	Disposition	File
M.R.O. - MINING RIGHTS ONLY				
S.R.O. - SURFACE RIGHTS ONLY				
M.+S. - MINING AND SURFACE RIGHTS				

FLOODING

RESERVE FLOODING RIGHTS AND LAND UNDER THE WATERS OF THE ENGLISH RIVER BETWEEN SEPARATION RAPIDS AND CARIBOU FALLS, INCLUDING THE STURGEON RIVER, BELOW CONTOUR ELEVATION 1049.0, G.S.C. DATUM, 1919, TO THE P.C. OF ONTARIO FOR THE DEVELOPMENT OF WATER POWER AT CARIBOU FALLS. FOR DETAIL OF CONTOUR, REFER TO PLAN No. U-2-27, dated 15th MARCH 1958, (H.E.P.C. PLAN No. 800-3359), W.P.L.A. No. 50, dated 21st DECEMBER 1959. File 34179

NOTE "A"

RESERVE FLOODING RIGHTS ON THE ENGLISH RIVER FROM THE UPPER END OF SEPARATION RAPIDS TO THE FOOT OF MAYNARD FALLS, INCLUDING SEPARATION LAKE, BEAUTY LAKE, AND LENNAN CREEK, TO A CONTOUR 5' ABOVE THE HIGH WATER MAP. File 34179, 65307. RESERVATION REQUESTED 30th NOVEMBER 1959.

SCALE: 1 INCH = 40 CHAINS

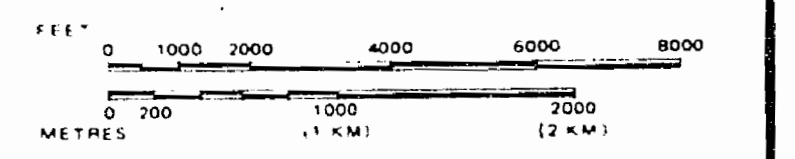

AREA TREE-LINED LAKE

M.N.R. ADMINISTRATIVE DISTRICT
 KENORA
 MINING DIVISION
 KENORA
 LAND TITLES / REGISTRY DIVISION
 KENORA / KENORA (PATRICIA PORTION)

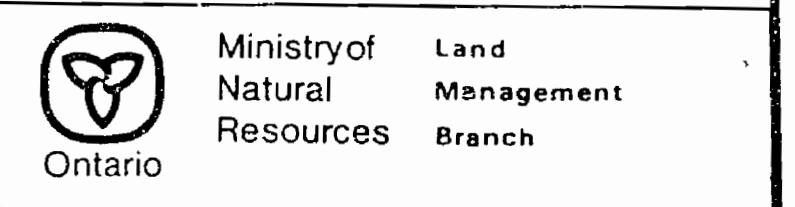

Date: FEBRUARY, 1984
 Number: M-2694 G-2651

LEGEND

TOURIST CAMPS OR OUTPOST

UPDATES

DATE OF ISSUE

MAR 03 1998
 PROVINCIAL RECORDING OFFICE - SUDBURY

DATE PUT IN SERVICE

JUL 19 1996
 KENORA MINING DIVISION

THE INFORMATION THAT APPEARS ON THIS MAP HAS BEEN COMPILED FROM VARIOUS SOURCES, AND ACCURACY IS NOT GUARANTEED. THOSE WISHING TO STAKE MINING CLAIMS SHOULD CONSULT WITH THE MINING RECORDER, MINISTRY OF NORTHERN DEVELOPMENT AND MINES, FOR ADDITIONAL INFORMATION ON THE STATUS OF THE LANDS SHOWN HEREON.

G2634 PATTERSON LAKE

G2522 LENNAN LAKE

STOP LAKE AREA G-2523

503942

TRIM LINE

G1864 ROGER LAKE

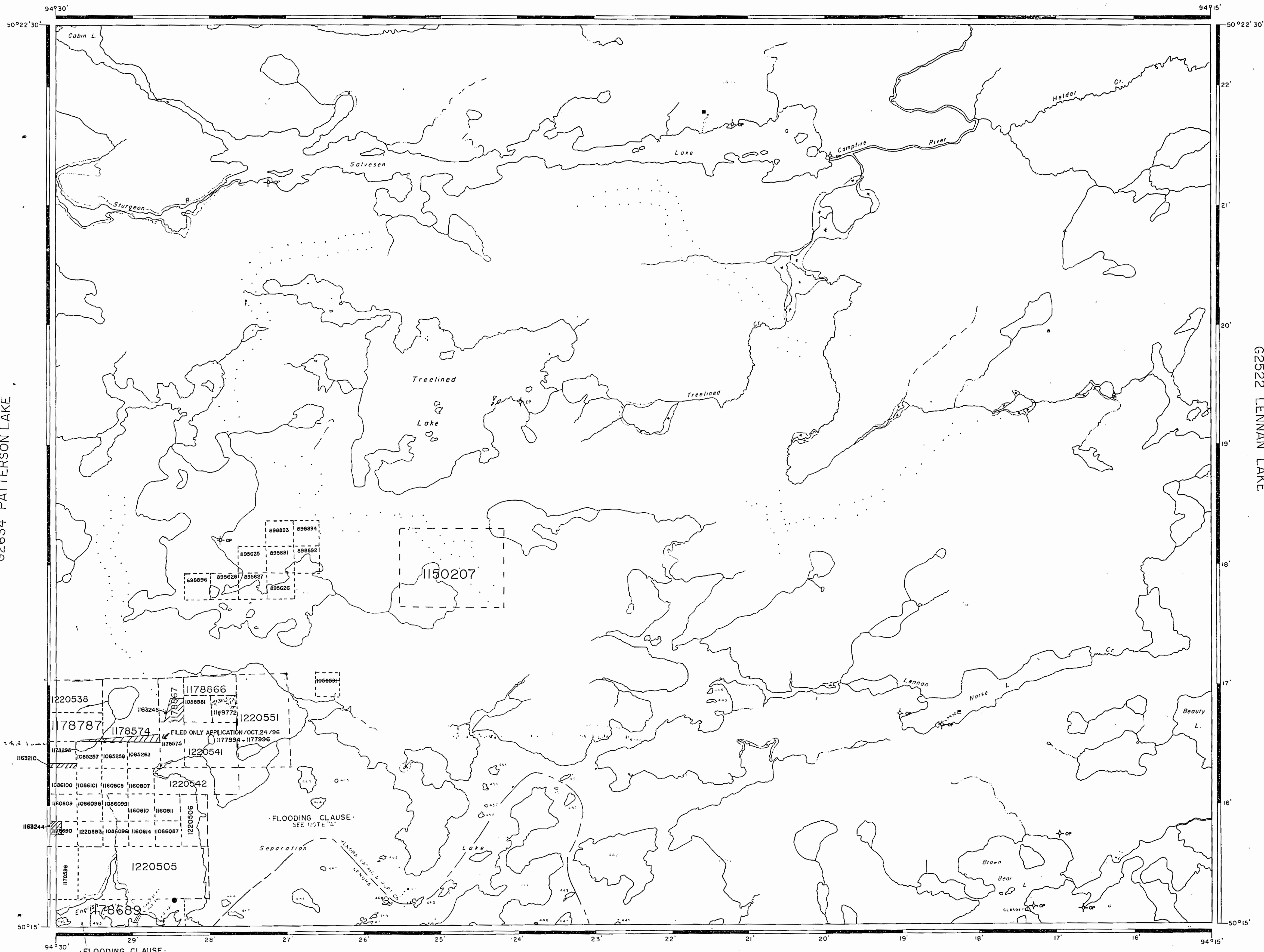

LEGEND

HIGHWAY AND ROUTE No	
OTHER ROADS	
TRAILS	
SURVEYED LINES	
TOWNSHIPS, BASE LINES, ETC	
LOTS, MINING CLAIMS, PARCELS, ETC	
UNSURVEYED LINES	
LOT LINES	
PARCEL BOUNDARY	
MINING CLAIMS ETC	
RAILWAY AND RIGHT OF WAY	
UTILITY LINES	
NON-PERENNIAL STREAM	
FLOODING OR FLOODING RIGHTS	
SUBDIVISION OR COMPOSITE PLAN	
RESERVATIONS	
ORIGINAL SHORELINE	
MARSH OR MUSKEG	
MINES	
TRAVERSE MONUMENT	

DISPOSITION OF CROWN LANDS

TYPE OF DOCUMENT	SYMBOL
PATENT, SURFACE & MINING RIGHTS	
" SURFACE RIGHTS ONLY	
" MINING RIGHTS ONLY	
LEASE, SURFACE & MINING RIGHTS	
" SURFACE RIGHTS ONLY	
" MINING RIGHTS ONLY	
LICENCE OF OCCUPATION	
ORDER-IN-COUNCIL	
RESERVATION	
CANCELLED	
SAND & GRAVEL	

NOTE: MINING RIGHTS IN PARCELS PATENTED PRIOR TO MAY 6 1912, VESTED IN ORIGINAL PATENTEES BY THE PUBLIC LANDS ACT, R.S.O. 1970, CHAP. 380, SEC. 63, SUBSEC. 1

REFERENCES

AREAS WITHDRAWN FROM DISPOSITION

Description	Order No.	Date	Disposition	File
M.R.O. - MINING RIGHTS ONLY				
S.R.O. - SURFACE RIGHTS ONLY				
M.+S. - MINING AND SURFACE RIGHTS				

FLOODING

RESERVE FLOODING RIGHTS AND LAND UNDER THE WATERS OF THE ENGLISH RIVER BETWEEN SEPARATION RAPIDS AND CARIBOU FALLS, INCLUDING THE STURGEON RIVER, BELOW CONTOUR ELEVATION 1049.0, G.S.C. DATUM, 1919, TO H.E.P.C. OF ONTARIO FOR THE DEVELOPMENT OF WATER POWER AT CARIBOU FALLS. FOR DETAIL OF CONTOUR, REFER TO PLAN No U-2-27, dated 15th MARCH 1958, (H.E.P.C. PLAN No.800-3359). W.P.L.A. No.50, dated 21st DECEMBER 1959 File 34179

NOTE "A"

RESERVE FLOODING RIGHTS ON THE ENGLISH RIVER FROM THE UPPER END OF SEPARATION RAPIDS TO THE FOOT OF MAYNARD FALLS, INCLUDING SEPARATION LAKE, BEAUTY LAKE, AND LENNAN CREEK, TO A CONTOUR 5' ABOVE THE HIGH WATER MARK. Files 34179, 63507. RESERVATION REQUESTED 30th NOVEMBER 1959.

SCALE: 1 INCH = 40 CHAINS

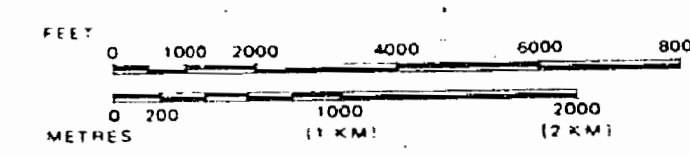

AREA TREELINED LAKE

M.N.R. ADMINISTRATIVE DISTRICT
KENORA
MINING DIVISION
KENORA
LAND TITLES / REGISTRY DIVISION
KENORA/KENORA (PATRICIA PORTION)

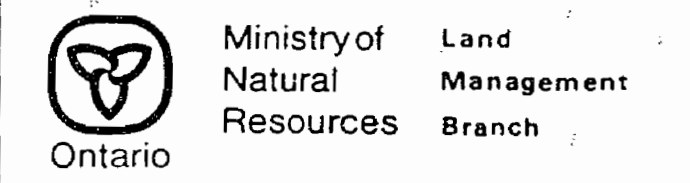

Date: FEBRUARY, 1984
Number: M-2694 G-2651

LEGEND

TOURIST CAMP OR (OUTPOST)

DATE OF ISSUE

FEB 12 1990

PROVINCIAL RECORDS OFFICE - SUDBURY

UPDATES

DATE PUT IN SERVICE

JUL 19 1996

KENORA MINING DIVISION

THE INFORMATION THAT APPEARS ON THIS MAP HAS BEEN COMPILED FROM VARIOUS SOURCES, AND ACCURACY IS NOT GUARANTEED. THOSE WISHING TO STAKE MINING CLAIMS SHOULD CONSULT WITH THE MINING RECORDER, MINISTRY OF NORTHERN DEVELOPMENT AND MINES, FOR ADDITIONAL INFORMATION ON THE STATUS OF THE LANDS SHOWN HEREON.

STOP LAKE AREA G-2523

503942

2694

M-2195

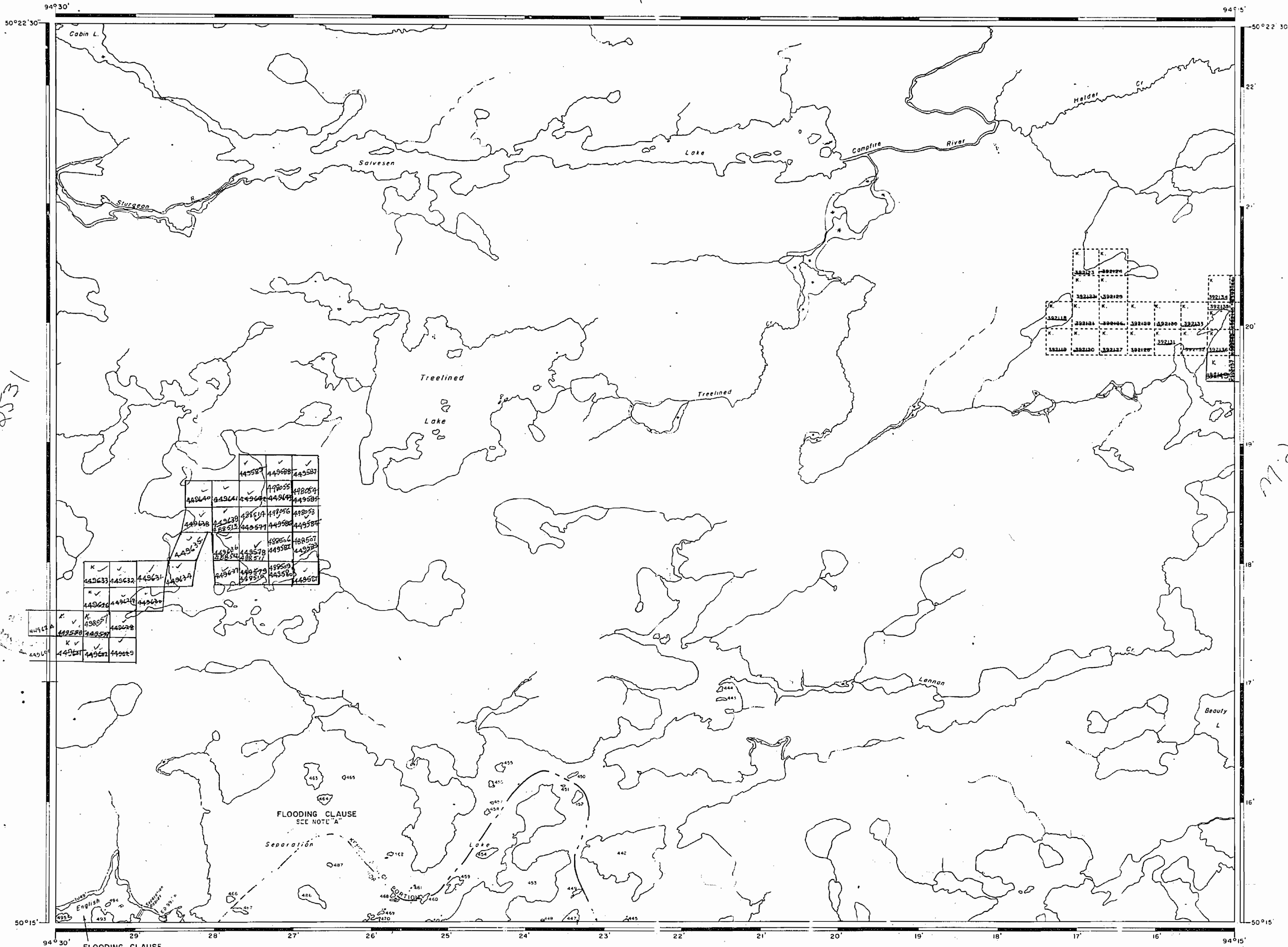

AREA OF
TREELINED LAKE

DISTRICT OF
KENORA (PATRICIA PORTION)

KENORA
MINING DIVISION

SCALE: 1-INCH = 40 CHAINS

LEGEND

- PATENTED LAND Ⓟ
- CROWN LAND SALE CS
- LEASES Ⓛ
- LOCATED LAND Loc
- LICENSE OF OCCUPATION L.O.
- MINING RIGHTS ONLY M.R.O.
- SURFACE RIGHTS ONLY S.R.O.
- ROADS —
- IMPROVED ROADS —
- KING'S HIGHWAYS —
- RAILWAYS —
- POWER LINES —
- MARSH OR MUSKEG —
- MINES *
- CANCELLED C

NOTES

400' reserve around all lakes and rivers to Dept. of Lands & Forests.

FLOODING NOTE "A"
Flooding rights on the English River from Maynard Falls to Separation Rapids to contour 5' to high water mark to Ont. H.E.P.C. 30 Nov 1956. File 3-179, 69309.

Note "B"
Flooding rights on the English River from Separation Rapids to Garbois Falls to contour 5' to 1049' G.S.C. to Ont. H.E.P.C. 30 Nov 1956. File 4-79, 69309.

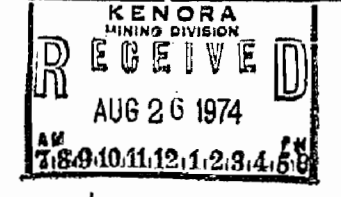

Sept. 16/74
Oct. 4/77
Oct. 24/77

NATIONAL TOPOGRAPHIC SERIES 52 L

PLAN NO. **M.2694**

MINISTRY OF NATURAL RESOURCES

SURVEYS AND MAPPING BRANCH

Stop Lake Area - M.3006

5C3942

TREELINED LK M-2694

2694

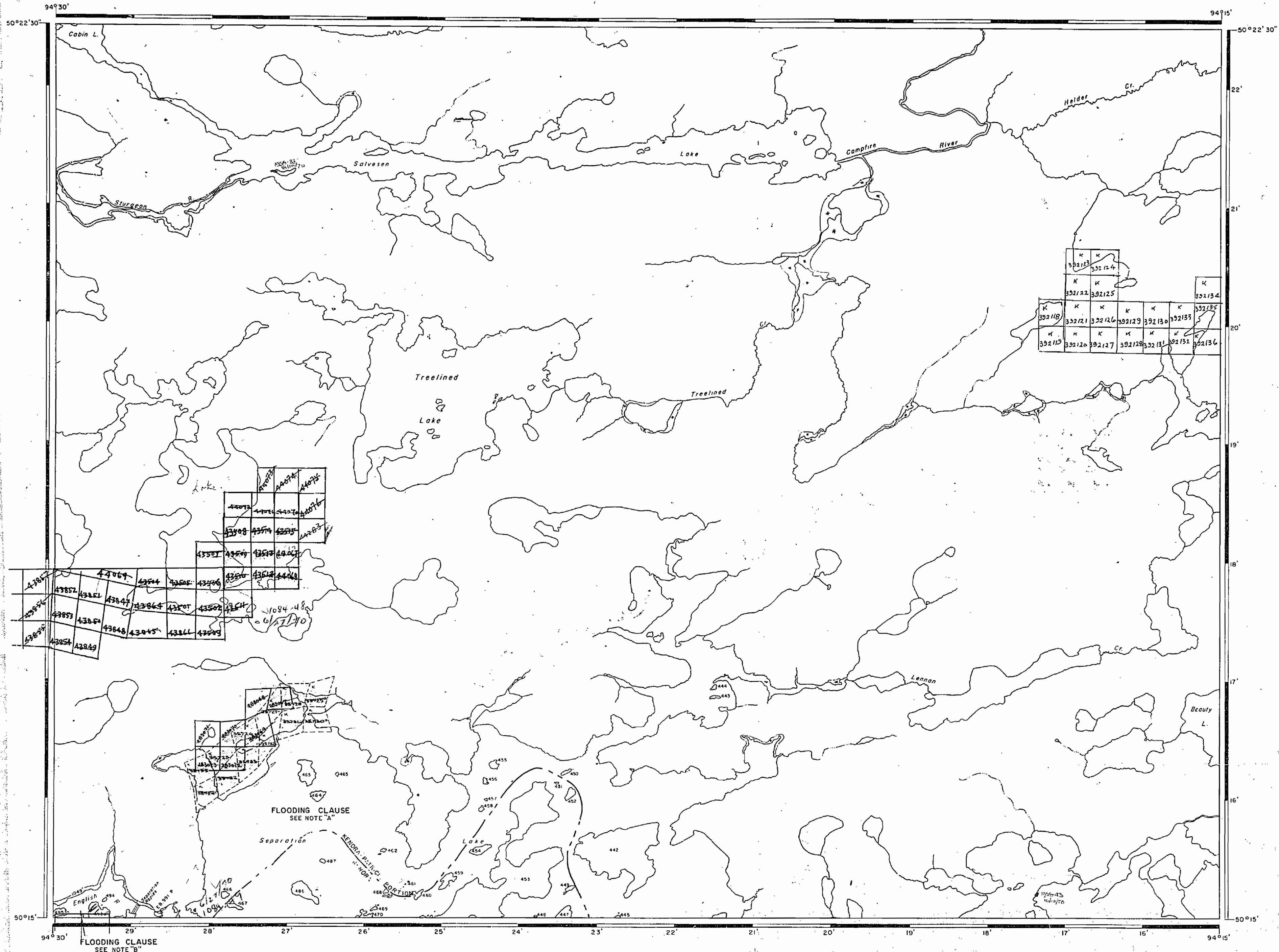

AREA OF
TREELINED LAKE

DISTRICT OF
KENORA, KENORA
(PATRICIA PORTION)

KENORA
MINING DIVISION

SCALE: 1-INCH = 40 CHAINS

LEGEND

PATENTED LAND	⊙
CROWN LAND SALE	⊙
LEASES	⊙
LOCATED LAND	⊙
LICENSE OF OCCUPATION	⊙
MINING RIGHTS ONLY	M.R.O.
SURFACE RIGHTS ONLY	S.R.O.
ROADS	—
IMPROVED ROADS	—
KING'S HIGHWAYS	—
RAILWAYS	—
POWER LINES	—
MARSH OR MUSKEG	—
MINES	*
CANCELLED	C.

NOTES

400' reserve around all lakes and rivers to Dept. of Lands & Forests.

FLOODING NOTE "A"
Flooding rights on the English River from Maynor Falls to Separation Rapids to contour 5' above high water mark to Ont. H.E.P.C. 30 Nov. 1956. File: 34179, 69309.

Note "B"
Flooding rights on the English River from Separation Rapids to Caribou Falls to contour elevation 1049 G.S.C. to Ont. H.E.P.C. 30 Nov. 1956. File: 34179 Vol. 2. Plan. U2-27.

KENORA
FILED:
REC'D. APR 15 1965
RECEIPT No.
MINING DIVISION

May 10/66
Aug 30/68
Sept 20/68
Oct 7/68
Oct. 30
Dec. 17/69
Feb 24/72
Jan 5/74
Friday 29/74

PLAN NO. **M.2694**

DEPARTMENT OF MINES
— ONTARIO —

1988 (Steel Lake)

67M 66M 65M 64M 63M 62M 61M 60M 59M

Land withdrawn from staking & reserved for Power Site, L. & F. file 69307- marked thus: [diagonal hatching symbol]

Mining
Indian
Dumpy
Treelin
Record

SALVERSON

LAKE

TREELINED LAKE
TERRAINED LAKE HAD BEEN AFFECTED BY FLOODING BY W.P.C. RESERVE FLOODING RIGHTS TO CONTOUR ELEVATION 1065 FOR R.E.P.C. FILE 1065

M. Okechuk

27499	27500	27501	27502	27503	27504	27505	27506	27507	27508	27509	27510
27511	27512	27513	27514	27515	27516	27517	27518	27519	27520	27521	27522
27523	27524	27525	27526	27527	27528	27529	27530	27531	27532	27533	27534
27535	27536	27537	27538	27539	27540	27541	27542	27543	27544	27545	27546

J. Hawes

27547	27548	27549	27550	27551	27552	27553	27554	27555	27556	27557	27558
27559	27560	27561	27562	27563	27564	27565	27566	27567	27568	27569	27570
27571	27572	27573	27574	27575	27576	27577	27578	27579	27580	27581	27582
27583	27584	27585	27586	27587	27588	27589	27590	27591	27592	27593	27594
27595	27596	27597	27598	27599	27600	27601	27602	27603	27604	27605	27606
27607	27608	27609	27610	27611	27612	27613	27614	27615	27616	27617	27618

Layne R. Shoullice

Geo. Bunn

J. Donnelly

J. Hutchuk

2694

SEPARATION

SEPARATION LAKE
RESERVE FLOODING RIGHTS TO CONTOUR ELEVATION 1065 FOR R.E.P.C. FILE 69307

LAKE

28115	28116	28117	28118	28119	28120	28121
28122	28123	28124	28125	28126	28127	28128
28129	28130	28131	28132	28133	28134	28135
28136	28137	28138	28139	28140	28141	28142

SEPARATION LAKE
RESERVE FLOODING RIGHTS TO CONTOUR

BIG I

2694

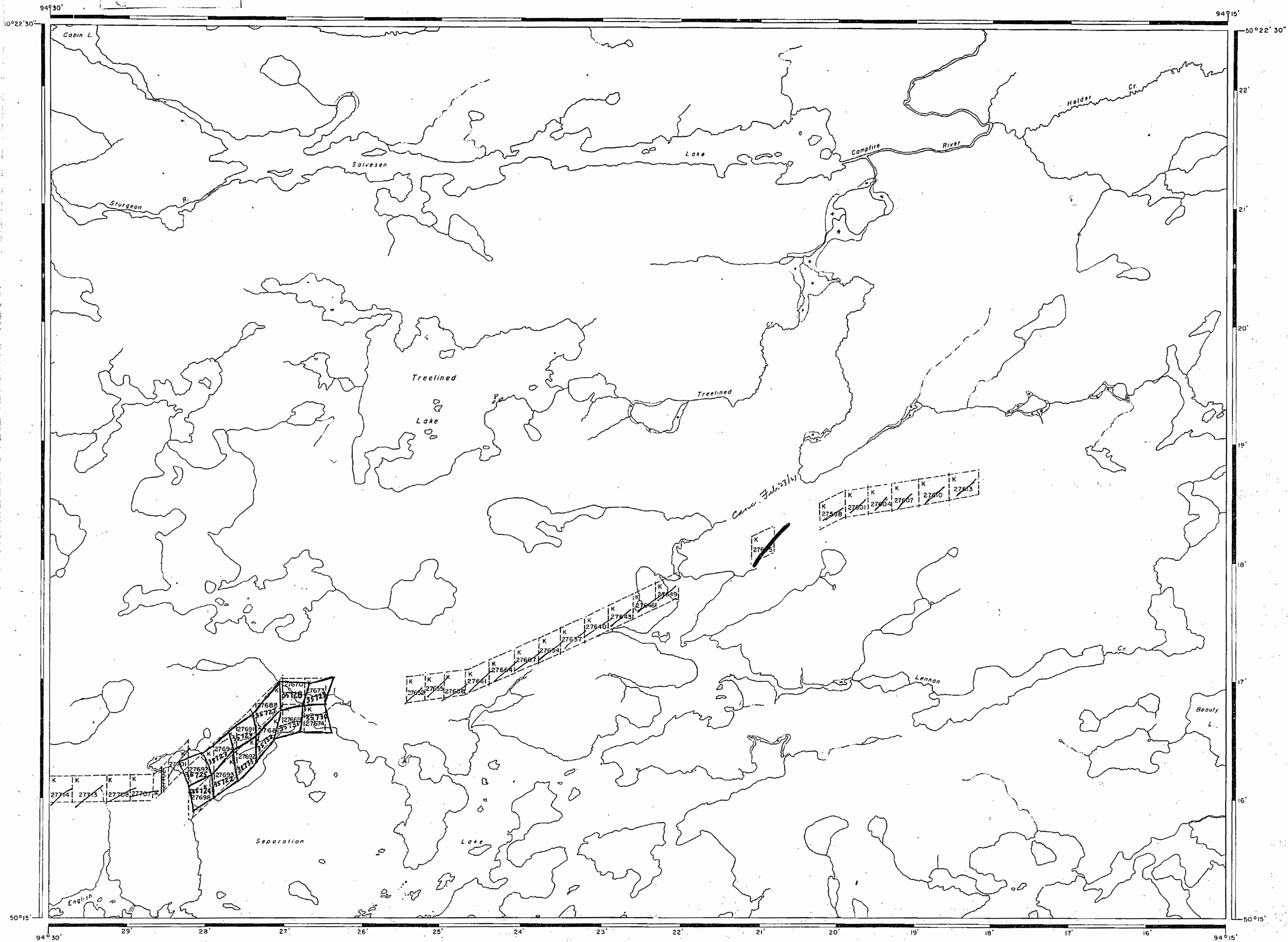

AREA OF
TREELINED LAKE

DISTRICT OF
KENORA

KENORA
MINING DIVISION

SCALE: 1-INCH = 40 CHAINS

LEGEND

PATENTED LAND	Ⓟ
CROWN LAND SALE	C.S.
LEASES	Ⓢ
LOCATED LAND	Loc.
LICENSE OF OCCUPATION	L.O.
MINING RIGHTS ONLY	M.R.O.
SURFACE RIGHTS ONLY	S.R.O.
ROADS	—
IMPROVED ROADS	—
KING'S HIGHWAYS	—
RAILWAYS	—
POWER LINES	—
MARSH OR MUSKEG	—
MINES	Ⓧ
CANCELLED	C.

NOTES

400' reserve around all lakes and rivers
to Dept. of Lands & Forests.

Flooding reserve to H.E.P.C. to contour
1065' adjacent to Treelined Lake; to con-
tour 1049' adjacent to Separation Lake &
Sturgeon River.

Feb. 21/63
MAR 2 1965
APRIL 5, 1945

RECEIVED
OCT 31 1960
KENORA MINING DIV.

PLAN NO. M. 2694

DEPARTMENT OF MINES
— ONTARIO —

1988 (Steel Lake)

67M 66M 65M 64M 63M 62M 61M 60M 59M

Land withdrawn from staking & reserved for Power Site, L. & F. file 69307- marked thus: [Symbol]

Mining Indian Dumpy Treeline Record

SALVERSON LAKE

TREELINED LAKE
TREELINED LAKE AFFECTED BY FLOODING BY WATER RESERVE FLOODING RIGHTS TO CONTOUR ELEVATION 1065

27579	27580	27581	27582	27583	27584	27585	27586	27587	27588	27589	27590
1	2	3	4	5	6	7	8	9	10	11	12
27600	27601	27602	27603	27604	27605	27606	27607	27608	27609	27610	27611
13	14	15	16	17	18	19	20	21	22	23	24

Geo. Bunn

Lorne R. Shoultice

J. Donnelly

J. Hawes

M. Ostrak

J. Hatchuk

2694

SEPARATION LAKE

SEPARATION LAKE
RESERVE FLOODING RIGHTS TO CONTOUR ELEVATION 1065 FOR H.E.P.C. FILE 49307

LAKE

28110	28111	28112	28113	28114	28115	28116	28117	28118	28119	28120	28121
1	2	3	4	5	6	7	8	9	10	11	12
28122	28123	28124	28125	28126	28127	28128	28129	28130	28131	28132	28133
13	14	15	16	17	18	19	20	21	22	23	24

LAKE
RESERVE FLOODING RIGHTS TO CONTOUR

BIG I

G1864 ROGER LAKE

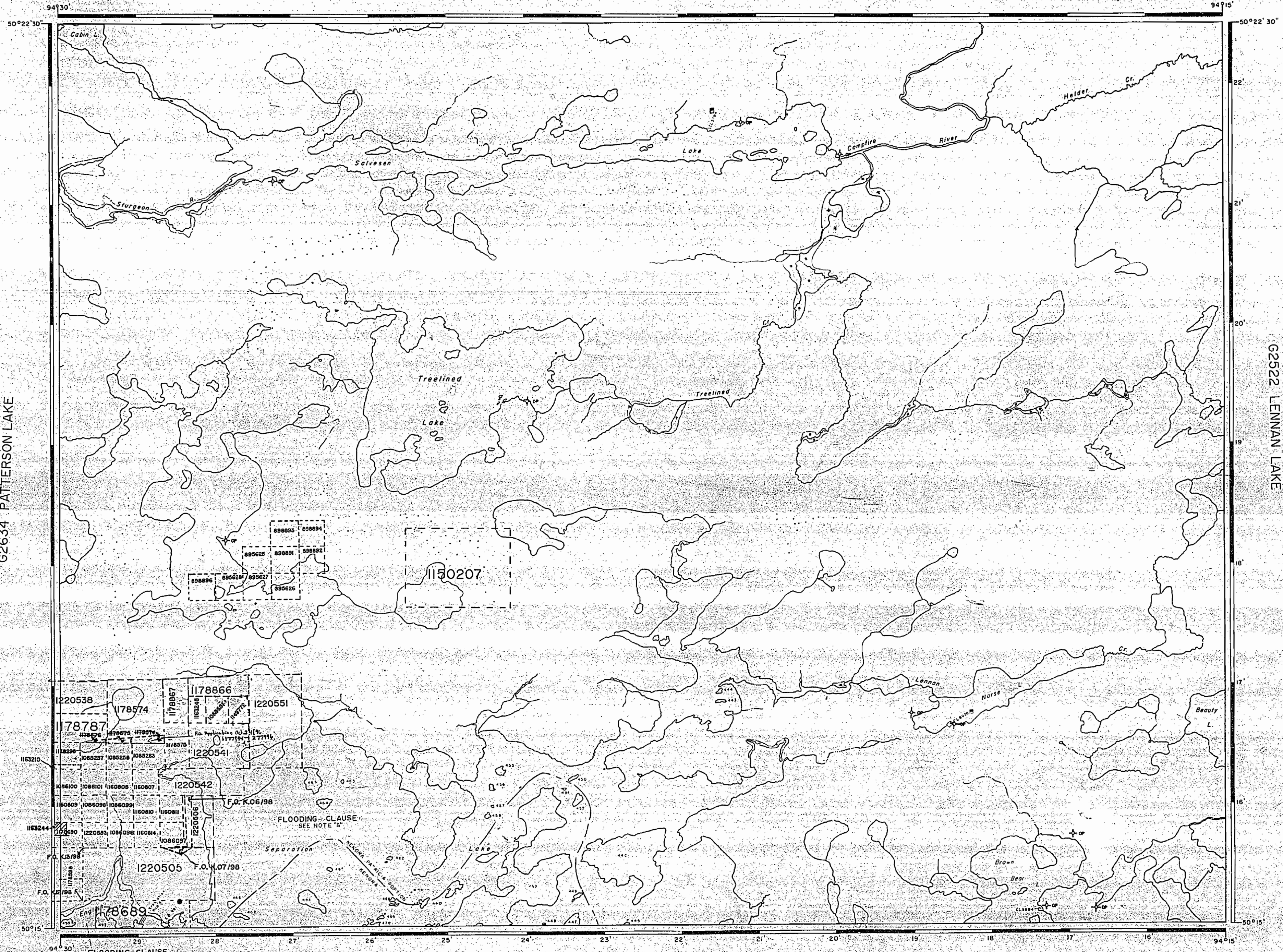

LEGEND

HIGHWAY AND ROUTE No	
OTHER ROADS	
TRAILS	
SURVEYED LINES:	
TOWNSHIPS, BASE LINES, ETC.	
LOTS, MINING CLAIMS, PARCELS, ETC.	
UNSURVEYED LINES	
LOT LINES	
PARCEL BOUNDARY	
MINING CLAIMS ETC.	
RAILWAY AND RIGHT OF WAY	
UTILITY LINES	
NON-PERENNIAL STREAM	
FLOODING OR FLOODING RIGHTS	
SUBDIVISION OR COMPOSITE PLAN	
RESERVATIONS	
ORIGINAL SHORELINE	
MARSH OR MUSKEG	
MINES	
TRAVERSE MONUMENT	

DISPOSITION OF CROWN LANDS

TYPE OF DOCUMENT	SYMBOL
PATENT, SURFACE & MINING RIGHTS	
SURFACE RIGHTS ONLY	
MINING RIGHTS ONLY	
LEASE, SURFACE & MINING RIGHTS	
SURFACE RIGHTS ONLY	
MINING RIGHTS ONLY	
LICENCE OF OCCUPATION	
ORDER-IN-COUNCIL	
RESERVATION	
CANCELLED	
SAND & GRAVEL	

NOTE: MINING RIGHTS IN PARCELS PATENTED PRIOR TO MAY 1 1972 VESTED IN ORIGINAL PATENTEES BY THE PUBLIC LANDS ACT, R.S.O. 1970, CHAP. 380, SEC. 63 SUBSEC. 1

REFERENCES

AREAS WITHDRAWN FROM DISPOSITION

M.R.O. - MINING RIGHTS ONLY
 S.R.O. - SURFACE RIGHTS ONLY
 M.+S. - MINING AND SURFACE RIGHTS

Description	Order No.	Date	Disposition	File

FLOODING

RESERVE FLOODING RIGHTS AND LAND UNDER THE WATERS OF THE ENGLISH RIVER BETWEEN SEPARATION RAPIDS AND CARIBOU FALLS, INCLUDING THE STURGEON RIVER, BELOW CONTOUR ELEVATION 1049.0, G.S.C. DATUM, 1919 TO H.E.P.C. OF ONTARIO FOR THE DEVELOPMENT OF WATER POWER AT CARIBOU FALLS.

FOR DETAIL OF CONTOUR, REFER TO PLAN No U-2-27, dated 15th MARCH 1958, (H.E.P.C. PLAN No. 800-3359).

W.P.L.A. No. 50, dated 2nd DECEMBER, 1959. File 34179

NOTE "A"

RESERVE FLOODING RIGHTS ON THE ENGLISH RIVER FROM THE UPPER END OF SEPARATION RAPIDS TO THE FOOT OF MAYNARD FALLS, INCLUDING SEPARATION LAKE, BEAUTY LAKE, AND LENNAN CREEK, TO A CONTOUR 5' ABOVE THE HIGH WATER MARK.

Files 34179, 69307, RESERVATION REQUESTED, 30th NOVEMBER 1959.

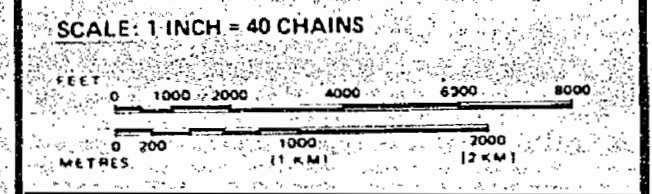

AREA TREELINED LAKE

M.N.R. ADMINISTRATIVE DISTRICT
KENORA
 MINING DIVISION
KENORA
 LAND TITLES / REGISTRY DIVISION
KENORA/KENORA (PATRICIA PORTION)

	Ministry of Natural Resources	Land Management Branch
Date:	FEBRUARY, 1984	Number:
M-2694		G-2651

LEGEND

TOURIST CAMP (OF OUTPOST)

UPDATES

DATE PUT IN SERVICE
JUL 19 1996
 KENORA
 MINING DIVISION

THE INFORMATION THAT APPEARS ON THIS MAP HAS BEEN COMPILED FROM VARIOUS SOURCES AND ACCURACY IS NOT GUARANTEED. THOSE WISHING TO STAKE MINING CLAIMS SHOULD CONSULT WITH THE MINING RECORDER, MINISTRY OF NORTHERN DEVELOPMENT AND MINES, FOR ADDITIONAL INFORMATION ON THE STATUS OF THE LANDS SHOWN HEREON.

STOP LAKE AREA G-2523

503942

1988 (Treeline Lake)

67M 66M 65M 64M 63M 62M 61M 60M 59M

Land withdrawn from staking & reserved for Power Site, L. & F. file 69307- marked thus: Mining Indian Dumping Treeline Record

SALVERSON LAKE

TREELINED LAKE
RESERVE FLOODING RIGHTS TO CONTOUR ELEVATION 1065 FOR H.E.P.C. FILE 19307

27579	27580	27581	27582	27583	27584	27585	27586	27587	27588	27589	27590	27591	27592	27593	27594	27595	27596	27597	27598	27599
27600	27601	27602	27603	27604	27605	27606	27607	27608	27609	27610	27611	27612	27613	27614	27615	27616	27617	27618	27619	27620
27621	27622	27623	27624	27625	27626	27627	27628	27629	27630	27631	27632	27633	27634	27635	27636	27637	27638	27639	27640	27641
27642	27643	27644	27645	27646	27647	27648	27649	27650	27651	27652	27653	27654	27655	27656	27657	27658	27659	27660	27661	27662
27663	27664	27665	27666	27667	27668	27669	27670	27671	27672	27673	27674	27675	27676	27677	27678	27679	27680	27681	27682	27683
27684	27685	27686	27687	27688	27689	27690	27691	27692	27693	27694	27695	27696	27697	27698	27699	27700	27701	27702	27703	27704
27705	27706	27707	27708	27709	27710	27711	27712	27713	27714	27715	27716	27717	27718	27719	27720	27721	27722	27723	27724	27725
27726	27727	27728	27729	27730	27731	27732	27733	27734	27735	27736	27737	27738	27739	27740	27741	27742	27743	27744	27745	27746
27747	27748	27749	27750	27751	27752	27753	27754	27755	27756	27757	27758	27759	27760	27761	27762	27763	27764	27765	27766	27767
27768	27769	27770	27771	27772	27773	27774	27775	27776	27777	27778	27779	27780	27781	27782	27783	27784	27785	27786	27787	27788
27789	27790	27791	27792	27793	27794	27795	27796	27797	27798	27799	27800	27801	27802	27803	27804	27805	27806	27807	27808	27809
27810	27811	27812	27813	27814	27815	27816	27817	27818	27819	27820	27821	27822	27823	27824	27825	27826	27827	27828	27829	27830

M. Oshtrak

J. Hawes

J. Hufchuk

Lorne A. Shoultice

Geo. Bunn

26014

SEPARATION LAKE

RESERVE FLOODING RIGHTS TO CONTOUR ELEVATION 1065 FOR H.E.P.C. FILE 19307

28100	28101	28102	28103	28104	28105	28106	28107	28108	28109	28110	28111	28112	28113	28114	28115	28116	28117	28118	28119	28120
28121	28122	28123	28124	28125	28126	28127	28128	28129	28130	28131	28132	28133	28134	28135	28136	28137	28138	28139	28140	28141
28142	28143	28144	28145	28146	28147	28148	28149	28150	28151	28152	28153	28154	28155	28156	28157	28158	28159	28160	28161	28162
28163	28164	28165	28166	28167	28168	28169	28170	28171	28172	28173	28174	28175	28176	28177	28178	28179	28180	28181	28182	28183
28184	28185	28186	28187	28188	28189	28190	28191	28192	28193	28194	28195	28196	28197	28198	28199	28200	28201	28202	28203	28204
28205	28206	28207	28208	28209	28210	28211	28212	28213	28214	28215	28216	28217	28218	28219	28220	28221	28222	28223	28224	28225
28226	28227	28228	28229	28230	28231	28232	28233	28234	28235	28236	28237	28238	28239	28240	28241	28242	28243	28244	28245	28246
28247	28248	28249	28250	28251	28252	28253	28254	28255	28256	28257	28258	28259	28260	28261	28262	28263	28264	28265	28266	28267
28268	28269	28270	28271	28272	28273	28274	28275	28276	28277	28278	28279	28280	28281	28282	28283	28284	28285	28286	28287	28288
28289	28290	28291	28292	28293	28294	28295	28296	28297	28298	28299	28300	28301	28302	28303	28304	28305	28306	28307	28308	28309

BIG I

2694

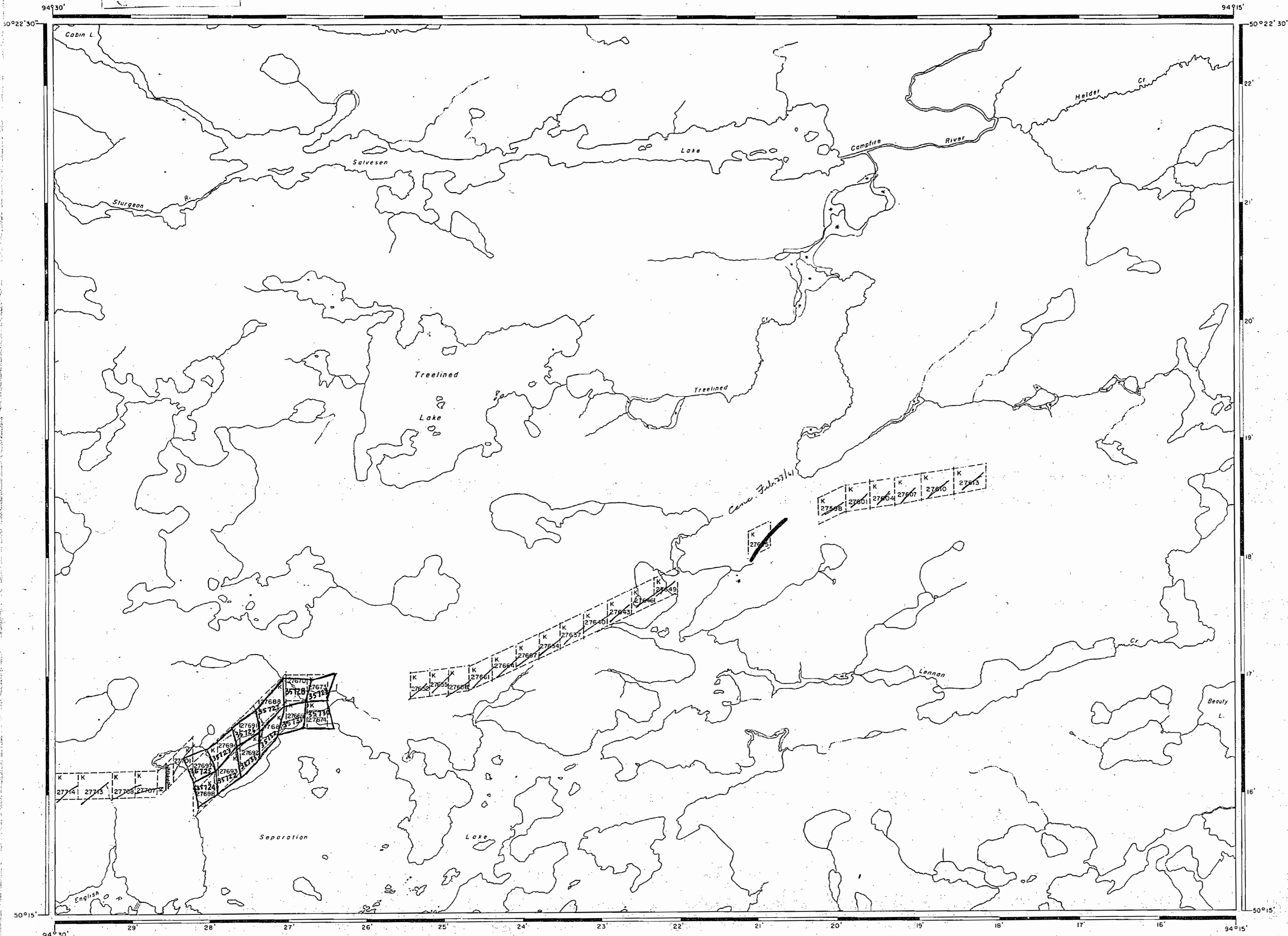

AREA OF
TREELINED LAKE

DISTRICT OF
KENORA

KENORA
MINING DIVISION

SCALE: 1-INCH = 40 CHAINS

LEGEND

PATENTED LAND	Ⓟ
CROWN LAND SALE	C.S.
LEASES	Ⓛ
LOCATED LAND	Loc
LICENSE OF OCCUPATION	L.O.
MINING RIGHTS ONLY	M.R.O.
SURFACE RIGHTS ONLY	S.R.O.
ROADS	—
IMPROVED ROADS	—
KING'S HIGHWAYS	—
RAILWAYS	—
POWER LINES	—
MARSH OR MUSKEG	—
MINES	Ⓜ
CANCELLED	C.

NOTES

400' reserve around all lakes and rivers.
to Dept. of Lands & Forests.

Flooding reserve to H.E.P.C. to contour
1065' adjacent to Treelined Lake; to con-
tour 1049' adjacent to Separation Lake &
Sturgeon River.

Feb. 21/63
MAR 2 1965
APRIL 5, 1945



PLAN NO. **M.2694**

DEPARTMENT OF MINES
— ONTARIO —

1988 (Treeline Lake)

61M 66M 65M 64M 63M 62M 61M 60M 59M

Land withdrawn from staking & reserved for Power Site, L.B.F. file 69307 - marked thus: [Symbol]

Mining
Indian
Dump
Treelin
Recor

SALYERSON LAKE

TREELINED LAKE
RESERVE FLOODING RIGHTS TO CONTOUR ELEVATION 1065 FOR H.E.P.C. FILE 1065

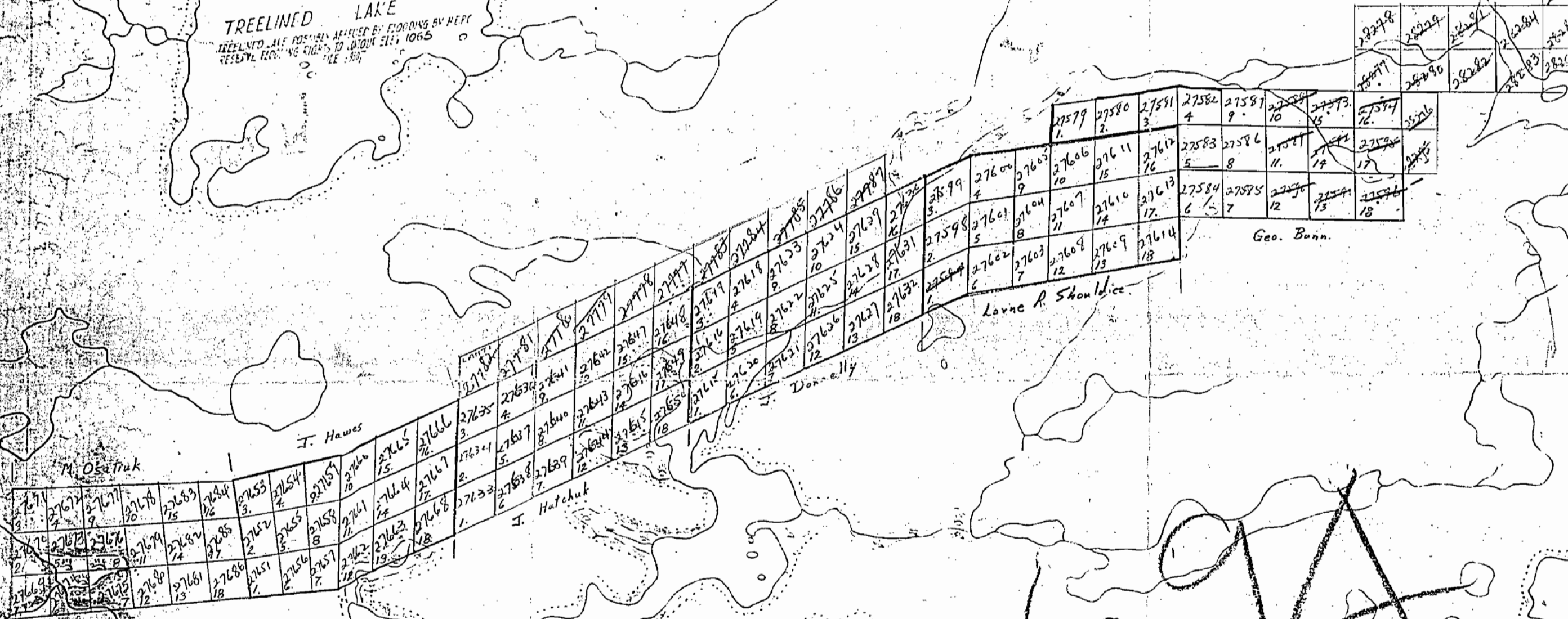

Geo. Bonn.

Layne R. Shoulice

Donnelly

T. Hawes

J. Hatohut

SEPARATION LAKE

RESERVE FLOODING RIGHTS TO CONTOUR ELEVATION 1065 FOR H.E.P.C. FILE 69307

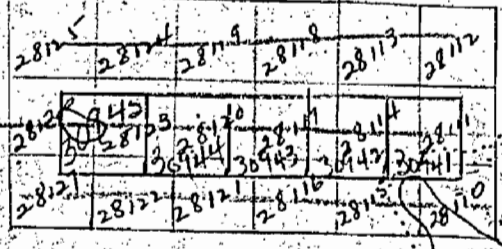

RESERVE FLOODING RIGHTS TO CONTOUR

BIG I

2694

AREA OF

TREELINED LAKE

DISTRICT OF
KENORA
(PATRICIA PORTION)

KENORA
MINING DIVISION

SCALE: 1-INCH = 40 CHAINS

LEGEND

- PATENTED LAND Ⓟ
- CROWN LAND SALE C.S.
- LEASES Ⓛ
- LOCATED LAND Loc
- LICENSE OF OCCUPATION L.O.
- MINING RIGHTS ONLY M.R.O.
- SURFACE RIGHTS ONLY S.R.O.
- ROADS —
- IMPROVED ROADS —
- KING'S HIGHWAYS —
- RAILWAYS —
- POWER LINES —
- MARSH OR MUSKEG —
- MINES —
- CANCELLED C.

NOTES

400' reserve around all lakes and rivers
to Dept. of Lands & Forests.

FLOODING NOTE "A"

Flooding rights on the English River from Maynar Falls to Separation Rapids to contour 5 feet above high water mark to Ont. H.E.P.C. 30 Nov 1956. File: 34179, 69309.

Note "B"

Flooding rights on the English River from Separation Rapids to Caribou Falls to contour elevation 1049' G.S.C. to Ont. H.E.P.C. 30 Nov 1956. File: 34179 Vol 2. Plan U2-27.

KENORA

FILED:
REC'D. APR 15 1965

RECEIPT No.
MINING DIVISION

May 10/66
Aug 30/68
Sept 20/68
Oct 7/68
Oct 30
Dec. 17/69
Feb 24/70
Jan 5/74
July 29/74

PLAN NO. **M.2694**

DEPARTMENT OF MINES
— ONTARIO —

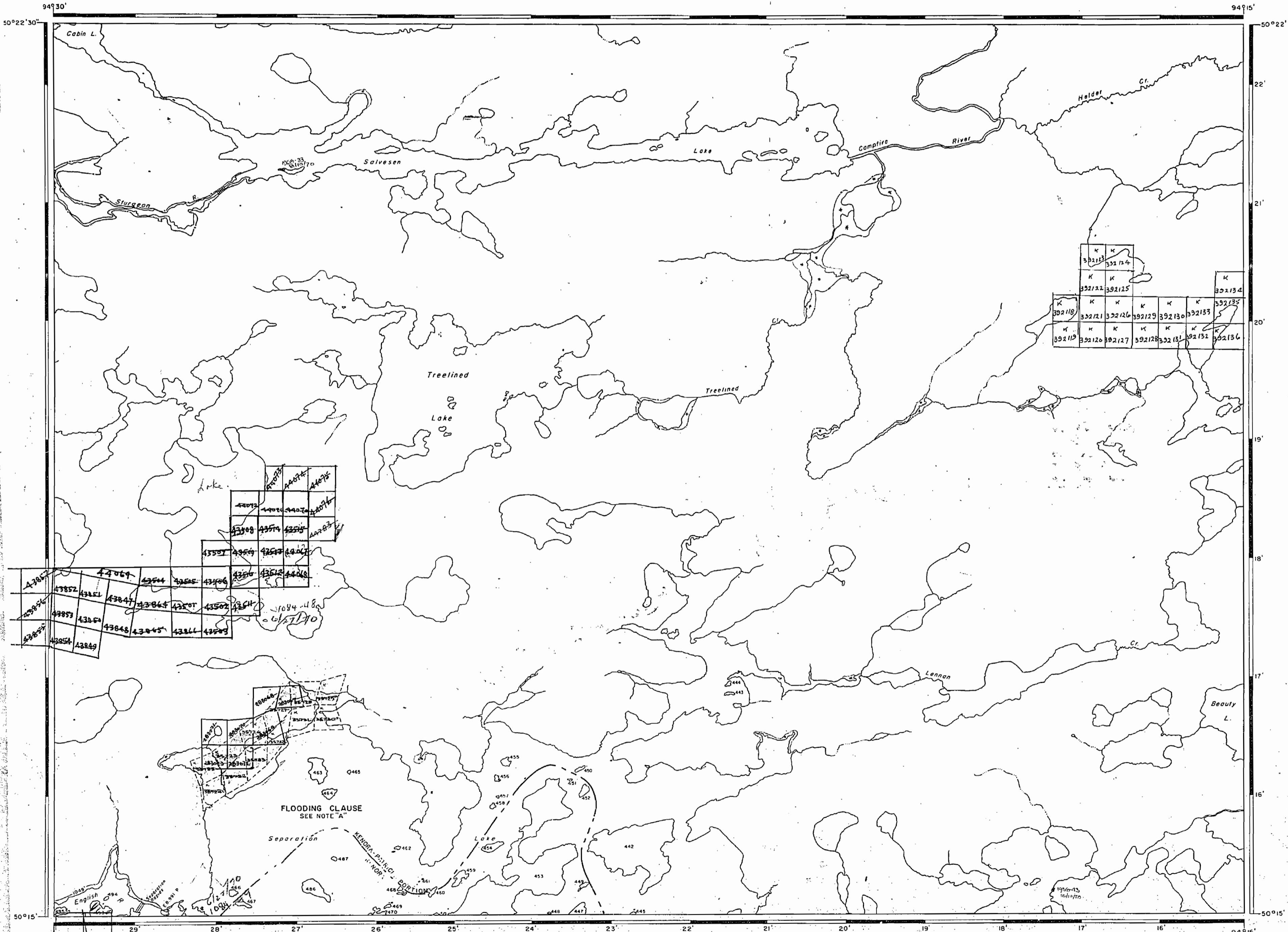

2694

M-2195

AREA OF
TREELINED LAKE

DISTRICT OF
KENORA, KENORA
(PATRICIA PORTION)

KENORA
MINING DIVISION

SCALE: 1-INCH = 40 CHAINS

LEGEND

- PATENTED LAND ⊙
- CROWN LAND SALE CS
- LEASES ⊙
- LOCATED LAND Loc
- LICENSE OF OCCUPATION L.O.
- MINING RIGHTS ONLY M.R.O.
- SURFACE RIGHTS ONLY S.R.O.
- ROADS —
- IMPROVED ROADS —
- KING'S HIGHWAYS —
- RAILWAYS —
- POWER LINES —
- MARSH OR MUSKEG —
- MINES *
- CANCELLED C.

NOTES

400' reserve around all lakes and rivers to Dept. of Lands & Forests.

FLOODING
NOTE "A"
Flooding rights on the English River from Maynard's to Separation Rapids to contour of 1049' high water mark to Ont. H.E.P.C. 30 Nov 1966 to 3-179, 69309.

Note "B"
Flooding rights on the English River from Separation Rapids to Caribou Falls to contour elevation of 1049' G.S.C. to Ont. H.E.P.C. 30 Nov 1966. File 4-79 Vol 1, Part 10.

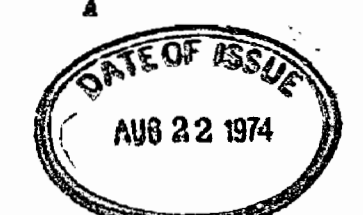

Sept. 16/74
Oct. 4/77
Oct. 24/77

NATIONAL TOPOGRAPHIC SERIES 52 L

PLAN NO. M.2694

ONTARIO
MINISTRY OF NATURAL RESOURCES
SURVEYS AND MAPPING BRANCH

503942

TREELINED LK M-2694

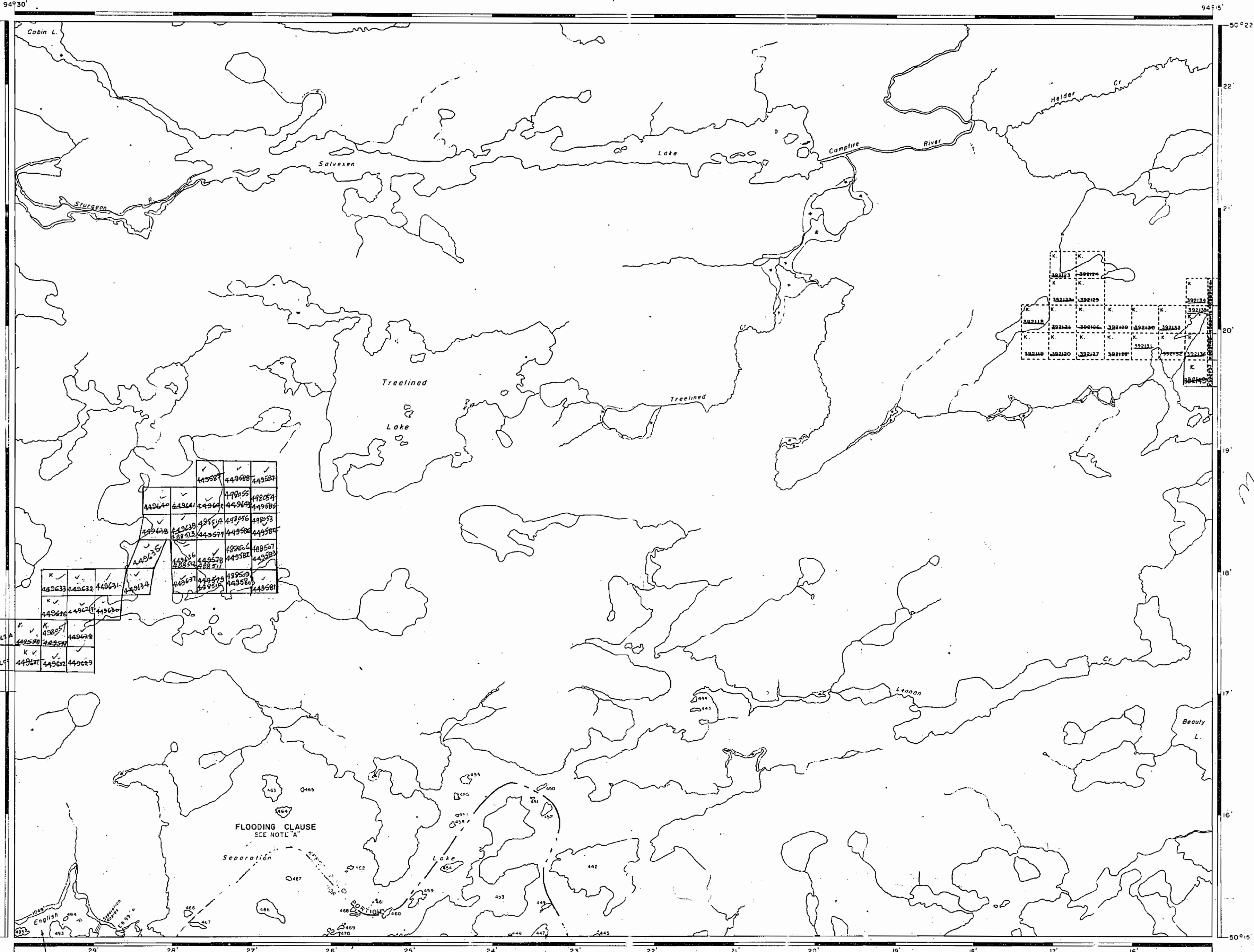

FLOODING CLAUSE
SEE NOTE "B"

FLOODING CLAUSE
SEE NOTE "A"

Stop Lake Area - M.3006

M-2694

M-2694

GI864 ROGER LAKE

LEGEND

- HIGHWAY AND ROUTE No.
- OTHER ROADS
- TRAILS
- SURVEYED LINES: TOWNSHIPS, BASE LINES, ETC.
- LOTS, MINING CLAIMS, PARCELS, ETC.
- UNSURVEYED LINES: LOT LINES
- PARCEL BOUNDARY
- MINING CLAIMS ETC.
- RAILWAY AND RIGHT OF WAY
- UTILITY LINES
- NON-PERENNIAL STREAM
- FLOODING OR FLOODING RIGHTS
- SUBDIVISION OR COMPOSITE PLAN
- RESERVATIONS
- ORIGINAL SHORELINE
- MARSH OR MUSKEG
- MINES
- TRAVERSE MONUMENT
- TOURIST CAMPS (OP - OUTPOST)

THE INFORMATION THAT APPEARS ON THIS MAP HAS BEEN COMPILED FROM VARIOUS SOURCES, AND ACCURACY IS NOT GUARANTEED. THOSE WISHING TO STAKE MINING CLAIMS SHOULD CONSULT WITH THE MINING RECORDER, MINISTRY OF NORTHERN DEVELOPMENT AND MINES, FOR ADDITIONAL INFORMATION ON THE STATUS OF THE LANDS SHOWN HEREON.

DISPOSITION OF CROWN LANDS

TYPE OF DOCUMENT	SYMBOL
PATENT, SURFACE & MINING RIGHTS	●
" SURFACE RIGHTS ONLY	○
" MINING RIGHTS ONLY	◐
LEASE, SURFACE & MINING RIGHTS	◑
" SURFACE RIGHTS ONLY	◒
" MINING RIGHTS ONLY	◓
LICENCE OF OCCUPATION	◔
ORDER-IN-COUNCIL	○C
RESERVATION	○R
CANCELLED	○X
SAND & GRAVEL	○S

NOTE: MINING RIGHTS IN PARCELS PATENTED PRIOR TO MAY 6, 1912, VESTED IN ORIGINAL PATENTEE BY THE PUBLIC LANDS ACT, R.S.O. 1970, CHAP. 380, SEC. 43, SUBSEC. 1.

REFERENCES

AREAS WITHDRAWN FROM DISPOSITION

Description	Order No.	Date	Disposition	File
M.R.O. - MINING RIGHTS ONLY				
S.R.O. - SURFACE RIGHTS ONLY				
M.+S. - MINING AND SURFACE RIGHTS				

FLOODING

RESERVE FLOODING RIGHTS AND LAND UNDER THE WATERS OF THE ENGLISH RIVER BETWEEN SEPARATION RAPIDS AND CARIBOU FALLS, INCLUDING THE STURGEON RIVER, BELOW CONTOUR ELEVATION 1049.0, G.S.C. DATUM, 1919, TO THE E.P.C. OF ONTARIO FOR THE DEVELOPMENT OF WATER POWER AT CARIBOU FALLS. FOR DETAIL OF CONTOUR, REFER TO PLAN No U.2-27, dated 15th MARCH 1958, (H.E.P.C. PLAN No. 800-3359). W.P.L.A. No. 50, dated 21st DECEMBER 1959. File 34179

NOTE "A"
RESERVE FLOODING RIGHTS ON THE ENGLISH RIVER FROM THE UPPER END OF SEPARATION RAPIDS TO THE FOOT OF MAYNARD FALLS, INCLUDING SEPARATION LAKE, BEAUTY LAKE, AND LENNAN CREEK, TO A CONTOUR 5' ABOVE THE HIGH WATER MARK. File 34179, 69307. RESERVATION REQUESTED 30th NOVEMBER 1959.

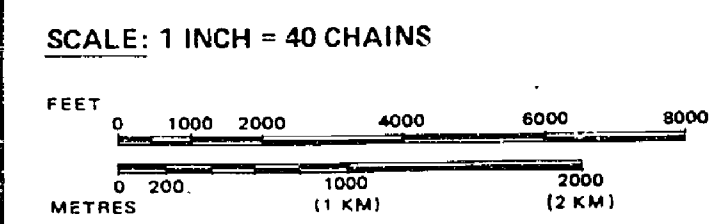

AREA TREELINED LAKE

M.N.R. ADMINISTRATIVE DISTRICT
KENORA
 MINING DIVISION
KENORA
 LAND TITLES / REGISTRY DIVISION
 KENORA/KENORA (PATRICIA PORTION)

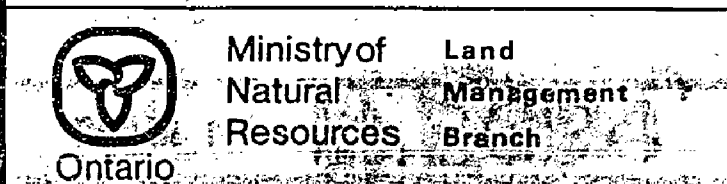

Date FEBRUARY, 1984 Number
 M-2694 G-2651

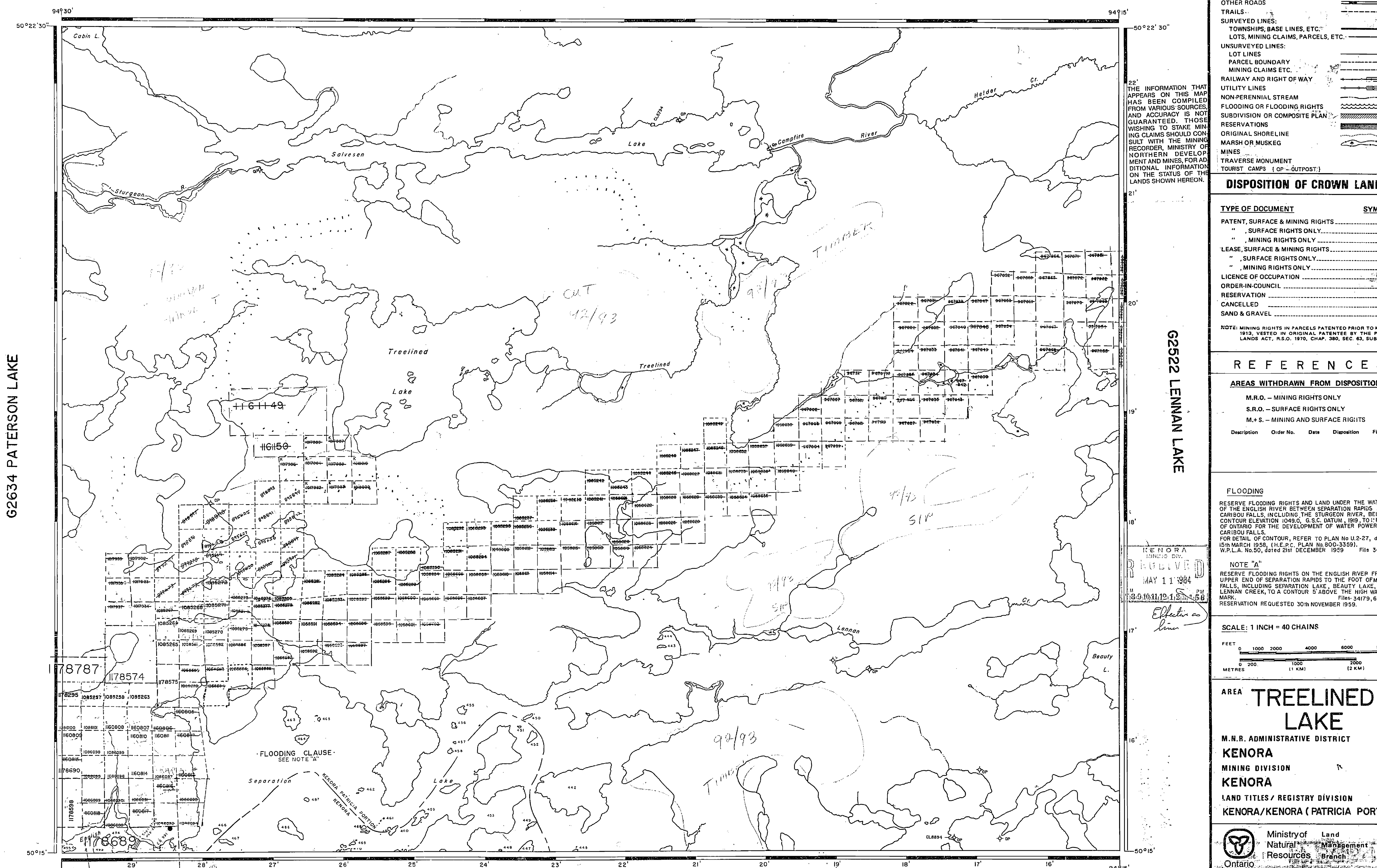

KENORA MINING DIV.
 RECEIVED
 MAY 11 1984
 3:09 PM
 Effect as line

STOP LAKE AREA G-2523

G2522 LENNAN LAKE

G2634 PATERSON LAKE

503942