

FOREST ACTIVITY INFORMATION
THIS TOWNSHIP/AREA FALLS WITHIN THE
TROUT LAKE FOREST

AND MAY BE SUBJECT TO FORESTRY OPERATIONS.
THE M.N.R. UNIT FORESTER FOR THIS AREA CAN BE
CONTACTED AT:
P.O. BOX 5003
RED LAKE, ONTARIO P0V 2M0
(807) 727-2253

REFERENCES

AREAS WITHDRAWN FROM DISPOSITION

- M.R.O. - MINING RIGHTS ONLY
- S.R.O. - SURFACE RIGHTS ONLY
- M.+S. - MINING AND SURFACE RIGHTS

Description Order No. Date Disposition File

ONT. HYDRO LINE FILE 119 40 - 100' WIDE

LEGEND

- HIGHWAY AND ROUTE No.
- OTHER ROADS
- TRAILS
- SURVEYED LINES:
 - TOWNSHIPS, BASE LINES, ETC.
 - LOTS, MINING CLAIMS, PARCELS, ETC.
- UNSURVEYED LINES:
 - LOT LINES
 - PARCEL BOUNDARY
 - MINING CLAIMS ETC.
- RAILWAY AND RIGHT OF WAY
- UTILITY LINES
- NON-PERENNIAL STREAM
- FLOODING OR FLOODING RIGHTS
- SUBDIVISION OR COMPOSITE PLAN
- RESERVATIONS:
 - ORIGINAL SHORELINE
 - MARSH OR MUSKEG
 - MINES
 - TRAVERSE MONUMENT

DISPOSITION OF CROWN LANDS

TYPE OF DOCUMENT	SYMBOL
PATENT, SURFACE & MINING RIGHTS	●
" SURFACE RIGHTS ONLY	○
" MINING RIGHTS ONLY	○
LEASE, SURFACE & MINING RIGHTS	■
" SURFACE RIGHTS ONLY	■
" MINING RIGHTS ONLY	■
LICENCE OF OCCUPATION	○
ORDER-IN-COUNCIL	○
RESERVATION	○
CANCELLED	○
SAND & GRAVEL	○

NOTE: MINING RIGHTS IN PARCELS PATENTED PRIOR TO MAY 6, 1913, VESTED IN ORIGINAL PATENTEE BY THE PUBLIC LANDS ACT, R.S.O. 1970, CHAP. 380, SEC. 63, SUBSEC. 1.

SCALE: 1 INCH = 40 CHAINS

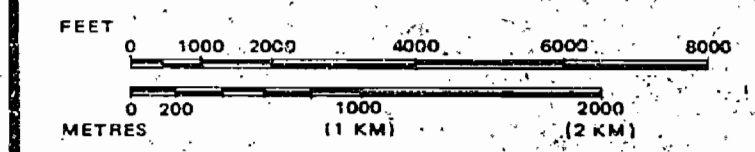

AREA
UCHI LAKE & EARNGEY TWP.
M.N.R. ADMINISTRATIVE DISTRICT

RED LAKE DATE OF ISSUE
MINING DIVISION

RED LAKE SEP 21 1998
LAND TITLES / REGISTRY DIVISION OFFICE - SUDBURY

KENORA / PATRICIA

Ministry of Natural Resources
Land Management Branch

Date FEB. 1983
Number **G-1901**

THE INFORMATION THAT APPEARS ON THIS MAP HAS BEEN COMPILED FROM VARIOUS SOURCES AND ACCURACY IS NOT GUARANTEED. THOSE WISHING TO STAKE MINING CLAIMS SHOULD CONSULT WITH THE MINING RECORDER, MINISTRY OF NORTHERN DEVELOPMENT AND MINES, FOR ADDITIONAL INFORMATION ON THE STATUS OF THE LANDS SHOWN HEREON.

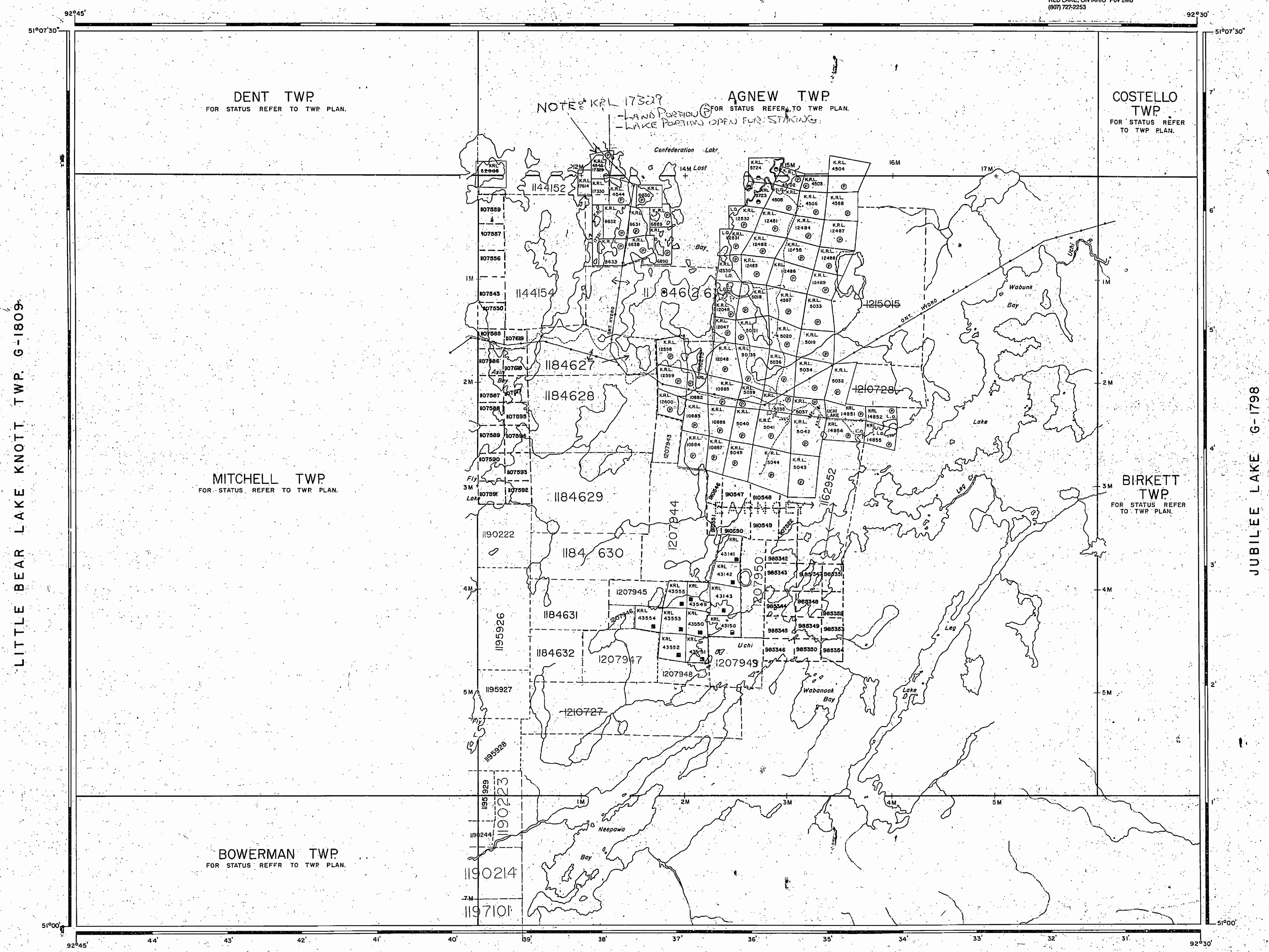

NOTE: K.R.L. 17327
- LAND PORTION (C) FOR STATUS REFER TO TWP PLAN.
- LAKE PORTION (D) OPEN FOR STAKING.

LITTLE BEAR LAKE KNOTT TWP. G-1809

JUBILEE LAKE G-1798

SLATE LAKE G-1884

G-1901 UCHI LAKE & EARNGEY TWP G-1901

FOREST ACTIVITY INFORMATION
THIS TOWNSHIP/AREA FALLS WITHIN THE
TROUT LAKE FOREST

AND MAY BE SUBJECT TO FORESTRY OPERATIONS.
THE M.N.R. UNIT FORESTER FOR THIS AREA CAN BE
CONTACTED AT:
P.O. BOX 5003
RED LAKE, ONTARIO P0V 2M0
(807) 727-2253

REFERENCES

AREAS WITHDRAWN FROM DISPOSITION

M.R.O. - MINING RIGHTS ONLY
S.R.O. - SURFACE RIGHTS ONLY
M.+S. - MINING AND SURFACE RIGHTS

Description	Order No.	Date	Disposition	File
ONT. HYDRO LINE				FILE 11940-100' WIDE

LEGEND

- HIGHWAY AND ROUTE No.
- OTHER ROADS
- TRAILS
- SURVEYED LINES: TOWNSHIPS, BASE LINES, ETC.
- LOTS, MINING CLAIMS, PARCELS, ETC.
- UNSURVEYED LINES: LOT LINES
- PARCEL BOUNDARY MINING CLAIMS ETC.
- RAILWAY AND RIGHT OF WAY
- UTILITY LINES
- NON-PERENNIAL STREAM
- FLOODING OR FLOODING RIGHTS
- SUBDIVISION OR COMPOSITE PLAN
- RESERVATIONS
- ORIGINAL SHORELINE
- MARSH OR MUSKEG
- MINES
- TRAVERSE MONUMENT

DISPOSITION OF CROWN LANDS

TYPE OF DOCUMENT	SYMBOL
PATENT, SURFACE & MINING RIGHTS	●
" SURFACE RIGHTS ONLY	○
" MINING RIGHTS ONLY	○
LEASE, SURFACE & MINING RIGHTS	■
" SURFACE RIGHTS ONLY	□
" MINING RIGHTS ONLY	□
LICENCE OF OCCUPATION	▽
ORDER-IN-COUNCIL	OC
RESERVATION	○
CANCELLED	○
SAND & GRAVEL	○

NOTE: MINING RIGHTS IN PARCELS PATENTED PRIOR TO MAY 6, 1913, VESTED IN ORIGINAL PATENTEE BY THE PUBLIC LANDS ACT, R.S.O. 1970, CHAP. 380, SEC. 63, SUBSEC. 1.

SCALE: 1 INCH = 40 CHAINS

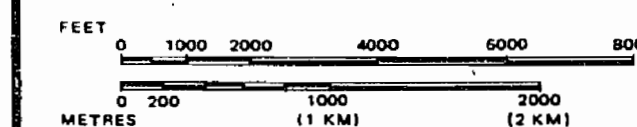

AREA
UCHI LAKE & EARNGEY TWP.
M.N.R. ADMINISTRATIVE DISTRICT
RED LAKE
MINING DIVISION
RED LAKE
LAND TITLES / REGISTRY DIVISION
KENORA/PATRICIA



Date FEB. 1983
Number **G-1901**

THE INFORMATION THAT APPEARS ON THIS MAP HAS BEEN COMPILED FROM VARIOUS SOURCES, AND ACCURACY IS NOT GUARANTEED. THOSE WISHING TO STAKE MINING CLAIMS SHOULD CONSULT WITH THE MINING RECORDER, MINISTRY OF NORTHERN DEVELOPMENT AND MINES, FOR ADDITIONAL INFORMATION ON THE STATUS OF THE LANDS SHOWN HEREON.

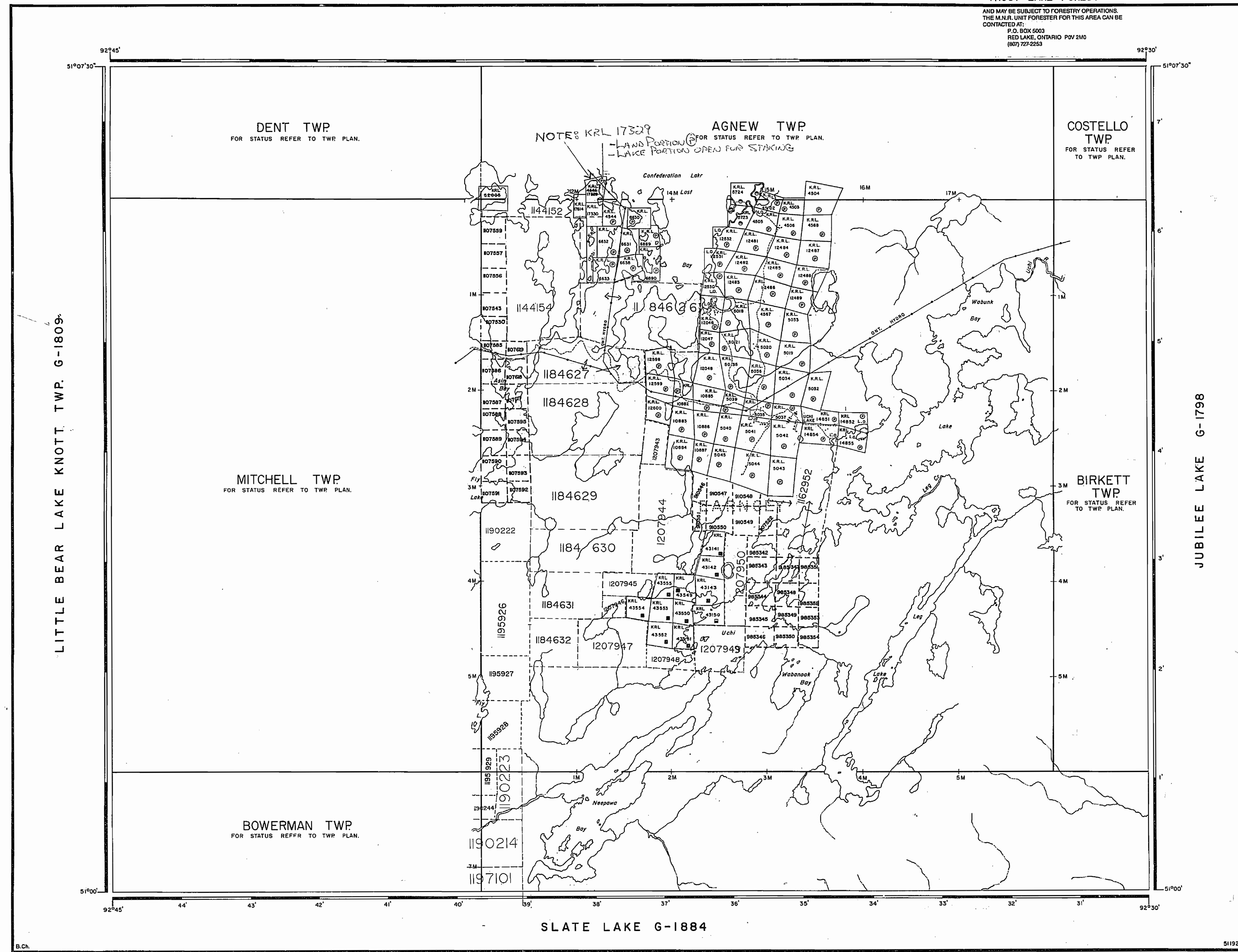

SLATE LAKE G-1884

51923

G-1801

DRAWING NUMBER

UCHI LAKE AREA AND EARNGEY TWP

PLAN HOLD CORPORATION • IRVINE, CALIFORNIA

REGISTERED BY NUMBER 07548

POSITION LOC. OF PRINT IN FIELD

G-1801

DRAWING NUMBER

UCHI LAKE & EARNGEY TWP.

PLAN HOLD CORPORATION • IRVINE, CALIFORNIA

REGISTERED BY NUMBER 07548

POSITION LOC. OF PRINT IN FIELD

G-1801

DRAWING NUMBER

UCHI LAKE & EARNGEY TWP.

PLAN HOLD CORPORATION • IRVINE, CALIFORNIA

REGISTERED BY NUMBER 07548

POSITION LOC. OF PRINT IN FIELD

G-1801

2157

TRIM LINE

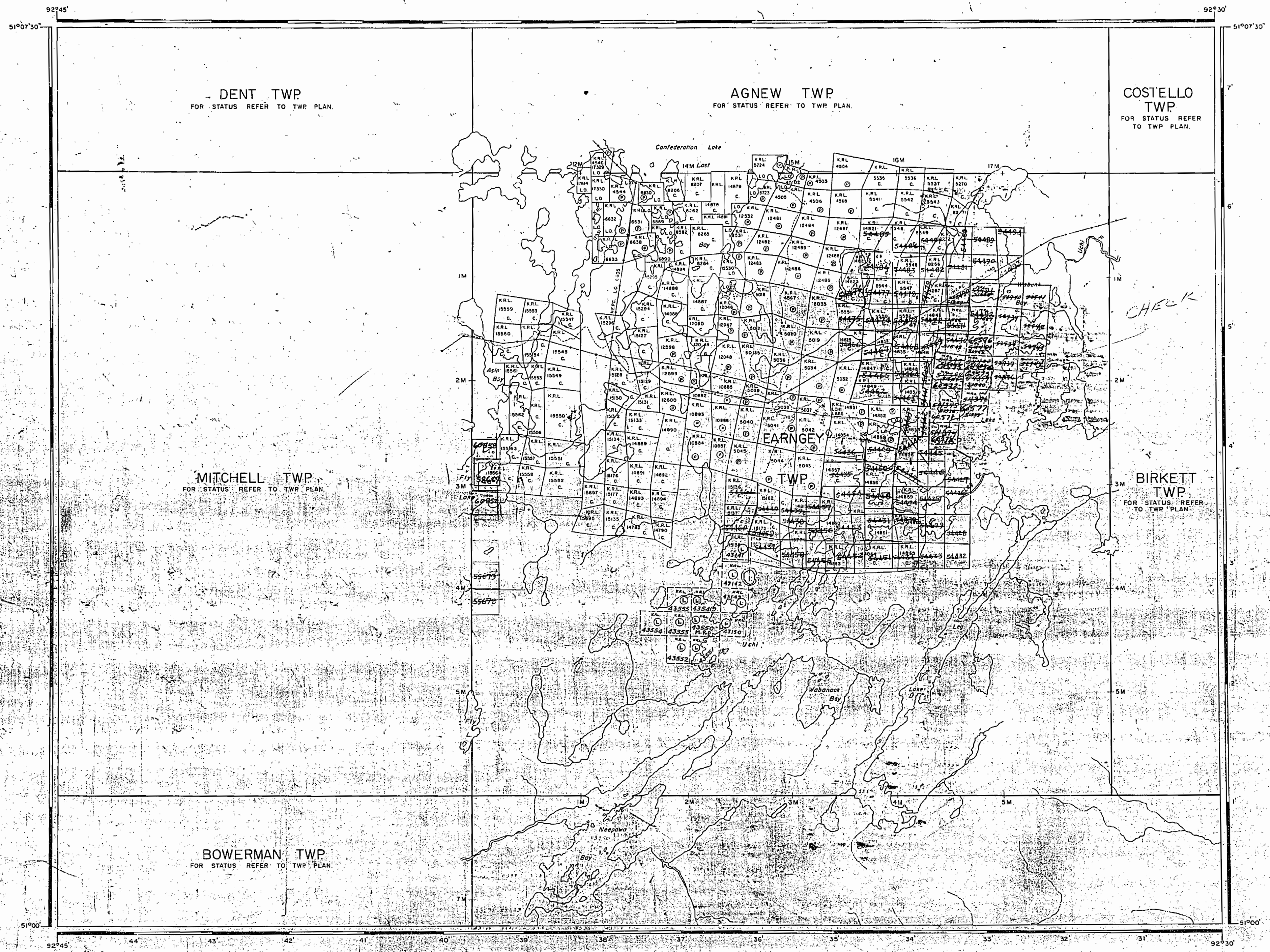

AREA OF

UCHI LAKE & EARNGEY TWP

DISTRICT OF KENORA
PATRICIA PORTION

RED LAKE MINING DIVISION

SCALE: 1-INCH = 40 CHAINS

LEGEND

PATENTED LAND	⊙
CROWN LAND SALE	C.S.
LEASES	⊖
LOCATED LAND	Loc.
LICENSE OF OCCUPATION	L.O.
MINING RIGHTS ONLY	M.R.O.
SURFACE RIGHTS ONLY	S.R.O.
ROADS	—
IMPROVED ROADS	—
KING'S HIGHWAYS	—
RAILWAYS	—
POWER LINES	—
MARSH OR MUSKEG	—
MINES	⊙
CANCELLED	C.

NOTES

400' Reserve ground all lakes & rivers to Dept of Lands & Forests

HEPC Transmission Line - File 11940 - 100' wide.

1967?

PLAN NO. **M-2157**

DEPARTMENT OF MINES
— ONTARIO —

before 1968

M-2157

M-2157

UCHI LAKE & EARNGEY TWP

UCHI LAKE & EARNGEY TWP

M-2157

M-2157

TRIM LINE

2157

AREA OF

UCHI LAKE
8 EARNGEY TWP

DISTRICT OF
KENORA
PATRICIA PORTION

RED LAKE
MINING DIVISION

SCALE: 1-INCH = 40' CHAINS

LEGEND

PATENTED LAND	⊙
CROWN LAND SALE	C.S.
LEASES	⊖
LOCATED LAND	Loc.
LICENSE OF OCCUPATION	L.O.
MINING RIGHTS ONLY	M.R.C.
SURFACE RIGHTS ONLY	S.R.O.
ROADS	—
IMPROVED ROADS	—
KING'S HIGHWAYS	—
RAILWAYS	—
POWER LINES	—
MARSH OR MUSKEG	—
MINES	⊗
CANCELLED	C

NOTES

400' Surface Rights Reservation around all
Lakes and Rivers

HEPC Transmission Line - File 11940 - 100' wide

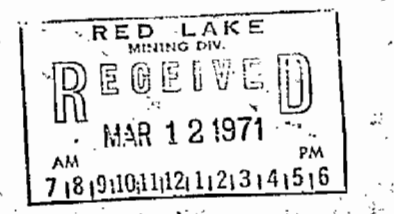

NATIONAL TOPOGRAPHIC SERIES 52

PLAN NO. **M-2157**

ONTARIO
DEPARTMENT OF MINES
AND NORTHERN AFFAIRS

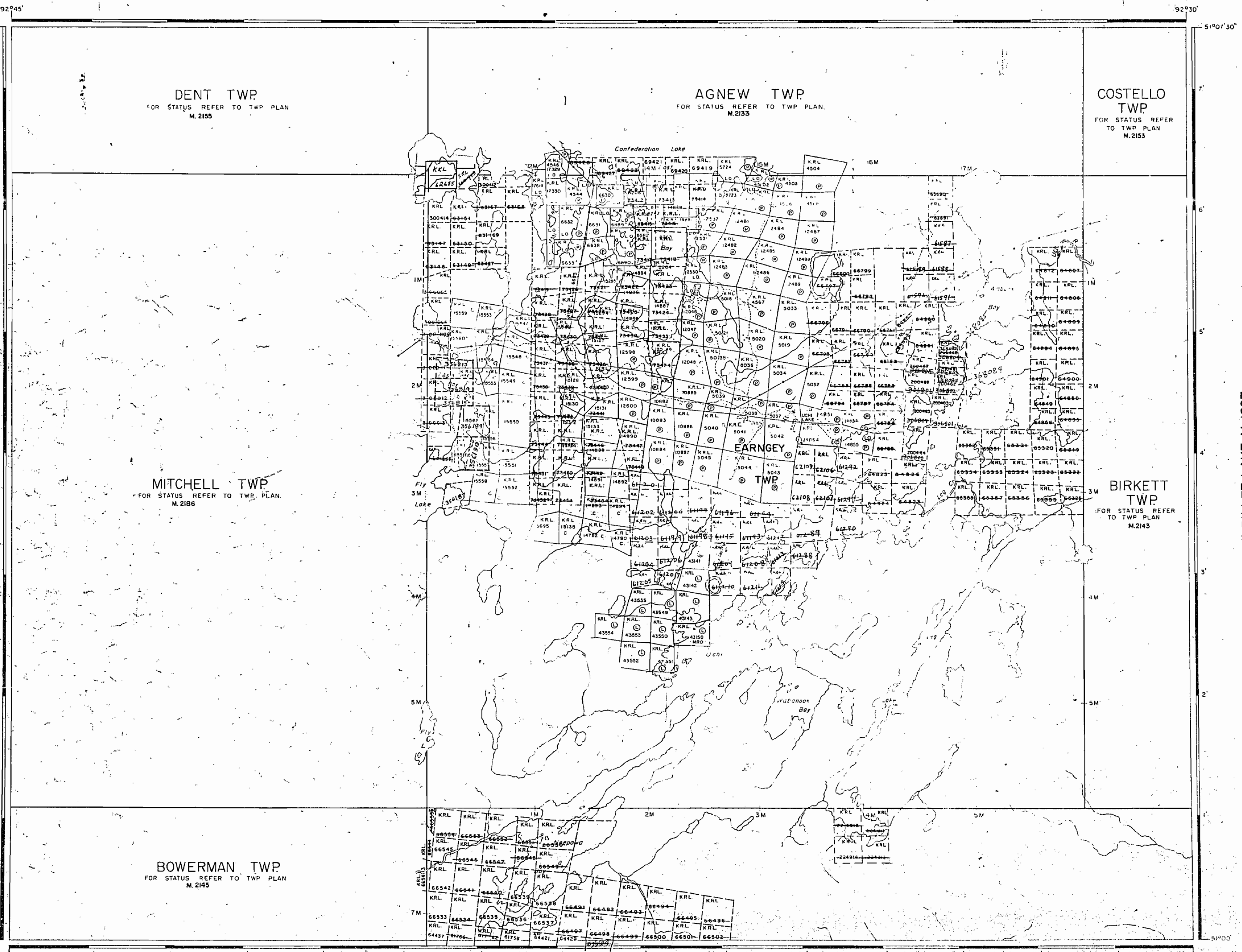

SLATE LAKE M-242

2157

AREA OF
UCHI LAKE
 & EARNEY TWP
 DISTRICT OF
 KENORA
 PATRICIA PORTION
 RED LAKE
 MINING DIVISION
 SCALE: 1-INCH = 40. CHAINS

LEGEND

PATENTED LAND	⊙
CROWN LAND SALE	⊙
LEASES	⊙
LOCATED LAND	⊙
LICENSE OF OCCUPATION	⊙
MINING RIGHTS ONLY	M.R.O.
SURFACE RIGHTS ONLY	S.R.O.
ROADS	—
IMPROVED ROADS	—
KING'S HIGHWAYS	—
RAILWAYS	—
POWER LINES	—
MARSH OR MUSKEG	—
MINES	⊙
CANCELLED	⊙

NOTES

400' Surface Rights Reservation around all
 Lakes and Rivers.

HEPC Transmission Line - File M-1940 - 100' wide

RED LAKE
 RECEIVED
 AUG 2 1973
 7 18 10 11 12 1 12 3 4 15 16

NATIONAL TOPOGRAPHIC SERIES 52 N
 PLAN NO. **M-2157**
 ONTARIO
 MINISTRY OF NATURAL RESOURCES
 SURVEYS AND MAPPING BRANCH

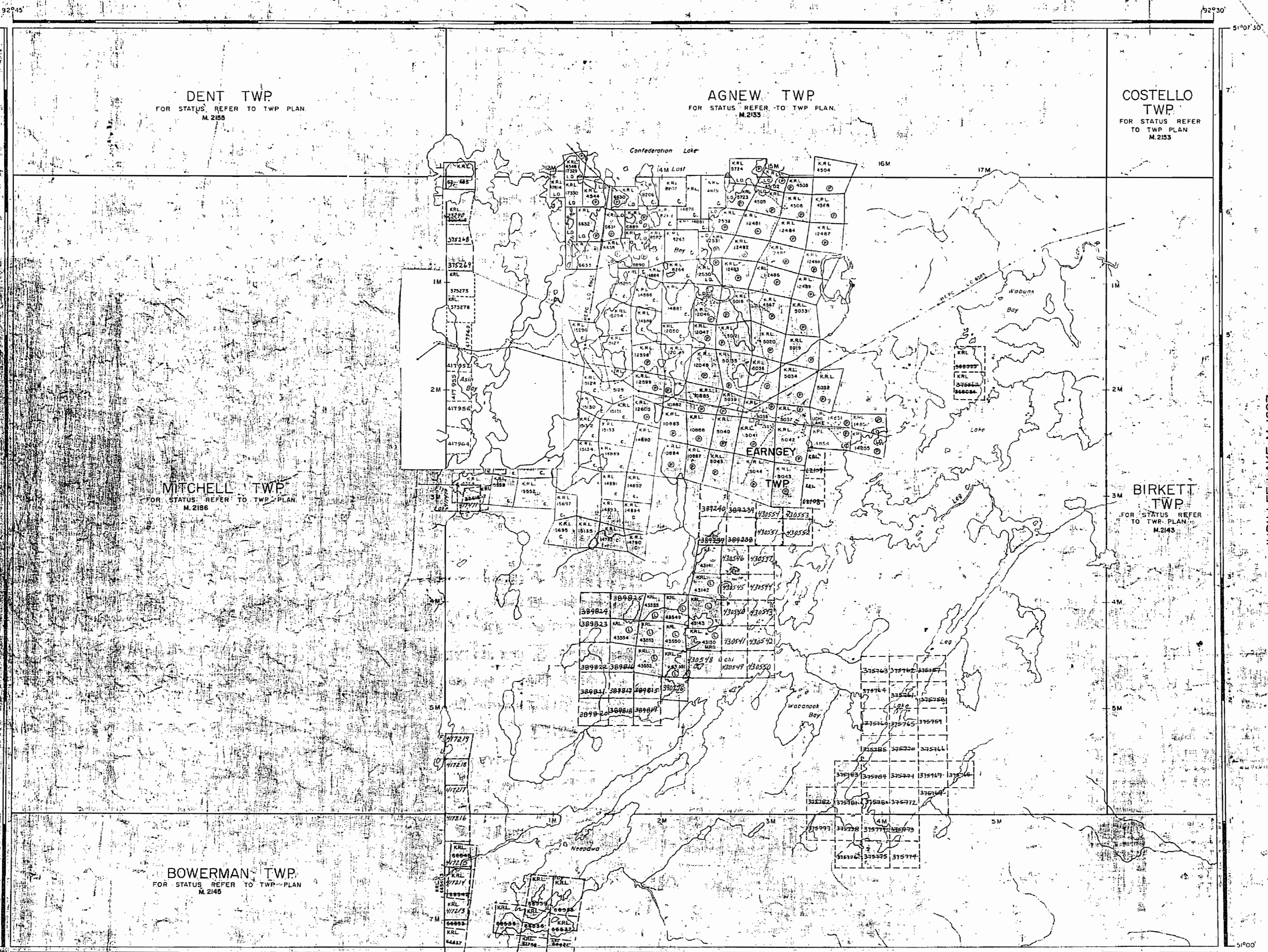

SLATE LAKE M-2412

2157

AREA OF

UCHI LAKE & EARNGEY TWP

DISTRICT OF KENORA
PATRICIA PORTION

RED LAKE MINING DIVISION

SCALE: 1-INCH = 40 CHAINS

LEGEND

- PATENTED LAND ⊙
- CROWN LAND SALE C.S.
- LEASES ⊖
- LOCATED LAND Loc.
- LICENSE OF OCCUPATION L.O.
- MINING RIGHTS ONLY M.R.O.
- SURFACE RIGHTS ONLY S.R.O.
- ROADS —
- IMPROVED ROADS —
- KING'S HIGHWAYS —
- RAILWAYS —
- POWER LINES —
- MARSH OR MUSKEG —
- MINES X
- CANCELLED C

NOTES

- 400' Surface Rights Reservation around all Lakes and Rivers
- HEPC Transmission Line - File 11940 - 100' wide

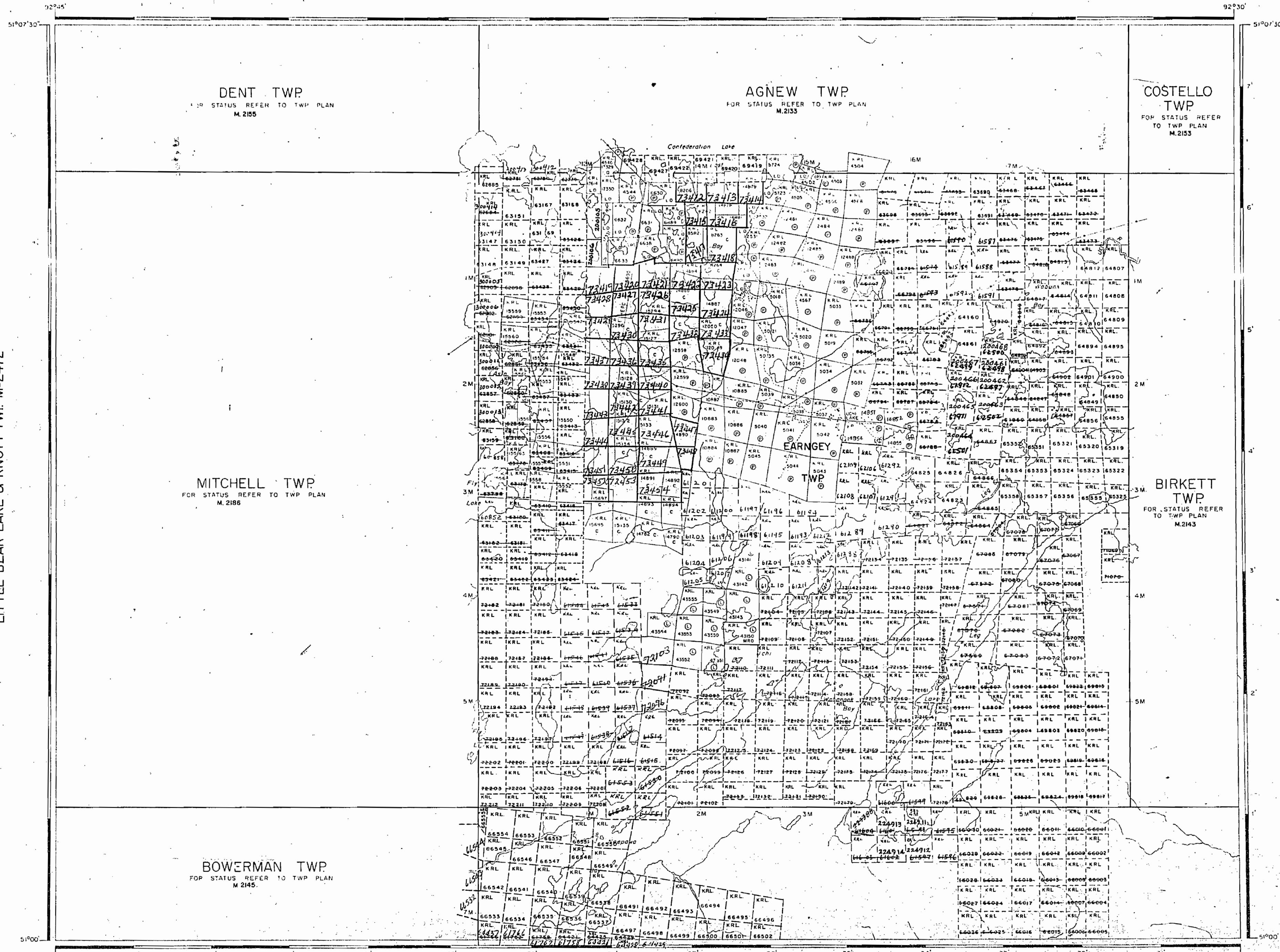

LITTLE BEAR LAKE & KNOTT TWP M-2472

JUBILEE LAKE M-1697

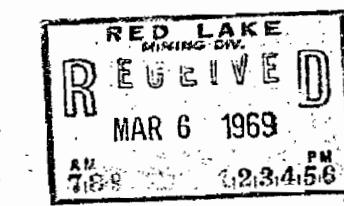

PLAN NO. M-2157

DEPARTMENT OF MINES

- ONTARIO -

SLATE LAKE M-2412

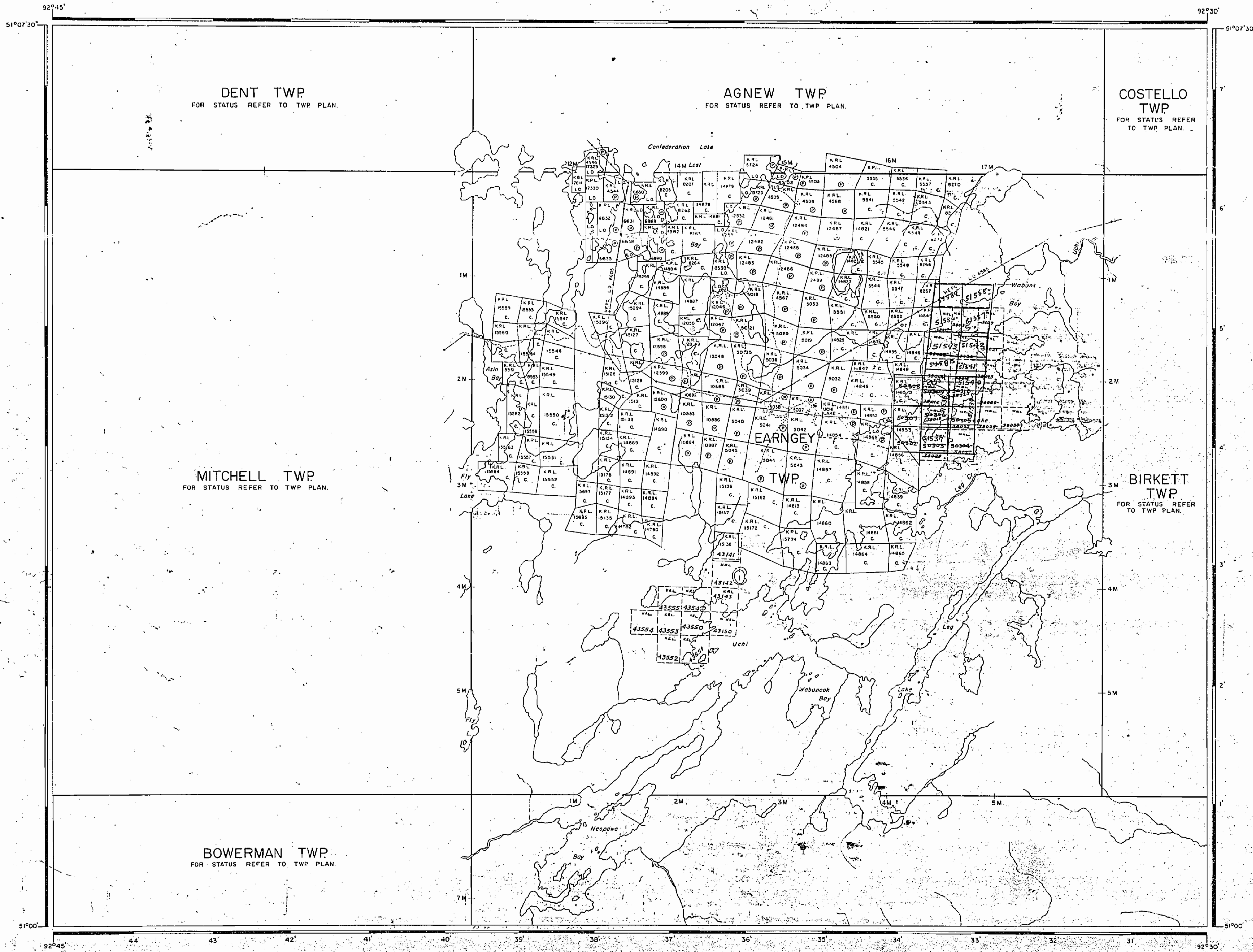

AREA OF
UCHI LAKE & EARNGEY TWP
 DISTRICT OF KENORA
 PATRICIA PORTION
 RED LAKE MINING DIVISION
 SCALE: 1-INCH = 40 CHAINS

LEGEND

PATENTED LAND	⊙
CROWN LAND SALE	C.S.
LEASES	⊙
LOCATED LAND	Loc
LICENSE OF OCCUPATION	L.O.
MINING RIGHTS ONLY	M.R.O.
SURFACE RIGHTS ONLY	S.R.O.
ROADS	—
IMPROVED ROADS	—
KING'S HIGHWAYS	—
RAILWAYS	—
POWER LINES	—
MARSH OR MUSKES	—
MINES	⊙
CANCELLED	⊙

NOTES
 400' Reserve around all lakes & rivers to Dept of Lands & Forests
 HEPC Transmission Line - File 11940 - 100' wide



PLAN NO. **M-2157**
 DEPARTMENT OF MINES
 - ONTARIO -

M-2157

M-2157

UCHI LAKE & EARNGEY TWP

UCHI LAKE & EARNGEY TWP

M-2157

M-2157

2157

M-S121

M-S121

UCHI LAKE

UCHI LAKE

M-S121

M-S121

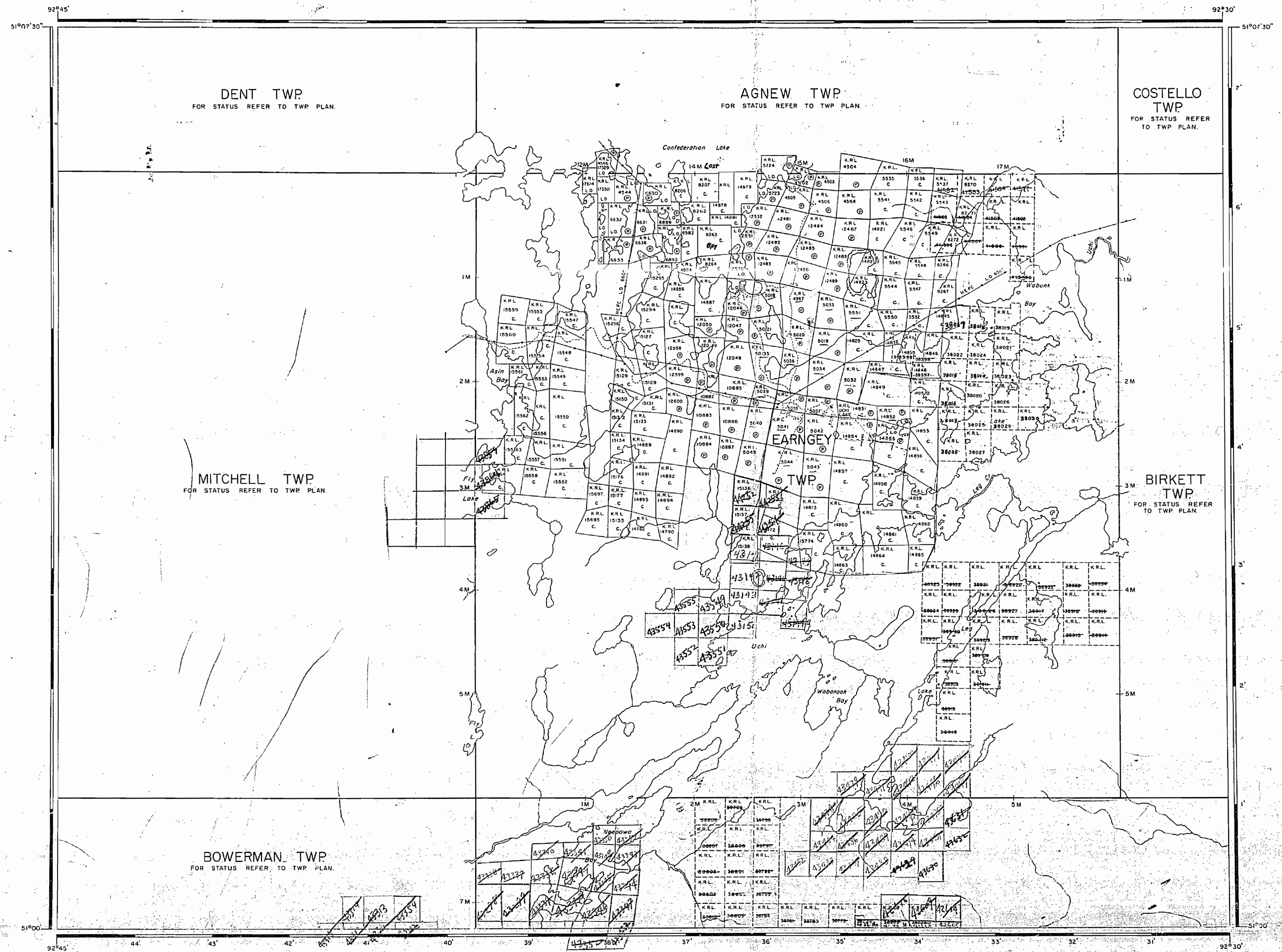

AREA OF
UCHI LAKE
 & EARNGEY TWP
 DISTRICT OF
 KENORA
 PATRICIA PORTION
 RED LAKE
 MINING DIVISION
 SCALE: 1-INCH = 40 CHAINS

LEGEND

PATENTED LAND	⊙
CROWN LAND SALE	C.S.
LEASES	⊖
LOCATED LAND	Loc.
LICENSE OF OCCUPATION	L.O.
MINING RIGHTS ONLY	M.R.O.
SURFACE RIGHTS ONLY	S.R.O.
ROADS	—
IMPROVED ROADS	—
KING'S HIGHWAYS	—
RAILWAYS	—
POWER LINES	—
MARSH OR MUSKOG	—
MINES	⊙
CANCELLED	⊙

NOTES
 400' Reserve around all lakes & rivers to
 Dept of Lands & Forests
 HEPC Transmission Line - File 11940 - 100' wide
 May 6/60
 June 30/60
 June 29/60



PLAN NO **M-2157**
 DEPARTMENT OF MINES
 - ONTARIO -

511923

2157

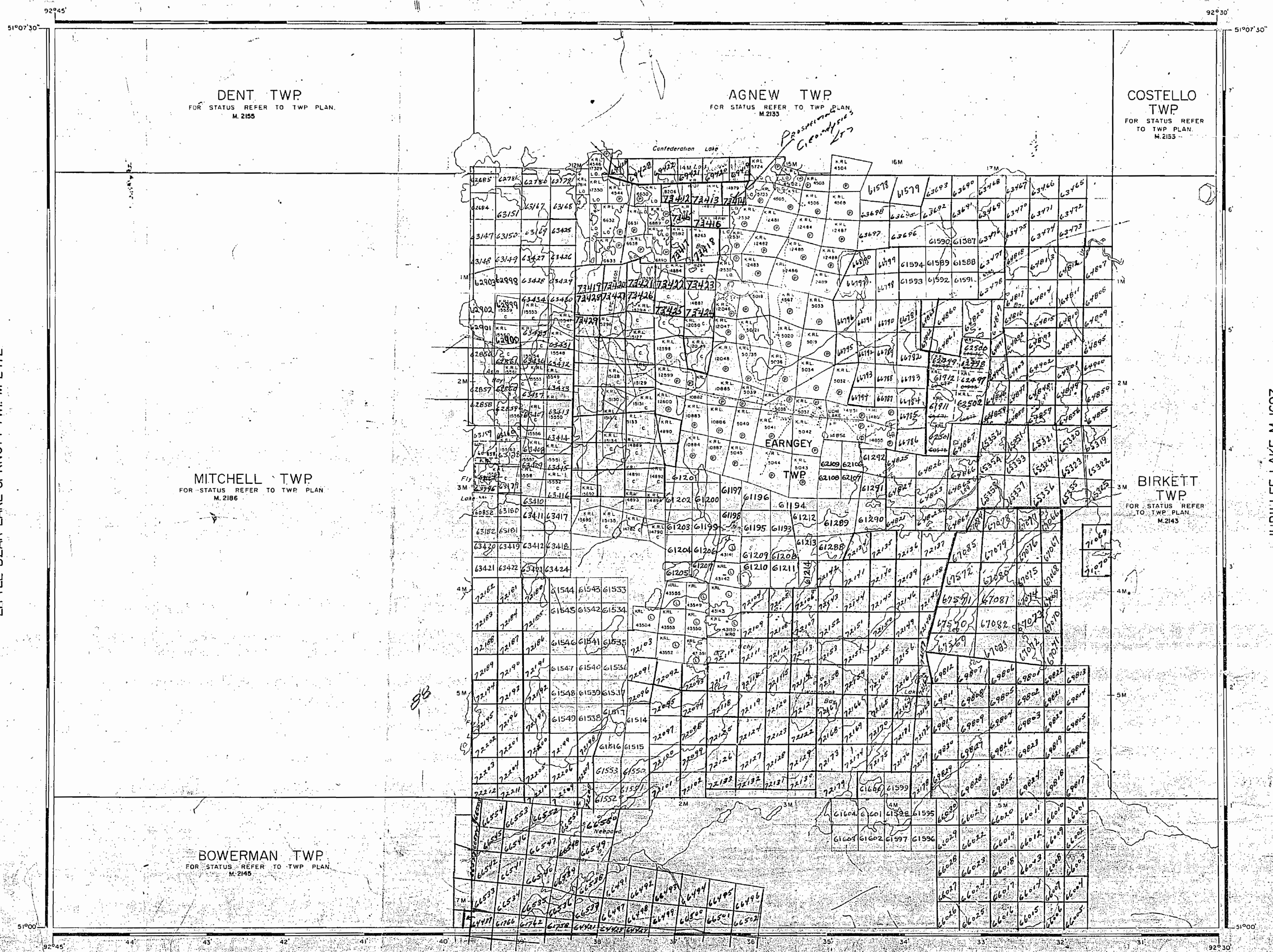

AREA OF
UCHI LAKE & EARNGEY TWP
 DISTRICT OF KENORA
 PATRICIA PORTION
 RED LAKE MINING DIVISION
 SCALE: 1-INCH = 40 CHAINS

LEGEND

PATENTED LAND	Ⓟ
CROWN LAND SALE	C.S.
LEASES	Ⓞ
LOCATED LAND	Loc.
LICENSE OF OCCUPATION	L.O.
MINING RIGHTS ONLY	M.F.U.
SURFACE RIGHTS ONLY	S.R.O.
ROADS	—
IMPROVED ROADS	—
KING'S HIGHWAYS	—
RAILWAYS	—
POWER LINES	—
MARSH OR MUSKEG	—
MINES	Ⓧ
CANCELLED	Ⓞ

NOTES

400' Surface Rights Reservation around all Lakes and Rivers.

H.E.P.C. Transmission Line - File 11940 - 100' wide.

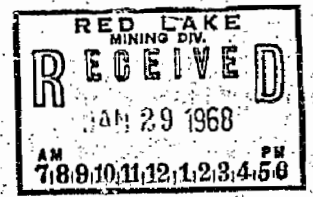

PLAN NO. **M-2157**
 DEPARTMENT OF MINES
 - ONTARIO -

LITTLE BEAR LAKE & KNOTT TWP M-2472

JUBILEE LAKE M-1697

SLATE LAKE M-2412

1013-101

2157

M-5121

M-5121

UCHI LAKE

UCHI LAKE

M-5121

M-5121

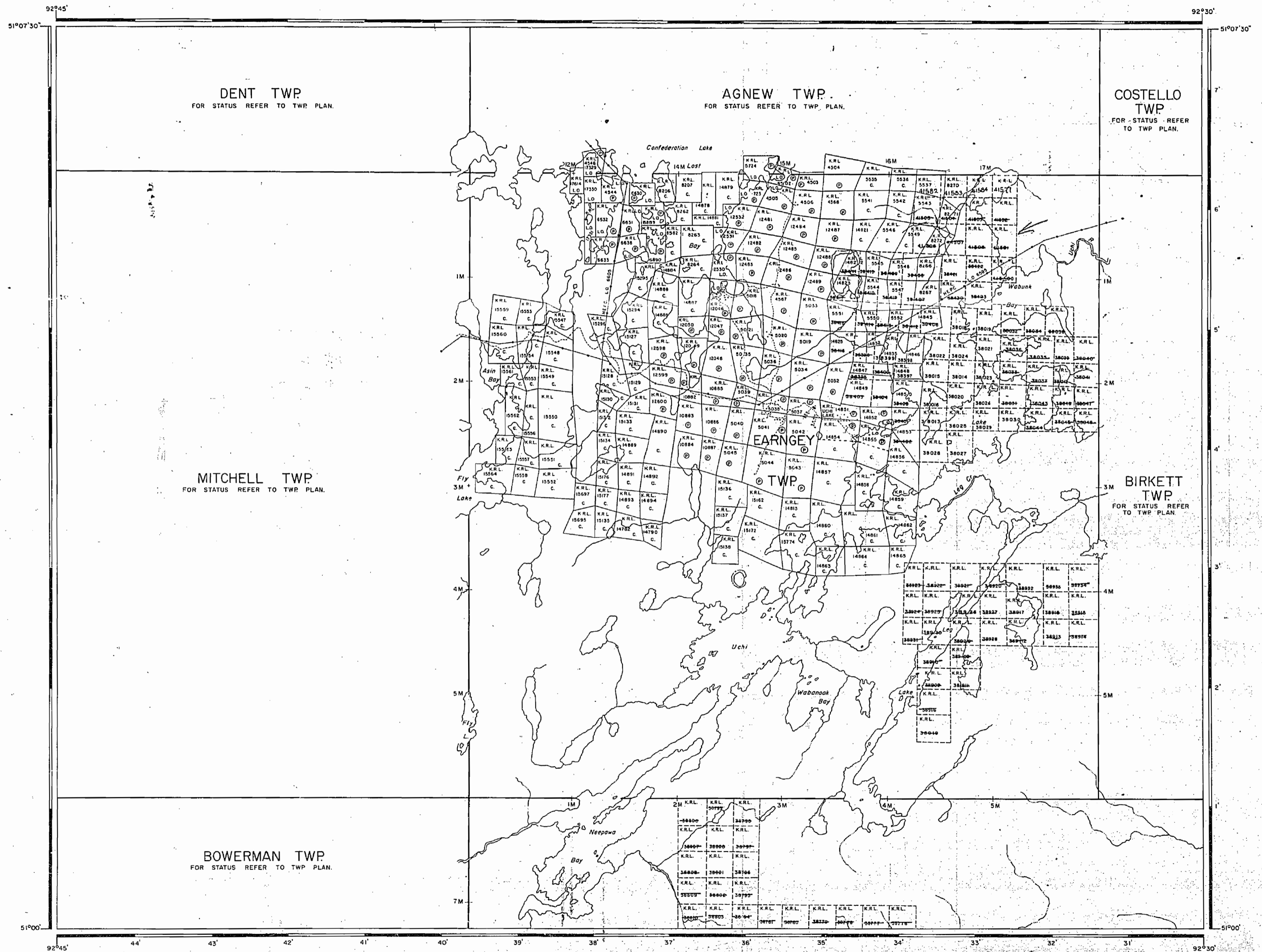

AREA OF

UCHI LAKE & EARNGEY TWP.

DISTRICT OF KENORA
PATRICIA PORTION

RED LAKE MINING DIVISION

SCALE: 1-INCH = 40 CHAINS

LEGEND

PATENTED LAND	⊙
CROWN LAND SALE	C.S.
LEASES	⊖
LOCATED LAND	Loc.
LICENSE OF OCCUPATION	L.O.
MINING RIGHTS ONLY	M.R.O.
SURFACE RIGHTS ONLY	S.R.O.
ROADS	—
IMPROVED ROADS	—
KING'S HIGHWAYS	—
RAILWAYS	—
POWER LINES	—
MARSH OR MUSKES	—
MINES	—
CANCELLED	C.

NOTES

400' Reserve around all lakes & rivers to Dept. of Lands & Forests

HEPC Transmission Line - File 11940 - 100' wide.

PLAN NO. **M-2157**

DEPARTMENT OF MINES
— ONTARIO —

Earngey 2157