

VERMILION ADDT'L. TP. M.2273

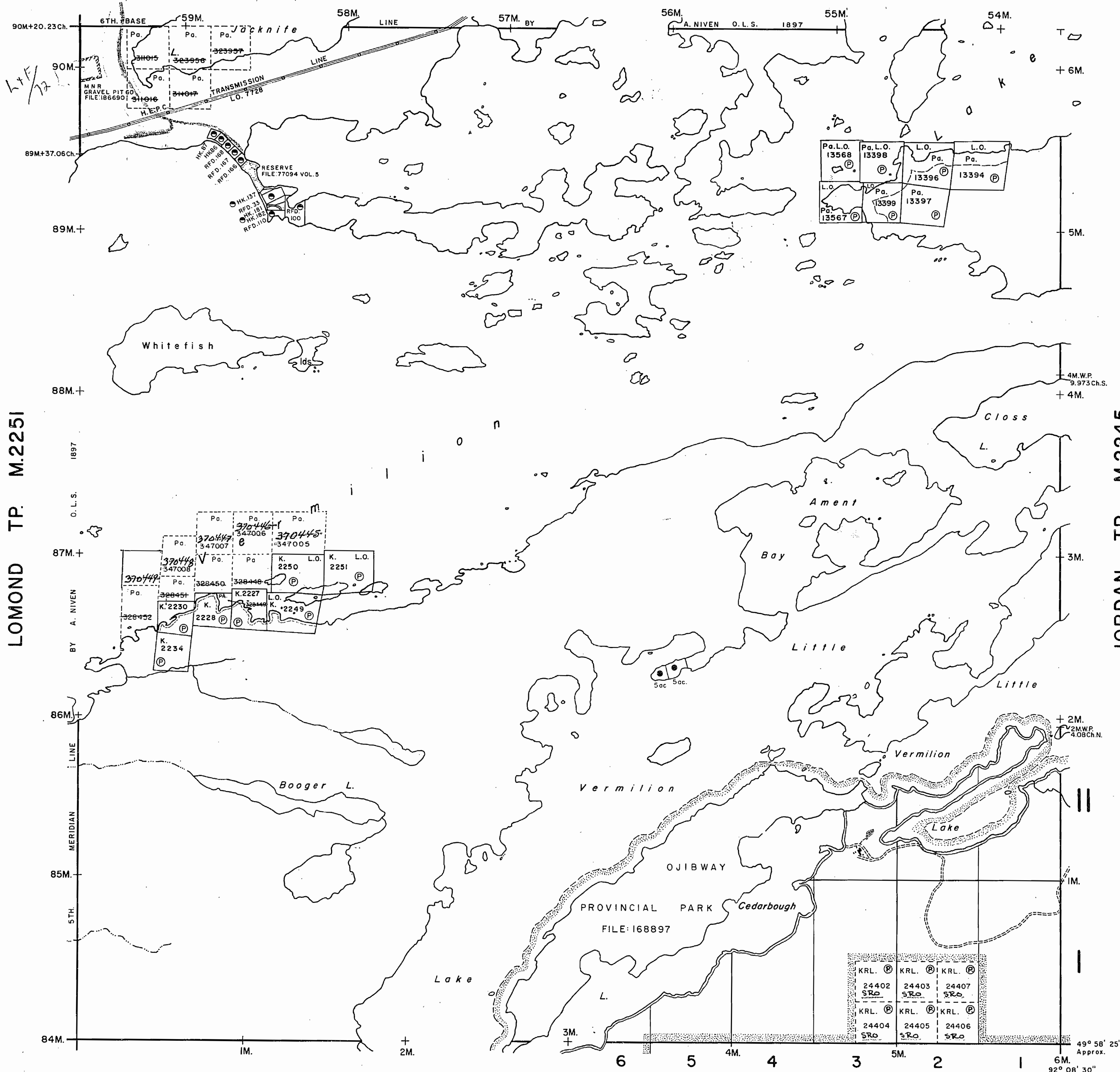

NOTES

400' surface rights reservation along the shores of all lakes and rivers.

LEGEND

- PATENTED LAND Ⓟ or ●*
 - PATENTED FOR SURFACE RIGHTS ONLY Ⓟ*
 - LEASE Ⓞ
 - LICENSE OF OCCUPATION L.O.
 - CROWN LAND SALES C.S.
 - LOCATED LAND Loc.
 - CANCELLED C.
 - MINING RIGHTS ONLY M.R.O.
 - SURFACE RIGHTS ONLY S.R.O.
 - HIGHWAY & ROUTE NO.
 - ROADS
 - TRAILS
 - RAILWAYS
 - POWER LINES
 - MARSH OR MUSKEG
 - MINES
- *used only with summer resort locations or when space is limited

TOWNSHIP OF

VERMILION

DISTRICT OF KENORA #4

PATRICIA MINING DIVISION

SCALE: 1 INCH = 40 CHAINS (1/2 MILE)

DR. A. T. V. PLAN NO. **M.2272**

DATE JUN 28/72

MINISTRY OF NATURAL RESOURCES ONTARIO

VERMILION ADDT'L. TP. M.2273

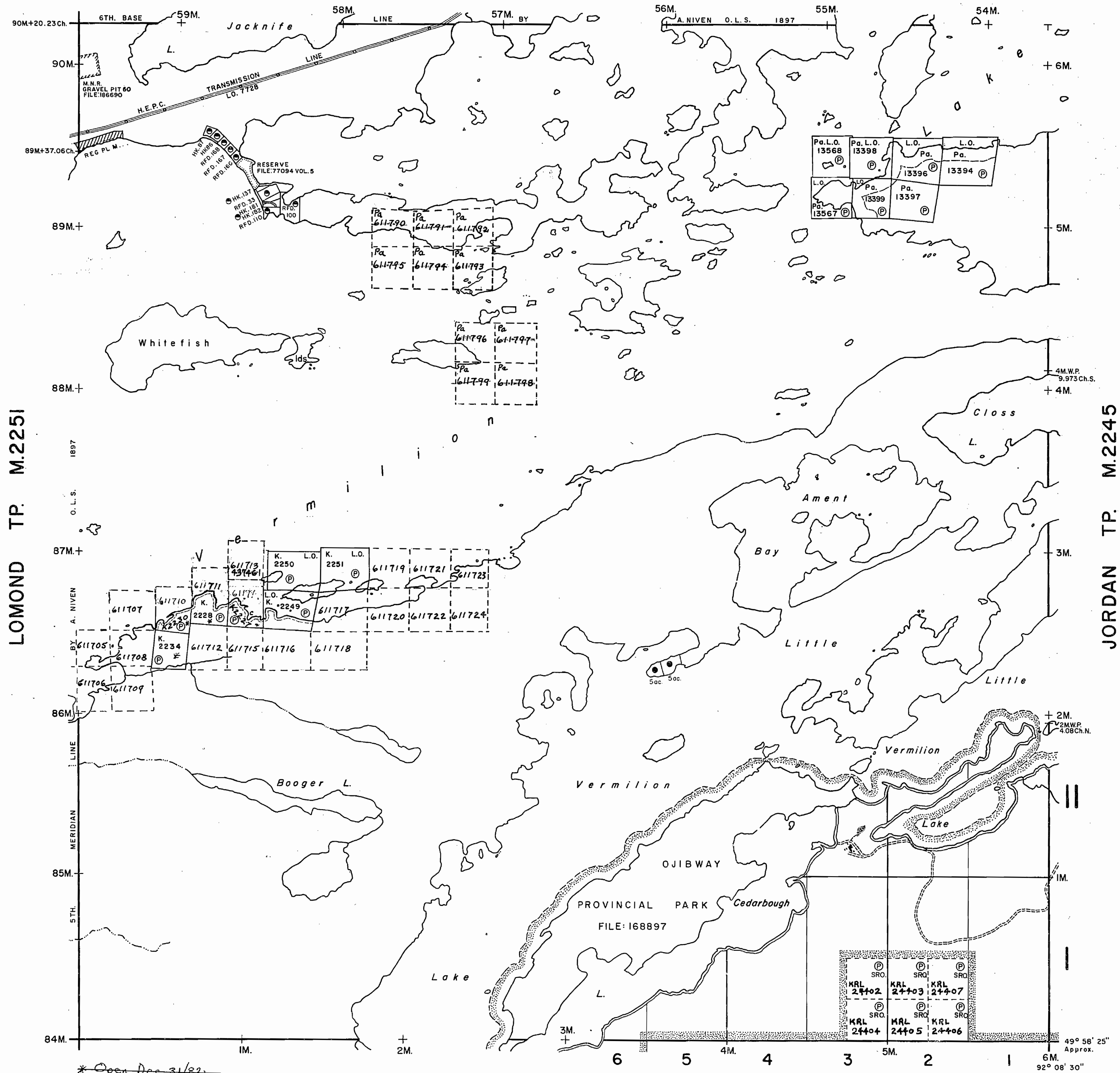

LOMOND TP. M.2251

JORDAN TP. M.2245

PICKEREL TP. M.2258

NOTES

400' surface rights reservation along the shores of all lakes and rivers.

Jan. 14, 1980
Feb. 17, 1981
June 9/83



#5

LEGEND

- PATENTED LAND P or ●*
 - PATENTED FOR SURFACE RIGHTS ONLY ●*
 - LEASE ⊙
 - LICENSE OF OCCUPATION L.O.
 - CROWN LAND SALES C.S.
 - LOCATED LAND Loc.
 - CANCELLED c.
 - MINING RIGHTS ONLY M.R.O.
 - SURFACE RIGHTS ONLY S.R.O.
 - HIGHWAY & ROUTE NO.
 - ROADS
 - TRAILS
 - RAILWAYS
 - POWER LINES
 - MARSH OR MUSKEG
 - MINES
- *used only with summer resort locations or when space is limited

TOWNSHIP OF

VERMILION

DISTRICT OF KENORA

PATRICIA G-2887
MINING DIVISION

SCALE: 1 INCH = 40 CHAINS (1/2 MILE)

DR. A. T. V.
DATE JUN 28/72

PLAN NO. M.2272

ONTARIO

MINISTRY OF NATURAL RESOURCES
SURVEYS AND MAPPING BRANCH

* Open Dec 31/82
unless taxes otherwise paid
K. 2227, K. 2228, K. 2230, 2234
TAXES PAID BY GOLD REEF MINES LTD.

VERMILION ADDT'L. TP. M.2273

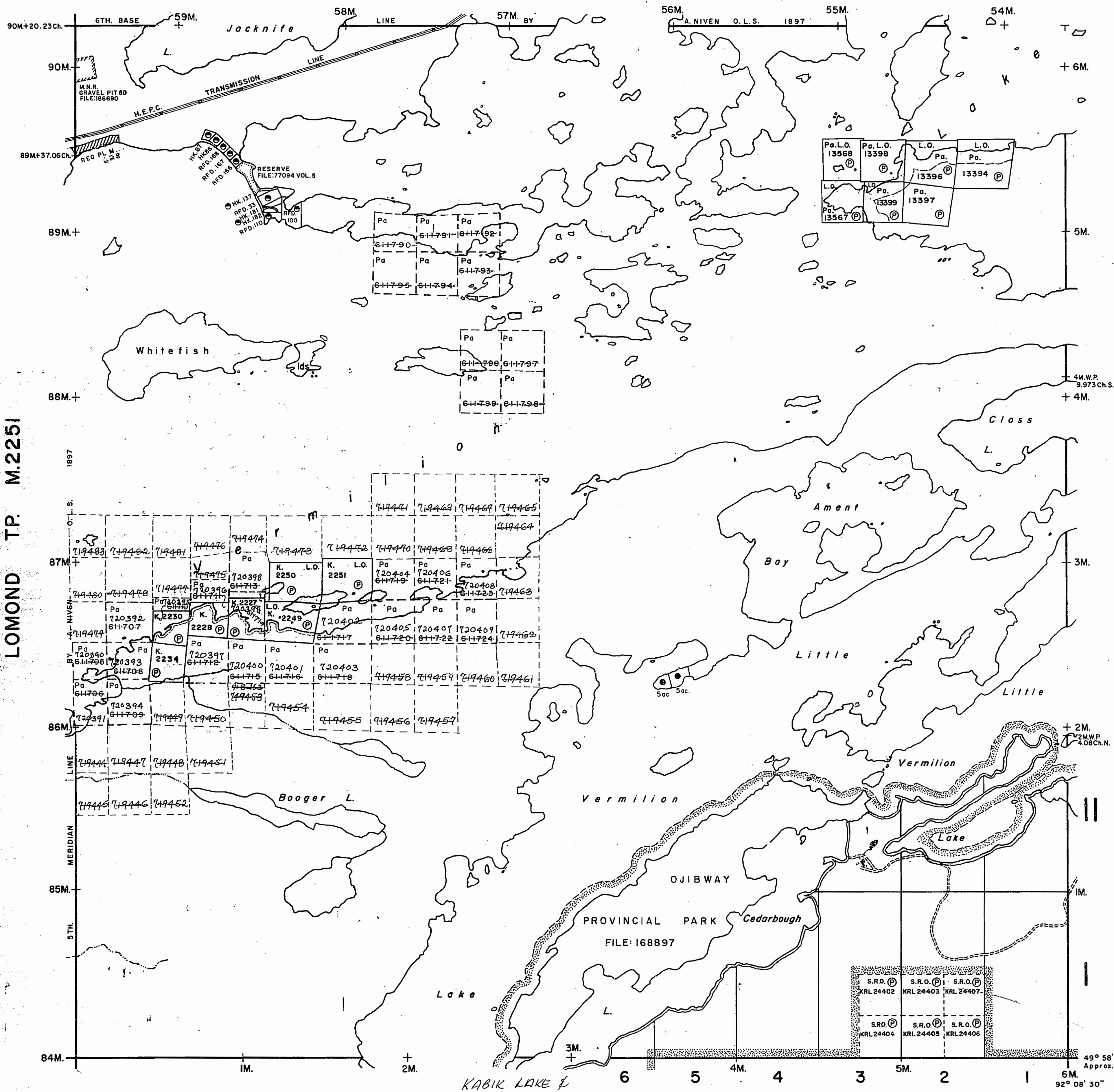

NOTES

400' surface rights reservation along the shores of all lakes and rivers.

Oct. 14, 1983
Apr. 25, 1984
Nov. 23/84

LEGEND

- PATENTED LAND (P or ●*)
 - PATENTED FOR SURFACE RIGHTS ONLY (●*)
 - LEASE (L)
 - LICENSE OF OCCUPATION (L.O.)
 - CROWN LAND SALES (C.S.)
 - LOCATED LAND (Loc.)
 - CANCELLED (C)
 - MINING RIGHTS ONLY (M.R.O.)
 - SURFACE RIGHTS ONLY (S.R.O.)
 - HIGHWAY & ROUTE NO. (17)
 - ROADS (—)
 - TRAILS (---)
 - RAILWAYS (—+—)
 - POWER LINES (—+—+—)
 - MARSH OR MUSKEG (—+—+—+—)
 - MINES (X)
- *used only with summer resort locations or when space is limited

TOWNSHIP OF

VERMILION

DISTRICT OF
KENORA

PATRICIA
MINING DIVISION

SCALE: 1 INCH = 40 CHAINS (1 1/2 MILES)

DR. A. T. V.
DATE JUN 28/72

PLAN NO. **M.2272**

ONTARIO
MINISTRY OF NATURAL RESOURCES
SURVEYS AND MAPPING BRANCH

62887

April 19/80
 July 24/80
 Sept. 5/80
 Jan 23/81
 Nov 12/81 C

93 H2928 ©

REFERENCES

AREAS WITHDRAWN FROM DISPOSITION

- M.R.O. - MINING RIGHTS ONLY
- S.R.O. - SURFACE RIGHTS ONLY
- M.+S. - MINING AND SURFACE RIGHTS

Description Order No. Date Disposition File

- ① M.N.R. RESERVE FILE NO 77094 VOL. 5
- REMOTE COTTAGE ②

SAND AND GRAVEL

- ③ M.N.R. GRAVEL PIT 60 FILE NO 186690

April 1986
 May 1986
 Oct 23/86
 Dec 31/86
 May 28/87
 June 13/87
 July 23/87
 Nov 12/87
 Jan 22/90
 March 2, 90
 Nov. 12/91 ©

FOREST ACTIVITY INFORMATION
 THIS TOWNSHIP/AREA FALLS WITHIN THE

CROWN FOREST MGT. UNIT
 AND MAY BE SUBJECT TO FORESTRY OPERATIONS.
 THE M.N.R. UNIT FORESTER FOR THIS AREA CAN BE CONTACTED AT:

P.O. BOX 309
 SIOUX LOOKOUT, ONTARIO P0V 2T0
 (807) 737-1140

VERMILION ADD'L. TP. G-2886

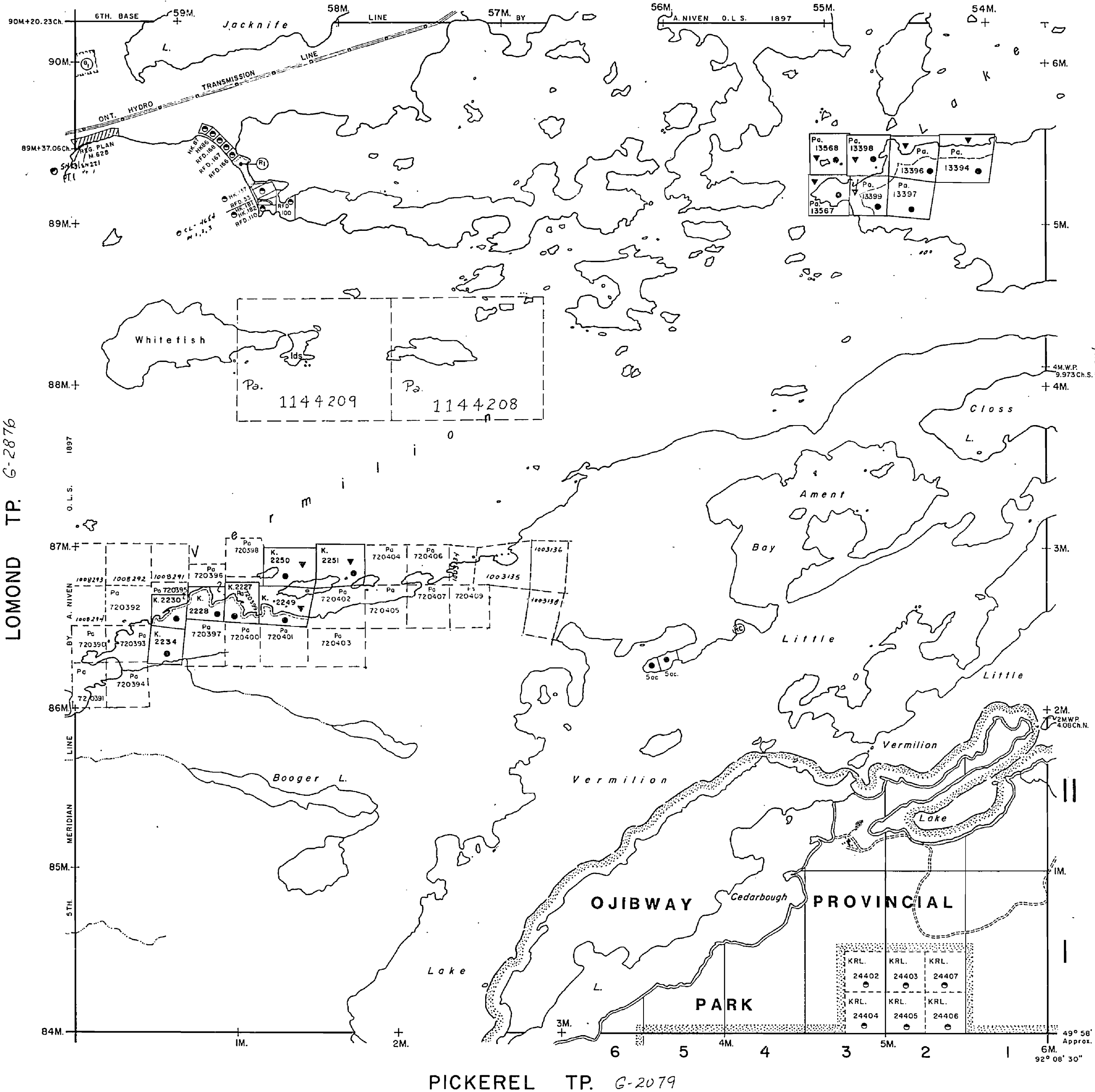

LEGEND

- HIGHWAY AND ROUTE No.
- OTHER ROADS
- TRAILS
- SURVEYED LINES:
 TOWNSHIPS, BASE LINES, ETC.
- LOTS, MINING CLAIMS, PARCELS, ETC.
- UNSURVEYED LINES:
 LOT LINES
- PARCEL BOUNDARY
- MINING CLAIMS ETC.
- RAILWAY AND RIGHT OF WAY
- UTILITY LINES
- NON-PERENNIAL STREAM
- FLOODING OR FLOODING RIGHTS
- SUBDIVISION OR COMPOSITE PLAN
- RESERVATIONS
- ORIGINAL SHORELINE
- MARSH OR MUSKEG
- MINES
- TRAVERSE MONUMENT

DISPOSITION OF CROWN LANDS

| TYPE OF DOCUMENT | SYMBOL |
|---------------------------------|--------|
| PATENT, SURFACE & MINING RIGHTS | ● |
| " SURFACE RIGHTS ONLY | ○ |
| " MINING RIGHTS ONLY | ◐ |
| LEASE, SURFACE & MINING RIGHTS | ■ |
| " SURFACE RIGHTS ONLY | □ |
| " MINING RIGHTS ONLY | ◑ |
| LICENCE OF OCCUPATION | ▼ |
| ORDER-IN-COUNCIL | OC |
| RESERVATION | ⊙ |
| CANCELLED | ⊖ |
| SAND & GRAVEL | ⊕ |

NOTE: MINING RIGHTS IN PARCELS PATENTED PRIOR TO MAY 6, 1919, VESTED IN ORIGINAL PATENTEE BY THE PUBLIC LANDS ACT, R.S.O. 1970, CHAP. 380, SEC. 63, SUBSEC 1.

SCALE: 1 INCH = 40 CHAINS

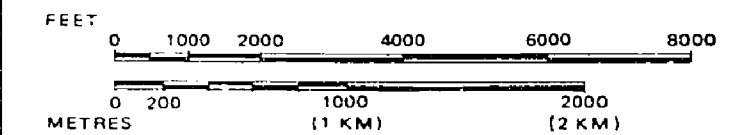

November 25/93

TOWNSHIP

VERMILION
 M.N.R. ADMINISTRATIVE DISTRICT
 SIOUX LOOKOUT
 MINING DIVISION
 PATRICIA
 LAND TITLES / REGISTRY DIVISION
 KENORA

Ministry of Natural Resources
 Land Management Branch

Date MAY 1985

Number
G-2887

THE INFORMATION THAT APPEARS ON THIS MAP HAS BEEN COMPILED FROM VARIOUS SOURCES, AND ACCURACY IS NOT GUARANTEED. THOSE WISHING TO STAKE MINING CLAIMS SHOULD CONSULT WITH THE MINING RECORDER, MINISTRY OF NORTHERN DEVELOPMENT AND MINES, FOR ADDITIONAL INFORMATION ON THE STATUS OF THE LANDS SHOWN HEREON.

C-5881

April 19/90
Sept 5/90
Jan 23/91
Nov 12/91
Nov 27/91
93 May 28
Aug 1/93
Nov 19/93

RECORDED
JUL 1-1 1996
Receipt

REFERENCES

AREAS WITHDRAWN FROM DISPOSITION

- M.R.O. - MINING RIGHTS ONLY
- S.R.O. - SURFACE RIGHTS ONLY
- M.+S. - MINING AND SURFACE RIGHTS

| Description | Order No. | Date | Disposition | File |
|----------------|---------------|--------|-------------|------|
| M.N.R. RESERVE | FILE N° 77094 | VOL. 5 | | |
| REMOTE COTTAGE | | | | |

SAND AND GRAVEL

M.N.R. GRAVEL, PT 60 FILE N° 186680

April 1, 1986
 May 12, 1986
 Oct 23, 1986
 Dec 31, 1986
 May 28, 1987
 June 13, 1987
 Oct 23, 1987
 Nov 7, 1987
 Aug 2, 1989
 Nov 3, 1989
 Jan 16, 1990
 March 5, 1990
 Nov 12, 1990
 Jun 23, 1991

FOREST ACTIVITY INFORMATION

THIS TOWNSHIP/AREA FALLS WITHIN THE CROWN FOREST MGT. UNIT AND MAY BE SUBJECT TO FORESTRY OPERATIONS. THE M.N.R. UNIT FORESTER FOR THIS AREA CAN BE CONTACTED AT:
 P.O. BOX 309
 SIOUX LOOKOUT, ONTARIO P0V 2T0
 (807) 737-1140

VERMILION ADD'L TP. G-2886

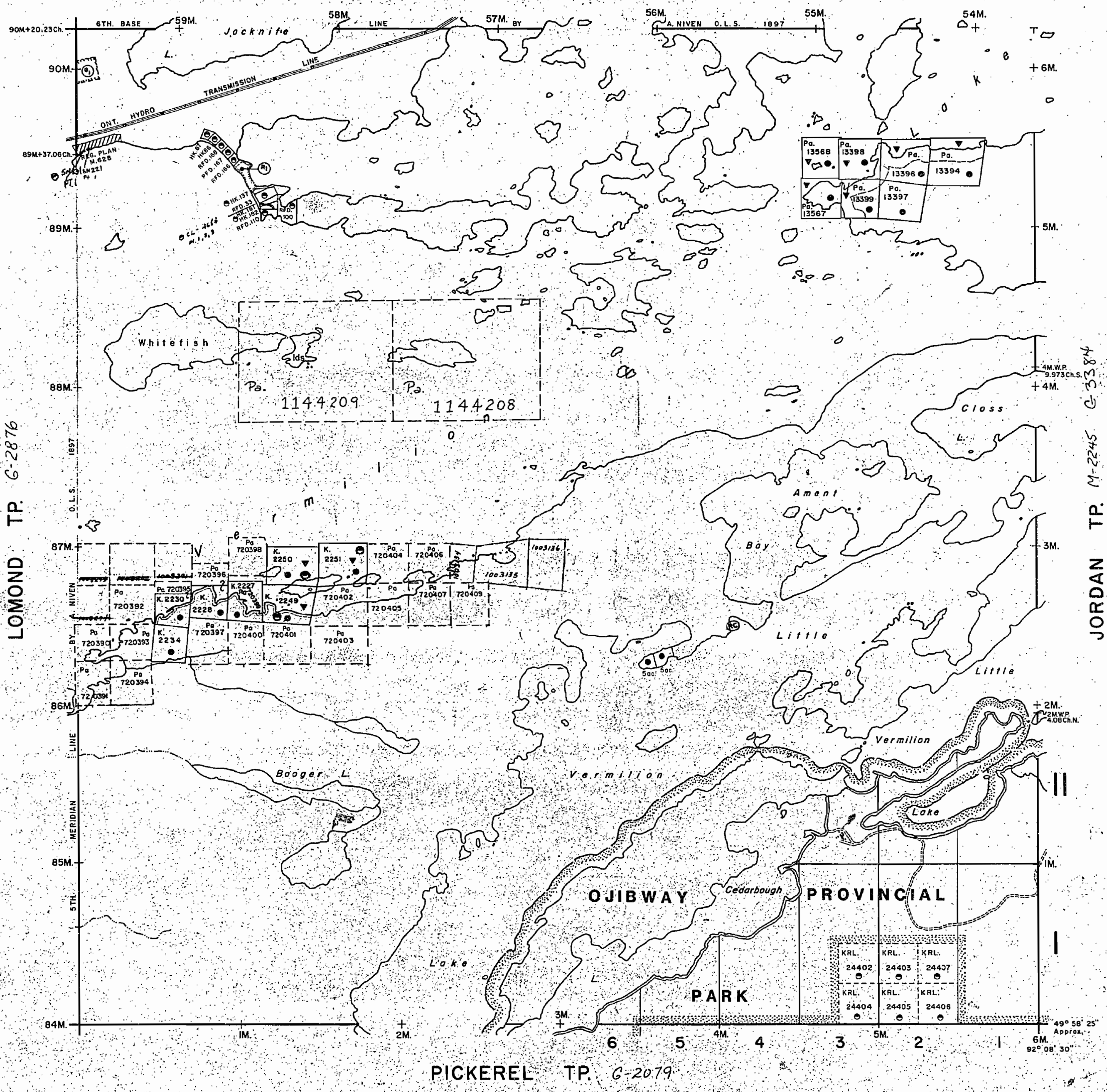

LEGEND

- HIGHWAY AND ROUTE No. [Symbol]
- OTHER ROADS [Symbol]
- TRAILS [Symbol]
- SURVEYED LINES: TOWNSHIPS, BASE LINES, ETC. [Symbol]
- LOTS, MINING CLAIMS, PARCELS, ETC. [Symbol]
- UNSURVEYED LINES: LOT LINES [Symbol]
- PARCEL BOUNDARY [Symbol]
- MINING CLAIMS ETC. [Symbol]
- RAILWAY AND RIGHT OF WAY [Symbol]
- UTILITY LINES [Symbol]
- NON-PERENNIAL STREAM [Symbol]
- FLOODING OR FLOODING RIGHTS [Symbol]
- SUBDIVISION OR COMPOSITE PLAN RESERVATIONS [Symbol]
- ORIGINAL SHORELINE [Symbol]
- MARSH OR MUSKEG [Symbol]
- MINES [Symbol]
- TRAVERSE MONUMENT [Symbol]

DISPOSITION OF CROWN LANDS

| TYPE OF DOCUMENT | SYMBOL |
|---------------------------------|--------|
| PATENT, SURFACE & MINING RIGHTS | ● |
| " SURFACE RIGHTS ONLY | ○ |
| " MINING RIGHTS ONLY | ◐ |
| LEASE, SURFACE & MINING RIGHTS | ■ |
| " SURFACE RIGHTS ONLY | ◑ |
| " MINING RIGHTS ONLY | ◒ |
| LICENCE OF OCCUPATION | ◔ |
| ORDER-IN-COUNCIL | ◕ |
| RESERVATION | ◖ |
| CANCELLED | ◗ |
| SAND & GRAVEL | ◘ |

NOTE: MINING RIGHTS IN PARCELS PATENTED PRIOR TO MAY 6, 1913, VESTED IN ORIGINAL PATENTEE BY THE PUBLIC LANDS ACT, R.S.O. 1970, CHAP. 380, SEC. 63, SUBSEC 1.

SCALE: 1 INCH = 40 CHAINS

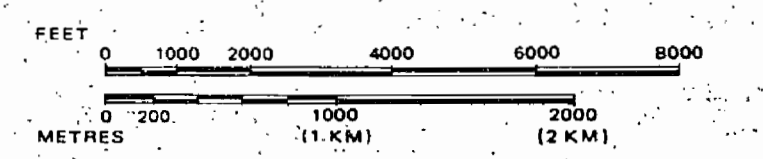

TOWNSHIP

VERMILION
 M.N.R. ADMINISTRATIVE DISTRICT
 SIOUX LOOKOUT
 MINING DIVISION
 PATRICIA
 LAND TITLES / REGISTRY DIVISION
 KENORA



Ministry of Natural Resources
 Land Management Branch

Date MAY 1985

Number G-2887

THE INFORMATION THAT APPEARS ON THIS MAP HAS BEEN COMPILED FROM VARIOUS SOURCES AND ACCURACY IS NOT GUARANTEED. THOSE WISHING TO STAKE MINING CLAIMS SHOULD CONSULT WITH THE MINING RECORDER, MINISTRY OF NORTHERN DEVELOPMENT AND MINES, FOR ADDITIONAL INFORMATION ON THE STATUS OF THE LANDS SHOWN HEREON.

C-5881

C-5881

G-5887

VERMILION TWP

G-5887

April 19/90
 July 24/90
 Sept. 5/90
 Jan 23/91
 Nov 21/91
 Oct 27/92
 93 May 28
 Aug 1/93
 Nov 1/93
 Nov 1/93
 May 29, 1996

REFERENCES

AREAS WITHDRAWN FROM DISPOSITION

- M.R.O. - MINING RIGHTS ONLY
- S.R.O. - SURFACE RIGHTS ONLY
- M.+S. - MINING AND SURFACE RIGHTS

| Description | Order No. | Date | Disposition | File |
|--------------------------------------|-----------|------|-------------|------|
| M.N.R. RESERVE, FILE NO 77094 VOL. 5 | | | | |
| REMOTE COTTAGE | | | | |

M.N.R. RESERVE, FILE NO 77094 VOL. 5
 REMOTE COTTAGE

SAND AND GRAVEL

M.N.R. GRAVEL PIT 60 FILE NO 186690

April 1, 1986
 May 13, 86
 Oct 23, 86
 Dec 31, 86
 May 29, 87
 June 13, 87
 Oct 21, 87
 Nov 17, 87
 Aug 2, 89
 Nov 3, 89
 Jan 16, 90
 Jan 22, 90
 March 5, 90
 Nov. 12, 90
 Jan 24, 91

FOREST ACTIVITY INFORMATION

THIS TOWNSHIP/AREA FALLS WITHIN THE

CROWN FOREST MGT. UNIT

AND MAY BE SUBJECT TO FORESTRY OPERATIONS.
 THE M.N.R. UNIT FORESTER FOR THIS AREA CAN BE CONTACTED AT:
 P.O. BOX 309
 SIOUX LOOKOUT, ONTARIO P0V 2T0
 (807) 737-1140

VERMILION ADDTL. TP. G-2886

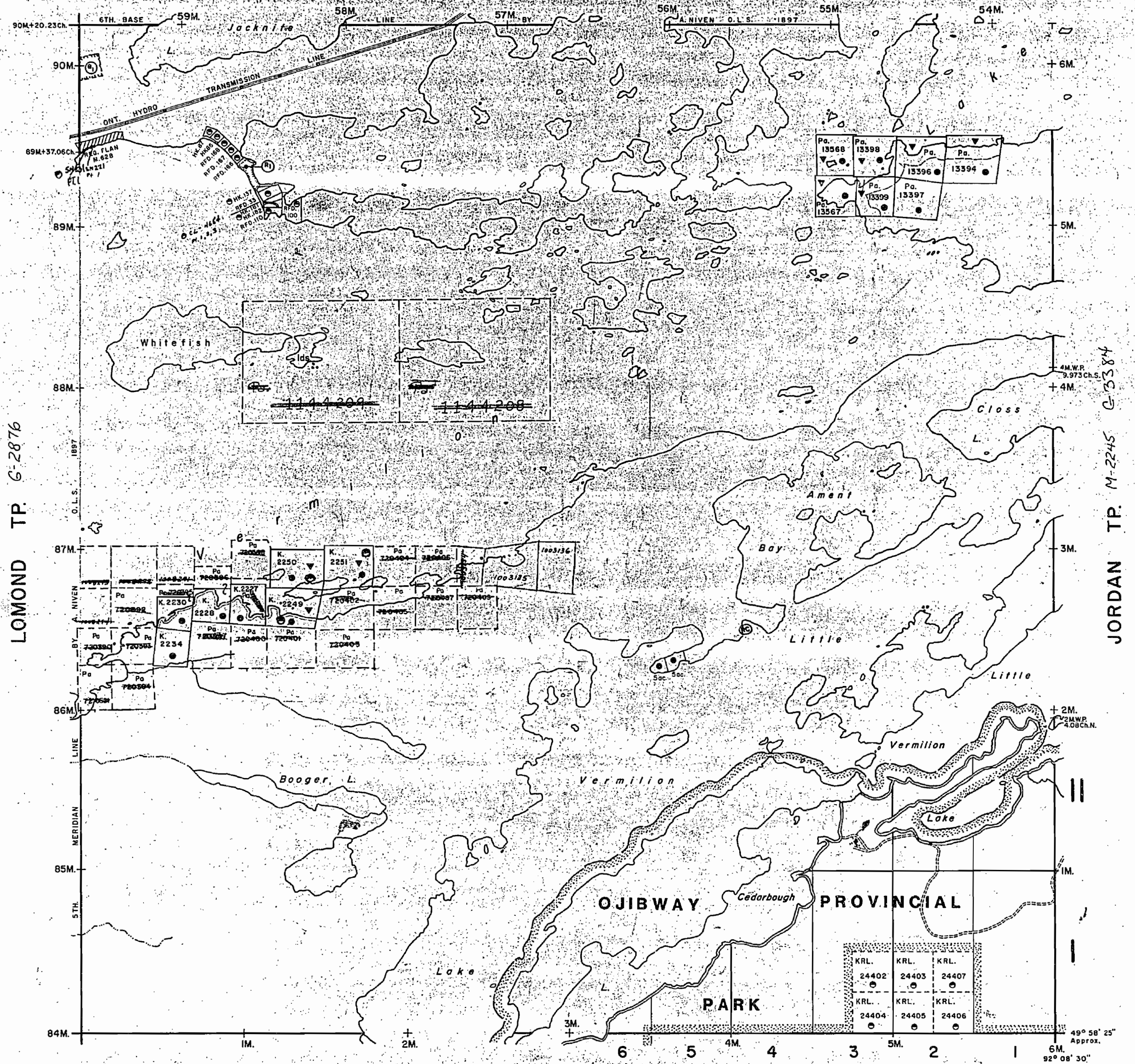

LOMOND TP. G-2876

JORDAN TP. M-2245 G-3384

PICKEREL TP. G-2079

LEGEND

- HIGHWAY AND ROUTE No. [Symbol]
- OTHER ROADS [Symbol]
- TRAILS [Symbol]
- SURVEYED LINES:
 - TOWNSHIPS, BASE LINES, ETC. [Symbol]
 - LOTS, MINING CLAIMS, PARCELS, ETC. [Symbol]
- UNSURVEYED LINES:
 - LOT LINES [Symbol]
 - PARCEL BOUNDARY [Symbol]
 - MINING CLAIMS ETC. [Symbol]
- RAILWAY AND RIGHT OF WAY [Symbol]
- UTILITY LINES [Symbol]
- NON-PERENNIAL STREAM [Symbol]
- FLOODING OR FLOODING RIGHTS [Symbol]
- SUBDIVISION OR COMPOSITE PLAN [Symbol]
- RESERVATIONS [Symbol]
- ORIGINAL SHORELINE [Symbol]
- MARSH OR MUSKEG [Symbol]
- MINES [Symbol]
- TRAVERSE MONUMENT [Symbol]

DISPOSITION OF CROWN LANDS

| TYPE OF DOCUMENT | SYMBOL |
|---------------------------------|--------|
| PATENT, SURFACE & MINING RIGHTS | ● |
| " SURFACE RIGHTS ONLY | ○ |
| " MINING RIGHTS ONLY | ○ |
| LEASE, SURFACE & MINING RIGHTS | ■ |
| " SURFACE RIGHTS ONLY | □ |
| " MINING RIGHTS ONLY | □ |
| LICENCE OF OCCUPATION | ◀ |
| ORDER-IN-COUNCIL | ○ |
| RESERVATION | ○ |
| CANCELLED | ○ |
| SAND & GRAVEL | ○ |

NOTE: MINING RIGHTS IN PARCELS PATENTED PRIOR TO MAY 6, 1913, VESTED IN ORIGINAL PATENTEE BY THE PUBLIC LANDS ACT, R.S.O. 1970, CHAP. 380, SEC. 63, SUBSEC. 1.

SCALE: 1 INCH = 40 CHAINS

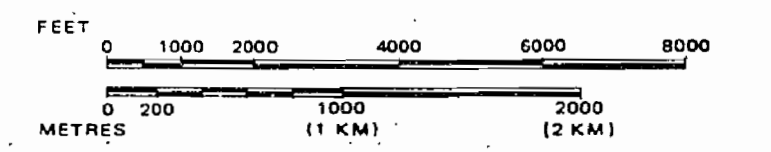

TOWNSHIP

VERMILION
 M.N.R. ADMINISTRATIVE DISTRICT
 SIOUX LOOKOUT
 MINING DIVISION
 PATRICIA
 LAND TITLES / REGISTRY DIVISION
 KENORA



Ministry of Natural Resources
 Land Management Branch

Date MAY 1985

Number

G-2887

G-5887

VERMILION TWP

G-5887

THE INFORMATION THAT APPEARS ON THIS MAP HAS BEEN COMPILED FROM VARIOUS SOURCES, AND ACCURACY IS NOT GUARANTEED. THOSE WISHING TO STAKE MINING CLAIMS SHOULD CONSULT WITH THE MINING RECORDER, MINISTRY OF NORTHERN DEVELOPMENT AND MINES, FOR ADDITIONAL INFORMATION ON THE STATUS OF THE LANDS SHOWN HEREON.

April 19/80
 July 24/80
 Sept. 5/80
 Jan 23/81
 Nov 12/81

REFERENCES

AREAS WITHDRAWN FROM DISPOSITION

- M.R.O. - MINING RIGHTS ONLY
- S.R.O. - SURFACE RIGHTS ONLY
- M.+S. - MINING AND SURFACE RIGHTS

| Description | Order No. | Date | Disposition | File |
|--------------------|---------------|--------|-------------|------|
| (M) M.N.R. RESERVE | FILE N° 77094 | VOL. 5 | | |
| REMOTE COTTAGE | (R) | | | |

(M) M.N.R. RESERVE FILE N° 77094 VOL. 5
 REMOTE COTTAGE (R)

SAND AND GRAVEL

(G) M.N.R. GRAVEL PIT 60 FILE N° 186690

April 1, 1986
 May 13, 86
 Oct 23, 86
 Dec 31, 86
 May 28, 87
 June 13, 87
 Oct 23, 87
 Nov 1, 87
 Nov 21, 87
 Jan 10, 88
 Jan 22, 88
 March 5, 88
 Nov. 12, 88

FOREST ACTIVITY INFORMATION
 THIS TOWNSHIP/AREA FALLS WITHIN THE

CROWN FOREST MGT. UNIT
 AND MAY BE SUBJECT TO FORESTRY OPERATIONS.
 THE M.N.R. UNIT FORESTER FOR THIS AREA CAN BE CONTACTED AT:
 P.O. BOX 309
 SIOUX LOOKOUT, ONTARIO P0V 2T0
 (807) 737-1140

VERMILION ADD'L. TP. G-2886

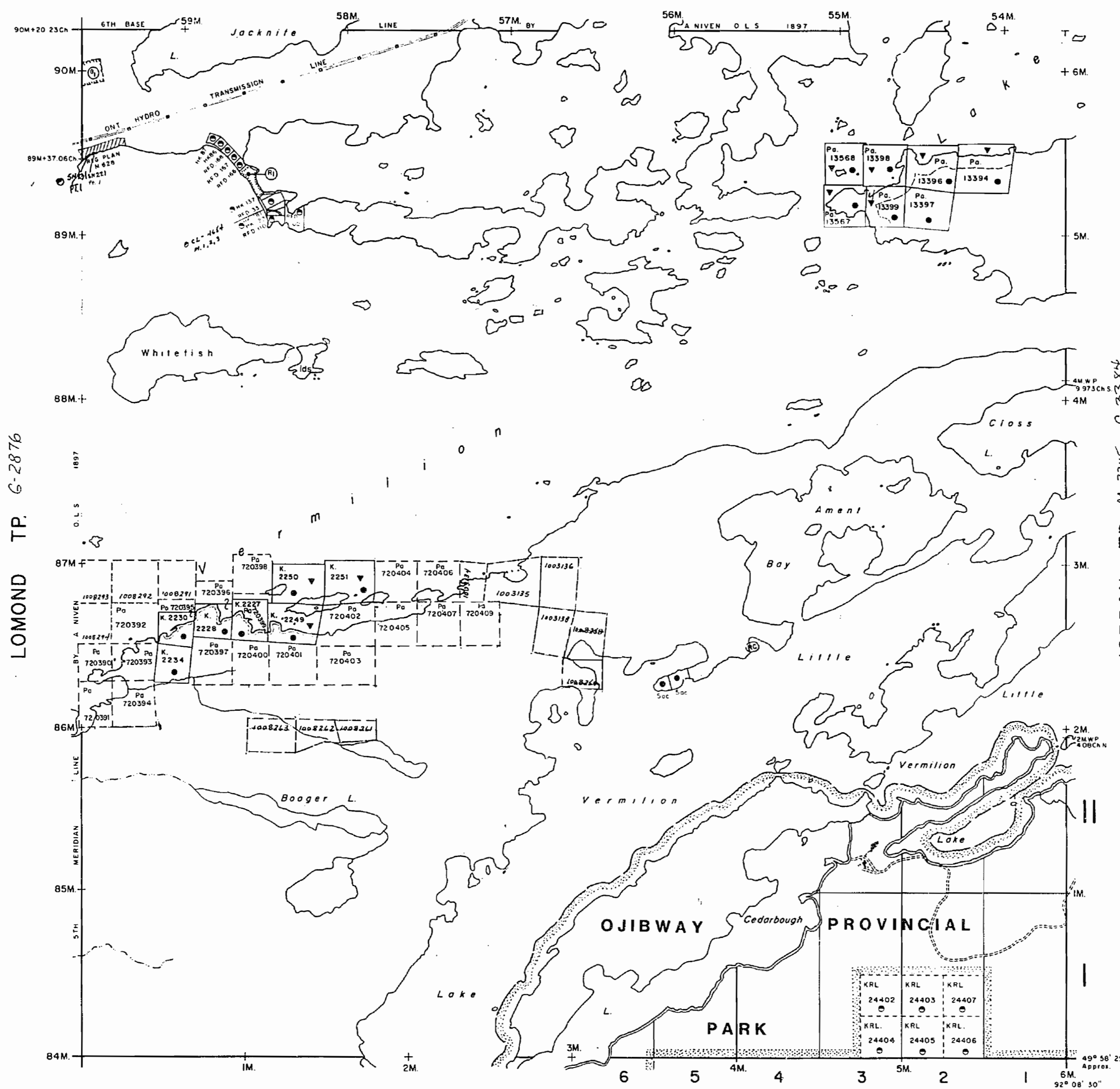

LEGEND

- HIGHWAY AND ROUTE No.
- OTHER ROADS
- TRAILS
- SURVEYED LINES:
 - TOWNSHIPS, BASE LINES, ETC.
 - LOTS, MINING CLAIMS, PARCELS, ETC.
- UNSURVEYED LINES:
 - LOT LINES
 - PARCEL BOUNDARY
 - MINING CLAIMS ETC.
- RAILWAY AND RIGHT OF WAY
- UTILITY LINES
- NON-PERENNIAL STREAM
- FLOODING OR FLOODING RIGHTS
- SUBDIVISION OR COMPOSITE PLAN
- RESERVATIONS
- ORIGINAL SHORE LINE
- MARSH OR MUSKOG
- MINES
- TRAVERSE MONUMENT

DISPOSITION OF CROWN LANDS

| TYPE OF DOCUMENT | SYMBOL |
|---------------------------------|--------|
| PATENT, SURFACE & MINING RIGHTS | ● |
| " SURFACE RIGHTS ONLY | ○ |
| " MINING RIGHTS ONLY | ◐ |
| LEASE, SURFACE & MINING RIGHTS | ■ |
| " SURFACE RIGHTS ONLY | □ |
| " MINING RIGHTS ONLY | ◑ |
| LICENCE OF OCCUPATION | ▼ |
| ORDER-IN COUNCIL | OC |
| RESERVATION | ⊙ |
| CANCELLED | ⊖ |
| SAND & GRAVEL | ⊙ |

NOTE: MINING RIGHTS IN PARCELS PATENTED PRIOR TO MAY 6, 1913, VESTED IN ORIGINAL PATENTEE BY THE PUBLIC LANDS ACT, R.S.O. 1910, CHAP. 380, SEC. 63, SUBSEC. 1

SCALE: 1 INCH = 40 CHAINS

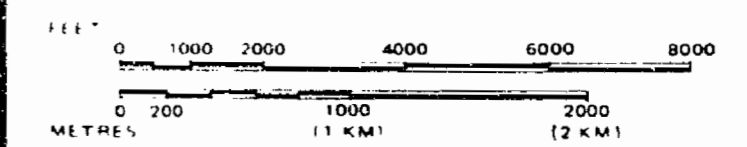

TOWNSHIP

VERMILION
 M.N.R. ADMINISTRATIVE DISTRICT
 SIOUX LOOKOUT
 MINING DIVISION
 PATRICIA
 LAND TITLES / REGISTRY DIVISION
 KENORA

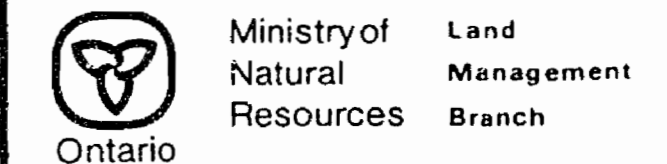

Date: MAY 1985

Number
G-2887

THE INFORMATION THAT APPEARS ON THIS MAP HAS BEEN COMPILED FROM VARIOUS SOURCES, AND ACCURACY IS NOT GUARANTEED. THOSE WISHING TO STAKE MINING CLAIMS SHOULD CONSULT WITH THE MINING RECORDER, MINISTRY OF NORTHERN DEVELOPMENT AND MINES, FOR ADDITIONAL INFORMATION ON THE STATUS OF THE LANDS SHOWN HEREON.

M.2272

VERMILION TWP.

PATRICIA MINING DIVISION.
DISTRICT OF KENORA - PATRICIA PORTION.

—Scale, 40 chains to an inch.—

VERMILION ADDTL.

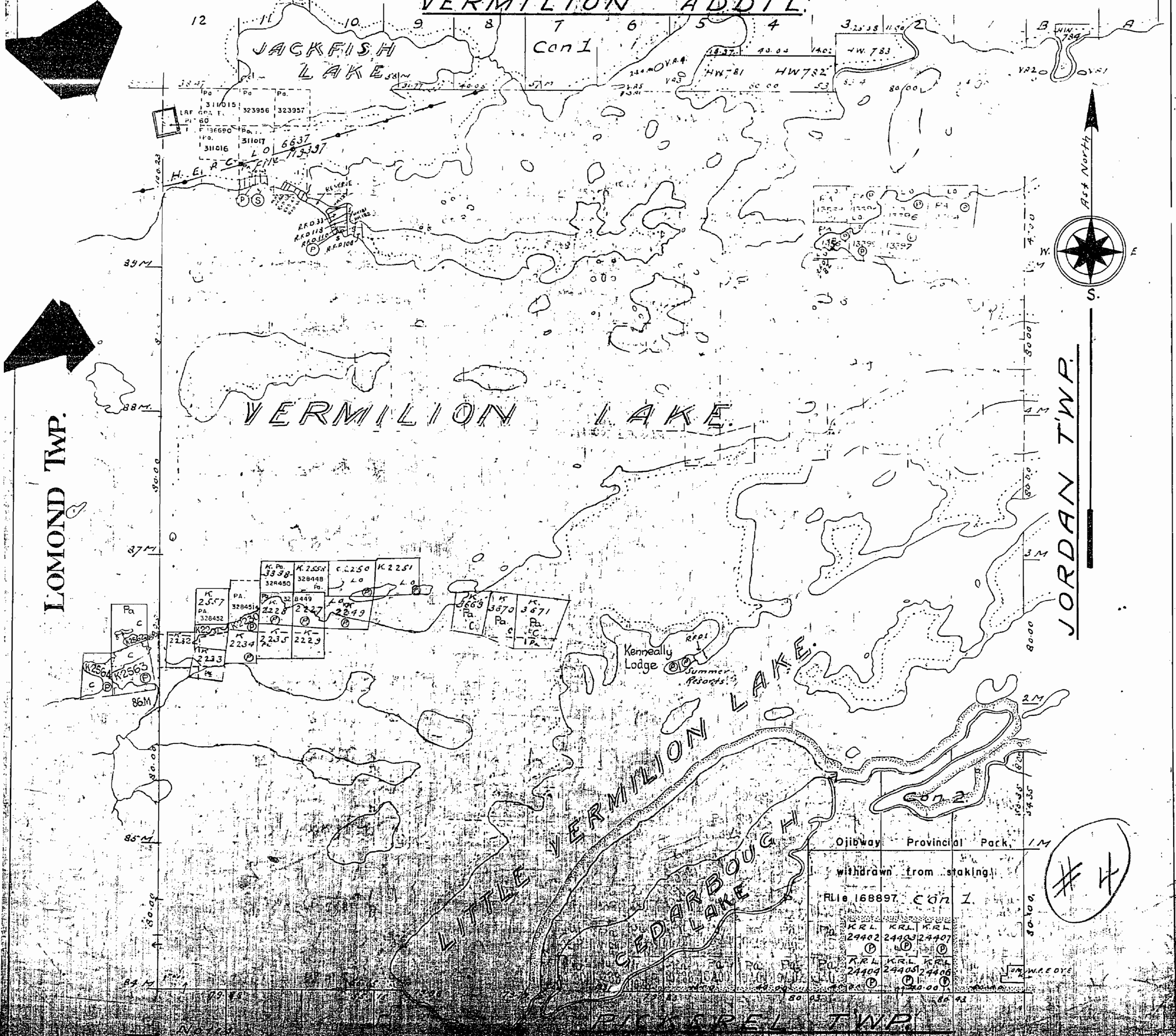

JORDAN TWP.

LOMOND TWP.

Ojibway Provincial Park

withdrawn from staking

RLie 168897 Con 1.

| | | |
|-------|-------|-------|
| KRL | KRL | KRL |
| 24402 | 24403 | 24407 |
| ⊙ | ⊙ | ⊙ |
| KRL | KRL | KRL |
| 24404 | 24405 | 24406 |
| ⊙ | ⊙ | ⊙ |

#4

G-2887

REFERENCES

AREAS WITHDRAWN FROM DISPOSITION

- M.R.O. - MINING RIGHTS ONLY
- S.R.O. - SURFACE RIGHTS ONLY
- M.+S. - MINING AND SURFACE RIGHTS

Description Order No. Date Disposition File

① M.N.R. RESERVE FILE N° 77094 VOL. 5
 REMOTE COTTAGE ②

SAND AND GRAVEL

③ M.N.R. GRAVEL PIT 60 FILE N° 186690

April 1, 1986
 May 13, 86
 Oct 23, 86
 Dec 31, 86
 May 28, 87
 Jul 13, 87
 Oct 23, 87
 Mar 7, 89
 Aug 2, 89
 Nov 3, 89
 Jan 16, 90
 Jan 22, 90
 March 5, 90
 Nov. 12, 91. ©

VERMILION ADD'L. TP. M-2273

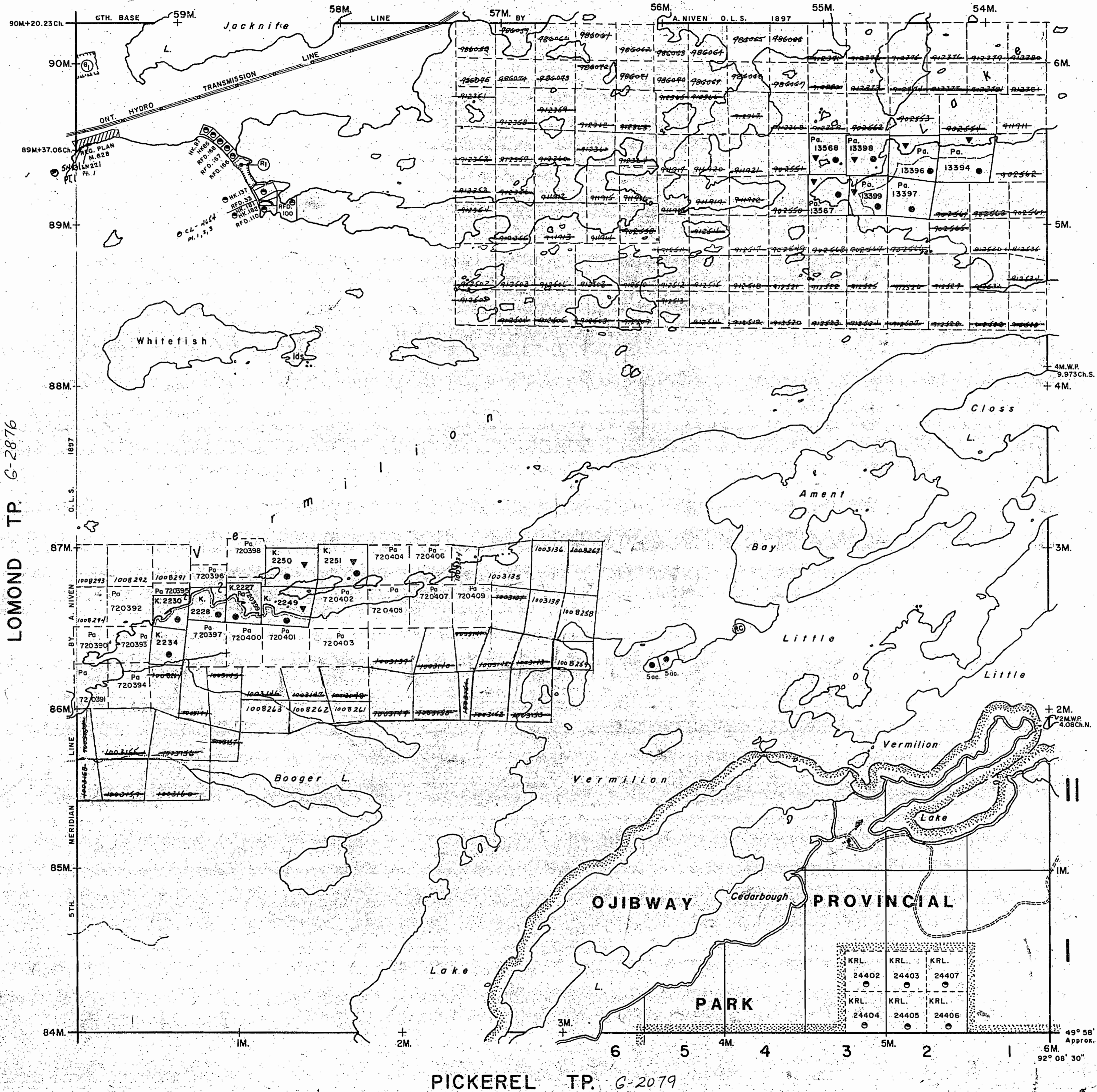

LEGEND

- HIGHWAY AND ROUTE No.
- OTHER ROADS
- TRAILS
- SURVEYED LINES:
 - TOWNSHIPS, BASE LINES, ETC.
 - LOTS, MINING CLAIMS, PARCELS, ETC.
- UNSURVEYED LINES:
 - LOT LINES
 - PARCEL BOUNDARY
 - MINING CLAIMS ETC.
- RAILWAY AND RIGHT OF WAY
- UTILITY LINES
- NON-PERENNIAL STREAM
- FLOODING OR FLOODING RIGHTS
- SUBDIVISION OR COMPOSITE PLAN
- RESERVATIONS
- ORIGINAL SHORELINE
- MARSH OR MUSKEG
- MINES
- TRAVERSE MONUMENT

DISPOSITION OF CROWN LANDS

| TYPE OF DOCUMENT | SYMBOL |
|---------------------------------|--------|
| PATENT, SURFACE & MINING RIGHTS | ● |
| " SURFACE RIGHTS ONLY | ○ |
| " MINING RIGHTS ONLY | ◐ |
| LEASE, SURFACE & MINING RIGHTS | ■ |
| " SURFACE RIGHTS ONLY | □ |
| " MINING RIGHTS ONLY | ◻ |
| LICENCE OF OCCUPATION | ▼ |
| ORDER-IN-COUNCIL | OC |
| RESERVATION | ⊙ |
| CANCELLED | ⊖ |
| SAND & GRAVEL | ⊕ |

NOTE: MINING RIGHTS IN PARCELS PATENTED PRIOR TO MAY 6, 1913, VESTED IN ORIGINAL PATENTEE BY THE PUBLIC LANDS ACT, R.S.O. 1970, CHAP. 380, SEC. 63, SUBSEC. 1.

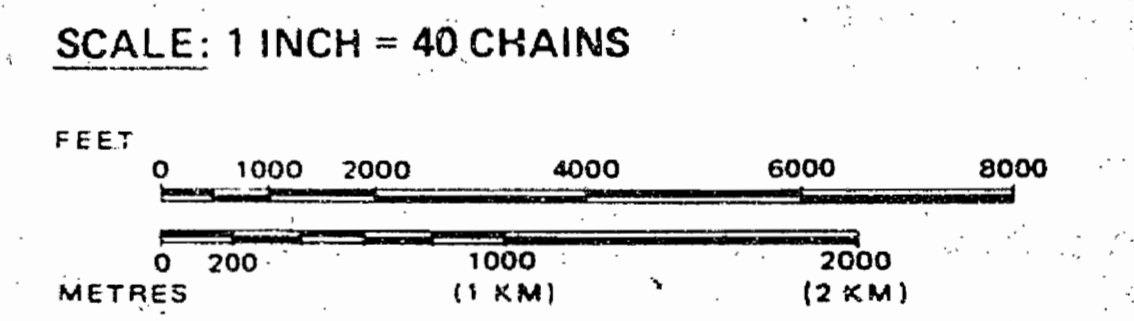

TOWNSHIP
VERMILION
 M.N.R. ADMINISTRATIVE DISTRICT
 SIOUX LOOKOUT
 MINING DIVISION
 PATRICIA
 LAND TITLES / REGISTRY DIVISION
 KENORA

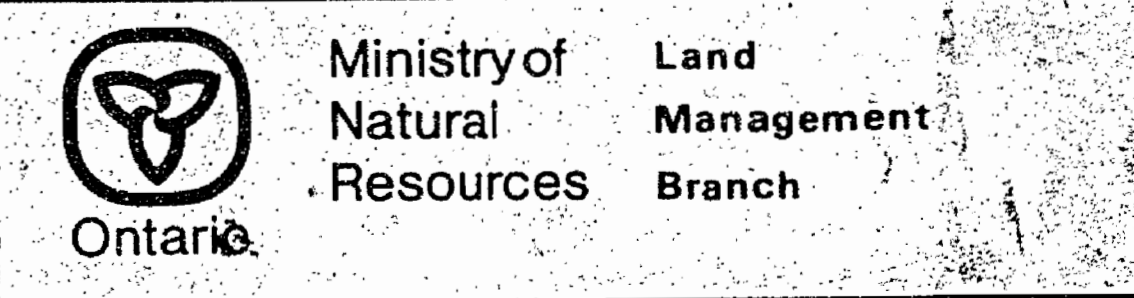

Date MAY 1985 Number **G-2887**

THE APPEAL HAS FROM AND GUARANTEEING C SULT RECO N ORT MENT DITIO ON T LAND

M.2272

PLAN OF VERMILION TWP.

PATRICIA MINING DIVISION.
DISTRICT OF KENORA - PATRICIA PORTION.

Scale 40 chains to an inch.

VERMILION ADDTL.

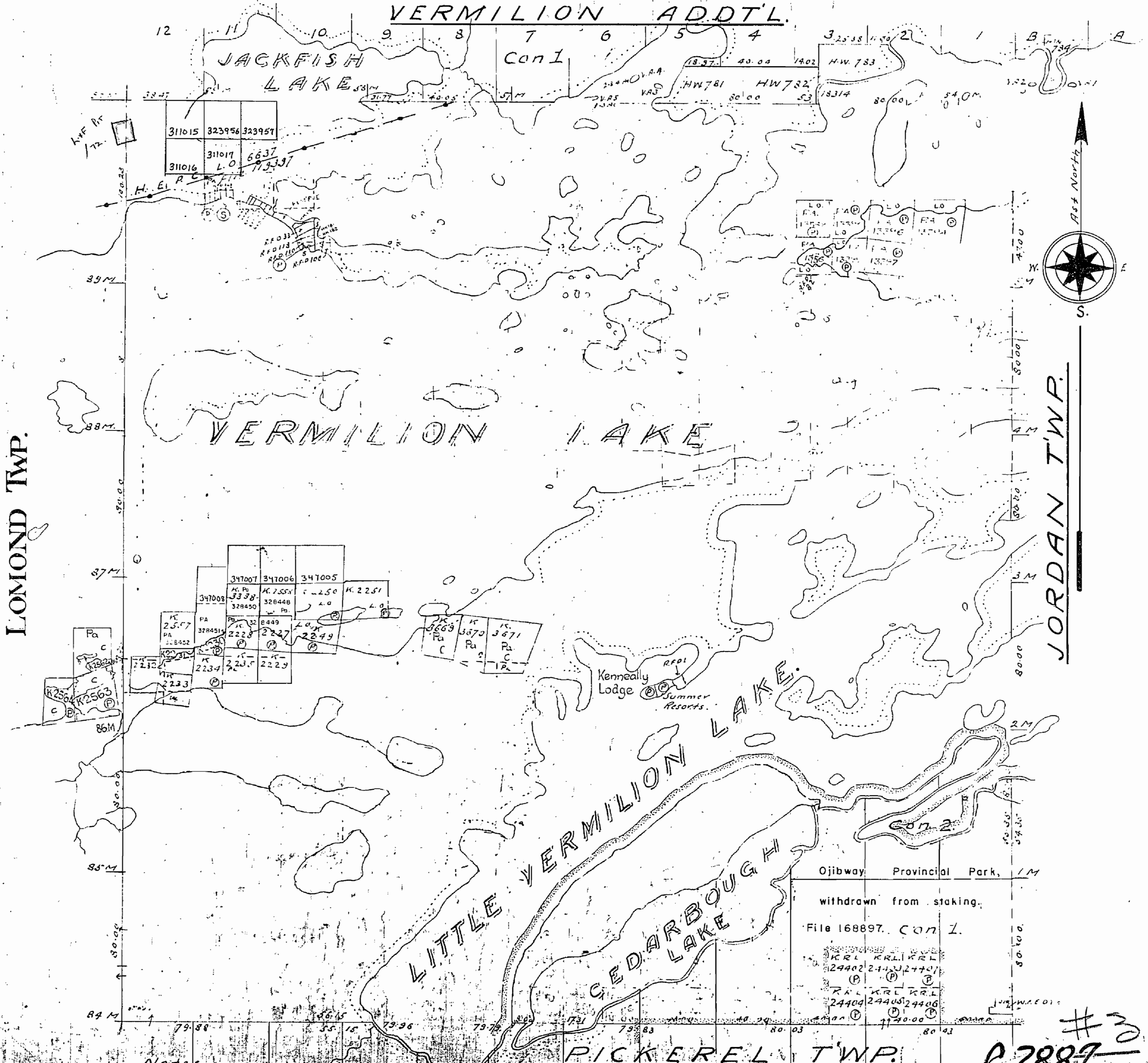

LOMOND TWP.

JORDAN TWP.

PICKEREL TWP.

Notes:

Railways shown as
 Road Highways
 Gravel
 Highways Road No.
 Other Road
 Trails Path
 Telephone and Telegraph Lines
 Electric Power Lines
 Surface Elevations by D.M. Dept. of Lands and Surveys

Non-perennial streams
 Springs
 Boulders
 Swamps
 Areas marked with a circle and a dot are patented
 Areas marked with a circle and a cross are leased
 Areas marked with a circle and a square are held under
 license of occupation

Ojibway Provincial Park, 1 M
 withdrawn from staking.
 File 168897. Con 1.
 KRL KRL KRL
 24402 24403 24404
 KRL KRL KRL
 24405 24406 24407
 1140.00

#3
 C 2887
 M 2272

PLAN OF VERMILION TWP.

M-2272

PATRICIA MINING DIVISION
DISTRICT OF KENORA - PATRICIA PORTION

Scale 40 chains to an inch

VERMILION ADDTL.

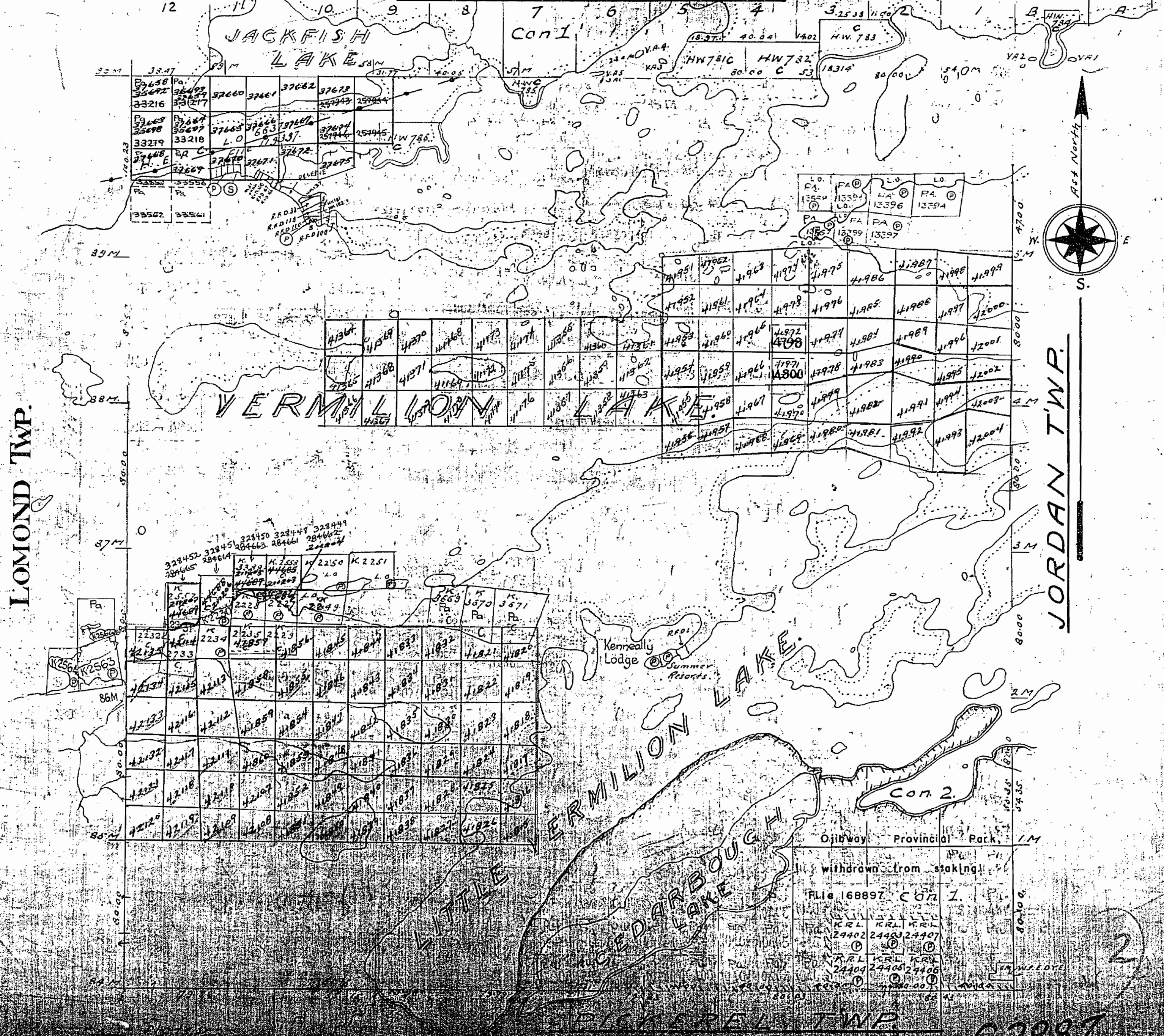

M-2272

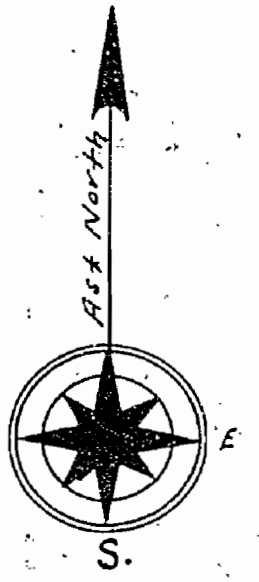

JORDAN TWP.

withdrawn from staking
File 168897 Con 1
KRL KRL KRL
24402 24403 24407
KRL KRL KRL
24404 24405 24406

G2887

M-2272

M-2272

PLAN OF VERMILION TWP.

PATRICIA MINING DIVISION.
DISTRICT OF KENORA.— PATRICIA PORTION.

—Scale 40 chains to an inch.—

VERMILION ADDTL.

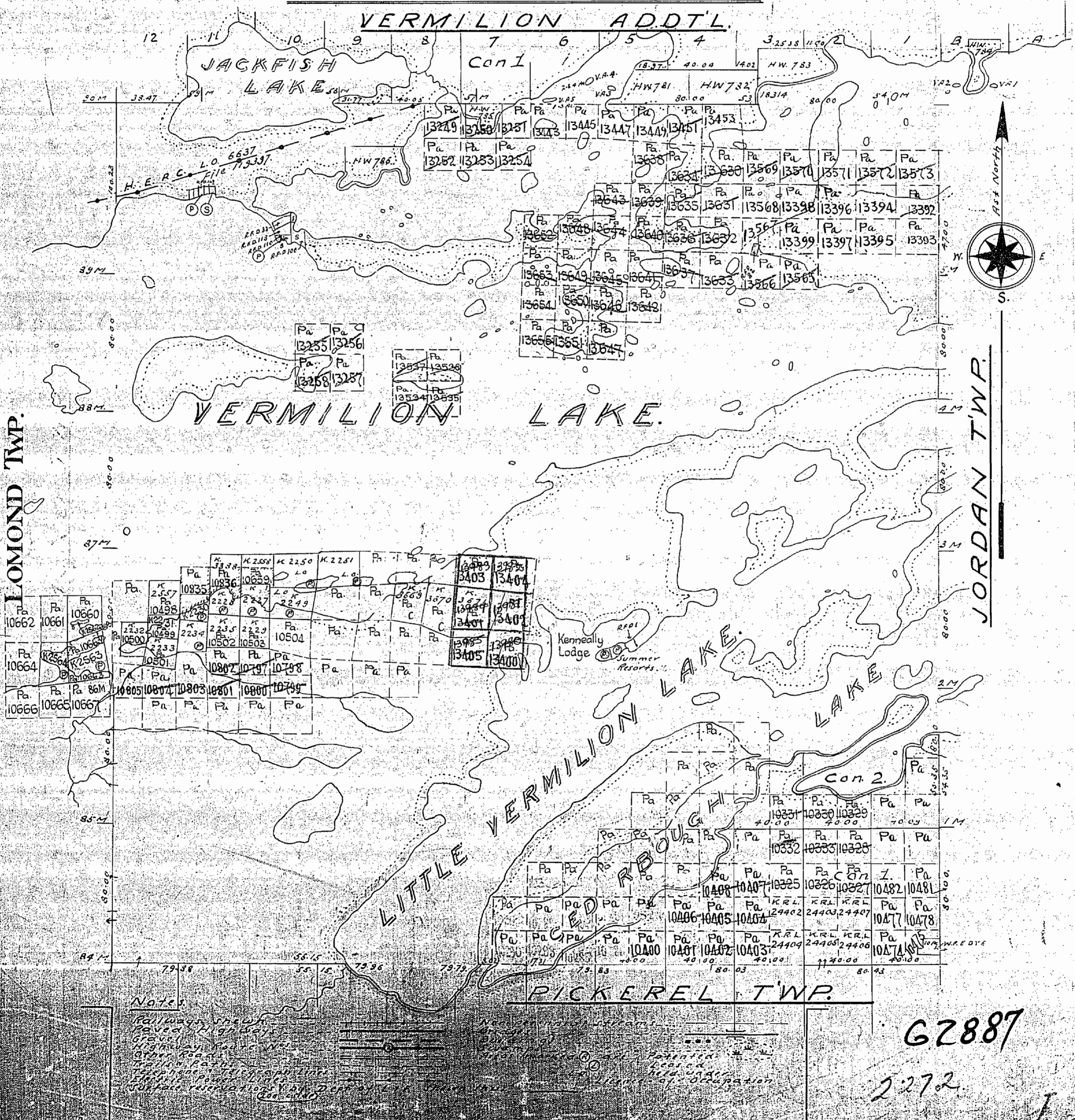

Notes

Railways shown
 Paved Highways
 Gravel
 Highways
 Other Roads
 Main Roads
 Telephone Lines
 Electric Power Lines
 Submarine Cables
 (See also)

Contour Lines
 Elevation
 (See also)

Occupied
 (See also)

G2887

2272

G-5881

VERMILION TWP

G-5881

G-5881

VERMILION TWP

G-5881

REFERENCES

AREAS WITHDRAWN FROM DISPOSITION

- M.R.O. - MINING RIGHTS ONLY
- S.R.O. - SURFACE RIGHTS ONLY
- M.+S. - MINING AND SURFACE RIGHTS

| Description | Order No. | Date | Disposition | File |
|---|-----------|------|-------------|------|
| (M) M.N.R. RESERVE FILE N° 77094 VOL. 5 | | | | |
| REMOTE COTTAGE | (R) | | | |

SAND AND GRAVEL

(G) M.N.R. GRAVEL PIT 60 FILE N° 186690

- April 1, 1986
- Oct 13, 1986
- Oct 23, 1986
- Dec 21, 1986
- May 28, 1987
- July 13, 1987
- Oct 21, 1987
- Nov 7, 1987
- Aug 2, 1989
- Nov 3, 1989
- Jan 16, 1990
- Jan 22, 1990
- March 5, 1990
- Nov. 12, 1990
- Jun 2, 1991

FOREST ACTIVITY INFORMATION

THIS TOWNSHIP/AREA FALLS WITHIN THE

CROWN FOREST MGT. UNIT

AND MAY BE SUBJECT TO FORESTRY OPERATIONS.
THE M.N.R. UNIT FORESTER FOR THIS AREA CAN BE CONTACTED AT:

P.O. BOX 309
SIOUX LOOKOUT, ONTARIO, P0V 2T0
(807) 737-1140

VERMILION ADD'L. TP. G-2886

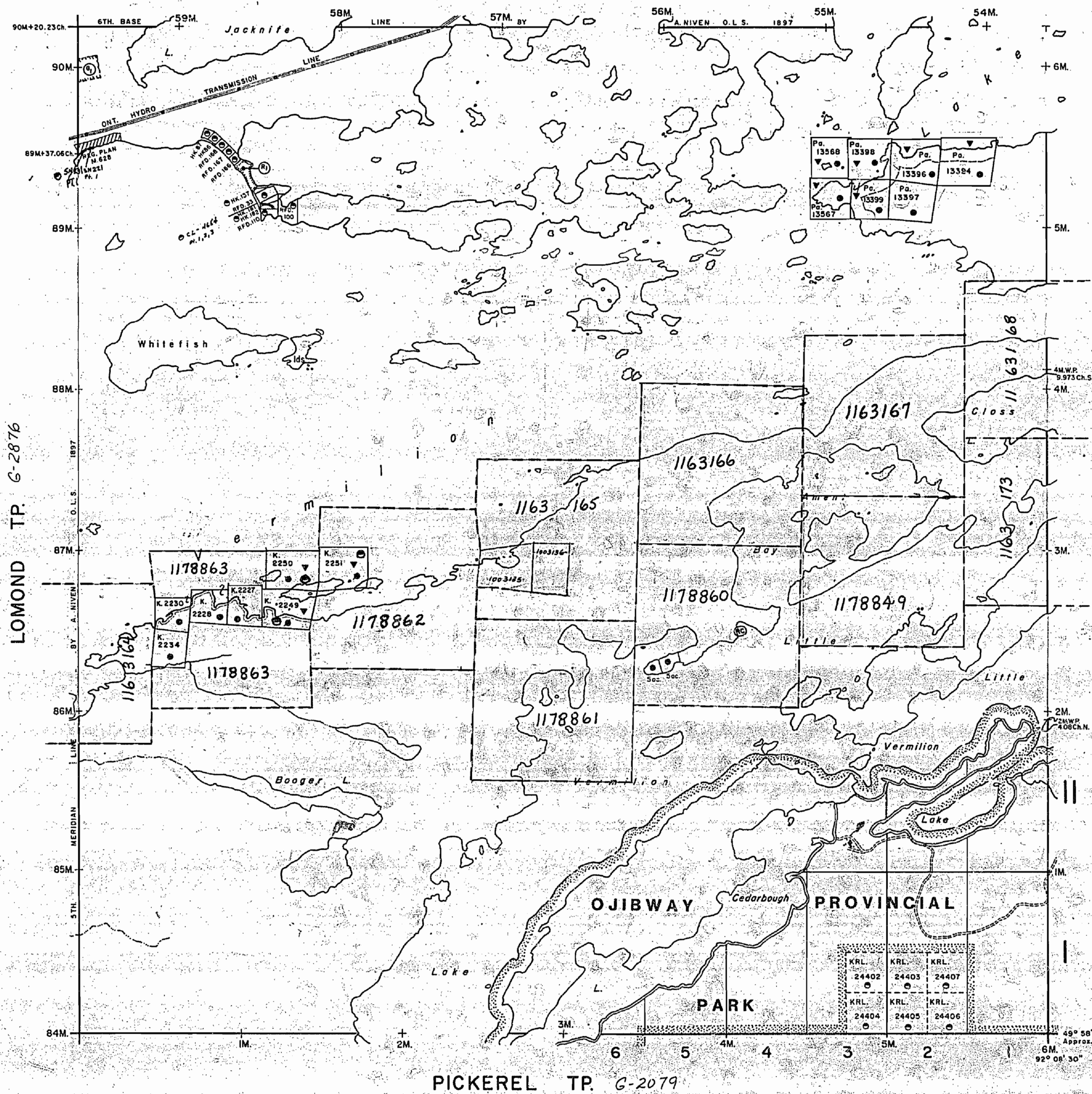

LEGEND

- HIGHWAY AND ROUTE No.
- OTHER ROADS
- TRAILS
- SURVEYED LINES:
 - TOWNSHIPS, BASE LINES, ETC.
 - LOTS, MINING CLAIMS, PARCELS, ETC.
- UNSURVEYED LINES:
 - LOT LINES
 - PARCEL BOUNDARY
 - MINING CLAIMS ETC.
- RAILWAY AND RIGHT OF WAY
- UTILITY LINES
- NON-PERENNIAL STREAM
- FLOODING OR FLOODING RIGHTS
- SUBDIVISION OR COMPOSITE PLAN
- RESERVATIONS
- ORIGINAL SHORELINE
- MARSH OR MUSKEG
- MINES
- TRAVERSE MONUMENT

DISPOSITION OF CROWN LANDS

| TYPE OF DOCUMENT | SYMBOL |
|---------------------------------|--------|
| PATENT, SURFACE & MINING RIGHTS | |
| SURFACE RIGHTS ONLY | |
| MINING RIGHTS ONLY | |
| LEASE, SURFACE & MINING RIGHTS | |
| SURFACE RIGHTS ONLY | |
| MINING RIGHTS ONLY | |
| LICENCE OF OCCUPATION | |
| ORDER-IN-COUNCIL | |
| RESERVATION | |
| CANCELLED | |
| SAND & GRAVEL | |

NOTE: MINING RIGHTS IN PARCELS PATENTED PRIOR TO MAY 6, 1913, VESTED IN ORIGINAL PATENTEE BY THE PUBLIC LANDS ACT, R.S.O. 1970, CHAP. 380, SEC. 63, SUBSEC 1.

SCALE: 1 INCH = 40 CHAINS

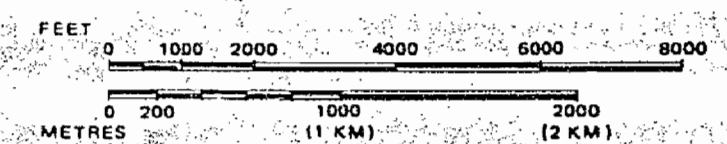

TOWNSHIP

VERMILION

M.N.R. ADMINISTRATIVE DISTRICT
SIOUX LOOKOUT
MINING DIVISION
PATRICIA
LAND TITLES / REGISTRY DIVISION
KENORA



Date MAY 1985

Number G-2887

THE INFORMATION THAT APPEARS ON THIS MAP HAS BEEN COMPILED FROM VARIOUS SOURCES, AND ACCURACY IS NOT GUARANTEED. THOSE WISHING TO STAKE MINING CLAIMS SHOULD CONSULT WITH THE MINING RECORDER, MINISTRY OF NORTHERN DEVELOPMENT AND MINES, FOR ADDITIONAL INFORMATION ON THE STATUS OF THE LANDS SHOWN HEREON.