

G.2364

PLAN OF

M.1389

TWP 3E

DATE OF ISSUE

MAR 29 1972

SAULT STE MARIE MINING RECORDER'S OFFICE

S. STE. MARIE MINING DIVISION.

DISTRICT OF ALGOMA

Scale: 40 chains to an inch.

TWP. 4 E.

NOTE: This twp. is covered by "Unspecified Pit Permit #11655" MIDWAY LUMBER MILLS LTD. W. See file for details.

Notes Surface Rights Only withdrawn from prospecting Staking Out Sale or lease under Section 43 - Deputy Minister's letter Jan 31/72 S.M.

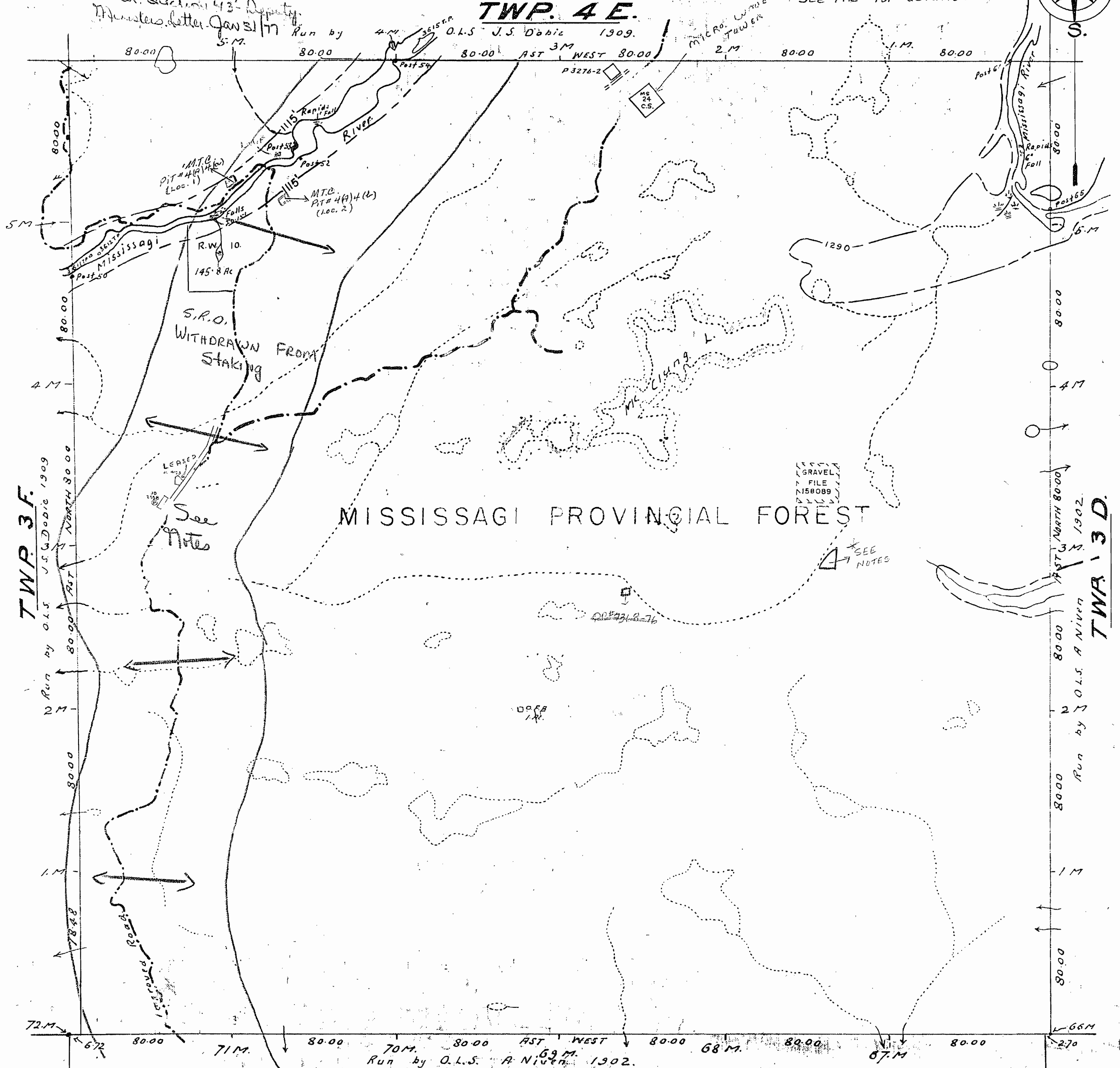

MISSISSAGI PROVINCIAL FOREST

TWP. 3 F.

TWP. 13 D.

400' SURFACE RIGHTS RESERVATION AROUND ALL LAKES & RIVER.

TWP. 2 E.

Approximate boundaries of areas liable to flooding shown thus Flooding Rights Reserved To H.E.P.C 1115 & 1290

Replaced by mylar June 28/83

6 4 2 1 2 1 6

VILLEVALE TWP. M.1389
02364

S. STE. MARIE MINING DIVISION.
DISTRICT OF ALGOMA

Areas withdrawn from staking under Section 43 of the Mining Act (R.S.O. 1970).

Scale: 40 chains to an inch.

NOTE: Surface Rights Only
Withdrawn from prospecting
See ORDER W-1133-BLIND
RIVER MARCH 1933



Order No.	File	Date	Disposition
W. 1/11	158089	3/1/77	S.R.O.
W. 1/19	158089	29/8/79	S.R.O. Reopened
W. J. 80	188605	30/7/80	S.R.O.
(According to contour elev. 1120')			
W. 1/81		10/10/81	S.M.S.R.O.

ROLLINS TWP. M.1398

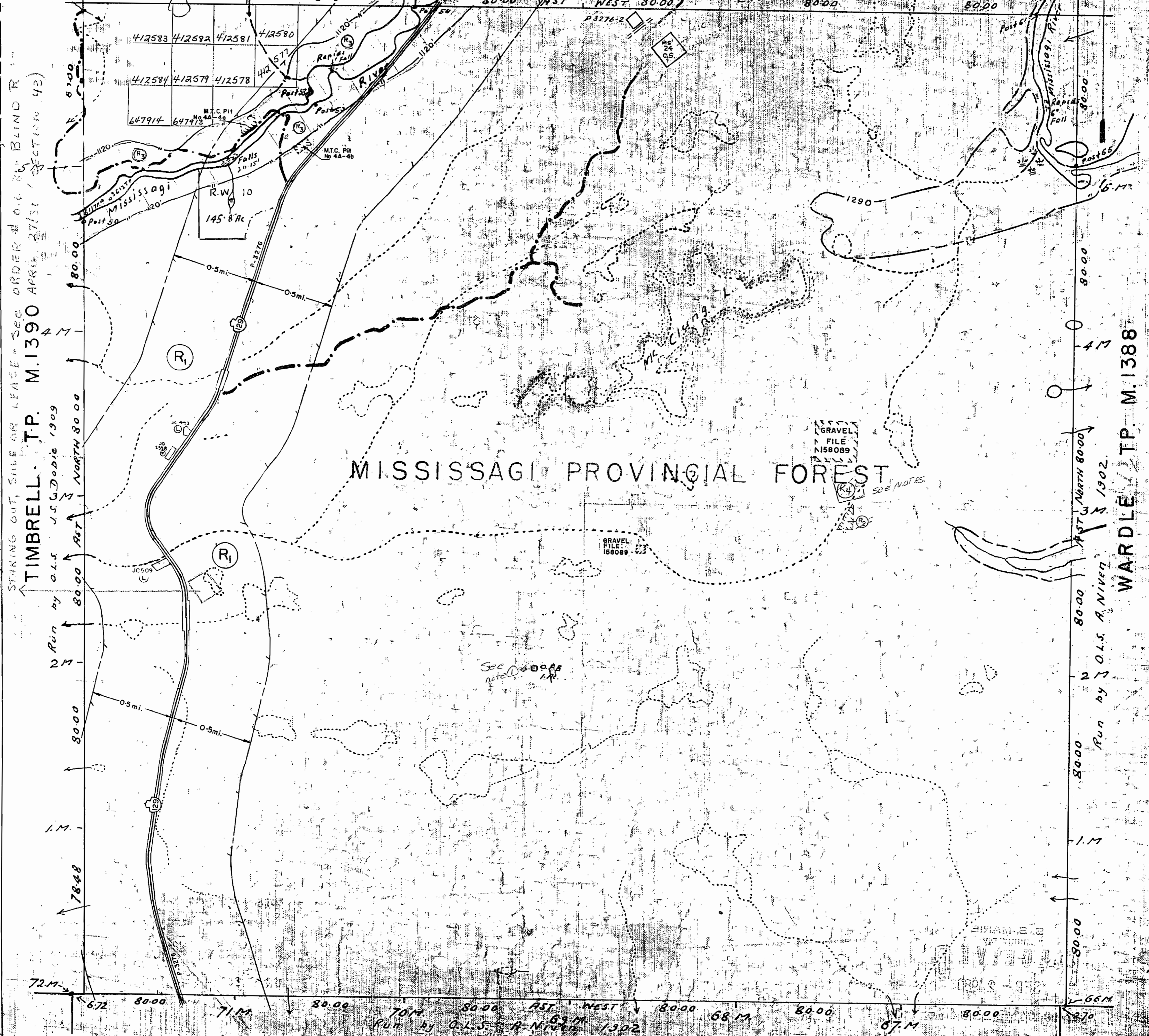

SURFACE RIGHTS ONLY REFERRED TO PROSPECTING
STAKING OUT, SALE OR LEASE - SEE ORDER W-1133-BLIND RIVER
TIMBRELL TWP. M.1390 APRIL 27/31 SECTION 43
Run by O.L.S. J.S. Dobbie 1909

WARDLE TWP. M.1388
Run by O.L.S. A. Niver 1902

RIOUX TWP. M.1384

400' SURFACE RIGHTS RESERVATION AROUND ALL LAKES & RIVERS

Approximate boundaries of areas
eligible for flooding shown. This is subject to
Flooding Rights Reserved To H.E.P.C. 1290

G-5364

ALLENUEVE T.M.B.

G-5364

G-5364

ALLENUEVE T.M.B.

G-5364

REFERENCES

AREAS WITHDRAWN FROM DISPOSITION

- M.R.O. - MINING RIGHTS ONLY
- S.R.O. - SURFACE RIGHTS ONLY
- M. S. - MINING AND SURFACE RIGHTS

Description Order No. Date Disposition File

SAND & GRAVEL

Areas withdrawn from staking under Section 43 of the Mining Act (R.S.O. 1970)

Order No	File	Date	Disposition
10	156089	31/1/77	S.R.O.
11	156089	11/5/85	S.R.O.
12	156089	11/5/85	S.R.O.
13	156089	04/5/81	S.R.O.

(contour elev. 1120')

FLOODING RIGHTS RESERVED TO H.E.P.C. 1290

ROLLINS (4E)

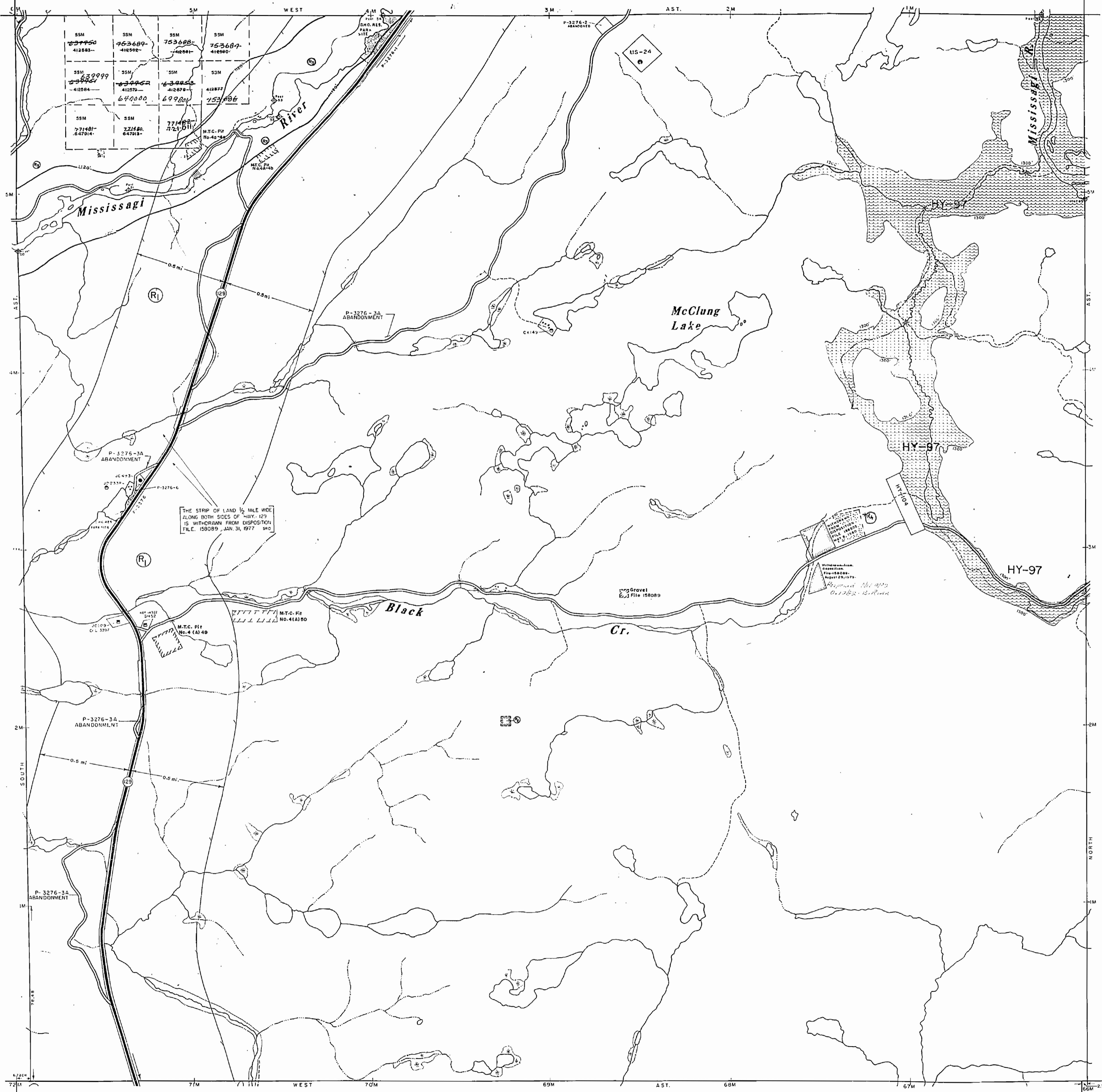

TIMBRELL (3F)

WARDLE (3D)

RIOUX (2E)

REFERENCES

TOPOGRAPHY

LAKES, RIVERS ETC. FROM FORESTS RESOURCES INVENTORY SHEET No. 467 831, 467 832, 468 831, 468 832

FLOODING

FLOODING RIGHTS TO CONTOUR ELEVATION 1300' ON MISSISSAGI RIVER RESERVED FOR WATER POWER DEV. AT GIBNEY FALLS POWER SITE PLAN 154-E-238 FILE 67633 3/2 1964

FLOODING RIGHTS ON THE MISSISSAGI RIVER TEMPORARILY RESERVED TO ONT HYDRO TO CONTOUR ELEVATION 1200 FT. FILE 168505 JULY 30, 1980

LEGEND

- HIGHWAY AND ROUTE No.
- OTHER ROADS
- TRAILS
- SURVEYED LINES
- TOWNSHIPS, BASE LINES ETC.
- LOTS, MINING CLAIMS, PARCELS, ETC.
- UNSURVEYED LINES
- LOT LINES
- PARCEL BOUNDARY
- MINING CLAIMS ETC.
- RAILWAY AND RIGHT OF WAY
- UTILITY LINES
- NON PERENNIAL STREAM
- FLOODING OR FLOODING RIGHTS
- SUBDIVISION OR COMPOSITE PLAN
- RESERVATIONS
- ORIGINAL SHORE LINE
- MARSH OR MUSKEG
- MINES
- TRAVERSE MONUMENT

DISPOSITION OF CROWN LANDS

TYPE OF DOCUMENT	SYMBOL
PATENT, SURFACE & MINING RIGHTS	●
" SURFACE RIGHTS ONLY	○
" MINING RIGHTS ONLY	◐
LEASE, SURFACE & MINING RIGHTS	◑
" SURFACE RIGHTS ONLY	◒
" MINING RIGHTS ONLY	◓
LICENCE OF OCCUPATION	◔
ORDER IN COUNCIL	◕
RESERVATION	◖
CANCELLED	◗
SAND & GRAVEL	◘

NOTE: MINING RIGHTS IN PARCELS PATENTED PRIOR TO MAY 6, 1910, VESTED IN ORIGINAL PATENTEE BY THE PUBLIC LANDS ACT, R.S.O. 1970, CHAP. 310, SEC. 63, SUBSEC. 1.

SCALE: 1 INCH = 20 CHAINS

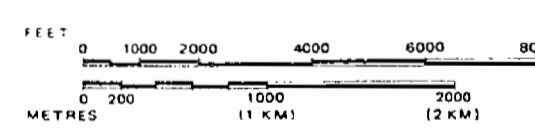

TOWNSHIP
VILLENEUVE
 M.N.R. ADMINISTRATIVE DISTRICT
BLIND RIVER
 MINING DIVISION
SAULT STE. MARIE
 LAND TITLES / REGISTRY DIVISION
ALGOMA

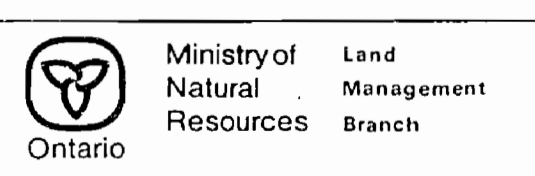

Date FEB. 15, 1983
 Number
G-2364

SAULT STE. MARIE
RECEIVED
 JUN 26 1983
 A.M. P.M.
 11:00 11:15 1:00 1:15

Revised by G-2364 - May 21/83

INDEX TO LAND DISPOSITION

PLAN
G-2364
TOWNSHIP

M.N.R. ADMINISTRATIVE DISTRICT
BLIND RIVER
MINING DIVISION
SAULT STE. MARIE
LAND TITLES/REGISTRY DIVISION
ALGOMA

VILLENEUVE

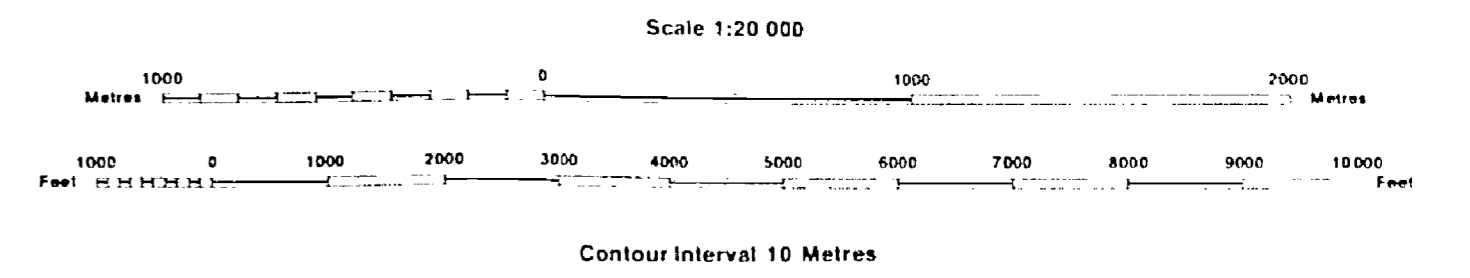

AREAS WITHDRAWN FROM DISPOSITION

MRO - Mining Rights Only
SRO - Surface Rights Only
M + S - Mining and Surface Rights

Description	Order No.	Date	Disposition	File
SEC 36/80	W 6/77	31/11/77	S RO	158 059
SEC 36/80	W 12/83	11/3/83	S RO	158 059
SEC 36/80	W 10/80	30/7/80	S RO	18 850
SEC 36/80	W 1/81	8/5/81	S RO	18 850
SEC 36/87	A 2/87	27/02/87	S RO	68554

SYMBOLS

Boundary	—
Township, Meridian, Baseline	—
Road allowance, surveyed	—
shoreline	—
Lot/Concession, surveyed	—
unsurveyed	—
Parcel, surveyed	—
unsurveyed	—
Right-of-way, road	—
railway	—
utility	—
Reservation	—
Cliff, Pit, Pile	—
Contour	—
Interpolated	—
Approximate	—
Depression	—
Control point (horizontal)	—
Flooded land	—
Mine head frame	—
Pipeline (above ground)	—
Railway: single track	—
double track	—
abandoned	—
Road, highway, county, township	—
access	—
trail, bush	—
Shoreline (original)	—
Transmission line	—
Wooded area	—

NOTES

FLOODING RIGHTS TO CONTOUR ELEVATION 1300' ON MISSISSAGI RIVER RESERVED FOR WATER POWER DEVELOPMENT AT AUBREY FALLS POWER SITE TO ONTARIO HYDRO AND W.P.L.A. No 94

DISPOSITION OF CROWN LANDS

Patent	—
Surface & Mining Rights	—
Surface Rights Only	—
Mining Rights Only	—
Lease	—
Surface & Mining Rights	—
Surface Rights Only	—
Mining Rights Only	—
Licence of Occupation	—
Order-in-Council	—
Cancelled	—
Reservation	—
Sand & Gravel	—

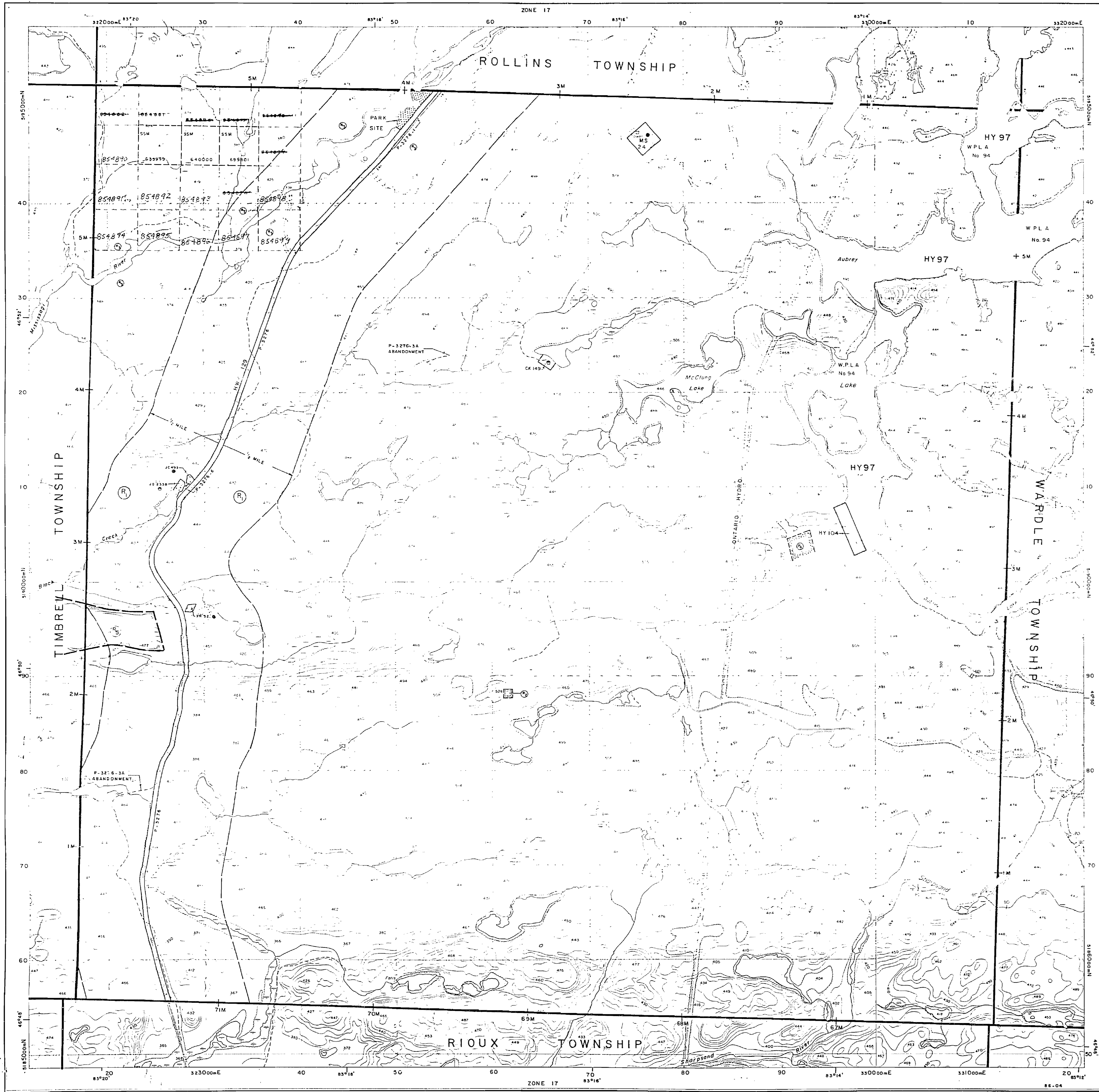
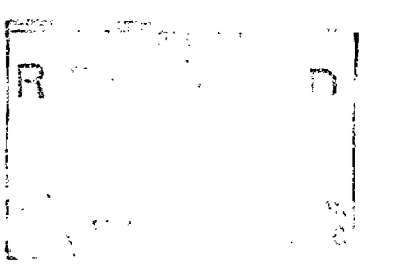
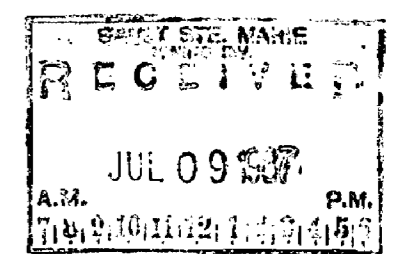

INDEX TO LAND DISPOSITION

PLAN
G-2364
TOWNSHIP

M.N.R. ADMINISTRATIVE DISTRICT
BLIND RIVER
MINING DIVISION
SAULT STE. MARIE
LAND TITLES/REGISTRY DIVISION
ALGOMA

VILLENEUVE

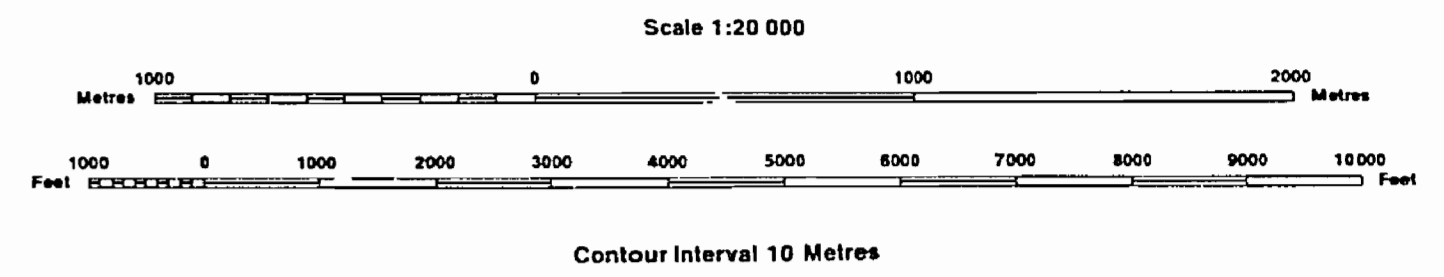

AREAS WITHDRAWN FROM DISPOSITION

Description	Order No.	Date	Disposition	File
MRD - Mining Rights Only				
SRO - Surface Rights Only				
M + S - Mining and Surface Rights				
SEC. 36/80	W. 6/77	31/1/77	SRO	158 089
SEC. 36/80	W. 1/83	11/3/83	SRO	158 089
SEC. 36/80	W. 10/80	30/7/80	SRO	18 8505
SEC. 36/80	W. 1/81	8/5/81	SRO	188 503
SEC. 36/87	W. 12/87	8/02/87	SRO	18555
<p>PROPOSED TOWER SITE JUNE 8/98</p> <p>ORDER NO. 4789 June 26/89</p>				

SYMBOLS

Boundary
Township, Meridian, Baseline
Road allowance: surveyed
shoreline
Lot/Concession: surveyed
unsurveyed
Parcel: surveyed
unsurveyed
Right-of-way: road
railway
utility
Reservation
Cliff, Pit, Pile
Contour
Interpolated
Approximate
Depression
Control point (horizontal)
Flooded land
Mine head frame
Pipeline (above ground)
Railway: single track
double track
abandoned
Road: highway, county, township
access
trail, bush
Shoreline (original)
Transmission line
Wooded area

NOTES

FLOODING RIGHTS TO CONTOUR ELEVATION 1300' ON MISSISSAGI RIVER RESERVED FOR WATER POWER DEVELOPMENT AT AUBREY FALLS POWER SITE TO ONTARIO HYDRO AND W.P.L.A. No. 94.

DISPOSITION OF CROWN LANDS

Patent
Surface & Mining Rights
Surface Rights Only
Mining Rights Only
Lease
Surface & Mining Rights
Surface Rights Only
Mining Rights Only
Licence of Occupation
Order-in-Council
Cancelled
Reservation
Sand & Gravel

The 1980 Magnetic Bearings
Approx. 7" Annual Change
Increasing 26"

THE INFORMATION THAT APPEARS ON THIS MAP HAS BEEN COMPILED FROM VARIOUS SOURCES, AND ACCURACY IS NOT GUARANTEED. THOSE WISHING TO STAKE MINING CLAIMS SHOULD CONSULT WITH THE MINING RECORDER, MINISTRY OF NORTHERN DEVELOPMENT AND MINES, FOR ADDITIONAL INFORMATION ON THE STATUS OF THE LANDS SHOWN HEREON.

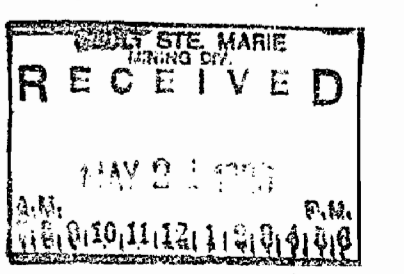

0353-0

0353-0

1389

OSM 22'E 3'E 22W 130

PLAN OF TWP 3E

(VILLENEUVE)
M. 1389

S. STE. MARIE MINING DIVISION. DISTRICT OF ALGOMA

Scale: 40 chains to an inch.

TWP. 4 E.

NOTE:

The N¹/₂ S. W¹/₄ of 3E withdrawn from staking, for water power development purposes until July 31, 1950

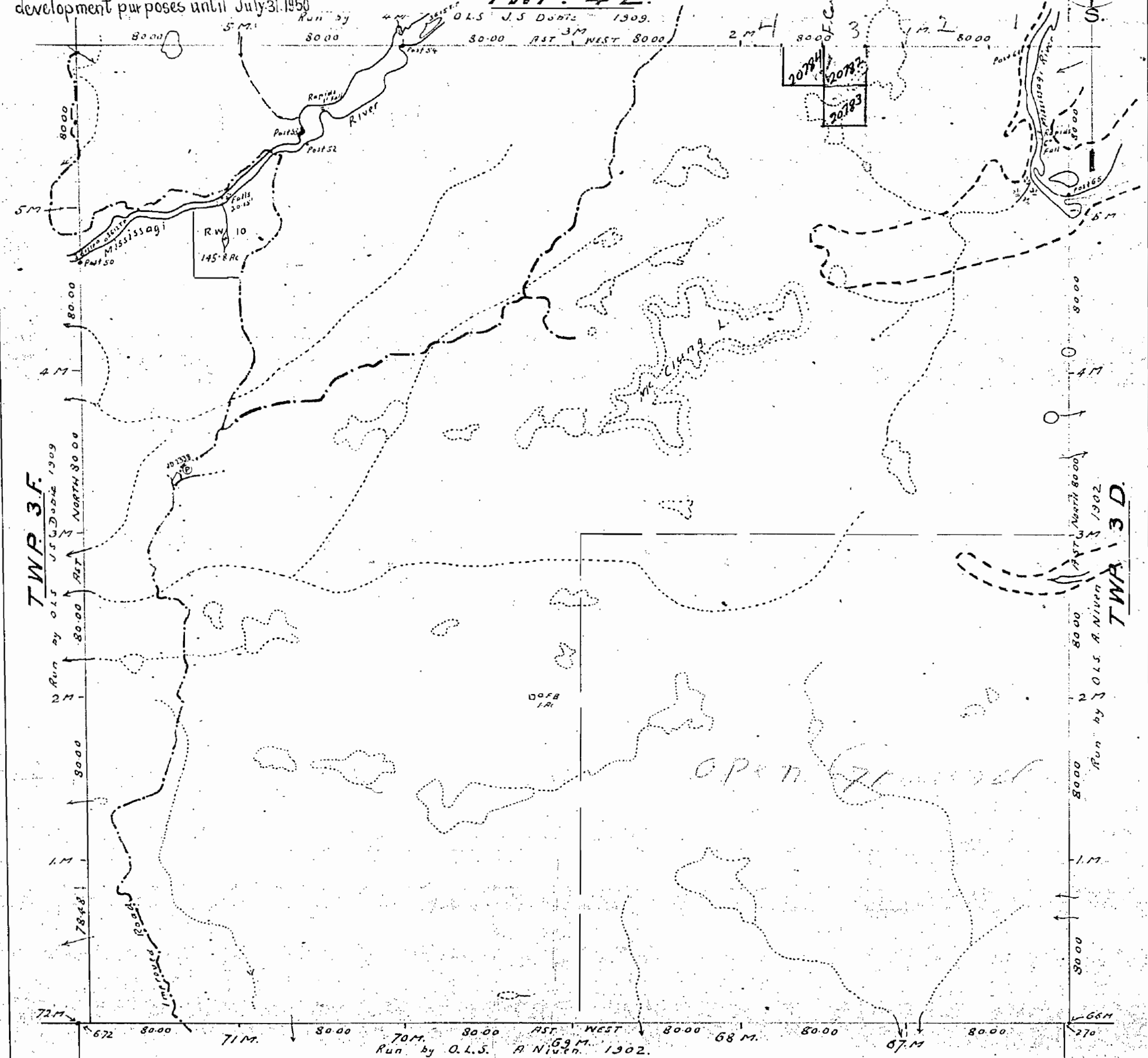

TWP. 3 F.

TWP. 3 D.

TWP. 2 E.

Surface reservations 200' wide by Dept. of L & F shown hereon thus -----

Approximate boundaries of areas liable to flooding shown thus -----

M22 TWP 3 E

See map document for Hydro - flooding rights

1389

PLAN OF (VILLENEUVE) TWP 3E

M. 1389

S. STE. MARIE MINING DIVISION. DISTRICT OF ALGOMA

Scale: 40 chains to an inch.

TWP. 4 E.

Run by O.L.S. J.S. Dobie 1909.

80.00 5 M 80.00 30.00 AST 3 M WEST 80.00 2 M 80.00 1 M 80.00

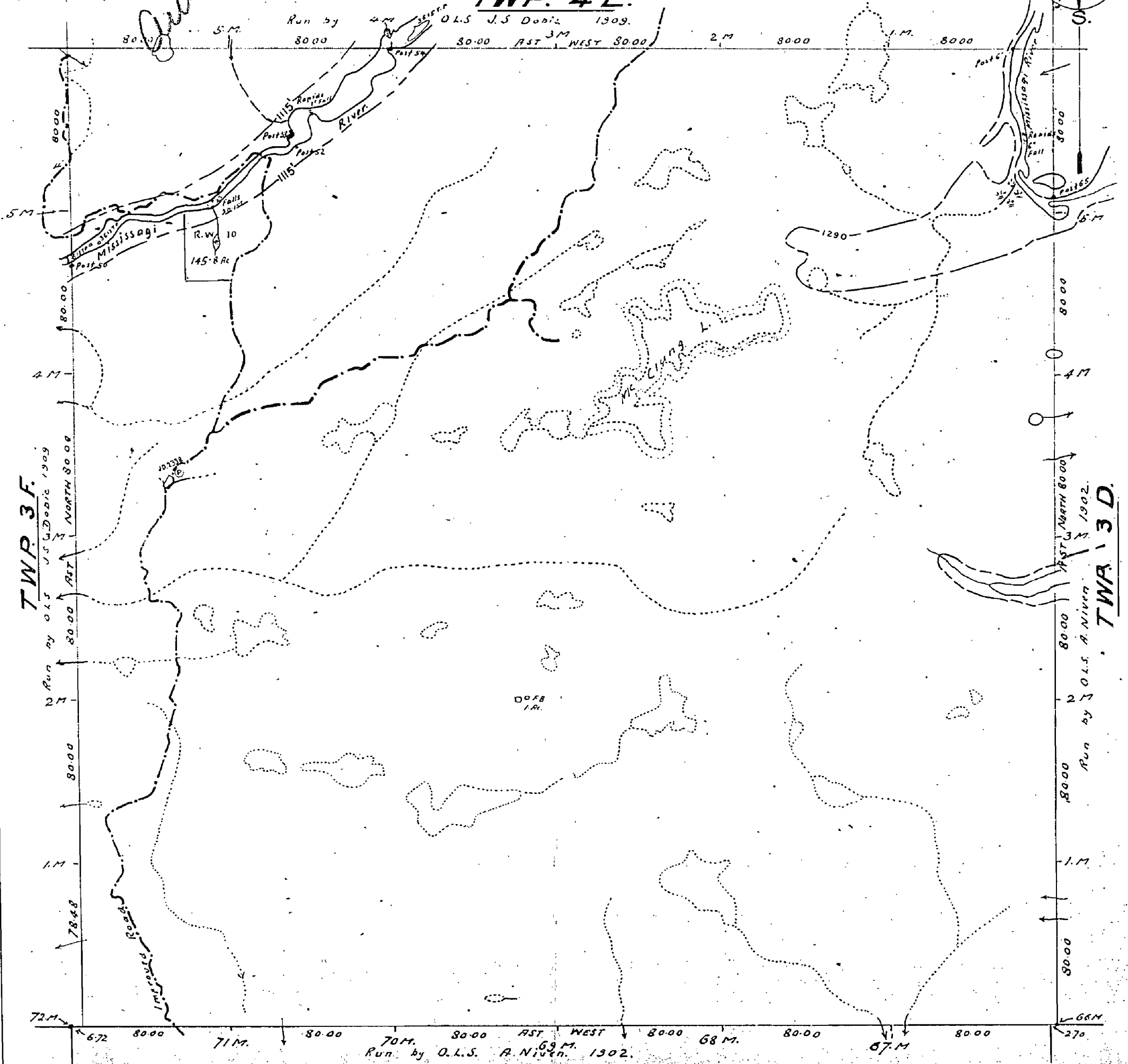
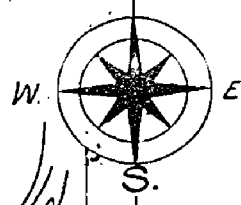

TWP. 3 F.

Run by O.L.S. J.S. Dobie 1909

Run by O.L.S. A. Niven 1902.

TWP. 3 D.

Surface reservations 200' wide by Dept. of L.A.F. shown hereon thus

TWP. 2 E.

Approximate boundaries of areas liable to flooding shown thus

Flooding Rights Reserved To H.E.P.C 1115 & 1296

1389

PLAN OF TWP 3E (ULLENEQUE)

S. STE. MARIE MINING DIVISION. DISTRICT OF ALGOMA

Scale: 40 chains to an inch.

TWP. 4 E.

Run by O.L.S. J.S. Dohie 1909.

AST 3M WEST 80.00

80.00

80.00

80.00

80.00

80.00

80.00

80.00

80.00

80.00

80.00

80.00

80.00

80.00

80.00

80.00

80.00

80.00

80.00

80.00

80.00

80.00

80.00

80.00

80.00

80.00

80.00

80.00

80.00

80.00

80.00

80.00

80.00

80.00

80.00

80.00

80.00

80.00

80.00

80.00

80.00

80.00

80.00

80.00

80.00

80.00

80.00

80.00

80.00

80.00

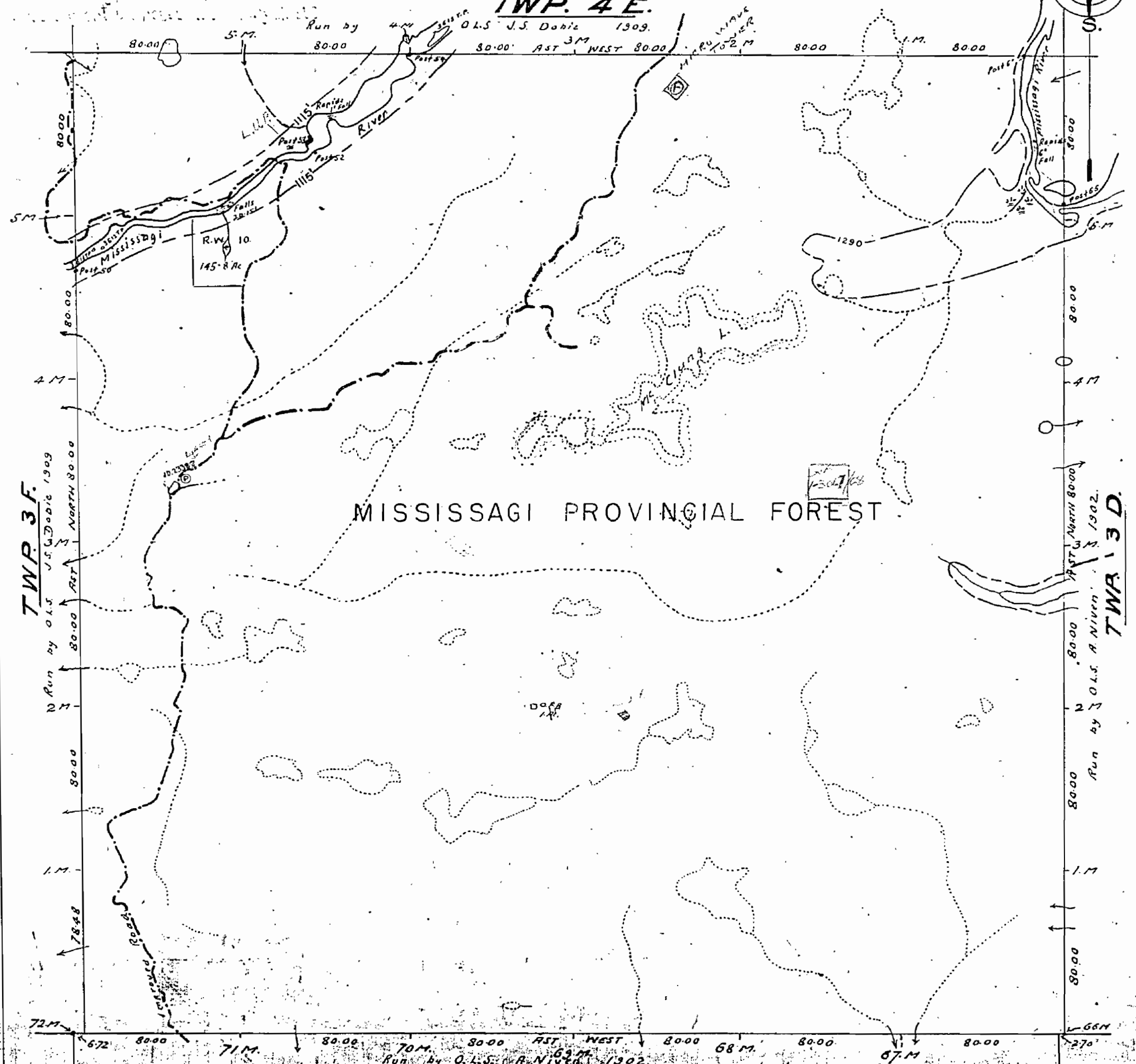

MISSISSAGI PROVINCIAL FOREST

TWP. 3 F.

Run by O.L.S. J.S. Dohie 1909.

AST NORTH 80.00

80.00

80.00

80.00

80.00

80.00

80.00

80.00

80.00

80.00

80.00

80.00

80.00

80.00

80.00

80.00

80.00

80.00

80.00

80.00

80.00

80.00

80.00

80.00

TWP. 13 D.

Run by O.L.S. A. Niven 1902.

AST NORTH 80.00

80.00

80.00

80.00

80.00

80.00

80.00

80.00

80.00

80.00

80.00

80.00

80.00

80.00

80.00

80.00

80.00

80.00

80.00

80.00

80.00

80.00

80.00

80.00

400 SURFACE RIGHTS RESERVATION AROUND ALL LAKES & RIVER

TWP. 2 E.

Run by O.L.S. A. Niven 1902.

AST WEST 80.00

80.00

80.00

80.00

Approximate boundaries of areas liable to flooding shown thus

Flooding Rights Reserved To H.E.P.C 1115 & 1290

1389

101° 22' W 52° 18' N

M. 1389

PLAN OF OFFICE MAP TWP 3E (UILLENEUVE)

S. STE. MARIE MINING DIVISION.

DISTRICT OF ALGOMA

Scale: 40 chains to an inch.

TWP. 4 E.

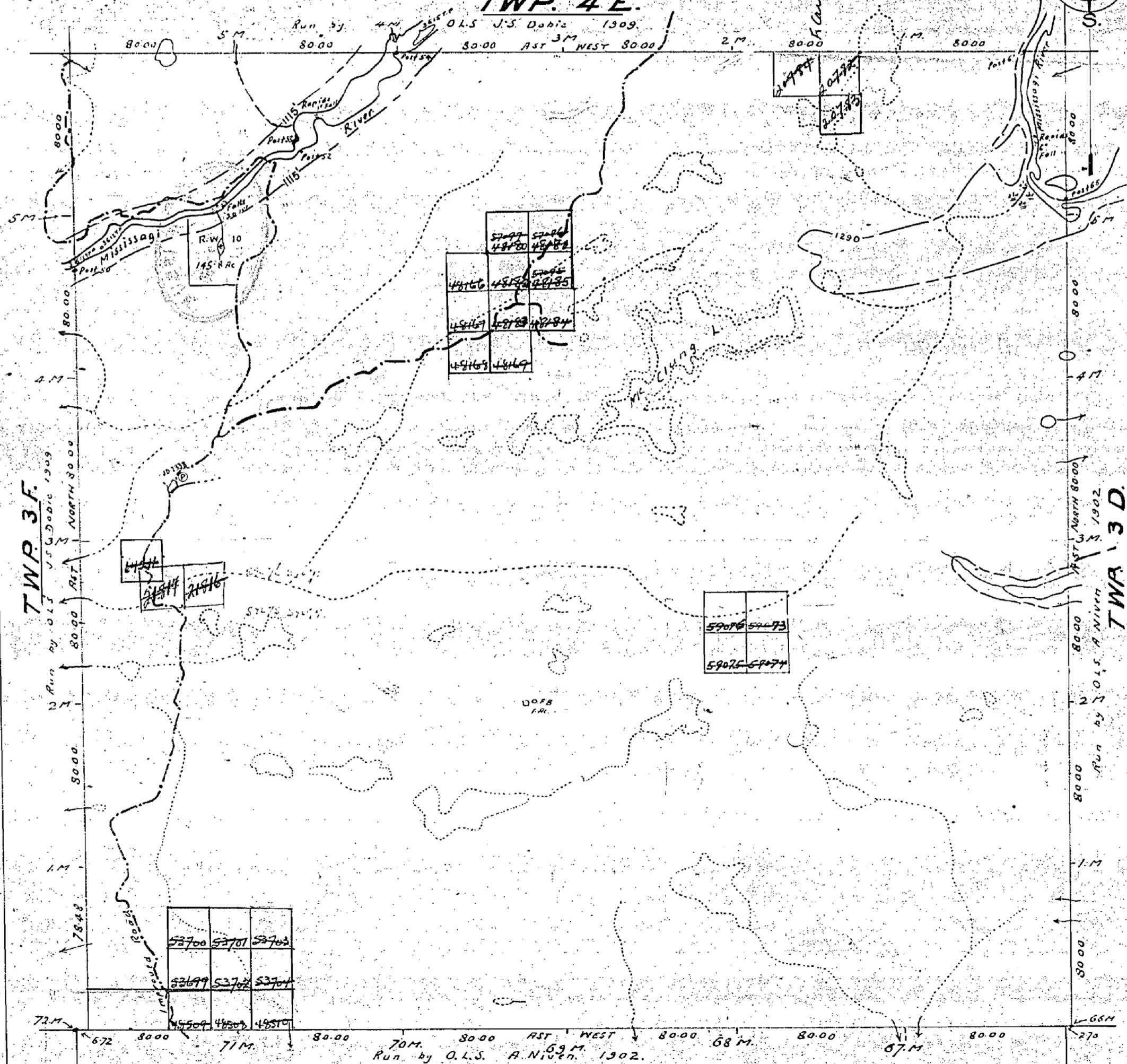

TWP 3 F.

TWP 2 E.

TWP 13 D.

Surface reservations 200' wide by Dept of L.F. shown hereon thus:

Approximate boundaries of areas liable to flooding shown thus: Flooding Rights Reserved To H.E.P.C 1115 & 1290

TWP 3 E

1389

TOWNSHIP 3 E 22 N 150

PLAN OF TWP 3E (UILLENEUVE) M. 1389

S. STE. MARIE MINING DIVISION. DISTRICT OF ALGOMA

Scale: 40 chains to an inch.

TWP. 4 E.

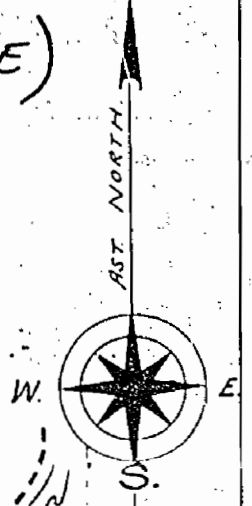

NOTE: The N 1/2 & S W 1/4 of 3E withdrawn from staking, for water power development purposes until July 31 1958

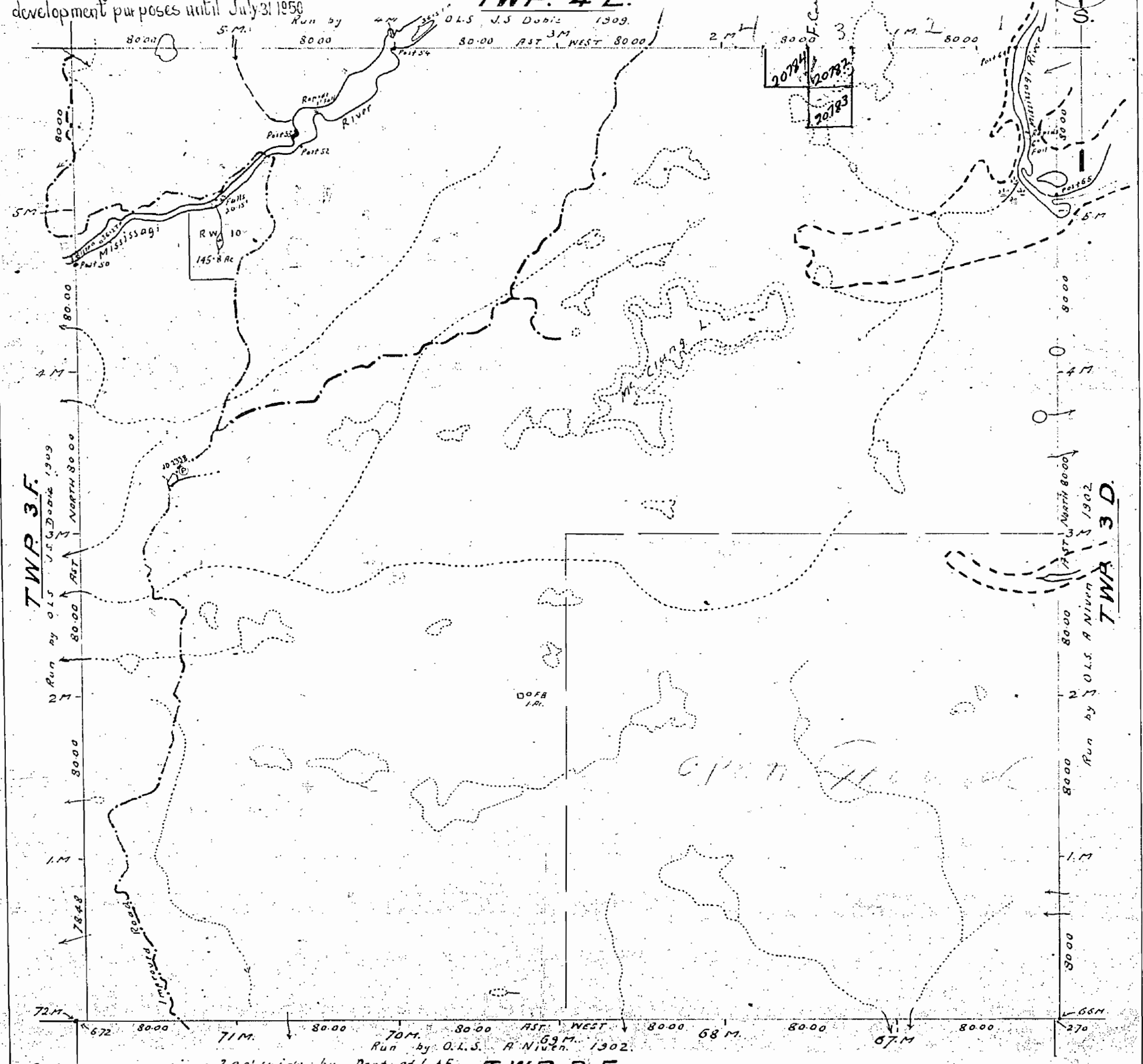

Surface reservations 200' wide by Dept of L. & F. shown hereon thus ----- Approximate boundaries of areas liable to flooding shown thus -----

TWP 3 E

1389

PLAN OF TWP 3E (LILLENBURG)

S. STE. MARIE MINING DIVISION. DISTRICT OF ALGOMA

Scale: 40 chains to an inch.

TWP. 4 E.

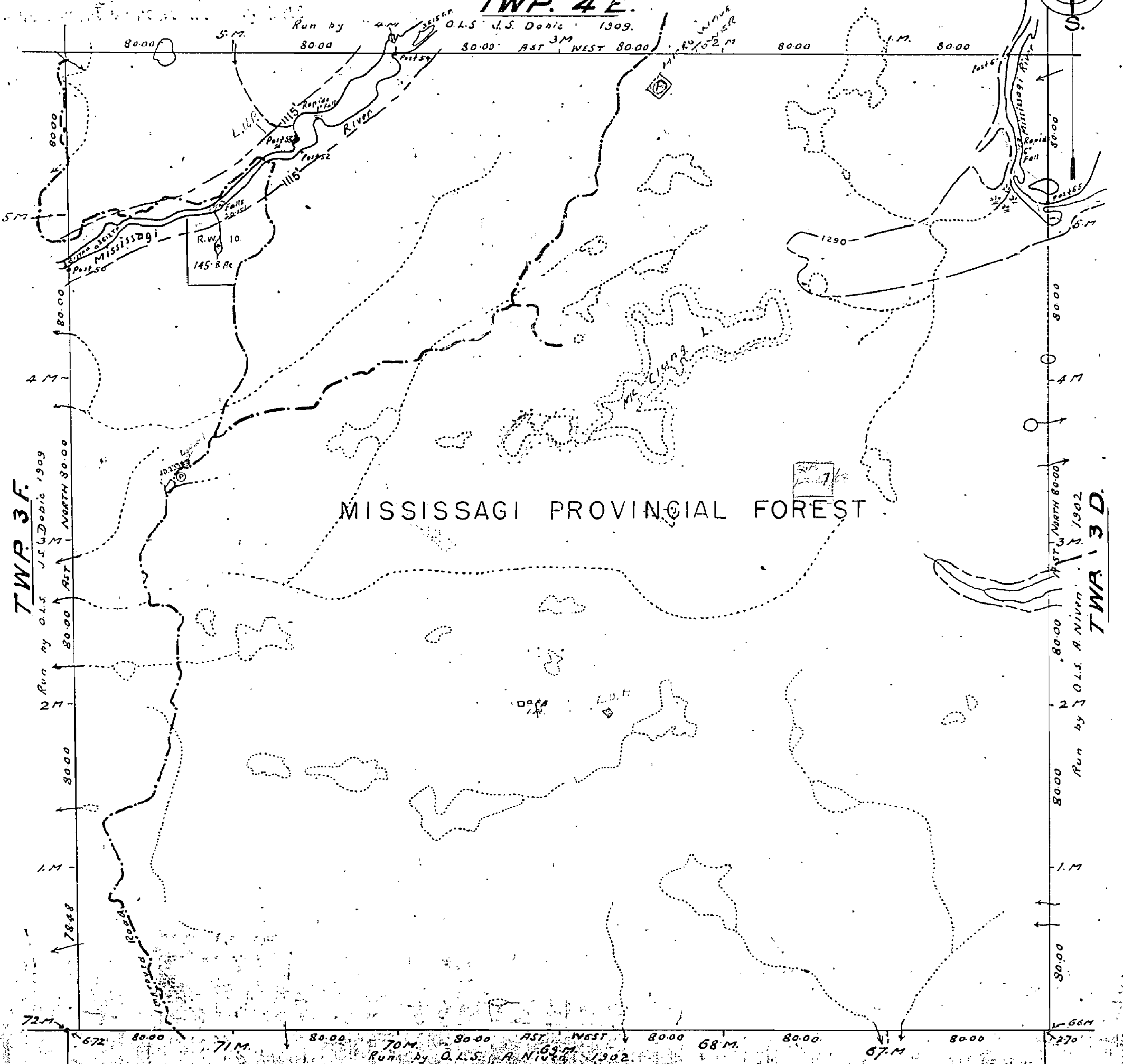

MISSISSAGI PROVINCIAL FOREST

TWP. 3 F.

TWP. 3 D.

400 SURFACE RIGHTS RESERVATION AROUND ALL LAKES & RIVER

Flooding Rights Reserved To H.E.P.C 1115 81290

1389

301 M22 E 310210M

M. 1389

PLAN OF OFFICE MAP TWP 3E (VILLENEUVE)

S. STE. MARIE MINING DIVISION. DISTRICT OF ALGOMA

Scale: 40 chains to an inch.

TWP. 4 E.

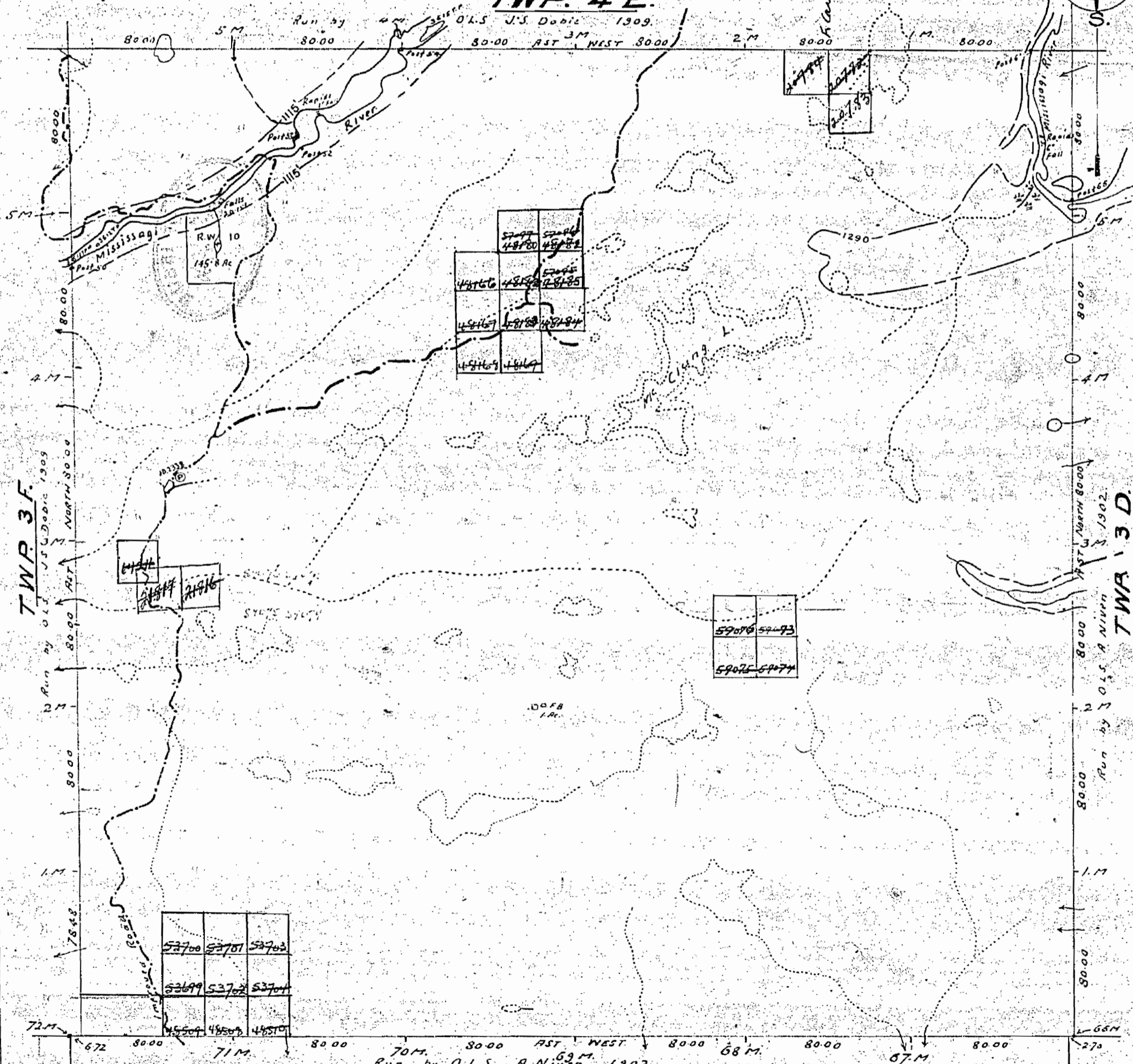

TWP. 3 F.

TWP. 3 D.

Surface reservations 200' wide by Dept. of L. & F. shown hereon thus

TWP. 2 E.

Approximate boundaries of areas liable to flooding shown thus. Flooding Rights Reserved To H.E.P.C. 1115 & 1290

TWP 3 E

1389

PLAN OF (VILLENEUVE) TWP 3E

M. 1389

S. STE. MARIE MINING DIVISION. DISTRICT OF ALGOMA

Scale: 40 chains to an inch.

TWP. 4 E.

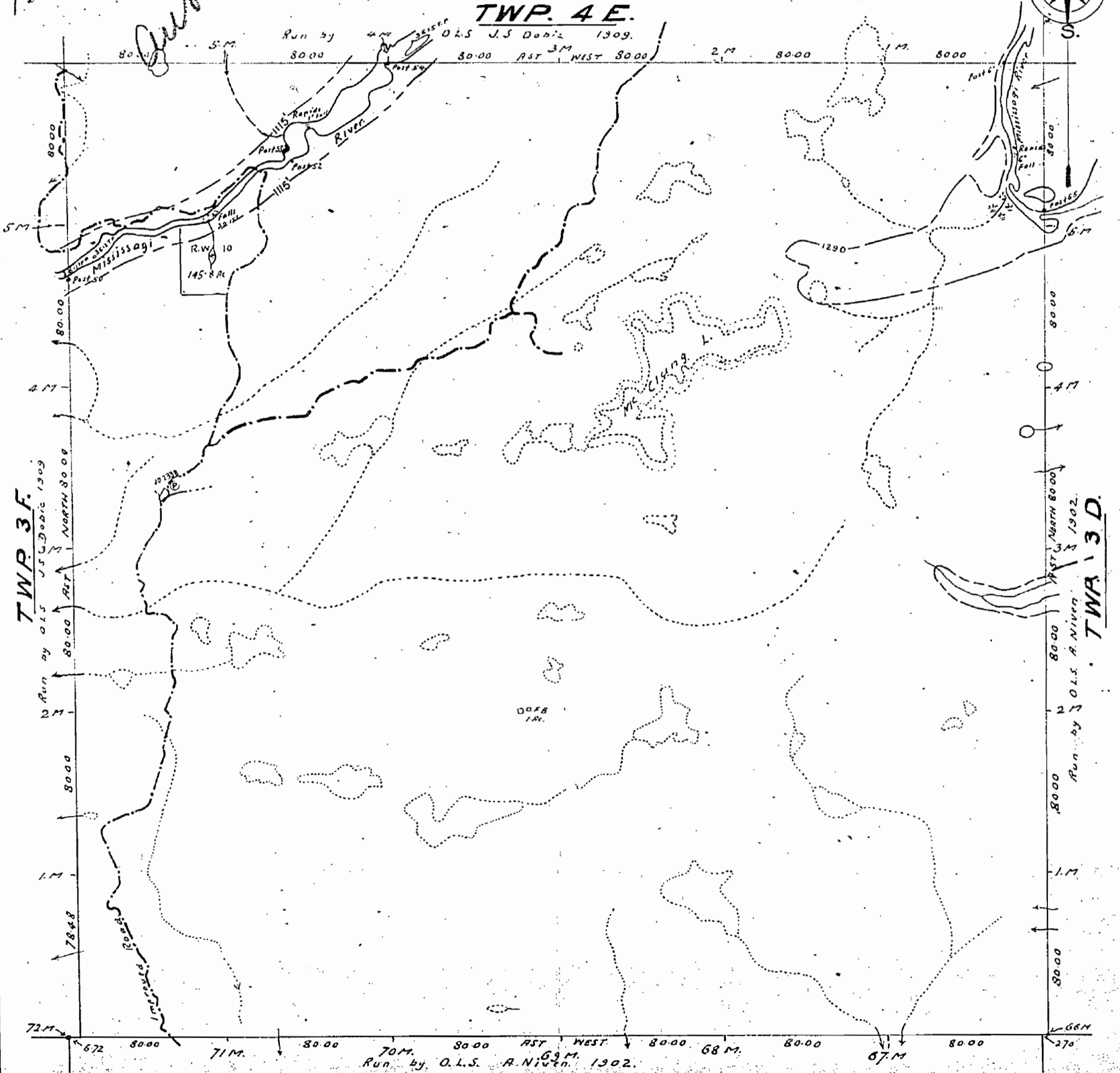

Surface reservations 200' wide by Dept of L. & F. shown hereon thus ~~-----~~

TWP. 2 E.

Approximate boundaries of areas liable to flooding shown thus ~~-----~~ Flooding Rights Reserved To H.E.P.C 1115 & 1296