

M-613 TWP WESLEY

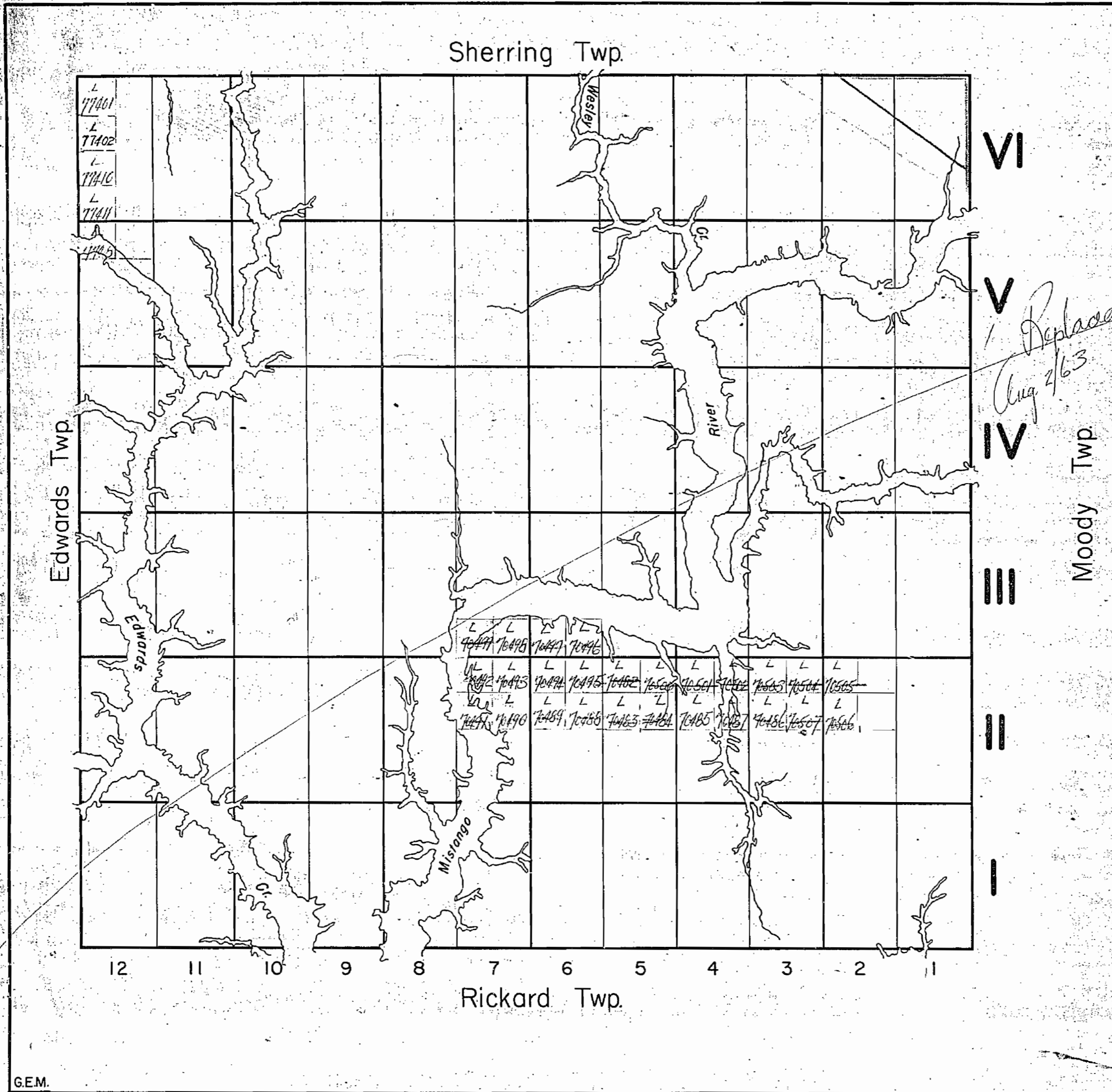

THE TOWNSHIP OF  
**WESLEY**  
DISTRICT OF COCHRANE  
LARDER LAKE MINING DIVISION  
SCALE: 1-INCH = 40 CHAINS

**LEGEND**

PATENTED LAND	Ⓟ
CROWN LAND SALE	Ⓢ
LEASES	Ⓛ
LOCATED LAND	Ⓛ
LICENSE OF OCCUPATION	Ⓛ
ROADS	—
IMPROVED ROADS	—
RAILWAYS	—
POWER LINES	—
MARSH OR MUSKEG	—

**NOTES**

License of Occupation No. 937 to cover all unpatented land along shores of Abitibi River, Mistrango River, Edwards Cr. & Wesley Cr.

Temporarily withdrawn. Return Oct 20/61

MINING RECORDS RECEIVED  
Apr 23/56  
SWASTICA - CAN.

PLAN NO. — M-613

DEPARTMENT OF MINES  
—ONTARIO—

Sherring Twp.

THE TOWNSHIP OF  
OF  
**WESLEY**  
DISTRICT OF  
COCHRANE  
LARDER LAKE  
MINING DIVISION

SCALE 1 INCH = 40 CHAINS

LEGEND

PATENTED LAND	P
CROWN LAND SALE	CS
LEASES	L
LOCATED LAND	Loc
LICENSE OF OCCUPATION	L.O.
ROADS	—
IMPROVED ROADS	—
RAILWAYS	—
POWER LINES	—
MARSH OR MUSKEG	—

NOTES

License of Occupation No 937 to cover all unpatented land along shores of Adrib River, Mistango River, Edwards Cr. & Wesley Cr.

Claims adjoining Mistango R, Edwards R. & Wesley Cr. subject to flooding rights.

Area temporarily withdrawn from staking indicated thus: L.O. No. 13,302

400' Surface Rights Reservation around all Lakes and Rivers

MINING RECORDER  
RECEIVED  
AUG 2 1963  
KESWICK LAKE - ONT.

PLAN NO - M-613

DEPARTMENT OF MINES  
- ONTARIO -

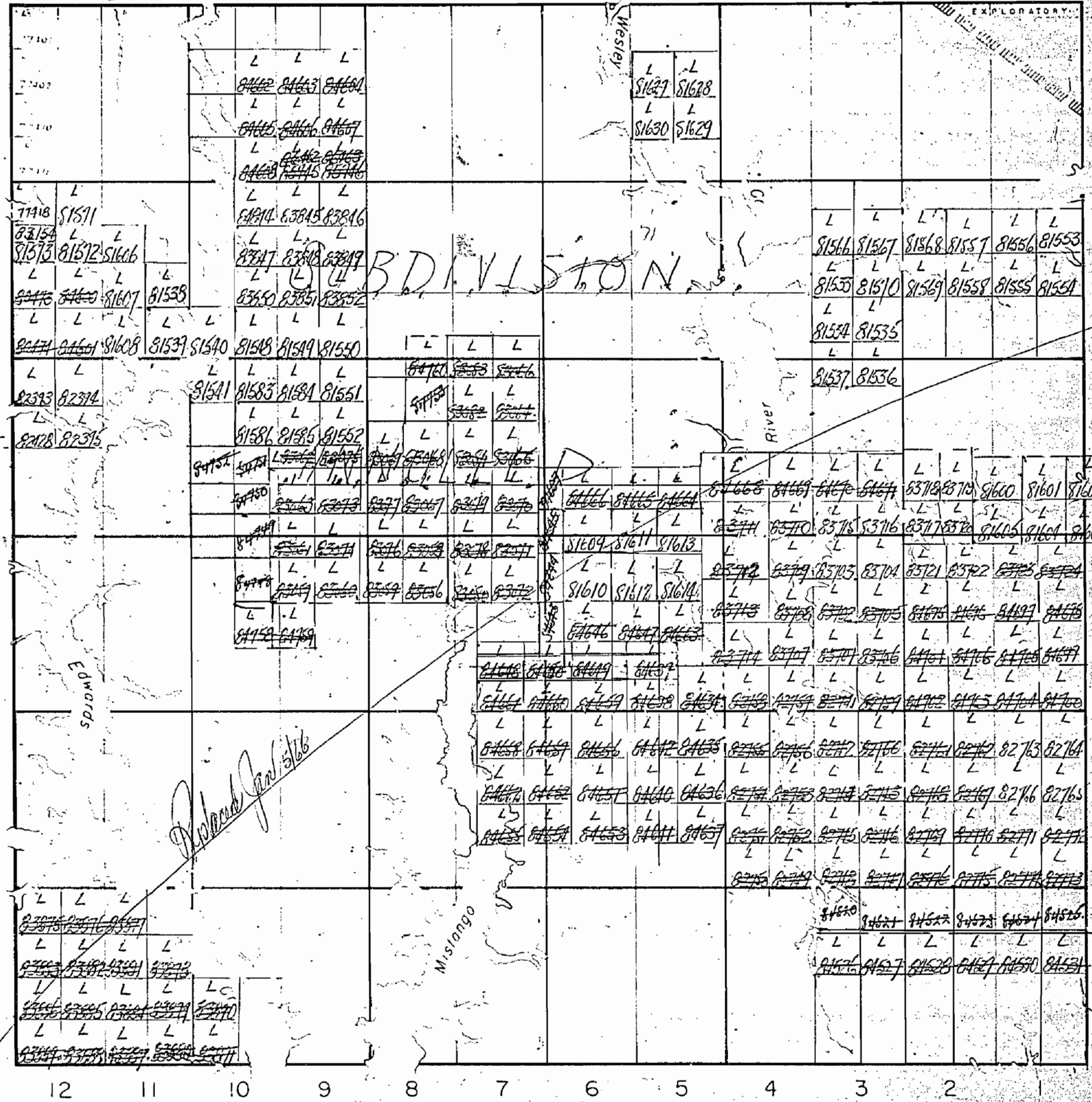

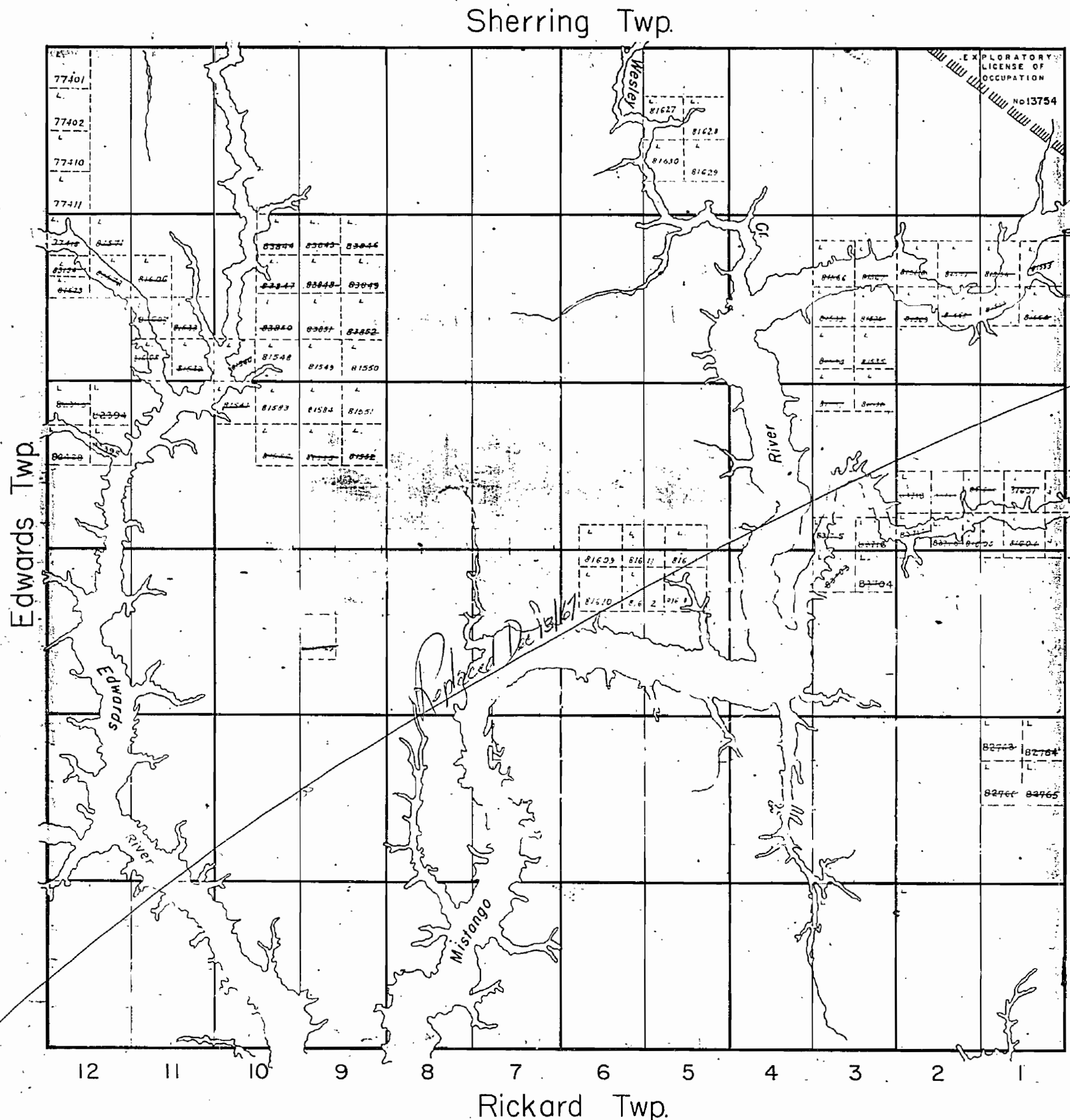

THE TOWNSHIP  
OF  
**WESLEY**  
DISTRICT OF  
COCHRANE  
LARDER LAKE  
MINING DIVISION

SCALE: 1-INCH = 40 CHAINS

**LEGEND**

PATENTED LAND	(P)
CROWN LAND SALE	(S)
LEASES	(L)
LOCATED LAND	(L.O.)
LICENSE OF OCCUPATION	(L.O.)
ROADS	(—)
IMPROVED ROADS	(—)
RAILWAYS	(—)
POWER LINES	(—)
MARSH OR MUSKEG	(—)

**NOTES**

License of Occupation No 937 to cover all unpatented land along shores of Abitibi River, Mistango River, Edwards Cr & Wesley Cr.

Claims adjoining Mistango R., Edwards R. & Wesley Cr. subject to flooding right.

Area temporarily withdrawn from staking indicated thus: L.O. No 374

400' Surface Rights Reservation around all Lakes and Rivers.

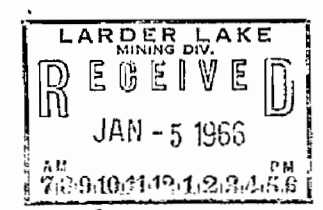

PLAN NO. - M-613

DEPARTMENT OF MINES  
—ONTARIO—

Sherring Twp.

THE TOWNSHIP OF

# WESLEY

DISTRICT OF COCHRANE

LARDER LAKE MINING DIVISION

SCALE: 1-INCH= 40 CHAINS

### LEGEND

- PATENTED LAND Ⓟ
- CROWN LAND SALE C.S.
- LEASES Ⓛ
- LOCATED LAND Loc.
- LICENSE OF OCCUPATION L.O.
- ROADS —
- IMPROVED ROADS —
- RAILWAYS —
- POWER LINES —
- MARSH OR MUSKEG —

### NOTES

License of Occupation No. 937 to cover all unpatented land along shores of Abitibi-River, Mistango River, Edwards Cr. & Wesley Cr.

Claims adjoining Mistango R. Edwards R. & Wesley Cr subject to flooding rights

400' Surface Rights Reservation around all Lakes and Rivers.

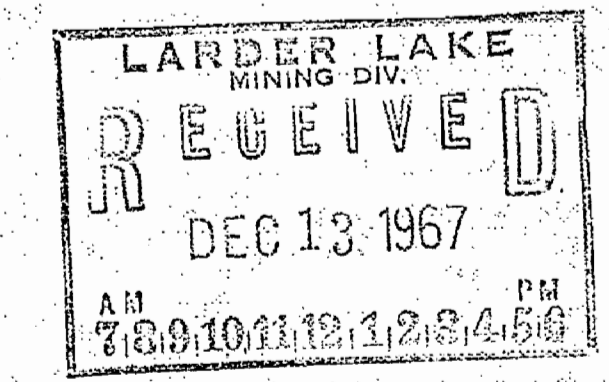

*Replaced by Mylar  
Sept 12/79*

PLAN NO. - M-613 #6

DEPARTMENT OF MINES  
-ONTARIO-

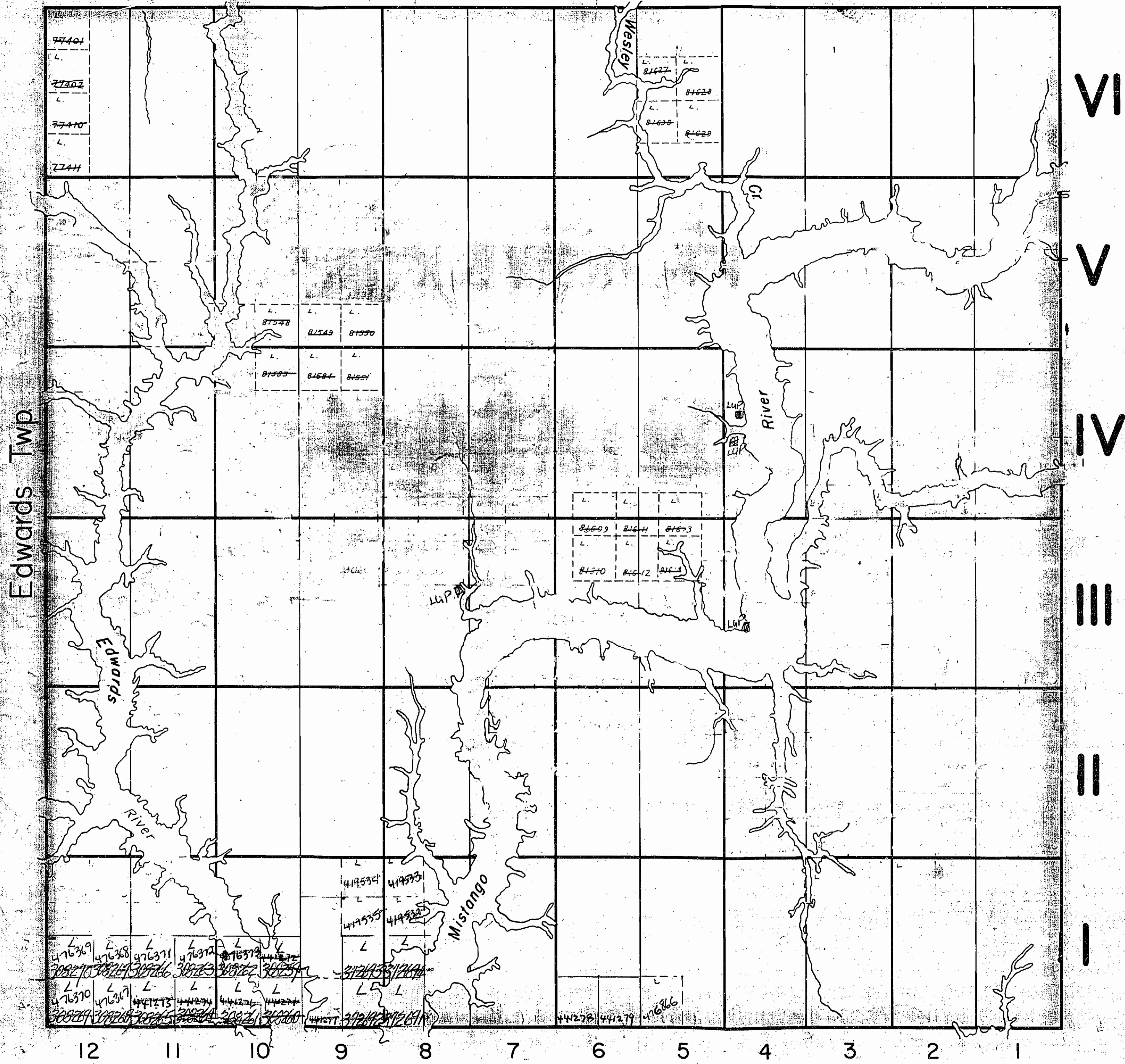

Sherring Twp.

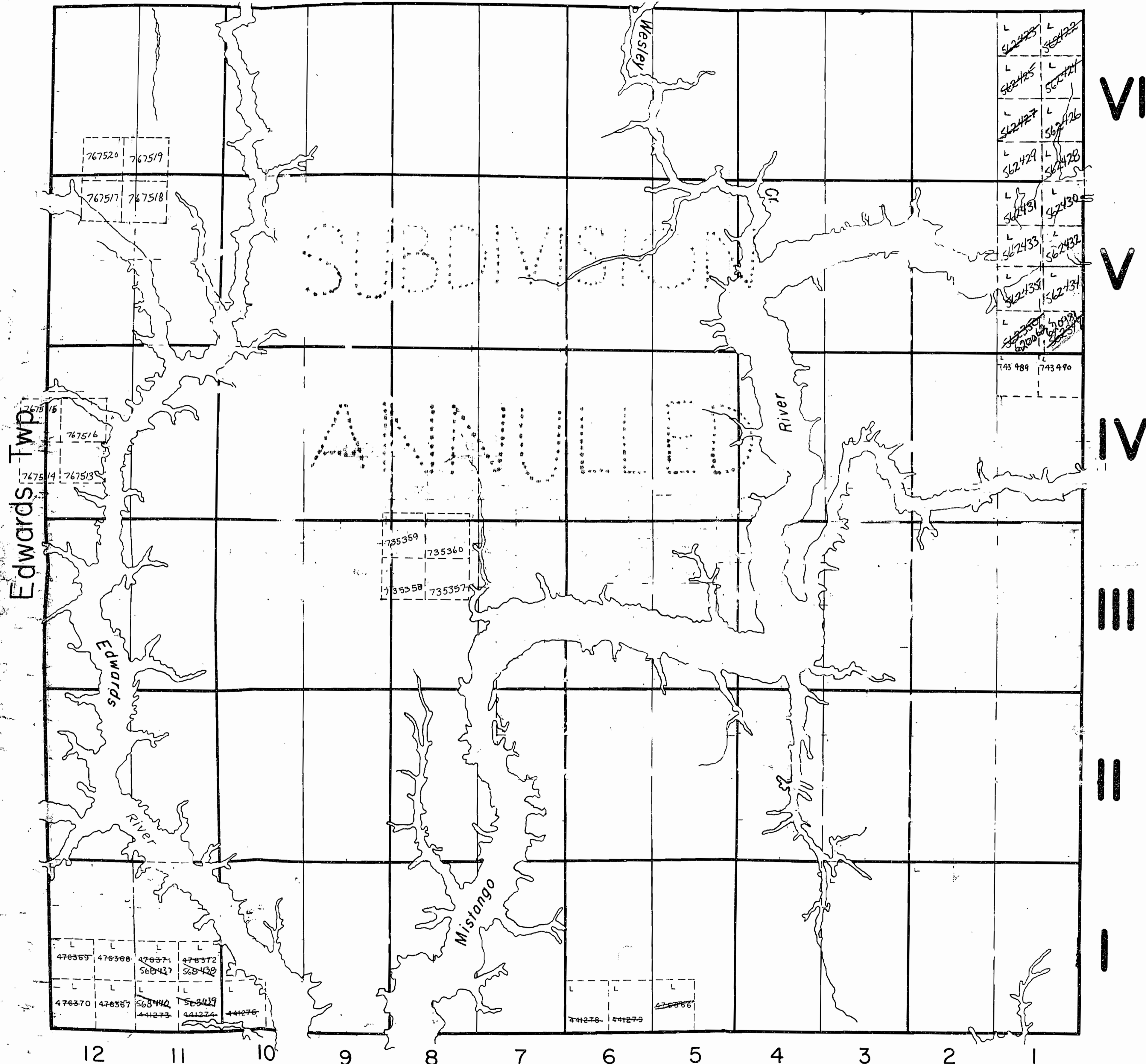

Rickard Twp.

THE TOWNSHIP OF

# WESLEY

DISTRICT OF COCHRANE

LARDER LAKE MINING DIVISION

SCALE: 1-INCH = 40 CHAINS

### LEGEND

PATENTED LAND	Ⓟ
CROWN LAND SALE	C.S.
LEASES	Ⓛ
LOCATED LAND	Loc.
LICENSE OF OCCUPATION	L.O.
ROADS	
IMPROVED ROADS	
RAILWAYS	
POWER LINES	
MARSH OR MUSKEG	

### NOTES

License of Occupation 8674 covers land below 826' & 881' level along shores of Abitibi River, Mistango River, Edwards Cr. & Wesley Cr.

Claims adjoining Mistango R., Edwards R. & Wesley Cr subject to flooding rights.

400' Surface Rights Reservation around all Lakes and Rivers.

PLAN NO. - M-613

ONTARIO  
MINISTRY OF NATURAL RESOURCES  
SURVEYS AND MAPPING BRANCH

G.E.M.

REPLACED August 14-1984 P.S.

Sherring Twp.

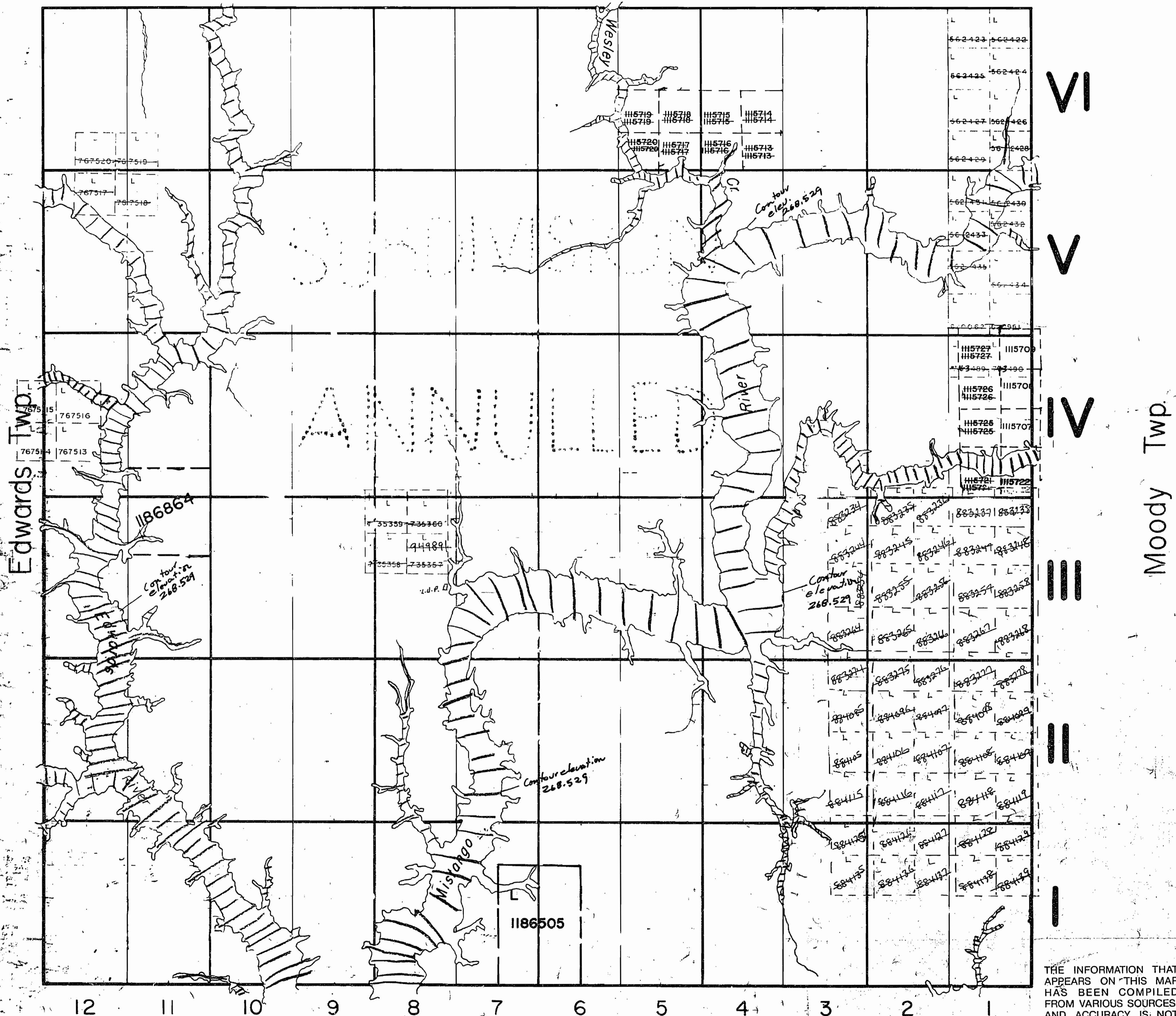

THE TOWNSHIP OF

**WESLEY**

DISTRICT OF COCHRANE

LARDER LAKE MINING DIVISION

SCALE: 1-INCH=40 CHAINS

LEGEND

PATENTED LAND	Ⓟ
CROWN LAND SALE	Ⓢ
LEASES	Ⓛ
LOCATED LAND	Loc.
LICENSE OF OCCUPATION	L.O.
ROADS	—
IMPROVED ROADS	—
RAILWAYS	—
POWER LINES	—
MARSH OR MUSKEG	—

NOTES

License of Occupation 8674 covers land below 826 & 881 level along shores of Abitibi River, Mistango River, Edwards Cr. & Wesley Cr.

Claims adjoining Mistango R., Edwards R. & Wesley Cr. subject to flooding rights

400' Surface Rights Reservation around all Lakes and Rivers

*Abitibi Detroyes Provincial Park*  
To Contour elevation 268.529

NOTICE OF FORESTRY ACTIVITY

THIS TOWNSHIP / AREA FALLS WITHIN THE IROQUOIS FALLS MANAGEMENT UNIT AND MAY BE SUBJECT TO FORESTRY OPERATIONS. THE MNR UNIT FORESTER FOR THIS AREA CAN BE CONTACTED AT: P.O. BOX 730, 2 THIRD AVE, COCHRANE, ONT. POL 1C0, 705-272-4365

PLAN NO - M-613

ONTARIO  
MINISTRY OF NATURAL RESOURCES  
SURVEYS AND MAPPING BRANCH

THE INFORMATION THAT APPEARS ON THIS MAP HAS BEEN COMPILED FROM VARIOUS SOURCES, AND ACCURACY IS NOT GUARANTEED. THOSE WISHING TO STAKE MINING CLAIMS SHOULD CONSULT WITH THE MINING RECORDER, MINISTRY OF NORTHERN DEVELOPMENT AND MINES, FOR ADDITIONAL INFORMATION ON THE STATUS OF THE LANDS SHOWN HEREON.

G.E.M.

REMOVED FROM CIRCULATION AND ARCHIVED ON DEC.01/92

RECEIVED August 14, 1984

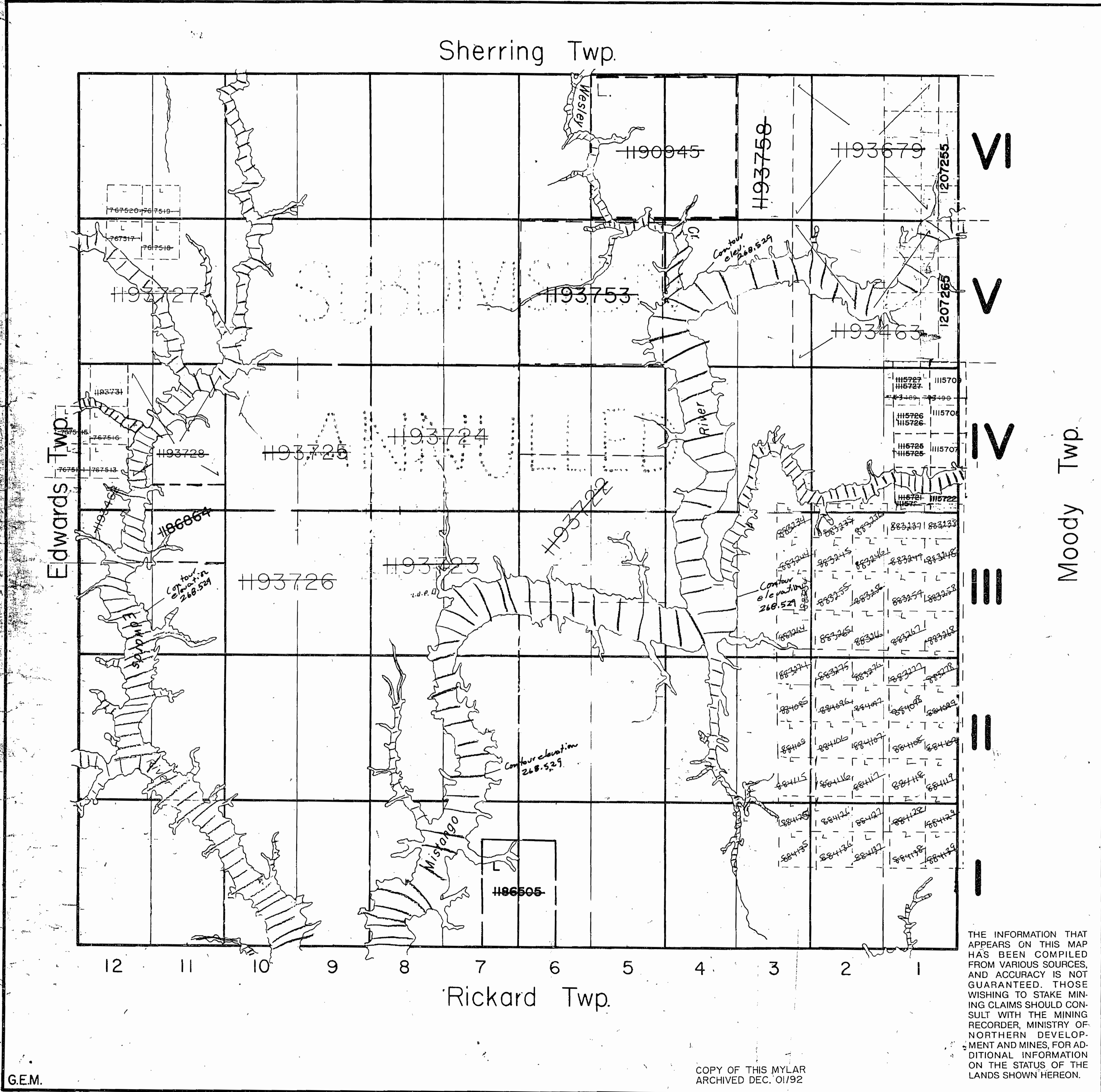

THE TOWNSHIP  
OF  
**WESLEY**  
DISTRICT OF  
COCHRANE  
LARDER LAKE  
MINING DIVISION  
SCALE: 1-INCH=40 CHAINS

**LEGEND**

PATENTED LAND	⊕
CROWN LAND SALE	C.S.
LEASES	⊙
LOCATED LAND	Loc.
LICENSE OF OCCUPATION	L.O.
ROADS	—
IMPROVED ROADS	—
RAILWAYS	—
POWER LINES	—
MARSH OR MUSKEG	—

**NOTES**

License of Occupation 8674 covers land below 826' & 881' level along shores of Abitibi River, Mistango River, Edwards Cr. & Wesley Cr.

Claims adjoining Mistango R., Edwards R. & Wesley Cr. subject to flooding rights

400' Surface Rights Reservation around all Lakes and Rivers

*Abitibi Detroyes Provincial Park*  
To Contour elevation 268.529

**NOTICE OF FORESTRY ACTIVITY**

THIS TOWNSHIP / AREA FALLS WITHIN THE IROQUOIS FALLS MANAGEMENT UNIT AND MAY BE SUBJECT TO FORESTRY OPERATIONS. THE MNR UNIT FORESTER FOR THIS AREA CAN BE CONTACTED AT:

P.O. BOX 730  
2 THIRD AVE.  
COCHRANE, ONT.  
POL 1C0  
705-272-4365

PLAN NO - M-613

ONTARIO  
MINISTRY OF NATURAL RESOURCES  
SURVEYS AND MAPPING BRANCH

THE INFORMATION THAT APPEARS ON THIS MAP HAS BEEN COMPILED FROM VARIOUS SOURCES, AND ACCURACY IS NOT GUARANTEED. THOSE WISHING TO STAKE MINING CLAIMS SHOULD CONSULT WITH THE MINING RECORDER, MINISTRY OF NORTHERN DEVELOPMENT AND MINES, FOR ADDITIONAL INFORMATION ON THE STATUS OF THE LANDS SHOWN HEREON.

G.E.M.

COPY OF THIS MYLAR ARCHIVED DEC. 01/92

ARCHIVED JULY 26/96

RECEIVED August 14, 1984

Sherring Twp

Edwards Twp

Moody Twp

Rickard Twp

THE TOWNSHIP OF  
OF  
**WESLEY**  
DISTRICT OF  
COCHRANE

LARDER LAKE  
MINING DIVISION

SCALE: 1-INCH=40 CHAINS

LEGEND

PATENTED LAND	Ⓟ
CROWN LAND SALE	C.S.
LEASES	Ⓞ
LOCATED LAND	Loc.
LICENSE OF OCCUPATION	L.O.
ROADS	—
IMPROVED ROADS	—
RAILWAYS	—
POWER LINES	—
MARSH OR MUSKEG	—

NOTES

License of Occupation 8674 covers land below 826' & 881' level along shores of Abitibi River, Mistango River, Edwards Cr. & Wesley Cr.

Claims adjoining Mistango R., Edwards R. & Wesley Cr subject to flooding rights.

400' Surface Rights Reservation around all Lakes and Rivers.

 *Abitibi Detroyes Provincial Park*  
To Contour elevation 268.529

NOTICE OF FORESTRY ACTIVITY

THIS TOWNSHIP / AREA FALLS WITHIN THE IROQUOIS FALLS MANAGEMENT UNIT

AND MAY BE SUBJECT TO FORESTRY OPERATIONS. THE MNR UNIT FORESTER FOR THIS AREA CAN BE CONTACTED AT:

P.O. BOX 730  
2 THIRD AVE.  
COCHRANE, ONT.  
P.O. BOX 100  
705-272-4365

#6

PLAN NO - M-613

ONTARIO  
MINISTRY OF NATURAL RESOURCES

SURVEYS AND MAPPING BRANCH

SUBDIVISION  
ANNULLED

VI

V

IV

III

II

I

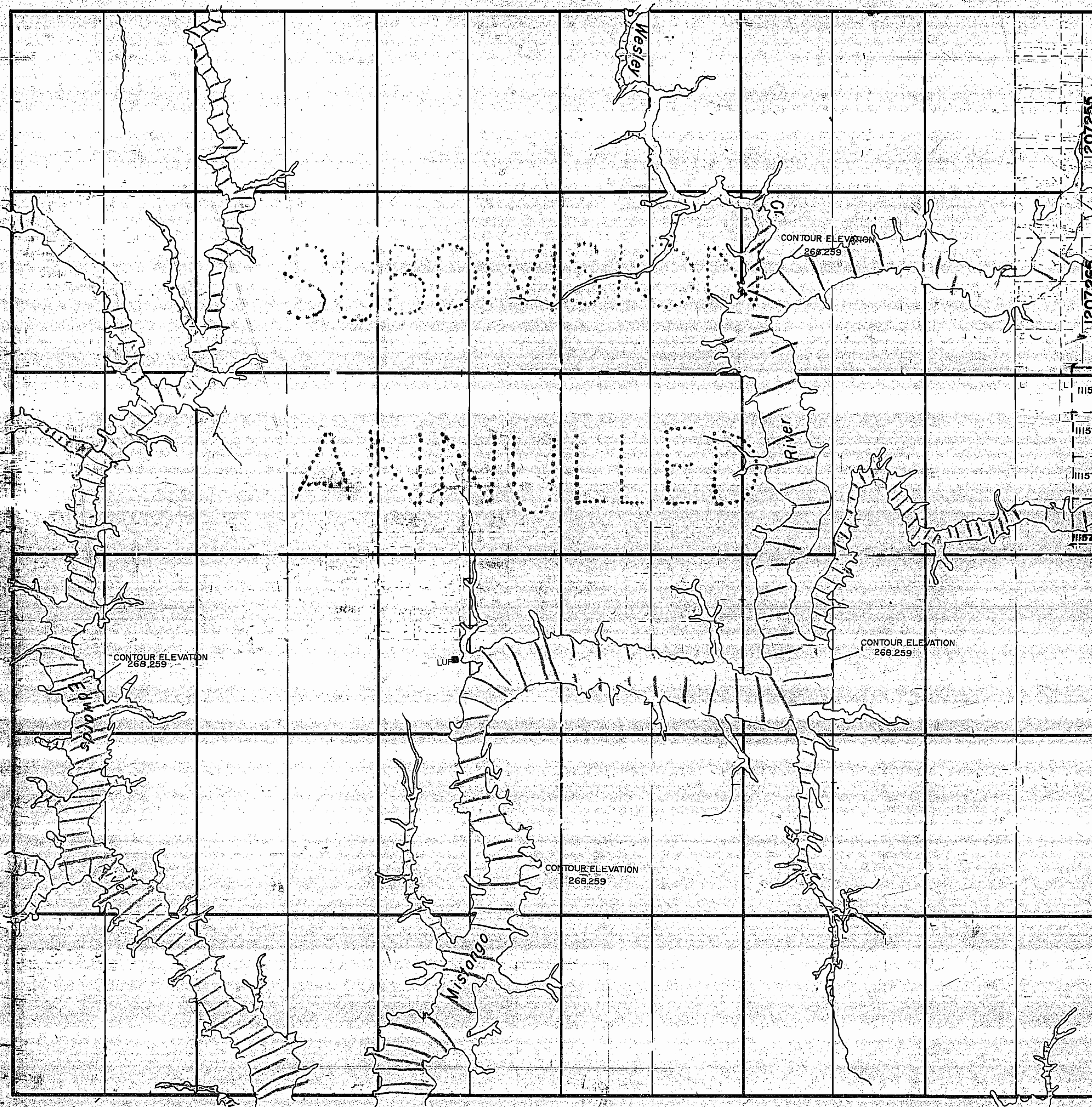

THE INFORMATION THAT APPEARS ON THIS MAP HAS BEEN COMPILED FROM VARIOUS SOURCES, AND ACCURACY IS NOT GUARANTEED. THOSE WISHING TO STAKE MINING CLAIMS SHOULD CONSULT WITH THE MINING RECORDER, MINISTRY OF NORTHERN DEVELOPMENT AND MINES, FOR ADDITIONAL INFORMATION ON THE STATUS OF THE LANDS SHOWN HEREON.

COPY OF THIS MYLAR ARCHIVED DEC. 01/92

ARCHIVED JULY 26/96

RECEIVED August 14, 1984

G.E.M.



613

60

# WESLEY M-613

formerly District of Nipissing now Timistaming  
Scale: 40 cts - 1 inch

